

Kansas Department of Agriculture
 Division of Water Resources
CHANGE: PD WORKSHEET

Document Signature DWB

1. File Number: 23626	2. Status Change Date: 7/5/2016	3. Change Num: C5	4. Field Office: 04	5. GMD: 03
---------------------------------	---	-----------------------------	-------------------------------	----------------------

6. Status: <input checked="" type="checkbox"/> Approved <input type="checkbox"/> Denied by DWR/GMD <input type="checkbox"/> Dismiss by Request/Failure to Return	7. Filing Date of Change: 6/11/2015
--	---

8a. Applicant(s) Person ID _____ New to system <input type="checkbox"/> Add Seq# _____ JERRY GUM 9938 N RD D JOHNSON KS 67855-5504	8c. Landowner(s) Person ID 6642 New to system <input type="checkbox"/> Add Seq# _____ MARY ELLEN GUM JERRY GUM 9938 N RD D JOHNSON KS 67855-5504 8cc. Landowner(s) Person ID 10867 New to system <input type="checkbox"/> Add Seq# _____ M & G FARMS MARTIE FLOYD & GARY FLOYD 6190 N ROAD G JOHNSON KS 67855-8861
---	---

8b. Landowner(s) Person ID 40622 New to system <input type="checkbox"/> Add Seq# _____ DOUGLAS F & RENELL M BELL 1 FORD DRIVE COLBY KS 67701	8d. WUC Person ID 40626 New to system <input type="checkbox"/> Add Seq# _____ 8b
--	--

9. Documents and Enclosure(s): <input checked="" type="checkbox"/> DWR Meter(s) Date to Comply: 12/31/16 <input checked="" type="checkbox"/> N & P Date to Comply: 12/31/16	
<input checked="" type="checkbox"/> Check Valve	<input type="checkbox"/> N & P Form
<input type="checkbox"/> Conservation Plan	<input type="checkbox"/> Water Tube <input type="checkbox"/> Driller Copy <input type="checkbox"/> H & E Letter
Date Required: _____ Date Approved: _____ Date to Comply: _____	

10. Use Made of Water From: _____ To: _____

Date Prepared: 6/23/16 By: LI
Date Entered: 7/6/2016 By: LCM

File No. **23626** 11. County: **ST** Basin: **BEAR CREEK** Stream: **NA** Formation Code: **211 & 331** Special Use: **NA**

12. Points of Diversion										Rate and Quantity				
MOD DEL ENT	PDIV	Qualifier	S	T	R	ID	'N	'W	Comment	Authorized		Additional		Overlap PD Files
										Rate gpm	Quantity af	Rate gpm	Quantity af	
MOD	8947	NE SE NE	17	27	39W	2	3649	410	GPS UPDATE	860	605	860	605	NONE
ENT	84882	NW SE NW	16	27	39W	9	3361	3496		285	202	285	202	20247

ID 9 IS ADDITIONAL WELL AND HAS THE PRIORITY OF JUNE 11, 2015 UNDER THIS RIGHT

13. Storage: Rate _____ NF Quantity _____ ac/ft Additional Rate _____ NF Additional Quantity _____ ac/ft

14. Limitation: _____ af/yr at _____ gpm (_____ cfs) when combined with file number(s) _____
 Limitation: _____ af/yr at _____ gpm (_____ cfs) when combined with file number(s) _____

15. 5YR Allocation: Allocation Type _____ Start Year _____ 5 YR Amount _____ Amount Unit _____ Base Acres _____ Comment _____

16. Place of Use MOD DEL ENT	T PUSE	S	T	R	ID	NE¼				NW¼				SW¼				SE¼				Total	Owner	Chg?	Overlap Files
						NE ¼	NW ¼	SW ¼	SE ¼	NE ¼	NW ¼	SW ¼	SE ¼	NE ¼	NW ¼	SW ¼	SE ¼	NE ¼	NW ¼	SW ¼	SE ¼				
CK	67539	9	27	39W	2													30.75	30.75	30.75	30.75	123	8b	NO	9687 10146 20247
MOD	26799	9	27	39W	1									31.0	31.0	31.0	31.0					124	8cc	YES	9687 10146 20247
MOD	8355	17	27	39W	1	40	40	40	40	33.5	18.0	33.5	40.0	40.0	40.0	40.0	40.0	40.0	40.0	40.0	15.0	580	8cc	YES	9687 10146 20247
CK	22691	16	27	39W	2					30.75	30.75	30.75	30.75									123	8b	NO	9687 10146 20247

Comments: **ACRES NOT CHANGING MOD IS FOR OWNERSHIP UPDATE PER EMAIL FROM STANTON CO REGISTER OF DEEDS**

KANSAS DEPARTMENT OF AGRICULTURE
Division of Water Resources

M E M O R A N D U M

TO: Files

DATE: June 16, 2016

FROM: Leslie Ireland

RE: Water Right, File No. 23,626

The widower, Mary Ellen Gum, as owner of the currently authorized places of use has filed an application for approval to change the point of diversion authorized for irrigation use which was executed on April 30, 2015, and received in the office of the Chief Engineer on June 8, 2015. This application for change proposes to add an existing well as an **additional well** and will be processed by K.A.R. 5-5-16, *Additional well*. The rights water use correspondent will remain as designated.

The referenced water right is considered in good standing as per K.S.A. 82a-718 and K.S.A. 82a-732. Since the filing of the change the owner has conveyed a portion of the place of use to Douglas F. and Renell M. Bell. The Northwest Quarter (NW¼) of Section 16 and the Southeast Quarter of Section 9 (SE¼) of Section 9, both in Township 27, Range 39 West, Stanton County, are now owned by the Bells. The application for change was submitted with a requested waiver of K.A.R. 5-23-3(a).

The applicants propose to add an existing well that had been constructed as a well for the referenced file and currently authorized by File No. 20,247. Historically, File No. 23,626 and 20,247 have authorized the wells involved in the requested change. The currently authorized point of diversion located in the NE¼ SE¼ NE¼, approximately 3,630 feet North and 150 feet West of the Southeast corner of Section 17, Township 27, Range 39W, Stanton County, (Referenced as the **NE Well**) will provide rate and quantity to the additional well located in the (SE¼ NW¼) recently determined to be 3,361 feet North and 3,496 feet West of the Southeast corner of Section 16, Township 27, Range 39W, Stanton County, (Referenced as **NW Well**). The proposed existing well location was determined to be approximately 2,114 feet to the Southeast of the well presently authorized. The description of the additional well, **NW Well**, matches that of File No. 20,247 that currently authorizes the proposed additional well. It would appear that the move would be acceptable pursuant to GMD No. 3, K.A.R. 5-23-3(b) maximum allowed move of 2,640 feet from the currently authorized and completed point of diversion.

The referenced file is authorized 960 acre-feet (AF) at a rate of 1,460 gallons per minute (GPM), with no additional limitations. The place of use for the referenced file is 950 acres that is also authorized by File Nos. 9,687; 10,146 & 20,247. The maximum acres of 480 acres was determined by staff at the Garden City Field Office. As required the determination of the quantity for the consumptive use calculation as required by K.A.R. 5-5-16(a)(2)(C)(i):

$$(480 \text{ acres} \times 1.43 \text{ (80\%NIR HS Co.)}) \div 0.85 = 807 \text{ acre-feet}$$

It appears the referenced file will require the authorized quantity to be reduced from 960 to 807 acre-feet. The owners to assigned a quantity of 605 acre-feet to the NE Well and 202 acre-feet to be assigned to the NW Well. The assigned quantity complies with K.A.R. 5-5-16 (d).

As required by K.A.R. 5-5-16(a)(3)(A) a rate test was conducted by DWR in August of 2015. The currently authorized well, **NE well**, produced an acceptable rate of 1,142.5 gallons per minute or 1,145 gallons per minute with our rounding rules. The owners have reduced the rate to a maximum rate of 1,145 gallons per minute (2.55 c.f.s.) and designated the division of the rate with the quantity. The additional well, **NW well**, will be assigned 202 AF at 285 gpm, (0.64 c.f.s.). The currently authorized point of diversion, NE well, will retain 860 AF at 605 gpm (1.35 c.f.s.). The application complies with the rate requirements of the additional well regulation.

The presently authorized and proposed well has had its source of supply determined to be the Ogallala Formation (211) and the unconfined Dakota Formation (331). The depth to water for the referenced file's well was last reported in 1997, had a depth of 210 feet to water with an overall depth of 600 feet is from the change approval from 2003. The log for the proposed additional well stated a depth to water of 339 feet with a proposed well depth of 565 feet. It would appear that the requirements of K.A.R. 5-5-16(b) have been met.

A check for nearby wells located within one-half ($\frac{1}{2}$) mile of the proposed additional point of diversion listed by KGS-KDHE indicated no domestic wells in its area. The WRIS database indicates there to be three irrigation wells located within one-half ($\frac{1}{2}$) mile of the proposed additional well. The well authorized under File No. 21,903, with an annual limited quantity of 1,056 acre-feet is approximately 1,950 feet from the proposed additional well. This nearby well owner was informed of the proposed change. No comments were submitted to this office and it would appear a comment was received by GMD 3. File Nos. 23,626 and 20,247 have historically pumped from the same well without a history of impairment, and the referenced file will take a reduction of 153 acre-feet, and the requested additional well is mainly due to the ownership of the place of use, with each owner wanting their own well.

Under K.A.R. 5-23-3 (a), *Minimum well spacing requirements: high plains aquifer*, the additional well would require 2,300 feet of well spacing base on the total quantity of 790 acre-feet when combined with File No. 20,247. The existing well will be reduced resulting in 605 acre-feet to be authorized which still requires the 2,300 feet of well to well spacing. This well will also be updated to the GPS determined coordinates of 3,649 feet North and 410 feet West of the Southeast corner of as determined by the June 11, 2015, Compliance Investigation. Based on the quantities that will remain and that the requested move of quantity between the wells is greater than 300 feet and a nearby well is also less than 2,300 feet away, **a waiver of K.A.R. 5-23-3(a) and essentially K.A.R. 5-5-16 (c)(1)** as required by the additional well regulation will be needed. A waiver of K.A.R. 5-23-3(a) was recommended by the Board of GMD 3 on January 14, 2016.

The Board recommendation of the waiver of spacing was summarized in their January 2016 letter that also recommend approval of the change as proposed. Jason Norquist, Assistant Manager, for GMD 3 summarized their recommendation and supplied their nearby notification correspondence. Their nearby notification letter included a graph which indicated a 71 foot decline in the regional average trend of the static water level from 1990 to 2015.

Mike Meyer, Water Commissioner of the Garden City Field Office indicated via email on June 16, 2016, that he had no objection to the proposed change that will add an additional well.

A water flow meter will be required on each well as per K.A.R. 5-5-16(e) and a check valve is required if any chemical or foreign substance is injected through the diversion works. A water level measurement tube will not be required as the recent compliance investigation indicates one is not present. A copy of a WWC-5 will not be required as a stratigraphic log was submitted with the application. As per K.A.R. 5-5-16(a)(4), a condition will be placed on the approval that the administrative priority of the additional well will be June 8, 2015, and the approval will contain the jurisdictional wording as required by K.A.R. 5-5-16(f).

Based on the above discussion, and that the change is reasonable, that impairment to existing water rights is unlikely, that there are no pending applications within the vicinity of this proposed change request that may be affected by this approval and that no change in the local source of supply will occur, it is recommended that the referenced application be approved.

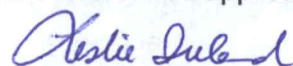

Leslie Ireland
Environmental Scientist
Change Application Unit

Kansas Department of Agriculture
 Division of Water Resources
WAIVER REQUEST & WAIVER RULE WORKSHEET

File Number: 23,626

FO: 4

GMD: 3

WAIVER REQUEST:

UMW	Date Requested	Rule ID	Applies	Rule Type	Rule Subtype
IRR	6/8/2015	147	statewide	Well Spacing Change Apps	Well to Well Spacing
Rule Number	Date Granted	Date Denied	Justification:	The proposed change in point of diversion does not meet the required 2,300 feet of well to well spacing as designated by KAR 5-23-3. GMD 3 recommended approval of the change approval with the requested waiver.	
K.A.R. 5-5-16-(c)(1)	7/5/2016				

WAIVER RULE:

Rule ID	Applicability	Type	Subtype	Rule Number	Date Active	Date Inactive
147	Statewide	Change approval	Well to Well Spacing	K.A.R. 5-5-16(c)(1)		

Date Prepared 6/17/2016 By LI

Date Entered 7/6/2016 By UM

Kansas Department of Agriculture
 Division of Water Resources
WAIVER REQUEST & WAIVER RULE WORKSHEET

File Number: **23,626**

FO: **4**

GMD: **3**

WAIVER REQUEST:

UMW	Date Requested	Rule ID	Applies	Rule Type	Rule Subtype
IRR	6/8/2015	27	GMD 3	Well Spacing Change Apps	Well to Well Spacing
Rule Number	Date Granted	Date Denied	Justification:		
K.A.R. 5-23-3(a)(1)	7/5/2016		The proposed change in point of diversion does not meet the required 2,300 feet of well to well spacing for the quantity authorized. Spacing is to a well that serves the same place of use, and the well authorized by the change and an overlapping right. Right was reduced in rate and quantity to comply with KAR 5-5-16. Area has no history of impairment. GMD 3 recommended approval of the change approval with the requested waiver.		

WAIVER RULE:

Rule ID	Applicability	Type	Subtype	Rule Number	Date Active	Date Inactive
				K.A.R.		

Date Prepared **6/17/2016** By **LI**

Date Entered **7/5/2016** By **LM**

THE STATE



OF KANSAS

KANSAS DEPARTMENT OF AGRICULTURE
Jackie McClaskey, Secretary of Agriculture

DIVISION OF WATER RESOURCES
David W. Barfield, Chief Engineer

WAIVER OF REGULATION
K.A.R. 5-5-16(c)(1)

Date: 7/5/10
Re: File No. 23,626

That K.A.R. 5-5-16(c)(1) states in part, that the additional well shall meet the well spacing requirements to all other wells with a priority earlier than the date the change application was filed.

1. The referenced file is located within the boundaries of the Southwest Kansas Groundwater Management District No. 3 (GMD 3) which requires wells meet the spacing requirements, in this case 2,300 feet as detailed in K.A.R. 5-23-3.
2. That the Southwest Groundwater Management District No. 3, recommended a waiver of part (a) of K.A.R. 5-23-3.
3. That the waiver will not prejudicially or unreasonably affect the public interest.

Comments:

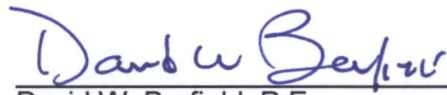

David W. Barfield, P.E.
Chief Engineer
Division of Water Resources

THE STATE



OF KANSAS

KANSAS DEPARTMENT OF AGRICULTURE
Jackie McClaskey, Secretary of Agriculture

DIVISION OF WATER RESOURCES
David W. Barfield, Chief Engineer

WAIVER OF REGULATION
K.A.R. 5-23-3(a)

Date: 7/5/2016
Re: File No. 23,626

1. That K.A.R. 5-23-3(a) states in part, that the minimum well spacing shall be based on the authorized maximum annual quantity of water and requested for the proposed well or authorized and requested by a senior application, permit or water right, if the change in point of diversion is greater than 300 feet and does not improve the well to well spacing.
2. The owners propose an additional well by moving quantity and rate to an existing well under File No. 23,626, moving it more than 300 feet to an existing well that had been authorized by the right and currently authorized by another right.
3. That the assignment of the quantities per well require 2,300 feet of well to well spacing per the regulation. The proposed and existing well, also authorized by File No. 20,247, do not meet the required spacing to each other, and the proposed existing also authorized by File No. 20,247, does not meeting the required spacing to the well authorized under File No. 21,903.
4. The overall quantity will be reduced from 960 to 807 acre-feet, with its rate being reduced from 1,460 to 1,145 gallons per minute, with portions assigned to the existing wells.
5. The authorized quantities will correlate more with the ownership of the land.
6. The wells have historically pumped more water to the same place of use that is also served by other water rights from different wells, without a history of impairment.
7. That the Southwest Groundwater Management District No. 3, recommended a waiver of part (a) of K.A.R. 5-23-3.
8. That the waiver will not prejudicially or unreasonably affect the public interest.

Comments:

A handwritten signature in blue ink that reads "David W. Barfield".

David W. Barfield, P.E.
Chief Engineer
Division of Water Resources

1320 Research Park Drive
Manhattan, Kansas 66502
(785) 564-6700



900 SW Jackson, Room 456
Topeka, Kansas 66612
(785) 296-3556

Jackie McClaskey, Secretary

Governor Sam Brownback

July 7, 2016

MARY ELLEN GUM
JERRY GUM
9938 N RD D
JOHNSON KS 67855-5504

RE: Water Right, File No. 23,626

Dear Mr. Gum:

Enclosed is the order executed by the Chief Engineer, Division of Water Resources, Kansas Department of Agriculture, approving the application for change under the above referenced file number.

Your attention is directed to the enclosures and to the terms, conditions, and limitations specified in this approval for change. A condition of this approval is that an acceptable water flowmeter must be installed on the diversion works authorized under the referenced file number. Please return the required, *Notification of the Completion of the Diversion Works*, prior to December 31, 2016.

Since this order modifies the original document referred to above, it should be recorded with the Register of Deeds as other instruments affecting real estate.

The application is approved subject to the condition that for the sole purpose of administering wells concerning direct impairment, the point of diversion approved by this order shall be considered to have the priority of the date the application was filed (June 8, 2015).

If you have any questions, please contact Leslie Ireland, Environmental Scientist, at (785) 564-6633. If you wish to discuss a specific file, please have the file number ready so that we may help you more efficiently.

Sincerely,

Brent A. Turney, P.G.
Change Applications Unit Supervisor

BAT:LI:li
Enclosures

pc: Garden City Field Office
Groundwater Management District No. 3
Douglass F. & Renell M. Bell
Martie Floyd

THE STATE



OF KANSAS

KANSAS DEPARTMENT OF AGRICULTURE
Jackie McClaskey, Secretary of Agriculture

DIVISION OF WATER RESOURCES
David W. Barfield, Chief Engineer

**APPROVAL OF APPLICATION
FOR
CHANGE IN POINT OF DIVERSION
WATER RIGHT
FILE NO. 23,626**

The Chief Engineer, Division of Water Resources, Kansas Department of Agriculture, after due consideration of the written application of Mary Ellen Gum, 9938 North Road D, Johnson, Kansas 67855-5504 along with Douglas F. and Renell M. Bell, of 1 Ford Drive, Colby, Kansas 67701, and Martie Floyd, on behalf of M & G Farm, 6190 N. Road G, Johnson, Kansas 67855-8861, received in the Office of the Chief Engineer on June 11, 2015, for approval of a change in the location of the point of diversion, under the certificate of appropriation issued pursuant to the application for permit to appropriate water for beneficial use, as modified and amended by the orders of the Chief Engineer dated December 20, 2002 and December 23, 2003, approving the applications to change the point of diversion, and by the order of the Chief Engineer dated September 2, 2009, approving the application to change the point of diversion and place of use along with the order of the Chief Engineer dated June 24, 2015, approving the application to change the place of use, finds that the change is reasonable and will not impair existing rights, that the change relates to the same local source of supply and that the application should be and is hereby approved.

This order effectively reduces the maximum rate of diversion to 1,145 gallons per minute (2.55 c.f.s) and the authorized quantity of water not to exceed 807 acre-feet per calendar year.

The effective date of the change shall be the date this order is executed by the Chief Engineer, after which the authorized location of the point of diversion shall be:

one (1) well located in the Northeast Quarter of the Southeast Quarter of the Northeast Quarter (NE $\frac{1}{4}$ SE $\frac{1}{4}$ NE $\frac{1}{4}$) of Section 17, more particularly described as being near a point 3,649 feet North and 410 feet West of the Southeast corner of said section at a diversion rate not in excess of 860 gallons per minute (1.92 c.f.s) and a quantity not to exceed 605 acre-feet of water per calendar year, and

one (1) well located in the Northwest Quarter of the Southeast Quarter of the Northwest Quarter (NW $\frac{1}{4}$ SE $\frac{1}{4}$ NW $\frac{1}{4}$) of Section 16, more particularly described as being near a point 3,361 feet North and 3,496 feet West of the Southeast corner of said section at a diversion rate not in excess of 285 gallons per minute (0.63 c.f.s) and a quantity not to exceed 202 acre-feet of water per calendar year,

both in Township 27 South, Range 39 West, Stanton County, Kansas,

located substantially as shown on the topographic map accompanying the application to change the point of diversion.

Installation of the works for diversion of water shall be completed on or before December 31, 2016, or within any authorized extension of time. The applicant shall notify the Chief Engineer of the Division of Water Resources, Kansas Department of Agriculture, when construction of the works for diversion has been completed.

The application, therefore, is approved subject to the condition that for the sole purpose of administering wells concerning direct impairment, the additional well shall be considered to have the priority of the date the application was filed (June 11, 2015) to add the additional well.

The water right owner shall properly install an acceptable water meter on the diversion works authorized under this water right, prior to the use of water, in strict accordance with the Kansas Administrative Regulations 5-1-4 through 5-1-12 adopted by the Chief Engineer. The water right owner shall notify the Chief Engineer when installation of the water meter has been completed. The water right owner shall maintain the water meter in an operating condition satisfactory to the Chief Engineer, at all times during diversion of water and shall maintain records from which the total quantity of water diverted may be determined. The water right owner shall also report the reading of said water meter and the total quantity of water diverted annually to the Chief Engineer. Such records shall be furnished to the Chief Engineer by March 1 following the end of each calendar year.

All diversion works shall be equipped with an in-line, automatic, quick-closing check valve capable of preventing pollution of the source of the water supply. The type of valve installed shall meet specifications adopted by the Chief Engineer and shall be maintained in an operating condition satisfactory to the Chief Engineer.

In all other respects, the Certificate of Appropriation issued pursuant to Approval of Application, File No. 23,626, for permit to appropriate water for beneficial use, is as stated and set forth in the Certificate of Appropriation dated December 21, 1984, as modified and amended by the aforementioned orders.

This Order shall become a final agency action, as defined by K.S.A. 77-607(b), without further notice to the parties, if a request for hearing or a petition for administrative review is not filed as set forth below.

Request for Hearing. According to K.A.R. 5-14-3(c), any party who desires a hearing must submit a request within 15 days after the date shown on the Certificate of Service attached to this Order. Filing a request for a hearing will give you the opportunity to submit additional facts for consideration, contest any findings made by the Chief Engineer or present any other information you believe should be considered in this matter. A timely-filed request for hearing will stay the deadline for requesting administrative review of this Order pending the outcome of the hearing.

Petition for Review. Any person aggrieved by this Summary Order may petition for administrative review, pursuant to K.S.A. 82a-708b(a) and K.S.A. 82a-1901(a). The petition must be filed within 30 days after the date shown on the Certificate of Service attached to this Order and must set forth the basis for the review, unless stayed by the timely filing of a request for hearing.

Any request for hearing or petition for administrative review shall be in writing and shall be submitted to the attention of: Chief Legal Counsel, Kansas Department of Agriculture, 1320 Research Park Drive, Manhattan, Kansas 66502, Fax: (785) 564 - 6777.

Ordered this 5th day of July, 2016, at Topeka, Shawnee County, Kansas.

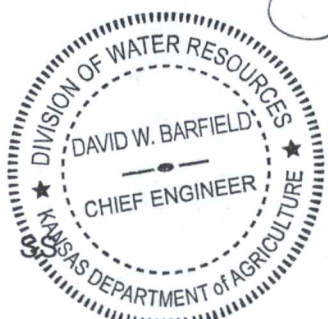

David W. Barfield
David W. Barfield, P.E.
Chief Engineer
Division of Water Resources
Kansas Department of Agriculture

State of Kansas)
County of Riley)

The foregoing instrument was acknowledged before me this 5th day of July, 2016, by David W. Barfield, P.E., Chief Engineer, Division of Water Resources, Kansas Department of Agriculture.



Karen Hunter
Notary Public

CERTIFICATE OF SERVICE

On this 7th day of July 2016, I hereby certify that the attached Approval of Application for Change in Point of Diversion, Water Right, File No. 23,626, dated July 5th 2016 was mailed postage prepaid, first class, US mail to the following:

Mary Ellen Gum
Jerry Gum
9938 N Road D
Johnson, KS 67855-5504

With a True & Correct Copy to:

Douglas F. & Renell M. Bell
1 Ford Drive
Colby, KS 67701

M & G Farms
Martie Floyd
6190 N Road G
Johnson, KS 67855-8861

With photocopies sent to:

Garden City Field Office
Groundwater Management District No. 3

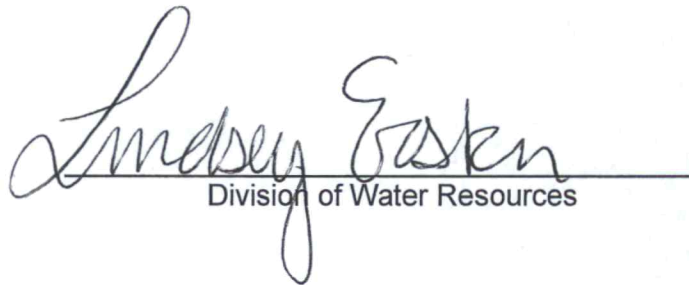
Division of Water Resources

Submit To: CHIEF ENGINEER
Division of Water Resources
Kansas Department of Agriculture
1320 Research Park Drive
Manhattan, Kansas 66502
http://agriculture.ks.gov/dwr

**APPLICATION FOR APPROVAL TO
CHANGE THE PLACE OF USE, THE
POINT OF DIVERSION OR THE USE
MADE OF THE WATER UNDER AN
EXISTING WATER RIGHT**



State of Kansas

*Filing Fee Must Accompany the Application
(Please refer to Fee Schedule on signature page of application form.)*

Paragraph Nos. 1, 2, 3, 4 & 8 must be completed. Complete all other applicable portions. A topographic map or detailed plat showing the authorized and proposed points(s) of diversion and /or place of use must accompany this application.

1. Application is hereby made for approval of the Chief Engineer to change the

- (Check one or more)
- Place of Use
 - Point of Diversion
 - Use Made of Water

WATER RESOURCES
RECEIVED

JUN 11 2015

RECEIVED
1:54 pm
JUN 08 2015
Garden City Field Office
Division of Water Resources

File No. 23626

KS DEPT OF AGRICULTURE

WATER RESOURCES
RECEIVED

2. Name of applicant: JERRY GUM

Address: 9338 N RD D

City, State and Zip: JOHNSON KS 67855-5504

Phone Number: () E-mail address: _____

What is your relationship to the water right; owner tenant agent other? If other, please explain. _____

Name of water use correspondent: NO CHANGE

Address: _____

City, State and Zip: _____

Phone Number: () E-mail address: _____

3. The change(s) proposed herein are desired for the following reasons (please be specific): TO MOVE

RATE AND QUANTITY TO A NEARBY WELL (ADDITIONAL WELL REQUEST)

The change(s) (was) (will be) completed by 2015

(Date)

For Office Use Only:

F.O. 4 GMD 3 Meets K.A.R. 5-5-1 (YES/NO) Use IRR Source G/S County ST By KAB Date 6/11/15
Code _____ Fee \$ 200.00 TR # _____ Receipt Date 6-8-15 Check # 4018

of \$1000.00

4. The presently authorized place of use is:

Owner of Land — NAME: NO CHANGE MARY ELLEN GUM c/o JERRY GUM
 ADDRESS: 9938 N RD D, JOHNSON KS 67855

Sec.	Twp.	Range	NE¼				NW¼				SW¼				SE¼				TOTAL ACRES
			NE¼	NW¼	SW¼	SE¼	NE¼	NW¼	SW¼	SE¼	NE¼	NW¼	SW¼	SE¼	NE¼	NW¼	SW¼	SE¼	
17	27	39W	40	40	40	40	33.5	18.0	33.5	40	40	40	40	40	40	40	18	580	
9	27	39W								31.0	31.0	31.0	31.0					124.0	
																	TOTAL	764.0	

List any other water rights that cover this place of use. 9687, 10146 & 29247

Owner of Land — NAME: NO CHANGE DOUGLAS F. RENELL M. BELL
 ADDRESS: 1 FORD DRIVE, COLBY KS 67701

Sec.	Twp.	Range	NE¼				NW¼				SW¼				SE¼				TOTAL ACRES
			NE¼	NW¼	SW¼	SE¼	NE¼	NW¼	SW¼	SE¼	NE¼	NW¼	SW¼	SE¼	NE¼	NW¼	SW¼	SE¼	
16	27	39W					30.75	30.75	30.75	30.75								123.0	
9	27	39W												30.75	30.75	30.75	30.75	123.0	
																	TOTAL	246.0	

List any other water rights that cover this place of use. 9687, 10146 & 20247

(If there are more than two landowners, attach additional sheets as necessary.)

TOTAL 950.00

5. It is proposed that the place of use be changed to:

Owner of Land — NAME: NO CHANGE
 ADDRESS: _____

Sec.	Twp.	Range	NE¼				NW¼				SW¼				SE¼				TOTAL ACRES
			NE¼	NW¼	SW¼	SE¼	NE¼	NW¼	SW¼	SE¼	NE¼	NW¼	SW¼	SE¼	NE¼	NW¼	SW¼	SE¼	

List any other water rights that cover this place of use. _____

Owner of Land — NAME: NO CHANGE
 ADDRESS: _____

Sec.	Twp.	Range	NE¼				NW¼				SW¼				SE¼				TOTAL ACRES
			NE¼	NW¼	SW¼	SE¼	NE¼	NW¼	SW¼	SE¼	NE¼	NW¼	SW¼	SE¼	NE¼	NW¼	SW¼	SE¼	

List any other water rights that cover this place of use. _____

IF MORE SPACE IS NEEDED ATTACH ADDITIONAL SHEETS AS NECESSARY

DEPT OF AGRICULTURE RECEIVED

WATER RESOURCES RECEIVED

JUN 17 2016

JUN 11 2015

**APPLICATION TO
CHANGE THE POINT OF DIVERISON
FILE NO. 23626**

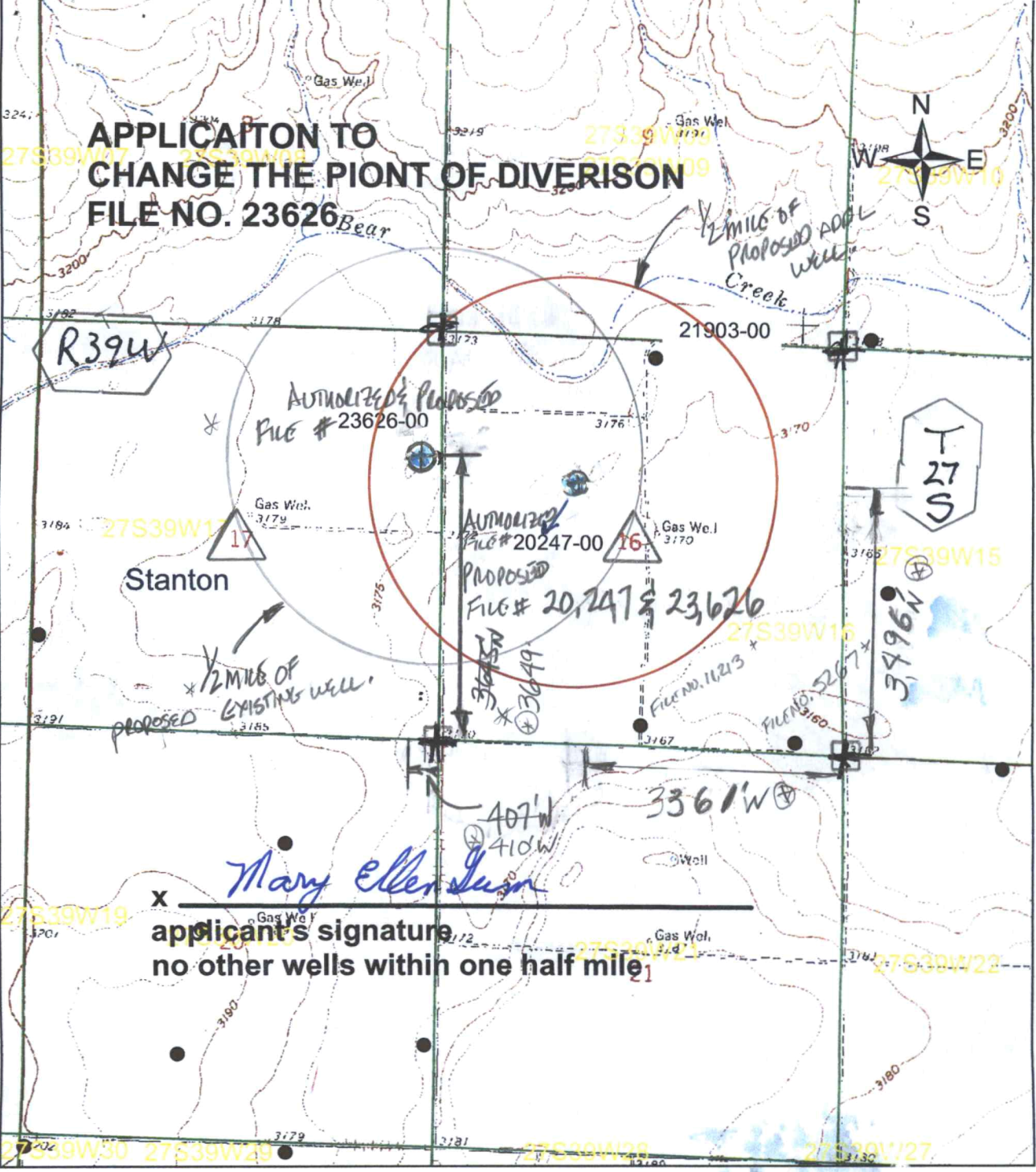

x **Mary Ellen Jun**
applicant's signature
no other wells within one half mile

⊗ LI/DWR 10/16/15

WATER RESOURCES RECEIVED

JUN 17 2016

KS DEPT OF AGRICULTURE

WATER RESOURCES RECEIVED

JUN 11 2015

KS DEPT OF AGRICULTURE

SCANNED

6. The presently authorized point(s) of diversion is one
(Provide description and number of points)

7. The proposed point(s) of diversion (is) (are) two
(Provide description and number of points)

List all presently authorized point(s) of diversion:

8. **Presently authorized point of diversion:**
 One in the NE Quarter of the SE Quarter of the NE Quarter of Section 17, Township 27 South, Range 39 W, in ST County, Kansas, 3630 feet North 150 feet West of Southeast corner of section. Authorized Rate 1460 GPM Authorized Quantity 960 AF
 (DWR use only: Computer ID No. 02 GPS 37.70317 feet North -101.60036 feet West)
 This point will not be changed This point will be changed as follows:
Proposed point of diversion: (Complete only if change is requested)
 One in the NE Quarter of the SE Quarter of the NE Quarter of Section 17, Township 27 South, Range 39 W, in ST County, Kansas, 3649 feet North 419 feet West of Southeast corner of section. Proposed Rate 860 GPM Proposed Quantity 605 AF
 This point is: Additional Well Geo Center List other water rights that will use this point _____

** COMPLIANCE INVESTIGATION * LE/DAW*

9. **Presently authorized point of diversion:**
 One in the _____ Quarter of the _____ Quarter of the _____ Quarter of Section _____, Township _____ South, Range _____ (EW), in _____ County, Kansas, _____ feet North _____ feet West of Southeast corner of section. Authorized Rate _____ Authorized Quantity _____
 (DWR use only: Computer ID No. _____ GPS _____ feet North _____ feet West)
 This point will not be changed This point will be changed as follows:
Proposed point of diversion: (Complete only if change is requested)
 One in the NW* Quarter of the NCSE SE* Quarter of the NW Quarter of Section 16, Township 27 South, Range 39 W, in ST County, Kansas, 3361 feet North 3395 feet West of Southeast corner of section. Proposed Rate 285 GPM Proposed Quantity 202 AF feet description based on GPS
 This point is: Additional Well Geo Center List other water rights that will use this point 20247

** WELL APPROVED DEC 2, 2015 PER 20,247*

10. **Presently authorized point of diversion:**
 One in the _____ Quarter of the _____ Quarter of the _____ Quarter of Section _____, Township _____ South, Range _____ (EW), in _____ County, Kansas, _____ feet North _____ feet West of Southeast corner of section. Authorized Rate _____ Authorized Quantity _____
 (DWR use only: Computer ID No. _____ GPS _____ feet North _____ feet West)
 This point will not be changed This point will be changed as follows:
Proposed point of diversion: (Complete only if change is requested)
 One in the _____ Quarter of the _____ Quarter of the _____ Quarter of Section _____, Township _____ South, Range _____ (EW), in _____ County, Kansas, _____ feet North _____ feet West of Southeast corner of section. Proposed Rate _____ Proposed Quantity _____
 This point is: Additional Well Geo Center List other water rights that will use this point _____

LE/DAW 1/15/16

11. Describe the current condition of and future plans for any point(s) of diversion which will no longer be used.

WATER RESOURCES RECEIVED
JUN 17 2016

NOTE: FILE NO. 20247 WELL LOCATION PER 12/2/15 CHOTIN PD.

WATER RESOURCES RECEIVED
JUN 11 2015

12. The presently authorized use of water is for IRR purposes.

It is proposed that the use be changed to NO CHANGE purposes.

13. If changing the place of use and/or use made of water, describe how the consumptive use will not be increased.

KAR 5-5-16.

(Please show any calculations here.)

14. It is requested that the maximum annual quantity of water be reduced to 807 AF TOTAL (acre-feet or million gallons).

15. It is requested that the maximum rate of diversion of water be reduced to 1145 gallons per minute (2.55 c.f.s.).

16. The application must include either a topographic map or detailed plat. A U.S. Geological Survey Topographic Map, scale 1:24,000, is available through the Kansas Geological Survey, 1930 Constant Avenue, University of Kansas, Lawrence, Kansas 66047-3726 (www.usgs.gov). The map should show the location of the presently authorized point(s) of diversion. Distances North and West of the Southeast corner of the section must be shown. The presently authorized place of use should also be shown. Identify the center of the section, the section lines and the section corners and show the appropriate section, township, and range numbers on the map. In addition the following information must also be shown on the map.

a. If a change in the location of the point(s) of diversion is proposed, show:

- 1) The location of the proposed point(s) of diversion. Distances North and West of the Southeast corner of the section must be shown. Please be certain that the information shown on the map agrees with the information shown in Paragraph Nos. 9, 10 and 11 of the application.
- 2) If the source of supply is groundwater, please show the location of existing water wells of any kind, including domestic wells, within ½ mile of the proposed well or wells. Identify each well as to its use and furnish name and mailing address of the property owner or owners. If there are no wells within ½ mile, please indicate so on the map.
- 3) If the source of supply is surface water, the names and mailing addresses of all landowner(s) ½ mile downstream and ½ mile upstream from your property lines must be shown.

b. If a change in the place of use is desired, show the proposed place of use by crosshatching on the map. Please be certain that the information shown on the map agrees with the information shown in Paragraph No. 5 of the application.

17. Attach documentation to show the change(s) proposed herein will not impair existing water rights and relates to the same local source of supply as to which the water right relates. This information may include statements, plats, geology reports, well logs, test hole logs, and other information as necessary information to show the above. Additional comments may be made below.

NO CHANGE IN LOCAL SOURCE OF SUPPLY OR SOURCE OF SUPPLY. A SIMILAR APPROVAL WAS GRANTED 9-2-2009 WITH WAIVER. WELLS ARE HAVE SAME DEPTH OF 650-665 FEET DEEP. WELL LOCATIONS ARE PARALLEL TO BEAR CREEK AND ARE IN THE OGALLALA.

18. If the proposed change(s) does not meet all applicable rules and regulations of the Kansas Water Appropriation Act, please identify the rules and regulations for which you request a waiver. State the reason why a waiver is needed and why the request should be granted. Attach documentation showing that granting the request will not impair existing water rights and will not prejudicially and unreasonably affect the public interest.

WIAVER 5-23-3 AS SPACING DOES NOT MEET THE REQUIREMENTS TODAY. THE WELL ARE 2116 FEET APART.

QUANTITY MOVING TO THE PROPOSED WELL IS LESS THE WELL HAD ORGINALLY

IF MORE SPACE IS NEEDED, ATTACH ADDITIONAL SHEETS AS NECESSARY

WATER RESOURCES

JUN 17 2016

KS DEPT OF AGRICULTURE

SCANNED

WATER RESOURCES
RECEIVED

JUN 11 2015

KS DEPT OF AGRICULTURE

Any use of water that is not as authorized by the water right or permit to authorize water before the chief engineer approves this application is a violation of the Kansas Water Appropriation Act for which criminal or civil penalties may be assessed. Such violation is a class C misdemeanor, punishable by a fine not to exceed \$500 and/or a term of confinement not to exceed one month in the county jail. K.S.A. 82a-728(b). Civil penalties shall be not less than \$100 nor more than \$1,000 per violation. In the case of a continuing violation, each day such violation continues may be deemed a separate violation. In addition to these penalties the water right may be modified or suspended. K.S.A. 82a-737, as amended.

The application must be signed by all owners of the place of use authorized under the water right and his or her spouse, if married. Please indicate if there is no spouse. If land is being purchased under contract, the seller must sign as landowner until such time as the contract is completed.

In the event that all applicants cannot appear before one notary public, they may as necessary sign separate copies of the application before any notary public conveniently available to them. All copies signed in this manner shall be considered to be valid parts of the application.

If the request is signed on behalf of any Owner by someone with legal authority to do so (for example, an agent, one who has power of attorney, or an executor, executrix, conservator), it will be necessary to attach proper documents showing such authority.

I declare that I am an owner of the currently authorized place of use as identified herein, or that I represent all such owners and am authorized to make this application on their behalf, and declare further that the statements contained herein are true, correct, and complete. By filing this application I authorize the chief engineer to permanently reduce the quantity of water and/or rate of diversion as specified in sections 14 and 15 of this application.

Dated at Johnson, Kansas, this 30th day of April, 2015.

<u>Mary Ellen Gumm</u> (Owner)	_____	(Spouse)
<u>Mary Ellen Gumm</u> (Please Print)	_____	(Please Print)
_____	_____	(Spouse)
(Owner)	_____	(Please Print)
_____	_____	(Spouse)
(Please Print)	_____	(Please Print)
_____	_____	(Spouse)
(Owner)	_____	(Please Print)
_____	_____	(Spouse)
(Please Print)	_____	(Please Print)

State of Kansas }
County of Stanton } SS

I hereby certify that the foregoing application was signed in my presence and sworn to before me this 30th day of April, 2015.



Bonnie C. Montoya
Notary Public

My Commission Expires _____

FEE SCHEDULE

Each application to change the place of use, the point of diversion or the use made of the water under this section shall be accompanied by the application fee set forth in the schedule below:

- (1) Application to change a point of diversion 300 feet or less \$100
- (2) Application to change a point of diversion more than 300 feet \$200
- (3) Application to change the place of use \$200
- (4) Application to change the use made of the water \$300

Make check payable to Kansas Department of Agriculture.

WATER RESOURCES RECEIVED

JUN 17 2016

KS DEPT OF AGRICULTURE

WATER RESOURCES RECEIVED

JUN 11 2015

KS DEPT OF AGRICULTURE

SCANNED

Any use of water that is not as authorized by the water right or permit to authorize water **before** the chief engineer approves this application is a violation of the Kansas Water Appropriation Act for which criminal or civil penalties may be assessed. Such violation is a class C misdemeanor, punishable by a fine not to exceed \$500 and/or a term of confinement not to exceed one month in the county jail. K.S.A. 82a-728(b). Civil penalties shall be not less than \$100 nor more than \$1,000 per violation. In the case of a continuing violation, each day such violation continues may be deemed a separate violation. In addition to these penalties the water right may be modified or suspended. K.S.A. 82a-737, as amended.

The application must be signed by all owners of the place of use authorized under the water right and his or her spouse, if married. Please indicate if there is no spouse. If land is being purchased under contract, the seller must sign as landowner until such time as the contract is completed.

In the event that all applicants cannot appear before one notary public, they may as necessary sign separate copies of the application before any notary public conveniently available to them. All copies signed in this manner shall be considered to be valid parts of the application.

If the request is signed on behalf of any Owner by someone with legal authority to do so (for example, an agent, one who has power of attorney, or an executor, executrix, conservator), it will be necessary to attach proper documents showing such authority.

I declare that I am an owner of the currently authorized place of use as identified herein, or that I represent all such owners and am authorized to make this application on their behalf, and declare further that the statements contained herein are true, correct, and complete. By filing this application I authorize the chief engineer to permanently reduce the quantity of water and/or rate of diversion as specified in sections 14 and 15 of this application.

Dated at Johnson, Kansas, this 7th day of June, 20 16.

Mary Ellen Gum
(Owner) _____ (Spouse) _____

Mary Ellen Gum
(Please Print) _____ (Please Print) _____

M & C Farms Martie Floyd
(Owner) _____ (Spouse) _____

M & C Farms Martie Floyd
(Please Print) _____ (Please Print) _____

(Owner) _____ (Spouse) _____

(Please Print) _____ (Please Print) _____

State of Kansas)
County of Stanton) SS

I hereby certify that the foregoing application was signed in my presence and sworn to before me this 7th day of June, 20 16.



Stephanie Dickson
Notary Public

My Commission Expires 2-26-2018

FEE SCHEDULE

Each application to change the place of use, the point of diversion or the use made of the water under this section shall be accompanied by the application fee set forth in the schedule below:

- (1) Application to change a point of diversion 300 feet or less \$100
- (2) Application to change a point of diversion more than 300 feet \$200
- (3) Application to change the place of use \$200
- (4) Application to change the use made of the water \$300

Make check payable to **Kansas Department of Agriculture.**

WATER RESOURCES RECEIVED

JUN 7 2016

KS DEPT OF AGRICULTURE

Any use of water that is not as authorized by the water right or permit to authorize water **before** the chief engineer approves this application is a violation of the Kansas Water Appropriation Act for which criminal or civil penalties may be assessed. Such violation is a class C misdemeanor, punishable by a fine not to exceed \$500 and/or a term of confinement not to exceed one month in the county jail. K.S.A. 82a-728(b). Civil penalties shall be not less than \$100 nor more than \$1,000 per violation. In the case of a continuing violation, each day such violation continues may be deemed a separate violation. In addition to these penalties the water right may be modified or suspended. K.S.A. 82a-737, as amended.

The application must be signed by all owners of the place of use authorized under the water right and his or her spouse, if married. Please indicate if there is no spouse. If land is being purchased under contract, the seller must sign as landowner until such time as the contract is completed.

In the event that all applicants cannot appear before one notary public, they may as necessary sign separate copies of the application before any notary public conveniently available to them. All copies signed in this manner shall be considered to be valid parts of the application.

If the request is signed on behalf of any Owner by someone with legal authority to do so (for example, an agent, one who has power of attorney, or an executor, executrix, conservator), it will be necessary to attach proper documents showing such authority.

I declare that I am an owner of the currently authorized place of use as identified herein, or that I represent all such owners and am authorized to make this application on their behalf, and declare further that the statements contained herein are true, correct, and complete. By filing this application I authorize the chief engineer to permanently reduce the quantity of water and/or rate of diversion as specified in sections 14 and 15 of this application.

Dated at COLBY, Kansas, this 4th day of February, 20 16.

[Signature]
(Owner)

[Signature]
(Spouse)

(Please Print)

(Please Print)

(Owner)

(Spouse)

(Please Print)

(Please Print)

(Owner)

(Spouse)

(Please Print)

(Please Print)

State of Kansas }
County of Thomas } SS

I hereby certify that the foregoing application was signed in my presence and sworn to before me this 4th day of February, 20 16.

[Signature]
Notary Public

My Commission Expires May 26, 2018.

FEE SCHEDULE

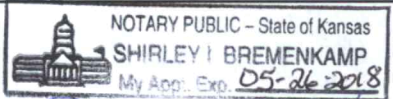

Each application to change the place of use, the point of diversion or the use made of the water under this section shall be accompanied by the application fee set forth in the schedule below:

- (1) Application to change a point of diversion 300 feet or less \$100
- (2) Application to change a point of diversion more than 300 feet \$200
- (3) Application to change the place of use \$200
- (4) Application to change the use made of the water \$300

Make check payable to **Kansas Department of Agriculture.**

WATER RESOURCES RECEIVED

FEB 12 2016

KS DEPT OF AGRICULTURE

Ireland, Leslie

From: Stanton County Register of Deeds <stcorod@pld.com>
Sent: Wednesday, June 22, 2016 4:31 PM
To: Ireland, Leslie
Subject: RE: Water Right Ownership

On 6-13-Gum sold to M & G Farms Sec 17-27-39 & S/2 9-27-39. Deed book 61, Pages 312 & 313. My records indicate the last deed of record on NW/4 16-27-39 was to Mary Ellen Gum, etal.

Susan

From: Ireland, Leslie [<mailto:Leslie.Ireland@KDA.KS.GOV>]
Sent: Tuesday, June 21, 2016 10:45 AM
To: stcorod@pld.com
Subject: FW: Water Right Ownership

Sorry to bother you, but I looked at that signature again and our records and it is Martie Floyd, not Martin.

Leslie Ireland

From: Ireland, Leslie
Sent: Tuesday, June 21, 2016 10:07 AM
To: 'stcorod@pld.com'
Subject: Water Right Ownership

The Division of Water Resources is processing an application for change to Water Right, File No. 23626 shown in our records to be owned by May Ellen Gum along with Douglas & Renell Bell. Could you please check your records for a recent deed or sale information showing Martin Floyd, M&G Farms as a new owner of any portion of the following property:

All of Sec 17, Twn 27, Rng 39W
South half of Sec 9, Twn 27, Rng 39W
NW Quarter of Sec 16, Twn 27, Rng 39W

Thank you.

Leslie Ireland, Environmental Scientist II
Kansas Department of Agriculture
Division of Water Resources - Change Unit
(785) 564-6633
Leslie.Ireland@kda.ks.gov
www.agriculture.ks.gov

COPY



**STATE OF KANSAS }
STANTON COUNTY } SS.**

This instrument was filed for record on the
14 day of May 2015
at 1:55 o'clock P M and duly recorded
in Book 61 Page 69 Fee \$ 20.00
Suzanne L. Lucas
Register of Deeds

**WARRANTY DEED
(Water Rights Only)**

Date: May
April 4, 2015

Grantors: **Mary Ellen Gum, a widow, as to her undivided one-half (1/2) interest, and Mary Ellen Gum, Jerry A. Gum and Suzanne Gum, as Co-Executors of the Estate of Lewis M. Gum, deceased, as to its undivided one-half (1/2) interest,**

Grantees: **Douglas F. Bell and Renell M. Bell,**

Grantors, for valuable consideration, convey and warrant to Grantees as joint tenants with the right of survivorship and not as tenants in common, the whole estate to vest in the survivor in the event of the death of either, the following described real property in Stanton County, Kansas, to wit:

All of Appropriation Water Right File No. 20,247, appurtenant to the following described lands located in Stanton County, Kansas:

- 124 acres in the SW¼ of Section 9-T27S-R39W,
- 122 acres in the SE¼ of Section 9-T27S-R39W,
- 124 acres in the NW¼ of Section 16-T27S-R39W,
- 160 acres in the NE¼ of Section 17-T27S-R39W,
- 116 acres in the NW¼ of Section 17-T27S-R39W,
- 160 acres in the SW¼ of Section 17-T27S-R39W, and
- 144 acres in the SE¼ of Section 17-T27S-R39W,

as more particularly described in the files and records of the Division of Water Resources, Kansas State Board of Agriculture,

SUBJECT TO the terms and conditions contained in a written agreement between Grantor and Grantees dated April 4, 2015, under the title of "AGREEMENT CONCERNING APPROPRIATION WATER RIGHT FILE NUMBERS 9,687, 10,146, 20,247 and 23,626."

SIGNED:

Mary Ellen Gum
MARY ELLEN GUM, Individually

Mary Ellen Gum
MARY ELLEN GUM, Co-Executor of the
Estate of Lewis M. Gum, deceased

WATER RESOURCES
RECEIVED

JUN 17 2016

KS DEPT OF AGRICULTURE

SCANNED

Jerry A. Gum
JERRY A. GUM, Co-Executor of the
Estate of Lewis M. Gum, deceased

Suzanne Gum
SUZANNE GUM, Co-Executor of the
Estate of Lewis M. Gum, deceased

STATE OF KANSAS, COUNTY OF Stanton, ss.

This Warranty Deed was acknowledged before me on the 4 day of ~~April~~ ^{May}, 2015, by
Mary Ellen Gum, in her individual capacity and as Co-Executor of the Estate of Lewis M. Gum, deceased.

Tina Schwieterman
Notary Public

My Appointment Expires: 5/8/2017



STATE OF KANSAS, COUNTY OF Stanton, ss.

This Warranty Deed was acknowledged before me on the 4 day of ~~April~~ ^{May}, 2015, by
Jerry A. Gum, as Co-Executor of the Estate of Lewis M. Gum, deceased.

Tina Schwieterman
Notary Public

My Appointment Expires: 5/8/2017

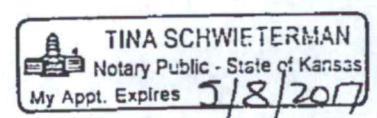

STATE OF KANSAS, COUNTY OF Stanton, ss.

This Warranty Deed was acknowledged before me on the 4th day of ~~April~~ ^{May}, 2015, by
Suzanne Gum, as Co-Executor of the Estate of Lewis M. Gum, deceased.

Lorenza Olivas
Notary Public

My Appointment Expires: 3-16-2019



Pursuant to K.S.A. 79-1437e,
a Real Estate Validation Questionnaire
is not required due to Exception No. 3.

WATER RESOURCES
RECEIVED

JUN 17 2016

KS DEPT OF AGRICULTURE
SCANNED

COPY



STATE OF KANSAS }
STANTON COUNTY } SS.

This instrument was filed for record on the
14 day of May 20 15
at 1:57 o'clock P M and duly recorded
in Book 61 Page 70 Fee \$ 20.00
Susan S. Lucas
Register of Deeds

WARRANTY DEED
(Water Rights Only)

Date: MAY
April 4th, 2015

Grantors: Douglas F. Bell and Renell M. Bell, husband and wife,

Grantees: Mary Ellen Gum, an undivided one-half (1/2) interest, and Mary Ellen Gum, Jerry A. Gum and Suzanne Gum, as Co-Executors of the Estate of Lewis M. Gum, deceased, an undivided one-half (1/2) interest,

Grantors, for valuable consideration, convey and warrant to Grantees, the following described real property in Stanton County, Kansas, to wit:

All of Appropriation Water Right Files Numbered 9,687, 10,146 and 23,626, appurtenant to the following described lands located in Stanton County, Kansas:

- 124 acres in the SW¼ of Section 9-T27S-R39W,
- 122 acres in the SE¼ of Section 9-T27S-R39W,
- 124 acres in the NW¼ of Section 16-T27S-R39W,
- 160 acres in the NE¼ of Section 17-T27S-R39W,
- 116 acres in the NW¼ of Section 17-T27S-R39W,
- 160 acres in the SW¼ of Section 17-T27S-R39W, and
- 144 acres in the SE¼ of Section 17-T27S-R39W,

as more particularly described in the files and records of the Division of Water Resources, Kansas State Board of Agriculture,

SUBJECT TO the terms and conditions contained in a written agreement between Grantor and Grantees dated April 4th, 2015, under the title of "AGREEMENT CONCERNING APPROPRIATION WATER RIGHT FILE NUMBERS 9,687, 10,146, 20,247 and 23,626."

SIGNED:

Douglas F. Bell
DOUGLAS F. BELL

Renell M. Bell
RENELL M. BELL

WATER RESOURCES
RECEIVED

JUN 17 2016

KS DEPT OF AGRICULTURE

SCANLINE

STATE OF KANSAS, COUNTY OF Kansas, ss.

This Warranty Deed was acknowledged before me on the 4th day of May, 2015, by Douglas F. Bell and Renell M. Bell, husband and wife.

Shirley I. Bremenkamp
Notary Public

My Appointment Expires: May 26, 2018

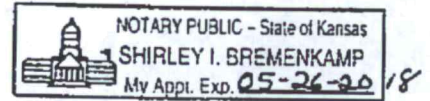

Pursuant to K.S.A. 79-1437e,
a Real Estate Questionnaire is not
required due to Exception No. 3.

WATER RESOURCES
RECEIVED

JUN 17 2016

KS DEPT OF AGRICULTURE

SCANNED

**AGREEMENT CONCERNING
APPROPRIATION WATER RIGHT FILE NUMBERS 9,687, 10,146, 20,247 and 23,626**

THIS AGREEMENT is made on this 4 ^{may} day April, 2015, by and between:

Mary Ellen Gum, a widow, whose address is 9938 North Road D, Johnson, Kansas 67855, as to her undivided one-half (1/2) interest, and **Mary Ellen Gum, Jerry A. Gum and Suzanne Gum, as Co-Executors of the Estate of Lewis M. Gum, deceased**, whose address is c/o Mary Ellen Gum, Co-Executor, 9938 North Road D, Johnson, Kansas 67855, as to its undivided one-half (1/2) interest, collectively referred to in this agreement as "Gum"; and,

Douglas F. Bell and Renell M. Bell, whose address is 1 Ford Drive, Colby, Kansas 67701, together referred to in this agreement as "Bell."

RECITALS:

I. Gum owns the surface estate and appurtenant water rights in the following described land in Stanton County, Kansas, to wit:

All of Section Seventeen (17), Township Twenty-seven (27) South, Range Thirty-nine (39) West of the 6th P.M., and

Southwest Quarter (SW¹/₄) of Section Nine (9), Township Twenty-seven (27) South, Range Thirty-nine (39) West of the 6th P.M.,

referred to in this agreement as "Gum's Land."

II. Bell has purchased from Gum the surface estate and appurtenant water rights in the following described land in Stanton County, Kansas, to wit:

Northwest Quarter (NW¹/₄) of Section Sixteen (16), Township Twenty-seven (27) South, Range Thirty-nine (39) West of the 6th P.M., and

Southeast Quarter (SE¹/₄) of Section Nine (9), Township Twenty-seven (27) South, Range Thirty-nine (39) West of the 6th P.M.,

referred to in this agreement as "Bell's Land."

III. There are four appropriation water rights authorized to irrigate 950 acres of land of which 704 acres are appurtenant to Gum's Land and 246 acres are appurtenant to Bell's Land. The water rights provide a total useable quantity of 1,868 acre-feet for irrigation from three wells that are the authorized points of diversion, of which two wells are located on Gum's Land and one well is located on Bell's Land. As of the date of this agreement, the water rights are described in the files and records of the Division of Water Resources ("DWR") as follows:

Appropriation Water Right No. 9,687 (referred to in this agreement as "AR 9,687"):

Priority Date:	January 13, 1964,
Authorized Use:	Irrigation,
Authorized Quantity:	390 acre-feet per year,
Authorized Diversion Rate:	1,550 gallons per minute,

**WATER RESOURCES
RECEIVED**

JUN 17 2016

KS DEPT OF AGRICULTURE

SCANNED

Authorized Point of Diversion: One well in the NW $\frac{1}{4}$ SW $\frac{1}{4}$ SW $\frac{1}{4}$ of Section 17-T27S-R39W, located 1,200 feet north and 5,200 feet west of the southeast corner of said Section 17 ("Gums SW Well"),

Authorized Place of Use: 124 acres in the SW $\frac{1}{4}$ of Section 9-T27S-R39W, 122 acres in the SE $\frac{1}{4}$ of Section 9-T27S-R39W, 124 acres in the NW $\frac{1}{4}$ of Section 16-T27S-R39W, 160 acres in the NE $\frac{1}{4}$ of Section 17-T27S-R39W, 116 acres in the NW $\frac{1}{4}$ of Section 17-T27S-R39W, 160 acres in the SW $\frac{1}{4}$ of Section 17-T27S-R39W, 144 acres in the SE $\frac{1}{4}$ of Section 17-T27S-R39W, a total of 950 acres;

Appropriation Water Right No. 10,146 ("AR 10,146"):
Priority Date: June 25, 1964,
Authorized Use: Irrigation,
Authorized Quantity: 356 acre-feet per year,
Authorized Diversion Rate: 1,550 gallons per minute (limited to 1,550 gallons per minute combined with AR 9,687; perfecting no (0) gallons per minute in addition to AR 9,687),

Authorized Points of Diversion: The same location as for AR 9,687,
Authorized Place of Use: 950 acres, the same place of use as for AR 9,687;

Appropriation Water Right No. 20,247 ("AR 20,247"):
Priority Date: February 26, 1973,
Authorized Use: Irrigation,
Authorized Quantity: 588 acre-feet per year (limited to 908 acre-feet per year combined with AR 9,687 and AR 10,146 on the 454 acres of land described in the certificate for AR 20,247, perfecting 162 acre-feet in addition to AR 9,687 and AR 10,146);

Authorized Diversion Rate: 1,720 gallons per minute,
Authorized Point of Diversion: One well near the center of the SE $\frac{1}{4}$ NW $\frac{1}{4}$ of Section 16-T27S-R39W, located 3,374 feet north and 3,519 feet west of the southeast corner of said Section 16 (Bell's Well"),

Authorized Place of Use: 950 acres, the same place of use as for AR 9,687 and AR 10,146; and,

Appropriation Water Right No. 23,626 ("AR 23,626"):
Priority Date: February 12, 1975,
Authorized Use: Irrigation,
Authorized Quantity: 960 acre-feet per year;
Authorized Diversion Rate: 1,460 gallons per minute,
Authorized Point of Diversion: One well in the NE $\frac{1}{4}$ SE $\frac{1}{4}$ NE $\frac{1}{4}$ of Section 17-T27S-R39W, located 3,630 feet north and 150 feet west of the southeast corner of said Section 17 ("Gum's NE Well"),

Authorized Place of Use: 950 acres, the same place of use as for AR 9,687, AR 10,146 and AR 20,247.

WATER RESOURCES
RECEIVED

JUN 17 2016

KS DEPT OF AGRICULTURE
SCANNED

IV. The parties desire to enter into an agreement by which each party will become the owner of and have control over the water rights authorized to be diverted from the well or wells located on such party's land, separate and apart from the other party, but subject to agreed terms, conditions and covenants.

AGREEMENT:

IN CONSIDERATION OF the promises, covenants and agreements set forth herein, and for other good and valuable consideration, the parties agree as follows:

1. **GUM'S SEPARATE WATER RIGHTS.** Gum will become the owner of AR 9,687, AR 10,146 and AR 23,626 as Gum's separate water rights. Gum's title in AR 9,687, AR 10,146 and AR 23,626 will be severed from Bell's Land. The authorized place of use for AR 9,687, AR 10,146 and AR 23,626 will remain completely overlapped with AR 20,247 on the 950 acres of land described in the recitals above. Gum will limit total annual diversions of water from Gum's SW Well authorized by AR 9,687 and AR 10,146 to not more than 416 acre-feet per calendar year, so that Bell will be entitled to divert up to 492 acre-feet per calendar year from Bell's Well authorized by AR 20,247 for irrigation of the 246 acres of authorized place of use located on Bell's Land, without violating the annual quantity limitation of 908 acre-feet imposed on AR 9,687, AR 10,146 and AR 20,247.

2. **BELL'S SEPARATE WATER RIGHT.** Bell will become the owner of AR 20,247 as Bell's separate water right to be owned as joint tenants with the right of survivorship, and Bell's title in AR 20,247 will be severed from Gum's Land. The authorized place of use for AR 20,247 will remain completely overlapped with AR 9,687, AR 10,146 and AR 23,626 on the 950 acres of land described in the recitals above. Bell will limit total annual diversions of water from Bell's Well authorized by AR 20,247 to not more than 492 acre-feet per calendar year, so that Gum will be entitled to divert up to 416 acre-feet per calendar year from Gum's SW Well authorized by AR 9,687 and AR 10,146 for irrigation of the 704 acres of authorized place of use located on Gum's Land, without violating the annual quantity limitation of 908 acre-feet imposed on AR 9,687, AR 10,146 and AR 20,247.

3. **SEPARATE OWNERSHIP OF AR 9,687, AR 10,146, AR 20,247 and AR 23,626.** Each party claims no interest in the water rights of the other party, and immediately following the execution of this agreement, the parties will exchange warranty deeds, subject only to the conditions and covenants stated in this agreement, as follows:

- a. Gum will convey title in AR 20,247 by warranty deed to Bell, including the portion of such water right that is appurtenant to Gum's Land, and;
- b. Bell will convey title in AR 9,687, AR 10,146 and AR 23,626 by warranty deed to Gum, including the portion of such water rights that is appurtenant to Bell's Land.

4. **OPTION TO DIVIDE AND CHANGE AR 23,626.** Gum will have to option at any time to submit a request to DWR to divide AR 23,626 into two separate water rights. Each of the subdivided water rights will include an authorized rate of diversion sufficient to fully divert the authorized annual quantity of the subdivided water right during an irrigation season of not greater than eight months. On DWR's administrative division of AR 23,626 into two separate water rights, Gum will have the option at any time to change the location of the authorized point of diversion of one of the subdivided water rights from Gum's NE Well to the location of Bell's Well. By virtue of this agreement Bell will be deemed to have preapproved Gum's application to change the point of diversion of the subdivided water right under AR 23,626 to Bell's Well, and Gum may present DWR with a copy of this agreement as proof of legal access to the point of

WATER RESOURCES
RECEIVED

JUN 17 2016

SCANNED

diversion of Bell's Well. On DWR's approval of the change of the location of the authorized point of diversion to the well on Bell's Land, Bell will be deemed to have accepted the change and will automatically become the owner of the subdivided water right, with title severed from Gum's Land. Gum will convey title in the subdivided water right by warranty deed to Bell, including the portion of such subdivided water right that is appurtenant to Gum's Land. Bell will be authorized to divert water from Bell's Well under the subdivided water right for the irrigation of the authorized place of use on Bell's Land. Thereafter, Bell's right under this agreement to divert 492 acre-feet per calendar year under AR 20,247 for irrigation of the 246 acres of authorized place of use located on Bell's Land will automatically be reduced on a 1:1 ratio, acre-foot for acre-foot, by the authorized annual quantity transferred by Gum to Bell's Well under the subdivided water right under AR 23,626. Simultaneously, Gum's right under this agreement to divert 416 acre-feet per calendar year from AR 9,687 and AR 10,146 for irrigation of the 704 acres of authorized place of use located on Gum's Land, will automatically be increased on a 1:1 ratio, acre-foot for acre-foot, by the authorized annual quantity transferred by Gum to Bell's Well under the subdivided water right under AR 23,626. After application of the automatic quantity reduction to AR 20,247 and the automatic quantity increase to AR 9,687 and AR 10,146 on transfer of quantity under the subdivided water right under AR 23,626, the combined total under this agreement of Bell's annual quantity under AR 20,247 and Gum's annual quantity under AR 9,687 and AR 10,146 will equal the annual quantity limitation of 908 acre-feet imposed on AR 9,687, AR 10,146 and AR 20,247.

5. CHANGES IN THE LOCATION OF POINTS OF DIVERSION. Subject to the limitations set forth in this paragraph, at any time after the execution of this agreement either Gum or Bell may file an application to change the location of the authorized point of diversion of any water right described in this agreement owned by either of them without the consent of the other party. All such changes shall be subject to the following limitation: no party may, without the written consent of the other party, change the location of an authorized point of diversion to a new location that would, by application of well spacing regulations, reduce or eliminate potential replacement well site locations of the other party that exist as of the date of this agreement. However, the limitation imposed by the preceding sentence will not apply to a so-called "short move" that is exempt from spacing regulations, for example the relocation of a well within 300 as currently exempted under K.A.R. 5-23-3(c)(1).

6. PRIOR AGREEMENTS. Except as expressly stated herein, this agreement is not intended to alter, amend, revoke, supersede, modify or replace any pre-existing agreements between the parties, or any pre-existing easements, rights-of-way, licenses, rights, options or other interests either party may have in the land described herein.

7. CONSTRUCTION AND SEVERABILITY. Paragraph headings are intended to be used for reference and shall not be used in the construction of this agreement. If any part of this agreement is determined unlawful or unenforceable, the parties will engage in a good faith effort to reform this agreement to the extent necessary to make the same lawful and enforceable, within the intent and spirit of this agreement. If such specific part or paragraph is not capable of reformation and if such specific part or paragraph is not interdependent and may be severed from other parts of this agreement, then such offensive part or parts shall be deemed removed from this agreement, and the balance of the agreement shall remain in full force and effect.

8. MODIFICATION AND AMENDMENT. No future amendment or modification of this agreement will be binding, unless and until the same is set forth in writing, signed by all parties.

9. **GOVERNING LAW.** This agreement shall be governed by, construed and enforced in accordance with the laws of the State of Kansas.

10. **BINDING EFFECT COVENANT RUNNING WITH TITLE.** This agreement will be binding upon and inure to the benefit of the respective parties and their successors and assigns. Further, the agreements, conditions and covenants set forth herein are covenants running with the title to the water rights and the lands described herein, binding upon and inuring to the benefit of the subsequent owners of such water rights and lands, however acquired.

SIGNED:

Mary Ellen Gum
Mary Ellen Gum, an individual

Estate of Lewis Gum, deceased, by:

Suzanne Gum
Suzanne Gum, co-executor

Jerry A Gum
Jerry A Gum, co-executor

Mary Ellen Gum
Mary Ellen Gum, co-executor

Douglas F. Bell
Douglas F. Bell

Renell M. Bell
Renell M. Bell

STATE OF KANSAS, COUNTY OF Stanton, ss:

The foregoing agreement was acknowledged before me on this 4 day of May April, 2015, by Mary Ellen Gum, an unmarried individual.

Tina Schwieterman
Notary Public

My Appointment Expires: 5/8/2017

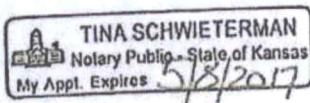

STATE OF KANSAS, COUNTY, ss: COUNTY OF Stanton, ss:

The foregoing agreement was acknowledged before me on this 4 day of May April, 2015, by Mary Ellen Gum, Jerry A. Gum and Suzanne Gum as co-executors of the Estate of Lewis M. Gum, deceased.

Tina Schwieterman
NOTARY PUBLIC

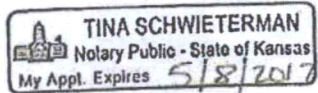

My Appointment Expires: 5/8/2017

STATE OF KANSAS, COUNTY OF Thomas, ss:

The foregoing agreement was acknowledged before me on this 6th day of May April, 2015, by Douglas F. Bell and Renell M. Bell, husband and wife.

Shirley I. Bremerkamp
Notary Public

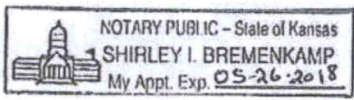

My Appointment Expires: May 26, 2018

WATER RESOURCES
RECEIVED

JUN 17 2016

KS DEPT OF AGRICULTURE

Ireland, Leslie

From: Meyer, Mike
Sent: Thursday, June 16, 2016 3:45 PM
To: Ireland, Leslie
Subject: RE: Recommendation for Change in Point of Diversion, File No. 23,626 Gum

I recommend approval

From: Ireland, Leslie
Sent: Thursday, June 16, 2016 12:29 PM
To: Meyer, Mike <Mike.Meyer@KDA.KS.GOV>
Subject: Recommendation for Change in Point of Diversion, File No. 23,626 Gum

Mike,

This is the summary for the change that will add an additional well for Gum & Bell. I guess Gum brought the original application it into your office and was mailed here by Julie.

As always comments and concerns are welcome.

Leslie Ireland, Environmental Scientist II
Kansas Department of Agriculture
Division of Water Resources - Change Unit
(785) 564-6633
Leslie.Ireland@kda.ks.gov
www.agriculture.ks.gov

1320 Research Park Drive
Manhattan, Kansas 66502
(785) 564-6700



900 SW Jackson, Room 456
Topeka, Kansas 66612
(785) 296-3556

Jackie McClaskey, Secretary

Governor Sam Brownback

February 9, 2016

JERRY GUM
9938 N RD D
JOHNSON KS 67855-5504

RE: Water Right, File No. 23,626

Dear Mr. Gum:

Reference is made to the application for approval of the Chief Engineer to change the point of diversion under the referenced file number which was received on June 11, 2015. Per my letter of January 20, 2016, and K.A.R. 5-5-5, *Signatures required on change application*, requires that the Division of Water Resources, obtain a notarized signature from each landowner and their spouse, or a duly authorized agent. The signatures of Douglas F. & Renell M. Bell have not been received, nor any additional correspondence regarding the application.

The Kansas Water Appropriation Act further affords that a water right is appurtenant to and severable from the land and may be conveyed by deed, lease, mortgage, or other means. If the extent of the ownership has been determined and Bells have conveyed the ownership of the water right please provide documentation to that effect.

The application has been enclosed so that the required signature(s) or information may be submitted. In order for the application retain its priority of filing the enclosed application, notarized signatures or ownership information must be returned to this office on or before **February 24, 2016**, or should you need to request additional time beyond the 15 days you must do so in writing, before the 15 day period expires.

According to law, default in the refilling of the application and requested information as outlined above within the time allowed or any authorized extension of time, shall cause dismissal of the application for change under the above referenced file number.

If you have any questions, please contact me at (785) 564-6633. If you wish to discuss a specific file, please have the file number ready so that I may help you more efficiently.

Sincerely,

Leslie Ireland
Change Application Unit
Division of Water Resources
Kansas Department of Agriculture

Enclosures

pc: Garden City Field Office
Groundwater Management District No. 3

FILE COPY



Southwest Kansas
Groundwater Management District No. 3
2009 E. Spruce Street
Garden City, Kansas 67846
(620) 275-7147 phone (620) 275-1431 fax
www.gmd3.org

January 14, 2016

Leslie Ireland
Kansas Department of Agriculture
Division of Water Resources
1320 Research Park Drive
Manhattan, Kansas 66502

RE: Change Applications, Additional Well
Water Right, File No. 23,626

Dear Leslie:

We have completed a review of the application for the above referenced water right. The proposal is in conflict with the Management Program of the Southwest Kansas Groundwater Management District No. 3 (GMD3). The additional well criteria has not been met in accordance with KAR 5-5-16. The spacing to the original well and neighboring wells is not in accordance with K.A.R. 5-23-3. We reviewed this application with the Board at our January 13, 2016 meeting.

The applicant, Jerry Gum, was in attendance to discuss this application with the Board as well. It was noted that the additional well is not a new well, but stacking authority on a well already authorized by Water Right 20,247. The needed spacing of 2300' is not met to the original well under 23,626 or a neighboring well under Water Right 21,903. In accordance with the additional well rule, Water Right 23, 626 will take an overall reduction of 153AF. The applicant applied for this change in order to equalize the authority on the two wells as part of an arrangement to sell off a portion of the place of use to another owner. Mr. Gum stated that part of the sale was a mutual agreement between parties that would in effect reduce the pumping of both wells equally and that he does not see this as a negative effect on the area aquifer. He also stated that if the application does not get approved, he would have a negative impact of his operation. Staff mentioned that they had received a response from their notice letter that was sent out to neighboring wells. After further discussion, the Board recommended a waiver to K.A.R. 5-23-3(a)(1) based on the fact that the original wells did not meet spacing and parties involved have agreed to limit pumping authority and reductions in order to have a more balanced authority between the two wells. Two members of our Board abstained from the vote due to one being the tenant of part of the place of use of the application and the other was a nearby neighbor with interest in the local water supply. It is therefore recommended that waiver to K.A.R. 5-23-3(a)(1) be granted and the application be approved at this time.

Thank you for the opportunity to review the applications and to provide a recommendation. If you have any questions, please don't hesitate to contact us.

Sincerely,

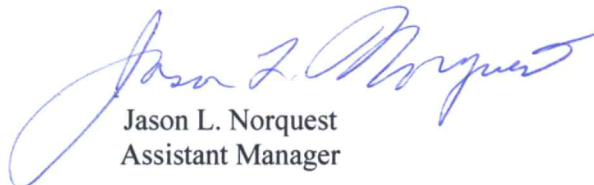

Jason L. Norquest
Assistant Manager

WATER RESOURCES
RECEIVED

JAN 19 2016
SCANNED

SCANNED

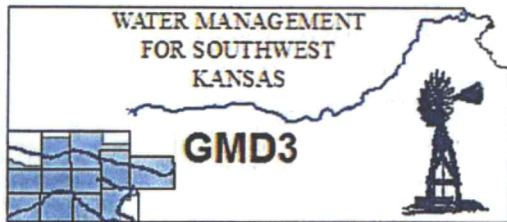
KS DEPT OF AGRICULTURE



Southwest Kansas
Groundwater Management District No. 3
2009 E. Spruce Street
Garden City, Kansas 67846
(620) 275-7147 phone (620) 275-1431 fax
www.gmd3.org

January 14, 2016

Leslie Ireland
Kansas Department of Agriculture
Division of Water Resources
1320 Research Park Drive
Manhattan, Kansas 66502

RE: Change Applications, Additional Well
Water Right, File No. 23,626

Dear Leslie:

We have completed a review of the application for the above referenced water right. The proposal is in conflict with the Management Program of the Southwest Kansas Groundwater Management District No. 3 (GMD3). The additional well criteria has not been met in accordance with KAR 5-5-16. The spacing to the original well and neighboring wells is not in accordance with K.A.R. 5-23-3. We reviewed this application with the Board at our January 13, 2016 meeting.

The applicant, Jerry Gum, was in attendance to discuss this application with the Board as well. It was noted that the additional well is not a new well, but stacking authority on a well already authorized by Water Right 20,247. The needed spacing of 2300' is not met to the original well under 23,626 or a neighboring well under Water Right 21,903. In accordance with the additional well rule, Water Right 23, 626 will take an overall reduction of 153AF. The applicant applied for this change in order to equalize the authority on the two wells as part of an arrangement to sell off a portion of the place of use to another owner. Mr. Gum stated that part of the sale was a mutual agreement between parties that would in effect reduce the pumping of both wells equally and that he does not see this as a negative effect on the area aquifer. He also stated that if the application does not get approved, he would have a negative impact of his operation. Staff mentioned that they had received a response from their notice letter that was sent out to neighboring wells. After further discussion, the Board recommended a waiver to K.A.R. 5-23-3(a)(1) based on the fact that the original wells did not meet spacing and parties involved have agreed to limit pumping authority and reductions in order to have a more balanced authority between the two wells. Two members of our Board abstained from the vote due to one being the tenant of part of the place of use of the application and the other was a nearby neighbor with interest in the local water supply. It is therefore recommended that waiver to K.A.R. 5-23-3(a)(1) be granted and the application be approved at this time.

Thank you for the opportunity to review the applications and to provide a recommendation. If you have any questions, please don't hesitate to contact us.

Sincerely,

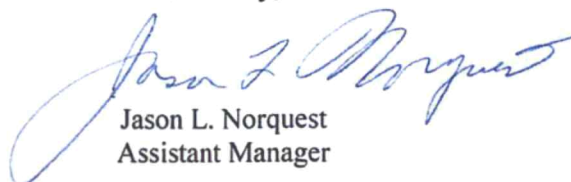

Jason L. Norquest
Assistant Manager

GMD3 Change Review

Change Application(s); PD, Add Well
 File No(s). 23626, Jerry Gum

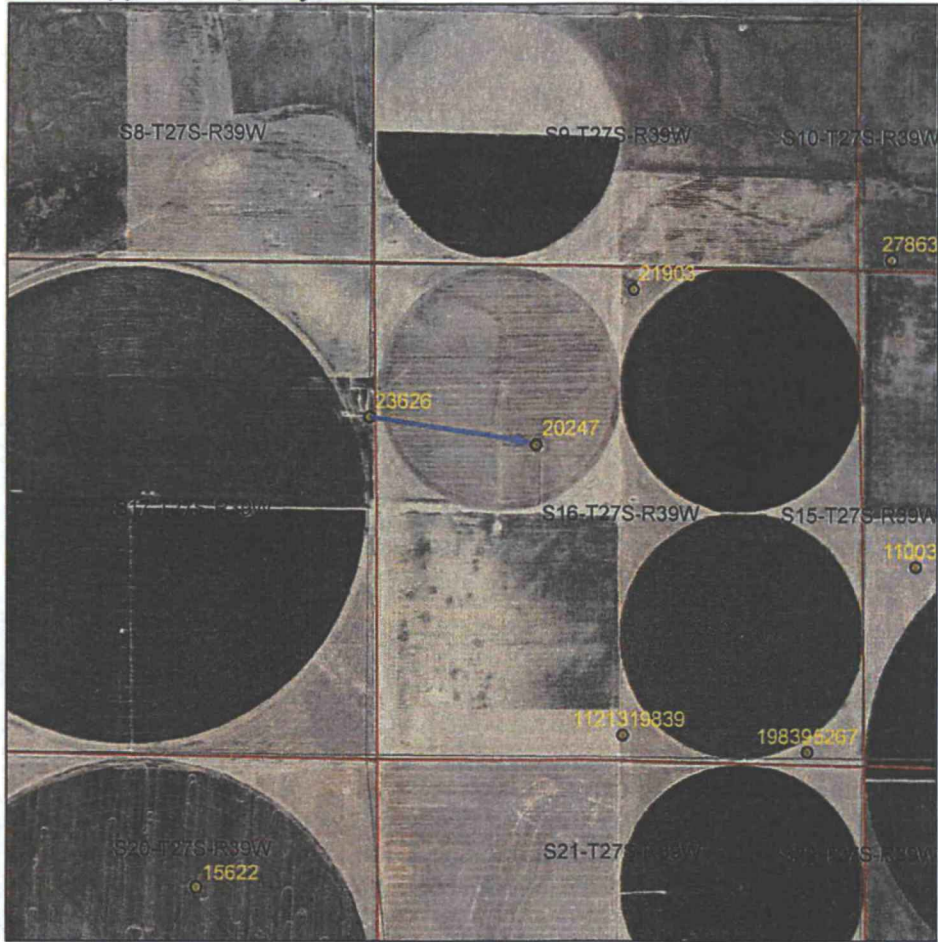

The original well proposed under 23626 will be authorized 605AF @ 860 gpm
 The proposal is to move 202AF @ 285gpm to stack on the well under 20247.
 WR 23626 well have a reduction of 153AF due to the additional well rule.

*In 2009 an application was submitted to flip the authority of the well between 20247 & 23626 to their current locations. At that time it also took a waiver of the spacing rule, which the Board granted due to the fact that the applicant had tried unsuccessfully to find a new well and also the overall fact that the greater authorization is moving away from neighboring wells.

	ft. North	ft. West	
Authorized P/D	3645	407	Sect. 17-27-39
Proposed P/D	3396	3571	Sect. 16-27-39
Difference	249	2116	
$a^2 + b^2 = c^2$	62001	4477456	2130.6 feet apart

Neighboring wells: Spacing is not met between the two wells. Also spacing not met to the well under WR21903.

Domestic wells: None found in area of concern

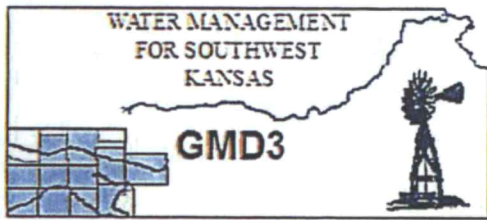

Southwest Kansas
Groundwater Management District No. 3
2009 E. Spruce Street
Garden City, Kansas 67846
(620) 275-7147 phone (620) 275-1431 fax
www.gmd3.org

November 3, 2015

Jerry Gum
9338 N RD D
Johnson, KS 67855-5504

RE: Water Right, File No. 23,626

Dear Mr. & Mrs. 23,626 and Neighbors,

This is to advise you that your application for approval of the Chief Engineer, Division of Water Resources, Kansas Department of Agriculture, to change the point of diversion under the above referenced application requires a waiver of a rule, specifically, K.A.R. 5-23-3 as it pertains to spacing to neighboring wells.

The application proposes to move 202AF of the allocation under water right, File No. 23,626, to a point described as being 3396 feet North and 3571 feet West of the SE corner of Section 16, Township 27s, Range 39w, in Stanton County, and stacking it on a well which is currently covered by Water Right, File No. 20,247. A plat and groundwater resource review information is enclosed for your reference.

Changing a water right in a local aquifer area can affect the water supply to the project and to other water rights and users. Kansas law (K.S.A. 82a-708b (2)) requires a demonstration that any change is reasonable and will not impair existing rights. Spacing rules provide a standard for implementing this requirement. Conversely, not meeting the spacing standard creates a presumption that impairment will occur

To meet the need for added due process beyond the ½ mile courtesy notice from the state, the GMD3 Board passed Resolution 2013-6, adopted December 17, 2013. This resolution established a process of seeking more information from you and the neighboring water right owners whose wells are located within a mile of a proposed location requiring a rule waiver.

Accordingly, local resource information is included with this letter and you are requested to provide information in response to the following questions:

- 1) Can the aquifer yield a similar water supply at both the present well location and at the proposed well location(s)? In other words, how might the well yield differ in the proposed location from the present location?
- 2) Can the addition of infrastructure, such as pipelines or purchase of neighboring wells with water rights, meet the need without a rule waiver?
- 3) How do the specifics of the proposal conserve energy and/or water over other alternatives?

The GMD3 board supports the pursuit of high value water use, through reasonable changes that don't have an unreasonable affect to other water rights. We request that any response you or your neighbors wish to provide should occur within 15 days from the date of this letter or any extension of time granted. If no response is received from you, the applicant, and concerns of merit are received

GMD3 Change Review

Regulation(s) Reviewed: KAR 5-23-3 & KAR 5-5-16

Board Review Date: January 13, 2016

Board Recommendation: waiver to spacing

Waiver Reason: this application is to balance out the water use between the wells due to a land sale of a portion of the place of use. There is a reduction taking place in accordance with the additional well rule and also limits already part of the water rights that will be modified and implemented.

Final Recommendation: after review of all available information with the applicant and Board, staff recommends approval of the application. Two Board members excused themselves from voting due to interest in the application.

A handwritten signature in blue ink, consisting of a large, stylized letter 'J' followed by a smaller, cursive flourish.

from the area water right owners, within that time, we may recommend that the rule be upheld and the application denied. We will consider information from the neighbors responding to their copy of this letter.

Should you have any questions, please feel free to call this office. If you would prefer, an appointment could be arranged for additional assistance. Please refer to the water right file number when you contact us.

Sincerely,

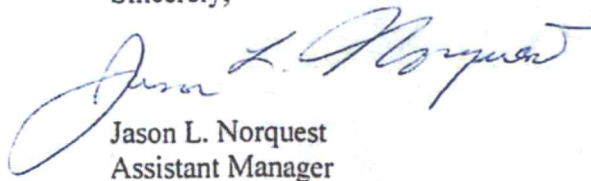

Jason L. Norquest
Assistant Manager

Attachment: GMD3 General Groundwater Resource Review, File No. 23,626
Copy to: Clay B. & Nancy J. Scott
Philip Shorter

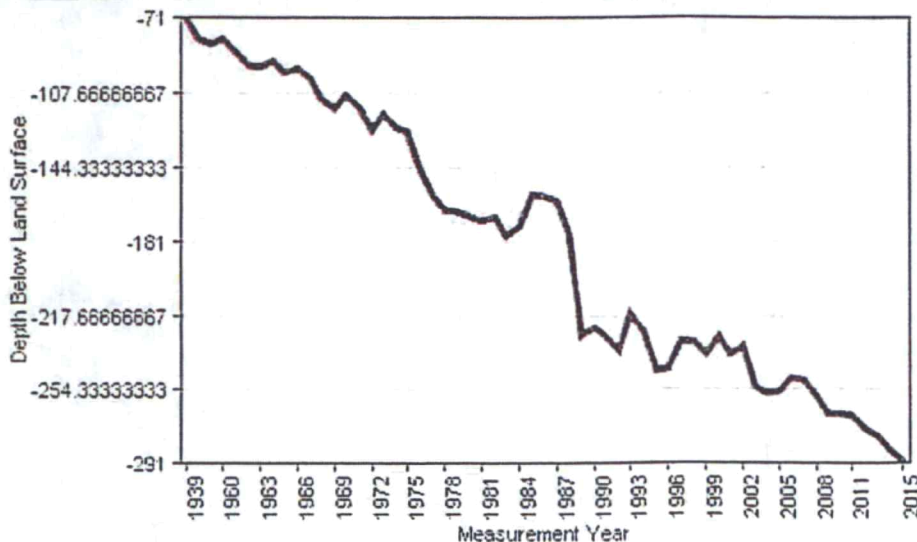
Regional Average Trends, from
<http://hercules.kgs.ku.edu/geohydro/wizard/wizardregional.cfm>

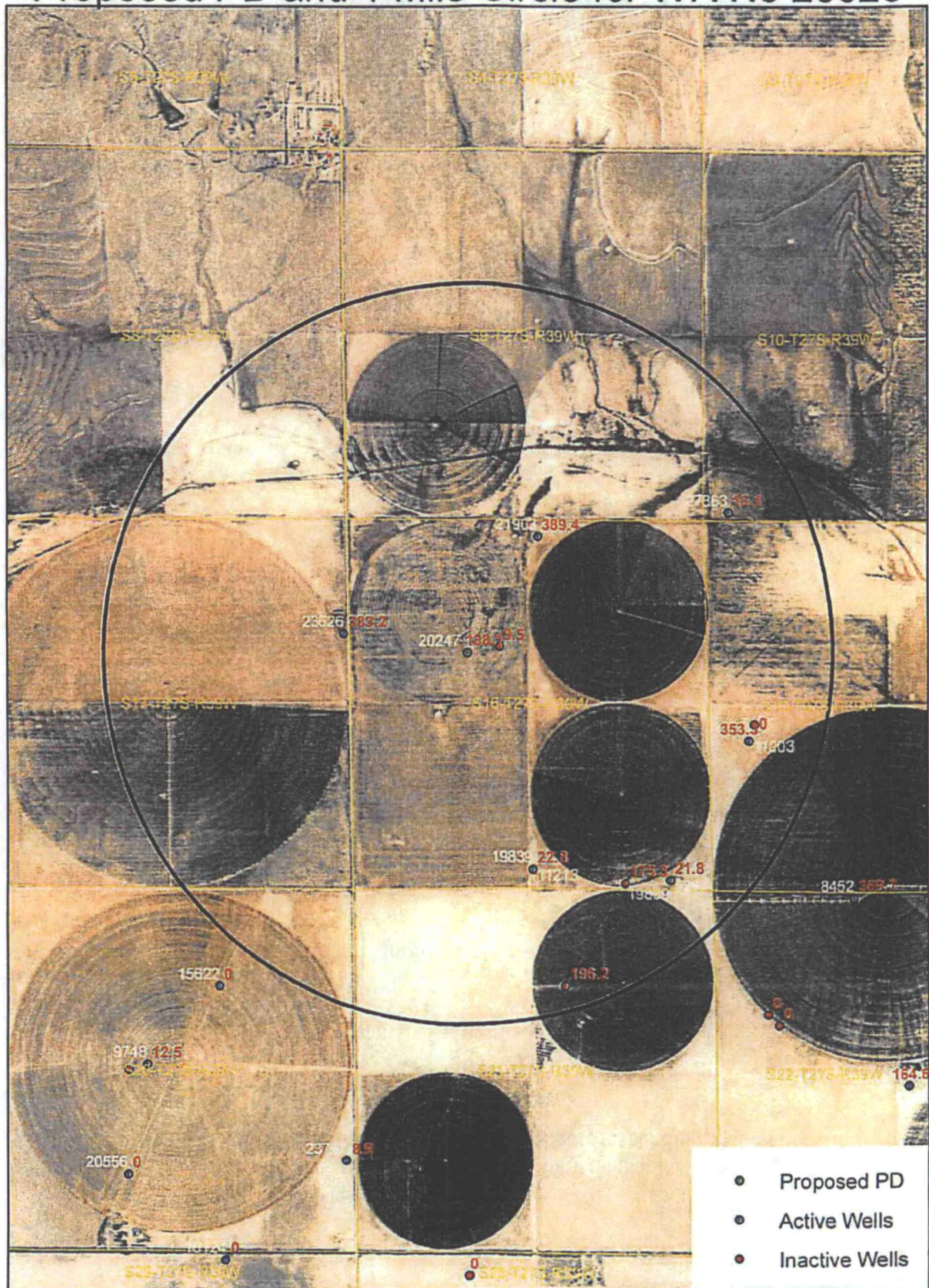

Proposed PD and 1 Mile Circle for WR No 23626



1:24,000

Water right numbers are in white text.
10 year average water use is in red text.



Entered in Transfer Record
 In My Office This 5 Day of
May A.D. 2015
Urberville Dep.
 County Clerk

STATE OF KANSAS }
 STANTON COUNTY } SS.

This instrument was filed for record on the
5 day of May 2015
 at 3:45 o'clock P M and duly recorded
 in Book 61 Page 61 Fee \$ 36.00
Susan G. Lucas
 Register of Deeds

RECORDING INFORMATION

WARRANTY DEED

Mary Ellen Gum, a widow, as to her undivided one-half (1/2) interest, and Mary Ellen Gum, Jerry A. Gum and Suzanne Gum, as Co-Executors of the Estate of Lewis M. Gum, deceased, as to its undivided one-half (1/2) interest, *Grantors*

CONVEY AND WARRANT TO

Douglas F. Bell and Renell M. Bell, husband and wife, as JOINT TENANTS and not as tenants in common, with full rights of survivorship, the whole estate to vest in the survivor in the event of the death of either, *Grantees*

The SURFACE RIGHTS in and to the following described real estate in the County of STANTON and the State of KANSAS, including all water rights appurtenant thereto, to-wit:

Northwest Quarter (NW $\frac{1}{4}$) of Section Sixteen (16), Township Twenty-seven (27) South, Range Thirty-nine (39) West of the 6th P.M., Stanton County, Kansas
 Southeast Quarter (SE $\frac{1}{4}$) of Section Nine (9), Township Twenty-seven (27) South, Range Thirty-nine (39) West of the 6th P.M., Stanton County, Kansas

FILE NO. 10,146 } 20,247
 23,626

TOGETHER WITH one (1) pump, one (1) gearhead and one (1) Valley irrigation sprinkler located on the Northwest Quarter (NW $\frac{1}{4}$) of Section Sixteen (16), Township Twenty-seven (27) South, Range Thirty-nine (39) West of the 6th P.M., Stanton County, Kansas.

For the sum of Ten Dollars (\$10.00) and other good and valuable consideration.

EXCEPT AND SUBJECT TO:

- (a) Oil and gas leases, easements, restrictions, covenants, reservations and rights-of-way of record;
- (b) All oil, gas and other minerals previously reserved or conveyed of record;
- (c) The rights of the tenant in possession with respect to the growing wheat crop; and

(d) A pipeline Right-of-Way Grant, to be granted to WGP-KHC, LLC prior to the delivery and recording of this deed, granting to said company the right of ingress and egress to maintain an underground natural gas pipeline presently buried along the eastern boundary line of the SE¼ of Section 9, Township 27 South, Range 39 West of the 6th P.M., Stanton County, Kansas.

AND FURTHER SUBJECT TO a reservation by Grantors of an underground water pipeline easement through and across the NW¼ of Section 16, Township 27 South, Range 39 West of the 6th P.M., in order to allow Grantors to transport irrigation water to the SW¼ of Section 9, Township 27 South, Range 39 West of the 6th P.M., from irrigation wells located on Section 17, Township 27 South, Range 39 West of the 6th P.M., together with the right of ingress and egress to and from said premises in order to maintain, alter, inspect, repair and replace the underground water pipeline. This easement shall be limited to thirty feet (30') in width, lying fifteen feet (15') on both sides of said pipeline as presently located, the center of such easement being located immediately over said pipeline and extending for the length of such pipeline as the same is located within the NW¼ of Section 16, Township 27 South, Range 39 West of the 6th P.M. This easement shall run with the land, be binding upon and inure to the benefit of the parties hereto and their respective heirs, assigns and successors in interest.

IN WITNESS WHEREOF, the undersigned have executed this Warranty Deed on the dates set forth in the acknowledgements to their respective signatures, to be effective as of the date set forth below.

Effective Date: April 17, 2015

Mary Ellen Gum
MARY ELLEN GUM, Individually

Mary Ellen Gum
MARY ELLEN GUM, Co-Executor of the Estate of
Lewis M. Gum, deceased

STATE OF KANSAS)
) ss.
COUNTY OF Stanton)

THIS INSTRUMENT was acknowledged before me on the 4 day of ~~April~~^{May}, 2015, by **Mary Ellen Gum**, in her individual capacity and as Co-Executor of the Estate of Lewis M. Gum, deceased.

IN WITNESS WHEREOF, I have subscribed my name and affixed my seal as of the day and year last above written.

Tina Schwieterman
Notary Public

My Appointment Expires: 5/8/2017

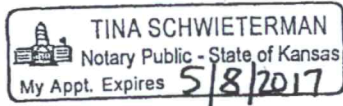

Page 2 of 4

→ PROBABLY SIGNATURES OF JERRY & SUZANNE GUM -



1320 Research Park Drive
Manhattan, Kansas 66502
(785) 564-6700

900 SW Jackson, Room 456
Topeka, Kansas 66612
(785) 296-3556

Jackie McClaskey, Secretary

Governor Sam Brownback

January 20, 2016

FILE COPY

DOUGLAS F & RENELL M BELL
1 FORD DRIVE
COLBY KS 67701

RE: Water Right, File Nos. 20,247 & 23,626

Dear Mr. & Mrs. Bell:

Reference is made to the application for approval of the Chief Engineer to change the point of diversion under the File No. 23,626, which was received in this office on June 11, 2015. Upon review of the application, we find that additional information is needed.

It is required by Part (c) of K.A.R. 5-5-1, that the Division of Water Resources, is require to obtain a notarized signature from each landowner and their spouse. Records in this office indicate you are now an owner of a portion of the place of use authorized by the referenced files.

A copy of the application for change and a new signature page is enclosed for your signatures as property owners. Please be reminded that all signing must be done with a notary public present.

As submitted the application for change under File No. 23,626, will authorized the diversion of some water from the well located in the Northwest Quarter (NW $\frac{1}{4}$) Section 16, Township 27 South, Range 39 West, that is authorized by File No. 20,247. Per the additional well regulation, K.A.R. 5-5-16, a well log or WWC-5 of the well that was approved by the December 2, 2015, *Approval of Application to Change the Point of Diversion* under Water Right, File No. 20,247, will be needed.

In order for the application to retain its priority of filing the enclosed signature page and a well log for the point of diversion that will be the additional well must be returned to this office on or before February 4, 2016. According to law, default in returning the requested information as outlined above within the time allowed or any authorized extension of time, shall cause dismissal of the application for change under the above referenced file number.

RE: Water Right, File Nos. 20,147 & 23,626

Should you need to request additional time in which to return the requested well log and signature page, please do so prior to the deadline.

If you have any questions, please contact me at (785) 564-6633. If you wish to discuss a specific file, please have the file number ready so that I may help you more efficiently.

Sincerely,



Leslie Ireland
Environmental Scientist
Water Appropriation Program

FILE COPY

LI:li

Enclosures

pc: Garden City Field Office
Groundwater Management District No. 3
Jerry Gum



1320 Research Park Drive
Manhattan, Kansas 66502
(785) 564-6700

900 SW Jackson, Room 456
Topeka, Kansas 66612
(785) 296-3556

Jackie McClaskey, Secretary

Governor Sam Brownback

December 11, 2015

SOUTHWEST KANSAS GROUNDWATER
MANAGEMENT DISTRICT NO 3
ATTN MARK RUDE
2009 E SPRUCE
GARDEN CITY KS 67846

Re: Change Application, Water Right, File No. 23,626

Dear Mr. Rude:

In response to Jason Norquest's, December 4, 2015, E-mail, the Chief Engineer has extended, the time in which to submit a recommendation concerning the above referenced file.

At your request the Chief Engineer has delayed any further action until January 18, 2016.

Please submit your recommendation within the allotted time, or any authorized extension of time thereof. If you wish to refer to a specific file, please reference it when you contact us.

Sincerely,

Leslie Ireland
Environmental Scientist
Water Appropriation Program

FILE COPY

LI:li

pc: Garden City Field Office
Mary Ellen Gum c/o Jerry Gum

Ireland, Leslie

From: Jason Norquest <norquest@gmd3.org>
Sent: Friday, December 04, 2015 2:45 PM
To: Ireland, Leslie; Krueger, Richelle
Cc: Mark Rude
Subject: 11442 & 23626

Good afternoon, hope the week has been a good one.

I would like to request an extension on the above water right applications until after our January 13th Board meeting. With representatives from State offices planning to be in attendance at our December meeting, we wanted to make sure that adequate time could be offered to discussion with them and make sure time was allowed for a complete review process for these two applications. We are also currently gathering more information and receiving questions from neighbors to our notice letter that was sent out. I have had a conversation with parties involved with both applications and both stated that pushing the review back to January is acceptable.

I appreciate your time and if you have any questions, please feel free to contact me at your convenience.

Jason Norquest

Assistant Manager, GMD3

Office: 620-275-7147 Cell: 620-271-1289

norquest@gmd3.org

www.gmd3.org

1320 Research Park Drive
Manhattan, Kansas 66502
(785) 564-6700



900 SW Jackson, Room 456
Topeka, Kansas 66612
(785) 296-3556

Jackie McClaskey, Secretary

Governor Sam Brownback

October 23, 2015

SOUTHWEST KANSAS GROUNDWATER
MANAGEMENT DISTRICT NO 3
ATTN MARK RUDE
2009 E SPRUCE
GARDEN CITY KS 67846

Re: Change Application, Water Right, File No. 23,626

Dear Mr. Rude:

In response to Jason Norquest's, October 23, 2015, E-mail, the Chief Engineer has extended, the initial time in which to submit a recommendation concerning the above referenced file.

At your request the Chief Engineer has delayed any further action until December 11, 2015.

Please submit your recommendation within the allotted time, or any authorized extension of time thereof. If you wish to refer to a specific file, please reference it when you contact us.

Sincerely,

Leslie Ireland
Environmental Scientist
Water Appropriation Program

LI:li

pc: Garden City Field Office
Mary Ellen Gum c/o Jerry Gum

SCANNED

1320 Research Park Drive
Manhattan, Kansas 66502
(785) 564-6700



900 SW Jackson, Room 456
Topeka, Kansas 66612
(785) 296-3556

Jackie McClaskey, Secretary

Governor Sam Brownback

October 13, 2015

SOUTHWEST KANSAS GROUNDWATER
MANAGEMENT DISTRICT NO 3
ATTN MARK RUDE
2009 E SPRUCE
GARDEN CITY KS 67846

Re: Application for Change, Water Right, File No. 23,626

Dear Mr. Rude:

We are enclosing a copy of the application referred to above which appears to be in proper form. The proposed change is requesting to add an additional well per K.A.R. 5-5-16, *Additional well*. The owner has requested a waiver of Part (a)(1) of K.A.R. 5-23-3, *Minimum well spacing requirements: high plains aquifer*.

We are delaying any further action for a period of 30 days from the date of this letter to allow you time to submit your recommendations concerning this application.

Please submit your recommendation within the allotted time, or any authorized extension of time thereof. If you wish to refer to a specific file, please reference it when you contact us.

Sincerely,

Leslie Ireland
Environmental Scientist
Water Appropriation Program

LI:li

Enclosure

pc: Garden City Field Office
Mary Ellen Gum c/o Jerry Gum

SCANNED

USE TYPEWRITER OR BALL POINT PEN-PRESS FIRMLY, PRINT CLEARLY.

T R EW sec 1/4 1/4 1/4 No.

WATER WELL RECORD
KSA 82a-1201-1215

Kansas State Dept. Of Health
(Water Well Contractors)
Forbes-Bldg. 740
Topeka, Kansas 66620

1 Location of well:	County Stanton	Township name	Fraction SE 1/4, SE 1/4, NW 1/4	Section number 17	Town number T27S	Range number R39W
---------------------	--------------------------	---------------	---	-----------------------------	----------------------------	-----------------------------

Distance and direction from nearest town or city: 8 mi. N., 1 1/2 mi. W.	3 Owner of well: Don Molz
Street address of well location if in city: 1 1/2 mi. N., 1/2 mi. W. of Big Bow	Address: Route 1 Johnson, Kansas 67855

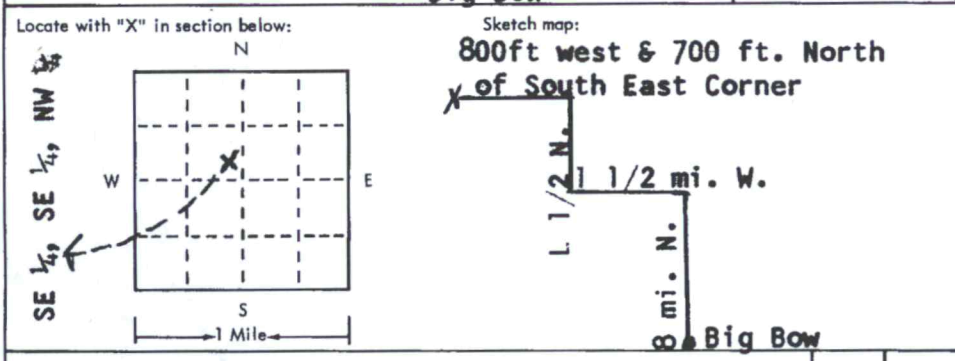

4 Well depth: 665 ft. Date of completion 5-19-75
Well diameter 26 in.
5 <input type="checkbox"/> Cable tool <input type="checkbox"/> Rotary <input type="checkbox"/> Driven <input type="checkbox"/> Dug <input type="checkbox"/> Hollow rod <input type="checkbox"/> Jetted <input type="checkbox"/> Bored <input checked="" type="checkbox"/> Reverse rotary
6 Use: <input type="checkbox"/> Domestic <input type="checkbox"/> Public supply <input type="checkbox"/> Industry <input checked="" type="checkbox"/> Irrigation <input type="checkbox"/> Air conditioning <input type="checkbox"/> Commercial <input type="checkbox"/> Test well
7 Casing: Material Steel Height: above/below Threaded <input type="checkbox"/> Welded <input checked="" type="checkbox"/> Surface 8 ft. Diam. 16 in. to 665 ft. depth Drive shoe? <input type="checkbox"/> Yes <input checked="" type="checkbox"/> No 16 in. to 665 ft. depth

2 Type and color of material	From	To
Surface & fine sand	0	15
Fine sand	15	60
Brown clay	60	105
Blue clay	105	150
Sand & medium gravel	150	210
Brown sandy clay	210	240
Brown sandy clay	240	285
Sand	285	300
Sandy clay	300	315
Sand - loose	315	360
Sand & sandstone	360	375
Blue Shale - Streaks of Dakota	375	495
Dakota - some Cheyenne	495	510
Dakota	510	540
Dakota Cheyenne & Sandstone (Loose)	540	665
(use a second sheet if needed)		

8 Screen: Manufacturer Johnson Type Galvanized Dia. 16 in. Slot/gauge 100X100 Length 50 ft. Set between 500 ft. and 550 ft. * Fittings: See Remarks Gravel pack <input checked="" type="checkbox"/> Yes <input type="checkbox"/> No Size range of material 1/2 down
9 Static water level: 105 ft. below land surface Date 5-8-75
10 Pumping level below land surfaces: 200 ft. after 24 hrs. pumping 1600 g.p.m. ____ ft. after ____ hrs. pumping ____ g.p.m. Estimated maximum yield 2000 g.p.m.
11 Water sample submitted: <input type="checkbox"/> Yes <input checked="" type="checkbox"/> No Date _____
12 Well head completion: 96 in. Customer ran. <input type="checkbox"/> Pitless adapter <input checked="" type="checkbox"/> Inches above grade
13 Well grouted? <input checked="" type="checkbox"/> Yes <input type="checkbox"/> No <input checked="" type="checkbox"/> Neat cement <input type="checkbox"/> Bentonite <input type="checkbox"/> _____ Depth: From 0 ft. to 15 ft.
14 Nearest source of possible contamination: ft. _____ Direction none Type _____ Well disinfected upon completion? <input type="checkbox"/> Yes <input checked="" type="checkbox"/> No
15 Pump: <input type="checkbox"/> Not installed Manufacturer's name Goulds Model number 14 J HP 150 Volts _____ Length of drop pipe 320 ft. capacity 600 g.m.p. Type: <input type="checkbox"/> Submersible <input checked="" type="checkbox"/> Turbine <input type="checkbox"/> Jet <input type="checkbox"/> Reciprocating <input type="checkbox"/> Centrifugal <input type="checkbox"/> Other

16 Remarks: elevation Drilling Sub-contracted to Minter-Wilson Drilling Co. Garden City, Kansas	License No. 208
Topography: <input type="checkbox"/> Hill <input checked="" type="checkbox"/> Slope <input type="checkbox"/> Upland <input type="checkbox"/> Valley	Lakewood Perf. - Slot - .125 X 66 Set between 180 ft. & 500 ft. and 550 ft & 665 ft.

17 Water well contractor's certification: This well was drilled under my jurisdiction and this report is true to the best of my knowledge and belief. K. I. Drilling Co. 263 Business name _____ License No. _____ Address Box 669 Ulysses Kan. Signed Bob Fisher Date 6-18-75 Authorized representative
--

SCANNED

1320 Research Park Drive
Manhattan, Kansas 66502
(785) 564-6700



900 SW Jackson, Room 456
Topeka, Kansas 66612
(785) 296-3556

Jackie McClaskey, Secretary

Governor Sam Brownback

September 9, 2015

CLAY B & NANCY J SCOTT
1773 N ROAD B
ULYSSES KS 67880

RE: Water Right, File No. 23,626

Dear Mr. & Mrs. Scott:

This is to advise you that Mary Ellen Gum, has filed an application for approval of the Chief Engineer, Division of Water Resources, Kansas Department of Agriculture, to change the point of diversion authorized by the referenced file.

The application proposes the following change in point of diversion to authorize an additional point of diversion to be authorized that together will divert at a reduced rate and quantity:

from: one (1) well located in the Northeast Quarter of the Southeast Quarter of the Northeast Quarter (NE $\frac{1}{4}$ SE $\frac{1}{4}$ NE $\frac{1}{4}$) of Section 17, more particularly described as being near a point 3,630 feet North and 150 feet West of the Southeast corner of said section, at a quantity not to exceed 960 acre-feet per calendar year and at a diversion rate not in excess of 1,460 gallons per minute (3.25 c.f.s.),

to: one (1) well located in the Northeast Quarter of the Southeast Quarter of the Northeast Quarter (NE $\frac{1}{4}$ SE $\frac{1}{4}$ NE $\frac{1}{4}$) of Section 17, more accurately located as being near a point 3,645 feet North and 407 feet West of the Southeast corner of said section, at a quantity not to exceed 605 acre-feet per calendar year and at a diversion rate not in excess of 860 gallons per minute (1.92 c.f.s.) and

one (1) existing well located near the center of the Southeast Quarter of the Northwest Quarter (SE $\frac{1}{4}$ NW $\frac{1}{4}$) of Section 16, more particularly described as being near a point 3,396 feet North and 3,571 feet West of the Southeast corner of said section, at a quantity not to exceed 202 acre-feet per calendar year and at a diversion rate not in excess of 285 gallons per minute (0.64 c.f.s.), this well is also authorized by Water Right, File No. 20,247, to divert 588 acre-feet at 1,720 gallons per minute (3.83 c.f.s.),

all in Township 27 South, Range 39 West, Stanton County, Kansas.

You are being notified of the proposed change so that you may furnish this office written comments or other information you may desire to submit. Such written comments or other information must be received in this office within 15 days from the date of this letter.

SCANNED

If you have any questions, please contact our office, my desk phone is (785) 564-6633. If you wish to discuss a specific file, please have the file numbers ready so that we may help you more efficiently.

Sincerely,

A handwritten signature in cursive script that reads "Leslie Ireland".

Leslie Ireland
Environmental Scientist
Water Appropriation Program

pc: Garden City Field Office
Groundwater Management District No. 3
Jerry Gum

Water Right, File No. 23,626
List of Well Owners Contacted within 2,640 feet
of proposed existing well for additional well

September 9, 2015

WELL OWNERS

File No. 21,903

CLAY B & NANCY J SCOTT
1773 N ROAD B
ULYSSES KS 67880

SCANNED

Ireland, Leslie

From: Meyer, Mike
Sent: Monday, August 31, 2015 9:09 AM
To: Ireland, Leslie
Subject: RE: Water Right, File No. 23,626 GUM

yes

Mike

From: Ireland, Leslie
Sent: Monday, August 31, 2015 8:54 AM
To: Meyer, Mike
Subject: RE: Water Right, File No. 23,626 GUM

Mike,

So the proposed 1145 is ok? With those rounding rules?
Leslie

From: Meyer, Mike
Sent: Monday, August 31, 2015 8:53 AM
To: Chavez, Ciro <Ciro.Chavez@KDA.KS.GOV>; Ireland, Leslie <Leslie.Ireland@KDA.KS.GOV>
Subject: RE: Water Right, File No. 23,626 GUM

1142.6 PGM was the max rate

Mike

From: Chavez, Ciro
Sent: Monday, August 31, 2015 8:48 AM
To: Ireland, Leslie
Cc: Meyer, Mike
Subject: RE: Water Right, File No. 23,626 GUM

I think we go for the installed meter 484.27 GPM rate, see Mike notes at the bottom, Is that right Mike?

K A N S A S
DEPARTMENT OF AGRICULTURE
Division of Water Resources

Ciro Alberto Chavez del Bosque
Environmental Scientist II
Garden City Field Office
cchavez@KDA.STATE.KS.US

From: Ireland, Leslie
Sent: Friday, August 28, 2015 1:59 PM
To: Chavez, Ciro
Subject: Water Right, File No. 23,626 GUM

Hi,

I picked-up the Jim Gum pd change application, but can't tell from this report what tested rate of diversion to use? I've never been able to,,, so it is me, not you.. he has requested to divide 1145 gpm, but can't tell if that was what the test got. The right is authorized 1460 gpm.

Leslie Ireland, Environmental Scientist II
Kansas Department of Agriculture
Division of Water Resources - Change Unit
(785) 564-6633
Leslie.Ireland@kda.ks.gov
www.agriculture.ks.gov

1320 Research Park Drive
Manhattan, Kansas 66502

Jackie McClaskey, Secretary



Phone: (785) 564-6700
Fax: (785) 564-6777
Email: ksag@kda.ks.gov
www.agriculture.ks.gov
Sam Brownback, Governor

JERRY GUM
9338 N RD D
JOHNSON KS 67855

June 11, 2015

RE: File No. 23626

Dear Sir or Madam:

An application for approval of the Chief Engineer to change the following condition or conditions of the file number referred to above has been received:

- place of use PD
- point of diversion
- use made of water

As a matter of record, the Division of Water Resources has on hand a large number of applications awaiting processing. Therefore to be fair to all concerned, and so that we can process those applications on hand in the order they were received, we intend to concentrate on the backlog of applications until the issue is resolved. You will be contacted regarding this application as soon as it has been examined.

In accordance with the provisions of the Kansas Water Appropriation Act, a portion of which is included below, the use of water prior to approval of the application is unlawful. You should not proceed and divert water as indicated by your plans in your application for a change for this file until you receive approval for this change from the Chief Engineer. Once approved, compliance with the terms, conditions and limitations of the permit is necessary. Conservation of the water resources of Kansas is required.

Section 82a-728 of the Kansas Water Appropriation Act, provides (a) except for the appropriation of water for the purpose of domestic use, . . . it shall be unlawful for any person to appropriate or threaten to appropriate water from any source without first applying for and obtaining a permit to appropriate water in accordance with the provisions of the Water Appropriation Act or for any person to violate any condition of a vested right, appropriation right or an approved application for a permit to appropriate water for beneficial use.

(b) (1) The violation of any provision of this section by any person is a class C misdemeanor...

A class C misdemeanor is punishable by a fine not to exceed \$500 and/or a term of confinement not to exceed one month in the county jail. Each day that the violation occurs constitutes a separate offense.

If you have any questions, please contact me at (785) 564-6645. If you wish to discuss a specific file, please have the file number ready so that we may help you more efficiently.

Sincerely,

Brent A Turney, L.G.
Change Applications Unit Supervisor
Water Appropriation Program

BAT: dlw
pc: GARDEN CITY Field Office
3