

Kansas Department of Agriculture
 Division of Water Resources
CHANGE: P/U WORKSHEET

1. File Number: 18729	2. Status Change Date: 4/15/18	3. Change Num: c1	4. Field Office: 04	5. GMD: 03
---------------------------------	--	-----------------------------	-------------------------------	----------------------

6. Status: <input checked="" type="checkbox"/> Approved <input type="checkbox"/> Denied by DWR/GMD <input type="checkbox"/> Dismiss by Request/Failure to Return	7. Filing Date of Change: 2/14/18
--	---

8a. Applicant(s) New to system <input type="checkbox"/>	Person ID <u>2832</u> Add Seq# <u>1</u>
CIRCLE LAND & CATTLE CORPORATION 901 ARKANSAS AVE HOLCOMB KS 67851	

8c. Landowner(s) New to system <input type="checkbox"/>	Person ID <u>40860</u> Add Seq# <u>1</u>
ARKANSAS RIVER STATELAND & WATER IN 00000	

8b. Landowner(s) New to system <input type="checkbox"/>	Person ID <u>2832</u> Add Seq# <u>1</u>
CIRCLE LAND & CATTLE CORPORATION 901 ARKANSAS AVE HOLCOMB KS 67851	

8d. WUC New to system <input type="checkbox"/>	Person ID <u>2832</u> Add Seq# <u>1</u>
CIRCLE LAND & CATTLE CORPORATION 901 ARKANSAS AVE HOLCOMB KS 67851	

9. Documents and Enclosure(s): <input checked="" type="checkbox"/> DWR Meter(s) Date to Comply: <u>12/31/18</u> <input type="checkbox"/> N & P Date to Comply: _____	
<input type="checkbox"/> Anti-Reverse Meter <input type="checkbox"/> Meter Seal <input type="checkbox"/> Check Valve <input type="checkbox"/> N & P Form <input type="checkbox"/> Water Tube <input type="checkbox"/> Driller Copy <input type="checkbox"/> H & E Letter <input type="checkbox"/> Conservation Plan Date Required: _____ Date Approved: _____ Date to Comply: _____	

10. Use Made of Water From: _____	To: _____
--------------------------------------	-----------

Date Prepared: 3/27/18	By: TPM
Date Entered: _____	By: _____

File No. 18729		Priority Date:	County: FI	Basin: ark	Stream:	Formation Code:															
11. Place of Use MOD DEL ENT	P U S E	S T R I D	NE%			NW%			SW%			SE%			Total	Owner	Chg?	Overlap Files			
			NE %	NW %	SW %	SE %	NE %	NW %	SW %	SE %	NE %	NW %	SW %	SE %					NE %	NW %	SW %
NC	20347	15 24	33W	5														48	8B	no	12821 18729 18730
NC	35004	22 24	33W	1	L-1 34	21	40	39	26	40	37.5	37.5	37.5	37.5	34	34	34	486	18731	18732	18733 18903 18976
ENT	11910	28 24	33W	1	34	34	34	34	34	34	34	34	34	34	34	34	34	544	18977	18978 18979 18980 18981	
ENT	37784	33 24	33W	1	34	34	34	34	34	34	34	34	34	34	34	34	34	544	18982		
ENT	22833	16 24	33W	2														232			
ENT	23737	21 24	33W	1	38	38	38	38	26.5	26.5	26.5	34	34	34	34	34	34	530			
ENT	NEW	17 24	33W															10			
ENT	25755	27 24	33W	2	34	34	34											408			
ENT	31969	34 24	33W	1	34	34	34	34	34	34	34	34	34	34	34	34	34	544			
ENT	3209	21 25	33W	1	34.5	34.5	34.5	34.5	34.5	34.5	34.5	34.5	34.5	34.5	38	38	38	566			
ENT	5799	3 25	33W	1	L-1 34	34	L-3 37.5	L-4 37.5	37.5	37.5	37.5	37.5	37.5	37.5	37.5	37.5	37.5	586			
ENT	8910	10 25	33W	1	34	34	34	34	34	34	34	34	34	34	34	34	34	558			
ENT	16102	15 25	33W	1	34	34	34	34	34	34	34	34	34	34	34	34	34	544			
ENT	13391	4 25	33W	1	L-1 34	34	L-3 34	L-4 34	34	34	34	34	34	34	34	34	34	544			
ENT	2050	5 25	33W	1	L-1 34	34									34	34	34	272			
ENT	9041	8 25	33W	1	34	34	34	34	34	34	34	34	34	34	34	34	34	272			
ENT	39456	9 25	33W	1	34	34	34	34	34	34	34	34	34	34	34	34	34	544			
ENT	6692	16 25	33W	1	34	34	34	34	34	34	34	34	34	34	34	34	34	544			
ENT	17958	17 25	33W	1	34	34	34	34	34	34	34	34	34	34	34	34	34	272			
ENT	NEW	15 24	33W															10	8c	yes	
ENT	NEW	16 24	33W															37	8c	yes	

STATE OF KANSAS



DEPARTMENT OF AGRICULTURE
DIVISION OF WATER RESOURCES
GARDEN CITY FIELD OFFICE
2508 JOHNS STREET
GARDEN CITY, KS 67846-2804

PHONE: (620) 276-2901
FAX: (620) 276-9315
www.agriculture.ks.gov

GOVERNOR JEFF COLYER, M.D.
JACKIE McCLASKEY, SECRETARY OF AGRICULTURE

April 13, 2018

CIRCLE LAND & CATTLE CORPORATION
901 ARKANSAS AVE
HOLCOMB KS 67851

RE: Change the Place of Use, File Nos 12821 18729 18730
18731 18732 18733 18903 18976 18977 18978 18979 18980
18981 18982

Dear Mr. Stillwell;

Enclosed you will find a *Summary Order Approving Application for Change in Place of Use* for the above referenced files. These orders modify the authorized acres that can be irrigated by these files. The authorized place of use is as shown on the plats within the change approvals.

A condition of this order is that an acceptable flow meter must be properly installed on the diversion works authorized under the referenced file number in accordance with the Kansas Administrative Regulations 5-1-4 through 5-1-12. This water flow meter shall be used to provide information required on the annual water use report (including the meter reading at the beginning and end of the report year).

This order shall become final if a request for a hearing is not filed with the Chief Engineer within 15 days of the date of service of this order. The date of service is the date listed on the enclosed *Certificate of Service*.

Should you have any questions, please feel free to call this office or arrange an appointment for additional assistance. Please refer to the file number when you contact us if you wish to discuss a specific file.

Sincerely,

Thomas P. Makens
Assistant Water Commissioner

TPM:tpm
Enclosures
GMD#3

CERTIFICATE OF SERVICE

On this *16* day of April 2018, I hereby certify that the attached original Approval of Application to Change the Place of Use under Water Right File 12821 18729 18730 18731 18732 18733 18903 18976 18977 18978 18979 18980 18981 18982 dated April 5, 2018, was provided in person to the following:

CIRCLE LAND & CATTLE CORPORATION
901 ARKANSAS AVE
HOLCOMB KS 67851

Copy provided to GMD#3



Division of Water Resources

Submit completed application to:
 Kansas Department of Agriculture
 Division of Water Resources
 Field Office for your area.

Call for address:

Topeka -- (785) 862-6300
 Stafford -- (620) 234-5311
 Stockton -- (785) 425-6787
 Garden City -- (620) 276-2901
www.ksda.gov/dwr

DWR FIELD OFFICE APPLICATION FOR APPROVAL TO CHANGE THE PLACE OF USE AND/OR THE POINT OF DIVERSION



STATE OF KANSAS

Filing Fee Must Accompany the Application, K.S.A. 82a-708b(b), as amended.
 Fee Schedule is on the third page of this application form.

Paragraph Nos. 1, 2, 3 & 5 must be completed. Complete all other applicable portions. If change in point of diversion is greater than 100 feet, or if place of use will be changed, include a topographic map or detailed plat showing the authorized and proposed point(s) of diversion and/or place of use.

File No. 18729

RECEIVED
 1:16 pm
 FEB 14 2018

1. Application is hereby made for approval of the Chief Engineer to change the (check one or both):
 Place of Use Point of Diversion Garden City Field Office
 Division of Water Resources
- under the water right which is the subject of this application in accordance with the conditions described below.
- The source of supply is: Groundwater Surface water

2. Name and address of Applicant: CIRCLE LAND & CATTLE CORPORATION
901 ARKANSAS AVE HOLCOMB, KS 67851
 Phone Number: () _____ Email address: _____
 Name and address of Water Use Correspondent: CIRCLE LAND & CATTLE CORPORATION
901 ARKANSAS AVE HOLCOMB, KS 67851
 Phone Number: () _____ Email address: _____

3. The presently authorized place of use is:
 Owner of Land ---- NAME: SEE ATTACHMENTS
 ADDRESS: _____
 (If there is more than one landowner, attach supplemental sheets as necessary.)

Sec.	Twp.	Range	NE¼				NW¼				SW¼				SE¼				TOTAL ACRES	
			NE¼	NW¼	SW¼	SE¼	NE¼	NW¼	SW¼	SE¼	NE¼	NW¼	SW¼	SE¼	NE¼	NW¼	SW¼	SE¼		

4. If this application is for a change in place of use, it is proposed that the place of use be changed to:
 Owner of Land ---- NAME: SEE ATTACHMENTS
 ADDRESS: _____
 (If there is more than one landowner, attach supplemental sheets as necessary.)

Sec.	Twp.	Range	NE¼				NW¼				SW¼				SE¼				TOTAL ACRES	
			NE¼	NW¼	SW¼	SE¼	NE¼	NW¼	SW¼	SE¼	NE¼	NW¼	SW¼	SE¼	NE¼	NW¼	SW¼	SE¼		

For Office Use Only: Code _____ Fee \$ 200 TR # _____ Receipt Date 2/14/18 Check # 2521

5. **Presently authorized point of diversion:**
 One in the _____ Quarter of the _____ Quarter of the _____ Quarter
 of Section _____, Township _____ South, Range _____ W,
 in _____ County, Kansas, _____ feet North _____ feet West of Southeast corner of section.
 Authorized Rate _____ Authorized Quantity _____ Depth of well _____ (feet)
 (DWR use only: Computer ID No. _____ GPS _____ feet North _____ feet West)
 This point will not be changed This point will be changed as follows:
Proposed point of diversion: (Complete only if change is requested)
 One in the _____ Quarter of the _____ Quarter of the _____ Quarter
 of Section _____, Township _____ South, Range _____ W,
 in _____ County, Kansas, _____ feet North _____ feet West of Southeast corner of section.
 Proposed Rate _____ Proposed Quantity _____ Proposed well depth (feet) _____
 This point is: Additional Well Geo Center List other water rights that will use this point _____

6. **Presently authorized point of diversion:**
 One in the _____ Quarter of the _____ Quarter of the _____ Quarter
 of Section _____, Township _____ South, Range _____ W,
 in _____ County, Kansas, _____ feet North _____ feet West of Southeast corner of section.
 Authorized Rate _____ Authorized Quantity _____ Depth of well _____ (feet)
 (DWR use only: Computer ID No. _____ GPS _____ feet North _____ feet West)
 This point will not be changed This point will be changed as follows:
Proposed point of diversion: (Complete only if change is requested)
 One in the _____ Quarter of the _____ Quarter of the _____ Quarter
 of Section _____, Township _____ South, Range _____ (E/W),
 in _____ County, Kansas, _____ feet North _____ feet West of Southeast corner of section.
 Proposed Rate _____ Proposed Quantity _____ Proposed well depth (feet) _____
 This point is: Additional Well Geo Center List other water rights that will use this point _____

7. Why do you need a new point of diversion? _____
 No PD Change _____

8. If a well, is the test hole log attached? Yes No

9. When do you propose to complete the new point of diversion?

10. If the point of diversion is a well:
 (a) What are you going to do with the old well?

 (b) When will this be done? _____

11. Groundwater Management District recommendation attached? Yes No

12. Assisted by _____

13a. If the proposed point of diversion will be relocated within 100 feet of the existing point of diversion, indicate its location on the diagram below in relation to the existing point of diversion. (PLEASE NOTE: The "X" in center of diagram below represents presently authorized point of diversion.)

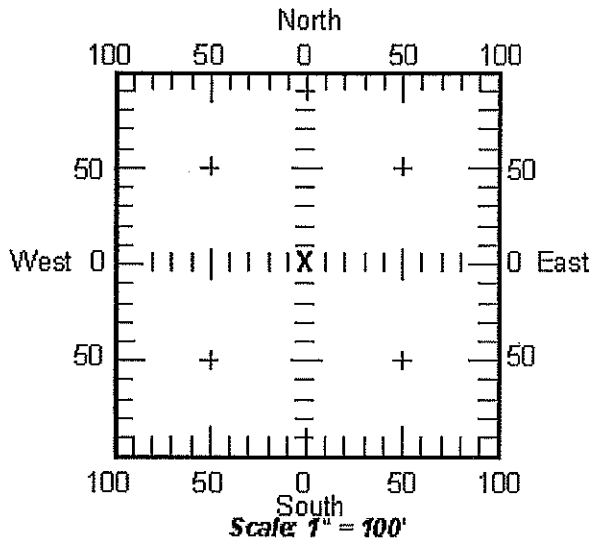

13b. If the proposed point of diversion will be relocated more than 100 feet but within 1320 feet from the existing point of diversion, attach a topographic map or aerial photograph. For groundwater sources, show all wells (including domestic) within one-half mile of the proposed point of diversion and the names and mailing addresses of the owners. For surface water sources, show the names and addresses of the landowner(s) one-half mile downstream and one-half mile upstream from your property lines.

APPLICATION FOR APPROVAL TO CHANGE
THE PLACE OF USE AND/OR POINT OF DIVERSION
SUPPLEMENTAL SHEET
FILE NO. 18729
MAKE ADDITIONAL COPIES AS NECESSARY

3. *Continued:* The presently authorized place of use is:

Owner of Land ---- NAME: CIRCLE LAND & CATTLE CORPORATION
ADDRESS: 901 ARKANSAS AVE HOLCOMB KS 67851

Sec.	Twp.	Range	NE¼				NW¼				SW¼				SE¼				TOTAL ACRES
			NE¼	NW¼	SW¼	SE¼	NE¼	NW¼	SW¼	SE¼	NE¼	NW¼	SW¼	SE¼	NE¼	NW¼	SW¼	SE¼	
27	24	33	34	34	34	34					34	34	34	34	34	34	34	34	408

Owner of Land ---- NAME: _____
ADDRESS: _____

Sec.	Twp.	Range	NE¼				NW¼				SW¼				SE¼				TOTAL ACRES
			NE¼	NW¼	SW¼	SE¼	NE¼	NW¼	SW¼	SE¼	NE¼	NW¼	SW¼	SE¼	NE¼	NW¼	SW¼	SE¼	

Owner of Land ---- NAME: _____
ADDRESS: _____

Sec.	Twp.	Range	NE¼				NW¼				SW¼				SE¼				TOTAL ACRES
			NE¼	NW¼	SW¼	SE¼	NE¼	NW¼	SW¼	SE¼	NE¼	NW¼	SW¼	SE¼	NE¼	NW¼	SW¼	SE¼	

4. *Continued:* If this application is for a change in place of use, it is proposed that the place of use be changed to:

Owner of Land ---- NAME: CIRCLE LAND & CATTLE CORPORATION
ADDRESS: 901 ARKANSAS AVE HOLCOMB KS 67851

SEE ATTACHMENT B

Sec.	Twp.	Range	NE¼				NW¼				SW¼				SE¼				TOTAL ACRES
			NE¼	NW¼	SW¼	SE¼	NE¼	NW¼	SW¼	SE¼	NE¼	NW¼	SW¼	SE¼	NE¼	NW¼	SW¼	SE¼	
21	25	33	34.5	34.5	34.5	34.5	34.5	34.5	34.5	34.5	34.5	34.5	34.5	34.5	34.5	34.5	34.5	34.5	566
27	24	33	34	34	34	34					34	34	34	34	34	34	34	34	408
34	24	33	34	34	34	34	34	34	34	34	34	34	34	34	34	34	34	34	544

Owner of Land ---- NAME: CIRCLE LAND & CATTLE CORPORATION
ADDRESS: 901 ARKANSAS AVE HOLCOMB KS 67851

Sec.	Twp.	Range	NE¼				NW¼				SW¼				SE¼				TOTAL ACRES
			NE¼	NW¼	SW¼	SE¼	NE¼	NW¼	SW¼	SE¼	NE¼	NW¼	SW¼	SE¼	NE¼	NW¼	SW¼	SE¼	
3	25	33	34	34	34	34	37.5	37.5	37.5	37.5	37.5	37.5	37.5	37.5	37.5	37.5	37.5	37.5	586
10	25	33	34	34	34	34	34	34	34	34	37.5	37.5	37.5	37.5	34	34	34	34	558
15	25	33	34	34	34	34	34	34	34	34	34	34	34	34	34	34	34	34	544

Owner of Land ---- NAME: CIRCLE LAND & CATTLE CORPORATION
ADDRESS: 901 ARKANSAS AVE HOLCOMB KS 67851

Sec.	Twp.	Range	NE¼				NW¼				SW¼				SE¼				TOTAL ACRES
			NE¼	NW¼	SW¼	SE¼	NE¼	NW¼	SW¼	SE¼	NE¼	NW¼	SW¼	SE¼	NE¼	NW¼	SW¼	SE¼	
15	24	33		34							17	17	30					11	58
22	24	33		34	21		40	39	26	40	37.5	37.5	37.5	37.5	34	34	34	34	486
28	24	33	34	34	34	34	34	34	34	34	34	34	34	34	34	34	34	34	544

APPLICATION FOR APPROVAL TO CHANGE
THE PLACE OF USE AND/OR POINT OF DIVERSION
SUPPLEMENTAL SHEET
FILE NO. 18729
MAKE ADDITIONAL COPIES AS NECESSARY

3. *Continued:* The presently authorized place of use is:

Owner of Land ---- NAME: _____
ADDRESS: _____

Sec.	Twp.	Range	NE¼				NW¼				SW¼				SE¼				TOTAL ACRES		
			NE¼	NW¼	SW¼	SE¼	NE¼	NW¼	SW¼	SE¼	NE¼	NW¼	SW¼	SE¼	NE¼	NW¼	SW¼	SE¼			

Owner of Land ---- NAME: _____
ADDRESS: _____

Sec.	Twp.	Range	NE¼				NW¼				SW¼				SE¼				TOTAL ACRES			
			NE¼	NW¼	SW¼	SE¼	NE¼	NW¼	SW¼	SE¼	NE¼	NW¼	SW¼	SE¼	NE¼	NW¼	SW¼	SE¼				

Owner of Land ---- NAME: _____
ADDRESS: _____

Sec.	Twp.	Range	NE¼				NW¼				SW¼				SE¼				TOTAL ACRES				
			NE¼	NW¼	SW¼	SE¼	NE¼	NW¼	SW¼	SE¼	NE¼	NW¼	SW¼	SE¼	NE¼	NW¼	SW¼	SE¼					

4. *Continued:* If this application is for a change in place of use, it is proposed that the place of use be changed to:

Owner of Land ---- NAME: CIRCLE LAND & CATTLE CORPORATION *SEE ATTACHMENT B*
ADDRESS: 901 ARKANSAS AVE HOLCOMB KS 67851

Sec.	Twp.	Range	NE¼				NW¼				SW¼				SE¼				TOTAL ACRES			
			NE¼	NW¼	SW¼	SE¼	NE¼	NW¼	SW¼	SE¼	NE¼	NW¼	SW¼	SE¼	NE¼	NW¼	SW¼	SE¼				
33	24	33	34	34	34	34	34	34	34	34	34	34	34	34	34	34	34	34	34	34	34	544
16	24	33	<i>(Lot 1 Lot 2)</i>				<i>(Lot 3 Lot 4)</i>		15	8	<i>31 AC 7 03 AC 8 20 AC 15 31 AC 16</i>		20	38	35	24						269
4	25	33	34	34	34	34	34	34	34	34	34	34	34	34	34	34	34	34	34	34	34	544

Owner of Land ---- NAME: CIRCLE LAND & CATTLE CORPORATION
ADDRESS: 901 ARKANSAS AVE HOLCOMB KS 67851

Sec.	Twp.	Range	NE¼				NW¼				SW¼				SE¼				TOTAL ACRES			
			NE¼	NW¼	SW¼	SE¼	NE¼	NW¼	SW¼	SE¼	NE¼	NW¼	SW¼	SE¼	NE¼	NW¼	SW¼	SE¼				
5	25	33	<i>L1</i> 34	<i>L2</i> 34	34	34																272
8	25	33	34	34	34	34																272
9	25	33	34	34	34	34	34	34	34	34	34	34	34	34	34	34	34	34	34	34	34	544

Owner of Land ---- NAME: CIRCLE LAND & CATTLE CORPORATION
ADDRESS: 901 ARKANSAS AVE HOLCOMB KS 67851

Sec.	Twp.	Range	NE¼				NW¼				SW¼				SE¼				TOTAL ACRES			
			NE¼	NW¼	SW¼	SE¼	NE¼	NW¼	SW¼	SE¼	NE¼	NW¼	SW¼	SE¼	NE¼	NW¼	SW¼	SE¼				
16	25	33	34	34	34	34	34	34	34	34	34	34	34	34	34	34	34	34	34	34	34	544
17	25	33	34	34	34	34																272
21	24	33	38	38	26.5	26.5	38	38	26.5	26.5	34	34	34	34	34	34	34	34	34	34	34	530

APPLICATION FOR APPROVAL TO CHANGE
THE PLACE OF USE AND/OR POINT OF DIVERSION
SUPPLEMENTAL SHEET
FILE NO. 18729
MAKE ADDITIONAL COPIES AS NECESSARY

3. *Continued:* The presently authorized place of use is:

Owner of Land ---- NAME: _____
ADDRESS: _____

Sec.	Twp.	Range	NE¼				NW¼				SW¼				SE¼				TOTAL ACRES		
			NE¼	NW¼	SW¼	SE¼	NE¼	NW¼	SW¼	SE¼	NE¼	NW¼	SW¼	SE¼	NE¼	NW¼	SW¼	SE¼			

Owner of Land ---- NAME: _____
ADDRESS: _____

Sec.	Twp.	Range	NE¼				NW¼				SW¼				SE¼				TOTAL ACRES			
			NE¼	NW¼	SW¼	SE¼	NE¼	NW¼	SW¼	SE¼	NE¼	NW¼	SW¼	SE¼	NE¼	NW¼	SW¼	SE¼				

Owner of Land ---- NAME: _____
ADDRESS: _____

Sec.	Twp.	Range	NE¼				NW¼				SW¼				SE¼				TOTAL ACRES				
			NE¼	NW¼	SW¼	SE¼	NE¼	NW¼	SW¼	SE¼	NE¼	NW¼	SW¼	SE¼	NE¼	NW¼	SW¼	SE¼					

4. *Continued:* If this application is for a change in place of use, it is proposed that the place of use be changed to:

Owner of Land ---- NAME: CIRCLE LAND & CATTLE CORPORATION SEE ATTACHMENT B
ADDRESS: 901 ARKANSAS AVE HOLCOMB KS 67851

Sec.	Twp.	Range	NE¼				NW¼				SW¼				SE¼				TOTAL ACRES							
			NE¼	NW¼	SW¼	SE¼	NE¼	NW¼	SW¼	SE¼	NE¼	NW¼	SW¼	SE¼	NE¼	NW¼	SW¼	SE¼								
17	24	33																	8				2	10		

Owner of Land ---- NAME: _____
ADDRESS: _____

Sec.	Twp.	Range	NE¼				NW¼				SW¼				SE¼				TOTAL ACRES						
			NE¼	NW¼	SW¼	SE¼	NE¼	NW¼	SW¼	SE¼	NE¼	NW¼	SW¼	SE¼	NE¼	NW¼	SW¼	SE¼							

Owner of Land ---- NAME: _____
ADDRESS: _____

Sec.	Twp.	Range	NE¼				NW¼				SW¼				SE¼				TOTAL ACRES						
			NE¼	NW¼	SW¼	SE¼	NE¼	NW¼	SW¼	SE¼	NE¼	NW¼	SW¼	SE¼	NE¼	NW¼	SW¼	SE¼							

ATTACHMENT "B"
APPLICATION TO CHANGE THE PLACE OF USE
FILE NO. 18729
PROPOSED PLACE OF USE

17 acres in Lot 6
31 acres in Lot 5
4.0 acres in the Southeast Quarter of the Southwest Quarter (SE1/4 SW1/4),
6.0 acres in the Southwest Quarter of the Southeast Quarter (SW1/4 SE1/4),

a total of 58 acres in Section 15,

34 acres in Lot 1
21 acres in the Southwest Quarter of the Northeast Quarter (SW1/4 NE1/4),

40 acres in the Northeast Quarter of the Northwest Quarter (NE1/4 NW1/4),
39 acres in the Northwest Quarter of the Northwest Quarter (NW1/4 NW1/4),
26 acres in the Southwest Quarter of the Northwest Quarter (SW1/4 NW1/4),
40 acres in the Southeast Quarter of the Northwest Quarter (SE1/4 NW1/4),

37.5 acres in the Northeast Quarter of the Southwest Quarter (NE1/4 SW1/4),
37.5 acres in the Northwest Quarter of the Southwest Quarter (NW1/4 SW1/4),
37.5 acres in the Southwest Quarter of the Southwest Quarter (SW1/4 SW1/4),
37.5 acres in the Southeast Quarter of the Southwest Quarter (SE1/4 SW1/4),

34 acres in the Northeast Quarter of the Southeast Quarter (NE1/4 SE1/4),
34 acres in the Northwest Quarter of the Southeast Quarter (NW1/4 SE1/4),
34 acres in the Southwest Quarter of the Southeast Quarter (SW1/4 SE1/4),
34 acres in the Southeast Quarter of the Southeast Quarter (SE1/4 SE1/4),

a total of 486 acres in Section 22,

34 acres in the Northeast Quarter of the Northeast Quarter (NE1/4 NE1/4),
34 acres in the Northwest Quarter of the Northeast Quarter (NW1/4 NE1/4),
34 acres in the Southwest Quarter of the Northeast Quarter (SW1/4 NE1/4),
34 acres in the Southeast Quarter of the Northeast Quarter (SE1/4 NE1/4),

34 acres in the Northeast Quarter of the Northwest Quarter (NE1/4 NW1/4),
34 acres in the Northwest Quarter of the Northwest Quarter (NW1/4 NW1/4),
34 acres in the Southwest Quarter of the Northwest Quarter (SW1/4 NW1/4),
34 acres in the Southeast Quarter of the Northwest Quarter (SE1/4 NW1/4),

34 acres in the Northeast Quarter of the Southwest Quarter (NE1/4 SW1/4),
34 acres in the Northwest Quarter of the Southwest Quarter (NW1/4 SW1/4),
34 acres in the Southwest Quarter of the Southwest Quarter (SW1/4 SW1/4),
34 acres in the Southeast Quarter of the Southwest Quarter (SE1/4 SW1/4),

34 acres in the Northeast Quarter of the Southeast Quarter (NE1/4 SE1/4),
34 acres in the Northwest Quarter of the Southeast Quarter (NW1/4 SE1/4),
34 acres in the Southwest Quarter of the Southeast Quarter (SW1/4 SE1/4),
34 acres in the Southeast Quarter of the Southeast Quarter (SE1/4 SE1/4),

a total of 544 acres in Section 28,

ATTACHMENT "B"
APPLICATION TO CHANGE THE PLACE OF USE
FILE NO. 18729
PROPOSED PLACE OF USE

34 acres in the Northeast Quarter of the Northeast Quarter (NE1/4 NE1/4),
34 acres in the Northwest Quarter of the Northeast Quarter (NW1/4 NE1/4),
34 acres in the Southwest Quarter of the Northeast Quarter (SW1/4 NE1/4),
34 acres in the Southeast Quarter of the Northeast Quarter (SE1/4 NE1/4),

34 acres in the Northeast Quarter of the Northwest Quarter (NE1/4 NW1/4),
34 acres in the Northwest Quarter of the Northwest Quarter (NW1/4 NW1/4),
34 acres in the Southwest Quarter of the Northwest Quarter (SW1/4 NW1/4),
34 acres in the Southeast Quarter of the Northwest Quarter (SE1/4 NW1/4),

34 acres in the Northeast Quarter of the Southwest Quarter (NE1/4 SW1/4),
34 acres in the Northwest Quarter of the Southwest Quarter (NW1/4 SW1/4),
34 acres in the Southwest Quarter of the Southwest Quarter (SW1/4 SW1/4),
34 acres in the Southeast Quarter of the Southwest Quarter (SE1/4 SW1/4),

34 acres in the Northeast Quarter of the Southeast Quarter (NE1/4 SE1/4),
34 acres in the Northwest Quarter of the Southeast Quarter (NW1/4 SE1/4),
34 acres in the Southwest Quarter of the Southeast Quarter (SW1/4 SE1/4),
34 acres in the Southeast Quarter of the Southeast Quarter (SE1/4 SE1/4),

a total of 544 acres in Section 33,

15 acres in the Southwest Quarter of the Northwest Quarter (SW1/4 NW1/4),
8 acres in the Southeast Quarter of the Northwest Quarter (SE1/4 NW1/4),

7 acres in the Northeast Quarter of the Southwest Quarter (NE1/4 SW1/4),
7 acres in the Northwest Quarter of the Southwest Quarter (NW1/4 SW1/4),
29 acres in the Southwest Quarter of the Southwest Quarter (SW1/4 SW1/4),
22 acres in the Southeast Quarter of the Southwest Quarter (SE1/4 SW1/4),

20 acres in Lot 5

7 acres in the Northwest Quarter of the Southeast Quarter (NW1/4 SE1/4),
35 acres in the Southwest Quarter of the Southeast Quarter (SW1/4 SE1/4),
24 acres in the Southeast Quarter of the Southeast Quarter (SE1/4 SE1/4),

31 acres in Lot 7,

33 acres in Lot 8,

31 acres in Lot 6,

a total of 269 acres in Section 16,

38 acres in the Northeast Quarter of the Northeast Quarter (NE1/4 NE1/4),
38 acres in the Northwest Quarter of the Northeast Quarter (NW1/4 NE1/4),
26.5 acres in the Southwest Quarter of the Northeast Quarter (SW1/4 NE1/4),
26.5 acres in the Southeast Quarter of the Northeast Quarter (SE1/4 NE1/4),

38 acres in the Northeast Quarter of the Northwest Quarter (NE1/4 NW1/4),
38 acres in the Northwest Quarter of the Northwest Quarter (NW1/4 NW1/4),
26.5 acres in the Southwest Quarter of the Northwest Quarter (SW1/4 NW1/4),

ATTACHMENT "B"
APPLICATION TO CHANGE THE PLACE OF USE
FILE NO. 18729
PROPOSED PLACE OF USE

26.5 acres in the Southeast Quarter of the Northwest Quarter (SE1/4 NW1/4),

34 acres in the Northeast Quarter of the Southwest Quarter (NE1/4 SW1/4),
34 acres in the Northwest Quarter of the Southwest Quarter (NW1/4 SW1/4),
34 acres in the Southwest Quarter of the Southwest Quarter (SW1/4 SW1/4),
34 acres in the Southeast Quarter of the Southwest Quarter (SE1/4 SW1/4),

34 acres in the Northeast Quarter of the Southeast Quarter (NE1/4 SE1/4),
34 acres in the Northwest Quarter of the Southeast Quarter (NW1/4 SE1/4),
34 acres in the Southwest Quarter of the Southeast Quarter (SW1/4 SE1/4),
34 acres in the Southeast Quarter of the Southeast Quarter (SE1/4 SE1/4),

a total of 530 acres in Section 21,

8 acres in Lot 4

2.0 acres in the Southeast Quarter of the Southeast Quarter (SE1/4 SE1/4),

a total of 10 acres in Section 17,

34 acres in the Northeast Quarter of the Northeast Quarter (NE1/4 NE1/4),
34 acres in the Northwest Quarter of the Northeast Quarter (NW1/4 NE1/4),
34 acres in the Southwest Quarter of the Northeast Quarter (SW1/4 NE1/4),
34 acres in the Southeast Quarter of the Northeast Quarter (SE1/4 NE1/4),

34 acres in the Northeast Quarter of the Southwest Quarter (NE1/4 SW1/4),
34 acres in the Northwest Quarter of the Southwest Quarter (NW1/4 SW1/4),
34 acres in the Southwest Quarter of the Southwest Quarter (SW1/4 SW1/4),
34 acres in the Southeast Quarter of the Southwest Quarter (SE1/4 SW1/4),

34 acres in the Northeast Quarter of the Southeast Quarter (NE1/4 SE1/4),
34 acres in the Northwest Quarter of the Southeast Quarter (NW1/4 SE1/4),
34 acres in the Southwest Quarter of the Southeast Quarter (SW1/4 SE1/4),
34 acres in the Southeast Quarter of the Southeast Quarter (SE1/4 SE1/4),

a total of 544 acres in Section 27,

34 acres in the Northeast Quarter of the Northeast Quarter (NE1/4 NE1/4),
34 acres in the Northwest Quarter of the Northeast Quarter (NW1/4 NE1/4),
34 acres in the Southwest Quarter of the Northeast Quarter (SW1/4 NE1/4),
34 acres in the Southeast Quarter of the Northeast Quarter (SE1/4 NE1/4),

34 acres in the Northeast Quarter of the Northwest Quarter (NE1/4 NW1/4),
34 acres in the Northwest Quarter of the Northwest Quarter (NW1/4 NW1/4),
34 acres in the Southwest Quarter of the Northwest Quarter (SW1/4 NW1/4),
34 acres in the Southeast Quarter of the Northwest Quarter (SE1/4 NW1/4),

34 acres in the Northeast Quarter of the Southwest Quarter (NE1/4 SW1/4),
34 acres in the Northwest Quarter of the Southwest Quarter (NW1/4 SW1/4),

ATTACHMENT "B"
APPLICATION TO CHANGE THE PLACE OF USE
FILE NO. 18729
PROPOSED PLACE OF USE

34 acres in the Southwest Quarter of the Southwest Quarter (SW1/4 SW1/4),
34 acres in the Southeast Quarter of the Southwest Quarter (SE1/4 SW1/4),

34 acres in the Northeast Quarter of the Southeast Quarter (NE1/4 SE1/4),
34 acres in the Northwest Quarter of the Southeast Quarter (NW1/4 SE1/4),
34 acres in the Southwest Quarter of the Southeast Quarter (SW1/4 SE1/4),
34 acres in the Southeast Quarter of the Southeast Quarter (SE1/4 SE1/4),

a total of 544 acres in Section 34,
all in Township 24 South, Range 33 west, in Finney County, Kansas

34.5 acres in the Northeast Quarter of the Northeast Quarter (NE1/4 NE1/4),
34.5 acres in the Northwest Quarter of the Northeast Quarter (NW1/4 NE1/4),
34.5 acres in the Southwest Quarter of the Northeast Quarter (SW1/4 NE1/4),
34.5 acres in the Southeast Quarter of the Northeast Quarter (SE1/4 NE1/4),

34.5 acres in the Northeast Quarter of the Northwest Quarter (NE1/4 NW1/4),
34.5 acres in the Northwest Quarter of the Northwest Quarter (NW1/4 NW1/4),
34.5 acres in the Southwest Quarter of the Northwest Quarter (SW1/4 NW1/4),
34.5 acres in the Southeast Quarter of the Northwest Quarter (SE1/4 NW1/4),

34.5 acres in the Northeast Quarter of the Southwest Quarter (NE1/4 SW1/4),
34.5 acres in the Northwest Quarter of the Southwest Quarter (NW1/4 SW1/4),
34.5 acres in the Southwest Quarter of the Southwest Quarter (SW1/4 SW1/4),
34.5 acres in the Southeast Quarter of the Southwest Quarter (SE1/4 SW1/4),

38 acres in the Northeast Quarter of the Southeast Quarter (NE1/4 SE1/4),
38 acres in the Northwest Quarter of the Southeast Quarter (NW1/4 SE1/4),
38 acres in the Southwest Quarter of the Southeast Quarter (SW1/4 SE1/4),
38 acres in the Southeast Quarter of the Southeast Quarter (SE1/4 SE1/4),

a total of 566 acres in Section 21,

34 acres in Lot 1 (NE1/4 NE1/4),
34 acres in Lot 2 (NW1/4 NE1/4),
34 acres in the Southwest Quarter of the Northeast Quarter (SW1/4 NE1/4),
34 acres in the Southeast Quarter of the Northeast Quarter (SE1/4 NE1/4),

37.5 acres in Lot 3 (NE1/4 NW1/4),
37.5 acres in Lot 4 (NW1/4 NW1/4),
37.5 acres in the Southwest Quarter of the Northwest Quarter (SW1/4 NW1/4),
37.5 acres in the Southeast Quarter of the Northwest Quarter (SE1/4 NW1/4),

37.5 acres in the Northeast Quarter of the Southwest Quarter (NE1/4 SW1/4),
37.5 acres in the Northwest Quarter of the Southwest Quarter (NW1/4 SW1/4),
37.5 acres in the Southwest Quarter of the Southwest Quarter (SW1/4 SW1/4),
37.5 acres in the Southeast Quarter of the Southwest Quarter (SE1/4 SW1/4),

37.5 acres in the Northeast Quarter of the Southeast Quarter (NE1/4 SE1/4),
37.5 acres in the Northwest Quarter of the Southeast Quarter (NW1/4 SE1/4),

ATTACHMENT "B"
APPLICATION TO CHANGE THE PLACE OF USE
FILE NO. 18729
PROPOSED PLACE OF USE

37.5 acres in the Southwest Quarter of the Southeast Quarter (SW1/4 SE1/4),
37.5 acres in the Southeast Quarter of the Southeast Quarter (SE1/4 SE1/4),

a total of 586 acres in Section 3,

34 acres in the Northeast Quarter of the Northeast Quarter (NE1/4 NE1/4),
34 acres in the Northwest Quarter of the Northeast Quarter (NW1/4 NE1/4),
34 acres in the Southwest Quarter of the Northeast Quarter (SW1/4 NE1/4),
34 acres in the Southeast Quarter of the Northeast Quarter (SE1/4 NE1/4),

34 acres in the Northeast Quarter of the Northwest Quarter (NE1/4 NW1/4),
34 acres in the Northwest Quarter of the Northwest Quarter (NW1/4 NW1/4),
34 acres in the Southwest Quarter of the Northwest Quarter (SW1/4 NW1/4),
34 acres in the Southeast Quarter of the Northwest Quarter (SE1/4 NW1/4),

37.5 acres in the Northeast Quarter of the Southwest Quarter (NE1/4 SW1/4),
37.5 acres in the Northwest Quarter of the Southwest Quarter (NW1/4 SW1/4),
37.5 acres in the Southwest Quarter of the Southwest Quarter (SW1/4 SW1/4),
37.5 acres in the Southeast Quarter of the Southwest Quarter (SE1/4 SW1/4),

34 acres in the Northeast Quarter of the Southeast Quarter (NE1/4 SE1/4),
34 acres in the Northwest Quarter of the Southeast Quarter (NW1/4 SE1/4),
34 acres in the Southwest Quarter of the Southeast Quarter (SW1/4 SE1/4),
34 acres in the Southeast Quarter of the Southeast Quarter (SE1/4 SE1/4),

a total of 558 acres in Section 10,

34 acres in the Northeast Quarter of the Northeast Quarter (NE1/4 NE1/4),
34 acres in the Northwest Quarter of the Northeast Quarter (NW1/4 NE1/4),
34 acres in the Southwest Quarter of the Northeast Quarter (SW1/4 NE1/4),
34 acres in the Southeast Quarter of the Northeast Quarter (SE1/4 NE1/4),

34 acres in the Northeast Quarter of the Northwest Quarter (NE1/4 NW1/4),
34 acres in the Northwest Quarter of the Northwest Quarter (NW1/4 NW1/4),
34 acres in the Southwest Quarter of the Northwest Quarter (SW1/4 NW1/4),
34 acres in the Southeast Quarter of the Northwest Quarter (SE1/4 NW1/4),

34 acres in the Northeast Quarter of the Southwest Quarter (NE1/4 SW1/4),
34 acres in the Northwest Quarter of the Southwest Quarter (NW1/4 SW1/4),
34 acres in the Southwest Quarter of the Southwest Quarter (SW1/4 SW1/4),
34 acres in the Southeast Quarter of the Southwest Quarter (SE1/4 SW1/4),

34 acres in the Northeast Quarter of the Southeast Quarter (NE1/4 SE1/4),
34 acres in the Northwest Quarter of the Southeast Quarter (NW1/4 SE1/4),
34 acres in the Southwest Quarter of the Southeast Quarter (SW1/4 SE1/4),
34 acres in the Southeast Quarter of the Southeast Quarter (SE1/4 SE1/4),

a total of 544 acres in Section 15,

ATTACHMENT "B"
APPLICATION TO CHANGE THE PLACE OF USE
FILE NO. 18729
PROPOSED PLACE OF USE

34 acres in Lot 1 (NE1/4 NE1/4),
34 acres in Lot 2 (NW1/4 NE1/4),
34 acres in the Southwest Quarter of the Northeast Quarter (SW1/4 NE1/4),
34 acres in the Southeast Quarter of the Northeast Quarter (SE1/4 NE1/4),

34 acres in Lot 3 (NE1/4 NW1/4),
34 acres in Lot 4 (NW1/4 NW1/4),
34 acres in the Southwest Quarter of the Northwest Quarter (SW1/4 NW1/4),
34 acres in the Southeast Quarter of the Northwest Quarter (SE1/4 NW1/4),

34 acres in the Northeast Quarter of the Southwest Quarter (NE1/4 SW1/4),
34 acres in the Northwest Quarter of the Southwest Quarter (NW1/4 SW1/4),
34 acres in the Southwest Quarter of the Southwest Quarter (SW1/4 SW1/4),
34 acres in the Southeast Quarter of the Southwest Quarter (SE1/4 SW1/4),

34 acres in the Northeast Quarter of the Southeast Quarter (NE1/4 SE1/4),
34 acres in the Northwest Quarter of the Southeast Quarter (NW1/4 SE1/4),
34 acres in the Southwest Quarter of the Southeast Quarter (SW1/4 SE1/4),
34 acres in the Southeast Quarter of the Southeast Quarter (SE1/4 SE1/4),

a total of 544 acres in Section 4,

34 acres in Lot 1 (NE1/4 NE1/4),
34 acres in Lot 2 (NW1/4 NE1/4),
34 acres in the Southwest Quarter of the Northeast Quarter (SW1/4 NE1/4),
34 acres in the Southeast Quarter of the Northeast Quarter (SE1/4 NE1/4),

34 acres in the Northeast Quarter of the Southeast Quarter (NE1/4 SE1/4),
34 acres in the Northwest Quarter of the Southeast Quarter (NW1/4 SE1/4),
34 acres in the Southwest Quarter of the Southeast Quarter (SW1/4 SE1/4),
34 acres in the Southeast Quarter of the Southeast Quarter (SE1/4 SE1/4),

a total of 272 acres in Section 5,

34 acres in the Northeast Quarter of the Northeast Quarter (NE1/4 NE1/4),
34 acres in the Northwest Quarter of the Northeast Quarter (NW1/4 NE1/4),
34 acres in the Southwest Quarter of the Northeast Quarter (SW1/4 NE1/4),
34 acres in the Southeast Quarter of the Northeast Quarter (SE1/4 NE1/4),

34 acres in the Northeast Quarter of the Southeast Quarter (NE1/4 SE1/4),
34 acres in the Northwest Quarter of the Southeast Quarter (NW1/4 SE1/4),
34 acres in the Southwest Quarter of the Southeast Quarter (SW1/4 SE1/4),
34 acres in the Southeast Quarter of the Southeast Quarter (SE1/4 SE1/4),

a total of 272 acres in Section 8,

34 acres in the Northeast Quarter of the Northeast Quarter (NE1/4 NE1/4),
34 acres in the Northwest Quarter of the Northeast Quarter (NW1/4 NE1/4),

ATTACHMENT "B"
APPLICATION TO CHANGE THE PLACE OF USE
FILE NO. 18729
PROPOSED PLACE OF USE

34 acres in the Southwest Quarter of the Northeast Quarter (SW1/4 NE1/4),
34 acres in the Southeast Quarter of the Northeast Quarter (SE1/4 NE1/4),

34 acres in the Northeast Quarter of the Northwest Quarter (NE1/4 NW1/4),
34 acres in the Northwest Quarter of the Northwest Quarter (NW1/4 NW1/4),
34 acres in the Southwest Quarter of the Northwest Quarter (SW1/4 NW1/4),
34 acres in the Southeast Quarter of the Northwest Quarter (SE1/4 NW1/4),

34 acres in the Northeast Quarter of the Southwest Quarter (NE1/4 SW1/4),
34 acres in the Northwest Quarter of the Southwest Quarter (NW1/4 SW1/4),
34 acres in the Southwest Quarter of the Southwest Quarter (SW1/4 SW1/4),
34 acres in the Southeast Quarter of the Southwest Quarter (SE1/4 SW1/4),

34 acres in the Northeast Quarter of the Southeast Quarter (NE1/4 SE1/4),
34 acres in the Northwest Quarter of the Southeast Quarter (NW1/4 SE1/4),
34 acres in the Southwest Quarter of the Southeast Quarter (SW1/4 SE1/4),
34 acres in the Southeast Quarter of the Southeast Quarter (SE1/4 SE1/4),

a total of 544 acres in Section 9,

34 acres in the Northeast Quarter of the Northeast Quarter (NE1/4 NE1/4),
34 acres in the Northwest Quarter of the Northeast Quarter (NW1/4 NE1/4),
34 acres in the Southwest Quarter of the Northeast Quarter (SW1/4 NE1/4),
34 acres in the Southeast Quarter of the Northeast Quarter (SE1/4 NE1/4),

34 acres in the Northeast Quarter of the Northwest Quarter (NE1/4 NW1/4),
34 acres in the Northwest Quarter of the Northwest Quarter (NW1/4 NW1/4),
34 acres in the Southwest Quarter of the Northwest Quarter (SW1/4 NW1/4),
34 acres in the Southeast Quarter of the Northwest Quarter (SE1/4 NW1/4),

34 acres in the Northeast Quarter of the Southwest Quarter (NE1/4 SW1/4),
34 acres in the Northwest Quarter of the Southwest Quarter (NW1/4 SW1/4),
34 acres in the Southwest Quarter of the Southwest Quarter (SW1/4 SW1/4),
34 acres in the Southeast Quarter of the Southwest Quarter (SE1/4 SW1/4),

34 acres in the Northeast Quarter of the Southeast Quarter (NE1/4 SE1/4),
34 acres in the Northwest Quarter of the Southeast Quarter (NW1/4 SE1/4),
34 acres in the Southwest Quarter of the Southeast Quarter (SW1/4 SE1/4),
34 acres in the Southeast Quarter of the Southeast Quarter (SE1/4 SE1/4),

a total of 544 acres in Section 16,

34 acres in the Northeast Quarter of the Northeast Quarter (NE1/4 NE1/4),
34 acres in the Northwest Quarter of the Northeast Quarter (NW1/4 NE1/4),
34 acres in the Southwest Quarter of the Northeast Quarter (SW1/4 NE1/4),
34 acres in the Southeast Quarter of the Northeast Quarter (SE1/4 NE1/4),

34 acres in the Northeast Quarter of the Southeast Quarter (NE1/4 SE1/4),
34 acres in the Northwest Quarter of the Southeast Quarter (NW1/4 SE1/4),
34 acres in the Southwest Quarter of the Southeast Quarter (SW1/4 SE1/4),

ATTACHMENT "B"
APPLICATION TO CHANGE THE PLACE OF USE
FILE NO. 18729
PROPOSED PLACE OF USE

34 acres in the Southeast Quarter of the Southeast Quarter (SE1/4 SE1/4),
a total of 272 acres in Section 17,
all in Township 25 South, Range 33 west, in Finney County, Kansas

14. If the proposed groundwater point of diversion is 300 or fewer feet from existing point of diversion, complete the following:

- (a) Does the undersigned represent all owners of the currently authorized place(s) of use identified in this application?
 Yes No (If no, all owners must sign this application.)
- (b) Will the ownership interest of any owner of the currently authorized place(s) of use identified in this application be adversely affected if this application is approved as requested?
 Yes No (If yes, all owners must sign this application.)
- (c) If this application is not approved expeditiously, will there be substantial damage to property, public health or safety?
 Yes No (If no, all owners must sign this application.)

If the application proposes a surface water change in point of diversion, a groundwater change in point of diversion greater than 300 feet, or a change in place of use, the application must be signed by all owners of the currently authorized place of use, or their duly authorized agent (attach notarized statement authorizing representation).

I hereby verify, being first duly sworn upon my oath or affirmation and under penalty of perjury, that I am of lawful age and the owner, the spouse of the owner, or a duly authorized agent of the owner(s) to make this application on their behalf, in regard to the water right(s) to which this application pertains. I further verify that the statements contained in this application are true, correct and complete.

Dated at Garden City, Kansas, this 14th day of February, 2018.

<u>[Signature]</u> (Owner)	_____	(Spouse)
<u>Gina Bigot</u> (Please Print)	_____	(Please Print)
<u>[Signature]</u> (Owner)	_____	(Spouse)
<u>Marc Bigot</u> (Please Print)	_____	(Please Print)
_____	_____	(Spouse)
_____	_____	(Please Print)

State of Kansas }
County of Finney } SS

I hereby certify that the foregoing application was signed in my presence and sworn to before me this 14th day of February



My Commission Expires _____

[Signature]
Notary Public

ONLY COMPLETE APPLICATIONS WILL BE PROCESSED. To be complete, all of the applicable portions of the application form must be completed with accurate information; maps, if necessary, must be included; signatures of all the appropriate owners' must be affixed to the application and notarized; and the appropriate fee must be paid.

FEE SCHEDULE

Each application to change the place of use or the point of diversion under this section shall be accompanied by the application fee set forth in the schedule below: Make checks payable to: **Kansas Department of Agriculture**

- (1) Application to change a point of diversion 300 feet or less \$100
- (2) Application to change a point of diversion more than 300 feet \$200
- (3) Application to change the place of use \$200

SUMMARY ORDER APPROVING APPLICATION FOR CHANGE AND IMPOSING CONDITIONS

This Summary Order is issued under authority of K.S.A. 82a-708b, as amended, and K.A.R. 5-14-3 and other applicable provisions of the *Kansas Water Appropriation Law, K.S.A. 82a-701 et. seq.*, and rules and regulations promulgated thereunder, K.A.R. 5-1-1 *et. seq.* With the exception of those conditions expressly contained herein, this Summary Order does not change the terms, conditions and limitations of File No. 18729.

1. A change application was received on FEBRUARY 14, 2018 requesting that the place of use and / or point of diversion authorized under the above-referenced file number be changed as described in the application.
2. On and after the effective date of this summary order, the authorized place(s) of use shall be located substantially as shown on the topographic map accompanying the application to change the place of use. Applicable Not Applicable
3. The change in point of diversion shall not impair existing rights and shall be limited to the same source or sources of water as previously authorized. The point of diversion authorized by this summary order shall be located within a _____ foot radius of the authorized point(s) of diversion. Applicable Not Applicable
4. The point(s) of diversion authorized herein shall not actually be located more than _____ feet from the previously authorized point(s) of diversion. Applicable Not Applicable
5. As required by K.A.R. 5-3-5d, if the works for diversion is a well with a diversion rate of 100 gallons per minute or more, a tube or other device suitable for making water level measurements shall be installed, operated and maintained in accordance with K.A.R. 5-6-13. Applicable Not Applicable
6. The owner of the authorized place(s) of use shall properly install an acceptable water flow meter on or before December 31, 2018, or before the first use of water, whichever occurs first. The water flow meter shall be installed, operated and maintained in accordance with K.A.R. 5-1-4 through 5-1-12. As required by K.S.A. 82a-732, as amended, and K.A.R. 5-3-5e, the owner shall maintain records and report the reading of the water flow meter and the total quantity of water diverted annually to the Chief Engineer by March 1 following the end of each calendar year. Applicable Not Applicable
7. Installation of the works for diversion of water shall be completed on or before December 31, 20_____, or within any authorized extension of time. By March 1, 20____ the applicant shall notify the Chief Engineer that construction of the works for diversion has been completed, on the form provided by the Chief Engineer, as required by K.A.R. 5-8-4e. Applicable Not Applicable
8. The completed well log shall be submitted with the required notice. Applicable Not Applicable
9. All diversion works into which any type of chemical or other foreign substance will be injected into the water shall be equipped with an in-line, automatic, quick-closing check valve capable of preventing pollution of the source of the water supply. The check valve(s) shall be installed, operated and maintained in accordance with K.A.R. 5-3-5c. Applicable Not Applicable
10. Additional Conditions are attached. Yes No
11. In accordance with K.S.A. 82a-708a, as amended, and K.A.R. 5-5-14, all of the owners of the authorized place(s) of use of water appropriated under the above-referenced file number are responsible for compliance with its terms, conditions and limitations, as amended and/or supplemented by this Summary Order, and with applicable provisions of the *Kansas Water Appropriation Law* and the *Rules and Regulations* promulgated thereunder. Failure to comply with these provisions may result in civil penalties pursuant to K.S.A. 82a-737, as amended, and/or the suspension or revocation and dismissal of the water or appropriation right or any other enforcement actions authorized by law.

Administrative Appeal and Effective Date of Order

You have the right to a hearing in accordance with K.A.R. 5-14-3 before this Summary Order becomes final action of the Kansas Department of Agriculture. Any request for a hearing must be filed with the **Chief Engineer, Division of Water Resources, Kansas Department of Agriculture, 109 SW 9th Street, Topeka, Kansas 66612**, within 15 days after the date shown on the Certificate of Service attached hereto. If a hearing is not requested in accordance with K.A.R. 5-14-3, this Summary Order will become effective on the 15th day after the date shown on the Certificate of Service.

For Use by Register of Deeds

FOR OFFICE USE ONLY
APPLICATION APPROVED AND
SUMMARY ORDER ISSUED

By: Thomas P. Makens
 Duly Authorized Designee of the Chief Engineer
 (Print Name): THOMAS P. MAKENS
 Division of Water Resources - Kansas Department of Agriculture
 Date of Issuance: April 5, 2018
 State of Kansas _____)
 County of Finney _____) ss
 Acknowledged before me on April 5, 2018
 by Thomas P. Makens
 Signature: Sue Keeny
 Notary Public

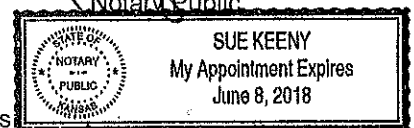

My commission expires _____

(Notary Seal)

Change in Place of Use: WR 18729



I agree to the best of my knowledge that all known water wells (IRR, DOM, IND, etc) are shown within green circles on map. If not, I have edited the map indicating the location of the well type & owner information.

Signature: *[Handwritten Signature]*

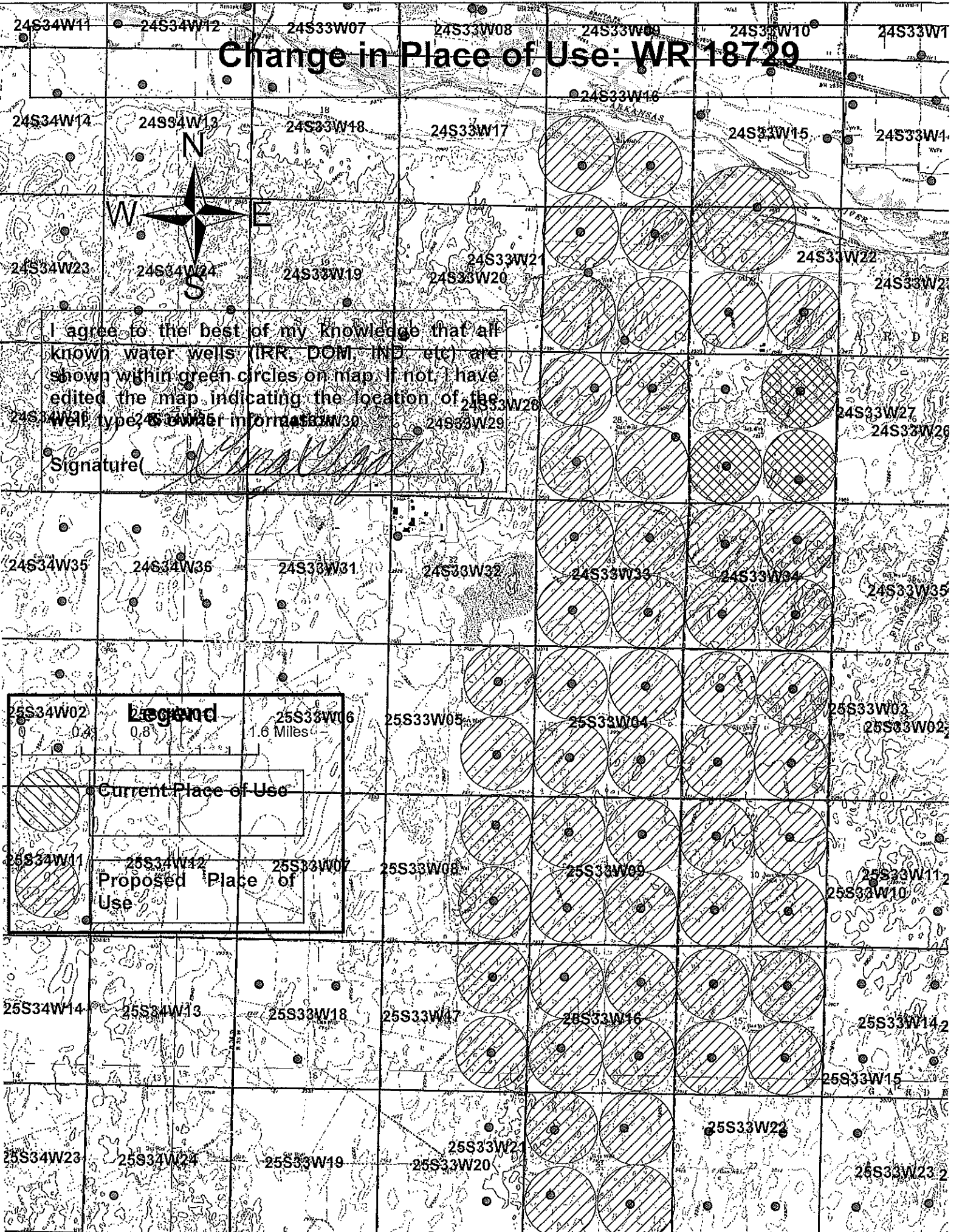

Legend

0.4 0.8 1.6 Miles

Current Place of Use

Proposed Place of Use

