









# STATE OF KANSAS



DEPARTMENT OF AGRICULTURE  
DIVISION OF WATER RESOURCES  
GARDEN CITY FIELD OFFICE  
2508 JOHNS STREET  
GARDEN CITY, KS 67846-2804

PHONE: (620) 276-2901  
FAX: (620) 276-9315  
www.agriculture.ks.gov

GOVERNOR JEFF COLYER, M.D.  
JACKIE McCLASKEY, SECRETARY OF AGRICULTURE

April 13, 2018

CIRCLE LAND & CATTLE CORPORATION  
901 ARKANSAS AVE  
HOLCOMB KS 67851

RE: Change the Place of Use, File Nos 12821 18729 18730  
18731 18732 18733 18903 18976 18977 18978 18979 18980  
18981 18982

Dear Mr. Stillwell;

Enclosed you will find a *Summary Order Approving Application for Change in Place of Use* for the above referenced files. These orders modify the authorized acres that can be irrigated by these files. The authorized place of use is as shown on the plats within the change approvals.

A condition of this order is that an acceptable flow meter must be properly installed on the diversion works authorized under the referenced file number in accordance with the Kansas Administrative Regulations 5-1-4 through 5-1-12. This water flow meter shall be used to provide information required on the annual water use report (including the meter reading at the beginning and end of the report year).

This order shall become final if a request for a hearing is not filed with the Chief Engineer within 15 days of the date of service of this order. The date of service is the date listed on the enclosed *Certificate of Service*.

Should you have any questions, please feel free to call this office or arrange an appointment for additional assistance. Please refer to the file number when you contact us if you wish to discuss a specific file.

Sincerely,

Thomas P. Makens  
Assistant Water Commissioner

TPM:tpm  
Enclosures  
GMD#3

**CERTIFICATE OF SERVICE**

On this 16<sup>th</sup> day of April 2018, I hereby certify that the attached original Approval of Application to Change the Place of Use under Water Right File 12821 18729 18730 18731 18732 18733 18903 18976 18977 18978 18979 18980 18981 18982 dated April 5, 2018, was provided in person to the following:

CIRCLE LAND & CATTLE CORPORATION  
901 ARKANSAS AVE  
HOLCOMB KS 67851

Copy provided to GMD#3



---

Division of Water Resources

Submit completed application to:  
 Kansas Department of Agriculture  
 Division of Water Resources  
 Field Office for your area.  
 Call for address:

Topeka -- (785) 862-6300  
 Stafford -- (620) 234-5311  
 Stockton -- (785) 425-6787  
 Garden City -- (620) 276-2901  
[www.ksda.gov/dwr](http://www.ksda.gov/dwr)

## DWR FIELD OFFICE APPLICATION FOR APPROVAL TO CHANGE THE PLACE OF USE AND/OR THE POINT OF DIVERSION



STATE OF KANSAS

Filing Fee Must Accompany the Application, K.S.A. 82a-708b(b), as amended.  
 Fee Schedule is on the third page of this application form.

Paragraph Nos. 1, 2, 3 & 5 must be completed. Complete all other applicable portions. If change in point of diversion is greater than 100 feet, or if place of use will be changed, include a topographic map or detailed plat showing the authorized and proposed point(s) of diversion and/or place of use.

RECEIVED  
 1:23pm  
 FEB 14 2018

File No. 18977

1. Application is hereby made for approval of the Chief Engineer to change the (check one or both): Garden City Field Office  
Division of Water Resources
- Place of Use                       Point of Diversion
- under the water right which is the subject of this application in accordance with the conditions described below.
- The source of supply is:                       Groundwater                       Surface water

2. Name and address of Applicant: CIRCLE LAND & CATTLE CORPORATION
- 901 ARKANSAS AVE HOLCOMB, KS 67851
- Phone Number: (     )                      Email address: \_\_\_\_\_
- Name and address of Water Use Correspondent: CIRCLE LAND & CATTLE CORPORATION
- 901 ARKANSAS AVE HOLCOMB, KS 67851
- Phone Number: (     )                      Email address: \_\_\_\_\_

3. The presently authorized place of use is:
- Owner of Land ---- NAME: SEE ATTACHMENTS
- ADDRESS: \_\_\_\_\_
- (If there is more than one landowner, attach supplemental sheets as necessary.)

Sec.	Twp.	Range	NE¼				NW¼				SW¼				SE¼				TOTAL ACRES	
			NE¼	NW¼	SW¼	SE¼	NE¼	NW¼	SW¼	SE¼	NE¼	NW¼	SW¼	SE¼	NE¼	NW¼	SW¼	SE¼		

4. If this application is for a change in place of use, it is proposed that the place of use be changed to:
- Owner of Land ---- NAME: SEE ATTACHMENTS
- ADDRESS: \_\_\_\_\_
- (If there is more than one landowner, attach supplemental sheets as necessary.)

Sec.	Twp.	Range	NE¼				NW¼				SW¼				SE¼				TOTAL ACRES	
			NE¼	NW¼	SW¼	SE¼	NE¼	NW¼	SW¼	SE¼	NE¼	NW¼	SW¼	SE¼	NE¼	NW¼	SW¼	SE¼		

For Office Use Only: Code _____ Fee \$ <u>200</u> TR # _____ Receipt Date <u>2/14/18</u> Check # <u>2521</u>
--

5. **Presently authorized point of diversion:**  
 One in the \_\_\_\_\_ Quarter of the \_\_\_\_\_ Quarter of the \_\_\_\_\_ Quarter  
 of Section \_\_\_\_\_, Township \_\_\_\_\_ South, Range \_\_\_\_\_ W,  
 in \_\_\_\_\_ County, Kansas, \_\_\_\_\_ feet North \_\_\_\_\_ feet West of Southeast corner of section.  
 Authorized Rate \_\_\_\_\_ Authorized Quantity \_\_\_\_\_ Depth of well \_\_\_\_\_ (feet)  
 (DWR use only: Computer ID No. \_\_\_\_\_ GPS \_\_\_\_\_ feet North \_\_\_\_\_ feet West)  
 This point will not be changed  This point will be changed as follows:  
**Proposed point of diversion: (Complete only if change is requested)**  
 One in the \_\_\_\_\_ Quarter of the \_\_\_\_\_ Quarter of the \_\_\_\_\_ Quarter  
 of Section \_\_\_\_\_, Township \_\_\_\_\_ South, Range \_\_\_\_\_ W,  
 in \_\_\_\_\_ County, Kansas, \_\_\_\_\_ feet North \_\_\_\_\_ feet West of Southeast corner of section.  
 Proposed Rate \_\_\_\_\_ Proposed Quantity \_\_\_\_\_ Proposed well depth (feet) \_\_\_\_\_  
 This point is:  Additional Well  Geo Center List other water rights that will use this point \_\_\_\_\_

6. **Presently authorized point of diversion:**  
 One in the \_\_\_\_\_ Quarter of the \_\_\_\_\_ Quarter of the \_\_\_\_\_ Quarter  
 of Section \_\_\_\_\_, Township \_\_\_\_\_ South, Range \_\_\_\_\_ W,  
 in \_\_\_\_\_ County, Kansas, \_\_\_\_\_ feet North \_\_\_\_\_ feet West of Southeast corner of section.  
 Authorized Rate \_\_\_\_\_ Authorized Quantity \_\_\_\_\_ Depth of well \_\_\_\_\_ (feet)  
 (DWR use only: Computer ID No. \_\_\_\_\_ GPS \_\_\_\_\_ feet North \_\_\_\_\_ feet West)  
 This point will not be changed  This point will be changed as follows:  
**Proposed point of diversion: (Complete only if change is requested)**  
 One in the \_\_\_\_\_ Quarter of the \_\_\_\_\_ Quarter of the \_\_\_\_\_ Quarter  
 of Section \_\_\_\_\_, Township \_\_\_\_\_ South, Range \_\_\_\_\_ (E/W),  
 in \_\_\_\_\_ County, Kansas, \_\_\_\_\_ feet North \_\_\_\_\_ feet West of Southeast corner of section.  
 Proposed Rate \_\_\_\_\_ Proposed Quantity \_\_\_\_\_ Proposed well depth (feet) \_\_\_\_\_  
 This point is:  Additional Well  Geo Center List other water rights that will use this point \_\_\_\_\_

7. Why do you need a new point of diversion? \_\_\_\_\_  
 No PD Change \_\_\_\_\_  
 \_\_\_\_\_

8. If a well, is the test hole log attached?  Yes  No

9. When do you propose to complete the new point of diversion?  
 \_\_\_\_\_

10. If the point of diversion is a well:  
 (a) What are you going to do with the old well?  
 \_\_\_\_\_  
 (b) When will this be done? \_\_\_\_\_

11. Groundwater Management District recommendation attached?  Yes  No

12. Assisted by \_\_\_\_\_

13a. If the proposed point of diversion will be relocated within 100 feet of the existing point of diversion, indicate its location on the diagram below in relation to the existing point of diversion. (PLEASE NOTE: The "X" in center of diagram below represents presently authorized point of diversion.)

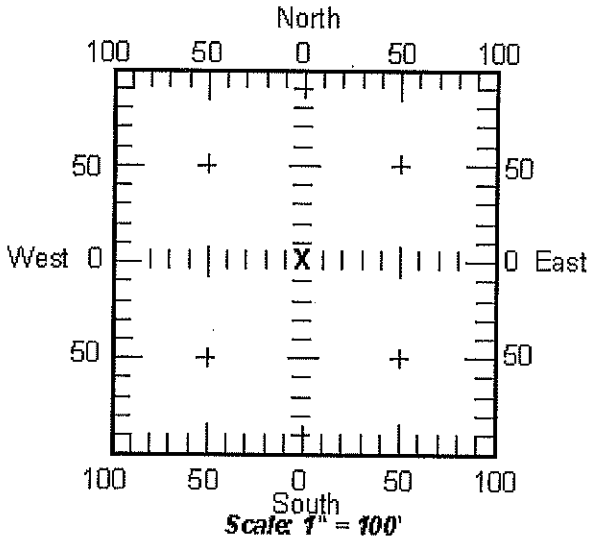

13b. If the proposed point of diversion will be relocated more than 100 feet but within 1320 feet from the existing point of diversion, attach a topographic map or aerial photograph. For groundwater sources, show all wells (including domestic) within one-half mile of the proposed point of diversion and the names and mailing addresses of the owners. For surface water sources, show the names and addresses of the landowner(s) one-half mile downstream and one-half mile upstream from your property lines.



APPLICATION FOR APPROVAL TO CHANGE  
THE PLACE OF USE AND/OR POINT OF DIVERSION  
SUPPLEMENTAL SHEET  
FILE NO. 18977  
MAKE ADDITIONAL COPIES AS NECESSARY

3. Continued: The presently authorized place of use is:

Owner of Land ----- NAME: CIRCLE LAND & CATTLE CORPORATION  
ADDRESS: 901 ARKANSAS AVE HOLCOMB KS 67851

Sec.	Twp.	Range	NE¼				NW¼				SW¼				SE¼				TOTAL ACRES	
			NE¼	NW¼	SW¼	SE¼	NE¼	NW¼	SW¼	SE¼	NE¼	NW¼	SW¼	SE¼	NE¼	NW¼	SW¼	SE¼		
33	24	33	34	34	34	34	34	34	34	34	34	34	34	34	34	34	34	34	34	544

Owner of Land ----- NAME: \_\_\_\_\_  
ADDRESS: \_\_\_\_\_

Sec.	Twp.	Range	NE¼				NW¼				SW¼				SE¼				TOTAL ACRES	
			NE¼	NW¼	SW¼	SE¼	NE¼	NW¼	SW¼	SE¼	NE¼	NW¼	SW¼	SE¼	NE¼	NW¼	SW¼	SE¼		

Owner of Land ----- NAME: \_\_\_\_\_  
ADDRESS: \_\_\_\_\_

Sec.	Twp.	Range	NE¼				NW¼				SW¼				SE¼				TOTAL ACRES	
			NE¼	NW¼	SW¼	SE¼	NE¼	NW¼	SW¼	SE¼	NE¼	NW¼	SW¼	SE¼	NE¼	NW¼	SW¼	SE¼		

4. Continued: If this application is for a change in place of use, it is proposed that the place of use be changed to:

Owner of Land ----- NAME: CIRCLE LAND & CATTLE CORPORATION  
ADDRESS: 901 ARKANSAS AVE HOLCOMB KS 67851

*SEE ATTACHMENT B*

Sec.	Twp.	Range	NE¼				NW¼				SW¼				SE¼				TOTAL ACRES		
			NE¼	NW¼	SW¼	SE¼	NE¼	NW¼	SW¼	SE¼	NE¼	NW¼	SW¼	SE¼	NE¼	NW¼	SW¼	SE¼			
21	25	33	34.5	34.5	34.5	34.5	34.5	34.5	34.5	34.5	34.5	34.5	34.5	34.5	34.5	34.5	34.5	34.5	34.5	34.5	566
27	24	33	34	34	34	34								34	34	34	34	34	34	34	408
34	24	33	34	34	34	34	34	34	34	34	34	34	34	34	34	34	34	34	34	34	544

Owner of Land ----- NAME: CIRCLE LAND & CATTLE CORPORATION  
ADDRESS: 901 ARKANSAS AVE HOLCOMB KS 67851

Sec.	Twp.	Range	NE¼				NW¼				SW¼				SE¼				TOTAL ACRES		
			NE¼	NW¼	SW¼	SE¼	NE¼	NW¼	SW¼	SE¼	NE¼	NW¼	SW¼	SE¼	NE¼	NW¼	SW¼	SE¼			
3	25	33	34	34	34	34	37.5	37.5	37.5	37.5	37.5	37.5	37.5	37.5	37.5	37.5	37.5	37.5	37.5	37.5	586
10	25	33	34	34	34	34	34	34	34	34	34	34	34	34	34	34	34	34	34	34	558
15	25	33	34	34	34	34	34	34	34	34	34	34	34	34	34	34	34	34	34	34	544

Owner of Land ----- NAME: CIRCLE LAND & CATTLE CORPORATION  
ADDRESS: 901 ARKANSAS AVE HOLCOMB KS 67851

Sec.	Twp.	Range	NE¼				NW¼				SW¼				SE¼				TOTAL ACRES		
			NE¼	NW¼	SW¼	SE¼	NE¼	NW¼	SW¼	SE¼	NE¼	NW¼	SW¼	SE¼	NE¼	NW¼	SW¼	SE¼			
15	24	33		34																	58
22	24	33		34	21		40	39	26	40	37.5	37.5	37.5	37.5	34	34	34	34	34	34	486
28	24	33	34	34	34	34	34	34	34	34	34	34	34	34	34	34	34	34	34	34	544

APPLICATION FOR APPROVAL TO CHANGE  
THE PLACE OF USE AND/OR POINT OF DIVERSION  
SUPPLEMENTAL SHEET  
**FILE NO. 18977**  
MAKE ADDITIONAL COPIES AS NECESSARY

3. *Continued:* The presently authorized place of use is:

Owner of Land ---- NAME: \_\_\_\_\_  
ADDRESS: \_\_\_\_\_

Sec.	Twp.	Range	NE¼				NW¼				SW¼				SE¼				TOTAL ACRES		
			NE¼	NW¼	SW¼	SE¼	NE¼	NW¼	SW¼	SE¼	NE¼	NW¼	SW¼	SE¼	NE¼	NW¼	SW¼	SE¼			

Owner of Land ---- NAME: \_\_\_\_\_  
ADDRESS: \_\_\_\_\_

Sec.	Twp.	Range	NE¼				NW¼				SW¼				SE¼				TOTAL ACRES			
			NE¼	NW¼	SW¼	SE¼	NE¼	NW¼	SW¼	SE¼	NE¼	NW¼	SW¼	SE¼	NE¼	NW¼	SW¼	SE¼				

Owner of Land ---- NAME: \_\_\_\_\_  
ADDRESS: \_\_\_\_\_

Sec.	Twp.	Range	NE¼				NW¼				SW¼				SE¼				TOTAL ACRES				
			NE¼	NW¼	SW¼	SE¼	NE¼	NW¼	SW¼	SE¼	NE¼	NW¼	SW¼	SE¼	NE¼	NW¼	SW¼	SE¼					

4. *Continued:* If this application is for a change in place of use, it is proposed that the place of use be changed to:

Owner of Land ---- NAME: CIRCLE LAND & CATTLE CORPORATION  
ADDRESS: 901 ARKANSAS AVE HOLCOMB KS 67851      *SEE ATTACHMENT B*

Sec.	Twp.	Range	NE¼				NW¼				SW¼				SE¼				TOTAL ACRES				
			NE¼	NW¼	SW¼	SE¼	NE¼	NW¼	SW¼	SE¼	NE¼	NW¼	SW¼	SE¼	NE¼	NW¼	SW¼	SE¼					
33	24	33	34	34	34	34	34	34	34	34	34	34	34	34	34	34	34	34	34	34	34	34	544
16	24	33	<i>Lot 1 Lot 2</i>				<i>Lot 3 Lot 4</i>				15	8	<i>31 ACRES 35 ACRES 20 ACRES 31 ACRES</i>				20	38	35	24	269		
4	25	33	34	34	34	34	34	34	34	34	34	34	34	34	34	34	34	34	34	34	34	34	544

Owner of Land ---- NAME: CIRCLE LAND & CATTLE CORPORATION  
ADDRESS: 901 ARKANSAS AVE HOLCOMB KS 67851

Sec.	Twp.	Range	NE¼				NW¼				SW¼				SE¼				TOTAL ACRES				
			NE¼	NW¼	SW¼	SE¼	NE¼	NW¼	SW¼	SE¼	NE¼	NW¼	SW¼	SE¼	NE¼	NW¼	SW¼	SE¼					
5	25	33	34	34	34	34																	272
8	25	33	34	34	34	34																	272
9	25	33	34	34	34	34	34	34	34	34	34	34	34	34	34	34	34	34	34	34	34	34	544

Owner of Land ---- NAME: CIRCLE LAND & CATTLE CORPORATION  
ADDRESS: 901 ARKANSAS AVE HOLCOMB KS 67851

Sec.	Twp.	Range	NE¼				NW¼				SW¼				SE¼				TOTAL ACRES				
			NE¼	NW¼	SW¼	SE¼	NE¼	NW¼	SW¼	SE¼	NE¼	NW¼	SW¼	SE¼	NE¼	NW¼	SW¼	SE¼					
16	25	33	34	34	34	34	34	34	34	34	34	34	34	34	34	34	34	34	34	34	34	34	544
17	25	33	34	34	34	34																	272
21	24	33	38	38	26.5	26.5	38	38	26.5	26.5	34	34	34	34	34	34	34	34	34	34	34	34	530

APPLICATION FOR APPROVAL TO CHANGE  
THE PLACE OF USE AND/OR POINT OF DIVERSION  
SUPPLEMENTAL SHEET  
FILE NO. 18977  
MAKE ADDITIONAL COPIES AS NECESSARY

3. *Continued:* The presently authorized place of use is:

Owner of Land ---- NAME: \_\_\_\_\_  
ADDRESS: \_\_\_\_\_

Sec.	Twp.	Range	NE¼				NW¼				SW¼				SE¼				TOTAL ACRES	
			NE¼	NW¼	SW¼	SE¼	NE¼	NW¼	SW¼	SE¼	NE¼	NW¼	SW¼	SE¼	NE¼	NW¼	SW¼	SE¼		

Owner of Land ---- NAME: \_\_\_\_\_  
ADDRESS: \_\_\_\_\_

Sec.	Twp.	Range	NE¼				NW¼				SW¼				SE¼				TOTAL ACRES	
			NE¼	NW¼	SW¼	SE¼	NE¼	NW¼	SW¼	SE¼	NE¼	NW¼	SW¼	SE¼	NE¼	NW¼	SW¼	SE¼		

Owner of Land ---- NAME: \_\_\_\_\_  
ADDRESS: \_\_\_\_\_

Sec.	Twp.	Range	NE¼				NW¼				SW¼				SE¼				TOTAL ACRES	
			NE¼	NW¼	SW¼	SE¼	NE¼	NW¼	SW¼	SE¼	NE¼	NW¼	SW¼	SE¼	NE¼	NW¼	SW¼	SE¼		

4. *Continued:* If this application is for a change in place of use, it is proposed that the place of use be changed to:

Owner of Land ---- NAME: CIRCLE LAND & CATTLE CORPORATION *SEE ATTACHMENT B*  
ADDRESS: 901 ARKANSAS AVE HOLCOMB KS 67851

Sec.	Twp.	Range	NE¼				NW¼				SW¼				SE¼				TOTAL ACRES				
			NE¼	NW¼	SW¼	SE¼	NE¼	NW¼	SW¼	SE¼	NE¼	NW¼	SW¼	SE¼	NE¼	NW¼	SW¼	SE¼					
<u>47</u>	<u>24</u>	<u>33</u>																					

Owner of Land ---- NAME: \_\_\_\_\_  
ADDRESS: \_\_\_\_\_

Sec.	Twp.	Range	NE¼				NW¼				SW¼				SE¼				TOTAL ACRES				
			NE¼	NW¼	SW¼	SE¼	NE¼	NW¼	SW¼	SE¼	NE¼	NW¼	SW¼	SE¼	NE¼	NW¼	SW¼	SE¼					

Owner of Land ---- NAME: \_\_\_\_\_  
ADDRESS: \_\_\_\_\_

Sec.	Twp.	Range	NE¼				NW¼				SW¼				SE¼				TOTAL ACRES				
			NE¼	NW¼	SW¼	SE¼	NE¼	NW¼	SW¼	SE¼	NE¼	NW¼	SW¼	SE¼	NE¼	NW¼	SW¼	SE¼					



**ATTACHMENT "B"**  
**APPLICATION TO CHANGE THE PLACE OF USE**  
**FILE NO. 18977**  
**PROPOSED PLACE OF USE**

17 acres in Lot 6  
31 acres in Lot 5  
4.0 acres in the Southeast Quarter of the Southwest Quarter (SE1/4 SW1/4),  
6.0 acres in the Southwest Quarter of the Southeast Quarter (SW1/4 SE1/4),  
  
a total of 58 acres in Section 15,

34 acres in Lot 1  
21 acres in the Southwest Quarter of the Northeast Quarter (SW1/4 NE1/4),

40 acres in the Northeast Quarter of the Northwest Quarter (NE1/4 NW1/4),  
39 acres in the Northwest Quarter of the Northwest Quarter (NW1/4 NW1/4),  
26 acres in the Southwest Quarter of the Northwest Quarter (SW1/4 NW1/4),  
40 acres in the Southeast Quarter of the Northwest Quarter (SE1/4 NW1/4),

37.5 acres in the Northeast Quarter of the Southwest Quarter (NE1/4 SW1/4),  
37.5 acres in the Northwest Quarter of the Southwest Quarter (NW1/4 SW1/4),  
37.5 acres in the Southwest Quarter of the Southwest Quarter (SW1/4 SW1/4),  
37.5 acres in the Southeast Quarter of the Southwest Quarter (SE1/4 SW1/4),

34 acres in the Northeast Quarter of the Southeast Quarter (NE1/4 SE1/4),  
34 acres in the Northwest Quarter of the Southeast Quarter (NW1/4 SE1/4),  
34 acres in the Southwest Quarter of the Southeast Quarter (SW1/4 SE1/4),  
34 acres in the Southeast Quarter of the Southeast Quarter (SE1/4 SE1/4),

a total of 486 acres in Section 22,

34 acres in the Northeast Quarter of the Northeast Quarter (NE1/4 NE1/4),  
34 acres in the Northwest Quarter of the Northeast Quarter (NW1/4 NE1/4),  
34 acres in the Southwest Quarter of the Northeast Quarter (SW1/4 NE1/4),  
34 acres in the Southeast Quarter of the Northeast Quarter (SE1/4 NE1/4),

34 acres in the Northeast Quarter of the Northwest Quarter (NE1/4 NW1/4),  
34 acres in the Northwest Quarter of the Northwest Quarter (NW1/4 NW1/4),  
34 acres in the Southwest Quarter of the Northwest Quarter (SW1/4 NW1/4),  
34 acres in the Southeast Quarter of the Northwest Quarter (SE1/4 NW1/4),

34 acres in the Northeast Quarter of the Southwest Quarter (NE1/4 SW1/4),  
34 acres in the Northwest Quarter of the Southwest Quarter (NW1/4 SW1/4),  
34 acres in the Southwest Quarter of the Southwest Quarter (SW1/4 SW1/4),  
34 acres in the Southeast Quarter of the Southwest Quarter (SE1/4 SW1/4),

34 acres in the Northeast Quarter of the Southeast Quarter (NE1/4 SE1/4),  
34 acres in the Northwest Quarter of the Southeast Quarter (NW1/4 SE1/4),  
34 acres in the Southwest Quarter of the Southeast Quarter (SW1/4 SE1/4),  
34 acres in the Southeast Quarter of the Southeast Quarter (SE1/4 SE1/4),

a total of 544 acres in Section 28,

ATTACHMENT "B"  
APPLICATION TO CHANGE THE PLACE OF USE  
FILE NO. 18977  
PROPOSED PLACE OF USE

34 acres in the Northeast Quarter of the Northeast Quarter (NE1/4 NE1/4),  
34 acres in the Northwest Quarter of the Northeast Quarter (NW1/4 NE1/4),  
34 acres in the Southwest Quarter of the Northeast Quarter (SW1/4 NE1/4),  
34 acres in the Southeast Quarter of the Northeast Quarter (SE1/4 NE1/4),

34 acres in the Northeast Quarter of the Northwest Quarter (NE1/4 NW1/4),  
34 acres in the Northwest Quarter of the Northwest Quarter (NW1/4 NW1/4),  
34 acres in the Southwest Quarter of the Northwest Quarter (SW1/4 NW1/4),  
34 acres in the Southeast Quarter of the Northwest Quarter (SE1/4 NW1/4),

34 acres in the Northeast Quarter of the Southwest Quarter (NE1/4 SW1/4),  
34 acres in the Northwest Quarter of the Southwest Quarter (NW1/4 SW1/4),  
34 acres in the Southwest Quarter of the Southwest Quarter (SW1/4 SW1/4),  
34 acres in the Southeast Quarter of the Southwest Quarter (SE1/4 SW1/4),

34 acres in the Northeast Quarter of the Southeast Quarter (NE1/4 SE1/4),  
34 acres in the Northwest Quarter of the Southeast Quarter (NW1/4 SE1/4),  
34 acres in the Southwest Quarter of the Southeast Quarter (SW1/4 SE1/4),  
34 acres in the Southeast Quarter of the Southeast Quarter (SE1/4 SE1/4),

a total of 544 acres in Section 33,

15 acres in the Southwest Quarter of the Northwest Quarter (SW1/4 NW1/4),  
8 acres in the Southeast Quarter of the Northwest Quarter (SE1/4 NW1/4),

7 acres in the Northeast Quarter of the Southwest Quarter (NE1/4 SW1/4),  
7 acres in the Northwest Quarter of the Southwest Quarter (NW1/4 SW1/4),  
29 acres in the Southwest Quarter of the Southwest Quarter (SW1/4 SW1/4),  
22 acres in the Southeast Quarter of the Southwest Quarter (SE1/4 SW1/4),

20 acres in Lot 5

7 acres in the Northwest Quarter of the Southeast Quarter (NW1/4 SE1/4),  
35 acres in the Southwest Quarter of the Southeast Quarter (SW1/4 SE1/4),  
24 acres in the Southeast Quarter of the Southeast Quarter (SE1/4 SE1/4),

31 acres in Lot 7,

33 acres in Lot 8,

31 acres in Lot 6,

a total of 269 acres in Section 16,

38 acres in the Northeast Quarter of the Northeast Quarter (NE1/4 NE1/4),  
38 acres in the Northwest Quarter of the Northeast Quarter (NW1/4 NE1/4),  
26.5 acres in the Southwest Quarter of the Northeast Quarter (SW1/4 NE1/4),  
26.5 acres in the Southeast Quarter of the Northeast Quarter (SE1/4 NE1/4),

38 acres in the Northeast Quarter of the Northwest Quarter (NE1/4 NW1/4),  
38 acres in the Northwest Quarter of the Northwest Quarter (NW1/4 NW1/4),  
26.5 acres in the Southwest Quarter of the Northwest Quarter (SW1/4 NW1/4),

**ATTACHMENT "B"**  
**APPLICATION TO CHANGE THE PLACE OF USE**  
**FILE NO. 18977**  
**PROPOSED PLACE OF USE**

26.5 acres in the Southeast Quarter of the Northwest Quarter (SE1/4 NW1/4),

34 acres in the Northeast Quarter of the Southwest Quarter (NE1/4 SW1/4),  
34 acres in the Northwest Quarter of the Southwest Quarter (NW1/4 SW1/4),  
34 acres in the Southwest Quarter of the Southwest Quarter (SW1/4 SW1/4),  
34 acres in the Southeast Quarter of the Southwest Quarter (SE1/4 SW1/4),

34 acres in the Northeast Quarter of the Southeast Quarter (NE1/4 SE1/4),  
34 acres in the Northwest Quarter of the Southeast Quarter (NW1/4 SE1/4),  
34 acres in the Southwest Quarter of the Southeast Quarter (SW1/4 SE1/4),  
34 acres in the Southeast Quarter of the Southeast Quarter (SE1/4 SE1/4),

a total of 530 acres in Section 21,

8 acres in Lot 4

2.0 acres in the Southeast Quarter of the Southeast Quarter (SE1/4 SE1/4),

a total of 10 acres in Section 17,

34 acres in the Northeast Quarter of the Northeast Quarter (NE1/4 NE1/4),  
34 acres in the Northwest Quarter of the Northeast Quarter (NW1/4 NE1/4),  
34 acres in the Southwest Quarter of the Northeast Quarter (SW1/4 NE1/4),  
34 acres in the Southeast Quarter of the Northeast Quarter (SE1/4 NE1/4),

34 acres in the Northeast Quarter of the Southwest Quarter (NE1/4 SW1/4),  
34 acres in the Northwest Quarter of the Southwest Quarter (NW1/4 SW1/4),  
34 acres in the Southwest Quarter of the Southwest Quarter (SW1/4 SW1/4),  
34 acres in the Southeast Quarter of the Southwest Quarter (SE1/4 SW1/4),

34 acres in the Northeast Quarter of the Southeast Quarter (NE1/4 SE1/4),  
34 acres in the Northwest Quarter of the Southeast Quarter (NW1/4 SE1/4),  
34 acres in the Southwest Quarter of the Southeast Quarter (SW1/4 SE1/4),  
34 acres in the Southeast Quarter of the Southeast Quarter (SE1/4 SE1/4),

a total of 544 acres in Section 27,

34 acres in the Northeast Quarter of the Northeast Quarter (NE1/4 NE1/4),  
34 acres in the Northwest Quarter of the Northeast Quarter (NW1/4 NE1/4),  
34 acres in the Southwest Quarter of the Northeast Quarter (SW1/4 NE1/4),  
34 acres in the Southeast Quarter of the Northeast Quarter (SE1/4 NE1/4),

34 acres in the Northeast Quarter of the Northwest Quarter (NE1/4 NW1/4),  
34 acres in the Northwest Quarter of the Northwest Quarter (NW1/4 NW1/4),  
34 acres in the Southwest Quarter of the Northwest Quarter (SW1/4 NW1/4),  
34 acres in the Southeast Quarter of the Northwest Quarter (SE1/4 NW1/4),

34 acres in the Northeast Quarter of the Southwest Quarter (NE1/4 SW1/4),  
34 acres in the Northwest Quarter of the Southwest Quarter (NW1/4 SW1/4),

ATTACHMENT "B"  
APPLICATION TO CHANGE THE PLACE OF USE  
FILE NO. 18977  
PROPOSED PLACE OF USE

34 acres in the Southwest Quarter of the Southwest Quarter (SW1/4 SW1/4),  
34 acres in the Southeast Quarter of the Southwest Quarter (SE1/4 SW1/4),

34 acres in the Northeast Quarter of the Southeast Quarter (NE1/4 SE1/4),  
34 acres in the Northwest Quarter of the Southeast Quarter (NW1/4 SE1/4),  
34 acres in the Southwest Quarter of the Southeast Quarter (SW1/4 SE1/4),  
34 acres in the Southeast Quarter of the Southeast Quarter (SE1/4 SE1/4),

a total of 544 acres in Section 34,  
all in Township 24 South, Range 33 west, in Finney County, Kansas

34.5 acres in the Northeast Quarter of the Northeast Quarter (NE1/4 NE1/4),  
34.5 acres in the Northwest Quarter of the Northeast Quarter (NW1/4 NE1/4),  
34.5 acres in the Southwest Quarter of the Northeast Quarter (SW1/4 NE1/4),  
34.5 acres in the Southeast Quarter of the Northeast Quarter (SE1/4 NE1/4),

34.5 acres in the Northeast Quarter of the Northwest Quarter (NE1/4 NW1/4),  
34.5 acres in the Northwest Quarter of the Northwest Quarter (NW1/4 NW1/4),  
34.5 acres in the Southwest Quarter of the Northwest Quarter (SW1/4 NW1/4),  
34.5 acres in the Southeast Quarter of the Northwest Quarter (SE1/4 NW1/4),

34.5 acres in the Northeast Quarter of the Southwest Quarter (NE1/4 SW1/4),  
34.5 acres in the Northwest Quarter of the Southwest Quarter (NW1/4 SW1/4),  
34.5 acres in the Southwest Quarter of the Southwest Quarter (SW1/4 SW1/4),  
34.5 acres in the Southeast Quarter of the Southwest Quarter (SE1/4 SW1/4),

38 acres in the Northeast Quarter of the Southeast Quarter (NE1/4 SE1/4),  
38 acres in the Northwest Quarter of the Southeast Quarter (NW1/4 SE1/4),  
38 acres in the Southwest Quarter of the Southeast Quarter (SW1/4 SE1/4),  
38 acres in the Southeast Quarter of the Southeast Quarter (SE1/4 SE1/4),

a total of 566 acres in Section 21,

34 acres in Lot 1 (NE1/4 NE1/4),  
34 acres in Lot 2 (NW1/4 NE1/4),  
34 acres in the Southwest Quarter of the Northeast Quarter (SW1/4 NE1/4),  
34 acres in the Southeast Quarter of the Northeast Quarter (SE1/4 NE1/4),

37.5 acres in Lot 3 (NE1/4 NW1/4),  
37.5 acres in Lot 4 (NW1/4 NW1/4),  
37.5 acres in the Southwest Quarter of the Northwest Quarter (SW1/4 NW1/4),  
37.5 acres in the Southeast Quarter of the Northwest Quarter (SE1/4 NW1/4),

37.5 acres in the Northeast Quarter of the Southwest Quarter (NE1/4 SW1/4),  
37.5 acres in the Northwest Quarter of the Southwest Quarter (NW1/4 SW1/4),  
37.5 acres in the Southwest Quarter of the Southwest Quarter (SW1/4 SW1/4),  
37.5 acres in the Southeast Quarter of the Southwest Quarter (SE1/4 SW1/4),

37.5 acres in the Northeast Quarter of the Southeast Quarter (NE1/4 SE1/4),  
37.5 acres in the Northwest Quarter of the Southeast Quarter (NW1/4 SE1/4),



ATTACHMENT "B"  
APPLICATION TO CHANGE THE PLACE OF USE  
FILE NO. 18977  
PROPOSED PLACE OF USE

37.5 acres in the Southwest Quarter of the Southeast Quarter (SW1/4 SE1/4),  
37.5 acres in the Southeast Quarter of the Southeast Quarter (SE1/4 SE1/4),

a total of 586 acres in Section 3,

34 acres in the Northeast Quarter of the Northeast Quarter (NE1/4 NE1/4),  
34 acres in the Northwest Quarter of the Northeast Quarter (NW1/4 NE1/4),  
34 acres in the Southwest Quarter of the Northeast Quarter (SW1/4 NE1/4),  
34 acres in the Southeast Quarter of the Northeast Quarter (SE1/4 NE1/4),

34 acres in the Northeast Quarter of the Northwest Quarter (NE1/4 NW1/4),  
34 acres in the Northwest Quarter of the Northwest Quarter (NW1/4 NW1/4),  
34 acres in the Southwest Quarter of the Northwest Quarter (SW1/4 NW1/4),  
34 acres in the Southeast Quarter of the Northwest Quarter (SE1/4 NW1/4),

37.5 acres in the Northeast Quarter of the Southwest Quarter (NE1/4 SW1/4),  
37.5 acres in the Northwest Quarter of the Southwest Quarter (NW1/4 SW1/4),  
37.5 acres in the Southwest Quarter of the Southwest Quarter (SW1/4 SW1/4),  
37.5 acres in the Southeast Quarter of the Southwest Quarter (SE1/4 SW1/4),

34 acres in the Northeast Quarter of the Southeast Quarter (NE1/4 SE1/4),  
34 acres in the Northwest Quarter of the Southeast Quarter (NW1/4 SE1/4),  
34 acres in the Southwest Quarter of the Southeast Quarter (SW1/4 SE1/4),  
34 acres in the Southeast Quarter of the Southeast Quarter (SE1/4 SE1/4),

a total of 558 acres in Section 10,

34 acres in the Northeast Quarter of the Northeast Quarter (NE1/4 NE1/4),  
34 acres in the Northwest Quarter of the Northeast Quarter (NW1/4 NE1/4),  
34 acres in the Southwest Quarter of the Northeast Quarter (SW1/4 NE1/4),  
34 acres in the Southeast Quarter of the Northeast Quarter (SE1/4 NE1/4),

34 acres in the Northeast Quarter of the Northwest Quarter (NE1/4 NW1/4),  
34 acres in the Northwest Quarter of the Northwest Quarter (NW1/4 NW1/4),  
34 acres in the Southwest Quarter of the Northwest Quarter (SW1/4 NW1/4),  
34 acres in the Southeast Quarter of the Northwest Quarter (SE1/4 NW1/4),

34 acres in the Northeast Quarter of the Southwest Quarter (NE1/4 SW1/4),  
34 acres in the Northwest Quarter of the Southwest Quarter (NW1/4 SW1/4),  
34 acres in the Southwest Quarter of the Southwest Quarter (SW1/4 SW1/4),  
34 acres in the Southeast Quarter of the Southwest Quarter (SE1/4 SW1/4),

34 acres in the Northeast Quarter of the Southeast Quarter (NE1/4 SE1/4),  
34 acres in the Northwest Quarter of the Southeast Quarter (NW1/4 SE1/4),  
34 acres in the Southwest Quarter of the Southeast Quarter (SW1/4 SE1/4),  
34 acres in the Southeast Quarter of the Southeast Quarter (SE1/4 SE1/4),

a total of 544 acres in Section 15,

ATTACHMENT "B"  
APPLICATION TO CHANGE THE PLACE OF USE  
FILE NO. 18977  
PROPOSED PLACE OF USE

34 acres in Lot 1 (NE1/4 NE1/4),  
34 acres in Lot 2 (NW1/4 NE1/4),  
34 acres in the Southwest Quarter of the Northeast Quarter (SW1/4 NE1/4),  
34 acres in the Southeast Quarter of the Northeast Quarter (SE1/4 NE1/4),

34 acres in Lot 3 (NE1/4 NW1/4),  
34 acres in Lot 4 (NW1/4 NW1/4),  
34 acres in the Southwest Quarter of the Northwest Quarter (SW1/4 NW1/4),  
34 acres in the Southeast Quarter of the Northwest Quarter (SE1/4 NW1/4),

34 acres in the Northeast Quarter of the Southwest Quarter (NE1/4 SW1/4),  
34 acres in the Northwest Quarter of the Southwest Quarter (NW1/4 SW1/4),  
34 acres in the Southwest Quarter of the Southwest Quarter (SW1/4 SW1/4),  
34 acres in the Southeast Quarter of the Southwest Quarter (SE1/4 SW1/4),

34 acres in the Northeast Quarter of the Southeast Quarter (NE1/4 SE1/4),  
34 acres in the Northwest Quarter of the Southeast Quarter (NW1/4 SE1/4),  
34 acres in the Southwest Quarter of the Southeast Quarter (SW1/4 SE1/4),  
34 acres in the Southeast Quarter of the Southeast Quarter (SE1/4 SE1/4),

a total of 544 acres in Section 4,

34 acres in Lot 1 (NE1/4 NE1/4),  
34 acres in Lot 2 (NW1/4 NE1/4),  
34 acres in the Southwest Quarter of the Northeast Quarter (SW1/4 NE1/4),  
34 acres in the Southeast Quarter of the Northeast Quarter (SE1/4 NE1/4),

34 acres in the Northeast Quarter of the Southeast Quarter (NE1/4 SE1/4),  
34 acres in the Northwest Quarter of the Southeast Quarter (NW1/4 SE1/4),  
34 acres in the Southwest Quarter of the Southeast Quarter (SW1/4 SE1/4),  
34 acres in the Southeast Quarter of the Southeast Quarter (SE1/4 SE1/4),

a total of 272 acres in Section 5,

34 acres in the Northeast Quarter of the Northeast Quarter (NE1/4 NE1/4),  
34 acres in the Northwest Quarter of the Northeast Quarter (NW1/4 NE1/4),  
34 acres in the Southwest Quarter of the Northeast Quarter (SW1/4 NE1/4),  
34 acres in the Southeast Quarter of the Northeast Quarter (SE1/4 NE1/4),

34 acres in the Northeast Quarter of the Southeast Quarter (NE1/4 SE1/4),  
34 acres in the Northwest Quarter of the Southeast Quarter (NW1/4 SE1/4),  
34 acres in the Southwest Quarter of the Southeast Quarter (SW1/4 SE1/4),  
34 acres in the Southeast Quarter of the Southeast Quarter (SE1/4 SE1/4),

a total of 272 acres in Section 8,

34 acres in the Northeast Quarter of the Northeast Quarter (NE1/4 NE1/4),  
34 acres in the Northwest Quarter of the Northeast Quarter (NW1/4 NE1/4),

ATTACHMENT "B"  
APPLICATION TO CHANGE THE PLACE OF USE  
FILE NO. 18977  
PROPOSED PLACE OF USE

34 acres in the Southwest Quarter of the Northeast Quarter (SW1/4 NE1/4),  
34 acres in the Southeast Quarter of the Northeast Quarter (SE1/4 NE1/4),

34 acres in the Northeast Quarter of the Northwest Quarter (NE1/4 NW1/4),  
34 acres in the Northwest Quarter of the Northwest Quarter (NW1/4 NW1/4),  
34 acres in the Southwest Quarter of the Northwest Quarter (SW1/4 NW1/4),  
34 acres in the Southeast Quarter of the Northwest Quarter (SE1/4 NW1/4),

34 acres in the Northeast Quarter of the Southwest Quarter (NE1/4 SW1/4),  
34 acres in the Northwest Quarter of the Southwest Quarter (NW1/4 SW1/4),  
34 acres in the Southwest Quarter of the Southwest Quarter (SW1/4 SW1/4),  
34 acres in the Southeast Quarter of the Southwest Quarter (SE1/4 SW1/4),

34 acres in the Northeast Quarter of the Southeast Quarter (NE1/4 SE1/4),  
34 acres in the Northwest Quarter of the Southeast Quarter (NW1/4 SE1/4),  
34 acres in the Southwest Quarter of the Southeast Quarter (SW1/4 SE1/4),  
34 acres in the Southeast Quarter of the Southeast Quarter (SE1/4 SE1/4),

a total of 544 acres in Section 9,

34 acres in the Northeast Quarter of the Northeast Quarter (NE1/4 NE1/4),  
34 acres in the Northwest Quarter of the Northeast Quarter (NW1/4 NE1/4),  
34 acres in the Southwest Quarter of the Northeast Quarter (SW1/4 NE1/4),  
34 acres in the Southeast Quarter of the Northeast Quarter (SE1/4 NE1/4),

34 acres in the Northeast Quarter of the Northwest Quarter (NE1/4 NW1/4),  
34 acres in the Northwest Quarter of the Northwest Quarter (NW1/4 NW1/4),  
34 acres in the Southwest Quarter of the Northwest Quarter (SW1/4 NW1/4),  
34 acres in the Southeast Quarter of the Northwest Quarter (SE1/4 NW1/4),

34 acres in the Northeast Quarter of the Southwest Quarter (NE1/4 SW1/4),  
34 acres in the Northwest Quarter of the Southwest Quarter (NW1/4 SW1/4),  
34 acres in the Southwest Quarter of the Southwest Quarter (SW1/4 SW1/4),  
34 acres in the Southeast Quarter of the Southwest Quarter (SE1/4 SW1/4),

34 acres in the Northeast Quarter of the Southeast Quarter (NE1/4 SE1/4),  
34 acres in the Northwest Quarter of the Southeast Quarter (NW1/4 SE1/4),  
34 acres in the Southwest Quarter of the Southeast Quarter (SW1/4 SE1/4),  
34 acres in the Southeast Quarter of the Southeast Quarter (SE1/4 SE1/4),

a total of 544 acres in Section 16,

34 acres in the Northeast Quarter of the Northeast Quarter (NE1/4 NE1/4),  
34 acres in the Northwest Quarter of the Northeast Quarter (NW1/4 NE1/4),  
34 acres in the Southwest Quarter of the Northeast Quarter (SW1/4 NE1/4),  
34 acres in the Southeast Quarter of the Northeast Quarter (SE1/4 NE1/4),

34 acres in the Northeast Quarter of the Southeast Quarter (NE1/4 SE1/4),  
34 acres in the Northwest Quarter of the Southeast Quarter (NW1/4 SE1/4),  
34 acres in the Southwest Quarter of the Southeast Quarter (SW1/4 SE1/4),

ATTACHMENT "B"  
APPLICATION TO CHANGE THE PLACE OF USE  
FILE NO. 18977  
PROPOSED PLACE OF USE

34 acres in the Southeast Quarter of the Southeast Quarter (SE1/4 SE1/4),  
a total of 272 acres in Section 17,  
all in Township 25 South, Range 33 west, in Finney County, Kansas

14. If the proposed groundwater point of diversion is 300 or fewer feet from existing point of diversion, complete the following:

- (a) Does the undersigned represent all owners of the currently authorized place(s) of use identified in this application?  
 Yes     No    (If no, all owners must sign this application.)
- (b) Will the ownership interest of any owner of the currently authorized place(s) of use identified in this application be adversely affected if this application is approved as requested?  
 Yes     No    (If yes, all owners must sign this application.)
- (c) If this application is not approved expeditiously, will there be substantial damage to property, public health or safety?  
 Yes     No    (If no, all owners must sign this application.)

If the application proposes a surface water change in point of diversion, a groundwater change in point of diversion greater than 300 feet, or a change in place of use, the application must be signed by all owners of the currently authorized place of use, or their duly authorized agent (attach notarized statement authorizing representation).

I hereby verify, being first duly sworn upon my oath or affirmation and under penalty of perjury, that I am of lawful age and the owner, the spouse of the owner, or a duly authorized agent of the owner(s) to make this application on their behalf, in regard to the water right(s) to which this application pertains. I further verify that the statements contained in this application are true, correct and complete.

Dated at Garden City, Kansas, this 14<sup>th</sup> day of February, 2018.

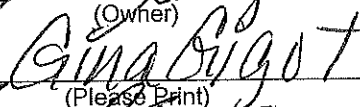
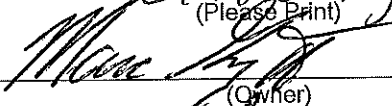
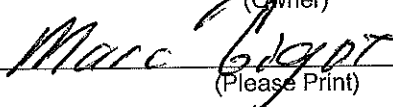
 (Owner)	(Spouse)
 (Please Print)	(Please Print)
 (Owner)	(Spouse)
 (Please Print)	(Please Print)
(Owner)	(Spouse)
(Please Print)	(Please Print)

State of Kansas }  
 County of Finney } SS

I hereby certify that the foregoing application was signed in my presence and sworn to before me this 14<sup>th</sup> day of February

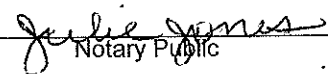

  
 Notary Public

My Commission Expires \_\_\_\_\_

**ONLY COMPLETE APPLICATIONS WILL BE PROCESSED.** To be complete, all of the applicable portions of the application form must be completed with accurate information; maps, if necessary, must be included; signatures of all the appropriate owners' must be affixed to the application and notarized; and the appropriate fee must be paid.

**FEE SCHEDULE**

Each application to change the place of use or the point of diversion under this section shall be accompanied by the application fee set forth in the schedule below: Make checks payable to: **Kansas Department of Agriculture**

- (1) Application to change a point of diversion 300 feet or less ..... \$100
- (2) Application to change a point of diversion more than 300 feet ..... \$200
- (3) Application to change the place of use ..... \$200



# Change in Place of Use: WR 18977



I agree to the best of my knowledge that all known water wells (IRR, DOM, IND, etc) are shown within green circles on map. If not, I have edited the map indicating the location of the well, type, & other water information.

Signature: \_\_\_\_\_

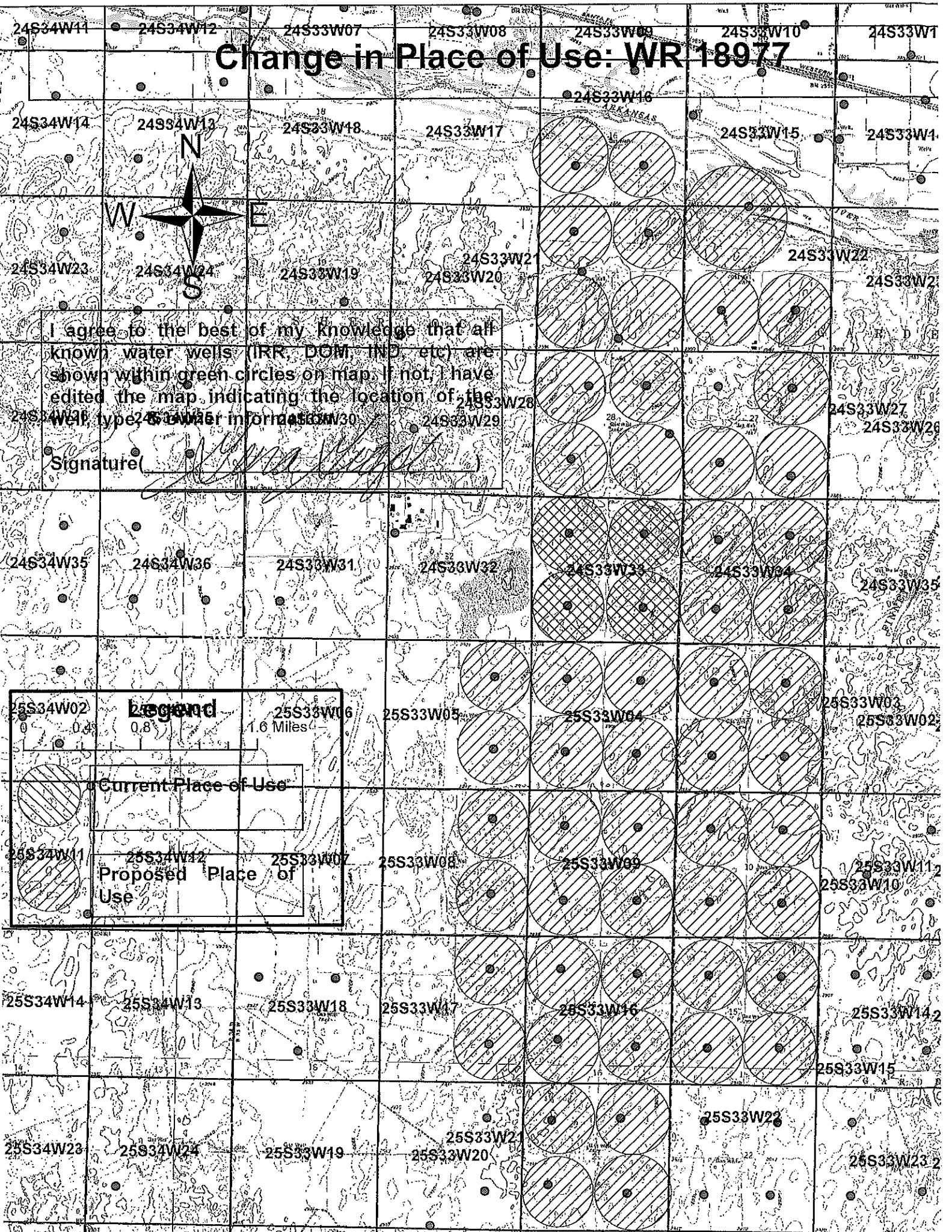

<p><b>Legend</b></p> <p>0 0.4 0.8 1.6 Miles</p>	
	<p>Current Place of Use</p>
	<p>Proposed Place of Use</p>

