

Kansas Department of Agriculture
 Division of Water Resources
CHANGE: P/U WORKSHEET

1. File Number: 19424	2. Status Change Date: 6/26/18	3. Change Num: C1	4. Field Office: 04	5. GMD: 03
---------------------------------	--	-----------------------------	-------------------------------	----------------------

6. Status: <input checked="" type="checkbox"/> Approved <input type="checkbox"/> Denied by DWR/GMD <input type="checkbox"/> Dismiss by Request/Failure to Return	7. Filing Date of Change: 5/17/18
--	---

8a. Applicant(s) Person ID 57233
 New to system Add Seq# 1

THERON LEE & DONNA J WALKER
16532 ROAD R
KISMET KS 67859-6036

8c. Landowner(s) Person ID _____
 New to system Add Seq# _____

8b. Landowner(s) Person ID 57233
 New to system Add Seq# 1

THERON LEE & DONNA J WALKER
16532 ROAD R
KISMET KS 67859-6036

8d. WUC Person ID 57233
 New to system Add Seq# 1

THERON LEE & DONNA J WALKER
16532 ROAD R
KISMET KS 67859-6036

9. Documents and Enclosure(s): DWR Meter(s) Date to Comply: 12/31/18 N & P Date to Comply: _____

Anti-Reverse Meter Meter Seal Check Valve N & P Form Water Tube Driller Copy H & E Letter

Conservation Plan Date Required: _____ Date Approved: _____ Date to Comply: _____

10. Use Made of Water From: _____ To: _____

Date Prepared: **6/15/18** By: **TPM**
 Date Entered: _____ By: _____

STATE OF KANSAS

DEPARTMENT OF AGRICULTURE
DIVISION OF WATER RESOURCES
GARDEN CITY FIELD OFFICE
2508 JOHNS STREET
GARDEN CITY, KS 67846-2804



PHONE: (620) 276-2901
FAX: (620) 276-9315
www.agriculture.ks.gov

GOVERNOR JEFF COLYER, M.D.
JACKIE McCLASKEY, SECRETARY OF AGRICULTURE

June 26, 2018

THERON LEE & DONNA J WALKER
16532 ROAD R
KISMET KS 67859-6036

RE: Change in Point of Diversion Water Right, File No 19424

Dear Mr. & Mrs. Walker;

Enclosed you will find a *Summary Order Approving Application for Change in Points of Diversion* for the above referenced file. This order modifies the authorized well location under the referenced file. This order modifies the original document; it should be recorded at the County Register of Deeds.

Your attention is directed to the enclosures and to the terms, conditions, and limitations specified in this order. The diversion works should be completed and reported to the Division of Water Resources by **December 31, 2018**. Enclosed is a form for this purpose, along with other information for reference.

A condition of this order is that an acceptable flow meter must be properly installed on the diversion works authorized under the referenced file number in accordance with the Kansas Administrative Regulations 5-1-4 through 5-1-12. This water flow meter shall be used to provide information required on the annual water use report.

This order shall become final if a request for a hearing is not filed with the Chief Engineer within 15 days of the date of service of this order. The date of service is the date listed on the enclosed *Certificate of Service*.

Should you have any questions, please feel free to call this office. If you would prefer, you could arrange an appointment for additional assistance.

Sincerely,

Thomas P. Makens
Assistant Water Commissioner

TPM:tpm
Enclosures
GMD#3

CERTIFICATE OF SERVICE

On this ^{27th} day of June 2018, I hereby certify that the attached original Approval of Application to Change the Point of Diversion under Water Right, File No. 19424 dated June 26, 2018 was mailed postage prepaid, first class, US mail to the following:

THERON LEE & DONNA J WALKER
16532 ROAD R
KISMET KS 67859-6036

Copy provided to GMD#3

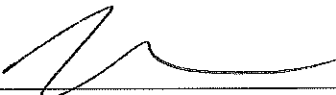

Division of Water Resources

Submit completed application to:
 Kansas Department of Agriculture
 Division of Water Resources
 Field Office for your area.
 Call for address:

Topeka -- (785) 862-6300
 Stafford -- (620) 234-5311
 Stockton -- (785) 425-6787
 Garden City -- (620) 276-2901
www.ksda.gov/dwr

DWR FIELD OFFICE APPLICATION FOR APPROVAL TO CHANGE THE PLACE OF USE AND/OR THE POINT OF DIVERSION



STATE OF KANSAS

Filing Fee Must Accompany the Application, K.S.A. 82a-708b(b), as amended.
 Fee Schedule is on the third page of this application form.

Paragraph Nos. 1, 2, 3 & 5 must be completed. Complete all other applicable portions. If change in point of diversion is greater than 100 feet, or if place of use will be changed, include a topographic map or detailed plat showing the authorized and proposed point(s) of diversion and/or place of use.

RECEIVED
 4:32 PM
 MAY 17 2018

File No. 19424

1. Application is hereby made for approval of the Chief Engineer to change the (check one or both):

Place of Use Point of Diversion

under the water right which is the subject of this application in accordance with the conditions described below.

The source of supply is: Groundwater Surface water

Garden City Field Office
 Division of Water Resources

2. Name and address of Applicant: THERON LEE & DONNA J WALKER

16532 ROAD R, KISMET KS 67859-6036

Phone Number: (620) 482-1575 Email address: theronwalker@hotmail.com

Name and address of Water Use Correspondent: Same

Phone Number: () Email address: _____

3. The presently authorized place of use is:

Owner of Land --- NAME: Theron Lee Walker and Donna Joyce Walker

ADDRESS: 16532 Rd R, Kismet KS 67859

(If there is more than one landowner, attach supplemental sheets as necessary.)

Sec.	Twp.	Range	NE¼				NW¼				SW¼				SE¼				TOTAL ACRES
			NE¼	NW¼	SW¼	SE¼	NE¼	NW¼	SW¼	SE¼	NE¼	NW¼	SW¼	SE¼	NE¼	NW¼	SW¼	SE¼	
13	33	32 W		40	27		40			40									147

4. If this application is for a change in place of use, it is proposed that the place of use be changed to:

Owner of Land --- NAME: Same owner

ADDRESS: _____

(If there is more than one landowner, attach supplemental sheets as necessary.)

Sec.	Twp.	Range	NE¼				NW¼				SW¼				SE¼				TOTAL ACRES
			NE¼	NW¼	SW¼	SE¼	NE¼	NW¼	SW¼	SE¼	NE¼	NW¼	SW¼	SE¼	NE¼	NW¼	SW¼	SE¼	
13	33	32 W		40	40		27			40									147

For Office Use Only: Code _____ Fee \$ 200 TR # _____ Receipt Date 5/17/18 Check # 6077

5. **Presently authorized point of diversion:**
 One in the _____ Quarter of the _____ Quarter of the _____ Quarter
 of Section _____, Township _____ South, Range _____ W,
 in _____ County, Kansas, _____ feet North _____ feet West of Southeast corner of section.
 Authorized Rate _____ Authorized Quantity _____ Depth of well _____ (feet)
 (DWR use only: Computer ID No. _____ GPS _____ feet North _____ feet West)
 This point will not be changed This point will be changed as follows:
Proposed point of diversion: (Complete only if change is requested)
 One in the _____ Quarter of the _____ Quarter of the _____ Quarter
 of Section _____, Township _____ South, Range _____ W,
 in _____ County, Kansas, _____ feet North _____ feet West of Southeast corner of section.
 Proposed Rate _____ Proposed Quantity _____ Proposed well depth (feet) _____
 This point is: Additional Well Geo Center List other water rights that will use this point _____

RECEIVED
MAY 17 2018
Garden City Field Office
Division of Water Resources

6. **Presently authorized point of diversion:**
 One in the _____ Quarter of the _____ Quarter of the _____ Quarter
 of Section _____, Township _____ South, Range _____ W,
 in _____ County, Kansas, _____ feet North _____ feet West of Southeast corner of section.
 Authorized Rate _____ Authorized Quantity _____ Depth of well _____ (feet)
 (DWR use only: Computer ID No. _____ GPS _____ feet North _____ feet West)
 This point will not be changed This point will be changed as follows:
Proposed point of diversion: (Complete only if change is requested)
 One in the _____ Quarter of the _____ Quarter of the _____ Quarter
 of Section _____, Township _____ South, Range _____ (E/W),
 in _____ County, Kansas, _____ feet North _____ feet West of Southeast corner of section.
 Proposed Rate _____ Proposed Quantity _____ Proposed well depth (feet) _____
 This point is: Additional Well Geo Center List other water rights that will use this point _____

7. Why do you need a new point of diversion? _____

NC TO WELL

13a. If the proposed point of diversion will be relocated within 100 feet of the existing point of diversion, indicate its location on the diagram below in relation to the existing point of diversion. (PLEASE NOTE: The "X" in center of diagram below represents presently authorized point of diversion.)

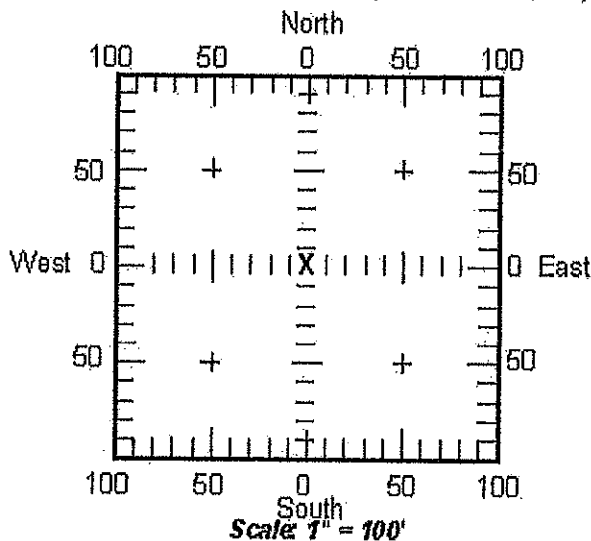

8. If a well, is the test hole log attached? Yes No

9. When do you propose to complete the new point of diversion?

10. If the point of diversion is a well:

(a) What are you going to do with the old well?

(b) When will this be done? _____

11. Groundwater Management District recommendation attached? Yes No

12. Assisted by MF 4-25-18

13b. If the proposed point of diversion will be relocated more than 100 feet but within 1320 feet from the existing point of diversion, attach a topographic map or aerial photograph. For groundwater sources, show all wells (including domestic) within one-half mile of the proposed point of diversion and the names and mailing addresses of the owners. For surface water sources, show the names and addresses of the landowner(s) one-half mile downstream and one-half mile upstream from your property lines.

14. If the proposed groundwater point of diversion is 300 or fewer feet from existing point of diversion, complete the following:

- (a) Does the undersigned represent all owners of the currently authorized place(s) of use identified in this application?
 Yes No (If no, all owners must sign this application.)
- (b) Will the ownership interest of any owner of the currently authorized place(s) of use identified in this application be adversely affected if this application is approved as requested?
 Yes No (If yes, all owners must sign this application.)
- (c) If this application is not approved expeditiously, will there be substantial damage to property, public health or safety?
 Yes No (If no, all owners must sign this application.)

RECEIVED

MAY 17 2018

Garden City Field Office
Division of Water Resources

If the application proposes a surface water change in point of diversion, a groundwater change in point of diversion greater than 300 feet, or a change in place of use, the application must be signed by all owners of the currently authorized place of use, or their duly authorized agent (attach notarized statement authorizing representation).

I hereby verify, being first duly sworn upon my oath or affirmation and under penalty of perjury, that I am of lawful age and the owner, the spouse of the owner, or a duly authorized agent of the owner(s) to make this application on their behalf, in regard to the water right(s) to which this application pertains. I further verify that the statements contained in this application are true, correct and complete.

Dated at Plains State Bank Plains, Kansas, this 10 day of May, 2018.

Shen Lee Walker
(Owner)

Donna J Walker
(Spouse)

Theron Lee Walker
(Please Print)

Donna J Walker
(Please Print)

(Owner)

(Spouse)

(Please Print)

(Please Print)

(Owner)

(Spouse)

(Please Print)

(Please Print)

State of Kansas }
County of Meade } SS

I hereby certify that the foregoing application was signed in my presence and sworn to before me this 10th day of May, 2018.

ANITA EVANS
Notary Public - State of Kansas
My Appl. Expires 12-09-2019

Anita Evans
Notary Public

ONLY COMPLETE APPLICATIONS WILL BE PROCESSED. To be complete, all of the applicable portions of the application form must be completed with accurate information; maps, if necessary, must be included; signatures of all the appropriate owners' must be affixed to the application and notarized; and the appropriate fee must be paid.

FEE SCHEDULE

Each application to change the place of use or the point of diversion under this section shall be accompanied by the application fee set forth in the schedule below: Make checks payable to: **Kansas Department of Agriculture**

(1) Application to change a point of diversion 300 feet or less	\$100
(2) Application to change a point of diversion more than 300 feet	\$200
(3) Application to change the place of use	\$200

**Change in Place of Use
Section 13, Township 33 South, Range 32 West
Seward County**

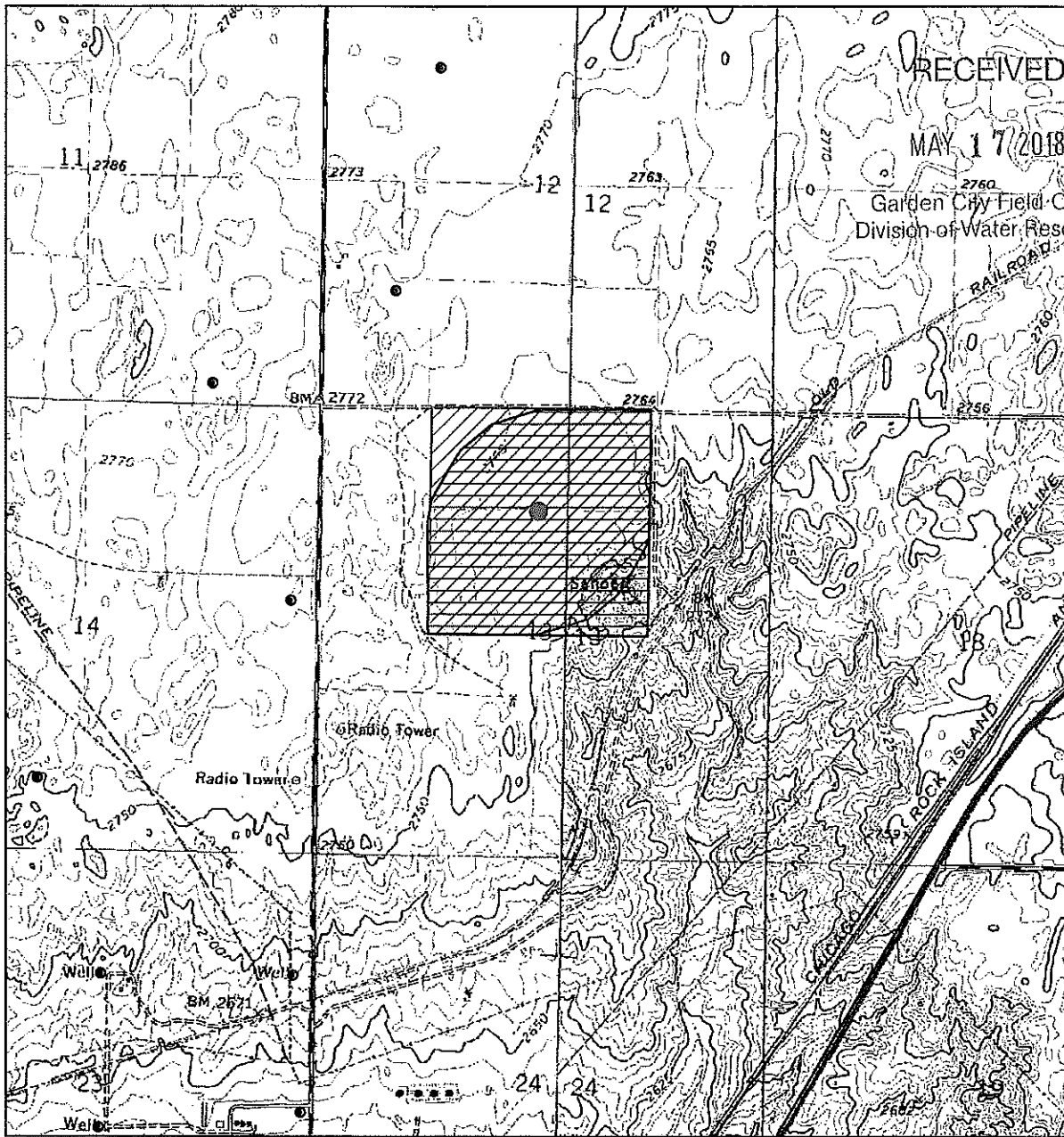

RECEIVED
MAY 17 2018
Garden City Field Office
Division of Water Resources

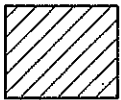

Authorized Place of Use

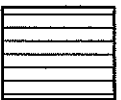

Requested Place of Use

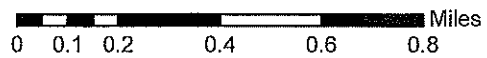
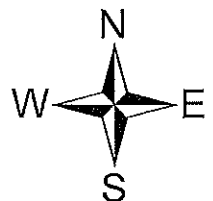

STATE OF KANSAS



DEPARTMENT OF AGRICULTURE
DIVISION OF WATER RESOURCES
GARDEN CITY FIELD OFFICE
2508 JOHNS STREET
GARDEN CITY, KS 67846-2804

PHONE: (620) 276-2901
FAX: (620) 276-9315
www.agriculture.ks.gov

GOVERNOR JEFF COLYER, M.D.
JACKIE McCLASKEY, SECRETARY OF AGRICULTURE

May 22, 2018

Southwest Kansas Groundwater
Management District No 3
409 Campus Drive, Suite 106
Garden City KS 67846

Re: Water Right file number 19424

Dear Mr. Norquest;

The Theron Walker has applied to alter the acres authorized to add a pivot location. The base acres are 147. There are no neighboring wells within ½ mile.

We are delaying action for 15 days on the change application to allow you time to review and provide a recommendation if you feel one is warranted. I have enclosed a copy of the change for your perusal.

Thank you and as always feel free to call or write us at any time.

Sincerely;

Thomas P Makens

encs.

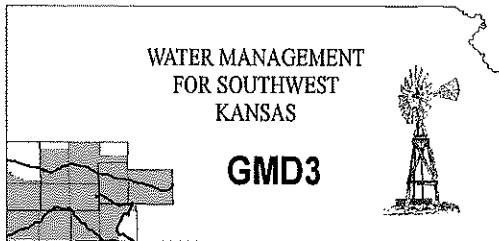

Southwest Kansas
Groundwater Management District No. 3
2009 E. Spruce Street
Garden City, Kansas 67846
(620) 275-7147 phone (620) 275-1431 fax
www.gmd3.org

May 24, 2018

Thomas P. Makens
Division of Water Resources
2508 N Johns Street
Garden City, Kansas 67846

RECEIVED

JUN 08 2018

Garden City Field Office
Division of Water Resources

RE: Applications for Change in Place of Use
Water Rights, File Nos. 19424

Dear Thomas:

We have completed a review of the application for the above referenced water right. The proposal is not in conflict with the Management Program of the Southwest Kansas Groundwater Management District No. 3 (GMD3). The proposed change in place of use, to shift some of the currently authorized acres in the corners, is in accordance with K.A.R. 5-5-11. It is therefore recommended that the application be approved at this time.

Thank you for the opportunity to review the applications and to provide a recommendation. If you have any questions, please don't hesitate to contact us.

Sincerely,

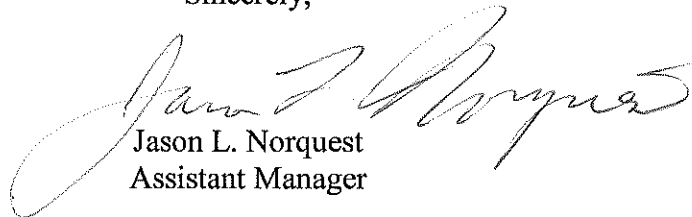

Jason L. Norquest
Assistant Manager

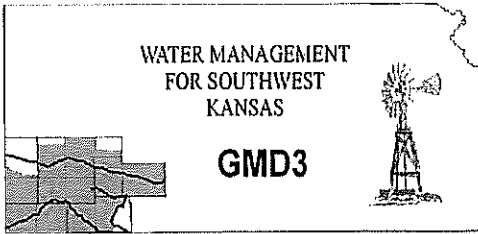

**Southwest Kansas
Groundwater Management District No. 3**
2009 E. Spruce Street
Garden City, Kansas 67846
(620) 275-7147 phone (620) 275-1431 fax
www.gmd3.org

May 24, 2018

Thomas P. Makens
Division of Water Resources
2508 N Johns Street
Garden City, Kansas 67846

RECEIVED

MAY 25 2018

RE: Applications for Change in Place of Use
Water Rights, File Nos. 19424

Garden City Field Office
Division of Water Resources

Dear Thomas:

We have completed a review of the application for the above referenced water right. The proposal is not in conflict with the Management Program of the Southwest Kansas Groundwater Management District No. 3 (GMD3). The proposed change in place of use, to shift some of the currently authorized acres in the corners, is in accordance with K.A.R. 5-5-11. It is therefore recommended that the application be approved at this time.

Thank you for the opportunity to review the applications and to provide a recommendation. If you have any questions, please don't hesitate to contact us.

Sincerely,

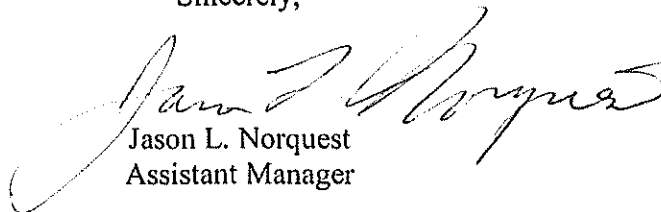

Jason L. Norquest
Assistant Manager

GMD3 Change Review

File No(s): 19424. DWR office: GC.

App filed to change: PU.

Is Landowner(s) correct in WRIS: .

 If NO, is documentation included?

Is Water Use Correspondent correct in WRIS? .

 If NO, is documentation included?

Regulation(s) Reviewed: KAR 5-5-11

Point of diversion ID No(s) being changed.

RECEIVED

MAY 25 2018

Garden City Field Office
Division of Water Resources

	ft. North	ft. West
Authorized PD		
Proposed PD		
Difference	0	0
$a^2 + b^2 = c^2$	0	0
		0

GPS for proposed PD: Lat: Long: .

Is proposed PD stacking on existing WRs? .

Is Proposed PU overlapping existing WRs? .

Land Owner(s) notified: .

Name . Name .

Address . Address .

Zip . Zip .

Neighboring certified well(s) notified: .

Name . Name .

Address . Address .

Zip . Zip .

Domestic well(s) notified: .

Name . Name .

Address . Address .

Zip . Zip .

Base Acres: 147 .

Perfected Acres: .

Irr. Return-Flow %

Keep same amount of acres, just rearranging the corners.

Is a waiver needed: No .

Final Recommendation: After review of all available information, it appears the current area rules are met. Staff therefore recommends approval of the application.



19424 PU Change Review

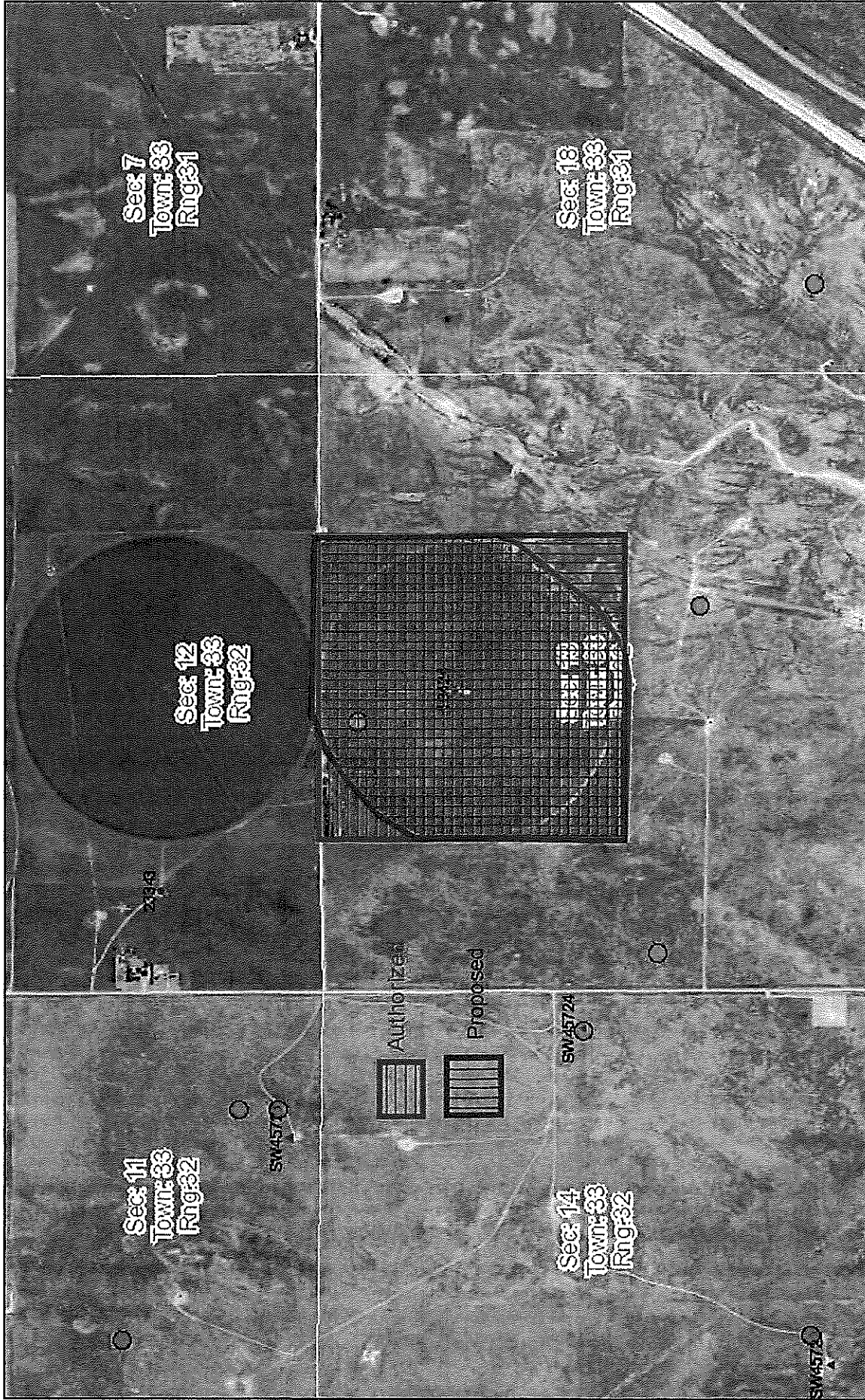

May 23, 2018
16:36 PM

DISCLAIMER: This map is not intended for conveyances, nor is it a legal survey. The information is presented on a best-efforts basis, and should not be relied upon for making financial, survey, legal or other commitments.

Wells

?	Other	+	CON	⚡	FPR	▲	MUN	⌘	THX
•	IRR	☒	DEW	•	HYD	⌘	REC	?	Empty
		▲	DOM	★	IND	⊙	STK	●	WMC5 WELLS GMD3

1:18,056

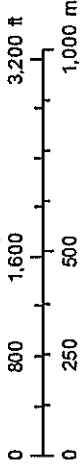

Sections RECEIVED

MAY 25 2018

Garden City Field Office
Division of Water Resources

Property Details for PID: 0881061300000002000

QuickRef ID : R1334

Owner Name : WALKER, THERON & DONNA J

Location: 18252 ROAD 14, Kismet, KS 67859

Abbreviated Boundary Description: S13, T33, R32, W2 OF NE4 & E2 OF NW4

Owner Information:

Owner WALKER, THERON & DONNA J

Mailing Address 16532 ROAD R KISMET, KS 67859

Property Information:

Type Farm Homesite

Status Active

Taxing Unit 032-FARGO 483 KIS

Neighborhood Code 711

Secondary Address Details

Address 18360 ROAD 14, Kismet, KS 67859

