

Kansas Department of Agriculture
 Division of Water Resources
CHANGE: P/D WORKSHEET

| | | | | |
|---|--|--|-------------------------------|---|
| 1. File Number: 21761 | 2. Status Change Date: 6/11/18 | 3. Change Num: C1 | 4. Field Office: 04 | 5. GMD: 03 |
| 6. Status: <input checked="" type="checkbox"/> Approved <input type="checkbox"/> Denied by DWR/GMD <input type="checkbox"/> Dismiss by Request/Failure to Return | | | | 7. Filing Date of Change: 4/16/18 |
| 8a. Applicant(s) New to system <input checked="" type="checkbox"/> DAVID K & CONNIE J GOERTZEN TRUST 1892 ROAD 105 LAKIN KS 67860-6211 | | 8c. Landowner(s) New to system <input type="checkbox"/> Person ID _____ Add Seq# _____ | | |
| 8b. Landowner(s) New to system <input checked="" type="checkbox"/> DAVID K & CONNIE J GOERTZEN TRUST 1892 ROAD 105 LAKIN KS 67860-6211 | | 8d. WUC New to system <input type="checkbox"/> DAVID K & CONNIE J GOERTZEN 1892 ROAD 105 LAKIN KS 67860-6211 Person ID 35307 Add Seq# 1 | | |
| 9. Documents and Enclosure(s): <input checked="" type="checkbox"/> DWR Meter(s) Date to Comply: 12/31/18 <input checked="" type="checkbox"/> N & P Date to Comply: 12/31/18 | | | | |
| <input type="checkbox"/> Anti-Reverse Meter <input type="checkbox"/> Meter Seal <input type="checkbox"/> Check Valve <input type="checkbox"/> N & P Form <input type="checkbox"/> Water Tube <input type="checkbox"/> Driller Copy <input type="checkbox"/> H & E Letter <input type="checkbox"/> Conservation Plan Date Required: _____ Date Approved: _____ Date to Comply: _____ | | | | |
| 10. Use Made of Water From: _____ To: _____ | | | | |
| Date Prepared: 5/8/18 By: TPM Date Entered: _____ By: _____ | | | | |

STATE OF KANSAS

DEPARTMENT OF AGRICULTURE
DIVISION OF WATER RESOURCES
GARDEN CITY FIELD OFFICE
2508 JOHNS STREET
GARDEN CITY, KS 67846-2804



PHONE: (620) 276-2901
FAX: (620) 276-9315
www.agriculture.ks.gov

GOVERNOR JEFF COLYER, M.D.
JACKIE McCLASKEY, SECRETARY OF AGRICULTURE

June 11, 2018

DAVID K & CONNIE J GOERTZEN
1892 ROAD 105
LAKIN KS 67860-6211

RE: Change in Point of Diversion Water Right, File No 21761

Dear Mr. & Mrs. Goertzen:

Enclosed you will find a *Summary Order Approving Application for Change in Points of Diversion* for the above referenced file. This order modifies the authorized well location under the referenced file. This order modifies the original document; it should be recorded at the County Register of Deeds.

Your attention is directed to the enclosures and to the terms, conditions, and limitations specified in this order. The diversion works should be completed and reported to the Division of Water Resources by **December 31, 2018**. Enclosed is a form for this purpose, along with other information for reference.

A condition of this order is that an acceptable flow meter must be properly installed on the diversion works authorized under the referenced file number in accordance with the Kansas Administrative Regulations 5-1-4 through 5-1-12. This water flow meter shall be used to provide information required on the annual water use report.

This order shall become final if a request for a hearing is not filed with the Chief Engineer within 15 days of the date of service of this order. The date of service is the date listed on the enclosed *Certificate of Service*.

Should you have any questions, please feel free to call this office. If you would prefer, you could arrange an appointment for additional assistance.

Sincerely,

Thomas P. Makens
Assistant Water Commissioner

TPM:tpm
Enclosures
GMD#3

CERTIFICATE OF SERVICE

On this *12th* day of June 2018, I hereby certify that the attached original Approval of Application to Change the Point of Diversion under Water Right, File No. 21761 dated June 11, 2018 was mailed postage prepaid, first class, US mail to the following:

DAVID K & CONNIE J GOERTZEN
1892 ROAD 105
LAKIN KS 67860-6211

Copy provided to GMD#3

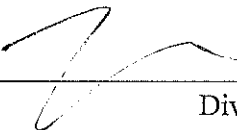

Division of Water Resources

Submit completed application to:
 Kansas Department of Agriculture
 Division of Water Resources
 Field Office for your area.
 Call for address:

Topeka -- (785) 296-5733
 Stafford -- (620) 234-5311
 Stockton -- (785) 425-6787
 Garden City -- (620) 276-2901
<http://agriculture.ks.gov/dwr>

DWR FIELD OFFICE APPLICATION FOR APPROVAL TO CHANGE THE PLACE OF USE AND/OR THE POINT OF DIVERSION



STATE OF KANSAS

Filing Fee Must Accompany the Application, K.S.A. 82a-708b(b), as amended.
 Fee Schedule is on the third page of this application form.

Paragraph Nos. 1, 2, 3 & 5 must be completed. Complete all other applicable portions. If change in point of diversion is greater than 100 feet, or if place of use will be changed, include a topographic map or detailed plat showing the authorized and proposed point(s) of diversion and/or place of use.

RECEIVED
 4:35 Am
 APR 16 2018

File No. 21761

1. Application is hereby made for approval of the Chief Engineer to change the (check one or both):

Place of Use Point of Diversion

Garden City Field Office
 Division of Water Resources

under the water right which is the subject of this application in accordance with the conditions described below.

The source of supply is: Groundwater Surface water

2. Name and address of Applicant: DAVID K. & CONNIE J. GOERTZEN Trust

~~PO BOX 11 DUNHAM KS 67438~~ 1892 Rd 105, Lakin, KS 67860

Phone Number: (620) 272-4993 Email address: _____

Name and address of Water Use Correspondent: JONAS E GIESBRECHT KENNETH GIESBRECHT

~~PO BOX 11 DUNHAM KS 67438~~ Same as applicant

Phone Number: () Email address: _____

3. The presently authorized place of use is:

Owner of Land --- NAME: JONAS E GIESBRECHT KENNETH GIESBRECHT Gowertzen Trust

ADDRESS: PO BOX 11 DUNHAM KS 67438

(If there is more than one landowner, attach supplemental sheets as necessary.)

| Sec. | Twp. | Range | NE¼ | | | | NW¼ | | | | SW¼ | | | | SE¼ | | | | TOTAL ACRES |
|------|------|-------|-----|-----|-----|-----|-----|-----|-----|-----|-----|-----|-----|-----|-----|-----|-----|-----|-------------|
| | | | NE¼ | NW¼ | SW¼ | SE¼ | NE¼ | NW¼ | SW¼ | SE¼ | NE¼ | NW¼ | SW¼ | SE¼ | NE¼ | NW¼ | SW¼ | SE¼ | |
| | | | | | | | | | | | | | | | | | | | |
| | | | | | | | | | | | | | | | | | | | |

4. If this application is for a change in place of use, it is proposed that the place of use be changed to:

Owner of Land --- NAME: no change to acres irrigated

ADDRESS: _____

(If there is more than one landowner, attach supplemental sheets as necessary.)

| Sec. | Twp. | Range | NE¼ | | | | NW¼ | | | | SW¼ | | | | SE¼ | | | | TOTAL ACRES |
|------|------|-------|-----|-----|-----|-----|-----|-----|-----|-----|-----|-----|-----|-----|-----|-----|-----|-----|-------------|
| | | | NE¼ | NW¼ | SW¼ | SE¼ | NE¼ | NW¼ | SW¼ | SE¼ | NE¼ | NW¼ | SW¼ | SE¼ | NE¼ | NW¼ | SW¼ | SE¼ | |
| | | | | | | | | | | | | | | | | | | | |
| | | | | | | | | | | | | | | | | | | | |

For Office Use Only: Code _____ Fee \$ 200.00 TR # _____ Receipt Date 4-16-18 Check # 2082

5. **Presently authorized point of diversion:**
 One in the _____ Quarter of the _____ cn _____ Quarter of the _____ se _____ Quarter
 of Section _____ 21 _____, Township _____ 25 _____ South, Range _____ 35 _____ W,
 in Kearny _____ County, Kansas, _____ 2550 _____ feet North _____ 1600 _____ feet West of Southeast corner of section.
 Authorized Rate _____ Authorized Quantity _____ Depth of well _____ (feet)
 (DWR use only: Computer ID No. 2 GPS _____ feet North _____ feet West)
 This point will not be changed This point will be changed as follows: No change, point better described with GPS as follows:
Proposed point of diversion: (Complete only if change is requested or if existing point is better described by GPS)
 One in the _____ ne _____ Quarter of the _____ nw _____ Quarter of the _____ se _____ Quarter
 of Section _____ 21 _____, Township _____ 25 _____ South, Range _____ 35 _____ W,
 in Kearny _____ County, Kansas, _____ 1989 _____ feet North _____ 1619 _____ feet West of Southeast corner of section.
 Proposed Rate _____ Proposed Quantity _____ Proposed well depth (feet) _____
 This point is: Additional Well Geo Center List other water rights that will use this point _____

6. **Presently authorized point of diversion:**
 One in the _____ Quarter of the _____ nc _____ Quarter of the _____ sw _____ Quarter
 of Section _____ 21 _____, Township _____ 25 _____ South, Range _____ 35 _____ W,
 in Kearny _____ County, Kansas, _____ 1320 _____ feet North _____ 3960 _____ feet West of Southeast corner of section.
 Authorized Rate _____ Authorized Quantity _____ Depth of well _____ (feet)
 (DWR use only: Computer ID No. 1 GPS _____ feet North _____ feet West)
 This point will not be changed This point will be changed as follows: No change, point better described with GPS as follows:
Proposed point of diversion: (Complete only if change is requested or if existing point is better described by GPS)
 One in the _____ Quarter of the _____ Quarter of the _____ Quarter
 of Section _____, Township _____ South, Range _____ (E/W),
 in _____ County, Kansas, _____ feet North _____ feet West of Southeast corner of section.
 Proposed Rate _____ Proposed Quantity _____ Proposed well depth (feet) _____
 This point is: Additional Well Geo Center List other water rights that will use this point _____

7. The changes herein are desired for the following reasons?
 (please be specific) old well needs to be replaced

8. If a well, is the test hole log attached? Yes No

9. The change(s) (was)(will be) completed by?
May 1, 2018

10. If the point of diversion is a well:
 (a) What are you going to do with the old well?
plug
 (b) When will this be done? 2018

11. Groundwater Management District recommendation attached?
 Yes No

12. Assisted by tpm

13a. If the proposed point of diversion will be relocated more than 300 feet but within 2,640 feet of the existing point of diversion, attach a topographic map or aerial photograph. For groundwater sources, show all wells (including domestic) within one-half mile of the proposed point of diversion and the names and mailing addresses of the owners. For surface water sources, show the names and addresses of the landowner(s) one-half mile downstream and one-half mile upstream from your property lines

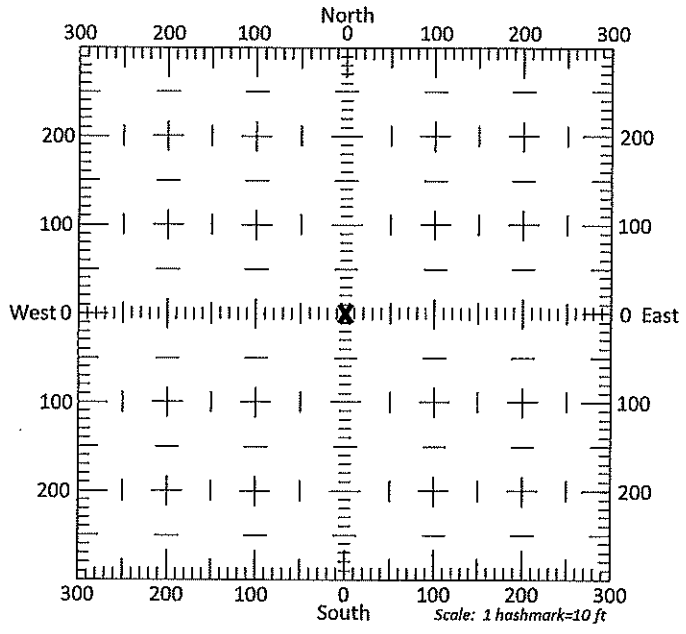

13b. If the proposed point of diversion will be relocated within 300 feet of the existing point of diversion, indicate its location on the diagram shown above in relation to the existing point of diversion. (PLEASE NOTE: The "X" in center of diagram above represents the presently authorized point of diversion.)

14. If the proposed groundwater point of diversion is 300 or fewer feet from the existing point of diversion, complete the following:

- (a) Does the undersigned represent all owners of the currently authorized place(s) of use identified in this application?
 Yes No (If no, all owners must sign this application.)
- (b) Will the ownership interest of any owner of the currently authorized place(s) of use identified in this application be adversely affected if this application is approved as requested?
 Yes No (If yes, all owners must sign this application.)
- (c) If this application is not approved expeditiously, will there be substantial damage to property, public health or safety?
 Yes No (If no, all owners must sign this application.)

If the application proposes a surface water change in point of diversion, a groundwater change in point of diversion greater than 300 feet, or a change in place of use, the application must be signed by all owners of the currently authorized place of use, or their duly authorized agent (attach notarized statement authorizing representation).

I hereby verify, being first duly sworn upon my oath or affirmation and under penalty of perjury, that I am of lawful age and the owner, the spouse of the owner, or a duly authorized agent of the owner(s) to make this application on their behalf, in regards to the water right(s) to which this application pertains. I further verify that the statements contained in this application are true, correct and complete.

Dated at Garden City, Kansas, this 16th day of April, 2018.

David Goertzen
(Owner)

Connie J. Goertzen
(Spouse)

David Goertzen
(Please Print)

Connie J. Goertzen
(Please Print)

(Owner)

(Spouse)

(Please Print)

(Please Print)

(Owner)

(Spouse)

(Please Print)

(Please Print)

State of Kansas }
County of Finney } SS

I hereby certify that the foregoing application was signed in my presence and sworn to before me this 16th day of April, 2018.



Julie Jones
Notary Public

My Commission Expires _____

ONLY COMPLETE APPLICATIONS WILL BE PROCESSED. To be complete, all of the applicable portions of the application form must be completed with accurate information; maps, if necessary, must be included; signatures of all the appropriate owners' must be affixed to the application and notarized; and the appropriate fee must be paid.

FEE SCHEDULE

Each application to change the place of use or the point of diversion under this section shall be accompanied by the application fee set forth in the schedule below: Make checks payable to: **Kansas Department of Agriculture**

| | |
|---|-------|
| (1) Application to change a point of diversion 300 feet or less | \$100 |
| (2) Application to change a point of diversion more than 300 feet | \$200 |
| (3) Application to change the place of use | \$200 |

21761

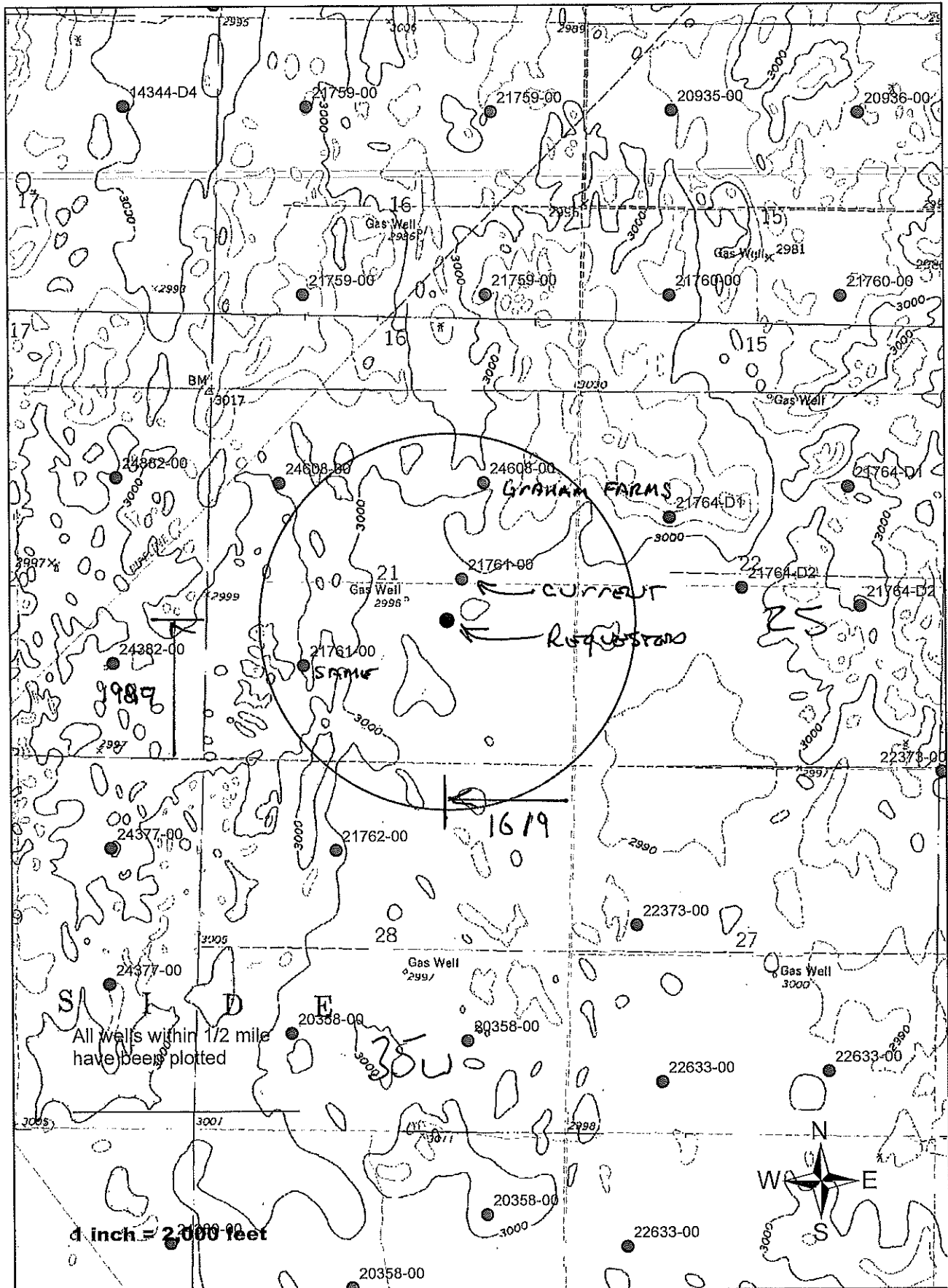

WELL LOG

DATE: 4/3/2018



#3

CUSTOMER NAME: DAVID GOERTZEN

LEGAL: SE 21-25S-35W

COUNTY: KEARNEY COUNTY

GPS: 37 61' 47.29" N

• 8631367

-101 09' 50.95" W

• 164527

TEST HOLE #3

DRILLER: CHRIS P

WO#: 18-160

| TW | FROM | TO | TYPE | HARDNESS | COLOR | SPEED | PULL DOWN | OTHER / DRILLING ACTION |
|----|------|-----|---|----------|-------|-------|-----------|-------------------------|
| | 0 | 2 | SANDY TOP SOIL | SOFT | DARK | FAST | | SMOOTH |
| | 2 | 12 | SILTY CLAY | SOFT | TAN | FAST | | SMOOTH |
| | 12 | 13 | FINE SAND | SOFT | RED | FAST | | CHOPPY |
| | 13 | 17 | SILTY CLAY AND TRACES OF SAND | SOFT | TAN | FAST | | SMOOTH |
| X | 17 | 43 | FINE-MEDIUM GRAVEL | SOFT | RED | FAST | | CHATTER |
| | 43 | 46 | SANDY CLAY | SOFT | WHITE | FAST | | SMOOTH |
| X | 46 | 85 | FINE-MEDIUM-COARSE GRAVEL | SOFT | RED | FAST | | CHATTER |
| | 85 | 103 | CLAY AND BLUE CLAY | SOFT | BLUE | FAST | | SMOOTH |
| | 103 | 116 | SANDY CLAY AND FINE-MEDIUM GRAVEL | SOFT | RED | FAST | | CHOPPY |
| | 116 | 137 | CLAY AND BLUE CLAY | SOFT | BLUE | FAST | | SMOOTH |
| | 137 | 169 | FINE GRAVEL WITH TRACES OF CLAY | SOFT | RED | FAST | | CHOPPY |
| | 169 | 206 | CLAY AND BLUE CLAY | SOFT | BLUE | FAST | | SMOOTH |
| | 206 | 240 | FINE-MEDIUM GRAVEL AND SOME BLUE CLAY | SOFT | RED | FAST | | IN & OUT CHATTER |
| X | 240 | 256 | MEDIUM SAND, FINE-MEDIUM GRAVEL, AND TRACES OF CLAY | SOFT | RED | FAST | | IN & OUT CHATTER |
| X | 256 | 274 | FINE-MEDIUM-TRACE OF COARSE GRAVEL | SOFT | RED | FAST | | CHATTER |
| | 274 | 300 | SANDY CLAY | SOFT | TAN | FAST | | SMOOTH |
| | 300 | 315 | SANDY CLAY AND SOME FINE-MEDIUM SAND | SOFT | TAN | FAST | | CHOPPY AT TIMES |
| | 315 | 334 | SANDY SILTY CLAY | FIRM | TAN | SLOW | | SMOOTH |
| | 334 | 366 | FINE-MEDIUM GRAVEL AND TRACES OF CLAY | SOFT | RED | FAST | | SLIGHT CHATTER |
| | 366 | 388 | CLAY AND TRACES OF SAND | SOFT | TAN | FAST | | CHOPPY AT TIMES |
| | 388 | 426 | RED CLAY WITH TRACES OF BROWN ROCK | SOFT | RED | FAST | | CHOPPY AT TIMES |
| | 426 | 455 | CLAY WITH TRACES OF OCHRE | SOFT | RED | FAST | | SMOOTH |
| X | 455 | | LOST CIRCULATION | | | | | |

SWH
255'
↓

STATE OF KANSAS

DEPARTMENT OF AGRICULTURE
DIVISION OF WATER RESOURCES
GARDEN CITY FIELD OFFICE
2508 JOHNS STREET
GARDEN CITY, KS 67846-2804



PHONE: (620) 276-2901
FAX: (620) 276-9315
www.agriculture.ks.gov

GOVERNOR JEFF COLYER, M.D.
JACKIE McCLASKEY, SECRETARY OF AGRICULTURE

April 18, 2018

GRAHAM FARMS INC
2150 ROAD 220
DEERFIELD KS 67838-9513

RE: Water Right 21761

Dear Mr. Graham:

This is to advise you that the David Goertzen has filed an application for approval of the Chief Engineer, Division of Water Resources, Kansas Department of Agriculture, to change the point of diversion under the above referenced application.

You can find the complete application posted by water right file number as referenced above at www.agriculture.ks.gov/divisions-programs/dwr/water-appropriation/notices

You are notified on this proposed change in point of diversion so that you may furnish this office with any comments or other information you may want to submit. Such comments or other information must be received in this office within 15 days from the date of this letter.

Should you have any questions, please feel free to call this office. If you would prefer, an appointment could be arranged for additional assistance. Please refer to the file number when you contact us if you wish to discuss a specific file.

Sincerely,

A handwritten signature in black ink, appearing to read "Thomas P. Makens", written over a horizontal line.

Thomas P. Makens
Environmental Scientist III

pc: GMD#3

DEPARTMENT OF AGRICULTURE
DIVISION OF WATER RESOURCES
GARDEN CITY FIELD OFFICE
2508 JOHNS STREET
GARDEN CITY, KS 67846-2804

STATE OF KANSAS



PHONE: (620) 276-2901
FAX: (620) 276-9315
www.agriculture.ks.gov

GOVERNOR JEFF COLYER, M.D.
JACKIE McCLASKEY, SECRETARY OF AGRICULTURE

May 3, 2018

Southwest Kansas Groundwater
Management District No 3
409 Campus Drive, Suite 106
Garden City KS 67846

Re: Water Right file number 21761

Dear Mr. Norquest;

David & Connie Goertzen has applied to relocate the well authorized by the above water right number. There are two neighboring wells within ½ mile of the requested.

We are delaying action for 15 days on the change application to allow you time to review and provide a recommendation if you feel one is warranted.

Thank you and as always feel free to call or write us at any time.

Sincerely;

A handwritten signature in black ink, appearing to read "Thomas P Makens".

Thomas P Makens

TPM:tpm

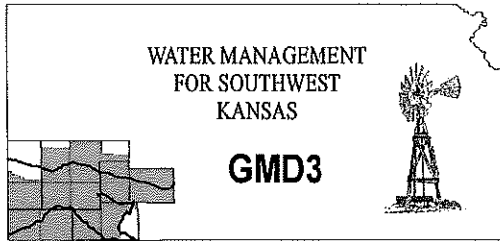

Southwest Kansas
Groundwater Management District No. 3
2009 E. Spruce Street
Garden City, Kansas 67846
(620) 275-7147 phone (620) 275-1431 fax
www.gmd3.org

May 7, 2018

Thomas P. Makens
Division of Water Resources
2508 N Johns Street
Garden City, Kansas 67846

RE: Application for Change in Point of Diversion
Water Right, File No. 21761

Dear Thomas:

We have completed a review of the application for the above referenced water right. The proposal is not in conflict with the Management Program of the Southwest Kansas Groundwater Management District No. 3 (GMD3). The proposed distance moved and well spacing is in accordance with K.A.R. 5-23-3. It is therefore recommended that the application be approved at this time.

Thank you for the opportunity to review the applications and to provide a recommendation. If you have any questions, please don't hesitate to contact us.

Sincerely,

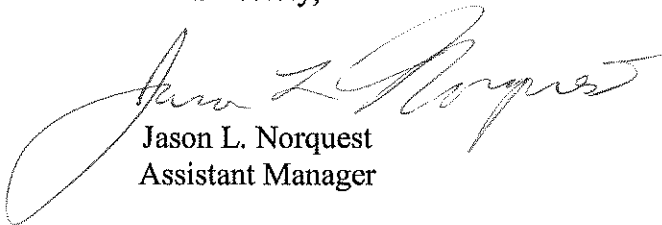

Jason L. Norquest
Assistant Manager

RECEIVED

MAY 09 2018

Garden City Field Office
DIVISION OF WATER RESOURCES

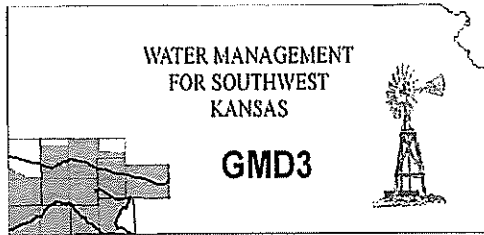

Southwest Kansas
Groundwater Management District No. 3
2009 E. Spruce Street
Garden City, Kansas 67846
(620) 275-7147 phone (620) 275-1431 fax
www.gmd3.org

May 7, 2018

Thomas P. Makens
Division of Water Resources
2508 N Johns Street
Garden City, Kansas 67846

RECEIVED

MAY 08 2018

Garden City Field Office
Division of Water Resources

RE: Application for Change in Point of Diversion
Water Right, File No. 21761

Dear Thomas:

We have completed a review of the application for the above referenced water right. The proposal is not in conflict with the Management Program of the Southwest Kansas Groundwater Management District No. 3 (GMD3). The proposed distance moved and well spacing is in accordance with K.A.R. 5-23-3. It is therefore recommended that the application be approved at this time.

Thank you for the opportunity to review the applications and to provide a recommendation. If you have any questions, please don't hesitate to contact us.

Sincerely,

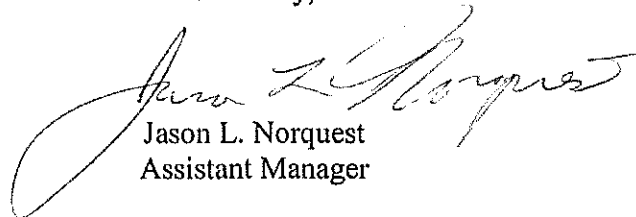

Jason L. Norquest
Assistant Manager

GMD3 Change Review

File No(s): 21761. DWR office: GC.

App filed to change: PD.

Is Landowner(s) correct in WRIS: David & Connie Goertrzen.

If NO, is documentation included?

Is Water Use Correspondent correct in WRIS? Jonas Giesbrecht.

If NO, is documentation included?

Regulation(s) Reviewed: KAR 5-23-3

Point of diversion ID No(s) 02 being changed.

RECEIVED

MAY 08 2018

Garden City Field Office
Division of Water Resources

| | ft. North | ft. West | |
|---------------|-----------|----------|-----------------------|
| Authorized PD | 2550 | 1600 | Sect. 21-25-35 |
| Proposed PD | 1989 | 1619 | |
| Difference | 561 S | -19 W | |
| a2 + b2 = c2 | 314721 | 361 | 561.3217 foot move SW |

GPS for proposed PD: Lat: 37.863136 Long: -101.164152.

Is proposed PD stacking on existing WRs? No.

Is Proposed PU overlapping existing WRs? ___.

Land Owner(s) notified: ___.

Name ___. Name ___.

Address ___. Address ___.

Zip ___. Zip ___.

Neighboring certified well(s) notified: ___.

Name ___. Name ___.

Address ___. Address ___.

Zip ___. Zip ___.

Domestic well(s) notified: ___.

Name ___. Name ___.

Address ___. Address ___.

Zip ___. Zip ___.

Base Acres: ___.

Perfected Acres: ___.

Irr. Return-Flow ___%

Loss of production in current well prompted application for redrill. Spacing is met to neighboring wells and follows current rules.

Proposed depth, slightly more than ones reported in area, still same source supply.

Is a waiver needed: No.

Final Recommendation: After review of all available information, it appears all current area rules are met. Staff therefore recommends approval of the application.



21761 Review; PD

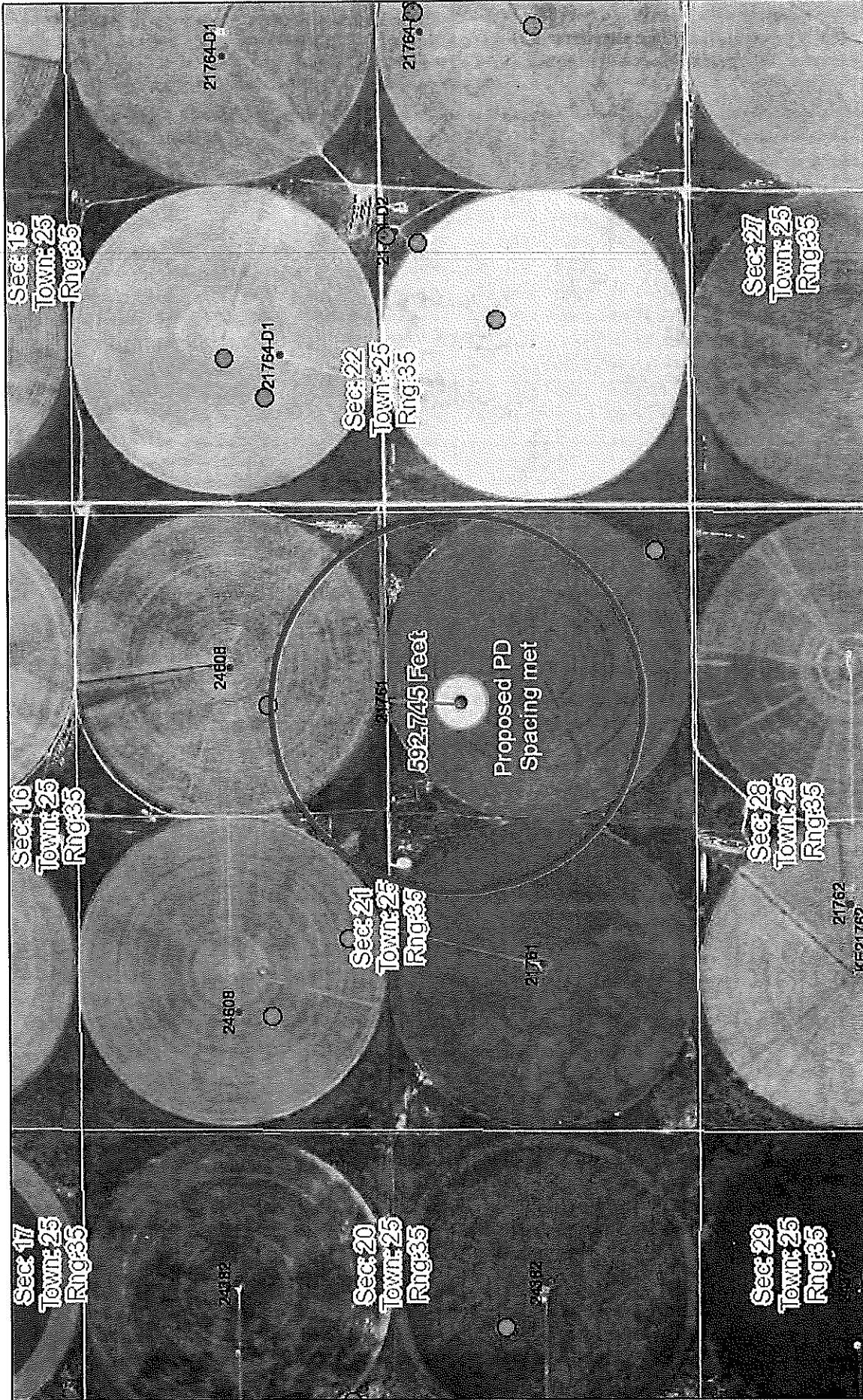

May 7, 2018
11:26 AM

DISCLAIMER: This map is not intended for conveyances, nor is it a legal survey. The information is presented on a best-efforts basis, and should not be relied upon for making financial, survey, legal or other commitments.

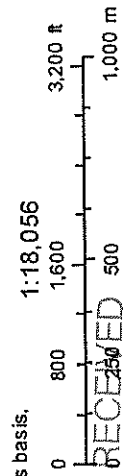

- GPS Position
- Wells
 - Other
 - IRR
 - CON
 - DEW
 - DOM
 - FPR
 - HYD
 - IND
 - MUN
 - REC
 - STK
 - THX
 - Empty

VWVC5 WELLS GMD3

MAY 08 2018

Water Rights and Points of Diversion Within 1.00 miles of point defined as:

1989 ft N and 1619 ft W of the SE Corner of Section 21, T 25S, R 35W
 Located at: 101.163704 West Longitude and 37.863082 North Latitude

GROUNDWATER ONLY

1600' Spacing on A11

| File Number | Use | ST | SR | Dist (ft) | Q4 | Q3 | Q2 | Q1 | FeetN | FeetW | Sec | Twp | Rng | ID | Batt | Auth_Quan | Add_Quan | Unit |
|--------------|-----|----|----|-----------|----|----|----|----|-------|-------|-----|-----|-----|----|------|-----------|----------|------|
| A__ 21759 00 | IRR | NK | G | 4670 | -- | -- | NC | SE | 1320 | 1350 | 16 | 25 | 35W | 4 | | 272.00 | 272.00 | AF ✓ |
| Same | | | | 5165 | -- | -- | NC | SW | 1265 | 3960 | 16 | 25 | 35W | 5 | | 272.00 | 272.00 | AF ✓ |
| A__ 21761 00 | IRR | NK | G | 2441 | -- | -- | NC | SW | 1320 | 3960 | 21 | 25 | 35W | 1 | | 272.00 | 272.00 | AF ✓ |
| Same | | | | 566 | -- | -- | CN | SE | 2550 | 1600 | 21 | 25 | 35W | 2 | | 272.00 | 272.00 | AF ✓ |
| A__ 21762 00 | IRR | NK | G | 3753 | -- | -- | NW | SE | 3935 | 3350 | 28 | 25 | 35W | 5 | | 272.00 | 272.00 | AF ✓ |
| A__ 21764 D1 | IRR | NK | G | 3164 | -- | -- | NE | SW | 3500 | 4065 | 22 | 25 | 35W | 6 | | 272.00 | 272.00 | AF ✓ |
| A__ 21764 D2 | IRR | NK | G | 4088 | -- | -- | NE | NE | 2355 | 2750 | 22 | 25 | 35W | 8 | | 272.00 | 272.00 | AF ✓ |
| A__ 22373 00 | IRR | NK | G* | 5006 | -- | -- | SE | SW | ----- | ----- | 27 | 25 | 35W | 1 | | 272.00 | 272.00 | AF ✓ |
| A__ 24382 00 | IRR | NK | G | 5059 | -- | -- | NC | SE | 1320 | 1350 | 20 | 25 | 35W | 4 | | 272.00 | 272.00 | AF ✓ |
| A__ 24608 00 | IRR | NK | G | 2003 | -- | -- | NC | NE | 3960 | 1320 | 21 | 25 | 35W | 3 | | 272.00 | 272.00 | AF ✓ |
| Same | | | | 3334 | -- | -- | NE | SW | 3915 | 4340 | 21 | 25 | 35W | 6 | | 272.00 | 272.00 | AF ✓ |

| Total Net Quantities Authorized: | Direct | Storage |
|----------------------------------|---------|---------|
| Total Requested Amount (AF) = | .00 | .00 |
| Total Permitted Amount (AF) = | .00 | .00 |
| Total Inspected Amount (AF) = | .00 | .00 |
| Total Pro_Cert Amount (AF) = | .00 | .00 |
| Total Certified Amount (AF) = | 2992.00 | .00 |
| Total Vested Amount (AF) = | .00 | .00 |
| TOTAL AMOUNT (AF) = | 2992.00 | .00 |

Spacing MET!

An * after the source of supply indicates a pending application for change for the file number.

An * after the ID indicates a 15 AF exemption was granted for the file number.

A "G" in the Batt column indicates the GEO CTR of a battery. A "B" indicates a well in the battery.

The number in the Batt column is the number of wells in the battery.

Water Rights and Points of Diversion Within 1.00 miles of point defined as:

101.163704 West Longitude and 37.863082 North Latitude

GROUNDWATER ONLY

WATER USE CORRESPONDENTS:

| File Number | Use | ST | SR |
|--------------|--------------------|----|----|
| A__ 21759 00 | IRR | NK | G |
| > | GRAHAM FARMS INC | | |
| > | 2150 ROAD 220 | | |
| > | DEERFIELD KS 67838 | | |
| A__ 21761 00 | IRR | NK | G |
| > | JONAS E GIESBRECHT | | |
| > | KENNETH GIESBRECHT | | |
| > | PO BOX 11 | | |
| > | DUNHAM KS 67438 | | |
| A__ 21762 00 | IRR | NK | G |
| > | GRAHAM FARMS INC | | |

RECEIVED

MAY 08 2018

Garden City Field Office
 Division of Water Resources

| INPUTS | |
|---|-------------|
| Target Section Definition | |
| Section | 21 |
| Township | 25 |
| Range | 35 |
| Range Direction | W |
| Target Point Coordinates (NAD27 or NAD83) | |
| Target Longitude | -101.164152 |
| Target Latitude | 37.863136 |

Load Data and Compute

- Instructions**
1. Enter values for section, township, range and range direction.
 2. Enter NAD27 or NAD83 longitude and latitude of target point.
 3. Click "Load Data and Compute" button.
 4. Use feet distances corresponding to datum of target point.

| Loaded Section Data | | |
|---|------------------------|----------------------|
| From LEOBASE using NAD83 | | |
| Corner | Corner Latitudes | Corner Longitudes |
| SW | 37.85761050 | -101.17683996 |
| NW | 37.87212159 | -101.17668674 |
| NE | 37.87228990 | -101.15849851 |
| SE | 37.85764084 | -101.15854360 |
| Degrees Longitude per Foot | 3.46381305E-06 | |
| Degrees Latitude per Foot | 2.74615695E-06 | |
| Target Point Distances from Corners using NAD83 | | |
| Corner | Feet North(+)/South(-) | Feet East(-)/West(+) |
| SW | 2012 | -3663 |
| NW | -3272 | -3619 |
| NE | -3333 | 1632 |
| SE | 2001 | 1619 |

Target point is in Section

| Loaded Section Data | | |
|---|------------------------|----------------------|
| From LEOBASE using NAD27 | | |
| Corner | Corner Latitudes | Corner Longitudes |
| SW | 37.85759000 | -101.17639200 |
| NW | 37.87210100 | -101.17623900 |
| NE | 37.87226900 | -101.15805100 |
| SE | 37.85762000 | -101.15809600 |
| Degrees Longitude per Foot | 3.46381208E-06 | |
| Degrees Latitude per Foot | 2.74598553E-06 | |
| Target Point Distances from Corners using NAD27 | | |
| Corner | Feet North(+)/South(-) | Feet East(-)/West(+) |
| SW | 2020 | -3534 |
| NW | -3265 | -3490 |
| NE | -3326 | 1761 |
| SE | 2009 | 1748 |

Target point is in Section

| Difference (NAD83 Minus NAD27) | | |
|--------------------------------|------------------------|----------------------|
| Corner | Corner Latitudes | Corner Longitudes |
| SW | 0.00002050 | -0.00044796 |
| NW | 0.00002059 | -0.00044774 |
| NE | 0.00002090 | -0.00044751 |
| SE | 0.00002084 | -0.00044760 |
| Difference (NAD83 Minus NAD27) | | |
| Corner | Feet North(+)/South(-) | Feet East(-)/West(+) |
| SW | -7.59105227 | -129.32469752 |
| NW | -7.29395332 | -129.26119606 |

RECEIVED

MAY 08 2018

Garden City Field Office
Division of Water Resources

> 2150 ROAD 220
> DEERFIELD KS 67838

A__ 21764 D1 IRR NK G
> WHEATLAND ELECTRIC COOPERATIVE INC
> PERRY SMITH
> PO BOX 953
> GARDEN CITY KS 67846

A__ 21764 D2 IRR NK G
> GRAHAM FARMS INC
>
> 2150 ROAD 220
> DEERFIELD KS 67838

A__ 22373 00 IRR NK G
> GRAHAM FARMS INC
>
> 2150 ROAD 220
> DEERFIELD KS 67838

A__ 24382 00 IRR NK G
> BLUE HOUSE FAMILY TRUST
> WALTER FLETCHER
> PO BOX C
> LAKIN KS 67860

A__ 24608 00 IRR NK G
> GRAHAM FARMS INC
>
> 2150 ROAD 220
> DEERFIELD KS 67838

=====

RECEIVED

MAY 08 2018

Garden City Field Office
Division of Water Resources

QUIT CLAIM DEED

Keith Giesbrecht and Karen Giesbrecht, husband and wife; and Karen Dirks and Lee Dirks, husband and wife; and Kenneth Giesbrecht and Michelle Giesbrecht, husband and wife,

QUIT CLAIM TO

The David K. and Connie J. Goertzen Trust,

all of the following described real estate in the County of Kearny, and the State of Kansas, to-wit:

South ½ of Section 21, Township 25 South, Township 35 West, except minerals thereunder.

EXCEPT AND SUBJECT TO: All easements and restrictions of record.

NOTICE: Pursuant to K.S.A. 79-1437e a real estate validation questionnaire is not required due to exception no 7.

Keith Giesbrecht

Karen Giesbrecht

And

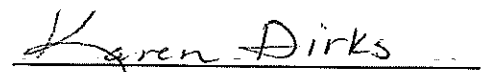
Karen Dirks

Lee Dirks

And

Kenneth Giesbrecht

Michelle Giesbrecht

RECEIVED

APR 16 2018

DATED: 09/25, 2017

STATE OF KANSAS

SS:

COUNTY OF Finney

BE IT REMEMBERED, that on this 25th day of September, 2017, before me, the undersigned, a Notary Public in and for the County and State aforesaid, came **Keith Giesbrecht and Karen Giesbrecht**, husband and wife, who are personally known to me to be the same persons who executed the within instrument of writing and such persons duly acknowledged the execution of the same.

Carolyn R. Peebles
NOTARY PUBLIC

MY APPOINTMENT EXPIRES:

03/22/2021



STATE OF KANSAS

SS:

COUNTY OF Kiowa

BE IT REMEMBERED, that on this 28th day of September, 2017, before me, the undersigned, a Notary Public in and for the County and State aforesaid, came **Karen Dirks and Lee Dirks**, wife and husband, who are personally known to me to be the same persons who executed the within instrument of writing and such persons duly acknowledged the execution of the same.

Deborah A. Wyrick
NOTARY PUBLIC

MY APPOINTMENT EXPIRES:

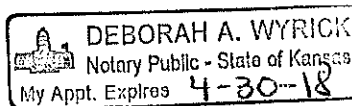

RECEIVED

APR 16 2018

STATE OF KANSAS

SS:

COUNTY OF Marion

BE IT REMEMBERED, that on this 3rd day of October, 2017, before me, the undersigned, a Notary Public in and for the County and State aforesaid, came **Kenneth Giesbrecht and Michelle Giesbrecht**, husband and wife, who are personally known to me to be the same persons who executed the within instrument of writing and such persons duly acknowledged the execution of the same.

Bradley K. Bartel
NOTARY PUBLIC

MY APPOINTMENT EXPIRES:

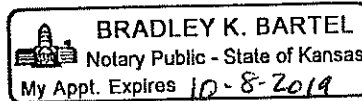

10/8/2019

STATE OF KANSAS } SS
KEARNY COUNTY }

This instrument was filed for record on the 16th day of November A.D. 2017 at 10:45 o'clock A.M., and duly recorded in Book 283 of Record, at Page 548

Melissa Geritzen
REGISTER OF DEEDS

By _____ Deputy

Rec. Fee \$ 46.00



INDEXED ✓
RECEPTION ✓
COMPUTER ✓
DIRECT C ✓
INDIRECT C ✓
NUMERICAL ✓
ORIG. COMP ✓

Entered in Transfer Record in my Office this 16th day of November A.D. 2017
Sayle Ansel Deputy
County Clerk

RECEIVED

APR 16 2018

Garden City Field Office
Division of Water Resources

