

Kansas Department of Agriculture  
 Division of Water Resources  
**CHANGE: P/D WORKSHEET**

1. File Number: <b>24652</b>	2. Status Change Date: <b>3/26/18</b>	3. Change Num: <b>C1</b>	4. Field Office: <b>04</b>	5. GMD: <b>03</b>
---------------------------------	--	-----------------------------	-------------------------------	----------------------

6. Status: <input checked="" type="checkbox"/> Approved <input type="checkbox"/> Denied by DWR/GMD <input type="checkbox"/> Dismiss by Request/Failure to Return	7. Filing Date of Change: <b>3/8/18</b>
--	--

8a. Applicant(s) Person ID \_\_\_\_\_  
 New to system  Add Seq# \_\_\_\_\_

**GREG BORTH**  
**PO BOX 386**  
**MEADE KS 67864**

8c. Landowner(s) Person ID \_\_\_\_\_  
 New to system  Add Seq# \_\_\_\_\_

8b. Landowner(s) Person ID **1633**  
 New to system  Add Seq# **1**

**WILLIAM DEAN BORTH**  
**PO BOX 386**  
**MEADE KS 67864**

8d. WUC Person ID **1633**  
 New to system  Add Seq# **1**

**WILLIAM DEAN BORTH**  
**PO BOX 386**  
**MEADE KS 67864**

9. Documents and Enclosure(s):  DWR Meter(s) Date to Comply: **12/31/18**     N & P Date to Comply: **12/31/18**

Anti-Reverse Meter     Meter Seal     Check Valve     N & P Form     Water Tube     Driller Copy     H & E Letter

Conservation Plan    Date Required: \_\_\_\_\_    Date Approved: \_\_\_\_\_    Date to Comply: \_\_\_\_\_

10. Use Made of Water    From: \_\_\_\_\_    To: \_\_\_\_\_

Date Prepared: **3/12/18**    By: **TPM**  
 Date Entered: \_\_\_\_\_    By: \_\_\_\_\_



STATE OF KANSAS



DEPARTMENT OF AGRICULTURE  
DIVISION OF WATER RESOURCES  
GARDEN CITY FIELD OFFICE  
2508 JOHNS STREET  
GARDEN CITY, KS 67846-2804

PHONE: (620) 276-2901  
FAX: (620) 276-9315  
www.agriculture.ks.gov

GOVERNOR JEFF COLYER, M.D.  
JACKIE McCLASKEY, SECRETARY OF AGRICULTURE

March 26, 2018

WILLIAM DEAN BORTH  
PO BOX 386  
MEADE KS 67864

RE: Change in Point of Diversion Water Right, File No 24652, 27411

Dear Mr. Borth:

Enclosed you will find a *Summary Order Approving Application for Change in Points of Diversion* for the above referenced file. This order modifies the authorized well location under the referenced file. This order modifies the original document; it should be recorded at the County Register of Deeds.

Your attention is directed to the enclosures and to the terms, conditions, and limitations specified in this order. The diversion works should be completed and reported to the Division of Water Resources by **December 31, 2018**. Enclosed is a form for this purpose, along with other information for reference.

A condition of this order is that an acceptable flow meter must be properly installed on the diversion works authorized under the referenced file number in accordance with the Kansas Administrative Regulations 5-1-4 through 5-1-12. This water flow meter shall be used to provide information required on the annual water use report.

This order shall become final if a request for a hearing is not filed with the Chief Engineer within 15 days of the date of service of this order. The date of service is the date listed on the enclosed *Certificate of Service*.

Should you have any questions, please feel free to call this office. If you would prefer, you could arrange an appointment for additional assistance.

Sincerely,

Thomas P. Makens  
Assistant Water Commissioner

TPM:tpm  
Enclosures  
GMD#3

**CERTIFICATE OF SERVICE**

On this 27<sup>th</sup> day of March 2018, I hereby certify that the attached original Approval of Application to Change the Point of Diversion under Water Right, File No. 24652, 27411 dated March 26, 2018 was mailed postage prepaid, first class, US mail to the following:

WILLIAM DEAN BORTH  
PO BOX 386  
MEADE KS 67864

Copy provided to GMD#3

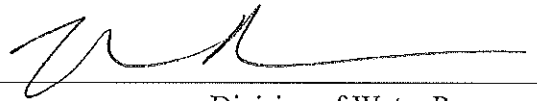
A handwritten signature in black ink, consisting of a stylized 'W' followed by a horizontal line extending to the right.

Division of Water Resources

Submit completed application to:  
 Kansas Department of Agriculture  
 Division of Water Resources  
 Field Office for your area.  
 Call for address:  
 Topeka -- (785) 862-6300  
 Stafford -- (620) 234-5311  
 Stockton -- (785) 425-6787  
 Garden City -- (620) 276-2901  
 www.ksda.gov/dwr

## DWR FIELD OFFICE APPLICATION FOR APPROVAL TO CHANGE THE PLACE OF USE AND/OR THE POINT OF DIVERSION



**STATE OF KANSAS**

**Filing Fee Must Accompany the Application, K.S.A. 82a-708b(b), as amended.**  
 Fee Schedule is on the third page of this application form.

**Paragraph Nos. 1, 2, 3 & 5 must be completed. Complete all other applicable portions.** If change in point of diversion is greater than 100 feet, or if place of use will be changed, include a topographic map or detailed plat showing the authorized and proposed point(s) of diversion and/or place of use.

RECEIVED  
 3:25pm  
 MAR 08 2018

File No. 24652

1. Application is hereby made for approval of the Chief Engineer to change the (check one or both):  
 Place of Use       Point of Diversion  
 under the water right which is the subject of this application in accordance with the conditions described below.  
 The source of supply is:       Groundwater       Surface water

Garden City Field Office  
 Division of Water Resources

2. Name and address of Applicant: Greg Borth  
PO BOX 386 MEADE KS 67864  
 Phone Number: ( ) \_\_\_\_\_ Email address: \_\_\_\_\_  
 Name and address of Water Use Correspondent: WILLIAM DEAN BORTH  
PO BOX 386 MEADE KS 67864  
 Phone Number: ( ) \_\_\_\_\_ Email address: \_\_\_\_\_

3. The presently authorized place of use is:  
 Owner of Land ---- NAME: WILLIAM DEAN BORTH  
ADDRESS: PO BOX 386 MEADE KS 67864  
 (If there is more than one landowner, attach supplemental sheets as necessary.)

Sec.	Twp.	Range	NE¼				NW¼				SW¼				SE¼				TOTAL ACRES
			NE¼	NW¼	SW¼	SE¼	NE¼	NW¼	SW¼	SE¼	NE¼	NW¼	SW¼	SE¼	NE¼	NW¼	SW¼	SE¼	

4. If this application is for a change in place of use, it is proposed that the place of use be changed to:  
 Owner of Land ---- NAME: no change to acres  
ADDRESS: \_\_\_\_\_  
 (If there is more than one landowner, attach supplemental sheets as necessary.)

Sec.	Twp.	Range	NE¼				NW¼				SW¼				SE¼				TOTAL ACRES
			NE¼	NW¼	SW¼	SE¼	NE¼	NW¼	SW¼	SE¼	NE¼	NW¼	SW¼	SE¼	NE¼	NW¼	SW¼	SE¼	

For Office Use Only: Code \_\_\_\_\_ Fee \$ 100 TR # \_\_\_\_\_ Receipt Date 3/8/18 Check # 1234

5. **Presently authorized point of diversion:**  
 One in the sw Quarter of the se Quarter of the ne Quarter of Section 19, Township 31 South, Range 29 W, in Meade County, Kansas, 2645 feet North 825 feet West of Southeast corner of section.  
 Authorized Rate \_\_\_\_\_ Authorized Quantity \_\_\_\_\_ Depth of well \_\_\_\_\_ (feet)  
 (DWR use only: Computer ID No. 1 GPS \_\_\_\_\_ feet North \_\_\_\_\_ feet West)  
 This point will not be changed  This point will be changed as follows:  
**Proposed point of diversion: (Complete only if change is requested)**  
 One in the sw Quarter of the se Quarter of the ne Quarter of Section 19, Township 31 South, Range 29 W, in Meade County, Kansas, 2668 feet North 741 feet West of Southeast corner of section.  
 Proposed Rate \_\_\_\_\_ Proposed Quantity \_\_\_\_\_ Proposed well depth (feet) \_\_\_\_\_  
 This point is:  Additional Well  Geo Center List other water rights that will use this point \_\_\_\_\_

6. **Presently authorized point of diversion:**  
 One in the \_\_\_\_\_ Quarter of the \_\_\_\_\_ Quarter of the \_\_\_\_\_ Quarter of Section \_\_\_\_\_, Township \_\_\_\_\_ South, Range \_\_\_\_\_ W, in \_\_\_\_\_ County, Kansas, \_\_\_\_\_ feet North \_\_\_\_\_ feet West of Southeast corner of section.  
 Authorized Rate \_\_\_\_\_ Authorized Quantity \_\_\_\_\_ Depth of well \_\_\_\_\_ (feet)  
 (DWR use only: Computer ID No. \_\_\_\_\_ GPS \_\_\_\_\_ feet North \_\_\_\_\_ feet West)  
 This point will not be changed  This point will be changed as follows:  
**Proposed point of diversion: (Complete only if change is requested)**  
 One in the \_\_\_\_\_ Quarter of the \_\_\_\_\_ Quarter of the \_\_\_\_\_ Quarter of Section \_\_\_\_\_, Township \_\_\_\_\_ South, Range \_\_\_\_\_ (E/W), in \_\_\_\_\_ County, Kansas, \_\_\_\_\_ feet North \_\_\_\_\_ feet West of Southeast corner of section.  
 Proposed Rate \_\_\_\_\_ Proposed Quantity \_\_\_\_\_ Proposed well depth (feet) \_\_\_\_\_  
 This point is:  Additional Well  Geo Center List other water rights that will use this point \_\_\_\_\_

7. Why do you need a new point of diversion? \_\_\_\_\_  
 old well need to be replaced \_\_\_\_\_

8. If a well, is the test hole log attached?  Yes  No

9. When do you propose to complete the new point of diversion?  
March 9 2018

10. If the point of diversion is a well:  
 (a) What are you going to do with the old well?  
plug  
 (b) When will this be done? 2018

11. Groundwater Management District recommendation attached?  Yes  No

12. Assisted by tpm

13a. If the proposed point of diversion will be relocated within 100 feet of the existing point of diversion, indicate its location on the diagram below in relation to the existing point of diversion. (PLEASE NOTE: The "X" in center of diagram below represents presently authorized point of diversion.)

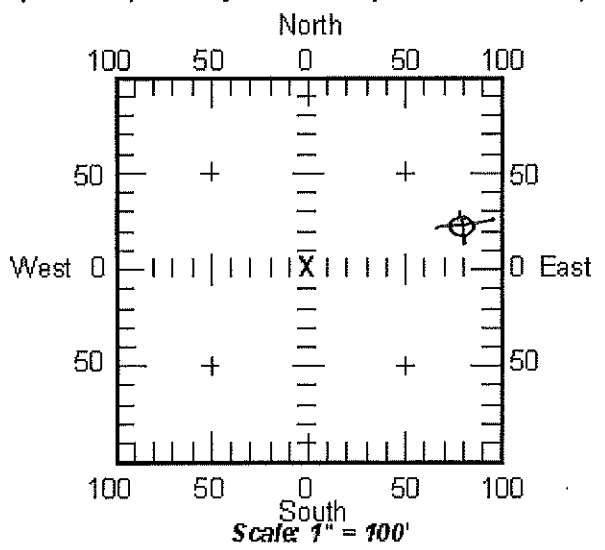

13b. If the proposed point of diversion will be relocated more than 100 feet but within 1320 feet from the existing point of diversion, attach a topographic map or aerial photograph. For groundwater sources, show all wells (including domestic) within one-half mile of the proposed point of diversion and the names and mailing addresses of the owners. For surface water sources, show the names and addresses of the landowner(s) one-half mile downstream and one-half mile upstream from your property lines.

14. If the proposed groundwater point of diversion is 300 or fewer feet from existing point of diversion, complete the following:

- (a) Does the undersigned represent all owners of the currently authorized place(s) of use identified in this application?  
 Yes     No    (If no, all owners must sign this application.)
- (b) Will the ownership interest of any owner of the currently authorized place(s) of use identified in this application be adversely affected if this application is approved as requested?  
 Yes     No    (If yes, all owners must sign this application.)
- (c) If this application is not approved expeditiously, will there be substantial damage to property, public health or safety?  
 Yes     No    (If no, all owners must sign this application.)

If the application proposes a surface water change in point of diversion, a groundwater change in point of diversion greater than 300 feet, or a change in place of use, the application must be signed by all owners of the currently authorized place of use, or their duly authorized agent (attach notarized statement authorizing representation).

I hereby verify, being first duly sworn upon my oath or affirmation and under penalty of perjury, that I am of lawful age and the owner, the spouse of the owner, or a duly authorized agent of the owner(s) to make this application on their behalf, in regard to the water right(s) to which this application pertains. I further verify that the statements contained in this application are true, correct and complete.

Dated at GARDEN CITY, Kansas, this 7<sup>th</sup> day of MARCH, 2018.

[Signature]  
 (Owner) \_\_\_\_\_ (Spouse) \_\_\_\_\_  
 \_\_\_\_\_ (Please Print) \_\_\_\_\_ (Please Print) \_\_\_\_\_  
 \_\_\_\_\_ (Owner) \_\_\_\_\_ (Spouse) \_\_\_\_\_  
 \_\_\_\_\_ (Please Print) \_\_\_\_\_ (Please Print) \_\_\_\_\_  
 \_\_\_\_\_ (Owner) \_\_\_\_\_ (Spouse) \_\_\_\_\_  
 \_\_\_\_\_ (Please Print) \_\_\_\_\_ (Please Print) \_\_\_\_\_

State of Kansas }  
County of FINNEY } SS

I hereby certify that the foregoing application was signed in my presence and sworn to before me this 7<sup>th</sup> day of MARCH, 2018.



[Signature]  
Notary Public

My Commission Expires 9-14-18

ONLY COMPLETE APPLICATIONS WILL BE PROCESSED. To be complete, all of the applicable portions of the application form must be completed with accurate information; maps, if necessary, must be included; signatures of all the appropriate owners' must be affixed to the application and notarized; and the appropriate fee must be paid.

**FEE SCHEDULE**

Each application to change the place of use or the point of diversion under this section shall be accompanied by the application fee set forth in the schedule below: Make checks payable to: **Kansas Department of Agriculture**

(1) Application to change a point of diversion 300 feet or less	\$100
(2) Application to change a point of diversion more than 300 feet	\$200
(3) Application to change the place of use	\$200





3795 W. Jones Ave.  
 Garden City, KS 67846  
 PH: 620-277-2389



PO Box 639  
 Garden City, KS 67846  
 Fax: 620-277-0224

FEB 28 2016

Customer Name: Greg Barth  
 Street Address: P.O. Box 3816  
 City, State: Meado, KS 67864  
 County: Meado Quarter: NE Section: 19  
 Location: From old well - 23°N + 84°E  
 Rig #: 10003

WO#: 13283 Date: 2/28/16  
 Test #: 1 E LOG: Ypo  
 Driller: David Fezzek  
 Township: 31 Range: 29  
 GPS: 37.33687°N 100.51052°W  
 Static WL: 221 Estimated? old well  
 Proposed Well Depth 542'

	%	Footage			Description of Strata
		From	Pay	To	
		0		2	Surface
		2		9	Brown Clay
		9		22	Brown - white clay, calcareous
		22		59	White - Brown clay (firm) calcareous
		59		70	Brown - grey clay, few yellow clay, few cemented sand + limestone
		70		97	Brown Clay (firm), few limestone
		97		154	Sand, fine to med. coarse, small to few med
		154		166	Brown - grey clay (firm)
		166		177	Blue Clay (firm + sticky)
		177		199	Sand, fine to med. coarse
		199		209	Brown clay
		209		220	Sand, fine to med. coarse
1	20%	220	18	239	Sandy, fine to med. (loose)
2	25%	239	41	280	Sand, fine to med. fine coarse (fairly loose)
1	20%	280	20	300	Sand, fine to med. (loose)
2	25%	300	33	333	Sand, fine to med. fine coarse (loose)
3	15%	333	9	342	Sand, fine to small, thin clay
2	25%	342	28	370	Sand, fine to med. fine coarse (fairly loose)
		370	—	379	Brown Clay (firm)
		379	—	402	Brown Clay (firm), limestone
4	30%	402	33	435	Sand, fine to med. coarse, few small gravel
		435	—	445	Brown Clay, limestone
		445	—	460	Brown - white clay, limestone
		460	—	474	Brown Clay
5	10%	474	30	514	Sand, fine (fairly loose), thin clay
6	5%	514	23	537	Sand, fine, clay matrix (fairly, loose)
		537	—	542	Red + Brown clay
		542		560	Red Bed
					093369
					- Test Rig -
					- Set up East -
					- Pit to Sample -
					2 - Super Gel X
					5 - Grout
					6 - Barite Plug
					1 - Perme Plug
					24652 27411

