

Kansas Department of Agriculture
 Division of Water Resources
CHANGE: P/U WORKSHEET

1. File Number: 26067 D4	2. Status Change Date: 7/5/18	3. Change Num: C1	4. Field Office: 04	5. GMD: 03
------------------------------------	---	-----------------------------	-------------------------------	----------------------

6. Status: <input checked="" type="checkbox"/> Approved <input type="checkbox"/> Denied by DWR/GMD <input type="checkbox"/> Dismiss by Request/Failure to Return	7. Filing Date of Change: 6/26/18
--	---

8a. Applicant(s) New to system <input type="checkbox"/>	Person ID 55237 Add Seq# 1
FRED RITSEMA & YOKA RODENHUIS TRUSTS LAKIN DAIRY PO BOX 389 LAKIN KS 67860-0389	

8c. Landowner(s) New to system <input type="checkbox"/>	Person ID _____ Add Seq# _____
--	-----------------------------------

8b. Landowner(s) New to system <input type="checkbox"/>	Person ID _____ Add Seq# _____
NC	

8d. WUC New to system <input type="checkbox"/>	Person ID _____ Add Seq# _____
NC	

9. Documents and Enclosure(s): <input checked="" type="checkbox"/> DWR Meter(s) Date to Comply: 12/31/18 <input checked="" type="checkbox"/> N & P Date to Comply: 12/31/18	
<input type="checkbox"/> Anti-Reverse Meter <input type="checkbox"/> Meter Seal <input type="checkbox"/> Check Valve <input type="checkbox"/> N & P Form <input type="checkbox"/> Water Tube <input type="checkbox"/> Driller Copy <input type="checkbox"/> H & E Letter	
<input type="checkbox"/> Conservation Plan Date Required: _____ Date Approved: _____ Date to Comply: _____	

10. Use Made of Water From: _____	To: _____
--------------------------------------	-----------

Date Prepared: 6/26/18	By: tpm
Date Entered: _____	By: _____

12. Points of Diversion
 CHK
 MOD
 DEL PDIV
 ENT
 Qualifier S T R ID 'N 'W Comment (AKA Line) Rate Quantity Rate Quantity Rate Quantity
 gpm/cfs af/mgy gpm/cfs af/mgy gpm/cfs af/mgy gpm/cfs af/mgy gpm/cfs af/mgy gpm/cfs af/mgy

ent ne sw ne 14 25 36 w 3668 1543

del 52909

13. Storage: Rate _____ NF Quantity _____ ac/ft Additional Rate _____ NF Additional Quantity _____ ac/ft

14. Limitation: _____ af/yr at _____ gpm (_____ cfs) when combined with file number(s) _____
 Limitation: _____ af/yr at _____ gpm (_____ cfs) when combined with file number(s) _____

15. 5YR Allocation: Allocation Type _____ Start Year _____ 5 YR Amount _____ Amount Unit _____ Base Acres _____ Comment _____

16. Place of Use CHK MOD DEL ENT	PUSE	S	T	R	ID	NE 1/4			NW 1/4			SW 1/4			SE 1/4			Total	Owner	Chg?	Overlap Files	
						NE 1/4	SW 1/4	SE 1/4	NW 1/4	SW 1/4	SE 1/4	NE 1/4	SW 1/4	SE 1/4	NW 1/4	SW 1/4	SE 1/4					
						1/4	1/4	1/4	1/4	1/4	1/4	1/4	1/4	1/4	1/4	1/4	1/4					

Base Acres: _____ Year: _____ Minimum Reasonable Quantity: _____

Comments: _____

STATE OF KANSAS

DEPARTMENT OF AGRICULTURE
DIVISION OF WATER RESOURCES
GARDEN CITY FIELD OFFICE
2508 JOHNS STREET
GARDEN CITY, KS 67846-2804



PHONE: (620) 276-2901
FAX: (620) 276-9315
www.agriculture.ks.gov

GOVERNOR JEFF COLYER, M.D.
JACKIE MCCLASKEY, SECRETARY OF AGRICULTURE

July 5, 2018

FRED RITSEMA & YOKA RODENHUIS TRUSTS
LAKIN DAIRY
PO BOX 389
LAKIN KS 67860-0389

RE: Change in Point of Diversion Water Right, File No 26067 D4

Dear Mr. Ritsema and Ms. Rodenhuis;

Enclosed you will find a *Summary Order Approving Application for Change in Points of Diversion* for the above referenced file. This order modifies the authorized well location under the referenced file. This order modifies the original document; it should be recorded at the County Register of Deeds.

Your attention is directed to the enclosures and to the terms, conditions, and limitations specified in this order. The diversion works should be completed and reported to the Division of Water Resources **by December 31, 2018**. Enclosed is a form for this purpose, along with other information for reference.

A condition of this order is that an acceptable flow meter must be properly installed on the diversion works authorized under the referenced file number in accordance with the Kansas Administrative Regulations 5-1-4 through 5-1-12. This water flow meter shall be used to provide information required on the annual water use report.

This order shall become final if a request for a hearing is not filed with the Chief Engineer within 15 days of the date of service of this order. The date of service is the date listed on the enclosed *Certificate of Service*.

Should you have any questions, please feel free to call this office. If you would prefer, you could arrange an appointment for additional assistance.

Sincerely,

Thomas P. Makens
Assistant Water Commissioner

TPM:tpm
Enclosures

GMD#3

CERTIFICATE OF SERVICE

On this 6th day of July 2018, I hereby certify that the attached original Approval of Application to Change the Point of Diversion under Water Right, File No. 26067 D4 dated July 5, 2018 was mailed postage prepaid, first class, US mail to the following:

FRED RITSEMA & YOKA RODENHUIS TRUSTS
LAKIN DAIRY
PO BOX 389
LAKIN KS 67860-0389

Copy provided to GMD#3

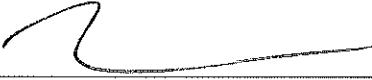

Division of Water Resources

Submit completed application to:
 Kansas Department of Agriculture
 Division of Water Resources
 Field Office for your area.
 Call for address:

Topeka -- (785) 296-5733
 Stafford -- (620) 234-5311
 Stockton -- (785) 425-6787
 Garden City -- (620) 276-2901
<http://agriculture.ks.gov/dwr>

DWR FIELD OFFICE APPLICATION FOR APPROVAL TO CHANGE THE PLACE OF USE AND/OR THE POINT OF DIVERSION



STATE OF KANSAS

Filing Fee Must Accompany the Application, K.S.A. 82a-708b(b), as amended.
 Fee Schedule is on the third page of this application form.

Paragraph Nos. 1, 2, 3 & 5 must be completed. Complete all other applicable portions. If change in point of diversion is greater than 100 feet, or if place of use will be changed, include a topographic map or detailed plat showing the authorized and proposed point(s) of diversion and/or place of use.

RECEIVED
 2:55 PM
 JUN 26 2018

File No. 26067 D4

1. Application is hereby made for approval of the Chief Engineer to change the (check one or both): Garden City Field Office
 Division of Water Resources
- Place of Use Point of Diversion
- under the water right which is the subject of this application in accordance with the conditions described below.
- The source of supply is: Groundwater Surface water

2. Name and address of Applicant: FRED RITSEMA & YOKA RODENHUIS TRUSTS
- PO BOX 389 LAKIN KS 67860-0389
- Phone Number: (620)271-2413 Email address: _____
- Name and address of Water Use Correspondent: FRED RITSEMA & YOKA RODENHUIS TRUSTS
- PO BOX 389 LAKIN KS 67860-0389
- Phone Number: () Email address: _____

3. The presently authorized place of use is:
- Owner of Land ---- NAME: FRED RITSEMA & YOKA RODENHUIS TRUSTS
- ADDRESS: PO BOX 389 LAKIN KS 67860-0389
- (If there is more than one landowner, attach supplemental sheets as necessary.)

Sec.	Twp.	Range	NE¼				NW¼				SW¼				SE¼				TOTAL ACRES		
			NE¼	NW¼	SW¼	SE¼	NE¼	NW¼	SW¼	SE¼	NE¼	NW¼	SW¼	SE¼	NE¼	NW¼	SW¼	SE¼			

4. If this application is for a change in place of use, it is proposed that the place of use be changed to:
- Owner of Land ---- NAME: no change in acres irrigated
- ADDRESS: _____
- (If there is more than one landowner, attach supplemental sheets as necessary.)

Sec.	Twp.	Range	NE¼				NW¼				SW¼				SE¼				TOTAL ACRES			
			NE¼	NW¼	SW¼	SE¼	NE¼	NW¼	SW¼	SE¼	NE¼	NW¼	SW¼	SE¼	NE¼	NW¼	SW¼	SE¼				

For Office Use Only: Code _____ Fee \$ 100 TR # _____ Receipt Date 6/26/18 Check # 1068

5. **Presently authorized point of diversion:**
 One in the nc n2 Quarter of the s2 Quarter of the ne Quarter of Section 14, Township 25 South, Range 36 W, in Kearny County, Kansas, 3660 feet North 1310 feet West of Southeast corner of section.
 Authorized Rate _____ Authorized Quantity _____ Depth of well _____ (feet)
 (DWR use only: Computer ID No. 1 GPS 3602 feet North 1263 feet West) GMD
 This point will not be changed This point will be changed as follows: No change, point better described with GPS as follows:
Proposed point of diversion: (Complete only if change is requested or if existing point is better described by GPS)
 One in the ne Quarter of the sw Quarter of the ne Quarter of Section 14, Township 25 South, Range 36 W, in Kearny County, Kansas, 3668 feet North 1543 feet West of Southeast corner of section.
 Proposed Rate _____ Proposed Quantity _____ Proposed well depth (feet) _____
 This point is: Additional Well Geo Center List other water rights that will use this point _____

6. **Presently authorized point of diversion:**
 One in the _____ Quarter of the _____ Quarter of the _____ Quarter of Section _____, Township _____ South, Range _____ (E/W), in _____ County, Kansas, _____ feet North _____ feet West of Southeast corner of section.
 Authorized Rate _____ Authorized Quantity _____ Depth of well _____ (feet)
 (DWR use only: Computer ID No. _____ GPS _____ feet North _____ feet West)
 This point will not be changed This point will be changed as follows: No change, point better described with GPS as follows:
Proposed point of diversion: (Complete only if change is requested or if existing point is better described by GPS)
 One in the _____ Quarter of the _____ Quarter of the _____ Quarter of Section _____, Township _____ South, Range _____ (E/W), in _____ County, Kansas, _____ feet North _____ feet West of Southeast corner of section.
 Proposed Rate _____ Proposed Quantity _____ Proposed well depth (feet) _____
 This point is: Additional Well Geo Center List other water rights that will use this point _____

7. The changes herein are desired for the following reasons?
 (please be specific) old well needs to be replaced

8. If a well, is the test hole log attached? Yes No

9. The change(s) (was)(will be) completed by?
July 1, 2018

10. If the point of diversion is a well:
 (a) What are you going to do with the old well?
plug
 (b) When will this be done? 2018

11. Groundwater Management District recommendation attached?
 Yes No

12. Assisted by tpm

13a. If the proposed point of diversion will be relocated more than 300 feet but within 2,640 feet of the existing point of diversion, attach a topographic map or aerial photograph. For groundwater sources, show all wells (including domestic) within one-half mile of the proposed point of diversion and the names and mailing addresses of the owners. For surface water sources, show the names and addresses of the landowner(s) one-half mile downstream and one-half mile upstream from your property lines

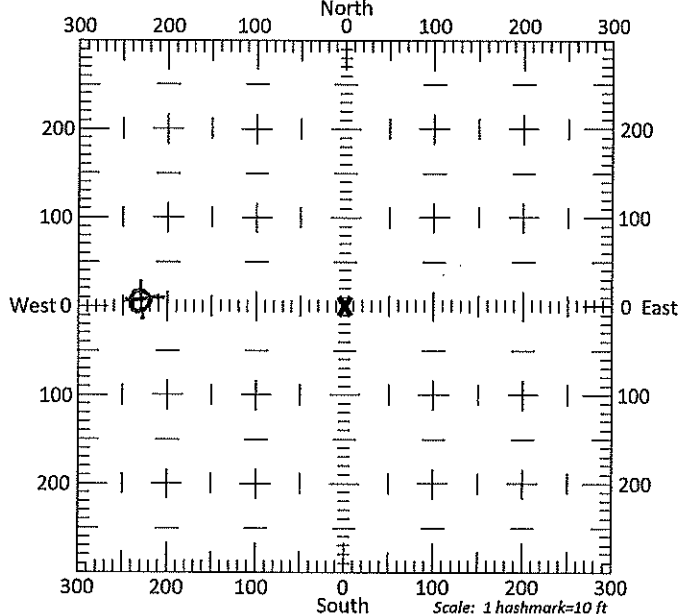

13b. If the proposed point of diversion will be relocated within 300 feet of the existing point of diversion, indicate its location on the diagram shown above in relation to the existing point of diversion. (PLEASE NOTE: The "X" in center of diagram above represents the presently authorized point of diversion.)

14. If the proposed groundwater point of diversion is 300 or fewer feet from the existing point of diversion, complete the following:
- (a) Does the undersigned represent all owners of the currently authorized place(s) of use identified in this application?
 Yes No (If no, all owners must sign this application.)
 - (b) Will the ownership interest of any owner of the currently authorized place(s) of use identified in this application be adversely affected if this application is approved as requested?
 Yes No (If yes, all owners must sign this application.)
 - (c) If this application is not approved expeditiously, will there be substantial damage to property, public health or safety?
 Yes No (If no, all owners must sign this application.)

If the application proposes a surface water change in point of diversion, a groundwater change in point of diversion greater than 300 feet, or a change in place of use, the application must be signed by all owners of the currently authorized place of use, or their duly authorized agent (attach notarized statement authorizing representation).

I hereby verify, being first duly sworn upon my oath or affirmation and under penalty of perjury, that I am of lawful age and the owner, the spouse of the owner, or a duly authorized agent of the owner(s) to make this application on their behalf, in regards to the water right(s) to which this application pertains. I further verify that the statements contained in this application are true, correct and complete.

Dated at GARDEN CITY, Kansas, this 26th day of JUNE, 2018.

X [Signature]

 (Owner)

 (Please Print)

 (Owner)

 (Please Print)

 (Owner)

 (Please Print)

 (Spouse)

 (Please Print)

 (Spouse)

 (Please Print)

 (Spouse)

 (Please Print)

State of Kansas }
 County of FINNEY } SS

I hereby certify that the foregoing application was signed in my presence and sworn to before me this 26 day of JUNE, 2018.

My Commission Expires 9-14-18  Catherine Reinert
 Notary Public

ONLY COMPLETE APPLICATIONS WILL BE PROCESSED. To be complete, all of the applicable portions of the application form must be completed with accurate information; maps, if necessary, must be included; signatures of all the appropriate owners' must be affixed to the application and notarized; and the appropriate fee must be paid.

FEE SCHEDULE

- Each application to change the place of use or the point of diversion under this section shall be accompanied by the application fee set forth in the schedule below: Make checks payable to: **Kansas Department of Agriculture**
- (1) Application to change a point of diversion 300 feet or less **\$100**
 - (2) Application to change a point of diversion more than 300 feet **\$200**
 - (3) Application to change the place of use **\$200**

SUMMARY ORDER APPROVING APPLICATION FOR CHANGE AND IMPOSING CONDITIONS

This Summary Order is issued under authority of K.S.A. 82a-708b, as amended, and K.A.R. 5-5-1, *et seq.* and other applicable provisions of the *Kansas Water Appropriation Law, K.S.A. 82a-701 et. seq.*, and rules and regulations promulgated thereunder. With the exception of those conditions expressly contained herein, this Summary Order does not change the terms, conditions and limitations of File No. 26067 D4.

1. A change application was received on JUNE 26, 2018 requesting that the place of use and / or point of diversion authorized under the above-referenced file number be changed as described in the application.
2. On and after the effective date of this summary order, the authorized place(s) of use shall be located substantially as shown on the topographic map accompanying the application to change the place of use. Applicable Not Applicable
3. The change in point of diversion shall not impair existing rights and shall be limited to the same source or sources of water as previously authorized. The point of diversion authorized by this summary order shall be located within a 50 foot radius of the authorized point(s) of diversion. Applicable Not Applicable
4. The point(s) of diversion described herein is administratively corrected to be more accurately described using the Global Positioning System (GPS), as described in the application. Applicable Not Applicable
5. The point(s) of diversion authorized herein shall not actually be located more than 300 feet from the previously authorized point(s) of diversion. Applicable Not Applicable
6. As required by K.A.R. 5-3-5d, if the works for diversion is a well with a diversion rate of 100 gallons per minute or more, a tube or other device suitable for making water level measurements shall be installed, operated and maintained in accordance with K.A.R. 5-6-13. Applicable Not Applicable
7. The owner of the authorized place(s) of use shall properly install an acceptable water flow meter on or before December 31, 2018, or before the first use of water, whichever occurs first. The water flow meter shall be installed, operated and maintained in accordance with K.A.R. 5-1-4 through 5-1-12. As required by K.S.A. 82a-732, as amended, and K.A.R. 5-3-5e, the owner shall maintain records and report the reading of the water flow meter and the total quantity of water diverted annually to the Chief Engineer by March 1 following the end of each calendar year. Applicable Not Applicable
8. Installation of the works for diversion of water shall be completed on or before December 31, 2018, or within any authorized extension of time. By March 1, 2019 the applicant shall notify the Chief Engineer that construction of the works for diversion has been completed, on the form provided by the Chief Engineer, as required by K.A.R. 5-8-4e. Applicable Not Applicable
9. The completed well log shall be submitted with the required notice. Applicable Not Applicable
10. All diversion works into which any type of chemical or other foreign substance will be injected into the water shall be equipped with an in-line, automatic, quick-closing check valve capable of preventing pollution of the source of the water supply. The check valve(s) shall be installed, operated and maintained in accordance with K.A.R. 5-3-5c. Applicable Not Applicable
11. Additional Conditions are attached. Yes No
12. In accordance with K.S.A. 82a-708a, as amended, and K.A.R. 5-5-14, all of the owners of the authorized place(s) of use of water appropriated under the above-referenced file number are responsible for compliance with its terms, conditions and limitations, as amended and/or supplemented by this Summary Order, and with applicable provisions of the *Kansas Water Appropriation Law* and the *Rules and Regulations* promulgated thereunder. Failure to comply with these provisions may result in civil penalties pursuant to K.S.A. 82a-737, as amended, and/or the suspension or revocation and dismissal of the water or appropriation right or any other enforcement actions authorized by law.

Administrative Appeal and Effective Date of Order

If you are aggrieved by this order, pursuant to K.S.A. 82a-1901, you may request an evidentiary hearing before the Chief Engineer or request administrative review by the Secretary of Agriculture. A request for hearing by the Chief Engineer must be filed within **15 days** of service of this Order and a request for administrative review by the Secretary must be filed within **30 days** pursuant to K.S.A. 77-531. Any request for administrative review must state a basis for review pursuant to K.S.A. 77-527. File any request with **Kansas Department of Agriculture, Legal Division, 1320 Research Park Drive, Manhattan, KS 66502**. Failure to timely request a hearing or review may preclude review under the Kansas Judicial Review Act.

For Use by Register of Deeds

FOR OFFICE USE ONLY
APPLICATION APPROVED AND SUMMARY ORDER ISSUED

By: TL P. L.
Duly Authorized Designee of the Chief Engineer

(Print Name): THOMAS P. MAIKONS
Division of Water Resources - Kansas Department of Agriculture

Date of Issuance: JULY 5, 2018

State of Kansas

County of Girney) SS

Acknowledged before me on July 5, 2018
by Thomas P. Maikons

Signature: Julie Jones
Notary Public

My commission expires: _____

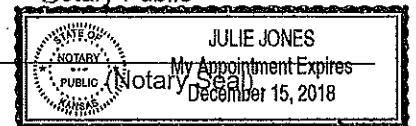

GSPF IRRIGATION SERVICE

RECEIVED

710 W Taylor Jones Rd

Holcomb, KS 67851

Phone: 620-277-2503

Fax: 620-277-2581

FRED RITSEMA 620-355-6640

CELL 620-871-2413

JUN 22 2018

Garden City Field Office
Division of Water Resources

Customer Name: Lakin Hay

Date: 5/10/18

Address: P.O. Box 389

Test # 2

E Log

City & state LAKIN, KS. 67860

Driller: Pana Vogts

County Kearney

Quarter NE

Section: 14

Township: 25

Range: 36

Location: 675 N 37.88202 W 101.23615

Elev: 3045

232' WEST of EXISTING WELL

Rig# 1

WO#

WELL LOCATION

%	From	Pay	To	Description of Strata	Static Water Level <u>180 GSPF</u>	Proposed Well Depth <u>418</u>
	0		2	Sand top soil		20' Sump
	2		18	Sand FM		
	18		26	Sandy clay		
	26		63	Sand FMC + gravel		
	63		66	Sandy clay		
	66		84	Sand FMC + gravel		
	84		117	Sandy clay		
	117		142	Sandy clay w/ 20% sand F-M strips		
	142		150	Sand FM		
	150		166	grey sandy clay		
	166		174	Sand FM		
	174		183	Sandy clay		
800	183	32	212	Sand FM		
	212	4	216	Cemented sand		
	216	31	247	Sand FM Few thin clay strips		
	247	16	263	Sand FMC Few clay strips		
	263	24	287	Sand FM some cemented strip strips		
13	287	-	300	Sandy clay		
	300	15	315	Sand FM		
	315	6	321	Sandy clay w/ white rock		
	321	9	330	Sand FM		

26067 DY

TOPO! map printed on 05/23/18 from "Untitled.tpo"

NAD27 101.23333° W

101.25000° W

37.88333° N

37.88333° N

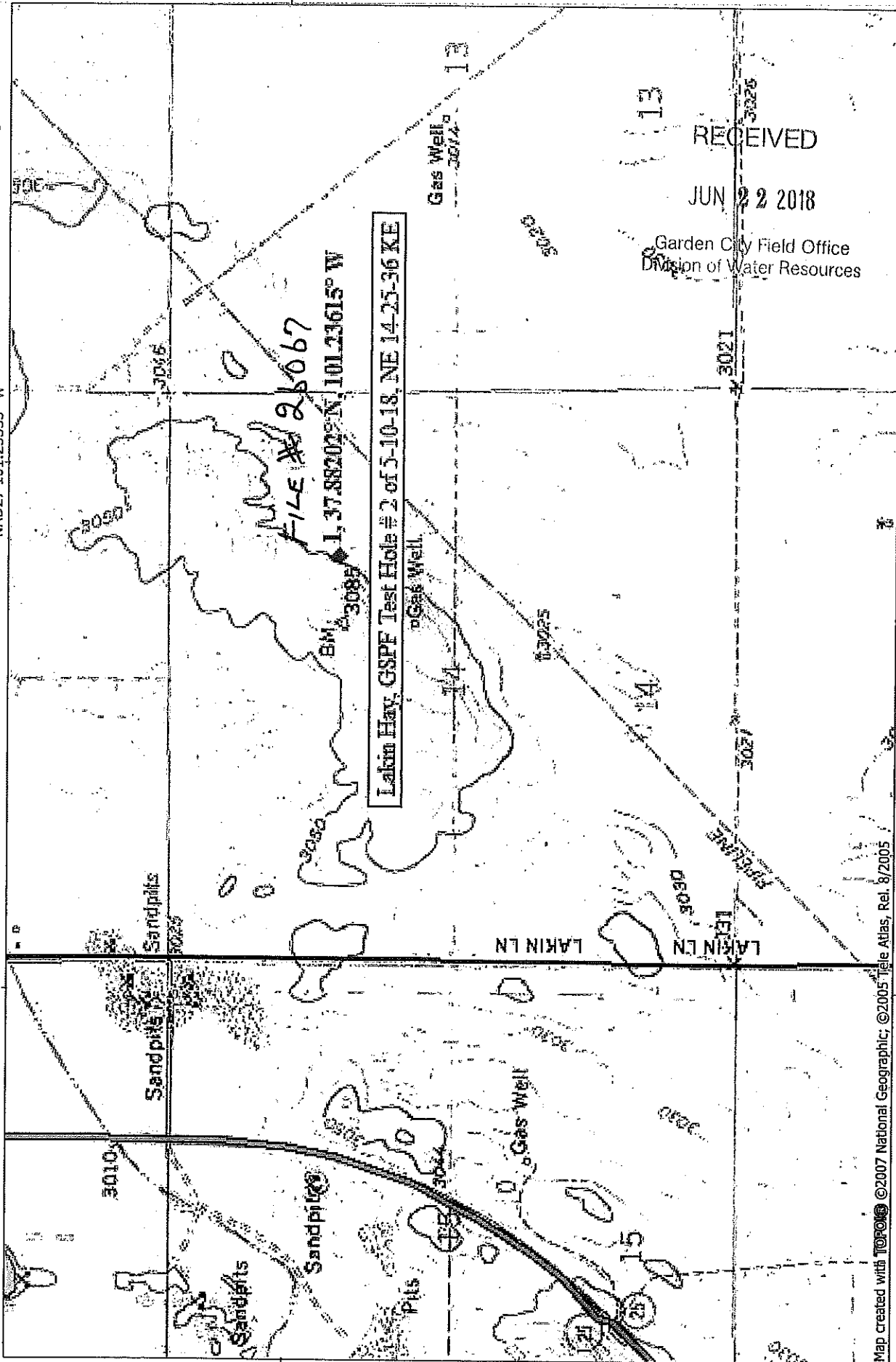

Map created with TOPO! ©2007 National Geographic; ©2005, Title Atlas, Rel. 8/2005

NAD27 101.23333° W

101.25000° W

NATIONAL GEOGRAPHIC

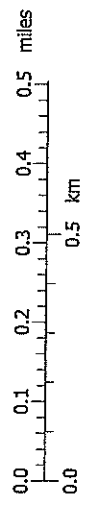

TN 6° 05/23/18

