

Kansas Department of Agriculture  
 Division of Water Resources  
**CHANGE: P/U WORKSHEET**

1. File Number: <b>3838</b>	2. Status Change Date: <b>8/7/18</b>	3. Change Num: <b>C1</b>	4. Field Office: <b>04</b>	5. GMD: <b>03</b>
--------------------------------	---	-----------------------------	-------------------------------	----------------------

6. Status: <input checked="" type="checkbox"/> Approved <input type="checkbox"/> Denied by DWR/GMD <input type="checkbox"/> Dismiss by Request/Failure to Return	7. Filing Date of Change: <b>7/9/18</b>
--	--

8a. Applicant(s)                      Person ID <u><b>840</b></u> New to system <input type="checkbox"/> Add Seq# <u><b>1</b></u>  <b>MIKE H &amp; CARLA J BARTLETT</b> <b>12720 103 RD</b> <b>FOWLER KS 67844-8702</b>	8c. Landowner(s)                      Person ID _____ New to system <input type="checkbox"/> Add Seq# _____
--	--

8b. Landowner(s)                      Person ID <u><b>840</b></u> New to system <input type="checkbox"/> Add Seq# <u><b>1</b></u>  <b>MIKE H &amp; CARLA J BARTLETT</b> <b>12720 103 RD</b> <b>FOWLER KS 67844-8702</b>	8d. WUC                                      Person ID <u><b>840</b></u> New to system <input type="checkbox"/> Add Seq# <u><b>1</b></u>  <b>MIKE H &amp; CARLA J BARTLETT</b> <b>12720 103 RD</b> <b>FOWLER KS 67844-8702</b>
--	---

9. Documents and Enclosure(s):  DWR Meter(s) Date to Comply: **12/31/18**     N & P Date to Comply: **12/31/18**

Anti-Reverse Meter     Meter Seal     Check Valve     N & P Form     Water Tube     Driller Copy     H & E Letter  
 Conservation Plan    Date Required: \_\_\_\_\_    Date Approved: \_\_\_\_\_    Date to Comply: \_\_\_\_\_

10. Use Made of Water    From: \_\_\_\_\_    To: \_\_\_\_\_

Date Prepared: **7/23/18**                      By: **TPM**  
 Date Entered: \_\_\_\_\_                      By: \_\_\_\_\_

File No. **3838**      11. County: FO      Basin: crooked      Stream:      Formation Code:      Special Use:

12. Points of Diversion  
 CHK      Rate and Quantity  
 MOD      Authorized      Additional  
 DEL      PDIV      Rate      Quantity      Rate      Quantity  
 ENT      Comment (AKA Line)      gpm      af      gpm      af      Overlap PD Files

Qualifier      S      T      R      ID      'N      'W      Comment (AKA Line)      gpm      af      gpm      af      Overlap PD Files

**nc**

13. Storage: Rate \_\_\_\_\_ NF \_\_\_\_\_ Quantity \_\_\_\_\_ ac/ft      Additional Rate \_\_\_\_\_ NF \_\_\_\_\_ Additional Quantity \_\_\_\_\_ ac/ft

14. Limitation: **nc**      af/yr at \_\_\_\_\_ gpm ( \_\_\_\_\_ cfs) when combined with file number(s) \_\_\_\_\_  
 Limitation: \_\_\_\_\_ af/yr at \_\_\_\_\_ gpm ( \_\_\_\_\_ cfs) when combined with file number(s) \_\_\_\_\_

15. 5YR Allocation:      Allocation Type \_\_\_\_\_      Start Year \_\_\_\_\_      5 YR Amount \_\_\_\_\_      Amount Unit \_\_\_\_\_      Base Acres \_\_\_\_\_      Comment \_\_\_\_\_

16. Place of Use

CHK MOD DEL ENT	PUSE	S	T	R	ID	NE 1/4			NW 1/4			SW 1/4			SE 1/4			Total	Owner	Chg?	Overlap Files										
						NE 1/4	NW 1/4	SW 1/4	SE 1/4	NE 1/4	NW 1/4	SW 1/4	SE 1/4	NE 1/4	NW 1/4	SW 1/4	SE 1/4														
ENT	5316	22	29	26	W	40	40	33	40	2	14	40	32	40	36	40	40	40	35	40	31	31	534	8B	y	1050	3838	12561	27888		
DEL	30327																														

Base Acres: **524**      Year:      Minimum Reasonable Quantity:  
 Comments:

STATE OF KANSAS

DEPARTMENT OF AGRICULTURE  
DIVISION OF WATER RESOURCES  
GARDEN CITY FIELD OFFICE  
2508 JOHNS STREET  
GARDEN CITY, KS 67846-2804



PHONE: (620) 276-2901  
FAX: (620) 276-9315  
www.agriculture.ks.gov

GOVERNOR JEFF COLYER, M.D.  
JACKIE McCLASKEY, SECRETARY OF AGRICULTURE

August 7, 2018

MIKE H & CARLA J BARTLETT  
12720 103 RD  
FOWLER KS 67844-8702

RE: Change the Place of Use, File Nos; 1050 3838 12561  
27888

Dear Mr. & Mrs. Bartlett;

Enclosed you will find a *Summary Order Approving Application for Change in Place of Use* for the above referenced files. Since these orders modify the original documents, it should be recorded at the County Register of Deeds.

These orders modify the authorized acres that can be irrigated by these files. The authorized place of use is as shown on the plats within the change approvals.

A condition of this order is that an acceptable flow meter must be properly installed on the diversion works authorized under the referenced file number in accordance with the Kansas Administrative Regulations 5-1-4 through 5-1-12. This water flow meter shall be used to provide information required on the annual water use report (including the meter reading at the beginning and end of the report year).

This order shall become final if a request for a hearing is not filed with the Chief Engineer within 15 days of the date of service of this order. The date of service is the date listed on the enclosed *Certificate of Service*.

Should you have any questions, please feel free to call this office or arrange an appointment for additional assistance. Please refer to the file number when you contact us if you wish to discuss a specific file.

Sincerely,

Thomas P. Makens  
Assistant Water Commissioner

TPM:tpm  
Enclosures  
GMD#3

**CERTIFICATE OF SERVICE**

On this 8<sup>th</sup> day of August 2018, I hereby certify that the attached original Approval of Application to Change the Place of Use under Water Right File 1050 3838 12561 27888 dated August 7, 2018, was mailed postage prepaid, first class, US mail to the following:

MIKE H & CARLA J BARTLETT  
12720 103 RD  
FOWLER KS 67844-8702

Scanned copy provided to GMD#3

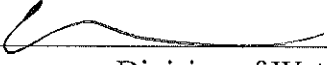
  
Division of Water Resources

Submit completed application to:  
Kansas Department of Agriculture  
Division of Water Resources  
Field Office for your area.  
Call for address:

Topeka -- (785) 296-5733  
Stafford -- (620) 234-5311  
Stockton -- (785) 425-6787  
Garden City -- (620) 278-2901  
<http://agriculture.ks.gov/dwr>

### DWR FIELD OFFICE APPLICATION FOR APPROVAL TO CHANGE THE PLACE OF USE AND/OR THE POINT OF DIVERSION



STATE OF KANSAS

Filing Fee Must Accompany the Application, K.S.A. 82a-708b(b), as amended.  
Fee Schedule is on the third page of this application form.

Paragraph Nos. 1, 2, 3 & 5 must be completed. Complete all other applicable portions. If change in point of diversion is greater than 100 feet, or if place of use will be changed, include a topographic map or detailed plat showing the authorized and proposed point(s) of diversion and/or place of use.

RECEIVED  
2:31 pm  
JUL 09 2018

File No. 3838

Garden City Field Office  
Division of Water Resources

1. Application is hereby made for approval of the Chief Engineer to change the (check one or both):

Place of Use       Point of Diversion

under the water right which is the subject of this application in accordance with the conditions described below.

The source of supply is:       Groundwater       Surface water

2. Name and address of Applicant: Mike Bartlett  
12720 103 RD, Fowler, KS 67844-8702

Phone Number: ( )      Email address: \_\_\_\_\_

Name and address of Water Use Correspondent: Mike H & Carla J Bartlett  
12702 103 RD, Fowler, KS 67844-8702

Phone Number: ( )      Email address: \_\_\_\_\_

3. The presently authorized place of use is:

Owner of Land ---- NAME: SEE ATTACHMENT  
ADDRESS: SEE ATTACHMENT

(If there is more than one landowner, attach supplemental sheets as necessary.)

Sec.	Twp.	Range	NE¼				NW¼				SW¼				SE¼				TOTAL ACRES	
			NE¼	NW¼	SW¼	SE¼	NE¼	NW¼	SW¼	SE¼	NE¼	NW¼	SW¼	SE¼	NE¼	NW¼	SW¼	SE¼		

4. If this application is for a change in place of use, it is proposed that the place of use be changed to:

Owner of Land --- NAME: SEE ATTACHMENT  
ADDRESS: SEE ATTACHMENT

(If there is more than one landowner, attach supplemental sheets as necessary.)

Sec.	Twp.	Range	NE¼				NW¼				SW¼				SE¼				TOTAL ACRES	
			NE¼	NW¼	SW¼	SE¼	NE¼	NW¼	SW¼	SE¼	NE¼	NW¼	SW¼	SE¼	NE¼	NW¼	SW¼	SE¼		

For Office Use Only: Code \_\_\_\_\_ Fee \$ 200.00 TR # \_\_\_\_\_ Receipt Date 7-9-18 Check # 12439

5. **Presently authorized point of diversion:**  
 One in the \_\_\_\_\_ Quarter of the \_\_\_\_\_ Quarter of the \_\_\_\_\_ Quarter  
 of Section \_\_\_\_\_, Township \_\_\_\_\_ South, Range \_\_\_\_\_ (E/W),  
 in \_\_\_\_\_ County, Kansas, \_\_\_\_\_ feet North \_\_\_\_\_ feet West of Southeast corner of section.  
 Authorized Rate \_\_\_\_\_ Authorized Quantity \_\_\_\_\_ Depth of well \_\_\_\_\_ (feet)  
 (DWR use only: Computer ID No. \_\_\_\_\_ GPS \_\_\_\_\_ feet North \_\_\_\_\_ feet West)  
 This point will not be changed  This point will be changed as follows:  No change, point better described with GPS as follows:  
**Proposed point of diversion: (Complete only if change is requested or if existing point is better described by GPS)**  
 One in the \_\_\_\_\_ Quarter of the \_\_\_\_\_ Quarter of the \_\_\_\_\_ Quarter  
 of Section \_\_\_\_\_, Township \_\_\_\_\_ South, Range \_\_\_\_\_ (E/W),  
 in \_\_\_\_\_ County, Kansas, \_\_\_\_\_ feet North \_\_\_\_\_ feet West of Southeast corner of section.  
 Proposed Rate \_\_\_\_\_ Proposed Quantity \_\_\_\_\_ Proposed well depth (feet) \_\_\_\_\_  
 This point is:  Additional Well  Geo Center List other water rights that will use this point \_\_\_\_\_

6. **Presently authorized point of diversion:**  
 One in the \_\_\_\_\_ Quarter of the \_\_\_\_\_ Quarter of the \_\_\_\_\_ Quarter  
 of Section \_\_\_\_\_, Township \_\_\_\_\_ South, Range \_\_\_\_\_ (E/W),  
 in \_\_\_\_\_ County, Kansas, \_\_\_\_\_ feet North \_\_\_\_\_ feet West of Southeast corner of section.  
 Authorized Rate \_\_\_\_\_ Authorized Quantity \_\_\_\_\_ Depth of well \_\_\_\_\_ (feet)  
 (DWR use only: Computer ID No. \_\_\_\_\_ GPS \_\_\_\_\_ feet North \_\_\_\_\_ feet West)  
 This point will not be changed  This point will be changed as follows:  No change, point better described with GPS as follows:  
**Proposed point of diversion: (Complete only if change is requested or if existing point is better described by GPS)**  
 One in the \_\_\_\_\_ Quarter of the \_\_\_\_\_ Quarter of the \_\_\_\_\_ Quarter  
 of Section \_\_\_\_\_, Township \_\_\_\_\_ South, Range \_\_\_\_\_ (E/W),  
 in \_\_\_\_\_ County, Kansas, \_\_\_\_\_ feet North \_\_\_\_\_ feet West of Southeast corner of section.  
 Proposed Rate \_\_\_\_\_ Proposed Quantity \_\_\_\_\_ Proposed well depth (feet) \_\_\_\_\_  
 This point is:  Additional Well  Geo Center List other water rights that will use this point \_\_\_\_\_

7. The changes herein are desired for the following reasons?  
 (please be specific) NO PD CHANGE

8. If a well, is the test hole log attached?  Yes  No

9. The change(s) (was)(will be) completed by?  
 \_\_\_\_\_

10. If the point of diversion is a well:  
 (a) What are you going to do with the old well?  
 \_\_\_\_\_  
 (b) When will this be done? \_\_\_\_\_

11. Groundwater Management District recommendation attached?  
 Yes  No

12. Assisted by \_\_\_\_\_

13a. If the proposed point of diversion will be relocated more than 300 feet but within 2,640 feet of the existing point of diversion, attach a topographic map or aerial photograph. For groundwater sources, show all wells (including domestic) within one-half mile of the proposed point of diversion and the names and mailing addresses of the owners. For surface water sources, show the names and addresses of the landowner(s) one-half mile downstream and one-half mile upstream from your property lines

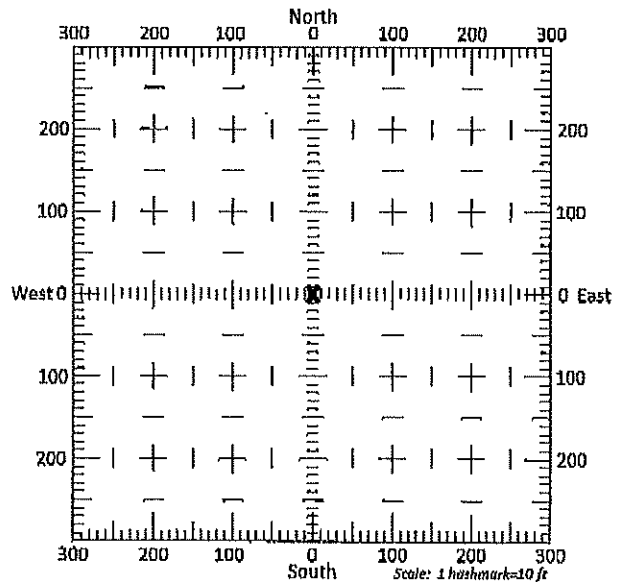

13b. If the proposed point of diversion will be relocated within 300 feet of the existing point of diversion, indicate its location on the diagram shown above in relation to the existing point of diversion. (PLEASE NOTE: The "X" in center of diagram above represents the presently authorized point of diversion.)

APPLICATION FOR APPROVAL TO CHANGE  
THE PLACE OF USE AND/OR POINT OF DIVERSION  
SUPPLEMENTAL SHEET  
**FILE NO. 3838**  
MAKE ADDITIONAL COPIES AS NECESSARY

3. *Continued:* The presently authorized place of use is:  
Owner of Land ---- NAME: Double B & S Cattle CO (Error- Never Took Ownership)  
ADDRESS: 10320 Wrangler RD, Fowler, KS 67844

Sec.	Twp.	Range	NE¼				NW¼				SW¼				SE¼				TOTAL ACRES
			NE¼	NW¼	SW¼	SE¼	NE¼	NW¼	SW¼	SE¼	NE¼	NW¼	SW¼	SE¼	NE¼	NW¼	SW¼	SE¼	
22	29	26	40	40	33	40													153

Owner of Land ---- NAME: D A & Jane A Bartlett  
ADDRESS: PO Box 42, Fowler, KS 67844

Sec.	Twp.	Range	NE¼				NW¼				SW¼				SE¼				TOTAL ACRES
			NE¼	NW¼	SW¼	SE¼	NE¼	NW¼	SW¼	SE¼	NE¼	NW¼	SW¼	SE¼	NE¼	NW¼	SW¼	SE¼	
22	29	26					2	14	40	22	33	40	40	40	35	40	30	40	376

Owner of Land ---- NAME: \_\_\_\_\_  
ADDRESS: \_\_\_\_\_

Sec.	Twp.	Range	NE¼				NW¼				SW¼				SE¼				TOTAL ACRES
			NE¼	NW¼	SW¼	SE¼	NE¼	NW¼	SW¼	SE¼	NE¼	NW¼	SW¼	SE¼	NE¼	NW¼	SW¼	SE¼	

4. *Continued:* If this application is for a change in place of use, it is proposed that the place of use be changed to:  
Owner of Land ---- NAME: Mike H & Carla Bartlett  
ADDRESS: 12720 103 RD, Fowler, KS 67844-8702

Sec.	Twp.	Range	NE¼				NW¼				SW¼				SE¼				TOTAL ACRES
			NE¼	NW¼	SW¼	SE¼	NE¼	NW¼	SW¼	SE¼	NE¼	NW¼	SW¼	SE¼	NE¼	NW¼	SW¼	SE¼	
22	29	26	40	40	33	40	2	14	40	32	36	40	40	40	35	40	31	31	534

Owner of Land ---- NAME: \_\_\_\_\_  
ADDRESS: \_\_\_\_\_

Sec.	Twp.	Range	NE¼				NW¼				SW¼				SE¼				TOTAL ACRES
			NE¼	NW¼	SW¼	SE¼	NE¼	NW¼	SW¼	SE¼	NE¼	NW¼	SW¼	SE¼	NE¼	NW¼	SW¼	SE¼	

Owner of Land ---- NAME: \_\_\_\_\_  
ADDRESS: \_\_\_\_\_

Sec.	Twp.	Range	NE¼				NW¼				SW¼				SE¼				TOTAL ACRES
			NE¼	NW¼	SW¼	SE¼	NE¼	NW¼	SW¼	SE¼	NE¼	NW¼	SW¼	SE¼	NE¼	NW¼	SW¼	SE¼	

14. If the proposed groundwater point of diversion is 300 or fewer feet from the existing point of diversion, complete the following:

- (a) Does the undersigned represent all owners of the currently authorized place(s) of use identified in this application?  
 Yes     No    (If no, all owners must sign this application.)
- (b) Will the ownership interest of any owner of the currently authorized place(s) of use identified in this application be adversely affected if this application is approved as requested?  
 Yes     No    (If yes, all owners must sign this application.)
- (c) If this application is not approved expeditiously, will there be substantial damage to property, public health or safety?  
 Yes     No    (If no, all owners must sign this application.)

If the application proposes a surface water change in point of diversion, a groundwater change in point of diversion greater than 300 feet, or a change in place of use, the application must be signed by all owners of the currently authorized place of use, or their duly authorized agent (attach notarized statement authorizing representation).

I hereby verify, being first duly sworn upon my oath or affirmation and under penalty of perjury, that I am of lawful age and the owner, the spouse of the owner, or a duly authorized agent of the owner(s) to make this application on their behalf, in regards to the water right(s) to which this application pertains. I further verify that the statements contained in this application are true, correct and complete.

Dated at Fowler, Kansas, this 9<sup>th</sup> day of July, 2018.

Mike H. Bartlett  
(Owner)

Carla Bartlett  
(Spouse)

MIKE H BARTLETT  
(Please Print)

CARLA BARTLETT  
(Please Print)

\_\_\_\_\_  
(Owner)

\_\_\_\_\_  
(Spouse)

\_\_\_\_\_  
(Please Print)

\_\_\_\_\_  
(Please Print)

\_\_\_\_\_  
(Owner)

\_\_\_\_\_  
(Spouse)

\_\_\_\_\_  
(Please Print)

\_\_\_\_\_  
(Please Print)

State of Kansas }  
County of Meade } SS



I hereby certify that the foregoing application was signed in my presence and sworn to before me this 9<sup>th</sup> day of July, 2018.

Dean Zortman  
Notary Public

My Commission Expires 4-30-19

**ONLY COMPLETE APPLICATIONS WILL BE PROCESSED.** To be complete, all of the applicable portions of the application form must be completed with accurate information; maps, if necessary, must be included; signatures of all the appropriate owners must be affixed to the application and notarized; and the appropriate fee must be paid.

**FEE SCHEDULE**

- Each application to change the place of use or the point of diversion under this section shall be accompanied by the application fee set forth in the schedule below: Make checks payable to: Kansas Department of Agriculture
- (1) Application to change a point of diversion 300 feet or less ..... \$100
  - (2) Application to change a point of diversion more than 300 feet ..... \$200
  - (3) Application to change the place of use ..... \$200



**SUMMARY ORDER APPROVING APPLICATION FOR CHANGE AND IMPOSING CONDITIONS**

This Summary Order is issued under authority of K.S.A. 82a-708b, as amended, and K.A.R. 5-5-1, *et seq.* and other applicable provisions of the *Kansas Water Appropriation Law, K.S.A. 82a-701 et. seq.*, and rules and regulations promulgated thereunder, With the exception of those conditions expressly contained herein, this Summary Order does not change the terms, conditions and limitations of File No. 3838.

1. A change application was received on July 9, 2018 requesting that the place of use and / or point of diversion authorized under the above-referenced file number be changed as described in the application.
2. On and after the effective date of this summary order, the authorized place(s) of use shall be located substantially as shown on the topographic map accompanying the application to change the place of use.  Applicable  Not Applicable
3. The change in point of diversion shall not impair existing rights and shall be limited to the same source or sources of water as previously authorized. The point of diversion authorized by this summary order shall be located within a \_\_\_\_\_ foot radius of the authorized point(s) of diversion.  Applicable  Not Applicable
4. The point(s) of diversion described herein is administratively corrected to be more accurately described using the Global Positioning System (GPS), as described in the application.  Applicable  Not Applicable
5. The point(s) of diversion authorized herein shall not actually be located more than \_\_\_\_\_ feet from the previously authorized point(s) of diversion.  Applicable  Not Applicable
6. As required by K.A.R. 5-3-5d, if the works for diversion is a well with a diversion rate of 100 gallons per minute or more, a tube or other device suitable for making water level measurements shall be installed, operated and maintained in accordance with K.A.R. 5-6-13.  Applicable  Not Applicable
7. The owner of the authorized place(s) of use shall properly install an acceptable water flow meter on or before December 31, 2018, or before the first use of water, whichever occurs first. The water flow meter shall be installed, operated and maintained in accordance with K.A.R. 5-1-4 through 5-1-12. As required by K.S.A. 82a-732, as amended, and K.A.R. 5-3-5e, the owner shall maintain records and report the reading of the water flow meter and the total quantity of water diverted annually to the Chief Engineer by March 1 following the end of each calendar year.  Applicable  Not Applicable
8. Installation of the works for diversion of water shall be completed on or before December 31, 20\_\_\_\_, or within any authorized extension of time. By March 1, 20\_\_\_\_ the applicant shall notify the Chief Engineer that construction of the works for diversion has been completed, on the form provided by the Chief Engineer, as required by K.A.R. 5-8-4e.  Applicable  Not Applicable
9. The completed well log shall be submitted with the required notice.  Applicable  Not Applicable
10. All diversion works into which any type of chemical or other foreign substance will be injected into the water shall be equipped with an in-line, automatic, quick-closing check valve capable of preventing pollution of the source of the water supply. The check valve(s) shall be installed, operated and maintained in accordance with K.A.R. 5-3-5c.  Applicable  Not Applicable
11. Additional Conditions are attached.  Yes  No
12. In accordance with K.S.A. 82a-708a, as amended, and K.A.R. 5-5-14, all of the owners of the authorized place(s) of use of water appropriated under the above-referenced file number are responsible for compliance with its terms, conditions and limitations, as amended and/or supplemented by this Summary Order, and with applicable provisions of the *Kansas Water Appropriation Law* and the *Rules and Regulations* promulgated thereunder. Failure to comply with these provisions may result in civil penalties pursuant to K.S.A. 82a-737, as amended, and/or the suspension or revocation and dismissal of the water or appropriation right or any other enforcement actions authorized by law.

**Administrative Appeal and Effective Date of Order**

If you are aggrieved by this order, pursuant to K.S.A. 82a-1901, you may request an evidentiary hearing before the Chief Engineer or request administrative review by the Secretary of Agriculture. A request for hearing by the Chief Engineer must be filed within 15 days of service of this Order and a request for administrative review by the Secretary must be filed within 30 days pursuant to K.S.A. 77-531. Any request for administrative review must state a basis for review pursuant to K.S.A. 77-527. File any request with Kansas Department of Agriculture, Legal Division, 1320 Research Park Drive, Manhattan, KS 66502. Failure to timely request a hearing or review may preclude review under the Kansas Judicial Review Act.

*For Use by Register of Deeds*

FOR OFFICE USE ONLY  
**APPLICATION APPROVED AND  
 SUMMARY ORDER ISSUED**

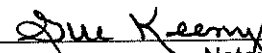
By:   
 Duly Authorized Designee of the Chief Engineer  
 (Print Name): Thomas P Makens  
 Division of Water Resources - Kansas Department of Agriculture  
 Date of Issuance: August 7, 2018  
 State of Kansas )  
 ) SS  
 County of Finnney )  
 Acknowledged before me on August 7, 2018  
 by Thomas P. Makens  
 Signature:   
 Notary Public

My commission expires:

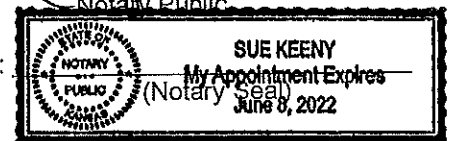

Jul. 3. 2018 1:34PM

# Change in Place of Use: WR 3,838

I agree to the best of my knowledge that all known water wells (IRR, DOM, IND, etc) are shown within green circles on map. If not, I have edited the map indicating the location of the well, type, & owner information.

Signature: *Walter H. R. [unclear]*

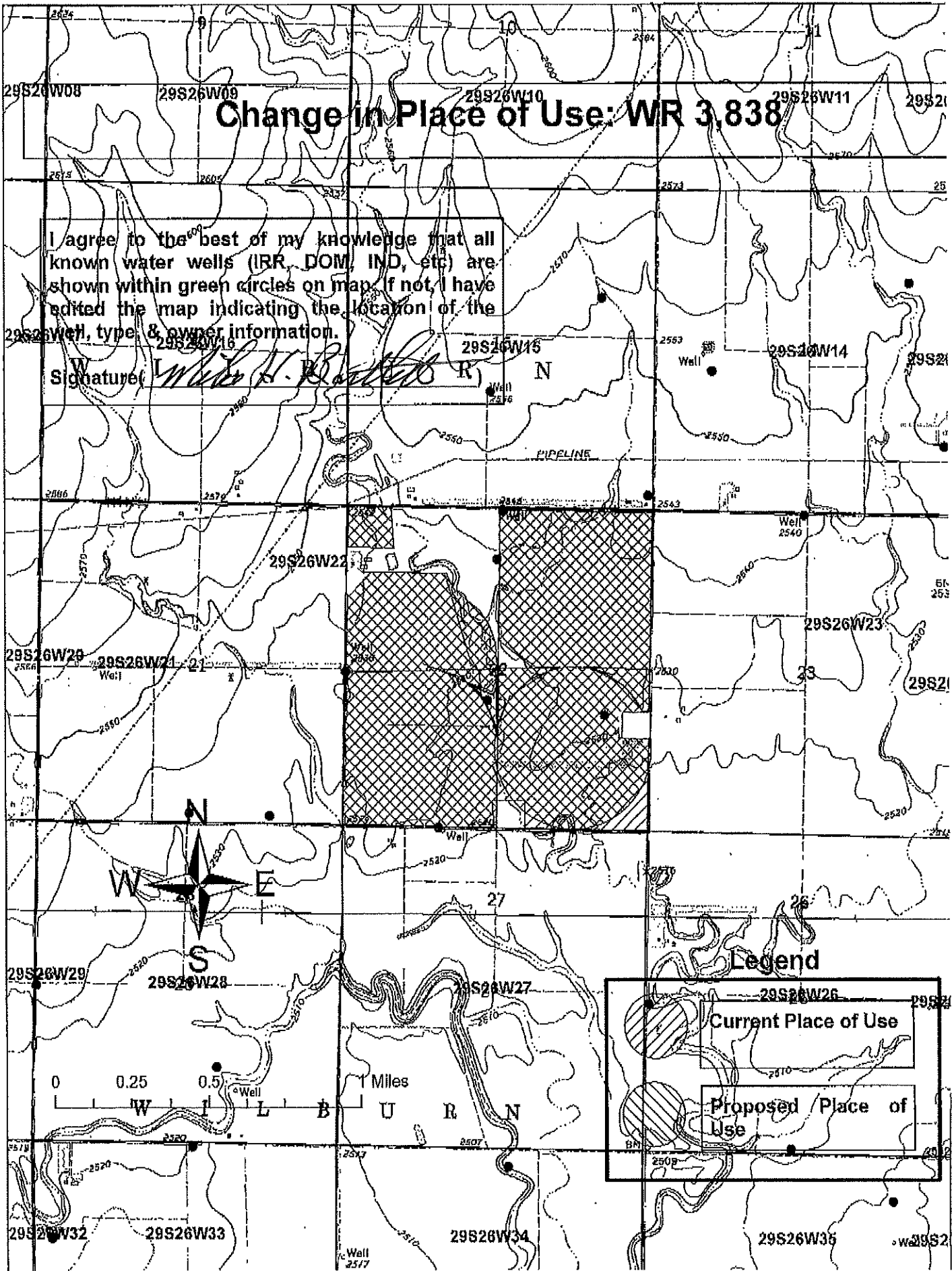

## Legend

	Current Place of Use
	Proposed Place of Use

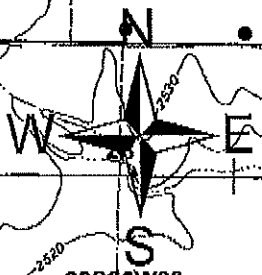
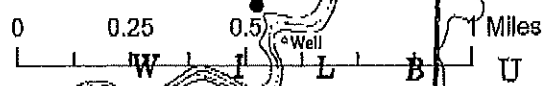

STATE OF KANSAS



DEPARTMENT OF AGRICULTURE  
DIVISION OF WATER RESOURCES  
GARDEN CITY FIELD OFFICE  
2508 JOHNS STREET  
GARDEN CITY, KS 67846-2804

PHONE: (620) 276-2901  
FAX: (620) 276-9315  
www.agriculture.ks.gov

GOVERNOR JEFF COLYER, M.D.  
JACKIE McCLASKEY, SECRETARY OF AGRICULTURE

July 27, 2018

Southwest Kansas Groundwater  
Management District No 3  
409 Campus Drive, Suite 106  
Garden City KS 67846

Re: Water Right file number 1050.3838 12561 27888

Dear Mr. Norquest;

Mike Bartlett has applied to alter the acres authorized due to existing pivot locations. The base acres are 524. There are 4 neighboring wells within ½ mile.

We are delaying action for 15 days on the change application to allow you time to review and provide a recommendation if you feel one is warranted. I have enclosed a copy of the change for your perusal.

Thank you and as always feel free to call or write us at any time.

Sincerely;

A handwritten signature in black ink, appearing to read "Thomas P Makens", written over a horizontal line.

Thomas P Makens

encs.



STATE OF KANSAS

DEPARTMENT OF AGRICULTURE  
1320 RESEARCH PARK DRIVE  
MANHATTAN, KS 66502  
PHONE: (785) 564-6700  
FAX: (785) 564-6777



900 SW JACKSON, ROOM 456  
TOPEKA, KS 66612  
PHONE: (785) 296-3556  
www.agriculture.ks.gov

GOVERNOR JEFF COLYER, M.D.  
JACKIE McCLASKEY, SECRETARY OF AGRICULTURE

July 10, 2018

Walter Goff  
12760 104 Road  
Fowler KS 67844

RE: Water Right 1050, 3838, 12561, 27888

Dear Mr. Goff:

This is to advise you that the Mike Bartlett has filed an application for approval of the Chief Engineer, Division of Water Resources, Kansas Department of Agriculture, to change the place of use under the above referenced application.

You are notified on this proposed change in place of use so that you may furnish this office with any comments or other information you may want to submit.

You can find the complete application posted by water right file number as referenced above at [www.agriculture.ks.gov/divisions-programs/dwr/water-appropriation/notices](http://www.agriculture.ks.gov/divisions-programs/dwr/water-appropriation/notices) Should you have any questions, please feel free to call this office. If you would prefer, an appointment could be arranged for additional assistance. Please refer to the file number when you contact us if you wish to discuss a specific file.

Sincerely,

A handwritten signature in black ink, appearing to read "Thomas P. Makens".

Thomas P. Makens  
Environmental Scientist III

pc: GMD#3

DEPARTMENT OF AGRICULTURE  
1320 RESEARCH PARK DRIVE  
MANHATTAN, KS 66502  
PHONE: (785) 564-6700  
FAX: (785) 564-6777

STATE OF KANSAS



900 SW JACKSON, ROOM 456  
TOPEKA, KS 66612  
PHONE: (785) 296-3556  
www.agriculture.ks.gov

GOVERNOR JEFF COLYER, M.D.  
JACKIE McCLASKEY, SECRETARY OF AGRICULTURE

July 10, 2018

Hugh Bartlett  
12720 104 Road  
Fowler KS 67844

RE: Water Right 1050, 3838, 12561, 27888

Dear Mr. Bartlett:

This is to advise you that the Mike Bartlett has filed an application for approval of the Chief Engineer, Division of Water Resources, Kansas Department of Agriculture, to change the place of use under the above referenced application.

You are notified on this proposed change in place of use so that you may furnish this office with any comments or other information you may want to submit.

You can find the complete application posted by water right file number as referenced above at [www.agriculture.ks.gov/divisions-programs/dwr/water-appropriation/notices](http://www.agriculture.ks.gov/divisions-programs/dwr/water-appropriation/notices) Should you have any questions, please feel free to call this office. If you would prefer, an appointment could be arranged for additional assistance. Please refer to the file number when you contact us if you wish to discuss a specific file.

Sincerely,

Thomas P. Makens  
Environmental Scientist III

pc: GMD#3

DEPARTMENT OF AGRICULTURE  
1320 RESEARCH PARK DRIVE  
MANHATTAN, KS 66502  
PHONE: (785) 564-6700  
FAX: (785) 564-6777

STATE OF KANSAS



900 SW JACKSON, ROOM 456  
TOPEKA, KS 66612  
PHONE: (785) 296-3556  
www.agriculture.ks.gov

GOVERNOR JEFF COLYER, M.D.  
JACKIE McCLASKEY, SECRETARY OF AGRICULTURE

July 10, 2018

DOUBLE H FARMS INC  
10905 WILDFIRE RD  
MINNEOLA KS 67865

RE: Water Right 1050, 3838, 12561, 27888

Dear Mr. Harshberger:

This is to advise you that the Mike Bartlett has filed an application for approval of the Chief Engineer, Division of Water Resources, Kansas Department of Agriculture, to change the place of use under the above referenced application.

You are notified on this proposed change in place of use so that you may furnish this office with any comments or other information you may want to submit.

You can find the complete application posted by water right file number as referenced above at [www.agriculture.ks.gov/divisions-programs/dwr/water-appropriation/notices](http://www.agriculture.ks.gov/divisions-programs/dwr/water-appropriation/notices) Should you have any questions, please feel free to call this office. If you would prefer, an appointment could be arranged for additional assistance. Please refer to the file number when you contact us if you wish to discuss a specific file.

Sincerely,

Thomas P. Makens  
Environmental Scientist III

pc: GMD#3

STATE OF KANSAS

DEPARTMENT OF AGRICULTURE  
1320 RESEARCH PARK DRIVE  
MANHATTAN, KS 66502  
PHONE: (785) 564-6700  
FAX: (785) 564-6777



900 SW JACKSON, ROOM 456  
TOPEKA, KS 66612  
PHONE: (785) 296-3556  
www.agriculture.ks.gov

GOVERNOR JEFF COLYER, M.D.  
JACKIE McCLASKEY, SECRETARY OF AGRICULTURE

July 10, 2018

LARRY J & ELIZABETH M STURGEON  
10320 WRANGLER RD  
FOWLER KS 67844-8707

RE: Water Right 1050, 3838, 12561, 27888

Dear Mr. & Mrs. Sturgeon:

This is to advise you that the Mike Bartlett has filed an application for approval of the Chief Engineer, Division of Water Resources, Kansas Department of Agriculture, to change the place of use under the above referenced application.

You are notified on this proposed change in place of use so that you may furnish this office with any comments or other information you may want to submit.

You can find the complete application posted by water right file number as referenced above at [www.agriculture.ks.gov/divisions-programs/dwr/water-appropriation/notices](http://www.agriculture.ks.gov/divisions-programs/dwr/water-appropriation/notices) Should you have any questions, please feel free to call this office. If you would prefer, an appointment could be arranged for additional assistance. Please refer to the file number when you contact us if you wish to discuss a specific file.

Sincerely,

A handwritten signature in black ink, appearing to read "Thomas P. Makens".

Thomas P. Makens  
Environmental Scientist III

pc: GMD#3



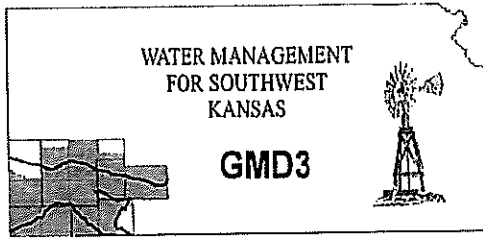

**Southwest Kansas**  
**Groundwater Management District No. 3**  
2009 E. Spruce Street  
Garden City, Kansas 67846  
(620) 275-7147 phone (620) 275-1431 fax  
www.gmd3.org

August 1, 2018

Thomas P. Makens  
Division of Water Resources  
2508 N Johns Street  
Garden City, Kansas 67846

RECEIVED

AUG 2 2018

RE: Applications for Change in Place of Use  
Water Rights, File Nos. 1050, 3838, 12561 & 27888

Garden City Field Office  
Division of Water Resources

Dear Thomas:

We have completed a review of the applications for the above referenced water rights. The proposals are not in conflict with the Management Program of the Southwest Kansas Groundwater Management District No. 3 (GMD3). The proposed change in place of use, to shuffle some of the acres in the corners of the quarters, which will increase the acres by 10 acres over base and maintain a complete overlap in place of use, is in accordance with K.A.R. 5-5-11. It is therefore recommended that the applications be approved at this time.

Thank you for the opportunity to review the applications and to provide a recommendation. If you have any questions, please don't hesitate to contact us.

Sincerely,

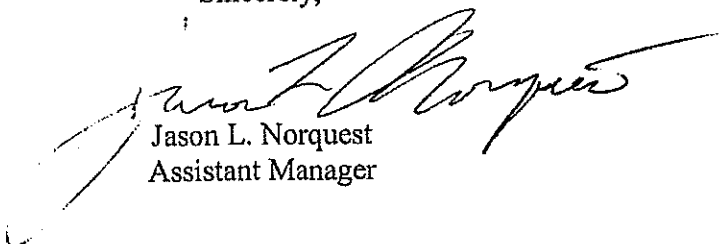

Jason L. Norquest  
Assistant Manager

# GMD3 Change Review

File No(s): 1050, 3838, 12561 & 27888.

DWR office: GC.

App filed to change: PU.

Is Landowner(s) correct in WRIS: Yes.

If NO, is documentation included?

Is Water Use Correspondent correct in WRIS? \_\_\_.

If NO, is documentation included?

Regulation(s) Reviewed: KAR 5-5-11

Point of diversion ID No(s) NA being changed.

RECEIVED

AUG 2 2018

Garden City Field Office  
Division of Water Resources

	ft. North	ft. West	
Authorized PD			
Proposed PD			
Difference	0	0	
a2 + b2 = c2	0	0	0

GPS for proposed PD: Lat: \_\_\_ Long: \_\_\_.

Is proposed PD stacking on existing WRs? \_\_\_.

Is Proposed PU overlapping existing WRs? \_\_\_.

Land Owner(s) notified: Yes.

Name \_\_\_.

Name \_\_\_.

Address \_\_\_.

Address \_\_\_.

Zip \_\_\_.

Zip \_\_\_.

Neighboring certified well(s) notified: Yes (attached to the applications).

Name \_\_\_.

Name \_\_\_.

Address \_\_\_.

Address \_\_\_.

Zip \_\_\_.

Zip \_\_\_.

Domestic well(s) notified: \_\_\_.

Name \_\_\_.

Name \_\_\_.

Address \_\_\_.

Address \_\_\_.

Zip \_\_\_.

Zip \_\_\_.

Base Acres: 524 (Agree with Thom).

Perfected Acres: \_\_\_.

Irr. Return-Flow \_\_\_%

**Current acres: 529**

**Proposed acres: 534 (10 more than base)**

**WR 27888 brings in limitation of 889AF when combined with all WRs**

Is a waiver needed: No.

Final Recommendation: After review of all available information, it appears the current area rules are met. Staff therefore recommends approval of the applications.



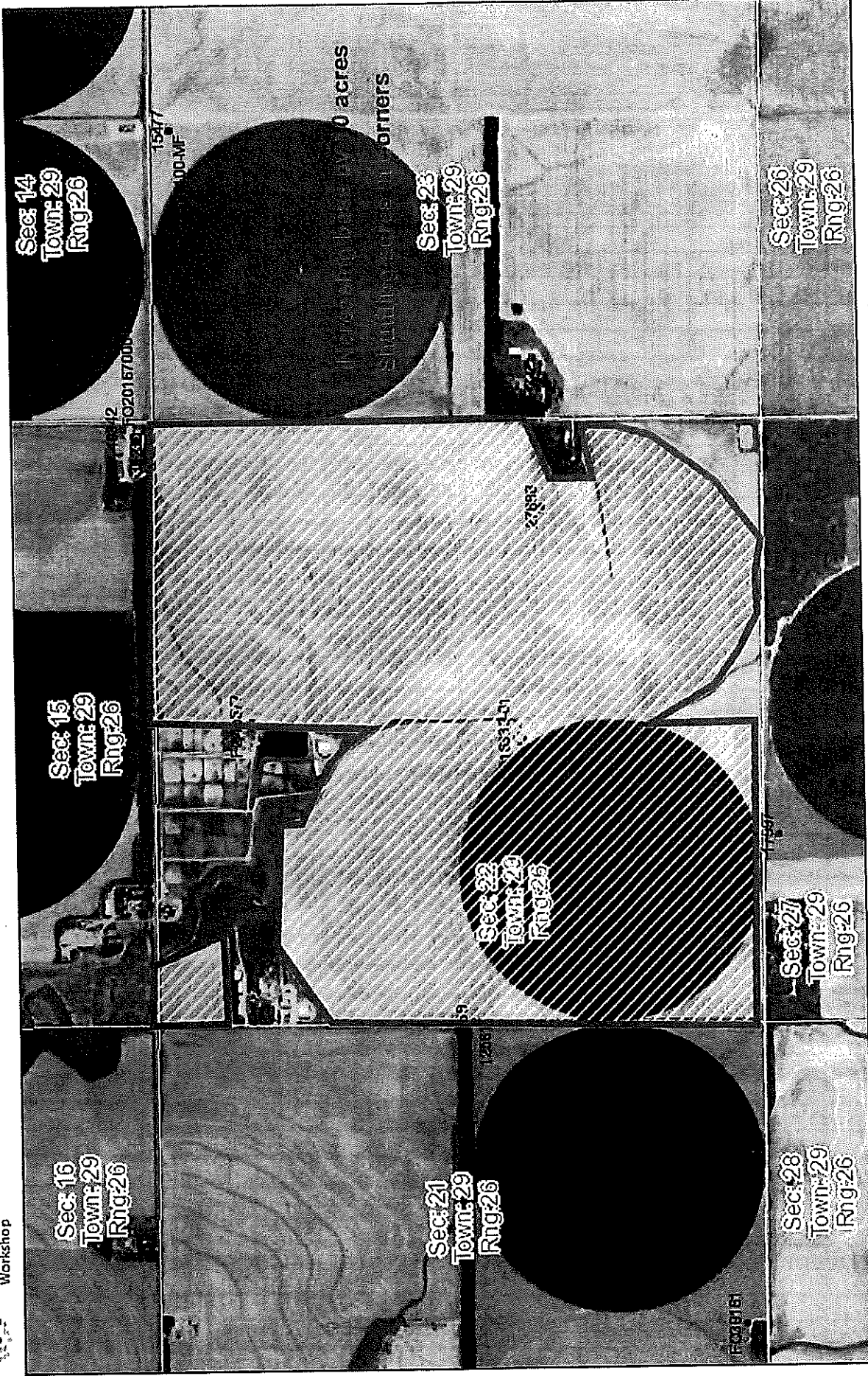

August 1, 2018 09:41 AM  
 DISCLAIMER: This map is not intended for conveyances, nor is it a legal survey. The information is presented on a best-efforts basis, and should not be relied upon for making financial, survey, legal or other commitments. **RECEIVED**

Wells: ? Other ? IRR • + CON ☒ DEW ⚡ DOM ★ FPR ⚡ HYD ⚡ IND ⚡ STK ? REC ? Empty THX  
 Sections:

AUG 2 2018  
 Garden City Field Office  
 Division of Water Resources

Jason  
 GIS Workshop, LLC.

524 acres Base

RECEIVED

APPLICATION FOR APPROVAL TO CHANGE  
THE PLACE OF USE AND/OR POINT OF DIVERSION  
SUPPLEMENTAL SHEET

AUG 2 2018

FILE NO. 1050

MAKE ADDITIONAL COPIES AS NECESSARY

Garden City Field Office  
Division of Water Resources

3. Continued: The presently authorized place of use is:

Owner of Land --- NAME: Double B & S Cattle CO (Error- Never Took Ownership)  
ADDRESS: 10320 Wrangler RD, Fowler, KS 67844

Sec.	Twp.	Range	NE¼				NW¼				SW¼				SE¼				TOTAL ACRES
			NE¼	NW¼	SW¼	SE¼	NE¼	NW¼	SW¼	SE¼	NE¼	NW¼	SW¼	SE¼	NE¼	NW¼	SW¼	SE¼	
22	29	26	40	40	33	40													153

Owner of Land --- NAME: D A & Jane A Bartlett  
ADDRESS: PO Box 42, Fowler, KS 67844

Sec.	Twp.	Range	NE¼				NW¼				SW¼				SE¼				TOTAL ACRES
			NE¼	NW¼	SW¼	SE¼	NE¼	NW¼	SW¼	SE¼	NE¼	NW¼	SW¼	SE¼	NE¼	NW¼	SW¼	SE¼	
22	29	26					2	14	40	22	33	40	40	40	35	40	30	40	376

524 Total

Owner of Land --- NAME: \_\_\_\_\_  
ADDRESS: \_\_\_\_\_

Sec.	Twp.	Range	NE¼				NW¼				SW¼				SE¼				TOTAL ACRES
			NE¼	NW¼	SW¼	SE¼	NE¼	NW¼	SW¼	SE¼	NE¼	NW¼	SW¼	SE¼	NE¼	NW¼	SW¼	SE¼	

4. Continued: If this application is for a change in place of use, it is proposed that the place of use be changed to:

Owner of Land --- NAME: Mike H & Carla Bartlett  
ADDRESS: 12720 103 RD, Fowler, KS 67844-8702

Sec.	Twp.	Range	NE¼				NW¼				SW¼				SE¼				TOTAL ACRES
			NE¼	NW¼	SW¼	SE¼	NE¼	NW¼	SW¼	SE¼	NE¼	NW¼	SW¼	SE¼	NE¼	NW¼	SW¼	SE¼	
22	29	26	40	40	33	40	2	14	40	32	36	40	40	40	35	40	31	31	534
			-	-	-	-	-	-	-	70	73	-	-	-	-	-	71	79	75

Owner of Land --- NAME: \_\_\_\_\_  
ADDRESS: \_\_\_\_\_

Sec.	Twp.	Range	NE¼				NW¼				SW¼				SE¼				TOTAL ACRES
			NE¼	NW¼	SW¼	SE¼	NE¼	NW¼	SW¼	SE¼	NE¼	NW¼	SW¼	SE¼	NE¼	NW¼	SW¼	SE¼	

Owner of Land --- NAME: \_\_\_\_\_  
ADDRESS: \_\_\_\_\_

Sec.	Twp.	Range	NE¼				NW¼				SW¼				SE¼				TOTAL ACRES
			NE¼	NW¼	SW¼	SE¼	NE¼	NW¼	SW¼	SE¼	NE¼	NW¼	SW¼	SE¼	NE¼	NW¼	SW¼	SE¼	

1994 - Pw Change

1050	320 AF	160-275
3838	200 AF	220-308
12561	197 AF	Report on 3838
27888	250 AF	90-202

1500gpm w/3838

889 AF with  
above 3wks

889 AF Limit for all

RECEIVED

AUG 2 2018

Garden City Field Office  
Division of Water Resources

