

Kansas Department of Agriculture
 Division of Water Resources
CHANGE: P/D WORKSHEET

1. File Number: 4094	2. Status Change Date: 7/3/18	3. Change Num: C1	4. Field Office: 04	5. GMD: 03
--------------------------------	---	-----------------------------	-------------------------------	----------------------

6. Status: <input checked="" type="checkbox"/> Approved <input type="checkbox"/> Denied by DWR/GMD <input type="checkbox"/> Dismiss by Request/Failure to Return	7. Filing Date of Change: 6/4/18
--	--

8a. Applicant(s) New to system <input type="checkbox"/> MAX AMERIN TRUST PO BOX 67 PLAINS KS 67869-0087	8c. Landowner(s) New to system <input type="checkbox"/> Person ID <u>60007</u> Add Seq# <u>1</u>
--	---

8b. Landowner(s) New to system <input type="checkbox"/> NC	8d. WUC New to system <input type="checkbox"/> nc
---	--

9. Documents and Enclosure(s): DWR Meter(s) Date to Comply: 12/31/18 N & P Date to Comply: 12/31/18

Anti-Reverse Meter Meter Seal Check Valve N & P Form Water Tube Driller Copy H & E Letter
 Conservation Plan Date Required: _____ Date Approved: _____ Date to Comply: _____

10. Use Made of Water From: _____ To: _____

Date Prepared: **6/21/18** By: **TPM**
 Date Entered: _____ By: _____

File No. **4094** 11. County: **ME** Basin: **crooked** Stream: Formation Code: **211** Special Use:

12. Points of Diversion
 CHK
 MOD
 DEL PDIV
 ENT
 Qualifier S T R ID 'N 'W Comment (AKA Line) Rate gpm/cfs Quantity af/mgy Rate gpm/cfs Quantity af/mgy Overlap PD Files
 Rate and Quantity Authorized Additional
 ent nw se se 17 31 30w 991 855
 del 49929

13. Storage: Rate _____ NF _____ Quantity _____ ac/ft Additional Rate _____ NF _____ Additional Quantity _____ ac/ft

14. Limitation: _____ af/yr at _____ gpm (_____ cfs) when combined with file number(s) _____
 Limitation: _____ af/yr at _____ gpm (_____ cfs) when combined with file number(s) _____

15. 5YR Allocation: Allocation Type _____ Start Year _____ 5 YR Amount _____ Amount Unit _____ Base Acres _____ Comment _____

16. Place of Use CHK MOD DEL ENT	P U S E	S T R I D	NE 1/4			NW 1/4			SW 1/4			SE 1/4			Total	Owner	Chg?	Overlap Files
			NE 1/4	SW 1/4	SE 1/4	NW 1/4	SW 1/4	SE 1/4	NE 1/4	SW 1/4	SE 1/4	NW 1/4	SW 1/4	SE 1/4				
NC																		

Base Acres: _____ Year: _____ Minimum Reasonable Quantity: _____
 Comments: _____

STATE OF KANSAS



PHONE: (620) 276-2901
FAX: (620) 276-9315
www.agriculture.ks.gov

DEPARTMENT OF AGRICULTURE
DIVISION OF WATER RESOURCES
GARDEN CITY FIELD OFFICE
2508 JOHNS STREET
GARDEN CITY, KS 67846-2804

GOVERNOR JEFF COLYER, M.D.
JACKIE McCLASKEY, SECRETARY OF AGRICULTURE

July 3, 2018

MAX AMERIN
PO BOX 67
PLAINS KS 67869-0087

RE: Change in Point of Diversion Water Right, File No 4094 14708 &
40323

Dear Mr. Amerin;

Enclosed you will find a *Summary Order Approving Application for Change in Points of Diversion* for the above referenced file. This order modifies the authorized well location under the referenced file. This order modifies the original document; it should be recorded at the County Register of Deeds.

Your attention is directed to the enclosures and to the terms, conditions, and limitations specified in this order. The diversion works should be completed and reported to the Division of Water Resources by **December 31, 2018**. Enclosed is a form for this purpose, along with other information for reference.

A condition of this order is that an acceptable flow meter must be properly installed on the diversion works authorized under the referenced file number in accordance with the Kansas Administrative Regulations 5-1-4 through 5-1-12. This water flow meter shall be used to provide information required on the annual water use report.

This order shall become final if a request for a hearing is not filed with the Chief Engineer within 15 days of the date of service of this order. The date of service is the date listed on the enclosed *Certificate of Service*.

Should you have any questions, please feel free to call this office. If you would prefer, you could arrange an appointment for additional assistance.

Sincerely,

Thomas P. Makens
Assistant Water Commissioner

TPM:tpm
Enclosures
GMD#3

CERTIFICATE OF SERVICE

On this 5th day of July 2018, I hereby certify that the attached original Approval of Application to Change the Point of Diversion under Water Right, File No. 4094 14708 & 40323 dated July 3, 2018 was mailed postage prepaid, first class, US mail to the following:

MAX AMERIN TRUST
PO BOX 67
PLAINS KS 67869-0087

Copy provided to GMD#3



Division of Water Resources

Submit completed application to:
 Kansas Department of Agriculture
 Division of Water Resources
 Field Office for your area.

Call for address:
 Topeka -- (785) 296-5733
 Stafford -- (620) 234-5311
 Stockton -- (785) 425-6787
 Garden City -- (620) 276-2901
<http://agriculture.ks.gov/dwr>

DWR FIELD OFFICE APPLICATION FOR APPROVAL TO CHANGE THE PLACE OF USE AND/OR THE POINT OF DIVERSION



STATE OF KANSAS

Filing Fee Must Accompany the Application, K.S.A. 82a-708b(b), as amended.
 Fee Schedule is on the third page of this application form.

Paragraph Nos. 1, 2, 3 & 5 must be completed. Complete all other applicable portions. If change in point of diversion is greater than 100 feet, or if place of use will be changed, include a topographic map or detailed plat showing the authorized and proposed point(s) of diversion and/or place of use.

File No. 4094

RECEIVED
 4:47pm
 JUN 04 2018

1. Application is hereby made for approval of the Chief Engineer to change the (check one or both):
 Place of Use Point of Diversion Garden City Field Office
 under the water right which is the subject of this application in accordance with the conditions described in the Division of Water Resources
 The source of supply is: Groundwater Surface water

2. Name and address of Applicant: MAX AMERIN TRUST
PO BOX 67 PLAINS KS 67869-0087
 Phone Number: () _____ Email address: _____
 Name and address of Water Use Correspondent: MAX AMERIN TRUST
PO BOX 67 PLAINS KS 67869-0087
 Phone Number: () _____ Email address: _____

3. The presently authorized place of use is:
 Owner of Land --- NAME: WILEY E & MARI LEA ZIMMERMAN
 ADDRESS: _____
 (If there is more than one landowner, attach supplemental sheets as necessary.)

Sec.	Twp.	Range	NE¼				NW¼				SW¼				SE¼				TOTAL ACRES		
			NE¼	NW¼	SW¼	SE¼	NE¼	NW¼	SW¼	SE¼	NE¼	NW¼	SW¼	SE¼	NE¼	NW¼	SW¼	SE¼			

4. If this application is for a change in place of use, it is proposed that the place of use be changed to:
 Owner of Land --- NAME: no change to acres irrigated
 ADDRESS: _____
 (If there is more than one landowner, attach supplemental sheets as necessary.)

Sec.	Twp.	Range	NE¼				NW¼				SW¼				SE¼				TOTAL ACRES			
			NE¼	NW¼	SW¼	SE¼	NE¼	NW¼	SW¼	SE¼	NE¼	NW¼	SW¼	SE¼	NE¼	NW¼	SW¼	SE¼				

For Office Use Only: Code _____ Fee \$ 100 TR # _____ Receipt Date 6/4/18 Check # 3997

5. **Presently authorized point of diversion:**
 One in the _____ nw _____ Quarter of the _____ se _____ Quarter of the _____ se _____ Quarter
 of Section _____ 17 _____, Township _____ 31 _____ South, Range _____ 30 _____ W,
 in Meade County, Kansas, _____ 975 _____ feet North _____ 1100 _____ feet West of Southeast corner of section.
 Authorized Rate _____ Authorized Quantity _____ Depth of well _____ (feet)
 (DWR use only: Computer ID No. 1 GPS _____ feet North _____ feet West)
 This point will not be changed This point will be changed as follows: No change, point better described with GPS as follows:
Proposed point of diversion: (Complete only if change is requested or if existing point is better described by GPS)
 One in the _____ nw _____ Quarter of the _____ se _____ Quarter of the _____ se _____ Quarter
 of Section _____ 17 _____, Township _____ 31 _____ South, Range _____ 30 _____ W,
 in Meade County, Kansas, _____ 991 _____ feet North _____ 855 _____ feet West of Southeast corner of section.
 Proposed Rate _____ Proposed Quantity _____ Proposed well depth (feet) _____
 This point is: Additional Well Geo Center List other water rights that will use this point _____

RECEIVED

6. **Presently authorized point of diversion:**
 One in the _____ Quarter of the _____ Quarter of the JUN 04 2018 Quarter
 of Section _____, Township _____ South, Range _____ (EW),
 in _____ County, Kansas, _____ feet North _____ feet West of Southeast corner of section.
 Authorized Rate _____ Authorized Quantity _____ Depth of well _____ (feet)
 (DWR use only: Computer ID No. _____ GPS _____ feet North _____ feet West)
 This point will not be changed This point will be changed as follows: No change, point better described with GPS as follows:
Proposed point of diversion: (Complete only if change is requested or if existing point is better described by GPS)
 One in the _____ Quarter of the _____ Quarter of the _____ Quarter
 of Section _____, Township _____ South, Range _____ (EW),
 in _____ County, Kansas, _____ feet North _____ feet West of Southeast corner of section.
 Proposed Rate _____ Proposed Quantity _____ Proposed well depth (feet) _____
 This point is: Additional Well Geo Center List other water rights that will use this point _____

Garden City Field Office
 Division of Water Resources

7. The changes herein are desired for the following reasons?
 (please be specific) _____
 old well needs to be replaced

8. If a well, is the test hole log attached? Yes No

9. The change(s) (was)(will be) completed by?
June 1, 2018

10. If the point of diversion is a well:
 (a) What are you going to do with the old well?
plug
 (b) When will this be done? 2018

11. Groundwater Management District recommendation attached?
 Yes No

12. Assisted by tom

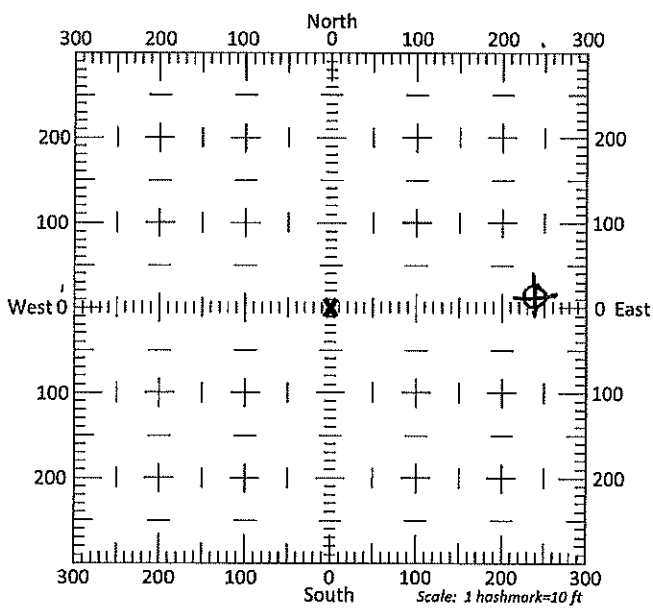

13a. If the proposed point of diversion will be relocated more than 300 feet but within 2,640 feet of the existing point of diversion, attach a topographic map or aerial photograph. For groundwater sources, show all wells (including domestic) within one-half mile of the proposed point of diversion and the names and mailing addresses of the owners. For surface water sources, show the names and addresses of the landowner(s) one-half mile downstream and one-half mile upstream from your property lines

13b. If the proposed point of diversion will be relocated within 300 feet of the existing point of diversion, indicate its location on the diagram shown above in relation to the existing point of diversion. (PLEASE NOTE: The "X" in center of diagram above represents the presently authorized point of diversion.)

14. If the proposed groundwater point of diversion is 300 or fewer feet from the existing point of diversion, complete the following:

- (a) Does the undersigned represent all owners of the currently authorized place(s) of use identified in this application?
 Yes No (If no, all owners must sign this application.)
- (b) Will the ownership interest of any owner of the currently authorized place(s) of use identified in this application be adversely affected if this application is approved as requested?
 Yes No (If yes, all owners must sign this application.)
- (c) If this application is not approved expeditiously, will there be substantial damage to property, public health or safety?
 Yes No (If no, all owners must sign this application.)

RECEIVED

JUN 04 2018

Garden City Field Office
Division of Water Resources

If the application proposes a surface water change in point of diversion, a groundwater change in point of diversion greater than 300 feet, or a change in place of use, the application must be signed by all owners of the currently authorized place of use, or their duly authorized agent (attach notarized statement authorizing representation).

I hereby verify, being first duly sworn upon my oath or affirmation and under penalty of perjury, that I am of lawful age and the owner, the spouse of the owner, or a duly authorized agent of the owner(s) to make this application on their behalf, in regards to the water right(s) to which this application pertains. I further verify that the statements contained in this application are true, correct and complete.

Dated at Plains, Kansas, this 31st day of May, 2018.

Max Amis Trust
 (Owner)
Max Amis Trust
 (Please Print)

 (Owner)

 (Please Print)

 (Owner)

 (Please Print)

 (Spouse)

 (Please Print)

 (Spouse)

 (Please Print)

 (Spouse)

 (Please Print)

State of Kansas }
County of Meade } SS

I hereby certify that the foregoing application was signed in my presence and sworn to before me this 31st day of May, 2018.

ANITA EVANS
 Notary Public - State of Kansas
 My Comm. Expires 12-09-2019

Anita Evans
 Notary Public

ONLY COMPLETE APPLICATIONS WILL BE PROCESSED. To be complete, all of the applicable portions of the application form must be completed with accurate information; maps, if necessary, must be included; signatures of all the appropriate owners' must be affixed to the application and notarized; and the appropriate fee must be paid.

FEE SCHEDULE

Each application to change the place of use or the point of diversion under this section shall be accompanied by the application fee set forth in the schedule below: Make checks payable to: **Kansas Department of Agriculture**

- (1) Application to change a point of diversion 300 feet or less **\$100**
- (2) Application to change a point of diversion more than 300 feet **\$200**
- (3) Application to change the place of use **\$200**

SUMMARY ORDER APPROVING APPLICATION FOR CHANGE AND IMPOSING CONDITIONS

This Summary Order is issued under authority of K.S.A. 82a-708b, as amended, and K.A.R. 5-5-1, *et seq.* and other applicable provisions of the *Kansas Water Appropriation Law, K.S.A. 82a-701 et seq.*, and rules and regulations promulgated thereunder, With the exception of those conditions expressly contained herein, this Summary Order does not change the terms, conditions and limitations of File No. 4094

1. A change application was received on JUNE 4, 2018 requesting that the place of use and / or point of diversion authorized under the above-referenced file number be changed as described in the application.
2. On and after the effective date of this summary order, the authorized place(s) of use shall be located substantially as shown on the topographic map accompanying the application to change the place of use. Applicable Not Applicable
3. The change in point of diversion shall not impair existing rights and shall be limited to the same source or sources of water as previously authorized. The point of diversion authorized by this summary order shall be located within a 50 foot radius of the authorized point(s) of diversion. Applicable Not Applicable
4. The point(s) of diversion described herein is administratively corrected to be more accurately described using the Global Positioning System (GPS), as described in the application. Applicable Not Applicable
5. The point(s) of diversion authorized herein shall not actually be located more than _____ feet from the previously authorized point(s) of diversion. Applicable Not Applicable
6. As required by K.A.R. 5-3-5d, if the works for diversion is a well with a diversion rate of 100 gallons per minute or more, a tube or other device suitable for making water level measurements shall be installed, operated and maintained in accordance with K.A.R. 5-6-13. Applicable Not Applicable
7. The owner of the authorized place(s) of use shall properly install an acceptable water flow meter on or before **December 31, 2018**, or before the first use of water, whichever occurs first. The water flow meter shall be installed, operated and maintained in accordance with K.A.R. 5-1-4 through 5-1-12. As required by K.S.A. 82a-732, as amended, and K.A.R. 5-3-5e, the owner shall maintain records and report the reading of the water flow meter and the total quantity of water diverted annually to the Chief Engineer by March 1 following the end of each calendar year. Applicable Not Applicable
8. Installation of the works for diversion of water shall be completed on or before **December 31, 2018**, or within any authorized extension of time. By March 1, 2019 the applicant shall notify the Chief Engineer that construction of the works for diversion has been completed, on the form provided by the Chief Engineer, as required by K.A.R. 5-8-4e. Applicable Not Applicable
9. The completed well log shall be submitted with the required notice. Applicable Not Applicable
10. All diversion works into which any type of chemical or other foreign substance will be injected into the water shall be equipped with an in-line, automatic, quick-closing check valve capable of preventing pollution of the source of the water supply. The check valve(s) shall be installed, operated and maintained in accordance with K.A.R. 5-3-5c. Applicable Not Applicable
11. Additional Conditions are attached. Yes No
12. In accordance with K.S.A. 82a-708a, as amended, and K.A.R. 5-5-14, all of the owners of the authorized place(s) of use of water appropriated under the above-referenced file number are responsible for compliance with its terms, conditions and limitations, as amended and/or supplemented by this Summary Order, and with applicable provisions of the *Kansas Water Appropriation Law* and the *Rules and Regulations* promulgated thereunder. Failure to comply with these provisions may result in civil penalties pursuant to K.S.A. 82a-737, as amended, and/or the suspension or revocation and dismissal of the water or appropriation right or any other enforcement actions authorized by law.

Administrative Appeal and Effective Date of Order

If you are aggrieved by this order, pursuant to K.S.A. 82a-1901, you may request an evidentiary hearing before the Chief Engineer or request administrative review by the Secretary of Agriculture. A request for hearing by the Chief Engineer must be filed within **15 days** of service of this Order and a request for administrative review by the Secretary must be filed within **30 days** pursuant to K.S.A. 77-531. Any request for administrative review must state a basis for review pursuant to K.S.A. 77-527. File any request with **Kansas Department of Agriculture, Legal Division, 1320 Research Park Drive, Manhattan, KS 66502**. Failure to timely request a hearing or review may preclude review under the Kansas Judicial Review Act.

For Use by Register of Deeds

FOR OFFICE USE ONLY
**APPLICATION APPROVED AND
SUMMARY ORDER ISSUED**

By: [Signature]
Duly Authorized Designee of the Chief Engineer

(Print Name): THOMAS P. MAKENS
Division of Water Resources - Kansas Department of Agriculture

Date of Issuance: JULY 3, 2018

State of Kansas)

County of Jinney) SS

Acknowledged before me on July 3, 2018

by Thomas P. Makens

Signature: [Signature]

My commission expires: _____

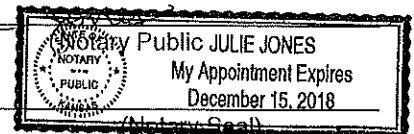

Elite Irrigation & Drilling

Ag/Domestic/Municipal
PO Box 1318
Liberal, KS 67901



Jimi Walters
620-482-5157

Tyler Palmer
580-716-8758

RR2 Box 284G Turpin, OK 73951

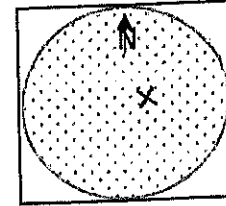

Customer Max Amerme #1 Date 5-08-18
 Address Box 67 Test # 1 E-Log 1
 City/State/Zip Pains, KS, 67869 Driller Tyler
 County Wood Quarter NWSESE Section 17 Township 31S Range 30W
 Location GPS: 37.3467; -100.6011 # 4094, 14708, 40323

RECEIVED

FOOTAGE			Description of Strata
From	Pay	To	
0	-	6	top soil
6	-	100	clay sand mix
100	-	170	gravel streaks of clay
170	150	356	medium sand
356	26	400	Blue shale / coarse sand mix
400	10	420	sandy clay
420	50	470	fine medium sand
470	10	490	sandy clay
490	-	500	red bed
			TD: 500
			Pay: 246'

MAY 18 2018

Garden City Field Office
Division of Water Resources

FOOTAGE

