

STATE OF KANSAS

DEPARTMENT OF AGRICULTURE
1320 RESEARCH PARK DRIVE
MANHATTAN, KS 66502
PHONE: (785) 564-6700
FAX: (785) 564-6777



900 SW JACKSON, ROOM 456
TOPEKA, KS 66612
PHONE: (785) 296-3556
www.agriculture.ks.gov

GOVERNOR JEFF COLYER, M.D.
JACKIE McCLASKEY, SECRETARY OF AGRICULTURE

April 4, 2018

LANDON KOEHN
1050 E COUNTY RD E
MARIENTHAL KS 67863

RE: Water Right file no. 8307 8308 10323 11161 15283 29985 39752

This is to advise you that the Eclipse Inc has filed an application for approval of the Chief Engineer, Division of Water Resources, Kansas Department of Agriculture, to change the place of use under the above referenced application.

You are notified on this proposed change in place of use so that you may furnish this office with any comments or other information you may want to submit.

You can find the complete application posted by water right file number as referenced above at www.agriculture.ks.gov/divisions-programs/dwr/water-appropriation/notices Should you have any questions, please feel free to call this office. If you would prefer, an appointment could be arranged for additional assistance. Please refer to the file number when you contact us if you wish to discuss a specific file.

Sincerely,

A handwritten signature in black ink, appearing to read "Thomas P. Makens".

Thomas P. Makens
Environmental Scientist III

pc: GMD#1

Submit completed application to:
 Kansas Department of Agriculture
 Division of Water Resources
 Field Office for your area.

Call for address:
 Topeka -- (785) 862-6300
 Stafford -- (620) 234-5311
 Stockton -- (785) 425-6787
 Garden City -- (620) 276-2901
www.ksda.gov/dwr

DWR FIELD OFFICE APPLICATION FOR APPROVAL TO CHANGE THE PLACE OF USE AND/OR THE POINT OF DIVERSION



STATE OF KANSAS

Filing Fee Must Accompany the Application, K.S.A. 82a-708b(b), as amended.
 Fee Schedule is on the third page of this application form.

Paragraph Nos. 1, 2, 3 & 5 must be completed. Complete all other applicable portions. If change in point of diversion is greater than 100 feet, or if place of use will be changed, include a topographic map or detailed plat showing the authorized and proposed point(s) of diversion and/or place of use.

RECEIVED

APR 2 2018
 4:12 pm
 Garden City Field Office
 Division of Water Resources

File No. 8308

1. Application is hereby made for approval of the Chief Engineer to change the (check one or both):

Place of Use Point of Diversion

under the water right which is the subject of this application in accordance with the conditions described below.

The source of supply is: Groundwater Surface water

2. Name and address of Applicant: ECLIPSE INC, A BRADFORD SMITH

~~695 KANSAS HWY 27, SHARON SPRINGS KS 67758-6029~~ 419 S Gardner

Phone Number: ()

Email address: _____

Name and address of Water Use Correspondent: A BRADFORD SMITH

P O BOX 547, SHARON SPRINGS KS 67758

Phone Number: ()

Email address: _____

3. The presently authorized place of use is:

Owner of Land ----- NAME: ECLIPSE INC, A BRADFORD SMITH

ADDRESS: 695 KANSAS HWY 27, SHARON SPRINGS KS 67758-6029

(If there is more than one landowner, attach supplemental sheets as necessary.)

Sec.	Twp.	Range	NE¼				NW¼				SW¼				SE¼				TOTAL ACRES		
			NE¼	NW¼	SW¼	SE¼	NE¼	NW¼	SW¼	SE¼	NE¼	NW¼	SW¼	SE¼	NE¼	NW¼	SW¼	SE¼			
3	16	40							32.5	32.5	32.5	32.5									130
8	16	40																		40	40
9	16	40											32.5	32.5	32.5	32.5	32.5	32.5	32.5	32.5	195

4. If this application is for a change in place of use, it is proposed that the place of use be changed to:

Owner of Land ----- NAME: _____

ADDRESS: _____

(If there is more than one landowner, attach supplemental sheets as necessary.)

Sec.	Twp.	Range	NE¼				NW¼				SW¼				SE¼				TOTAL ACRES				
			NE¼	NW¼	SW¼	SE¼	NE¼	NW¼	SW¼	SE¼	NE¼	NW¼	SW¼	SE¼	NE¼	NW¼	SW¼	SE¼					
3	16	40							32.5	32.5	32.5	32.5									130		
9	16	40									15	17.5	17.5	15	32.5	32.5	32.5	32.5					195

For Office Use Only: Code _____ Fee \$ _____ TR # _____ Receipt Date _____ Check # <u>2631</u>

APPLICATION FOR APPROVAL TO CHANGE
THE PLACE OF USE AND/OR POINT OF DIVERSION
SUPPLEMENTAL SHEET

FILE NO. 8308

MAKE ADDITIONAL COPIES AS NECESSARY

3. *Continued:* The presently authorized place of use is:

Owner of Land ---- NAME: ECLIPSE INC, A BRADFORD SMITH

ADDRESS: 695 KANSAS HWY 27, SHARON SPRINGS KS 67758-6029

Sec.	Twp.	Range	NE¼				NW¼				SW¼				SE¼				TOTAL ACRES
			NE¼	NW¼	SW¼	SE¼	NE¼	NW¼	SW¼	SE¼	NE¼	NW¼	SW¼	SE¼	NE¼	NW¼	SW¼	SE¼	
10	16	40									32.5	32.5	32.5	32.5	32.5	32.5	32.5	32.5	260
16	16	40	32.5	32.5	32.5	32.5	32.5	32.5	32.5	32.5									260
21	16	40	32.5	32.5	32.5	32.5	32.5	32.5	32.5	32.5									260

Owner of Land ---- NAME: RAY P SMITH

ADDRESS: 695 KANSAS HWY 27, SHARON SPRINGS KS 67758-6029

Sec.	Twp.	Range	NE¼				NW¼				SW¼				SE¼				TOTAL ACRES
			NE¼	NW¼	SW¼	SE¼	NE¼	NW¼	SW¼	SE¼	NE¼	NW¼	SW¼	SE¼	NE¼	NW¼	SW¼	SE¼	
21	16	40									32.5	32.5	32.5	32.5					130

Owner of Land ---- NAME: _____

ADDRESS: _____

Sec.	Twp.	Range	NE¼				NW¼				SW¼				SE¼				TOTAL ACRES
			NE¼	NW¼	SW¼	SE¼	NE¼	NW¼	SW¼	SE¼	NE¼	NW¼	SW¼	SE¼	NE¼	NW¼	SW¼	SE¼	

4. *Continued:* If this application is for a change in place of use, it is proposed that the place of use be changed to:

Owner of Land ---- NAME: ECLIPSE INC, A BRADFORD SMITH

ADDRESS: 695 KANSAS HWY 27, SHARON SPRINGS KS 67758-6029

Sec.	Twp.	Range	NE¼				NW¼				SW¼				SE¼				TOTAL ACRES
			NE¼	NW¼	SW¼	SE¼	NE¼	NW¼	SW¼	SE¼	NE¼	NW¼	SW¼	SE¼	NE¼	NW¼	SW¼	SE¼	
10	16	40			25	25					32.5	32.5	32.5	32.5	32.5	32.5	32.5	32.5	310
16	16	40	32.5	32.5	32.5	32.5	32.5	32.5	32.5	32.5									260
21	16	40	32.5	32.5	32.5	32.5	32.5	32.5	32.5	32.5									260

Owner of Land ---- NAME: RAY P SMITH

ADDRESS: 695 KANSAS HWY 27, SHARON SPRINGS KS 67758-6029

Sec.	Twp.	Range	NE¼				NW¼				SW¼				SE¼				TOTAL ACRES
			NE¼	NW¼	SW¼	SE¼	NE¼	NW¼	SW¼	SE¼	NE¼	NW¼	SW¼	SE¼	NE¼	NW¼	SW¼	SE¼	
21	16	40									32.5	32.5	32.5	32.5					130

Owner of Land ---- NAME: _____

ADDRESS: _____

Sec.	Twp.	Range	NE¼				NW¼				SW¼				SE¼				TOTAL ACRES
			NE¼	NW¼	SW¼	SE¼	NE¼	NW¼	SW¼	SE¼	NE¼	NW¼	SW¼	SE¼	NE¼	NW¼	SW¼	SE¼	

**Change in Place of Use
for Water Right Number 8308
All in Township 16 S, Range 40 West, Greeley County**

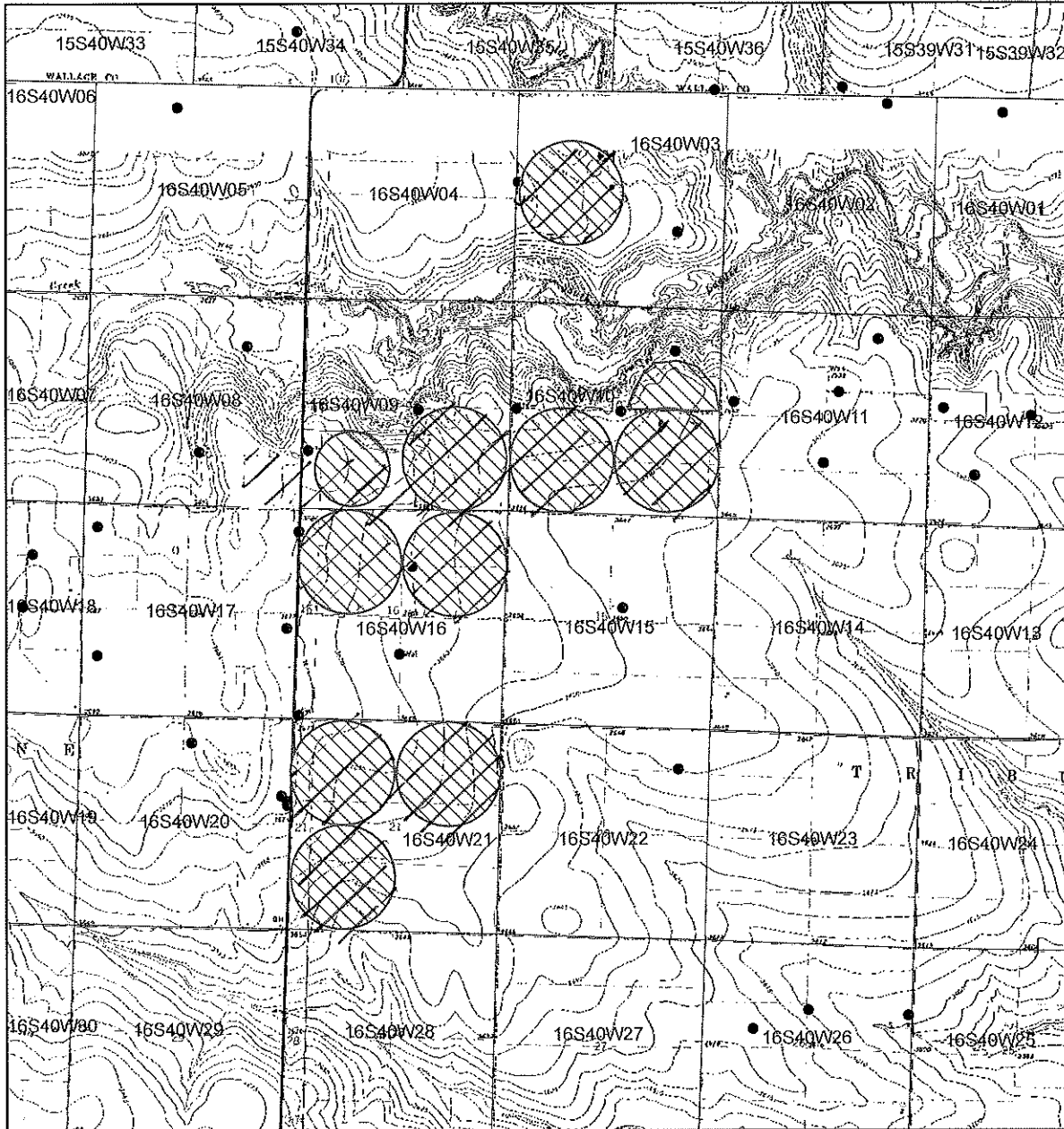

Authorized Place of Use



Requested Place of Use

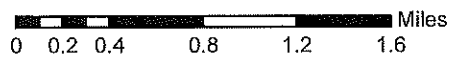

All wells within 1/2 mile have been identified.

X Al Smith