

STATE OF KANSAS



DEPARTMENT OF AGRICULTURE
DIVISION OF WATER RESOURCES
GARDEN CITY FIELD OFFICE
2508 JOHNS STREET
GARDEN CITY, KS 67846-2804

PHONE: (620) 276-2901
FAX: (620) 276-9315
www.agriculture.ks.gov

GOVERNOR JEFF COLYER, M.D.
JACKIE McCLASKEY, SECRETARY OF AGRICULTURE

April 18, 2018

MICHAEL R & STEPHANIE S WESTEMAN
3421 SW CR I
SYRACUSE KS 67878-780

RE: Change the Place of Use, File Nos 9074 9117 9949
10983

Dear Mr. & Mrs Westeman;

Enclosed you will find a *Summary Order Approving Application for Change in Place of Use* for the above referenced files. Since these orders modify the original documents, it should be recorded at the County Register of Deeds.

These orders modify the authorized acres that can be irrigated by these files. The authorized place of use is as shown on the plats within the change approvals.

A condition of this order is that an acceptable flow meter must be properly installed on the diversion works authorized under the referenced file number in accordance with the Kansas Administrative Regulations 5-1-4 through 5-1-12. This water flow meter shall be used to provide information required on the annual water use report (including the meter reading at the beginning and end of the report year).

This order shall become final if a request for a hearing is not filed with the Chief Engineer within 15 days of the date of service of this order. The date of service is the date listed on the enclosed *Certificate of Service*.

Should you have any questions, please feel free to call this office or arrange an appointment for additional assistance. Please refer to the file number when you contact us if you wish to discuss a specific file.

Sincerely,

Thomas P. Makens
Assistant Water Commissioner

TPM:tpm
Enclosures

GMD#3

CERTIFICATE OF SERVICE

On this 20th day of April 2018, I hereby certify that the attached original Approval of Application to Change the Place of Use under Water Right File 9074, 9117, 9949, 10983 dated April 18, 2018, was mailed postage prepaid, first class, US mail to the following:

MICHAEL R & STEPHANIE S WESTEMAN
3421 SW CR I
SYRACUSE KS 67878-7809

Copy provided to GMD#3

A handwritten signature in black ink, consisting of a stylized, cursive 'R' followed by a horizontal line extending to the right.

Division of Water Resources

Submit completed application to:
 Kansas Department of Agriculture
 Division of Water Resources
 Field Office for your area.

Call for address:

Topeka -- (785) 862-6300
 Stafford -- (620) 234-5311
 Stockton -- (785) 425-6787
 Garden City -- (620) 276-2901
www.ksda.gov/dwr

DWR FIELD OFFICE APPLICATION FOR APPROVAL TO CHANGE THE PLACE OF USE AND/OR THE POINT OF DIVERSION



STATE OF KANSAS

Filing Fee Must Accompany the Application, K.S.A. 82a-708b(b), as amended.
 Fee Schedule is on the third page of this application form.

Paragraph Nos. 1, 2, 3 & 5 must be completed. Complete all other applicable portions. If change in point of diversion is greater than 100 feet, or if place of use will be changed, include a topographic map or detailed plat showing the authorized and proposed point(s) of diversion and/or place of use.

File No. 9074

RECEIVED
 11:40am
 MAR 05 2018

1. Application is hereby made for approval of the Chief Engineer to change the (check one or both):

Place of Use Point of Diversion

Garden City Field Office
 Division of Water Resources

under the water right which is the subject of this application in accordance with the conditions described below.

The source of supply is: Groundwater Surface water

2. Name and address of Applicant: Westeman Land LLC

3421 SW CR I, Syracuse, KS 67878

Phone Number: (620)384-4278

Email address: smmw@pld.com

Name and address of Water Use Correspondent: Same

Phone Number: ()

Email address: _____

3. The presently authorized place of use is:

Owner of Land --- NAME: Westeman Land LLC

ADDRESS: 3421 SW CR I, Syracuse, KS 67878

(If there is more than one landowner, attach supplemental sheets as necessary.)

Sec.	Twp.	Range	NE¼				NW¼				SW¼				SE¼				TOTAL ACRES
			NE¼	NW¼	SW¼	SE¼	NE¼	NW¼	SW¼	SE¼	NE¼	NW¼	SW¼	SE¼	NE¼	NW¼	SW¼	SE¼	
23	26s	42w	11.4	34.3	40.0	34.3	34.3	11.4	34.3	40.0	34.3	11.4	34.3					360.0	
24	26s	42w					32.5	32.5	32.5	32.5								130.0	
14	26s	42w					40.0	40.0	40.0	40.0					40.0	40.0	40.0	40.0	320.0

4. If this application is for a change in place of use, it is proposed that the place of use be changed to:

Owner of Land --- NAME: Westeman Land LLC

ADDRESS: 3421 SW CR I, Syracuse, KS 67878

(If there is more than one landowner, attach supplemental sheets as necessary.)

Sec.	Twp.	Range	NE¼				NW¼				SW¼				SE¼				TOTAL ACRES
			NE¼	NW¼	SW¼	SE¼	NE¼	NW¼	SW¼	SE¼	NE¼	NW¼	SW¼	SE¼	NE¼	NW¼	SW¼	SE¼	
23	26s	42w	11.40	34.30	40.0	34.30	34.30	11.40	34.30	40.0	34.30	11.40	34.30	40.0	40.0	40.0	40.0	40.0	520.0
24	26s	42w					32.5	32.5	32.5	32.5									130.0
14	26s	42w					40.0	40.0	40.0	40.0					40.0	40.0	40.0	40.0	320.0

For Office Use Only: Code _____ Fee \$ 200 TR # _____ Receipt Date 3/5/10 Check # 1036

5. **Presently authorized point of diversion:**
 One in the SW Quarter of the SW Quarter of the NE Quarter of Section 23, Township 26 South, Range 42 W, in HAMILTON County, Kansas, 2660 feet North 2600 feet West of Southeast corner of section. Authorized Rate 1290gpm Authorized Quantity 480AF Depth of well _____ (feet) (DWR use only: Computer ID No. _____ GPS _____ feet North _____ feet West)
 This point will not be changed This point will be changed as follows:
Proposed point of diversion: (Complete only if change is requested)
 One in the _____ Quarter of the _____ Quarter of the _____ Quarter of Section _____, Township _____ South, Range _____, in _____ County, Kansas, _____ feet North _____ feet West of Southeast corner of section. Proposed Rate _____ Proposed Quantity _____ Proposed well depth (feet) _____
 This point is: Additional Well Geo Center List other water rights that will use this point _____

6. **Presently authorized point of diversion:**
 One in the _____ Quarter of the _____ Quarter of the _____ Quarter of Section _____, Township _____ South, Range _____, in _____ County, Kansas, _____ feet North _____ feet West of Southeast corner of section. Authorized Rate _____ Authorized Quantity _____ Depth of well _____ (feet) (DWR use only: Computer ID No. _____ GPS _____ feet North _____ feet West)
 This point will not be changed This point will be changed as follows:
Proposed point of diversion: (Complete only if change is requested)
 One in the _____ Quarter of the _____ Quarter of the _____ Quarter of Section _____, Township _____ South, Range _____ (EW), in _____ County, Kansas, _____ feet North _____ feet West of Southeast corner of section. Proposed Rate _____ Proposed Quantity _____ Proposed well depth (feet) _____
 This point is: Additional Well Geo Center List other water rights that will use this point _____

7. Why do you need a new point of diversion? _____

the diagram below in relation to the existing point of diversion. (PLEASE NOTE: The "X" in center of diagram below represents presently authorized point of diversion.)

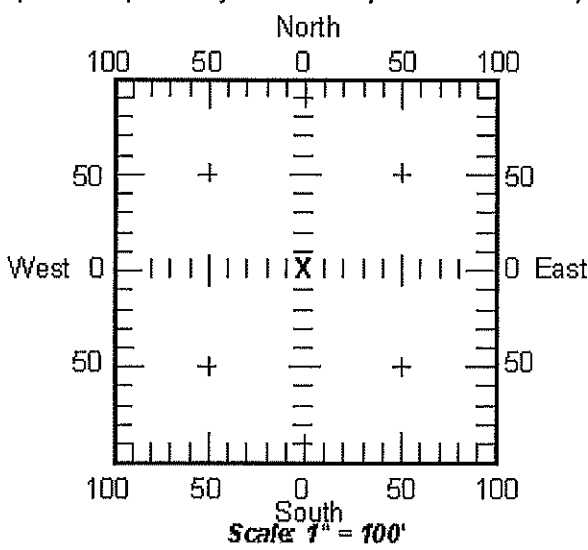

8. If a well, is the test hole log attached? Yes No

9. When do you propose to complete the new point of diversion?

10. If the point of diversion is a well:
 (a) What are you going to do with the old well?

 (b) When will this be done? _____

11. Groundwater Management District recommendation attached?
 Yes No

12. Assisted by GMD3/JLN

13b. If the proposed point of diversion will be relocated more than 100 feet but within 1320 feet from the existing point of diversion, attach a topographic map or aerial photograph. For groundwater sources, show all wells (including domestic) within one-half mile of the proposed point of diversion and the names and mailing addresses of the owners. For surface water sources, show the names and addresses of the landowner(s) one-half mile downstream and one-half mile upstream from your property lines.

13a. If the proposed point of diversion will be relocated within 100 feet of the existing point of diversion, indicate its location on

Submit completed application to:
 Kansas Department of Agriculture
 Division of Water Resources
 Field Office for your area.
 Call for address:
 Topeka -- (785) 862-6300
 Stafford -- (620) 234-5311
 Stockton -- (785) 425-6787
 Garden City -- (620) 276-2901
www.ksda.gov/dwr

**DWR FIELD OFFICE
 APPLICATION FOR APPROVAL
 TO CHANGE THE PLACE OF
 USE AND/OR THE
 POINT OF DIVERSION**



**STATE OF
 KANSAS**

Filing Fee Must Accompany the Application, K.S.A. 82a-708b(b), as amended.

Fee Schedule is on the third page of this application form.

Paragraph Nos. 1, 2, 3 & 5 must be completed. Complete all other applicable portions. If change in point of diversion is greater than 100 feet, or if place of use will be changed, include a topographic map or detailed plat showing the authorized and proposed point(s) of diversion and/or place of use.

File No. 9074

1. Application is hereby made for approval of the Chief Engineer to change the (check one or both):

Place of Use Point of Diversion
 under the water right which is the subject of this application in accordance with the conditions described below.
 The source of supply is: Groundwater Surface water

2. Name and address of Applicant: Westeman Land LLC

3421 SW CR 1, Syracuse, KS 67878

Phone Number: (620)384-4278 Email address: smmw@pld.com

Name and address of Water Use Correspondent: Same

Phone Number: () Email address:

3. The presently authorized place of use is:

Owner of Land ---- NAME: Westeman Land LLC

ADDRESS: 3421 SW CR 1, Syracuse, KS 67878

(If there is more than one landowner, attach supplemental sheets as necessary.)

Sec.	Twp.	Range	NE¼				NW¼				SW¼				SE¼				TOTAL ACRES
			NE¼	NW¼	SW¼	SE¼	NE¼	NW¼	SW¼	SE¼	NE¼	NW¼	SW¼	SE¼	NE¼	NW¼	SW¼	SE¼	
23	26s	42w	11.4	34.3	40.0	34.3	34.3	11.4	34.3	40.0	40.0	34.3	11.4	34.3					360.0
24	26s	42w					32.5	32.5	32.5	32.5									130.0
14	26s	42w					40.0	40.0	40.0	40.0					40.0	40.0	40.0	40.0	320.0

4. If this application is for a change in place of use, it is proposed that the place of use be changed to:

Owner of Land ---- NAME: Westeman Land LLC

ADDRESS: 3421 SW CR 1, Syracuse, KS 67878

(If there is more than one landowner, attach supplemental sheets as necessary.)

Sec.	Twp.	Range	NE¼				NW¼				SW¼				SE¼				TOTAL ACRES
			NE¼	NW¼	SW¼	SE¼	NE¼	NW¼	SW¼	SE¼	NE¼	NW¼	SW¼	SE¼	NE¼	NW¼	SW¼	SE¼	
23	26s	42w	11.40	34.30	40.0	34.30	34.30	11.40	34.30	40.0	40.0	34.30	11.40	34.30	40.0	40.0	40.0	40.0	520.0
24	26s	42w					32.5	32.5	32.5	32.5									130.0
14	26s	42w					40.0	40.0	40.0	40.0					40.0	40.0	40.0	40.0	320.0

For Office Use Only: Code	Fee \$	TR #	Receipt Date	Check #
----------------------------------	---------------	-------------	---------------------	----------------

Presently authorized point of diversion:

One in the SW Quarter of the SW Quarter of the NE Quarter
of Section 23, Township 26 South, Range 42 W,
in HAMILTON County, Kansas, 2660 feet North 2600 feet West of Southeast corner of
section.
Authorized Rate 1290gpm Authorized Quantity 480AF Depth of well _____
(DWR use only: Computer ID No. _____ GPS _____ feet North _____ feet West)

This point will not be changed This point will be changed as follows:

Proposed point of diversion: (Complete only if change is requested)

One in the _____ Quarter of the _____ Quarter of the _____ Quarter
of Section _____, Township _____ South, Range _____,
in _____ County, Kansas, _____ feet North _____ feet West of Southeast corner of
section.
Proposed Rate _____ Proposed Quantity _____ Proposed well depth (feet)

This point is: Additional Well Geo Center List other water rights that will use this point _____

Presently authorized point of diversion:

One in the _____ Quarter of the _____ Quarter of the _____ Quarter
of Section _____, Township _____ South, Range _____,
in _____ County, Kansas, _____ feet North _____ feet West of Southeast corner of
section.
Authorized Rate _____ Authorized Quantity _____ Depth of well _____ (feet)
(DWR use only: Computer ID No. _____ GPS _____ feet North _____ feet West)

This point will not be changed This point will be changed as follows:

Proposed point of diversion: (Complete only if change is requested)

One in the _____ Quarter of the _____ Quarter of the _____ Quarter
of Section _____, Township _____ South, Range _____ (E/W),
in _____ County, Kansas, _____ feet North _____ feet West of Southeast corner of
section.
Proposed Rate _____ Proposed Quantity _____ Proposed well depth (feet)

This point is: Additional Well Geo Center List other water rights that will use this point _____

7. Why do you need a new point of diversion? _____

5. _____

8. If a well, is the test hole log attached? Yes No

9. When do you propose to complete the new point of diversion?

10. If the point of diversion is a well:

(a) What are you going to do with the old well?

(b) When will this be done? _____

11. Groundwater Management District recommendation attached? Yes No

12. Assisted by GMD3/JLN

13a. If the proposed point of diversion will be relocated within 100 feet of the existing point of diversion, indicate its location on the diagram below in relation to the existing point of diversion. (PLEASE NOTE: The "X" in center of diagram below represents presently authorized point of diversion.)

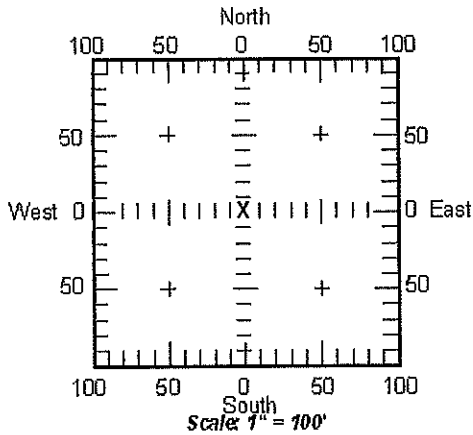

13b. If the proposed point of diversion will be relocated more than 100 feet but within 1320 feet from the existing point of diversion, attach a topographic map or aerial photograph. For groundwater sources, show all wells (including domestic) within one-half mile of the proposed point of diversion and the names and mailing addresses of the owners. For surface water sources, show the names and addresses of the landowner(s) one-half mile downstream and one-half mile upstream from your property lines.

14. If the proposed groundwater point of diversion is 300 or fewer feet from existing point of diversion, complete the following:

(a) Does the undersigned represent all owners of the currently authorized place(s) of use identified in this application?

Yes No (If no, all owners must sign this application.)

(b) Will the ownership interest of any owner of the currently authorized place(s) of use identified in this application be adversely affected if this application is approved as requested?

Yes No (If yes, all owners must sign this application.)

(c) If this application is not approved expeditiously, will there be substantial damage to property, public health or safety?

Yes No (If no, all owners must sign this application.)

If the application proposes a surface water change in point of diversion, a groundwater change in point of diversion greater than 300 feet, or a change in place of use, the application must be signed by all owners of the currently authorized place of use, or their duly authorized agent (attach notarized statement authorizing representation).

I hereby verify, being first duly sworn upon my oath or affirmation and under penalty of perjury, that I am of lawful age and the owner, the spouse of the owner, or a duly authorized agent of the owner(s) to make this application on their behalf, in regard to the water right(s) to which this application pertains. I further verify that the statements contained in this application are true, correct and complete.

Dated at _____, Kansas, this _____ day of _____, 20____.

(Owner) (Spouse)
MIKE WESTEMAN Stephanie S Westeman
(Please Print) (Please Print)

(Owner) (Spouse)

(Please Print) (Please Print)

(Owner) (Spouse)

(Please Print) (Please Print)

State of Kansas)
) SS
County of Hamilton

I hereby certify that the foregoing application was signed in my presence and sworn to before me this 5th day of March, 2018.

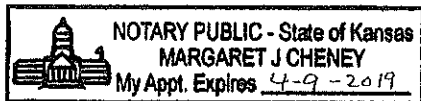

Notary Public Margaret J. Cheney

My Commission Expires
 4.9.2019

ONLY COMPLETE APPLICATIONS WILL BE PROCESSED. To be complete, all of the applicable portions of the application form must be completed with accurate information; maps, if necessary, must be included; signatures of all the appropriate owners' must be affixed to the application and notarized; and the appropriate fee must be paid.

FEE SCHEDULE

Each application to change the place of use or the point of diversion under this section shall be accompanied by the application fee set forth in the schedule below: Make checks payable to: Kansas Department of Agriculture

- (1) Application to change a point of diversion 300 feet or less \$100
(2) Application to change a point of diversion more than 300 feet \$200
(3) Application to change the place of use \$200

SUMMARY ORDER APPROVING APPLICATION FOR CHANGE AND IMPOSING CONDITIONS

This Summary Order is issued under authority of K.S.A. 82a-708b, as amended, and K.A.R. 5-14-3 and other applicable provisions of the Kansas Water Appropriation Law, K.S.A. 82a-701 et. seq., and rules and regulations promulgated thereunder, K.A.R. 5-1-1 et. seq. With the exception of those conditions expressly contained herein, this Summary Order does not change the terms, conditions and limitations of File No. _____

- 1. A change application was received on _____ requesting that the place of use and / or point of diversion authorized under the above-referenced file number be changed as described in the application.
2. On and after the effective date of this summary order, the authorized place(s) of use shall be located substantially as shown on the topographic map accompanying the application to change the place of use. Applicable Not Applicable
3. The change in point of diversion shall not impair existing rights and shall be limited to the same source or sources of water as previously authorized. The point of diversion authorized by this summary order shall be located within a _____ foot radius of the authorized point(s) of diversion. Applicable Not Applicable
4. The point(s) of diversion authorized herein shall not actually be located more than _____ feet from the previously authorized point(s) of diversion. Applicable Not Applicable

5. As required by K.A.R. 5-3-5d, if the works for diversion is a well with a diversion rate of 100 gallons per minute or more, a tube or other device suitable for making water level measurements shall be installed, operated and maintained in accordance with K.A.R. 5-

6-13. Applicable Not Applicable

6. The owner of the authorized place(s) of use shall properly install an acceptable water flow meter on or before December 31, 20____, or before the first use of water, whichever occurs first. The water flow meter shall be installed, operated and maintained in accordance with K.A.R. 5-1-4 through 5-1-12. As required by K.S.A. 82a-732, as amended, and K.A.R. 5-3-5e, the owner shall maintain records and report the reading of the water flow meter and the total quantity of water diverted annually to the Chief Engineer by March 1 following the end of each calendar year.

Applicable Not Applicable

7. Installation of the works for diversion of water shall be completed on or before December 31, 20____, or within any authorized extension of time. By March 1, 20____ the applicant shall notify the Chief Engineer that construction of the works for diversion has been completed, on the form provided by the Chief Engineer, as required by K.A.R. 5-8-4e.

Applicable Not Applicable

8. The completed well log shall be submitted with the required notice. Applicable Not Applicable

9. All diversion works into which any type of chemical or other foreign substance will be injected into the water shall be equipped with an in-line, automatic, quick-closing check valve capable of preventing pollution of the source of the water supply. The check valve(s) shall be installed, operated and maintained in accordance with K.A.R. 5-3-5c. Applicable Not Applicable

10. Additional Conditions are attached. Yes No

11. In accordance with K.S.A. 82a-708a, as amended, and K.A.R. 5-5-14, all of the owners of the authorized place(s) of use of water appropriated under the above-referenced file number are responsible for compliance with its terms, conditions and limitations, as amended and/or supplemented by this Summary Order, and with applicable provisions of the *Kansas Water Appropriation Law* and the *Rules and Regulations* promulgated thereunder. Failure to comply with these provisions may result in civil penalties pursuant to K.S.A. 82a-737, as amended, and/or the suspension or revocation and dismissal of the water or appropriation right or any other enforcement actions authorized by law.

Administrative Appeal and Effective Date of Order

You have the right to a hearing in accordance with K.A.R. 5-14-3 before this Summary Order becomes final action of the Kansas Department of Agriculture. Any request for a hearing must be filed with the **Chief Engineer, Division of Water Resources, Kansas Department of Agriculture, 109 SW 9th Street, Topeka, Kansas 66612**, within 15 days after the date shown on the Certificate of Service attached hereto. If a hearing is not requested in accordance with K.A.R. 5-14-3, this Summary Order will become effective on the 15th day after the date shown on the Certificate of Service.

For Use by Register of Deeds

FOR OFFICE USE ONLY

APPLICATION APPROVED AND

SUMMARY ORDER ISSUED

SUMMARY ORDER APPROVING APPLICATION FOR CHANGE AND IMPOSING CONDITIONS

This Summary Order is issued under authority of K.S.A. 82a-708b, as amended, and K.A.R. 5-5-1, *et seq.* and other applicable provisions of the *Kansas Water Appropriation Law, K.S.A. 82a-701 et seq.*, and rules and regulations promulgated thereunder, With the exception of those conditions expressly contained herein, this Summary Order does not change the terms, conditions and limitations of File No. 9074.

- 1. A change application was received on March 5, 2018 requesting that the place of use and / or point of diversion authorized under the above-referenced file number be changed as described in the application.
- 2. On and after the effective date of this summary order, the authorized place(s) of use shall be located substantially as shown on the topographic map accompanying the application to change the place of use. Applicable Not Applicable
- 3. The change in point of diversion shall not impair existing rights and shall be limited to the same source or sources of water as previously authorized. The point of diversion authorized by this summary order shall be located within a _____ foot radius of the authorized point(s) of diversion. Applicable Not Applicable
- 4. The point(s) of diversion described herein is administratively corrected to be more accurately described using the Global Positioning System (GPS), as described in the application. Applicable Not Applicable
- 5. The point(s) of diversion authorized herein shall not actually be located more than _____ feet from the previously authorized point(s) of diversion. Applicable Not Applicable
- 6. As required by K.A.R. 5-3-5d, if the works for diversion is a well with a diversion rate of 100 gallons per minute or more, a tube or other device suitable for making water level measurements shall be installed, operated and maintained in accordance with K.A.R. 5-6-13. Applicable Not Applicable
- 7. **The owner of the authorized place(s) of use shall properly install an acceptable water flow meter on or before December 31, 2018**, or before the first use of water, whichever occurs first. The water flow meter shall be installed, operated and maintained in accordance with K.A.R. 5-1-4 through 5-1-12. As required by K.S.A. 82a-732, as amended, and K.A.R. 5-3-5e, the owner shall maintain records and report the reading of the water flow meter and the total quantity of water diverted annually to the Chief Engineer by March 1 following the end of each calendar year. Applicable Not Applicable
- 8. **Installation of the works for diversion of water shall be completed on or before December 31, 20____**, or within any authorized extension of time. By March 1, 20____ the applicant shall notify the Chief Engineer that construction of the works for diversion has been completed, on the form provided by the Chief Engineer, as required by K.A.R. 5-8-4e. Applicable Not Applicable
- 9. **The completed well log shall be submitted with the required notice.** Applicable Not Applicable
- 10. All diversion works into which any type of chemical or other foreign substance will be injected into the water shall be equipped with an in-line, automatic, quick-closing check valve capable of preventing pollution of the source of the water supply. The check valve(s) shall be installed, operated and maintained in accordance with K.A.R. 5-3-5c. Applicable Not Applicable
- 11. Additional Conditions are attached. Yes No
- 12. In accordance with K.S.A. 82a-708a, as amended, and K.A.R. 5-5-14, all of the owners of the authorized place(s) of use of water appropriated under the above-referenced file number are responsible for compliance with its terms, conditions and limitations, as amended and/or supplemented by this Summary Order, and with applicable provisions of the *Kansas Water Appropriation Law* and the *Rules and Regulations* promulgated thereunder. Failure to comply with these provisions may result in civil penalties pursuant to K.S.A. 82a-737, as amended, and/or the suspension or revocation and dismissal of the water or appropriation right or any other enforcement actions authorized by law.

Administrative Appeal and Effective Date of Order

If you are aggrieved by this order, pursuant to K.S.A. 82a-1901, you may request an evidentiary hearing before the Chief Engineer or request administrative review by the Secretary of Agriculture. A request for hearing by the Chief Engineer must be filed within 15 days of service of this Order and a request for administrative review by the Secretary must be filed within 30 days pursuant to K.S.A. 77-531. Any request for administrative review must state a basis for review pursuant to K.S.A. 77-527. File any request with **Kansas Department of Agriculture, Legal Division, 1320 Research Park Drive, Manhattan, KS 66502**. Failure to timely request a hearing or review may preclude review under the Kansas Judicial Review Act.

For Use by Register of Deeds

FOR OFFICE USE ONLY
APPLICATION APPROVED AND SUMMARY ORDER ISSUED

By: Thomas P. Makens
Duly Authorized Designee of the Chief Engineer

(Print Name): Thomas P Makens
Division of Water Resources - Kansas Department of Agriculture

Date of Issuance: April 18, 2018

State of Kansas)

County of Lincoln) SS

Acknowledged before me on April 18, 2018

by Thomas P. Makens

Signature: Julie Jones

My commission expires: _____



9074, 9117 & 9949 PU Change

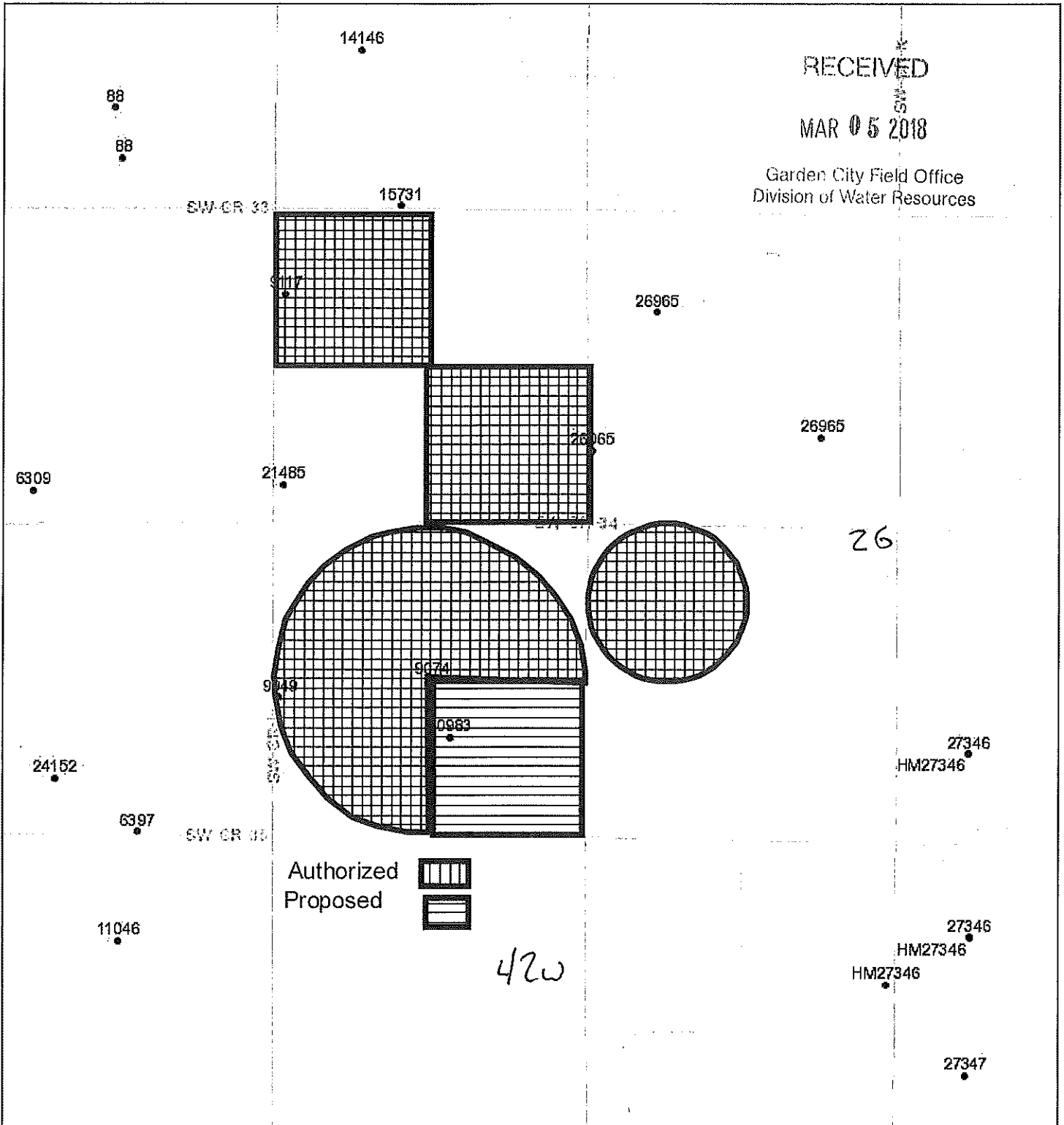

February 27, 2018

DISCLAIMER: This map is not intended for conveyances, nor is it a legal survey. The information is presented on a best-efforts basis, and should not be relied upon for making financial, survey, legal or other commitments.

Legend

- | | | | | | |
|--------------|-------|-----|-----|-----|----------|
| Wells | | FPR | | STK | |
| | Other | | HYD | THX | |
| | IRR | | IND | | Empty |
| | CON | | MUN | | Sections |
| | DEW | | REC | | |
| | DOM | | | | |

1:36,112

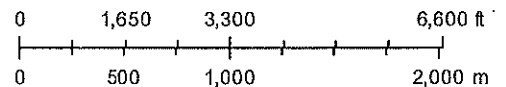

Sources: Esri, HERE, Garmin, Intelmap, increment P Corp., GEBCO, USGS, FAO, NPS, NRCAN, GeoBase, IGN, Kadaster NL, Ordnance Survey, Esri Japan, METI, Esri China (Hong Kong), swisstopo, © OpenStreetMap contributors, and the GIS User Community

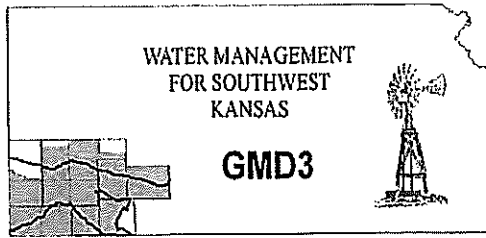

Southwest Kansas
Groundwater Management District No. 3
2009 E. Spruce Street
Garden City, Kansas 67846
(620) 275-7147 phone (620) 275-1431 fax
www.gmd3.org

January 28, 2018

Michael A. Meyers
Division of Water Resources
2508 N Johns Street
Garden City, Kansas 67846

RECEIVED

MAR 05 2018

Garden City Field Office
Division of Water Resources

RE: Applications for Change in Point of Diversion
Water Right, File No. 10983
Applications for Change in Place of Use
Water Right, File Nos. 9074, 9117, 9949 & 10983

Dear Mike:

We have assisted with the applications for the above referenced water rights. The proposals are not in conflict with the Management Program of the Southwest Kansas Groundwater Management District No. 3 (GMD3). The proposed change in point of diversion, for Water Right 10983, is in accordance with K.A.R. 5-23-3, as it pertains to distance moved and minimum spacing to neighboring wells. The proposed complete overlap in place of use is in accordance with K.A.R. 5-5-11(b)(1). It is therefore recommended that the applications be approved at this time.

Thank you for the opportunity to review the applications and to provide a recommendation. If you have any questions, please don't hesitate to contact us.

Sincerely,

Jason L. Norquest
Assistant Manager

9074, 9117 & 9949 PU Change

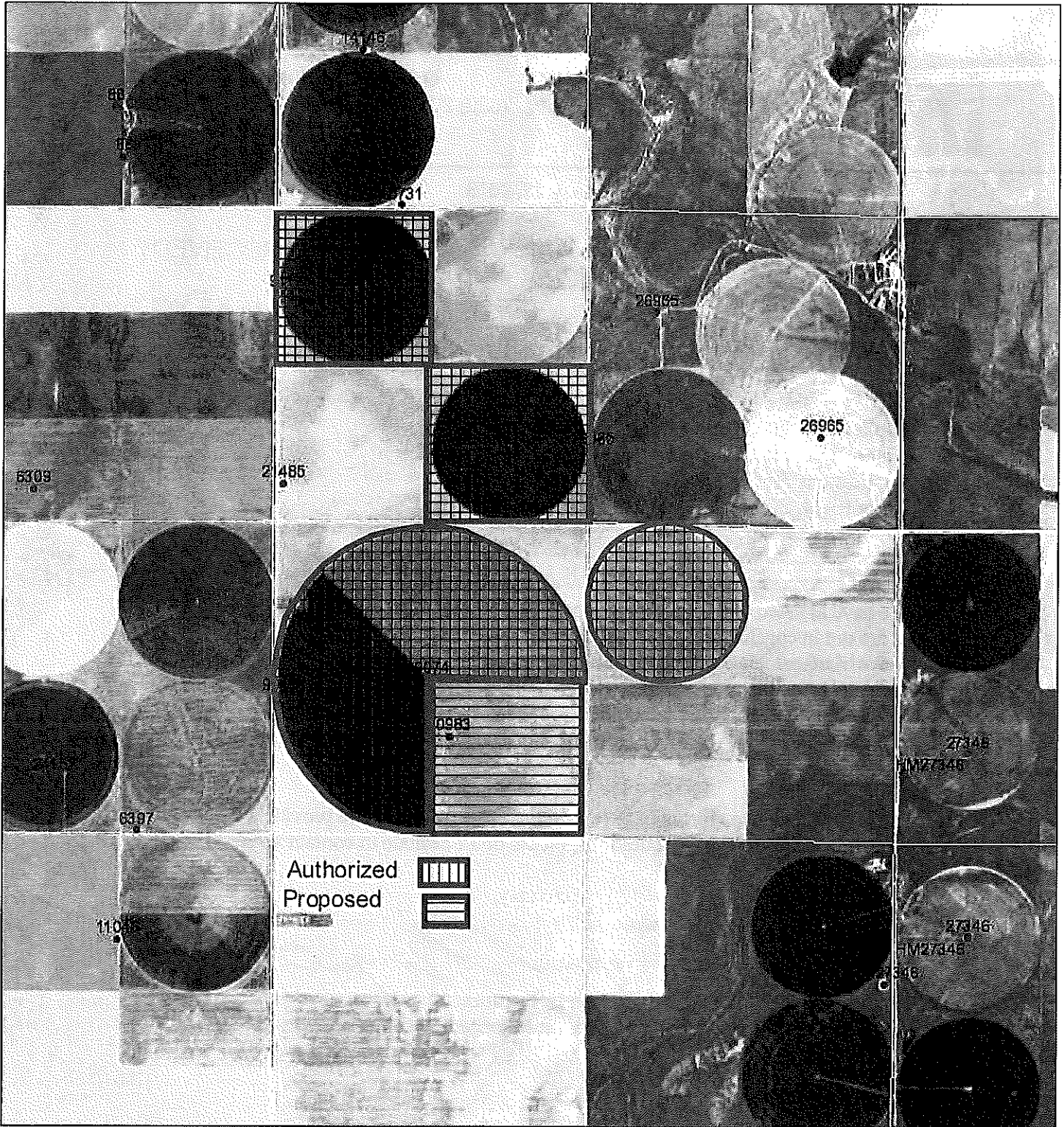

February 27, 2018

DISCLAIMER: This map is not intended for conveyances, nor is it a legal survey. The information is presented on a best-efforts basis, and should not be relied upon for making financial, survey, legal or other commitments.

Legend

- | | | | | |
|--------------|-------|-----|-----|----------|
| Wells | | FPR | | STK |
| | Other | | HYD | THX |
| | IRR | | IND | |
| | CON | | MUN | Empty |
| | DEW | | REC | |
| | DOM | | | Sections |

RECEIVED

MAR 05 2018

Garden City Field Office
Division of Water Resources

1:36,112

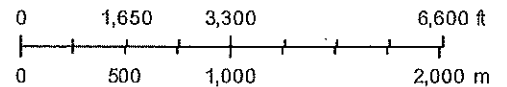

GMD FSA 2016

RECEIVED

MAR 05 2018

Garden City Field Office
Division of Water Resources



STATE OF KANSAS }
HAMILTON COUNTY } 762
This instrument was filed for record
on the 25th day of NOVEMBER
A.D. 2014 at 1:00 o'clock P M
and duly recorded in book 171
Page 96 fee \$ 12.00
Vicky Valentine
Register of Deeds

WARRANTY DEED

Michael R. Westeman and Stephanie S. Westeman, husband and wife, CONTRIBUTE, CONVEY AND WARRANT to Westeman Land, LLC, a Kansas limited liability company, with a mailing address of 3421 SW County Road I, Syracuse, Kansas 67878, all of the following described real estate, to-wit:

The Northeast Quarter (NE/4) of Section Twenty-seven (27), Township Twenty-six (26) South, Range Forty-two (42) West of the 6th P.M., Hamilton County, Kansas;

The West Half (W/2) and the North Half of the Southeast Quarter (N/2 SE/4) of Section Fourteen (14), Township Twenty-six (26) South, Range Forty-two (42) West of the 6th P.M., Hamilton County, Kansas;

The South Half of the Southeast Quarter (S/2 SE/4) of Section Fourteen (14), Township Twenty-six (26) South, Range Forty-two (42) West of the 6th P.M., Hamilton County, Kansas;

The East Half (E/2) of Section Twenty-two (22), Township Twenty-six (26) South, Range Forty-two (42) West of the 6th P.M., Hamilton County, Kansas;

All of Section Twenty-three (23), Township Twenty-six (26) South, Range Forty-two (42) West of the 6th P.M., Hamilton County, Kansas; and

The North Half (N/2) of Section Twenty-four (24), Township Twenty-six (26) South, Range Forty-two (42) West of the 6th P.M., Hamilton County, Kansas;

[No Kansas Real Estate Sales Validation Questionnaire required, K.S.A. 79-1437e(a)(4).]

together with all its appurtenances and warrants the title to the same, subject to all prior mineral reservations, oil and gas leases, rights-of-way, easements and protective covenants of record, if any.

Copy
Numerical
Computer
Indirect
Direct

RECEIVED

MAR 05 2018

DATED this 19th day of September, 2014.

Garden City Field Office
Division of Water Resources

Michael R. Westeman

Michael R. Westeman

Stephanie S. Westeman

Stephanie S. Westeman

State of Kansas)

County of Finney)

) ss

The foregoing instrument was acknowledged before me this 19th day of September, 2014, by Michael R. Westeman and Stephanie S. Westeman, husband and wife.

Stacy L. Hurtado

Notary Public



My Appointment Expires:

12-10-2016