

Kansas Department of Agriculture
 Division of Water Resources
CHANGE: P/D WORKSHEET

1. File Number: FI 186	2. Status Change Date: 3/20/18	3. Change Num: c1	4. Field Office: 04	5. GMD: 03
----------------------------------	--	-----------------------------	-------------------------------	----------------------

6. Status: <input checked="" type="checkbox"/> Approved <input type="checkbox"/> Denied by DWR/GMD <input type="checkbox"/> Dismiss by Request/Failure to Return	7. Filing Date of Change: 3/6/18
--	--

8a. Applicant(s) New to system <input type="checkbox"/>	Person ID 5846 Add Seq# 1
THE GARDEN CITY CO PO BOX 597 GARDEN CITY KS 67846	

8c. Landowner(s) New to system <input type="checkbox"/>	Person ID _____ Add Seq# _____
--	-----------------------------------

8b. Landowner(s) New to system <input type="checkbox"/>	Person ID 5846 Add Seq# 1
THE GARDEN CITY CO PO BOX 597 GARDEN CITY KS 67846	

8d. WUC New to system <input type="checkbox"/>	Person ID 5846 Add Seq# 1
THE GARDEN CITY CO PO BOX 597 GARDEN CITY KS 67846	

9. Documents and Enclosure(s): <input checked="" type="checkbox"/> DWR Meter(s) Date to Comply: 12/31/18 <input checked="" type="checkbox"/> N & P Date to Comply: 12/31/18	
<input type="checkbox"/> Anti-Reverse Meter <input type="checkbox"/> Meter Seal <input type="checkbox"/> Check Valve <input type="checkbox"/> N & P Form <input type="checkbox"/> Water Tube <input type="checkbox"/> Driller Copy <input type="checkbox"/> H & E Letter <input type="checkbox"/> Conservation Plan Date Required: _____ Date Approved: _____ Date to Comply: _____	

10. Use Made of Water From: _____	To: _____
--------------------------------------	-----------

Date Prepared: 3/9/18	By: TPM
Date Entered: _____	By: _____

File No. **FI 186** 11. County: FI Basin: Ark Stream: Formation Code: 211 Special Use:

12. Points of Diversion
 Rate and Quantity
 Authorized Additional
 Rate Quantity Rate Quantity
 gpm/cfs af/mgy gpm/cfs af/mgy
 Comment (AKA Line) 'W 'N 'W
 4825 4785

ent nw nw nw 19 23 34w 4825 4785
 del 41487

13. Storage: Rate _____ NF _____ Quantity _____ ac/ft Additional Rate _____ NF _____ Additional Quantity _____ ac/ft

14. Limitation: _____ af/yr at _____ gpm (_____ cfs) when combined with file number(s) _____
 Limitation: _____ af/yr at _____ gpm (_____ cfs) when combined with file number(s) _____

15. 5YR Allocation: Allocation Type _____ Start Year _____ 5 YR Amount _____ Amount Unit _____ Base Acres _____ Comment _____

16. Place of Use CHK MOD DEL ENT	P U S E	S T R I D	NE 1/4		NW 1/4		SW 1/4		SE 1/4		Total	Owner	Chg?	Overlap Files
			NE 1/4	SW 1/4	NE 1/4	SW 1/4	NE 1/4	SW 1/4	NE 1/4	SW 1/4				
NC												nc		

Base Acres: _____ Year: _____ Minimum Reasonable Quantity: _____
 Comments: _____

STATE OF KANSAS

DEPARTMENT OF AGRICULTURE
DIVISION OF WATER RESOURCES
GARDEN CITY FIELD OFFICE
2508 JOHNS STREET
GARDEN CITY, KS 67846-2804



PHONE: (620) 276-2901
FAX: (620) 276-9315
www.agriculture.ks.gov

GOVERNOR JEFF COLYER, M.D.
JACKIE McCLASKEY, SECRETARY OF AGRICULTURE

March 20, 2018

THE GARDEN CITY CO
PO BOX 597
GARDEN CITY KS 67846

RE: Change in Point of Diversion Water Right, File No FI 186

Dear Mr. Dumler:

Enclosed you will find a *Summary Order Approving Application for Change in Points of Diversion* for the above referenced file. This order modifies the authorized well location under the referenced file. This order modifies the original document; it should be recorded at the County Register of Deeds.

Your attention is directed to the enclosures and to the terms, conditions, and limitations specified in this order. The diversion works should be completed and reported to the Division of Water Resources by **December 31, 2018**. Enclosed is a form for this purpose, along with other information for reference.

A condition of this order is that an acceptable flow meter must be properly installed on the diversion works authorized under the referenced file number in accordance with the Kansas Administrative Regulations 5-1-4 through 5-1-12. This water flow meter shall be used to provide information required on the annual water use report.

This order shall become final if a request for a hearing is not filed with the Chief Engineer within 15 days of the date of service of this order. The date of service is the date listed on the enclosed *Certificate of Service*.

Should you have any questions, please feel free to call this office. If you would prefer, you could arrange an appointment for additional assistance.

Sincerely,

A handwritten signature in black ink, appearing to read "T. P. Makens".

Thomas P. Makens
Assistant Water Commissioner

TPM:tpm
Enclosures
GMD#3

CERTIFICATE OF SERVICE

On this 21ST day of March 2018, I hereby certify that the attached original Approval of Application to Change the Point of Diversion under Water Right, File No. FI 186 dated March 20, 2018 was mailed postage prepaid, first class, US mail to the following:

THE GARDEN CITY CO
PO BOX 597
GARDEN CITY KS 67846

Copy provided to GMD#3

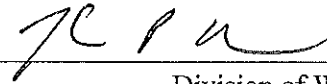
A handwritten signature in black ink, appearing to read 'J. P. A.', is written above a horizontal line.

Division of Water Resources

Submit completed application to:
 Kansas Department of Agriculture
 Division of Water Resources
 Field Office for your area.

Call for address:

Topeka -- (785) 862-6300
 Stafford -- (620) 234-5311
 Stockton -- (785) 425-6787
 Garden City -- (620) 276-2901
www.ksda.gov/dwr

DWR FIELD OFFICE APPLICATION FOR APPROVAL TO CHANGE THE PLACE OF USE AND/OR THE POINT OF DIVERSION



STATE OF KANSAS

Filing Fee Must Accompany the Application, K.S.A. 82a-708b(b), as amended.
 Fee Schedule is on the third page of this application form.

Paragraph Nos. 1, 2, 3 & 5 must be completed. Complete all other applicable portions. If change in point of diversion is greater than 100 feet, or if place of use will be changed, include a topographic map or detailed plat showing the authorized and proposed point(s) of diversion and/or place of use.

File No. FI 186

RECEIVED
 2:34pm
 MAR 06 2018

1. Application is hereby made for approval of the Chief Engineer to change the (check one or both):
 Place of Use Point of Diversion
 under the water right which is the subject of this application in accordance with the conditions described below,
 The source of supply is: Groundwater Surface water

Garden City Field Office
 Division of Water Resources

2. Name and address of Applicant: THE GARDEN CITY COMPANY
P.O. BOX 597, GARDEN CITY, KS 67846
 Phone Number: (620)276-3246 Email address: troy.dumler@sbcglobal.net
 Name and address of Water Use Correspondent: THE GARDEN CITY COMPANY
P.O. BOX 597, GARDEN CITY, KS 67846
 Phone Number: (620)276-3246 Email address: _____

3. The presently authorized place of use is:
 Owner of Land ---- NAME: THE GARDEN CITY COMPANY
 ADDRESS: P.O. BOX 597, GARDEN CITY, KS 67846
 (If there is more than one landowner, attach supplemental sheets as necessary.)

Sec.	Twp.	Range	NE¼				NW¼				SW¼				SE¼				TOTAL ACRES
			NE¼	NW¼	SW¼	SE¼	NE¼	NW¼	SW¼	SE¼	NE¼	NW¼	SW¼	SE¼	NE¼	NW¼	SW¼	SE¼	

4. If this application is for a change in place of use, it is proposed that the place of use be changed to:
 Owner of Land ---- NAME: NO CHANGE
 ADDRESS: _____
 (If there is more than one landowner, attach supplemental sheets as necessary.)

Sec.	Twp.	Range	NE¼				NW¼				SW¼				SE¼				TOTAL ACRES
			NE¼	NW¼	SW¼	SE¼	NE¼	NW¼	SW¼	SE¼	NE¼	NW¼	SW¼	SE¼	NE¼	NW¼	SW¼	SE¼	

For Office Use Only: Code _____ Fee \$ 100 TR # _____ Receipt Date 3/6/18 Check # 023747

5. **Presently authorized point of diversion:**
 One in the SW Quarter of the NW Quarter of the NW Quarter of Section 19, Township 23 South, Range 34 W, in Finney County, Kansas, 4597 feet North 4971 feet West of Southeast corner of section.
 Authorized Rate 1160 Authorized Quantity 640 Depth of well 290 (feet)
 (DWR use only: Computer ID No. 1 GPS feet North feet West)
 This point will not be changed This point will be changed as follows:
Proposed point of diversion: (Complete only if change is requested)
 One in the NW Quarter of the NW Quarter of the NW Quarter of Section 19, Township 23 South, Range 34 W, in Finney County, Kansas, 4825 feet North 4785 feet West of Southeast corner of section.
 Proposed Rate 1160 Proposed Quantity 640 Proposed well depth (feet) 306
 This point is: Additional Well Geo Center List other water rights that will use this point

6. **Presently authorized point of diversion:**
 One in the Quarter of the Quarter of the Quarter of Section , Township South, Range (E/W), in County, Kansas, feet North feet West of Southeast corner of section.
 Authorized Rate Authorized Quantity Depth of well (feet)
 (DWR use only: Computer ID No. GPS feet North feet West)
 This point will not be changed This point will be changed as follows:
Proposed point of diversion: (Complete only if change is requested)
 One in the Quarter of the Quarter of the Quarter of Section , Township South, Range (E/W), in County, Kansas, feet North feet West of Southeast corner of section.
 Proposed Rate Proposed Quantity Proposed well depth (feet)
 This point is: Additional Well Geo Center List other water rights that will use this point

7. Why do you need a new point of diversion?
Casing failure in old well

8. If a well, is the test hole log attached? Yes No

9. When do you propose to complete the new point of diversion?
August 2018

10. If the point of diversion is a well:
 (a) What are you going to do with the old well?
Plug and abandon
 (b) When will this be done? August 2018

11. Groundwater Management District recommendation attached?
 Yes No

12. Assisted by NA

13a. If the proposed point of diversion will be relocated within 100 feet of the existing point of diversion, indicate its location on

the diagram below in relation to the existing point of diversion. (PLEASE NOTE: The "X" in center of diagram below represents presently authorized point of diversion.)

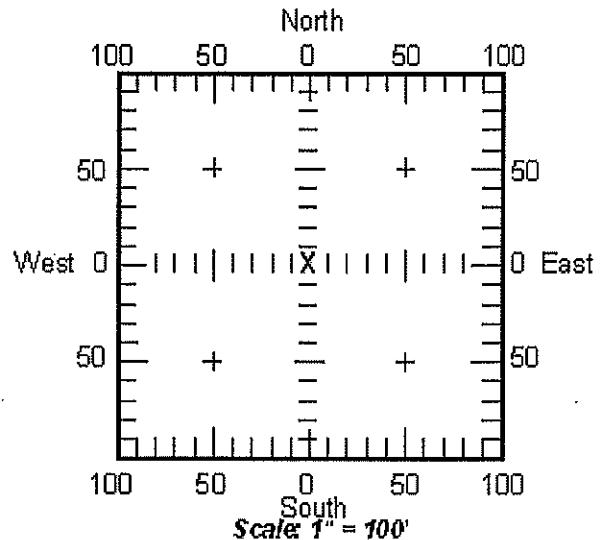

13b. If the proposed point of diversion will be relocated more than 100 feet but within 1320 feet from the existing point of diversion, attach a topographic map or aerial photograph. For groundwater sources, show all wells (including domestic) within one-half mile of the proposed point of diversion and the names and mailing addresses of the owners. For surface water sources, show the names and addresses of the landowner(s) one-half mile downstream and one-half mile upstream from your property lines.

TOPO! map printed on 02/20/18 from "Untitled.tpo"

101.10000° W

NAD27 101.08333° W

38.05000° N

38.03333° N

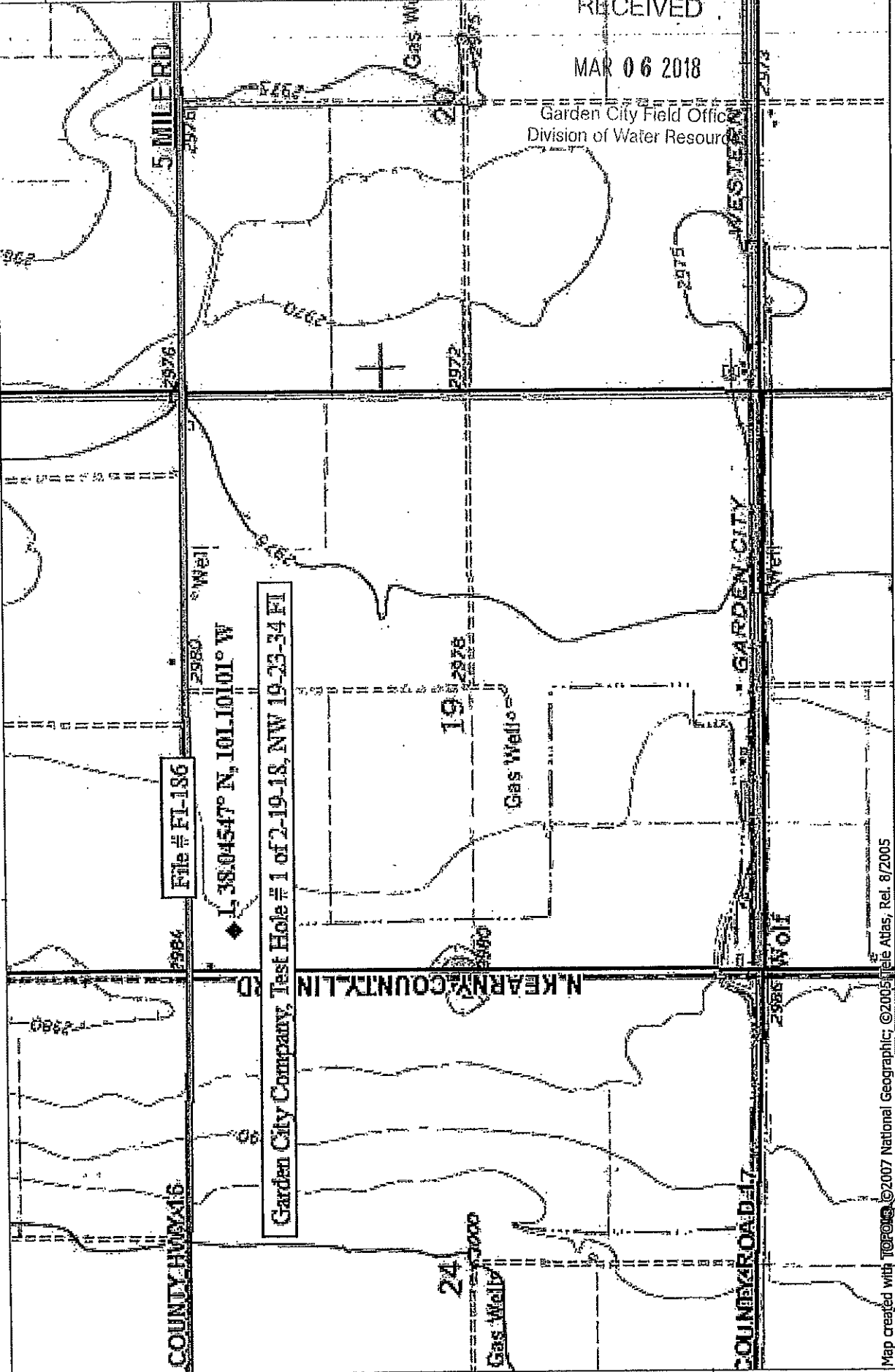

NAD27 101.08333° W

101.10000° W

Map created with TOPO! ©2007 National Geographic; ©2005 Tele Atlas, Rel. 8/2005

NATIONAL GEOGRAPHIC

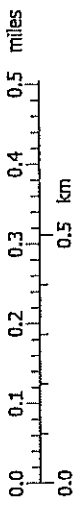

TIN

5/2°

02/20/18

