

Kansas Department of Agriculture
 Division of Water Resources
CHANGE: P/U WORKSHEET

1. File Number: 14287-D1	2. Status Change Date: 5-20-19	3. Change Num: C1	4. Field Office: 4	5. GMD: 3
------------------------------------	------------------------------------------	-----------------------------	------------------------------	---------------------

6. Status: <input checked="" type="checkbox"/> Approved <input type="checkbox"/> Denied by DWR/GMD <input type="checkbox"/> Dismiss by Request/Failure to Return	7. Filing Date of Change: 4/18/19
------------------------------------------------------------------------------------------------------------------------------------------------------------------	---------------------------------------------

8a. Applicant(s) Person ID 29624
 New to system Add Seq# _____

STANTON & DIANE REDGER
622 ROAD S
LAKIN KS 67860-6204

8c. Landowner(s) Person ID _____
 New to system Add Seq# _____

8b. Landowner(s) Person ID _____
 New to system Add Seq# _____

8a

8d. WUC Person ID _____
 New to system Add Seq# _____

8a

9. Documents and Enclosure(s): DWR Meter(s) Date to Comply: 12/31/19 N & P Date to Comply: _____

Anti-Reverse Meter Meter Seal Check Valve N & P Form Water Tube Driller Copy H & E Letter

Conservation Plan Date Required: _____ Date Approved: _____ Date to Comply: _____

10. Use Made of Water From: _____ To: _____

Date Prepared: **4/29/19** By: **AM**
 Date Entered: _____ By: _____

File No. **14287-D1** 11. County: **KE** Basin: **ARKANSAS RIVER** Stream: _____ Formation Code: _____ Special Use: _____

12. Points of Diversion
 CHK _____ Rate and Quantity
 MOD _____ Authorized _____ Additional _____
 DEL PDIV _____
 ENT _____ Qualifier S T R ID 'N 'W Comment (AKA Line) Rate gpm/cfs Quantity af/mgy Rate gpm/cfs Quantity af/mgy Overlap PD Files

NO CHANGE

13. Storage: Rate _____ NF Quantity _____ ac/ft Additional Rate _____ NF Additional Quantity _____ ac/ft

14. Limitation: _____ af/yr at _____ gpm (_____ cfs) when combined with file number(s) _____
 Limitation: _____ af/yr at _____ gpm (_____ cfs) when combined with file number(s) _____

15. 5YR Allocation: Allocation Type _____ Start Year _____ 5 YR Amount _____ Amount Unit _____ Base Acres _____ Comment _____

16. Place of Use CHK MOD DEL ENT	PUSE	S	T	R	ID	NE¼				NW¼				SW¼				SE¼				Total	Owner	Chg?	Overlap Files
						NE ¼	NW ¼	SW ¼	SE ¼	NE ¼	NW ¼	SW ¼	SE ¼	NE ¼	NW ¼	SW ¼	SE ¼	NE ¼	NW ¼	SW ¼	SE ¼				
ENT	14915	9	26S	36W	4									40	40	40	40					160	8a		MULTIPLE
ENT	4895	8	26S	36W	1	40	40	40	40									40	40	40	40	320	8a		MULTIPLE
ENT	949	9	26S	36W	5					40	40	40	40									160	8a		MULTIPLE
CHK	14006	8	26S	36W	3					40	40	40	40									160	8a		MULTIPLE
ENT	3162	5	26S	36W	1						6	13	40	38	23	38		17	10		185	8a		MULTIPLE	

Base Acres: _____ Year: _____ Minimum Reasonable Quantity: _____
 Comments: **OVERLAPPING PU WATER RIGHTS: 14266-D1; 14265; 14273-D1; 17878-D1**

Garden City Field Office
4532 W. Jones, Suite A
Garden City, KS 67846



Phone: 620-276-2901
Fax: 620-276-9315
www.agriculture.ks.gov

Mike Beam, Secretary

Laura Kelly, Governor

May 20, 2019

STANTON & DIANE REDGER
622 ROAD S
LAKIN KS 67860-6204

RE: Water Right, File Nos. 14265, 14266-D1, 14273-D1, 14287-D1, & 17878-D1

Dear Sir and Madam:

Enclosed are orders executed by the designee of the Chief Engineer, Division of Water Resources, Kansas Department of Agriculture, approving the applications for change under the above referenced file numbers.

Your attention is directed to the enclosures and to the terms, conditions, and limitations specified in these approvals for change. A condition of these approvals are that acceptable water flow meters must be installed on the diversion works authorized under the referenced file numbers and meet current specifications. Please return the required notification of completion of the diversion works and installation of the required meters as soon as these actions are completed.

Since these orders modify the original documents referred to above, they should be recorded with the Register of Deeds as other instruments affecting real estate.

Should you have any questions, please feel free to call this office. If you would prefer, you could arrange an appointment for additional assistance.

Sincerely,

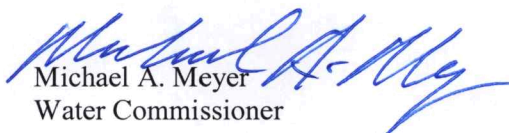
Michael A. Meyer
Water Commissioner

MAM:
enclosures

pc:

GROUNDWATER MANAGEMENT DISTRICT NO. 3

CERTIFICATE OF SERVICE

On this 20th day of May, 2019, I hereby certify that the foregoing Approval of Application for Change in Place of Use, Water Right, File Nos. 14265, 14266-D1, 14273-D1, 14287-D1, 17878-D1 dated 20th day of May, 2019 was mailed postage prepaid, first class, US mail to the following:

STANTON & DIANE REDGER
622 ROAD S
LAKIN KS 67860-6204

Pc:

GROUNDWATER MANAGEMENT DISTRICT NO. 3



Division of Water Resources Staff

Submit completed application to:
 Kansas Department of Agriculture
 Division of Water Resources
 Field Office for your area.

Call for address:

Topeka -- (785) 296-5733
 Stafford -- (620) 234-5311
 Stockton -- (785) 425-6787
 Garden City -- (620) 276-2901
<http://agriculture.ks.gov/dwr>

DWR FIELD OFFICE APPLICATION FOR APPROVAL TO CHANGE THE PLACE OF USE AND/OR THE POINT OF DIVERSION



STATE OF KANSAS

Filing Fee Must Accompany the Application, K.S.A. 82a-708b(b), as amended.
 Fee Schedule is on the third page of this application form.

Paragraph Nos. 1, 2, 3 & 5 must be completed. Complete all other applicable portions. If change in point of diversion is greater than 100 feet, or if place of use will be changed, include a topographic map or detailed plat showing the authorized and proposed point(s) of diversion and/or place of use.

File No. 14287 D1

RECEIVED
 3:33pm
 APR 18 2019

Garden City Field Office
 DIVISION OF WATER RESOURCES

1. Application is hereby made for approval of the Chief Engineer to change the (check one or both):

Place of Use Point of Diversion

under the water right which is the subject of this application in accordance with the conditions described below.

The source of supply is: Groundwater Surface water

2. Name and address of Applicant: STANTON & DIANE REDGER

622 ROAD S, LAKIN, KS 67860

Phone Number: () Email address: _____

Name and address of Water Use Correspondent: SAME AS ABOVE

Phone Number: () Email address: _____

3. The presently authorized place of use is:

Owner of Land ---- NAME: STANTON & DIANE REDGER

ADDRESS: 622 ROAD S, LAKIN, KS 67860

(If there is more than one landowner, attach supplemental sheets as necessary.)

Sec.	Twp.	Range	NE¼				NW¼				SW¼				SE¼				TOTAL ACRES
			NE¼	NW¼	SW¼	SE¼	NE¼	NW¼	SW¼	SE¼	NE¼	NW¼	SW¼	SE¼	NE¼	NW¼	SW¼	SE¼	
8	26	36W					40	40	40	40									160

4. If this application is for a change in place of use, it is proposed that the place of use be changed to:

Owner of Land ---- NAME: STANTON & DIANE REDGER

ADDRESS: 622 ROAD S, LAKIN, KS 67860

(If there is more than one landowner, attach supplemental sheets as necessary.)

Sec.	Twp.	Range	NE¼				NW¼				SW¼				SE¼				TOTAL ACRES
			NE¼	NW¼	SW¼	SE¼	NE¼	NW¼	SW¼	SE¼	NE¼	NW¼	SW¼	SE¼	NE¼	NW¼	SW¼	SE¼	
5	26	36W							6	13	40	38	23	38		17	10		185
8	26	36W	40	40	40	40	40	40	40	40					40	40	40	40	480
9	26	36W					40	40	40	40	40	40	40	40					320

For Office Use Only: Code _____ Fee \$ 200.00 TR # _____ Receipt Date 4-18-19 Check # Credit Card

5. **Presently authorized point of diversion:**
 One in the _____ Quarter of the _____ Quarter of the _____ Quarter
 of Section _____, Township _____ South, Range _____ (E/W),
 in _____ County, Kansas, _____ feet North _____ feet West of Southeast corner of section.
 Authorized Rate _____ Authorized Quantity _____ Depth of well _____ (feet)
 (DWR use only: Computer ID No. _____ GPS _____ feet North _____ feet West)
 This point will not be changed This point will be changed as follows: No change, point better described with GPS as follows:
Proposed point of diversion: (Complete only if change is requested or if existing point is better described by GPS)
 One in the _____ Quarter of the _____ Quarter of the _____ Quarter
 of Section _____, Township _____ South, Range _____ (E/W),
 in _____ County, Kansas, _____ feet North _____ feet West of Southeast corner of section.
 Proposed Rate _____ Proposed Quantity _____ Proposed well depth (feet) _____
 This point is: Additional Well Geo Center List other water rights that will use this point _____

6. **Presently authorized point of diversion:**
 One in the _____ Quarter of the _____ Quarter of the _____ Quarter
 of Section _____, Township _____ South, Range _____ (E/W),
 in _____ County, Kansas, _____ feet North _____ feet West of Southeast corner of section.
 Authorized Rate _____ Authorized Quantity _____ Depth of well _____ (feet)
 (DWR use only: Computer ID No. _____ GPS _____ feet North _____ feet West)
 This point will not be changed This point will be changed as follows: No change, point better described with GPS as follows:
Proposed point of diversion: (Complete only if change is requested or if existing point is better described by GPS)
 One in the _____ Quarter of the _____ Quarter of the _____ Quarter
 of Section _____, Township _____ South, Range _____ (E/W),
 in _____ County, Kansas, _____ feet North _____ feet West of Southeast corner of section.
 Proposed Rate _____ Proposed Quantity _____ Proposed well depth (feet) _____
 This point is: Additional Well Geo Center List other water rights that will use this point _____

7. The changes herein are desired for the following reasons?
 (please be specific) OVERLAP ALL WELLS TO
ALL PLACES OF USE.

8. If a well, is the test hole log attached? Yes No

9. The change(s) (was)(will be) completed by?
UPON APPROVAL

10. If the point of diversion is a well:
 (a) What are you going to do with the old well?

 (b) When will this be done? _____

11. Groundwater Management District recommendation attached?
 Yes No

12. Assisted by BSC

13a. If the proposed point of diversion will be relocated more than 300 feet but within 2,640 feet of the existing point of diversion, attach a topographic map or aerial photograph. For groundwater sources, show all wells (including domestic) within one-half mile of the proposed point of diversion and the names and mailing addresses of the owners. For surface water sources, show the names and addresses of the landowner(s) one-half mile downstream and one-half mile upstream from your property lines

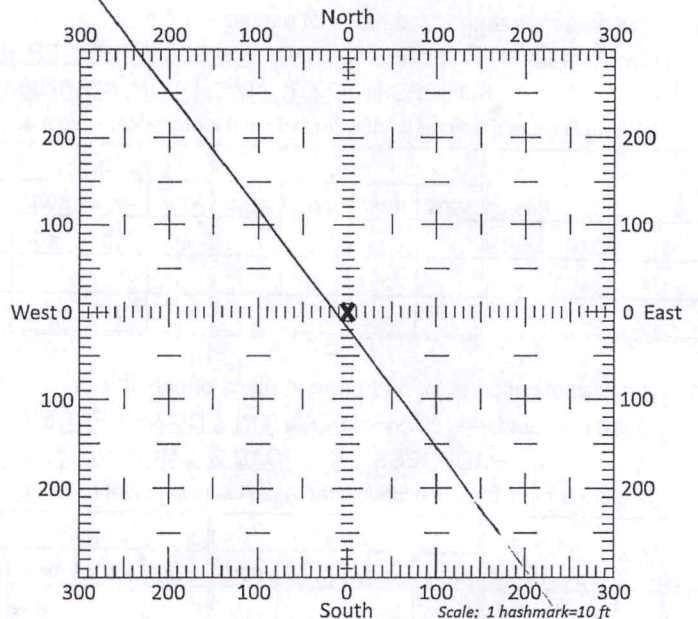

13b. If the proposed point of diversion will be relocated within 300 feet of the existing point of diversion, indicate its location on the diagram shown above in relation to the existing point of diversion. (PLEASE NOTE: The "X" in center of diagram above represents the presently authorized point of diversion.)

14. If the proposed groundwater point of diversion is 300 or fewer feet from the existing point of diversion, complete the following:

- (a) Does the undersigned represent all owners of the currently authorized place(s) of use identified in this application?
 Yes No (If no, all owners must sign this application.)
- (b) Will the ownership interest of any owner of the currently authorized place(s) of use identified in this application be adversely affected if this application is approved as requested?
 Yes No (If yes, all owners must sign this application.)
- (c) If this application is not approved expeditiously, will there be substantial damage to property, public health or safety?
 Yes No (If no, all owners must sign this application.)

If the application proposes a surface water change in point of diversion, a groundwater change in point of diversion greater than 300 feet, or a change in place of use, the application must be signed by all owners of the currently authorized place of use, or their duly authorized agent (attach notarized statement authorizing representation).

I hereby verify, being first duly sworn upon my oath or affirmation and under penalty of perjury, that I am of lawful age and the owner, the spouse of the owner, or a duly authorized agent of the owner(s) to make this application on their behalf, in regards to the water right(s) to which this application pertains. I further verify that the statements contained in this application are true, correct and complete.

Dated at Garden City, Kansas, this 18th day of April, 2019.

Stanton Redger
(Owner)

Stanton Redger
(Please Print)

(Owner)

(Please Print)

(Owner)

(Please Print)

Diane Redger
(Spouse)

Diane Redger
(Please Print)

(Spouse)

(Please Print)

(Spouse)

(Please Print)

State of Kansas }
County of Jinney } SS

I hereby certify that the foregoing application was signed in my presence and sworn to before me this 18th day of April, 2019.



Julie Jones
Notary Public

My Commission Expires _____

ONLY COMPLETE APPLICATIONS WILL BE PROCESSED. To be complete, all of the applicable portions of the application form must be completed with accurate information; maps, if necessary, must be included; signatures of all the appropriate owners' must be affixed to the application and notarized; and the appropriate fee must be paid.

FEE SCHEDULE

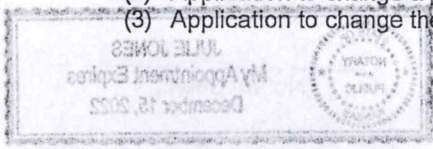

Each application to change the place of use or the point of diversion under this section shall be accompanied by the application fee set forth in the schedule below: Make checks payable to: **Kansas Department of Agriculture**

- (1) Application to change a point of diversion 300 feet or less \$100
- (2) Application to change a point of diversion more than 300 feet \$200
- (3) Application to change the place of use \$200



Change in Place of Use for Water Right 14287 D1 Sections 5, 8 & 9, Township 25 South, Range 36 West, Kearny County



-  Authorized Place of Use
-  Proposed Place of Use

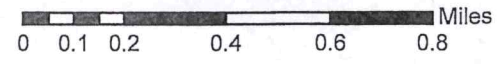

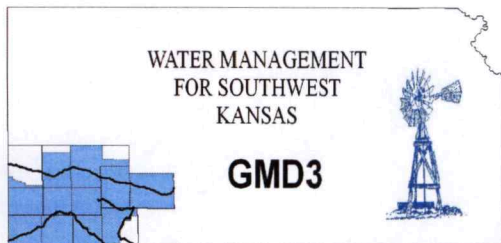

Southwest Kansas
Groundwater Management District No. 3
2009 E. Spruce Street
Garden City, Kansas 67846
(620) 275-7147 phone (620) 275-1431 fax
www.gmd3.org

April 30, 2019

Michael A. Meyer
Division of Water Resources
2508 N Johns Street
Garden City, Kansas 67846

RE: Applications for Change in Place of Use
Water Right, File Nos. 14265, 14266 D1, 14273 D1, 14287 D1 & 17878 D1

Dear Mike:

We have completed a review of the applications for the above referenced water rights. The proposals are not in conflict with the Management Program of the Southwest Kansas Groundwater Management District No. 3 (GMD3). The proposed change in place of use for a complete overlap in irrigation acres is in accordance with K.A.R. 5-5-11(b)(1). It is therefore recommended that the applications be approved at this time.

Thank you for the opportunity to review the applications and to provide a recommendation. If you have any questions, please don't hesitate to contact us.

Sincerely,

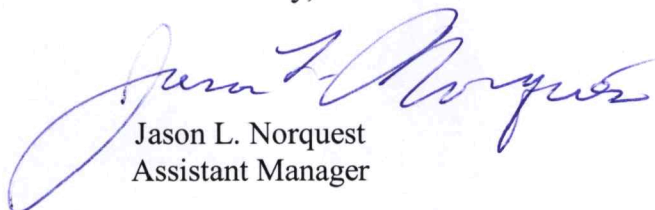
A handwritten signature in blue ink, which appears to read "Jason L. Norquest".

Jason L. Norquest
Assistant Manager

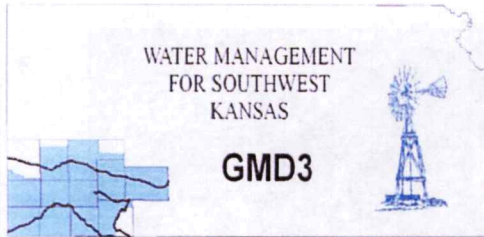

Southwest Kansas
Groundwater Management District No. 3
2009 E. Spruce Street
Garden City, Kansas 67846
(620) 275-7147 phone (620) 275-1431 fax
www.gmd3.org

April 30, 2019

Michael A. Meyer
Division of Water Resources
2508 N Johns Street
Garden City, Kansas 67846

RE: Applications for Change in Place of Use
Water Right, File Nos. 14265, 14266 D1, 14273 D1, 14287 D1 & 17878 D1

Dear Mike:

We have completed a review of the applications for the above referenced water rights. The proposals are not in conflict with the Management Program of the Southwest Kansas Groundwater Management District No. 3 (GMD3). The proposed change in place of use for a complete overlap in irrigation acres is in accordance with K.A.R. 5-5-11(b)(1). It is therefore recommended that the applications be approved at this time.

Thank you for the opportunity to review the applications and to provide a recommendation. If you have any questions, please don't hesitate to contact us.

Sincerely,

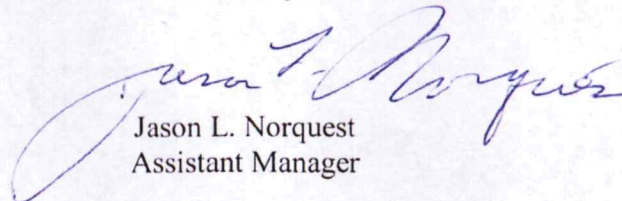

Jason L. Norquest
Assistant Manager

Redger Apps: PU overlap

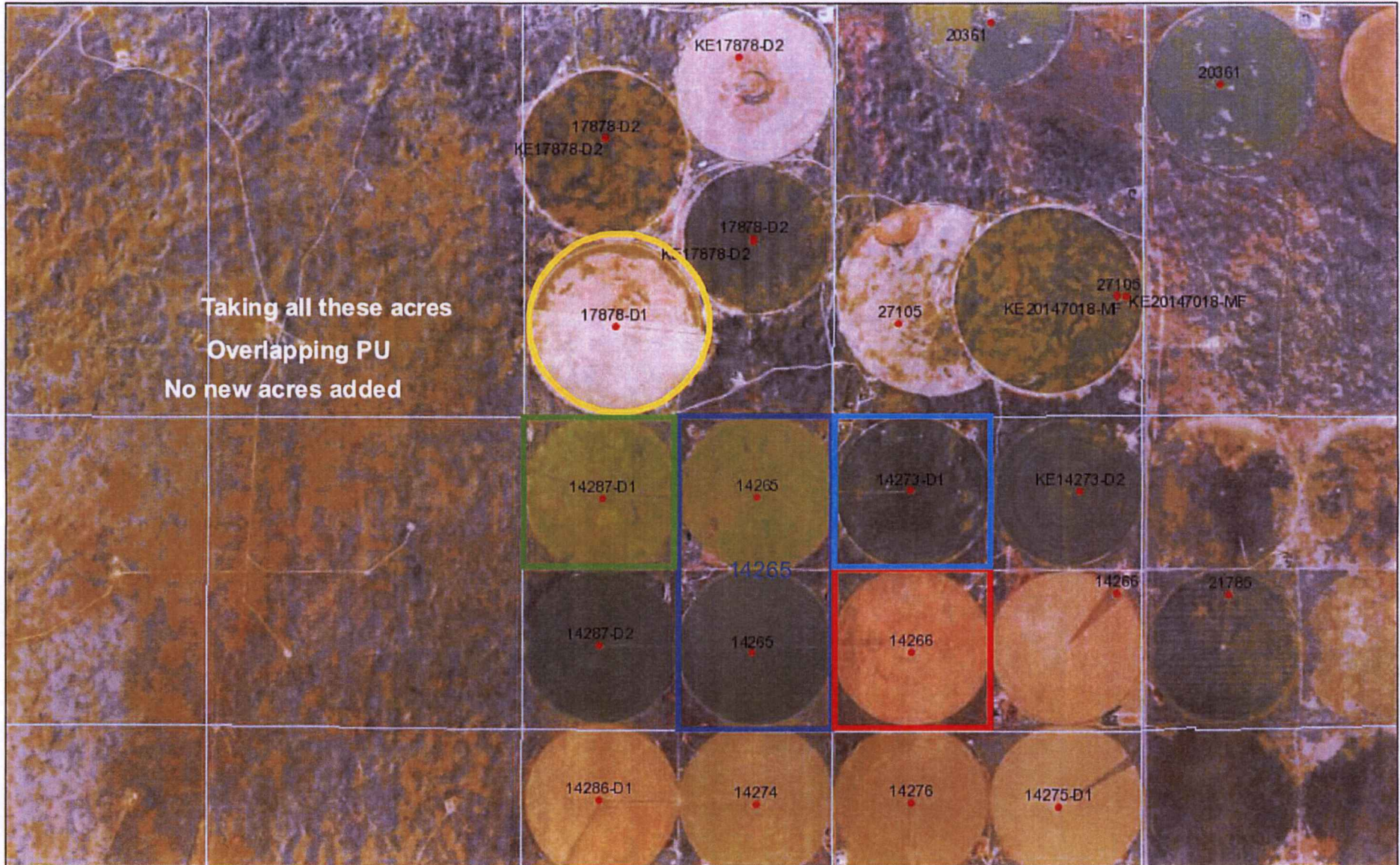

April 30, 2019
10:07 AM

DISCLAIMER: This map is not intended for conveyances, nor is it a legal survey. The information is presented on a best-efforts basis, and should not be relied upon for making financial, survey, legal or other commitments.

1:36,112

Wells	+	CON	■	FPR	▲	MUN	⚡	THX	
?	Other	⊠	DEW	○	HYD	▢	REC	?	Empty
•	IRR	•	DOM	★	IND	⊗	STK	Sections	

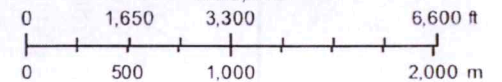

GMD3 Change Review

File No(s): 14265, 14266D1, 14273D1, 14287D1 & 17878D1. DWR office: GC.

App filed to change: PU.

Is Landowner(s) correct in WRIS: Stanton & Diane Redger.

If NO, is documentation included?

Is Water Use Correspondent correct in WRIS? ___.

If NO, is documentation included?

Regulation(s) Reviewed: KAR 5-5-11

Point of diversion ID No(s) ___ being changed.

	ft. North	ft. West
Authorized PD		
Proposed PD		
<hr/>		
Difference	0	0
$a^2 + b^2 = c^2$	0	0
<hr/>		

GPS for proposed PD: Lat: ___ Long: ___.

Is proposed PD stacking on existing WRs? No Change.

Is Proposed PU overlapping existing WRs? This will make a complete overlap on the acres.

Land Owner(s) notified: ___.

Name ___. Name ___.

Address ___. Address ___.

Zip ___. Zip ___.

Neighboring certified well(s) notified: ___.

Name ___. Name ___.

Address ___. Address ___.

Zip ___. Zip ___.

Domestic well(s) notified: ___.

Name ___. Name ___.

Address ___. Address ___.

Zip ___. Zip ___.

Base Acres: ___.

Perfected Acres: ___.

Irr. Return-Flow ___%

Is a waiver needed: NO. Apps to overlap acres on all WRs. No new acres that are not currently covered are being applied for.

Recommendation: The apps meets all current area rules. Staff therefore recommends approval of the applications.



Garden City Field Office
4532 W. Jones, Suite A
Garden City, KS 67846



Phone: 620-276-2901
Fax: 620-276-9315
www.agriculture.ks.gov

Mike Beam, Secretary

Laura Kelly, Governor

April 29, 2019

SOUTHWEST KANSAS GROUNDWATER
MANAGEMENT DISTRICT NO. 3
409 CAMPUS DRIVE, SUITE 106
GARDEN CITY KS 67846

Re: Water Right
File Nos. 14265, 14266-D1, 14273-D1, 14287-D1, 17878-D1

Dear Mr. Norquest:

This is to advise you that Stanton Redger has filed applications for approval of the Chief Engineer, Division of Water Resources, Kansas Department of Agriculture, to change the place of use for the above referenced files.

We are delaying action on the change applications to allow you time to review and provide a recommendation. Please submit a recommendation within 15 days from the date of this letter.

Thank you and as always feel free to contact this office at any time.

Sincerely,

A handwritten signature in blue ink, appearing to read "Michael A. Meyer".

Michael A. Meyer
Water Commissioner

MAM
Enclosures