

Kansas Department of Agriculture
 Division of Water Resources
CHANGE: P/U WORKSHEET

1. File Number: 14703	2. Status Change Date:	3. Change Num: C4	4. Field Office: 4	5. GMD: 3
---------------------------------	------------------------	-----------------------------	------------------------------	---------------------

6. Status: <input checked="" type="checkbox"/> Approved <input type="checkbox"/> Denied by DWR/GMD <input type="checkbox"/> Dismiss by Request/Failure to Return	7. Filing Date of Change: 8/7/2019
--	--

8a. Applicant(s) Person ID 25213 New to system <input type="checkbox"/> Add Seq# _____ GREGORY C & SUE LOVE 24506 13 RD MONTEZUMA KS 67867-9073	8c. Landowner(s) Person ID 41565 New to system <input type="checkbox"/> Add Seq# _____ LOVE AG COMPANY GREG LOVE 24506 13 RD MONTEZUMA KS 67867-9073
--	---

8b. Landowner(s) Person ID 10737 New to system <input type="checkbox"/> Add Seq# _____ CARL L LOVE POA GREG LOVE OR CARLS SON 24506 13 ROAD MONTEZUMA KS 67867-9073	8d. WUC Person ID _____ New to system <input type="checkbox"/> Add Seq# _____ 8a
--	--

9. Documents and Enclosure(s): <input checked="" type="checkbox"/> DWR Meter(s) Date to Comply: 12/31/19 <input type="checkbox"/> N & P Date to Comply: _____	
<input type="checkbox"/> Anti-Reverse Meter <input type="checkbox"/> Meter Seal <input type="checkbox"/> Check Valve <input type="checkbox"/> N & P Form <input type="checkbox"/> Water Tube <input type="checkbox"/> Driller Copy <input type="checkbox"/> H & E Letter	
<input type="checkbox"/> Conservation Plan Date Required: _____ Date Approved: _____ Date to Comply: _____	

10. Use Made of Water From: _____ To: _____

Date Prepared: 8/14/2019 By: AM
Date Entered: _____ By: _____

File No. **14703** 11. County: **GY** Basin: **ARKANSAS RIVER** Stream: _____ Formation Code: _____ Special Use: _____

12. Points of Diversion
 CHK
 MOD
 DEL PDIV
 ENT Qualifier S T R ID 'N 'W Comment (AKA Line) Rate gpm/cfs Quantity af/mgy Rate gpm/cfs Quantity af/mgy Overlap PD Files

CHK 76541

13. Storage: Rate _____ NF Quantity _____ ac/ft Additional Rate _____ NF Additional Quantity _____ ac/ft

14. Limitation: _____ af/yr at _____ gpm (_____ cfs) when combined with file number(s) _____
 Limitation: _____ af/yr at _____ gpm (_____ cfs) when combined with file number(s) _____

15. 5YR Allocation: Allocation Type _____ Start Year _____ 5 YR Amount _____ Amount Unit _____ Base Acres _____ Comment _____

16. Place of Use CHK MOD DEL ENT	PUSE	S	T	R	ID	NE¼				NW¼				SW¼				SE¼				Total	Owner	Chg?	Overlap Files
						NE ¼	NW ¼	SW ¼	SE ¼	NE ¼	NW ¼	SW ¼	SE ¼	NE ¼	NW ¼	SW ¼	SE ¼	NE ¼	NW ¼	SW ¼	SE ¼				
MOD 26100	31	27S28W	3							32.5	L-1 32.5	L-2 32.5	32.5	32.5	L-3 32.5	L-4 32.5	32.5					260	8a		MULTIPLE
MOD 31341	31	27S28W	1			32.5	32.5	32.5	32.5													130	8b		MULTIPLE
ENT	25	27S29W				29	33	40	24	38	23	33	40	38	23			34	40	34	34	463	8a		MULTIPLE
DEL 32013; 25628; 33737																									
MOD 9805	36	27S29W	2			32	32	32	32	32	32	32	32					30	30	30	30	376	8c		MULTIPLE
ENT 306	29	27S28W	1							31	31	31	31	31	31	31	31	31	31	31	31	372	8c		MULTIPLE

Base Acres: **255** Year: _____ Minimum Reasonable Quantity: _____
 Comments: **OVERLAPPING WR ON PLACE OF USE: 14536; 14703; 17891; 21362; 26293; 27702; 28636; 28648; 31626**

Garden City Field Office
4532 W. Jones, Suite B
Garden City, KS 67846



Phone: 620-276-2901
Fax: 620-276-9315
www.agriculture.ks.gov

Mike Beam, Secretary

Laura Kelly, Governor

August 15, 2019

GREGORY C & SUE LOVE
24506 13 RD
MONTEZUMA KS 67867-9073

RE: Water Right, File Nos. 14536; 14703; 17891; 21362; 26293; 27702; 28636; 28648; 31626

Dear Sir or Madam:

Enclosed are the orders executed by the designee of the Chief Engineer, Division of Water Resources, Kansas Department of Agriculture, approving the applications for change under the above referenced file numbers.

Your attention is directed to the enclosures and to the terms, conditions, and limitations specified in these approvals for change. A condition of these approvals is that an acceptable water flow meter must be installed on the diversion works authorized under the referenced file numbers and meet current specifications. Please return the required notifications of completion of the diversion works and/or installation of the required meter as soon as these actions are completed.

Since the order modifies the original documents referred to above, they should be recorded with the Register of Deeds as other instruments affecting real estate.

Should you have any questions, please feel free contact this office. If you would prefer, you could arrange an appointment for additional assistance.

Sincerely,

A handwritten signature in blue ink that reads "Austin J. McColloch".

Austin J. McColloch
Assistant Water Commissioner

AM:
enclosures

pc:
GROUNDWATER MANAGEMENT DISTRICT NO. 3

CERTIFICATE OF SERVICE

On this 15th day of August, 2019, I hereby certify that the foregoing Approval of Application for Change in Place of Use, Water Right, File Nos. 14536; 14703; 17891; 21362; 26293; 27702; 28636; 28648; 31626 dated 15th day of August, 2019 was mailed postage prepaid, first class, US mail to the following:

GREGORY C & SUE LOVE
24506 13 RD
MONTEZUMA KS 67867-9073

Pc:

GROUNDWATER MANAGEMENT DISTRICT NO. 3

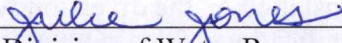

Julie Jones
Division of Water Resources Staff

Submit completed application to:
 Kansas Department of Agriculture
 Division of Water Resources
 Field Office for your area.
 Call for address:

Topeka -- (785) 296-5733
 Stafford -- (620) 234-5311
 Stockton -- (785) 425-6787
 Garden City -- (620) 276-2901
<http://agriculture.ks.gov/dwr>

DWR FIELD OFFICE APPLICATION FOR APPROVAL TO CHANGE THE PLACE OF USE AND/OR THE POINT OF DIVERSION



STATE OF KANSAS

Filing Fee Must Accompany the Application, K.S.A. 82a-708b(b), as amended.
 Fee Schedule is on the third page of this application form.

Paragraph Nos. 1, 2, 3 & 5 must be completed. Complete all other applicable portions. If change in point of diversion is greater than 100 feet, or if place of use will be changed, include a topographic map or detailed plat showing the authorized and proposed point(s) of diversion and/or place of use.

RECEIVED

AUG 07 2019

4:40

Garden City Field Office
 Division of Water Resources

File No. 14703

1. Application is hereby made for approval of the Chief Engineer to change the (check one or both):

Place of Use Point of Diversion

under the water right which is the subject of this application in accordance with the conditions described below.

The source of supply is: Groundwater Surface water

2. Name and address of Applicant: Gregory C & Sue Love

24506 13 RD, Montezuma, KS 67867

Phone Number: (620)8460222

Email address: greg.c.love@gmail.com

Name and address of Water Use Correspondent: SAME

Phone Number: ()

Email address: _____

3. The presently authorized place of use is:

Owner of Land ---- NAME: Gregory C & Sue Love

ADDRESS: 24506 13RD, Montezuma, KS 67867

(If there is more than one landowner, attach supplemental sheets as necessary.)

Sec.	Twp.	Range	NE¼				NW¼				SW¼				SE¼				TOTAL ACRES
			NE¼	NW¼	SW¼	SE¼	NE¼	NW¼	SW¼	SE¼	NE¼	NW¼	SW¼	SE¼	NE¼	NW¼	SW¼	SE¼	
25	27s	29w	40.0	40.0	40.0	33.7			40.0	40.0	40.0	40.0	40.0	40.0	40.0	40.0	40.0	40.0	437.7
31	27s	28w					34.0	34.0	34.0	34.0	34.0	34.0	34.0	34.0					272.0

4. If this application is for a change in place of use, it is proposed that the place of use be changed to:

Owner of Land ---- NAME: Gregory C & Sue Love

ADDRESS: 24506 13 RD, Montezuma, KS 67867

(If there is more than one landowner, attach supplemental sheets as necessary.)

Sec.	Twp.	Range	NE¼				NW¼				SW¼				SE¼				TOTAL ACRES
			NE¼	NW¼	SW¼	SE¼	NE¼	NW¼	SW¼	SE¼	NE¼	NW¼	SW¼	SE¼	NE¼	NW¼	SW¼	SE¼	
25	27s	29w	29.0	33.0	40.0	24.0	38.0	23.0	33.0	40.0	38.0	23.0			34.0	40.0	34.0	34.0	463.0
31	27s	28w					32.5	32.5	32.5	32.5	32.5	32.5	32.5	32.5					260.0

For Office Use Only: Code _____ Fee \$ 200 TR # _____ Receipt Date 8-7-19 Check # 6128

5. **Presently authorized point of diversion:**
 One in the NW Quarter of the SW Quarter of the SE Quarter
 of Section 25, Township 27 South, Range 29 W,
 in GRAY County, Kansas, 940 feet North 2520 feet West of Southeast corner of section.
 Authorized Rate 1040gpm Authorized Quantity 249AF Depth of well _____ (feet)
(DWR use only: Computer ID No. _____ GPS _____ feet North _____ feet West)
 This point will not be changed This point will be changed as follows: No change, point better described with GPS as follows:
Proposed point of diversion: (Complete only if change is requested or if existing point is better described by GPS)
 One in the _____ Quarter of the _____ Quarter of the _____ Quarter
 of Section _____, Township _____ South, Range _____ (E/W),
 in _____ County, Kansas, _____ feet North _____ feet West of Southeast corner of section.
 Proposed Rate _____ Proposed Quantity _____ Proposed well depth (feet) _____
 This point is: Additional Well Geo Center List other water rights that will use this point _____

6. **Presently authorized point of diversion:**
 One in the _____ Quarter of the _____ Quarter of the _____ Quarter
 of Section _____, Township _____ South, Range _____ (E/W),
 in _____ County, Kansas, _____ feet North _____ feet West of Southeast corner of section.
 Authorized Rate _____ Authorized Quantity _____ Depth of well _____ (feet)
(DWR use only: Computer ID No. _____ GPS _____ feet North _____ feet West)
 This point will not be changed This point will be changed as follows: No change, point better described with GPS as follows:
Proposed point of diversion: (Complete only if change is requested or if existing point is better described by GPS)
 One in the _____ Quarter of the _____ Quarter of the _____ Quarter
 of Section _____, Township _____ South, Range _____ (E/W),
 in _____ County, Kansas, _____ feet North _____ feet West of Southeast corner of section.
 Proposed Rate _____ Proposed Quantity _____ Proposed well depth (feet) _____
 This point is: Additional Well Geo Center List other water rights that will use this point _____

7. The changes herein are desired for the following reasons?
 (please be specific) _____
 Make complete overlap in place of use _____

8. If a well, is the test hole log attached? Yes No

9. The change(s) (was)(will be) completed by?

10. If the point of diversion is a well:
 (a) What are you going to do with the old well?

 (b) When will this be done? _____

11. Groundwater Management District recommendation attached?
 Yes No

12. Assisted by JLN/GMD3

13a. If the proposed point of diversion will be relocated more than 300 feet but within 2,640 feet of the existing point of diversion, attach a topographic map or aerial photograph. For groundwater sources, show all wells (including domestic) within one-half mile of the proposed point of diversion and the names and mailing addresses of the owners. For surface water sources, show the names and addresses of the landowner(s) one-half mile downstream and one-half mile upstream from your property lines

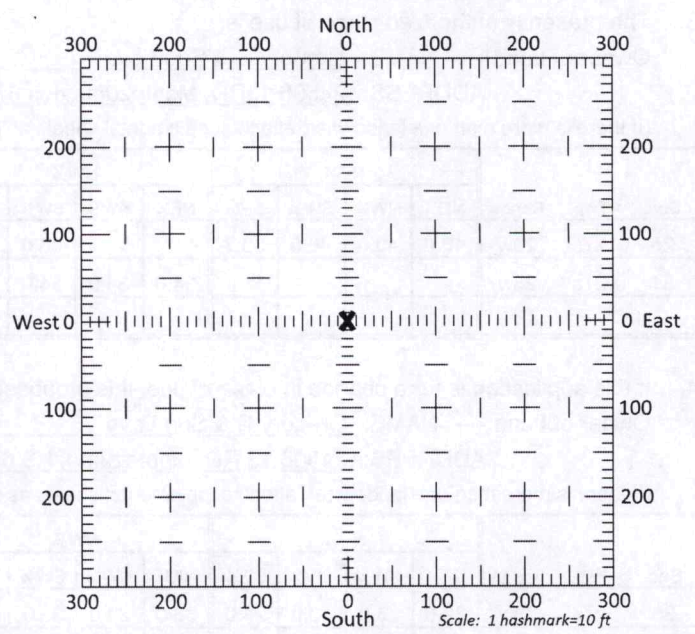

13b. If the proposed point of diversion will be relocated within 300 feet of the existing point of diversion, indicate its location on the diagram shown above in relation to the existing point of diversion. (PLEASE NOTE: The "X" in center of diagram above represents the presently authorized point of diversion.)

APPLICATION FOR APPROVAL TO CHANGE
THE PLACE OF USE AND/OR POINT OF DIVERSION
SUPPLEMENTAL SHEET

FILE NO. _____
MAKE ADDITIONAL COPIES AS NECESSARY

3. Continued: The presently authorized place of use is:

* Am
GLFO

Owner of Land ---- NAME: Greg C & Sue Love
ADDRESS: 24506 13 RD Montezuma KS 67867

Sec.	Twp.	Range	NE¼				NW¼				SW¼				SE¼				TOTAL ACRES
			NE¼	NW¼	SW¼	SE¼	NE¼	NW¼	SW¼	SE¼	NE¼	NW¼	SW¼	SE¼	NE¼	NW¼	SW¼	SE¼	
31	27S	28W	34	34	34	34												136	

Owner of Land ---- NAME: Love AG Company
ADDRESS: 24506 13 RD, Montezuma, KS 67867

Sec.	Twp.	Range	NE¼				NW¼				SW¼				SE¼				TOTAL ACRES
			NE¼	NW¼	SW¼	SE¼	NE¼	NW¼	SW¼	SE¼	NE¼	NW¼	SW¼	SE¼	NE¼	NW¼	SW¼	SE¼	
36	27S	29W	32	32	32	32	32	32	32	32	32	32	32	32	32	32	32	392	

Owner of Land ---- NAME: _____
ADDRESS: _____

Sec.	Twp.	Range	NE¼				NW¼				SW¼				SE¼				TOTAL ACRES
			NE¼	NW¼	SW¼	SE¼	NE¼	NW¼	SW¼	SE¼	NE¼	NW¼	SW¼	SE¼	NE¼	NW¼	SW¼	SE¼	

4. Continued: If this application is for a change in place of use, it is proposed that the place of use be changed to:

Owner of Land ---- NAME: Greg C. & Sue Love
ADDRESS: 24506 13 RD, Montezuma, KS 67867

Sec.	Twp.	Range	NE¼				NW¼				SW¼				SE¼				TOTAL ACRES
			NE¼	NW¼	SW¼	SE¼	NE¼	NW¼	SW¼	SE¼	NE¼	NW¼	SW¼	SE¼	NE¼	NW¼	SW¼	SE¼	
31	27s	28w	32.5	32.5	32.5	32.5												130.0	

Owner of Land ---- NAME: Love AG Company
ADDRESS: 24506 13 RD, Montezuma, KS 67867

Sec.	Twp.	Range	NE¼				NW¼				SW¼				SE¼				TOTAL ACRES
			NE¼	NW¼	SW¼	SE¼	NE¼	NW¼	SW¼	SE¼	NE¼	NW¼	SW¼	SE¼	NE¼	NW¼	SW¼	SE¼	
36	27s	29w	32.0	32.0	32.0	32.0	32.0	32.0	32.0	32.0	32.0	32.0	32.0	32.0	32.0	32.0	32.0	376.0	
29	27s	28w					31.0	31.0	31.0	31.0	31.0	31.0	31.0	31.0	31.0	31.0	31.0	372.0	

Owner of Land ---- NAME: _____
ADDRESS: 24506 13 RD, Montezuma, KS 67867

Sec.	Twp.	Range	NE¼				NW¼				SW¼				SE¼				TOTAL ACRES
			NE¼	NW¼	SW¼	SE¼	NE¼	NW¼	SW¼	SE¼	NE¼	NW¼	SW¼	SE¼	NE¼	NW¼	SW¼	SE¼	

14. If the proposed groundwater point of diversion is 300 or fewer feet from the existing point of diversion, complete the following:

- (a) Does the undersigned represent all owners of the currently authorized place(s) of use identified in this application?
 Yes No (If no, all owners must sign this application.)
- (b) Will the ownership interest of any owner of the currently authorized place(s) of use identified in this application be adversely affected if this application is approved as requested?
 Yes No (If yes, all owners must sign this application.)
- (c) If this application is not approved expeditiously, will there be substantial damage to property, public health or safety?
 Yes No (If no, all owners must sign this application.)

If the application proposes a surface water change in point of diversion, a groundwater change in point of diversion greater than 300 feet, or a change in place of use, the application must be signed by all owners of the currently authorized place of use, or their duly authorized agent (attach notarized statement authorizing representation).

I hereby verify, being first duly sworn upon my oath or affirmation and under penalty of perjury, that I am of lawful age and the owner, the spouse of the owner, or a duly authorized agent of the owner(s) to make this application on their behalf, in regards to the water right(s) to which this application pertains. I further verify that the statements contained in this application are true, correct and complete.

Dated at _____, Kansas, this _____ day of _____, 20_____.

(Owner)	<i>Susan M. Love</i> (Spouse)
(Please Print)	<i>SUSAN M. LOVE</i> (Please Print)
(Owner)	(Spouse)
(Please Print)	(Please Print)
(Owner)	(Spouse)
(Please Print)	(Please Print)

State of Missouri }
 County of Jackson } SS

ADAM CARRETT SHULYAN
 NOTARY PUBLIC - NOTARY # 12241
 STATE OF MISSOURI - JACKSON COUNTY
 COMMISSION # 140000316
 MY COMMISSION EXPIRES APR 1, 2022

I hereby certify that the foregoing application was signed in my presence and sworn to before me this 6th day of August, 2019.

Adam Carrett Shulyan
 Notary Public
 Notary for Susan Love only

My Commission Expires 4-1-22

ONLY COMPLETE APPLICATIONS WILL BE PROCESSED. To be complete, all of the applicable portions of the application form must be completed with accurate information; maps, if necessary, must be included; signatures of all the appropriate owners must be affixed to the application and notarized; and the appropriate fee must be paid.

FEE SCHEDULE

Each application to change the place of use or the point of diversion under this section shall be accompanied by the application fee set forth in the schedule below. Make checks payable to: **Kansas Department of Agriculture**

(1) Application to change a point of diversion 300 feet or less	\$100
(2) Application to change a point of diversion more than 300 feet	\$200
(3) Application to change the place of use	\$200

14. If the proposed groundwater point of diversion is 300 or fewer feet from the existing point of diversion, complete the following:

- (a) Does the undersigned represent all owners of the currently authorized place(s) of use identified in this application?
 Yes No (If no, all owners must sign this application.)
- (b) Will the ownership interest of any owner of the currently authorized place(s) of use identified in this application be adversely affected if this application is approved as requested?
 Yes No (If yes, all owners must sign this application.)
- (c) If this application is not approved expeditiously, will there be substantial damage to property, public health or safety?
 Yes No (If no, all owners must sign this application.)

If the application proposes a surface water change in point of diversion, a groundwater change in point of diversion greater than 300 feet, or a change in place of use, the application must be signed by all owners of the currently authorized place of use, or their duly authorized agent (attach notarized statement authorizing representation).

I hereby verify, being first duly sworn upon my oath or affirmation and under penalty of perjury, that I am of lawful age and the owner, the spouse of the owner, or a duly authorized agent of the owner(s) to make this application on their behalf, in regards to the water right(s) to which this application pertains. I further verify that the statements contained in this application are true, correct and complete.

Dated at GMD3, Kansas, this 7th day of August, 2019.

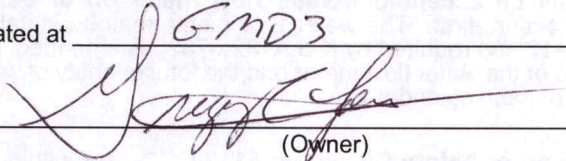
 (Owner)	(Spouse)
<u>Gregory E. Love</u> (Please Print)	(Please Print)
(Owner)	(Spouse)
(Please Print)	(Please Print)
(Owner)	(Spouse)
(Please Print)	(Please Print)

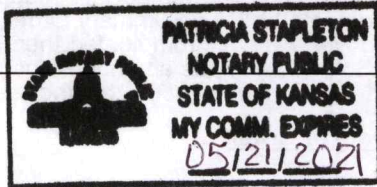

State of Kansas }
 County of Finnery } SS

I hereby certify that the foregoing application was signed in my presence and sworn to before me this 7th day of August, 2019.

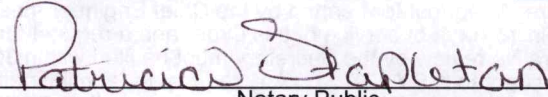
 Notary Public

My Commission Expires 5-21-2021.

ONLY COMPLETE APPLICATIONS WILL BE PROCESSED. To be complete, all of the applicable portions of the application form must be completed with accurate information; maps, if necessary, must be included; signatures of all the appropriate owners' must be affixed to the application and notarized; and the appropriate fee must be paid.

FEE SCHEDULE

Each application to change the place of use or the point of diversion under this section shall be accompanied by the application fee set forth in the schedule below: Make checks payable to: **Kansas Department of Agriculture**

- (1) Application to change a point of diversion 300 feet or less \$100
- (2) Application to change a point of diversion more than 300 feet \$200
- (3) Application to change the place of use \$200

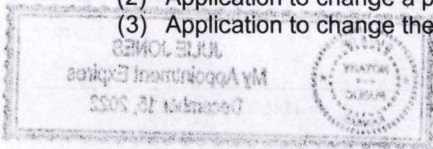

S14-T27S-R29W S13-T27S-R29W S18-T27S-R28W S17-T27S-R28W S16-T27S-R28W

Change App. PU, File No.

14536, 14703, 17891, 21362,
26293, 28648 & 31620

S23-T27S-R29W S24-T27S-R29W S19-T27S-R28W S20-T27S-R28W S21-T27S-R28W

S26-T27S-R29W S25-T27S-R29W S30-T27S-R28W S29-T27S-R28W S28-T27S-R28W

S35-T27S-R29W S36-T27S-R29W S31-T27S-R28W S32-T27S-R28W S33-T27S-R28W

S2-T28S-R29W S1-T28S-R29W S6-T28S-R28W S5-T28S-R28W S4-T28S-R28W

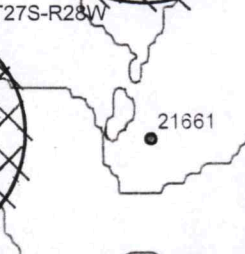
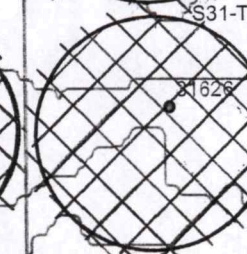
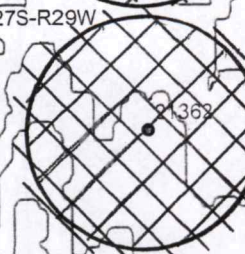
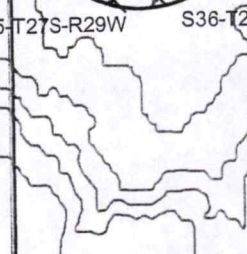
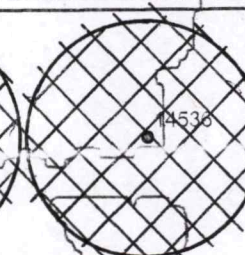
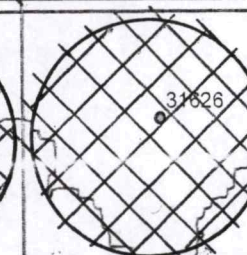
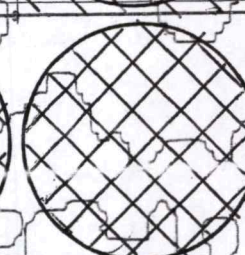
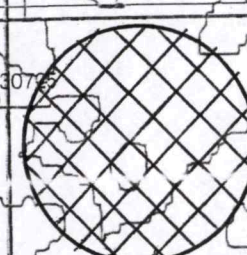
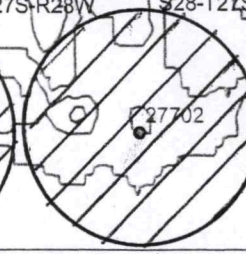
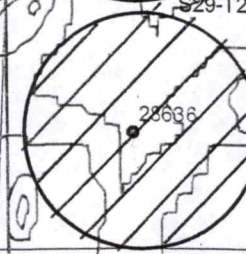
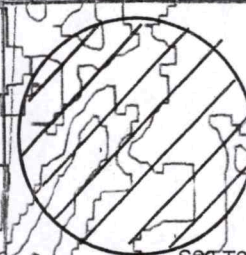
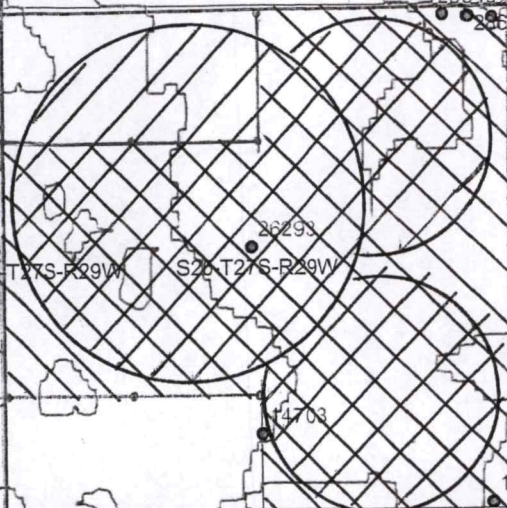

Authorized
Proposed

Scale: 1"=2000'

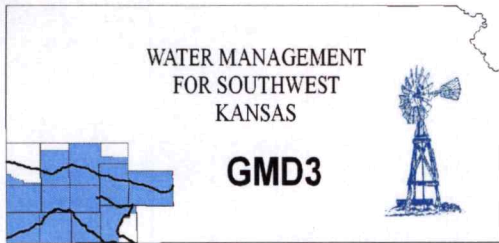

Southwest Kansas
Groundwater Management District No. 3
2009 E. Spruce Street
Garden City, Kansas 67846
(620) 275-7147 phone (620) 275-1431 fax
www.gmd3.org

June 14, 2019

RECEIVED

AUG 07 2019

Garden City Field Office
Division of Water Resources

Michael A. Meyer
Division of Water Resources
4532 W Jones Ave., Suite B
Garden City, Kansas 67846

RE: Applications for Change in Place of Use
Water Right, File Nos. 14536, 14703, 17891, 21362, 26293, 27702, 28636, 28648 &
31626

Dear Mike:

We have assisted with the applications for the above referenced water rights. The proposal is not in conflict with the Management Program of the Southwest Kansas Groundwater Management District No. 3 (GMD3). The proposed change in place of use for a complete overlap in irrigation acres is in accordance with K.A.R. 5-5-11. No new acres are being proposed. It is therefore recommended that the applications be approved at this time.

Thank you for the opportunity to review the applications and to provide a recommendation. If you have any questions, please don't hesitate to contact us.

Sincerely,

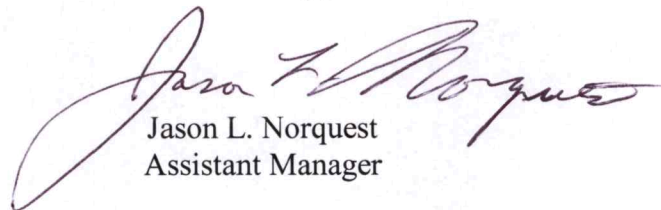

Jason L. Norquest
Assistant Manager