

Kansas Department of Agriculture  
 Division of Water Resources  
**CHANGE: P/D WORKSHEET**

1. File Number: <b>24690</b>	2. Status Change Date:	3. Change Num: <b>C4</b>	4. Field Office: <b>04</b>	5. GMD: <b>03</b>
---------------------------------	------------------------	-----------------------------	-------------------------------	----------------------

6. Status: <input checked="" type="checkbox"/> Approved <input type="checkbox"/> Denied by DWR/GMD <input type="checkbox"/> Dismiss by Request/Failure to Return	7. Filing Date of Change: <b>1/31/2019</b>
--	---

8a. Applicant, Landowner, *WUC*    Person ID **38690**  
 New to system     Add Seq# **1**

**JOHN D BORTH**  
**PO BOX 754**  
**MEADE KS 67864**

8c. WUC    Person ID \_\_\_\_\_  
 New to system     Add Seq# \_\_\_\_\_

**8a**

8b. Landowner(s)    Person ID **38691**  
 New to system     Add Seq# **1**

**J D BORTH FARMS LTD**  
**PO BOX 754**  
**MEADE KS 67864**

8d. WUC    Person ID \_\_\_\_\_  
 New to system     Add Seq# \_\_\_\_\_

9. Documents and Enclosure(s):  DWR Meter(s) Date to Comply: **12/31/19**     N & P Date to Comply: **12/31/2019**

Anti-Reverse Meter     Meter Seal     Check Valve     N & P Form     Water Tube     Driller Copy     H & E Letter

Conservation Plan    Date Required: \_\_\_\_\_    Date Approved: \_\_\_\_\_    Date to Comply: \_\_\_\_\_

10. Use Made of Water    From: \_\_\_\_\_    To: \_\_\_\_\_

*Remove completion requirement for change*  
*No. 3 (C3)*

Date Prepared: **2/13/2019**    By: **AM**  
 Date Entered: \_\_\_\_\_    By: \_\_\_\_\_

File No. **24690**      11. County: **ME**      Basin: **CROOKED CREEK**      Stream:      Formation Code: **211**      Special Use:

12. Points of Diversion Rate and Quantity  
**CHK** Authorized Additional  
**MOD** Rate Quantity  
**DEL** PDIV Qualifier S T R ID 'N 'W **Comment (AKA Line)** gpm af gpm af Overlap PD Files  
**ENT**

**CHK 86978**

**DEL 87093**

**ENT NW NW NW 23 31S 30W 4652 5279 ADDITIONAL WELL 967.5 315.3 967.5 315.3**

**\*\*\*KEEP ADDITIONAL WELL SPECIAL CONDITION ADDITIONAL WELL (REVIEW AFTER 5-10 YRS)**

13. Storage: Rate \_\_\_\_\_ NF Quantity \_\_\_\_\_ ac/ft Additional Rate \_\_\_\_\_ NF Additional Quantity \_\_\_\_\_ ac/ft

14. Limitation: \_\_\_\_\_ af/yr at \_\_\_\_\_ gpm ( \_\_\_\_\_ cfs) when combined with file number(s) \_\_\_\_\_  
 Limitation: \_\_\_\_\_ af/yr at \_\_\_\_\_ gpm ( \_\_\_\_\_ cfs) when combined with file number(s) \_\_\_\_\_

15. 5YR Allocation: Allocation Type \_\_\_\_\_ Start Year \_\_\_\_\_ 5 YR Amount \_\_\_\_\_ Amount Unit \_\_\_\_\_ Base Acres \_\_\_\_\_ Comment \_\_\_\_\_

16. Place of Use <b>CHK</b> <b>MOD</b> <b>DEL</b> <b>ENT</b>	NE¼				NW¼				SW¼				SE¼				Total	Owner	Chg?	Overlap Files		
	PUSE	S	T	R	ID	NE ¼	NW ¼	SW ¼	SE ¼	NE ¼	NW ¼	SW ¼	SE ¼	NE ¼	NW ¼	SW ¼					SE ¼	
<b>CHK 16731</b>																					<b>8B</b>	<b>24689</b>
<b>CHK 67691</b>																					<b>8B</b>	<b>24689</b>
<b>CHK 10710</b>																					<b>8B</b>	<b>24689</b>

**Base Acres: 400 Year: 1978 Minimum Reasonable Quantity:**

Comments:

Garden City Field Office  
2508 Johns Street  
Garden City, KS 67846-2804



Phone: 620-276-2901  
Fax: 620-276-9315  
[www.agriculture.ks.gov](http://www.agriculture.ks.gov)

Mike Beam, Interim Secretary

Laura Kelly, Governor

February 13, 2019

JOHN D BORTH  
PO BOX 754  
MEADE KS 67864

RE: Water Right, File No. 24690

Dear Sir:

Enclosed is an order executed by the designee of the Chief Engineer, Division of Water Resources, Kansas Department of Agriculture, approving the application for change under the above referenced file number.

Your attention is directed to the enclosures and to the terms, conditions, and limitations specified in this approval for change. A condition of this approval is that acceptable water flow meter must be installed on the diversion works authorized under the referenced file number and meet current specifications. Please return the required notification of completion of the diversion works and installation of the required meter as soon as these actions are completed.

Since this order modifies the original document referred to above, it should be recorded with the Register of Deeds as other instruments affecting real estate.

Should you have any questions, please feel free to call this office. If you would prefer, you could arrange an appointment for additional assistance.

Sincerely,

A handwritten signature in blue ink, appearing to read "Michael A. Meyer".

Michael A. Meyer  
Water Commissioner

MAM:  
enclosures

pc:

J D BORTH FARMS LTD  
PO BOX 754  
MEADE KS 67864

GROUNDWATER MANAGEMENT DISTRICT NO. 3

**CERTIFICATE OF SERVICE**

On this 13<sup>th</sup> day of February, 2019, I hereby certify that the foregoing Approval of Application for Change in Point of Diversion, Water Right, File No. 24,690, dated 13<sup>th</sup> day of February, 2019 was mailed postage prepaid, first class, US mail to the following:

J D BORTH FARMS LTD  
PO BOX 754  
MEADE KS 67864

With photocopies to:

JOHN D BORTH  
PO BOX 754  
MEADE KS 67864

GROUNDWATER MANAGEMENT DISTRICT NO. 3

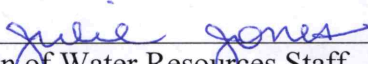
  
\_\_\_\_\_  
Division of Water Resources Staff

Submit completed application to:  
 Kansas Department of Agriculture  
 Division of Water Resources  
 Field Office for your area.

Call for address:

Topeka -- (785) 296-5733  
 Stafford -- (620) 234-5311  
 Stockton -- (785) 425-6787  
 Garden City -- (620) 276-2901  
<http://agriculture.ks.gov/dwr>

## DWR FIELD OFFICE APPLICATION FOR APPROVAL TO CHANGE THE PLACE OF USE AND/OR THE POINT OF DIVERSION



**STATE OF KANSAS**

Filing Fee Must Accompany the Application, K.S.A. 82a-708b(b), as amended.  
 Fee Schedule is on the third page of this application form.

**Paragraph Nos. 1, 2, 3 & 5 must be completed. Complete all other applicable portions.** If change in point of diversion is greater than 100 feet, or if place of use will be changed, include a topographic map or detailed plat showing the authorized and proposed point(s) of diversion and/or place of use.

**RECEIVED**  
 4:30 pm  
 JAN 31 2019

File No. 24690

1. Application is hereby made for approval of the Chief Engineer to change the (check one or both):

Place of Use                       Point of Diversion

Garden City Field Office  
 Division of Water Resources

under the water right which is the subject of this application in accordance with the conditions described below.

The source of supply is:                       Groundwater                       Surface water

2. Name and address of Applicant: JOHN D BORTH

PO BOX 754, MEADE, KS. 67864

Phone Number: (    )                      Email address: \_\_\_\_\_

Name and address of Water Use Correspondent: \_\_\_\_\_

Phone Number: (    )                      Email address: \_\_\_\_\_

3. The presently authorized place of use is:

Owner of Land ---- NAME: NO CHANGE

ADDRESS: \_\_\_\_\_

(If there is more than one landowner, attach supplemental sheets as necessary.)

Sec.	Twp.	Range	NE¼				NW¼				SW¼				SE¼				TOTAL ACRES
			NE¼	NW¼	SW¼	SE¼	NE¼	NW¼	SW¼	SE¼	NE¼	NW¼	SW¼	SE¼	NE¼	NW¼	SW¼	SE¼	

4. If this application is for a change in place of use, it is proposed that the place of use be changed to:

Owner of Land ---- NAME: NO CHANGE

ADDRESS: \_\_\_\_\_

(If there is more than one landowner, attach supplemental sheets as necessary.)

Sec.	Twp.	Range	NE¼				NW¼				SW¼				SE¼				TOTAL ACRES
			NE¼	NW¼	SW¼	SE¼	NE¼	NW¼	SW¼	SE¼	NE¼	NW¼	SW¼	SE¼	NE¼	NW¼	SW¼	SE¼	

For Office Use Only: Code \_\_\_\_\_ Fee \$ 200.00 TR # \_\_\_\_\_ Receipt Date 1-31-19 Check # 7221

5. **Presently authorized point of diversion:**  
 One in the SW Quarter of the SW Quarter of the NW Quarter of Section 23, Township 31 South, Range 30 (W), in ME County, Kansas, 2642 feet North 5244 feet West of Southeast corner of section.  
 Authorized Rate          Authorized Quantity          Depth of well          (feet)  
**(DWR use only: Computer ID No. 04 GPS          feet North          feet West)**  
 This point will not be changed     This point will be changed as follows:     No change, point better described with GPS as follows:  
**Proposed point of diversion: (Complete only if change is requested or if existing point is better described by GPS)**  
 One in the          Quarter of the          Quarter of the          Quarter of Section         , Township          South, Range         , in          County, Kansas,          feet North          feet West of Southeast corner of section.  
 Proposed Rate          Proposed Quantity          Proposed well depth (feet)         .  
 This point is:  Additional Well     Geo Center    List other water rights that will use this point         .

6. **Presently authorized point of diversion:**  
 One in the NW Quarter of the NW Quarter of the NW Quarter of Section 23, Township 31 South, Range 30 W, in ME County, Kansas, 5253 feet North 5174 feet West of Southeast corner of section.  
 Authorized Rate          Authorized Quantity          Depth of well          (feet)  
**(DWR use only: Computer ID No. 05 GPS          feet North          feet West)**  
 This point will not be changed     This point will be changed as follows:     No change, point better described with GPS as follows:  
**Proposed point of diversion: (Complete only if change is requested or if existing point is better described by GPS)**  
 One in the NW Quarter of the NW Quarter of the NW Quarter of Section 23, Township 31 South, Range 30 W, in ME County, Kansas, 4652 feet North 5279 feet West of Southeast corner of section.  
 Proposed Rate          Proposed Quantity          Proposed well depth (feet)         .  
 This point is:  Additional Well     Geo Center    List other water rights that will use this point         .

7. The changes herein are desired for the following reasons?  
 (please be specific) new 2018 well was not constructed correctly which prevented water to be pumped from the well. all attempts failed on well develop

8. If a well, is the test hole log attached?  Yes     No

9. The change(s) (was)(will be) completed by?  
asap

10. If the point of diversion is a well:  
 (a) What are you going to do with the old well?  
plug  
 (b) When will this be done? 2019

11. Groundwater Management District recommendation attached?  
 Yes     No

12. Assisted by MAM/GCFO

13a. If the proposed point of diversion will be relocated more than 300 feet but within 2,640 feet of the existing point of diversion, attach a topographic map or aerial photograph. For groundwater sources, show all wells (including domestic) within one-half mile of the proposed point of diversion and the names and mailing addresses of the owners. For surface water sources, show the names and addresses of the landowner(s) one-half mile downstream and one-half mile upstream from your property lines

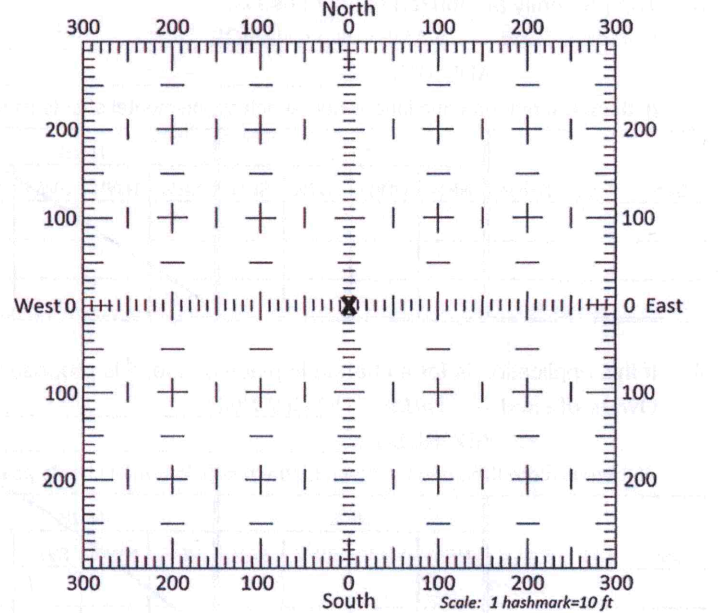

13b. If the proposed point of diversion will be relocated within 300 feet of the existing point of diversion, indicate its location on the diagram shown above in relation to the existing point of diversion. (PLEASE NOTE: The "X" in center of diagram above represents the presently authorized point of diversion.)

14. If the proposed groundwater point of diversion is 300 or fewer feet from the existing point of diversion, complete the following:
- (a) Does the undersigned represent all owners of the currently authorized place(s) of use identified in this application?  
 Yes     No    (If no, all owners must sign this application.)
  - (b) Will the ownership interest of any owner of the currently authorized place(s) of use identified in this application be adversely affected if this application is approved as requested?  
 Yes     No    (If yes, all owners must sign this application.)
  - (c) If this application is not approved expeditiously, will there be substantial damage to property, public health or safety?  
 Yes     No    (If no, all owners must sign this application.)

If the application proposes a surface water change in point of diversion, a groundwater change in point of diversion greater than 300 feet, or a change in place of use, the application must be signed by all owners of the currently authorized place of use, or their duly authorized agent (attach notarized statement authorizing representation).

I hereby verify, being first duly sworn upon my oath or affirmation and under penalty of perjury, that I am of lawful age and the owner, the spouse of the owner, or a duly authorized agent of the owner(s) to make this application on their behalf, in regards to the water right(s) to which this application pertains. I further verify that the statements contained in this application are true, correct and complete.

Dated at Meade, Kansas, this 31 day of JAN, 2019.

<u>J.D. BORTH FARMS LTD.</u>	
(Owner)	(Spouse)
<u>John D Borth Pres.</u>	
(Please Print)	(Please Print)
(Owner)	(Spouse)
(Please Print)	(Please Print)
(Owner)	(Spouse)
(Please Print)	(Please Print)

State of Kansas }  
 County of Meade } SS

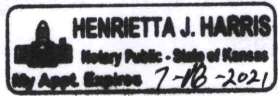

I hereby certify that the foregoing application was signed in my presence and sworn to before me this 31st day of January, 2019.

Henrietta J. Harris  
 Notary Public

My Commission Expires 7-16-2021.

**ONLY COMPLETE APPLICATIONS WILL BE PROCESSED.** To be complete, all of the applicable portions of the application form must be completed with accurate information; maps, if necessary, must be included; signatures of all the appropriate owners' must be affixed to the application and notarized; and the appropriate fee must be paid.

**FEE SCHEDULE**

Each application to change the place of use or the point of diversion under this section shall be accompanied by the application fee set forth in the schedule below: Make checks payable to: **Kansas Department of Agriculture**

- (1) Application to change a point of diversion 300 feet or less ..... \$100
- (2) Application to change a point of diversion more than 300 feet ..... \$200
- (3) Application to change the place of use ..... \$200

**SUMMARY ORDER APPROVING APPLICATION FOR CHANGE AND IMPOSING CONDITIONS**

This Summary Order is issued under authority of K.S.A. 82a-708b, as amended, and K.A.R. 5-5-1, *et seq.* and other applicable provisions of the *Kansas Water Appropriation Law, K.S.A. 82a-701 et. seq.*, and rules and regulations promulgated thereunder. With the exception of those conditions expressly contained herein, this Summary Order does not change the terms, conditions and limitations of File No. 24690

- A change application was received on January 31, 2019 requesting that the place of use and / or point of diversion authorized under the above-referenced file number be changed as described in the application.
- On and after the effective date of this summary order, the authorized place(s) of use shall be located substantially as shown on the topographic map accompanying the application to change the place of use.     Applicable     Not Applicable
- The change in point of diversion shall not impair existing rights and shall be limited to the same source or sources of water as previously authorized. The point of diversion authorized by this summary order shall be located within a 300 foot radius of the authorized point(s) of diversion.     Applicable     Not Applicable
- The point(s) of diversion described herein is administratively corrected to be more accurately described using the Global Positioning System (GPS), as described in the application.     Applicable     Not Applicable
- The point(s) of diversion authorized herein shall not actually be located more than        feet from the previously authorized point(s) of diversion.     Applicable     Not Applicable
- As required by K.A.R. 5-3-5d, if the works for diversion is a well with a diversion rate of 100 gallons per minute or more, a tube or other device suitable for making water level measurements shall be installed, operated and maintained in accordance with K.A.R. 5-6-13.     Applicable     Not Applicable
- The owner of the authorized place(s) of use shall properly install an acceptable water flow meter on or before December 31, 2019, or before the first use of water, whichever occurs first. The water flow meter shall be installed, operated and maintained in accordance with K.A.R. 5-1-4 through 5-1-12. As required by K.S.A. 82a-732, as amended, and K.A.R. 5-3-5e, the owner shall maintain records and report the reading of the water flow meter and the total quantity of water diverted annually to the Chief Engineer by March 1 following the end of each calendar year.     Applicable     Not Applicable
- Installation of the works for diversion of water shall be completed on or before December 31, 2019, or within any authorized extension of time. By March 1, 2020 the applicant shall notify the Chief Engineer that construction of the works for diversion has been completed, on the form provided by the Chief Engineer, as required by K.A.R. 5-8-4e.     Applicable     Not Applicable
- The completed well log shall be submitted with the required notice.     Applicable     Not Applicable
- All diversion works into which any type of chemical or other foreign substance will be injected into the water shall be equipped with an in-line, automatic, quick-closing check valve capable of preventing pollution of the source of the water supply. The check valve(s) shall be installed, operated and maintained in accordance with K.A.R. 5-3-5c.     Applicable     Not Applicable
- Additional Conditions are attached.     Yes     No
- In accordance with K.S.A. 82a-708a, as amended, and K.A.R. 5-5-14, all of the owners of the authorized place(s) of use of water appropriated under the above-referenced file number are responsible for compliance with its terms, conditions and limitations, as amended and/or supplemented by this Summary Order, and with applicable provisions of the *Kansas Water Appropriation Law* and the *Rules and Regulations* promulgated thereunder. Failure to comply with these provisions may result in civil penalties pursuant to K.S.A. 82a-737, as amended, and/or the suspension or revocation and dismissal of the water or appropriation right or any other enforcement actions authorized by law.

**Administrative Appeal and Effective Date of Order**

If you are aggrieved by this order, pursuant to K.S.A. 82a-1901, you may request an evidentiary hearing before the Chief Engineer or request administrative review by the Secretary of Agriculture. A request for hearing by the Chief Engineer must be filed within **15 days** of service of this Order and a request for administrative review by the Secretary must be filed within **30 days** pursuant to K.S.A. 77-531. Any request for administrative review must state a basis for review pursuant to K.S.A. 77-527. File any request with **Kansas Department of Agriculture, Legal Division, 1320 Research Park Drive, Manhattan, KS 66502**. Failure to timely request a hearing or review may preclude review under the Kansas Judicial Review Act.

*For Use by Register of Deeds*

FOR OFFICE USE ONLY  
**APPLICATION APPROVED AND SUMMARY ORDER ISSUED**

By: Michael A. Meyer  
Duly Authorized Designee of the Chief Engineer  
(Print Name): MICHAEL A. MEYER  
Division of Water Resources - Kansas Department of Agriculture

Date of Issuance: February 13, 2019

State of Kansas   )  
  ) SS  
County of Stinson   )

Acknowledged before me on February 13, 2019  
by Michael A. Meyer

Signature: Julie Jones  
Notary Public

My commission expires:

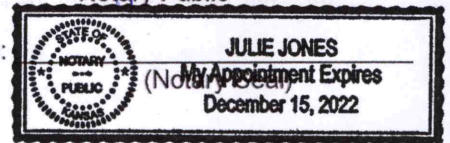



# FILE NO. 24690

# APPLICATION TO CHANGE THE POINT OF DIVERSION

R30W

T31S

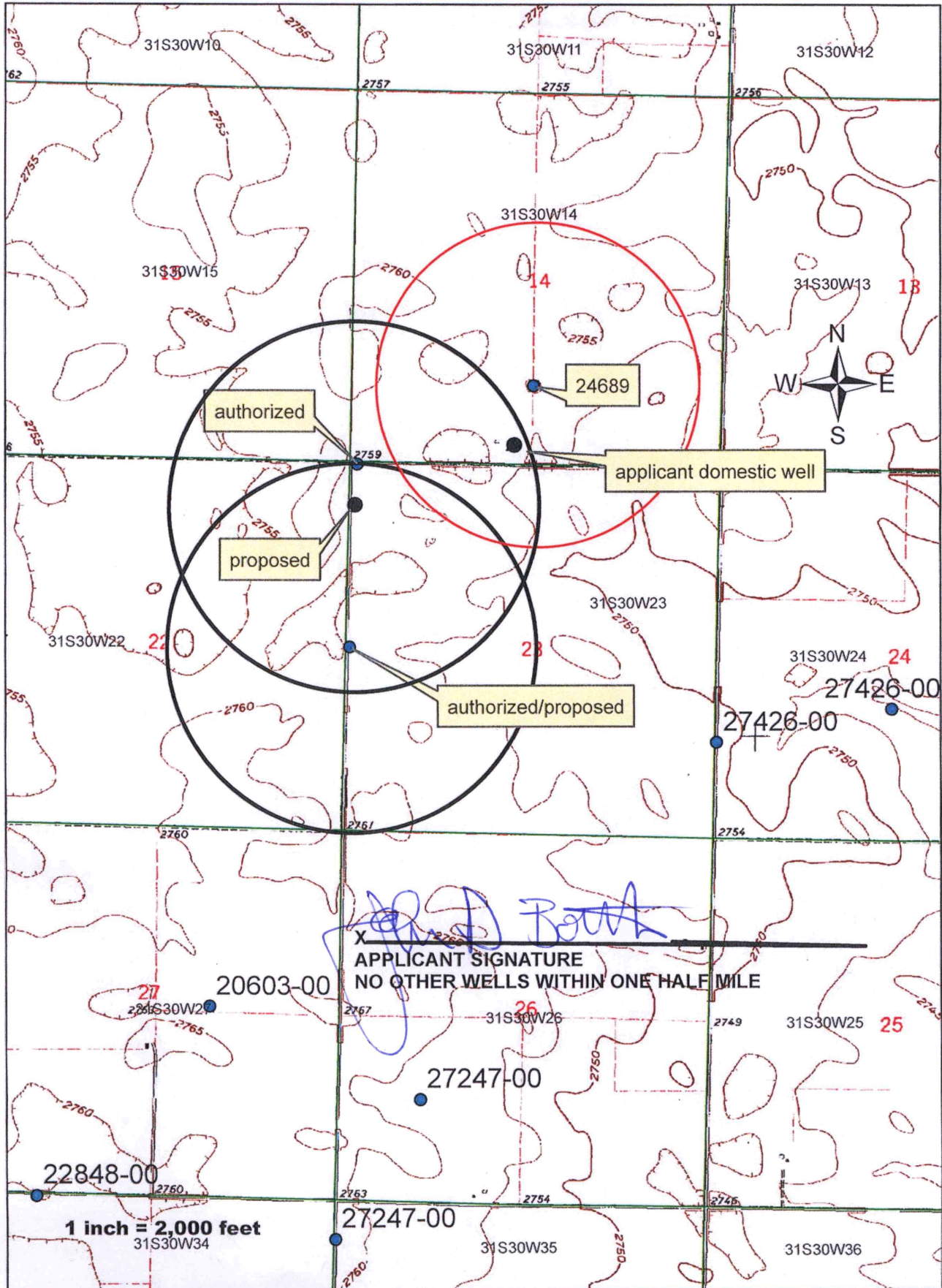





# Untitled Map

Write a description for your map.

## Legend

 37.34209 -100.56169

 37.34209 -100.56169

6 Rd

Google Earth

© 2018 Google



1000 ft

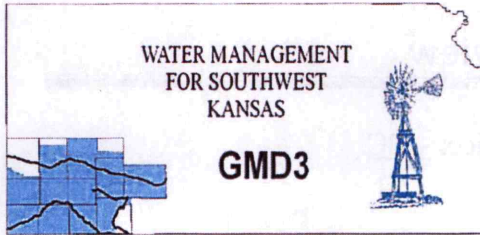

Southwest Kansas  
Groundwater Management District No. 3  
2009 E. Spruce Street  
Garden City, Kansas 67846  
(620) 275-7147 phone (620) 275-1431 fax  
www.gmd3.org

February 11, 2019

Michael A. Meyer  
Division of Water Resources  
2508 N Johns Street  
Garden City, Kansas 67846

RE: Application for Change in Point of Diversion  
Water Right, File Nos. 24690

Dear Mike:

We have completed a review of the application for the above referenced water right. The proposed change in point of diversion is in accordance with current area rules, K.A.R. 5-23-3, as it pertains to distance moved and minimum spacing to neighboring wells.

Well evaluations were conducted to estimate possible effects of the proposal on the supply of other wells with water rights prior to the proposal per K.S.A. 82a-708b, and the draft revised management program. Under K.S.A. 82a-708b, an applicant requesting a change in point of diversion must demonstrate to the chief engineer that any proposed change is reasonable and will not impair. The enclosed report is an analysis performed by the GMD on behalf of the applicant. Under this analysis, the proposed change is considered to be reasonable and unlikely to impair if either the net in-season well-to-well effect of the proposed change is less than a strict maximum allowable threshold (4 ft in cases where saturated thickness is greater than 200 ft), or if no well with a net well-to-well effect exceeding the threshold is identified as critical. Critical wells are identified as wells that are expected to either lose or greatly diminish water supply over the next 25 years. The attached review information is based on a Theis analysis using inputs from the GMD3 aquifer model, which is considered to be the best information on well and aquifer data readily and easily available to the public. If either the applicant or the neighbors believe they have better data that might change the result of the analysis, they should contact GMD3. Conclusions of the well analysis may change if better information on well and aquifer data can be made available.

Every neighboring well within 1 mile of the proposed move was evaluated. Evaluations showed that in no case did the net effect on neighboring wells exceed the 4.0 ft maximum allowable threshold. Therefore, GMD3 sees this move as reasonable and unlikely to impair neighboring wells. It is therefore recommended that the applications be approved.

. Thank you for the opportunity to review the applications and to provide a recommendation. If you have any questions, please don't hesitate to contact us.

Sincerely,

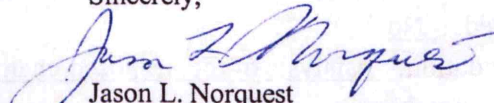
  
Jason L. Norquest  
Assistant Manager

RECEIVED

FEB 11 2019

## GMD3 Change Review

---

File No(s): 24690.

DWR office: GC.

App filed to change: PD.

Is Landowner(s) correct in WRIS: John Borth.

If NO, is documentation included?

Is Water Use Correspondent correct in WRIS? Yes.

If NO, is documentation included?

Regulation(s) Reviewed: KAR5-23-3

Point of diversion ID No(s) 05 being changed.

	ft. North	ft. West		
Authorized PD	5253	5174	Sect. 23-31-30	
Proposed PD	4652	5279		
Difference	601 s	-105 w		
a2 + b2 = c2	361201	11025	610.1033 foot move SW	GPS

for proposed PD: Lat: 37.34209 Long: -100.56169.

Is proposed PD stacking on existing WRs? No.

Is Proposed PU overlapping existing WRs? No Change.

Land Owner(s) notified:    .

Name    .

Name    .

Address    .

Address    .

Zip    .

Zip    .

Neighboring certified well(s) notified:    .

Name    .

Name    .

Address    .

Address    .

Zip    .

Zip    .

Domestic well(s) notified:    .

Name    .

Name    .

Address    .

Address    .

Zip    .

Zip    .

Base Acres:    .

Perfected Acres:    .

Irr. Return-Flow    %

**WR was recently approved for additional well. The new well was not drilled/constructed properly, so the redrill was needed.**

Is a waiver needed: No.

Final Recommendation: Analysis of the proposed change shows that there will be minimal effect on neighboring wells. Appears all current area rules are met, staff therefore recommends approval of the application.

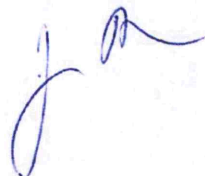

**Evaluation of proposed move for Water Right Nos 24690 ID 5**

Proposed: Move water right number 24690 ID 5 a distance of 610 ft to the southwest.

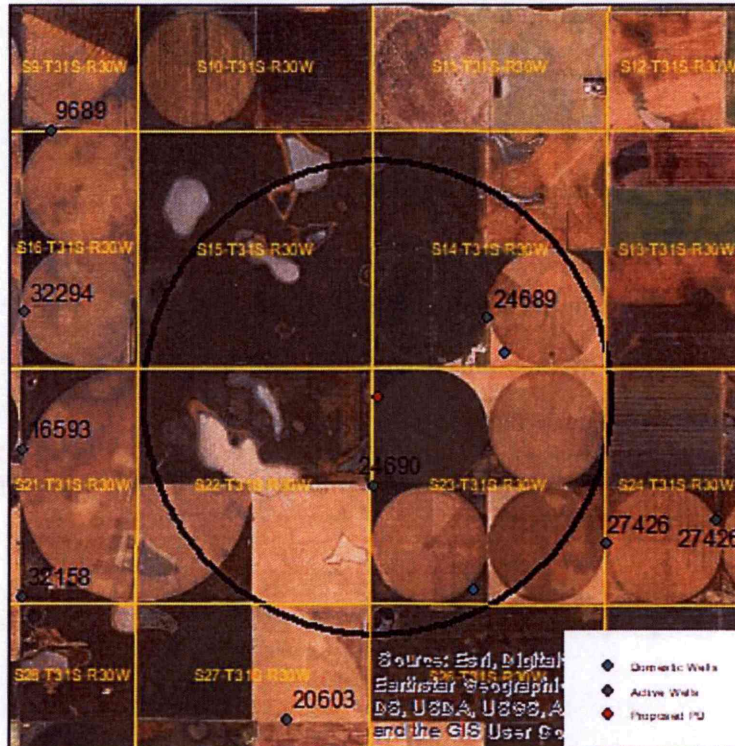

Wells within 1 mile: 24689, domestic well in section 14-31-30, and domestic well in section 23-31-30.

The saturated thickness at the proposed well location is estimated to be 228 ft, based upon water table elevation from the well driller's log, observed January 9, 2019.

Note that this water right was split in 2018 to create an additional well, but the additional well was not constructed correctly, preventing any water to be pumped from the well. This move is being analyzed as if the well currently authorized under ID 4, with its previous rate and quantity is being split into an additional well at the proposed PD.

**50 year Theis Analysis:** The following values were used to run the analysis:

$S = 0.2624$ ,  $T = 30,641 \text{ ft}^2/\text{day}$ ,  $tp_{\text{current}} = 125 \text{ days}$  (based upon observed rate and reported quantity),  $Q_{\text{current}} = 1143 \text{ gpm}$  (based upon observation during 2016 field visit),  $tp_{\text{proposed}} = 74 \text{ days}$  (at both ID 4 and ID 5),  $Q_{\text{proposed}} = 1825 \text{ gpm}$  (at both ID 4 and ID 5). Wells were given the following X-Y coordinates:

- 24690 ID 4: X = 69,124 ft, Y = 170,148 ft
- Proposed PD: X = 69,115 ft, Y = 170,151 ft
- 24689: X = 71,602 ft, Y = 171,921 ft
- Domestic 14-31-30: X = 71,993 ft, Y = 171,140 ft
- Domestic 23-31-30: X = 71,302 ft, Y = 165,867 ft

RECEIVED

FEB 11 2019

Garden City Field Office  
Division of Water Resources

This drawdowns were calculated as follows:

24689: Drawdown from current location = 1.62 ft  
Drawdown from proposed location = 1.80 ft  
Net drawdown = 0.2 ft

Domestic 14-31-30: Drawdown from current location = 1.63 ft  
Drawdown from proposed location = 1.81 ft  
Net drawdown = 0.2 ft

Domestic 23-31-30: Drawdown from current location = 1.23 ft  
Drawdown from proposed location = 1.27 ft  
Net drawdown = 0.0 ft

None of the net well effects exceed the drawdown allowance of 4.0 ft, therefore none of the neighboring wells are likely to be impaired.

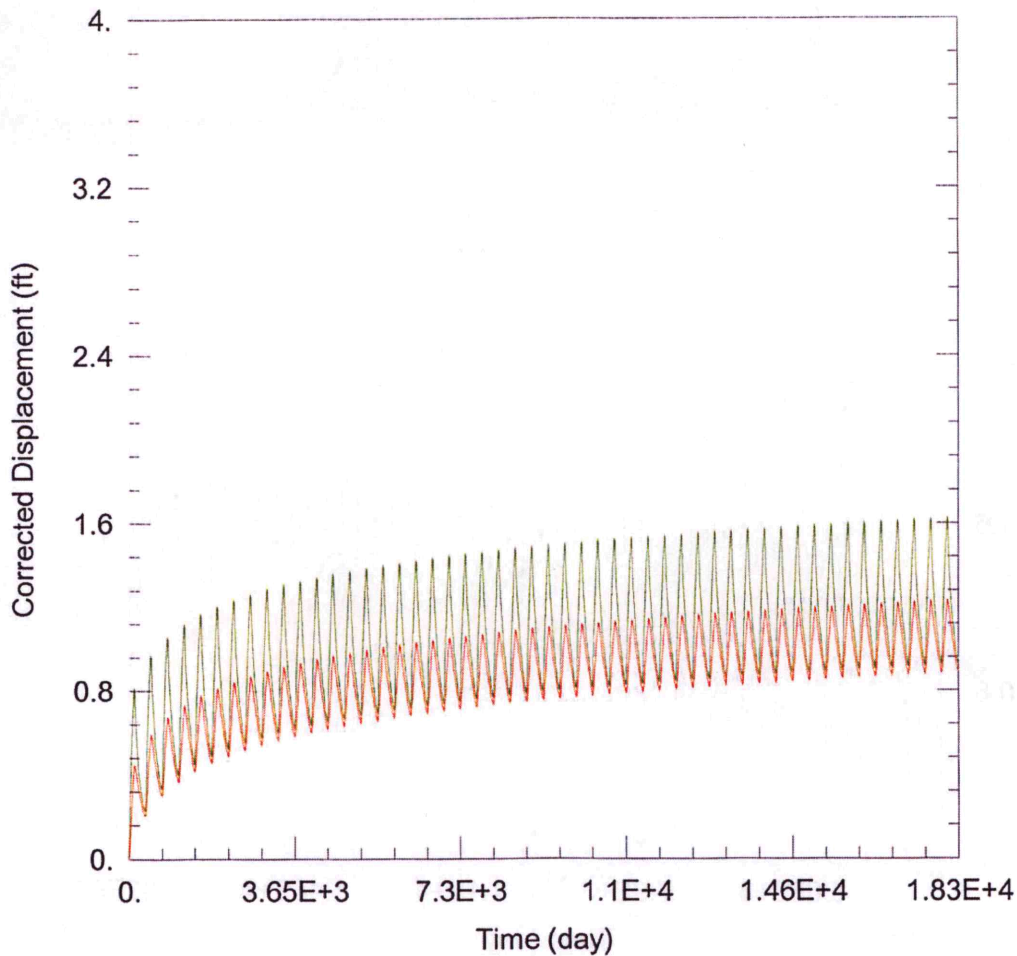

WELL TEST ANALYSIS

Data Set: C:\Users\trevora\Documents\2019\_moves\24690\24690 Current.aqt  
 Date: 02/11/19 Time: 13:49:12

PROJECT INFORMATION

Company: GMD 3  
 Client: John Borth  
 Project: 24690  
 Location: Meade County  
 Test Well: 24690

WELL DATA

Pumping Wells

Well Name	X (ft)	Y (ft)
24690	69124	170148

Observation Wells

Well Name	X (ft)	Y (ft)
□	69124	170148
□ 24689	71602	171921
□ Domestic 14-31-30	71993	171140
□ Domestic 23-31-30	71302	165867

SOLUTION

Aquifer Model: Unconfined  
 T = 3.064E+4 ft<sup>2</sup>/day  
 Kz/Kr = 1.

Solution Method: Theis  
 S = 0.2624  
 b = 228. ft

**RECEIVED**

**FEB 11 2019**

Garden City Field Office  
 Division of Water Resources



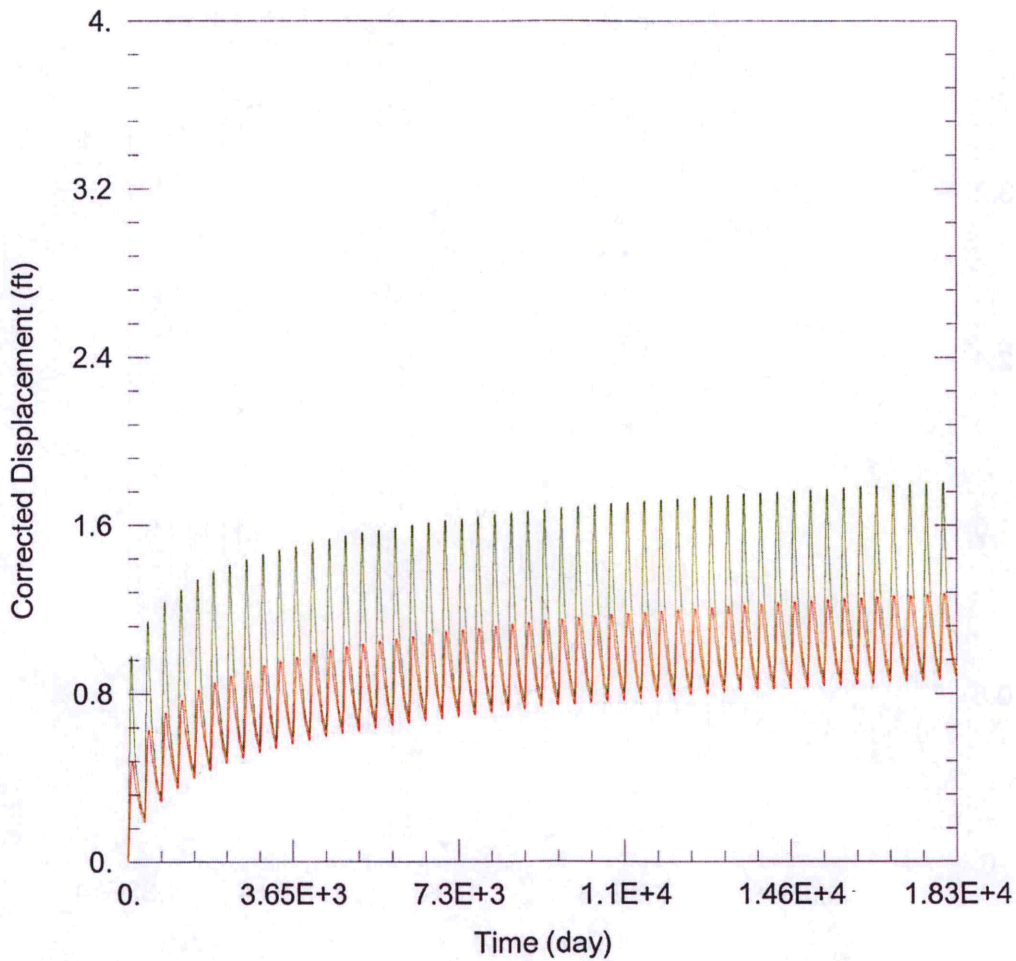

### WELL TEST ANALYSIS

Data Set: C:\Users\trevora\Documents\2019\_moves\24690\24690 Proposed.aqt  
 Date: 02/11/19 Time: 13:48:43

### PROJECT INFORMATION

Company: GMD 3  
 Client: John Borth  
 Project: 24690  
 Location: Meade County  
 Test Well: 24690

### WELL DATA

#### Pumping Wells

Well Name	X (ft)	Y (ft)
	69124	170148
	69115	170151

#### Observation Wells

Well Name	X (ft)	Y (ft)
□	69124	170148
□	69115	170151
□ 24689	71602	171921
□ Domestic 14-31-30	71993	171140
□ Domestic 23-31-30	71302	165867

### SOLUTION

Aquifer Model: Unconfined

Solution Method: Theis

T = 3.064E+4 ft<sup>2</sup>/day

S = 0.2624

Kz/Kr = 1.

b = 228. ft

Garden City Field Office  
2508 Johns Street  
Garden City, KS 67846-2804



Phone: 620-276-2901  
Fax: 620-276-9315  
[www.agriculture.ks.gov](http://www.agriculture.ks.gov)

Mike Beam, Interim Secretary

Laura Kelly, Governor

February 1, 2019

SOUTHWEST KANSAS GROUNDWATER  
MANAGEMENT DISTRICT NO. 3  
409 CAMPUS DRIVE, SUITE 106  
GARDEN CITY KS 67846

Re: Water Right File No. 24690

Dear Mr. Norquest:

This is to advise you that John Borth has filed an application for approval of the Chief Engineer, Division of Water Resources, Kansas Department of Agriculture, to change the point of diversion for the above referenced file.

We are delaying action on the change application to allow you time to review and provide a recommendation. Please submit a recommendation within 15 days from the date of this letter.

Thank you and as always feel free to contact this office at any time.

Sincerely,

A handwritten signature in blue ink that reads "Michael A. Meyer". The signature is fluid and cursive, with a long horizontal flourish extending to the right.

Michael A. Meyer  
Water Commissioner

MAM  
Enclosures