

File No. **27702** 11. County: **GY** Basin: **ARKANSAS RIVER** Stream: Formation Code: **211** Special Use:

12. Points of Diversion
 Rate and Quantity
 Authorized Additional
 Rate Quantity Rate Quantity
 gpm/cfs af/mgy gpm/cfs af/mgy Overlap PD Files

CHK	MOD	DEL	ENT	PDIV	Qualifier	S	T	R	ID	'N	'W	Comment (AKA Line)	Rate gpm/cfs	Quantity af/mgy	Rate gpm/cfs	Quantity af/mgy	Overlap PD Files
CHK					86731												

13. Storage: Rate _____ NF Quantity _____ ac/ft Additional Rate _____ NF Additional Quantity _____ ac/ft

14. Limitation: _____ af/yr at _____ gpm (_____ cfs) when combined with file number(s) _____
 Limitation: _____ af/yr at _____ gpm (_____ cfs) when combined with file number(s) _____

15. 5YR Allocation: Allocation Type _____ Start Year _____ 5 YR Amount _____ Amount Unit _____ Base Acres _____ Comment _____

CHK	MOD	DEL	ENT	PUSE	S	T	R	ID	NE¼				NW¼				SW¼				SE¼				Total	Owner	Chg?	Overlap Files		
									NE ¼	NW ¼	SW ¼	SE ¼	NE ¼	NW ¼	SW ¼	SE ¼	NE ¼	NW ¼	SW ¼	SE ¼	NE ¼	NW ¼	SW ¼	SE ¼						
ENT	26100				31			27S28W 3					32.5	L-1 32.5	L-2 32.5	32.5	32.5	L-3 32.5	L-4 32.5	32.5					260	8a		MULTIPLE		
ENT	31341				31			27S28W 1	32.5	32.5	32.5	32.5												130	8b		MULTIPLE			
ENT					25			27S29W	29	33	40	24	38	23	33	40	38	23					34	40	34	34	463	8a		MULTIPLE
ENT	9805				36			27S29W 2	32	32	32	32	32	32	32	32						30	30	30	30	376	8c		MULTIPLE	
MOD	306				29			27S28W 1					31	31	31	31	31	31	31	31	31	31	31	31	31	31	372	8c		MULTIPLE

Base Acres: **136** Year: Minimum Reasonable Quantity:
 Comments: **OVERLAPPING WR ON PLACE OF USE: 14536; 14703; 17891; 21362; 26293; 27702; 28636; 28648; 31626**

Garden City Field Office
4532 W. Jones, Suite B
Garden City, KS 67846



Phone: 620-276-2901
Fax: 620-276-9315
www.agriculture.ks.gov

Mike Beam, Secretary

Laura Kelly, Governor

August 15, 2019

GREGORY C & SUE LOVE
24506 13 RD
MONTEZUMA KS 67867-9073

RE: Water Right, File Nos. 14536; 14703; 17891; 21362; 26293; 27702; 28636; 28648; 31626

Dear Sir or Madam:

Enclosed are the orders executed by the designee of the Chief Engineer, Division of Water Resources, Kansas Department of Agriculture, approving the applications for change under the above referenced file numbers.

Your attention is directed to the enclosures and to the terms, conditions, and limitations specified in these approvals for change. A condition of these approvals is that an acceptable water flow meter must be installed on the diversion works authorized under the referenced file numbers and meet current specifications. Please return the required notifications of completion of the diversion works and/or installation of the required meter as soon as these actions are completed.

Since the order modifies the original documents referred to above, they should be recorded with the Register of Deeds as other instruments affecting real estate.

Should you have any questions, please feel free contact this office. If you would prefer, you could arrange an appointment for additional assistance.

Sincerely,

A handwritten signature in blue ink that reads "Austin J. McColloch".

Austin J. McColloch
Assistant Water Commissioner

AM:
enclosures

pc:
GROUNDWATER MANAGEMENT DISTRICT NO. 3

CERTIFICATE OF SERVICE

On this 15th day of August, 2019, I hereby certify that the foregoing Approval of Application for Change in Place of Use, Water Right, File Nos. 14536; 14703; 17891; 21362; 26293; 27702; 28636; 28648; 31626 dated 15th day of August, 2019 was mailed postage prepaid, first class, US mail to the following:

GREGORY C & SUE LOVE
24506 13 RD
MONTEZUMA KS 67867-9073

Pc:

GROUNDWATER MANAGEMENT DISTRICT NO. 3

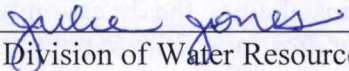

Division of Water Resources Staff

Submit completed application to:
 Kansas Department of Agriculture
 Division of Water Resources
 Field Office for your area.

Call for address:
 Topeka -- (785) 296-5733
 Stafford -- (620) 234-5311
 Stockton -- (785) 425-6787
 Garden City -- (620) 276-2901
<http://agriculture.ks.gov/dwr>

DWR FIELD OFFICE APPLICATION FOR APPROVAL TO CHANGE THE PLACE OF USE AND/OR THE POINT OF DIVERSION



STATE OF KANSAS

Filing Fee Must Accompany the Application, K.S.A. 82a-708b(b), as amended.
 Fee Schedule is on the third page of this application form.

Paragraph Nos. 1, 2, 3 & 5 must be completed. Complete all other applicable portions. If change in point of diversion is greater than 100 feet, or if place of use will be changed, include a topographic map or detailed plat showing the authorized and proposed point(s) of diversion and/or place of use.

RECEIVED

AUG 07 2019

4:40

Garden City Field Office
 Division of Water Resources

File No. 27702

1. Application is hereby made for approval of the Chief Engineer to change the (check one or both):

Place of Use Point of Diversion

under the water right which is the subject of this application in accordance with the conditions described below.

The source of supply is: Groundwater Surface water

2. Name and address of Applicant: Love Ag Company
24506 13 RD, Montezuma, KS 67867
 Phone Number: (620)8460222 Email address: greg.c.love@gmail.com
 Name and address of Water Use Correspondent: SAME

Phone Number: () Email address: _____

3. The presently authorized place of use is:
 Owner of Land ---- NAME: Love Ag Company
 ADDRESS: 24506 13RD, Montezuma, KS 67867
 (If there is more than one landowner, attach supplemental sheets as necessary.)

Sec.	Twp.	Range	NE¼				NW¼				SW¼				SE¼				TOTAL ACRES
			NE¼	NW¼	SW¼	SE¼	NE¼	NW¼	SW¼	SE¼	NE¼	NW¼	SW¼	SE¼	NE¼	NW¼	SW¼	SE¼	
29	27s	28w													40.0	40.0	40.0	40.0	160.0

4. If this application is for a change in place of use, it is proposed that the place of use be changed to:
 Owner of Land ---- NAME: Gregory C & Sue Love
 ADDRESS: 24506 13 RD, Montezuma, KS 67867
 (If there is more than one landowner, attach supplemental sheets as necessary.)

Sec.	Twp.	Range	NE¼				NW¼				SW¼				SE¼				TOTAL ACRES
			NE¼	NW¼	SW¼	SE¼	NE¼	NW¼	SW¼	SE¼	NE¼	NW¼	SW¼	SE¼	NE¼	NW¼	SW¼	SE¼	
25	27s	29w	29.0	33.0	40.0	24.0	38.0	23.0	33.0	40.0	38.0	23.0			34.0	40.0	34.0	34.0	463.0
31	27s	28w					32.5	32.5	32.5	32.5	32.5	32.5	32.5	32.5					260.0

For Office Use Only: Code _____ Fee \$ 200 TR # _____ Receipt Date 8-7-19 Check # 6128

5. **Presently authorized point of diversion:**
 One in the SE Quarter of the SE Quarter of the SE Quarter
 of Section 29, Township 27 South, Range 28 W,
 in GRAY County, Kansas, 338 feet North 415 feet West of Southeast corner of section.
 Authorized Rate 735gpm Authorized Quantity 272AF Depth of well _____ (feet)
(DWR use only: Computer ID No. _____ GPS _____ feet North _____ feet West)
 This point will not be changed This point will be changed as follows: No change, point better described with GPS as follows:
Proposed point of diversion: (Complete only if change is requested or if existing point is better described by GPS)
 One in the _____ Quarter of the _____ Quarter of the _____ Quarter
 of Section _____, Township _____ South, Range _____ (E/W),
 in _____ County, Kansas, _____ feet North _____ feet West of Southeast corner of section.
 Proposed Rate _____ Proposed Quantity _____ Proposed well depth (feet) _____
 This point is: Additional Well Geo Center List other water rights that will use this point _____

6. **Presently authorized point of diversion:**
 One in the _____ Quarter of the _____ Quarter of the _____ Quarter
 of Section _____, Township _____ South, Range _____ W,
 in _____ County, Kansas, _____ feet North _____ feet West of Southeast corner of section.
 Authorized Rate _____ Authorized Quantity _____ Depth of well _____ (feet)
(DWR use only: Computer ID No. _____ GPS _____ feet North _____ feet West)
 This point will not be changed This point will be changed as follows: No change, point better described with GPS as follows:
Proposed point of diversion: (Complete only if change is requested or if existing point is better described by GPS)
 One in the _____ Quarter of the _____ Quarter of the _____ Quarter
 of Section _____, Township _____ South, Range _____ (E/W),
 in _____ County, Kansas, _____ feet North _____ feet West of Southeast corner of section.
 Proposed Rate _____ Proposed Quantity _____ Proposed well depth (feet) _____
 This point is: Additional Well Geo Center List other water rights that will use this point _____

7. The changes herein are desired for the following reasons?
 (please be specific) _____
 Make complete overlap in place of use _____

8. If a well, is the test hole log attached? Yes No

9. The change(s) (was)(will be) completed by?

10. If the point of diversion is a well:
 (a) What are you going to do with the old well?

 (b) When will this be done? _____

11. Groundwater Management District recommendation attached?
 Yes No

12. Assisted by JLN/GMD3

13a. If the proposed point of diversion will be relocated more than 300 feet but within 2,640 feet of the existing point of diversion, attach a topographic map or aerial photograph. For groundwater sources, show all wells (including domestic) within one-half mile of the proposed point of diversion and the names and mailing addresses of the owners. For surface water sources, show the names and addresses of the landowner(s) one-half mile downstream and one-half mile upstream from your property lines

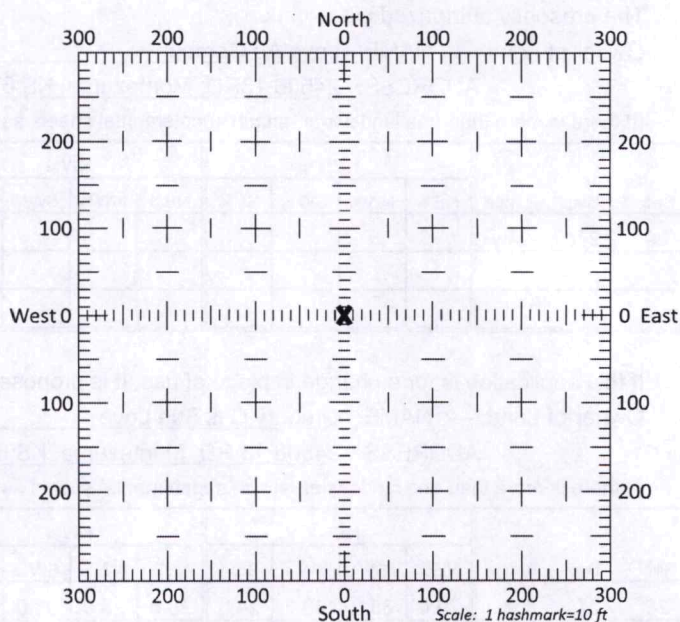

13b. If the proposed point of diversion will be relocated within 300 feet of the existing point of diversion, indicate its location on the diagram shown above in relation to the existing point of diversion. **(PLEASE NOTE: The "X" in center of diagram above represents the presently authorized point of diversion.)**

APPLICATION FOR APPROVAL TO CHANGE
THE PLACE OF USE AND/OR POINT OF DIVERSION
SUPPLEMENTAL SHEET
FILE NO. _____
MAKE ADDITIONAL COPIES AS NECESSARY

3. *Continued:* The presently authorized place of use is:

Owner of Land ---- NAME: _____
ADDRESS: _____

Sec.	Twp.	Range	NE¼				NW¼				SW¼				SE¼				TOTAL ACRES	
			NE¼	NW¼	SW¼	SE¼	NE¼	NW¼	SW¼	SE¼	NE¼	NW¼	SW¼	SE¼	NE¼	NW¼	SW¼	SE¼		

Owner of Land ---- NAME: _____
ADDRESS: _____

Sec.	Twp.	Range	NE¼				NW¼				SW¼				SE¼				TOTAL ACRES		
			NE¼	NW¼	SW¼	SE¼	NE¼	NW¼	SW¼	SE¼	NE¼	NW¼	SW¼	SE¼	NE¼	NW¼	SW¼	SE¼			

Owner of Land ---- NAME: _____
ADDRESS: _____

Sec.	Twp.	Range	NE¼				NW¼				SW¼				SE¼				TOTAL ACRES			
			NE¼	NW¼	SW¼	SE¼	NE¼	NW¼	SW¼	SE¼	NE¼	NW¼	SW¼	SE¼	NE¼	NW¼	SW¼	SE¼				

4. *Continued:* If this application is for a change in place of use, it is proposed that the place of use be changed to:

Owner of Land ---- NAME: Greg C & Sue Love
ADDRESS: 24506 31 RD Montezuma KS 67867

Sec.	Twp.	Range	NE¼				NW¼				SW¼				SE¼				TOTAL ACRES			
			NE¼	NW¼	SW¼	SE¼	NE¼	NW¼	SW¼	SE¼	NE¼	NW¼	SW¼	SE¼	NE¼	NW¼	SW¼	SE¼				
31	27s	38w	32.5	32.5	32.5	32.5															130.0	

Owner of Land ---- NAME: Love AG Company
ADDRESS: 24506 31 RD Montezuma KS 67867

Sec.	Twp.	Range	NE¼				NW¼				SW¼				SE¼				TOTAL ACRES			
			NE¼	NW¼	SW¼	SE¼	NE¼	NW¼	SW¼	SE¼	NE¼	NW¼	SW¼	SE¼	NE¼	NW¼	SW¼	SE¼				
36	27s	29w	32.0	32.0	32.0	32.0	32.0	32.0	32.0	32.0	32.0	32.0	32.0	32.0	32.0	32.0	32.0	32.0	32.0	32.0	32.0	376.0
29	27s	28w					31.0	31.0	31.0	31.0	31.0	31.0	31.0	31.0	31.0	31.0	31.0	31.0	31.0	31.0	31.0	372.0

Owner of Land ---- NAME: _____
ADDRESS: _____

Sec.	Twp.	Range	NE¼				NW¼				SW¼				SE¼				TOTAL ACRES				
			NE¼	NW¼	SW¼	SE¼	NE¼	NW¼	SW¼	SE¼	NE¼	NW¼	SW¼	SE¼	NE¼	NW¼	SW¼	SE¼					

14. If the proposed groundwater point of diversion is 300 or fewer feet from the existing point of diversion, complete the following:

- (a) Does the undersigned represent all owners of the currently authorized place(s) of use identified in this application?
 Yes No (If no, all owners must sign this application.)
- (b) Will the ownership interest of any owner of the currently authorized place(s) of use identified in this application be adversely affected if this application is approved as requested?
 Yes No (If yes, all owners must sign this application.)
- (c) If this application is not approved expeditiously, will there be substantial damage to property, public health or safety?
 Yes No (If no, all owners must sign this application.)

If the application proposes a surface water change in point of diversion, a groundwater change in point of diversion greater than 300 feet, or a change in place of use, the application must be signed by all owners of the currently authorized place of use, or their duly authorized agent (attach notarized statement authorizing representation).

I hereby verify, being first duly sworn upon my oath or affirmation and under penalty of perjury, that I am of lawful age and the owner, the spouse of the owner, or a duly authorized agent of the owner(s) to make this application on their behalf, in regards to the water right(s) to which this application pertains. I further verify that the statements contained in this application are true, correct and complete.

Dated at _____, Kansas, this _____ day of _____, 20_____.

_____	<i>Susan M. Love</i>
(Owner)	(Spouse)
_____	<i>SUSAN M. LOVE</i>
(Please Print)	(Please Print)
_____	_____
(Owner)	(Spouse)
_____	_____
(Please Print)	(Please Print)
_____	_____
(Owner)	(Spouse)
_____	_____
(Please Print)	(Please Print)

State of Missouri }
 County of Jackson } SS

ADAM GARRETT SHULYAN
 NOTARY PUBLIC - NOT COMEAL
 STATE OF MISSOURI - JACKSON COUNTY
 COMMISSION # 00900316
 MY COMMISSION EXPIRES APR 1, 2022

I hereby certify that the foregoing application was signed in my presence and sworn to before me this 6th day of August, 2019.

Adam Garrett Shulyan
 Notary Public
 Notary for Susan Love only

My Commission Expires 4-1-22

ONLY COMPLETE APPLICATIONS WILL BE PROCESSED. To be complete, all of the applicable portions of the application form must be completed with accurate information; maps, if necessary, must be included; signatures of all the appropriate owners must be affixed to the application and notarized; and the appropriate fee must be paid.

FEE SCHEDULE

Each application to change the place of use or the point of diversion under this section shall be accompanied by the application fee set forth in the schedule below: Make checks payable to: **Kansas Department of Agriculture**

- (1) Application to change a point of diversion 300 feet or less \$100
- (2) Application to change a point of diversion more than 300 feet \$200
- (3) Application to change the place of use \$200

14. If the proposed groundwater point of diversion is 300 or fewer feet from the existing point of diversion, complete the following:
- (a) Does the undersigned represent all owners of the currently authorized place(s) of use identified in this application?
 Yes No (If no, all owners must sign this application.)
 - (b) Will the ownership interest of any owner of the currently authorized place(s) of use identified in this application be adversely affected if this application is approved as requested?
 Yes No (If yes, all owners must sign this application.)
 - (c) If this application is not approved expeditiously, will there be substantial damage to property, public health or safety?
 Yes No (If no, all owners must sign this application.)

If the application proposes a surface water change in point of diversion, a groundwater change in point of diversion greater than 300 feet, or a change in place of use, the application must be signed by all owners of the currently authorized place of use, or their duly authorized agent (attach notarized statement authorizing representation).

I hereby verify, being first duly sworn upon my oath or affirmation and under penalty of perjury, that I am of lawful age and the owner, the spouse of the owner, or a duly authorized agent of the owner(s) to make this application on their behalf, in regards to the water right(s) to which this application pertains. I further verify that the statements contained in this application are true, correct and complete.

Dated at Morden City, Kansas, this 7th day of August, 2019.

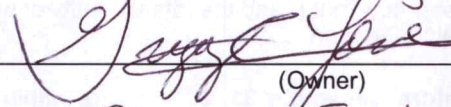
 (Owner)	 (Spouse)
<u>Gregory E. Love</u> (Please Print)	 (Please Print)
 (Owner)	 (Spouse)
 (Please Print)	 (Please Print)
 (Owner)	 (Spouse)
 (Please Print)	 (Please Print)

State of Kansas }
 County of Finney } SS



I hereby certify that the foregoing application was signed in my presence and sworn to before me this 7th day of August, 2019.

Patricia Stapleton
 Notary Public

My Commission Expires 5-21-2021.

ONLY COMPLETE APPLICATIONS WILL BE PROCESSED. To be complete, all of the applicable portions of the application form must be completed with accurate information; maps, if necessary, must be included; signatures of all the appropriate owners' must be affixed to the application and notarized; and the appropriate fee must be paid.

FEE SCHEDULE

Each application to change the place of use or the point of diversion under this section shall be accompanied by the application fee set forth in the schedule below: Make checks payable to: **Kansas Department of Agriculture**

(1) Application to change a point of diversion 300 feet or less	\$100
(2) Application to change a point of diversion more than 300 feet	\$200
(3) Application to change the place of use	\$200

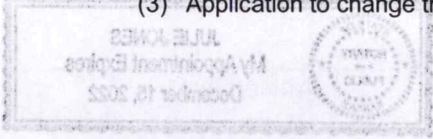

SUMMARY ORDER APPROVING APPLICATION FOR CHANGE AND IMPOSING CONDITIONS

This Summary Order is issued under authority of K.S.A. 82a-708b, as amended, and K.A.R. 5-5-1, *et seq.* and other applicable provisions of the *Kansas Water Appropriation Law, K.S.A. 82a-701 et seq.*, and rules and regulations promulgated thereunder, With the exception of those conditions expressly contained herein, this Summary Order does not change the terms, conditions and limitations of File No. 27702.

1. A change application was received on August 7, 2019 requesting that the place of use and / or point of diversion authorized under the above-referenced file number be changed as described in the application.
2. On and after the effective date of this summary order, the authorized place(s) of use shall be located substantially as shown on the topographic map accompanying the application to change the place of use. Applicable Not Applicable
3. The change in point of diversion shall not impair existing rights and shall be limited to the same source or sources of water as previously authorized. The point of diversion authorized by this summary order shall be located within a foot radius of the authorized point(s) of diversion. Applicable Not Applicable
4. The point(s) of diversion described herein is administratively corrected to be more accurately described using the Global Positioning System (GPS), as described in the application. Applicable Not Applicable
5. The point(s) of diversion authorized herein shall not actually be located more than feet from the previously authorized point(s) of diversion. Applicable Not Applicable
6. As required by K.A.R. 5-3-5d, if the works for diversion is a well with a diversion rate of 100 gallons per minute or more, a tube or other device suitable for making water level measurements shall be installed, operated and maintained in accordance with K.A.R. 5-6-13. Applicable Not Applicable
7. **The owner of the authorized place(s) of use shall properly install an acceptable water flow meter on or before December 31, 2019**, or before the first use of water, whichever occurs first. The water flow meter shall be installed, operated and maintained in accordance with K.A.R. 5-1-4 through 5-1-12. As required by K.S.A. 82a-732, as amended, and K.A.R. 5-3-5e, the owner shall maintain records and report the reading of the water flow meter and the total quantity of water diverted annually to the Chief Engineer by March 1 following the end of each calendar year. Applicable Not Applicable
8. **Installation of the works for diversion of water shall be completed on or before December 31, 20**, or within any authorized extension of time. By March 1, 20 the applicant shall notify the Chief Engineer that construction of the works for diversion has been completed, on the form provided by the Chief Engineer, as required by K.A.R. 5-8-4e. Applicable Not Applicable
9. **The completed well log shall be submitted with the required notice.** Applicable Not Applicable
10. All diversion works into which any type of chemical or other foreign substance will be injected into the water shall be equipped with an in-line, automatic, quick-closing check valve capable of preventing pollution of the source of the water supply. The check valve(s) shall be installed, operated and maintained in accordance with K.A.R. 5-3-5c. Applicable Not Applicable
11. Additional Conditions are attached. Yes No
12. In accordance with K.S.A. 82a-708a, as amended, and K.A.R. 5-5-14, all of the owners of the authorized place(s) of use of water appropriated under the above-referenced file number are responsible for compliance with its terms, conditions and limitations, as amended and/or supplemented by this Summary Order, and with applicable provisions of the *Kansas Water Appropriation Law* and the *Rules and Regulations* promulgated thereunder. Failure to comply with these provisions may result in civil penalties pursuant to K.S.A. 82a-737, as amended, and/or the suspension or revocation and dismissal of the water or appropriation right or any other enforcement actions authorized by law.

Administrative Appeal and Effective Date of Order

If you are aggrieved by this order, pursuant to K.S.A. 82a-1901, you may request an evidentiary hearing before the Chief Engineer or request administrative review by the Secretary of Agriculture. A request for hearing by the Chief Engineer must be filed within **15 days** of service of this Order and a request for administrative review by the Secretary must be filed within **30 days** pursuant to K.S.A. 77-531. Any request for administrative review must state a basis for review pursuant to K.S.A. 77-527. File any request with **Kansas Department of Agriculture, Legal Division, 1320 Research Park Drive, Manhattan, KS 66502**. Failure to timely request a hearing or review may preclude review under the Kansas Judicial Review Act.

For Use by Register of Deeds

FOR OFFICE USE ONLY
**APPLICATION APPROVED AND
 SUMMARY ORDER ISSUED**

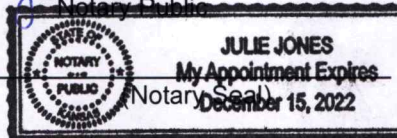
By: Austin McColloch
 Duly Authorized Designee of the Chief Engineer
 (Print Name): Austin McColloch
 Division of Water Resources - Kansas Department of Agriculture
 Date of Issuance: August 15, 2019
 State of Kansas)
) SS
 County of Finney)
 Acknowledged before me on August 15, 2019
 by Austin McColloch
 Signature: Julie Jones
 Notary Public
 My commission expires: _____

Change App. PU, File No. 27702

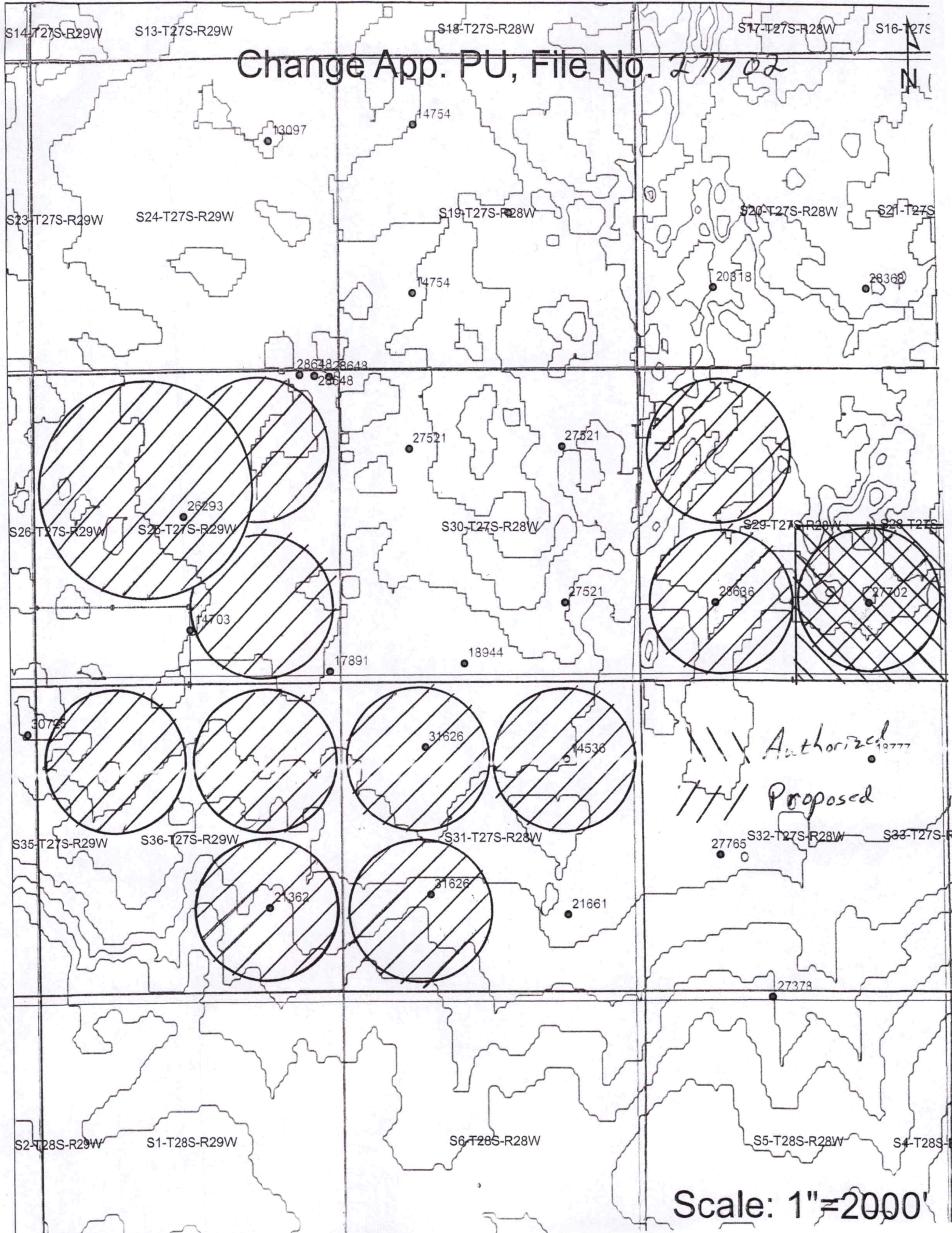

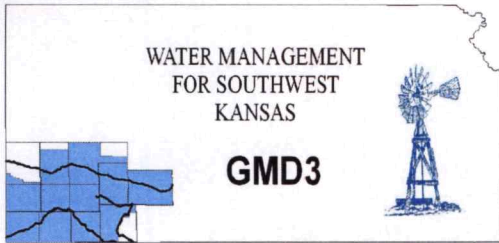

Southwest Kansas
Groundwater Management District No. 3
2009 E. Spruce Street
Garden City, Kansas 67846
(620) 275-7147 phone (620) 275-1431 fax
www.gmd3.org

June 14, 2019

RECEIVED

AUG 07 2019

Garden City Field Office
Division of Water Resources

Michael A. Meyer
Division of Water Resources
4532 W Jones Ave., Suite B
Garden City, Kansas 67846

RE: Applications for Change in Place of Use
Water Right, File Nos. 14536, 14703, 17891, 21362, 26293, 27702, 28636, 28648 &
31626

Dear Mike:

We have assisted with the applications for the above referenced water rights. The proposal is not in conflict with the Management Program of the Southwest Kansas Groundwater Management District No. 3 (GMD3). The proposed change in place of use for a complete overlap in irrigation acres is in accordance with K.A.R. 5-5-11. No new acres are being proposed. It is therefore recommended that the applications be approved at this time.

Thank you for the opportunity to review the applications and to provide a recommendation. If you have any questions, please don't hesitate to contact us.

Sincerely,

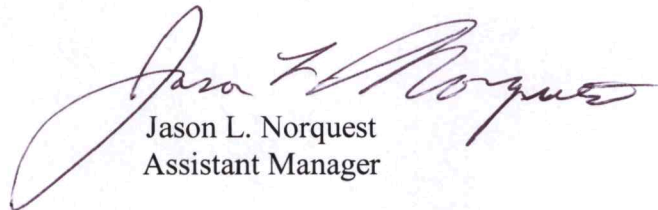

Jason L. Norquest
Assistant Manager

Entered on Record in this office this 13th day of Nov, 2017
Gray Co. Clk Megan Wilson
Deputy Clerk

State of Kansas, Gray County SS.
This instrument was filed for Record on 11/13/2017 at 10:54 AM and Recorded in Book 135
Page 120-121 Fee: \$32.00



PHOTO-COPIED
INDEXED

Y. Fairbanks Deputy
Bene L Shriner, Register of Deeds

WR # 27702

TRUSTEE'S DEED

SE29-27-28
Love Ag Co

THIS INDENTURE, made on 11 ^{TRUST}, 2017 by and between EDWARD L. ZIMMERMAN as Trustee of THE TRUSE OF EDWARD L. ZIMMERMAN AND DOROTHY J. ZIMMERMAN, under agreement dated February 22, 1992 as GRANTOR, and

LOVE AG CO., as GRANTEE:

GRANTOR, by virtue of the terms and provisions of said trust agreement, in consideration of the sum of \$10 and other valuable consideration, the receipt of which is hereby acknowledged, does hereby grant, bargain, sell and convey unto Grantee all of the following described property in GRAY County, Kansas:

The Southeast Quarter (SE/4) of Section Twenty-nine (29), Township Twenty-seven (27) South, Range Twenty-eight (28) West of the 6th P.M., Gray County, Kansas.

GRANTOR covenants that the trust remains in full force and effect at this time, and the Trustee has authorization without limitation to sell and convey all of the above described real estate.

DATED: 11-1-17

By Edward Zimmerman
EDWARD L. ZIMMERMAN, Trustee

RECEIVED

AUG 07 2019

Garden City Field Office
Division of Water Resources

STATE OF Calif
COUNTY OF Sacramento

BE IT REMEMBERED, That on _____, 2017, the foregoing instrument was acknowledged by

EDWARD L. ZIMMERMAN as Trustee of THE TRUST OF Edward L. ZIMMERMAN AND DOROTHY J. ZIMMERMAN, under agreement dated February 22, 1992

IN WITNESS WHEREOF, I have hereunto set my hand and affixed my seal, the day and year last above written.

* See attached California ^{CO} Acknowledgement

Notary Public

My Term Expires: _____

SE 29-27-28

CALIFORNIA ALL-PURPOSE ACKNOWLEDGMENT

CIVIL CODE § 1189

A notary public or other officer completing this certificate verifies only the identity of the individual who signed the document to which this certificate is attached, and not the truthfulness, accuracy, or validity of that document.

State of California)
County of Sacramento)
On 11/11/17 before me, Samantha Dennis
Date Here Insert Name and Title of the Officer
personally appeared Edward Zimmerman
Name(s) of Signer(s)

who proved to me on the basis of satisfactory evidence to be the person(s) whose name(s) is/are subscribed to the within instrument and acknowledged to me that he/she/they executed the same in his/her/their authorized capacity(ies), and that by his/her/their signature(s) on the instrument the person(s), or the entity upon behalf of which the person(s) acted, executed the instrument.

I certify under PENALTY OF PERJURY under the laws of the State of California that the foregoing paragraph is true and correct.

WITNESS my hand and official seal.



Signature [Handwritten Signature]
Signature of Notary Public

2E 29-27-28
Place Notary Seal Above

OPTIONAL

Though this section is optional, completing this information can deter alteration of the document or fraudulent reattachment of this form to an unintended document.

Description of Attached Document

Title or Type of Document: Trustee's Deed
Document Date: 11/11/17 Number of Pages: 1
Signer(s) Other Than Named Above: _____

Capacity(ies) Claimed by Signer(s)

Signer's Name: _____
 Corporate Officer — Title(s): _____
 Partner — Limited General
 Individual Attorney in Fact
 Trustee Guardian or Conservator
 Other: _____
Signer Is Representing: _____

Signer's Name: _____
 Corporate Officer — Title(s): _____
 Partner — Limited General
 Individual Attorney in Fact
 Trustee Guardian or Conservator
 Other: _____
Signer Is Representing: _____

RECEIVED

AUG 07 2019

Garden City Field Office
Division of Water Resources