

NOTICE

This scan only represents the application as filed. The information contained herein meets the requirements of K.A.R. 5-3-1 or K.A.R. 5-5-1, and has been found acceptable for filing in the office of the Chief Engineer. The application should not be considered to be a complete application as per K.A.R. 5-3-1b or K.A.R. 5-5-2a.

Submit completed application to:
 Kansas Department of Agriculture
 Division of Water Resources
 Field Office for your area.
 Call for address:
 Topeka -- (785) 296-5733
 Stafford -- (620) 234-5311
 Stockton -- (785) 425-6787
 Garden City -- (620) 276-2901
<http://agriculture.ks.gov/dwr>

DWR FIELD OFFICE APPLICATION FOR APPROVAL TO CHANGE THE PLACE OF USE AND/OR THE POINT OF DIVERSION



STATE OF KANSAS

**Filing Fee Must Accompany the Application, K.S.A. 82a-708b(b), as amended.
 Fee Schedule is on the third page of this application form.**

Paragraph Nos. 1, 2, 3 & 5 must be completed. Complete all other applicable portions. If change in point of diversion is greater than 100 feet, or if place of use will be changed, include a topographic map or detailed plat showing the authorized and proposed point(s) of diversion and/or place of use.

File No. 9878

RECEIVED
 11:35 AM
DEC 06 2019
 Garden City Field Office
 DIVISION OF WATER RESOURCES

1. Application is hereby made for approval of the Chief Engineer to change the (check one or both):

Place of Use Point of Diversion

under the water right which is the subject of this application in accordance with the conditions described below.

The source of supply is: Groundwater Surface water

2. Name and address of Applicant: Stapleton Family Farms TH#6 113 Diamond Hill Dr. Garden City KS 67846

Phone Number: () _____ Email address: _____

Name and address of Water Use Correspondent: Joyce Stapleton 113 Diamond Hill Dr. Garden City KS 67846

Phone Number: () _____ Email address: _____

3. The presently authorized place of use is:

Owner of Land --- NAME: _____

ADDRESS: _____

(If there is more than one landowner, attach supplemental sheets as necessary.)

Sec.	Twp.	Range	NE¼				NW¼				SW¼				SE¼				TOTAL ACRES		
			NE¼	NW¼	SW¼	SE¼	NE¼	NW¼	SW¼	SE¼	NE¼	NW¼	SW¼	SE¼	NE¼	NW¼	SW¼	SE¼			

4. If this application is for a change in place of use, it is proposed that the place of use be changed to:

Owner of Land --- NAME: _____

ADDRESS: _____

(If there is more than one landowner, attach supplemental sheets as necessary.)

Sec.	Twp.	Range	NE¼				NW¼				SW¼				SE¼				TOTAL ACRES			
			NE¼	NW¼	SW¼	SE¼	NE¼	NW¼	SW¼	SE¼	NE¼	NW¼	SW¼	SE¼	NE¼	NW¼	SW¼	SE¼				

For Office Use Only: Code _____ Fee \$ 200.00 TR # _____ Receipt Date 12-6-19 Check # 1144

5. **Presently authorized point of diversion:**
 One in the NW Quarter of the NW Quarter of the SE Quarter
 of Section 6, Township 31 South, Range 32 W,
 in Seward County, Kansas, 2594 feet North 2437 feet West of Southeast corner of section.
 Authorized Rate 1940 GPM Authorized Quantity 146 AF Depth of well _____ (feet)
(DWR use only: Computer ID No. _____ GPS _____ feet North _____ feet West)
 This point will not be changed This point will be changed as follows: No change, point better described with GPS as follows:
Proposed point of diversion: (Complete only if change is requested or if existing point is better described by GPS)
 One in the SE Quarter of the SW Quarter of the SE Quarter
 of Section 6, Township 31 South, Range 32 W,
 in Seward County, Kansas, 223 feet North 1427 feet West of Southeast corner of section.
 Proposed Rate _____ Proposed Quantity _____ Proposed well depth (feet) _____
 This point is: Additional Well Geo Center List other water rights that will use this point _____

6. **Presently authorized point of diversion:**
 One in the NE E1/2 Quarter of the NW Quarter of the NW Quarter
 of Section 6, Township 31 South, Range 32 W,
 in Seward County, Kansas, 4662 feet North 4129 feet West of Southeast corner of section.
 Authorized Rate 1980 GPM Authorized Quantity 606 AF Depth of well _____ (feet)
(DWR use only: Computer ID No. _____ GPS _____ feet North _____ feet West)
 This point will not be changed This point will be changed as follows: No change, point better described with GPS as follows:
Proposed point of diversion: (Complete only if change is requested or if existing point is better described by GPS)
 One in the _____ Quarter of the _____ Quarter of the _____ Quarter
 of Section _____, Township _____ South, Range _____ (E/W),
 in _____ County, Kansas, _____ feet North _____ feet West of Southeast corner of section.
 Proposed Rate _____ Proposed Quantity _____ Proposed well depth (feet) _____
 This point is: Additional Well Geo Center List other water rights that will use this point _____

7. The changes herein are desired for the following reasons?
 (please be specific) _____

8. If a well, is the test hole log attached? Yes No

9. The change(s) (was)(will be) completed by?

10. If the point of diversion is a well:
 (a) What are you going to do with the old well?

 (b) When will this be done? _____

11. Groundwater Management District recommendation attached?
 Yes No

12. Assisted by SZ _____

13a. If the proposed point of diversion will be relocated more than 300 feet but within 2,640 feet of the existing point of diversion, attach a topographic map or aerial photograph. For groundwater sources, show all wells (including domestic) within one-half mile of the proposed point of diversion and the names and mailing addresses of the owners. For surface water sources, show the names and addresses of the landowner(s) one-half mile downstream and one-half mile upstream from your property lines

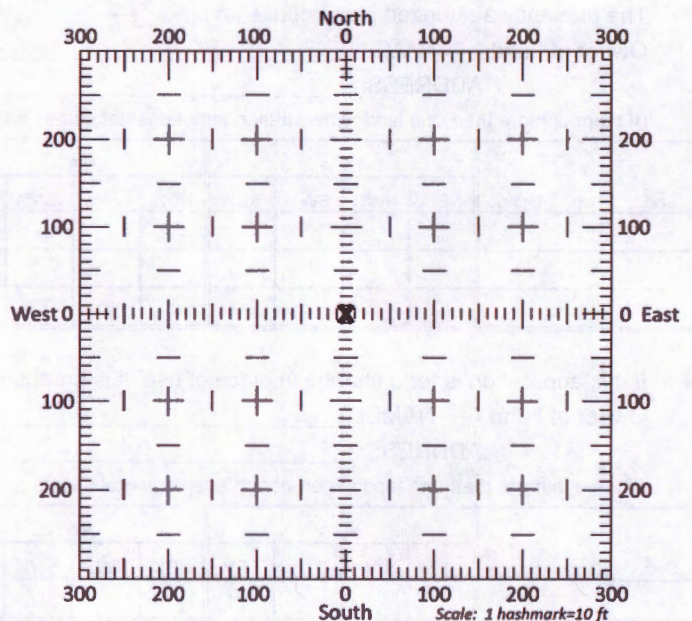

13b. If the proposed point of diversion will be relocated within 300 feet of the existing point of diversion, indicate its location on the diagram shown above in relation to the existing point of diversion. (PLEASE NOTE: The "X" in center of diagram above represents the presently authorized point of diversion.)

6. **Presently authorized point of diversion:**
 One in the NE Quarter of the SE Quarter of the NE Quarter
 of Section 1, Township 31 South, Range 33 W,
 in Seward County, Kansas, 3685 feet North 45 feet West of Southeast corner of section.
 Authorized Rate 2140 GPM Authorized Quantity 1311 AF Depth of well _____ (feet)
 (DWR use only: Computer ID No. _____ GPS _____ feet North _____ feet West)
 This point will not be changed This point will be changed as follows: No change, point better described with GPS as follows:
Proposed point of diversion: (Complete only if change is requested or if existing point is better described by GPS)
 One in the _____ Quarter of the _____ Quarter of the _____ Quarter
 of Section _____, Township _____ South, Range _____ (E/W),
 in _____ County, Kansas, _____ feet North _____ feet West of Southeast corner of section.
 Proposed Rate _____ Proposed Quantity _____ Proposed well depth (feet) _____
 This point is: Additional Well Geo Center List other water rights that will use this point _____

6. **Presently authorized point of diversion:**
 One in the _____ Quarter of the _____ Quarter of the _____ Quarter
 of Section 1, Township 31 South, Range 33 W,
 in Seward County, Kansas, 5196 feet North 4895 feet West of Southeast corner of section.
 Authorized Rate 2050 GPM Authorized Quantity 485 AF Depth of well _____ (feet)
 (DWR use only: Computer ID No. _____ GPS _____ feet North _____ feet West)
 This point will not be changed This point will be changed as follows: No change, point better described with GPS as follows:
Proposed point of diversion: (Complete only if change is requested or if existing point is better described by GPS)
 One in the _____ Quarter of the _____ Quarter of the _____ Quarter
 of Section _____, Township _____ South, Range _____ (E/W),
 in _____ County, Kansas, _____ feet North _____ feet West of Southeast corner of section.
 Proposed Rate _____ Proposed Quantity _____ Proposed well depth (feet) _____
 This point is: Additional Well Geo Center List other water rights that will use this point _____

14. If the proposed groundwater point of diversion is 300 or fewer feet from the existing point of diversion, complete the following:

- (a) Does the undersigned represent all owners of the currently authorized place(s) of use identified in this application?
 Yes No (If no, all owners must sign this application.)
- (b) Will the ownership interest of any owner of the currently authorized place(s) of use identified in this application be adversely affected if this application is approved as requested?
 Yes No (If yes, all owners must sign this application.)
- (c) If this application is not approved expeditiously, will there be substantial damage to property, public health or safety?
 Yes No (If no, all owners must sign this application.)

If the application proposes a surface water change in point of diversion, a groundwater change in point of diversion greater than 300 feet, or a change in place of use, the application must be signed by all owners of the currently authorized place of use, or their duly authorized agent (attach notarized statement authorizing representation).

I hereby verify, being first duly sworn upon my oath or affirmation and under penalty of perjury, that I am of lawful age and the owner, the spouse of the owner, or a duly authorized agent of the owner(s) to make this application on their behalf, in regards to the water right(s) to which this application pertains. I further verify that the statements contained in this application are true, correct and complete.

Dated at Garden City, Kansas, this 6th day of December, 2019.

Donna White

 (Owner)

Donna White

 (Please Print)

 (Owner)

 (Please Print)

 (Owner)

 (Please Print)

 (Spouse)

 (Please Print)

 (Spouse)

 (Please Print)

 (Spouse)

 (Please Print)

State of Kansas }
County of Finney } SS

I hereby certify that the foregoing application was signed in my presence and sworn to before me this 6th day of December, 2019.



My Commission Expires _____

Julie Jones

 Notary Public

ONLY COMPLETE APPLICATIONS WILL BE PROCESSED. To be complete, all of the applicable portions of the application form must be completed with accurate information; maps, if necessary, must be included; signatures of all the appropriate owners' must be affixed to the application and notarized; and the appropriate fee must be paid.

FEE SCHEDULE

Each application to change the place of use or the point of diversion under this section shall be accompanied by the application fee set forth in the schedule below: Make checks payable to: **Kansas Department of Agriculture**

- (1) Application to change a point of diversion 300 feet or less \$100
- (2) Application to change a point of diversion more than 300 feet \$200
- (3) Application to change the place of use \$200

CHANGE IN PLACE OF DIVERSION WATER RIGHT, FILE NO. 459 & 9878

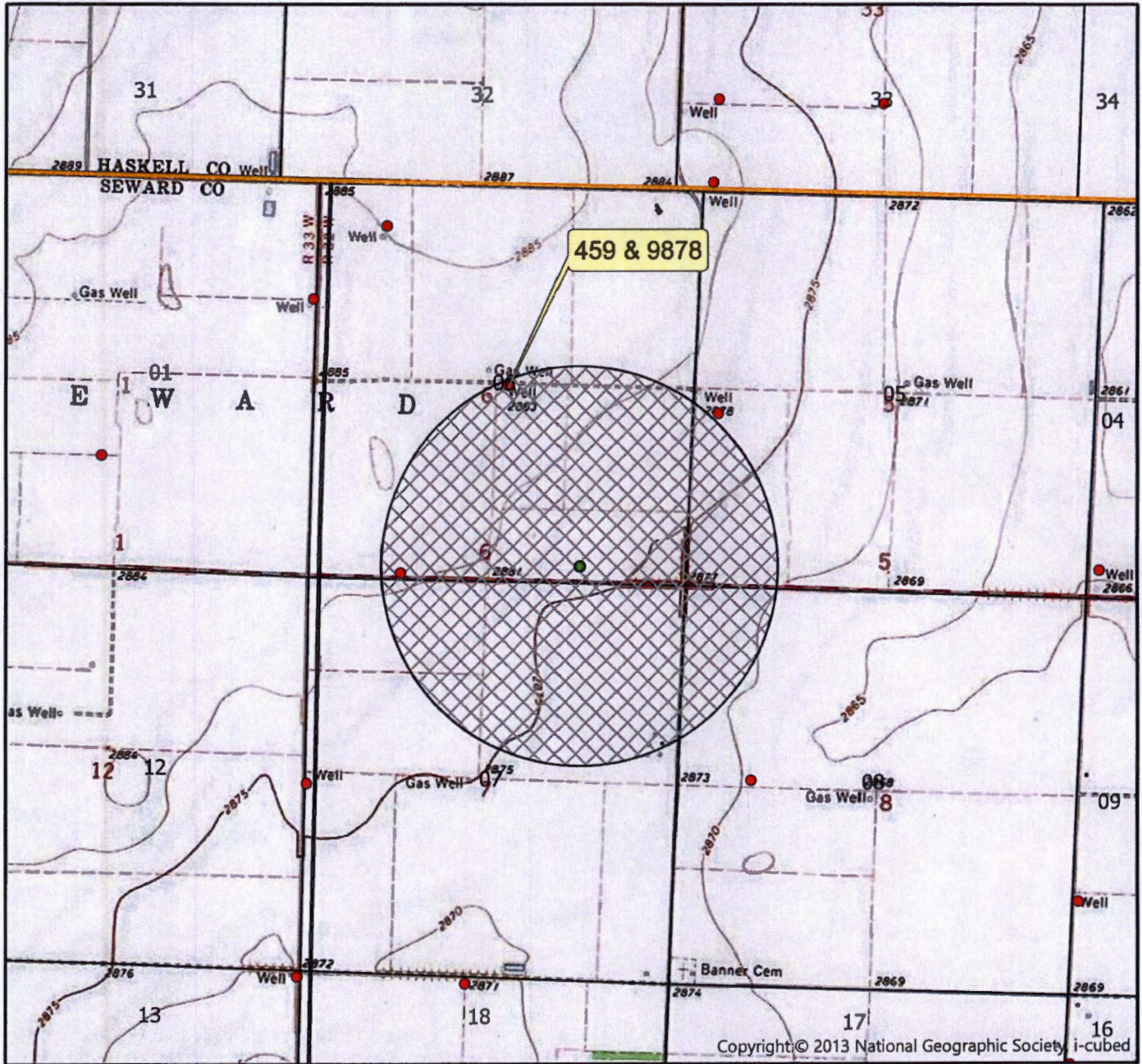

Township 31 South Range 32 West
Seward County

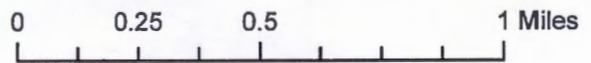

- Authorized Point of Diversion
- Proposed Point of Diversion

1/2 mile buffer

All wells of any kind within 1/2 mile of the requested place of use have been plotted.



(Signature)

Created by: SZ/GCFO

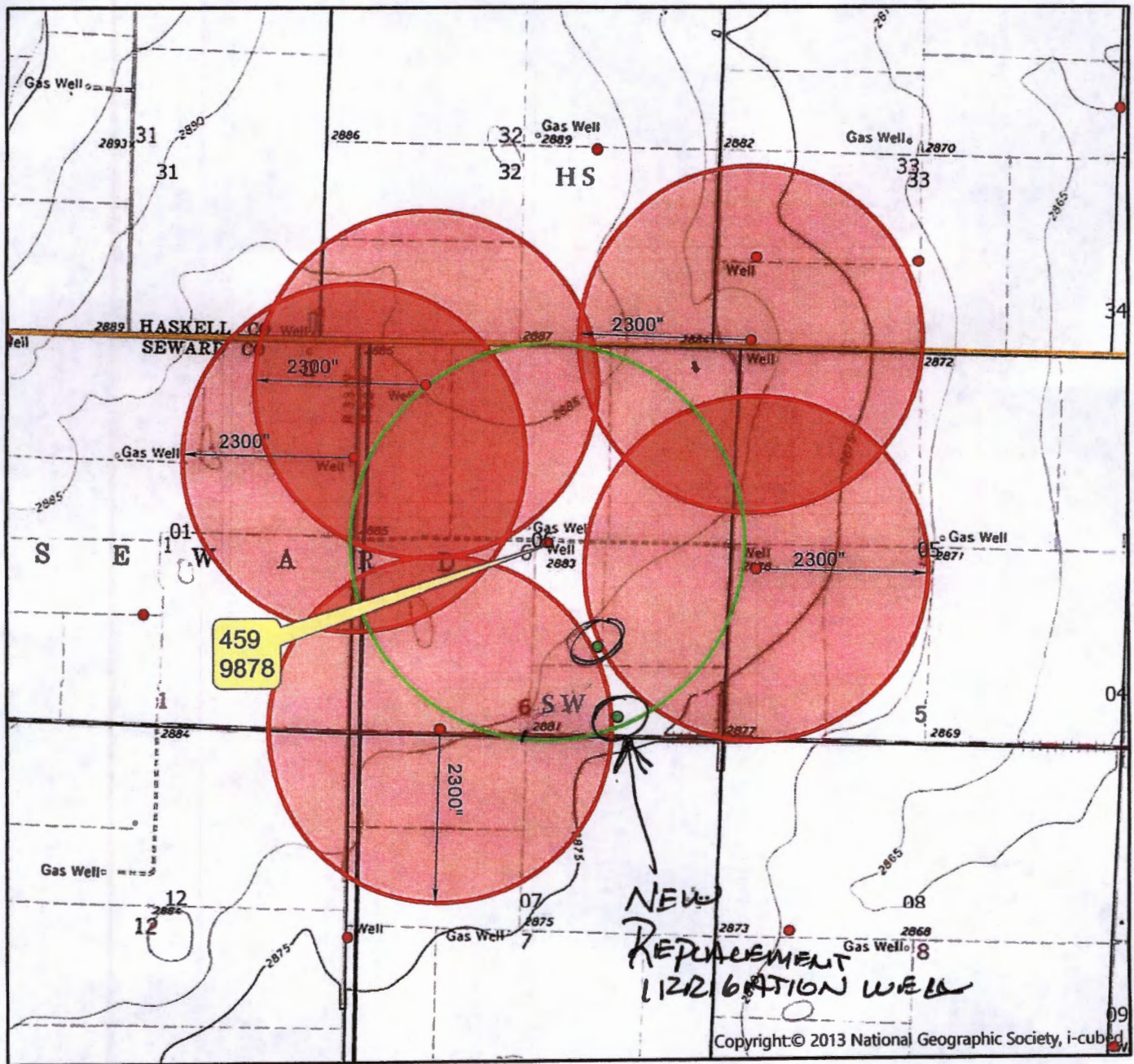

WR 459 & 9878

Preliminary Map as of 10/04/2019. Using data given to the DWR by the customer.
Based on the best information that was received and in the DWR files as of the above date.

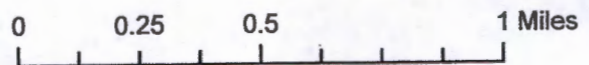

Township 31 South Range 32 West
Seward County



-  1/2 mile radius, maximum distance
-  Minimum well spacing of neighboring wells
-  Proposed new location



Created by: SZ/GCFO

STAPLETON FAMILY FARMS

SE 6-31S-32W SEWARD CO.

IRR WELL ELEV=2887'

TH #4 ELEV=2887'

TH #1 ELEV=2887'

TH #2 ELEV=2885'

TH #3 ELEV=2882'

TH #5 ELEV=2878'

TH #6 ELEV=2878'

NEW WELL REPLACEMENT

Go Rd N

WELL LOG

DATE: 11/20/2019

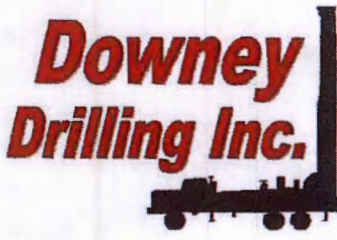

#10

ELEV = 2878

CUSTOMER NAME: STAPLETON FAMILY FARMS TH#6

LEGAL: SE 6-315-32W

COUNTY: SEWARD

GPS: N 37.373940

W 100.838600

LOGGER:

DRILLER: DALE GUINN

WO: 19-1067

TW	FROM	TO	TYPE	HARDNESS	COLOR	SPEED	PULL DOWN	OTHER / DRILLING ACTION
0	14		SANDY CLAY		BROWN			SMOOTH
14	21		SANDY CLAY W/ SOME CALICHE		BROWN			SMOOTH SMOOTH & LITTLE CHOPPY
21	29		SANDY CLAY & CALICHE		TAN			
29	34		SANDY CLAY		BROWN			SMOOTH SMOOTH & LITTLE CHOPPY
34	40		CLAY & CALICHE		BROWN			
40	58		SANDY CLAY W/ FINE SAND MIXED		BROWN			SMOOTH
58	89		FINE-MED-COARSE SAND, SMALL-MED-LARGE GRAVEL					CHATTER SMOOTH & LITTLE CHOPPY
89	102		CLAY W/ LITTLE CALICHE LAYER		BROWN			
102	111		FINE-MED-COARSE W/ FEW CLAY STRINGERS					SMOOTH
111	155		FINE-MED-COARSE SAND, SMALL-MED GRAVEL					CHATTER
155	160		SANDY CLAY		TAN			SMOOTH
160	210		FINE-MED-COARSE SAND, SMALL GRAVEL					CHATTER
210	212		SANDY CLAY					SMOOTH CHATTER & SMOOTH IN PLACES
212	269		FINE-MED-COARSE SAND, SMALL GRAVEL W/ FEW CLAY LAYERS					
269	272		SANDY CLAY					SMOOTH
272	291		FINE-MED-COARSE SAND, SMALL GRAVEL					CHATTER SMOOTH & LITTLE CHATTER
291	300		SANDY CLAY W/ SOME SAND STRIPS		LIGHT BLUE &			
300	376		FINE-MED-COARSE SAND, SMALL GRAVEL					CHATTER
376	389		SANDY CLAY & FINE-MED-COARSE SAND					CHATTER
389	400		SANDY CLAY		TAN TAN & WHITE			SMOOTH
400	411		SANDY CLAY W/ LIME ROCK & FINE SAND					CHOPPY LITTLE CHATTER & SMOOTH IN PLACES
411	431		SANDY CLAY W/ FEW THIN FINE SAND STRIPS		BROWN			
431	449		SANDY CLAY		BROWN			SMOOTH
449	460		FINE-MED SAND					VIBRATION
460	482		FINE SAND					VIBRATION
482	490		SANDY CLAY		BROWN LIGHT BLUE &			SMOOTH
490	509		SHALE					SMOOTH
509	519		SANDSTONE USED WATER MIXED WITH BRAN & MUD					VIBRATION
519	534		SANDSTONE & SOAPSTONE LEDGES					VIBRATION
534	549		SANDSTONE, LOST CIRCULATION @ 547' - LOTS OF WATER & HAS SOME DARK BROWN ROCK					VIBRATION
549	586		SANDSTONE & FEW SOAPSTONE STRIPS					VIBRATION
586	600		RED BED		RED			CHOPPY

STATIC 300'
68
13

11
22

13
15
15
10

LOOSE
LITTLE
TIGHT
LOOSE
TIGHT

Garden City Field Office
4532 W. Jones, Suite B
Garden City, KS 67846



Phone: 620-276-2901
Fax: 620-276-9315
www.agriculture.ks.gov

Mike Beam, Secretary

Laura Kelly, Governor

December 17, 2019

EDWIN L STAPLETON
P O BOX 548
SUBLETTE, KS 67877

RE: Water Right, File Nos. 459 & 9878

Dear Sir or Madam:

This is to advise you that Stapleton Family Farms has filed an application for approval of the Chief Engineer, Division of Water Resources, Kansas Department of Agriculture, to change the point of diversion under the above referenced applications. An irrigation well is proposed to be relocated to the SE $\frac{1}{4}$ SW $\frac{1}{4}$ SE $\frac{1}{4}$ of Section 6, Township 31 South, Range 32 West, Seward County.

You can find the complete applications posted by water right file number as referenced above at: <https://agriculture.ks.gov/divisions-programs/dwr/water-appropriation/notices>

You are notified on this proposed point of diversion (well) so that you may furnish this office with any comments or other information you want to submit. Such comments or other information must be received in this office within 15 days from the date of this letter.

Should you have any questions, please feel free contact this office. If you would prefer, you could arrange an appointment for additional assistance. Please refer to the file number when you contact us if you wish to discuss a specific file.

Sincerely,

A handwritten signature in blue ink, appearing to read "Austin J. McCulloch".

Austin J. McCulloch
Assistant Water Commissioner

AM:
enclosures

pc:
GROUNDWATER MANAGEMENT DISTRICT NO. 3