

Kansas Department of Agriculture  
 Division of Water Resources  
**CHANGE: P/U WORKSHEET**

1. File Number: <b>11011</b>	2. Status Change Date: <i>11-4-2020</i>	3. Change Num: <b>C1</b>	4. Field Office: <b>04</b>	5. GMD: <b>03</b>
---------------------------------	--	-----------------------------	-------------------------------	----------------------

6. Status: <input checked="" type="checkbox"/> Approved <input type="checkbox"/> Denied by DWR/GMD <input type="checkbox"/> Dismiss by Request/Failure to Return	7. Filing Date of Change: <b>10/30/2020</b>
--	--

8a. LANDOWNER, applicant, WUC    Person ID **12335**  
 New to system     Add Seq# \_\_\_\_\_

**GREGORY & SHERRYL MORRIS**  
**501 S WILDCAT CT**  
**HUGOTON, KS 67951-3210**

8c. Correspondent    Person ID \_\_\_\_\_  
 New to system     Add Seq# \_\_\_\_\_

8b. Landowner(s),    Person ID **?**  
 New to system     Add Seq# \_\_\_\_\_

8d. correspondent    Person ID \_\_\_\_\_  
 New to system     Add Seq# \_\_\_\_\_

9. Documents and Enclosure(s):  DWR Meter(s) Date to Comply: **12/31/2021**     N & P Date to Comply: \_\_\_\_\_

Anti-Reverse Meter     Meter Seal     Check Valve     N & P Form     Water Tube     Driller Copy     H & E Letter

Conservation Plan    Date Required: \_\_\_\_\_    Date Approved: \_\_\_\_\_    Date to Comply: \_\_\_\_\_

10. Use Made of Water    From: \_\_\_\_\_    To: \_\_\_\_\_

Date Prepared: **11/4/20**    By: **MAM**  
 Date Entered: \_\_\_\_\_    By: \_\_\_\_\_

File No. **11011**      11. County: **SV**      Basin: **CIMARRON RIVER**      Stream:      Formation Code:      Special Use:

12. Points of Diversion  
**CHK**  
**MOD**  
**DEL** PDIV  
**ENT**

Qualifier	S	T	R	ID	'N	'W	Comment (AKA Line)	Rate and Quantity		Additional		Overlap PD Files
								Rate gpm	Quantity af	Rate gpm	Quantity af	

**CHK 234**

13. Storage: Rate \_\_\_\_\_ NF      Quantity \_\_\_\_\_ ac/ft      Additional Rate \_\_\_\_\_ NF      Additional Quantity \_\_\_\_\_ ac/ft

14. Limitation: \_\_\_\_\_ af/yr at \_\_\_\_\_ gpm ( \_\_\_\_\_ cfs) when combined with file number(s) \_\_\_\_\_  
 Limitation: \_\_\_\_\_ af/yr at \_\_\_\_\_ gpm ( \_\_\_\_\_ cfs) when combined with file number(s) \_\_\_\_\_

15. 5YR Allocation:      Allocation Type \_\_\_\_\_      Start Year \_\_\_\_\_      5 YR Amount \_\_\_\_\_      Amount Unit \_\_\_\_\_      Base Acres \_\_\_\_\_      Comment \_\_\_\_\_

16. Place of Use <b>CHK</b> <b>MOD</b> <b>DEL</b> <b>ENT</b>	PUSE	S	T	R	ID	NE¼				NW¼				SW¼				SE¼				Total	Owner	Chg?	Overlap Files
						NE ¼	NW ¼	SW ¼	SE ¼	NE ¼	NW ¼	SW ¼	SE ¼	NE ¼	NW ¼	SW ¼	SE ¼	NE ¼	NW ¼	SW ¼	SE ¼				
<b>MOD 6818</b>	<b>2</b>	<b>34</b>	<b>38</b>	<b>W</b>	<b>01</b>	39.49	39.46	40	40	36	13	36	40	40	40	40	40	36	40	36	13	568.95	<b>8a</b>	<b>No</b>	<b>12619, 12699</b>
						L-1	L-2			L-3	L-4														

Base Acres: **160**      Year:      Minimum Reasonable Quantity:  
 Comments: **LOT 1 IN NENE, LOT 2 IN NWNE, LOT 3 IN NENW, LOT 4 IN NWNW**



Garden City Field Office  
4532 W. Jones, Suite B  
Garden City, KS 67846



Phone: 620-276-2901  
Fax: 620-276-9315  
www.agriculture.ks.gov

Mike Beam, Secretary

Laura Kelly, Governor

November 4, 2020

GREGORY & SHERRYL MORRIS  
501 S WILDCAT CT  
HUGOTON, KS 67951-3210

RE: Water Right, File Nos. 11011, 12619, 12699

Dear Sir:

Enclosed are the orders executed by the designee of the Chief Engineer, Division of Water Resources, Kansas Department of Agriculture, approving the applications for change under the above referenced file numbers.

Your attention is directed to the enclosures and to the terms, conditions, and limitations specified in the approvals for change. A condition of these approvals are that an acceptable water flow meter must be installed on the diversion works authorized under the referenced file numbers and meet current specifications. Please return the required notification of completion of the diversion works and installation of the required meter as soon as these actions are completed.

Since the orders modify the original documents referred to above, they should be recorded with the Register of Deeds as other instruments affecting real estate.

Should you have any questions, please feel free contact this office. If you would prefer, you could arrange an appointment for additional assistance.

Sincerely,

A handwritten signature in blue ink that reads "Michael A. Meyer".

Michael A. Meyer  
Water Commissioner

MAM  
enclosures

pc:  
GMD3

**CERTIFICATE OF SERVICE**

On this 4<sup>th</sup> day of November 2020, I hereby certify that the foregoing Approvals of Application for Change in Place of Use, Water Right, File Nos. 11,011, 12,619, 12,699 dated 4<sup>th</sup> day of November 2020 was mailed postage prepaid, first class, US mail to the following:

GREGORY & SHERRYL MORRIS  
501 S WILDCAT CT  
HUGOTON, KS 67951-3210

Pc:

GROUNDWATER MANAGEMENT DISTRICT NO. 3

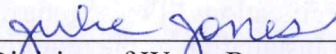
  
\_\_\_\_\_  
Division of Water Resources Staff



Submit completed application to:  
 Kansas Department of Agriculture  
 Division of Water Resources  
 Field Office for your area.

Call for address:

Topeka -- (785) 296-5733  
 Stafford -- (620) 234-5311  
 Stockton -- (785) 425-6787  
 Garden City -- (620) 276-2901  
<http://agriculture.ks.gov/dwr>

## DWR FIELD OFFICE APPLICATION FOR APPROVAL TO CHANGE THE PLACE OF USE AND/OR THE POINT OF DIVERSION



**STATE OF KANSAS**

**Filing Fee Must Accompany the Application, K.S.A. 82a-708b(b), as amended.**  
 Fee Schedule is on the third page of this application form.

**Paragraph Nos. 1, 2, 3 & 5 must be completed. Complete all other applicable portions.** If change in point of diversion is greater than 100 feet, or if place of use will be changed, include a topographic map or detailed plat showing the authorized and proposed point(s) of diversion and/or place of use.

File No. 11011

**RECEIVED**  
 3:45 PM  
**OCT 30 2020**

1. Application is hereby made for approval of the Chief Engineer to change the (check one or both):

Place of Use                       Point of Diversion

under the water right which is the subject of this application in accordance with the conditions described below.

The source of supply is:                       Groundwater                       Surface water

**Garden City Field Office  
 DIVISION OF WATER RESOURCES**

2. Name and address of Applicant: GREGORY & SHERRYL MORRIS  
501 S WILDCAT CT HUGOTON KS 67951-3210

Phone Number: (620) 544-9216                      Email address: \_\_\_\_\_

Name and address of Water Use Correspondent: ERNEST M MOSER  
BOX 303 HUGOTON KS 67951

Phone Number: (\_\_\_\_\_) \_\_\_\_\_                      Email address: \_\_\_\_\_

3. The presently authorized place of use is:

Owner of Land ---- NAME: GREGORY & SHERRYL MORRIS

ADDRESS: 501 S WILDCAT CT HUGOTON KS 67951-3210

(If there is more than one landowner, attach supplemental sheets as necessary.)

Sec.	Twp.	Range	NE¼				NW¼				SW¼				SE¼				TOTAL ACRES
			NE¼	NW¼	SW¼	SE¼	NE¼	NW¼	SW¼	SE¼	NE¼	NW¼	SW¼	SE¼	NE¼	NW¼	SW¼	SE¼	
2	34S	38W					36	13	36	40	40	40	40	40	36	40	36	13	410
							L-3	L-4											

4. If this application is for a change in place of use, it is proposed that the place of use be changed to:

Owner of Land ---- NAME: GREGORY & SHERRYL MORRIS

ADDRESS: 501 S WILDCAT CT HUGOTON KS 67951-3210

(If there is more than one landowner, attach supplemental sheets as necessary.)

Sec.	Twp.	Range	NE¼				NW¼				SW¼				SE¼				TOTAL ACRES
			NE¼	NW¼	SW¼	SE¼	NE¼	NW¼	SW¼	SE¼	NE¼	NW¼	SW¼	SE¼	NE¼	NW¼	SW¼	SE¼	
2	34S	38W	39.77	39.96	40	40	36	13	36	40	40	40	40	40	36	40	36	13	570
			L-1	L-2			L-3	L-4											568.95

**For Office Use Only:** Code \_\_\_\_\_ Fee \$ 200.00 TR # \_\_\_\_\_ Receipt Date 10-30-20 Check # 13494



5. **Presently authorized point of diversion:**  
 One in the SW Quarter of the NE Quarter of the SW Quarter of Section 2, Township 34 South, Range 38 (W), in STEVENS County, Kansas,          feet North          feet West of Southeast corner of section.  
 Authorized Rate          Authorized Quantity          Depth of well          (feet)  
**(DWR use only: Computer ID No. 01 GPS          feet North          feet West)**  
 This point will not be changed     This point will be changed as follows:     No change, point better described with GPS as follows:  
**Proposed point of diversion: (Complete only if change is requested or if existing point is better described by GPS)**  
 One in the          Quarter of the          Quarter of the          Quarter of Section         , Township          South, Range          (E/W), in          County, Kansas,          feet North          feet West of Southeast corner of section.  
 Proposed Rate          Proposed Quantity          Proposed well depth (feet)         .  
 This point is:  Additional Well     Geo Center    List other water rights that will use this point         .

6. **Presently authorized point of diversion:**  
 One in the          Quarter of the          Quarter of the          Quarter of Section         , Township          South, Range          (E/W), in          County, Kansas,          feet North          feet West of Southeast corner of section.  
 Authorized Rate          Authorized Quantity          Depth of well          (feet)  
**(DWR use only: Computer ID No.          GPS          feet North          feet West)**  
 This point will not be changed     This point will be changed as follows:     No change, point better described with GPS as follows:  
**Proposed point of diversion: (Complete only if change is requested or if existing point is better described by GPS)**  
 One in the          Quarter of the          Quarter of the          Quarter of Section         , Township          South, Range          (E/W), in          County, Kansas,          feet North          feet West of Southeast corner of section.  
 Proposed Rate          Proposed Quantity          Proposed well depth (feet)         .  
 This point is:  Additional Well     Geo Center    List other water rights that will use this point         .

7. The changes herein are desired for the following reasons?  
 (please be specific) CREATE COMPLETE PU OVERLAP WITH FILE NOS. 11011; 12699 & 12619

8. If a well, is the test hole log attached?  Yes     No

9. The change(s) (was)(will be) completed by?  
UPON APPROVAL

10. If the point of diversion is a well:  
 (a) What are you going to do with the old well?  
N/A  
 (b) When will this be done? N/A

11. Groundwater Management District recommendation attached?  
 Yes     No

12. Assisted by AM/GCFO

13a. If the proposed point of diversion will be relocated more than 300 feet but within 2,640 feet of the existing point of diversion, attach a topographic map or aerial photograph. For groundwater sources, show all wells (including domestic) within one-half mile of the proposed point of diversion and the names and mailing addresses of the owners. For surface water sources, show the names and addresses of the landowner(s) one-half mile downstream and one-half mile upstream from your property lines

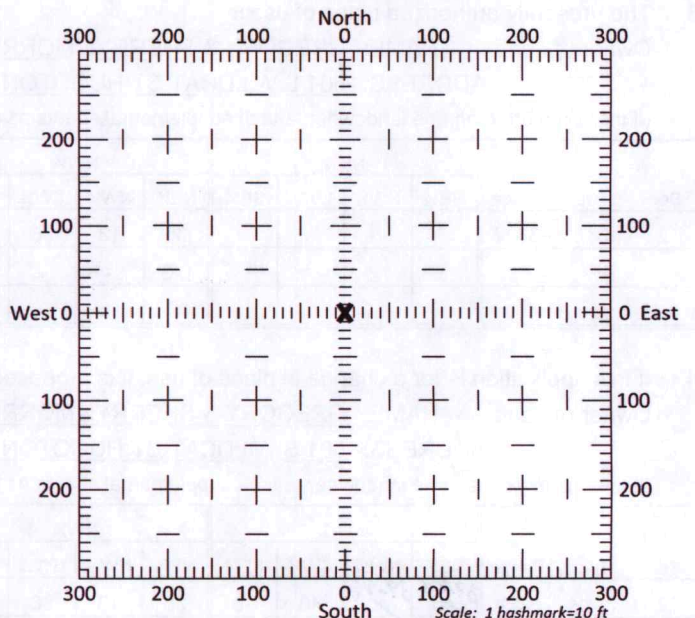

13b. If the proposed point of diversion will be relocated within 300 feet of the existing point of diversion, indicate its location on the diagram shown above in relation to the existing point of diversion. **(PLEASE NOTE: The "X" in center of diagram above represents the presently authorized point of diversion.)**



14. If the proposed groundwater point of diversion is 300 or fewer feet from the existing point of diversion, complete the following:
- (a) Does the undersigned represent all owners of the currently authorized place(s) of use identified in this application?  
 Yes     No    (If no, all owners must sign this application.)
  - (b) Will the ownership interest of any owner of the currently authorized place(s) of use identified in this application be adversely affected if this application is approved as requested?  
 Yes     No    (If yes, all owners must sign this application.)
  - (c) If this application is not approved expeditiously, will there be substantial damage to property, public health or safety?  
 Yes     No    (If no, all owners must sign this application.)

If the application proposes a surface water change in point of diversion, a groundwater change in point of diversion greater than 300 feet, or a change in place of use, the application must be signed by all owners of the currently authorized place of use, or their duly authorized agent (attach notarized statement authorizing representation).

I hereby verify, being first duly sworn upon my oath or affirmation and under penalty of perjury, that I am of lawful age and the owner, the spouse of the owner, or a duly authorized agent of the owner(s) to make this application on their behalf, in regards to the water right(s) to which this application pertains. I further verify that the statements contained in this application are true, correct and complete.

Dated at Hugoton, Kansas, this 27th day of October, 2020.

<p><u>Gary Morris</u> (Owner)</p> <p><u>Gregory Morris</u> (Please Print)</p> <p><u>Sherryl Morris</u> (Owner)</p> <p><u>Sherryl Morris</u> (Please Print)</p> <p>_____ (Owner)</p> <p>_____ (Please Print)</p>	<p>_____ (Spouse)</p> <p>_____ (Please Print)</p> <p>_____ (Spouse)</p> <p>_____ (Please Print)</p> <p>_____ (Spouse)</p> <p>_____ (Please Print)</p>
---	---

State of Kansas }  
 County of Stevens } SS

I hereby certify that the foregoing application was signed in my presence and sworn to before me this 27th day of October, 2020.



Jack Rowden  
 Notary Public

My Commission Expires 05-16-2023

**ONLY COMPLETE APPLICATIONS WILL BE PROCESSED.** To be complete, all of the applicable portions of the application form must be completed with accurate information; maps, if necessary, must be included; signatures of all the appropriate owners' must be affixed to the application and notarized; and the appropriate fee must be paid.

**FEE SCHEDULE**

Each application to change the place of use or the point of diversion under this section shall be accompanied by the application fee set forth in the schedule below: Make checks payable to: **Kansas Department of Agriculture**

- (1) Application to change a point of diversion 300 feet or less . . . . . \$100
- (2) Application to change a point of diversion more than 300 feet . . . . . \$200
- (3) Application to change the place of use . . . . . \$200

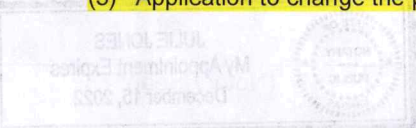







# CHANGE IN PLACE OF USE WATER RIGHT, FILE NOS. 11011 & 12699

Section 2 Township 34 South Range 38 West Stevens County

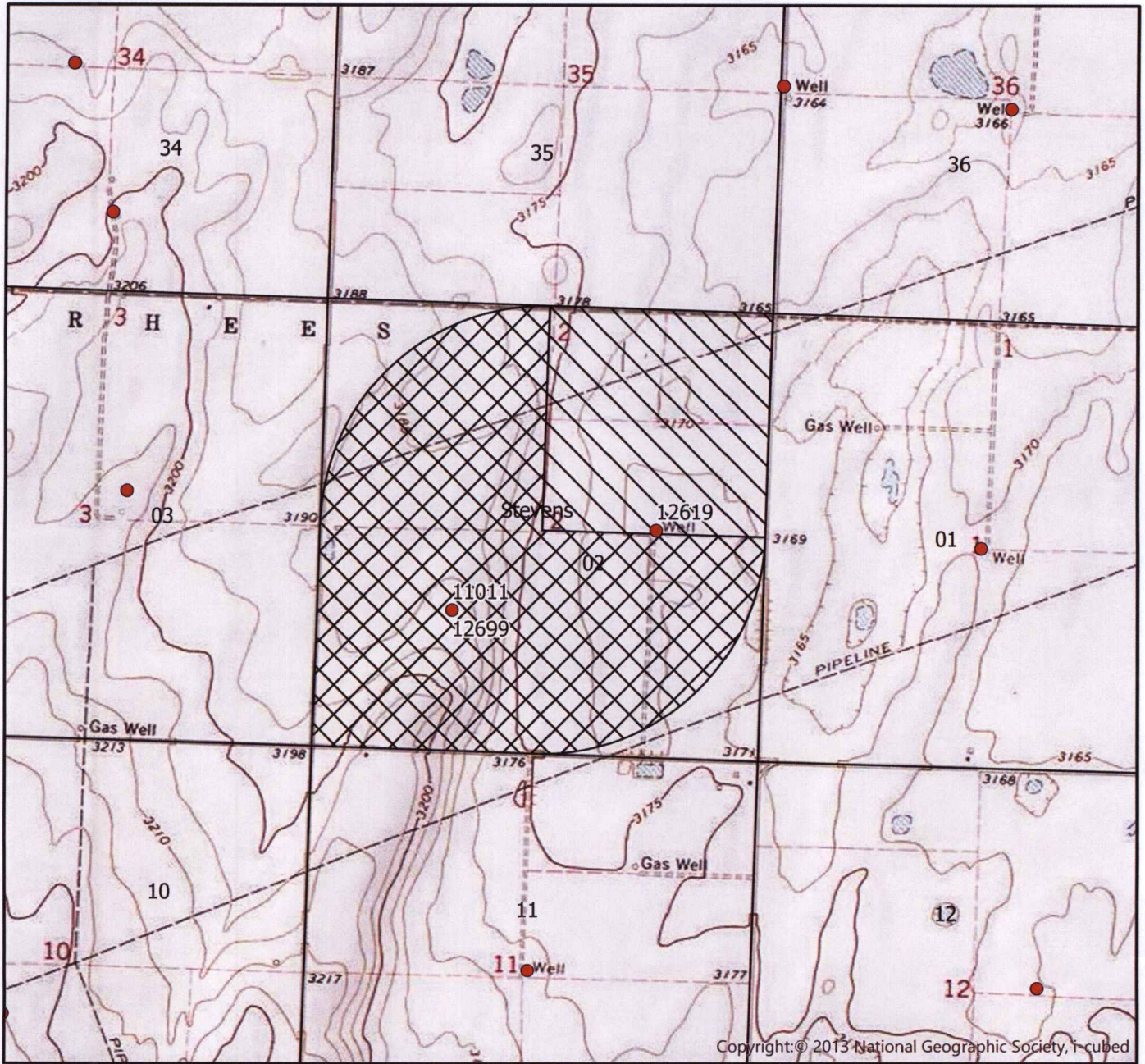

	Authorized Point of Diversion
	Permitted Water Right
	Domestic Well within 1/2 mile
	Authorized Place of Use
	Proposed Place of Use

List of owner name and addresses within 1/2 mile:



By signing below I agree that all wells, including domestic, and owners names and addresses within 1/2 mile of the point of diversion have been shown on the map

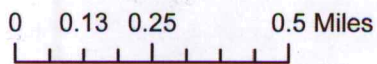

(Signature)

Date

AM/GCFO



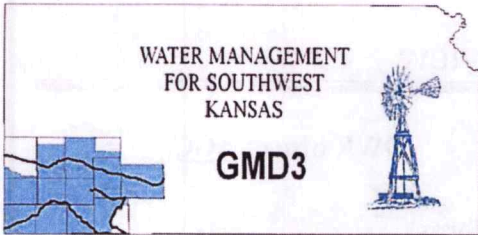

**Southwest Kansas**  
**Groundwater Management District No. 3**  
2009 E. Spruce Street  
Garden City, Kansas 67846  
(620) 275-7147 phone (620) 275-1431 fax  
www.gmd3.org

November 2, 2020

Michael A. Meyer  
Division of Water Resources  
4532 W Jones Ave., Suite B  
Garden City, Kansas 67846

RE: Applications for Change in Place of Use  
Water Right, File Nos. 11011, 12619 & 12699

Dear Mike:

We have reviewed the applications for the above referenced water rights. The proposal is not in conflict with the Management Program of the Southwest Kansas Groundwater Management District No. 3 (GMD3). The proposed change in place of use will create a complete overlap in currently authorized acres to better suit the operation and is in accordance with K.A.R. 5-5-11(b). It is therefore recommended that the applications be approved at this time.

Thank you for the opportunity to review the applications and to provide a recommendation. If you have any questions, please don't hesitate to contact us.

Sincerely,

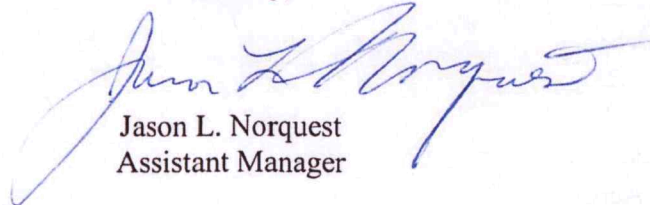

Jason L. Norquest  
Assistant Manager



# GMD3 Change Review

File No(s): 11011, 12619 & 12699.

DWR office: GC.

App filed to change: PI.

Is Landowner(s) correct in WRIS: Greg & Sherrly Morris.

If NO, is documentation included?

Is Water Use Correspondent correct in WRIS?    .

If NO, is documentation included?

Regulation(s) Reviewed: KAR 5-5-11

Point of diversion ID No(s)     being changed.

	ft. North	ft. West			
Authorized PD					
Proposed PD					
Difference	0	0			
$a^2 + b^2 = c^2$	0	0	0		

GPS for proposed PD: Lat:     Long:    .

Is proposed PD stacking on existing WRs? No change.

Is Proposed PU overlapping existing WRs? Make a complete overlap, no new acres.

Neighboring certified well(s) notified:    .

Name    .

Address    .

Zip    .

Email:     Phone:    .

Domestic well(s) notified:    .

Name    .

Address    .

Zip    .

Base Acres:    .

Perfected Acres:    .

Irr. Return-Flow    %

**The applications propose to make a complete overlap and are NOT brining in any new acres that are not already covered.**

**The three water rights cover two wells and the section currently has a half mile pivot that makes a complete circle. Applications would just cover the acres in current productions it appears.**

Is a waiver needed: No new acres and meets current rules.

Recommendation: After review of all available information, it appears current area rules are met. Staff therefore recommends approval of the applications.

  
RECEIVED  
NOV 02 2020

Garden City Field Office  
Division of Water Resources



Garden City Field Office  
4532 W. Jones, Suite B  
Garden City, KS 67846



Phone: 620-276-2901  
Fax: 620-276-9315  
www.agriculture.ks.gov

Mike Beam, Secretary

Laura Kelly, Governor

November 2, 2020

SOUTHWEST KANSAS GROUNDWATER  
MANAGEMENT DISTRICT NO. 3  
2009 E SPRUCE ST  
GARDEN CITY KS 67846

Re: Water Right, File Nos. 11011, 12619, 12699

Dear Mr. Norquest:

This is to advise you that Gregory and Sherry Morris, has filed an application for approval of the Chief Engineer, Division of Water Resources, Kansas Department of Agriculture, to change the place of use for the above referenced files. The request is to make a complete overlap in place of use with no new acres.

We are delaying action on the change applications to allow you time to review and provide a recommendation. Please submit a recommendation within 15 days from the date of this letter.

Thank you and as always feel free to contact this office at any time.

Sincerely,

A handwritten signature in blue ink that reads "Michael A. Meyer".

Michael A. Meyer  
Water Commissioner

MAM  
Enclosures