

Kansas Department of Agriculture
Division of Water Resources
CHANGE: P/U WORKSHEET

1. File Number: <b style="font-size: 1.2em;">14288	2. Status Change Date:	3. Change Num: <b style="font-size: 1.2em;">C4	4. Field Office: <b style="font-size: 1.2em;">4	5. GMD: <b style="font-size: 1.2em;">3
6. Status: <input checked="" type="checkbox"/> Approved <input type="checkbox"/> Denied by DWR/GMD <input type="checkbox"/> Dismiss by Request/Failure to Return				7. Filing Date of Change: <b style="font-size: 1.2em;">9/24/2020
8a. Applicant(s) New to system <input type="checkbox"/> LAKIN DAIRY LLP Attn: FEEDYARD PO BOX 323 LAKIN, KS 67860-0323		Person ID 59476 Add Seq# _____	8c. Landowner(s) New to system <input type="checkbox"/> Person ID _____ Add Seq# _____	
8b. Landowner(s) New to system <input type="checkbox"/> 8a		Person ID _____ Add Seq# _____	8d. WUC New to system <input type="checkbox"/> 8a	
9. Documents and Enclosure(s): <input checked="" type="checkbox"/> DWR Meter(s) Date to Comply: 12/31/2020 <input type="checkbox"/> N & P Date to Comply: _____ <input type="checkbox"/> Anti-Reverse Meter <input type="checkbox"/> Meter Seal <input type="checkbox"/> Check Valve <input type="checkbox"/> N & P Form <input type="checkbox"/> Water Tube <input type="checkbox"/> Driller Copy <input type="checkbox"/> H & E Letter <input type="checkbox"/> Conservation Plan Date Required: _____ Date Approved: _____ Date to Comply: _____				
10. Use Made of Water From: _____ To: _____				
Date Prepared: 9/24/2020 By: AM Date Entered: _____ By: _____				

File No. **14288** 11. County: **KE** Basin: **ARKANSAS RIVER** Stream: Formation Code: **211** Special Use:

12. Points of Diversion
 Rate and Quantity
 Authorized Additional
 Rate Quantity Rate Quantity
 gpm/cfs af/mgy gpm/cfs af/mgy Overlap PD Files

CHK 34999

CHK 82539

13. Storage: Rate _____ NF Quantity _____ ac/ft Additional Rate _____ NF Additional Quantity _____ ac/ft

14. Limitation: _____ af/yr at _____ gpm (_____ cfs) when combined with file number(s) _____
 Limitation: _____ af/yr at _____ gpm (_____ cfs) when combined with file number(s) _____

15. 5YR Allocation: Allocation Type _____ Start Year _____ 5 YR Amount _____ Amount Unit _____ Base Acres _____ Comment _____

16. Place of Use CHK MOD DEL ENT	PUSE	S	T	R	ID	NE¼				NW¼				SW¼				SE¼				Total	Owner	Chg?	Overlap Files	
						NE ¼	NW ¼	SW ¼	SE ¼	NE ¼	NW ¼	SW ¼	SE ¼	NE ¼	NW ¼	SW ¼	SE ¼	NE ¼	NW ¼	SW ¼	SE ¼					
						L-1	L-2			L-3	L-4															
ENT	60937	5	26S36W	2		80.5	75.5	35	35	57	58	17.5	17.5					22.5	22.5			421	8a	N	MULTIPLE	
ENT	24615	9	26S36W	2		40	40	40	40													160	8a	N	MULTIPLE	
ENT	24533	4	26S36W	2				29	19			18	29	40	39	17	27	39	40	27	17	341	8a	N	MULTIPLE	
CHK	30458	33	25S36W	1		40	40	40	40	40	40	40	40	40	40	40	40	40	40	40	40	640	8a	N	MULTIPLE	

Base Acres: Year: Minimum Reasonable Quantity:

Comments: **CREATING A COMPLETE OVERLAP IN PLACE OF USE FOR FILE NOS. 14273-D2; 14279; 14288; 17878-D2 & 27105**

Garden City Field Office
4532 W. Jones, Suite B
Garden City, KS 67846



Phone: 620-276-2901
Fax: 620-276-9315
www.agriculture.ks.gov

Mike Beam, Secretary

Laura Kelly, Governor

September 25, 2020

LAKIN DAIRY LLP
Attn: FEEDYARD
PO BOX 323
LAKIN, KS 67860-0323

RE: Water Right, File Nos. 14273-D2; 14279; 14288; 17878-D2 & 27105

Dear Sir or Madam:

Enclosed is the order executed by the designee of the Chief Engineer, Division of Water Resources, Kansas Department of Agriculture, approving the application for change under the above referenced file numbers.

Your attention is directed to the enclosures and to the terms, conditions, and limitations specified in this approval for change. A condition of this approval is that an acceptable water flow meter must be installed on the diversion works authorized under the referenced file numbers and meet current specifications. Please return the required notification of completion of the diversion works and installation of the required meter as soon as these actions are completed.

Since the order modifies the original document referred to above, it should be recorded with the Register of Deeds as other instruments affecting real estate.

Should you have any questions, please feel free contact this office. If you would prefer, you could arrange an appointment for additional assistance.

Sincerely,

A handwritten signature in blue ink that reads "Austin J. McColloch".

Austin J. McColloch
Assistant Water Commissioner

AM:
enclosures

pc:
GROUNDWATER MANAGEMENT DISTRICT NO. 3

CERTIFICATE OF SERVICE

On this 25th day of September, 2020, I hereby certify that the foregoing Approval of Application for Change in Point of Diversion, Water Right, File Nos. 14273-D2; 14279; 14288; 17878-D2 & 27105 dated 25th day of September, 2020 was mailed postage prepaid, first class, US mail to the following:

LAKIN DAIRY LLP
Attn: FEEDYARD
PO BOX 323
LAKIN, KS 67860-0323

Pc:

GROUNDWATER MANAGEMENT DISTRICT NO. 3

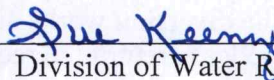

Division of Water Resources Staff

Submit completed application to:
 Kansas Department of Agriculture
 Division of Water Resources
 Field Office for your area.
 Call for address:

Topeka -- (785) 296-5733
 Stafford -- (620) 234-5311
 Stockton -- (785) 425-6787
 Garden City -- (620) 276-2901
<http://agriculture.ks.gov/dwr>

DWR FIELD OFFICE APPLICATION FOR APPROVAL TO CHANGE THE PLACE OF USE AND/OR THE POINT OF DIVERSION



STATE OF KANSAS

Filing Fee Must Accompany the Application, K.S.A. 82a-708b(b), as amended.
 Fee Schedule is on the third page of this application form.

Paragraph Nos. 1, 2, 3 & 5 must be completed. Complete all other applicable portions. If change in point of diversion is greater than 100 feet, or if place of use will be changed, include a topographic map or detailed plat showing the authorized and proposed point(s) of diversion and/or place of use.

File No. 14288

RECEIVED
8:00 AM
SEP 24 2020

1. Application is hereby made for approval of the Chief Engineer to change the (check one or both):

Place of Use Point of Diversion

under the water right which is the subject of this application in accordance with the conditions described below.

The source of supply is: Groundwater Surface water

Garden City Field Office
 Division of Water Resources

2. Name and address of Applicant: LAKIN DAIRY LLP

PO BOX 323 LAKIN KS 67860 - 0323

Phone Number: _____ Email address: _____

Name and address of Water Use Correspondent: SAME AS ABOVE

Phone Number: () _____ Email address: _____

3. The presently authorized place of use is:

Owner of Land ---- NAME: LAKIN DAIRY LLP

ADDRESS: PO BOX 323 LAKIN KS 67860 - 0323

(If there is more than one landowner, attach supplemental sheets as necessary.)

Sec.	Twp.	Range	NE¼				NW¼				SW¼				SE¼				TOTAL ACRES
			NE¼	NW¼	SW¼	SE¼	NE¼	NW¼	SW¼	SE¼	NE¼	NW¼	SW¼	SE¼	NE¼	NW¼	SW¼	SE¼	
33	25S	36W	40	40	40	40	40	40	40	40	40	40	40	40	40	40	40	40	640

4. If this application is for a change in place of use, it is proposed that the place of use be changed to:

Owner of Land ---- NAME: LAKIN DAIRY LLP

ADDRESS: PO BOX 323 LAKIN KS 67860 - 0323

(If there is more than one landowner, attach supplemental sheets as necessary.)

Sec.	Twp.	Range	NE¼				NW¼				SW¼				SE¼				TOTAL ACRES
			NE¼	NW¼	SW¼	SE¼	NE¼	NW¼	SW¼	SE¼	NE¼	NW¼	SW¼	SE¼	NE¼	NW¼	SW¼	SE¼	
33	25S	36W	40	40	40	40	40	40	40	40	40	40	40	40	40	40	40	40	640

For Office Use Only: Code _____	Fee \$ <u>200.00</u>	TR # _____	Receipt Date <u>9-27-2020</u> Check # <u>6887</u>
---------------------------------	----------------------	------------	---

APPLICATION FOR APPROVAL TO CHANGE
THE PLACE OF USE AND/OR POINT OF DIVERSION
SUPPLEMENTAL SHEET
FILE NO. 14288
MAKE ADDITIONAL COPIES AS NECESSARY

3. *Continued:* The presently authorized place of use is:

Owner of Land ---- NAME: _____
ADDRESS: _____

Sec.	Twp.	Range	NE¼				NW¼				SW¼				SE¼				TOTAL ACRES
			NE¼	NW¼	SW¼	SE¼	NE¼	NW¼	SW¼	SE¼	NE¼	NW¼	SW¼	SE¼	NE¼	NW¼	SW¼	SE¼	

Owner of Land ---- NAME: _____
ADDRESS: _____

Sec.	Twp.	Range	NE¼				NW¼				SW¼				SE¼				TOTAL ACRES
			NE¼	NW¼	SW¼	SE¼	NE¼	NW¼	SW¼	SE¼	NE¼	NW¼	SW¼	SE¼	NE¼	NW¼	SW¼	SE¼	

Owner of Land ---- NAME: _____
ADDRESS: _____

Sec.	Twp.	Range	NE¼				NW¼				SW¼				SE¼				TOTAL ACRES
			NE¼	NW¼	SW¼	SE¼	NE¼	NW¼	SW¼	SE¼	NE¼	NW¼	SW¼	SE¼	NE¼	NW¼	SW¼	SE¼	

4. *Continued:* If this application is for a change in place of use, it is proposed that the place of use be changed to:

Owner of Land ---- NAME: LAKIN DAIRY LLP
ADDRESS: PO BOX 323 LAKIN KS 67860 - 0323

Sec.	Twp.	Range	NE¼				NW¼				SW¼				SE¼				TOTAL ACRES
			NE¼	NW¼	SW¼	SE¼	NE¼	NW¼	SW¼	SE¼	NE¼	NW¼	SW¼	SE¼	NE¼	NW¼	SW¼	SE¼	
4	26S	36W	0	0	29	19	0	0	18	29	40	39	17	27	39	40	27	17	341
9	26S	36W	40	40	40	40													160
5	26S	36W	80.5	75.5	35	35	57	58	17.5	17.5	0	0	0	0	22.5	22.5	0	0	421

Owner of Land ---- NAME: _____
ADDRESS: _____

Sec.	Twp.	Range	NE¼				NW¼				SW¼				SE¼				TOTAL ACRES
			NE¼	NW¼	SW¼	SE¼	NE¼	NW¼	SW¼	SE¼	NE¼	NW¼	SW¼	SE¼	NE¼	NW¼	SW¼	SE¼	

Owner of Land ---- NAME: _____
ADDRESS: _____

Sec.	Twp.	Range	NE¼				NW¼				SW¼				SE¼				TOTAL ACRES
			NE¼	NW¼	SW¼	SE¼	NE¼	NW¼	SW¼	SE¼	NE¼	NW¼	SW¼	SE¼	NE¼	NW¼	SW¼	SE¼	

5. **Presently authorized point of diversion:**
 One in the _____ Quarter of the _____ Quarter of the _____ Quarter
 of Section _____, Township _____ South, Range _____ (E/W),
 in _____ County, Kansas, _____ feet North _____ feet West of Southeast corner of section.
 Authorized Rate _____ Authorized Quantity _____ Depth of well _____ (feet)
 (DWR use only: Computer ID No. _____ GPS _____ feet North _____ feet West)
 This point will not be changed This point will be changed as follows: No change, point better described with GPS as follows:
Proposed point of diversion: (Complete only if change is requested or if existing point is better described by GPS)
 One in the _____ Quarter of the _____ Quarter of the _____ Quarter
 of Section _____, Township _____ South, Range _____ (E/W),
 in _____ County, Kansas, _____ feet North _____ feet West of Southeast corner of section.
 Proposed Rate _____ Proposed Quantity _____ Proposed well depth (feet) _____
 This point is: Additional Well Geo Center List other water rights that will use this point _____

6. **Presently authorized point of diversion:**
 One in the _____ Quarter of the _____ Quarter of the _____ Quarter
 of Section _____, Township _____ South, Range _____ (E/W),
 in _____ County, Kansas, _____ feet North _____ feet West of Southeast corner of section.
 Authorized Rate _____ Authorized Quantity _____ Depth of well _____ (feet)
 (DWR use only: Computer ID No. _____ GPS _____ feet North _____ feet West)
 This point will not be changed This point will be changed as follows: No change, point better described with GPS as follows:
Proposed point of diversion: (Complete only if change is requested or if existing point is better described by GPS)
 One in the _____ Quarter of the _____ Quarter of the _____ Quarter
 of Section _____, Township _____ South, Range _____ (E/W),
 in _____ County, Kansas, _____ feet North _____ feet West of Southeast corner of section.
 Proposed Rate _____ Proposed Quantity _____ Proposed well depth (feet) _____
 This point is: Additional Well Geo Center List other water rights that will use this point _____

7. The changes herein are desired for the following reasons?
 (please be specific) _____

8. If a well, is the test hole log attached? Yes No

9. The change(s) (was)(will be) completed by?

10. If the point of diversion is a well:
 (a) What are you going to do with the old well?
N/A
 (b) When will this be done? _____

11. Groundwater Management District recommendation attached?
 Yes No

12. Assisted by Alex Torrance

13a. If the proposed point of diversion will be relocated more than 300 feet but within 2,640 feet of the existing point of diversion, attach a topographic map or aerial photograph. For groundwater sources, show all wells (including domestic) within one-half mile of the proposed point of diversion and the names and mailing addresses of the owners. For surface water sources, show the names and addresses of the landowner(s) one-half mile downstream and one-half mile upstream from your property lines

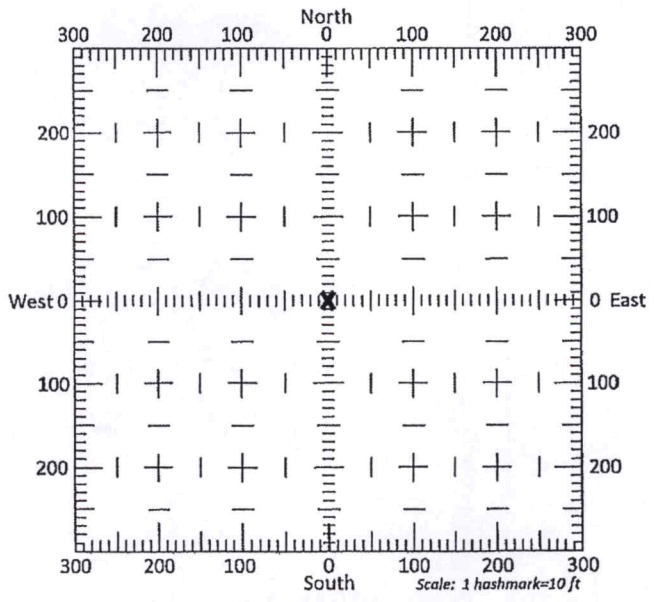

13b. If the proposed point of diversion will be relocated within 300 feet of the existing point of diversion, indicate its location on the diagram shown above in relation to the existing point of diversion. (PLEASE NOTE: The "X" in center of diagram above represents the presently authorized point of diversion.)

14. If the proposed groundwater point of diversion is 300 or fewer feet from the existing point of diversion, complete the following:
- (a) Does the undersigned represent all owners of the currently authorized place(s) of use identified in this application?
 Yes No (If no, all owners must sign this application.)
 - (b) Will the ownership interest of any owner of the currently authorized place(s) of use identified in this application be adversely affected if this application is approved as requested?
 Yes No (If yes, all owners must sign this application.)
 - (c) If this application is not approved expeditiously, will there be substantial damage to property, public health or safety?
 Yes No (If no, all owners must sign this application.)

If the application proposes a surface water change in point of diversion, a groundwater change in point of diversion greater than 300 feet, or a change in place of use, the application must be signed by all owners of the currently authorized place of use, or their duly authorized agent (attach notarized statement authorizing representation).

I hereby verify, being first duly sworn upon my oath or affirmation and under penalty of perjury, that I am of lawful age and the owner, the spouse of the owner, or a duly authorized agent of the owner(s) to make this application on their behalf, in regards to the water right(s) to which this application pertains. I further verify that the statements contained in this application are true, correct and complete.

Dated at Lakin, KS, Kansas, this 9th day of Sept., 2020.

Lakin Dairy, LLP by Robert Hennen _____
 (Owner) (Spouse)

Lakin Dairy, LLP by Robert Hennen _____
 (Please Print) (Please Print)

 (Owner) (Spouse)

 (Please Print) (Please Print)

 (Owner) (Spouse)

 (Please Print) (Please Print)

State of Kansas }
 County of Kearny } SS

I hereby certify that the foregoing application was signed in my presence and sworn to before me this 9 day of Sept, 2020.

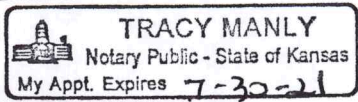

Tracy Manly
 Notary Public

My Commission Expires _____

ONLY COMPLETE APPLICATIONS WILL BE PROCESSED. To be complete, all of the applicable portions of the application form must be completed with accurate information; maps, if necessary, must be included; signatures of all the appropriate owners' must be affixed to the application and notarized; and the appropriate fee must be paid.

FEE SCHEDULE

- Each application to change the place of use or the point of diversion under this section shall be accompanied by the application fee set forth in the schedule below: Make checks payable to: **Kansas Department of Agriculture**
- (1) Application to change a point of diversion 300 feet or less \$100
 - (2) Application to change a point of diversion more than 300 feet \$200
 - (3) Application to change the place of use \$200

SUMMARY ORDER APPROVING APPLICATION FOR CHANGE AND IMPOSING CONDITIONS

This Summary Order is issued under authority of K.S.A. 82a-708b, as amended, and K.A.R. 5-5-1, *et seq.* and other applicable provisions of the *Kansas Water Appropriation Law, K.S.A. 82a-701 et seq.*, and rules and regulations promulgated thereunder, With the exception of those conditions expressly contained herein, this Summary Order does not change the terms, conditions and limitations of File No. 14288

- 1. A change application was received on September 24, 2020 requesting that the place of use and / or point of diversion authorized under the above-referenced file number be changed as described in the application.
- 2. On and after the effective date of this summary order, the authorized place(s) of use shall be located substantially as shown on the topographic map accompanying the application to change the place of use. Applicable Not Applicable
- 3. The change in point of diversion shall not impair existing rights and shall be limited to the same source or sources of water as previously authorized. The point of diversion authorized by this summary order shall be located within a foot radius of the authorized point(s) of diversion. Applicable Not Applicable
- 4. The point(s) of diversion described herein is administratively corrected to be more accurately described using the Global Positioning System (GPS), as described in the application. Applicable Not Applicable
- 5. The point(s) of diversion authorized herein shall not actually be located more than feet from the previously authorized point(s) of diversion. Applicable Not Applicable
- 6. As required by K.A.R. 5-3-5d, if the works for diversion is a well with a diversion rate of 100 gallons per minute or more, a tube or other device suitable for making water level measurements shall be installed, operated and maintained in accordance with K.A.R. 5-6-13. Applicable Not Applicable
- 7. The owner of the authorized place(s) of use shall properly install an acceptable water flow meter on or before December 31, 2020, or before the first use of water, whichever occurs first. The water flow meter shall be installed, operated and maintained in accordance with K.A.R. 5-1-4 through 5-1-12. As required by K.S.A. 82a-732, as amended, and K.A.R. 5-3-5e, the owner shall maintain records and report the reading of the water flow meter and the total quantity of water diverted annually to the Chief Engineer by March 1 following the end of each calendar year. Applicable Not Applicable
- 8. Installation of the works for diversion of water shall be completed on or before December 31, 20 , or within any authorized extension of time. By March 1, 20 the applicant shall notify the Chief Engineer that construction of the works for diversion has been completed, on the form provided by the Chief Engineer, as required by K.A.R. 5-8-4e. Applicable Not Applicable
- 9. The completed well log shall be submitted with the required notice. Applicable Not Applicable
- 10. All diversion works into which any type of chemical or other foreign substance will be injected into the water shall be equipped with an in-line, automatic, quick-closing check valve capable of preventing pollution of the source of the water supply. The check valve(s) shall be installed, operated and maintained in accordance with K.A.R. 5-3-5c. Applicable Not Applicable
- 11. Additional Conditions are attached. Yes No
- 12. In accordance with K.S.A. 82a-708a, as amended, and K.A.R. 5-5-14, all of the owners of the authorized place(s) of use of water appropriated under the above-referenced file number are responsible for compliance with its terms, conditions and limitations, as amended and/or supplemented by this Summary Order, and with applicable provisions of the *Kansas Water Appropriation Law* and the *Rules and Regulations* promulgated thereunder. Failure to comply with these provisions may result in civil penalties pursuant to K.S.A. 82a-737, as amended, and/or the suspension or revocation and dismissal of the water or appropriation right or any other enforcement actions authorized by law.

Administrative Appeal and Effective Date of Order

If you are aggrieved by this order, pursuant to K.S.A. 82a-1901, you may request an evidentiary hearing before the Chief Engineer or request administrative review by the Secretary of Agriculture. A request for hearing by the Chief Engineer must be filed within **15 days** of service of this Order and a request for administrative review by the Secretary must be filed within **30 days** pursuant to K.S.A. 77-531. Any request for administrative review must state a basis for review pursuant to K.S.A. 77-527. File any request with **Kansas Department of Agriculture, Legal Division, 1320 Research Park Drive, Manhattan, KS 66502.** Failure to timely request a hearing or review may preclude review under the Kansas Judicial Review Act.

For Use by Register of Deeds

FOR OFFICE USE ONLY
APPLICATION APPROVED AND SUMMARY ORDER ISSUED

By: Austin McColloch
Duly Authorized Designee of the Chief Engineer
(Print Name): Austin McColloch
Division of Water Resources - Kansas Department of Agriculture
Date of Issuance: September 25, 2020
State of Kansas)
) SS
County of Finnney)
Acknowledged before me on September 25, 2020
by Austin McColloch
Signature: Sue Keeny
Notary Public

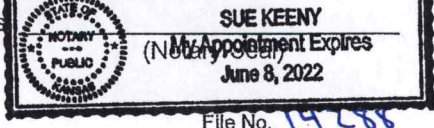
My commission expires 
SUE KEENY
(Notary Public)
My Appointment Expires
June 8, 2022

OVERLAP IN PLACE OF USE 14288 & 14279 WITH 14273-D2, 17878-D2, 27105

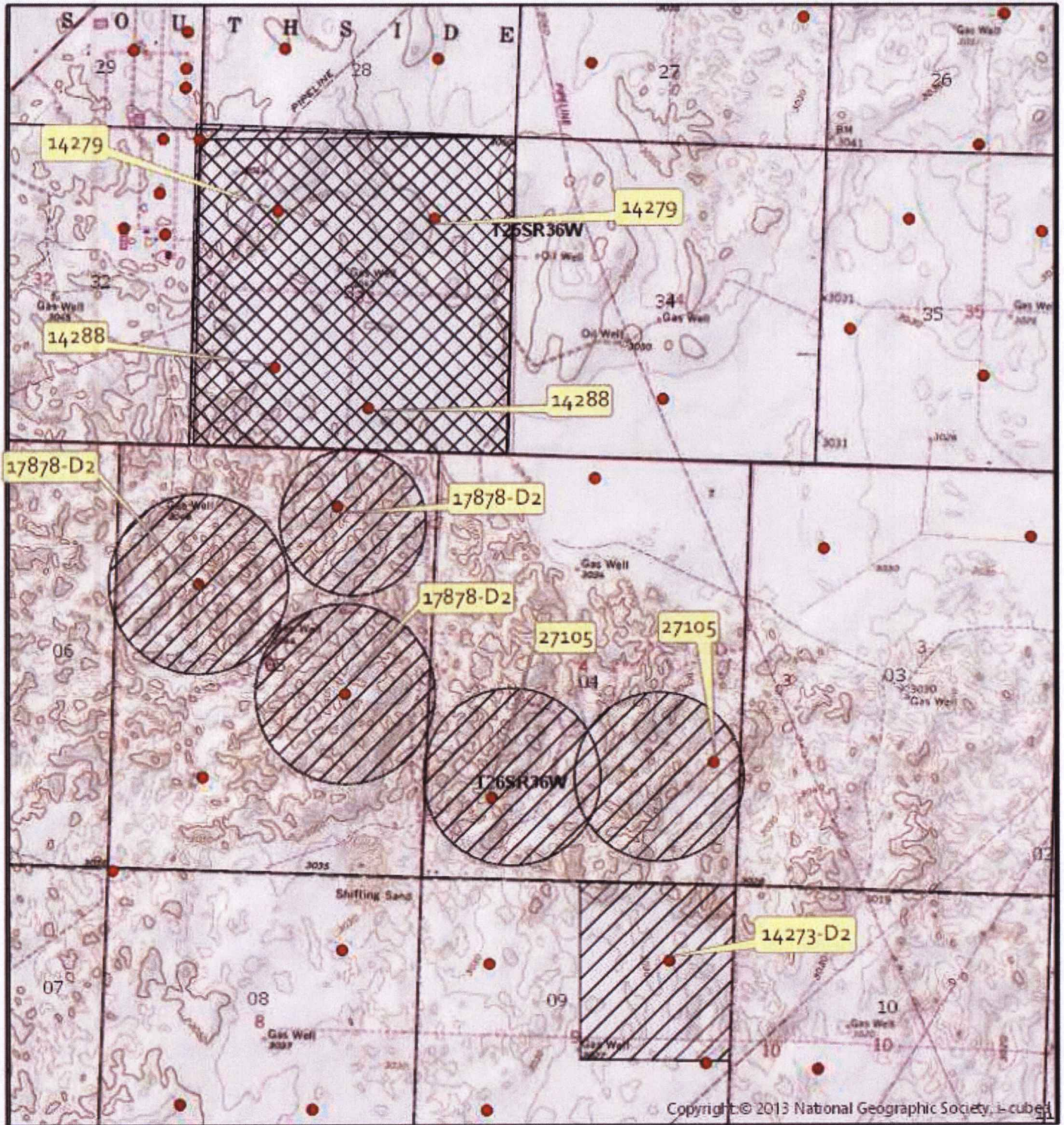

Township 27 South Range 29 West
GY County



PROPOSED PLACE OF USE



POINT OF DIVERSION



AUTHORIZED PLACE OF USE

