

Kansas Department of Agriculture
 Division of Water Resources
CHANGE: P/U WORKSHEET

1. File Number: 22566	2. Status Change Date: <i>11-25-2020</i>	3. Change Num: C3	4. Field Office: 4	5. GMD: 3
---------------------------------	---	-----------------------------	------------------------------	---------------------

6. Status: <input checked="" type="checkbox"/> Approved <input type="checkbox"/> Denied by DWR/GMD <input type="checkbox"/> Dismiss by Request/Failure to Return	7. Filing Date of Change: 10/29/2020
--	--

8a. Applicant(s) Person ID **64846**
 New to system Add Seq# _____

SANDYHILL ENTERPRISES LLC
Attn: JACOB NEUFELD
P O BOX 1005
HOLCOMB, KS 67851

8c. Landowner(s) Person ID _____
 New to system Add Seq# _____

8b. Landowner(s) Person ID _____
 New to system Add Seq# _____

8a

8d. WUC Person ID _____
 New to system Add Seq# _____

8a

9. Documents and Enclosure(s): DWR Meter(s) Date to Comply: **12/31/2021** N & P Date to Comply: **3/1/2022**

Anti-Reverse Meter Meter Seal Check Valve N & P Form Water Tube Driller Copy H & E Letter

Conservation Plan Date Required: _____ Date Approved: _____ Date to Comply: _____

10. Use Made of Water From: _____ To: _____

Date Prepared: **11/23/2020** By: **MAM**
 Date Entered: _____ By: _____

File No. 22566	11. County: FI	Basin: ARKANSAS RIVER	Stream:	Formation Code: 211/331	Special Use:																	
12. Points of Diversion CHK MOD DEL PDIV ENT						Rate and Quantity																
						Authorized		Additional		Overlap PD Files												
Qualifier	S	T	R	ID	'N	'W	Comment (AKA Line)	Rate gpm	Quantity af	Rate gpm	Quantity af	Overlap PD Files										
DEL 42755																						
CHK 86738																						
ENT	NWNESW	4	25	34W	2293	3916		1035	272	1035	272	NONE										
13. Storage: Rate _____ NF Quantity _____ ac/ft Additional Rate _____ NF Additional Quantity _____ ac/ft																						
14. Limitation: _____ af/yr at _____ gpm (_____ cfs) when combined with file number(s) _____ Limitation: _____ af/yr at _____ gpm (_____ cfs) when combined with file number(s) _____																						
15. 5YR Allocation: Allocation Type _____ Start Year _____ 5 YR Amount _____ Amount Unit _____ Base Acres _____ Comment _____																						
16. Place of Use		NE¼				NW¼				SW¼				SE¼				Total	Owner	Chg?	Overlap Files	
CHK		NE	NW	SW	SE	NE	NW	SW	SE	NE	NW	SW	SE	NE	NW	SW	SE					
MOD																						
DEL	PUSE	S	T	R	ID																	
ENT	1763	9	25S	34W	1	34	34	34	34	34	34	34	34	34	34	34	34	34	544	8a	N	MULTIPLE
ENT	28904	4	25S	34W	1	L-1 34	L-2 34	34	34	L-3 34	L-4 34	34	34	34	34	34	34	34	544	8a	N	MULTIPLE
ENT	28419	10	25S	34W	1	34	34	34	34	34	34	34	34	34	34	34	34	34	272	8a	N	MULTIPLE
ENT	40119	3	25S	34W	1	L-1 34	L-2 34	34	34	L-3 34	L-4 34	34	34	34	34	34	34	34	544	8a	N	MULTIPLE
ENT	31371	2	25S	34W	1	L-1 34	L-2 34	34	34	L-3 34	L-4 34	34	34	34	34	34	34	34	544	8a	N	MULTIPLE
ENT	17990	11	25S	34W	1	34	34	34	34	34	34	34	34	34	34	34	34	34	544	8a	N	MULTIPLE
CHK	22348	4	25S	34W	2					34	34	34	34	34	34	34	34	34	272	8a	N	MULTIPLE
Base Acres: Year: Minimum Reasonable Quantity:																						
Comments: OVERLAPPING PU W/ FILE NOS. 20893; 20894; 20897; 20898; 20902; 22565; 22566																						

Garden City Field Office
4532 W. Jones, Suite B
Garden City, KS 67846



Phone: 620-276-2901
Fax: 620-276-9315
www.agriculture.ks.gov

Mike Beam, Secretary

Laura Kelly, Governor

November 25, 2020

SANDYHILL ENTERPRISES LLC
Attn: JACOB NEUFELD
P O BOX 1005
HOLCOMB, KS 67851

RE: Water Right, File No. 22566
Dear Sir:

Enclosed is the order executed by the designee of the Chief Engineer, Division of Water Resources, Kansas Department of Agriculture, approving the application for change under the above referenced file number.

Your attention is directed to the enclosures and to the terms, conditions, and limitations specified in the approval for change. A condition of the approval is that an acceptable water flow meter must be installed on the diversion works authorized under the referenced file number and meet current specifications. Please return the required notification of completion of the diversion works and installation of the required meter as soon as these actions are completed.

Since the order modifies the original documents referred to above, it should be recorded with the Register of Deeds as other instruments affecting real estate.

Should you have any questions, please feel free contact this office. If you would prefer, you could arrange an appointment for additional assistance.

Sincerely,

A handwritten signature in blue ink that reads "Michael A. Meyer".

Michael A. Meyer
Water Commissioner

MAM
enclosures

pc:
GMD3

CERTIFICATE OF SERVICE

On this 25th day of November 2020, I hereby certify that the foregoing Approvals of Application for Change in Point of Diversion, Water Right, File No. 22,566 dated 25th day of November 2020 was mailed postage prepaid, first class, US mail to the following:

SANDYHILL ENTERPRISES LLC
Attn: JACOB NEUFELD
P O BOX 1005
HOLCOMB, KS 67851

Pc:

GROUNDWATER MANAGEMENT DISTRICT NO. 3

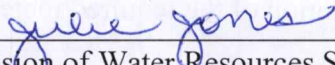

Division of Water Resources Staff

Submit completed application to:
 Kansas Department of Agriculture
 Division of Water Resources
 Field Office for your area.

Call for address:

Topeka -- (785) 296-5733
 Stafford -- (620) 234-5311
 Stockton -- (785) 425-6787
 Garden City -- (620) 276-2901
<http://agriculture.ks.gov/dwr>

DWR FIELD OFFICE APPLICATION FOR APPROVAL TO CHANGE THE PLACE OF USE AND/OR THE POINT OF DIVERSION



STATE OF KANSAS

**Filing Fee Must Accompany the Application, K.S.A. 82a-708b(b), as amended.
 Fee Schedule is on the third page of this application form.**

Paragraph Nos. 1, 2, 3 & 5 must be completed. Complete all other applicable portions. If change in point of diversion is greater than 100 feet, or if place of use will be changed, include a topographic map or detailed plat showing the authorized and proposed point(s) of diversion and/or place of use.

File No. 22566

RECEIVED
 5:00 PM
OCT 29 2020

**Garden City Field Office
 DIVISION OF WATER RESOURCES**

1. Application is hereby made for approval of the Chief Engineer to change the (check one or both):

Place of Use Point of Diversion

under the water right which is the subject of this application in accordance with the conditions described below.

The source of supply is: Groundwater Surface water

2. Name and address of Applicant: SANDHILL ENTERPRISES LLC

PO BOX 1005 HOLCOMB KS. 67851

Phone Number: (620)271 4493 Email address: _____

Name and address of Water Use Correspondent: SAME AS ABOVE

Phone Number: () _____ Email address: _____

3. The presently authorized place of use is:

Owner of Land --- NAME: NO CHANGE

ADDRESS: _____

(If there is more than one landowner, attach supplemental sheets as necessary.)

Sec.	Twp.	Range	NE¼				NW¼				SW¼				SE¼				TOTAL ACRES
			NE¼	NW¼	SW¼	SE¼	NE¼	NW¼	SW¼	SE¼	NE¼	NW¼	SW¼	SE¼	NE¼	NW¼	SW¼	SE¼	

4. If this application is for a change in place of use, it is proposed that the place of use be changed to:

Owner of Land --- NAME: NO CHANGE

ADDRESS: _____

(If there is more than one landowner, attach supplemental sheets as necessary.)

Sec.	Twp.	Range	NE¼				NW¼				SW¼				SE¼				TOTAL ACRES
			NE¼	NW¼	SW¼	SE¼	NE¼	NW¼	SW¼	SE¼	NE¼	NW¼	SW¼	SE¼	NE¼	NW¼	SW¼	SE¼	

For Office Use Only: Code _____ Fee \$ 200.00 TR # _____ Receipt Date 10-29-20 Check # 1133

NW-20894
37.91243
- 101.06174

**Point of Diversion Change
WR 22566
T25 R34W Section 4
Finney Co.**

Spacing distances are estimated on rough GPS on data base and/or GPS submitted by customer, is sole responsibility of the owner or agent to select location for test hole(s) within required distances from surrounding PD(s) & 1/2 mile radius from Authorized PD.

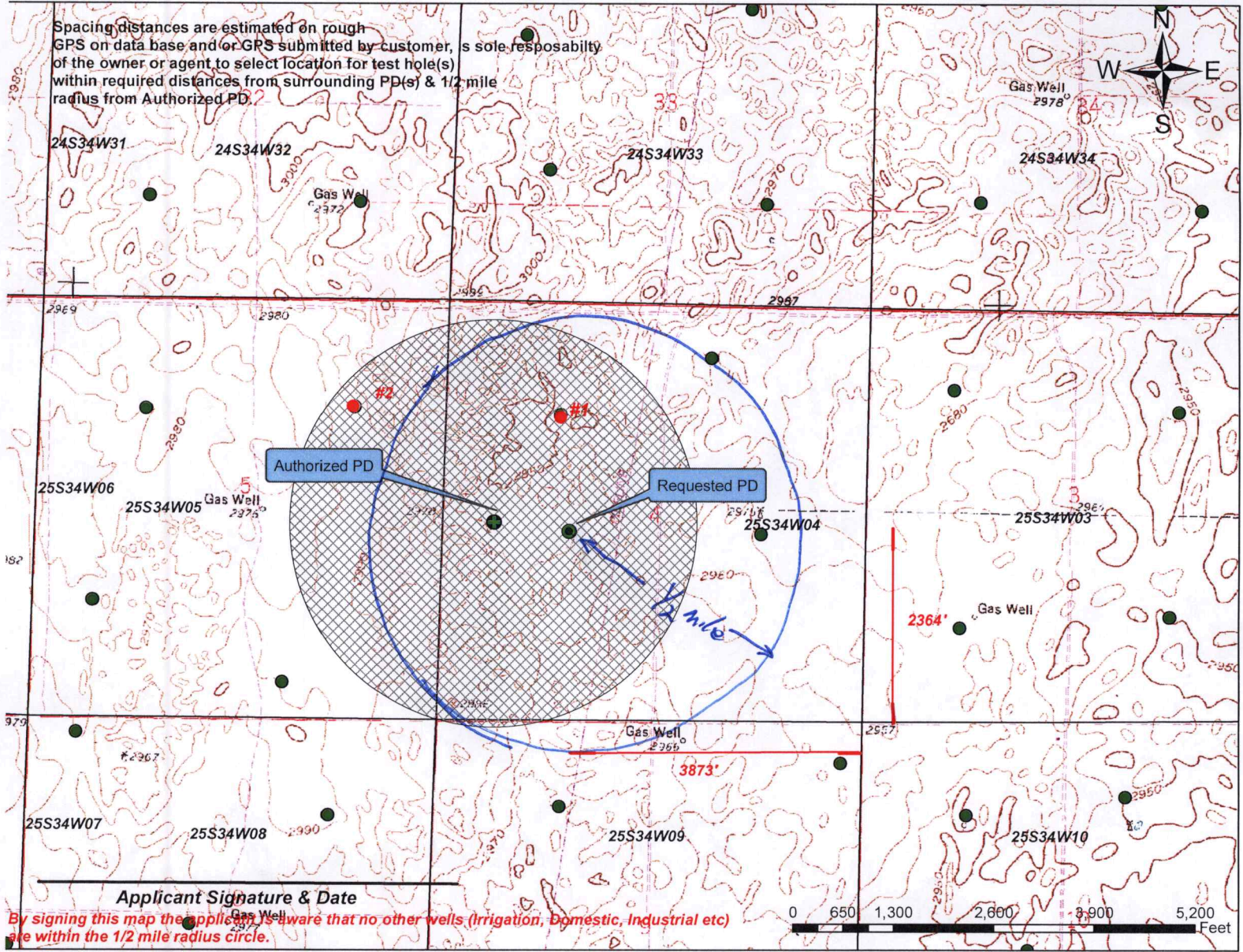

Applicant Signature & Date

By signing this map the applicant is aware that no other wells (Irrigation, Domestic, Industrial etc) are within the 1/2 mile radius circle.

- Authorized PD
- Requested PD
- Point of Diversion
- Half Mile Radius
- Active Water Right w/in 1/2 mile
- domestic well w/in 1/2 mile
- Authorized PU
- Requested PD

Water Right w/in 1/2 mile & Owner(if apply) **Domestic well w/in 1/2 mile & Owner (if apply)**

- #1 Water Right No. 20894 Owner SandyHill Enterprises A.- Domestic well
- #2 Water Right No. 21386 Owner Wheatland Electric Coop. Inc

WELL LOG

2293' N x 39 1/2' W.

DATE: 10/23/2020

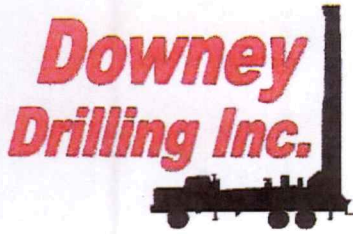

CUSTOMER NAME: SANDYHILL ENTERPRISES LLC TRI-7 TH#2

LEGAL: SW 4-25S-34W

COUNTY: FINNEY

GPS: 37.908022

-101.061322

LOGGER:

DRILLER: ROGELIO

WO: 20-968

TW	FROM	TO	TYPE	HARDNESS	COLOR	SPEED	PULL DOWN	OTHER / DRILLING ACTION
	0	10	SURFACE SAND	SOFT	YELLOWISH H	FAST		SMOOTH
	10	20	FINE-MED-COARSE SAND	SOFT		FAST		VIBRATION
	20	47	FINE-MED-COARSE SAND W/ FINE GRAVEL	SOFT	RED	FAST		FAST CHATTER
	47	65	FINE-MED-COARSE SAND W/ FINE-MED GRAVEL	SOFT	RED	FAST		FAST CHATTER
	65	82	SANDY CLAY	SOFT	TAN	FAST		SMOOTH
	82	119	FINE-MED-COARSE SAND W/ FINE GRAVEL	SEMI-SOFT	TAN / RED	FAST		FAST CHATTER
	119	130	SANDY CLAY	SOFT	GRAY	FAST		SMOOTH
	130	155	FINE-MED-COARSE SAND W/ FINE GRAVEL	SEMI-SOFT	TAN	FAST		FAST CHATTER
	155	165	CLAY, SANDY CLAY	SOFT	GRAY	FAST		SMOOTH
	165	174	SANDY CLAY	SOFT	BLACK	FAST		SMOOTH
	174	182	FINE-MED-COARSE SAND (BLACK)	FIRM	BLACK	FAST		FAST CHATTER
	182	190	BLUE CLAY W/ BLACK SANDY CLAY	SOFT	BLUE	FAST		SMOOTH
	190	192	CEMENTED	STIFF		FAST		CHOPPY
	192	198	CLAY	DENSE	BLUE	FAST		SMOOTH
	198	232	MED-COARSE, VERY COARSE SAND, FINE GRAVEL	SOFT	TAN	FAST		CHATTER
	232	240	CLAY	SOFT	BLACK	FAST		SMOOTH
	240	264	MED-COARSE SAND W/ FINE GRAVEL	SEMI-SOFT	TAN	FAST		FAST CHATTER
	264	270	SANDY CLAY	SOFT	TAN	FAST		SMOOTH
	270	283	MED-VERY COARSE SAND W/ FINE GRAVEL	SEMI-SOFT	TAN	FAST		FAST CHATTER
	283	298	FINE-MED-COARSE SAND W/ SANDY CLAY	SOFT	TAN	FAST		VIBRATION
	298	328	MED-VERY COARSE SAND W/ CEMENTED SAND & LIMEROCK	FIRM	WHITE	SLOW		CHATTER
	328	334	SANDY CLAY S/LIMEROCK	FIRM	TAN / WHITE	FAST		CHOPPY
	334	346	FINE-MED-COARSE SAND W/ LIMEROCK & SANDY CLAY LAYERS	FIRM	WHITE & TAN	FAST		CHOPPY
	346	357	SAND, SANDY CLAY	FIRM		FAST		CHOPPY
	357	370	MED-VERY COARSE SAND	SEMI-SOFT	TAN	FAST		CHOPPY/CHATTER
	365	370	FINE-MED-COARSE SAND, FINE, TR. MED GRAVEL	SEMI-FIRM	TAN	NOT AS FAST		CHATTER
	370	373	SANDY CLAY	SOFT	TAN	LITTLE SLOWER		SMOOTHER
	373	398	FINE-MED SAND	FIRM	TAN	FAST		CHOPPY
	398	402	CLAY	SEMI-FIRM	GRAY	SLOWER		SMOOTHER
x	393	414	MED-COARSE SAND W/BROWN ROCK/ SANDSTONE	SEMI-FIRM	TAN & BROWN	SAME AS ABOVE		CHOPPY
	414	430	FINE SAND W/ SANDSTONE/ BROWN ROCK, SOAPSTONE & LIMESTONE	FIRM	BROWN & BROWN	SLOW		CHOPPY
	430	453	FINE-MED SAND W/ BROWN ROCK & SANDSTONE	FIRM	BROWN & TAN	SEMI-FAST		CHOPPY
	453	470	FINE SAND, BROWN ROCK & SANDSTONE, TR. SOAPSTONE	SEMI-FIRM	BROWN & WHITE	FASTER		FAST CHATTER
	470	496	SHALE, TR. FINE SAND & IRON PYRITE LENSES	HARD	BLUE / DARK	SLOW		SMOOTH, CHOPPY @ TIMES
	496	502	FINE SAND, SANDSTONE	SEMI-FIRM	GRAY	NOT AS SLOW		VERY LT. CHATTER
	502	519	BLUE SHALE	SOFT	BLUE	SLOW		SMOOTH

SANDYHILL ENT. LLC TRI-7

SW 4-25S-34W FINNEY CO.

Legend

TH #1 ELEV=2963'

TRI-7 ELEV=2957'

TH #2 ELEV=2950'

NEW IRR WELL LOCATION N37.908022 W101.061322

Google Earth

© 2020 Google

900 ft



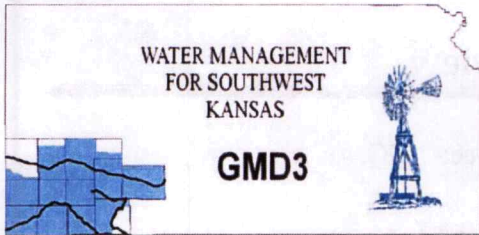

Southwest Kansas
Groundwater Management District No. 3
2009 E. Spruce Street
Garden City, Kansas 67846
(620) 275-7147 phone (620) 275-1431 fax
www.gmd3.org

November 19, 2020

Michael A. Meyer
Division of Water Resources
4532 W Jones Ave., Suite B
Garden City, Kansas 67846

RE: Application for Change in Point of Diversion
Water Right, File No. 22566

Dear Mike:

We have completed a review of the application for the above referenced water right. The proposed change in point of diversion is in accordance with current area rules, K.A.R. 5-23-3, as it pertains to distance moved and minimum spacing to neighboring wells.

Well evaluations were conducted to estimate possible effects of the proposal on the supply of other wells with water rights prior to the proposal per K.S.A. 82a-708b, and the draft revised management program. Under K.S.A. 82a-708b, an applicant requesting a change in point of diversion must demonstrate to the chief engineer that any proposed change is reasonable and will not impair. The enclosed report is an analysis performed by the GMD on behalf of our membership. Under this analysis, the proposed change is considered to be reasonable and unlikely to impair if either the net in-season well-to-well effect of the proposed change is less than a strict maximum allowable threshold (4.0 ft in cases where saturated thickness range is greater than 200 ft), or if no well with a net well-to-well effect exceeding the threshold is identified as critical. Critical wells are identified as wells that are expected to either lose or greatly diminish water supply over the next 25 years. The attached review information is based on a Theis analysis using inputs from the GMD3 aquifer model, which is considered to be the best information on well and aquifer data readily and easily available to the public. If either the applicant or the neighbors believe they have better data that might change the result of the analysis, they should contact GMD3. Conclusions of the well analysis may change if better information on well and aquifer data can be made available.

Every neighboring well within 1 mile of the proposed move was evaluated. Evaluations showed that none of the neighboring wells exceeded the net effect above the maximum allowable threshold and were actually well under that threshold. Our office received no comments from neighboring well owners. Therefore, GMD3 sees this move as reasonable and recommends that the application be approved. If aquifer conditions change or there is a change to the water right in the future, we would be happy to evaluate the effects at that time.

Thank you for the opportunity to review the applications and to provide a recommendation. If you have any questions, please don't hesitate to contact us.

Sincerely,

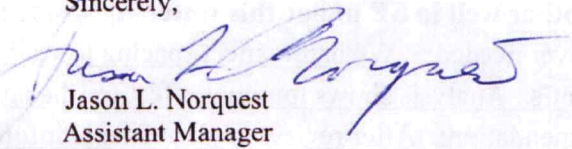
Jason L. Norquest
Assistant Manager

RECEIVED

NOV 19 2020

Garden City Field Office
Division of Water Resources

GMD3 Change Review

File No(s): 22566. DWR office: GC.

App filed to change: PD.

Is Landowner(s) correct in WRIS: Sandhill Enterprises LLC.

If NO, is documentation included?

Is Water Use Correspondent correct in WRIS? .

If NO, is documentation included?

Regulation(s) Reviewed: KAR 5-23-3

Point of diversion ID No(s) 04 being changed.

	ft. North	ft. West	
Authorized PD	2415	4755	Sect 4-25-34
Proposed PD	2293	3916	
Difference	122 s	839 e	
a ² + b ² = c ²	14884	703921	847.8237 foot move SE

GPS for proposed PD: Lat: 37.908022 Long: -101.061322.

Is proposed PD stacking on existing WRs? No.

Is Proposed PU overlapping existing WRs? No Change.

Neighboring certified well(s) notified: Wells in area are owned by applicant or have been recently gotten from what I see in our records.

Name .

Address .

Zip .

Email: Phone: .

Domestic well(s) notified: .

Name Donald Marston (NW NE 5-25-34).

Address 11600 W Crist RD.

Zip Holcomb, KS 67851.

Base Acres: .

Perfected Acres: .

Irr. Return-Flow %

This well authorized 272AF @ 1035gpm

10 year reported use: 206.2AF

Reported 300gpm in 2017

2018 GMD3 field inspection showed calculated rate of 415gpm.

There other well in SE under this water right was recently redrilled also.

Is a waiver needed: We barely meet spacing to well to the north, but it is also the applicant's. Analysis shows minimal effect for the area, well within in guidelines.

Recommendation: After review of all available information, current area rules appear met. We didn't receive comments from neighbor notices. Staff therefore recommends approval of the applicaton.

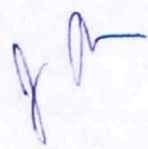

Evaluation of proposed move for Water Right No 22566

Proposed: Move water right no. 22566 ID 4 a distance of 848 ft to the southeast.

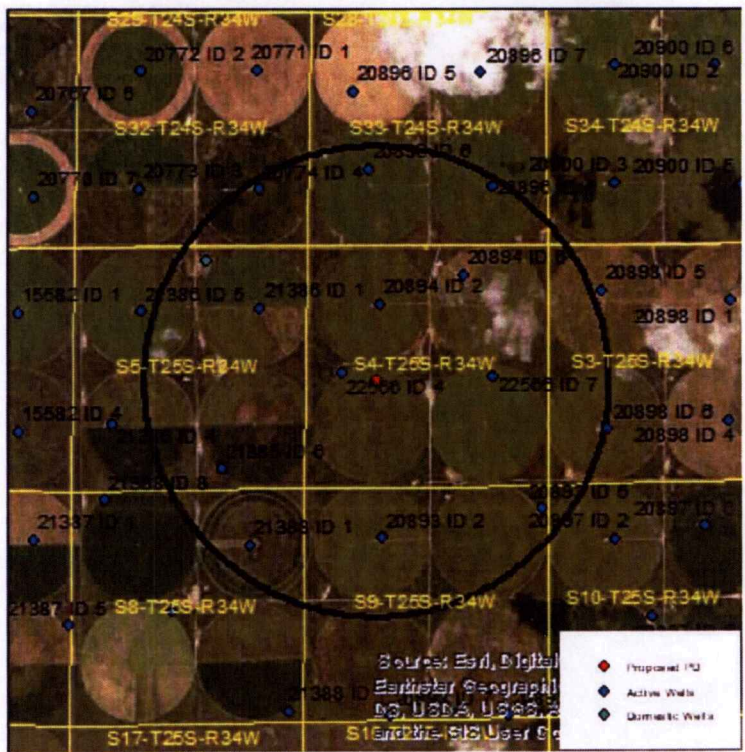

RECEIVED
 NOV 19 2020
 Garden City Field Office
 Division of Water Resources

Wells within 1 mile: 22566 ID7, 20894 ID2, 20894 ID6, 20896 ID4, 20896 ID6, 20774, 21386 ID1, 21386 ID6, 21388, 20893 ID2, 20893 ID5, and a domestic well in section 5-25-34.

The saturated thickness at the proposed well location is estimated to be 212 ft, based upon an observation well in section 8-25-34 and the driller’s log. For saturated thickness greater than 200 ft, the drawdown allowance is 4.0 ft.

50 year Theis Analysis: The following values were used to run the analysis:

$S = 0.2178$, $T = 16,048 \text{ ft}^2/\text{day}$, $t_{\text{current}} = 112 \text{ days}$ (based upon average use and observed rate),
 $Q_{\text{current}} = 415 \text{ gpm}$ (based upon 2018 field inspection), $t_{\text{proposed}} = 59 \text{ days}$, $Q_{\text{proposed}} = 1035 \text{ gpm}$

Theis drawdowns were calculated as follows:

- 22566 ID7:
 - Drawdown from current location = 0.83 ft
 - Drawdown from proposed location = 1.42 ft
 - Net drawdown = **0.6 ft**

- 20894 ID2:
 - Drawdown from current location = 1.26 ft
 - Drawdown from proposed location = 2.05 ft
 - Net drawdown = **0.8 ft**

GMD3 Change Review

RECEIVED
NOV 20 2011

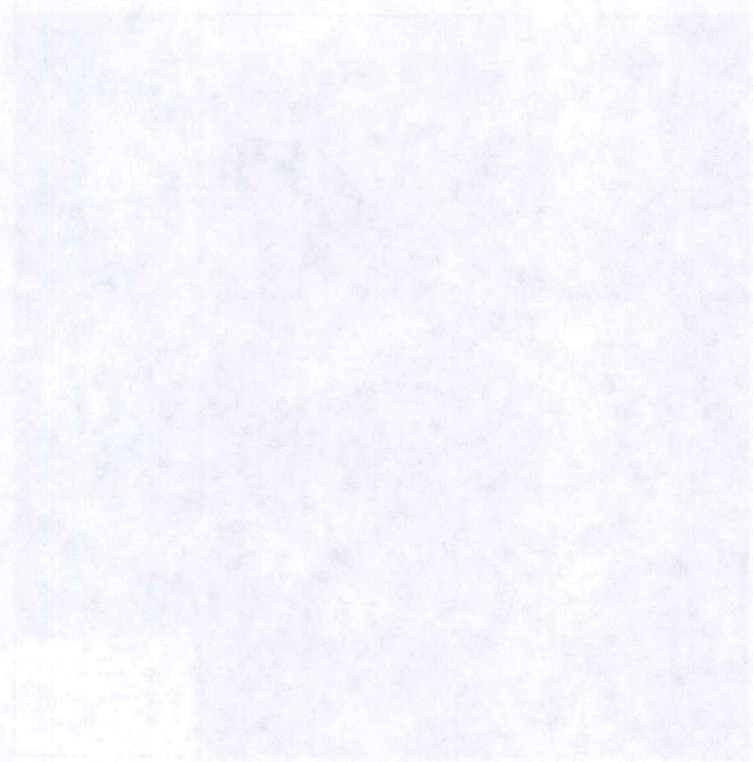

...the ... of ...
...the ... of ...
...the ... of ...

...the ... of ...
...the ... of ...
...the ... of ...

...the ... of ...
...the ... of ...
...the ... of ...

...the ... of ...
...the ... of ...
...the ... of ...

20894 ID6: Drawdown from current location = 0.82 ft
Drawdown from proposed location = 1.27 ft
Net drawdown = **0.5 ft**

20896 ID4: Drawdown from current location = 0.62 ft
Drawdown from proposed location = 0.85 ft
Net drawdown = **0.2 ft**

20896 ID6: Drawdown from current location = 0.68 ft
Drawdown from proposed location = 0.90 ft
Net drawdown = **0.2 ft**

20774: Drawdown from current location = 0.69 ft
Drawdown from proposed location = 0.86 ft
Net drawdown = **0.2 ft**

21386 ID1: Drawdown from current location = 1.05 ft
Drawdown from proposed location = 1.26 ft
Net drawdown = **0.2 ft**

21386 ID6: Drawdown from current location = 0.83 ft
Drawdown from proposed location = 1.01 ft
Net drawdown = **0.2 ft**

21388: Drawdown from current location = 0.70 ft
Drawdown from proposed location = 0.91 ft
Net drawdown = **0.2 ft**

20893 ID2: Drawdown from current location = 0.77 ft
Drawdown from proposed location = 1.12 ft
Net drawdown = **0.3 ft**

20893 ID5: Drawdown from current location = 0.61 ft
Drawdown from proposed location = 0.90 ft
Net drawdown = **0.3 ft**

RECEIVED

NOV 19 2020

Garden City Field Office
Division of Water Resources

Domestic 5-25-34: Drawdown from current location = 0.75 ft
Drawdown from proposed location = 0.90 ft
Net Drawdown = **0.2 ft**

Net drawdown does not exceed the drawdown allowance of 4.0 ft for any wells within 1 mile of the proposed location. Therefore, critical well analysis is not necessary.

Conclusion:

Based upon information from the GMD3 model, this proposal will cause minimal effects on neighboring wells, and is unlikely to create an impairment. GMD3 staff recommends approval of the application.

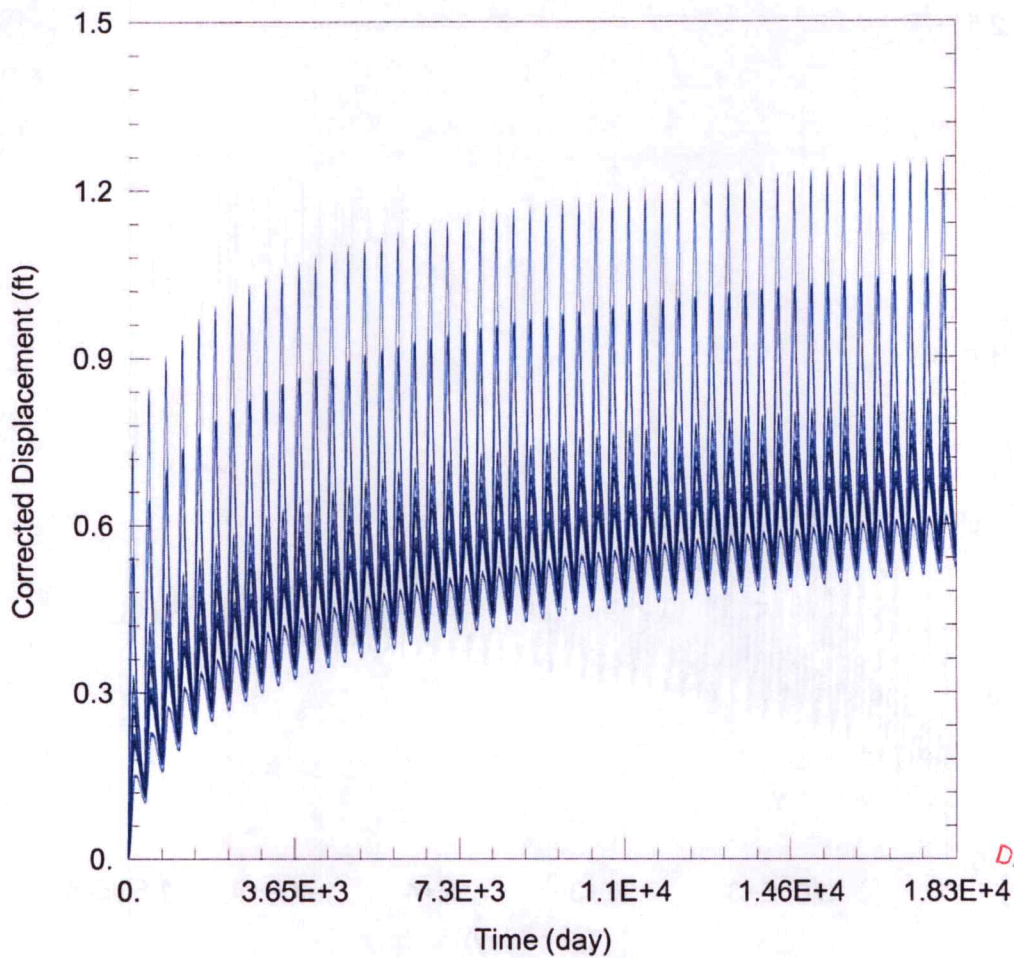

RECEIVED
 NOV 19 2020
 Garden City Field Office
 Division of Water Resources

WELL TEST ANALYSIS

Data Set: C:\Users\trevora\Documents\2020_moves\22566\22566 Current.aqt
 Date: 11/09/20 Time: 16:17:58

PROJECT INFORMATION

Company: GMD 3
 Project: 22566
 Location: Finney County
 Test Well: 22566

WELL DATA

Pumping Wells

Well Name	X (ft)	Y (ft)
22566 ID4	-76338	376416

Observation Wells

Well Name	X (ft)	Y (ft)
□	-76338	376416
□ 22566 ID7	-72882	376323
□ 20894 ID2	-75459	377944
□ 20894 ID6	-73565	378597
□ 20896 ID4	-72902	380601
□ 20896 ID6	-75722	380995
□ 20774	-78190	380536
□ 21386 ID1	-78181	377878
□ 21386 ID6	-79074	374282
□ 21388	-78420	372554
□ 20893 ID2	-75430	372718
□ 20893 ID5	-71788	373370
□ Domestic 5-25-34	-79427	378948

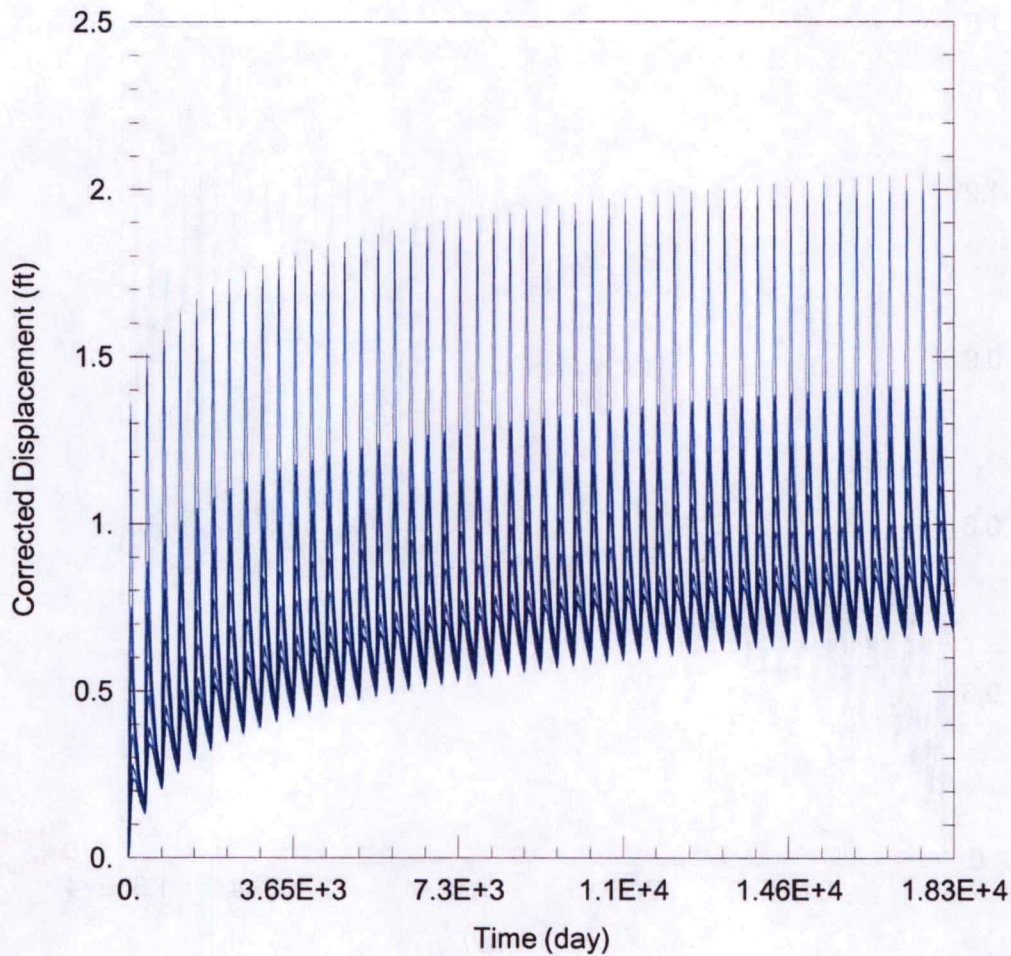

WELL TEST ANALYSIS

Data Set: C:\Users\trevora\Documents\2020_moves\22566\22566 Proposed.aqt
 Date: 11/09/20 Time: 16:17:52

PROJECT INFORMATION

Company: GMD 3
 Project: 22566
 Location: Finney County
 Test Well: 22566

WELL DATA

Pumping Wells

Well Name	X (ft)	Y (ft)
22566 ID4	-75557	376250

Observation Wells

Well Name	X (ft)	Y (ft)
□	-75557	376250
□ 22566 ID7	-72882	376323
□ 20894 ID2	-75459	377944
□ 20894 ID6	-73565	378597
□ 20896 ID4	-72902	380601
□ 20896 ID6	-75722	380995
□ 20774	-78190	380536
□ 21386 ID1	-78181	377878
□ 21386 ID6	-79074	374282
□ 21388	-78420	372554
□ 20893 ID2	-75430	372718
□ 20893 ID5	-71788	373370
□ Domestic 5-25-34	-79427	378948

Meyer, Mike [KDA]

From: Meyer, Mike [KDA]
Sent: Friday, November 6, 2020 9:16 AM
To: 'Norquest, Jason (Norquest@gmd3.org)'
Subject: request for recommendation, File No. 22566
Attachments: 20201106084059501.pdf

good morning , attached is an application for change in point of diversion, File No. 22566. please review and submit a recommendation within 15 days

thank you

Mike

-----Original Message-----

From: kda.fax@ks.gov <kda.fax@ks.gov>
Sent: Friday, November 6, 2020 8:41 AM
To: Meyer, Mike [KDA] <Mike.Meyer@ks.gov>
Subject: Message from "GardenCity-Savin-Color"

This E-mail was sent from "GardenCity-Savin-Color" (MP C3004ex).

Scan Date: 11.06.2020 08:40:59 (-0600)
Queries to: kda.fax@ks.gov

This E-Mail was sent from the Kansas Department of Agriculture.

Garden City Field Office
4532 W. Jones, Suite B
Garden City, KS 67846



Phone: 620-276-2901
Fax: 620-276-9315
www.agriculture.ks.gov

Mike Beam, Secretary

Laura Kelly, Governor

November 6, 2020

SOUTHWEST KANSAS GROUNDWATER
MANAGEMENT DISTRICT NO. 3
2009 E SPRUCE ST
GARDEN CITY KS 67846

Re: Water Right, File No. 22566

Dear Mr. Norquest:

This is to advise you that Sandyhill Enterprises LLC, has filed an application for approval of the Chief Engineer, Division of Water Resources, Kansas Department of Agriculture, to change the point of diversion for the above referenced file.

We are delaying action on the change applications to allow you time to review and provide a recommendation. Please submit a recommendation within 15 days from the date of this letter.

Thank you and as always feel free to contact this office at any time.

Sincerely,

A handwritten signature in blue ink that reads "Michael A. Meyer".

Michael A. Meyer
Water Commissioner

MAM
Enclosures