

Kansas Department of Agriculture
 Division of Water Resources
CHANGE: P/D WORKSHEET

1. File Number: 7310-D1	2. Status Change Date: 6-29-2020	3. Change Num: C1	4. Field Office: 4	5. GMD: 3
-----------------------------------	--	-----------------------------	------------------------------	---------------------

6. Status: <input checked="" type="checkbox"/> Approved <input type="checkbox"/> Denied by DWR/GMD <input type="checkbox"/> Dismiss by Request/Failure to Return	7. Filing Date of Change: 6/24/2020
--	---

8a. Applicant(s) New to system <input type="checkbox"/> SOBBA & SONS LLC Attn: ROBERT SOBBA 10119 WRANGLER RD FOWLER, KS 67844	8c. Landowner(s) New to system <input type="checkbox"/> Person ID 58319 Add Seq# _____
--	--

8b. Landowner(s) New to system <input type="checkbox"/> 8a	8d. WUC New to system <input type="checkbox"/> JAY W & JOLENE D LUNDEEN 2165 26 RD FOWLER, KS 67844
---	--

9. Documents and Enclosure(s): DWR Meter(s) Date to Comply: **12/31/2020** N & P Date to Comply: **3/1/2021**

Anti-Reverse Meter Meter Seal Check Valve N & P Form Water Tube Driller Copy H & E Letter

Conservation Plan Date Required: _____ Date Approved: _____ Date to Comply: _____

10. Use Made of Water From: _____ To: _____

Date Prepared: **6/26/2020** By: **AM**
 Date Entered: _____ By: _____

File No. **7310-D1** 11. County: **ME** Basin: **CROOKED CREEK** Stream: Formation Code: **211** Special Use:

12. Points of Diversion
 CHK
 MOD
 DEL PDIV
 ENT Qualifier S T R ID 'N 'W Comment (AKA Line) Rate gpm Quantity af Rate gpm Quantity af Overlap PD Files

DEL 41558
ENT SW NW SW 5 30S 26W 1717 5201 160 85 160 85 ME-005

13. Storage: Rate _____ NF Quantity _____ ac/ft Additional Rate _____ NF Additional Quantity _____ ac/ft

14. Limitation: _____ af/yr at _____ gpm (_____ cfs) when combined with file number(s) _____
 Limitation: _____ af/yr at _____ gpm (_____ cfs) when combined with file number(s) _____

15. 5YR Allocation: Allocation Type _____ Start Year _____ 5 YR Amount _____ Amount Unit _____ Base Acres _____ Comment _____

16. Place of Use CHK MOD DEL ENT	PUSE	S	T	R	ID	NE¼				NW¼				SW¼				SE¼				Total	Owner	Chg?	Overlap Files
						NE ¼	NW ¼	SW ¼	SE ¼	NE ¼	NW ¼	SW ¼	SE ¼	NE ¼	NW ¼	SW ¼	SE ¼	NE ¼	NW ¼	SW ¼	SE ¼				
CHK 31772																									
CHK 33481																									

Base Acres: Year: Minimum Reasonable Quantity:
 Comments:

Garden City Field Office
4532 W. Jones, Suite B
Garden City, KS 67846



Phone: 620-276-2901
Fax: 620-276-9315
www.agriculture.ks.gov

Mike Beam, Secretary

Laura Kelly, Governor

June 29, 2020

SOBBA & SONS LLC
Attn: ROBERT SOBBA
10119 WRANGLER RD
FOWLER, KS 67844

RE: Vested Right, File No. ME 005
Water Right, File No. 7310-D1

Dear Sir or Madam:

Enclosed is the order executed by the designee of the Chief Engineer, Division of Water Resources, Kansas Department of Agriculture, approving the application for change under the above referenced file number.

Your attention is directed to the enclosures and to the terms, conditions, and limitations specified in this approval for change. A condition of this approval is that an acceptable water flow meter must be installed on the diversion works authorized under the referenced file number and meet current specifications. Please return the required notification of completion of the diversion works and installation of the required meter as soon as these actions are completed.

Since the order modifies the original document referred to above, it should be recorded with the Register of Deeds as other instruments affecting real estate.

The abandoned well must be plugged in accordance with the requirements of Article 30 of the Rules and Regulations as adopted by the Kansas Department of Health and Environment.

Should you have any questions, please feel free contact this office. If you would prefer, you could arrange an appointment for additional assistance.

Sincerely,

Michael A. Meyer
Water Commissioner

MAM:am
enclosures

pc: Jay & Jolene Lundeen
GROUNDWATER MANAGEMENT DISTRICT NO. 3

CERTIFICATE OF SERVICE

On this 29th day of June, 2020, I hereby certify that the foregoing Approval of Application for Change in Point of Diversion, Vested Right, File No. ME 005 and Water Right, File No. 7,310-D1 dated 29th day of June, 2020 was mailed postage prepaid, first class, US mail to the following:

SOBBA & SONS LLC
Attn: ROBERT SOBBA
10119 WRANGLER RD
FOWLER, KS 67844

Pc:

JAY W & JOLENE D LUNDEEN
2165 26 RD
FOWLER, KS 67844

GROUNDWATER MANAGEMENT DISTRICT NO. 3

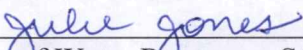

Division of Water Resources Staff

Submit completed application to:
 Kansas Department of Agriculture
 Division of Water Resources
 Field Office for your area.

Call for address:

Topeka -- (785) 296-5733
 Stafford -- (620) 234-5311
 Stockton -- (785) 425-6787
 Garden City -- (620) 276-2901
<http://agriculture.ks.gov/dwr>

DWR FIELD OFFICE APPLICATION FOR APPROVAL TO CHANGE THE PLACE OF USE AND/OR THE POINT OF DIVERSION



STATE OF KANSAS

Filing Fee Must Accompany the Application, K.S.A. 82a-708b(b), as amended.
 Fee Schedule is on the third page of this application form.

Paragraph Nos. 1, 2, 3 & 5 must be completed. Complete all other applicable portions. If change in point of diversion is greater than 100 feet, or if place of use will be changed, include a topographic map or detailed plat showing the authorized and proposed point(s) of diversion and/or place of use.

File No. 7310 D1

RECEIVED
 1:26 PM
 JUN 24 2020

Garden City Field Office
 DIVISION OF WATER RESOURCES

1. Application is hereby made for approval of the Chief Engineer to change the (check one or both):

Place of Use Point of Diversion

under the water right which is the subject of this application in accordance with the conditions described below.

The source of supply is: Groundwater Surface water

2. Name and address of Applicant: SOBBA & SONS LLC

10119 WRANGLER RD FOWLER, KS. 67844

Phone Number: (620)646 6076 Email address: _____

Name and address of Water Use Correspondent: JAY W. & JOLENE D. LUNDEEN

2165 26 RD FOWLER, KS. 67844

Phone Number: () _____ Email address: _____

3. The presently authorized place of use is:

Owner of Land ---- NAME: NO CHANE

ADDRESS: _____

(If there is more than one landowner, attach supplemental sheets as necessary.)

Sec.	Twp.	Range	NE¼				NW¼				SW¼				SE¼				TOTAL ACRES	
			NE¼	NW¼	SW¼	SE¼	NE¼	NW¼	SW¼	SE¼	NE¼	NW¼	SW¼	SE¼	NE¼	NW¼	SW¼	SE¼		

4. If this application is for a change in place of use, it is proposed that the place of use be changed to:

Owner of Land ---- NAME: NO CHANGE

ADDRESS: _____

(If there is more than one landowner, attach supplemental sheets as necessary.)

Sec.	Twp.	Range	NE¼				NW¼				SW¼				SE¼				TOTAL ACRES		
			NE¼	NW¼	SW¼	SE¼	NE¼	NW¼	SW¼	SE¼	NE¼	NW¼	SW¼	SE¼	NE¼	NW¼	SW¼	SE¼			

For Office Use Only: Code _____ Fee \$ 200.00 TR # _____ Receipt Date 6-24-20 Check # 1750

5. **Presently authorized point of diversion:**
 One in the SW Quarter of the NW Quarter of the SW Quarter of Section 5, Township 30 South, Range 26 (W), in MEADE County, Kansas, 1799 feet North 4890 feet West of Southeast corner of section. Authorized Rate 160GPM Authorized Quantity 85 AF Depth of well _____ (feet)
(DWR use only: Computer ID No. 1 GPS 1564 feet North 5080 feet West)
 This point will not be changed This point will be changed as follows: No change, point better described with GPS as follows:
Proposed point of diversion: (Complete only if change is requested or if existing point is better described by GPS)
 One in the SW Quarter of the NW Quarter of the SW Quarter of Section 5, Township 30 South, Range 26 (W), in MEADE County, Kansas, 1777 feet North 5211 feet West of Southeast corner of section. Proposed Rate _____ Proposed Quantity _____ Proposed well depth (feet) _____
 This point is: Additional Well Geo Center List other water rights that will use this point _____

1777' 5211' Revised by driller

6. **Presently authorized point of diversion:**
 One in the _____ Quarter of the _____ Quarter of the _____ Quarter of Section _____, Township _____ South, Range _____ (W), in _____ County, Kansas, _____ feet North _____ feet West of Southeast corner of section. Authorized Rate _____ Authorized Quantity _____ Depth of well _____ (feet)
(DWR use only: Computer ID No. _____ GPS _____ feet North _____ feet West)
 This point will not be changed This point will be changed as follows: No change, point better described with GPS as follows:
Proposed point of diversion: (Complete only if change is requested or if existing point is better described by GPS)
 One in the _____ Quarter of the _____ Quarter of the _____ Quarter of Section _____, Township _____ South, Range _____ (W), in _____ County, Kansas, _____ feet North _____ feet West of Southeast corner of section. Proposed Rate _____ Proposed Quantity _____ Proposed well depth (feet) _____
 This point is: Additional Well Geo Center List other water rights that will use this point _____

7. The changes herein are desired for the following reasons?
 (please be specific) lack of production on current PD

8. If a well, is the test hole log attached? Yes No

9. The change(s) (was)(will be) completed by?

10. If the point of diversion is a well:
 (a) What are you going to do with the old well?
To be plugged
 (b) When will this be done? _____

11. Groundwater Management District recommendation attached?
 Yes No

12. Assisted by CAC

13a. If the proposed point of diversion will be relocated more than 300 feet but within 2,640 feet of the existing point of diversion, attach a topographic map or aerial photograph. For groundwater sources, show all wells (including domestic) within one-half mile of the proposed point of diversion and the names and mailing addresses of the owners. For surface water sources, show the names and addresses of the landowner(s) one-half mile downstream and one-half mile upstream from your property lines

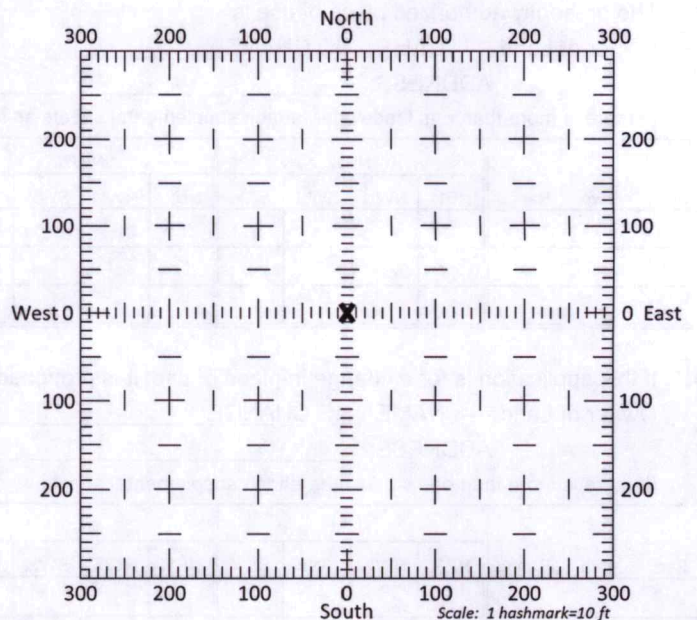

13b. If the proposed point of diversion will be relocated within 300 feet of the existing point of diversion, indicate its location on the diagram shown above in relation to the existing point of diversion. **(PLEASE NOTE: The "X" in center of diagram above represents the presently authorized point of diversion.)**

14. If the proposed groundwater point of diversion is 300 or fewer feet from the existing point of diversion, complete the following:

- (a) Does the undersigned represent all owners of the currently authorized place(s) of use identified in this application?
 Yes No (If no, all owners must sign this application.)
- (b) Will the ownership interest of any owner of the currently authorized place(s) of use identified in this application be adversely affected if this application is approved as requested?
 Yes No (If yes, all owners must sign this application.)
- (c) If this application is not approved expeditiously, will there be substantial damage to property, public health or safety?
 Yes No (If no, all owners must sign this application.)

If the application proposes a surface water change in point of diversion, a groundwater change in point of diversion greater than 300 feet, or a change in place of use, the application must be signed by all owners of the currently authorized place of use, or their duly authorized agent (attach notarized statement authorizing representation).

I hereby verify, being first duly sworn upon my oath or affirmation and under penalty of perjury, that I am of lawful age and the owner, the spouse of the owner, or a duly authorized agent of the owner(s) to make this application on their behalf, in regards to the water right(s) to which this application pertains. I further verify that the statements contained in this application are true, correct and complete.

Dated at _____, Kansas, this 24 day of JUNE, 2020.

<u>Penny Sobba</u> (Owner)	_____	(Spouse)
<u>PENNY SOBBA</u> (Please Print)	_____	(Please Print)
_____	_____	(Spouse)
(Owner)	_____	(Please Print)
_____	_____	(Spouse)
(Please Print)	_____	(Please Print)
_____	_____	(Spouse)
(Owner)	_____	(Please Print)
_____	_____	(Spouse)
(Please Print)	_____	(Please Print)

State of ~~Kansas~~ }
County of Moake } SS

I hereby certify that the foregoing application was signed in my presence and sworn to before me this 24 day of June, 2020.

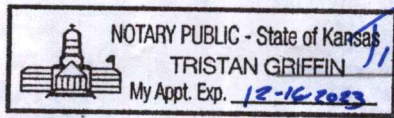

Tristan Griffin
Notary Public

My Commission Expires 12-16-2023

ONLY COMPLETE APPLICATIONS WILL BE PROCESSED. To be complete, all of the applicable portions of the application form must be completed with accurate information; maps, if necessary, must be included; signatures of all the appropriate owners' must be affixed to the application and notarized; and the appropriate fee must be paid.

FEE SCHEDULE

Each application to change the place of use or the point of diversion under this section shall be accompanied by the application fee set forth in the schedule below: Make checks payable to: **Kansas Department of Agriculture**

- (1) Application to change a point of diversion 300 feet or less \$100
- (2) Application to change a point of diversion more than 300 feet \$200
- (3) Application to change the place of use \$200

SUMMARY ORDER APPROVING APPLICATION FOR CHANGE AND IMPOSING CONDITIONS

This Summary Order is issued under authority of K.S.A. 82a-708b, as amended, and K.A.R. 5-5-1, *et seq.* and other applicable provisions of the *Kansas Water Appropriation Law, K.S.A. 82a-701 et seq.*, and rules and regulations promulgated thereunder. With the exception of those conditions expressly contained herein, this Summary Order does not change the terms, conditions and limitations of File No. 7310-01.

1. A change application was received on June 24, 2020 requesting that the place of use and / or point of diversion authorized under the above-referenced file number be changed as described in the application.
2. On and after the effective date of this summary order, the authorized place(s) of use shall be located substantially as shown on the topographic map accompanying the application to change the place of use. Applicable Not Applicable
3. The change in point of diversion shall not impair existing rights and shall be limited to the same source or sources of water as previously authorized. The point of diversion authorized by this summary order shall be located within a 50 foot radius of the authorized point(s) of diversion. Applicable Not Applicable
4. The point(s) of diversion described herein is administratively corrected to be more accurately described using the Global Positioning System (GPS), as described in the application. Applicable Not Applicable
5. The point(s) of diversion authorized herein shall not actually be located more than 300 feet from the previously authorized point(s) of diversion. Applicable Not Applicable
6. As required by K.A.R. 5-3-5d, if the works for diversion is a well with a diversion rate of 100 gallons per minute or more, a tube or other device suitable for making water level measurements shall be installed, operated and maintained in accordance with K.A.R. 5-6-13. Applicable Not Applicable
7. **The owner of the authorized place(s) of use shall properly install an acceptable water flow meter on or before December 31, 2020, or before the first use of water, whichever occurs first.** The water flow meter shall be installed, operated and maintained in accordance with K.A.R. 5-1-4 through 5-1-12. As required by K.S.A. 82a-732, as amended, and K.A.R. 5-3-5e, the owner shall maintain records and report the reading of the water flow meter and the total quantity of water diverted annually to the Chief Engineer by March 1 following the end of each calendar year. Applicable Not Applicable
8. **Installation of the works for diversion of water shall be completed on or before December 31, 2020, or within any authorized extension of time.** By March 1, 2021 the applicant shall notify the Chief Engineer that construction of the works for diversion has been completed, on the form provided by the Chief Engineer, as required by K.A.R. 5-8-4e. Applicable Not Applicable
9. **The completed well log shall be submitted with the required notice.** Applicable Not Applicable
10. All diversion works into which any type of chemical or other foreign substance will be injected into the water shall be equipped with an in-line, automatic, quick-closing check valve capable of preventing pollution of the source of the water supply. The check valve(s) shall be installed, operated and maintained in accordance with K.A.R. 5-3-5c. Applicable Not Applicable
11. Additional Conditions are attached. Yes No
12. In accordance with K.S.A. 82a-708a, as amended, and K.A.R. 5-5-14, all of the owners of the authorized place(s) of use of water appropriated under the above-referenced file number are responsible for compliance with its terms, conditions and limitations, as amended and/or supplemented by this Summary Order, and with applicable provisions of the *Kansas Water Appropriation Law* and the *Rules and Regulations* promulgated thereunder. Failure to comply with these provisions may result in civil penalties pursuant to K.S.A. 82a-737, as amended, and/or the suspension or revocation and dismissal of the water or appropriation right or any other enforcement actions authorized by law.

Administrative Appeal and Effective Date of Order

If you are aggrieved by this order, pursuant to K.S.A. 82a-1901, you may request an evidentiary hearing before the Chief Engineer or request administrative review by the Secretary of Agriculture. A request for hearing by the Chief Engineer must be filed within **15 days** of service of this Order and a request for administrative review by the Secretary must be filed within **30 days** pursuant to K.S.A. 77-531. Any request for administrative review must state a basis for review pursuant to K.S.A. 77-527. File any request with **Kansas Department of Agriculture, Legal Division, 1320 Research Park Drive, Manhattan, KS 66502.** Failure to timely request a hearing or review may preclude review under the Kansas Judicial Review Act.

For Use by Register of Deeds

FOR OFFICE USE ONLY
**APPLICATION APPROVED AND
SUMMARY ORDER ISSUED**

By: Michael A. Meyer
Duly Authorized Designee of the Chief Engineer

(Print Name): Michael A. Meyer
Division of Water Resources - Kansas Department of Agriculture

Date of Issuance: June 29, 2020

State of Kansas)

County of Atterney) SS

Acknowledged before me on June 29, 2020

by Michael A. Meyer



Signature: Julie Jones
Notary Public

My commission expires:

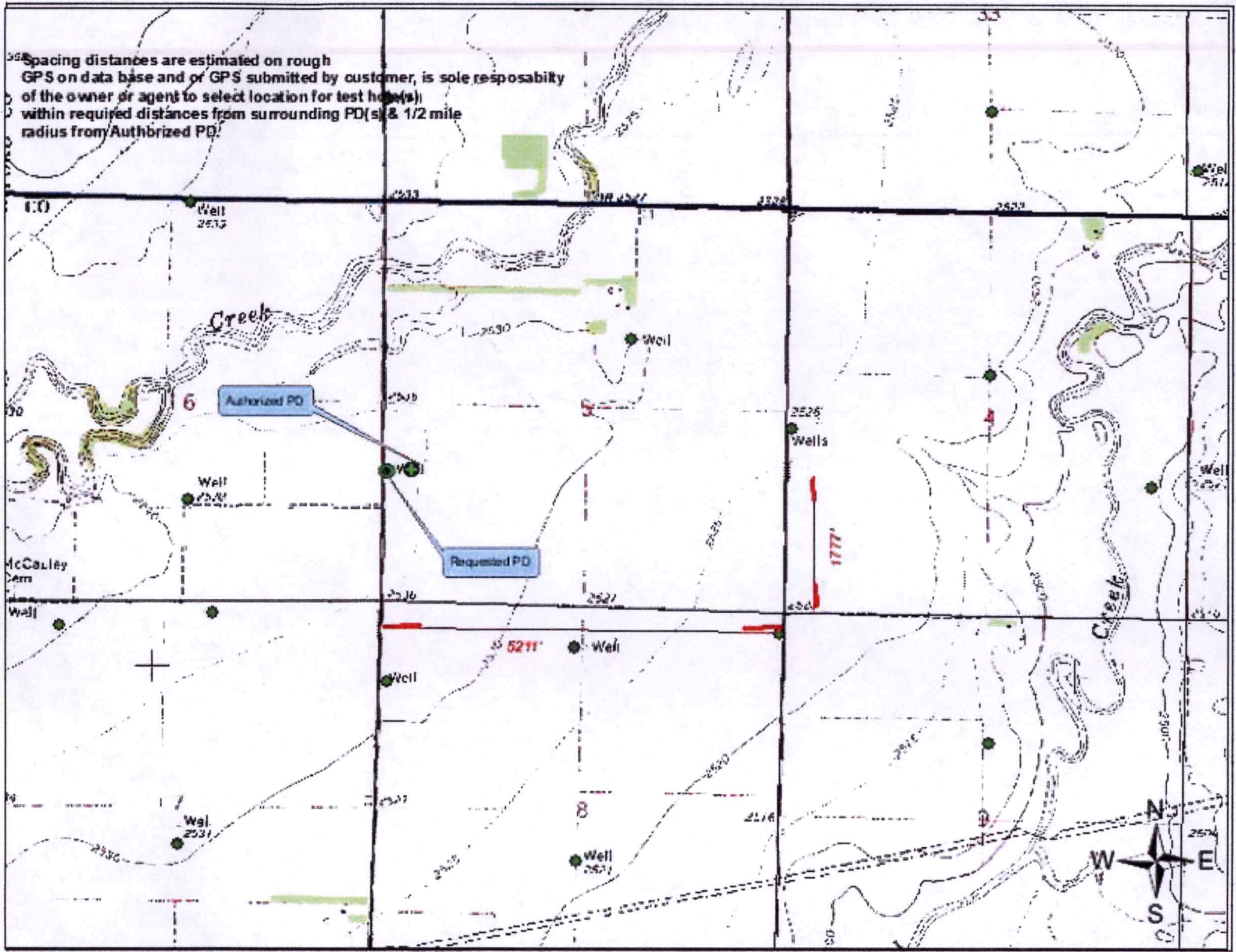

Point of Diversion Change
 WR's ME 5 & 7310 D1
 T30 R26W Section
 Meade Co.

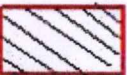

- Authorized PD
 - Requested PD
 - Point of Diversion
 -  Authorized PU
 -  Requested PU
 -  Half Mile Radius
- (2006 Scaled air photo)
 0 650 1,300 2,600 3,900 5,200 Feet

WELL LOG

MEAD

DATE: 6/22/2020

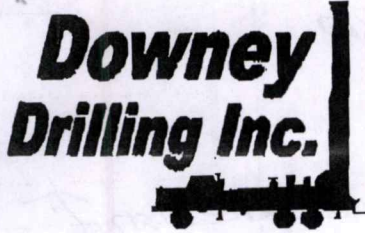

CUSTOMER NAME: SOBBA FARMS LTD PTSHP TH#1

LEGAL: SW 5-30S-26W

COUNTY: MEADE

GPS: 37.465445

TEST HOLE #1

-100.198092

LOGGER:

DRILLER: ROGELIO

WO:

20-517

TW	FROM	TO	TYPE	HARDNESS	COLOR	SPEED	PULL DOWN	OTHER / DRILLING ACTION
	0	2	TOPSOIL	SOFT	BROWN	FAST		SMOOTH
	2	67	BROWN CLAY	SOFT	BROWN	FAST		SMOOTH
	67	110	BLUE CLAY W/ FINE SAND LAYERS	SOFT	BLUE	FAST		SMOOTH
	110	145	FINE-MED-COARSE SAND, FINE SAND	FIRM	TAN	FAST		VIBRATION
	145	150	BROWN CLAY	SOFT	TAN	FAST		SMOOTH
	150	205	FINE-MED-COARSE GRAVEL, FINE-MED-COARSE SAND	FIRM	TAN	FAST		FAST CHATTER
	205	215	SANDY CLAY	SOFT	TAN	FAST		SMOOTH
	215	226	FINE SAND	SOFT	TAN	FAST		VIBRATION
	225	256	SANDY CLAY	SOFT	TAN	FAST		SMOOTH
	256	263	FINE-MED-COARSE SAND, FINE SAND LIMEROCK TRACES	SOFT	TAN	FAST		VIBRATION
	263	294	SANDY CLAY W/ FINE SAND LIMEROCK TRACES	SOFT	TAN	FAST		SMOOTH
	294	323	SANDY CLAY W/ FINE SAND AND LIMEROCK	SOFT	TAN	FAST		SMOOTH
	323	325	WEATHERED SHALE, LITTLE BROWN ROCK	SOFT	TAN	FAST		SMOOTH
	325	340	BROWN CLAY	SOFT	TAN	FAST		SMOOTH
			QUIKGEL - 4					
			HOLEPLUG - 2					
			CASING SEAL - 1					
			WATER LOADS - 1					
			SODA ASH - 1/4 BAG					

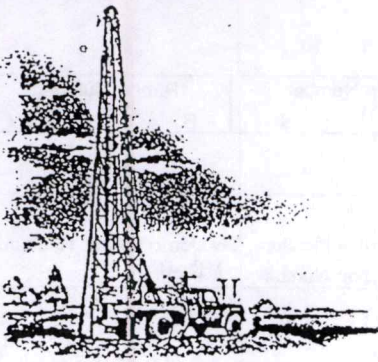

Henkle

DRILLING & SUPPLY CO., INC.

3795 W. JONES AVE.
316/277-2389
FAX/277-0224

P.O. Box 639
GARDEN CITY, KANSAS 67846

CUSTOMER'S NAME Larry & Ralph Sturgeon DATE July 23, 1990
 STREET ADDRESS Rt. 1. Box 36-A TEST # 1 E. LOG Yes
 CITY & STATE Fowler, Ks. 67844 DRILLER Shelden
 COUNTY Meade QUARTER ~~3~~ SW SECTION 4 TOWNSHIP 30 RANGE 26

LOCATION 100' south of old well - 16' west of underground line - 60' east of center of road

%	FOOTAGE			DESCRIPTION OF STRATA	Well location	
	From	Pay	To		STATIC WATER LEVEL: <u>Approx. 100'</u>	Proposed Well Depth: <u>289'</u>
	0		2	Top soil		
	2		34	Brown sandy clay & some fine sand streaks		
	34		93	Gray clay & some lime rock		
	93		106	Sand fine to medium		
	106		124	Blue clay & brown clay		
45	124	19	143	Sand fine to medium with lots of clay streaks some lime rock ledges		
50	143	18	161	Sand fine to medium		
60	161	39	200	Sand fine to medium coarse small gravel		
40	200	31	231	Sand fine to medium with some clay streaks & lime rock ledges		
45	231	42	273	Sand fine to small cemented in places		
45	273	13	286	Sand fine to small with small brown & tan rock		
	286		322	Gray shale with some hard brown rock ledges		
				Well depth = 289'		
				1 - 50 lb. bag Quick Gel		
				1 - 50 lb. Bag Hole Plug		
				1 - Perma Plug		
				Set up south pit on west		

