

Kansas Department of Agriculture
 Division of Water Resources
CHANGE: P/U WORKSHEET

1. File Number: 14101	2. Status Change Date:	3. Change Num: C3	4. Field Office: 04	5. GMD: 03
---------------------------------	------------------------	-----------------------------	-------------------------------	----------------------

6. Status: <input checked="" type="checkbox"/> Approved <input type="checkbox"/> Denied by DWR/GMD <input type="checkbox"/> Dismiss by Request/Failure to Return	7. Filing Date of Change: 8/24/2021
--	---

8a. LANDOWNER, applicant, New to system <input type="checkbox"/> Person ID 41565 Add Seq# _____ LOVE AG COMPANY ATTN: GREG LOVE 24506 13 RD MONTEZUMA, KS 67867-9073	8c. Landowner New to system <input type="checkbox"/> Person ID _____ Add Seq# _____
---	---

8b. Landowner(s), correspondent New to system <input type="checkbox"/> Person ID 25213 Add Seq# _____ GREGORY C & SUE LOVE 24506 13 RD MONTEZUMA, KS 67867-9073	8d. WUC New to system <input checked="" type="checkbox"/> Person ID _____ Add Seq# _____
--	--

9. Documents and Enclosure(s): DWR Meter(s) Date to Comply: **12/31/2021** N & P Date to Comply: _____

Anti-Reverse Meter Meter Seal Check Valve N & P Form Water Tube Driller Copy H & E Letter
 Conservation Plan Date Required: _____ Date Approved: _____ Date to Comply: _____

10. Use Made of Water From: _____ To: _____

Date Prepared: **8/25/2021** By: **MAM**
 Date Entered: _____ By: _____

File No. **14101** 11. County: GY Basin: ARKANSAS RIVER Stream: Formation Code: Special Use:

12. Points of Diversion
CHK Rate and Quantity
MOD Authorized Additional
DEL PDIV Qualifier S T R ID 'N 'W **Comment (AKA Line)** Rate Quantity Rate Quantity
ENT gpm af gpm af Overlap PD Files

CHK 31599

13. Storage: Rate _____ NF Quantity _____ ac/ft Additional Rate _____ NF Additional Quantity _____ ac/ft

14. Limitation: _____ af/yr at _____ gpm (_____ cfs) when combined with file number(s) _____
 Limitation: _____ af/yr at _____ gpm (_____ cfs) when combined with file number(s) _____

15. 5YR Allocation: Allocation Type _____ Start Year _____ 5 YR Amount _____ Amount Unit _____ Base Acres _____ Comment _____

16. Place of Use CHK MOD DEL ENT	PUSE	S	T	R	ID	NE¼				NW¼				SW¼				SE¼				Total	Owner	Chg?	Overlap Files
						NE ¼	NW ¼	SW ¼	SE ¼	NE ¼	NW ¼	SW ¼	SE ¼	NE ¼	NW ¼	SW ¼	SE ¼	NE ¼	NW ¼	SW ¼	SE ¼				
CHK 1423	6	27	28W	01										31	L-6 31	L-7 31	31	31	31	31	31	248	8a	NO	13145, 14550, 19266, 19809, 20063, 21037, 21455, 26527
MOD 33304	7	27	28W	04	31	31	31	31						31.5	L-3 31.5	L-4 31.5	31.5	31	31	31	31	374	8a	NO	13145, 14550, 19266, 19809, 20063, 21037, 21455, 26527
CHK 17889	13	27	29W	01	31	31	31	31	31	31	31	31	31	31	31	31	31	31	31	31	31	496	8a	NO	13145, 14550, 19266, 19809, 20063, 21037, 21455, 26527
CHK 6605	18	27	28W	01	31	31	31	31	31	L-1 31	L-2 31	31	31	31	L-3 31	L-4 31	31	31	31	31	31	496	8b	NO	13145, 14550, 19266, 19809, 20063, 21037, 21455, 26527
ENT 33536	12	27	29W	02										31.5	31.5	31.5	31.5	31.5	31.5	31.5	31.5	252	8a	NO	13145, 14550, 19266, 19809, 20063, 21037, 21455, 26527

Base Acres: **Year:** **Minimum Reasonable Quantity:**

Comments:

Garden City Field Office
4532 W. Jones, Suite B
Garden City, KS 67846



Phone: 620-276-2901
Fax: 620-276-9315
www.agriculture.ks.gov

Mike Beam, Secretary

Laura Kelly, Governor

September 1, 2021

LOVE AG COMPANY
Attn: GREG LOVE
24506 13 RD
MONTEZUMA, KS 67867-9073

RE: Approval of Application for Change
Water Right, File Nos. 13145, 14101, 14550, 19622, 19809, 20063, 21037,
21455, 26527

Dear Sir:

Enclosed are orders executed by the designee of the Chief Engineer, Division of Water Resources, Kansas Department of Agriculture, approving the applications for change under the above referenced file numbers.

Your attention is directed to the enclosures and to the terms, conditions, and limitations specified in the approvals for change. A condition of the approval is that acceptable water flow meters must be installed on the diversion works authorized under the referenced file numbers and meet current specification. Please return the required notification of completion of the diversion works and installation of the required meters as soon as these actions are completed. Also please note the condition that referenced File No. 19,001 has been reduced in annual authorized quantity.

Since the orders modify the original documents referred to above, they should be recorded with the Register of Deeds as other instruments affecting real estate.

Should you have any questions, please feel free to call this office. If you would prefer, you could arrange an appointment for additional assistance.

Sincerely,

A handwritten signature in blue ink that reads "Michael A. Meyer".

Michael A. Meyer
Water Commissioner

MAM:
enclosures
pc: GMD3

CERTIFICATE OF SERVICE

On this 1st day of September 2021, I hereby certify that the foregoing Approval of Application for Change in Place of Use, Water Right, File Nos. 13,145, 14,101, 14,550, 19,622, 19,809, 20,063, 21,037, 21,455 & 26,527 dated 1st day of September 2021 was mailed postage prepaid, first class, US mail to the following:

LOVE AG COMPANY
Attn: GREG LOVE
24506 13 RD
MONTEZUMA, KS 67867-9073

Pc:

GREGORY C & SUE LOVE
24506 13 RD
MONTEZUMA, KS 67867-9073

GROUNDWATER MANAGEMENT DISTRICT NO. 3



Division of Water Resources

Submit completed application to:
 Kansas Department of Agriculture
 Division of Water Resources
 Field Office for your area.

Call for address:

Topeka -- (785) 296-5733
 Stafford -- (620) 234-5311
 Stockton -- (785) 425-6787
 Garden City -- (620) 276-2901
<http://agriculture.ks.gov/dwr>

DWR FIELD OFFICE APPLICATION FOR APPROVAL TO CHANGE THE PLACE OF USE AND/OR THE POINT OF DIVERSION



STATE OF KANSAS

Filing Fee Must Accompany the Application, K.S.A. 82a-708b(b), as amended.
 Fee Schedule is on the third page of this application form.

Paragraph Nos. 1, 2, 3 & 5 must be completed. Complete all other applicable portions. If change in point of diversion is greater than 100 feet, or if place of use will be changed, include a topographic map or detailed plat showing the authorized and proposed point(s) of diversion and/or place of use.

File No. 14101

RECEIVED
 3:51 pm
 AUG 24 2021

Garden City Field Office
 Division of Water Resources

1. Application is hereby made for approval of the Chief Engineer to change the (check one or both):

Place of Use Point of Diversion

under the water right which is the subject of this application in accordance with the conditions described below.

The source of supply is: Groundwater Surface water

2. Name and address of Applicant: Love Ag Company %Greg Love

24506 13 RD, Montezuma, KS 67867

Phone Number: (620)846-0222 Email address: greg.c.love@gmail.com

Name and address of Water Use Correspondent: SAME

Phone Number: () Email address: _____

3. The presently authorized place of use is:

Owner of Land ---- NAME: Love Ag Company %Greg Love

ADDRESS: 24506 13 RD, Montezuma, KS 67867

(If there is more than one landowner, attach supplemental sheets as necessary.)

Sec.	Twp.	Range	NE¼				NW¼				SW¼				SE¼				TOTAL ACRES
			NE¼	NW¼	SW¼	SE¼	NE¼	NW¼	SW¼	SE¼	NE¼	NW¼	SW¼	SE¼	NE¼	NW¼	SW¼	SE¼	
6	27s	28w									31.0	31.0	31.0	31.0	31.0	31.0	31.0	31.0	248.0
7	27s	28w	31.0	31.0	31.0	31.0									31.0	31.0	31.0	31.0	248.0
13	27s	29w	31.0	31.0	31.0	31.0	31.0	31.0	31.0	31.0	31.0	31.0	31.0	31.0	31.0	31.0	31.0	31.0	496.0

4. If this application is for a change in place of use, it is proposed that the place of use be changed to:

Owner of Land ---- NAME: Love Ag Company %Greg Love

ADDRESS: 24506 13 RD, Montezuma, KS 67867

(If there is more than one landowner, attach supplemental sheets as necessary.)

Sec.	Twp.	Range	NE¼				NW¼				SW¼				SE¼				TOTAL ACRES
			NE¼	NW¼	SW¼	SE¼	NE¼	NW¼	SW¼	SE¼	NE¼	NW¼	SW¼	SE¼	NE¼	NW¼	SW¼	SE¼	
6	27s	28w									31.0	31.0	31.0	31.0	31.0	31.0	31.0	31.0	248.0
7	27s	28w	31.0	31.0	31.0	31.0					31.5	31.5	31.5	31.5	31.0	31.0	31.0	31.0	374.0
13	27s	29w	31.0	31.0	31.0	31.0	31.0	31.0	31.0	31.0	31.0	31.0	31.0	31.0	31.0	31.0	31.0	31.0	496.0

For Office Use Only: Code _____ **Fee \$** 200.00 **TR #** _____ **Receipt Date** 8-24-21 **Check #** 6918

5. **Presently authorized point of diversion:**
 One in the _____ Quarter of the _____ NC _____ Quarter of the _____ NW _____ Quarter
 of Section _____ 13 _____, Township _____ 27 _____ South, Range _____ 29 _____ W,
 in Gray _____ County, Kansas, _____ 3960 _____ feet North _____ 3960 _____ feet West of Southeast corner of section.
 Authorized Rate _____ 770gpm _____ Authorized Quantity _____ 272AF _____ Depth of well _____ (feet)
(DWR use only: Computer ID No. _____ 0/ _____ GPS _____ feet North _____ feet West)
 This point will not be changed This point will be changed as follows: No change, point better described with GPS as follows:
Proposed point of diversion: (Complete only if change is requested or if existing point is better described by GPS)
 One in the _____ Quarter of the _____ Quarter of the _____ Quarter
 of Section _____, Township _____ South, Range _____ (E/W),
 in _____ County, Kansas, _____ feet North _____ feet West of Southeast corner of section.
 Proposed Rate _____ Proposed Quantity _____ Proposed well depth (feet) _____
 This point is: Additional Well Geo Center List other water rights that will use this point _____

6. **Presently authorized point of diversion:**
 One in the _____ Quarter of the _____ Quarter of the _____ Quarter
 of Section _____, Township _____ South, Range _____ W,
 in Gray _____ County, Kansas, _____ feet North _____ feet West of Southeast corner of section.
 Authorized Rate _____ Authorized Quantity _____ Depth of well _____ (feet)
(DWR use only: Computer ID No. _____ GPS _____ feet North _____ feet West)
 This point will not be changed This point will be changed as follows: No change, point better described with GPS as follows:
Proposed point of diversion: (Complete only if change is requested or if existing point is better described by GPS)
 One in the _____ Quarter of the _____ Quarter of the _____ Quarter
 of Section _____, Township _____ South, Range _____ (E/W),
 in _____ County, Kansas, _____ feet North _____ feet West of Southeast corner of section.
 Proposed Rate _____ Proposed Quantity _____ Proposed well depth (feet) _____
 This point is: Additional Well Geo Center List other water rights that will use this point _____

7. The changes herein are desired for the following reasons?
 (please be specific) _____
 Make a complete overlap in place of use

8. If a well, is the test hole log attached? Yes No

9. The change(s) (was)(will be) completed by?
 As soon as approved _____

10. If the point of diversion is a well:
 (a) What are you going to do with the old well?

 (b) When will this be done? _____

11. Groundwater Management District recommendation attached?
 Yes No

12. Assisted by GMD3/JLN

13a. If the proposed point of diversion will be relocated more than 300 feet but within 2,640 feet of the existing point of diversion, attach a topographic map or aerial photograph. For groundwater sources, show all wells (including domestic) within one-half mile of the proposed point of diversion and the names and mailing addresses of the owners. For surface water sources, show the names and addresses of the landowner(s) one-half mile downstream and one-half mile upstream from your property lines

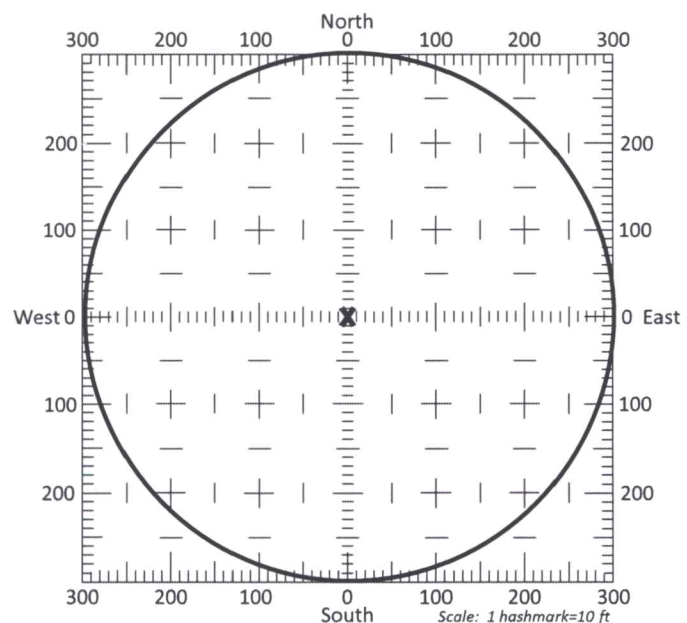

13b. If the proposed point of diversion will be relocated within a 300 foot radius of the existing point of diversion, indicate its location on the diagram shown above in relation to the existing point of diversion. The proposed point of diversion must be located within the circle shown above. **(PLEASE NOTE: The "X" in center of diagram above represents the presently authorized point of diversion.)**

APPLICATION FOR APPROVAL TO CHANGE
THE PLACE OF USE AND/OR POINT OF DIVERSION
SUPPLEMENTAL SHEET

FILE NO. 14101

MAKE ADDITIONAL COPIES AS NECESSARY

3. *Continued:* The presently authorized place of use is:

Owner of Land ---- NAME: Gregory C & Sue Love
ADDRESS: 24506 13 RD, Montezuma, KS 67867

Sec.	Twp.	Range	NE¼				NW¼				SW¼				SE¼				TOTAL ACRES
			NE¼	NW¼	SW¼	SE¼	NE¼	NW¼	SW¼	SE¼	NE¼	NW¼	SW¼	SE¼	NE¼	NW¼	SW¼	SE¼	
18	27s	28w	31.0	31.0	31.0	31.0	31.0	31.0	31.0	31.0	31.0	31.0	31.0	31.0	31.0	31.0	31.0	31.0	496.0

Owner of Land ---- NAME: _____
ADDRESS: _____

Sec.	Twp.	Range	NE¼				NW¼				SW¼				SE¼				TOTAL ACRES
			NE¼	NW¼	SW¼	SE¼	NE¼	NW¼	SW¼	SE¼	NE¼	NW¼	SW¼	SE¼	NE¼	NW¼	SW¼	SE¼	

Owner of Land ---- NAME: _____
ADDRESS: _____

Sec.	Twp.	Range	NE¼				NW¼				SW¼				SE¼				TOTAL ACRES
			NE¼	NW¼	SW¼	SE¼	NE¼	NW¼	SW¼	SE¼	NE¼	NW¼	SW¼	SE¼	NE¼	NW¼	SW¼	SE¼	

4. *Continued:* If this application is for a change in place of use, it is proposed that the place of use be changed to:

Owner of Land ---- NAME: Gregory C & Sue Love
ADDRESS: 24506 13 RD, Montezuma, KS 67867

Sec.	Twp.	Range	NE¼				NW¼				SW¼				SE¼				TOTAL ACRES	
			NE¼	NW¼	SW¼	SE¼	NE¼	NW¼	SW¼	SE¼	NE¼	NW¼	SW¼	SE¼	NE¼	NW¼	SW¼	SE¼		
18	27s	28w	31.0	31.0	31.0	31.0	31.0	31.0	31.0	31.0	31.0	31.0	31.0	31.0	31.0	31.0	31.0	31.0	31.0	496.0

Owner of Land ---- NAME: Love Ag Company %Greg Love
ADDRESS: 24506 13 RD, Montezuma, KS 67867

Sec.	Twp.	Range	NE¼				NW¼				SW¼				SE¼				TOTAL ACRES	
			NE¼	NW¼	SW¼	SE¼	NE¼	NW¼	SW¼	SE¼	NE¼	NW¼	SW¼	SE¼	NE¼	NW¼	SW¼	SE¼		
12	27s	29w																		

Owner of Land ---- NAME: _____
ADDRESS: _____

Sec.	Twp.	Range	NE¼				NW¼				SW¼				SE¼				TOTAL ACRES	
			NE¼	NW¼	SW¼	SE¼	NE¼	NW¼	SW¼	SE¼	NE¼	NW¼	SW¼	SE¼	NE¼	NW¼	SW¼	SE¼		

14. If the proposed groundwater point of diversion is 300 or fewer feet from the existing point of diversion, complete the following:
- (a) Does the undersigned represent all owners of the currently authorized place(s) of use identified in this application?
 Yes No (If no, all owners must sign this application.)
 - (b) Will the ownership interest of any owner of the currently authorized place(s) of use identified in this application be adversely affected if this application is approved as requested?
 Yes No (If yes, all owners must sign this application.)
 - (c) If this application is not approved expeditiously, will there be substantial damage to property, public health or safety?
 Yes No (If no, all owners must sign this application.)

If the application proposes a surface water change in point of diversion, a groundwater change in point of diversion greater than 300 feet, or a change in place of use, the application must be signed by all owners of the currently authorized place of use, or their duly authorized agent (attach notarized statement authorizing representation).

I hereby verify, being first duly sworn upon my oath or affirmation and under penalty of perjury, that I am of lawful age and the owner, the spouse of the owner, or a duly authorized agent of the owner(s) to make this application on their behalf, in regards to the water right(s) to which this application pertains. I further verify that the statements contained in this application are true, correct and complete.

Dated at Garden City, Kansas, this 20th day of August, 2021.

[Signature]
 (Owner)

[Signature]
 (Spouse)

Gregory L. Love
 (Please Print)

Susan M. Love
 (Please Print)

(Owner)

(Spouse)

(Please Print)

(Please Print)

(Owner)

(Spouse)

(Please Print)

(Please Print)

State of Kansas }
 County of Finney } SS



I hereby certify that the foregoing application was signed in my presence and sworn to before me this 20th day of August, 2021.

[Signature]
 Notary Public

My Commission Expires 11/19/23.

ONLY COMPLETE APPLICATIONS WILL BE PROCESSED. To be complete, all of the applicable portions of the application form must be completed with accurate information; maps, if necessary, must be included; signatures of all the appropriate owners' must be affixed to the application and notarized; and the appropriate fee must be paid.

FEE SCHEDULE

- Each application to change the place of use or the point of diversion under this section shall be accompanied by the application fee set forth in the schedule below: Make checks payable to: **Kansas Department of Agriculture**
- (1) Application to change a point of diversion 300 feet or less \$100
 - (2) Application to change a point of diversion more than 300 feet \$200
 - (3) Application to change the place of use \$200

SUMMARY ORDER APPROVING APPLICATION FOR CHANGE AND IMPOSING CONDITIONS

This Summary Order is issued under authority of K.S.A. 82a-708b, as amended, and K.A.R. 5-5-1, *et seq.* and other applicable provisions of the *Kansas Water Appropriation Law, K.S.A. 82a-701 et. seq.*, and rules and regulations promulgated thereunder, With the exception of those conditions expressly contained herein, this Summary Order does not change the terms, conditions and limitations of File No. 14101.

1. A change application was received on August 24, 2021 requesting that the place of use and / or point of diversion authorized under the above-referenced file number be changed as described in the application.
2. On and after the effective date of this summary order, the authorized place(s) of use shall be located substantially as shown on the topographic map accompanying the application to change the place of use. Applicable Not Applicable
3. The change in point of diversion shall not impair existing rights and shall be limited to the same source or sources of water as previously authorized. The point of diversion authorized by this summary order shall be located within a foot radius of the authorized point(s) of diversion. Applicable Not Applicable
4. The point(s) of diversion described herein is administratively corrected to be more accurately described using the Global Positioning System (GPS), as described in the application. Applicable Not Applicable
5. The point(s) of diversion authorized herein shall not actually be located more than feet from the previously authorized point(s) of diversion. Applicable Not Applicable
6. As required by K.A.R. 5-3-5d, if the works for diversion is a well with a diversion rate of 100 gallons per minute or more, a tube or other device suitable for making water level measurements shall be installed, operated and maintained in accordance with K.A.R. 5-6-13. Applicable Not Applicable
7. **The owner of the authorized place(s) of use shall properly install an acceptable water flow meter on or before December 31, 2021**, or before the first use of water, whichever occurs first. The water flow meter shall be installed, operated and maintained in accordance with K.A.R. 5-1-4 through 5-1-12. As required by K.S.A. 82a-732, as amended, and K.A.R. 5-3-5e, the owner shall maintain records and report the reading of the water flow meter and the total quantity of water diverted annually to the Chief Engineer by March 1 following the end of each calendar year. Applicable Not Applicable
8. **Installation of the works for diversion of water shall be completed on or before December 31, 2021**, or within any authorized extension of time. By March 1, 2021 the applicant shall notify the Chief Engineer that construction of the works for diversion has been completed, on the form provided by the Chief Engineer, as required by K.A.R. 5-8-4e. Applicable Not Applicable
9. **The completed well log shall be submitted with the required notice.** Applicable Not Applicable
10. All diversion works into which any type of chemical or other foreign substance will be injected into the water shall be equipped with an in-line, automatic, quick-closing check valve capable of preventing pollution of the source of the water supply. The check valve(s) shall be installed, operated and maintained in accordance with K.A.R. 5-3-5c. Applicable Not Applicable
11. Additional Conditions are attached. Yes No
12. In accordance with K.S.A. 82a-708a, as amended, and K.A.R. 5-5-14, all of the owners of the authorized place(s) of use of water appropriated under the above-referenced file number are responsible for compliance with its terms, conditions and limitations, as amended and/or supplemented by this Summary Order, and with applicable provisions of the *Kansas Water Appropriation Law* and the *Rules and Regulations* promulgated thereunder. Failure to comply with these provisions may result in civil penalties pursuant to K.S.A. 82a-737, as amended, and/or the suspension or revocation and dismissal of the water or appropriation right or any other enforcement actions authorized by law.

Administrative Appeal and Effective Date of Order

If you are aggrieved by this order, pursuant to K.S.A. 82a-1901, you may request an evidentiary hearing before the Chief Engineer or request administrative review by the Secretary of Agriculture. A request for hearing by the Chief Engineer must be filed within **15 days** of service of this Order and a request for administrative review by the Secretary must be filed within **30 days** pursuant to K.S.A. 77-531. Any request for administrative review must state a basis for review pursuant to K.S.A. 77-527. File any request with **Kansas Department of Agriculture, Legal Division, 1320 Research Park Drive, Manhattan, KS 66502**. Failure to timely request a hearing or review may preclude review under the Kansas Judicial Review Act.

For Use by Register of Deeds

FOR OFFICE USE ONLY
APPLICATION APPROVED AND SUMMARY ORDER ISSUED

By: Michael A. Meyer
Duly Authorized Designee of the Chief Engineer
(Print Name): MICHAEL A. MEYER
Division of Water Resources - Kansas Department of Agriculture
Date of Issuance: September 1, 2021
State of Kansas)
County of Finney) SS
Acknowledged before me on September 1, 2021
by Michael A. Meyer
Signature: Julie Jones
Notary Public

My commission expires: _____
Notary Seal: JULIE JONES, My Appointment Expires December 15, 2022

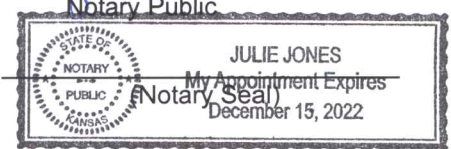

Change App. PU, File No. 14101

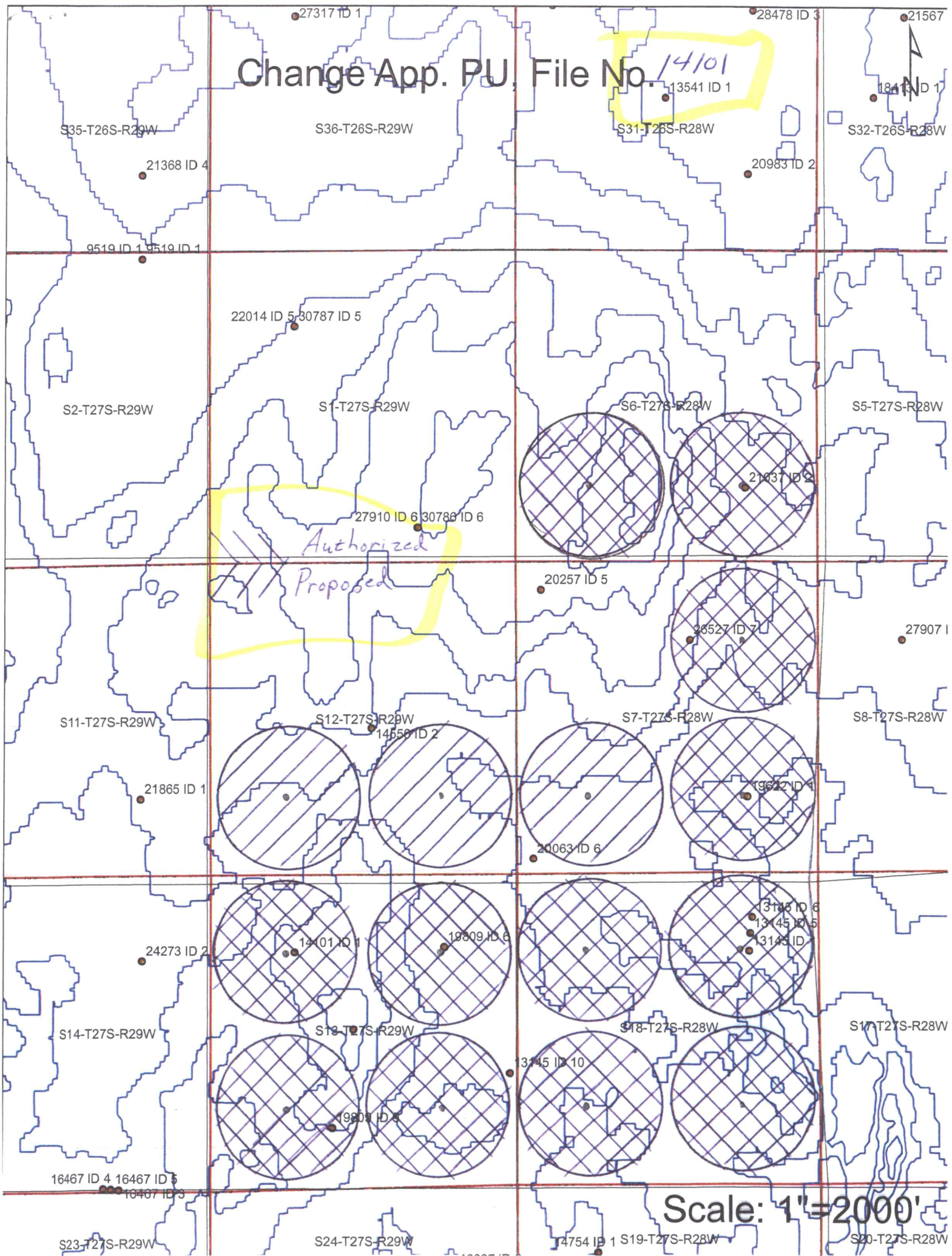

Scale: 1"=2000'

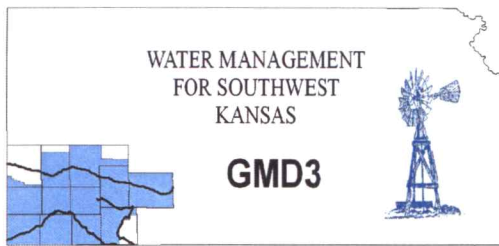

Southwest Kansas
Groundwater Management District No. 3
2009 E. Spruce Street
Garden City, Kansas 67846
(620) 275-7147 phone (620) 275-1431 fax
www.gmd3.org

August 16, 2021

Michael A. Meyer
Division of Water Resources
4532 W Jones Ave., Suite B
Garden City, Kansas 67846

RE: Applications for Change in Place of Use
Water Right, File Nos. 13145, 14101, 14550, 19622, 19809, 20063, 21037, 21455 &
26527

Dear Mike:

We have assisted with the applications for the above referenced water rights. The proposals are not in conflict with the Management Program of the Southwest Kansas Groundwater Management District No. 3 (GMD3). The proposed change in place of use will make a complete overlap in place of use and is in accordance with K.A.R. 5-5-11(b). No new acres are being proposed. It is therefore recommended that the applications be approved at this time.

Thank you for the opportunity to review the applications and to provide a recommendation. If you have any questions, please don't hesitate to contact us.

Sincerely,

A handwritten signature in blue ink, which appears to read "Jason L. Norquest". The signature is fluid and cursive, written over the printed name and title.

Jason L. Norquest
Assistant Manager

RECEIVED

AUG 24 2021

Garden City Field Office
Division of Water Resources