

Kansas Department of Agriculture  
Division of Water Resources  
**CHANGE: P/U WORKSHEET**

1. File Number: <b>17667</b>	2. Status Change Date: <i>9-22-2021</i>	3. Change Num: <b>C4</b>	4. Field Office: <b>04</b>	5. GMD: <b>03</b>
6. Status: <input checked="" type="checkbox"/> Approved <input type="checkbox"/> Denied by DWR/GMD <input type="checkbox"/> Dismiss by Request/Failure to Return				7. Filing Date of Change: <b>9/7/2021</b>
8a. Landowner, applicant, correspondent Person ID <b>66467</b> New to system <input type="checkbox"/> Add Seq# _____  <b>PRAIRIE SKY FARMS LLC ATTN: DALE ZORTMAN 5088 23 ROAD FOWLER, KS 67844</b>		8c. Landowner Person ID _____ New to system <input type="checkbox"/> Add Seq# _____		
8b. Landowner(s), Person ID _____ New to system <input type="checkbox"/> Add Seq# _____		8d. correspondent Person ID _____ New to system <input type="checkbox"/> Add Seq# _____		
8e. Landowner(s), Person ID _____ New to system <input type="checkbox"/> Add Seq# _____				
9. Documents and Enclosure(s): <input checked="" type="checkbox"/> DWR Meter(s) Date to Comply: <b>12/31/2021</b> <input checked="" type="checkbox"/> N & P Date to Comply: <b>3/1/2022</b> <input type="checkbox"/> Anti-Reverse Meter <input type="checkbox"/> Meter Seal <input checked="" type="checkbox"/> Check Valve <input type="checkbox"/> N & P Form <input type="checkbox"/> Water Tube <input type="checkbox"/> Driller Copy <input type="checkbox"/> H & E Letter <input type="checkbox"/> Conservation Plan    Date Required: _____    Date Approved: _____    Date to Comply: _____				
10. Use Made of Water    From: _____    To: _____				
Date Prepared: <b>9/13/2021</b> By: <b>MAM</b> Date Entered: _____    By: _____				

File No. <b>17667</b>	11. County: <b>ME</b>	Basin: <b>CROOKED CREEK</b>	Stream:	Formation Code:	Special Use:																
12. Points of Diversion			Rate and Quantity																		
CHK MOD DEL ENT	PDIV	Qualifier	S	T	R	ID	'N	'W	Comment (AKA Line)	Authorized	Additional										
										Rate gpm	Quantity af	Rate gpm	Quantity af	Overlap PD Files							
<b>CHK 70593</b>																					
13. Storage: Rate _____ NF    Quantity _____ ac/ft    Additional Rate _____ NF    Additional Quantity _____ ac/ft																					
14. Limitation: _____ af/yr at _____ gpm ( _____ cfs) when combined with file number(s) _____																					
Limitation: _____ af/yr at _____ gpm ( _____ cfs) when combined with file number(s) _____																					
15. 5YR Allocation:    Allocation Type _____    Start Year _____    5 YR Amount _____    Amount Unit _____    Base Acres _____    Comment _____																					
16. Place of Use		NE¼				NW¼				SW¼				SE¼				Total	Owner	Chg?	Overlap Files
CHK MOD DEL ENT	PUSE	S	T	R	ID	NE ¼	NW ¼	SW ¼	SE ¼	NE ¼	NW ¼	SW ¼	SE ¼	NE ¼	NW ¼	SW ¼	SE ¼				
<b>MOD 31992</b>	<b>21</b>	<b>31</b>	<b>27W</b>	<b>01</b>		30.5	30.5			30.5	30.5	30.5	30.					183	<b>8a</b>	<b>yes</b>	<b>42278, 43404</b>
<b>MOD 51886</b>	<b>16</b>	<b>31</b>	<b>27W</b>	<b>01</b>						30.5	30.5	30.5	30.5			30.5	30.5	183	<b>8a</b>	<b>No</b>	<b>42278, 43404</b>
<b>DEL 59539</b>																					
Base Acres: <b>160</b> Year:    Minimum Reasonable Quantity:																					
Comments:																					

Garden City Field Office  
4532 W. Jones, Suite B  
Garden City, KS 67846



Phone: 620-276-2901  
Fax: 620-276-9315  
[www.agriculture.ks.gov](http://www.agriculture.ks.gov)

Mike Beam, Secretary

Laura Kelly, Governor

September 22, 2021

PRAIRIE SKY FARMS LLC  
Attn: DALE ZORTMAN  
5088 23 ROAD  
FOWLER, KS 67844

RE: Field Office Application for Change  
Water Right, File Nos. 17667, 42278, 43404

Dear Sir:

Enclosed are orders executed by the designee of the Chief Engineer, Division of Water Resources, Kansas Department of Agriculture, approving the applications for change under the above referenced file numbers.

Your attention is directed to the enclosures and to the terms, conditions, and limitations specified in these approvals for change. Conditions of these approvals are that an acceptable water flow meter must be installed on the diversion works authorized under the referenced file numbers and meet current specifications. Please return the required notification of completion of the diversion works and/or installation of the required meter as soon as these actions are completed.

Since the orders modify the original documents referred to above, they should be recorded with the Register of Deeds as other instruments affecting real estate.

Should you have any questions, please feel free contact this office. If you would prefer, you could arrange an appointment for additional assistance.

Sincerely,

A blue ink signature of Michael A. Meyer, written in a cursive style.

Michael A. Meyer  
Water Commissioner

MAM  
enclosures

pc: GROUNDWATER MANAGEMENT DISTRICT NO. 3

**CERTIFICATE OF SERVICE**

On this day of September 22, 2021, I hereby certify that the foregoing Approvals of Application for Change in Place of Use, Water Right, File Nos. 17667, 42278, and 43404 dated day of September 22, 2021 was mailed postage prepaid, first class, US mail to the following:

PRAIRIE SKY FARMS LLC  
Attn: DALE ZORTMAN  
5088 23 ROAD  
FOWLER, KS 67844

Pc:

GROUNDWATER MANAGEMENT DISTRICT NO. 3

  
\_\_\_\_\_  
Division of Water Resources Staff

Submit completed application to:  
 Kansas Department of Agriculture  
 Division of Water Resources  
 Field Office for your area.  
 Call for address:

Topeka -- (785) 296-5733  
 Stafford -- (620) 234-5311  
 Stockton -- (785) 425-6787  
 Garden City -- (620) 276-2901  
<http://agriculture.ks.gov/dwr>

## DWR FIELD OFFICE APPLICATION FOR APPROVAL TO CHANGE THE PLACE OF USE AND/OR THE POINT OF DIVERSION



**STATE OF KANSAS**

**Filing Fee Must Accompany the Application, K.S.A. 82a-708b(b), as amended.**  
 Fee Schedule is on the third page of this application form.

**Paragraph Nos. 1, 2, 3 & 5 must be completed. Complete all other applicable portions.** If change in point of diversion is greater than 100 feet, or if place of use will be changed, include a topographic map or detailed plat showing the authorized and proposed point(s) of diversion and/or place of use.

File No. 17667

RECEIVED

SEP 07 2021

10:41AM

Garden City Field Office  
 Division of Water Resources

1. Application is hereby made for approval of the Chief Engineer to change the (check one or both):

Place of Use       Point of Diversion

under the water right which is the subject of this application in accordance with the conditions described below.

The source of supply is:       Groundwater       Surface water

2. Name and address of Applicant: Prairie Sky Farms LLC %Dale Zortman

5088 23 Road, Fowler, KS 67844

Phone Number: (620)338-1282      Email address: dalezort@gmail.com

Name and address of Water Use Correspondent: SAME

Phone Number: (      )      Email address:      \_\_\_\_\_

3. The presently authorized place of use is:

Owner of Land ---- NAME: Prairie Sky Farms LLC %Dale Zortman

ADDRESS: 5088 23 Road, Fowler, KS 67844

(If there is more than one landowner, attach supplemental sheets as necessary.)

Sec.	Twp.	Range	NE¼				NW¼				SW¼				SE¼				TOTAL ACRES
			NE¼	NW¼	SW¼	SE¼	NE¼	NW¼	SW¼	SE¼	NE¼	NW¼	SW¼	SE¼	NE¼	NW¼	SW¼	SE¼	
16	31s	27w									40.0	40.0	40.0	40.0			40.0	40.0	240.0
21	31s	27w					40.0	40.0	40.0	40.0	10.0	38.0	5.0						213.0

4. If this application is for a change in place of use, it is proposed that the place of use be changed to:

Owner of Land ---- NAME: Prairie Sky Farms LLC %Dale Zortman

ADDRESS: 5088 23 Road, Fowler, KS 67844

(If there is more than one landowner, attach supplemental sheets as necessary.)

Sec.	Twp.	Range	NE¼				NW¼				SW¼				SE¼				TOTAL ACRES
			NE¼	NW¼	SW¼	SE¼	NE¼	NW¼	SW¼	SE¼	NE¼	NW¼	SW¼	SE¼	NE¼	NW¼	SW¼	SE¼	
16	31s	27w									30.5	30.5	30.5	30.5			30.5	30.5	183.0
21	31s	27w	30.5	30.5			30.5	30.5	30.5	30.5									183.0

**For Office Use Only:** Code \_\_\_\_\_ Fee \$ 200 TR # \_\_\_\_\_ Receipt Date 9-7-2021 Check # 2005



5. **Presently authorized point of diversion:**

One in the      NW      Quarter of the      NW      Quarter of the      NW      Quarter of Section      21     , Township      31      South, Range      27      W, in Meade County, Kansas, 5040 feet North 5030 feet West of Southeast corner of section. Authorized Rate 1225gpm Authorized Quantity 320AF Depth of well      (feet)

(DWR use only: Computer ID No. 03 GPS      feet North      feet West)

This point will not be changed  This point will be changed as follows:  No change, point better described with GPS as follows:

**Proposed point of diversion: (Complete only if change is requested or if existing point is better described by GPS)**

One in the      Quarter of the      Quarter of the      Quarter of Section     , Township      South, Range      (E/W), in      County, Kansas,      feet North      feet West of Southeast corner of section. Proposed Rate      Proposed Quantity      Proposed well depth (feet)     . This point is:  Additional Well  Geo Center List other water rights that will use this point     .

6. **Presently authorized point of diversion:**

One in the      Quarter of the      Quarter of the      Quarter of Section     , Township      South, Range      (E/W), in      County, Kansas,      feet North      feet West of Southeast corner of section. Authorized Rate      Authorized Quantity      Depth of well      (feet)

(DWR use only: Computer ID No.      GPS      feet North      feet West)

This point will not be changed  This point will be changed as follows:  No change, point better described with GPS as follows:

**Proposed point of diversion: (Complete only if change is requested or if existing point is better described by GPS)**

One in the      Quarter of the      Quarter of the      Quarter of Section     , Township      South, Range      (E/W), in      County, Kansas,      feet North      feet West of Southeast corner of section. Proposed Rate      Proposed Quantity      Proposed well depth (feet)     . This point is:  Additional Well  Geo Center List other water rights that will use this point     .

7. The changes herein are desired for the following reasons?

(please be specific) Rearrange acres for the operation

8. If a well, is the test hole log attached?  Yes  No

9. The change(s) (was)(will be) completed by?

As soon as approved

10. If the point of diversion is a well:

(a) What are you going to do with the old well?

NA

(b) When will this be done?     

11. Groundwater Management District recommendation attached?

X  Yes  No

12. Assisted by GMD3/JLN

13a. If the proposed point of diversion will be relocated more than 300 feet but within 2,640 feet of the existing point of diversion, attach a topographic map or aerial photograph. For groundwater sources, show all wells (including domestic) within one-half mile of the proposed point of diversion and the names and mailing addresses of the owners. For surface water sources, show the names and addresses of the landowner(s) one-half mile downstream and one-half mile upstream from your property lines

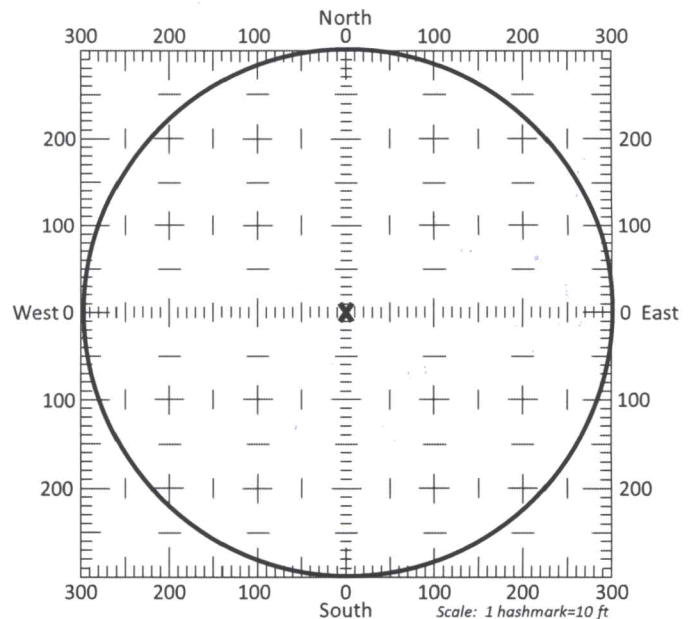

13b. If the proposed point of diversion will be relocated within a 300 foot radius of the existing point of diversion, indicate its location on the diagram shown above in relation to the existing point of diversion. The proposed point of diversion must be located within the circle shown above. (PLEASE NOTE: The "X" in center of diagram above represents the presently authorized point of diversion.)

14. If the proposed groundwater point of diversion is 300 or fewer feet from the existing point of diversion, complete the following:
- (a) Does the undersigned represent all owners of the currently authorized place(s) of use identified in this application?  
 Yes     No    (If no, all owners must sign this application.)
  - (b) Will the ownership interest of any owner of the currently authorized place(s) of use identified in this application be adversely affected if this application is approved as requested?  
 Yes     No    (If yes, all owners must sign this application.)
  - (c) If this application is not approved expeditiously, will there be substantial damage to property, public health or safety?  
 Yes     No    (If no, all owners must sign this application.)

If the application proposes a surface water change in point of diversion, a groundwater change in point of diversion greater than 300 feet, or a change in place of use, the application must be signed by all owners of the currently authorized place of use, or their duly authorized agent (attach notarized statement authorizing representation).

I hereby verify, being first duly sworn upon my oath or affirmation and under penalty of perjury, that I am of lawful age and the owner, the spouse of the owner, or a duly authorized agent of the owner(s) to make this application on their behalf, in regards to the water right(s) to which this application pertains. I further verify that the statements contained in this application are true, correct and complete.

Dated at GMD3 Office, Kansas, this 25<sup>th</sup> day of August, 2021.

<u>Dale Zortman</u> (Owner)	(Spouse)
<u>Dale Zortman</u> (Please Print)	(Please Print)
(Owner)	(Spouse)
(Please Print)	(Please Print)
(Owner)	(Spouse)
(Please Print)	(Please Print)

State of Kansas }  
 County of Finney } SS

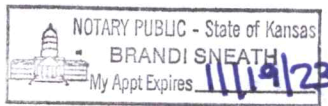

I hereby certify that the foregoing application was signed in my presence and sworn to before me this 25th day of August, 2021.

Brandi Sneath  
Notary Public

My Commission Expires 11/19/23.

**ONLY COMPLETE APPLICATIONS WILL BE PROCESSED.** To be complete, all of the applicable portions of the application form must be completed with accurate information; maps, if necessary, must be included; signatures of all the appropriate owners' must be affixed to the application and notarized; and the appropriate fee must be paid.

**FEE SCHEDULE**

Each application to change the place of use or the point of diversion under this section shall be accompanied by the application fee set forth in the schedule below: Make checks payable to: **Kansas Department of Agriculture**

(1) Application to change a point of diversion 300 feet or less .....	\$100
(2) Application to change a point of diversion more than 300 feet .....	\$200
(3) Application to change the place of use .....	\$200

RECEIVED  
SEP 07 2021



**SUMMARY ORDER APPROVING APPLICATION FOR CHANGE AND IMPOSING CONDITIONS**

This Summary Order is issued under authority of K.S.A. 82a-708b, as amended, and K.A.R. 5-5-1, *et seq.* and other applicable provisions of the *Kansas Water Appropriation Law, K.S.A. 82a-701 et seq.*, and rules and regulations promulgated thereunder, With the exception of those conditions expressly contained herein, this Summary Order does not change the terms, conditions and limitations of File No. 17667.

1. A change application was received on September 7, 2021 requesting that the place of use and / or point of diversion authorized under the above-referenced file number be changed as described in the application.
2. On and after the effective date of this summary order, the authorized place(s) of use shall be located substantially as shown on the topographic map accompanying the application to change the place of use.  Applicable  Not Applicable
3. The change in point of diversion shall not impair existing rights and shall be limited to the same source or sources of water as previously authorized. The point of diversion authorized by this summary order shall be located within a \_\_\_\_\_ foot radius of the authorized point(s) of diversion.  Applicable  Not Applicable
4. The point(s) of diversion described herein is administratively corrected to be more accurately described using the Global Positioning System (GPS), as described in the application.  Applicable  Not Applicable
5. The point(s) of diversion authorized herein shall not actually be located more than \_\_\_\_\_ feet from the previously authorized point(s) of diversion.  Applicable  Not Applicable
6. As required by K.A.R. 5-3-5d, if the works for diversion is a well with a diversion rate of 100 gallons per minute or more, a tube or other device suitable for making water level measurements shall be installed, operated and maintained in accordance with K.A.R. 5-6-13.  Applicable  Not Applicable
7. **The owner of the authorized place(s) of use shall properly install an acceptable water flow meter on or before December 31, 2031**, or before the first use of water, whichever occurs first. The water flow meter shall be installed, operated and maintained in accordance with K.A.R. 5-1-4 through 5-1-12. As required by K.S.A. 82a-732, as amended, and K.A.R. 5-3-5e, the owner shall maintain records and report the reading of the water flow meter and the total quantity of water diverted annually to the Chief Engineer by March 1 following the end of each calendar year.  Applicable  Not Applicable
8. **Installation of the works for diversion of water shall be completed on or before December 31, 2031**, or within any authorized extension of time. By March 1, 2031 the applicant shall notify the Chief Engineer that construction of the works for diversion has been completed, on the form provided by the Chief Engineer, as required by K.A.R. 5-8-4e.  Applicable  Not Applicable
9. **The completed well log shall be submitted with the required notice.**  Applicable  Not Applicable
10. All diversion works into which any type of chemical or other foreign substance will be injected into the water shall be equipped with an in-line, automatic, quick-closing check valve capable of preventing pollution of the source of the water supply. The check valve(s) shall be installed, operated and maintained in accordance with K.A.R. 5-3-5c.  Applicable  Not Applicable
11. Additional Conditions are attached.  Yes  No
12. In accordance with K.S.A. 82a-708a, as amended, and K.A.R. 5-5-14, all of the owners of the authorized place(s) of use of water appropriated under the above-referenced file number are responsible for compliance with its terms, conditions and limitations, as amended and/or supplemented by this Summary Order, and with applicable provisions of the *Kansas Water Appropriation Law* and the *Rules and Regulations* promulgated thereunder. Failure to comply with these provisions may result in civil penalties pursuant to K.S.A. 82a-737, as amended, and/or the suspension or revocation and dismissal of the water or appropriation right or any other enforcement actions authorized by law.

**Administrative Appeal and Effective Date of Order**

If you are aggrieved by this order, pursuant to K.S.A. 82a-1901, you may request an evidentiary hearing before the Chief Engineer or request administrative review by the Secretary of Agriculture. A request for hearing by the Chief Engineer must be filed within **15 days** of service of this Order and a request for administrative review by the Secretary must be filed within **30 days** pursuant to K.S.A. 77-531. Any request for administrative review must state a basis for review pursuant to K.S.A. 77-527. File any request with **Kansas Department of Agriculture, Legal Division, 1320 Research Park Drive, Manhattan, KS 66502**. Failure to timely request a hearing or review may preclude review under the Kansas Judicial Review Act.

*For Use by Register of Deeds*

FOR OFFICE USE ONLY  
**APPLICATION APPROVED AND SUMMARY ORDER ISSUED**

By: Michael A. Meyer  
Duly Authorized Designee of the Chief Engineer  
(Print Name): MICHAEL A. MEYER  
Division of Water Resources - Kansas Department of Agriculture

Date of Issuance: September 22, 2021  
State of Kansas )  
County of Stinson ) SS

Acknowledged before me on September 22, 2021  
by Michael A. Meyer

Signature: Julie Jones  
Notary Public

My commission expires: \_\_\_\_\_  
(Notary Seal) \_\_\_\_\_

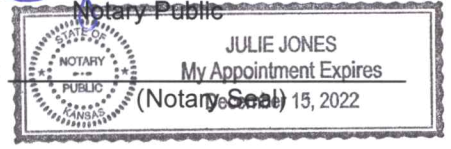



# Change App. PU, File No. 17667, 42278, 43404

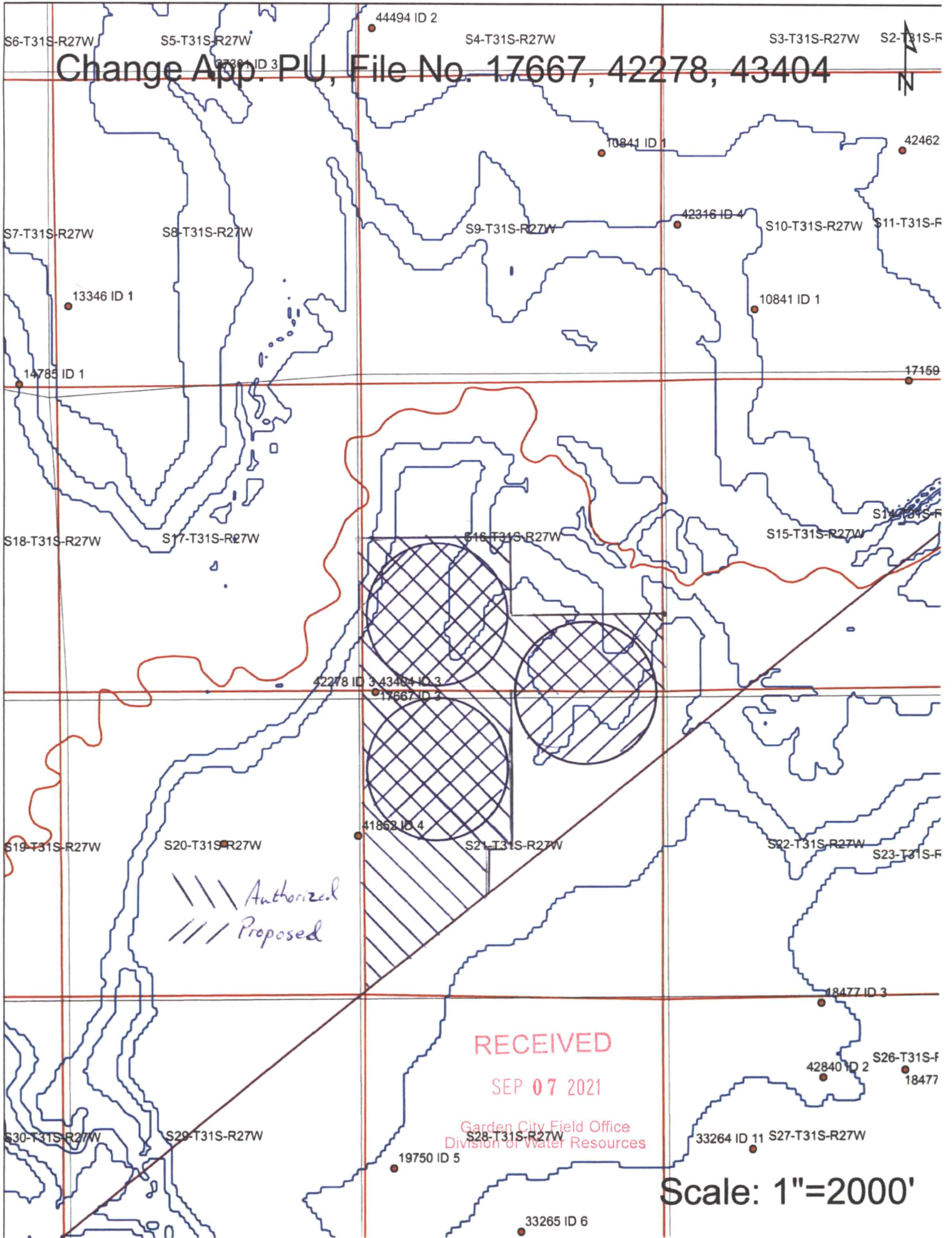

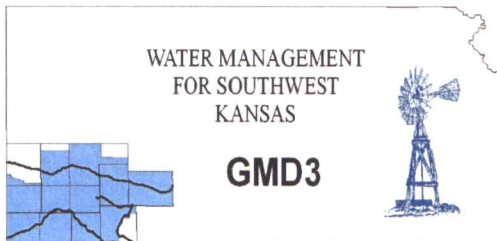

**Southwest Kansas**  
**Groundwater Management District No. 3**  
**2009 E. Spruce Street**  
**Garden City, Kansas 67846**  
(620) 275-7147 phone (620) 275-1431 fax  
www.gmd3.org

August 27, 2020

Michael A. Meyer  
Division of Water Resources  
4532 W Jones Ave., Suite B  
Garden City, Kansas 67846

RE: Applications for Change in Place of Use  
Water Rights, File Nos. 17667, 43404 & 42278

Dear Mike:

We have assisted with the applications for the above referenced water rights. The proposal is not in conflict with the Management Program of the Southwest Kansas Groundwater Management District No. 3 (GMD3). The proposed change in place of use will rearrange the acres to better suit the operation and is in accordance with K.A.R. 5-5-11(b). It is therefore recommended that the applications be approved at this time.

Thank you for the opportunity to review the applications and to provide a recommendation. If you have any questions, please don't hesitate to contact us.

Sincerely,

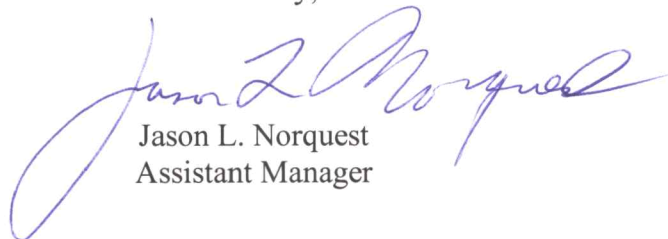

Jason L. Norquest  
Assistant Manager

**RECEIVED**

**SEP 07 2021**

Garden City Field Office  
Division of Water Resources

Entered in Transfer Record  
in my office this 2 day  
of FEBRUARY 2009

Janet Hale  
County Clerk 225



STATE OF KANSAS, Meade County  
This instrument was filed for record on the  
2 day of February, A.D. 2009,  
at 9:45 A. M. and duly recorded  
in Book 89, on Page(s) 307-309  
Alida Haver  
Register of Deeds \$16<sup>00</sup>

4 Please return  
recorded Warranty Deed to:

Todd Davidson  
Hampton & Royce, L.C.  
P.O. Box 1247  
Salina, Kansas 67402-1247

X acv

Photocopied

WARRANTY DEED

**Dale Zortman**, also known as Dale O. Zortman, also known as Dale Owen Zortman and **Jeanette Zortman**, also known as Jeanette L. Zortman, also known as Jeanette Louise Zortman, husband and wife, CONTRIBUTE, CONVEY AND WARRANT to **Prairie Sky Farms, LLC**, a Kansas limited liability company (*mailing address for tax purposes: 310 E. 7th, Fowler, Kansas 67844*), all of the following described real estate, to-wit:

An undivided one-half (1/2) interest in and to the Northwest Quarter (NW/4) of Section Three (3), Township Thirty (30) South, Range Twenty-seven (27) West of the Sixth P.M., Meade County, Kansas;

An undivided one-half (1/2) interest in and to the Northeast Quarter (NE/4) of Section Eight (8), Township Thirty (30) South, Range Twenty-seven (27) West of the Sixth P.M., Meade County, Kansas;

The West Half of the Northwest Quarter (W/2 NW/4) of Section Nine (9), Township Thirty (30) South, Range Twenty-seven (27) West of the 6th P.M., Meade County, Kansas;

The Northeast Quarter (NE/4) and the East Half of the Northwest Quarter (E/2 NW/4) of Section Nine (9), Township Thirty (30) South, Range Twenty-seven (27) West of the Sixth P.M., Meade County, Kansas;

An undivided one-half (1/2) interest in and to the Southeast Quarter (SE/4) of Section Fifteen (15), Township Thirty (30) South, Range Twenty-seven (27) West of the 6th P.M., Meade County, Kansas;

RECEIVED

SEP 21 2021

Garden City Field Office  
Division of Water Resources

021520



The Southeast Quarter (SE/4) of Section Twenty-two (22), Township Thirty (30) South, Range Twenty-seven (27) West of the 6th P.M., Meade County, Kansas, EXCEPT a tract of land located in said Southeast Quarter (SE/4) of Section Twenty-two (22) described as follows:

Beginning at the Northeast corner of the Southeast Quarter (SE/4) of said Section Twenty-two (22); thence South 00°00'00" East (assumed bearing), along the East line of said Southeast Quarter, 1,173.00 feet, thence North 90°00'00" West 50.67 feet; thence on a curve to the left with a radius of 1,300.00 feet, a central angle of 78°09'22", an arc distance of 1,773.31 feet; a chord length of 1,638.98 feet and a chord bearing of N44°13'21" West, to a point on the North line of said Southeast Quarter; thence South 89°55'33" East, along the North line of said Southeast Quarter, 1,193.77 feet to the point of beginning, said excepted tract containing 9.28 acres, more or less, including 0.81 acres of County Road Right-of-Way, subject to a ten year term interest beginning August 4, 2005, reserved unto Prairie Farms, a Kansas general partnership, by a Corporation General Warranty Deed dated August 4, 2005;

The Southwest Quarter (SW/4) of Section Twenty-three (23), Township Thirty (30) South, Range Twenty-seven (27) West of the 6th P.M., Meade County, Kansas;

An undivided two-fifths (2/5) interest in and to the Northwest Quarter (NW/4) of Section Twenty-six (26), Township Thirty (30) South, Range Twenty-seven (27) West of the 6th P.M., Meade County, Kansas;

The South Half of the Southeast Quarter (S/2 SE/4) of Section Sixteen (16), Township Thirty-one (31) South, Range Twenty-seven (27) West of the 6th P.M., Meade County, Kansas, subject to a fifteen (15) year term interest reserved unto Prairie Farms, a Kansas general partnership, by General Warranty Deed dated October 6, 1998;

The Southwest Quarter (SW/4) of Section Sixteen (16), Township Thirty-one (31) South, Range Twenty-seven (27) West of the 6th P.M., Meade County, Kansas, subject to a fifteen (15) year term interest reserved unto Prairie Farms, a Kansas general partnership, by General Warranty Deed and Trustee's Deed, each dated July 24, 1998;

The Northwest Quarter (NW/4) of Section Twenty-one (21), Township Thirty-one (31) South, Range Twenty-seven (27) West of the Sixth P.M., Meade County, Kansas;

The Southwest Quarter (SW/4) of Section Twenty-one (21), Township Thirty-one (31) South, Range Twenty-seven (27) West of the 6th P.M., Meade County, Kansas;

[No Kansas Real Estate Sales Validation Questionnaire required, K.S.A. 79-1437e(a)(4).]

for the sum of One Dollar (\$1.00) and other valuable consideration, together with all its appurtenances and warrants the title to the same, subject to all mortgages, prior mineral reservations, oil and gas leases, rights-of-way, easements and protective covenants of record, if any.

DATED this 5<sup>th</sup> day of October, 2008.

Dale Zortman  
Dale Zortman

Jeanette Zortman  
Jeanette Zortman

State of Kansas     )  
                                  ) ss  
County of Finney    )

The foregoing instrument was acknowledged before me this 5<sup>th</sup> day of October, 2008, by Dale Zortman, also known as Dale O. Zortman, also known as Dale Owen Zortman, and by Jeanette Zortman, also known as Jeanette L. Zortman, also known as Jeanette Louise Zortman.

Patty A. Wheet  
Notary Public

My Appointment Expires:

06-11-2011



RECEIVED  
SEP 21 2021  
Garden City Field Office  
Division of Water Resources