

Kansas Department of Agriculture
 Division of Water Resources
CHANGE: P/D WORKSHEET

1. File Number: 18014	2. Status Change Date:	3. Change Num: C1	4. Field Office: 04	5. GMD: 03
6. Status: <input checked="" type="checkbox"/> Approved <input type="checkbox"/> Denied by DWR/GMD <input type="checkbox"/> Dismiss by Request/Failure to Return				7. Filing Date of Change: 1/7/21
8a. Applicant(s) New to system <input type="checkbox"/>		Person ID 17072 Add Seq# _____		8c. Landowner(s) New to system <input type="checkbox"/>
CLINTON L & DELAINE S STALKER 651 ROAD 220 SATANTA, KS 67870-9427		ELS PROPERTIES LLC PO BOX 605 SATANTA KS, KS 67870-0605		*UPDATE ADDRESS*
8b. Landowner(s) New to system <input type="checkbox"/>		Person ID _____ Add Seq# _____		8d. WUC New to system <input type="checkbox"/>
8a		8a		8a
9. Documents and Enclosure(s): <input checked="" type="checkbox"/> DWR Meter(s) Date to Comply: 12/31/21 <input checked="" type="checkbox"/> N & P Date to Comply: 3/1/22				
<input type="checkbox"/> Anti-Reverse Meter <input type="checkbox"/> Meter Seal <input checked="" type="checkbox"/> Check Valve <input checked="" type="checkbox"/> N & P Form <input checked="" type="checkbox"/> Water Tube <input checked="" type="checkbox"/> Driller Copy <input checked="" type="checkbox"/> H & E Letter				
<input type="checkbox"/> Conservation Plan Date Required: _____ Date Approved: _____ Date to Comply: _____				
10. Use Made of Water From: _____ To: _____				
Date Prepared: 2/12/21 By: AM Date Entered: _____ By: _____				

File No. **18014** 11. County: **HS** Basin: **CIMARRON RIVER** Stream: Formation Code: **211** Special Use:

12. Points of Diversion
 CHK
 MOD
 DEL PDIV
 ENT Qualifier S T R ID 'N 'W Comment (AKA Line) Rate gpm Quantity af Additional Rate gpm Quantity af Overlap PD Files

DEL 16042
ENT SE NE NE 23 30S 34W 4309 10 1570 320 1570 320 NONE

13. Storage: Rate _____ NF Quantity _____ ac/ft Additional Rate _____ NF Additional Quantity _____ ac/ft

14. Limitation: _____ af/yr at _____ gpm (_____ cfs) when combined with file number(s) _____
 Limitation: _____ af/yr at _____ gpm (_____ cfs) when combined with file number(s) _____

15. 5YR Allocation: Allocation Type _____ Start Year _____ 5 YR Amount _____ Amount Unit _____ Base Acres _____ Comment _____

16. Place of Use CHK MOD DEL ENT	PUSE	S	T	R	ID	NE¼				NW¼				SW¼				SE¼				Total	Owner	Chg?	Overlap Files
						NE ¼	NW ¼	SW ¼	SE ¼	NE ¼	NW ¼	SW ¼	SE ¼	NE ¼	NW ¼	SW ¼	SE ¼	NE ¼	NW ¼	SW ¼	SE ¼				
CHK 8459	24	30S	34W	1					40	40	40	40									160	8a	Y	3273; 9779; 24572	
CHK 14989	23	30S	34W	1		40	40	40	40					40	40	40	40	40	40	40	480	8a	N	3273; 9779; 24572	
CHK 22514	25	30S	34W	1		40	40	40	40	40			40								240	8c	Y	3273; 9779; 24572	
CHK 22557	24	30S	34W	3										40	40	40	40				160	8a	Y	3273; 9779; 24572	

Base Acres: Year: Minimum Reasonable Quantity:
 Comments: **UPDATE OWNERSHIP INFORMATION AND ADDRESSES**

Garden City Field Office
4532 W. Jones, Suite B
Garden City, KS 67846



Phone: 620-276-2901
Fax: 620-276-9315
www.agriculture.ks.gov

Mike Beam, Secretary

Laura Kelly, Governor

February 12, 2021

CLINTON L & DELAINE S STALKER
651 ROAD 220
SATANTA, KS 67870-9427

RE: Water Right, File No. 18014

Dear Sir or Madam:

Enclosed is the order executed by the designee of the Chief Engineer, Division of Water Resources, Kansas Department of Agriculture, approving the application for change under the above referenced file number.

Your attention is directed to the enclosures and to the terms, conditions, and limitations specified in this approval for change. A condition of this approval is that an acceptable water flow meter must be installed on the diversion works authorized under the referenced file number and meet current specifications. Please return the required notification of completion of the diversion works and installation of the required meter as soon as these actions are completed.

Since the order modifies the original document referred to above, it should be recorded with the Register of Deeds as other instruments affecting real estate.

Should you have any questions, please feel free contact this office. If you would prefer, you could arrange an appointment for additional assistance.

Sincerely,

A handwritten signature in blue ink, appearing to read "Austin J. McColloch".

Austin J. McColloch
Assistant Water Commissioner

AM:
enclosures

pc: ELS Properties LLC
GROUNDWATER MANAGEMENT DISTRICT NO. 3

CERTIFICATE OF SERVICE

On this 12th day of February, 2021, I hereby certify that the foregoing Approval of Application for Change in Point of Diversion, Water Right, File No. 18,014 dated 12th day of February, 2021 was mailed postage prepaid, first class, US mail to the following:

CLINTON L & DELAINE S STALKER
651 ROAD 220
SATANTA, KS 67870-9427

Pc:

ELS PROPERTIES LLC
PO BOX 605
SATANTA KS, KS 67870-0605

GROUNDWATER MANAGEMENT DISTRICT NO. 3

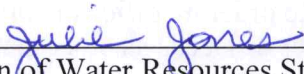

Division of Water Resources Staff

Submit completed application to:
 Kansas Department of Agriculture
 Division of Water Resources
 Field Office for your area.

Call for address:

Topeka -- (785) 296-5733
 Stafford -- (620) 234-5311
 Stockton -- (785) 425-6787
 Garden City -- (620) 276-2901
<http://agriculture.ks.gov/dwr>

DWR FIELD OFFICE APPLICATION FOR APPROVAL TO CHANGE THE PLACE OF USE AND/OR THE POINT OF DIVERSION



STATE OF KANSAS

Filing Fee Must Accompany the Application, K.S.A. 82a-708b(b), as amended.
 Fee Schedule is on the third page of this application form.

Paragraph Nos. 1, 2, 3 & 5 must be completed. Complete all other applicable portions. If change in point of diversion is greater than 100 feet, or if place of use will be changed, include a topographic map or detailed plat showing the authorized and proposed point(s) of diversion and/or place of use.

File No. 18014

RECEIVED

JAN 07 2021

Garden City Field Office
 Division of Water Resources

3:05 pm

1. Application is hereby made for approval of the Chief Engineer to change the (check one or both):

Place of Use Point of Diversion

under the water right which is the subject of this application in accordance with the conditions described below.

The source of supply is: Groundwater Surface water

2. Name and address of Applicant: CLINTON STALKER

~~RT 2 BOX 30-C, SATANTA KS 67870~~ 651 Road 220 Satanta KS 67870

Phone Number: _____ Email address: _____

Name and address of Water Use Correspondent: NO CHANGE

Phone Number: (620) 353-9889 (Brad) Email address: _____

3. The presently authorized place of use is:

Owner of Land ---- NAME: NO CHANGE

ADDRESS: _____

(If there is more than one landowner, attach supplemental sheets as necessary.)

Sec.	Twp.	Range	NE¼				NW¼				SW¼				SE¼				TOTAL ACRES		
			NE¼	NW¼	SW¼	SE¼	NE¼	NW¼	SW¼	SE¼	NE¼	NW¼	SW¼	SE¼	NE¼	NW¼	SW¼	SE¼			

4. If this application is for a change in place of use, it is proposed that the place of use be changed to:

Owner of Land ---- NAME: NO CHANGE

ADDRESS: _____

(If there is more than one landowner, attach supplemental sheets as necessary.)

Sec.	Twp.	Range	NE¼				NW¼				SW¼				SE¼				TOTAL ACRES			
			NE¼	NW¼	SW¼	SE¼	NE¼	NW¼	SW¼	SE¼	NE¼	NW¼	SW¼	SE¼	NE¼	NW¼	SW¼	SE¼				

For Office Use Only: Code _____ Fee \$ 200.00 TR # _____ Receipt Date 1-7-21 Check # 7189

5. **Presently authorized point of diversion:**
 One in the _____ Quarter of the _____ CE _____ Quarter of the _____ NE _____ Quarter
 of Section _____ 23 _____, Township _____ 30 _____ South, Range _____ 34 _____ W),
 in Haskell _____ County, Kansas, _____ feet North _____ feet West of Southeast corner of section.
 Authorized Rate _____ Authorized Quantity _____ Depth of well _____ (feet)
(DWR use only: Computer ID No. 01 GPS 3918 3928 feet North 900-31 feet West)
 This point will not be changed This point will be changed as follows: No change, point better described with GPS as follows:
Proposed point of diversion: (Complete only if change is requested or if existing point is better described by GPS)
 One in the _____ SE _____ Quarter of the _____ NE _____ Quarter of the _____ NE _____ Quarter
 of Section _____ 23 _____, Township _____ 30 _____ South, Range _____ 34 _____ (W),
 in Haskell _____ County, Kansas, 4309 feet North 10 feet West of Southeast corner of section.
 Proposed Rate _____ Proposed Quantity _____ Proposed well depth (feet) 560
 This point is: Additional Well Geo Center List other water rights that will use this point none

6. **Presently authorized point of diversion:**
 One in the _____ Quarter of the _____ Quarter of the _____ Quarter
 of Section _____, Township _____ South, Range _____ (E/W),
 in _____ County, Kansas, _____ feet North _____ feet West of Southeast corner of section.
 Authorized Rate _____ Authorized Quantity _____ Depth of well _____ (feet)
(DWR use only: Computer ID No. _____ GPS _____ feet North _____ feet West)
 This point will not be changed This point will be changed as follows: No change, point better described with GPS as follows:
Proposed point of diversion: (Complete only if change is requested or if existing point is better described by GPS)
 One in the _____ Quarter of the _____ Quarter of the _____ Quarter
 of Section _____, Township _____ South, Range _____ (E/W),
 in _____ County, Kansas, _____ feet North _____ feet West of Southeast corner of section.
 Proposed Rate _____ Proposed Quantity _____ Proposed well depth (feet) _____
 This point is: Additional Well Geo Center List other water rights that will use this point _____

7. The changes herein are desired for the following reasons?
 (please be specific) old well lost
production

8. If a well, is the test hole log attached? Yes No

9. The change(s) (was)(will be) completed by?
ASAP

10. If the point of diversion is a well:
 (a) What are you going to do with the old well?
C9p
 (b) When will this be done? ASAP

11. Groundwater Management District recommendation attached?
 Yes No

12. Assisted by Alex Torrance

13a. If the proposed point of diversion will be relocated more than 300 feet but within 2,640 feet of the existing point of diversion, attach a topographic map or aerial photograph. For groundwater sources, show all wells (including domestic) within one-half mile of the proposed point of diversion and the names and mailing addresses of the owners. For surface water sources, show the names and addresses of the landowner(s) one-half mile downstream and one-half mile upstream from your property lines

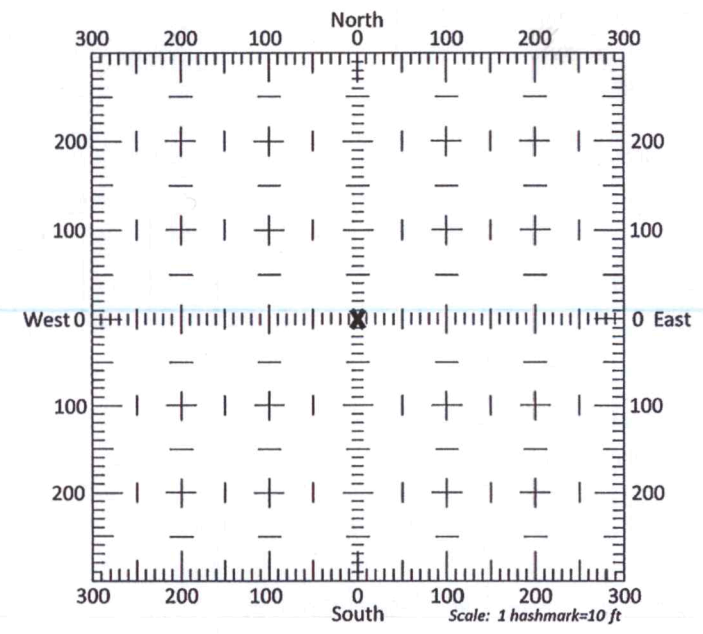

13b. If the proposed point of diversion will be relocated within 300 feet of the existing point of diversion, indicate its location on the diagram shown above in relation to the existing point of diversion. (PLEASE NOTE: The "X" in center of diagram above represents the presently authorized point of diversion.)

14. If the proposed groundwater point of diversion is 300 or fewer feet from the existing point of diversion, complete the following:
- (a) Does the undersigned represent all owners of the currently authorized place(s) of use identified in this application?
 Yes No (If no, all owners must sign this application.)
 - (b) Will the ownership interest of any owner of the currently authorized place(s) of use identified in this application be adversely affected if this application is approved as requested?
 Yes No (If yes, all owners must sign this application.)
 - (c) If this application is not approved expeditiously, will there be substantial damage to property, public health or safety?
 Yes No (If no, all owners must sign this application.)

If the application proposes a surface water change in point of diversion, a groundwater change in point of diversion greater than 300 feet, or a change in place of use, the application must be signed by all owners of the currently authorized place of use, or their duly authorized agent (attach notarized statement authorizing representation).

I hereby verify, being first duly sworn upon my oath or affirmation and under penalty of perjury, that I am of lawful age and the owner, the spouse of the owner, or a duly authorized agent of the owner(s) to make this application on their behalf, in regards to the water right(s) to which this application pertains. I further verify that the statements contained in this application are true, correct and complete.

Dated at SATANTA STALKER'S ~~December 2020~~, Kansas, this 31st day of December, 2020.

Clinton L. Stalker
 (Owner)

Delaine Stalker
 (Spouse)

Clinton L. Stalker
 (Please Print)

DELAINÉ STALKER
 (Please Print)

EHS Properties LLC
 (Owner)

[Signature]
 (Spouse)

Gary Schnellbacher
 Administrative Member
 (Please Print)

Gary Schnellbacher
 (Please Print)

 (Owner)

 (Spouse)

 (Please Print)

 (Please Print)

State of Kansas }
 County of HASKELL } SS

I hereby certify that the foregoing application was signed in my presence and sworn to before me this 31st day of December, 2020.

My Commission Expires July 14, 2022.

Nancy Groth
 Notary Public
 NANCY GROTH
 Notary Public - State of Kansas
 My Appt. Expires 7-14-22

ONLY COMPLETE APPLICATIONS WILL BE PROCESSED. To be complete, all of the applicable portions of the application form must be completed with accurate information; maps, if necessary, must be included; signatures of all the appropriate owners' must be affixed to the application and notarized; and the appropriate fee must be paid.

FEE SCHEDULE

Each application to change the place of use or the point of diversion under this section shall be accompanied by the application fee set forth in the schedule below: Make checks payable to: **Kansas Department of Agriculture**

- (1) Application to change a point of diversion 300 feet or less \$100
- (2) Application to change a point of diversion more than 300 feet \$200
- (3) Application to change the place of use \$200

SUMMARY ORDER APPROVING APPLICATION FOR CHANGE AND IMPOSING CONDITIONS

This Summary Order is issued under authority of K.S.A. 82a-708b, as amended, and K.A.R. 5-5-1, *et seq.* and other applicable provisions of the *Kansas Water Appropriation Law, K.S.A. 82a-701 et. seq.*, and rules and regulations promulgated thereunder, With the exception of those conditions expressly contained herein, this Summary Order does not change the terms, conditions and limitations of File No. 18014

- 1. A change application was received on January 7, 2021 requesting that the place of use and / or point of diversion authorized under the above-referenced file number be changed as described in the application.
- 2. On and after the effective date of this summary order, the authorized place(s) of use shall be located substantially as shown on the topographic map accompanying the application to change the place of use. Applicable Not Applicable
- 3. The change in point of diversion shall not impair existing rights and shall be limited to the same source or sources of water as previously authorized. The point of diversion authorized by this summary order shall be located within a 50 foot radius of the authorized point(s) of diversion. Applicable Not Applicable
- 4. The point(s) of diversion described herein is administratively corrected to be more accurately described using the Global Positioning System (GPS), as described in the application. Applicable Not Applicable
- 5. The point(s) of diversion authorized herein shall not actually be located more than — feet from the previously authorized point(s) of diversion. Applicable Not Applicable
- 6. As required by K.A.R. 5-3-5d, if the works for diversion is a well with a diversion rate of 100 gallons per minute or more, a tube or other device suitable for making water level measurements shall be installed, operated and maintained in accordance with K.A.R. 5-6-13. Applicable Not Applicable
- 7. The owner of the authorized place(s) of use shall properly install an acceptable water flow meter on or before December 31, 2021, or before the first use of water, whichever occurs first. The water flow meter shall be installed, operated and maintained in accordance with K.A.R. 5-1-4 through 5-1-12. As required by K.S.A. 82a-732, as amended, and K.A.R. 5-3-5e, the owner shall maintain records and report the reading of the water flow meter and the total quantity of water diverted annually to the Chief Engineer by March 1 following the end of each calendar year. Applicable Not Applicable
- 8. Installation of the works for diversion of water shall be completed on or before December 31, 2021, or within any authorized extension of time. By March 1, 2022 the applicant shall notify the Chief Engineer that construction of the works for diversion has been completed, on the form provided by the Chief Engineer, as required by K.A.R. 5-8-4e. Applicable Not Applicable
- 9. The completed well log shall be submitted with the required notice. Applicable Not Applicable
- 10. All diversion works into which any type of chemical or other foreign substance will be injected into the water shall be equipped with an in-line, automatic, quick-closing check valve capable of preventing pollution of the source of the water supply. The check valve(s) shall be installed, operated and maintained in accordance with K.A.R. 5-3-5c. Applicable Not Applicable
- 11. Additional Conditions are attached. Yes No
- 12. In accordance with K.S.A. 82a-708a, as amended, and K.A.R. 5-5-14, all of the owners of the authorized place(s) of use of water appropriated under the above-referenced file number are responsible for compliance with its terms, conditions and limitations, as amended and/or supplemented by this Summary Order, and with applicable provisions of the *Kansas Water Appropriation Law* and the *Rules and Regulations* promulgated thereunder. Failure to comply with these provisions may result in civil penalties pursuant to K.S.A. 82a-737, as amended, and/or the suspension or revocation and dismissal of the water or appropriation right or any other enforcement actions authorized by law.

Administrative Appeal and Effective Date of Order

If you are aggrieved by this order, pursuant to K.S.A. 82a-1901, you may request an evidentiary hearing before the Chief Engineer or request administrative review by the Secretary of Agriculture. A request for hearing by the Chief Engineer must be filed within **15 days** of service of this Order and a request for administrative review by the Secretary must be filed within **30 days** pursuant to K.S.A. 77-531. Any request for administrative review must state a basis for review pursuant to K.S.A. 77-527. File any request with **Kansas Department of Agriculture, Legal Division, 1320 Research Park Drive, Manhattan, KS 66502.** Failure to timely request a hearing or review may preclude review under the Kansas Judicial Review Act.

For Use by Register of Deeds

FOR OFFICE USE ONLY
**APPLICATION APPROVED AND
SUMMARY ORDER ISSUED**

By: Austin McColloch
Duly Authorized Designee of the Chief Engineer
(Print Name): Austin McColloch
Division of Water Resources - Kansas Department of Agriculture
Date of Issuance: February 12, 2021
State of Kansas)
County of Stimney) SS
Acknowledged before me on February 12, 2021
by Austin McColloch
Signature: Julie Jones



My commission expires: _____
(Notary Seal)

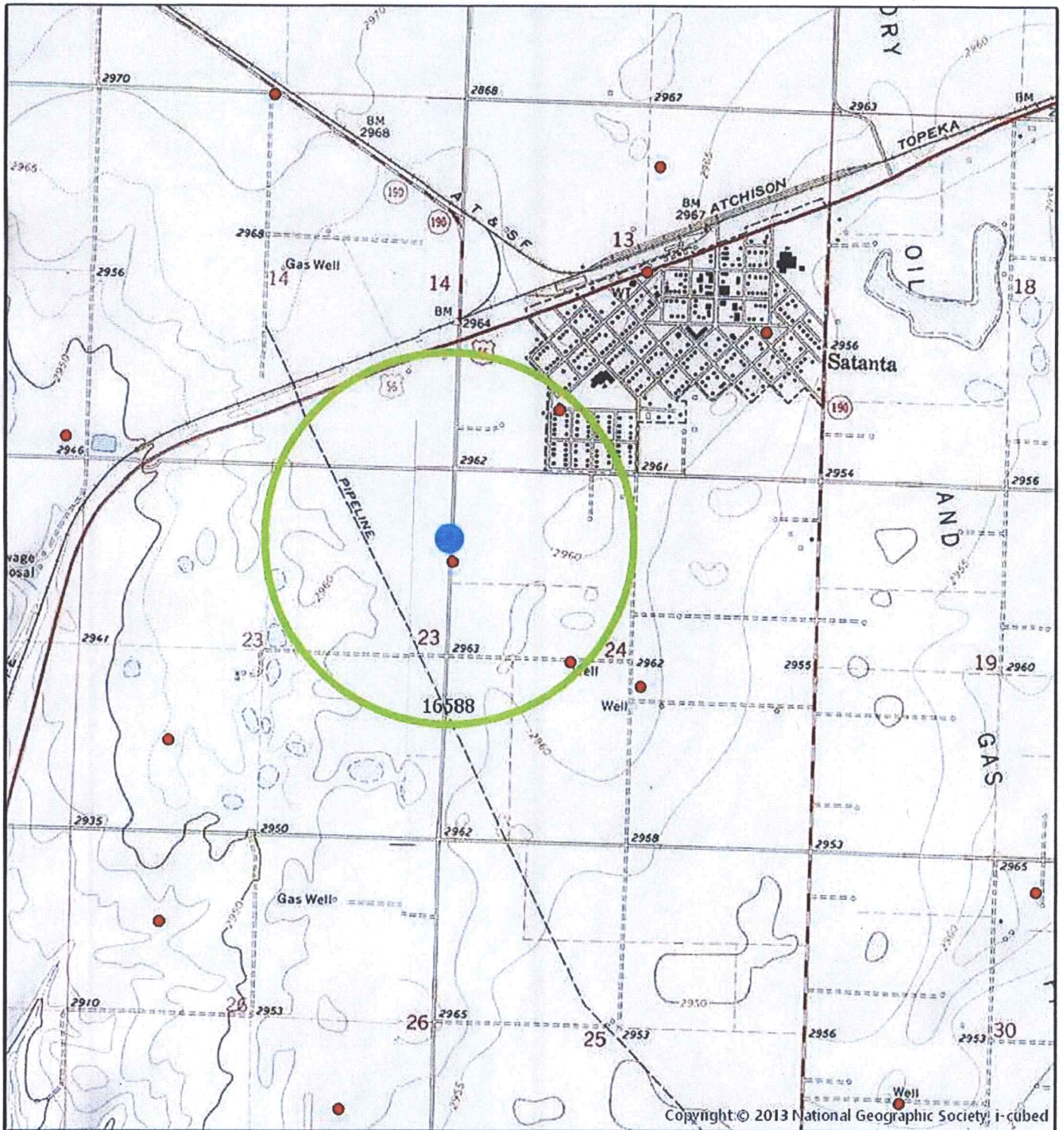

CHANGE IN POINT OF DIVERSION 18014



Township 30 South Range 34 West
HS County

0 0.2 0.4 0.8 Miles

All wells of any kind within a half mile of the proposed point of diversion are shown:

-  POINT OF DIVERSION
-  PROPOSED PD



Created By: AT/GCFO

WELL LOG

WR 18014

DATE: 3/18/2020

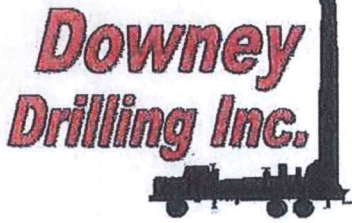

CUSTOMER NAME: STALKER, INC. (BRAD STALKER)

LEGAL: NE 23-30S-34W

COUNTY: HASKELL

GPS: N 37.428744

SWL APPROX. 310'

W 100.998535

LOGGER: DALE

DRILLER: DALE GUINN

WO: 20-117

TW	FROM	TO	TYPE	HARDNESS	COLOR	SPEED	PULL DOWN	OTHER / DRILLING ACTION
	0	17	SANDY CLAY	SOFT	BROWN	FAST		SMOOTH
	17	21	CALICHE	STIFF	WHITE & TAN	SEMI SLOW		CHOPPY
	21	60	CLAY W/ TR. CALICHE LENSES	SOFT	BROWN	SEMI SLOW		SMOOTH
	60	76	FINE SAND	SOFT		FAST		SMOOTH
	76	99	SANDY CLAY W/ FEW LIME ROCK LAYERS	SOFT	BROWN	FAST		SMOOTH
	99	180	FINE, MED, COURSE SAND AND SMALL GRAVEL	SOFT		FAST		CHATTER
	180	218	FINE, MED, COURSE SAND, SM. GRAVEL	SOFT		FAST		CHATTER
	218	247	CLAY W/ TR. CALICHE LENSES	SOFT	BLUE	FAST		SMOOTH
	247	290	FINE, MED, COURSE SAND AND SMALL GRAVEL	SOFT		FAST		CHATTER
	290	303	CLAY W/ TR. CALICHE LENSES	SOFT	BLUE	FAST		SMOOTH
	303	325	FINE, MED, COURSE SAND	SOFT		FAST		CHATTER
	325	338	CLAY	SOFT	BLUE & BROWN	FAST		SMOOTH
	338	354	FINE, MED, COURSE SAND, FINE, TR. MED GRAVEL	SOFT		FAST		CHATTER
	354	364	CLAY	SOFT	LIGHT BLUE	FAST		SMOOTH
	364	382	FINE, MED, COURSE SAND	SOFT		FAST		CHATTER
	382	401	SANDY CLAY W/ MED SAND STRINGERS	STIFF	TAN	SEMI SLOW		CHATTERY & SMOOTH
	401	431	SANDY CLAY	SOFT	TAN	SEMI SLOW		SMOOTH
	431	475	FINE, MED SAND	SOFT		SEMI SLOW		VIBRATION
	475	477	SOAPSTONE	SOFT	GRAY	SEMI SLOW		SMOOTH
X	477	529	SANDSTONE	NOT AS SOFT	BROWN	SEMI SLOW		CHOPPY
	529	549	SANDSTONE AND SOAPSTONE	NOT AS SOFT	YELLOW	SEMI SLOW		CHOPPY
	549	560	RED BED	HARD	RED	SLOW		CHOPPY
			QUIKGEL - 9					
			BRAN - 1					
			HOLEPLUG - 2					
			CASING SEAL - 1					
			WATER USAGE - 4,200 GAL					
			6-1/4 DRAG BIT - 1					

RECEIVED

NOV 25 2020

Garden City Field Office
Division of Water Resources

18014 Proposed Well location

INPUTS	
Target Section Definition	
Section	23
Township	30
Range	34
Range Direction	W
Target Point Coordinates (NAD27 or NAD83)	
Target Longitude	-100.998535
Target Latitude	37.428744

Load Data and Compute

Instructions

1. Enter values for section, township, range and range direction.
2. Enter **NAD27** or **NAD83** longitude and latitude of target point.
3. Click "Load Data and Compute" button.
4. Use feet distances corresponding to datum of target point.

Loaded Section Data From LEOBASE using NAD83		
Corner	Corner Latitudes	Corner Longitudes
SW	37.41700151	-101.01684787
NW	37.43148259	-101.01668006
NE	37.43145158	-100.99838505
SE	37.41690965	-100.99856794
Degrees Longitude per Foot		3.44340992E-06
Degrees Latitude per Foot		2.74636401E-06
Target Point Distances from Corners using NAD83		
Corner	Feet North(+)/South(-)	Feet East(-)/West(+)
SW	4276	-5318
NW	-997	-5270
NE	-986	44
SE	4309	-10

Target point is in Section

Loaded Section Data From LEOBASE using NAD27		
Corner	Corner Latitudes	Corner Longitudes
SW	37.41697700	-101.01640300
NW	37.43145800	-101.01623500
NE	37.43142700	-100.99794000
SE	37.41688500	-100.99812300
Degrees Longitude per Foot		3.44340879E-06
Degrees Latitude per Foot		2.74598553E-06
Target Point Distances from Corners using NAD27		
Corner	Feet North(+)/South(-)	Feet East(-)/West(+)
SW	4285	-5189
NW	-988	-5140
NE	-977	173
SE	4319	120

Target point is in Section

Difference (NAD83 Minus NAD27)		
Corner	Corner Latitudes	Corner Longitudes
SW	0.00002451	-0.00044487
NW	0.00002459	-0.00044506
NE	0.00002458	-0.00044505
SE	0.00002465	-0.00044494
Difference (NAD83 Minus NAD27)		
Corner	Feet North(+)/South(-)	Feet East(-)/West(+)
SW	-9.51507423	-129.19291322
NW	-8.81744976	-129.24810703
NE	-8.81536437	-129.24693980
SE	-9.57066790	-129.21497735

18014 Current Well location
Per 2015 GMD3 Inspection

INPUTS	
Target Section Definition	
Section	23
Township	30
Range	34
Range Direction	w
Target Point Coordinates (NAD27 or NAD83)	
Target Longitude	-100.998230
Target Latitude	37.427670

Load Data and Compute

Instructions

1. Enter values for section, township, range and range direction.
2. Enter **NAD27** or **NAD83** longitude and latitude of target point.
3. Click "Load Data and Compute" button.
4. Use feet distances corresponding to datum of target point.

Loaded Section Data From LEOBASE using NAD83		
Corner	Corner Latitudes	Corner Longitudes
SW	37.41700151	-101.01684787
NW	37.43148259	-101.01668006
NE	37.43145158	-100.99838505
SE	37.41690965	-100.99856794
Degrees Longitude per Foot		3.44340992E-06
Degrees Latitude per Foot		2.74636401E-06
Target Point Distances from Corners using NAD83		
Corner	Feet North(+)/South(-)	Feet East(-)/West(+)
SW	3885	-5407
NW	-1388	-5358
NE	-1377	-45
SE	3918	-98

Target point is NOT In Section

Loaded Section Data From LEOBASE using NAD27		
Corner	Corner Latitudes	Corner Longitudes
SW	37.41697700	-101.01640300
NW	37.43145800	-101.01623500
NE	37.43142700	-100.99794000
SE	37.41688500	-100.99812300
Degrees Longitude per Foot		3.44340879E-06
Degrees Latitude per Foot		2.74598553E-06
Target Point Distances from Corners using NAD27		
Corner	Feet North(+)/South(-)	Feet East(-)/West(+)
SW	3894	-5278
NW	-1379	-5229
NE	-1368	84
SE	3928	31

Target point is In Section

Difference (NAD83 Minus NAD27)		
Corner	Corner Latitudes	Corner Longitudes
SW	0.00002451	-0.00044487
NW	0.00002459	-0.00044506
NE	0.00002458	-0.00044505
SE	0.00002465	-0.00044494
Difference (NAD83 Minus NAD27)		
Corner	Feet North(+)/South(-)	Feet East(-)/West(+)
SW	-9.46117369	-129.19288426
NW	-8.76354922	-129.24807808
NE	-8.76146383	-129.24691085
SE	-9.51676736	-129.21494840



Southwest Kansas
Groundwater Management District No. 3
2009 E. Spruce Street
Garden City, Kansas 67846
(620) 275-7147 phone (620) 275-1431 fax
www.gmd3.org

February 11, 2021

Austin J McColloch
Division of Water Resources
4532 W Jones Ave., Suite B
Garden City, Kansas 67846

RE: Application for Change in Point of Diversion
Water Right, File No. 18014

Dear Austin:

We have completed a review of the application for the above referenced water right. The proposed change in point of diversion is in accordance with current area rules, K.A.R. 5-23-3, as it pertains to distance moved and minimum spacing to neighboring wells.

Well evaluations were conducted to estimate possible effects of the proposal on the supply of other wells with water rights prior to the proposal per K.S.A. 82a-708b, and the draft revised management program. Under K.S.A. 82a-708b, an applicant requesting a change in point of diversion must demonstrate to the chief engineer that any proposed change is reasonable and will not impair. The enclosed report is an analysis performed by the GMD on behalf of our membership. Under this analysis, the proposed change is considered to be reasonable and unlikely to impair if either the net in-season well-to-well effect of the proposed change is less than a strict maximum allowable threshold (3.5 ft in cases where saturated thickness range is between 150-200 ft), or if no well with a net well-to-well effect exceeding the threshold is identified as critical. Critical wells are identified as wells that are expected to either lose or greatly diminish water supply over the next 25 years. The attached review information is based on a Theis analysis using inputs from the GMD3 aquifer model, which is considered to be the best information on well and aquifer data readily and easily available to the public. If either the applicant or the neighbors believe they have better data that might change the result of the analysis, they should contact GMD3. Conclusions of the well analysis may change if better information on well and aquifer data can be made available.

Every neighboring well within 1 mile of the proposed move was evaluated. Evaluations showed that two of the neighboring wells exceeded the net effect above the maximum allowable threshold and needed further review. That evaluation showed that the only well that could be considered critical was the well owned/operated by the applicant. So it should be noted that if run at authorized rate, the applicant will be causing possible harm to his own well. Our office received no comments of concern from any of the other neighboring well owners. Therefore, GMD3 sees this move as reasonable and therefore recommend that the application be approved. If aquifer conditions change or there is a change to the water right in the future, we would be happy to evaluate the effects at that time.

Thank you for the opportunity to review the applications and to provide a recommendation. If you have any questions, please don't hesitate to contact us.

Sincerely,

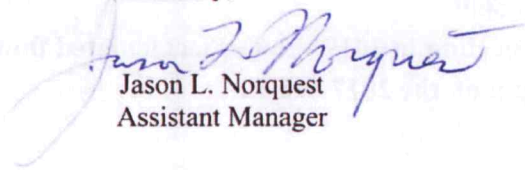
Jason L. Norquest
Assistant Manager

GMD3 Change Review

File No(s): 18014.

DWR office: GC.

App filed to change: PD.

Is Landowner(s) correct in WRIS: Clinton Stalker.

If NO, is documentation included?

Is Water Use Correspondent correct in WRIS? SAME.

If NO, is documentation included?

Regulation(s) Reviewed: KAR 5-23-3

Point of diversion ID No(s) 01 being changed.

	ft. North	ft. West	
Authorized PD	3928	31	Sect 23-30-34
Proposed PD	4309	10	
Difference	-381 n	21 e	
a2 + b2 = c2	145161	441	381.5783 foot move NE

GPS for proposed PD: Lat: 37.428744 Long: -100.998535.

Is proposed PD stacking on existing WRs? No.

Is Proposed PU overlapping existing WRs? No Change.

Neighboring certified well(s) notified: ___.

Name James & Gloria Garner (14701).

Address 1125 Free State CT.

Zip Burlington, KS 66839.

Email: jgarner443@hotmail.com Phone: 620-364-6203.

Name City of Satanta (34476 & 38635).

Address PO Box 665.

Zip Satanta, KS 67870.

Email: CitySupt@pld.com. Phone: 620-649-2500.

Domestic well(s) notified: ___.

Name ___.

Address ___.

Zip ___.

Base Acres: ___.

Perfected Acres: ___.

Irr. Return-Flow ___%

Authorized 320AF @ 1570gpm.

Proposed depth 560'

GMD3 field inspection in 2019 showed a calculated flow of 123gpm.

Reported 250gpm on the 2017 WUR.

GMD3 Change Review

10 average reported use (2010-2019) = 160.8AF (appears to have started dropping production around 2014 according to the reports.

Best hope for new well, according to operator is around 550gpm.

Is a waiver needed: Move less than half mile and spacing appears met to neighboring wells. Analysis shows that the only real effect will be to another well owned by applicant, which has not been able to pump full authority at current time.

Recommendation: After review of all available information, it appears the proposed move meets current area rules. Only critical well was also owned by the applicant and that is if he could still pump full rate/quantity and he should be made aware of that fact. None of the other wells showed to be critical. Staff therefore recommends approval of the application.



34476: Drawdown from current location = 4.28 ft
Drawdown from proposed location = 9.16 ft
Net drawdown = **4.9 ft**

38635: Drawdown from current location = 2.93 ft
Drawdown from proposed location = 6.00 ft
Net drawdown = **3.1 ft**

24572: Drawdown from current location = 3.00 ft
Drawdown from proposed location = 5.93 ft
Net drawdown = **2.9 ft**

Domestic 1: Drawdown from current location = 2.99 ft
Drawdown from proposed location = 5.84 ft
Net drawdown = **2.9 ft**

Domestic 2: Drawdown from current location = 3.59 ft
Drawdown from proposed location = 6.80 ft
Net drawdown = **3.2 ft**

Domestic 3: Drawdown from current location = 2.98 ft
Drawdown from proposed location = 5.72 ft
Net drawdown = **2.7 ft**

Net drawdown exceeds the drawdown allowance of 3.5 ft for water right nos. 3273 & 9779 and 34476. Critical well analysis is necessary on those wells.

Critical Well Evaluation:

3273 & 9779:

Water Column = 158 ft

DP = 4.2 ft

DE = 38.1 ft (water level decline from 2021 through 2046 based upon GMD3 model)

DD = 95.8 ft (S = 0.1222, T = 15,930 gpd/ft, Q = 600 gpm, tp = 143 days, efficiency = 70%)

DT = 138.1 ft

Economic Drawdown Constraint (EDC) = $0.4 * 158 \text{ ft} = 63.2 \text{ ft}$

Physical Drawdown Constraint (PDC) = $158 \text{ ft} - 60 \text{ ft} = 98 \text{ ft}$

Total drawdown (138.1 ft) is greater than both the EDC (63.2 ft) and the PDC (98 ft) so the well is **critical**.

34476:

Water Column = 183 ft

DP = 4.9 ft

DE = 30 ft (water level decline from 2021 through 2046 based upon GMD3 model)

DD = 4.6 ft (S = 0.2145, T = 79,234 gpd/ft, Q = 134 gpm (assume 60% production time on municipal wells), tp = 219 days, efficiency = 70%)

DT = 39.5 ft

Economic Drawdown Constraint (EDC) = $0.4 * 183 \text{ ft} = 73.2 \text{ ft}$

Physical Drawdown Constraint (PDC) = $183 \text{ ft} - 60 \text{ ft} = 123 \text{ ft}$

Total drawdown (39.5 ft) is less than the EDC (73.2 ft) and the PDC (123 ft), so this well is **not critical**.

Conclusion:

If the proposed well is operated at its fully authorized rate and quantity, it is likely to cause a noticeable effect on the operation of neighboring water right no. 3273 & 9774, a critical well. This well is owned by the applicant. GMD3 staff recommends approval of the application on the basis that the applicant is only likely to create an impairment situation on his own well and is fully aware of potential problems that may occur.

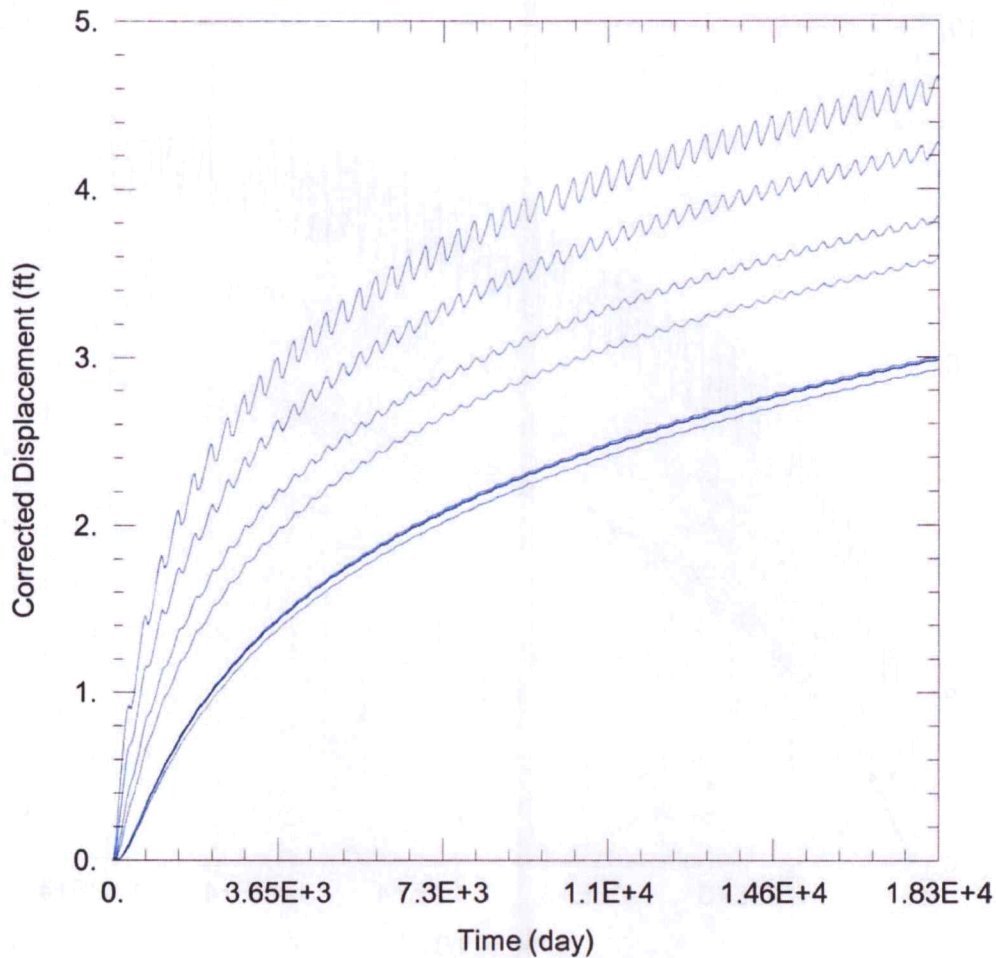

WELL TEST ANALYSIS

Data Set: C:\Users\trevora\Documents\2021_Moves\18014\18014 Current.aqt
 Date: 02/02/21 Time: 11:07:14

PROJECT INFORMATION

Company: GMD 3
 Project: 18014
 Location: Haskell County
 Test Well: 18014

WELL DATA

Pumping Wells

Well Name	X (ft)	Y (ft)
18014	-57654	201333

Observation Wells

Well Name	X (ft)	Y (ft)
□	-57654	201333
□ 3273 & 9779	-55893	199947
□ 14701	-54895	199624
□ 34476	-56163	203538
□ 38635	-54959	205534
□ 24572	-61658	198669
□ Domestic 1	-52823	201648
□ Domestic 2	-57493	197700
□ Domestic 3	-59155	196721

SOLUTION

Aquifer Model: Unconfined

Solution Method: Theis

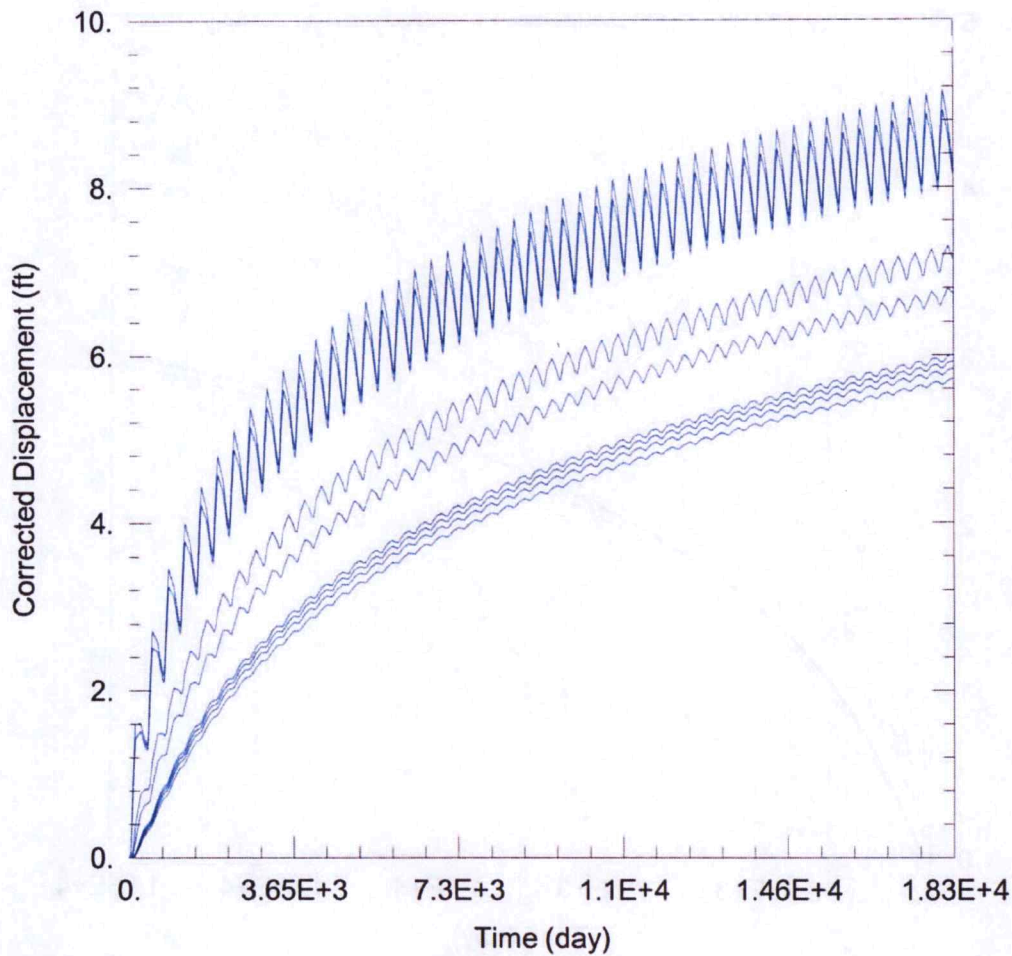

WELL TEST ANALYSIS

Data Set: C:\Users\trevora\Documents\2021_Moves\18014\18014 Proposed.aqt
 Date: 02/02/21 Time: 11:07:07

PROJECT INFORMATION

Company: GMD 3
 Project: 18014
 Location: Haskell County
 Test Well: 18014

WELL DATA

Pumping Wells

Well Name	X (ft)	Y (ft)
18014	-57812	201680

Observation Wells

Well Name	X (ft)	Y (ft)
□	-57812	201680
□ 3273 & 9779	-55893	199947
□ 14701	-54895	199624
□ 34476	-56163	203538
□ 38635	-54959	205534
□ 24572	-61658	198669
□ Domestic 1	-52823	201648
□ Domestic 2	-57493	197700
□ Domestic 3	-59155	196721

SOLUTION

Aquifer Model: Unconfined

Solution Method: Theis

Water Rights and Points of Diversion Within 1 mile of point defined as:

4309 Feet N and 10 Feet W of the Southeast Corner of Section 23 Twp 30S Rng 34W

Located at: 100.998602 West Longitude and 37.428744 North Latitude

Both SURFACE WATER and GROUNDWATER

File Number	Use	ST	SR	Dist (ft)	Q4	Q3	Q2	Q1	FeetN	FeetW	Sec	Twp	Rng	ID	Batt	Auth_Quan	Add_Quan	
A__ AF	3273 00	IRR	NK	G	2491	--	NW	NE	SW	2600	3540	24	30	34W	1		589.00	589.00
A__ AF	9779 00	IRR	NK	G	2491	--	NW	NE	SW	2600	3540	24	30	34W	1		307.00	307.00
A__ AF	14701 00	IRR	NK	G	3479	--	NW	NW	SE	2280	2540	24	30	34W	2		559.00	559.00
A__ AF	18014 00	IRR	NK	G*	345	--	CE	NE	-----	-----	23	30	34W	1		320.00	320.00	
A__ AF	24572 00	IRR	NK	G	4965	--	NC	SW	1300	3960	23	30	34W	2		640.00	640.00	
A__ AF	34476 00	MUN	NK	G	2422	--	NW	SE	SW	900	3800	13	30	34W	3		122.76	122.76
A__ AF	38635 00	MUN	NK	G	4735	--	SW	SW	NE	2900	2600	13	30	34W	4		.60	.00

Total Net Quantities Authorized:	Direct	Storage
Total Requested Amount (AF) =	.00	.00
Total Permitted Amount (AF) =	.00	.00
Total Inspected Amount (AF) =	.00	.00
Total Pro_Cert Amount (AF) =	.00	.00
Total Certified Amount (AF) =	2537.76	.00
Total Vested Amount (AF) =	.00	.00
TOTAL AMOUNT (AF) =	2537.76	.00

acing Appears MET!

An * after the source of supply indicates a pending application for change under the file number.

An * after the ID indicates a 15 AF exemption was granted under the file number.

A "G" in the Batt column indicates the GEO CTR of a battery. A "B" indicates a well in the battery.

The number in the Batt column is the number of wells in the battery.

Water Rights and Points of Diversion Within 1 mile of point defined as:

4309 Feet North and 10 Feet West of the Southeast Corner of Section 23 Twp 30S Rng 34W

Located at: 100.998602 West Longitude and 37.428744 North Latitude

Both SURFACE WATER and GROUNDWATER

WATER USE CORRESPONDENTS:

- > CLINTON L & DELAINE S STALKER
- > 651 ROAD 220
- > SATANTA KS 67870
-
- > CLINTON L & DELAINE S STALKER
- > 651 ROAD 220
- > SATANTA KS 67870
-
- > JAMES & GLORIA GARNER
- > 1125 FREE STATE CT
- > BURLINGTON KS 66839
-
- > CLINTON L & DELAINE S STALKER
- > 651 ROAD 220
- > SATANTA KS 67870
-

3273

9779

14701

18014

1125 Free St

App

Hope 500 gpm @ base

> CLINTON L & DELAINE S STALKER
>
> 651 ROAD 220
> SATANTA KS 67870

24572

Applicant's

> CITY OF SATANTA
>
> PO BOX 665
> SATANTA KS 67870

34478

> CITY OF SATANTA
>
> PO BOX 665
> SATANTA KS 67870

38635

Garden City Field Office
4532 W. Jones, Suite B
Garden City, KS 67846



Phone: 620-276-2901
Fax: 620-276-9315
www.agriculture.ks.gov

Mike Beam, Secretary

Laura Kelly, Governor

January 28, 2021

GROUNDWATER MANAGEMENT DISTRICT #3
2009 E SPRUCE ST
GARDEN CITY KS 67846

Change Application,
File Nos. 18014

Dear Sir or Madam:

We are enclosing a copy of the referenced application, which was submitted by Clinton Stalker and appears to be in proper form, for your review.

We are delaying any further action for a period of 15 days from the date of this letter to allow you time to submit your recommendation concerning this application. Please submit your recommendation within the allotted time, or any authorized extension of time thereof.

If you have any questions, please contact me at (620) 276-2901. If you wish to discuss a specific file, please have the file number ready to that I may help you more efficiently.

Sincerely,

A handwritten signature in blue ink, appearing to read "Austin McColloch".

Austin McColloch
Assistant Water Commissioner

Enclosure
pc:

Garden City Field Office
4532 W. Jones, Suite B
Garden City, KS 67846



Phone: 620-276-2901
Fax: 620-276-9315
www.agriculture.ks.gov

Mike Beam, Secretary

Laura Kelly, Governor

January 12, 2021

CITY OF SATANTA
PO BOX 665
SATANTA, KS 67870-0665

RE: Water Right, File No. 18014

Dear Sir or Madam:

This is to advise you that Clinton Stalker has filed an application for approval of the Chief Engineer, Division of Water Resources, Kansas Department of Agriculture, to change the point of diversion under the above referenced applications. An irrigation well is proposed to be relocated to the SE $\frac{1}{4}$ NE $\frac{1}{4}$ NE $\frac{1}{4}$ of Section 23, Township 30 South, Range 34 West, Haskell County.

You can find the complete applications posted by water right file number as referenced above at: <https://agriculture.ks.gov/divisions-programs/dwr/water-appropriation/notices>

You are notified on this proposed point of diversion (well) so that you may furnish this office with any comments or other information you want to submit. Such comments or other information must be received in this office within 15 days from the date of this letter.

Should you have any questions, please feel free contact this office. If you would prefer, you could arrange an appointment for additional assistance. Please refer to the file number when you contact us if you wish to discuss a specific file.

Sincerely,

A handwritten signature in black ink that reads "Austin J. McColloch".

Austin J. McColloch
Assistant Water Commissioner

AM:
enclosures

pc:
GROUNDWATER MANAGEMENT DISTRICT NO. 3

SCANNED