

# NOTICE

This scan only represents the application as filed. The information contained herein meets the requirements of K.A.R. 5-3-1 or K.A.R. 5-5-1, and has been found acceptable for filing in the office of the Chief Engineer. The application should not be considered to be a complete application as per K.A.R. 5-3-1b or K.A.R. 5-5-2a.

THE STATE OF KANSAS



KANSAS DEPARTMENT OF AGRICULTURE
Mike Beam, Secretary of Agriculture

DIVISION OF WATER RESOURCES
Earl D. Lewis Jr., Chief Engineer

File Number 50671
This item to be completed by the Division of Water Resources.

WATER RESOURCES RECEIVED

OCT 25 2021

3:07

KS DEPT OF AGRICULTURE

APPLICATION FOR PERMIT TO APPROPRIATE WATER FOR BENEFICIAL USE

Filing Fee Must Accompany the Application
(Please refer to Fee Schedule attached to this application form.)

To the Chief Engineer of the Division of Water Resources, Kansas Department of Agriculture,
1320 Research Park Drive, Manhattan, Kansas 66502:

1. Name of Applicant (Please Print): CITY OF SYRACUSE
Address: PO BOX 148
City: SYRACUSE State KS Zip Code 67878
Telephone Number: ( )

2. The source of water is: [ ] surface water in (stream)
OR [X] groundwater in ARKANSAS RIVER (drainage basin)

Certain streams in Kansas have minimum target flows established by law or may be subject to administration when water is released from storage for use by water assurance district members. If your application is subject to these regulations on the date we receive your application, you will be sent the appropriate form to complete and return to the Division of Water Resources.

3. The maximum quantity of water desired is 16.826 acre-feet OR 5,482,768 gallons per calendar year, to be diverted at a maximum rate of 1,000 gallons per minute OR cubic feet per second.

Once your application has been assigned a priority, the requested maximum rate of diversion and maximum requested quantity of water under that priority number can NOT be increased. Please be certain your requested maximum rate of diversion and maximum quantity of water are appropriate and reasonable for your proposed project and are in agreement with the Division of Water Resources' requirements.

4. The water is intended to be appropriated for (Check use intended):
(a) [ ] Artificial Recharge (b) [ ] Irrigation (c) [ ] Recreational (d) [ ] Water Power
(e) [ ] Industrial (f) [X] Municipal (g) [ ] Stockwatering (h) [ ] Sediment Control
(i) [ ] Domestic (j) [ ] Dewatering (k) [ ] Hydraulic Dredging (l) [ ] Fire Protection
(m) [ ] Thermal Exchange (n) [ ] Contamination Remediation

YOU MUST COMPLETE AND ATTACH ADDITIONAL DIVISION OF WATER RESOURCES FORM(S) PROVIDING INFORMATION TO SUBSTANTIATE YOUR REQUEST FOR THE AMOUNT OF WATER FOR THE INTENDED USE REFERENCED ABOVE.

For Office Use Only:
F.O. 4 GMD Meets K.A.R. 5-3-1 (YES/NO) Use MUN Source G/S County HM By BMM Date 10/26/21
Code REG Fee \$ 200 TR # Receipt Date 10-25-21 Check # 6769

10/28/2021
LMoody

5. The location of the proposed wells, pump sites or other works for diversion of water is:

**Note:** For the application to be accepted, the point of diversion location must be described to at least a 10 acre tract, unless you specifically request a 60 day period of time in which to locate the site within a specifically described, minimal legal quarter section of land.

- (A) One in the NE quarter of the SE quarter of the NE quarter of Section 22, more particularly described as being near a point 3719 feet North and 559 feet West of the Southeast corner of said section, in Township 24 South, Range 41 West, HAMILTON County, Kansas.
- (B) One in the \_\_\_\_\_ quarter of the \_\_\_\_\_ quarter of the \_\_\_\_\_ quarter of Section \_\_\_\_\_, more particularly described as being near a point \_\_\_\_\_ feet North and \_\_\_\_\_ feet West of the Southeast corner of said section, in Township \_\_\_\_\_ South, Range \_\_\_\_\_ East/West (circle one), \_\_\_\_\_ County, Kansas.
- (C) One in the \_\_\_\_\_ quarter of the \_\_\_\_\_ quarter of the \_\_\_\_\_ quarter of Section \_\_\_\_\_, more particularly described as being near a point \_\_\_\_\_ feet North and \_\_\_\_\_ feet West of the Southeast corner of said section, in Township \_\_\_\_\_ South, Range \_\_\_\_\_ East/West (circle one), \_\_\_\_\_ County, Kansas.
- (D) One in the \_\_\_\_\_ quarter of the \_\_\_\_\_ quarter of the \_\_\_\_\_ quarter of Section \_\_\_\_\_, more particularly described as being near a point \_\_\_\_\_ feet North and \_\_\_\_\_ feet West of the Southeast corner of said section, in Township \_\_\_\_\_ South, Range \_\_\_\_\_ East/West (circle one), \_\_\_\_\_ County, Kansas.

If the source of supply is groundwater, a separate application shall be filed for each proposed well or battery of wells, except that a single application may include up to four wells within a circle with a quarter (1/4) mile radius in the same local source of supply which do not exceed a maximum diversion rate of 20 gallons per minute per well.

A battery of wells is defined as two or more wells connected to a common pump by a manifold; or not more than four wells in the same local source of supply within a 300 foot radius circle which are being operated by pumps not to exceed a total maximum diversion rate of 800 gallons per minute and which supply water to a common distribution system.

6. The owner of the point of diversion, if other than the applicant is (please print):

SAME AS APPLICANT  
 \_\_\_\_\_  
 (name, address and telephone number)

You must provide evidence of legal access to, or control of, the point of diversion from the landowner or the landowner's authorized representative. Provide a copy of a recorded deed, lease, easement or other document with this application. In lieu thereof, you may sign the following sworn statement:

I have legal access to, or control of, the point of diversion described in this application from the landowner or the landowner's authorized representative. I declare under penalty of perjury that the foregoing is true and correct.

Executed on Oct. 21, 2021. \_\_\_\_\_  
 Applicant's Signature

The applicant must provide the required information or signature irrespective of whether they are the landowner. Failure to complete this portion of the application will cause it to be unacceptable for filing and the application will be returned to the applicant.

7. The proposed project for diversion of water will consist of ONNE WELL; MOTOR & PUMP  
 \_\_\_\_\_  
 (number of wells, pumps or dams, etc.)  
 and (was)(will be) completed (by) 1/25/2001  
 \_\_\_\_\_  
 (Month/Day/Year - each was or will be completed)

8. The first actual application of water for the proposed beneficial use was or is estimated to be \_\_\_\_\_  
 (Mo/Day/Year)

WATER RESOURCES  
 RECEIVED  
 OCT 25 2021  
 KS DEPT OF AGRICULTURE

9. Will pesticide, fertilizer, or other foreign substance be injected into the water pumped from the diversion works?  
 Yes  No If "yes", a check valve shall be required.

All chemigation safety requirements must be met including a chemigation permit and reporting requirements.

10. If you are planning to impound water, please contact the Division of Water Resources for assistance, prior to submitting the application. Please attach a reservoir area capacity table and inform us of the total acres of surface drainage area above the reservoir.

Have you also made an application for a permit for construction of this dam and reservoir with the Division of Water Resources?  Yes  No

• If yes, show the Water Structures permit number here N/A

• If no, explain here why a Water Structures permit is not required N/A

11. The application must be supplemented by a U.S.G.S. topographic map, aerial photograph or a detailed plat showing the following information. On the topographic map, aerial photograph, or plat, identify the center of the section, the section lines or the section corners and show the appropriate section, township and range numbers. Also, please show the following information:

(a) The location of the proposed point(s) of diversion (wells, stream-bank installations, dams, or other diversion works) should be plotted as described in Paragraph No. 5 of the application, showing the North-South distance and the East-West distance from a section line or southeast corner of section.

(b) If the application is for groundwater, please show the location of any existing water wells of any kind within 1/2 mile of the proposed well or wells. Identify each existing well as to its use and furnish the name and mailing address of the property owner or owners. If there are no wells within 1/2 mile, please advise us.

(c) If the application is for surface water, the names and addresses of the landowner(s) 1/2 mile downstream and 1/2 mile upstream from your property lines must be shown.

(d) The location of the proposed place of use should be shown by crosshatching on the topographic map, aerial photograph or plat.

(e) Show the location of the pipelines, canals, reservoirs or other facilities for conveying water from the point of diversion to the place of use.

A 7.5 minute U.S.G.S. topographic map may be obtained by providing the section, township and range numbers to: Kansas Geological Survey, 1930 Constant, Campus West, University of Kansas, Lawrence, Kansas 66047.

12. List any application, appropriation of water, water right, or vested right file number that covers the same diversion points or any of the same place of use described in this application. Also list any other recent modifications made to existing permits or water rights in conjunction with the filing of this application.

OVERLAP IN POINT OF DIVERSION: WATER RIGHT FILE NO. 41613

OVERLAP IN PLACE OF USE: VESTED RIGHT FILE NO. HM-001; WATER RIGHT FILE NOS. 11852;

27492; 41613 & 43226

QUANTITY IS TO BE ALL ADDITIONAL; RATE WILL BE LIMITED WHEN COMBINED WITH WR 41613

WATER RESOURCES  
RECEIVED  
OCT 25 2021  
KS DEPT OF AGRICULTURE

13. Furnish the following well information if the proposed appropriation is for the use of groundwater. If the well has not been completed, give information obtained from test holes, if available.

Information below is from:     Test holes     Well as completed     Drillers log attached

Well location as shown in paragraph No.	(A)	(B)	(C)	(D)
Date Drilled	<u>7/14/2000</u>	_____	_____	_____
Total depth of well	<u>95'</u>	_____	_____	_____
Depth to water bearing formation	<u>30'</u>	_____	_____	_____
Depth to static water level	<u>32'</u>	_____	_____	_____
Depth to bottom of pump intake pipe	<u>94'</u>	_____	_____	_____

14. The relationship of the applicant to the proposed place where the water will be used is that of OWNER  
(owner, tenant, agent or otherwise)

15. The owner(s) of the property where the water is used, if other than the applicant, is (please print):

SAME AS APPLICANT  
(name, address and telephone number)

\_\_\_\_\_  
(name, address and telephone number)

16. The undersigned states that the information set forth above is true to the best of his/her knowledge and that this application is submitted in good faith.

Dated at Syracuse, Kansas, this 21<sup>st</sup> day of October, 2021.  
(month) (year)

[Signature]  
(Applicant Signature)

By [Signature]  
(Agent or Officer Signature)

\_\_\_\_\_  
(Agent or Officer - Please Print)

Assisted by AM / GCFO  
(office/title)

Date: \_\_\_\_\_

WATER RESOURCES RECEIVED  
OCT 25 2021  
KS DEPT OF AGRICULTURE

# NEW APPLICATION, FILE NO.

NE1/4 of Section 22 Township 24 South Range 41 West Hamilton County

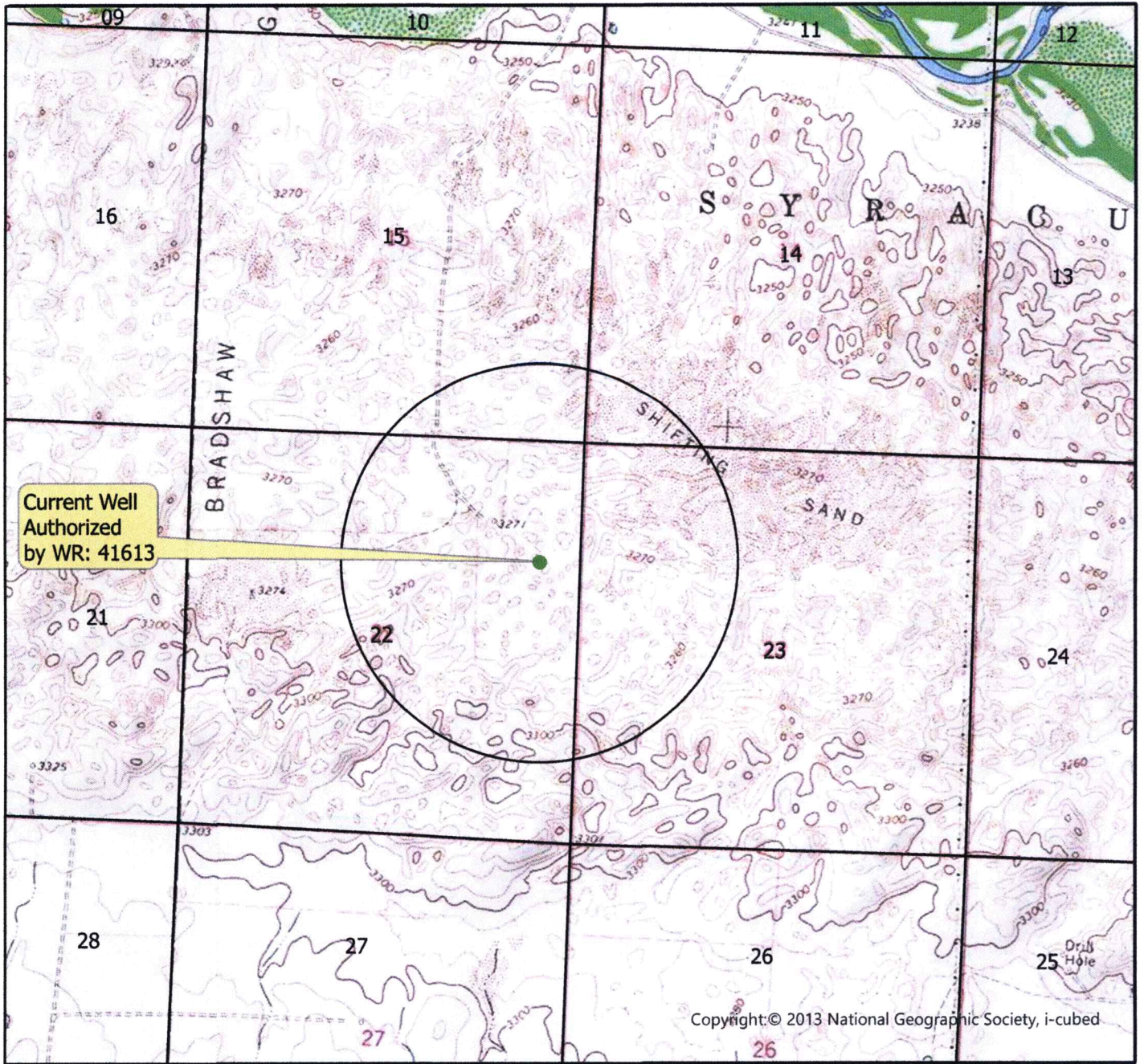

Current Well Authorized by WR: 41613

Copyright © 2013 National Geographic Society, i-cubed

- Proposed Point of Diversion
- Permitted Water Right
- ★ Domestic Well within 1/2 mile
- 1/2 mile buffer

List of owner name and addresses within 1/2 mile:



WATER RESOURCES RECEIVED  
OCT 25 2021

KS DEPT OF AGRICULTURE

By signing below I agree that all wells, including domestic, and owners names and addresses within 1/2 mile of the proposed point of diversion have been shown on the map

*[Signature]* 10/21/21  
(Signature) Date

Date AM/GCFO  
1:24,000 Scale

## FEE SCHEDULE

1. The fee for an application for a permit to appropriate water for beneficial use, except for domestic use, shall be (see paragraph No. 2 below if requesting storage):

ACRE-FEET	FEE
0-100	\$200.00
101-320	\$300.00
More than 320	\$300.00 plus \$20.00 for each additional 100 acre-feet or any part thereof.

2. The fee for an application in which storage is requested, except for domestic use, shall be:

ACRE-FEET	FEE
0-250	\$200.00
More than 250	\$200.00 plus \$20.00 for each additional 250 acre-feet of storage or any part thereof.

Note: If an application requests both direct use *and* storage, the fee charged shall be as determined under No. 1 or No. 2 above, whichever is greater, but not both fees.

3. The fee for an application for a permit to appropriate water for water power or dewatering purposes shall be \$100.00 plus \$200.00 for each 100 cubic feet per second, or part thereof, of the diversion rate requested.

Note: The applicant shall notify the Chief Engineer and pay the statutorily required field inspection fee of \$400.00 when construction of the works for diversion has been completed, except that for applications filed on or after July 1, 2009, for works constructed for sediment control use and for evaporation from a groundwater pit for industrial use shall be accompanied by a field inspection fee of \$200.00.

### **MAKE CHECKS PAYABLE TO THE KANSAS DEPARTMENT OF AGRICULTURE**

#### **ATTENTION**

A Water Conservation Plan may be required per K.S.A. 82a-733. A statement that your application for permit to appropriate water may be subject to the minimum desirable streamflow requirements per K.S.A. 82a-703a, b, and c may also be required from you. After the Division of Water Resources has had the opportunity to review your application, you will be notified whether or not you will need to submit a Water Conservation Plan. You also may be required to install a water flow meter or water stage measuring device on your diversion works prior to diverting water. There may be other special conditions or Groundwater Management District regulations that you will need to comply with if this application is approved.

#### **CONVERSION FACTORS**

1 acre-foot equals 325,851 gallons

1 million gallons equal 3.07 acre-feet

WATER RESOURCES  
RECEIVED  
OCT 25 2021  
KS DEPT OF AGRICULTURE

Applicant's Name CITY OF SYRACUSE  
(Please Print)

## MUNICIPAL (PUBLIC WATER SUPPLY) APPLICATION SUPPLEMENTAL INFORMATION SHEET

Application File Number

(assigned by DWR)

WATER RESOURCES  
RECEIVED  
OCT 25 2022

**SECTION 1: PRESENT WATER USE SUMMARY (IF NO PREVIOUS MUNICIPAL WATER USE HAS BEEN UTILIZED, PROCEED TO SECTION 3)**

**NOTE: WORKSHEET FOR WATER PUMPED, PURCHASED, AND SOLD BY YOUR WATER DISTRIBUTION SYSTEM.**

Column 1	Column 2	Column 3	Column 4	Column 5	Column 6	Column 7
Raw Water Diverted Under Your Rights	Water Purchased From All Sources	Water Sold to Other Public Water Suppliers	Water Sold to Your Industrial, Stock, and Bulk Customers	Water Sold to Your Residential and Commercial Customers	Other Metered Water	Remaining Water Used (See Below Explanation)
<b>TOTAL WATER = Columns 1 + 2</b>		<b>ACCOUNTED FOR WATER = Columns 3 + 4 + 5 + 6</b>				<b>UNACCOUNTED FOR WATER</b>

**UNACCOUNTED FOR WATER = TOTAL WATER - ACCOUNTED FOR WATER**

- Column 1: The amount of raw water diverted from all of your points of diversion.
- Column 2: The amount of water purchased wholesale from all other public water supply systems or the Kansas Water Office.
- Column 3: The amount of water sold wholesale to all other public water supply systems.
- Column 4: The amount of water sold retail to all industrial, pasture, stockwater, feedlot, and bulk water service connections. Include the amount of water sold to all farmsteads using at least 200,000 gallons of water per year.
- Column 5: The amount of water sold retail to your residential and commercial customers and to industries and farmsteads using less than 200,000 gallons of water per year.
- Column 6: The amount of water used that is metered at individual service connections and supplied free, such as for public service, treatment processes, and connections receiving free water.
- Column 7: The amount of remaining water used. The gallons reported in this column are found by adding the numbers in Columns 1 and 2 and subtracting the numbers in Columns 3, 4, 5, and 6.

**UNACCOUNTED FOR WATER**

Use the following to calculate your distribution system's Unaccounted For Water:

Start with the amount in Column 1 and add the amount in Column 2, then subtract the amounts in Columns 3, 4, 5, and 6 leaving an amount of water representing your unaccounted for water to enter in Column 7.

Use the following to calculate the percent Unaccounted For Water versus the Total Water of your system:

$$\text{Percent Unaccounted For Water} = \frac{\text{Unaccounted For Water}}{\text{Total Water (Columns 1,2)}} \times 100$$

If this number exceeds 20%, please explain the large amount of unaccounted for water and describe any steps being taken to reduce it.

**SECTION 2: PAST WATER USE**

**COMPLETE THE FOLLOWING TABLE FROM YOUR PAST WATER USE RECORDS.**

	Column 1	Column 2	Column 3	Column 4	Column 5	Column 6	Column 7
	Raw Water Diverted Under Your Rights	Water Purchased From All Sources	Water Sold to Other Public Water Suppliers	Water Sold to Your Industrial, Stock, and Bulk Customers	Water Sold to Your Residential and Commercial Customers	Other Metered Water	Remaining Water Used (See Above Explanation)
20 years ago	247006			5039	206849	7762	27356
15 years ago	255889			4124	224275	5901	21589
10 years ago	240956			4341	203792	22617	10206
5 years ago	268478			9549	222588	4870	31471
	<b>TOTAL WATER = Columns 1 + 2</b>		<b>ACCOUNTED FOR WATER = Columns 3 + 4 + 5 + 6</b>				<b>UNACCOUNTED FOR WATER</b>



**SECTION 3: PROJECTED FUTURE WATER NEEDS**

PLEASE COMPLETE THE FOLLOWING TABLE SHOWING YOUR FUTURE WATER REQUIREMENTS FOR THE NEXT 20 YEARS:

	Column 1 Raw Water Diverted Under Your Rights	Column 2 Water Purchased From All Sources	Column 3 Water Sold to Other Public Water Suppliers	Column 4 Water Sold to Your Industrial, Stock, and Bulk Customers	Column 5 Water Sold to Your Residential and Commercial Customers	Column 6 Other Metered Water	Column 7 Remaining Water Used (See Explanation on other side)
Year 5	270 402			5408	227138	8112	29744
Year 10	272 326			5446	228754	8170	29955
Year 15	274 250			5485	230370	8228	30168
Year 20	276 174			5523	231986	8285	30379
<b>TOTAL WATER = Columns 1 + 2</b>			<b>ACCOUNTED FOR WATER = Columns 3 + 4 + 5 + 6</b>				<b>UNACCOUNTED FOR WATER</b>

**SECTION 4: POPULATION AND SERVICE CONNECTIONS**

ESTIMATE THE NUMBER OF PERSONS DIRECTLY SERVED BY YOUR WATER DISTRIBUTION SYSTEM

PAST POPULATION - PROVIDE INFORMATION BELOW:  
(CENSUS BUREAU INFORMATION)

LAST 20 YEARS	POPULATION
20 years ago	1800
15 years ago	1824
10 years ago	1820
5 years ago	1830
Last Year	1855

PROJECTED FUTURE POPULATION

ESTIMATE FUTURE POPULATION AND SUBSTANTIATE NUMBERS ON SEPARATE ATTACHMENTS

NEXT 20 YEARS	POPULATION
Year 5	1869
Year 10	1883
Year 15	1897
Year 20	1911

Provide number of current active service connections:

879 Residential      92 Industrial      \_\_\_\_\_ Other (specify) \_\_\_\_\_  
 \_\_\_\_\_ Commercial      \_\_\_\_\_ Pasture/ Stockwater/ Feedlot      977 Total

**SECTION 5: PRESENT GALLONS PER PERSON PER DAY**

CALCULATE YOUR GALLONS PER PERSON PER DAY

Water in Columns 5, 6, and 7 + Population + 365 Days/Year = Gallons per Person per Day

$\frac{254998}{1855} \div 365 \text{ Days/Year} = 376.62$  GALLONS PER PERSON PER DAY.  
 Amount of water in Columns 5, 6, and 7 of Section 1      Population from Last Year of Section 4

**SECTION 6: AREA TO BE SERVED**

Describe the area to be served or provide the legal description of the location where the water is to be used including any other city of water supply system (i.e. Rural Water District): \_\_\_\_\_

CITY OF SYRACUSE & IMMEDIATE VICINITY

You may attach additional information you believe will assist in informing the Division of the need for your request.

OCT 25 2017  
 KS DEPT OF AGRICULTURE

**DATA ENTRY SYSTEM ID NUMBER SHEET**

**FILE NUMBER** 50671

<b>APPLICANT PERSON ID &amp; SEQ #</b>	<b>63320</b>	<b>PDIV ID</b>	<b>BATTERY ID</b>
<b>17702</b>			

<b>LANDOWNER PERSON ID &amp; SEQ #</b>	<b>7731</b>	<b>PUSE ID</b>
<b>17702</b>		

<b>WATER USE CORRESPONDENT PERSON ID &amp; SEQ #</b>
<b>17702</b>