

File No. **20262** 11. County: HS Basin: ARKANSAS RIVER Stream: Formation Code: 211/331 Special Use:

12. Points of Diversion
 CHK
 MOD
 DEL PDIV
 ENT Qualifier S T R ID 'N 'W Comment (AKA Line) Rate gpm/cfs Quantity af/mgy Additional Rate gpm/cfs Quantity af/mgy Overlap PD Files

CHK 86143

13. Storage: Rate _____ NF Quantity _____ ac/ft Additional Rate _____ NF Additional Quantity _____ ac/ft

14. Limitation: _____ af/yr at _____ gpm (_____ cfs) when combined with file number(s) _____
 Limitation: _____ af/yr at _____ gpm (_____ cfs) when combined with file number(s) _____

15. 5YR Allocation: Allocation Type _____ Start Year _____ 5 YR Amount _____ Amount Unit _____ Base Acres _____ Comment _____

| 16. Place of Use CHK MOD DEL ENT | PUSE | S | T | R | ID | NE¼ | | | | NW¼ | | | | SW¼ | | | | SE¼ | | | | Total | Owner | Chg? | Overlap Files |
|--|-------|----|-----|-----|----|------|------|------|------|------|------|------|------|------|------|------|------|-------|-------|-------|-------|--------|-------|------|---------------|
| | | | | | | NE ¼ | NW ¼ | SW ¼ | SE ¼ | NE ¼ | NW ¼ | SW ¼ | SE ¼ | NE ¼ | NW ¼ | SW ¼ | SE ¼ | NE ¼ | NW ¼ | SW ¼ | SE ¼ | | | | |
| CHK | 9737 | 23 | 27S | 34W | 5 | | | | | 32.5 | 32.5 | 32.5 | 32.5 | | | | | 40 | 34.55 | 40 | 30 | 274.55 | 8a | N | MULTIPLE |
| CHK | 15176 | 35 | 27S | 34W | 1 | | | | | 31.5 | 31.5 | 31.5 | 31.5 | | | | | | | | | 126 | 8a | N | MULTIPLE |
| CHK | 23801 | 26 | 27S | 34W | 1 | 40 | 40 | 40 | 40 | | | | | | | | | 40 | | | 6 | 206 | 8a | N | MULTIPLE |
| ENT | 21098 | 21 | 27S | 34W | 2 | | | | | | | | | | | | | 33.75 | 33.75 | 33.75 | 33.75 | 135 | 8a | N | MULTIPLE |
| ENT | 38427 | 22 | 27S | 34W | 4 | | | | | | | | | 34 | 34 | 34 | 34 | | | | | | 8a | N | MULTIPLE |
| | | | | | | | | | | | | | | | | | | | | | | | | | |

Base Acres: Year: Minimum Reasonable Quantity:
 Comments: **CREATING A COMPLETE OVERLAP UNDER FILE NOS. 11299; 16645 (IRR); 16702; 20262; 21214 & 23650**

Garden City Field Office
4532 W. Jones, Suite B
Garden City, KS 67846



Phone: 620-276-2901
Fax: 620-276-9315
www.agriculture.ks.gov

Mike Beam, Secretary

Laura Kelly, Governor

September 15, 2021

DESERET CATTLE FEEDERS LLC
Attn: ARMANDO CABALLERO GM
521 RD 50
SATANTA, KS 67870

RE: Field Office Application for Change
Water Right, File Nos. 11299, 16645, 16702, 20262, 21214 & 23650

Dear Sir:

Enclosed are orders executed by the designee of the Chief Engineer, Division of Water Resources, Kansas Department of Agriculture, approving the applications for change under the above referenced file numbers.

Your attention is directed to the enclosures and to the terms, conditions, and limitations specified in this approval for change. A condition of this approval is that an acceptable water flow meter must be installed on the diversion works authorized under the referenced file number and meet current specifications. Please return the required notification of completion of the diversion works and/or installation of the required meter as soon as these actions are completed.

Since the orders modify the original documents referred to above, they should be recorded with the Register of Deeds as other instruments affecting real estate.

Should you have any questions, please feel free contact this office. If you would prefer, you could arrange an appointment for additional assistance.

Sincerely,

A handwritten signature in blue ink that reads "Michael A. Meyer".

Michael A. Meyer
Water Commissioner

MAM:am
enclosures

pc: GMD 3

CERTIFICATE OF SERVICE

On this 15th day of September 2021, I hereby certify that the foregoing Approval of Applications for Change in Place of Use, Water Right, File Nos. 11,299; 16,645; 16,702; 20262; 21,214 & 23,650 dated 15th day of September 2021 was mailed postage prepaid, first class, US mail to the following:

DESERET CATTLE FEEDERS LLC
Attn: ARMANDO CABALLERO GM
521 RD 50
SATANTA, KS 67870

Pc:

GROUNDWATER MANAGEMENT DISTRICT NO. 3



Division of Water Resources Staff

Submit completed application to:
 Kansas Department of Agriculture
 Division of Water Resources
 Field Office for your area.

Call for address:

Topeka -- (785) 296-5733
 Stafford -- (620) 234-5311
 Stockton -- (785) 425-6787
 Garden City -- (620) 276-2901

<http://agriculture.ks.gov/dwr>

DWR FIELD OFFICE APPLICATION FOR APPROVAL TO CHANGE THE PLACE OF USE AND/OR THE POINT OF DIVERSION



STATE OF KANSAS

Filing Fee Must Accompany the Application, K.S.A. 82a-708b(b), as amended.
 Fee Schedule is on the third page of this application form.

Paragraph Nos. 1, 2, 3 & 5 must be completed. Complete all other applicable portions. If change in point of diversion is greater than 100 feet, or if place of use will be changed, include a topographic map or detailed plat showing the authorized and proposed point(s) of diversion and/or place of use.

File No. 20262

RECEIVED

SEP 07 2021
 3:47 PM
 Garden City Field Office
 Division of Water Resources

1. Application is hereby made for approval of the Chief Engineer to change the (check one or both):

Place of Use Point of Diversion

under the water right which is the subject of this application in accordance with the conditions described below.

The source of supply is: Groundwater Surface water

2. Name and address of Applicant: DESERET CATTLE FEEDERS LLC

521 RD 50 SATANTA KS 67870

Phone Number: ()

Email address: _____

Name and address of Water Use Correspondent: SAME AS ABOVE

Phone Number: ()

Email address: _____

3. The presently authorized place of use is:

Owner of Land ---- NAME: DESERET CATTLE FEEDERS LLC

ADDRESS: 521 RD 50 SATANTA KS 67870

(If there is more than one landowner, attach supplemental sheets as necessary.)

| Sec. | Twp. | Range | NE¼ | | | | NW¼ | | | | SW¼ | | | | SE¼ | | | | TOTAL ACRES |
|------|------|-------|-----|-----|-----|-----|------|------|------|------|-----|-----|-----|-----|-----|-------|-----|-----|-------------|
| | | | NE¼ | NW¼ | SW¼ | SE¼ | NE¼ | NW¼ | SW¼ | SE¼ | NE¼ | NW¼ | SW¼ | SE¼ | NE¼ | NW¼ | SW¼ | SE¼ | |
| 23 | 27 | 34 | | | | | 32.5 | 32.5 | 32.5 | 32.5 | | | | | 40 | 34.55 | 40 | 30 | 274.55 |
| 35 | 27 | 34 | | | | | 31.5 | 31.5 | 31.5 | 31.5 | | | | | | | | | 126 |
| 26 | 27 | 34 | 40 | 40 | 40 | 40 | | | | | | | | | 40 | | | 6 | 206 |

4. If this application is for a change in place of use, it is proposed that the place of use be changed to:

Owner of Land ---- NAME: DESERET CATTLE FEEDERS LLC

ADDRESS: 521 RD 50 SATANTA KS 67870

(If there is more than one landowner, attach supplemental sheets as necessary.)

| Sec. | Twp. | Range | NE¼ | | | | NW¼ | | | | SW¼ | | | | SE¼ | | | | TOTAL ACRES |
|------|------|-------|-----|-----|-----|-----|------|------|------|------|-----|-----|-----|-----|-----|-------|-----|-----|-------------|
| | | | NE¼ | NW¼ | SW¼ | SE¼ | NE¼ | NW¼ | SW¼ | SE¼ | NE¼ | NW¼ | SW¼ | SE¼ | NE¼ | NW¼ | SW¼ | SE¼ | |
| 23 | 27 | 34 | | | | | 32.5 | 32.5 | 32.5 | 32.5 | | | | | 40 | 34.55 | 40 | 30 | 274.55 |
| 35 | 27 | 34 | | | | | 31.5 | 31.5 | 31.5 | 31.5 | | | | | | | | | 126 |
| 26 | 27 | 34 | 40 | 40 | 40 | 40 | | | | | | | | | 40 | | | 6 | 206 |

| |
|---|
| For Office Use Only: Code _____ Fee \$ <u>200.00</u> TR # _____ Receipt Date <u>9-7-2021</u> Check # <u>19805</u> |
|---|

5. **Presently authorized point of diversion:**
 One in the _____ Quarter of the _____ Quarter of the _____ Quarter
 of Section _____, Township _____ South, Range _____ (E/W),
 in _____ County, Kansas, _____ feet North _____ feet West of Southeast corner of section.
 Authorized Rate _____ Authorized Quantity _____ Depth of well _____ (feet)
 (DWR use only: Computer ID No. _____ GPS _____ feet North _____ feet West)
 This point will not be changed This point will be changed as follows: No change, point better described with GPS as follows:
Proposed point of diversion: (Complete only if change is requested or if existing point is better described by GPS)
 One in the _____ Quarter of the _____ Quarter of the _____ Quarter
 of Section _____, Township _____ South, Range _____ (E/W),
 in _____ County, Kansas, _____ feet North _____ feet West of Southeast corner of section.
 Proposed Rate _____ Proposed Quantity _____ Proposed well depth (feet) _____
 This point is: Additional Well Geo Center List other water rights that will use this point _____

6. **Presently authorized point of diversion:**
 One in the _____ Quarter of the _____ Quarter of the _____ Quarter
 of Section _____, Township _____ South, Range _____ (E/W),
 in _____ County, Kansas, _____ feet North _____ feet West of Southeast corner of section.
 Authorized Rate _____ Authorized Quantity _____ Depth of well _____ (feet)
 (DWR use only: Computer ID No. _____ GPS _____ feet North _____ feet West)
 This point will not be changed This point will be changed as follows: No change, point better described with GPS as follows:
Proposed point of diversion: (Complete only if change is requested or if existing point is better described by GPS)
 One in the _____ Quarter of the _____ Quarter of the _____ Quarter
 of Section _____, Township _____ South, Range _____ (E/W),
 in _____ County, Kansas, _____ feet North _____ feet West of Southeast corner of section.
 Proposed Rate _____ Proposed Quantity _____ Proposed well depth (feet) _____
 This point is: Additional Well Geo Center List other water rights that will use this point _____

7. The changes herein are desired for the following reasons?
 (please be specific) _____

8. If a well, is the test hole log attached? Yes No

9. The change(s) (was)(will be) completed by?

10. If the point of diversion is a well:
 (a) What are you going to do with the old well?

 (b) When will this be done? _____

11. Groundwater Management District recommendation attached?
 Yes No

12. Assisted by _____

13a. If the proposed point of diversion will be relocated more than 300 feet but within 2,640 feet of the existing point of diversion, attach a topographic map or aerial photograph. For groundwater sources, show all wells (including domestic) within one-half mile of the proposed point of diversion and the names and mailing addresses of the owners. For surface water sources, show the names and addresses of the landowner(s) one-half mile downstream and one-half mile upstream from your property lines

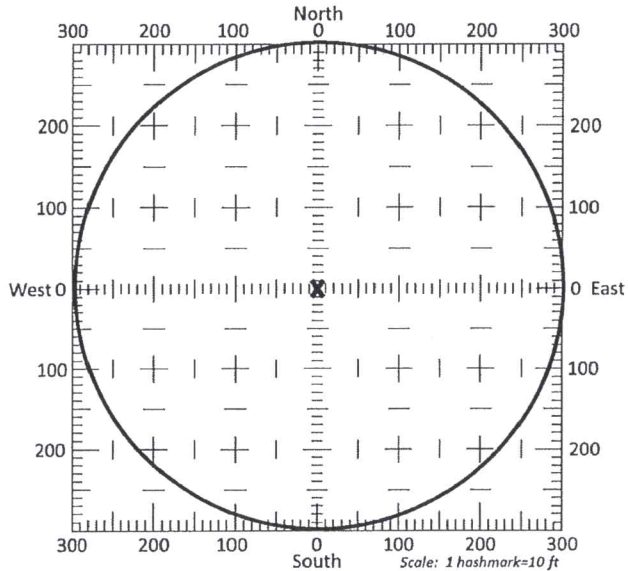

13b. If the proposed point of diversion will be relocated within a 300 foot radius of the existing point of diversion, indicate its location on the diagram shown above in relation to the existing point of diversion. The proposed point of diversion must be located within the circle shown above. (PLEASE NOTE: The "X" in center of diagram above represents the presently authorized point of diversion.)

14. If the proposed groundwater point of diversion is 300 or fewer feet from the existing point of diversion, complete the following:
- (a) Does the undersigned represent all owners of the currently authorized place(s) of use identified in this application?
 Yes No (If no, all owners must sign this application.)
 - (b) Will the ownership interest of any owner of the currently authorized place(s) of use identified in this application be adversely affected if this application is approved as requested?
 Yes No (If yes, all owners must sign this application.)
 - (c) If this application is not approved expeditiously, will there be substantial damage to property, public health or safety?
 Yes No (If no, all owners must sign this application.)

If the application proposes a surface water change in point of diversion, a groundwater change in point of diversion greater than 300 feet, or a change in place of use, the application must be signed by all owners of the currently authorized place of use, or their duly authorized agent (attach notarized statement authorizing representation).

I hereby verify, being first duly sworn upon my oath or affirmation and under penalty of perjury, that I am of lawful age and the owner, the spouse of the owner, or a duly authorized agent of the owner(s) to make this application on their behalf, in regards to the water right(s) to which this application pertains. I further verify that the statements contained in this application are true, correct and complete.

Dated at SLE, ^{Utah} Kansas, this 2 day of September, 2021.

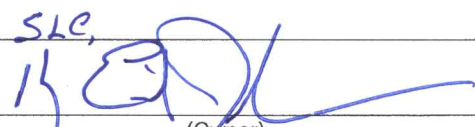
| | |
|--|---|
| <p> _____ (Owner)</p> <p><u>K. Erik Jacobsen</u> _____ (Please Print)</p> <p>_____ (Owner)</p> <p>_____ (Please Print)</p> <p>_____ (Owner)</p> <p>_____ (Please Print)</p> | <p>_____ (Spouse)</p> <p>_____ (Please Print)</p> <p>_____ (Spouse)</p> <p>_____ (Please Print)</p> <p>_____ (Spouse)</p> <p>_____ (Please Print)</p> <p>_____ (Spouse)</p> <p>_____ (Please Print)</p> |
|--|---|

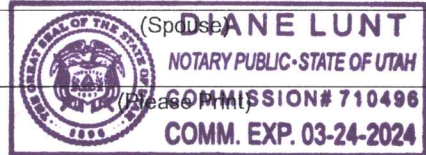

State of ^{Utah} ~~Kansas~~ }
 County of Salt Lake } SS

I hereby certify that the foregoing application was signed in my presence and sworn to before me this 2 day of September, 2021.



 Notary Public

My Commission Expires 03-24-2024.

ONLY COMPLETE APPLICATIONS WILL BE PROCESSED. To be complete, all of the applicable portions of the application form must be completed with accurate information; maps, if necessary, must be included; signatures of all the appropriate owners' must be affixed to the application and notarized; and the appropriate fee must be paid.

FEE SCHEDULE

Each application to change the place of use or the point of diversion under this section shall be accompanied by the application fee set forth in the schedule below: Make checks payable to: **Kansas Department of Agriculture**

| | |
|---|-------|
| (1) Application to change a point of diversion 300 feet or less | \$100 |
| (2) Application to change a point of diversion more than 300 feet | \$200 |
| (3) Application to change the place of use | \$200 |

SUMMARY ORDER APPROVING APPLICATION FOR CHANGE AND IMPOSING CONDITIONS

This Summary Order is issued under authority of K.S.A. 82a-708b, as amended, and K.A.R. 5-5-1, *et seq.* and other applicable provisions of the *Kansas Water Appropriation Law, K.S.A. 82a-701 et seq.*, and rules and regulations promulgated thereunder, With the exception of those conditions expressly contained herein, this Summary Order does not change the terms, conditions and limitations of File No. 20,262.

1. A change application was received on September 7, 2021 requesting that the place of use and / or point of diversion authorized under the above-referenced file number be changed as described in the application.
2. On and after the effective date of this summary order, the authorized place(s) of use shall be located substantially as shown on the topographic map accompanying the application to change the place of use. Applicable Not Applicable
3. The change in point of diversion shall not impair existing rights and shall be limited to the same source or sources of water as previously authorized. The point of diversion authorized by this summary order shall be located within a foot radius of the authorized point(s) of diversion. Applicable Not Applicable
4. The point(s) of diversion described herein is administratively corrected to be more accurately described using the Global Positioning System (GPS), as described in the application. Applicable Not Applicable
5. The point(s) of diversion authorized herein shall not actually be located more than feet from the previously authorized point(s) of diversion. Applicable Not Applicable
6. As required by K.A.R. 5-3-5d, if the works for diversion is a well with a diversion rate of 100 gallons per minute or more, a tube or other device suitable for making water level measurements shall be installed, operated and maintained in accordance with K.A.R. 5-6-13. Applicable Not Applicable
7. **The owner of the authorized place(s) of use shall properly install an acceptable water flow meter on or before December 31, 2021, or before the first use of water, whichever occurs first.** The water flow meter shall be installed, operated and maintained in accordance with K.A.R. 5-1-4 through 5-1-12. As required by K.S.A. 82a-732, as amended, and K.A.R. 5-3-5e, the owner shall maintain records and report the reading of the water flow meter and the total quantity of water diverted annually to the Chief Engineer by March 1 following the end of each calendar year. Applicable Not Applicable
8. **Installation of the works for diversion of water shall be completed on or before December 31, 20 , or within any authorized extension of time.** By March 1, 20 the applicant shall notify the Chief Engineer that construction of the works for diversion has been completed, on the form provided by the Chief Engineer, as required by K.A.R. 5-8-4e. Applicable Not Applicable
9. **The completed well log shall be submitted with the required notice.** Applicable Not Applicable
10. All diversion works into which any type of chemical or other foreign substance will be injected into the water shall be equipped with an in-line, automatic, quick-closing check valve capable of preventing pollution of the source of the water supply. The check valve(s) shall be installed, operated and maintained in accordance with K.A.R. 5-3-5c. Applicable Not Applicable
11. Additional Conditions are attached. Yes No
12. In accordance with K.S.A. 82a-708a, as amended, and K.A.R. 5-5-14, all of the owners of the authorized place(s) of use of water appropriated under the above-referenced file number are responsible for compliance with its terms, conditions and limitations, as amended and/or supplemented by this Summary Order, and with applicable provisions of the *Kansas Water Appropriation Law* and the *Rules and Regulations* promulgated thereunder. Failure to comply with these provisions may result in civil penalties pursuant to K.S.A. 82a-737, as amended, and/or the suspension or revocation and dismissal of the water or appropriation right or any other enforcement actions authorized by law.

Administrative Appeal and Effective Date of Order

If you are aggrieved by this order, pursuant to K.S.A. 82a-1901, you may request an evidentiary hearing before the Chief Engineer or request administrative review by the Secretary of Agriculture. A request for hearing by the Chief Engineer must be filed within **15 days** of service of this Order and a request for administrative review by the Secretary must be filed within **30 days** pursuant to K.S.A. 77-531. Any request for administrative review must state a basis for review pursuant to K.S.A. 77-527. File any request with **Kansas Department of Agriculture, Legal Division, 1320 Research Park Drive, Manhattan, KS 66502.** Failure to timely request a hearing or review may preclude review under the Kansas Judicial Review Act.

For Use by Register of Deeds

FOR OFFICE USE ONLY
**APPLICATION APPROVED AND
SUMMARY ORDER ISSUED**

By: Michael A. Meyer
Duly Authorized Designee of the Chief Engineer

(Print Name): MICHAEL A. MEYER
Division of Water Resources - Kansas Department of Agriculture

Date of Issuance: September 15, 2021

State of Kansas)

County of Ginnery) SS

Acknowledged before me on September 15, 2021
by Michael A. Meyer

Signature: Julie Jones
Notary Public

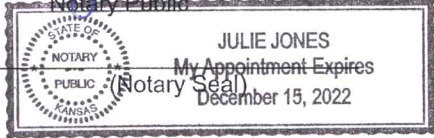

My commission expires: December 15, 2022
(Notary Seal)

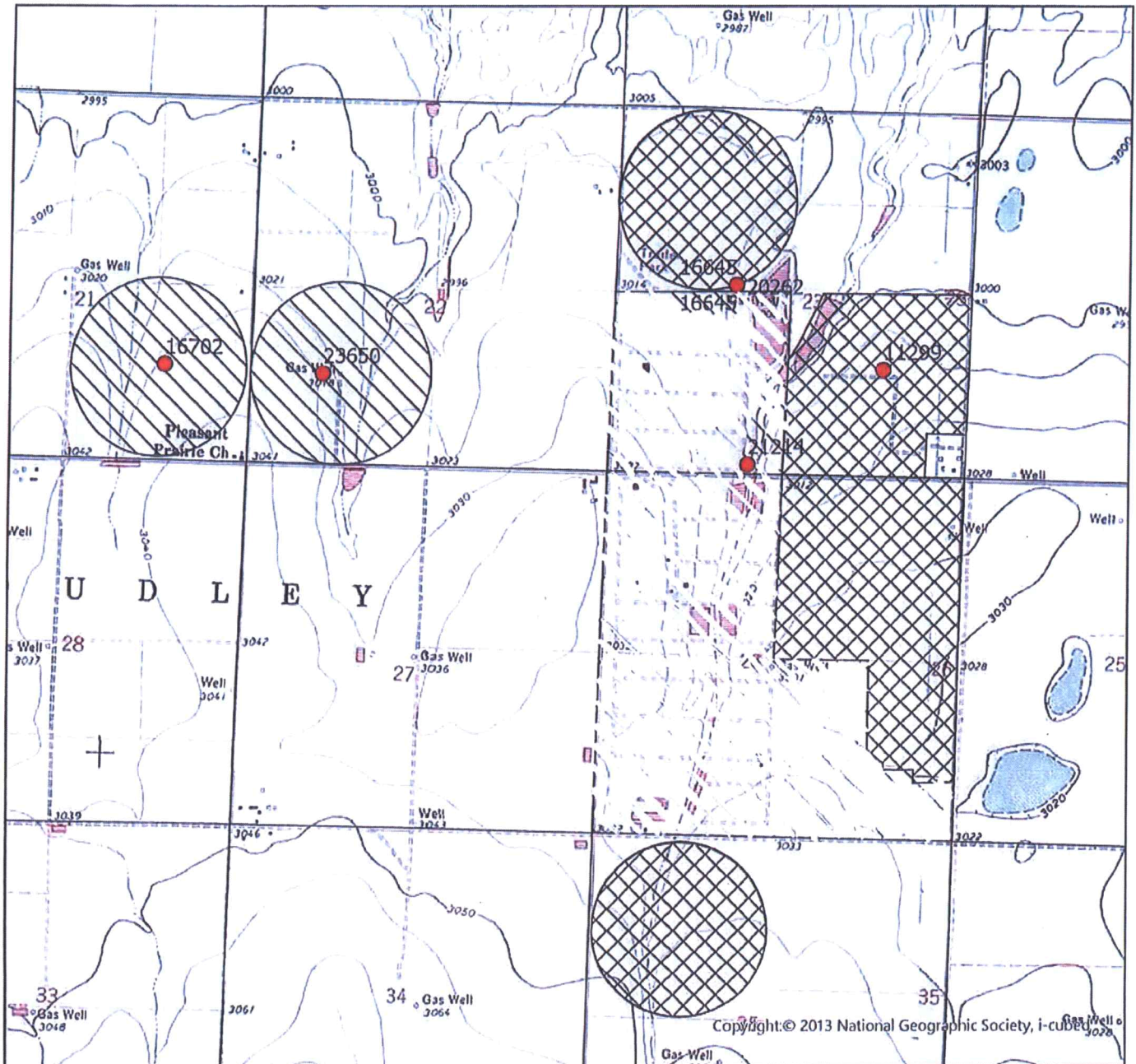

CHANGE IN PLACE OF USE WATER RIGHT, FILE NO. 20262

Section 23 Township 27 South Range 34 West Haskell County



| | |
|---|-------------------------|
|  | Authorized Place of Use |
|  | Proposed Place of Use |



(Signature) _____ Date _____

Date: 8/9/21 HH/GCFO
Scale: 1:24,000

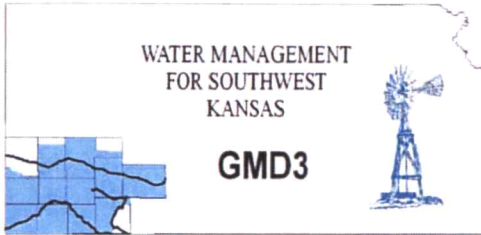

Southwest Kansas
Groundwater Management District No. 3
2009 E. Spruce Street
Garden City, Kansas 67846
(620) 275-7147 phone (620) 275-1431 fax
www.gmd3.org

September 10, 2021

Michael A. Meyer
Division of Water Resources
4532 W Jones Ave., Suite B
Garden City, Kansas 67846

RE: Applications for Change in Place of Use
Water Right, File Nos. 11299, 16645, 16702, 20262, 21214 & 23650

Dear Mike:

We have reviewed the applications for the above referenced water rights. The proposal is not in conflict with the Management Program of the Southwest Kansas Groundwater Management District No. 3 (GMD3). The proposed change in place of use will make a complete overlap in place of use in irrigated acres, with no new acres being proposed, which is in accordance with K.A.R. 5-5-11. It is therefore recommended that the applications be approved at this time.

Thank you for the opportunity to review the applications and to provide a recommendation. If you have any questions, please don't hesitate to contact us.

Sincerely,

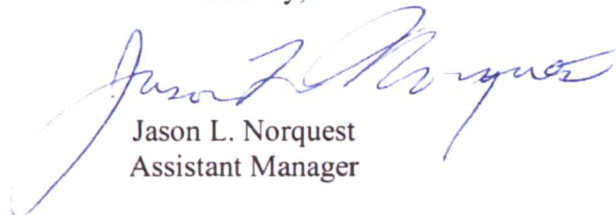

Jason L. Norquest
Assistant Manager

RECEIVED

SEP 10 2021

Garden City Field Office
Division of Water Resources

GMD3 Change Review

File No(s): 11299, 16645, 16702, 20262, 21214 & 23650.

DWR office: GC.

App filed to change: PU.

Is Landowner(s) correct in WRIS: Desert Cattle Feeders LLC.

If NO, is documentation included?

Is Water Use Correspondent correct in WRIS? .

If NO, is documentation included?

Regulation(s) Reviewed: KAR 5-5-11

Point of diversion ID No(s) being changed.

| | ft. North | ft. West | |
|---------------|-----------|----------|---|
| Authorized PD | | | |
| Proposed PD | | | |
| Difference | 0 | 0 | |
| a2 + b2 = c2 | 0 | 0 | 0 |

GPS for proposed PD: Lat: Long: .

Is proposed PD stacking on existing WRs? No Change to any PD.

Is Proposed PU overlapping existing WRs? Proposed complete overlap for WRs on IRR acres.

Neighboring certified well(s) notified: .

Name .

Address .

Zip .

Email: . Phone: .

Domestic well(s) notified: .

Name .

Address .

Zip .

Base Acres: .

Perfected Acres: .

Irr. Return-Flow %

Currently authorized acres: 11299, 16645, 20262, 21214

274.55 acres, NW & SE 23-27-34

206 acres, NE & SE 26-27-34

126 acres, NW 35-27-34

Currently authorized acres: 23650

136 acres, SW 22-27-34

Currently authorized acres: 16702

135 acres, SE 21-27-34

ALL water rights list the above acres as proposed IRR acres.

16645 shows the feedlot as place of use since also lists STK use on the water right.

GMD3 Change Review

Is a waiver needed: Complete overlap in current authorized IRR acres, no new acres proposed. Applicant does have easement agreement to run water to all acres that are not directly connected.

Recommendation: After review of all available information, it appears current area rules are met. Staff therefore recommends approval of the applications.



RECEIVED

SEP 10 2021

Garden City Field Office
Division of Water Resources

Garden City Field Office
4532 W. Jones, Suite B
Garden City, KS 67846



Phone: 620-276-2901
Fax: 620-276-9315
www.agriculture.ks.gov

Mike Beam, Secretary

Laura Kelly, Governor

September 9, 2021

SOUTHWEST KANSAS GROUNDWATER
MANAGEMENT DISTRICT NO. 3
2009 E SPRUCE ST
GARDEN CITY KS 67846

Re: Request for Recommendation
Water Right, File Nos. 11299, 16645, 16702, 20262, 21214, 23650

Dear Mr. Norquest:

This is to advise you that Deseret Cattle Feeders LLC, have filed applications for approval of the Chief Engineer, Division of Water Resources, Kansas Department of Agriculture, to change the place of use.

We are delaying action on the change application to allow you time to review and provide a recommendation. Please submit a recommendation within 15 days from the date of this letter.

Thank you and as always feel free to contact this office at any time.

Sincerely,

A handwritten signature in blue ink that reads "Michael A. Meyer". The signature is fluid and cursive, with a long horizontal flourish extending to the right.

Michael A. Meyer
Water Commissioner

MAM
Enclosures