

Kansas Department of Agriculture  
 Division of Water Resources  
**CHANGE: P/U WORKSHEET**

1. File Number: <b>22507</b>	2. Status Change Date:	3. Change Num: <b>C1</b>	4. Field Office: <b>4</b>	5. GMD: <b>3</b>
---------------------------------	------------------------	-----------------------------	------------------------------	---------------------

6. Status: <input checked="" type="checkbox"/> Approved <input type="checkbox"/> Denied by DWR/GMD <input type="checkbox"/> Dismiss by Request/Failure to Return	7. Filing Date of Change: <b>11/3/2021</b>
--	---

8a. Applicant(s)                      Person ID <u><b>16762</b></u> New to system <input type="checkbox"/> Add Seq# _____  <b>RAY ALLEN SMITH</b> <b>5505 S RD</b> <b>INGALLS, KS 67853-9072</b>	8c. Landowner(s)                      Person ID <u><b>16711</b></u> New to system <input type="checkbox"/> Add Seq# _____  <b>HERMAN J &amp; LENA SMITH TRUST</b> <b>Attn: HERMAN &amp; LENA SMITH TTEES</b> <b>15203 3 RD</b> <b>INGALLS, KS 67853</b>
---	---

8b. Landowner(s)                      Person ID _____ New to system <input type="checkbox"/> Add Seq# _____  <b>8a</b>	8d. WUC                                      Person ID _____ New to system <input type="checkbox"/> Add Seq# _____  <b>8a</b>
---	--

9. Documents and Enclosure(s):  DWR Meter(s) Date to Comply: **12/31/2022**     N & P Date to Comply: **3/1/2023**

Anti-Reverse Meter     Meter Seal     Check Valve     N & P Form     Water Tube     Driller Copy     H & E Letter

Conservation Plan    Date Required: \_\_\_\_\_    Date Approved: \_\_\_\_\_    Date to Comply: \_\_\_\_\_

10. Use Made of Water    From: \_\_\_\_\_    To: \_\_\_\_\_

Date Prepared: **11/23/2021**    By: **AM**  
 Date Entered: \_\_\_\_\_    By: \_\_\_\_\_

File No. **22507**      11. County: **GY**      Basin: **ARKANSAS RIVER**      Stream:      Formation Code: **211**      Special Use:

12. Points of Diversion  
 Rate and Quantity  
 Authorized      Additional  
 Rate      Quantity      Rate      Quantity  
 gpm/cfs      af/mgy      gpm/cfs      af/mgy      Overlap PD Files

CHK	MOD	DEL	ENT	PDIV	Qualifier	S	T	R	ID	'N	'W	Comment (AKA Line)	Rate gpm/cfs	Quantity af/mgy	Rate gpm/cfs	Quantity af/mgy	Overlap PD Files
<b>CHK</b>					<b>65525</b>												

13. Storage: Rate \_\_\_\_\_ NF      Quantity \_\_\_\_\_ ac/ft      Additional Rate \_\_\_\_\_ NF      Additional Quantity \_\_\_\_\_ ac/ft

14. Limitation: \_\_\_\_\_ af/yr at \_\_\_\_\_ gpm ( \_\_\_\_\_ cfs) when combined with file number(s) \_\_\_\_\_  
 Limitation: \_\_\_\_\_ af/yr at \_\_\_\_\_ gpm ( \_\_\_\_\_ cfs) when combined with file number(s) \_\_\_\_\_

15. 5YR Allocation:      Allocation Type \_\_\_\_\_      Start Year \_\_\_\_\_      5 YR Amount \_\_\_\_\_      Amount Unit \_\_\_\_\_      Base Acres \_\_\_\_\_      Comment \_\_\_\_\_

16. Place of Use CHK MOD DEL ENT	PUSE	S	T	R	ID	NE¼				NW¼				SW¼				SE¼				Total	Owner	Chg?	Overlap Files
						NE ¼	NW ¼	SW ¼	SE ¼	NE ¼	NW ¼	SW ¼	SE ¼	NE ¼	NW ¼	SW ¼	SE ¼	NE ¼	NW ¼	SW ¼	SE ¼				
<b>ENT</b>	<b>26827</b>	<b>2</b>	<b>27S</b>	<b>30W</b>	<b>1</b>					<b>40</b>	<b>32</b>	<b>40</b>	<b>40</b>					<b>34</b>	<b>34</b>	<b>34</b>	<b>34</b>	<b>288</b>	<b>8a</b>	<b>N</b>	<b>MULTIPLE</b>
<b>CHK</b>	<b>39415</b>	<b>2</b>	<b>27S</b>	<b>30W</b>	<b>2</b>									<b>34</b>	<b>34</b>	<b>34</b>	<b>34</b>					<b>136</b>	<b>8c</b>	<b>N</b>	<b>MULTIPLE</b>

Base Acres:      Year:      Minimum Reasonable Quantity:  
 Comments: **OVERLAPPING PU FILES: 19765; 22507 & 27260 NOTE: COMBINE PU IDS 26827 (KEEP) & 32861 (DELETE)**

Garden City Field Office  
4532 W. Jones, Suite B  
Garden City, KS 67846



Phone: 620-276-2901  
Fax: 620-276-9315  
www.agriculture.ks.gov

Mike Beam, Secretary

Laura Kelly, Governor

November 23, 2021

RAY ALLEN SMITH  
5505 S RD  
INGALLS, KS 67853-9072

RE: Filed Office Application for Change  
Water Right, File Nos. 19765; 22507 & 27260

Dear Sir or Madam:

Enclosed is the order executed by the designee of the Chief Engineer, Division of Water Resources, Kansas Department of Agriculture, approving the application for change under the above referenced file numbers.

Your attention is directed to the enclosures and to the terms, conditions, and limitations specified in this approval for change. A condition of this approval is that an acceptable water flow meter must be installed on the diversion works authorized under the referenced file number and meet current specifications. Please return the required notification of completion of the diversion works and/or installation of the required meter as soon as these actions are completed.

Since the order modifies the original document referred to above, it should be recorded with the Register of Deeds as other instruments affecting real estate.

Should you have any questions, please feel free contact this office. If you would prefer, you could arrange an appointment for additional assistance.

Sincerely,

A handwritten signature in blue ink, appearing to read "Austin J. McColloch".

Austin J. McColloch  
Assistant Water Commissioner

AM:  
enclosures

pc: Herman & Lena Smith Trust  
GROUNDWATER MANAGEMENT DISTRICT NO. 3

### CERTIFICATE OF SERVICE

On this 23<sup>rd</sup> day of November, 2021, I hereby certify that the foregoing Approval of Application for Change in Place of Use, Water Right, File Nos. 19,765; 22,507 & 27,260 dated 23<sup>rd</sup> day of November, 2021 was mailed postage prepaid, first class, US mail to the following:

RAY ALLEN SMITH  
5505 S RD  
INGALLS, KS 67853-9072

Pc:

HERMAN J & LENA SMITH TRUST  
Attn: HERMAN & LENA SMITH TTEES  
15203 3 RD  
INGALLS, KS 67853

GROUNDWATER MANAGEMENT DISTRICT NO. 3

  
\_\_\_\_\_  
Division of Water Resources Staff

Submit completed application to:  
 Kansas Department of Agriculture  
 Division of Water Resources  
 Field Office for your area.

Call for address:

Topeka -- (785) 296-5733  
 Stafford -- (620) 234-5311  
 Stockton -- (785) 425-6787  
 Garden City -- (620) 276-2901  
<http://agriculture.ks.gov/dwr>

## DWR FIELD OFFICE APPLICATION FOR APPROVAL TO CHANGE THE PLACE OF USE AND/OR THE POINT OF DIVERSION



STATE OF KANSAS

**Filing Fee Must Accompany the Application, K.S.A. 82a-708b(b), as amended.**  
 Fee Schedule is on the third page of this application form.

**Paragraph Nos. 1, 2, 3 & 5 must be completed. Complete all other applicable portions.** If change in point of diversion is greater than 100 feet, or if place of use will be changed, include a topographic map or detailed plat showing the authorized and proposed point(s) of diversion and/or place of use.

**RECEIVED**  
 4:31 PM  
 NOV 03 2021

File No. 22507

1. Application is hereby made for approval of the Chief Engineer to change the (check one or both):

Place of Use                       Point of Diversion

under the water right which is the subject of this application in accordance with the conditions described below.

The source of supply is:                       Groundwater                       Surface water

Garden City Field Office  
 Division of Water Resources

2. Name and address of Applicant: RAY ALLEN SMITH

5505 S RD INGALLS KS 67853-9072

Phone Number: (    )                      Email address: \_\_\_\_\_

Name and address of Water Use Correspondent: SAME AS ABOVE

Phone Number: (    )                      Email address: \_\_\_\_\_

3. The presently authorized place of use is:

Owner of Land ---- NAME: SAME AS ABOVE - NO CHANGE

ADDRESS: \_\_\_\_\_

(If there is more than one landowner, attach supplemental sheets as necessary.)

Sec.	Twp.	Range	NE¼				NW¼				SW¼				SE¼				TOTAL ACRES
			NE¼	NW¼	SW¼	SE¼	NE¼	NW¼	SW¼	SE¼	NE¼	NW¼	SW¼	SE¼	NE¼	NW¼	SW¼	SE¼	
2	27S	30W									34	34	34	34					136

4. If this application is for a change in place of use, it is proposed that the place of use be changed to:

Owner of Land ---- NAME: SAME AS ABOVE - NO CHANGE // HERMAN J & LENA SMITH TRUST (RAY SMITH TRUSTEE)

ADDRESS: \_\_\_\_\_

(If there is more than one landowner, attach supplemental sheets as necessary.)

Sec.	Twp.	Range	NE¼				NW¼				SW¼				SE¼				TOTAL ACRES
			NE¼	NW¼	SW¼	SE¼	NE¼	NW¼	SW¼	SE¼	NE¼	NW¼	SW¼	SE¼	NE¼	NW¼	SW¼	SE¼	
2	27S	30W					40	32	40	40	34	34	34	34	34	34	34	34	424

For Office Use Only: Code \_\_\_\_\_ Fee \$ 200.00 TR # \_\_\_\_\_ Receipt Date 11-3-21 Check # 4934

5. **Presently authorized point of diversion:**  
 One in the \_\_\_\_\_ Quarter of the \_\_\_\_\_ Quarter of the \_\_\_\_\_ Quarter  
 of Section \_\_\_\_\_, Township \_\_\_\_\_ South, Range \_\_\_\_\_ (W),  
 in \_\_\_\_\_ County, Kansas, \_\_\_\_\_ feet North \_\_\_\_\_ feet West of Southeast corner of section.  
 Authorized Rate \_\_\_\_\_ Authorized Quantity \_\_\_\_\_ Depth of well \_\_\_\_\_ (feet)  
**(DWR use only: Computer ID No. \_\_\_\_\_ GPS \_\_\_\_\_ feet North \_\_\_\_\_ feet West)**  
 This point will not be changed  This point will be changed as follows:  No change, point better described with GPS as follows:  
**Proposed point of diversion: (Complete only if change is requested or if existing point is better described by GPS)**  
 One in the \_\_\_\_\_ Quarter of the \_\_\_\_\_ Quarter of the \_\_\_\_\_ Quarter  
 of Section \_\_\_\_\_, Township \_\_\_\_\_ South, Range \_\_\_\_\_ (W),  
 in \_\_\_\_\_ County, Kansas, \_\_\_\_\_ feet North \_\_\_\_\_ feet West of Southeast corner of section.  
 Proposed Rate \_\_\_\_\_ Proposed Quantity \_\_\_\_\_ Proposed well depth (feet) \_\_\_\_\_  
 This point is:  Additional Well  Geo Center List other water rights that will use this point \_\_\_\_\_

6. **Presently authorized point of diversion:**  
 One in the \_\_\_\_\_ Quarter of the \_\_\_\_\_ Quarter of the \_\_\_\_\_ Quarter  
 of Section \_\_\_\_\_, Township \_\_\_\_\_ South, Range \_\_\_\_\_ (W),  
 in \_\_\_\_\_ County, Kansas, \_\_\_\_\_ feet North \_\_\_\_\_ feet West of Southeast corner of section.  
 Authorized Rate \_\_\_\_\_ Authorized Quantity \_\_\_\_\_ Depth of well \_\_\_\_\_ (feet)  
**(DWR use only: Computer ID No. \_\_\_\_\_ GPS \_\_\_\_\_ feet North \_\_\_\_\_ feet West)**  
 This point will not be changed  This point will be changed as follows:  No change, point better described with GPS as follows:  
**Proposed point of diversion: (Complete only if change is requested or if existing point is better described by GPS)**  
 One in the \_\_\_\_\_ Quarter of the \_\_\_\_\_ Quarter of the \_\_\_\_\_ Quarter  
 of Section \_\_\_\_\_, Township \_\_\_\_\_ South, Range \_\_\_\_\_ (W),  
 in \_\_\_\_\_ County, Kansas, \_\_\_\_\_ feet North \_\_\_\_\_ feet West of Southeast corner of section.  
 Proposed Rate \_\_\_\_\_ Proposed Quantity \_\_\_\_\_ Proposed well depth (feet) \_\_\_\_\_  
 This point is:  Additional Well  Geo Center List other water rights that will use this point \_\_\_\_\_

7. The changes herein are desired for the following reasons?  
 (please be specific) MAKE A COMPLETE OVERLAP  
IN PLACE OF USE WITH FILE NOS. 19765; 22507 &  
27260

8. If a well, is the test hole log attached?  Yes  No

9. The change(s) (was)(will be) completed by?  
UPON APPROVAL

10. If the point of diversion is a well:  
 (a) What are you going to do with the old well?  
N / A  
 (b) When will this be done? N / A

11. Groundwater Management District recommendation attached?  
 Yes  No

12. Assisted by AM / GCFO

13a. If the proposed point of diversion will be relocated more than 300 feet but within 2,640 feet of the existing point of diversion, attach a topographic map or aerial photograph. For groundwater sources, show all wells (including domestic) within one-half mile of the proposed point of diversion and the names and mailing addresses of the owners. For surface water sources, show the names and addresses of the landowner(s) one-half mile downstream and one-half mile upstream from your property lines

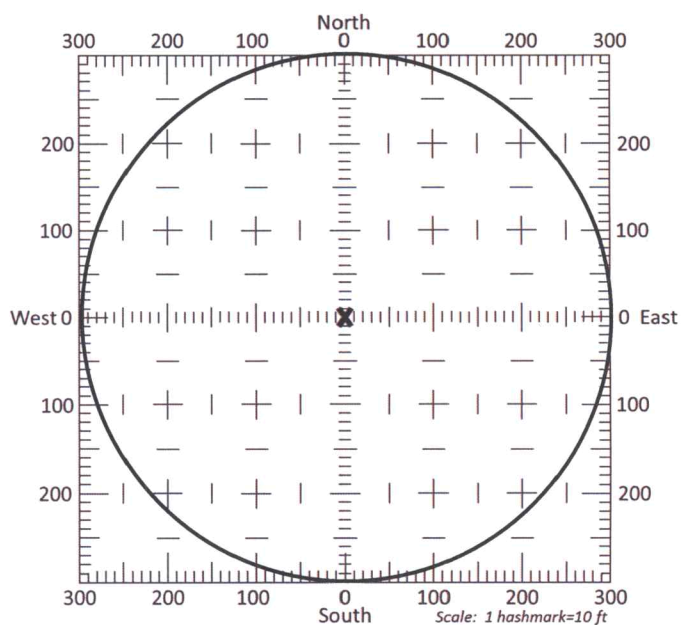

13b. If the proposed point of diversion will be relocated within a 300 foot radius of the existing point of diversion, indicate its location on the diagram shown above in relation to the existing point of diversion. The proposed point of diversion must be located within the circle shown above. (PLEASE NOTE: The "X" in center of diagram above represents the presently authorized point of diversion.)

14. If the proposed groundwater point of diversion is 300 or fewer feet from the existing point of diversion, complete the following:

- (a) Does the undersigned represent all owners of the currently authorized place(s) of use identified in this application?  
 Yes     No    (If no, all owners must sign this application.)
- (b) Will the ownership interest of any owner of the currently authorized place(s) of use identified in this application be adversely affected if this application is approved as requested?  
 Yes     No    (If yes, all owners must sign this application.)
- (c) If this application is not approved expeditiously, will there be substantial damage to property, public health or safety?  
 Yes     No    (If no, all owners must sign this application.)

If the application proposes a surface water change in point of diversion, a groundwater change in point of diversion greater than 300 feet, or a change in place of use, the application must be signed by all owners of the currently authorized place of use, or their duly authorized agent (attach notarized statement authorizing representation).

I hereby verify, being first duly sworn upon my oath or affirmation and under penalty of perjury, that I am of lawful age and the owner, the spouse of the owner, or a duly authorized agent of the owner(s) to make this application on their behalf, in regards to the water right(s) to which this application pertains. I further verify that the statements contained in this application are true, correct and complete.

Dated at Warden City, Kansas, this 3rd day of November, 2021.

<u>Ray A Smith</u> (Owner)	_____	(Spouse)
<u>Ray A Smith</u> (Please Print)	_____	(Please Print)
_____	_____	(Spouse)
_____	_____	(Please Print)
_____	_____	(Spouse)
_____	_____	(Please Print)

State of Kansas }  
County of Finney } SS

I hereby certify that the foregoing application was signed in my presence and sworn to before me this 3rd day of November, 2021.

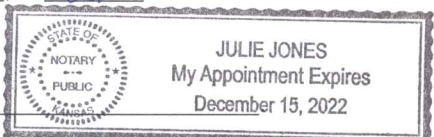

Julie Jones  
Notary Public

My Commission Expires \_\_\_\_\_

**ONLY COMPLETE APPLICATIONS WILL BE PROCESSED.** To be complete, all of the applicable portions of the application form must be completed with accurate information; maps, if necessary, must be included; signatures of all the appropriate owners' must be affixed to the application and notarized; and the appropriate fee must be paid.

**FEE SCHEDULE**

Each application to change the place of use or the point of diversion under this section shall be accompanied by the application fee set forth in the schedule below: Make checks payable to: **Kansas Department of Agriculture**

- (1) Application to change a point of diversion 300 feet or less ..... \$100
- (2) Application to change a point of diversion more than 300 feet ..... \$200
- (3) Application to change the place of use ..... \$200





# CHANGE IN PLACE OF USE WATER RIGHT, FILE NO. 22507

Township 27 South Range 30 West Gray County

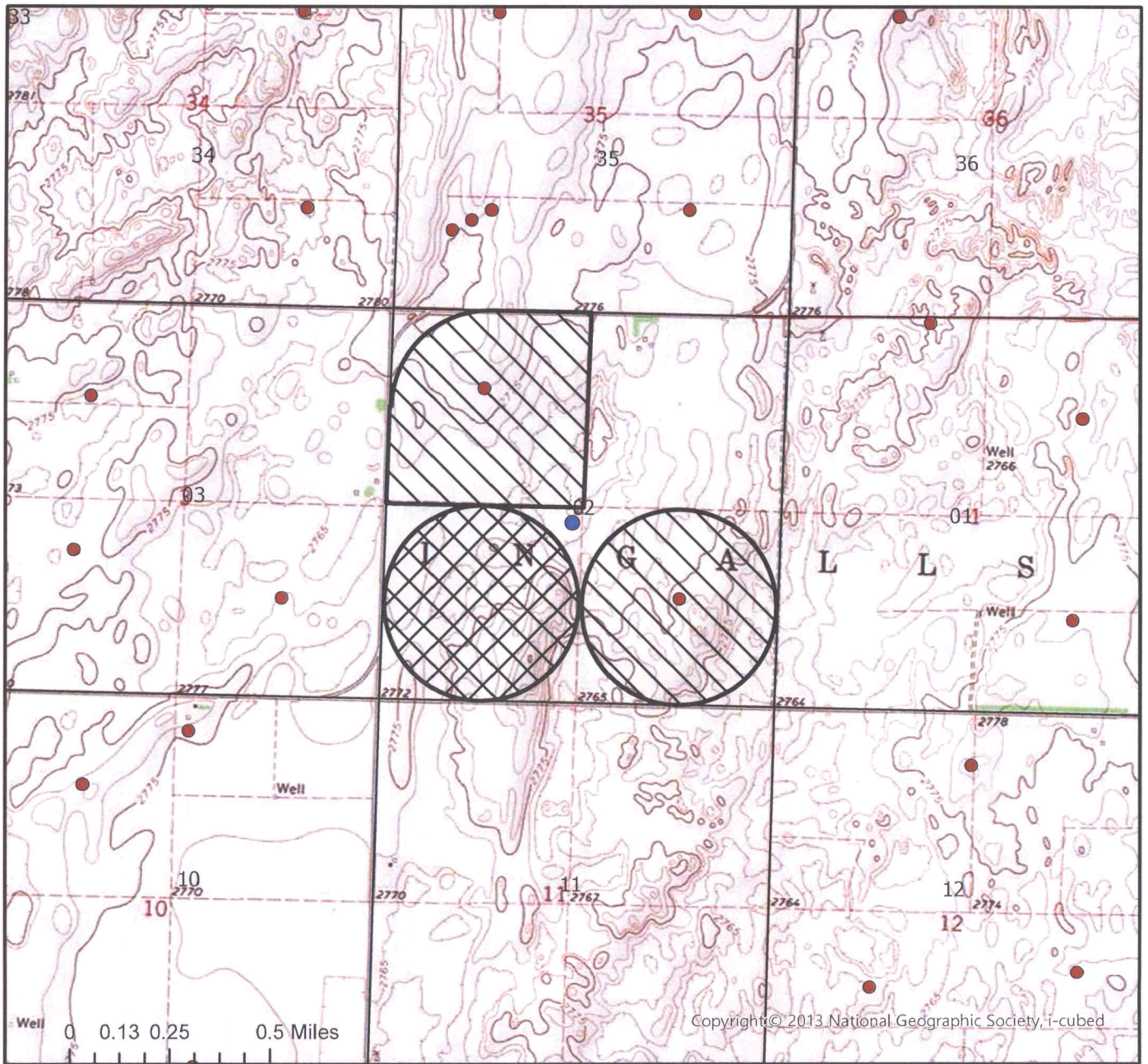

- Authorized Point of Diversion
- Permitted Water Right
- ★ Domestic Well within 1/2 mile
- Authorized Place of Use
- Proposed Place of Use

List of owner name and addresses within 1/2 mile:



By signing below I agree that all wells, including domestic, and owners names and addresses within 1/2 mile of the proposed point of diversion have been shown on the map

(Signature)

Date

Date AM/GCFO  
1:24,000 Scale

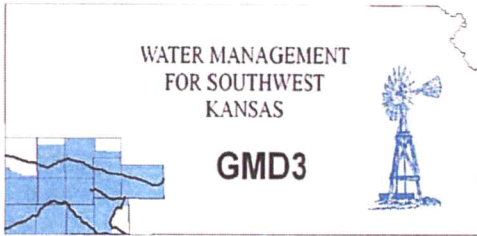

Southwest Kansas  
Groundwater Management District No. 3  
2009 E. Spruce Street  
Garden City, Kansas 67846  
(620) 275-7147 phone (620) 275-1431 fax  
www.gmd3.org

November 12, 2021

Austin J McColloch  
Division of Water Resources  
4532 W Jones Ave., Suite B  
Garden City, Kansas 67846

RE: Applications for Change in Place of Use  
Water Right, File Nos. 19765, 22507 & 27260

Dear Austin:

We have completed a review of the application for the above referenced water right. The proposal is not in conflict with the Management Program of the Southwest Kansas Groundwater Management District No. 3 (GMD3). The proposed change in place of use will create a complete overlap in currently authorized acres, no new acres being proposed, in accordance with K.A.R. 5-5-11. It is therefore recommended that the application be approved at this time.

Thank you for the opportunity to review the applications and to provide a recommendation. If you have any questions, please don't hesitate to contact us.

Sincerely,

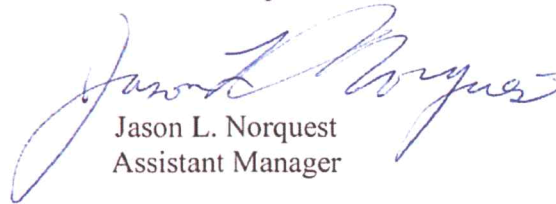

Jason L. Norquest  
Assistant Manager

RECEIVED

NOV 12 2021

Garden City Field Office  
Division of Water Resources

## GMD3 Change Review

---

File No(s): 19675, 22507 & 27260.

DWR office: GC.

App filed to change: PU.

Is Landowner(s) correct in WRIS: Ray Allen Smith .

If NO, is documentation included?

Is Water Use Correspondent correct in WRIS? \_\_.

If NO, is documentation included?

Regulation(s) Reviewed: KAR 5-5-11

Point of diversion ID No(s) \_\_ being changed.

	ft. North	ft. West	
Authorized PD			
Proposed PD			
Difference	0	0	
a2 + b2 = c2	0	0	0

GPS for proposed PD: Lat: \_\_ Long: \_\_.

Is proposed PD stacking on existing WRs? No Change .

Is Proposed PU overlapping existing WRs? Making a complete overlap in acres.

Neighboring certified well(s) notified: \_\_.

Name \_\_.

Address \_\_.

Zip \_\_.

Email: \_\_. Phone: \_\_.

Domestic well(s) notified: \_\_.

Name \_\_.

Address \_\_.

Zip \_\_.

Base Acres: \_\_.

Perfected Acres: \_\_.

Irr. Return-Flow \_\_%

**19765: 304AF@1400gpme, 152 acres NW 2-27-30**

**22507: 272AF@870gpm, 136 acres SW 2-27-30**

**27260: 272AF@830gpm, 136 acres SE 2-27-30**

**Proposed acres total 424 acres. all acres are currently authorized by one of the WRs.**

Is a waiver needed: All proposed acres are currently authorized, no new acres are proposed. Applicant is making a complete overlap in PU.

Recommendation: After review of all available information, it appears current area rules are met. Staff therefore recommends approval of the applicatoins.



Garden City Field Office  
4532 W. Jones, Suite B  
Garden City, KS 67846



Phone: 620-276-2901  
Fax: 620-276-9315  
[www.agriculture.ks.gov](http://www.agriculture.ks.gov)

Mike Beam, Secretary

Laura Kelly, Governor

November 5, 2021

GROUNDWATER MANAGEMENT DISTRICT #3  
2009 E SPRUCE ST  
GARDEN CITY KS 67846

Re: Request for Recommendation,  
File Nos. 19765, 22507 & 27260

Dear Sir or Madam:

We are enclosing a copy of the referenced application, which was submitted by Ray Smith and appears to be in proper form, for your review.

We are delaying any further action for a period of 15 days from the date of this letter to allow you time to submit your recommendation concerning this application. Please submit your recommendation within the allotted time, or any authorized extension of time thereof.

If you have any questions, please contact me at (620) 276-2901. If you wish to discuss a specific file, please have the file number ready to that I may help you more efficiently.

Sincerely,

A handwritten signature in blue ink, appearing to read "Austin McColloch".

Austin McColloch  
Assistant Water Commissioner

Enclosure  
pc: