

Kansas Department of Agriculture  
 Division of Water Resources  
**CHANGE: P/U WORKSHEET**

1. File Number: <b>25870</b>	2. Status Change Date:	3. Change Num: <b>C1</b>	4. Field Office: <b>4</b>	5. GMD: <b>3</b>
---------------------------------	------------------------	-----------------------------	------------------------------	---------------------

6. Status: <input checked="" type="checkbox"/> Approved <input type="checkbox"/> Denied by DWR/GMD <input type="checkbox"/> Dismiss by Request/Failure to Return	7. Filing Date of Change: <b>4/28/2021</b>
--	---

8a. Applicant(s) New to system <input type="checkbox"/>  <b>ANDREW KOEHN          1107 ROAD 70          SUBLETTE, KS 67877-8016</b>	Person ID <u><b>9650</b></u> Add Seq# _____
--	--

8c. Landowner(s) New to system <input type="checkbox"/>	Person ID _____ Add Seq# _____
--	-----------------------------------

8b. Landowner(s) New to system <input type="checkbox"/>  <b>8a</b>	Person ID _____ Add Seq# _____
---	-----------------------------------

8d. WUC New to system <input type="checkbox"/>  <b>8a</b>	Person ID _____ Add Seq# _____
--	-----------------------------------

9. Documents and Enclosure(s): <input checked="" type="checkbox"/> DWR Meter(s) Date to Comply: <u><b>12/31/2021</b></u> <input checked="" type="checkbox"/> N & P Date to Comply: <u><b>3/1/2022</b></u>	
<input type="checkbox"/> Anti-Reverse Meter <input type="checkbox"/> Meter Seal <input type="checkbox"/> Check Valve <input checked="" type="checkbox"/> N & P Form <input type="checkbox"/> Water Tube <input type="checkbox"/> Driller Copy <input type="checkbox"/> H & E Letter	
<input type="checkbox"/> Conservation Plan            Date Required: _____            Date Approved: _____            Date to Comply: _____	

10. Use Made of Water    From: _____	To: _____
--------------------------------------	-----------

Date Prepared: <b>4/29/2021</b> By: <b>AM</b> Date Entered: _____    By: _____
---

File No. **25870**      11. County: **HS**      Basin: **ARKANSAS RIVER**      Stream:      Formation Code: **211**      Special Use:

12. Points of Diversion  
 Rate and Quantity  
 Authorized      Additional  
 Rate      Quantity      Rate      Quantity  
 gpm/cfs      af/mgy      gpm/cfs      af/mgy      Overlap PD Files

CHK	MOD	DEL	ENT	PDIV	Qualifier	S	T	R	ID	'N	'W	Comment (AKA Line)	Rate gpm/cfs	Quantity af/mgy	Rate gpm/cfs	Quantity af/mgy	Overlap PD Files
<b>CHK</b>																	
<b>397</b>																	

13. Storage: Rate \_\_\_\_\_ NF      Quantity \_\_\_\_\_ ac/ft      Additional Rate \_\_\_\_\_ NF      Additional Quantity \_\_\_\_\_ ac/ft

14. Limitation: \_\_\_\_\_ af/yr at \_\_\_\_\_ gpm ( \_\_\_\_\_ cfs) when combined with file number(s) \_\_\_\_\_  
 Limitation: \_\_\_\_\_ af/yr at \_\_\_\_\_ gpm ( \_\_\_\_\_ cfs) when combined with file number(s) \_\_\_\_\_

15. 5YR Allocation:      Allocation Type \_\_\_\_\_      Start Year \_\_\_\_\_      5 YR Amount \_\_\_\_\_      Amount Unit \_\_\_\_\_      Base Acres \_\_\_\_\_      Comment \_\_\_\_\_

16. Place of Use CHK MOD DEL ENT	PUSE	S	T	R	ID	NE¼				NW¼				SW¼				SE¼				Total	Owner	Chg?	Overlap Files
						NE ¼	NW ¼	SW ¼	SE ¼	NE ¼	NW ¼	SW ¼	SE ¼	NE ¼	NW ¼	SW ¼	SE ¼	NE ¼	NW ¼	SW ¼	SE ¼				
<b>ENT</b>	<b>10630</b>	<b>34</b>	<b>27</b>	<b>S</b>	<b>33</b>	<b>W</b>	<b>2</b>	40	40	40	40							40	40	40	40	320	<b>8a</b>	<b>N</b>	<b>16731; 17832</b>
<b>CHK</b>	<b>794</b>	<b>2</b>	<b>28</b>	<b>S</b>	<b>33</b>	<b>W</b>	<b>1</b>					40	40	40	40							160	<b>8a</b>	<b>N</b>	<b>16731; 17832</b>

Base Acres:      Year:      Minimum Reasonable Quantity:  
 Comments: **COMBINE PUSE ID 61523 INTO PUSE ID 10630**

Garden City Field Office  
4532 W. Jones, Suite B  
Garden City, KS 67846



Phone: 620-276-2901  
Fax: 620-276-9315  
www.agriculture.ks.gov

Mike Beam, Secretary

Laura Kelly, Governor

April 29, 2021

ANDREW KOEHN  
1107 ROAD 70  
SUBLETTE, KS 67877-8016

RE: Water Right, File Nos. 16731; 17832 & 25870

Dear Sir or Madam:

Enclosed is the order executed by the designee of the Chief Engineer, Division of Water Resources, Kansas Department of Agriculture, approving the application for change under the above referenced file numbers.

Your attention is directed to the enclosures and to the terms, conditions, and limitations specified in this approval for change. A condition of this approval is that an acceptable water flow meter must be installed on the diversion works authorized under the referenced file number and meet current specifications. Please return the required notification of completion of the diversion works and/or installation of the required meter as soon as these actions are completed.

Since the order modifies the original document referred to above, it should be recorded with the Register of Deeds as other instruments affecting real estate.

Should you have any questions, please feel free contact this office. If you would prefer, you could arrange an appointment for additional assistance.

Sincerely,

A handwritten signature in blue ink, appearing to read "Austin J. McColloch".

Austin J. McColloch  
Assistant Water Commissioner

AM:  
enclosures

pc: GROUNDWATER MANAGEMENT DISTRICT NO. 3

**CERTIFICATE OF SERVICE**

On this 29<sup>th</sup> day of April, 2021, I hereby certify that the foregoing Approval of Application for Change in Place of Use, Water Right, File Nos. 16,731; 17,832 & 25,870 dated 29<sup>th</sup> day of April, 2021 was mailed postage prepaid, first class, US mail to the following:

ANDREW KOEHN  
1107 ROAD 70  
SUBLETTE, KS 67877-8016

Pc:

GROUNDWATER MANAGEMENT DISTRICT NO. 3

  
\_\_\_\_\_  
Division of Water Resources Staff

Submit completed application to:  
 Kansas Department of Agriculture  
 Division of Water Resources  
 Field Office for your area.  
 Call for address:  
 Topeka -- (785) 296-5733  
 Stafford -- (620) 234-5311  
 Stockton -- (785) 425-6787  
 Garden City -- (620) 276-2901  
<http://agriculture.ks.gov/dwr>

## DWR FIELD OFFICE APPLICATION FOR APPROVAL TO CHANGE THE PLACE OF USE AND/OR THE POINT OF DIVERSION



**STATE OF KANSAS**

**Filing Fee Must Accompany the Application, K.S.A. 82a-708b(b), as amended.**  
 Fee Schedule is on the third page of this application form.

**Paragraph Nos. 1, 2, 3 & 5 must be completed. Complete all other applicable portions.** If change in point of diversion is greater than 100 feet, or if place of use will be changed, include a topographic map or detailed plat showing the authorized and proposed point(s) of diversion and/or place of use.

**RECEIVED**  
 11:32 AM  
 APR 28 2021

File No. 25870

Garden City Field Office  
 Division of Water Resources

1. Application is hereby made for approval of the Chief Engineer to change the (check one or both):

Place of Use                       Point of Diversion

under the water right which is the subject of this application in accordance with the conditions described below.

The source of supply is:                       Groundwater                       Surface water

2. Name and address of Applicant: ANDREW KOEHN

1107 ROAD 70 SUBLETTE KS 67877-8016

Phone Number: (     )    Email address: \_\_\_\_\_

Name and address of Water Use Correspondent: SAME AS ABOVE

Phone Number: (     )    Email address: \_\_\_\_\_

3. The presently authorized place of use is:

Owner of Land ---- NAME: SAME AS ABOVE - NO CHANGE

ADDRESS: \_\_\_\_\_

(If there is more than one landowner, attach supplemental sheets as necessary.)

Sec.	Twp.	Range	NE¼				NW¼				SW¼				SE¼				TOTAL ACRES
			NE¼	NW¼	SW¼	SE¼	NE¼	NW¼	SW¼	SE¼	NE¼	NW¼	SW¼	SE¼	NE¼	NW¼	SW¼	SE¼	
2	28S	33W					40	40	40	40									160

4. If this application is for a change in place of use, it is proposed that the place of use be changed to:

Owner of Land ---- NAME: SAME AS ABOVE - NO CHANGE

ADDRESS: \_\_\_\_\_

(If there is more than one landowner, attach supplemental sheets as necessary.)

Sec.	Twp.	Range	NE¼				NW¼				SW¼				SE¼				TOTAL ACRES
			NE¼	NW¼	SW¼	SE¼	NE¼	NW¼	SW¼	SE¼	NE¼	NW¼	SW¼	SE¼	NE¼	NW¼	SW¼	SE¼	
34	27S	33W	40	40	40	40									40	40	40	40	320
2	28S	33W					40	40	40	40									160

<b>For Office Use Only: Code</b> _____ <b>Fee \$</b> <u>200.00</u> <b>TR #</b> _____ <b>Receipt Date</b> <u>4-28-21</u> <b>Check #</b> <u>7396</u>
--



5. **Presently authorized point of diversion:**  
 One in the \_\_\_\_\_ Quarter of the \_\_\_\_\_ Quarter of the \_\_\_\_\_ Quarter  
 of Section \_\_\_\_\_, Township \_\_\_\_\_ South, Range \_\_\_\_\_ (W),  
 in \_\_\_\_\_ County, Kansas, \_\_\_\_\_ feet North \_\_\_\_\_ feet West of Southeast corner of section.  
 Authorized Rate \_\_\_\_\_ Authorized Quantity \_\_\_\_\_ Depth of well \_\_\_\_\_ (feet)  
 (DWR use only: Computer ID No. \_\_\_\_\_ GPS \_\_\_\_\_ feet North \_\_\_\_\_ feet West)  
 This point will not be changed.  This point will be changed as follows:  No change, point better described with GPS as follows:  
**Proposed point of diversion: (Complete only if change is requested or if existing point is better described by GPS)**  
 One in the \_\_\_\_\_ Quarter of the \_\_\_\_\_ Quarter of the \_\_\_\_\_ Quarter  
 of Section \_\_\_\_\_, Township \_\_\_\_\_ South, Range \_\_\_\_\_ (W),  
 in \_\_\_\_\_ County, Kansas, \_\_\_\_\_ feet North \_\_\_\_\_ feet West of Southeast corner of section.  
 Proposed Rate \_\_\_\_\_ Proposed Quantity \_\_\_\_\_ Proposed well depth (feet) \_\_\_\_\_  
 This point is:  Additional Well  Geo Center List other water rights that will use this point \_\_\_\_\_

6. **Presently authorized point of diversion:**  
 One in the \_\_\_\_\_ Quarter of the \_\_\_\_\_ Quarter of the \_\_\_\_\_ Quarter  
 of Section \_\_\_\_\_, Township \_\_\_\_\_ South, Range \_\_\_\_\_ (W),  
 in \_\_\_\_\_ County, Kansas, \_\_\_\_\_ feet North \_\_\_\_\_ feet West of Southeast corner of section.  
 Authorized Rate \_\_\_\_\_ Authorized Quantity \_\_\_\_\_ Depth of well \_\_\_\_\_ (feet)  
 (DWR use only: Computer ID No. \_\_\_\_\_ GPS \_\_\_\_\_ feet North \_\_\_\_\_ feet West)  
 This point will not be changed.  This point will be changed as follows:  No change, point better described with GPS as follows:  
**Proposed point of diversion: (Complete only if change is requested or if existing point is better described by GPS)**  
 One in the \_\_\_\_\_ Quarter of the \_\_\_\_\_ Quarter of the \_\_\_\_\_ Quarter  
 of Section \_\_\_\_\_, Township \_\_\_\_\_ South, Range \_\_\_\_\_ (W),  
 in \_\_\_\_\_ County, Kansas, \_\_\_\_\_ feet North \_\_\_\_\_ feet West of Southeast corner of section.  
 Proposed Rate \_\_\_\_\_ Proposed Quantity \_\_\_\_\_ Proposed well depth (feet) \_\_\_\_\_  
 This point is:  Additional Well  Geo Center List other water rights that will use this point \_\_\_\_\_

7. The changes herein are desired for the following reasons?  
 (please be specific) CREATE A COMPLETE OVERLAP  
IN PLACE OF USE BETWEEN FILE NOS. 16731; 17832  
& 25870

8. If a well, is the test hole log attached?  Yes  No

9. The change(s) (was)(will be) completed by?  
UPON APPROVAL

10. If the point of diversion is a well:  
 (a) What are you going to do with the old well?  
N / A  
 (b) When will this be done? N / A

11. Groundwater Management District recommendation attached?  
 Yes  No

12. Assisted by AM / GCFO

13a. If the proposed point of diversion will be relocated more than 300 feet but within 2,640 feet of the existing point of diversion, attach a topographic map or aerial photograph. For groundwater sources, show all wells (including domestic) within one-half mile of the proposed point of diversion and the names and mailing addresses of the owners. For surface water sources, show the names and addresses of the landowner(s) one-half mile downstream and one-half mile upstream from your property lines

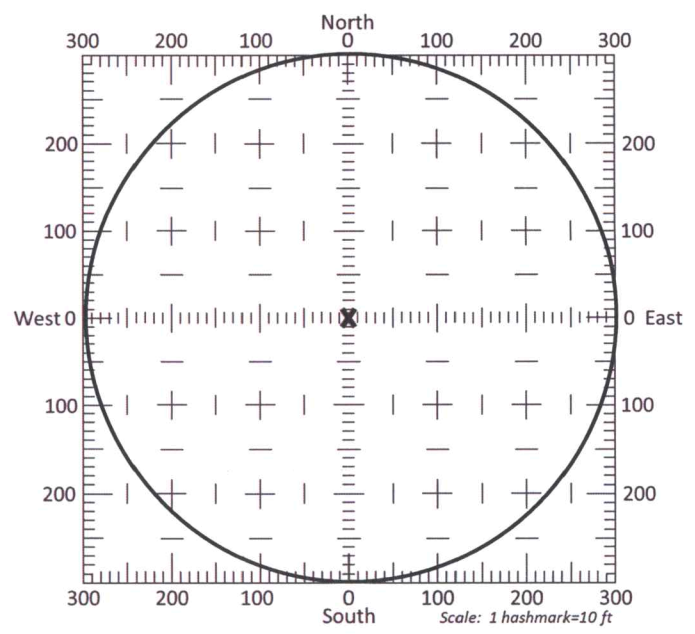

13b. If the proposed point of diversion will be relocated within a 300 foot radius of the existing point of diversion, indicate its location on the diagram shown above in relation to the existing point of diversion. The proposed point of diversion must be located within the circle shown above. (PLEASE NOTE: The "X" in center of diagram above represents the presently authorized point of diversion.)

14. If the proposed groundwater point of diversion is 300 or fewer feet from the existing point of diversion, complete the following:

- (a) Does the undersigned represent all owners of the currently authorized place(s) of use identified in this application?  
 Yes     No    (If no, all owners must sign this application.)
- (b) Will the ownership interest of any owner of the currently authorized place(s) of use identified in this application be adversely affected if this application is approved as requested?  
 Yes     No    (If yes, all owners must sign this application.)
- (c) If this application is not approved expeditiously, will there be substantial damage to property, public health or safety?  
 Yes     No    (If no, all owners must sign this application.)

If the application proposes a surface water change in point of diversion, a groundwater change in point of diversion greater than 300 feet, or a change in place of use, the application must be signed by all owners of the currently authorized place of use, or their duly authorized agent (attach notarized statement authorizing representation).

I hereby verify, being first duly sworn upon my oath or affirmation and under penalty of perjury, that I am of lawful age and the owner, the spouse of the owner, or a duly authorized agent of the owner(s) to make this application on their behalf, in regards to the water right(s) to which this application pertains. I further verify that the statements contained in this application are true, correct and complete.

Dated at Garden City, Kansas, this 28<sup>th</sup> day of April, 2021.

<u>Andrew Koehn</u> (Owner)	
<u>Andrew Koehn</u> (Please Print)	
	(Spouse)
	(Please Print)
	(Spouse)
	(Please Print)
	(Spouse)
	(Please Print)

State of Kansas }  
County of Finney } SS



I hereby certify that the foregoing application was signed in my presence and sworn to before me this 28<sup>th</sup> day of April, 2021.

My Commission Expires \_\_\_\_\_  
JULIE JONES  
My Appointment Expires  
December 15, 2022

Julie Jones  
Notary Public

**ONLY COMPLETE APPLICATIONS WILL BE PROCESSED.** To be complete, all of the applicable portions of the application form must be completed with accurate information; maps, if necessary, must be included; signatures of all the appropriate owners' must be affixed to the application and notarized; and the appropriate fee must be paid.

**FEE SCHEDULE**

Each application to change the place of use or the point of diversion under this section shall be accompanied by the application fee set forth in the schedule below: Make checks payable to: **Kansas Department of Agriculture**

- (1) Application to change a point of diversion 300 feet or less . . . . . \$100
- (2) Application to change a point of diversion more than 300 feet . . . . . \$200
- (3) Application to change the place of use . . . . . \$200



**SUMMARY ORDER APPROVING APPLICATION FOR CHANGE AND IMPOSING CONDITIONS**

This Summary Order is issued under authority of K.S.A. 82a-708b, as amended, and K.A.R. 5-5-1, *et seq.* and other applicable provisions of the *Kansas Water Appropriation Law, K.S.A. 82a-701 et. seq.*, and rules and regulations promulgated thereunder, With the exception of those conditions expressly contained herein, this Summary Order does not change the terms, conditions and limitations of File No. 25870.

1. A change application was received on April 28, 2021 requesting that the place of use and / or point of diversion authorized under the above-referenced file number be changed as described in the application.
2. On and after the effective date of this summary order, the authorized place(s) of use shall be located substantially as shown on the topographic map accompanying the application to change the place of use.  Applicable  Not Applicable
3. The change in point of diversion shall not impair existing rights and shall be limited to the same source or sources of water as previously authorized. The point of diversion authorized by this summary order shall be located within a        foot radius of the authorized point(s) of diversion.  Applicable  Not Applicable
4. The point(s) of diversion described herein is administratively corrected to be more accurately described using the Global Positioning System (GPS), as described in the application.  Applicable  Not Applicable
5. The point(s) of diversion authorized herein shall not actually be located more than        feet from the previously authorized point(s) of diversion.  Applicable  Not Applicable
6. As required by K.A.R. 5-3-5d, if the works for diversion is a well with a diversion rate of 100 gallons per minute or more, a tube or other device suitable for making water level measurements shall be installed, operated and maintained in accordance with K.A.R. 5-6-13.  Applicable  Not Applicable
7. **The owner of the authorized place(s) of use shall properly install an acceptable water flow meter on or before December 31, 2021**, or before the first use of water, whichever occurs first. The water flow meter shall be installed, operated and maintained in accordance with K.A.R. 5-1-4 through 5-1-12. As required by K.S.A. 82a-732, as amended, and K.A.R. 5-3-5e, the owner shall maintain records and report the reading of the water flow meter and the total quantity of water diverted annually to the Chief Engineer by March 1 following the end of each calendar year.  Applicable  Not Applicable
8. **Installation of the works for diversion of water shall be completed on or before December 31, 2021**, or within any authorized extension of time. By March 1, 2021 the applicant shall notify the Chief Engineer that construction of the works for diversion has been completed, on the form provided by the Chief Engineer, as required by K.A.R. 5-8-4e.  Applicable  Not Applicable
9. **The completed well log shall be submitted with the required notice.**  Applicable  Not Applicable
10. All diversion works into which any type of chemical or other foreign substance will be injected into the water shall be equipped with an in-line, automatic, quick-closing check valve capable of preventing pollution of the source of the water supply. The check valve(s) shall be installed, operated and maintained in accordance with K.A.R. 5-3-5c.  Applicable  Not Applicable
11. Additional Conditions are attached.  Yes  No
12. In accordance with K.S.A. 82a-708a, as amended, and K.A.R. 5-5-14, all of the owners of the authorized place(s) of use of water appropriated under the above-referenced file number are responsible for compliance with its terms, conditions and limitations, as amended and/or supplemented by this Summary Order, and with applicable provisions of the *Kansas Water Appropriation Law* and the *Rules and Regulations* promulgated thereunder. Failure to comply with these provisions may result in civil penalties pursuant to K.S.A. 82a-737, as amended, and/or the suspension or revocation and dismissal of the water or appropriation right or any other enforcement actions authorized by law.

**Administrative Appeal and Effective Date of Order**

If you are aggrieved by this order, pursuant to K.S.A. 82a-1901, you may request an evidentiary hearing before the Chief Engineer or request administrative review by the Secretary of Agriculture. A request for hearing by the Chief Engineer must be filed within **15 days** of service of this Order and a request for administrative review by the Secretary must be filed within **30 days** pursuant to K.S.A. 77-531. Any request for administrative review must state a basis for review pursuant to K.S.A. 77-527. File any request with **Kansas Department of Agriculture, Legal Division, 1320 Research Park Drive, Manhattan, KS 66502**. Failure to timely request a hearing or review may preclude review under the Kansas Judicial Review Act.

*For Use by Register of Deeds*

FOR OFFICE USE ONLY  
**APPLICATION APPROVED AND SUMMARY ORDER ISSUED**

By: Austin McColloch  
Duly Authorized Designee of the Chief Engineer

(Print Name): Austin McColloch  
Division of Water Resources - Kansas Department of Agriculture

Date of Issuance: April 29, 2021

State of Kansas )

County of Jiminy ) SS

Acknowledged before me on April 29, 2021  
by Austin McColloch

Signature: Julie Jones  
Notary Public

My commission expires: \_\_\_\_\_  
My Assignment Expires \_\_\_\_\_

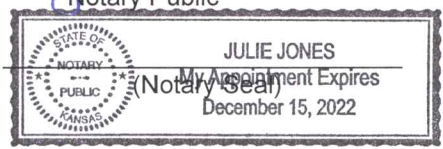



# CHANGE IN PLACE OF USE WATER RIGHT, FILE NO. 25870

Haskell County

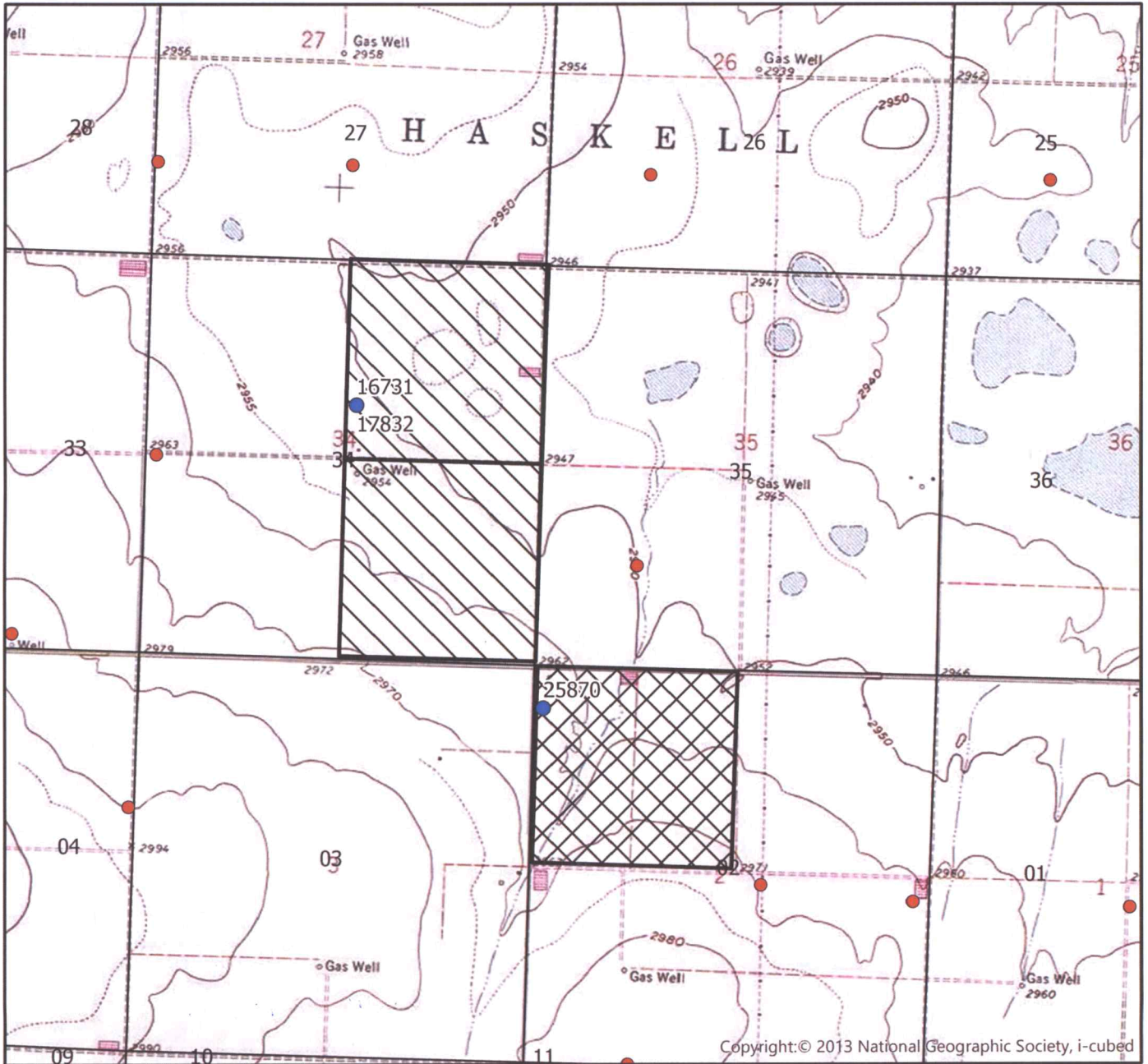

- Authorized Point of Diversion
- Permitted Water Right
- ★ Domestic Well within 1/2 mile
- Authorized Place of Use
- Proposed Place of Use

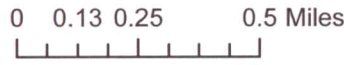

List of owner name and addresses within 1/2 mile:

WR 27558  
 BRAD & SONJA WOOLRIDGE  
 612 E NEBRASKA ULYSSES KS 67880

By signing below I agree that all wells, including domestic, and owners names and addresses within 1/2 mile of the proposed point of diversion have been shown on the map

\_\_\_\_\_  
 (Signature) Date AM/GCFO 1:24,000 Scale