

Kansas Department of Agriculture  
 Division of Water Resources  
**CHANGE: P/U WORKSHEET**

1. File Number: <b>26527</b>	2. Status Change Date:	3. Change Num: <b>C4</b>	4. Field Office: <b>04</b>	5. GMD: <b>03</b>
---------------------------------	------------------------	-----------------------------	-------------------------------	----------------------

6. Status: <input checked="" type="checkbox"/> Approved <input type="checkbox"/> Denied by DWR/GMD <input type="checkbox"/> Dismiss by Request/Failure to Return	7. Filing Date of Change: <b>8/24/2021</b>
--	---

8a. LANDOWNER, applicant, New to system <input type="checkbox"/> Person ID <b>41565</b> Add Seq# _____  <b>LOVE AG COMPANY</b> <b>ATTN: GREG LOVE</b> <b>24506 13 RD</b> <b>MONTEZUMA, KS 67867-9073</b>	8c. Landowner New to system <input type="checkbox"/> Person ID _____ Add Seq# _____
---	---

8b. Landowner(s), correspondent New to system <input type="checkbox"/> Person ID <b>25213</b> Add Seq# _____  <b>GREGORY C &amp; SUE LOVE</b> <b>24506 13 RD</b> <b>MONTEZUMA, KS 67867-9073</b>	8d. WUC New to system <input checked="" type="checkbox"/> Person ID _____ Add Seq# _____
--	--

9. Documents and Enclosure(s):  DWR Meter(s) Date to Comply: **12/31/2021**     N & P Date to Comply: \_\_\_\_\_

Anti-Reverse Meter     Meter Seal     Check Valve     N & P Form     Water Tube     Driller Copy     H & E Letter

Conservation Plan    Date Required: \_\_\_\_\_    Date Approved: \_\_\_\_\_    Date to Comply: \_\_\_\_\_

10. Use Made of Water    From: \_\_\_\_\_    To: \_\_\_\_\_

Date Prepared: **8/25/2021**    By: **MAM**  
 Date Entered: \_\_\_\_\_    By: \_\_\_\_\_

File No. **26527**      11. County: **GY**      Basin: **ARKANSAS RIVER**      Stream:      Formation Code:      Special Use:

12. Points of Diversion Rate and Quantity  
**CHK** Authorized Additional  
**MOD** Rate Quantity  
**DEL** gpm af  
**ENT** af gpm af Overlap PD Files

PDIV      Qualifier      S      T      R      ID      'N      'W      **Comment (AKA Line)**

**CHK 84504**

13. Storage: Rate \_\_\_\_\_ NF      Quantity \_\_\_\_\_ ac/ft      Additional Rate \_\_\_\_\_ NF      Additional Quantity \_\_\_\_\_ ac/ft

14. Limitation: \_\_\_\_\_ af/yr at \_\_\_\_\_ gpm ( \_\_\_\_\_ cfs) when combined with file number(s) \_\_\_\_\_  
 Limitation: \_\_\_\_\_ af/yr at \_\_\_\_\_ gpm ( \_\_\_\_\_ cfs) when combined with file number(s) \_\_\_\_\_

15. 5YR Allocation:      Allocation Type \_\_\_\_\_      Start Year \_\_\_\_\_      5 YR Amount \_\_\_\_\_      Amount Unit \_\_\_\_\_      Base Acres \_\_\_\_\_      Comment \_\_\_\_\_

16. Place of Use <b>CHK</b> <b>MOD</b> <b>DEL</b> <b>ENT</b>	PUSE	S	T	R	ID	NE¼				NW¼				SW¼				SE¼				Total	Owner	Chg?	Overlap Files
						NE ¼	NW ¼	SW ¼	SE ¼	NE ¼	NW ¼	SW ¼	SE ¼	NE ¼	NW ¼	SW ¼	SE ¼	NE ¼	NW ¼	SW ¼	SE ¼				
<b>CHK</b>	<b>1423</b>	<b>6</b>	<b>27</b>	<b>28W</b>	<b>01</b>									31	L-6 31	L-7 31	31	31	31	31	31	248	8a	NO	13145, 14101, 14550, 19266, 19809, 20063, 21037, 21455
<b>MOD</b>	<b>33304</b>	<b>7</b>	<b>27</b>	<b>28W</b>	<b>04</b>	31	31	31	31					31.5	L-3 31.5	L-4 31.5	31.5	31	31	31	31	374	8a	NO	13145, 14101, 14550, 19266, 19809, 20063, 21037, 21455,
<b>CHK</b>	<b>17889</b>	<b>13</b>	<b>27</b>	<b>29W</b>	<b>01</b>	31	31	31	31	31	31	31	31	31	31	31	31	31	31	31	31	496	8a	NO	13145, 14101, 14550, 19266, 19809, 20063, 21037, 21455,
<b>CHK</b>	<b>6605</b>	<b>18</b>	<b>27</b>	<b>28W</b>	<b>01</b>	31	31	31	31	31	L-1 31	L-2 31	31	31	L-3 31	L-4 31	31	31	31	31	31	496	8b	NO	13145, 14101, 14550, 19266, 19809, 20063, 21037, 21455,
<b>ENT</b>	<b>33536</b>	<b>12</b>	<b>27</b>	<b>29W</b>	<b>02</b>									31.5	31.5	31.5	31.5	31.5	31.5	31.5	31.5	252	8a	NO	13145, 14101, 14550, 19266, 19809, 20063, 21037, 21455,

**Base Acres:**      **Year:**      **Minimum Reasonable Quantity:**

Comments:

Garden City Field Office  
4532 W. Jones, Suite B  
Garden City, KS 67846



Phone: 620-276-2901  
Fax: 620-276-9315  
www.agriculture.ks.gov

Mike Beam, Secretary

Laura Kelly, Governor

September 1, 2021

LOVE AG COMPANY  
Attn: GREG LOVE  
24506 13 RD  
MONTEZUMA, KS 67867-9073

RE: Approval of Application for Change  
Water Right, File Nos. 13145, 14101, 14550, 19622, 19809, 20063, 21037,  
21455, 26527

Dear Sir:

Enclosed are orders executed by the designee of the Chief Engineer, Division of Water Resources, Kansas Department of Agriculture, approving the applications for change under the above referenced file numbers.

Your attention is directed to the enclosures and to the terms, conditions, and limitations specified in the approvals for change. A condition of the approval is that acceptable water flow meters must be installed on the diversion works authorized under the referenced file numbers and meet current specification. Please return the required notification of completion of the diversion works and installation of the required meters as soon as these actions are completed. Also please note the condition that referenced File No. 19,001 has been reduced in annual authorized quantity.

Since the orders modify the original documents referred to above, they should be recorded with the Register of Deeds as other instruments affecting real estate.

Should you have any questions, please feel free to call this office. If you would prefer, you could arrange an appointment for additional assistance.

Sincerely,

  
Michael A. Meyer  
Water Commissioner

MAM:  
enclosures  
pc: GMD3

## CERTIFICATE OF SERVICE

On this 1<sup>st</sup> day of September 2021, I hereby certify that the foregoing Approval of Application for Change in Place of Use, Water Right, File Nos. 13,145, 14,101, 14,550, 19,622, 19,809, 20,063, 21,037, 21,455 & 26,527 dated 1<sup>st</sup> day of September 2021 was mailed postage prepaid, first class, US mail to the following:

LOVE AG COMPANY  
Attn: GREG LOVE  
24506 13 RD  
MONTEZUMA, KS 67867-9073

Pc:

GREGORY C & SUE LOVE  
24506 13 RD  
MONTEZUMA, KS 67867-9073

GROUNDWATER MANAGEMENT DISTRICT NO. 3

  
\_\_\_\_\_  
Division of Water Resources



Submit completed application to:  
 Kansas Department of Agriculture  
 Division of Water Resources  
 Field Office for your area.

Call for address:  
 Topeka -- (785) 296-5733  
 Stafford -- (620) 234-5311  
 Stockton -- (785) 425-6787  
 Garden City -- (620) 276-2901  
<http://agriculture.ks.gov/dwr>

## DWR FIELD OFFICE APPLICATION FOR APPROVAL TO CHANGE THE PLACE OF USE AND/OR THE POINT OF DIVERSION



**STATE OF KANSAS**

**Filing Fee Must Accompany the Application, K.S.A. 82a-708b(b), as amended.**  
 Fee Schedule is on the third page of this application form.

**Paragraph Nos. 1, 2, 3 & 5 must be completed. Complete all other applicable portions.** If change in point of diversion is greater than 100 feet, or if place of use will be changed, include a topographic map or detailed plat showing the authorized and proposed point(s) of diversion and/or place of use.

**RECEIVED**  
 3: 58 pm  
 AUG 24 2021

File No. 26527

Garden City Field Office  
 Division of Water Resources

1. Application is hereby made for approval of the Chief Engineer to change the (check one or both):

Place of Use       Point of Diversion

under the water right which is the subject of this application in accordance with the conditions described below.

The source of supply is:       Groundwater       Surface water

2. Name and address of Applicant: Love Ag Company %Greg Love  
24506 13 RD, Montezuma, KS 67867

Phone Number: (620)846-0222      Email address: greg.c.love@gmail.com

Name and address of Water Use Correspondent: SAME

Phone Number: (      )      Email address:      \_\_\_\_\_

3. The presently authorized place of use is:  
 Owner of Land ---- NAME: Love Ag Company %Greg Love  
 ADDRESS: 24506 13 RD, Montezuma, KS 67867

(If there is more than one landowner, attach supplemental sheets as necessary.)

Sec.	Twp.	Range	NE¼				NW¼				SW¼				SE¼				TOTAL ACRES
			NE¼	NW¼	SW¼	SE¼	NE¼	NW¼	SW¼	SE¼	NE¼	NW¼	SW¼	SE¼	NE¼	NW¼	SW¼	SE¼	
6	27s	28w									31.0	31.0	31.0	31.0	31.0	31.0	31.0	31.0	248.0
7	27s	28w	31.0	31.0	31.0	31.0									31.0	31.0	31.0	31.0	248.0
13	27s	29w	31.0	31.0	31.0	31.0	31.0	31.0	31.0	31.0	31.0	31.0	31.0	31.0	31.0	31.0	31.0	31.0	496.0

4. If this application is for a change in place of use, it is proposed that the place of use be changed to:  
 Owner of Land ---- NAME: Love Ag Company %Greg Love  
 ADDRESS: 24506 13 RD, Montezuma, KS 67867

(If there is more than one landowner, attach supplemental sheets as necessary.)

Sec.	Twp.	Range	NE¼				NW¼				SW¼				SE¼				TOTAL ACRES
			NE¼	NW¼	SW¼	SE¼	NE¼	NW¼	SW¼	SE¼	NE¼	NW¼	SW¼	SE¼	NE¼	NW¼	SW¼	SE¼	
6	27s	28w									31.0	31.0	31.0	31.0	31.0	31.0	31.0	31.0	248.0
7	27s	28w	31.0	31.0	31.0	31.0					31.5	31.5	31.5	31.5	31.0	31.0	31.0	31.0	374.0
13	27s	29w	31.0	31.0	31.0	31.0	31.0	31.0	31.0	31.0	31.0	31.0	31.0	31.0	31.0	31.0	31.0	31.0	496.0

<b>For Office Use Only: Code</b> _____ <b>Fee \$</b> <u>200.00</u> <b>TR #</b> _____ <b>Receipt Date</b> <u>8-24-21</u> <b>Check #</b> <u>6918</u>
--

5. **Presently authorized point of diversion:**  
 One in the SW Quarter of the NW Quarter of the NE Quarter of Section 7, Township 27 South, Range 28 W, in Gray County, Kansas, 3993 feet North 2321 feet West of Southeast corner of section.  
 Authorized Rate 800gpm Authorized Quantity 260,000 AF Depth of well \_\_\_\_\_ (feet)  
**(DWR use only: Computer ID No. 07 GPS \_\_\_\_\_ feet North \_\_\_\_\_ feet West)**  
 This point will not be changed  This point will be changed as follows:  No change, point better described with GPS as follows:  
**Proposed point of diversion: (Complete only if change is requested or if existing point is better described by GPS)**  
 One in the \_\_\_\_\_ Quarter of the \_\_\_\_\_ Quarter of the \_\_\_\_\_ Quarter of Section \_\_\_\_\_, Township \_\_\_\_\_ South, Range \_\_\_\_\_ (E/W), in \_\_\_\_\_ County, Kansas, \_\_\_\_\_ feet North \_\_\_\_\_ feet West of Southeast corner of section.  
 Proposed Rate \_\_\_\_\_ Proposed Quantity \_\_\_\_\_ Proposed well depth (feet) \_\_\_\_\_  
 This point is:  Additional Well  Geo Center List other water rights that will use this point \_\_\_\_\_

6. **Presently authorized point of diversion:**  
 One in the \_\_\_\_\_ Quarter of the \_\_\_\_\_ Quarter of the \_\_\_\_\_ Quarter of Section \_\_\_\_\_, Township \_\_\_\_\_ South, Range \_\_\_\_\_ W, in Gray County, Kansas, \_\_\_\_\_ feet North \_\_\_\_\_ feet West of Southeast corner of section.  
 Authorized Rate \_\_\_\_\_ Authorized Quantity \_\_\_\_\_ Depth of well \_\_\_\_\_ (feet)  
**(DWR use only: Computer ID No. \_\_\_\_\_ GPS \_\_\_\_\_ feet North \_\_\_\_\_ feet West)**  
 This point will not be changed  This point will be changed as follows:  No change, point better described with GPS as follows:  
**Proposed point of diversion: (Complete only if change is requested or if existing point is better described by GPS)**  
 One in the \_\_\_\_\_ Quarter of the \_\_\_\_\_ Quarter of the \_\_\_\_\_ Quarter of Section \_\_\_\_\_, Township \_\_\_\_\_ South, Range \_\_\_\_\_ (E/W), in \_\_\_\_\_ County, Kansas, \_\_\_\_\_ feet North \_\_\_\_\_ feet West of Southeast corner of section.  
 Proposed Rate \_\_\_\_\_ Proposed Quantity \_\_\_\_\_ Proposed well depth (feet) \_\_\_\_\_  
 This point is:  Additional Well  Geo Center List other water rights that will use this point \_\_\_\_\_

7. The changes herein are desired for the following reasons?  
 (please be specific) \_\_\_\_\_  
Make a complete overlap in place of use

8. If a well, is the test hole log attached?  Yes  No

9. The change(s) (was)(will be) completed by?  
As soon as approved

10. If the point of diversion is a well:  
 (a) What are you going to do with the old well?  
 \_\_\_\_\_  
 (b) When will this be done? \_\_\_\_\_

11. Groundwater Management District recommendation attached?  
 Yes  No

12. Assisted by GMD3/JLN

13a. If the proposed point of diversion will be relocated more than 300 feet but within 2,640 feet of the existing point of diversion, attach a topographic map or aerial photograph. For groundwater sources, show all wells (including domestic) within one-half mile of the proposed point of diversion and the names and mailing addresses of the owners. For surface water sources, show the names and addresses of the landowner(s) one-half mile downstream and one-half mile upstream from your property lines

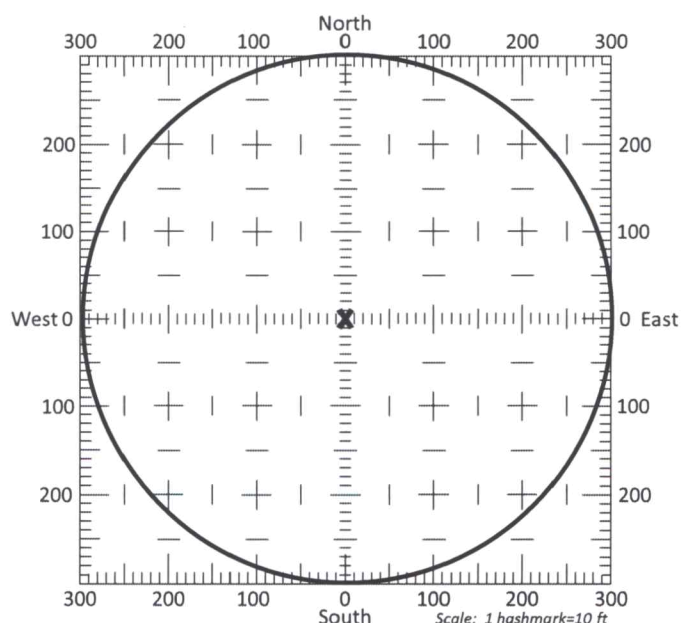

13b. If the proposed point of diversion will be relocated within a 300 foot radius of the existing point of diversion, indicate its location on the diagram shown above in relation to the existing point of diversion. The proposed point of diversion must be located within the circle shown above. **(PLEASE NOTE: The "X" in center of diagram above represents the presently authorized point of diversion.)**



APPLICATION FOR APPROVAL TO CHANGE  
THE PLACE OF USE AND/OR POINT OF DIVERSION  
SUPPLEMENTAL SHEET  
**FILE NO. 26527**  
MAKE ADDITIONAL COPIES AS NECESSARY

3. *Continued:* The presently authorized place of use is:

Owner of Land ---- NAME: Gregory C & Sue Love  
ADDRESS: 24506 13 RD, Montezuma, KS 67867

Sec.	Twp.	Range	NE¼				NW¼				SW¼				SE¼				TOTAL ACRES
			NE¼	NW¼	SW¼	SE¼	NE¼	NW¼	SW¼	SE¼	NE¼	NW¼	SW¼	SE¼	NE¼	NW¼	SW¼	SE¼	
18	27s	28w	31.0	31.0	31.0	31.0	31.0	31.0	31.0	31.0	31.0	31.0	31.0	31.0	31.0	31.0	31.0	31.0	496.0

Owner of Land ---- NAME: \_\_\_\_\_  
ADDRESS: \_\_\_\_\_

Sec.	Twp.	Range	NE¼				NW¼				SW¼				SE¼				TOTAL ACRES
			NE¼	NW¼	SW¼	SE¼	NE¼	NW¼	SW¼	SE¼	NE¼	NW¼	SW¼	SE¼	NE¼	NW¼	SW¼	SE¼	

Owner of Land ---- NAME: \_\_\_\_\_  
ADDRESS: \_\_\_\_\_

Sec.	Twp.	Range	NE¼				NW¼				SW¼				SE¼				TOTAL ACRES
			NE¼	NW¼	SW¼	SE¼	NE¼	NW¼	SW¼	SE¼	NE¼	NW¼	SW¼	SE¼	NE¼	NW¼	SW¼	SE¼	

4. *Continued:* If this application is for a change in place of use, it is proposed that the place of use be changed to:

Owner of Land ---- NAME: Gregory C & Sue Love  
ADDRESS: 24506 13 RD, Montezuma, KS 67867

Sec.	Twp.	Range	NE¼				NW¼				SW¼				SE¼				TOTAL ACRES	
			NE¼	NW¼	SW¼	SE¼	NE¼	NW¼	SW¼	SE¼	NE¼	NW¼	SW¼	SE¼	NE¼	NW¼	SW¼	SE¼		
18	27s	28w	31.0	31.0	31.0	31.0	31.0	31.0	31.0	31.0	31.0	31.0	31.0	31.0	31.0	31.0	31.0	31.0	31.0	496.0

Owner of Land ---- NAME: Love Ag Company %Greg Love  
ADDRESS: 24506 13 RD, Montezuma, KS 67867

Sec.	Twp.	Range	NE¼				NW¼				SW¼				SE¼				TOTAL ACRES	
			NE¼	NW¼	SW¼	SE¼	NE¼	NW¼	SW¼	SE¼	NE¼	NW¼	SW¼	SE¼	NE¼	NW¼	SW¼	SE¼		
12	27s	29w																		

Owner of Land ---- NAME: \_\_\_\_\_  
ADDRESS: \_\_\_\_\_

Sec.	Twp.	Range	NE¼				NW¼				SW¼				SE¼				TOTAL ACRES	
			NE¼	NW¼	SW¼	SE¼	NE¼	NW¼	SW¼	SE¼	NE¼	NW¼	SW¼	SE¼	NE¼	NW¼	SW¼	SE¼		

14. If the proposed groundwater point of diversion is 300 or fewer feet from the existing point of diversion, complete the following:

- (a) Does the undersigned represent all owners of the currently authorized place(s) of use identified in this application?  
 Yes     No    (If no, all owners must sign this application.)
- (b) Will the ownership interest of any owner of the currently authorized place(s) of use identified in this application be adversely affected if this application is approved as requested?  
 Yes     No    (If yes, all owners must sign this application.)
- (c) If this application is not approved expeditiously, will there be substantial damage to property, public health or safety?  
 Yes     No    (If no, all owners must sign this application.)

If the application proposes a surface water change in point of diversion, a groundwater change in point of diversion greater than 300 feet, or a change in place of use, the application must be signed by all owners of the currently authorized place of use, or their duly authorized agent (attach notarized statement authorizing representation).

I hereby verify, being first duly sworn upon my oath or affirmation and under penalty of perjury, that I am of lawful age and the owner, the spouse of the owner, or a duly authorized agent of the owner(s) to make this application on their behalf, in regards to the water right(s) to which this application pertains. I further verify that the statements contained in this application are true, correct and complete.

Dated at Garden City, Kansas, this 20th day of August, 2021.

[Signature]  
\_\_\_\_\_  
(Owner)

[Signature]  
\_\_\_\_\_  
(Spouse)

Gregory C. Love  
\_\_\_\_\_  
(Please Print)

Susan M Love  
\_\_\_\_\_  
(Please Print)

\_\_\_\_\_  
(Owner)

\_\_\_\_\_  
(Spouse)

\_\_\_\_\_  
(Please Print)

\_\_\_\_\_  
(Please Print)

\_\_\_\_\_  
(Owner)

\_\_\_\_\_  
(Spouse)

\_\_\_\_\_  
(Please Print)

\_\_\_\_\_  
(Please Print)

State of Kansas }  
County of Finney } SS



I hereby certify that the foregoing application was signed in my presence and sworn to before me this 20th day of August, 2021.

[Signature]  
\_\_\_\_\_  
Notary Public

My Commission Expires 11/19/23.

**ONLY COMPLETE APPLICATIONS WILL BE PROCESSED.** To be complete, all of the applicable portions of the application form must be completed with accurate information; maps, if necessary, must be included; signatures of all the appropriate owners' must be affixed to the application and notarized; and the appropriate fee must be paid.

**FEE SCHEDULE**

Each application to change the place of use or the point of diversion under this section shall be accompanied by the application fee set forth in the schedule below: Make checks payable to: **Kansas Department of Agriculture**

- (1) Application to change a point of diversion 300 feet or less ..... \$100
- (2) Application to change a point of diversion more than 300 feet ..... \$200
- (3) Application to change the place of use ..... \$200







# Change App. PU, File No. 26527

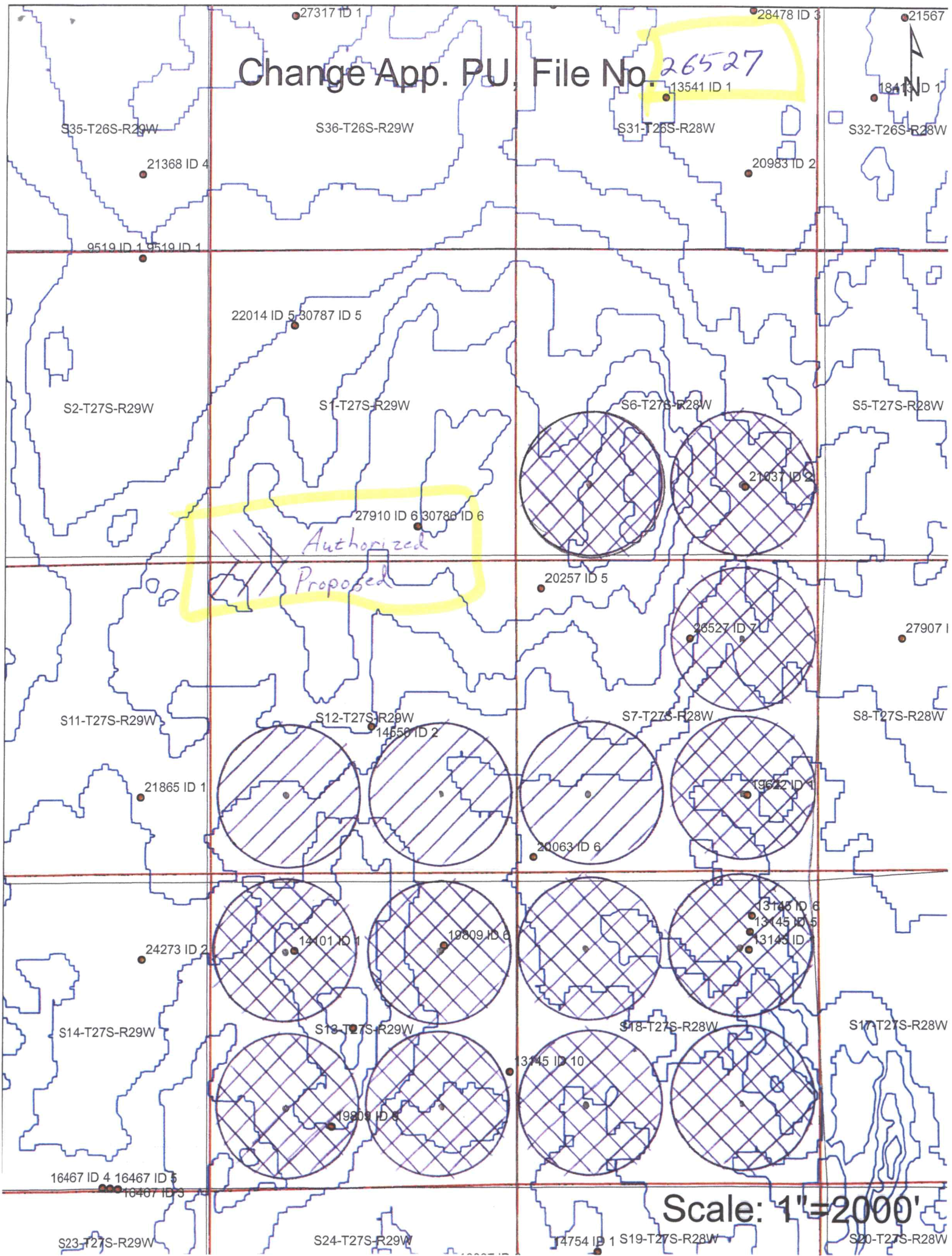

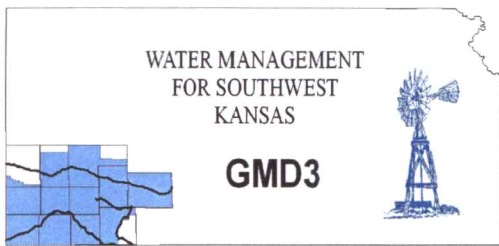

**Southwest Kansas**  
**Groundwater Management District No. 3**  
2009 E. Spruce Street  
Garden City, Kansas 67846  
(620) 275-7147 phone (620) 275-1431 fax  
www.gmd3.org

August 16, 2021

Michael A. Meyer  
Division of Water Resources  
4532 W Jones Ave., Suite B  
Garden City, Kansas 67846

RE: Applications for Change in Place of Use  
Water Right, File Nos. 13145, 14101, 14550, 19622, 19809, 20063, 21037, 21455 &  
26527

Dear Mike:

We have assisted with the applications for the above referenced water rights. The proposals are not in conflict with the Management Program of the Southwest Kansas Groundwater Management District No. 3 (GMD3). The proposed change in place of use will make a complete overlap in place of use and is in accordance with K.A.R. 5-5-11(b). No new acres are being proposed. It is therefore recommended that the applications be approved at this time.

Thank you for the opportunity to review the applications and to provide a recommendation. If you have any questions, please don't hesitate to contact us.

Sincerely,

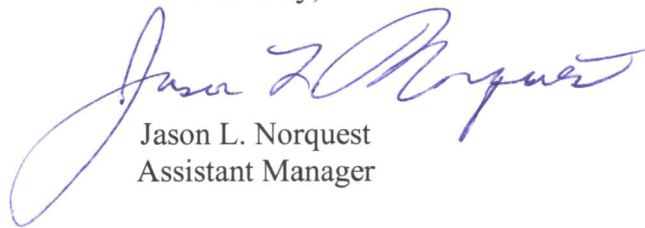

Jason L. Norquest  
Assistant Manager

RECEIVED

AUG 24 2021

Garden City Field Office  
Division of Water Resources