

Kansas Department of Agriculture  
 Division of Water Resources  
**CHANGE: P/U WORKSHEET**

1. File Number: <b>41191-D1</b>	2. Status Change Date: <i>4/20/21</i>	3. Change Num: <b>C2</b>	4. Field Office: <b>04</b>	5. GMD: <b>03</b>
------------------------------------	--	-----------------------------	-------------------------------	----------------------

6. Status: <input type="checkbox"/> Approved <input type="checkbox"/> Denied by DWR/GMD <input type="checkbox"/> Dismiss by Request/Failure to Return	7. Filing Date of Change: <b>3/19/2021</b>
---	---

8a. Applicant(s) New to system <input type="checkbox"/>  <b>WALTER BEESLEY</b> <b>PO BOX 818</b> <b>HUGOTON, KS 67951</b>	Person ID <u>1056</u> Add Seq# <u>1</u>
8c. Landowner(s) New to system <input type="checkbox"/>	Person ID Add Seq#

8b. Landowner(s) New to system <input type="checkbox"/>  <b>MID AMERICA CATTLE CO</b> <b>Attn: WALTER BEESLEY</b> <b>PO BOX 818</b> <b>HUGOTON, KS 67951-0818</b>	Person ID <u>39574</u> Add Seq# <u>1</u>
8d. WUC New to system <input type="checkbox"/>  <b>WALTER BEESLEY</b> <b>PO BOX 818</b> <b>HUGOTON, KS 67951</b>  <b>NO CHANGE</b>	Person ID <u>1056</u> Add Seq# <u>1</u>

9. Documents and Enclosure(s):  DWR Meter(s) Date to Comply: 12/31/21  N & P Date to Comply: \_\_\_\_\_

Anti-Reverse Meter  
  Meter Seal  
  Check Valve  
  N & P Form  
  Water Tube  
  Driller Copy  
  H & E Letter

Conservation Plan  
 Date Required: \_\_\_\_\_  
 Date Approved: \_\_\_\_\_  
 Date to Comply: \_\_\_\_\_

10. Use Made of Water    From: \_\_\_\_\_    To: \_\_\_\_\_

Date Prepared: **3/31/2021**    By: **MAM**

Date Entered: \_\_\_\_\_    By: \_\_\_\_\_



Garden City Field Office  
4532 W. Jones, Suite B  
Garden City, KS 67846



Phone: 620-276-2901  
Fax: 620-276-9315  
[www.agriculture.ks.gov](http://www.agriculture.ks.gov)

Mike Beam, Secretary

Laura Kelly, Governor

April 1, 2021

WALTER BEESLEY  
PO BOX 818  
HUGOTON, KS 67951

RE: Water Right, File Nos. 22858, 24942-D1, 27034, 38511, 41191-D1, 42019,  
45333, 45507, 45742

Dear Sir:

Enclosed are orders executed by the designee of the Chief Engineer, Division of Water Resources, Kansas Department of Agriculture, approving the applications for change under the above referenced file numbers.

Your attention is directed to the enclosures and to the terms, conditions, and limitations specified in the approval for change. A condition of these approvals is that an acceptable water flow meter must be installed on the diversion works authorized under the referenced file number and meet current specifications. Please return the required notification of completion of the diversion works and installation of the required water flowmeter as soon as these actions are completed.

Since the orders modify the original documents referred to above, it should be recorded with the Register of Deeds as other instruments affecting real estate.

Should you have any questions, please feel free contact this office. If you would prefer, you could arrange an appointment for additional assistance.

Sincerely,

A handwritten signature in blue ink that reads "Michael A. Meyer".

Michael A. Meyer  
Water Commissioner

MAM  
enclosures

pc: Mid America Cattle Co  
GMD3

**CERTIFICATE OF SERVICE**

On this 1<sup>st</sup> day of April 2021, I hereby certify that the foregoing Approval of Applications for Change in Place of Use, Water Right, File Nos. 22858, 24942-D1, 27034, 38511, 41191-D1, 42019, 45333, 45507, 45742 dated 1<sup>st</sup> day of April 2021 was mailed postage prepaid, first class, US mail to the following:

WALTER BEESLEY  
PO BOX 818  
HUGOTON, KS 67951

Pc:

MID AMERICA CATTLE CO  
Attn: WALTER BEESLEY  
PO BOX 818  
HUGOTON, KS 67951-0818

GROUNDWATER MANAGEMENT DISTRICT NO. 3

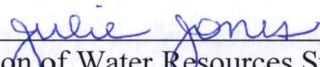
  
\_\_\_\_\_  
Division of Water Resources Staff

Submit completed application to:  
 Kansas Department of Agriculture  
 Division of Water Resources  
 Field Office for your area.  
 Call for address:

Topeka -- (785) 296-5733  
 Stafford -- (620) 234-5311  
 Stockton -- (785) 425-6787  
 Garden City -- (620) 276-2901  
<http://agriculture.ks.gov/dwr>

## DWR FIELD OFFICE APPLICATION FOR APPROVAL TO CHANGE THE PLACE OF USE AND/OR THE POINT OF DIVERSION



**STATE OF KANSAS**

**Filing Fee Must Accompany the Application, K.S.A. 82a-708b(b), as amended.**  
 Fee Schedule is on the third page of this application form.

**Paragraph Nos. 1, 2, 3 & 5 must be completed. Complete all other applicable portions.** If change in point of diversion is greater than 100 feet, or if place of use will be changed, include a topographic map or detailed plat showing the authorized and proposed point(s) of diversion and/or place of use.

File No. 41191 D1 \_\_\_\_\_

**RECEIVED**  
 11:34 AM  
**MAR 19 2021**

1. Application is hereby made for approval of the Chief Engineer to change the (check one or both):

Place of Use                       Point of Diversion

under the water right which is the subject of this application in accordance with the conditions described below.

The source of supply is:                       Groundwater                       Surface water

Garden City Field Office  
 Division of Water Resources

2. Name and address of Applicant: MID AMERICA CATTLE CO (ATTN WALTER BEESLEY) \_\_\_\_\_  
 PO BOX 818 HUGOTON KS 67951

Phone Number: \_\_\_\_\_ Email address: \_\_\_\_\_

Name and address of Water Use Correspondent: WALTER BEESLEY \_\_\_\_\_  
 PO BOX 818 HUGOTON KS 67951

Phone Number: ( ) \_\_\_\_\_ Email address: \_\_\_\_\_

3. The presently authorized place of use is:

Owner of Land ---- NAME: MID AMERICA CATTLE CO \_\_\_\_\_  
 ADDRESS: PO BOX 818 HUGOTON KS 67951 - 0818 \_\_\_\_\_

(If there is more than one landowner, attach supplemental sheets as necessary.)

Sec.	Twp.	Range	NE¼				NW¼				SW¼				SE¼				TOTAL ACRES
			NE¼	NW¼	SW¼	SE¼	NE¼	NW¼	SW¼	SE¼	NE¼	NW¼	SW¼	SE¼	NE¼	NW¼	SW¼	SE¼	
13	34S	38W									30.5	30.5	30.5	30.5	30.5	30.5	30.5	30.5	244
18	34S	37W									30.5	6.3	6.4	30.5					122
14	34S	38W	40	40	40	40	40			40	40			10	40	40	14	40	424

4. If this application is for a change in place of use, it is proposed that the place of use be changed to:

Owner of Land ---- NAME: MID AMERICA CATTLE CO \_\_\_\_\_  
 ADDRESS: PO BOX 818 HUGOTONKS 67951 - 0818 \_\_\_\_\_

(If there is more than one landowner, attach supplemental sheets as necessary.)

Sec.	Twp.	Range	NE¼				NW¼				SW¼				SE¼				TOTAL ACRES
			NE¼	NW¼	SW¼	SE¼	NE¼	NW¼	SW¼	SE¼	NE¼	NW¼	SW¼	SE¼	NE¼	NW¼	SW¼	SE¼	
13	34S	38W									30.5	30.5	30.5	30.5	30.5	30.5	30.5	30.5	244
18	34S	37W									30.5	6.3	6.4	30.5					122
14	34S	38W	40	40	40	40	40			40	40			10	40	40	14	40	424

**For Office Use Only:** Code \_\_\_\_\_ Fee \$ 200.00 TR # \_\_\_\_\_ Receipt Date 3-19-21 Check # 9780

5. **Presently authorized point of diversion:**  
 One in the \_\_\_\_\_ Quarter of the \_\_\_\_\_ Quarter of the \_\_\_\_\_ Quarter  
 of Section \_\_\_\_\_, Township \_\_\_\_\_ South, Range \_\_\_\_\_ (W),  
 in Stanton \_\_\_\_\_ County, Kansas, \_\_\_\_\_ feet North \_\_\_\_\_ feet West of Southeast corner of section.  
 Authorized Rate \_\_\_\_\_ Authorized Quantity \_\_\_\_\_ Depth of well \_\_\_\_\_ (feet)  
**(DWR use only: Computer ID No. \_\_\_\_\_ GPS \_\_\_\_\_ feet North \_\_\_\_\_ feet West)**  
 This point will not be changed  This point will be changed as follows:  No change, point better described with GPS as follows:  
**Proposed point of diversion: (Complete only if change is requested or if existing point is better described by GPS)**  
 One in the \_\_\_\_\_ Quarter of the \_\_\_\_\_ Quarter of the \_\_\_\_\_ Quarter  
 of Section \_\_\_\_\_, Township \_\_\_\_\_ South, Range \_\_\_\_\_ (E/W),  
 in \_\_\_\_\_ County, Kansas, \_\_\_\_\_ feet North \_\_\_\_\_ feet West of Southeast corner of section.  
 Proposed Rate \_\_\_\_\_ Proposed Quantity \_\_\_\_\_ Proposed well depth (feet) \_\_\_\_\_  
 This point is:  Additional Well  Geo Center List other water rights that will use this point \_\_\_\_\_

6. **Presently authorized point of diversion:**  
 One in the \_\_\_\_\_ Quarter of the \_\_\_\_\_ Quarter of the \_\_\_\_\_ Quarter  
 of Section \_\_\_\_\_, Township \_\_\_\_\_ South, Range \_\_\_\_\_ (E/W),  
 in \_\_\_\_\_ County, Kansas, \_\_\_\_\_ feet North \_\_\_\_\_ feet West of Southeast corner of section.  
 Authorized Rate \_\_\_\_\_ Authorized Quantity \_\_\_\_\_ Depth of well \_\_\_\_\_ (feet)  
**(DWR use only: Computer ID No. \_\_\_\_\_ GPS \_\_\_\_\_ feet North \_\_\_\_\_ feet West)**  
 This point will not be changed  This point will be changed as follows:  No change, point better described with GPS as follows:  
**Proposed point of diversion: (Complete only if change is requested or if existing point is better described by GPS)**  
 One in the \_\_\_\_\_ Quarter of the \_\_\_\_\_ Quarter of the \_\_\_\_\_ Quarter  
 of Section \_\_\_\_\_, Township \_\_\_\_\_ South, Range \_\_\_\_\_ (E/W),  
 in \_\_\_\_\_ County, Kansas, \_\_\_\_\_ feet North \_\_\_\_\_ feet West of Southeast corner of section.  
 Proposed Rate \_\_\_\_\_ Proposed Quantity \_\_\_\_\_ Proposed well depth (feet) \_\_\_\_\_  
 This point is:  Additional Well  Geo Center List other water rights that will use this point \_\_\_\_\_

7. The changes herein are desired for the following reasons?  
 (please be specific) \_\_\_\_\_  
 \_\_\_\_\_  
 \_\_\_\_\_

8. If a well, is the test hole log attached?  Yes  No

9. The change(s) (was)(will be) completed by?  
 \_\_\_\_\_  
 \_\_\_\_\_

10. If the point of diversion is a well:  
 (a) What are you going to do with the old well?  
 \_\_\_\_\_  
 Not Applicable  
 (b) When will this be done? \_\_\_\_\_

11. Groundwater Management District recommendation attached?  
 Yes  No

12. Assisted by Alex Torrance

13a. If the proposed point of diversion will be relocated more than 300 feet but within 2,640 feet of the existing point of diversion, attach a topographic map or aerial photograph. For groundwater sources, show all wells (including domestic) within one-half mile of the proposed point of diversion and the names and mailing addresses of the owners. For surface water sources, show the names and addresses of the landowner(s) one-half mile downstream and one-half mile upstream from your property lines

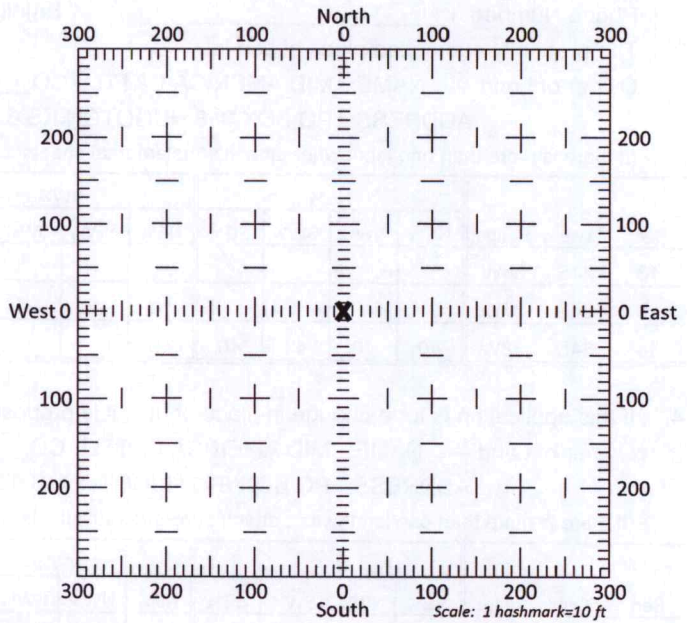

13b. If the proposed point of diversion will be relocated within 300 feet of the existing point of diversion, indicate its location on the diagram shown above in relation to the existing point of diversion. (PLEASE NOTE: The "X" in center of diagram above represents the presently authorized point of diversion.)

APPLICATION FOR APPROVAL TO CHANGE  
THE PLACE OF USE AND/OR POINT OF DIVERSION  
SUPPLEMENTAL SHEET

FILE NO. 41191D1  
MAKE ADDITIONAL COPIES AS NECESSARY

3. *Continued:* The presently authorized place of use is:

Owner of Land ---- NAME: MID AMERICA CATTLE CO  
ADDRESS: PO BOX 818 HUGOTON KS 67951 - 0818

Sec.	Twp.	Range	NE¼				NW¼				SW¼				SE¼				TOTAL ACRES
			NE¼	NW¼	SW¼	SE¼	NE¼	NW¼	SW¼	SE¼	NE¼	NW¼	SW¼	SE¼	NE¼	NW¼	SW¼	SE¼	
19	34S	37W	12	35	40	35	35	12	35	40	40	35	12	35	35	40	35	12	488

Owner of Land ---- NAME: \_\_\_\_\_  
ADDRESS: \_\_\_\_\_

Sec.	Twp.	Range	NE¼				NW¼				SW¼				SE¼				TOTAL ACRES
			NE¼	NW¼	SW¼	SE¼	NE¼	NW¼	SW¼	SE¼	NE¼	NW¼	SW¼	SE¼	NE¼	NW¼	SW¼	SE¼	

Owner of Land ---- NAME: \_\_\_\_\_  
ADDRESS: \_\_\_\_\_

Sec.	Twp.	Range	NE¼				NW¼				SW¼				SE¼				TOTAL ACRES
			NE¼	NW¼	SW¼	SE¼	NE¼	NW¼	SW¼	SE¼	NE¼	NW¼	SW¼	SE¼	NE¼	NW¼	SW¼	SE¼	

4. *Continued:* If this application is for a change in place of use, it is proposed that the place of use be changed to:

Owner of Land ---- NAME: MID AMERICA CATTLE CO  
ADDRESS: PO BOX 818 HUGOTON KS 67951 - 0818

Sec.	Twp.	Range	NE¼				NW¼				SW¼				SE¼				TOTAL ACRES
			NE¼	NW¼	SW¼	SE¼	NE¼	NW¼	SW¼	SE¼	NE¼	NW¼	SW¼	SE¼	NE¼	NW¼	SW¼	SE¼	
19	34S	37W	12	35	40	35	35	12	35	40	40	35	12	35	35	40	35	12	488

Owner of Land ---- NAME: MID AMERICA CATTLE CO  
ADDRESS: PO BOX 818 HUGOTON KS 67951 - 0818

Sec.	Twp.	Range	NE¼				NW¼				SW¼				SE¼				TOTAL ACRES
			NE¼	NW¼	SW¼	SE¼	NE¼	NW¼	SW¼	SE¼	NE¼	NW¼	SW¼	SE¼	NE¼	NW¼	SW¼	SE¼	
18	34S	37W													40	40	40	40	160

Owner of Land ---- NAME: \_\_\_\_\_  
ADDRESS: \_\_\_\_\_

Sec.	Twp.	Range	NE¼				NW¼				SW¼				SE¼				TOTAL ACRES
			NE¼	NW¼	SW¼	SE¼	NE¼	NW¼	SW¼	SE¼	NE¼	NW¼	SW¼	SE¼	NE¼	NW¼	SW¼	SE¼	

14. If the proposed groundwater point of diversion is 300 or fewer feet from the existing point of diversion, complete the following:
- (a) Does the undersigned represent all owners of the currently authorized place(s) of use identified in this application?  
 Yes     No    (If no, all owners must sign this application.)
  - (b) Will the ownership interest of any owner of the currently authorized place(s) of use identified in this application be adversely affected if this application is approved as requested?  
 Yes     No    (If yes, all owners must sign this application.)
  - (c) If this application is not approved expeditiously, will there be substantial damage to property, public health or safety?  
 Yes     No    (If no, all owners must sign this application.)

If the application proposes a surface water change in point of diversion, a groundwater change in point of diversion greater than 300 feet, or a change in place of use, the application must be signed by all owners of the currently authorized place of use, or their duly authorized agent (attach notarized statement authorizing representation).

I hereby verify, being first duly sworn upon my oath or affirmation and under penalty of perjury, that I am of lawful age and the owner, the spouse of the owner, or a duly authorized agent of the owner(s) to make this application on their behalf, in regards to the water right(s) to which this application pertains. I further verify that the statements contained in this application are true, correct and complete.

Dated at Huyagon, Kansas, this 18<sup>th</sup> day of March, 2021.

Mid America Cattle Co  
Walter Beesley Pres  
 (Owner) \_\_\_\_\_ (Spouse) \_\_\_\_\_

Walter Beesley President  
 (Please Print) \_\_\_\_\_ (Please Print) \_\_\_\_\_

\_\_\_\_\_  
 (Owner) \_\_\_\_\_ (Spouse) \_\_\_\_\_

\_\_\_\_\_  
 (Please Print) \_\_\_\_\_ (Please Print) \_\_\_\_\_

\_\_\_\_\_  
 (Owner) \_\_\_\_\_ (Spouse) \_\_\_\_\_

\_\_\_\_\_  
 (Please Print) \_\_\_\_\_ (Please Print) \_\_\_\_\_

State of Kansas }  
 County of Stevens } SS

**DELETA HOSKINSON**  
**NOTARY PUBLIC, STATE OF KANSAS**  
 My Appt. Exp. 7-18-21

I hereby certify that the foregoing application was signed in my presence and sworn to before me this 18 day of March, 2021.

Deleta Hoskinson  
 Notary Public

My Commission Expires 7-18-21

**ONLY COMPLETE APPLICATIONS WILL BE PROCESSED.** To be complete, all of the applicable portions of the application form must be completed with accurate information; maps, if necessary, must be included; signatures of all the appropriate owners' must be affixed to the application and notarized; and the appropriate fee must be paid.

**FEE SCHEDULE**

Each application to change the place of use or the point of diversion under this section shall be accompanied by the application fee set forth in the schedule below: Make checks payable to: **Kansas Department of Agriculture**

- (1) Application to change a point of diversion 300 feet or less ..... \$100
- (2) Application to change a point of diversion more than 300 feet ..... \$200
- (3) Application to change the place of use ..... \$200



**SUMMARY ORDER APPROVING APPLICATION FOR CHANGE AND IMPOSING CONDITIONS**

This Summary Order is issued under authority of K.S.A. 82a-708b, as amended, and K.A.R. 5-5-1, *et seq.* and other applicable provisions of the *Kansas Water Appropriation Law, K.S.A. 82a-701 et. seq.*, and rules and regulations promulgated thereunder. With the exception of those conditions expressly contained herein, this Summary Order does not change the terms, conditions and limitations of File No. 41191 D1.

1. A change application was received on March 19, 2021 requesting that the place of use and / or point of diversion authorized under the above-referenced file number be changed as described in the application.
2. On and after the effective date of this summary order, the authorized place(s) of use shall be located substantially as shown on the topographic map accompanying the application to change the place of use.  Applicable  Not Applicable
3. The change in point of diversion shall not impair existing rights and shall be limited to the same source or sources of water as previously authorized. The point of diversion authorized by this summary order shall be located within a \_\_\_\_\_ foot radius of the authorized point(s) of diversion.  Applicable  Not Applicable
4. The point(s) of diversion described herein is administratively corrected to be more accurately described using the Global Positioning System (GPS), as described in the application.  Applicable  Not Applicable
5. The point(s) of diversion authorized herein shall not actually be located more than \_\_\_\_\_ feet from the previously authorized point(s) of diversion.  Applicable  Not Applicable
6. As required by K.A.R. 5-3-5d, if the works for diversion is a well with a diversion rate of 100 gallons per minute or more, a tube or other device suitable for making water level measurements shall be installed, operated and maintained in accordance with K.A.R. 5-6-13.  Applicable  Not Applicable
7. **The owner of the authorized place(s) of use shall properly install an acceptable water flow meter on or before December 31, 2021**, or before the first use of water, whichever occurs first. The water flow meter shall be installed, operated and maintained in accordance with K.A.R. 5-1-4 through 5-1-12. As required by K.S.A. 82a-732, as amended, and K.A.R. 5-3-5e, the owner shall maintain records and report the reading of the water flow meter and the total quantity of water diverted annually to the Chief Engineer by March 1 following the end of each calendar year.  Applicable  Not Applicable
8. **Installation of the works for diversion of water shall be completed on or before December 31, 2021**, or within any authorized extension of time. By March 1, 2021 the applicant shall notify the Chief Engineer that construction of the works for diversion has been completed, on the form provided by the Chief Engineer, as required by K.A.R. 5-8-4e.  Applicable  Not Applicable
9. **The completed well log shall be submitted with the required notice.**  Applicable  Not Applicable
10. All diversion works into which any type of chemical or other foreign substance will be injected into the water shall be equipped with an in-line, automatic, quick-closing check valve capable of preventing pollution of the source of the water supply. The check valve(s) shall be installed, operated and maintained in accordance with K.A.R. 5-3-5c.  Applicable  Not Applicable
11. Additional Conditions are attached.  Yes  No
12. In accordance with K.S.A. 82a-708a, as amended, and K.A.R. 5-5-14, all of the owners of the authorized place(s) of use of water appropriated under the above-referenced file number are responsible for compliance with its terms, conditions and limitations, as amended and/or supplemented by this Summary Order, and with applicable provisions of the *Kansas Water Appropriation Law* and the *Rules and Regulations* promulgated thereunder. Failure to comply with these provisions may result in civil penalties pursuant to K.S.A. 82a-737, as amended, and/or the suspension or revocation and dismissal of the water or appropriation right or any other enforcement actions authorized by law.

**Administrative Appeal and Effective Date of Order**

If you are aggrieved by this order, pursuant to K.S.A. 82a-1901, you may request an evidentiary hearing before the Chief Engineer or request administrative review by the Secretary of Agriculture. A request for hearing by the Chief Engineer must be filed within **15 days** of service of this Order and a request for administrative review by the Secretary must be filed within **30 days** pursuant to K.S.A. 77-531. Any request for administrative review must state a basis for review pursuant to K.S.A. 77-527. File any request with **Kansas Department of Agriculture, Legal Division, 1320 Research Park Drive, Manhattan, KS 66502**. Failure to timely request a hearing or review may preclude review under the Kansas Judicial Review Act.

*For Use by Register of Deeds*

FOR OFFICE USE ONLY  
**APPLICATION APPROVED AND  
SUMMARY ORDER ISSUED**

By: Michael A. Meyer  
Duly Authorized Designee of the Chief Engineer  
(Print Name): MICHAEL A. MEYER  
Division of Water Resources - Kansas Department of Agriculture  
Date of Issuance: April 1, 2021  
State of Kansas )  
County of Finney ) SS  
Acknowledged before me on April 1, 2021  
by Michael A. Meyer  
Signature: Julie Jones  
My commission expires: \_\_\_\_\_



CHANGE IN PLACE OF USE 41191-D1

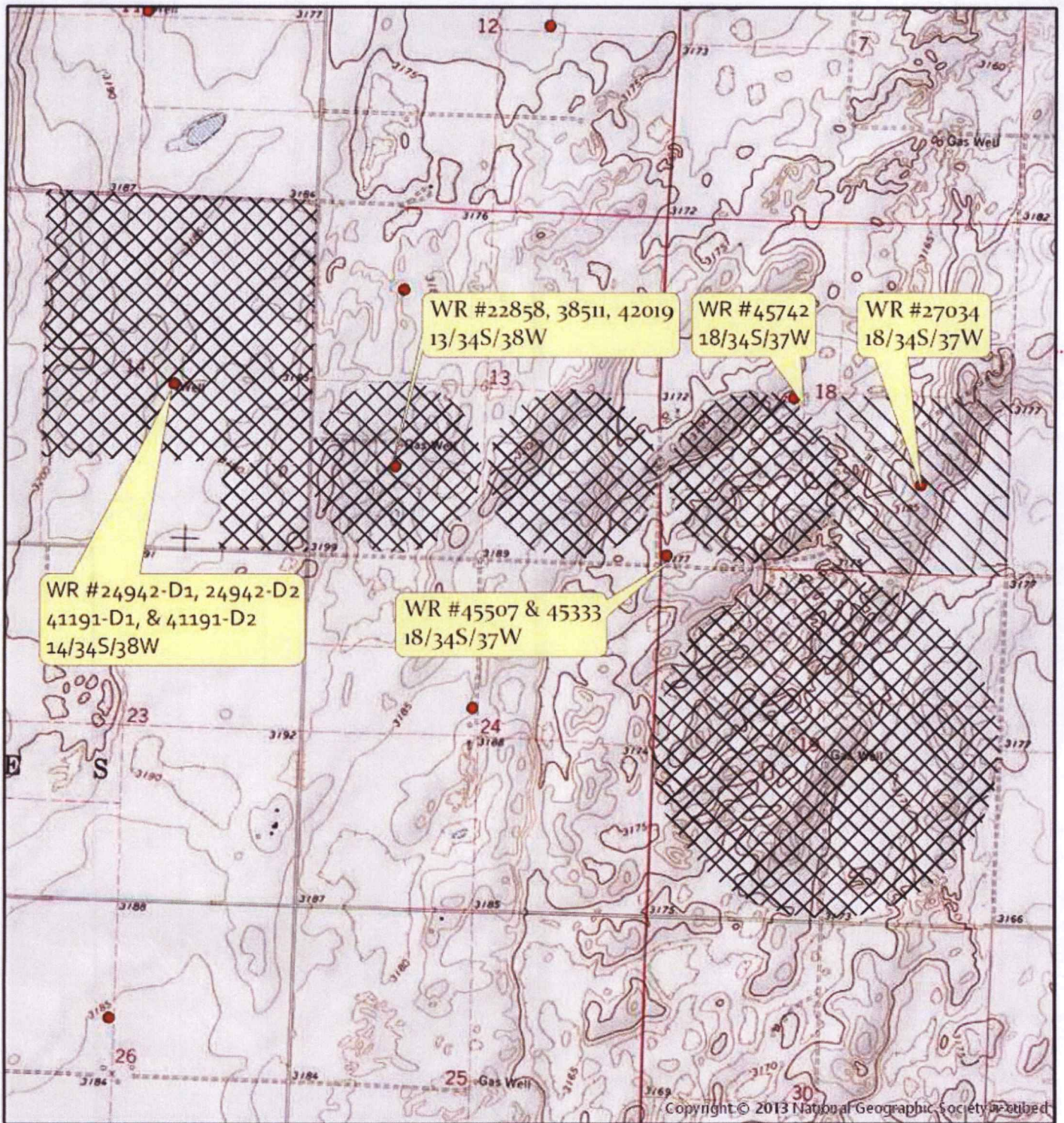

Township 34 South Range 38 West  
SV County

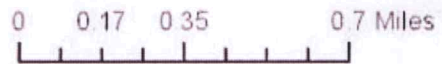

PROPOSED PLACE OF USE



AUTHORIZED PLACE OF USE

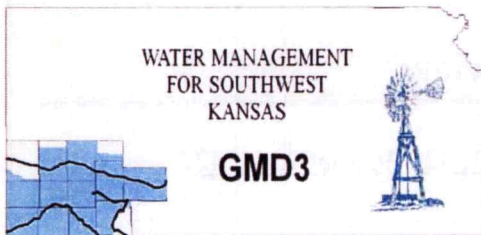

**Southwest Kansas**  
**Groundwater Management District No. 3**  
2009 E. Spruce Street  
Garden City, Kansas 67846  
(620) 275-7147 phone (620) 275-1431 fax  
www.gmd3.org

March 29, 2021

Michael A. Meyer  
Division of Water Resources  
4532 W Jones Ave., Suite B  
Garden City, Kansas 67846

RE: Applications for Change in Place of Use  
Water Right, File Nos. 22858, 24942 D1, 27034,38511, 41191 D1, 42019, 45507 &  
45742

Dear Mike:

We have reviewed the applications for the above referenced water rights. The proposal is not in conflict with the Management Program of the Southwest Kansas Groundwater Management District No. 3 (GMD3). The proposed change in place of use will make a complete overlap in place of use with no new acres being proposed, which is in accordance with K.A.R. 5-5-11. It is therefore recommended that the applications be approved at this time.

Thank you for the opportunity to review the applications and to provide a recommendation. If you have any questions, please don't hesitate to contact us.

Sincerely,

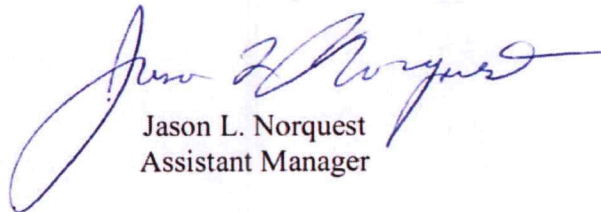

Jason L. Norquest  
Assistant Manager

**RECEIVED**  
**MAR 29 2021**  
Garden City Field Office  
Division of Water Resources

## GMD3 Change Review

---

File No(s): 22858, 24942D1, 27034, 38511, 41191D1, 42019, 45507, 45742.

DWR office: GC.

App filed to change: PU.

Is Landowner(s) correct in WRIS: Mid America Cattle Co.

If NO, is documentation included?

Is Water Use Correspondent correct in WRIS? \_\_\_.

If NO, is documentation included?

Regulation(s) Reviewed: KAR 5-5-11

Point of diversion ID No(s) \_\_\_ being changed.

	ft. North	ft. West	
Authorized PD			
Proposed PD			
Difference	0	0	
$a^2 + b^2 = c^2$	0	0	0

GPS for proposed PD: Lat: \_\_\_ Long: \_\_\_.

Is proposed PD stacking on existing WRs? No Change.

Is Proposed PU overlapping existing WRs? Proposed complete overlap, no new acres.

Neighboring certified well(s) notified: \_\_\_.

Name \_\_\_.

Address \_\_\_.

Zip \_\_\_.

Email: \_\_\_. Phone: \_\_\_.

Domestic well(s) notified: \_\_\_.

Name \_\_\_.

Address \_\_\_.

Zip \_\_\_.

Base Acres: \_\_\_.

Perfected Acres: \_\_\_.

Irr. Return-Flow \_\_\_%

**27034 Currently authorizes 160acres SE 18-34-37**

**All the rest authorize:**

**244acres S 13**

**122acres SW18**

**424acres section 14**

**488acres in 19**

**This will bring in the SE of 18 for a complete overlap.**

**All acres already listed proposed to still be listed.**

Is a waiver needed: No new acres, proposed making a complete overlap in PU for existing acres under the water rights.

## GMD3 Change Review

---

Recommendation: After review of all available information, it appears current area rules are met. No new acres being proposed. Staff therefore recommends approval of the application.



RECEIVED

MAR 29 2021

Garden City Field Office  
Division of Water Resources

**Meyer, Mike [KDA]**

---

**From:** Meyer, Mike [KDA]  
**Sent:** Tuesday, March 23, 2021 8:14 AM  
**To:** 'Norquest, Jason (Norquest@gmd3.org)'  
**Subject:** request for recommendation, File Nos. 24858 et al,  
**Attachments:** 20210323075810405.pdf

good morning

attached are applications to change the place of use to make a complete overlap for Mid America Cattle Company. essentially adding file no. 27034 to the already overlapped group.

please review and provide a recommendation within 15 days.

thank you

*Mike*

Garden City Field Office  
4532 W. Jones, Suite B  
Garden City, KS 67846



Phone: 620-276-2901  
Fax: 620-276-9315  
[www.agriculture.ks.gov](http://www.agriculture.ks.gov)

Mike Beam, Secretary

Laura Kelly, Governor

March 23, 2021

SOUTHWEST KANSAS GROUNDWATER  
MANAGEMENT DISTRICT NO. 3  
2009 E SPRUCE ST  
GARDEN CITY KS 67846

Re: Water Right,  
File Nos. 22858, 24942-D1, 27034, 38511,  
41191-D1, 42019, 45333, 45507, 45742

Dear Mr. Norquest:

This is to advise you that Mid America Cattle Co has filed applications for approval of the Chief Engineer, Division of Water Resources, Kansas Department of Agriculture, to change the place of use for the above referenced files.

We are delaying action on the change application to allow you time to review and provide a recommendation. Please submit a recommendation within 15 days from the date of this letter.

Thank you and as always feel free to contact this office at any time.

Sincerely,

Michael A. Meyer  
Water Commissioner

MAM  
Enclosures