

Kansas Department of Agriculture
 Division of Water Resources
CHANGE: P/U WORKSHEET

1. File Number: 42019	2. Status Change Date: 4-1-2021	3. Change Num: C2	4. Field Office: 04	5. GMD: 03
---------------------------------	---	-----------------------------	-------------------------------	----------------------

6. Status: <input type="checkbox"/> Approved <input type="checkbox"/> Denied by DWR/GMD <input type="checkbox"/> Dismiss by Request/Failure to Return	7. Filing Date of Change: 3/19/2021
---	---

8a. Applicant(s) New to system <input type="checkbox"/> WALTER BEESLEY PO BOX 818 HUGOTON, KS 67951	Person ID <u>1056</u> Add Seq# <u>1</u> 8c. Landowner(s) New to system <input type="checkbox"/> Person ID Add Seq#
--	---

8b. Landowner(s) New to system <input type="checkbox"/> MID AMERICA CATTLE CO Attn: WALTER BEESLEY PO BOX 818 HUGOTON, KS 67951-0818	Person ID <u>39574</u> Add Seq# <u>1</u> 8d. WUC New to system <input type="checkbox"/> Person ID <u>1056</u> Add Seq# <u>1</u> WALTER BEESLEY PO BOX 818 HUGOTON, KS 67951 NO CHANGE
---	--

9. Documents and Enclosure(s): DWR Meter(s) Date to Comply: **12/31/21** N & P Date to Comply: _____

Anti-Reverse Meter Meter Seal Check Valve N & P Form Water Tube Driller Copy H & E Letter

Conservation Plan Date Required: _____ Date Approved: _____ Date to Comply: _____

10. Use Made of Water From: _____ To: _____

Date Prepared: **3/31/2021** By: **MAM**
 Date Entered: _____ By: _____

File No. **42019** 11. County: **SV** Basin: **CIMARRON RIVER** Stream: _____ Formation Code: _____ Special Use: _____

12. Points of Diversion
 CHK
 MOD
 DEL PDIV
 ENT Qualifier S T R ID 'N 'W Comment (AKA Line) Rate gpm/cfs Quantity af/mgy Rate gpm/cfs Quantity af/mgy Overlap PD Files

NO CHANGES

13. Storage: Rate _____ NF Quantity _____ ac/ft Additional Rate _____ NF Additional Quantity _____ ac/ft

14. Limitation: _____ gpm (_____ cfs) when combined with file number(s) _____
 Limitation: _____ gpm (_____ cfs) when combined with file number(s) _____

15. 5YR Allocation: Allocation Type _____ Start Year _____ 5 YR Amount _____ Amount Unit _____ Base Acres _____ Comment _____

16. Place of Use CHK MOD DEL ENT PUSE S T R ID	NE¼				NW¼				SW¼				SE¼				Total	Owner	Chg?	Overlap Files		
	NE¼	NW¼	SW¼	SE¼	NE¼	NW¼	SW¼	SE¼	NE¼	NW¼	SW¼	SE¼	NE¼	NW¼	SW¼	SE¼						
MOD 24523 18 34 37W 3 PU COMMENT L-3 (NW SW), L-4 (SW SW)										30.50	L-3 30.50	L-4 30.50	30.50	40	40	40	40	282.00	22858, 24,942-D1; 27034, 38,511; 41,191-D1; 45,333, 45,507 and 45,742	8B	YES	see above
CHK55646 19 34 37W 2 PU COMMENT L-1 (NW NW), L-2 (SW NW) L-3 (NW SW), L-4 (SW SW)	12.00	35.00	40.00	35.00	35.00	L-1 12.00	L-2 35.00	40.00	40.00	40.00	L-3 35.00	L-4 12.00	35.00	35.00	40.00	35.00	12.00	488.00		8B	NO	see above
CHK 2905 13 34 38W 1										30.50	30.50	30.50	30.50	30.50	30.50	30.50	30.50	244.00		8B	NO	see above
CHK 53448 14 34 38W 4	40.00	40.00	40.00	40.00	40.00				40.00	40.00			10.00	40.00	40.00	14.00	40.00	424.00		8B	NO	see above

Base Acres: _____ Year: _____ Minimum Reasonable Quantity: _____
 Comments: _____

Garden City Field Office
4532 W. Jones, Suite B
Garden City, KS 67846



Phone: 620-276-2901
Fax: 620-276-9315
www.agriculture.ks.gov

Mike Beam, Secretary

Laura Kelly, Governor

April 1, 2021

WALTER BEESLEY
PO BOX 818
HUGOTON, KS 67951

RE: Water Right, File Nos. 22858, 24942-D1, 27034, 38511, 41191-D1, 42019,
45333, 45507, 45742

Dear Sir:

Enclosed are orders executed by the designee of the Chief Engineer, Division of Water Resources, Kansas Department of Agriculture, approving the applications for change under the above referenced file numbers.

Your attention is directed to the enclosures and to the terms, conditions, and limitations specified in the approval for change. A condition of these approvals is that an acceptable water flow meter must be installed on the diversion works authorized under the referenced file number and meet current specifications. Please return the required notification of completion of the diversion works and installation of the required water flowmeter as soon as these actions are completed.

Since the orders modify the original documents referred to above, it should be recorded with the Register of Deeds as other instruments affecting real estate.

Should you have any questions, please feel free contact this office. If you would prefer, you could arrange an appointment for additional assistance.

Sincerely,

A handwritten signature in blue ink, appearing to read "Michael A. Meyer".

Michael A. Meyer
Water Commissioner

MAM
enclosures

pc: Mid America Cattle Co
GMD3

CERTIFICATE OF SERVICE

On this 1st day of April 2021, I hereby certify that the foregoing Approval of Applications for Change in Place of Use, Water Right, File Nos. 22858, 24942-D1, 27034, 38511, 41191-D1, 42019, 45333, 45507, 45742 dated 1st day of April 2021 was mailed postage prepaid, first class, US mail to the following:

WALTER BEESLEY
PO BOX 818
HUGOTON, KS 67951

Pc:

MID AMERICA CATTLE CO
Attn: WALTER BEESLEY
PO BOX 818
HUGOTON, KS 67951-0818

GROUNDWATER MANAGEMENT DISTRICT NO. 3

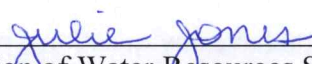

Division of Water Resources Staff

Submit completed application to:
 Kansas Department of Agriculture
 Division of Water Resources
 Field Office for your area.
 Call for address:

Topeka -- (785) 296-5733
 Stafford -- (620) 234-5311
 Stockton -- (785) 425-6787
 Garden City -- (620) 276-2901
<http://agriculture.ks.gov/dwr>

DWR FIELD OFFICE APPLICATION FOR APPROVAL TO CHANGE THE PLACE OF USE AND/OR THE POINT OF DIVERSION



STATE OF KANSAS

Filing Fee Must Accompany the Application, K.S.A. 82a-708b(b), as amended.
 Fee Schedule is on the third page of this application form.

Paragraph Nos. 1, 2, 3 & 5 must be completed. Complete all other applicable portions. If change in point of diversion is greater than 100 feet, or if place of use will be changed, include a topographic map or detailed plat showing the authorized and proposed point(s) of diversion and/or place of use.

RECEIVED
 11:35 AM
MAR 19 2021

File No. 42019 _____

Garden City Field Office
 Division of Water Resources

1. Application is hereby made for approval of the Chief Engineer to change the (check one or both):

Place of Use Point of Diversion

under the water right which is the subject of this application in accordance with the conditions described below.

The source of supply is: Groundwater Surface water

2. Name and address of Applicant: MID AMERICA CATTLE CO (ATTN WALTER BEESLEY) _____
 PO BOX 818 HUGOTON KS 67951

Phone Number: _____ Email address: _____

Name and address of Water Use Correspondent: WALTER BEESLEY
 PO BOX 818 HUGOTON KS 67951

Phone Number: () _____ Email address: _____

3. The presently authorized place of use is:

Owner of Land ---- NAME: MID AMERICA CATTLE CO _____
 ADDRESS: PO BOX 818 HUGOTON KS 67951 - 0818 _____

(If there is more than one landowner, attach supplemental sheets as necessary.)

Sec.	Twp.	Range	NE¼				NW¼				SW¼				SE¼				TOTAL ACRES
			NE¼	NW¼	SW¼	SE¼	NE¼	NW¼	SW¼	SE¼	NE¼	NW¼	SW¼	SE¼	NE¼	NW¼	SW¼	SE¼	
13	34S	38W									30.5	30.5	30.5	30.5	30.5	30.5	30.5	30.5	244
18	34S	37W									30.5	30.5	30.5	30.5					122
14	34S	38W	40	40	40	40	40			40	40			10	40	40	14	40	424

4. If this application is for a change in place of use, it is proposed that the place of use be changed to:

Owner of Land ---- NAME: MID AMERICA CATTLE CO _____
 ADDRESS: PO BOX 818 HUGOTONKS 67951 - 0818 _____

(If there is more than one landowner, attach supplemental sheets as necessary.)

Sec.	Twp.	Range	NE¼				NW¼				SW¼				SE¼				TOTAL ACRES
			NE¼	NW¼	SW¼	SE¼	NE¼	NW¼	SW¼	SE¼	NE¼	NW¼	SW¼	SE¼	NE¼	NW¼	SW¼	SE¼	
13	34S	38W									30.5	30.5	30.5	30.5	30.5	30.5	30.5	30.5	244
18	34S	37W									30.5	30.5	30.5	30.5					122
14	34S	38W	40	40	40	40	40			40	40			10	40	40	14	40	424

For Office Use Only: Code _____ Fee \$ 200.00 TR # _____ Receipt Date 3-19-21 Check # 9780

5. **Presently authorized point of diversion:**
 One in the _____ Quarter of the _____ Quarter of the _____ Quarter
 of Section _____, Township _____ South, Range _____ (W),
 in Stanton _____ County, Kansas, _____ feet North _____ feet West of Southeast corner of section.
 Authorized Rate _____ Authorized Quantity _____ Depth of well _____ (feet)
(DWR use only: Computer ID No. _____ GPS _____ feet North _____ feet West)
 This point will not be changed This point will be changed as follows: No change, point better described with GPS as follows:
Proposed point of diversion: (Complete only if change is requested or if existing point is better described by GPS)
 One in the _____ Quarter of the _____ Quarter of the _____ Quarter
 of Section _____, Township _____ South, Range _____ (E/W),
 in _____ County, Kansas, _____ feet North _____ feet West of Southeast corner of section.
 Proposed Rate _____ Proposed Quantity _____ Proposed well depth (feet) _____
 This point is: Additional Well Geo Center List other water rights that will use this point _____

6. **Presently authorized point of diversion:**
 One in the _____ Quarter of the _____ Quarter of the _____ Quarter
 of Section _____, Township _____ South, Range _____ (E/W),
 in _____ County, Kansas, _____ feet North _____ feet West of Southeast corner of section.
 Authorized Rate _____ Authorized Quantity _____ Depth of well _____ (feet)
(DWR use only: Computer ID No. _____ GPS _____ feet North _____ feet West)
 This point will not be changed This point will be changed as follows: No change, point better described with GPS as follows:
Proposed point of diversion: (Complete only if change is requested or if existing point is better described by GPS)
 One in the _____ Quarter of the _____ Quarter of the _____ Quarter
 of Section _____, Township _____ South, Range _____ (E/W),
 in _____ County, Kansas, _____ feet North _____ feet West of Southeast corner of section.
 Proposed Rate _____ Proposed Quantity _____ Proposed well depth (feet) _____
 This point is: Additional Well Geo Center List other water rights that will use this point _____

7. The changes herein are desired for the following reasons?
 (please be specific) _____

8. If a well, is the test hole log attached? Yes No

9. The change(s) (was)(will be) completed by?

10. If the point of diversion is a well:
 (a) What are you going to do with the old well?

 Not Applicable
 (b) When will this be done? _____

11. Groundwater Management District recommendation attached?
 Yes No

12. Assisted by Alex Torrance

13a. If the proposed point of diversion will be relocated more than 300 feet but within 2,640 feet of the existing point of diversion, attach a topographic map or aerial photograph. For groundwater sources, show all wells (including domestic) within one-half mile of the proposed point of diversion and the names and mailing addresses of the owners. For surface water sources, show the names and addresses of the landowner(s) one-half mile downstream and one-half mile upstream from your property lines

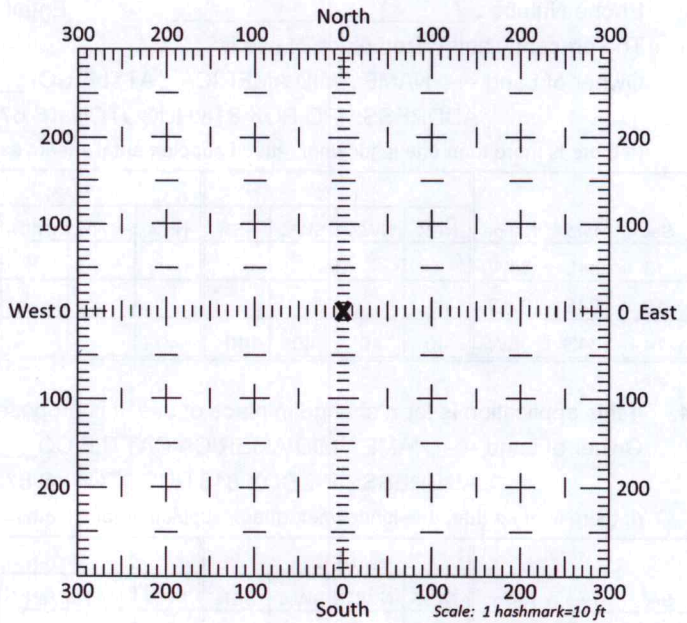

13b. If the proposed point of diversion will be relocated within 300 feet of the existing point of diversion, indicate its location on the diagram shown above in relation to the existing point of diversion. (PLEASE NOTE: The "X" in center of diagram above represents the presently authorized point of diversion.)

APPLICATION FOR APPROVAL TO CHANGE
THE PLACE OF USE AND/OR POINT OF DIVERSION
SUPPLEMENTAL SHEET

FILE NO. 42019

MAKE ADDITIONAL COPIES AS NECESSARY

3. *Continued:* The presently authorized place of use is:

Owner of Land --- NAME: MID AMERICA CATTLE CO
ADDRESS: PO BOX 818 HUGOTON KS 67951 - 0818

Sec.	Twp.	Range	NE¼				NW¼				SW¼				SE¼				TOTAL ACRES
			NE¼	NW¼	SW¼	SE¼	NE¼	NW¼	SW¼	SE¼	NE¼	NW¼	SW¼	SE¼	NE¼	NW¼	SW¼	SE¼	
19	34S	37W	12	35	40	35	35	12	35	40	40	35	12	35	35	40	35	12	488

Owner of Land --- NAME: _____
ADDRESS: _____

Sec.	Twp.	Range	NE¼				NW¼				SW¼				SE¼				TOTAL ACRES
			NE¼	NW¼	SW¼	SE¼	NE¼	NW¼	SW¼	SE¼	NE¼	NW¼	SW¼	SE¼	NE¼	NW¼	SW¼	SE¼	

Owner of Land --- NAME: _____
ADDRESS: _____

Sec.	Twp.	Range	NE¼				NW¼				SW¼				SE¼				TOTAL ACRES
			NE¼	NW¼	SW¼	SE¼	NE¼	NW¼	SW¼	SE¼	NE¼	NW¼	SW¼	SE¼	NE¼	NW¼	SW¼	SE¼	

4. *Continued:* If this application is for a change in place of use, it is proposed that the place of use be changed to:

Owner of Land --- NAME: MID AMERICA CATTLE CO
ADDRESS: PO BOX 818 HUGOTON KS 67951 - 0818

Sec.	Twp.	Range	NE¼				NW¼				SW¼				SE¼				TOTAL ACRES
			NE¼	NW¼	SW¼	SE¼	NE¼	NW¼	SW¼	SE¼	NE¼	NW¼	SW¼	SE¼	NE¼	NW¼	SW¼	SE¼	
19	34S	37W	12	35	40	35	35	12	35	40	40	35	12	35	35	40	35	12	488

Owner of Land --- NAME: MID AMERICA CATTLE CO
ADDRESS: PO BOX 818 HUGOTON KS 67951 - 0818

Sec.	Twp.	Range	NE¼				NW¼				SW¼				SE¼				TOTAL ACRES
			NE¼	NW¼	SW¼	SE¼	NE¼	NW¼	SW¼	SE¼	NE¼	NW¼	SW¼	SE¼	NE¼	NW¼	SW¼	SE¼	
18	34S	37W																	160

Owner of Land --- NAME: _____
ADDRESS: _____

Sec.	Twp.	Range	NE¼				NW¼				SW¼				SE¼				TOTAL ACRES
			NE¼	NW¼	SW¼	SE¼	NE¼	NW¼	SW¼	SE¼	NE¼	NW¼	SW¼	SE¼	NE¼	NW¼	SW¼	SE¼	

14. If the proposed groundwater point of diversion is 300 or fewer feet from the existing point of diversion, complete the following:

- (a) Does the undersigned represent all owners of the currently authorized place(s) of use identified in this application?
 Yes No (If no, all owners must sign this application.)
- (b) Will the ownership interest of any owner of the currently authorized place(s) of use identified in this application be adversely affected if this application is approved as requested?
 Yes No (If yes, all owners must sign this application.)
- (c) If this application is not approved expeditiously, will there be substantial damage to property, public health or safety?
 Yes No (If no, all owners must sign this application.)

If the application proposes a surface water change in point of diversion, a groundwater change in point of diversion greater than 300 feet, or a change in place of use, the application must be signed by all owners of the currently authorized place of use, or their duly authorized agent (attach notarized statement authorizing representation).

I hereby verify, being first duly sworn upon my oath or affirmation and under penalty of perjury, that I am of lawful age and the owner, the spouse of the owner, or a duly authorized agent of the owner(s) to make this application on their behalf, in regards to the water right(s) to which this application pertains. I further verify that the statements contained in this application are true, correct and complete.

Dated at Huyoton, Kansas, this 18th day of March, 2021.

Mid America Cattle Co.
 _____ (Owner) _____ (Spouse)
Walter Beasley Pres.
 _____ (Please Print) _____ (Please Print)
 _____ (Owner) _____ (Spouse)
 _____ (Please Print) _____ (Please Print)
 _____ (Owner) _____ (Spouse)
 _____ (Please Print) _____ (Please Print)

State of Kansas }
County of Stewens } SS

DELETA HOSKINSON
NOTARY PUBLIC, STATE OF KANSAS
My Appt Exp. 7-18-21

I hereby certify that the foregoing application was signed in my presence and sworn to before me this 18 day of March, 2021.

Deleta Hoskinson
Notary Public

My Commission Expires 7-18-21

ONLY COMPLETE APPLICATIONS WILL BE PROCESSED. To be complete, all of the applicable portions of the application form must be completed with accurate information; maps, if necessary, must be included; signatures of all the appropriate owners' must be affixed to the application and notarized; and the appropriate fee must be paid.

FEE SCHEDULE

- Each application to change the place of use or the point of diversion under this section shall be accompanied by the application fee set forth in the schedule below: Make checks payable to: **Kansas Department of Agriculture**
- (1) Application to change a point of diversion 300 feet or less \$100
 - (2) Application to change a point of diversion more than 300 feet \$200
 - (3) Application to change the place of use \$200

CHANGE IN PLACE OF USE 42019

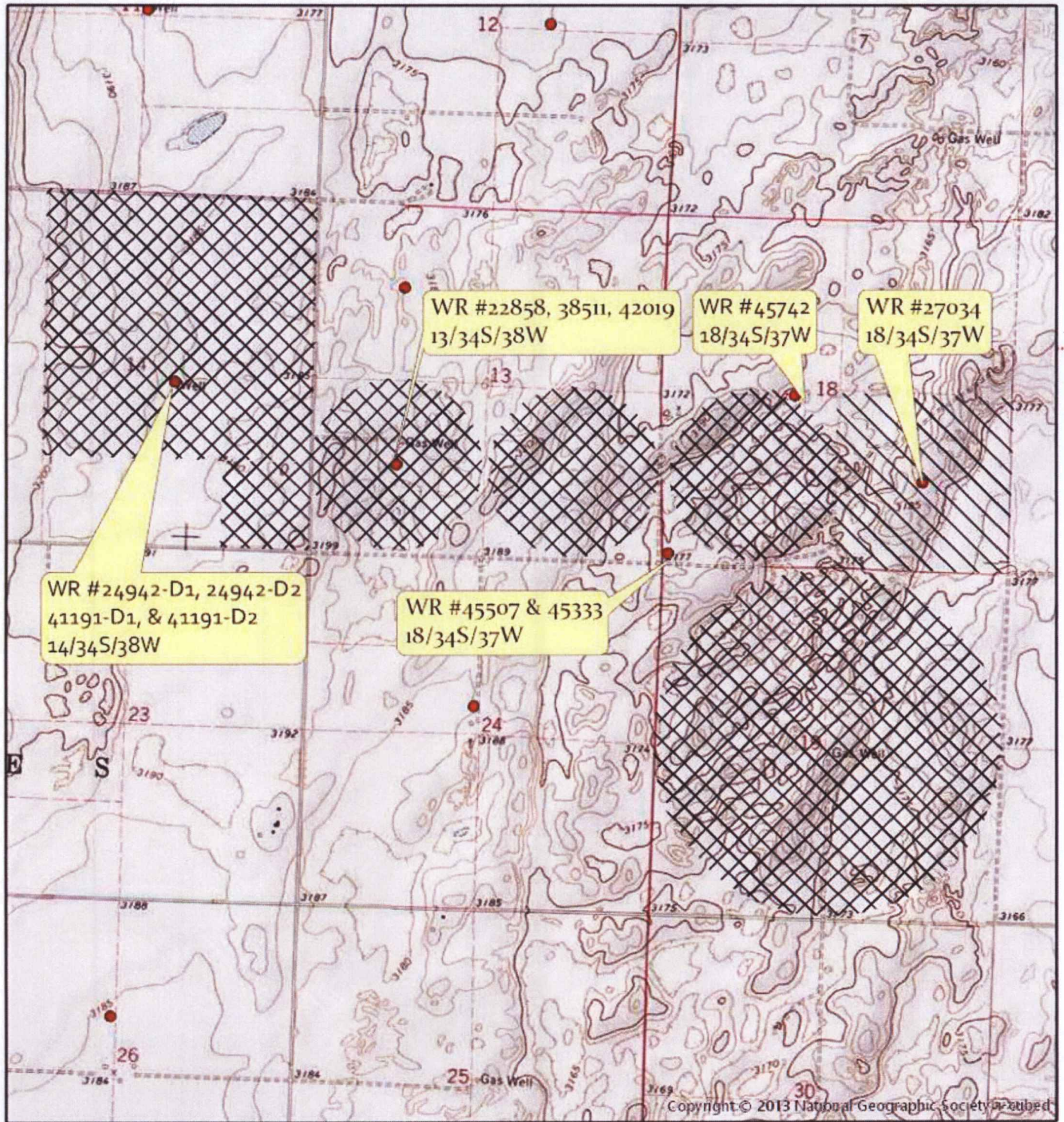

Township 34 South Range 38 West
SV County

0 0.17 0.35 0.7 Miles

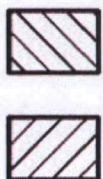

PROPOSED PLACE OF USE

AUTHORIZED PLACE OF USE



Created By: AT/GCFO



Southwest Kansas
Groundwater Management District No. 3
2009 E. Spruce Street
Garden City, Kansas 67846
(620) 275-7147 phone (620) 275-1431 fax
www.gmd3.org

March 29, 2021

Michael A. Meyer
Division of Water Resources
4532 W Jones Ave., Suite B
Garden City, Kansas 67846

RE: Applications for Change in Place of Use
Water Right, File Nos. 22858, 24942 D1, 27034,38511, 41191 D1, 42019, 45507 &
45742

Dear Mike:

We have reviewed the applications for the above referenced water rights. The proposal is not in conflict with the Management Program of the Southwest Kansas Groundwater Management District No. 3 (GMD3). The proposed change in place of use will make a complete overlap in place of use with no new acres being proposed, which is in accordance with K.A.R. 5-5-11. It is therefore recommended that the applications be approved at this time.

Thank you for the opportunity to review the applications and to provide a recommendation. If you have any questions, please don't hesitate to contact us.

Sincerely,

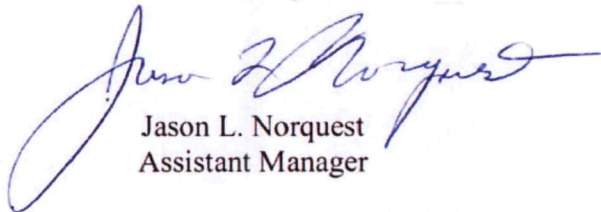

Jason L. Norquest
Assistant Manager

RECEIVED
MAR 29 2021
Garden City Field Office
Division of Water Resources

GMD3 Change Review

File No(s): 22858, 24942D1, 27034, 38511, 41191D1, 42019, 45507, 45742.

DWR office: GC.

App filed to change: PU.

Is Landowner(s) correct in WRIS: Mid America Cattle Co.

If NO, is documentation included?

Is Water Use Correspondent correct in WRIS? ___.

If NO, is documentation included?

Regulation(s) Reviewed: KAR 5-5-11

Point of diversion ID No(s) ___ being changed.

	ft. North	ft. West	
Authorized PD			
Proposed PD			
Difference	0	0	
$a^2 + b^2 = c^2$	0	0	0

GPS for proposed PD: Lat: ___ Long: ___.

Is proposed PD stacking on existing WRs? No Change.

Is Proposed PU overlapping existing WRs? Proposed complete overlap, no new acres.

Neighboring certified well(s) notified: ___.

Name ___.

Address ___.

Zip ___.

Email: ___. Phone: ___.

Domestic well(s) notified: ___.

Name ___.

Address ___.

Zip ___.

Base Acres: ___.

Perfected Acres: ___.

Irr. Return-Flow ___%

27034 Currently authorizes 160acres SE 18-34-37

All the rest authorize:

244acres S 13

122acres SW18

424acres section 14

488acres in 19

This will bring in the SE of 18 for a complete overlap.

All acres already listed proposed to still be listed.

Is a waiver needed: No new acres, proposed making a complete overlap in PU for existing acres under the water rights.

GMD3 Change Review

Recommendation: After review of all available information, it appears current area rules are met. No new acres being proposed. Staff therefore recommends approval of the application.



RECEIVED

MAR 29 2021

Garden City Field Office
Division of Water Resources

Meyer, Mike [KDA]

From: Meyer, Mike [KDA]
Sent: Tuesday, March 23, 2021 8:14 AM
To: 'Norquest, Jason (Norquest@gmd3.org)'
Subject: request for recommendation, File Nos. 24858 et al,
Attachments: 20210323075810405.pdf

good morning

attached are applications to change the place of use to make a complete overlap for Mid America Cattle Company. essentially adding file no. 27034 to the already overlapped group.

please review and provide a recommendation within 15 days.

thank you

Mike

Garden City Field Office
4532 W. Jones, Suite B
Garden City, KS 67846



Phone: 620-276-2901
Fax: 620-276-9315
www.agriculture.ks.gov

Mike Beam, Secretary

Laura Kelly, Governor

March 23, 2021

SOUTHWEST KANSAS GROUNDWATER
MANAGEMENT DISTRICT NO. 3
2009 E SPRUCE ST
GARDEN CITY KS 67846

Re: Water Right,
File Nos. 22858, 24942-D1, 27034, 38511,
41191-D1, 42019, 45333, 45507, 45742

Dear Mr. Norquest:

This is to advise you that Mid America Cattle Co has filed applications for approval of the Chief Engineer, Division of Water Resources, Kansas Department of Agriculture, to change the place of use for the above referenced files.

We are delaying action on the change application to allow you time to review and provide a recommendation. Please submit a recommendation within 15 days from the date of this letter.

Thank you and as always feel free to contact this office at any time.

Sincerely,

Michael A. Meyer
Water Commissioner

MAM
Enclosures