

NOTICE

This scan only represents the application as filed. The information contained herein meets the requirements of K.A.R. 5-3-1 or K.A.R. 5-5-1, and has been found acceptable for filing in the office of the Chief Engineer. The application should not be considered to be a complete application as per K.A.R. 5-3-1b or K.A.R. 5-5-2a.

5. **Presently authorized point of diversion:**
 One in the SW Quarter of the NW Quarter of the SW Quarter of Section 1, Township 24 South, Range 35 W, in Kearny County, Kansas, 1350 feet North 5200 feet West of Southeast corner of section.
 Authorized Rate _____ Authorized Quantity _____ Depth of well _____ (feet)
(DWR use only: Computer ID No. _____ GPS _____ feet North _____ feet West)
 This point will not be changed This point will be changed as follows: No change, point better described with GPS as follows:
Proposed point of diversion: (Complete only if change is requested or if existing point is better described by GPS)
 One in the SW Quarter of the NW Quarter of the SW Quarter of Section 1, Township 24 South, Range 35 (E/W), in Kearny County, Kansas, 1922 feet North 5240 feet West of Southeast corner of section.
 Proposed Rate _____ Proposed Quantity _____ Proposed well depth (feet) _____
 This point is: Additional Well Geo Center List other water rights that will use this point _____

6. **Presently authorized point of diversion:**
 One in the NE Quarter of the NW Quarter of the NW Quarter of Section 1, Township 24 South, Range 35 W, in Kearny County, Kansas, 4915 feet North 4185 feet West of Southeast corner of section.
 Authorized Rate _____ Authorized Quantity _____ Depth of well _____ (feet)
(DWR use only: Computer ID No. _____ GPS _____ feet North _____ feet West)
 This point will not be changed This point will be changed as follows: No change, point better described with GPS as follows:
Proposed point of diversion: (Complete only if change is requested or if existing point is better described by GPS)
 One in the _____ Quarter of the _____ Quarter of the _____ Quarter of Section _____, Township _____ South, Range _____ (E/W), in _____ County, Kansas, _____ feet North _____ feet West of Southeast corner of section.
 Proposed Rate _____ Proposed Quantity _____ Proposed well depth (feet) _____
 This point is: Additional Well Geo Center List other water rights that will use this point _____

7. The changes herein are desired for the following reasons?
 (please be specific) _____

8. If a well, is the test hole log attached? Yes No

9. The change(s) (was)(will be) completed by?

10. If the point of diversion is a well:
 (a) What are you going to do with the old well?

 (b) When will this be done? _____

11. Groundwater Management District recommendation attached?
 Yes No

12. Assisted by HH / GCFO _____

13a. If the proposed point of diversion will be relocated more than 300 feet but within 2,640 feet of the existing point of diversion, attach a topographic map or aerial photograph. For groundwater sources, show all wells (including domestic) within one-half mile of the proposed point of diversion and the names and mailing addresses of the owners. For surface water sources, show the names and addresses of the landowner(s) one-half mile downstream and one-half mile upstream from your property lines

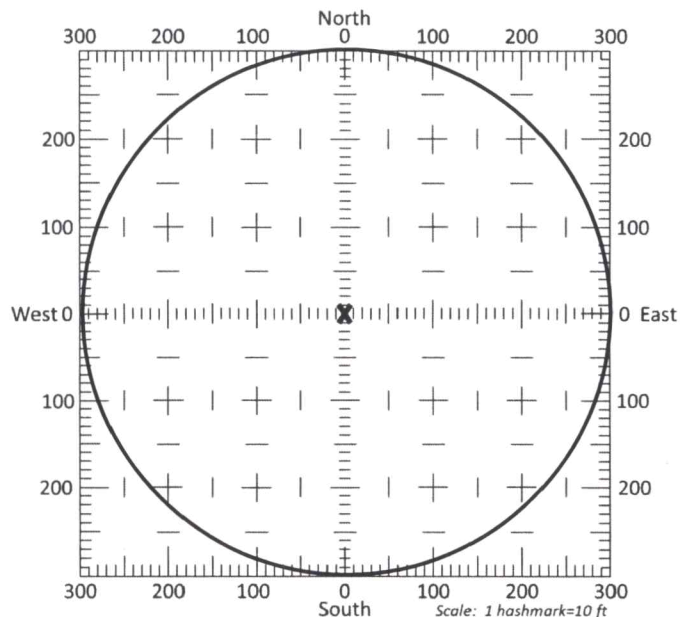

13b. If the proposed point of diversion will be relocated within a 300 foot radius of the existing point of diversion, indicate its location on the diagram shown above in relation to the existing point of diversion. The proposed point of diversion must be located within the circle shown above. **(PLEASE NOTE: The "X" in center of diagram above represents the presently authorized point of diversion.)**

14. If the proposed groundwater point of diversion is 300 or fewer feet from the existing point of diversion, complete the following:
- (a) Does the undersigned represent all owners of the currently authorized place(s) of use identified in this application?
 Yes No (If no, all owners must sign this application.)
 - (b) Will the ownership interest of any owner of the currently authorized place(s) of use identified in this application be adversely affected if this application is approved as requested?
 Yes No (If yes, all owners must sign this application.)
 - (c) If this application is not approved expeditiously, will there be substantial damage to property, public health or safety?
 Yes No (If no, all owners must sign this application.)

If the application proposes a surface water change in point of diversion, a groundwater change in point of diversion greater than 300 feet, or a change in place of use, the application must be signed by all owners of the currently authorized place of use, or their duly authorized agent (attach notarized statement authorizing representation).

I hereby verify, being first duly sworn upon my oath or affirmation and under penalty of perjury, that I am of lawful age and the owner, the spouse of the owner, or a duly authorized agent of the owner(s) to make this application on their behalf, in regards to the water right(s) to which this application pertains. I further verify that the statements contained in this application are true, correct and complete.

Dated at GARDEN CITY, Kansas, this 6th day of OCTOBER, 2021.

<u>X</u>	
(Owner)	(Spouse)
<u>X</u> <u>Jason Shanburg</u>	
(Please Print)	(Please Print)
(Owner)	(Spouse)
(Please Print)	(Please Print)
(Owner)	(Spouse)
(Please Print)	(Please Print)

State of Kansas }
 County of FINNEY } SS

I hereby certify that the foregoing application was signed in my presence and sworn to before me this 6th day of OCT, 2021.



Catherine Reinert
 Notary Public

My Commission Expires 9-14-22

ONLY COMPLETE APPLICATIONS WILL BE PROCESSED. To be complete, all of the applicable portions of the application form must be completed with accurate information; maps, if necessary, must be included; signatures of all the appropriate owners' must be affixed to the application and notarized; and the appropriate fee must be paid.

FEE SCHEDULE

Each application to change the place of use or the point of diversion under this section shall be accompanied by the application fee set forth in the schedule below: **Make checks payable to: Kansas Department of Agriculture**

(1) Application to change a point of diversion 300 feet or less	\$100
(2) Application to change a point of diversion more than 300 feet	\$200
(3) Application to change the place of use	\$200

CHANGE IN POINT OF DIVERSION WATER RIGHT, FILE NO. 7195-D1

SW 1/4 of Section 1 Township 24 South Range 35 West Kearny County

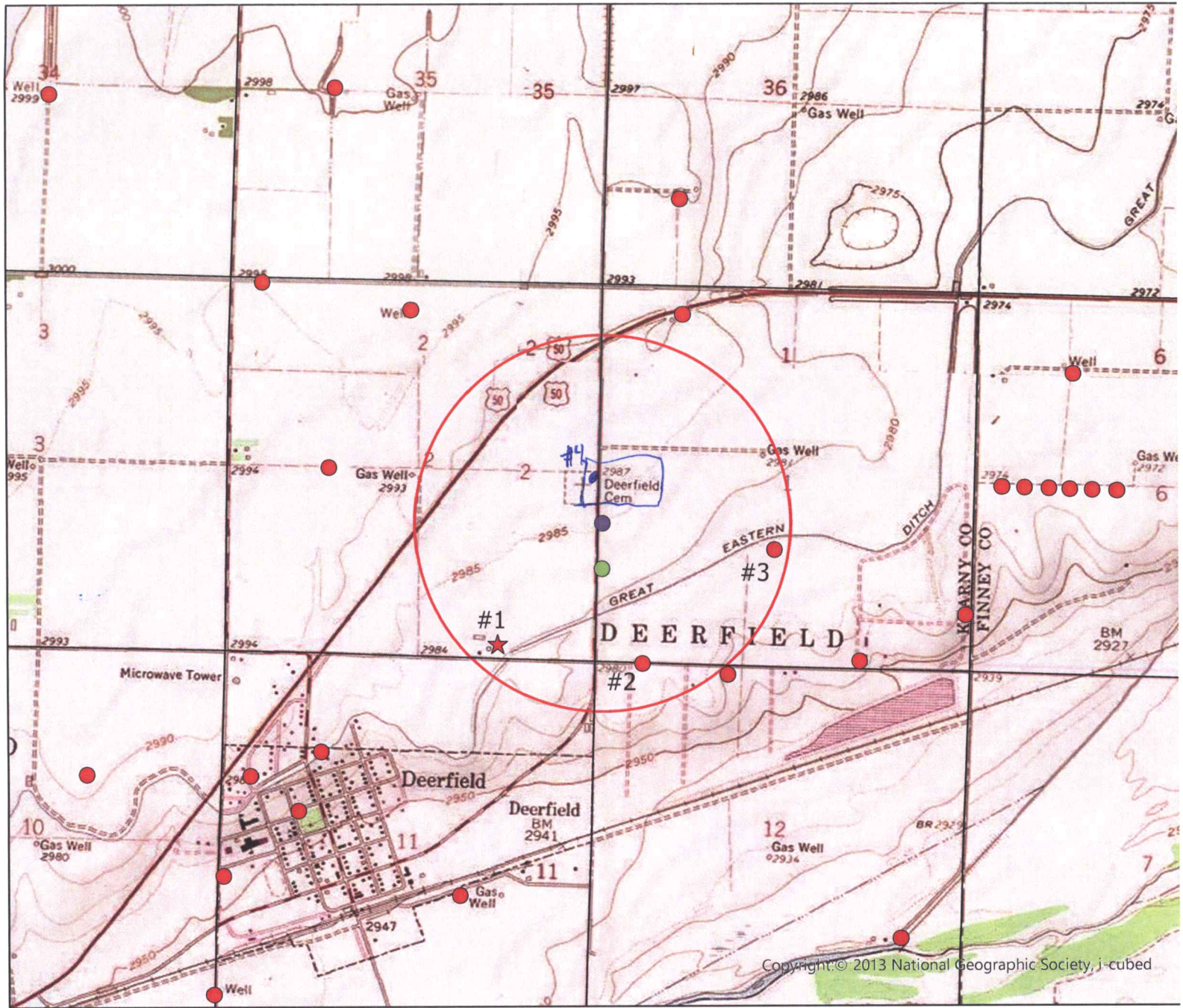

- Authorized Point of Diversion
- Proposed Point of Diversion
- ★ Domestic Wells within 1/2 mile
- Permitted Wells within 1/2 mile
- 1/2 Mile Buffer

List of owner name and addresses within 1/2 mile:

- #1 Domestic Well
Hal Scheuerman - PO Box 222 Deerfield KS 67838
- #2 File No. 38993
KANSAS DAIRY DEVELOPMENT LLC
- #3 File No. 16536
KANSAS DAIRY DEVELOPMENT LLC
- #4 Deerfield Cemetery
PO Box 1276 Lakin KS 67860



All wells of any kind within 1/2 mile of the proposed point of diversion have been plotted.

(Signature)

Date

Date: 10/1/21 HH/GCFO
Scale: 1:24,000

101.13333° W

101.11667° W

WGS84 101.10000° W

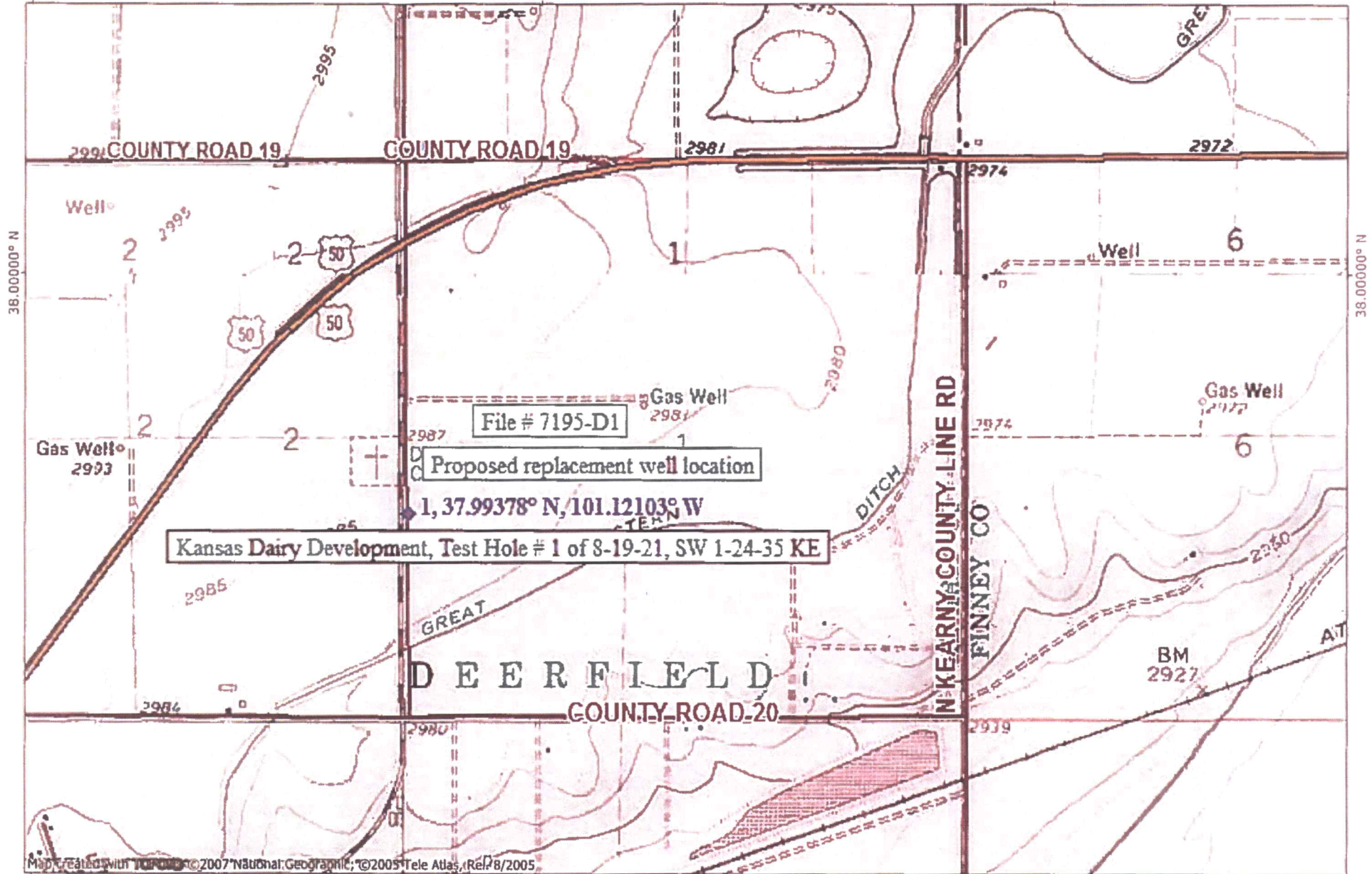

Map created with TOPO! © 2007 National Geographic, © 2005 Tele Atlas, Ref 8/2005

101.13333° W

101.11667° W

WGS84 101.10000° W

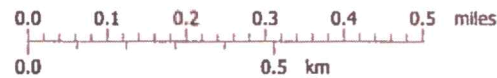

Garden City Field Office
4532 W. Jones, Suite B
Garden City, KS 67846



Phone: 620-276-2901
Fax: 620-276-9315
www.agriculture.ks.gov

Mike Beam, Secretary

Laura Kelly, Governor

October 8, 2021

DEERFIELD CEMETARY
PO BOX 1276
LAKIN KS 67860

RE: Application for Change
Water Right, File No. 7195-D1

Dear Sir or Madam:

This is to advise you that Kansas Dairy Development LLC has filed applications for approval of the Chief Engineer, Division of Water Resources, Kansas Department of Agriculture, for change in point of diversion under the above referenced application.

You can find the complete application posted by water right file number as referenced above at www.agriculture.ks.gov/divisions-programs/dwr/water-appropriation/notices .

You are notified of this proposed point of diversion (well) so that you may furnish this office with any comments or other information you may want to submit. Such comments or other information must be received in this office within 15 days from the date of this letter.

Should you have any questions, please feel free to call this office. If you would prefer, an appointment could be arranged for additional assistance. Please refer to the file number when you contact us if you wish to discuss a specific file.

Sincerely,

A handwritten signature in blue ink that reads "Michael A. Meyer".

Michael A. Meyer
Water Commissioner

MAM

pc: Groundwater Management District No. 3

Garden City Field Office
4532 W. Jones, Suite B
Garden City, KS 67846



Phone: 620-276-2901
Fax: 620-276-9315
www.agriculture.ks.gov

Mike Beam, Secretary

Laura Kelly, Governor

October 8, 2021

HAL SCHEUERMAN
PO BOX 222
DEERFIELD KS 67838

RE: Application for Change
Water Right, File No. 7195-D1

Dear Sir:

This is to advise you that Kansas Dairy Development LLC has filed applications for approval of the Chief Engineer, Division of Water Resources, Kansas Department of Agriculture, for change in point of diversion under the above referenced application.

You can find the complete application posted by water right file number as referenced above at www.agriculture.ks.gov/divisions-programs/dwr/water-appropriation/notices .

You are notified of this proposed point of diversion (well) so that you may furnish this office with any comments or other information you may want to submit. Such comments or other information must be received in this office within 15 days from the date of this letter.

Should you have any questions, please feel free to call this office. If you would prefer, an appointment could be arranged for additional assistance. Please refer to the file number when you contact us if you wish to discuss a specific file.

Sincerely,



Michael A. Meyer
Water Commissioner

MAM

pc: Groundwater Management District No. 3