

Kansas Department of Agriculture
 Division of Water Resources
CHANGE: P/D WORKSHEET

1. File Number: 11068	2. Status Change Date: 2/1/2022	3. Change Num: C1	4. Field Office: 4	5. GMD: 3
6. Status: <input checked="" type="checkbox"/> Approved <input type="checkbox"/> Denied by DWR/GMD <input type="checkbox"/> Dismiss by Request/Failure to Return				7. Filing Date of Change: 12/20/2022
8a. Landowner, Applicant(s) New to system <input type="checkbox"/> GREGORY ROME 6165 W 7 MILE RD HOLCOMB, KS 67851		8c. Landowner(s) New to system <input type="checkbox"/> Person ID 25248 Add Seq# _____		
8b. Landowner(s), New to system <input checked="" type="checkbox"/> Person ID _____ Add Seq# _____		8d. WUC New to system <input type="checkbox"/> Person ID 23921 Add Seq# _____ MIKE ROME JR 7925 W 9 MILE RD HOLCOMB, KS 67851		
9. Documents and Enclosure(s): <input checked="" type="checkbox"/> DWR Meter(s) Date to Comply: 12/31/2022 <input checked="" type="checkbox"/> N & P Date to Comply: 3/1/2023				
<input type="checkbox"/> Anti-Reverse Meter <input type="checkbox"/> Meter Seal <input checked="" type="checkbox"/> Check Valve <input checked="" type="checkbox"/> N & P Form <input checked="" type="checkbox"/> Water Tube <input type="checkbox"/> Driller Copy <input checked="" type="checkbox"/> H & E Letter <input type="checkbox"/> Conservation Plan Date Required: _____ Date Approved: _____ Date to Comply: _____				
10. Use Made of Water From: _____ To: _____				
Date Prepared: 2/11/2022 By: MAM Date Entered: _____ By: _____				

File No. **11068** 11. County: FI Basin: ARKANSAS RIVER Stream: Formation Code: 211 Special Use:

12. Points of Diversion
 CHK
 MOD
 DEL PDIV
 ENT
 Qualifier S T R ID 'N 'W Comment (AKA Line) Rate gpm Quantity af Additional Rate gpm Quantity af Overlap PD Files

DEL 13113
ENT SWSWNE 35 22S 34W 2713 2063 *511 347 +511 347 NONE

***VOLUNEER REDUCTION IN DIVERSION RATE**

13. Storage: Rate _____ NF Quantity _____ ac/ft Additional Rate _____ NF Additional Quantity _____ ac/ft

14. Limitation: _____ af/yr at _____ gpm (_____ cfs) when combined with file number(s) _____
 Limitation: _____ af/yr at _____ gpm (_____ cfs) when combined with file number(s) _____

15. 5YR Allocation: Allocation Type _____ Start Year _____ 5 YR Amount _____ Amount Unit _____ Base Acres _____ Comment _____

16. Place of Use CHK MOD DEL ENT PUSE S T R ID	NE¼				NW¼				SW¼				SE¼				Total	Owner	Chg?	Overlap Files
	NE ¼	NW ¼	SW ¼	SE ¼	NE ¼	NW ¼	SW ¼	SE ¼	NE ¼	NW ¼	SW ¼	SE ¼	NE ¼	NW ¼	SW ¼	SE ¼				
CHK 12884																				

Base Acres: Year: Minimum Reasonable Quantity:
 Comments:

Garden City Field Office
4532 W. Jones, Suite B
Garden City, KS 67846



Phone: 620-276-2901
Fax: 620-276-9315
www.agriculture.ks.gov

Mike Beam, Secretary

Laura Kelly, Governor

February 11, 2022

GREGORY ROME
6165 W 7 MILE RD
HOLCOMB, KS 67851

RE: Field Office Application for Change
Water Right, File No. 11068

Dear Sir:

Enclosed is an order executed by the designee of the Chief Engineer, Division of Water Resources, Kansas Department of Agriculture, approving the application for change under the above referenced file number.

Your attention is directed to the enclosures and to the terms, conditions, and limitations specified in this approval for change. A condition of this approval is that an acceptable water flow meter must be installed on the diversion works authorized under the referenced file number and meet current specifications. Please return the required notification of completion of the diversion works and installation of the required meter as soon as these actions are completed. Also please note the additional condition attached to the approval.

Since the order modifies the original document referred to above, it should be recorded with the Register of Deeds as other instruments affecting real estate.

The abandoned well must be plugged in accordance with the requirements of Article 30 of the Rules and Regulations as adopted by the Kansas Department of Health and Environment.

Should you have any questions, please feel free contact this office. If you would prefer, you could arrange an appointment for additional assistance.

Sincerely,

A handwritten signature in blue ink, appearing to read "Michael A. Meyer".

Michael A. Meyer
Water Commissioner

MAM
enclosures

pc: Mike Rome
Groundwater Management District No. 3

CERTIFICATE OF SERVICE

On this 11th day of February 2022, I hereby certify that the foregoing Approval of Application for Change in Point of Diversion, Water Right, File No. 11,068 dated 11th day of February 2022 was mailed postage prepaid, first class, US mail to the following:

GREGORY ROME
6165 W 7 MILE RD
HOLCOMB, KS 67851

Pc:

MIKE ROME JR
7925 W 9 MILE RD
HOLCOMB, KS 67851

GROUNDWATER MANAGEMENT DISTRICT NO. 3



Division of Water Resources Staff

Submit completed application to:
 Kansas Department of Agriculture
 Division of Water Resources
 Field Office for your area.

Call for address:

Topeka -- (785) 296-5733
 Stafford -- (620) 234-5311
 Stockton -- (785) 425-6787
 Garden City -- (620) 276-2901
<http://agriculture.ks.gov/dwr>

DWR FIELD OFFICE APPLICATION FOR APPROVAL TO CHANGE THE PLACE OF USE AND/OR THE POINT OF DIVERSION



STATE OF KANSAS

Filing Fee Must Accompany the Application, K.S.A. 82a-708b(b), as amended.
 Fee Schedule is on the third page of this application form.

Paragraph Nos. 1, 2, 3 & 5 must be completed. Complete all other applicable portions. If change in point of diversion is greater than 100 feet, or if place of use will be changed, include a topographic map or detailed plat showing the authorized and proposed point(s) of diversion and/or place of use.

File No. 11068

RECEIVED
 11:26 AM
 DEC 20 2021

Garden City Field Office
 Division of Water Resources

1. Application is hereby made for approval of the Chief Engineer to change the (check one or both):

Place of Use Point of Diversion

under the water right which is the subject of this application in accordance with the conditions described below.

The source of supply is: Groundwater Surface water

2. Name and address of Applicant: GREGORY ROME

6165 W 7 MILE RD, HOLCOMB, KS 67851

Phone Number: () Email address: _____

Name and address of Water Use Correspondent: MIKE ROME JR

7925 W 9 MILE RD, HOLCOMB, KS 67851

Phone Number: () Email address: _____

3. The presently authorized place of use is:

Owner of Land ---- NAME: Same

ADDRESS: _____

(If there is more than one landowner, attach supplemental sheets as necessary.)

Sec.	Twp.	Range	NE¼				NW¼				SW¼				SE¼				TOTAL ACRES
			NE¼	NW¼	SW¼	SE¼	NE¼	NW¼	SW¼	SE¼	NE¼	NW¼	SW¼	SE¼	NE¼	NW¼	SW¼	SE¼	

4. If this application is for a change in place of use, it is proposed that the place of use be changed to:

Owner of Land ---- NAME: No change

ADDRESS: _____

(If there is more than one landowner, attach supplemental sheets as necessary.)

Sec.	Twp.	Range	NE¼				NW¼				SW¼				SE¼				TOTAL ACRES
			NE¼	NW¼	SW¼	SE¼	NE¼	NW¼	SW¼	SE¼	NE¼	NW¼	SW¼	SE¼	NE¼	NW¼	SW¼	SE¼	

For Office Use Only: Code _____ Fee \$ 200.00 TR # _____ Receipt Date 12-20-21 Check # 002476

5. **Presently authorized point of diversion:**
 One in the SE Quarter of the SW Quarter of the NE Quarter
 of Section 35, Township 22 South, Range 34 W,
 in FI County, Kansas, 3850 feet North 2590 feet West of Southeast corner of section.
 Authorized Rate 1325 GPM Authorized Quantity 347 AF Depth of well _____ (feet)
 (DWR use only: Computer ID No. 3 GPS _____ feet North _____ feet West)
 This point will not be changed This point will be changed as follows: No change, point better described with GPS as follows:
Proposed point of diversion: (Complete only if change is requested or if existing point is better described by GPS)
 One in the SE SW Quarter of the SW Quarter of the NE Quarter
 of Section 35, Township 22 South, Range 34 W,
 in FI County, Kansas, 2713 feet North 2063 feet West of Southeast corner of section.
 Proposed Rate 511 GPM Proposed Quantity 347 AF Proposed well depth (feet) 300
 This point is: Additional Well Geo Center List other water rights that will use this point N/A

** Agree to reduce Rate as shown ~~on~~ Aug 10 2022*
OWNER

6. **Presently authorized point of diversion:**
 One in the _____ Quarter of the _____ Quarter of the _____ Quarter
 of Section _____, Township _____ South, Range _____ (E/W),
 in _____ County, Kansas, _____ feet North _____ feet West of Southeast corner of section.
 Authorized Rate _____ Authorized Quantity _____ Depth of well _____ (feet)
 (DWR use only: Computer ID No. _____ GPS _____ feet North _____ feet West)
 This point will not be changed This point will be changed as follows: No change, point better described with GPS as follows:
Proposed point of diversion: (Complete only if change is requested or if existing point is better described by GPS)
 One in the _____ Quarter of the _____ Quarter of the _____ Quarter
 of Section _____, Township _____ South, Range _____ (E/W),
 in _____ County, Kansas, _____ feet North _____ feet West of Southeast corner of section.
 Proposed Rate _____ Proposed Quantity _____ Proposed well depth (feet) _____
 This point is: Additional Well Geo Center List other water rights that will use this point _____

7. The changes herein are desired for the following reasons?
 (please be specific) _____

8. If a well, is the test hole log attached? Yes No

9. The change(s) (was)(will be) completed by?

10. If the point of diversion is a well:
 (a) What are you going to do with the old well?

 (b) When will this be done? _____

11. Groundwater Management District recommendation attached?
 Yes No

12. Assisted by mdf/GCFO

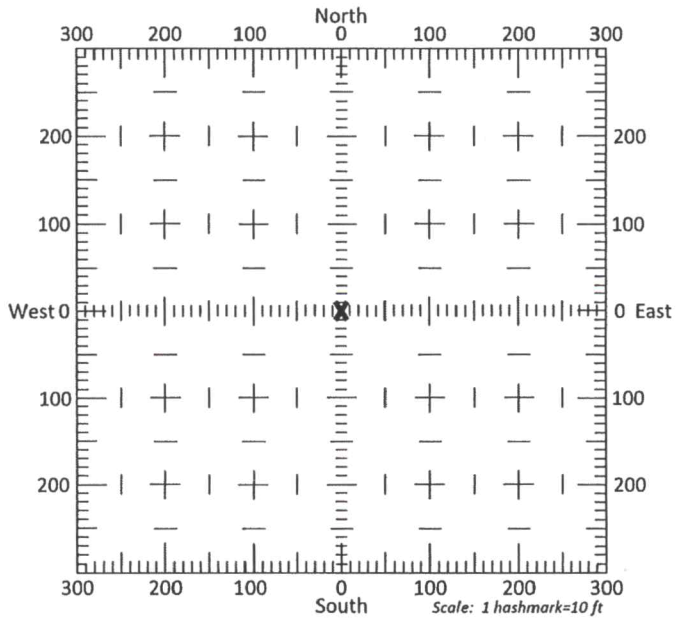

13a. If the proposed point of diversion will be relocated more than 300 feet but within 2,640 feet of the existing point of diversion, attach a topographic map or aerial photograph. For groundwater sources, show all wells (including domestic) within one-half mile of the proposed point of diversion and the names and mailing addresses of the owners. For surface water sources, show the names and addresses of the landowner(s) one-half mile downstream and one-half mile upstream from your property lines

13b. If the proposed point of diversion will be relocated within 300 feet of the existing point of diversion, indicate its location on the diagram shown above in relation to the existing point of diversion. (PLEASE NOTE: The "X" in center of diagram above represents the presently authorized point of diversion.)

14. If the proposed groundwater point of diversion is 300 or fewer feet from the existing point of diversion, complete the following:
- (a) Does the undersigned represent all owners of the currently authorized place(s) of use identified in this application?
 Yes No (If no, all owners must sign this application.)
 - (b) Will the ownership interest of any owner of the currently authorized place(s) of use identified in this application be adversely affected if this application is approved as requested?
 Yes No (If yes, all owners must sign this application.)
 - (c) If this application is not approved expeditiously, will there be substantial damage to property, public health or safety?
 Yes No (If no, all owners must sign this application.)

If the application proposes a surface water change in point of diversion, a groundwater change in point of diversion greater than 300 feet, or a change in place of use, the application must be signed by all owners of the currently authorized place of use, or their duly authorized agent (attach notarized statement authorizing representation).

I hereby verify, being first duly sworn upon my oath or affirmation and under penalty of perjury, that I am of lawful age and the owner, the spouse of the owner, or a duly authorized agent of the owner(s) to make this application on their behalf, in regards to the water right(s) to which this application pertains. I further verify that the statements contained in this application are true, correct and complete.

Dated at GARDEN CITY, Kansas, this 20th day of DECEMBER, 2021.

<p><u>* Mrs. A. Rome</u> (Owner)</p> <p><u>AREG A. Rome</u> (Please Print)</p> <p>_____ (Owner)</p> <p>_____ (Please Print)</p> <p>_____ (Owner)</p> <p>_____ (Please Print)</p>	<p>_____ (Spouse)</p> <p>_____ (Please Print)</p> <p>_____ (Spouse)</p> <p>_____ (Please Print)</p> <p>_____ (Spouse)</p> <p>_____ (Please Print)</p>
--	---

State of Kansas }
 County of FINNEY } SS

I hereby certify that the foregoing application was signed in my presence and sworn to before me this 20th day of DEC, 2021.

My Commission Expires 9-14-22



Catherine Reinert
Notary Public

ONLY COMPLETE APPLICATIONS WILL BE PROCESSED. To be complete, all of the applicable portions of the application form must be completed with accurate information; maps, if necessary, must be included; signatures of all the appropriate owners' must be affixed to the application and notarized; and the appropriate fee must be paid.

FEE SCHEDULE

Each application to change the place of use or the point of diversion under this section shall be accompanied by the application fee set forth in the schedule below: Make checks payable to: **Kansas Department of Agriculture**

(1) Application to change a point of diversion 300 feet or less	\$100
(2) Application to change a point of diversion more than 300 feet	\$200
(3) Application to change the place of use	\$200

SUMMARY ORDER APPROVING APPLICATION FOR CHANGE AND IMPOSING CONDITIONS

This Summary Order is issued under authority of K.S.A. 82a-708b, as amended, and K.A.R. 5-5-1, *et seq.* and other applicable provisions of the *Kansas Water Appropriation Law, K.S.A. 82a-701 et. seq.*, and rules and regulations promulgated thereunder, With the exception of those conditions expressly contained herein, this Summary Order does not change the terms, conditions and limitations of File No. 11068

1. A change application was received on November 30, 2021 requesting that the place of use and / or point of diversion authorized under the above-referenced file number be changed as described in the application.
2. On and after the effective date of this summary order, the authorized place(s) of use shall be located substantially as shown on the topographic map accompanying the application to change the place of use. Applicable Not Applicable
3. The change in point of diversion shall not impair existing rights and shall be limited to the same source or sources of water as previously authorized. The point of diversion authorized by this summary order shall be located within a 300 foot radius of the authorized point(s) of diversion. Applicable Not Applicable
4. The point(s) of diversion described herein is administratively corrected to be more accurately described using the Global Positioning System (GPS), as described in the application. Applicable Not Applicable
5. The point(s) of diversion authorized herein shall not actually be located more than _____ feet from the previously authorized point(s) of diversion. Applicable Not Applicable
6. As required by K.A.R. 5-3-5d, if the works for diversion is a well with a diversion rate of 100 gallons per minute or more, a tube or other device suitable for making water level measurements shall be installed, operated and maintained in accordance with K.A.R. 5-6-13. Applicable Not Applicable
7. The owner of the authorized place(s) of use shall properly install an acceptable water flow meter on or before December 31, 2022, or before the first use of water, whichever occurs first. The water flow meter shall be installed, operated and maintained in accordance with K.A.R. 5-1-4 through 5-1-12. As required by K.S.A. 82a-732, as amended, and K.A.R. 5-3-5e, the owner shall maintain records and report the reading of the water flow meter and the total quantity of water diverted annually to the Chief Engineer by March 1 following the end of each calendar year. Applicable Not Applicable
8. Installation of the works for diversion of water shall be completed on or before December 31, 2022, or within any authorized extension of time. By March 1, 2023 the applicant shall notify the Chief Engineer that construction of the works for diversion has been completed, on the form provided by the Chief Engineer, as required by K.A.R. 5-8-4e. Applicable Not Applicable
9. The completed well log shall be submitted with the required notice. Applicable Not Applicable
10. All diversion works into which any type of chemical or other foreign substance will be injected into the water shall be equipped with an in-line, automatic, quick-closing check valve capable of preventing pollution of the source of the water supply. The check valve(s) shall be installed, operated and maintained in accordance with K.A.R. 5-3-5c. Applicable Not Applicable
11. Additional Conditions are attached. Yes No
12. In accordance with K.S.A. 82a-708a, as amended, and K.A.R. 5-5-14, all of the owners of the authorized place(s) of use of water appropriated under the above-referenced file number are responsible for compliance with its terms, conditions and limitations, as amended and/or supplemented by this Summary Order, and with applicable provisions of the *Kansas Water Appropriation Law* and the *Rules and Regulations* promulgated thereunder. Failure to comply with these provisions may result in civil penalties pursuant to K.S.A. 82a-737, as amended, and/or the suspension or revocation and dismissal of the water or appropriation right or any other enforcement actions authorized by law.

Administrative Appeal and Effective Date of Order

If you are aggrieved by this order, pursuant to K.S.A. 82a-1901, you may request an evidentiary hearing before the Chief Engineer or request administrative review by the Secretary of Agriculture. A request for hearing by the Chief Engineer must be filed within **15 days** of service of this Order and a request for administrative review by the Secretary must be filed within **30 days** pursuant to K.S.A. 77-531. Any request for administrative review must state a basis for review pursuant to K.S.A. 77-527. File any request with **Kansas Department of Agriculture, Legal Division, 1320 Research Park Drive, Manhattan, KS 66502**. Failure to timely request a hearing or review may preclude review under the Kansas Judicial Review Act.

For Use by Register of Deeds

FOR OFFICE USE ONLY
**APPLICATION APPROVED AND
SUMMARY ORDER ISSUED**

By: Michael A. Meyer
Duly Authorized Designee of the Chief Engineer
(Print Name): MICHAEL A. MEYER
Division of Water Resources - Kansas Department of Agriculture

Date of Issuance: February 11, 2022

State of Kansas)
) SS
County of Stinson)

Acknowledged before me on February 11, 2022
by Michael A. Meyer

Signature: Julie Jones
Notary Public

My commission expires: _____
Julie Jones
My Appointment Expires
December 15, 2022

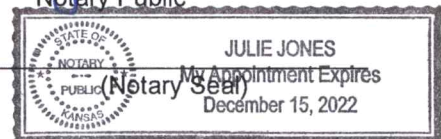

ADDITIONAL CONDITIONS TO
SUMMARY ORDER APPROVING APPLICATION FOR CHANGE
AND IMPOSING CONDITIONS,
Water Right, File No. 11,068

The effective date of the change shall be the date this order is executed by the Chief Engineer, after which the following condition is included as a condition of the approval of this application for change in point of diversion.

This order effectively reduces the authorized maximum rate of diversion to a rate not to exceed 511 gallons per minute (1.13 c.f.s.) from the authorized point of diversion described herein.

By: *Michael A. Meyer*
(Duly Authorized Designee of the Chief Engineer)

(Print Name): Michael A. Meyer
Division of Water Resources Kansas Department of Agriculture

Dated of Issuance: February 11, 2022

State of Kansas)

County of Finney) SS

County of Finney)

Acknowledged before me on the 11th day of February 2022

By Michael A. Meyer

Signature *Julie Jones*
Notary Public

My Commission expires:



Change in point of diversion for water right 11068

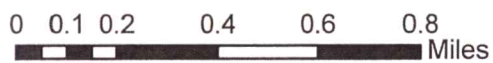
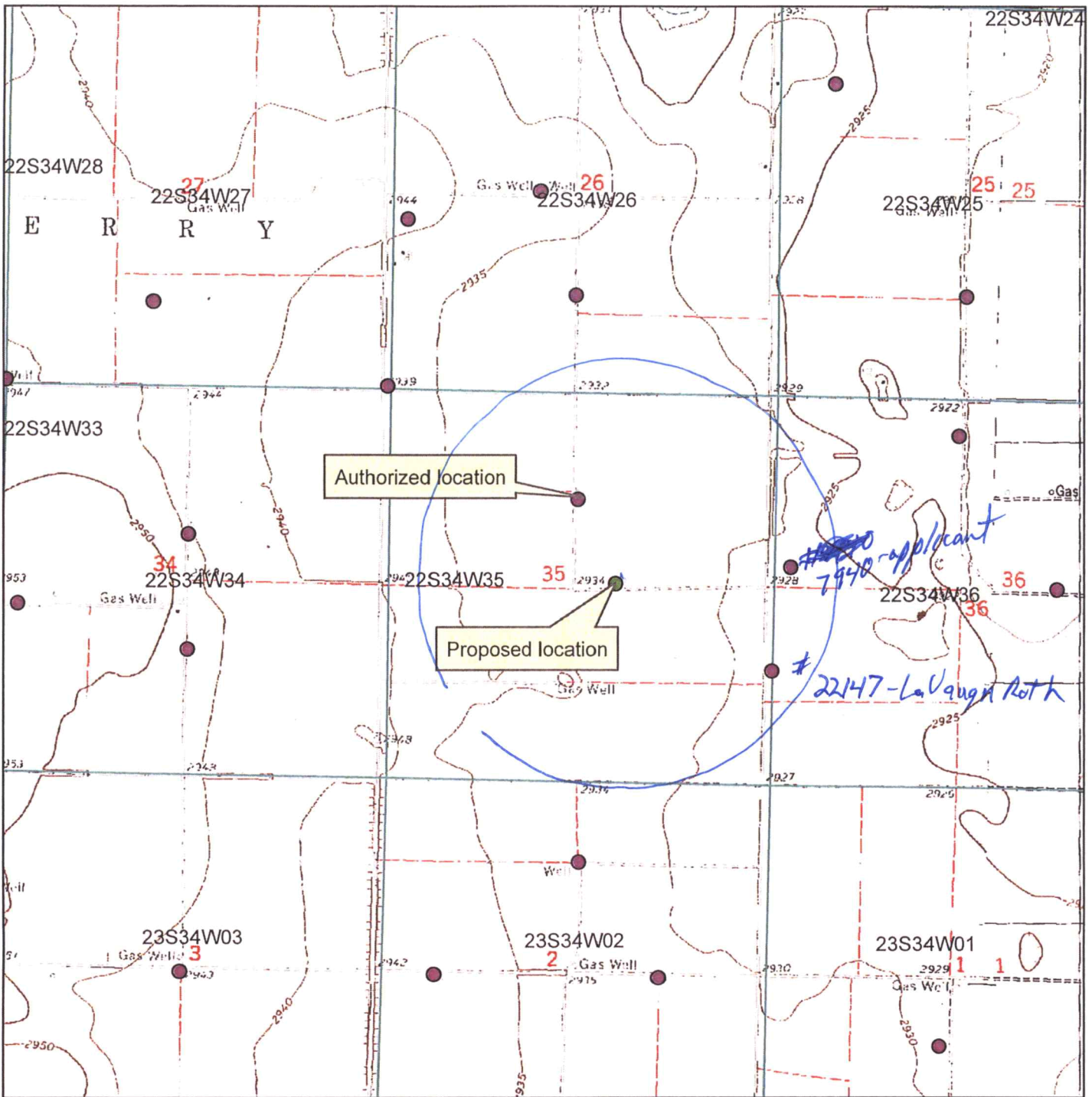

- Authorized point of diversion
- Proposed point of diversion

All wells within 1/2 mile are on this map.

X _____

TOPO! map printed on 12/12/21 from "Untitled.tpo"

101.03333° W

101.01667° W

WGS84 101.00000° W

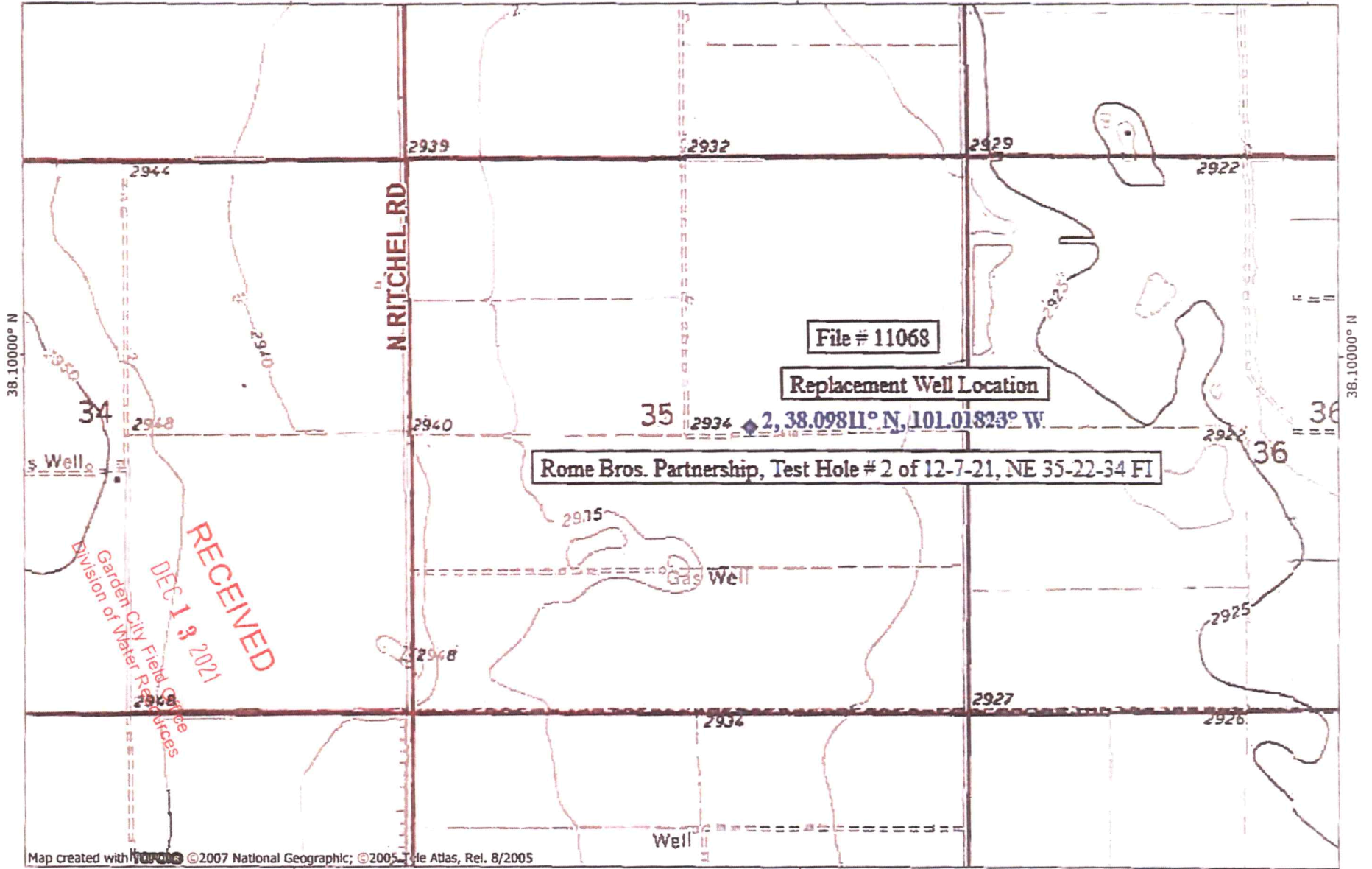

38.10000° N

38.10000° N

Map created with ©2007 National Geographic; ©2005 The Atlas, Rel. 8/2005

101.03333° W

101.01667° W

WGS84 101.00000° W

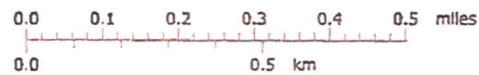

TN MN
5°

12/12/21

KANSAS DEPARTMENT OF AGRICULTURE
Division of Water Resources
Garden City Field Office

M E M O R A N D U M

TO: File

DATE: February 11, 2022

FROM: Michael A. Meyer
Water Commissioner

RE: File No. 11068

An Application to Change the Point of Diversion under the above referenced water right was received in this office December 20, 2022. This application received a recommendation from the GMD3 that there were concerning effects with the proposal to change the point of diversion which caused DWR to run This analysis for the application. This application appeared to show concerns of effects to the nearest well which was the same applicant. The landowner agreed to reduce his authorized diversion rate to limit effects.

The referenced will be reduced to 511 GPM by amending the proposed diversion rate on the application and applying a condition to reduce the diversion rate.

With these reductions, it meets our future calculations to limit effects and thus can be approved.

A. McColloch
2/3/2022

This analysis of change in point of diversion, File No. 11,068

A This analysis was used to evaluate the potential impacts of a change in point of diversion. The application proposes moving the point of diversion authorized by File No. 11,068 approximately 1,250 feet southeast. The 2068 projected saturated thickness (19.8 feet) from the GMD No. 3 groundwater model was used and transmissivity (10,752 ft²/day) from an aquifer test in nearby Section 12-23S-34W. The specific storage was assumed to be 10⁻⁵, which results in a storage coefficient of 0.000198. Pumping the proposed rate and quantity at the new location was compared to pumping the ten-year average use (162 acre-feet) at the last reported rate (250 gallons per minute). Drawdowns were evaluated at the point of diversion authorized by File No. 22,147. With these assumptions, the drawdown at File No. 22,147 increases by 11.5 feet, or 58.3% of the projected future saturated thickness (Table 1). If the proposed rate is limited to 511 gallons per minute, the increase in drawdown is reduced to 4.0 feet, or 20.0% of the projected future saturated thickness (Table 2).

Table 1: This analysis of drawdown at File No. 22,147; T = 10,752 ft²/day; S = 0.000198

Scenario	Distance (Feet)	Quantity (Acre-Feet)	Rate (GPM)	Drawdown (Feet)	Drawdown (%ST)
Proposed	2442	347	1325	14.7	74.4%
Current	3521	162	250	3.2	16.1%
			Net:	11.5	58.3%

Table 2: This analysis of drawdown at File No. 22,147; T = 10,752 ft²/day; S = 0.000198

Scenario	Distance (Feet)	Quantity (Acre-Feet)	Rate (GPM)	Drawdown (Feet)	Drawdown (%ST)
Alternative	2442	347	511	7.1	36.1%
Current	3521	162	250	3.2	16.1%
			Net:	4.0	20.0%

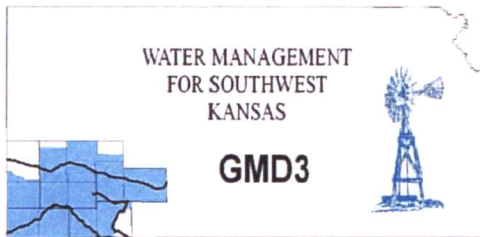

Southwest Kansas
Groundwater Management District No. 3
2009 E. Spruce Street
Garden City, Kansas 67846
(620) 275-7147 phone (620) 275-1431 fax
www.gmd3.org

January 24, 2022

Mike A Meyer
Division of Water Resources
4532 W Jones Ave., Suite B
Garden City, Kansas 67846

RE: Application for Change in Point of Diversion
Water Right, File No. 11068

Dear Mike:

We have completed a review of the application for the above referenced water right. The proposed change in point of diversion is in accordance with current area rules, K.A.R. 5-23-3, as it pertains to minimum spacing to neighboring wells and distance moved.

Well evaluations were conducted to estimate possible effects of the proposal on the supply of other wells with water rights prior to the proposal per K.S.A. 82a-708b, and the draft revised management program. Under K.S.A. 82a-708b, an applicant requesting a change in point of diversion must demonstrate to the chief engineer that any proposed change is reasonable and will not impair. The enclosed report is an analysis performed by the GMD on behalf of our membership. Under this analysis, the proposed change is considered to be reasonable and unlikely to impair if either the net in-season well-to-well effect of the proposed change is less than a strict maximum allowable threshold (dependent on the sections saturated thickness), or if no well with a net well-to-well effect exceeding the threshold is identified as critical. Critical wells are identified as wells that are expected to either lose or greatly diminish water supply over the next 25 years. The attached review information is based on a Theis analysis using inputs from the GMD3 aquifer model, which is considered to be the best information on well and aquifer data readily and easily available to the public. If either the applicant or the neighbors believe they have better data that might change the result of the analysis, they should contact GMD3. Conclusions of the well analysis may change if better information on well and aquifer data can be made available.

Every neighboring well within 1 mile of the proposed move was evaluated. Evaluations showed that several of the neighboring wells exceeded the net effect above the maximum allowable threshold and needed further evaluation. There could be the potential for critical wells in the area. The evaluations from our data showed that the effects could be mitigated with limitations to the proposed well. We did not receive any comments from neighbor notices. Therefore, GMD3 sees this move as meeting current rules and would recommend approval with possible limitations or better information given to ensure that neighboring wells are not adversely affected. If aquifer conditions change or there is a change to the water right in the future, we would be happy to evaluate the effects at that time.

Thank you for the opportunity to review the applications and to provide a recommendation. If you have any questions, please don't hesitate to contact us.

Sincerely,

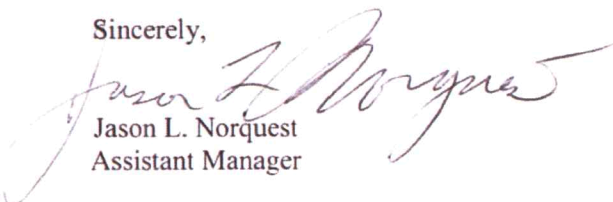
Jason L. Norquest
Assistant Manager

GMD3 Change Review

File No(s): 11068 . DWR office: GC.

App filed to change: PD .

Is Landowner(s) correct in WRIS: Mike Rome .

If NO, is documentation included?

Is Water Use Correspondent correct in WRIS? .

If NO, is documentation included?

Regulation(s) Reviewed: KAR 5-23-3

Point of diversion ID No(s) 03 being changed.

	ft. North	ft. West	
Authorized PD	3850	2530	SECT 35-22-34
Proposed PD	2713	2063	
Difference	1137 s	467 e	
a2 + b2 = c2	1292769	218089	1229.17 foot move SE

GPS for proposed PD: Lat: 38.09811 Long: -101.01823 .

Is proposed PD stacking on existing WRs? No .

Is Proposed PU overlapping existing WRs? No change .

Neighboring certified well(s) notified: .

Name Scott & Tamara Martin (9803) .

Address 5485 W 6 Mile Road.

Zip Holcomb, KS 67851.

Email: samartin@wbsnet.org Phone: 620-272-1462.

Name Kyle Maddux (10190).

Address 2245 Road 190.

Zip Deerfield, KS 67838.

Email: ccm7777@hotmail.com Phone: 785-313-2699.

Name Timothy & Rebecca Miller (18801).

Address 9715 W Miller RD.

Zip Holcomb, KS 67851.

Email: millertl@wbsnet.org Phone: 620-287-4455.

Name Lavaughn Roth (22147 & a domestic).

Address PO Box 1006.

Zip Holcomb, KS 67851.

Email: poorfarmer@wbsnet.org Phone: 620-290-307 .

Domestic well(s) notified: appears domestics will be contacted with above contacts or are listed under the applicant.

GMD3 Change Review

Name ___.

Address ___.

Zip ___.

Base Acres: ___.

Perfected Acres: ___.

Irr. Return-Flow ___%

Currently Authorized: 347AF/1325gpm

250gpm reported on 2018 WUR

267gpm calculated during 2019 field inspection.

Is a waiver needed: Move is less than half mile and minimum spacing appears to have been met. Analysis shows that some area effects could be considered critical, but mitigated with limitations. No response from neighbors.

Recommendation: After review of all available information, it appears current area rules are met. Analysis shows that they could be concern for critical wells in the area and would like further analysis from State. If all seems to be agreeable, staff would recommend approval of the applicaiton.



9803: Saturated Thickness = 101 ft (no well log available)
Drawdown from current location = 2.63 ft
Drawdown from proposed location = 4.55 ft
Net drawdown = **1.9 ft**

7940: Saturated Thickness = 478 ft (well is screened in both Ogallala and Dakota aqfs)
Drawdown from current location = 2.48 ft
Drawdown from proposed location = 6.20 ft
Net drawdown = **3.7 ft**

22147: Saturated Thickness = 106 ft (based on driller's log)
Drawdown from current location = 2.26 ft
Drawdown from proposed location = 6.14 ft
Net drawdown = **3.9 ft**

26993 & 40298: Saturated Thickness = 106 ft (based on driller's log)
Drawdown from current location = 1.75 ft
Drawdown from proposed location = 3.85ft
Net drawdown = **2.1 ft**

10190: Saturated Thickness = 135 ft (based on driller's log)
Drawdown from current location = 1.83 ft
Drawdown from proposed location = 4.64 ft
Net drawdown = **2.8 ft**

Domestic 1: Saturated Thickness = 64 ft
Drawdown from current location = 2.57 ft
Drawdown from proposed location = 4.98 ft
Net drawdown = **2.4 ft**

Domestic 2: Saturated Thickness = 61 ft
Drawdown from current location = 2.45 ft
Drawdown from proposed location = 5.07 ft
Net drawdown = **2.6 ft**

Domestic 3: Saturated Thickness = 61 ft
 Drawdown from current location = 1.79 ft
 Drawdown from proposed location = 4.27 ft
 Net drawdown = 2.5 ft

Net drawdown exceeds the drawdown allowance for water right number 22147 and all three domestic wells. Critical well analysis was performed for those wells.

Critical Well Evaluation:

22147:

Water Column = 106 ft

DP = 3.9 ft (Net drawdown from the proposal indicated above)

DE = 32 ft (Water level decline from 2022 through 2047 based upon GMD3 model)

DD = 45.6 ft (S = 0.2271, T = 28,188 gpd/ft, Q = 521 gpm, tp = 94 days, efficiency = 70%)

DT = 81.5 ft

Economic Drawdown Constraint (EDC) = $0.4 * 106 \text{ ft} = 42.4 \text{ ft}$

Physical Drawdown Constraint (PDC) = $106 \text{ ft} - 60 \text{ ft} = 46 \text{ ft}$

Total drawdown of 81.5 ft is greater than the EDC and PDC, so this well is **critical**.

Domestic 1:

Water Column = 64 ft

DP = 2.4 ft (Net drawdown from the proposal indicated above)

DE = 32 ft (Water level decline from 2022 through 2047 based upon GMD3 model)

DT = 34.4 ft

Economic Drawdown Constraint (EDC) = $0.4 * 64 \text{ ft} = 25.6 \text{ ft}$

Physical Drawdown Constraint (PDC) = $64 \text{ ft} - 20 \text{ ft} = 44 \text{ ft}$

Total drawdown of 34.4 ft is greater than the EDC, so this well is **critical**.

***Note that the GMD3 model showed significantly less water available in section 26-22-34 than the well log indicated, so nearby section 36-22-34 was used to project water level decline over the next 25 years.**

Domestic 2:

Water Column = 61 ft

DP = 2.6 ft (Net drawdown from the proposal indicated above)

DE = 32 ft (Water level decline from 2022 through 2047 based upon GMD3 model)

DT = 34.6 ft

Economic Drawdown Constraint (EDC) = $0.4 * 61 \text{ ft} = 24.4 \text{ ft}$

Physical Drawdown Constraint (PDC) = $61 \text{ ft} - 20 \text{ ft} = 41 \text{ ft}$

Total drawdown of 34.6 ft is greater than the EDC, so this well **is critical**.

Domestic 3:

Water Column = 61 ft

DP = 2.5 ft (Net drawdown from the proposal indicated above)

DE = 32 ft (Water level decline from 2022 through 2047 based upon GMD3 model)

DT = 34.5 ft

Economic Drawdown Constraint (EDC) = $0.4 * 61 \text{ ft} = 24.4 \text{ ft}$

Physical Drawdown Constraint (PDC) = $61 \text{ ft} - 20 \text{ ft} = 41 \text{ ft}$

Total drawdown of 34.5 ft is greater than the EDC, so this well **is critical**.

Conclusion:

The proposed move is in an area with depleted saturated thickness. Nearby wells are expected to lose productivity as water levels continue to decline in the coming years. If the proposed well were to operate at its proposed rate and quantity, it is likely to create noticeable effects on nearby wells that are already losing productivity. Our analysis shows that these neighboring wells are critical because pumping season saturated thickness is projected to decline by more than 40% over the next 25 years. Well to well effects may be mitigated by limiting the allocation provided to the proposed well. Neighbors may contact GMD 3 at (620) 275-7147 or the Division of Water Resources at (620) 276-2901 to express any concerns they have. Otherwise, it is likely that the change will be approved as proposed.

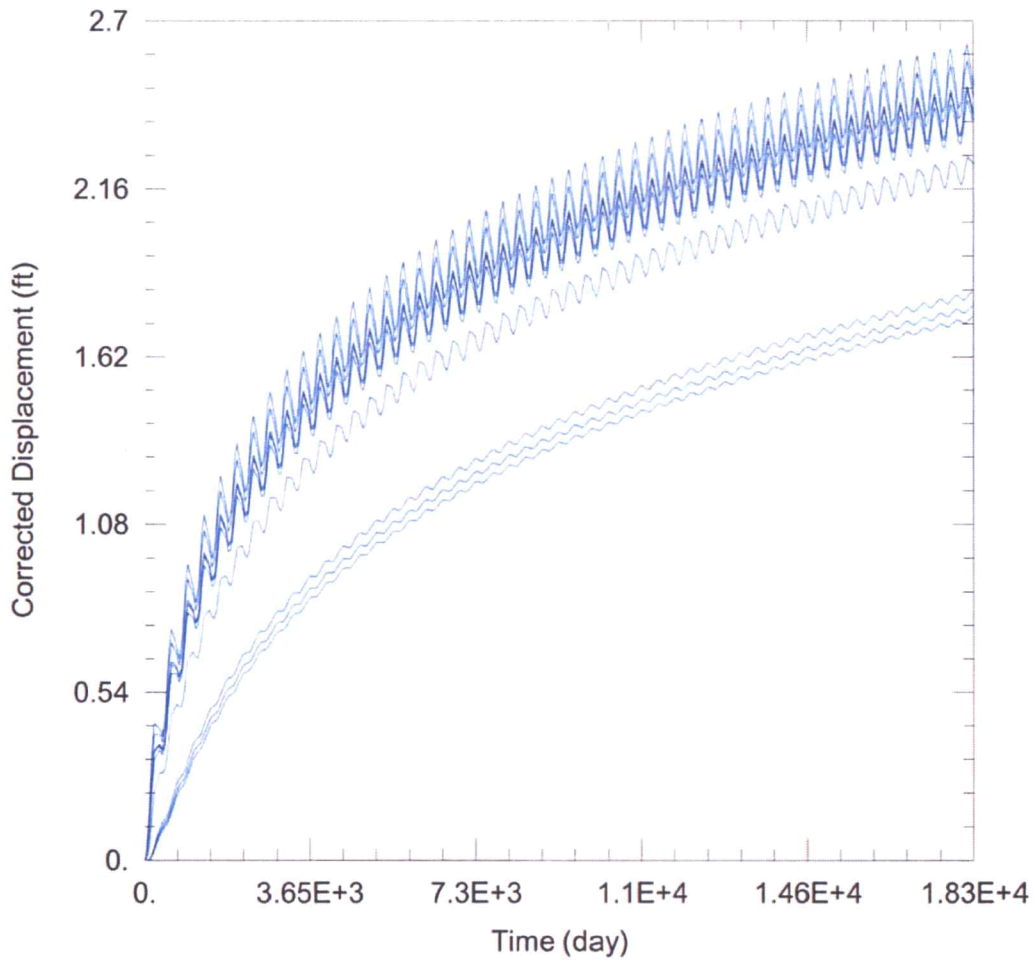

WELL TEST ANALYSIS

Data Set: C:\Users\trevora\Documents\2022_moves\11068\11068 Current.aqt
 Date: 01/05/22 Time: 16:16:28

PROJECT INFORMATION

Company: GMD 3
 Project: 11068
 Location: Finney County

WELL DATA

Pumping Wells

Well Name	X (ft)	Y (ft)
11068	-63499	446578

Observation Wells

Well Name	X (ft)	Y (ft)
□	-63499	446578
□ 18801	-66142	448070
□ 9803	-63578	449353
□ 7940	-60565	445708
□ 22147	-60799	444288
□ 26993 & 40298	-58317	447535
□ 10190	-63395	441636
□ Domestic 1	-61239	448362
□ Domestic 2	-60575	447699
□ Domestic 3	-58607	445055

SOLUTION

Aquifer Model: Unconfined

Solution Method: Theis

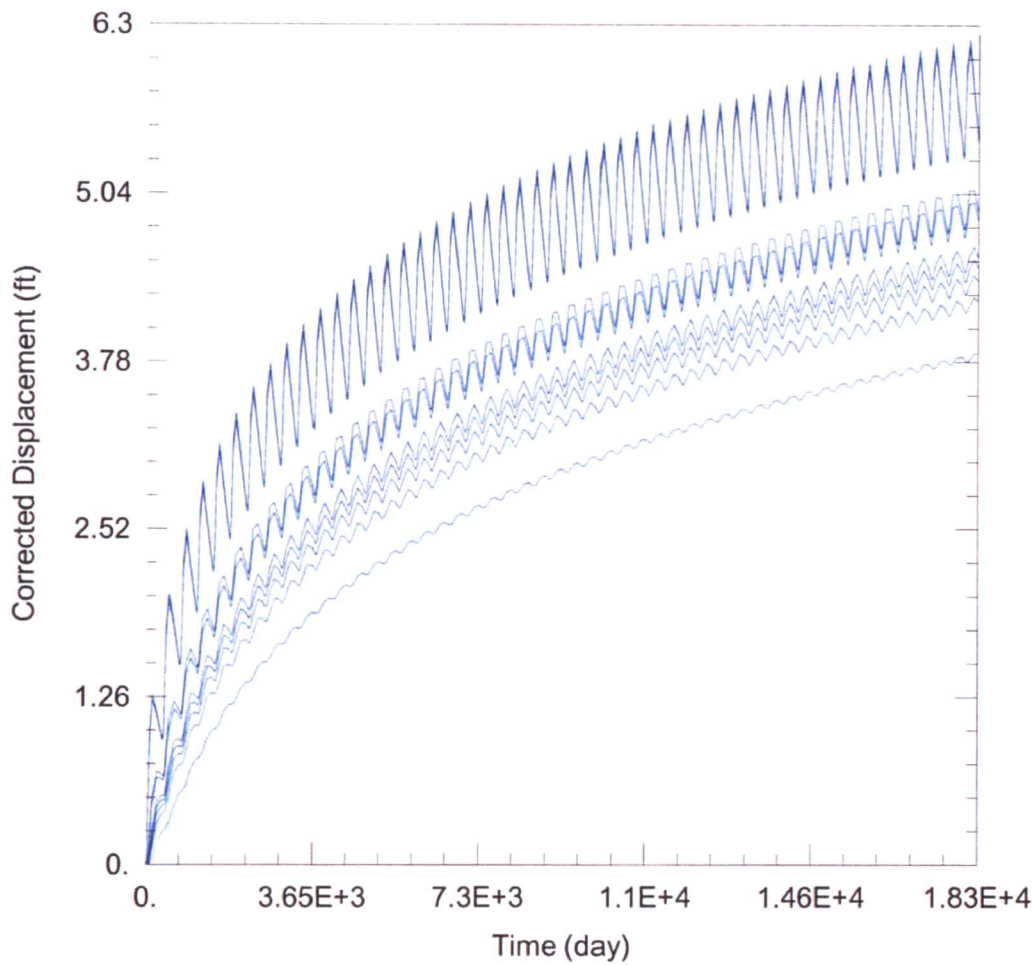

WELL TEST ANALYSIS

Data Set: C:\Users\trevora\Documents\2022_moves\11068\11068 Proposed.aqt
 Date: 01/05/22 Time: 16:16:20

PROJECT INFORMATION

Company: GMD 3
 Project: 11068
 Location: Finney County

WELL DATA

Pumping Wells			Observation Wells		
Well Name	X (ft)	Y (ft)	Well Name	X (ft)	Y (ft)
11068	-62963	445441	□	-62963	445441
			□ 18801	-66142	448070
			□ 9803	-63578	449353
			□ 7940	-60565	445708
			□ 22147	-60799	444288
			□ 26993 & 40298	-58317	447535
			□ 10190	-63395	441636
			□ Domestic 1	-61239	448362
			□ Domestic 2	-60575	447699
			□ Domestic 3	-58607	445055

SOLUTION

Aquifer Model: Unconfined

Solution Method: Theis

Water Rights and Points of Diversion Within 1 mile of point defined as:

2713 Feet N and 2063 Feet W of the Southeast Corner of Section 35 Twp 22S Rng 34W
 Located at: 101.018230 West Longitude and 38.098111 North Latitude
 Both SURFACE WATER and GROUNDWATER

File Number	Use	ST	SR	Dist (ft)	Q4	Q3	Q2	Q1	FeetN	FeetW	Sec	Twp	Rng	ID	Batt	Auth_Quan	Add_Quan		
A__ AF	7940	00	IRR	NK	G				2413	↙ SW SW NW	-----	-----	36	22	34W	1	1000	313.00	313.00
A__ AF	9803	00	IRR	NK	G				3960	↙ -- CW SE	-----	-----	26	22	34W	2	2300	960.00	176.10
A__ AF	10190	00	IRR	NK	G				3712	↙ SW NW NE	-----	-----	2	23	34W	3	2300	640.00	640.00
A__ AF	11068	00	IRR	NK	G*	↔			1257	-- NW SW NE	3850	2590	35	22	34W	3	1000	347.00	347.00
A__ AF	18801	00	IRR	NK	G				4126	↙ SW SW SW	28	5239	26	22	34W	4		320.00	.00
A__ AF	22147	00	IRR	NK	G				2513	↙ SW NW SW	1400	5150	36	22	34W	3		320.00	320.00
A__ AF	26993	00	IRR	NK	G				5104	↙ -- NE NE NW	4795	2670	36	22	34W	5		258.00	258.00
A__ AF	40289	00	IRR	NK	G				5104	-- NE NE NW	4795	2670	36	22	34W	5		258.00	.00

Total Net Quantities Authorized:	Direct	Storage
Total Requested Amount (AF) =	.00	.00
Total Permitted Amount (AF) =	.00	.00
Total Inspected Amount (AF) =	.00	.00
Total Pro_Cert Amount (AF) =	.00	.00
Total Certified Amount (AF) =	2054.10	.00
Total Vested Amount (AF) =	.00	.00
TOTAL AMOUNT (AF) =	2054.10	.00

Spacing Appears MET. for

An * after the source of supply indicates a pending application for change under the file number.
 An * after the ID indicates a 15 AF exemption was granted under the file number.
 A "G" in the Batt column indicates the GEO CTR of a battery. A "B" indicates a well in the battery.
 The number in the Batt column is the number of wells in the battery.

Water Rights and Points of Diversion Within 1 mile of point defined as:

2713 Feet North and 2063 Feet West of the Southeast Corner of Section 35 Twp 22S Rng 34W
 Located at: 101.018230 West Longitude and 38.098111 North Latitude
 Both SURFACE WATER and GROUNDWATER
 WATER USE CORRESPONDENTS:

File Number Use ST SR

> MIKE ROME JR

>

> 7925 W 9 MILE RD

> HOLCOMB KS 67851

>

> SCOTT & TAMARA MARTIN

>

> 5485 W 6 MILE ROAD

> HOLCOMB KS 67851

>

> KYLE MADDUX

>

> 2245 ROAD 190

> DEERFIELD KS 67838

>

> MIKE ROME JR

>

7940 Applicant

9403

10190

11068

Application

> 7925 W 9 MILE RD
> HOLCOMB KS 67851

>-----
> TIMOTHY L & REBECCA MILLER

>
> 9715 W MILLER RD
> HOLCOMB KS 67851

18901

>-----
> LAVAUGHN J ROTH

>
> PO BOX 1006
> HOLCOMB KS 67851

22147

>-----
> MIKE ROME JR

>
> 7925 W 9 MILE RD
> HOLCOMB KS 67851

26943

Applicant

>-----
> MIKE ROME JR

>
> 7925 W 9 MILE RD
> HOLCOMB KS 67851

40285

Applicant

>-----
=====

Garden City Field Office
4532 W. Jones, Suite B
Garden City, KS 67846



Phone: 620-276-2901
Fax: 620-276-9315
www.agriculture.ks.gov

Mike Beam, Secretary

Laura Kelly, Governor

January 3, 2022

SOUTHWEST KANSAS GROUNDWATER
MANAGEMENT DISTRICT NO. 3
2009 E SPRUCE ST
GARDEN CITY KS 67846

Re: Request for Recommendation
Water Right, File No. 11068

Dear Mr. Norquest:

This is to advise you that Gregory Rome, has filed an application for approval of the Chief Engineer, Division of Water Resources, Kansas Department of Agriculture, to change the point of diversion. The application meets all rules and regulations.

We are delaying action on the change applications to allow you time to review and provide a recommendation. Please submit a recommendation within 15 days from the date of this letter.

Thank you and as always feel free to contact this office at any time.

Sincerely,

A handwritten signature in blue ink, appearing to read "Michael A. Meyer".

Michael A. Meyer
Water Commissioner

MAM
Enclosures

Garden City Field Office
4532 W. Jones, Suite B
Garden City, KS 67846



Phone: 620-276-2901
Fax: 620-276-9315
www.agriculture.ks.gov

Mike Beam, Secretary

Laura Kelly, Governor

December 21, 2021

LAVAUGHN J ROTH
PO BOX 1006
HOLCOMB, KS 67851-1006

Re: Water Right, File No. 11068

Dear Sir:

This is to advise you that Greg Rome has filed an application for approval of the Chief Engineer, Division of Water Resources, Kansas Department of Agriculture, for change in point of diversion under the above referenced application.

You can find the complete application posted by water right file number as referenced above at www.agriculture.ks.gov/divisions-programs/dwr/water-appropriation/notices

You are notified of this proposed point of diversion (well) so that you may furnish this office with any comments or other information you may want to submit. Such comments or other information must be received in this office within 15 days from the date of this letter.

Should you have any questions, please feel free to call this office. If you would prefer, an appointment could be arranged for additional assistance. Please refer to the file number when you contact us if you wish to discuss a specific file.

Sincerely,

Sincerely,

Michael A. Meyer
Water Commissioner

MAM

Pc:

SCANNED