

Kansas Department of Agriculture
 Division of Water Resources
CHANGE: P/D WORKSHEET

1. File Number: 12481	2. Status Change Date: 4-8-2022	3. Change Num: C2	4. Field Office: 4	5. GMD:
---------------------------------	---	-----------------------------	------------------------------	---------

6. Status: <input checked="" type="checkbox"/> Approved <input type="checkbox"/> Denied by DWR/GMD <input type="checkbox"/> Dismiss by Request/Failure to Return	7. Filing Date of Change: 3/30/2022
--	---

8a. Landowner, applicant, WUC New to system <input type="checkbox"/> DAN NICKELSON 820 S COUNTY ROAD 5 LEOTI, KS 67861-6243	8c. Landowner(s) New to system <input type="checkbox"/> Person ID 12845 _____ Add Seq# _____ Person _____ Add Seq# _____
--	---

8b. Landowner(s), New to system <input type="checkbox"/> Person ID _____ Add Seq# _____	8d. WUC New to system <input type="checkbox"/> Person ID _____ Add Seq# _____
--	--

9. Documents and Enclosure(s): DWR Meter(s) Date to Comply: **12/31/2022** N & P Date to Comply: **3/1/2023**

Anti-Reverse Meter Meter Seal Check Valve N & P Form Water Tube Driller Copy H & E Letter
 Conservation Plan Date Required: _____ Date Approved: _____ Date to Comply: _____

10. Use Made of Water From: _____ To: _____

Date Prepared: **4/08/2022** By: **MAM**
 Date Entered: _____ By: _____

File No. **12481** 11. County: WH Basin: WHITEWOMAN CREEK Stream: Formation Code: 211 Special Use:

12. Points of Diversion										Rate and Quantity							
CHK	MOD	DEL	ENT	PDIV	Qualifier	S	T	R	ID	'N	'W	Comment (AKA Line)	Rate gpm	Quantity af	Rate gpm	Quantity af	Overlap PD Files
MOD	13599				Lot 6 (NWSW)	6	20S	30W	02	2446	5245		450	121	450	121	NONE
ENT	45818				Lot 7 (SWSW)	6	20S	38W	01	545	5225		190	49	190	49	NONE

13. Storage: Rate _____ NF Quantity _____ ac/ft Additional Rate _____ NF Additional Quantity _____ ac/ft

14. Limitation: _____ af/yr at _____ gpm (_____ cfs) when combined with file number(s) _____
 Limitation: _____ af/yr at _____ gpm (_____ cfs) when combined with file number(s) _____

15. 5YR Allocation: Allocation Type _____ Start Year _____ 5 YR Amount _____ Amount Unit _____ Base Acres _____ Comment _____

16. Place of Use					NE¼				NW¼				SW¼				SE¼				Total	Owner	Chg?	Overlap Files			
CHK	MOD	DEL	ENT	PUSE	S	T	R	ID	NE ¼	NW ¼	SW ¼	SE ¼	NE ¼	NW ¼	SW ¼	SE ¼	NE ¼	NW ¼	SW ¼	SE ¼	NE ¼	NW ¼	SW ¼	SE ¼			
CHK	35173																										

Base Acres: Year: Minimum Reasonable Quantity:
 Comments:

Garden City Field Office
4532 W. Jones, Suite B
Garden City, KS 67846



Phone: 620-276-2901
Fax: 620-276-9315
www.agriculture.ks.gov

Mike Beam, Secretary

Laura Kelly, Governor

April 8, 2022

DAN NICKELSON
820 S COUNTY ROAD 5
LEOTI, KS 67861-6243

RE: Field Office Application for Change
Water Right, File No. 12481

Dear Sir and Madam:

Enclosed is an order executed by the designee of the Chief Engineer, Division of Water Resources, Kansas Department of Agriculture, approving the application for change under the above referenced file number.

Your attention is directed to the enclosures and to the terms, conditions, and limitations specified in this approval for change. Conditions of these approvals are that an acceptable water flow meter must be installed on each of the diversion works authorized under the referenced file number and meet current specifications. Please return the required notification of completion of the diversion works and installation of the required meter as soon as these actions are completed.

Since the order modifies the original document referred to above, it should be recorded with the Register of Deeds as other instruments affecting real estate.

Should you have any questions, please feel free contact this office. If you would prefer, you could arrange an appointment for additional assistance.

Sincerely,

Michael A. Meyer
Water Commissioner

MAM
enclosures

CERTIFICATE OF SERVICE

On this 8th day of April 2022, I hereby certify that the foregoing Approval of Application for Change in Point of Diversion, Water Right, File No. 12,481 dated 8th day of April 2022 was mailed postage prepaid, first class, US mail to the following:

DAN NICKELSON
820 S COUNTY ROAD 5
LEOTI, KS 67861-6243



Division of Water Resources Staff

Submit completed application to:
 Kansas Department of Agriculture
 Division of Water Resources
 Field Office for your area.
 Call for address:

Topeka -- (785) 296-5733
 Stafford -- (620) 234-5311
 Stockton -- (785) 425-6787
 Garden City -- (620) 276-2901
<http://agriculture.ks.gov/dwr>

DWR FIELD OFFICE APPLICATION FOR APPROVAL TO CHANGE THE PLACE OF USE AND/OR THE POINT OF DIVERSION



STATE OF KANSAS

Filing Fee Must Accompany the Application, K.S.A. 82a-708b(b), as amended.
 Fee Schedule is on the third page of this application form.

Paragraph Nos. 1, 2, 3 & 5 must be completed. Complete all other applicable portions. If change in point of diversion is greater than 100 feet, or if place of use will be changed, include a topographic map or detailed plat showing the authorized and proposed point(s) of diversion and/or place of use.

File No. 12481

RECEIVED
 10:10 am
 MAR 30 2022

Garden City Field Office
 Division of Water Resources

1. Application is hereby made for approval of the Chief Engineer to change the (check one or both):

Place of Use Point of Diversion

under the water right which is the subject of this application in accordance with the conditions described below.

The source of supply is: Groundwater Surface water

2. Name and address of Applicant: Dan Nickelson

Phone Number: () Email address: nickelm@pld.com

Name and address of Water Use Correspondent: NO CHANGE

NO CHANGE

Phone Number: () Email address: _____

3. The presently authorized place of use is:

Owner of Land ---- NAME: NO CHANGE

ADDRESS: NO CHANGE

(If there is more than one landowner, attach supplemental sheets as necessary.)

Sec.	Twp.	Range	NE¼				NW¼				SW¼				SE¼				TOTAL ACRES		
			NE¼	NW¼	SW¼	SE¼	NE¼	NW¼	SW¼	SE¼	NE¼	NW¼	SW¼	SE¼	NE¼	NW¼	SW¼	SE¼			

4. If this application is for a change in place of use, it is proposed that the place of use be changed to:

Owner of Land ---- NAME: _____

ADDRESS: _____

(If there is more than one landowner, attach supplemental sheets as necessary.)

Sec.	Twp.	Range	NE¼				NW¼				SW¼				SE¼				TOTAL ACRES			
			NE¼	NW¼	SW¼	SE¼	NE¼	NW¼	SW¼	SE¼	NE¼	NW¼	SW¼	SE¼	NE¼	NW¼	SW¼	SE¼				

For Office Use Only: Code _____ Fee \$ 200.00 TR # _____ Receipt Date 3/30/22 Check # 546

5. **Presently authorized point of diversion:**

One in the NW Quarter of the NW Quarter of the LOT 6 (NWSW) Quarter of Section 6, Township 20 South, Range 38 W, in WICHITA County, Kansas, 2446 feet North 5245 feet West of Southeast corner of section. Authorized Rate 640 GPM Authorized Quantity 170 AF Depth of well 215 (feet)

(DWR use only: Computer ID No. 321389 GPS _____ feet North _____ feet West)

This point will not be changed This point will be changed as follows: No change, point better described with GPS as follows:

Proposed point of diversion: (Complete only if change is requested or if existing point is better described by GPS)

One in the NW Quarter of the NW Quarter of the LOT 6 (NWSW) Quarter of Section 6, Township 20 South, Range 38 W, in WICHITA County, Kansas, 2446 feet North 5245 feet West of Southeast corner of section. Proposed Rate 450/500 GPM Proposed Quantity 121/130 AF Proposed well depth (feet) 215

This point is: Additional Well Geo Center List other water rights that will use this point _____

6. **Presently authorized point of diversion:**

One in the _____ Quarter of the _____ Quarter of the _____ Quarter of Section _____, Township _____ South, Range _____ (E/W), in _____ County, Kansas, _____ feet North _____ feet West of Southeast corner of section. Authorized Rate _____ Authorized Quantity _____ Depth of well _____ (feet)

(DWR use only: Computer ID No. _____ GPS _____ feet North _____ feet West)

This point will not be changed This point will be changed as follows: No change, point better described with GPS as follows:

Proposed point of diversion: (Complete only if change is requested or if existing point is better described by GPS)

One in the SW Quarter of the SW Quarter of the LOT 7 (SW SW) Quarter of Section 6, Township 20 South, Range 38 W, in WICHITA County, Kansas, 545 feet North 5225 feet West of Southeast corner of section. Proposed Rate 190/40 GPM Proposed Quantity 40 AF / 49 AF Proposed well depth (feet) 215

This point is: Additional Well Geo Center List other water rights that will use this point _____

7. The changes herein are desired for the following reasons? (please be specific) _____
8. If a well, is the test hole log attached? Yes No
9. The change(s) (was)(will be) completed by? _____
10. If the point of diversion is a well:
 (a) What are you going to do with the old well? _____
 (b) When will this be done? _____
11. Groundwater Management District recommendation attached? Yes No
12. Assisted by JG/GCFO _____

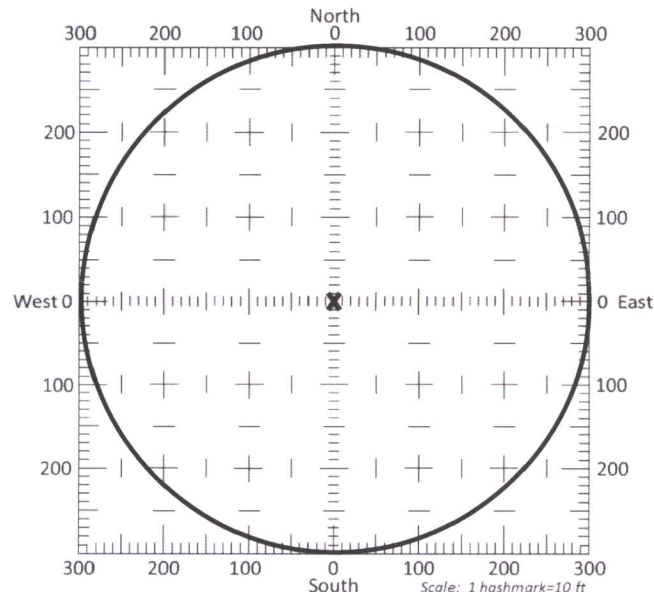

13a. If the proposed point of diversion will be relocated more than 300 feet but within 2,640 feet of the existing point of diversion, attach a topographic map or aerial photograph. For groundwater sources, show all wells (including domestic) within one-half mile of the proposed point of diversion and the names and mailing addresses of the owners. For surface water sources, show the names and addresses of the landowner(s) one-half mile downstream and one-half mile upstream from your property lines

13b. If the proposed point of diversion will be relocated within a 300 foot radius of the existing point of diversion, indicate its location on the diagram shown above in relation to the existing point of diversion. The proposed point of diversion must be located within the circle shown above. **(PLEASE NOTE: The "X" in center of diagram above represents the presently authorized point of diversion.)**

14. If the proposed groundwater point of diversion is 300 or fewer feet from the existing point of diversion, complete the following:
- (a) Does the undersigned represent all owners of the currently authorized place(s) of use identified in this application?
 Yes No (If no, all owners must sign this application.)
 - (b) Will the ownership interest of any owner of the currently authorized place(s) of use identified in this application be adversely affected if this application is approved as requested?
 Yes No (If yes, all owners must sign this application.)
 - (c) If this application is not approved expeditiously, will there be substantial damage to property, public health or safety?
 Yes No (If no, all owners must sign this application.)

If the application proposes a surface water change in point of diversion, a groundwater change in point of diversion greater than 300 feet, or a change in place of use, the application must be signed by all owners of the currently authorized place of use, or their duly authorized agent (attach notarized statement authorizing representation).

I hereby verify, being first duly sworn upon my oath or affirmation and under penalty of perjury, that I am of lawful age and the owner, the spouse of the owner, or a duly authorized agent of the owner(s) to make this application on their behalf, in regards to the water right(s) to which this application pertains. I further verify that the statements contained in this application are true, correct and complete.

Dated at Garden City, Kansas, this 30th day of March, 20 22.

Mike Nickel executive

 (Owner)

 (Spouse)

Mike Nickelson

 (Please Print)

 (Please Print)

 (Owner)

 (Spouse)

 (Please Print)

 (Please Print)

 (Owner)

 (Spouse)

 (Please Print)

 (Please Print)

State of Kansas }
 County of Stinney } SS

I hereby certify that the foregoing application was signed in my presence and sworn to before me this 30th day of March, 20 22.

My Commission Expires _____



Julie Jones
 Notary Public

ONLY COMPLETE APPLICATIONS WILL BE PROCESSED. To be complete, all of the applicable portions of the application form must be completed with accurate information; maps, if necessary, must be included; signatures of all the appropriate owners' must be affixed to the application and notarized; and the appropriate fee must be paid.

FEE SCHEDULE

Each application to change the place of use or the point of diversion under this section shall be accompanied by the application fee set forth in the schedule below: Make checks payable to: **Kansas Department of Agriculture**

- (1) Application to change a point of diversion 300 feet or less \$100
- (2) Application to change a point of diversion more than 300 feet \$200
- (3) Application to change the place of use \$200

CHANGE IN POINT OF DIVERSION WATER RIGHT, FILE NO. 12481

SW 1/4 of Section 6 Township 20 South Range 38 West Wichita County

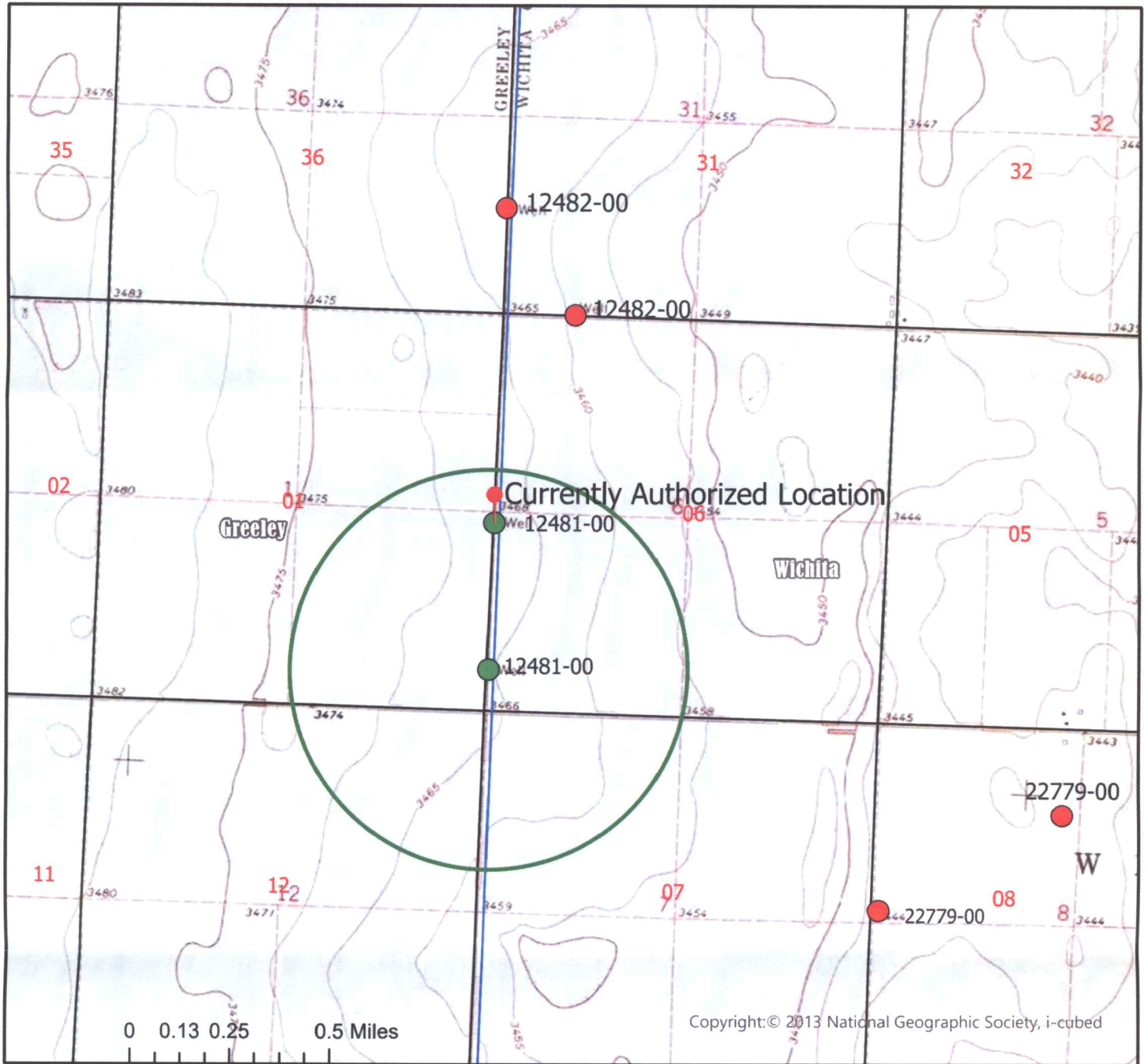

- Authorized Point of Diversion
- Proposed Point of Diversion
- Domestic Well within 1/2 mile
- 1/2 mile buffer

List of owner name and addresses within 1/2 mile:



All wells of any kind within 1/2 mile of the requested place of use have been plotted.

Mike Nickel executive 2-27-22

(Signature)

Date

Date JG/GCFO
1:24,000 Scale

KANSAS DEPARTMENT OF AGRICULTURE
Division of Water Resources
Garden City Field Office

M E M O R A N D U M

TO: File

DATE: April 5, 2022

FROM: Michael A. Meyer 
Water Commissioner

RE: Water Right, File No. 12481

An application to change the point of diversion, File No. 12481 has been filed on March 20, 2022, to “add” an authorized point of diversion. Historically the water right originally authorized two wells with separate diversion rates and quantities. In calendar year 2015, the landowner requested to combined these to wells to one single point of diversion (eliminate the south originally authorized well). The request was approved on June 10, 2015, for a combined diversion rate and quantity on the one currently authorized well.

The current proposal is to “unstack the wells” again and give authority to the south well with separate rates and quantities. The application meets all rules and regulations.