

File No. **14135** 11. County: HS Basin: CROOKED CREEK Stream: Formation Code: **211/331** Special Use:

12. Points of Diversion
 Rate and Quantity
 Authorized Additional
 Rate Quantity Rate Quantity
 gpm af gpm af Overlap PD Files

CHK	MOD	DEL	ENT	PDIV	Qualifier	S	T	R	ID	'N	'W	Comment (AKA Line)	Rate gpm	Quantity af	Rate gpm	Quantity af	Overlap PD Files
CHK	69933																

13. Storage: Rate _____ NF Quantity _____ ac/ft Additional Rate _____ NF Additional Quantity _____ ac/ft

14. Limitation: _____ af/yr at _____ gpm (_____ cfs) when combined with file number(s) _____
 Limitation: _____ af/yr at _____ gpm (_____ cfs) when combined with file number(s) _____

15. 5YR Allocation: Allocation Type _____ Start Year _____ 5 YR Amount _____ Amount Unit _____ Base Acres _____ Comment _____

16. Place of Use CHK MOD DEL ENT	PUSE	S	T	R	ID	NE¼				NW¼				SW¼				SE¼				Total	Owner	Chg?	Overlap Files
						NE ¼	NW ¼	SW ¼	SE ¼	NE ¼	NW ¼	SW ¼	SE ¼	NE ¼	NW ¼	SW ¼	SE ¼	NE ¼	NW ¼	SW ¼	SE ¼				
MOD 288	23	28S31W	1			12	36	40	36	40	40	40	40	40	36	13	36				409	8a	N	MULTIPLE	
MOD 6139	24	28S31W	2			31.25	31.25	31.25	31.25	31.25	31.25	31.25	31.25	31.25	31.25	31.25	31.25	31.25	31.25	31.25	500	8a	N	MULTIPLE	
CHK 9541	26	28S31W	1							31.25	31.25	31.25	31.25								125	8a	N	MULTIPLE	
MOD 21706	13	28S31W	3											31.25	31.25	31.25	31.25	31.25	31.25	31.25	250	8a	N	MULTIPLE	

Base Acres: Year: Minimum Reasonable Quantity:
 Comments: **OVERLAPPING FILES ON PLACE OF USE 5075; 14135; 23383; 28481& 29859 TOTAL BASE ACRES FOR GROUP = 1274 ACRES**

Garden City Field Office
4532 W. Jones, Suite B
Garden City, KS 67846



Phone: 620-276-2901
Fax: 620-276-9315
www.agriculture.ks.gov

Mike Beam, Secretary

Laura Kelly, Governor

June 16, 2022

MIKE & EVANGELYN NIGHTENGALE
1011 XX RD
COPELAND, KS 67837

RE: Filed Office Application for Change
Water Right, File Nos. 5075; 14135; 23383; 28481 & 29859

Dear Sir or Madam:

Enclosed is the order executed by the designee of the Chief Engineer, Division of Water Resources, Kansas Department of Agriculture, approving the application for change under the above referenced file numbers.

Your attention is directed to the enclosures and to the terms, conditions, and limitations specified in this approval for change. A condition of this approval is that an acceptable water flow meter must be installed on the diversion works authorized under the referenced file number and meet current specifications. Please return the required notification of completion of the diversion works and/or installation of the required meter as soon as these actions are completed.

Since the order modifies the original document referred to above, it should be recorded with the Register of Deeds as other instruments affecting real estate.

Should you have any questions, please feel free contact this office. If you would prefer, you could arrange an appointment for additional assistance.

Sincerely,

A handwritten signature in blue ink, appearing to read "Austin J. McColloch".

Austin J. McColloch
Assistant Water Commissioner

AM:
enclosures

pc: GROUNDWATER MANAGEMENT DISTRICT NO. 3

CERTIFICATE OF SERVICE

On this 16th day of June, 2022, I hereby certify that the foregoing Approval of Application for Change in Place of Use, Water Right, File Nos. 5,075, 14,135, 23,383, 28,481 and 29,859 dated 16th day of June, 2022 was mailed postage prepaid, first class, US mail to the following:

MIKE & EVANGELYN NIGHTENGALE
1011 XX RD
COPELAND, KS 67837

Pc:

GROUNDWATER MANAGEMENT DISTRICT NO. 3



Division of Water Resources Staff

Submit completed application to:
 Kansas Department of Agriculture
 Division of Water Resources
 Field Office for your area.
 Call for address:

Topeka -- (785) 296-5733
 Stafford -- (620) 234-5311
 Stockton -- (785) 425-6787
 Garden City -- (620) 276-2901
<http://agriculture.ks.gov/dwr>

DWR FIELD OFFICE APPLICATION FOR APPROVAL TO CHANGE THE PLACE OF USE AND/OR THE POINT OF DIVERSION



STATE OF KANSAS

Filing Fee Must Accompany the Application, K.S.A. 82a-708b(b), as amended.
 Fee Schedule is on the third page of this application form.

Paragraph Nos. 1, 2, 3 & 5 must be completed. Complete all other applicable portions. If change in point of diversion is greater than 100 feet, or if place of use will be changed, include a topographic map or detailed plat showing the authorized and proposed point(s) of diversion and/or place of use.

RECEIVED
 4:16 PM
 MAY 24 2022

 File No. 14135

1. Application is hereby made for approval of the Chief Engineer to change the (check one or both): Garden City Field Office
Division of Water Resources

Place of Use Point of Diversion

under the water right which is the subject of this application in accordance with the conditions described below.

The source of supply is: Groundwater Surface water

2. Name and address of Applicant: MIKE & EVANGELYN NIGHTENGALE
1011 XX RD COPELAND KS 67837
 Phone Number: (620) 272-2068 Email address: vangienightengale@hotmail.com
 Name and address of Water Use Correspondent: SAME AS ABOVE

Phone Number: () Email address: _____

3. The presently authorized place of use is:
 Owner of Land ---- NAME: SEE ATTACHMENT
 ADDRESS: _____
 (If there is more than one landowner, attach supplemental sheets as necessary.)

Sec.	Twp.	Range	NE¼				NW¼				SW¼				SE¼				TOTAL ACRES
			NE¼	NW¼	SW¼	SE¼	NE¼	NW¼	SW¼	SE¼	NE¼	NW¼	SW¼	SE¼	NE¼	NW¼	SW¼	SE¼	

4. If this application is for a change in place of use, it is proposed that the place of use be changed to:
 Owner of Land ---- NAME: SEE ATTACHMENT
 ADDRESS: _____
 (If there is more than one landowner, attach supplemental sheets as necessary.)

Sec.	Twp.	Range	NE¼				NW¼				SW¼				SE¼				TOTAL ACRES
			NE¼	NW¼	SW¼	SE¼	NE¼	NW¼	SW¼	SE¼	NE¼	NW¼	SW¼	SE¼	NE¼	NW¼	SW¼	SE¼	

For Office Use Only: Code _____ Fee \$ 200.00 TR # _____ Receipt Date 5/24/22 Check # 10515

5. **Presently authorized point of diversion:**
 One in the _____ Quarter of the _____ Quarter of the _____ Quarter
 of Section _____, Township _____ South, Range _____ (W),
 in _____ County, Kansas, _____ feet North _____ feet West of Southeast corner of section.
 Authorized Rate _____ Authorized Quantity _____ Depth of well _____ (feet)
(DWR use only: Computer ID No. _____ GPS _____ feet North _____ feet West)
 This point will not be changed This point will be changed as follows: No change, point better described with GPS as follows:
Proposed point of diversion: (Complete only if change is requested or if existing point is better described by GPS)
 One in the _____ Quarter of the _____ Quarter of the _____ Quarter
 of Section _____, Township _____ South, Range _____ (W),
 in _____ County, Kansas, _____ feet North _____ feet West of Southeast corner of section.
 Proposed Rate _____ Proposed Quantity _____ Proposed well depth (feet) _____
 This point is: Additional Well Geo Center List other water rights that will use this point _____

6. **Presently authorized point of diversion:**
 One in the _____ Quarter of the _____ Quarter of the _____ Quarter
 of Section _____, Township _____ South, Range _____ (W),
 in _____ County, Kansas, _____ feet North _____ feet West of Southeast corner of section.
 Authorized Rate _____ Authorized Quantity _____ Depth of well _____ (feet)
(DWR use only: Computer ID No. _____ GPS _____ feet North _____ feet West)
 This point will not be changed This point will be changed as follows: No change, point better described with GPS as follows:
Proposed point of diversion: (Complete only if change is requested or if existing point is better described by GPS)
 One in the _____ Quarter of the _____ Quarter of the _____ Quarter
 of Section _____, Township _____ South, Range _____ (W),
 in _____ County, Kansas, _____ feet North _____ feet West of Southeast corner of section.
 Proposed Rate _____ Proposed Quantity _____ Proposed well depth (feet) _____
 This point is: Additional Well Geo Center List other water rights that will use this point _____

7. The changes herein are desired for the following reasons?
 (please be specific) MOVE ACRES AROUND TO
BETTER FIT OPERATION. ALREADY COMPLETE
OVERLAP W/ FILE 5075; 14135; 23383; 28481; 29859

8. If a well, is the test hole log attached? Yes No

9. The change(s) (was)(will be) completed by?
UPON APPROVAL

10. If the point of diversion is a well:
 (a) What are you going to do with the old well?
N / A
 (b) When will this be done? _____

11. Groundwater Management District recommendation attached?
 Yes No

12. Assisted by AM / GCFO

13a. If the proposed point of diversion will be relocated more than 300 feet but within 2,640 feet of the existing point of diversion, attach a topographic map or aerial photograph. For groundwater sources, show all wells (including domestic) within one-half mile of the proposed point of diversion and the names and mailing addresses of the owners. For surface water sources, show the names and addresses of the landowner(s) one-half mile downstream and one-half mile upstream from your property lines

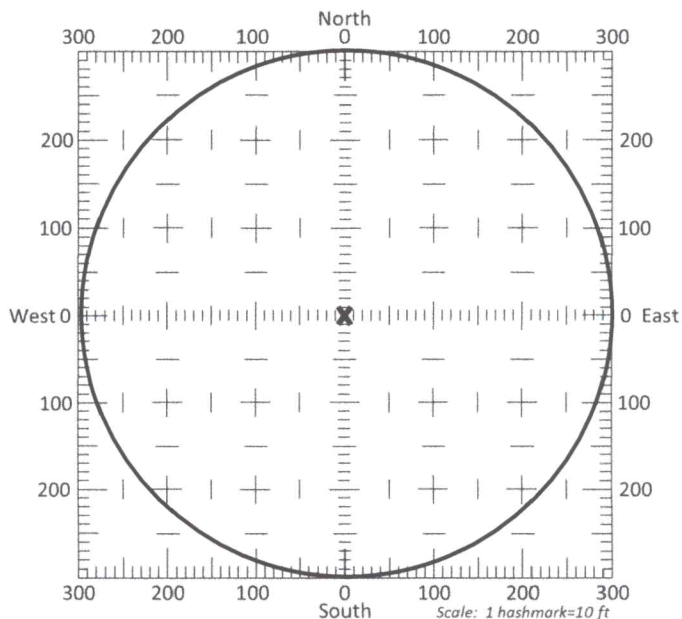

13b. If the proposed point of diversion will be relocated within a 300 foot radius of the existing point of diversion, indicate its location on the diagram shown above in relation to the existing point of diversion. The proposed point of diversion must be located within the circle shown above. **(PLEASE NOTE: The "X" in center of diagram above represents the presently authorized point of diversion.)**

APPLICATION FOR APPROVAL TO CHANGE
THE PLACE OF USE AND/OR POINT OF DIVERSION
SUPPLEMENTAL SHEET
FILE NO. 5075; 14135; 23383; 28481 & 29859
MAKE ADDITIONAL COPIES AS NECESSARY

3. *Continued:* The presently authorized place of use is:
Owner of Land ---- NAME: MIKE & EVANGELYN NIGHTENGALE
ADDRESS: 1011 XX RD COPELAND KS 67837

Sec.	Twp.	Range	NE¼				NW¼				SW¼				SE¼				TOTAL ACRES
			NE¼	NW¼	SW¼	SE¼	NE¼	NW¼	SW¼	SE¼	NE¼	NW¼	SW¼	SE¼	NE¼	NW¼	SW¼	SE¼	
13	28S	31W									40	40	40	40	40	40	40	40	320
23	28S	31W	34	40	40	40	40	40	40	40	40	36	13	36					439
24	28S	31W	30	30	30	30	40	40	40	40					30	30	30	30	400

Owner of Land ---- NAME: MIKE & EVANGELYN NIGHTENGALE
ADDRESS: 1011 XX RD COPELAND KS 67837

Sec.	Twp.	Range	NE¼				NW¼				SW¼				SE¼				TOTAL ACRES
			NE¼	NW¼	SW¼	SE¼	NE¼	NW¼	SW¼	SE¼	NE¼	NW¼	SW¼	SE¼	NE¼	NW¼	SW¼	SE¼	
26	28S	31W					31.25	31.25	31.25	31.25									125

Owner of Land ---- NAME: _____
ADDRESS: _____

Sec.	Twp.	Range	NE¼				NW¼				SW¼				SE¼				TOTAL ACRES
			NE¼	NW¼	SW¼	SE¼	NE¼	NW¼	SW¼	SE¼	NE¼	NW¼	SW¼	SE¼	NE¼	NW¼	SW¼	SE¼	

4. *Continued:* If this application is for a change in place of use, it is proposed that the place of use be changed to:
Owner of Land ---- NAME: MIKE & EVANGELYN NIGHTENGALE
ADDRESS: 1011 XX RD COPELAND KS 67837

Sec.	Twp.	Range	NE¼				NW¼				SW¼				SE¼				TOTAL ACRES
			NE¼	NW¼	SW¼	SE¼	NE¼	NW¼	SW¼	SE¼	NE¼	NW¼	SW¼	SE¼	NE¼	NW¼	SW¼	SE¼	
13	28S	31W									31.25	31.25	31.25	31.25	31.25	31.25	31.25	31.25	250
23	28S	31W	12	36	40	36	40	40	40	40	40	36	13	36					409
24	28S	31W	31.25	31.25	31.25	31.25	31.25	31.25	31.25	31.25	31.25	31.25	31.25	31.25	31.25	31.25	31.25	31.25	500

Owner of Land ---- NAME: MIKE & EVANGELYN NIGHTENGALE
ADDRESS: 1011 XX RD COPELAND KS 67837

Sec.	Twp.	Range	NE¼				NW¼				SW¼				SE¼				TOTAL ACRES
			NE¼	NW¼	SW¼	SE¼	NE¼	NW¼	SW¼	SE¼	NE¼	NW¼	SW¼	SE¼	NE¼	NW¼	SW¼	SE¼	
26	28S	31W					31.25	31.25	31.25	31.25									125

Owner of Land ---- NAME: _____
ADDRESS: _____

Sec.	Twp.	Range	NE¼				NW¼				SW¼				SE¼				TOTAL ACRES
			NE¼	NW¼	SW¼	SE¼	NE¼	NW¼	SW¼	SE¼	NE¼	NW¼	SW¼	SE¼	NE¼	NW¼	SW¼	SE¼	

14. If the proposed groundwater point of diversion is 300 or fewer feet from the existing point of diversion, complete the following:

- (a) Does the undersigned represent all owners of the currently authorized place(s) of use identified in this application?
 Yes No (If no, all owners must sign this application.)
- (b) Will the ownership interest of any owner of the currently authorized place(s) of use identified in this application be adversely affected if this application is approved as requested?
 Yes No (If yes, all owners must sign this application.)
- (c) If this application is not approved expeditiously, will there be substantial damage to property, public health or safety?
 Yes No (If no, all owners must sign this application.)

If the application proposes a surface water change in point of diversion, a groundwater change in point of diversion greater than 300 feet, or a change in place of use, the application must be signed by all owners of the currently authorized place of use, or their duly authorized agent (attach notarized statement authorizing representation).

I hereby verify, being first duly sworn upon my oath or affirmation and under penalty of perjury, that I am of lawful age and the owner, the spouse of the owner, or a duly authorized agent of the owner(s) to make this application on their behalf, in regards to the water right(s) to which this application pertains. I further verify that the statements contained in this application are true, correct and complete.

Dated at Landon City, Kansas, this 24th day of May, 20 22.

[Signature]
(Owner)

Evangelyn Nightengale
(Spouse)

Mike Nightengale
(Please Print)

Evangelyn Nightengale
(Please Print)

(Owner)

(Spouse)

(Please Print)

(Please Print)

(Owner)

(Spouse)

(Please Print)

(Please Print)

State of Kansas }
County of Linney } SS

I hereby certify that the foregoing application was signed in my presence and sworn to before me this 24th day of May, 20 22.



My Commission Expires _____

Julie Jones
Notary Public

ONLY COMPLETE APPLICATIONS WILL BE PROCESSED. To be complete, all of the applicable portions of the application form must be completed with accurate information; maps, if necessary, must be included; signatures of all the appropriate owners' must be affixed to the application and notarized; and the appropriate fee must be paid.





FEE SCHEDULE

Each application to change the place of use or the point of diversion under this section shall be accompanied by the application fee set forth in the schedule below: Make checks payable to: **Kansas Department of Agriculture**

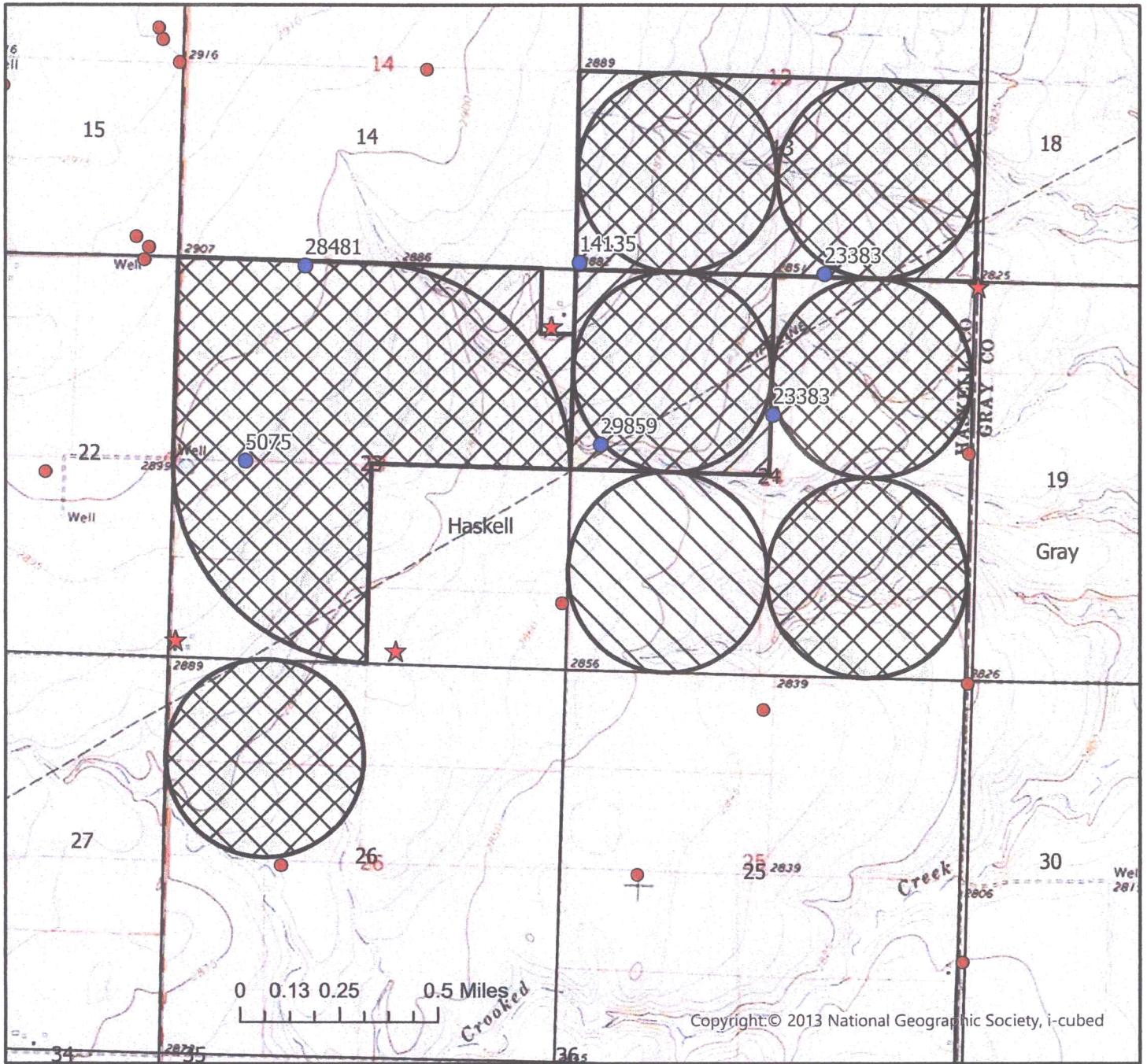
(1) Application to change a point of diversion 300 feet or less	\$100
(2) Application to change a point of diversion more than 300 feet	\$200
(3) Application to change the place of use	\$200

CHANGE IN PLACE OF USE WATER RIGHT FILE NOS. 5075; 14135; 23383; 28481 & 29859



	Authorized Point of Diversion
	Permitted Water Right
	Domestic Well within 1/2 mile
	Authorized Place of Use
	Proposed Place of Use

List of owner name and addresses within 1/2 mile:



By signing below I agree that all wells, including domestic, and owners names and addresses within 1/2 mile of the proposed point of diversion have been shown on the map

(Signature)

Date

Date AM/GCFO
1:24,000 Scale

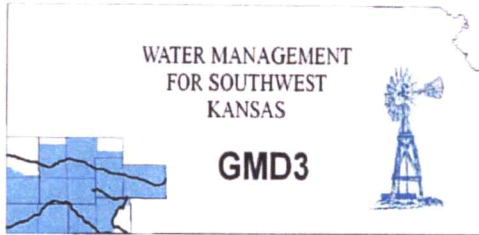

Southwest Kansas
Groundwater Management District No. 3
2009 E. Spruce Street
Garden City, Kansas 67846
(620) 275-7147 phone (620) 275-1431 fax
www.gmd3.org

June 14, 2022

Austin McColloch
Division of Water Resources
4532 W Jones Ave., Suite B
Garden City, Kansas 67846

RECEIVED

JUN 14 2022

Garden City Field Office
Division of Water Resources

RE: Applications for Change in Place of Use
Water Right, File Nos. 5075, 14135, 23383, 28481 & 29859

Dear Austin:

We have completed a review of the applications for the above referenced water rights. The proposals are not in conflict with the Management Program of the Southwest Kansas Groundwater Management District No. 3 (GMD3). The proposed change in place of use will rearrange current acres to cover land that was not previously authorized and eliminate homesteads and pivot corners that are not watered. At the same time, the applications will keep a complete overlap in place of use in accordance with K.A.R. 5-5-11(b). It is therefore recommended that the applications be approved at this time.

Thank you for the opportunity to review the applications and to provide a recommendation. If you have any questions, please don't hesitate to contact us.

Sincerely,



Jason L. Norquest
Assistant Manager

GMD3 Change Review

File No(s): 5075, 14135, 23383, 28481, 29859.

DWR office: GC.

App filed to change: Mike & Evangelyn Nightengale.

Is Landowner(s) correct in WRIS: .

If NO, is documentation included?

Is Water Use Correspondent correct in WRIS? .

If NO, is documentation included?

Regulation(s) Reviewed: KAR 5-5-11

Point of diversion ID No(s) being changed.

	ft. North	ft. West
Authorized PD		
Proposed PD		
Difference	0	0
a2 + b2 = c2	0	0
		0

GPS for proposed PD: Lat: Long: .

Is proposed PD stacking on existing WRs? No Change.

Is Proposed PU overlapping existing WRs? Maintain complete overlap, but rearrange acres.

Neighboring certified well(s) notified: .

Name .

Address .

Zip .

Email: Phone: .

Domestic well(s) notified: .

Name .

Address .

Zip .

Base Acres: .

Perfected Acres: .

Irr. Return-Flow %

WRs are currently completely overlapped.

Combined authority on WRs: 2465AF

		Current	Proposed	
13-28-31	S2	320acres	250acres	-70
23-28-31	NE, NW, SW	439acres	409acres	-30
24-28-31	NE, NW, SE	400acres	500acres	+100
26-28-31	NW	125acres	125acres	
		1284 Total	1284acres	

Is a waiver needed: No, stayed within limits of the base acres for the WRs.

Recommendation: After review of all available information, it appears current area rules are met. Staff therefore recommends approval of the applications.

Garden City Field Office
4532 W. Jones, Suite B
Garden City, KS 67846



Phone: 620-276-2901
Fax: 620-276-9315
www.agriculture.ks.gov

Mike Beam, Secretary

Laura Kelly, Governor

June 10, 2022

GROUNDWATER MANAGEMENT DISTRICT #3
2009 E SPRUCE ST
GARDEN CITY KS 67846

Re: Request for Recommendation,
File No. 5075; 14135; 23383; 28481 & 29859

Dear Sir or Madam:

We are enclosing a copy of the referenced application, which was submitted by Mike Nightengale and appears to be in proper form, for your review.

We are delaying any further action for a period of 15 days from the date of this letter to allow you time to submit your recommendation concerning this application. Please submit your recommendation within the allotted time, or any authorized extension of time thereof.

If you have any questions, please contact me at (620) 276-2901. If you wish to discuss a specific file, please have the file number ready to that I may help you more efficiently.

Sincerely,

A handwritten signature in blue ink that reads "Austin McColloch".

Austin McColloch
Assistant Water Commissioner

Enclosure
pc:

Garden City Field Office
4532 W. Jones, Suite B
Garden City, KS 67846



Phone: 620-276-2901
Fax: 620-276-9315
www.agriculture.ks.gov

Mike Beam, Secretary

Laura Kelly, Governor

May 25, 2022

HIGH PLAINS RANCH LLC
12225 E HIGHWAY 160
SATANTA, KS 67870

RE: Application for Change
Water Right, File Nos. 5075; 14135; 23383; 28481
& 29859

Dear Sir or Madam:

This is to advise you that Mike Nightengale has filed an application for approval of the Chief Engineer, Division of Water Resources, Kansas Department of Agriculture, to change the place of use under the above referenced file numbers.

From: a total of 1,284 acres in Sections 13, 23, 24 and 26, all in Township 28 South, Range 31 West, Haskell County, Kansas,

To: a total of 1,284 acres Sections 13, 23, 24 and 26, all in Township 28 South, Range 31 West, Haskell County, Kansas,

You can find the complete applications posted by water right file number as referenced above at: www.Agriculture.ks.gov/DWRNotices

You are notified on this proposed change in the place of use so that you may furnish this office with any comments or other information you want to submit. Such comments or other information must be received in this office within 15 days from the date of this letter.

Should you have any questions, please feel free contact this office. If you would prefer, you could arrange an appointment for additional assistance. Please refer to the file number when you contact us if you wish to discuss a specific file.

Sincerely,

A handwritten signature in black ink, appearing to read "Austin J. McColloch".

Austin J. McColloch
Assistant Water Commissioner

AM:
enclosures

pc:
GROUNDWATER MANAGEMENT DISTRICT NO. 3

SCANNED

Garden City Field Office
4532 W. Jones, Suite B
Garden City, KS 67846



Phone: 620-276-2901
Fax: 620-276-9315
www.agriculture.ks.gov

Mike Beam, Secretary

Laura Kelly, Governor

May 25, 2022

BARBARA RIPHAHN
2318 150TH RD
COPELAND, KS 67837

RE: Application for Change
Water Right, File Nos. 5075; 14135; 23383; 28481
& 29859

Dear Sir or Madam:

This is to advise you that Mike Nightengale has filed an application for approval of the Chief Engineer, Division of Water Resources, Kansas Department of Agriculture, to change the place of use under the above referenced file numbers.

From: a total of 1,284 acres in Sections 13, 23, 24 and 26, all in Township 28 South, Range 31 West, Haskell County, Kansas,

To: a total of 1,284 acres Sections 13, 23, 24 and 26, all in Township 28 South, Range 31 West, Haskell County, Kansas,

You can find the complete applications posted by water right file number as referenced above at: www.Agriculture.ks.gov/DWRNotices

You are notified on this proposed change in the place of use so that you may furnish this office with any comments or other information you want to submit. Such comments or other information must be received in this office within 15 days from the date of this letter.

Should you have any questions, please feel free contact this office. If you would prefer, you could arrange an appointment for additional assistance. Please refer to the file number when you contact us if you wish to discuss a specific file.

Sincerely,

A handwritten signature in black ink, appearing to read "Austin J. McColloch".

Austin J. McColloch
Assistant Water Commissioner

AM:
enclosures

pc:
GROUNDWATER MANAGEMENT DISTRICT NO. 3

SCANNED

Garden City Field Office
4532 W. Jones, Suite B
Garden City, KS 67846



Phone: 620-276-2901
Fax: 620-276-9315
www.agriculture.ks.gov

Mike Beam, Secretary

Laura Kelly, Governor

May 25, 2022

KENNETH & SHIRLEY NICKEL
2352 110TH RD
COPELAND, KS 67837

RE: Application for Change
Water Right, File Nos. 5075; 14135; 23383; 28481
& 29859

Dear Sir or Madam:

This is to advise you that Mike Nightengale has filed an application for approval of the Chief Engineer, Division of Water Resources, Kansas Department of Agriculture, to change the place of use under the above referenced file numbers.

From: a total of 1,284 acres in Sections 13, 23, 24 and 26, all in Township 28 South, Range 31 West, Haskell County, Kansas,

To: a total of 1,284 acres Sections 13, 23, 24 and 26, all in Township 28 South, Range 31 West, Haskell County, Kansas,

You can find the complete applications posted by water right file number as referenced above at: www.Agriculture.ks.gov/DWRNotices

You are notified on this proposed change in the place of use so that you may furnish this office with any comments or other information you want to submit. Such comments or other information must be received in this office within 15 days from the date of this letter.

Should you have any questions, please feel free contact this office. If you would prefer, you could arrange an appointment for additional assistance. Please refer to the file number when you contact us if you wish to discuss a specific file.

Sincerely,

A handwritten signature in black ink, appearing to read "Austin J. McColloch".

Austin J. McColloch
Assistant Water Commissioner

AM:
enclosures

pc:
GROUNDWATER MANAGEMENT DISTRICT NO. 3

SCANNED

Garden City Field Office
4532 W. Jones, Suite B
Garden City, KS 67846



Phone: 620-276-2901
Fax: 620-276-9315
www.agriculture.ks.gov

Mike Beam, Secretary

Laura Kelly, Governor

May 25, 2022

6-T FARMS
Attn: NANCY DOTTS
BOX 351
MONTEZUMA, KS 67867

RE: Application for Change
Water Right, File Nos. 5075; 14135; 23383; 28481
& 29859

Dear Sir or Madam:

This is to advise you that Mike Nightengale has filed an application for approval of the Chief Engineer, Division of Water Resources, Kansas Department of Agriculture, to change the place of use under the above referenced file numbers.

From: a total of 1,284 acres in Sections 13, 23, 24 and 26, all in Township 28 South, Range 31 West, Haskell County, Kansas,

To: a total of 1,284 acres Sections 13, 23, 24 and 26, all in Township 28 South, Range 31 West, Haskell County, Kansas,

You can find the complete applications posted by water right file number as referenced above at:
www.Agriculture.ks.gov/DWRNotices

You are notified on this proposed change in the place of use so that you may furnish this office with any comments or other information you want to submit. Such comments or other information must be received in this office within 15 days from the date of this letter.

Should you have any questions, please feel free contact this office. If you would prefer, you could arrange an appointment for additional assistance. Please refer to the file number when you contact us if you wish to discuss a specific file.

Sincerely,

A handwritten signature in black ink that reads "Austin J. McColloch".

Austin J. McColloch
Assistant Water Commissioner

AM:
enclosures

pc:
GROUNDWATER MANAGEMENT DISTRICT NO. 3

SCANNED

Garden City Field Office
4532 W. Jones, Suite B
Garden City, KS 67846



Phone: 620-276-2901
Fax: 620-276-9315
www.agriculture.ks.gov

Mike Beam, Secretary

Laura Kelly, Governor

May 25, 2022

ROXIE JTUCKER TRUST
1005 BB RD
COPELAND, KS 67837-8017

RE: Application for Change
Water Right, File Nos. 5075; 14135; 23383; 28481
& 29859

Dear Sir or Madam:

This is to advise you that Mike Nightengale has filed an application for approval of the Chief Engineer, Division of Water Resources, Kansas Department of Agriculture, to change the place of use under the above referenced file numbers.

From: a total of 1,284 acres in Sections 13, 23, 24 and 26, all in Township 28 South, Range 31 West, Haskell County, Kansas,

To: a total of 1,284 acres Sections 13, 23, 24 and 26, all in Township 28 South, Range 31 West, Haskell County, Kansas,

You can find the complete applications posted by water right file number as referenced above at:
www.Agriculture.ks.gov/DWRNotices

You are notified on this proposed change in the place of use so that you may furnish this office with any comments or other information you want to submit. Such comments or other information must be received in this office within 15 days from the date of this letter.

Should you have any questions, please feel free contact this office. If you would prefer, you could arrange an appointment for additional assistance. Please refer to the file number when you contact us if you wish to discuss a specific file.

Sincerely,

Austin J. McColloch
Assistant Water Commissioner

AM:
enclosures

pc:
GROUNDWATER MANAGEMENT DISTRICT NO. 3

SCANNED