

Kansas Department of Agriculture  
 Division of Water Resources  
**CHANGE: pu WORKSHEET**

1. File Number: <b>25248</b>	2. Status Change Date: <b>9-16-2022</b>	3. Change Num: <b>C1</b>	4. Field Office: <b>04</b>	5. GMD: <b>01</b>
---------------------------------	--	-----------------------------	-------------------------------	----------------------

6. Status: <input checked="" type="checkbox"/> Approved <input type="checkbox"/> Denied by DWR/GMD <input type="checkbox"/> Dismiss by Request/Failure to Return	7. Filing Date of Change: <b>7/19/2022</b>
--	---

8a. Landowner, New to system <input type="checkbox"/>  Person ID <b>9363</b> Add Seq# _____  <b>KIMBALL CATTLE CO INC</b> <b>ATTN: K MIKE KIMBALL</b> <b>PO BOX 527</b> <b>ULYSSES, KS 67880</b>	8c. Landowner(s) New to system <input type="checkbox"/>  Person ID <b>61260</b> Add Seq# _____  <b>FOUR B FARMS</b> <b>3171 W HIGHWAY 96</b> <b>SCOTT CITY, KS 67871-6089</b>
---	---

8b. Landowner(s) New to system <input type="checkbox"/>  Person ID <b>24499</b> Add Seq# _____  <b>MIKE &amp; JANET KIMBALL</b> <b>PO BOX 505</b> <b>ULYSSES, KS 67880</b>	8d. Correspondent, applicant New to system <input type="checkbox"/>  Person ID <b>39173</b> Add Seq# _____  <b>TERRY BERNING</b> <b>3171 W HWY 96</b> <b>SCOTT CITY, KS 67871-6089</b>
--	--

9. Documents and Enclosure(s):  DWR Meter(s) Date to Comply: **12/31/22**     N & P Date to Comply: \_\_\_\_\_

Anti-Reverse Meter   
  Meter Seal   
  Check Valve   
  N & P Form   
  Water Tube   
  Driller Copy   
  H & E Letter

Conservation Plan   
 Date Required: \_\_\_\_\_   
 Date Approved: \_\_\_\_\_   
 Date to Comply: \_\_\_\_\_

10. Use Made of Water    From: \_\_\_\_\_    To: \_\_\_\_\_

Date Prepared: **9/13/2022**    By: **MAM**

Date Entered: \_\_\_\_\_    By: \_\_\_\_\_

File No. **25248**      11. County: **SC**      Basin: **WHITEWOMAN**      Stream: \_\_\_\_\_      Formation Code: \_\_\_\_\_      Special Use: \_\_\_\_\_

12. Points of Diversion  
**CHK**      Rate and Quantity  
**MOD**      Authorized      Additional  
**DEL**      PDIV      Qualifier      S      T      R      ID      'N      'W      **Comment (AKA Line)**      Rate      Quantity      Rate      Quantity  
**ENT**                                                                            gpm      af      gpm      af      Overlap PD Files

**CHK 31563**

13. Storage: Rate \_\_\_\_\_ NF      Quantity \_\_\_\_\_ ac/ft      Additional Rate \_\_\_\_\_ NF      Additional Quantity \_\_\_\_\_ ac/ft

14. Limitation: \_\_\_\_\_ af/yr at \_\_\_\_\_ gpm ( \_\_\_\_\_ cfs) when combined with file number(s) \_\_\_\_\_  
 Limitation: \_\_\_\_\_ af/yr at \_\_\_\_\_ gpm ( \_\_\_\_\_ cfs) when combined with file number(s) \_\_\_\_\_

15. 5YR Allocation:      Allocation Type \_\_\_\_\_      Start Year \_\_\_\_\_      5 YR Amount \_\_\_\_\_      Amount Unit \_\_\_\_\_      Base Acres \_\_\_\_\_      Comment \_\_\_\_\_

16. Place of Use <b>CHK</b> <b>MOD</b> <b>DEL</b> <b>ENT</b>	PUSE	S	T	R	ID	NE¼				NW¼				SW¼				SE¼				Total	Owner	Chg?	Overlap Files	
						NE ¼	NW ¼	SW ¼	SE ¼	NE ¼	NW ¼	SW ¼	SE ¼	NE ¼	NW ¼	SW ¼	SE ¼	NE ¼	NW ¼	SW ¼	SE ¼					
<b>CHK</b>	<b>9347</b>	<b>30</b>	<b>18</b>	<b>32W</b>	<b>03</b>				<b>40</b>									<b>40</b>			<b>40</b>	<b>120</b>	<b>8b</b>	<b>N</b>	<b>SC 025, 8030-D2, 25367,</b>	
<b>MOD</b>	<b>35293</b>	<b>32</b>	<b>18</b>	<b>32W</b>	<b>02</b>	<b>10</b>	<b>35</b>	<b>40</b>	<b>35</b>	<b>10</b>	<b>35</b>	<b>35</b>	<b>40</b>	<b>40</b>	<b>35</b>			<b>35</b>	<b>40</b>		<b>390</b>	<b>8a</b>	<b>N</b>	<b>SC 025, 8030-D2, 25367,</b>		
<b>CHK</b>	<b>40648</b>	<b>29</b>	<b>18</b>	<b>32W</b>	<b>01</b>									<b>40</b>	<b>20</b>	<b>40</b>	<b>40</b>				<b>140</b>	<b>8b</b>	<b>N</b>	<b>SC 025, 8030-D2, 25367,</b>		
<b>ENT</b>	<b>37519</b>	<b>32</b>	<b>18</b>	<b>32W</b>	<b>01</b>											<b>40</b>	<b>40</b>			<b>40</b>	<b>40</b>	<b>160</b>	<b>8c</b>	<b>Y</b>	<b>SC 025, 8030-D2, 25367,</b>	

Base Acres: **400**      Year: \_\_\_\_\_      Minimum Reasonable Quantity: \_\_\_\_\_  
 Comments: \_\_\_\_\_

Garden City Field Office  
4532 W. Jones, Suite B  
Garden City, KS 67846



Phone: 620-276-2901  
Fax: 620-276-9315  
www.agriculture.ks.gov

Mike Beam, Secretary

Laura Kelly, Governor

September 16, 2022

TERRY BERNING  
3171 W HWY 96  
SCOTT CITY, KS 67871-6089

RE: Field Office Application for Change  
Vested Right, File No. SC 025  
Water Right, File Nos. 8030-D2, 25248, 25367

Dear Sir:

Enclosed are orders executed by the designee of the Chief Engineer, Division of Water Resources, Kansas Department of Agriculture, approving the applications for change under the above referenced file numbers.

Your attention is directed to the enclosures and to the terms, conditions, and limitations specified in this approval for change. Conditions of these approvals are that an acceptable water flow meter must be installed on the diversion works authorized under the referenced file numbers and meet current specifications. Please return the required notification of completion of the diversion works and installation of the required meter as soon as these actions are completed.

Since the order modifies the original document referred to above, it should be recorded with the Register of Deeds as other instruments affecting real estate.

Should you have any questions, please feel free contact this office. If you would prefer, you could arrange an appointment for additional assistance.

Sincerely,

A blue ink signature of Michael A. Meyer, written in a cursive style. The signature is positioned above the printed name and title.

Michael A. Meyer  
Water Commissioner

MAM:  
enclosures

pc: KIMBALL CATTLE (w/enc)  
MIKE & JANET KIMBALL (w/ enc)  
FOUR B FARMS  
GROUNDWATER MANAGEMENT DISTRICT NO. 1

**CERTIFICATE OF SERVICE**

On this 16<sup>th</sup> day of September 2022, I hereby certify that the foregoing Approvals of Application for Change in Place of Use, Vested Right, File No. SC 025, Water Right, File Nos. 8030-D2, 25248, 25367 dated 16<sup>th</sup> day of September 2022 was mailed postage prepaid, first class, US mail to the following:

TERRY BERNING  
3171 W HWY 96  
SCOTT CITY, KS 67871-6089

Pc:

KIMBALL CATTLE CO INC  
ATTN: K MIKE KIMBALL  
PO BOX 527  
ULYSSES, KS 67880

MIKE & JANET KIMBALL  
PO BOX 505  
ULYSSES, KS 67880

FOUR B FARMS  
3171 W HIGHWAY 96  
SCOTT CITY, KS 67871-6089

GROUNDWATER MANAGEMENT DISTRICT NO. 1

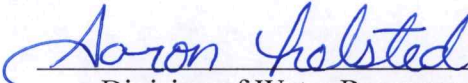
  
\_\_\_\_\_  
Division of Water Resources Staff

Submit completed application to:  
 Kansas Department of Agriculture  
 Division of Water Resources  
 Field Office for your area.

Call for address:

Topeka -- (785) 296-5733  
 Stafford -- (620) 234-5311  
 Stockton -- (785) 425-6787  
 Garden City -- (620) 276-2901  
<http://agriculture.ks.gov/dwr>

## DWR FIELD OFFICE APPLICATION FOR APPROVAL TO CHANGE THE PLACE OF USE AND/OR THE POINT OF DIVERSION



STATE OF KANSAS

**Filing Fee Must Accompany the Application, K.S.A. 82a-708b(b), as amended.**  
 Fee Schedule is on the third page of this application form.

**Paragraph Nos. 1, 2, 3 & 5 must be completed. Complete all other applicable portions.** If change in point of diversion is greater than 100 feet, or if place of use will be changed, include a topographic map or detailed plat showing the authorized and proposed point(s) of diversion and/or place of use.

**RECEIVED**  
 8:02 am  
 JUL 19 2022

File No. 25248

1. Application is hereby made for approval of the Chief Engineer to change the (check one or both): Garden City Field Office  
Division of Water Resources

Place of Use                       Point of Diversion

under the water right which is the subject of this application in accordance with the conditions described below.

The source of supply is:                       Groundwater                       Surface water

2. Name and address of Applicant: TERRY BERNING  
3171 W HWY 96 SCOTT CITY, KS 67871

Phone Number: (620)872-5503                      Email address: deere@wbsnet.org

Name and address of Water Use Correspondent: KIMBALL CATTLE CO INC

PO BOX 527 ULYSSES, KS 67880

Phone Number: (620) 353-8280                      Email address: HKAC@Pco.com

3. The presently authorized place of use is:  
 Owner of Land --- NAME: SAME AS ABOVE  
 ADDRESS: SAME AS ABOVE

(If there is more than one landowner, attach supplemental sheets as necessary.)

Sec.	Twp.	Range	NE¼				NW¼				SW¼				SE¼				TOTAL ACRES
			NE¼	NW¼	SW¼	SE¼	NE¼	NW¼	SW¼	SE¼	NE¼	NW¼	SW¼	SE¼	NE¼	NW¼	SW¼	SE¼	
32	18S	32W	37	40	40	37	40	40	40	40	35	10			10	35			404

4. If this application is for a change in place of use, it is proposed that the place of use be changed to:  
 Owner of Land --- NAME: SAME AS ABOVE  
 ADDRESS: SAME AS ABOVE

(If there is more than one landowner, attach supplemental sheets as necessary.)

Sec.	Twp.	Range	NE¼				NW¼				SW¼				SE¼				TOTAL ACRES
			NE¼	NW¼	SW¼	SE¼	NE¼	NW¼	SW¼	SE¼	NE¼	NW¼	SW¼	SE¼	NE¼	NW¼	SW¼	SE¼	
32	18S	32W	10 37	35 40	40 40	35 37	35 40	10 40	35 40	40	40 35	35 40			35 40	40 35			404 390
<del>30</del>	<del>18S</del>	<del>32W</del>				40									40				120
<del>29</del>	<del>18S</del>	<del>32W</del>									40	20	40	40					140

For Office Use Only: Code \_\_\_\_\_ Fee \$ 200.00 TR # \_\_\_\_\_ Receipt Date 7-19-22 Check # 3053

5. **Presently authorized point of diversion:**  
 One in the \_\_\_\_\_ Quarter of the \_\_\_\_\_ Quarter of the \_\_\_\_\_ Quarter  
 of Section \_\_\_\_\_, Township \_\_\_\_\_ South, Range \_\_\_\_\_ W,  
 in \_\_\_\_\_ County, Kansas, \_\_\_\_\_ feet North \_\_\_\_\_ feet West of Southeast corner of section.  
 Authorized Rate \_\_\_\_\_ Authorized Quantity \_\_\_\_\_ Depth of well \_\_\_\_\_ (feet)  
**(DWR use only: Computer ID No. 1 \_\_\_\_\_ GPS \_\_\_\_\_ feet North \_\_\_\_\_ feet West)**  
 This point will not be changed  This point will be changed as follows:  No change, point better described with GPS as follows:  
**Proposed point of diversion: (Complete only if change is requested or if existing point is better described by GPS)**  
 One in the \_\_\_\_\_ Quarter of the \_\_\_\_\_ Quarter of the \_\_\_\_\_ Quarter  
 of Section \_\_\_\_\_, Township \_\_\_\_\_ South, Range \_\_\_\_\_ W,  
 in \_\_\_\_\_ County, Kansas, \_\_\_\_\_ feet North \_\_\_\_\_ feet West of Southeast corner of section.  
 Proposed Rate \_\_\_\_\_ Proposed Quantity \_\_\_\_\_ Proposed well depth (feet) \_\_\_\_\_  
 This point is:  Additional Well  Geo Center List other water rights that will use this point \_\_\_\_\_

6. **Presently authorized point of diversion:**  
 One in the \_\_\_\_\_ Quarter of the \_\_\_\_\_ Quarter of the \_\_\_\_\_ Quarter  
 of Section \_\_\_\_\_, Township \_\_\_\_\_ South, Range \_\_\_\_\_ W,  
 in \_\_\_\_\_ County, Kansas, \_\_\_\_\_ feet North \_\_\_\_\_ feet West of Southeast corner of section.  
 Authorized Rate \_\_\_\_\_ Authorized Quantity \_\_\_\_\_ Depth of well \_\_\_\_\_ (feet)  
**(DWR use only: Computer ID No. \_\_\_\_\_ GPS \_\_\_\_\_ feet North \_\_\_\_\_ feet West)**  
 This point will not be changed  This point will be changed as follows:  No change, point better described with GPS as follows:  
**Proposed point of diversion: (Complete only if change is requested or if existing point is better described by GPS)**  
 One in the \_\_\_\_\_ Quarter of the \_\_\_\_\_ Quarter of the \_\_\_\_\_ Quarter  
 of Section \_\_\_\_\_, Township \_\_\_\_\_ South, Range \_\_\_\_\_ W,  
 in \_\_\_\_\_ County, Kansas, \_\_\_\_\_ feet North \_\_\_\_\_ feet West of Southeast corner of section.  
 Proposed Rate \_\_\_\_\_ Proposed Quantity \_\_\_\_\_ Proposed well depth (feet) \_\_\_\_\_  
 This point is:  Additional Well  Geo Center List other water rights that will use this point \_\_\_\_\_

7. The changes herein are desired for the following reasons?  
 (please be specific) \_\_\_\_\_  
 \_\_\_\_\_

8. If a well, is the test hole log attached?  Yes  No

9. The change(s) (was)(will be) completed by?  
 \_\_\_\_\_

10. If the point of diversion is a well:  
 (a) What are you going to do with the old well?  
 \_\_\_\_\_  
 (b) When will this be done? \_\_\_\_\_

11. Groundwater Management District recommendation attached?  
 Yes  No

12. Assisted by JG/GCFO \_\_\_\_\_

13a. If the proposed point of diversion will be relocated more than 300 feet but within 2,640 feet of the existing point of diversion, attach a topographic map or aerial photograph. For groundwater sources, show all wells (including domestic) within one-half mile of the proposed point of diversion and the names and mailing addresses of the owners. For surface water sources, show the names and addresses of the landowner(s) one-half mile downstream and one-half mile upstream from your property lines

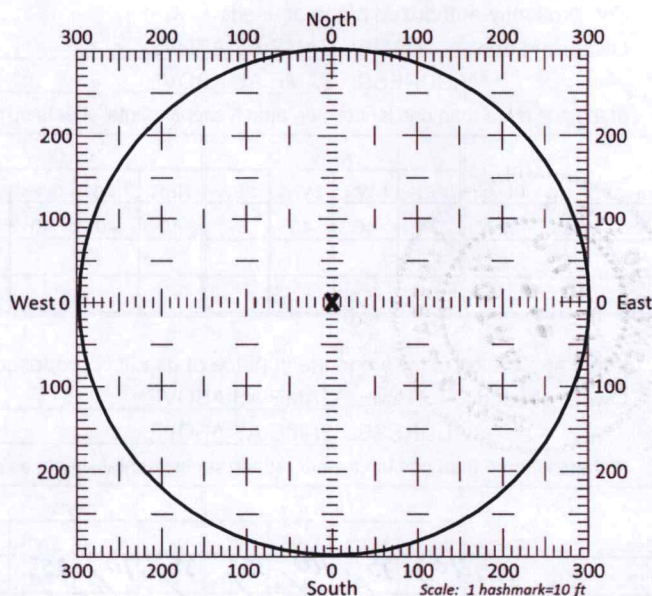

13b. If the proposed point of diversion will be relocated within a 300 foot radius of the existing point of diversion, indicate its location on the diagram shown above in relation to the existing point of diversion. The proposed point of diversion must be located within the circle shown above. **(PLEASE NOTE: The "X" in center of diagram above represents the presently authorized point of diversion.)**

APPLICATION FOR APPROVAL TO CHANGE  
THE PLACE OF USE AND/OR POINT OF DIVERSION  
SUPPLEMENTAL SHEET

**FILE NO. 25367**

MAKE ADDITIONAL COPIES AS NECESSARY

3. *Continued:* The presently authorized place of use is:

Owner of Land ---- NAME: NO CHANGE

ADDRESS: \_\_\_\_\_

Sec.	Twp.	Range	NE¼				NW¼				SW¼				SE¼				TOTAL ACRES		
			NE¼	NW¼	SW¼	SE¼	NE¼	NW¼	SW¼	SE¼	NE¼	NW¼	SW¼	SE¼	NE¼	NW¼	SW¼	SE¼			

Owner of Land ---- NAME: \_\_\_\_\_

ADDRESS: \_\_\_\_\_

Sec.	Twp.	Range	NE¼				NW¼				SW¼				SE¼				TOTAL ACRES			
			NE¼	NW¼	SW¼	SE¼	NE¼	NW¼	SW¼	SE¼	NE¼	NW¼	SW¼	SE¼	NE¼	NW¼	SW¼	SE¼				

Owner of Land ---- NAME: \_\_\_\_\_

ADDRESS: \_\_\_\_\_

Sec.	Twp.	Range	NE¼				NW¼				SW¼				SE¼				TOTAL ACRES				
			NE¼	NW¼	SW¼	SE¼	NE¼	NW¼	SW¼	SE¼	NE¼	NW¼	SW¼	SE¼	NE¼	NW¼	SW¼	SE¼					

4. *Continued:* If this application is for a change in place of use, it is proposed that the place of use be changed to:

Owner of Land ---- NAME: KIMBALL CATTLE CO INC

ADDRESS: PO BOX 527 ULYSSES KS 67880

Sec.	Twp.	Range	NE¼				NW¼				SW¼				SE¼				TOTAL ACRES				
			NE¼	NW¼	SW¼	SE¼	NE¼	NW¼	SW¼	SE¼	NE¼	NW¼	SW¼	SE¼	NE¼	NW¼	SW¼	SE¼					
32	18	32W	10	35	40	35	35	10	35	40	35	10			10	35						330	

Owner of Land ---- NAME: MIKE & JANET KIMBALL

ADDRESS: PO BOX 505 ULYSSES KS 67880

Sec.	Twp.	Range	NE¼				NW¼				SW¼				SE¼				TOTAL ACRES					
			NE¼	NW¼	SW¼	SE¼	NE¼	NW¼	SW¼	SE¼	NE¼	NW¼	SW¼	SE¼	NE¼	NW¼	SW¼	SE¼						
29	18	32W													40	20	40	40					140	
30	18	32W				40									40						40		120	

Owner of Land ---- NAME: \_\_\_\_\_

ADDRESS: \_\_\_\_\_

Sec.	Twp.	Range	NE¼				NW¼				SW¼				SE¼				TOTAL ACRES					
			NE¼	NW¼	SW¼	SE¼	NE¼	NW¼	SW¼	SE¼	NE¼	NW¼	SW¼	SE¼	NE¼	NW¼	SW¼	SE¼						

Terry

14. If the proposed groundwater point of diversion is 300 or fewer feet from the existing point of diversion, complete the following:

- (a) Does the undersigned represent all owners of the currently authorized place(s) of use identified in this application?  
 Yes     No    (If no, all owners must sign this application.)
- (b) Will the ownership interest of any owner of the currently authorized place(s) of use identified in this application be adversely affected if this application is approved as requested?  
 Yes     No    (If yes, all owners must sign this application.)
- (c) If this application is not approved expeditiously, will there be substantial damage to property, public health or safety?  
 Yes     No    (If no, all owners must sign this application.)

If the application proposes a surface water change in point of diversion, a groundwater change in point of diversion greater than 300 feet, or a change in place of use, the application must be signed by all owners of the currently authorized place of use, or their duly authorized agent (attach notarized statement authorizing representation).

I hereby verify, being first duly sworn upon my oath or affirmation and under penalty of perjury, that I am of lawful age and the owner, the spouse of the owner, or a duly authorized agent of the owner(s) to make this application on their behalf, in regards to the water right(s) to which this application pertains. I further verify that the statements contained in this application are true, correct and complete.

Dated at Scott City, Kansas, this 2<sup>nd</sup> day of August, 2022.

Louise Berning partner  
(Owner)

\_\_\_\_\_  
(Spouse)

Terry Berning partner  
(Please Print)

\_\_\_\_\_  
(Please Print)

\_\_\_\_\_  
(Owner)

\_\_\_\_\_  
(Spouse)

\_\_\_\_\_  
(Please Print)

\_\_\_\_\_  
(Please Print)

\_\_\_\_\_  
(Owner)

\_\_\_\_\_  
(Spouse)

\_\_\_\_\_  
(Please Print)

\_\_\_\_\_  
(Please Print)

State of Kansas }  
County of Scott } SS

I hereby certify that the foregoing application was signed in my presence and sworn to before me this 2<sup>nd</sup> day of August, 2022.

My Commission Expires February 4, 2024  
LOUISE J. BERNING  
Notary Public - Kansas  
My Comm. Expires February 4, 2024

[Signature]  
Notary Public

**ONLY COMPLETE APPLICATIONS WILL BE PROCESSED.** To be complete, all of the applicable portions of the application form must be completed with accurate information; maps, if necessary, must be included; signatures of all the appropriate owners must be affixed to the application and notarized; and the appropriate fee must be paid.

**FEE SCHEDULE**

Each application to change the place of use or the point of diversion under this section shall be accompanied by the application fee set forth in the schedule below: Make checks payable to: **Kansas Department of Agriculture**

(1) Application to change a point of diversion 300 feet or less .....	\$100
(2) Application to change a point of diversion more than 300 feet .....	\$200
(3) Application to change the place of use .....	\$200



Mike + Janel

14. If the proposed groundwater point of diversion is 300 or fewer feet from the existing point of diversion, complete the following:

- (a) Does the undersigned represent all owners of the currently authorized place(s) of use identified in this application?  
 Yes     No    (If no, all owners must sign this application.)
- (b) Will the ownership interest of any owner of the currently authorized place(s) of use identified in this application be adversely affected if this application is approved as requested?  
 Yes     No    (If yes, all owners must sign this application.)
- (c) If this application is not approved expeditiously, will there be substantial damage to property, public health or safety?  
 Yes     No    (If no, all owners must sign this application.)

If the application proposes a surface water change in point of diversion, a groundwater change in point of diversion greater than 300 feet, or a change in place of use, the application must be signed by all owners of the currently authorized place of use, or their duly authorized agent (attach notarized statement authorizing representation).

I hereby verify, being first duly sworn upon my oath or affirmation and under penalty of perjury, that I am of lawful age and the owner, the spouse of the owner, or a duly authorized agent of the owner(s) to make this application on their behalf, in regards to the water right(s) to which this application pertains. I further verify that the statements contained in this application are true, correct and complete.

Dated at Lawrence, Kansas, this 22 day of August, 20 22.

[Signature]  
 (Owner)  
Mike Kimball  
 (Please Print)  
Janel K Kimball  
 (Owner)  
Janel K Kimball  
 (Please Print)  
 \_\_\_\_\_  
 (Owner)  
 \_\_\_\_\_  
 (Please Print)

[Signature]  
 (Spouse)  
Janel K Kimball  
 (Please Print)  
[Signature]  
 (Spouse)  
Mike Kimball  
 (Please Print)  
 \_\_\_\_\_  
 (Spouse)  
 \_\_\_\_\_  
 (Please Print)

State of Kansas }  
County of Douglas } SS

I hereby certify that the foregoing application was signed in my presence and sworn to before me this 22 day of August, 20 22.

[Signature]

**JOHN HAMER**  
 Notary Public-State of Kansas  
 My Appt. Expires 02/05/2025

My Commission Expires 02/05/2025.

**ONLY COMPLETE APPLICATIONS WILL BE PROCESSED.** To be complete, all of the applicable portions of the application form must be completed with accurate information; maps, if necessary, must be included; signatures of all the appropriate owners' must be affixed to the application and notarized; and the appropriate fee must be paid.

**FEE SCHEDULE**

Each application to change the place of use or the point of diversion under this section shall be accompanied by the application fee set forth in the schedule below: Make checks payable to: **Kansas Department of Agriculture**

- (1) Application to change a point of diversion 300 feet or less ..... \$100
- (2) Application to change a point of diversion more than 300 feet ..... \$200
- (3) Application to change the place of use ..... \$200

**RECEIVED**

**AUG 24 2022**

Garden City Field Office  
Division of Water Resources

14. If the proposed groundwater point of diversion is 300 or fewer feet from the existing point of diversion, complete the following:
- (a) Does the undersigned represent all owners of the currently authorized place(s) of use identified in this application?  
 Yes     No    (If no, all owners must sign this application.)
  - (b) Will the ownership interest of any owner of the currently authorized place(s) of use identified in this application be adversely affected if this application is approved as requested?  
 Yes     No    (If yes, all owners must sign this application.)
  - (c) If this application is not approved expeditiously, will there be substantial damage to property, public health or safety?  
 Yes     No    (If no, all owners must sign this application.)

If the application proposes a surface water change in point of diversion, a groundwater change in point of diversion greater than 300 feet, or a change in place of use, the application must be signed by all owners of the currently authorized place of use, or their duly authorized agent (attach notarized statement authorizing representation).

I hereby verify, being first duly sworn upon my oath or affirmation and under penalty of perjury, that I am of lawful age and the owner, the spouse of the owner, or a duly authorized agent of the owner(s) to make this application on their behalf, in regards to the water right(s) to which this application pertains. I further verify that the statements contained in this application are true, correct and complete.

Dated at Wichita, Kansas, this 27<sup>th</sup> day of May, 2022.

Kirbell Cattle Co, Inc  
 (Owner)

[Signature]  
 (Spouse) President

\_\_\_\_\_  
 (Please Print)

\_\_\_\_\_  
 (Please Print)

\_\_\_\_\_  
 (Owner)

\_\_\_\_\_  
 (Spouse)

\_\_\_\_\_  
 (Please Print)

\_\_\_\_\_  
 (Please Print)

\_\_\_\_\_  
 (Owner)

\_\_\_\_\_  
 (Spouse)

\_\_\_\_\_  
 (Please Print)

\_\_\_\_\_  
 (Please Print)

State of Kansas }  
 County of GRANT } SS

I hereby certify that the foregoing application was signed in my presence and sworn to before me this 27<sup>th</sup> day of May, 2022.

My Commission Expires 12-18-22

[Signature]  
 Notary Public  
TAMERA J. OLIVER

**ONLY COMPLETE APPLICATIONS WILL BE PROCESSED.** To be complete, all of the applicable portions of the application form must be completed with accurate information; maps, if necessary, must be included; signatures of all the appropriate owners' must be affixed to the application and notarized; and the appropriate fee must be paid.

**FEE SCHEDULE**





- Each application to change the place of use or the point of diversion under this section shall be accompanied by the application fee set forth in the schedule below: Make checks payable to: **Kansas Department of Agriculture**
- (1) Application to change a point of diversion 300 feet or less ..... \$100
  - (2) Application to change a point of diversion more than 300 feet ..... \$200
  - (3) Application to change the place of use ..... \$200

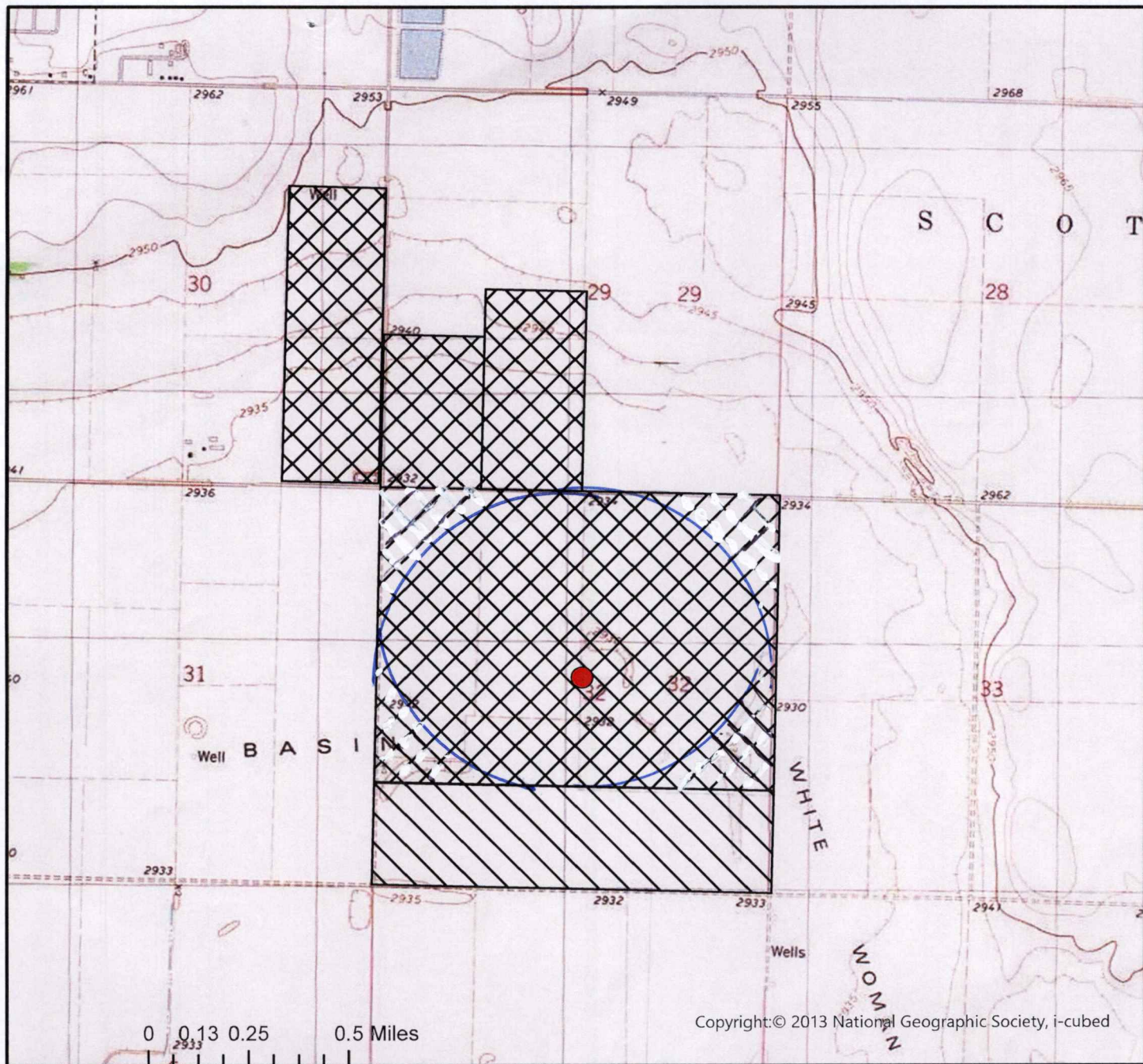

# CHANGE IN PLACE OF USE WATER RIGHT, FILE NO. 25248

NE 1/4 of Section 32 Township 18 South Range 32 West Scott County



	Authorized Point of Diversion
	
	Domestic Well within 1/2 mile
	Authorized Place of Use
	Proposed Place of Use

List of owner name and addresses within 1/2 mile:

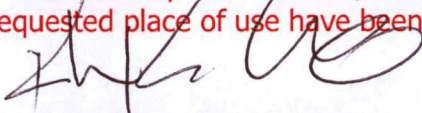

All wells of any kind within 1/2 mile of the requested place of use have been plotted.

 5/27/22  
 \_\_\_\_\_  
 (Signature) Date

Date JG/GCFO  
 1:24,000 Scale



---

WESTERN KANSAS GROUNDWATER MANAGEMENT DISTRICT NO.1

September 15<sup>th</sup>, 2022

Michael Meyer  
Water Commissioner  
4532 W. Jones, Suite B  
Garden City, KS 67846

Re: Request for Recommendation  
Vested Right, File No. SC025  
Water Right, File Nos. 8030-D2, 25367, 25248

This is in response to your letter dated August 29<sup>th</sup>, 2022 in regard to the Place of Use Change Applications for Terry Berning on File Nos. SC025, 8030, 25367, 25248. Upon review, we find them in order and therefore recommend approval of the applications to the Chief Engineer. These applications will be subject to the rules and regulations of the Kansas Division of Water Resources.

Please feel free to reach out with any questions or concerns.

Regards,

Katie Durham  
District Manager

RECEIVED  
SEP 15 2022  
Garden City Field Office  
Division of Water Resources

Garden City Field Office  
4532 W. Jones, Suite B  
Garden City, KS 67846



Phone: 620-276-2901  
Fax: 620-276-9315  
www.agriculture.ks.gov

Mike Beam, Secretary

Laura Kelly, Governor

August 29, 2022

GROUNDWATER MANAGEMENT DISTRICT NO.1  
906 W. 5TH  
P.O. BOX 604  
SCOTT CITY, KS 67871

RE: Request for Recommendation  
Vested Right, File No. SC 025  
Water Right, File Nos. 8030-D2, 25367, 25248

Dear Ms. Durham:

This is to advise you that Terry Berning has filed applications for approval of the Chief Engineer, Division of Water Resources, Kansas Department of Agriculture, to change the place of use. The applications meet all rules and regulations.

We are delaying action on the change applications to allow you time to review and provide a recommendation. Please submit a recommendation within 15 days from the date of this letter.

Thank you and as always feel free to contact this office at any time.

Sincerely,

A handwritten signature in blue ink that reads "Michael A. Meyer". The signature is fluid and cursive, with a long horizontal stroke at the end.

Michael A. Meyer  
Water Commissioner

MAM