

NOTICE

This scan only represents the application as filed. The information contained herein meets the requirements of K.A.R. 5-3-1 or K.A.R. 5-5-1, and has been found acceptable for filing in the office of the Chief Engineer. The application should not be considered to be a complete application as per K.A.R. 5-3-1b or K.A.R. 5-5-2a.

Submit To: CHIEF ENGINEER
Division of Water Resources
Kansas Department of Agriculture
1320 Research Park Drive
Manhattan, Kansas 66502
http://agriculture.ks.gov/dwr

**APPLICATION FOR APPROVAL TO
CHANGE THE PLACE OF USE, THE
POINT OF DIVERSION OR THE USE
MADE OF THE WATER UNDER AN
EXISTING WATER RIGHT**



Filing Fee Must Accompany the Application
(Please refer to Fee Schedule on signature page of application form.)

Paragraph Nos. 1, 2, 3, 4 & 8 must be completed. Complete all other applicable portions. A topographic map or detailed plat showing the authorized and proposed points(s) of diversion and /or place of use must accompany this application.

1. Application is hereby made for approval of the Chief Engineer to change the

- Place of Use
 Point of Diversion
 Use Made of Water

(Check one or more)

File No. 43060

2. Name of applicant: IRSIK & DOLL FEED SERVICES INC

Address: PO BOX 847

City, State and Zip: CIMARRON KS 67835

Phone Number: (620) 855-3111

E-mail address: jheiman@irsikanddoll.com

What is your relationship to the water right; owner tenant agent other? If other, please explain. _____

Name of water use correspondent: SUNBELT FEED YARD

Address: PO BOX 38

City, State and Zip: HUGOTON KS 67951

Phone Number: () _____

E-mail address: _____

3. The change(s) proposed herein are desired for the following reasons (please be specific): _____

TO ACCOMMODATE A FEEDLOT OPERATION. THIS CHANGE WILL CONVERT AN IRRIGATION RIGHT TO A DUAL USE IRRIGATION/STOCKWATERING PERMIT. IN ADDITION, THIS APPLICATION WILL CHANGE THE AUTHORIZED PLACE OF USE TO COVER THE FEEDLOT.

The change(s) (was) (will be) completed by UPON APPROVAL

(Date)

For Office Use Only:

F.O. 4 GMD 3 Meets K.A.R. 5-5-1 (YES / NO) Use IRR Source G / S County SV By BMM Date 6/13/22
Code C-2 Fee \$ 500 TR # _____ Receipt Date 6/10/22 Check # 662837

1 of 2

6/14/2022
LMoody

4. The presently authorized place of use is:

Owner of Land — NAME: IRSIK & DOLL FEED SERVICES INC

ADDRESS: PO BOX 847 CIMARRON KS 67835

Sec.	Twp.	Range	NE¼				NW¼				SW¼				SE¼				TOTAL ACRES
			NE¼	NW¼	SW¼	SE¼	NE¼	NW¼	SW¼	SE¼	NE¼	NW¼	SW¼	SE¼	NE¼	NW¼	SW¼	SE¼	
24	32S	37W									32	32	32	32					128

List any other water rights that cover this place of use. 41554

Owner of Land — NAME: _____

ADDRESS: _____

Sec.	Twp.	Range	NE¼				NW¼				SW¼				SE¼				TOTAL ACRES
			NE¼	NW¼	SW¼	SE¼	NE¼	NW¼	SW¼	SE¼	NE¼	NW¼	SW¼	SE¼	NE¼	NW¼	SW¼	SE¼	

List any other water rights that cover this place of use. _____

(If there are more than two landowners, attach additional sheets as necessary.)

5. It is proposed that the place of use be changed to:

Owner of Land — NAME: IRSIK & DOLL FEED SERVICES INC

ADDRESS: PO BOX 847 CIMARRON KS 67835

Sec.	Twp.	Range	NE¼				NW¼				SW¼				SE¼				TOTAL ACRES
			NE¼	NW¼	SW¼	SE¼	NE¼	NW¼	SW¼	SE¼	NE¼	NW¼	SW¼	SE¼	NE¼	NW¼	SW¼	SE¼	
24	32S	37W									32	32	32	32					128

List any other water rights that cover this place of use. 41554

Owner of Land — NAME: IRSIK & DOLL FEED SERVICES INC

ADDRESS: PO BOX 847 CIMARRON KS 67835

Sec.	Twp.	Range	NE¼				NW¼				SW¼				SE¼				TOTAL ACRES
			NE¼	NW¼	SW¼	SE¼	NE¼	NW¼	SW¼	SE¼	NE¼	NW¼	SW¼	SE¼	NE¼	NW¼	SW¼	SE¼	
24	32S	37W	FEEDLOT IN E2 LYING NORTH OF RAILROAD RIGHT OF WAY, E2 NW & 8AC NE SW																

List any other water rights that cover this place of use. 20484; 37812; 41554; 43070

IF MORE SPACE IS NEEDED, ATTACH ADDITIONAL SHEETS AS NECESSARY

JUN 09 2022

KS DEPT OF AGRICULTURE

- 6. The presently authorized point(s) of diversion (is) (are) ONE WELL; PUMP; MOTOR
(Provide description and number of points)
- 7. The proposed point(s) of diversion (is) (are) ONE WELL; PUMP; MOTOR
(Provide description and number of points)

List all presently authorized point(s) of diversion:

8. **Presently authorized point of diversion:**

One in the NE Quarter of the NE Quarter of the SE Quarter of Section 24, Township 32 South, Range 37 (W), in STEVENS County, Kansas, 2603 feet North 3223 feet West of Southeast corner of section. Authorized Rate 380 GPM Authorized Quantity 162 AF
(DWR use only: Computer ID No. 06 GPS _____ feet North _____ feet West)

This point will not be changed This point will be changed as follows:

Proposed point of diversion: (Complete only if change is requested)

One in the NE Quarter of the NE Quarter of the SE Quarter of Section 24, Township 32 South, Range 37 (W), in STEVENS County, Kansas, 2603 feet North 3223 feet West of Southeast corner of section. Proposed Rate 380 GPM Proposed Quantity STK: 144.34 AF IRR: 162 AF LIMITED (SEE ITEM 13 & 17)
This point is: Additional Well Geo Center List other water rights that will use this point 41554

9. **Presently authorized point of diversion:**

One in the _____ Quarter of the _____ Quarter of the _____ Quarter of Section _____, Township _____ South, Range _____ (E/W), in _____ County, Kansas, _____ feet North _____ feet West of Southeast corner of section. Authorized Rate _____ Authorized Quantity _____
(DWR use only: Computer ID No. _____ GPS _____ feet North _____ feet West)

This point will not be changed This point will be changed as follows:

Proposed point of diversion: (Complete only if change is requested)

One in the _____ Quarter of the _____ Quarter of the _____ Quarter of Section _____, Township _____ South, Range _____ (E/W), in _____ County, Kansas, _____ feet North _____ feet West of Southeast corner of section. Proposed Rate _____ Proposed Quantity _____
This point is: Additional Well Geo Center List other water rights that will use this point _____

10. **Presently authorized point of diversion:**

One in the _____ Quarter of the _____ Quarter of the _____ Quarter of Section _____, Township _____ South, Range _____ (E/W), in _____ County, Kansas, _____ feet North _____ feet West of Southeast corner of section. Authorized Rate _____ Authorized Quantity _____
(DWR use only: Computer ID No. _____ GPS _____ feet North _____ feet West)

This point will not be changed This point will be changed as follows:

Proposed point of diversion: (Complete only if change is requested)

One in the _____ Quarter of the _____ Quarter of the _____ Quarter of Section _____, Township _____ South, Range _____ (E/W), in _____ County, Kansas, _____ feet North _____ feet West of Southeast corner of section. Proposed Rate _____ Proposed Quantity _____
This point is: Additional Well Geo Center List other water rights that will use this point _____

- 11. Describe the current condition of and future plans for any point(s) of diversion which will no longer be used. N/A

IF MORE SPACE IS NEEDED, ATTACH ADDITIONAL SHEETS AS NECESSARY

12. The presently authorized use of water is for IRRIGATION purposes.
It is proposed that the use be changed to IRRIGATION / STOCKWATERING purposes.
13. If changing the place of use and/or use made of water, describe how the consumptive use will not be increased.
THIS REQUEST PROPOSED TO CONVERT THE WATER RIGHT INTO BOTH IRRIGATION AND STOCKWATERING
USE FOR A DUAL USE PERMIT. THE PROPOSED STOCKWATERING AUTHORIZED QUANTITY IS BASED ON A
CONSUMPTIVE USE CONVERSION OF 89.1% IN STEVENS COUNTY (K.A.R. 5-5-9)
CURRENT AUTHORIZED = 162 AF * 89.1% = 144.34 AF
ORIGINAL LIMITATION WILL BE UPDATED TO: LIMITED TO 144.34 AF/YR @ 380 GPM COM / W #41554
(Please show any calculations here.)
14. It is requested that the maximum annual quantity of water be reduced to SEE ITEM 17 (acre-feet or million gallons).
15. It is requested that the maximum rate of diversion of water be reduced to N / A gallons per minute (c.f.s.).
16. The application must include either a topographic map or detailed plat. A U.S. Geological Survey Topographic Map, scale 1:24,000, is available through the Kansas Geological Survey, 1930 Constant Avenue, University of Kansas, Lawrence, Kansas 66047-3726 (www.usgs.gov). The map should show the location of the presently authorized point(s) of diversion. Distances North and West of the Southeast corner of the section must be shown. The presently authorized place of use should also be shown. Identify the center of the section, the section lines and the section corners and show the appropriate section, township, and range numbers on the map. In addition the following information must also be shown on the map.
- a. If a change in the location of the point(s) of diversion is proposed, show:
 - 1) The location of the proposed point(s) of diversion. Distances North and West of the Southeast corner of the section must be shown. Please be certain that the information shown on the map agrees with the information shown in Paragraph Nos. 9, 10 and 11 of the application.
 - 2) If the source of supply is groundwater, please show the location of existing water wells of any kind, including domestic wells, within ½ mile of the proposed well or wells. Identify each well as to its use and furnish name and mailing address of the property owner or owners. If there are no wells within ½ mile, please indicate so on the map.
 - 3) If the source of supply is surface water, the names and mailing addresses of all landowner(s) ½ mile downstream and ½ mile upstream from your property lines must be shown.
 - b. If a change in the place of use is desired, show the proposed place of use by crosshatching on the map. Please be certain that the information shown on the map agrees with the information shown in Paragraph No. 5 of the application.
17. Attach documentation to show the change(s) proposed herein will not impair existing water rights and relates to the same local source of supply as to which the water right relates. This information may include statements, plats, geology reports, well logs, test hole logs, and other information as necessary information to show the above. Additional comments may be made below.
THE APPLICANT REQUESTS THAT THEY RETAIN THE ORIGINAL 162 AF FOR IRRIGATION, BUT WILL LIMIT THE
TOTAL ANNUAL USE TO 144.34 AF DURING THE DURATION OF THE DUAL USE IRRIGATION/STOCKWATERING
PERMIT. SHOULD THE STOCKWATERING USE EVER CEASE, THE APPLICANT WILL REQUEST TO
REVERT BACK TO IRRIGATION FOR THE ORIGINAL QUANTITY
18. If the proposed change(s) does not meet all applicable rules and regulations of the Kansas Water Appropriation Act, please identify the rules and regulations for which you request a waiver. State the reason why a waiver is needed and why the request should be granted. Attach documentation showing that granting the request will not impair existing water rights and will not prejudicially and unreasonably affect the public interest.

N / A

IF MORE SPACE IS NEEDED, ATTACH ADDITIONAL SHEETS AS NECESSARY

WATER RESOURCES RECEIVED

JUN 09 2022 File No. 43060

Any use of water that is not as authorized by the water right or permit to authorize water before the chief engineer approves this application is a violation of the Kansas Water Appropriation Act for which criminal or civil penalties may be assessed. Such violation is a class C misdemeanor, punishable by a fine not to exceed \$500 and/or a term of confinement not to exceed one month in the county jail. K.S.A. 82a-728(b). Civil penalties shall be not less than \$100 nor more than \$1,000 per violation. In the case of a continuing violation, each day such violation continues may be deemed a separate violation. In addition to these penalties the water right may be modified or suspended. K.S.A. 82a-737, as amended.

The application must be signed by all owners of the place of use authorized under the water right and his or her spouse, if married. Please indicate if there is no spouse. If land is being purchased under contract, the seller must sign as landowner until such time as the contract is completed.

In the event that all applicants cannot appear before one notary public, they may as necessary sign separate copies of the application before any notary public conveniently available to them. All copies signed in this manner shall be considered to be valid parts of the application.

If the request is signed on behalf of any Owner by someone with legal authority to do so (for example, an agent, one who has power of attorney, or an executor, executrix, conservator), it will be necessary to attach proper documents showing such authority.

I declare that I am an owner of the currently authorized place of use as identified herein, or that I represent all such owners and am authorized to make this application on their behalf, and declare further that the statements contained herein are true, correct, and complete. By filing this application I authorize the chief engineer to permanently reduce the quantity of water and/or rate of diversion as specified in sections 14 and 15 of this application.

Dated at GRAY CO., Kansas, this 6 day of June, 20 22.

Scott Feldt (Owner)

Scott Skill (Please Print)

(Owner)

(Please Print)

(Owner)

(Please Print)

(Spouse)

(Please Print)

(Spouse)

(Please Print)

(Spouse)

(Please Print)

State of Kansas }
County of GRAY } SS



I hereby certify that the foregoing application was signed in my presence and sworn to before me this 6th day of June, 20 22.

[Signature] Notary Public

My Commission Expires 10-13-22

FEE SCHEDULE

Each application to change the place of use, the point of diversion or the use made of the water under this section shall be accompanied by the application fee set forth in the schedule below:

Table with 2 columns: Description of application change and Fee amount. Includes items like 'Application to change a point of diversion 300 feet or less' for \$100.

Make check payable to Kansas Department of Agriculture.

CHANGE IN PU & UMW WATER RIGHT, FILE NOS. 41554 & 43060

Section 24 Township 32 South Range 37 West Stevens County

WATER RESOURCES RECEIVED
JUN 09 2022

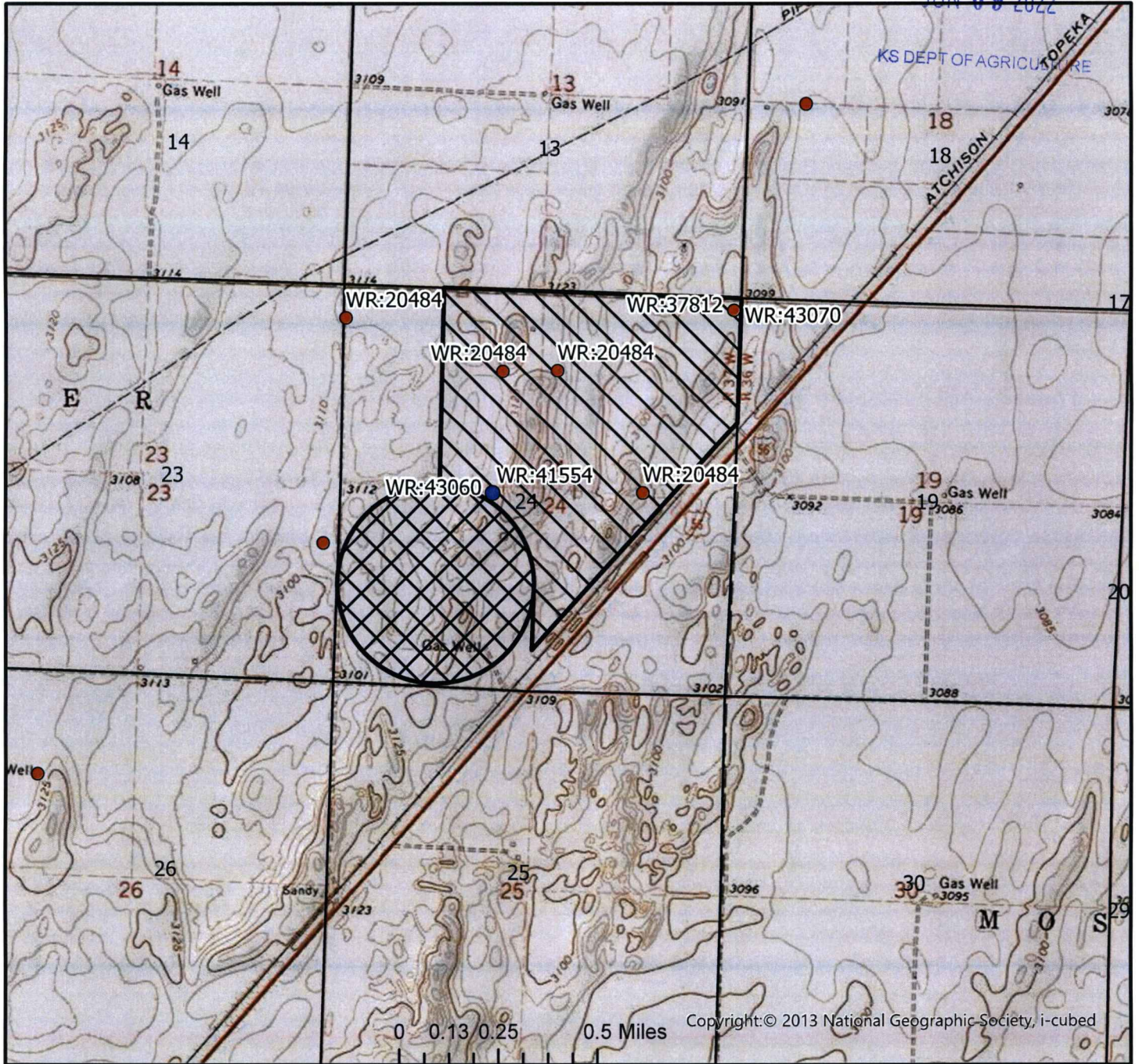

	Authorized Point of Diversion
	Permitted Water Right
	Domestic Well within 1/2 mile
	Authorized Place of Use
	Proposed Place of Use

List of owner name and addresses within 1/2 mile:



By signing below I agree that all wells, including domestic, and owners names and addresses within 1/2 mile of the proposed point of diversion have been shown on the map

(Signature)

Date

AM/GCFO
1:24,000 Scale