

Kansas Department of Agriculture
Division of Water Resources
CHANGE: P/U WORKSHEET

1. File Number: 16803	2. Status Change Date:	3. Change Num: C2	4. Field Office: 4	5. GMD: 3
6. Status: <input checked="" type="checkbox"/> Approved <input type="checkbox"/> Denied by DWR/GMD <input type="checkbox"/> Dismiss by Request/Failure to Return				7. Filing Date of Change: 3/31/2023
8a. Applicant(s) New to system <input type="checkbox"/> HEMINK FARMS LTD 2635 CR 521 HART, TX 79043		Person ID <u>64577</u> Add Seq# <u>01</u>		
8b. Landowner(s) New to system <input type="checkbox"/> 8a		Person ID _____ Add Seq# _____		
		8c. Landowner(s) New to system <input type="checkbox"/> ARCH B & MICHELLE FRINK PO BOX 1088 CIMARRON, KS 67835-1088		
		Person ID <u>41940</u> Add Seq# _____		
8d. WUC New to system <input type="checkbox"/>				
9. Documents and Enclosure(s): <input checked="" type="checkbox"/> DWR Meter(s) Date to Comply: <u>12/31/2023</u> <input checked="" type="checkbox"/> N & P Date to Comply: <u>3/1/2024</u> <input type="checkbox"/> Anti-Reverse Meter <input type="checkbox"/> Meter Seal <input type="checkbox"/> Check Valve <input type="checkbox"/> N & P Form <input type="checkbox"/> Water Tube <input type="checkbox"/> Driller Copy <input type="checkbox"/> H & E Letter <input type="checkbox"/> Conservation Plan Date Required: _____ Date Approved: _____ Date to Comply: _____				
10. Use Made of Water From: _____ To: _____				
Date Prepared: 4/6/2023 By: AM Date Entered: _____ By: _____				

File No. **16803** 11. County: **GY** Basin: **BUCKNER CREEK** Stream: Formation Code: Special Use:

12. Points of Diversion Rate and Quantity
 CHK MOD DEL PDIV Qualifier S T R ID 'N 'W Comment (AKA Line) Authorized Additional
 ENT Rate Quantity Rate Quantity
 gpm/cfs af/mgy gpm/cfs af/mgy Overlap PD Files

CHK	7001																			

13. Storage: Rate _____ NF Quantity _____ ac/ft Additional Rate _____ NF Additional Quantity _____ ac/ft

14. Limitation: _____ af/yr at _____ gpm (_____ cfs) when combined with file number(s) _____
 Limitation: _____ af/yr at _____ gpm (_____ cfs) when combined with file number(s) _____

15. 5YR Allocation: Allocation Type _____ Start Year _____ 5 YR Amount _____ Amount Unit _____ Base Acres _____ Comment _____

16. Place of Use CHK MOD DEL ENT	PUSE	S	T	R	ID	NE¼				NW¼				SW¼				SE¼				Total	Owner	Chg?	Overlap Files
						NE ¼	NW ¼	SW ¼	SE ¼	NE ¼	NW ¼	SW ¼	SE ¼	NE ¼	NW ¼	SW ¼	SE ¼	NE ¼	NW ¼	SW ¼	SE ¼				
MOD	1715	24	24S	28W	2					31.25	31.25	31.25	31.25	31.25	31.25	31.25	31.25					250	7a	N	MULTIPLE
MOD	26526	25	24S	28W	1	31.25	31.25	31.25	31.25	25	25	25	25	31.25	31.25	31.25	31.25	31.25	31.25	31.25	31.25	475	7a	N	MULTIPLE
MOD	33049	31	24S	27W	1					31.25	31.25	31.25	31.25	31.25	31.25	31.25	31.25					125	7a	N	MULTIPLE
ENT		30	24S	27W										31.25	31.25	31.25	31.25					250	7a	N	MULTIPLE

Base Acres: Year: Minimum Reasonable Quantity:
 Comments: **OVERLAPPING WR ON PLACE OF USE: 12315; 12456; 13865; 16803; 21819; 21820 & 23295;**

Garden City Field Office
4532 W. Jones, Suite B
Garden City, KS 67846



Phone: 620-276-2901
Fax: 620-276-9315
www.agriculture.ks.gov

Mike Beam, Secretary

Laura Kelly, Governor

April 6, 2023

HEMINK FARMS LTD
2635 CR 521
HART, TX 79043

RE: Filed Office Application for Change
Water Right, File Nos. 12,315; 12,456; 13,865; 16,803; 21,819; 21,820 & 23,295

Dear Sir or Madam:

Enclosed is the order executed by the designee of the Chief Engineer, Division of Water Resources, Kansas Department of Agriculture, approving the application for change under the above referenced file numbers. **Note:** this approval does not allow any single point of diversion to exceed its annual authorized quantity.

Your attention is directed to the enclosures and to the terms, conditions, and limitations specified in this approval for change. A condition of this approval is that an acceptable water flow meter must be installed on the diversion works authorized under the referenced file number and meet current specifications. Please return the required notification of completion of the diversion works and/or installation of the required meter as soon as these actions are completed.

Since the order modifies the original document referred to above, it should be recorded with the Register of Deeds as other instruments affecting real estate.

Should you have any questions, please feel free contact this office. If you would prefer, you could arrange an appointment for additional assistance.

Sincerely,

A handwritten signature in blue ink that reads "Austin J. McColloch".

Austin J. McColloch
Assistant Water Commissioner

AM:
enclosures

pc: GMD 3

CERTIFICATE OF SERVICE

On this 6th day of April, 2023, I hereby certify that the foregoing Approval of Application for Change in Place of Use, Water Right, File Nos. 12,315, 12,456, 13,865, 16,803, 21,819, 21,820 and 23,295 dated 6th day of April, 2023 was mailed postage prepaid, first class, US mail to the following:

HEMINK FARMS LTD
2635 CR 521
HART, TX 79043

Pc:

GMD 3



Division of Water Resources Staff

Submit completed application to:
 Kansas Department of Agriculture
 Division of Water Resources
 Field Office for your area.

Call for address:

Topeka -- (785) 296-5733
 Stafford -- (620) 234-5311
 Stockton -- (785) 425-6787
 Garden City -- (620) 276-2901
<http://agriculture.ks.gov/dwr>

DWR FIELD OFFICE APPLICATION FOR APPROVAL TO CHANGE THE PLACE OF USE AND/OR THE POINT OF DIVERSION



STATE OF KANSAS

Filing Fee Must Accompany the Application, K.S.A. 82a-708b(b), as amended.
 Fee Schedule is on the third page of this application form.

Paragraph Nos. 1, 2, 3 & 5 must be completed. Complete all other applicable portions. If change in point of diversion is greater than 100 feet, or if place of use will be changed, include a topographic map or detailed plat showing the authorized and proposed point(s) of diversion and/or place of use.

File No. 16803

RECEIVED
 10:33 am
 MAR 31 2023

1. Application is hereby made for approval of the Chief Engineer to change the (check one or both):

Place of Use Point of Diversion

Garden City Field Office
 Division of Water Resources

under the water right which is the subject of this application in accordance with the conditions described below.

The source of supply is: Groundwater Surface water

2. Name and address of Applicant: ARCH B & MICHELLE FRINK

PO BOX 1088, CIMARRON, KS 67835-1088

Phone Number: (620)338-3514 Email address: afrink14@hotmail.com

Name and address of Water Use Correspondent: SAME AS ABOVE

SAME AS ABOVE

Phone Number: () Email address: _____

3. The presently authorized place of use is:

Owner of Land ---- NAME: HEMINK FARMS LTD

ADDRESS: 2635 CR 521 HART, TEXAS 79043

(If there is more than one landowner, attach supplemental sheets as necessary.)

Sec.	Twp.	Range	NE¼				NW¼				SW¼				SE¼				TOTAL ACRES
			NE¼	NW¼	SW¼	SE¼	NE¼	NW¼	SW¼	SE¼	NE¼	NW¼	SW¼	SE¼	NE¼	NW¼	SW¼	SE¼	
24	24	28					31	31	31	31	31	31	31	31					248
25	24	28	31	31	31	31	25	25	25	25	36.76	38.50	38.50	40	40	40	40	40	537.76
31	24	27					40	L-1 38.14	L-2 38.42	40	40	L-3 38.70	L-4 38.98	40					314.24

4. If this application is for a change in place of use, it is proposed that the place of use be changed to:

Owner of Land ---- NAME: Same as Above

ADDRESS: Same as Above

(If there is more than one landowner, attach supplemental sheets as necessary.)

Sec.	Twp.	Range	NE¼				NW¼				SW¼				SE¼				TOTAL ACRES
			NE¼	NW¼	SW¼	SE¼	NE¼	NW¼	SW¼	SE¼	NE¼	NW¼	SW¼	SE¼	NE¼	NW¼	SW¼	SE¼	
24	24	28					31.25	31.25	31.25	31.25	31.25	31.25	31.25	31.25					250
25	24	28	31.25	31.25	31.25	31.25	25	25	25	25	31.25	31.25	31.25	31.25	31.25	31.25	31.25	31.25	475
30	24	27									31.25	31.25	31.25	31.25					125

L-3 L-4

For Office Use Only: Code _____ Fee \$ 200.00 TR # _____ Receipt Date 3-31-23 Check # 015353

5. **Presently authorized point of diversion:**
 One in the _____ Quarter of the _____ Quarter of the _____ Quarter
 of Section _____, Township _____ South, Range _____ W,
 in _____ County, Kansas, _____ feet North _____ feet West of Southeast corner of section.
 Authorized Rate _____ Authorized Quantity _____ Depth of well _____ (feet)
(DWR use only: Computer ID No. 1 _____ GPS _____ feet North _____ feet West)
 This point will not be changed This point will be changed as follows: No change, point better described with GPS as follows:
Proposed point of diversion: (Complete only if change is requested or if existing point is better described by GPS)
 One in the _____ Quarter of the _____ Quarter of the _____ Quarter
 of Section _____, Township _____ South, Range _____ W,
 in _____ County, Kansas, _____ feet North _____ feet West of Southeast corner of section.
 Proposed Rate _____ Proposed Quantity _____ Proposed well depth (feet) _____
 This point is: Additional Well Geo Center List other water rights that will use this point _____

6. **Presently authorized point of diversion:**
 One in the _____ Quarter of the _____ Quarter of the _____ Quarter
 of Section _____, Township _____ South, Range _____ W,
 in _____ County, Kansas, _____ feet North _____ feet West of Southeast corner of section.
 Authorized Rate _____ Authorized Quantity _____ Depth of well _____ (feet)
(DWR use only: Computer ID No. _____ GPS _____ feet North _____ feet West)
 This point will not be changed This point will be changed as follows: No change, point better described with GPS as follows:
Proposed point of diversion: (Complete only if change is requested or if existing point is better described by GPS)
 One in the _____ Quarter of the _____ Quarter of the _____ Quarter
 of Section _____, Township _____ South, Range _____ W,
 in _____ County, Kansas, _____ feet North _____ feet West of Southeast corner of section.
 Proposed Rate _____ Proposed Quantity _____ Proposed well depth (feet) _____
 This point is: Additional Well Geo Center List other water rights that will use this point _____

7. The changes herein are desired for the following reasons?
 (please be specific) _____

8. If a well, is the test hole log attached? Yes No

9. The change(s) (was)(will be) completed by?
Open Approval

10. If the point of diversion is a well:
 (a) What are you going to do with the old well?
—
 (b) When will this be done? —

11. Groundwater Management District recommendation attached?
 Yes No

12. Assisted by JG/GCFO _____

13a. If the proposed point of diversion will be relocated more than 300 feet but within 2,640 feet of the existing point of diversion, attach a topographic map or aerial photograph. For groundwater sources, show all wells (including domestic) within one-half mile of the proposed point of diversion and the names and mailing addresses of the owners. For surface water sources, show the names and addresses of the landowner(s) one-half mile downstream and one-half mile upstream from your property lines

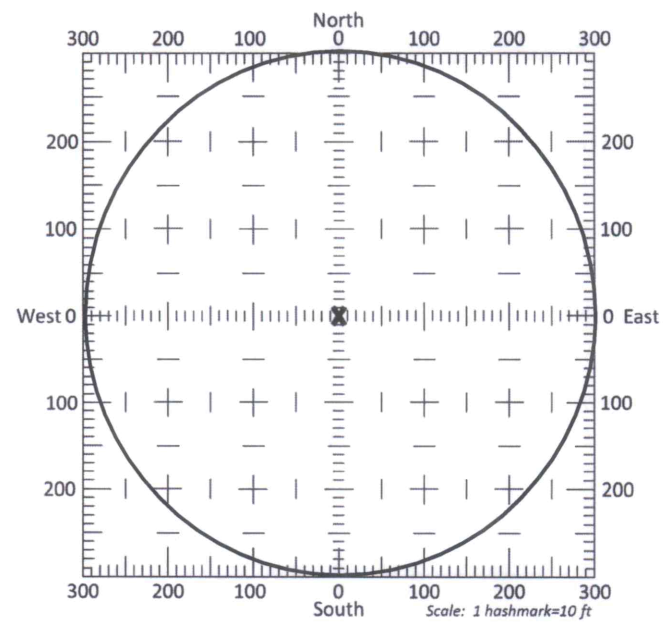

13b. If the proposed point of diversion will be relocated within a 300 foot radius of the existing point of diversion, indicate its location on the diagram shown above in relation to the existing point of diversion. The proposed point of diversion must be located within the circle shown above. **(PLEASE NOTE: The "X" in center of diagram above represents the presently authorized point of diversion.)**

APPLICATION FOR APPROVAL TO CHANGE
THE PLACE OF USE AND/OR POINT OF DIVERSION
SUPPLEMENTAL SHEET
FILE NO. 16803
MAKE ADDITIONAL COPIES AS NECESSARY

3. *Continued:* The presently authorized place of use is:

Owner of Land ---- NAME: _____
ADDRESS: _____

Sec.	Twp.	Range	NE¼				NW¼				SW¼				SE¼				TOTAL ACRES		
			NE¼	NW¼	SW¼	SE¼	NE¼	NW¼	SW¼	SE¼	NE¼	NW¼	SW¼	SE¼	NE¼	NW¼	SW¼	SE¼			

Owner of Land ---- NAME: _____
ADDRESS: _____

Sec.	Twp.	Range	NE¼				NW¼				SW¼				SE¼				TOTAL ACRES			
			NE¼	NW¼	SW¼	SE¼	NE¼	NW¼	SW¼	SE¼	NE¼	NW¼	SW¼	SE¼	NE¼	NW¼	SW¼	SE¼				

Owner of Land ---- NAME: _____
ADDRESS: _____

Sec.	Twp.	Range	NE¼				NW¼				SW¼				SE¼				TOTAL ACRES				
			NE¼	NW¼	SW¼	SE¼	NE¼	NW¼	SW¼	SE¼	NE¼	NW¼	SW¼	SE¼	NE¼	NW¼	SW¼	SE¼					

4. *Continued:* If this application is for a change in place of use, it is proposed that the place of use be changed to:

Owner of Land ---- NAME: HEMINK FARMS LTD
ADDRESS: 2635 CR 521 HART, TEXAS 79043

Sec.	Twp.	Range	NE¼				NW¼				SW¼				SE¼				TOTAL ACRES
			NE¼	NW¼	SW¼	SE¼	NE¼	NW¼	SW¼	SE¼	NE¼	NW¼	SW¼	SE¼	NE¼	NW¼	SW¼	SE¼	
31	24	27					31.25	31.25	31.25	31.25	31.25	31.25	31.25	31.25					250

Owner of Land ---- NAME: _____
ADDRESS: _____

Sec.	Twp.	Range	NE¼				NW¼				SW¼				SE¼				TOTAL ACRES				
			NE¼	NW¼	SW¼	SE¼	NE¼	NW¼	SW¼	SE¼	NE¼	NW¼	SW¼	SE¼	NE¼	NW¼	SW¼	SE¼					

Owner of Land ---- NAME: _____
ADDRESS: _____

Sec.	Twp.	Range	NE¼				NW¼				SW¼				SE¼				TOTAL ACRES					
			NE¼	NW¼	SW¼	SE¼	NE¼	NW¼	SW¼	SE¼	NE¼	NW¼	SW¼	SE¼	NE¼	NW¼	SW¼	SE¼						

14. If the proposed groundwater point of diversion is 300 or fewer feet from the existing point of diversion, complete the following:
- (a) Does the undersigned represent all owners of the currently authorized place(s) of use identified in this application?
 Yes No (If no, all owners must sign this application.)
 - (b) Will the ownership interest of any owner of the currently authorized place(s) of use identified in this application be adversely affected if this application is approved as requested?
 Yes No (If yes, all owners must sign this application.)
 - (c) If this application is not approved expeditiously, will there be substantial damage to property, public health or safety?
 Yes No (If no, all owners must sign this application.)

If the application proposes a surface water change in point of diversion, a groundwater change in point of diversion greater than 300 feet, or a change in place of use, the application must be signed by all owners of the currently authorized place of use, or their duly authorized agent (attach notarized statement authorizing representation).

I hereby verify, being first duly sworn upon my oath or affirmation and under penalty of perjury, that I am of lawful age and the owner, the spouse of the owner, or a duly authorized agent of the owner(s) to make this application on their behalf, in regards to the water right(s) to which this application pertains. I further verify that the statements contained in this application are true, correct and complete.

Dated at Amarillo, ^{Texas}~~Kansas~~, this 22 day of March, 2023.

<u>L. Schilderink</u> (Owner)	_____ (Spouse)
<u>LAURENS SCHILDERINK</u> (Please Print)	_____ (Please Print)
_____ (Owner)	_____ (Spouse)
_____ (Please Print)	_____ (Please Print)
_____ (Owner)	_____ (Spouse)
_____ (Please Print)	_____ (Please Print)

State of ^{Texas}~~Kansas~~ }
 County of Randall } SS

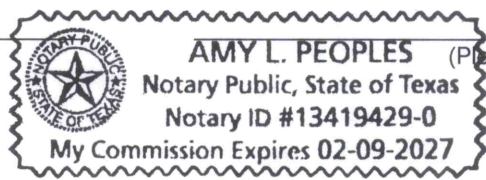

I hereby certify that the foregoing application was signed in my presence and sworn to before me this 22 day of March, 2023.

Amy L Peoples
Notary Public

My Commission Expires 2/9/2027.

ONLY COMPLETE APPLICATIONS WILL BE PROCESSED. To be complete, all of the applicable portions of the application form must be completed with accurate information; maps, if necessary, must be included; signatures of all the appropriate owners' must be affixed to the application and notarized; and the appropriate fee must be paid.

FEE SCHEDULE

Each application to change the place of use or the point of diversion under this section shall be accompanied by the application fee set forth in the schedule below: Make checks payable to: **Kansas Department of Agriculture**

(1) Application to change a point of diversion 300 feet or less	\$100
(2) Application to change a point of diversion more than 300 feet	\$200
(3) Application to change the place of use	\$200





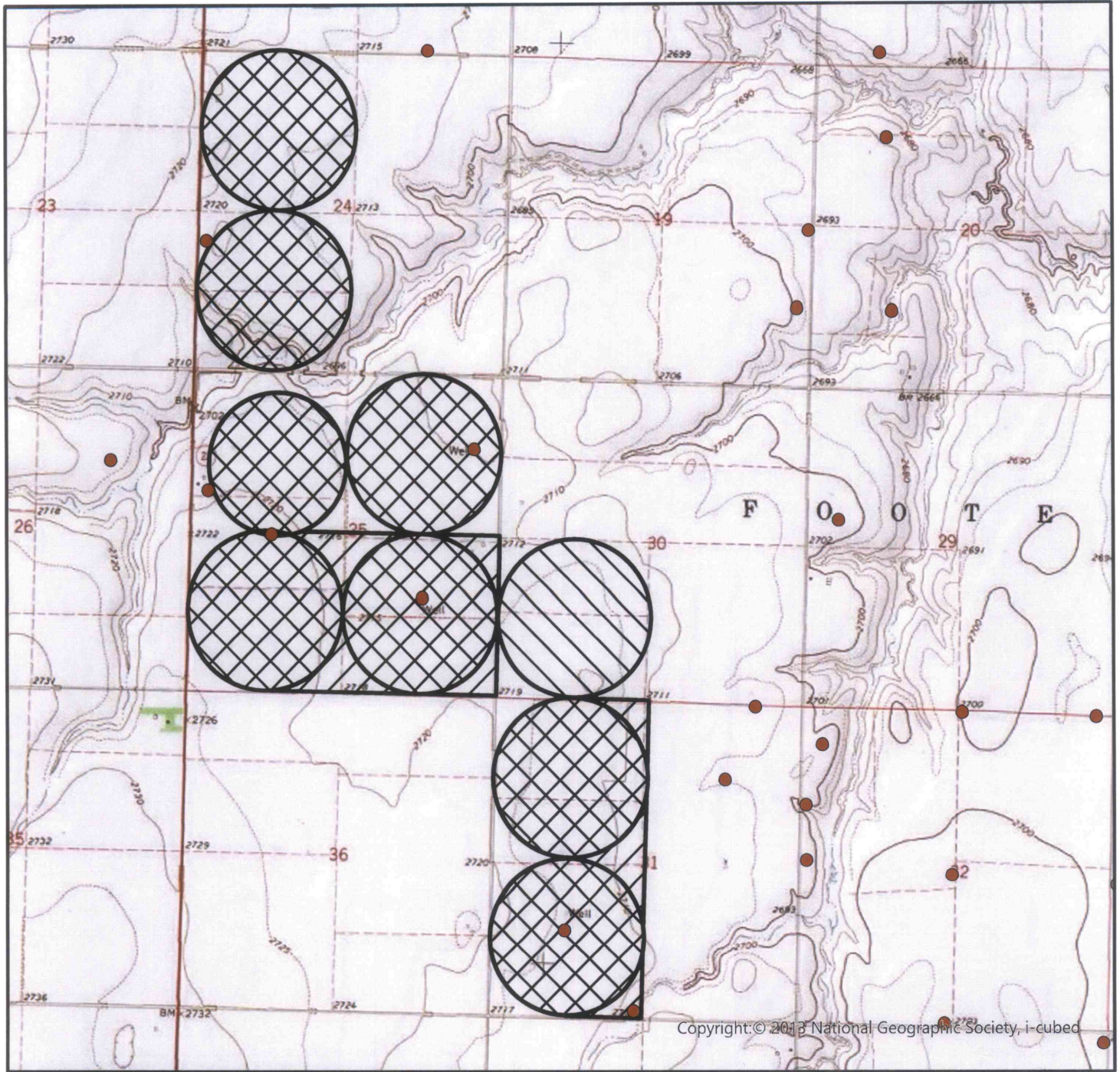

CHANGE IN PLACE OF USE WATER RIGHT

FILE NOS. 12315; 12456; 16803; 21819; 21820 & 23295



Copyright © 2013 National Geographic Society, i-cubed

Township 24 South Range 27 West Gray County

	Authorized Point of Diversion
	Permitted Water Right
	Domestic Well within 1/2 mile
	Authorized Place of Use
	Proposed Place of Use
	Authorized STK Place of Use



Date AM/GCFO
1:24,000 Scale

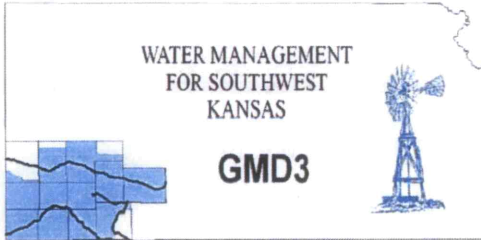

**Southwest Kansas
Groundwater Management District No. 3**
2009 E. Spruce Street
Garden City, Kansas 67846
(620) 275-7147 phone
www.gmd3.org

April 5, 2023

RECEIVED

APR 05 2023

**Garden City Field Office
Division of Water Resources**

Austin McColloch
Division of Water Resources
4532 W Jones Ave., Suite B
Garden City, Kansas 67846

RE: Applications for Change in Place of Use
Water Right, File Nos. 12315, 12456, 13865, 16803, 21819, 21820 & 23295

Dear Austin:

We have reviewed the applications for the above referenced water rights. The proposals are not in conflict with the Management Program of the Southwest Kansas Groundwater Management District No. 3 (GMD3). The proposed change in place of use will make a complete overlap in authorized place of use while rearranging acres to better suit the operation. In accordance with K.A.R. 5-5-11(b), the proposed acres are within the allowance of the base acres for the water rights. It is therefore recommended that the applications be approved at this time.

Thank you for the opportunity to review the applications and to provide a recommendation. If you have any questions, please don't hesitate to contact us.

Sincerely,

Jason L. Norquest
Assistant Manager

GMD3 Change Review

File No(s): 12315, 12456, 13865, 16803, 21819, 21820, 23295. DWR office: GC.

App filed to change: PU.

Is Landowner(s) correct in WRIS: Arch & Michelle Frink.

If NO, is documentation included?

Is Water Use Correspondent correct in WRIS? .

If NO, is documentation included?

Regulation(s) Reviewed: KAR 5-5-11

Point of diversion ID No(s) being changed.

	ft. North	ft. West	
Authorized PD			
Proposed PD			
Difference	0	0	
a2 + b2 = c2	0	0	0

GPS for proposed PD: Lat: Long: .

Is proposed PD stacking on existing WRs? No Change.

Is Proposed PU overlapping existing WRs? Maintaining a complete overlap while bringing in new acres for the operation.

Neighboring certified well(s) notified: .

Name .

Address .

Zip .

Email: . Phone: .

Domestic well(s) notified: .

Name .

Address .

Zip .

Base Acres: 1100 acres, same as confirmed with 2022 applications.

Perfected Acres: .

Irr. Return-Flow %

12315: 320AF @ 700gpm

248 acres W2 24-24-28

537.76 acres 25-24-28

314.24 acres W2 31-24-27

Total current acres = 1100

12456: 319AF @ 700gpm

Same current acres

13865: ID02 120AF @ 400gpm ID05 120AF @ 265gpm

Limited to 214.32AF for dual use STK/IRR. Not changing STK area.

Same current acres

GMD3 Change Review

16803: 320AF @ 650gpm

Same current acres

21819: 186AF @ 350gpm

Same current acres

21820: 268AF @ 1085gpm

Same current acres

23295: 75AF @ 1085 gpm. Limited to 1085gpm w/21280

Same current acres

Proposed acres:

250 acres W2 24-24-28

475 acres 25-24-28

125 acres SW 30-24-27

250 acres W2 31-24-27

Total = 1100 acres

Is a waiver needed: No, staying within the base acres range as allowed by the rules.

Recommendation: after review of all information, current area rules appear met. Staff recommends approval of the applications.



Garden City Field Office
4532 W. Jones, Suite B
Garden City, KS 67846



Phone: 620-276-2901
Fax: 620-276-9315
www.agriculture.ks.gov

Mike Beam, Secretary

Laura Kelly, Governor

April 4, 2023

GROUNDWATER MANAGEMENT DISTRICT #3
2009 E SPRUCE ST
GARDEN CITY KS 67846

Re: Request for Recommendation,
File Nos. 12315; 12456; 13865; 16803; 21819; 21820 & 23295

Dear Sir or Madam:

We are enclosing a copy of the referenced application, which was submitted by Arch Frink and appears to be in proper form, for your review.

We are delaying any further action for a period of 15 days from the date of this letter to allow you time to submit your recommendation concerning this application. Please submit your recommendation within the allotted time, or any authorized extension of time thereof.

If you have any questions, please contact me at (620) 276-2901. If you wish to discuss a specific file, please have the file number ready to that I may help you more efficiently.

Sincerely,

A handwritten signature in blue ink that reads "Austin McColloch".

Austin McColloch
Assistant Water Commissioner

Enclosure
pc: