

# NOTICE

This scan only represents the application as filed. The information contained herein meets the requirements of K.A.R. 5-3-1 or K.A.R. 5-5-1, and has been found acceptable for filing in the office of the Chief Engineer. The application should not be considered to be a complete application as per K.A.R. 5-3-1b or K.A.R. 5-5-2a.

Submit To: CHIEF ENGINEER  
Division of Water Resources  
Kansas Department of Agriculture  
1320 Research Park Drive  
Manhattan, Kansas 66502  
http://agriculture.ks.gov/dwr

**APPLICATION FOR APPROVAL TO  
CHANGE THE PLACE OF USE, THE  
POINT OF DIVERSION OR THE USE  
MADE OF THE WATER UNDER AN  
EXISTING WATER RIGHT**



State of Kansas

**Filing Fee Must Accompany the Application**  
(Please refer to Fee Schedule on signature page of application form.)

Paragraph Nos. 1, 2, 3, 4 & 8 must be completed. Complete all other applicable portions. A topographic map or detailed plat showing the authorized and proposed points(s) of diversion and /or place of use must accompany this application.

1. Application is hereby made for approval of the Chief Engineer to change the

- Place of Use  
 Point of Diversion  
 Use Made of Water

(Check one or more)

**RECEIVED**

3:02 PM  
APR 20 2023

Garden City Field Office  
Division of Water Resources

File No. 18123

2. Name of applicant: HRC FEED YARDS LLC

Address: PO BOX 224

City, State and Zip: SCOTT CITY KS 67871

Phone Number: (620)872-5328 E-mail address: \_\_\_\_\_

What is your relationship to the water right;  owner  tenant  agent  other? If other, please explain. \_\_\_\_\_

Name of water use correspondent: NO CHANGE SAME

Address: \_\_\_\_\_

City, State and Zip: \_\_\_\_\_

Phone Number: ( ) \_\_\_\_\_ E-mail address: \_\_\_\_\_

3. The change(s) proposed herein are desired for the following reasons (please be specific): \_\_\_\_\_

TO RELOCATE A WELL FOR A LOCATION THAT ACTUALLY HAS BENEFICIAL WATER

The change(s) (was) (will be) completed by 2023

(Date)

**For Office Use Only:**

F.O. GMD Meets K.A.R. 5-5-1 (YES / NO) Use \_\_\_\_\_ Source G / S County \_\_\_\_\_ By \_\_\_\_\_ Date \_\_\_\_\_  
Code \_\_\_\_\_ Fee \$ 200.00 TR # \_\_\_\_\_ Receipt Date 4-20-23 Check # 60876

4. The presently authorized place of use is:

Owner of Land — NAME: HRC FEED YARDS LLC

ADDRESS: \_\_\_\_\_

Sec.	Twp.	Range	NE¼				NW¼				SW¼				SE¼				TOTAL ACRES
			NE¼	NW¼	SW¼	SE¼	NE¼	NW¼	SW¼	SE¼	NE¼	NW¼	SW¼	SE¼	NE¼	NW¼	SW¼	SE¼	
24	17	32W	feed	lot	locate	in	NW	&	N2SW										

List any other water rights that cover this place of use. 6974, 8716.05, 15772, 17125.05, 32665, 36173, 38388.

Owner of Land — NAME: \_\_\_\_\_

ADDRESS: \_\_\_\_\_

Sec.	Twp.	Range	NE¼				NW¼				SW¼				SE¼				TOTAL ACRES
			NE¼	NW¼	SW¼	SE¼	NE¼	NW¼	SW¼	SE¼	NE¼	NW¼	SW¼	SE¼	NE¼	NW¼	SW¼	SE¼	

List any other water rights that cover this place of use. \_\_\_\_\_

(If there are more than two landowners, attach additional sheets as necessary.)

5. It is proposed that the place of use be changed to:

Owner of Land — NAME: NO CHANGE

ADDRESS: \_\_\_\_\_

Sec.	Twp.	Range	NE¼				NW¼				SW¼				SE¼				TOTAL ACRES
			NE¼	NW¼	SW¼	SE¼	NE¼	NW¼	SW¼	SE¼	NE¼	NW¼	SW¼	SE¼	NE¼	NW¼	SW¼	SE¼	

List any other water rights that cover this place of use. \_\_\_\_\_

Owner of Land — NAME: \_\_\_\_\_

ADDRESS: \_\_\_\_\_

Sec.	Twp.	Range	NE¼				NW¼				SW¼				SE¼				TOTAL ACRES
			NE¼	NW¼	SW¼	SE¼	NE¼	NW¼	SW¼	SE¼	NE¼	NW¼	SW¼	SE¼	NE¼	NW¼	SW¼	SE¼	

List any other water rights that cover this place of use. \_\_\_\_\_

6. The presently authorized point(s) of diversion is ONE WELL, PUMP, MOTOR  
(Provide description and number of points)

7. The proposed point(s) of diversion is ONE, WELL PUMP, MOTOR  
(Provide description and number of points)

List all presently authorized point(s) of diversion: **SEE ATTACHCED**

8. **Presently authorized point of diversion:**  
One in the \_\_\_\_\_ Quarter of the \_\_\_\_\_ Quarter of the \_\_\_\_\_ Quarter  
of Section \_\_\_\_\_, Township \_\_\_\_\_ South, Range \_\_\_\_\_ (E/W),  
in \_\_\_\_\_ County, Kansas, \_\_\_\_\_ feet North \_\_\_\_\_ feet West of Southeast corner of section.  
Authorized Rate \_\_\_\_\_ Authorized Quantity \_\_\_\_\_  
**(DWR use only: Computer ID No. \_\_\_\_\_ GPS \_\_\_\_\_ feet North \_\_\_\_\_ feet West)**  
 This point will not be changed  This point will be changed as follows:  
**Proposed point of diversion: (Complete only if change is requested)**  
One in the \_\_\_\_\_ Quarter of the \_\_\_\_\_ Quarter of the \_\_\_\_\_ Quarter  
of Section \_\_\_\_\_, Township \_\_\_\_\_ South, Range \_\_\_\_\_ (E/W),  
in \_\_\_\_\_ County, Kansas, \_\_\_\_\_ feet North \_\_\_\_\_ feet West of Southeast corner of section.  
Proposed Rate \_\_\_\_\_ Proposed Quantity \_\_\_\_\_  
This point is:  Additional Well  Geo Center List other water rights that will use this point \_\_\_\_\_

9. **Presently authorized point of diversion:**  
One in the \_\_\_\_\_ Quarter of the \_\_\_\_\_ Quarter of the \_\_\_\_\_ Quarter  
of Section \_\_\_\_\_, Township \_\_\_\_\_ South, Range \_\_\_\_\_ (E/W),  
in \_\_\_\_\_ County, Kansas, \_\_\_\_\_ feet North \_\_\_\_\_ feet West of Southeast corner of section.  
Authorized Rate \_\_\_\_\_ Authorized Quantity \_\_\_\_\_  
**(DWR use only: Computer ID No. \_\_\_\_\_ GPS \_\_\_\_\_ feet North \_\_\_\_\_ feet West)**  
 This point will not be changed  This point will be changed as follows:  
**Proposed point of diversion: (Complete only if change is requested)**  
One in the \_\_\_\_\_ Quarter of the \_\_\_\_\_ Quarter of the \_\_\_\_\_ Quarter  
of Section \_\_\_\_\_, Township \_\_\_\_\_ South, Range \_\_\_\_\_ (E/W),  
in \_\_\_\_\_ County, Kansas, \_\_\_\_\_ feet North \_\_\_\_\_ feet West of Southeast corner of section.  
Proposed Rate \_\_\_\_\_ Proposed Quantity \_\_\_\_\_  
This point is:  Additional Well  Geo Center List other water rights that will use this point \_\_\_\_\_

10. **Presently authorized point of diversion:**  
One in the \_\_\_\_\_ Quarter of the \_\_\_\_\_ Quarter of the \_\_\_\_\_ Quarter  
of Section \_\_\_\_\_, Township \_\_\_\_\_ South, Range \_\_\_\_\_ (E/W),  
in \_\_\_\_\_ County, Kansas, \_\_\_\_\_ feet North \_\_\_\_\_ feet West of Southeast corner of section.  
Authorized Rate \_\_\_\_\_ Authorized Quantity \_\_\_\_\_  
**(DWR use only: Computer ID No. \_\_\_\_\_ GPS \_\_\_\_\_ feet North \_\_\_\_\_ feet West)**  
 This point will not be changed  This point will be changed as follows:  
**Proposed point of diversion: (Complete only if change is requested)**  
One in the \_\_\_\_\_ Quarter of the \_\_\_\_\_ Quarter of the \_\_\_\_\_ Quarter  
of Section \_\_\_\_\_, Township \_\_\_\_\_ South, Range \_\_\_\_\_ (E/W),  
in \_\_\_\_\_ County, Kansas, \_\_\_\_\_ feet North \_\_\_\_\_ feet West of Southeast corner of section.  
Proposed Rate \_\_\_\_\_ Proposed Quantity \_\_\_\_\_  
This point is:  Additional Well  Geo Center List other water rights that will use this point \_\_\_\_\_

11. Describe the current condition of and future plans for any point(s) of diversion which will no longer be used. \_\_\_\_\_

5. **Presently authorized point of diversion:**

One in the NW Quarter of the NW Quarter of the NE Quarter of Section 23, Township 17 South, Range 32 W, in SCOTT County, Kansas, 5026 feet North 2030 feet West of Southeast corner of section.

Authorized Rate 290 GPM Authorized Quantity 36.83 MGY Depth of well \_\_\_\_\_ (feet)

(DWR use only: Computer ID No. 1 GPS \_\_\_\_\_ feet North \_\_\_\_\_ feet West)

This point will not be changed  This point will be changed as follows:  No change, point better described with GPS as follows:

**Proposed point of diversion: (Complete only if change is requested or if existing point is better described by GPS)**

One in the SW Quarter of the NW Quarter of the NW Quarter of Section 24, Township 17 South, Range 32 W, in SCOTT County, Kansas, 3952 feet North 5292 feet West of Southeast corner of section.

Proposed Rate \_\_\_\_\_ Proposed Quantity \_\_\_\_\_ Proposed well depth (feet) 200

This point is:  Additional Well  Geo Center List other water rights that will use this point \_\_\_\_\_

6. **Presently authorized point of diversion:**

One in the \_\_\_\_\_ Quarter of the \_\_\_\_\_ Quarter of the \_\_\_\_\_ Quarter of Section \_\_\_\_\_, Township \_\_\_\_\_ South, Range \_\_\_\_\_ W, in \_\_\_\_\_ County, Kansas, \_\_\_\_\_ feet North \_\_\_\_\_ feet West of Southeast corner of section.

Authorized Rate \_\_\_\_\_ Authorized Quantity \_\_\_\_\_ Depth of well \_\_\_\_\_ (feet)

(DWR use only: Computer ID No. \_\_\_\_\_ GPS \_\_\_\_\_ feet North \_\_\_\_\_ feet West)

This point will not be changed  This point will be changed as follows:  No change, point better described with GPS as follows:

**Proposed point of diversion: (Complete only if change is requested or if existing point is better described by GPS)**

One in the \_\_\_\_\_ Quarter of the \_\_\_\_\_ Quarter of the \_\_\_\_\_ Quarter of Section \_\_\_\_\_, Township \_\_\_\_\_ South, Range \_\_\_\_\_ W, in \_\_\_\_\_ County, Kansas, \_\_\_\_\_ feet North \_\_\_\_\_ feet West of Southeast corner of section.

Proposed Rate \_\_\_\_\_ Proposed Quantity \_\_\_\_\_ Proposed well depth (feet) \_\_\_\_\_

This point is:  Additional Well  Geo Center List other water rights that will use this point \_\_\_\_\_

7. The changes herein are desired for the following reasons?  
(please be specific) \_\_\_\_\_

8. If a well, is the test hole log attached?  Yes  No

9. The change(s) (was)(will be) completed by?  
\_\_\_\_\_

10. If the point of diversion is a well:  
(a) What are you going to do with the old well?  
\_\_\_\_\_  
(b) When will this be done? \_\_\_\_\_

11. Groundwater Management District recommendation attached?  
 Yes  No

12. Assisted by JG/GCFO

13a. If the proposed point of diversion will be relocated more than 300 feet but within 2,640 feet of the existing point of diversion, attach a topographic map or aerial photograph. For groundwater sources, show all wells (including domestic) within one-half mile of the proposed point of diversion and the names and mailing addresses of the owners. For surface water sources, show the names and addresses of the landowner(s) one-half mile downstream and one-half mile upstream from your property lines

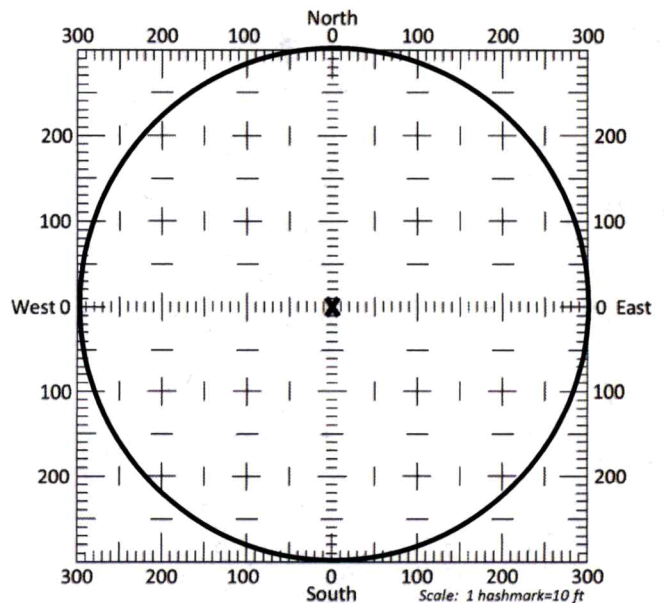

13b. If the proposed point of diversion will be relocated within a 300 foot radius of the existing point of diversion, indicate its location on the diagram shown above in relation to the existing point of diversion. The proposed point of diversion must be located within the circle shown above. (PLEASE NOTE: The "X" in center of diagram above represents the presently authorized point of diversion.)

12. The presently authorized use of water is for STK purposes.

It is proposed that the use be changed to NO CHANG3E purposes.

13. If changing the place of use and/or use made of water, describe how the consumptive use will not be increased.

NA  
\_\_\_\_\_  
\_\_\_\_\_

(Please show any calculations here.)

14. It is requested that the maximum annual quantity of water be reduced to ---- (acre-feet or million gallons).

15. It is requested that the maximum rate of diversion of water be reduced to ---- gallons per minute (\_\_\_\_ c.f.s.).

16. The application must include either a topographic map or detailed plat. A U.S. Geological Survey Topographic Map, scale 1:24,000, is available through the Kansas Geological Survey, 1930 Constant Avenue, University of Kansas, Lawrence, Kansas 66047-3726 ([www.usgs.gov](http://www.usgs.gov)). The map should show the location of the presently authorized point(s) of diversion. Distances North and West of the Southeast corner of the section must be shown. The presently authorized place of use should also be shown. Identify the center of the section, the section lines and the section corners and show the appropriate section, township, and range numbers on the map. In addition the following information must also be shown on the map.

a. If a change in the location of the point(s) of diversion is proposed, show:

- 1) The location of the proposed point(s) of diversion. Distances North and West of the Southeast corner of the section must be shown. Please be certain that the information shown on the map agrees with the information shown in Paragraph Nos. 9, 10 and 11 of the application.
- 2) If the source of supply is groundwater, please show the location of existing water wells of any kind, including domestic wells, within 1/2 mile of the proposed well or wells. Identify each well as to its use and furnish name and mailing address of the property owner or owners. If there are no wells within 1/2 mile, please indicate so on the map.
- 3) If the source of supply is surface water, the names and mailing addresses of all landowner(s) 1/2 mile downstream and 1/2 mile upstream from your property lines must be shown.

b. If a change in the place of use is desired, show the proposed place of use by crosshatching on the map. Please be certain that the information shown on the map agrees with the information shown in Paragraph No. 5 of the application.

17. Attach documentation to show the change(s) proposed herein will not impair existing water rights and relates to the same local source of supply as to which the water right relates. This information may include statements, plats, geology reports, well logs, test hole logs, and other information as necessary information to show the above. Additional comments may be made below.

NO CHANGE IN SOURCE OF SUPPLY

NO CHANGE IN LOCAL SOURCE OF SUPPLY

ONLY NEARBY WELLS ARE OUR WELLS, NO ISSUES WITH IMPAIRMENT

18. If the proposed change(s) does not meet all applicable rules and regulations of the Kansas Water Appropriation Act, please identify the rules and regulations for which you request a waiver. State the reason why a waiver is needed and why the request should be granted. Attach documentation showing that granting the request will not impair existing water rights and will not prejudicially and unreasonably affect the public interest.

REQUEST WAIVER OF KAR 5-21-3, DUE TO OUR OWN WELL, AFTER MULTIPLE TESTHOLES OF TRYING

TO FIND BENEFICAL PRODUCTIVE WATER, OUR REQUEST IS FOR THE PROPOSED LOCATION

MOVING FURTHER AWAY FROM NON OWNED WELLS.

14. If the proposed groundwater point of diversion is 300 or fewer feet from the existing point of diversion, complete the following:

- (a) Does the undersigned represent all owners of the currently authorized place(s) of use identified in this application?  
 Yes     No    (If no, all owners must sign this application.)
- (b) Will the ownership interest of any owner of the currently authorized place(s) of use identified in this application be adversely affected if this application is approved as requested?  
 Yes     No    (If yes, all owners must sign this application.)
- (c) If this application is not approved expeditiously, will there be substantial damage to property, public health or safety?  
 Yes     No    (If no, all owners must sign this application.)

If the application proposes a surface water change in point of diversion, a groundwater change in point of diversion greater than 300 feet, or a change in place of use, the application must be signed by all owners of the currently authorized place of use, or their duly authorized agent (attach notarized statement authorizing representation).

I hereby verify, being first duly sworn upon my oath or affirmation and under penalty of perjury, that I am of lawful age and the owner, the spouse of the owner, or a duly authorized agent of the owner(s) to make this application on their behalf, in regards to the water right(s) to which this application pertains. I further verify that the statements contained in this application are true, correct and complete.

Dated at Scott City, Kansas, this 20 day of April, 2023.

<u>Lee Mayo</u>	
(Owner)	(Spouse)
<u>Lee MAYO</u>	
(Please Print)	(Please Print)
(Owner)	(Spouse)
(Please Print)	(Please Print)
(Owner)	(Spouse)
(Please Print)	(Please Print)

State of Kansas }  
County of Scott } SS

I hereby certify that the foregoing application was signed in my presence and sworn to before me this 20<sup>th</sup> day of April, 2023.

 LOUISE J. BERNING  
 Notary Public - State of Kansas  
 My Appt. Expires February 4, 2024

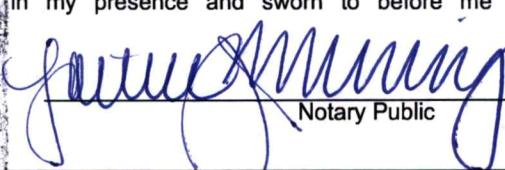
  
 Notary Public

My Commission Expires \_\_\_\_\_

**ONLY COMPLETE APPLICATIONS WILL BE PROCESSED.** To be complete, all of the applicable portions of the application form must be completed with accurate information; maps, if necessary, must be included; signatures of all the appropriate owners' must be affixed to the application and notarized; and the appropriate fee must be paid.

**FEE SCHEDULE**

Each application to change the place of use or the point of diversion under this section shall be accompanied by the application fee set forth in the schedule below: Make checks payable to: **Kansas Department of Agriculture**

- (1) Application to change a point of diversion 300 feet or less ..... \$100
- (2) Application to change a point of diversion more than 300 feet ..... \$200
- (3) Application to change the place of use ..... \$200

# CHANGE IN PLACE OF DIVERSION WATER RIGHT, FILE NO. 18123

NE 1/4 of Section 23 Township 17 South Range 32 West SCOTT County

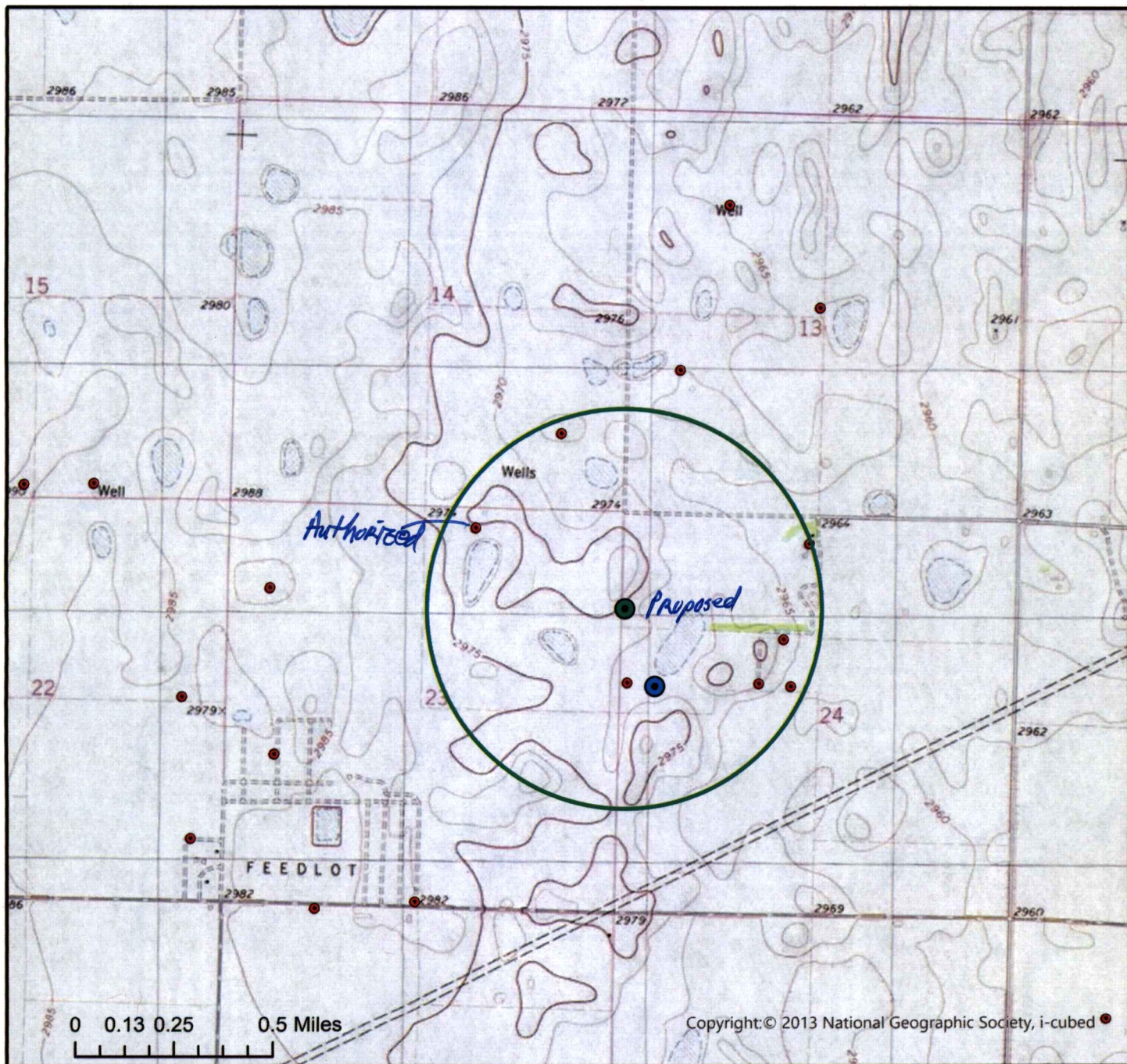

- Authorized Point of Diversion
- Proposed Point of Diversion
- Domestic Well within 1/2 mile
- ▣ 1/2 mile buffer

List of owner name and addresses within 1/2 mile:



All wells of any kind within 1/2 mile of the requested place of use have been plotted.

*[Handwritten Signature]*

Date

Date JG/GCFO  
1:24,000 Scale



# WELL LOG

DATE: 3/30/2023

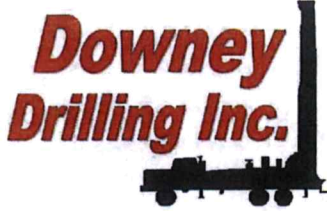

CUSTOMER NAME: HRC FEEDYARD INC.

LEGAL: NW 24-17S-32W

COUNTY: SCOTT COUNTY

GPS: 38.566441

100.815198

DRILLER: RYAN DOWNEY

WO: 22-1588

TW	FROM	TO	TYPE	HARDNESS	COLOR	SPEED	PULL DOWN	OTHER / DRILLING ACTION
	0	2	TOP SOIL	SOFT	DARK	FAST	NO	SMOOTH
	2	35	SILTY SANDY CLAY	SOFT	LIGHT BROWN	FAST	NO	SMOOTH
	35	40	CEMENTED SAND / SS	FIRM	BROWN / WHITE	SLOW	YES	CHOPPY @ TIMES
	40	61	FINE-MED SAND / SS / CLAY	FIRM	BROWN	SLOW	NO	SMOOTH
X	61	79	COARSE-SAND / FINE-GRAVEL	SOFT	BROWN / RED	FAST	NO	CHATTER
	79	87	CEMENTED SAND / SS	FIRM	BROWN / WHITE	SLOW	NO	CHOPPY @ TIMES
X	87	94	SS / FINE-SAND / CEMENTED SAND	SOFT	BROWN / WHITE	FAST	NO	SLIGHT VIBRATION
X	94	99	FINE GRAVEL / COARSE-SAND	SOFT	BROWN / RED	FAST	NO	CHATTER
X	99	120	FINE-MED SAND / CEMENTED SAND / SS	FIRM	BROWN / RED	SLOW	AT TIMES	CHOPPY
	120	135	FINE-MED SAND / SILT LAYERS	SOFT	BROWN	FAST	NO	SLIGHT VIBRATION
X	135	154	FINE-MED SAND / T-COARSE SAND	SOFT	BROWN	FAST	NO	CHATTER
X	154	171	FINE-MED-COARSE SAND	SOFT	BROWN	FAST	NO	CHATTER
	171	189	CLAY	SOFT	REDDISH	SLOW	NO	SMOOTH
	189	195	OCHER	FIRM	ORANGE	SLOW	NO	SMOOTH
	195	200	SHALE	FIRM	GRAY	SLOW	NO	SMOOTH
			WATER - 2000 GALLONS					
			QG - 2 BAGS					
			HOLE PLUG - 2 BAGS					

*STATIC 129'*

*+2'-0'    } PLAIN CASING  
0'-135'    }  
135'-175'    SCREEN  
175'-195'    } PLAIN CASING*

**1 LOCATION OF WATER WELL:** County: SCOTT Fracti: SW 1/4 SW 1/4 NW 1/4 Section Number: 94 Township Number: T 17 S Range Number: R 52 E

Distance and direction from nearest town or city street address of well if located within city?  
5 miles East 5 1/2 miles North of Scott City, Kansas 38300

**2 WATER WELL OWNER:** Griffith Cattle Co. Board of Agriculture, Division of Water Resources  
 RR#, St. Address, Box #: 307 Alice Application Number: 38388  
 City, State, ZIP Code: Scott City, Kansas 67871

**3 LOCATE WELL'S LOCATION WITH AN "X" IN SECTION BOX:**

1 Mile

**4 DEPTH OF COMPLETED WELL:** 180 ft. ELEVATION: .....

Depth(s) Groundwater Encountered 1. 123 ft. 2. .... ft. 3. .... ft.

WELL'S STATIC WATER LEVEL 123 ft. below land surface measured on 6/11/87

NA Pump test data: Well water was ..... ft. after ..... hours pumping ..... gpm  
 Est. Yield ..... gpm: Well water was ..... ft. after ..... hours pumping ..... gpm

Bore Hole Diameter: 9 in. to 180 ft., and ..... in. to ..... ft.

WELL WATER TO BE USED AS:

5 Public water supply	8 Air conditioning	11 Injection well
1 Domestic	<u>3 Feedlot</u>	6 Oil field water supply
2 Irrigation	4 Industrial	7 Lawn and garden only
		10 Observation well

Was a chemical/bacteriological sample submitted to Department? Yes.....No X.....; If yes, mo/day/yr sample was submitted Water Well Disinfected? Yes X No

**5 TYPE OF BLANK CASING USED:**

1 Steel	3 RMP (SR)	5 Wrought iron	8 Concrete tile	CASING JOINTS/ <u>Glued</u>	Clamped .....
<u>2 PVC</u>	4 ABS	6 Asbestos-Cement	9 Other (specify below)	Welded .....	
		7 Fiberglass		Threaded .....	

Blank casing diameter: 5 in. to 140 ft., Dia. .... in. to .... ft., Dia. .... in. to .... ft.

Casing height above land surface: 12 in., weight 2.9 lbs./ft. Wall thickness or gauge No. 265

**TYPE OF SCREEN OR PERFORATION MATERIAL:**

1 Steel	3 Stainless steel	5 Fiberglass	<u>7 PVC</u>	10 Asbestos-cement
2 Brass	4 Galvanized steel	6 Concrete tile	8 RMP (SR)	11 Other (specify) .....
			9 ABS	12 None used (open hole)

**SCREEN OR PERFORATION OPENINGS ARE:**

1 Continuous slot	3 Mill slot	5 Gauzed wrapped	<u>8 Saw cut</u>	11 None (open hole)
2 Louvered shutter	4 Key punched	6 Wire wrapped	9 Drilled holes	
		7 Torch cut	10 Other (specify) .....	

**SCREEN-PERFORATED INTERVALS:** From 140 ft. to 180 ft., From ..... ft. to ..... ft.

**GRAVEL PACK INTERVALS:** From 100 ft. to 180 ft., From ..... ft. to ..... ft.

**6 GROUT MATERIAL:** 1 Near cement 2 Cement grout 3 Bentonite 4 Other Drill cuttings .....

Grout intervals: From 25 ft. to 100 ft., From 4 ft. to 25 ft., From ..... ft. to ..... ft.

What is the nearest source of possible contamination:

1 Septic tank	4 Lateral lines	7 Pit privy	<u>10 Livestock pens</u>	14 Abandoned water well
2 Sewer lines	5 Cess pool	8 Sewage lagoon	11 Fuel storage	15 Oil well/Gas well
3 Watertight sewer lines	6 Seepage pit	9 Feedyard	12 Fertilizer storage	16 Other (specify below)
			13 Insecticide storage	

Direction from well? North How many feet? 50

FROM	TO	LITHOLOGIC LOG	FROM	TO	LITHOLOGIC LOG
0	24	Clay	24	49	Caliche
49	58	Fine sand	58	79	Sand
79	84	Caliche	84	111	Sand cemented
111	162	Fine sand	162	175	Sand fine to medium
175	180	Yellow clay			

**7 CONTRACTOR'S OR LANDOWNER'S CERTIFICATION:** This water well was (1) constructed, (2) reconstructed, or (3) plugged under my jurisdiction and was completed on (mo/day/year) 6/12/87 and this record is true to the best of my knowledge and belief. Kansas Water Well Contractor's License No. 232. This Water Well Record was completed on (mo/day/yr) 6/29/87 under the business name of Weishaar Drilling & Supply Inc. by (signature) [Signature]

INSTRUCTIONS: Use typewriter or ball point pen. PLEASE PRESS FIRMLY and PRINT clearly. Please fill in blanks, underline or circle the correct answers. Send top three copies to Kansas Department of Health and Environment, Bureau of Water Protection, Topeka, Kansas 66620-7320, Telephone: 913-862-9360. Send one to WATER WELL OWNER and retain one for your records.

OFFICE USE ONLY

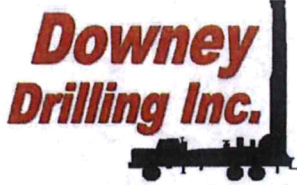

# Well Design & Construction

"PROPOSED"  
WR #38388

Customer Name: HRC FEEDYARD

Legal: NW 24-17S-32W

County: SCOTT CO.

GPS: 37.566441

Date: \_\_\_\_\_

100.815198

WO #: \_\_\_\_\_

DRILLER: \_\_\_\_\_

WATER SUPPLY: NEARBY WELL

HELPER(S): \_\_\_\_\_

DRILLING RIG: 908

BOREHOLE DIAMETER: 16"

DRILLING METHOD: REVERSE

CASING DIAMETER: 8" SDR 17 PVC

QUIKGEL: TBD

HOLE PLUG: 40'

TOTAL WELL DEPTH: 195'

GRAVEL: 70/30 WELL GRAVEL

DRILLING FLUID: H2O

GRAVEL SUPPLIER: HUBER

ADDITIONAL INFO: \_\_\_\_\_

GROUT AND GRAVEL

SCREEN AND CASING

IRRIGATION WELL

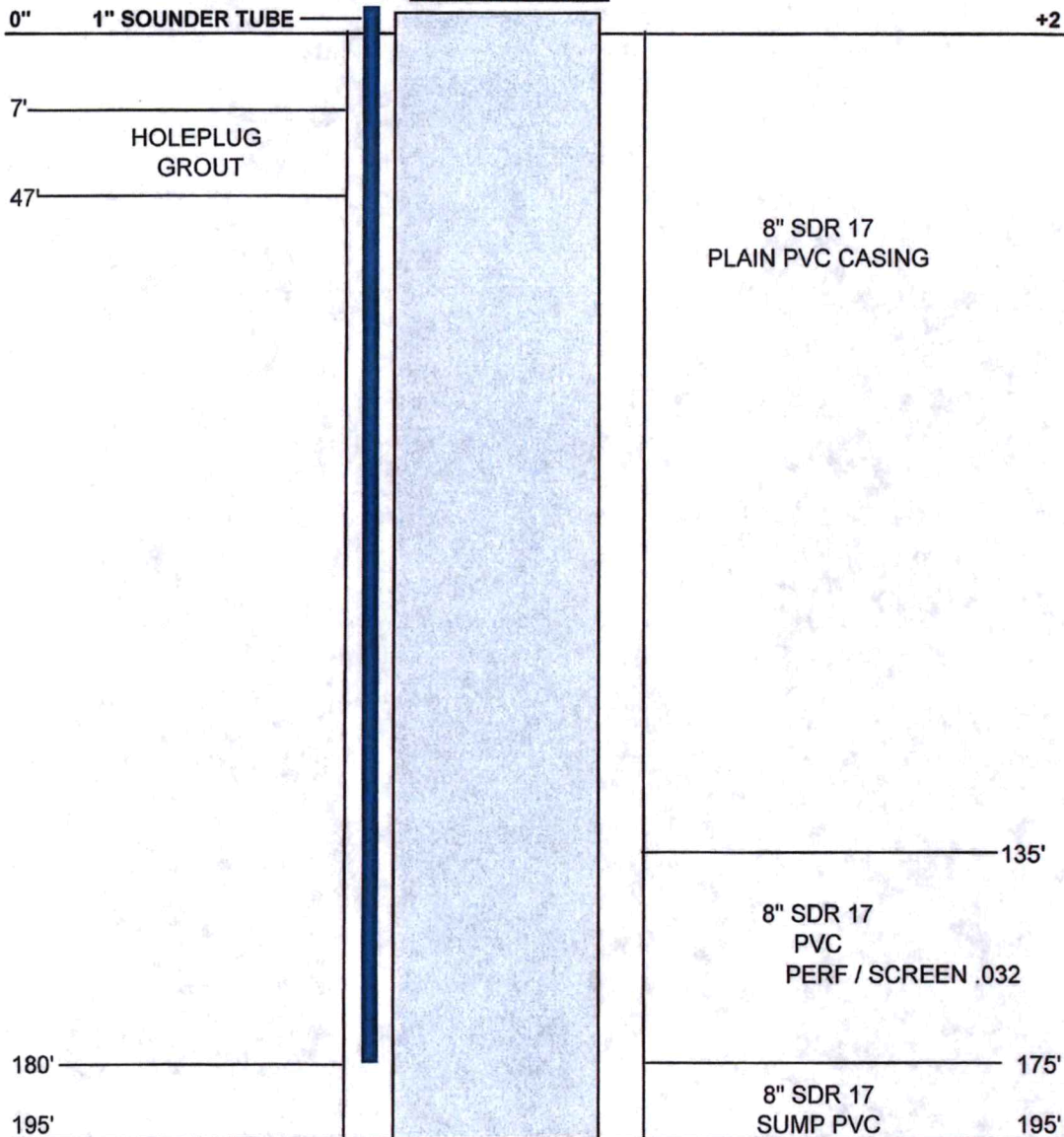

# HRC FEEDYARD - #5

NW/NE 24-17S-32W SCOTT CO.  
NW 24-17S-32W SCOTT CO.

Legend

TH 2023 ELEV=2968' Feedyard #5

TH 2023 ELEV=2980'

WELL 1982 ELEV=2979'

WELL 1987 ELEV=2975'

Google Earth



1000 ft



Scan of WWC5 Form

HRC FEEDLOT #2

WATER WELL RECORD Form WWC-5 KSA 82a-1212

1 LOCATION OF WATER WELL: County: **Scott** Fraction: **NW 1/4 NE 1/4 NW 1/4** Section Number: **35** Township Number: **T 18 S** Range Number: **R 33 E(W)**  
 Distance and direction from nearest town or city street address of well if located within city?

2 WATER WELL OWNER: **Patrick Ryan**  
 RR#, St. Address, Box #: **801 E. 5th** Board of Agriculture, Division of Water Resources  
 City, State, ZIP Code: **Scott City, Ka. 67871** Application Number:

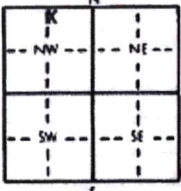
3 LOCATE WELL'S LOCATION WITH AN "X" IN SECTION BOX:  DEPTH OF COMPLETED WELL: **152** ft. ELEVATION: \_\_\_\_\_ ft.  
 Depth(s) Groundwater Encountered: 1 \_\_\_\_\_ ft. 2 \_\_\_\_\_ ft. 3 \_\_\_\_\_ ft.  
 WELL'S STATIC WATER LEVEL: **84** ft. below land surface measured on mo/day/yr: **9-14-99**  
 Pump test data: Well water was \_\_\_\_\_ ft. after \_\_\_\_\_ hours pumping \_\_\_\_\_ gpm  
 Est. Yield: **26** gpm. Well water was \_\_\_\_\_ ft. after \_\_\_\_\_ hours pumping \_\_\_\_\_ gpm  
 Bore Hole Diameter: **10** in. to **152** ft. and \_\_\_\_\_ in. to \_\_\_\_\_ ft.  
 WELL WATER TO BE USED AS: 5 Public water supply 8 Air conditioning 11 Injection well  
 1 Domestic 3 Feedlot 6 Oil field water supply 9 Dewatering 12 Other (Specify below)  
 2 Irrigation 4 Industrial 7 Lawn and garden only 10 Monitoring well  
 Was a chemical/bacteriological sample submitted to Department? Yes \_\_\_\_\_ No **X** If yes, mo/day/yr sample was submitted \_\_\_\_\_ Water Well Disinfected? Yes **X** No \_\_\_\_\_

5 TYPE OF BLANK CASING USED: 5 Wrought iron 8 Concrete tile CASING JOINTS: Glued **X** Cramped \_\_\_\_\_  
 1 Steel 3 RMP (SR) 6 Asbestos-Cement 9 Other (specify below) Welded \_\_\_\_\_  
**X** PVC 4 ABS 7 Fiberglass Threaded \_\_\_\_\_  
 Blank casing diameter: **5** in. to **152** in. Dia \_\_\_\_\_ in. to \_\_\_\_\_ in. Dia \_\_\_\_\_ ft. Dia \_\_\_\_\_ ft.  
 Casing height above land surface: **12** in. weight \_\_\_\_\_ lbs./ft. Wall thickness or gauge No. **200** psi  
 TYPE OF SCREEN OR PERFORATION MATERIAL: **X** PVC 10 Asbestos-cement  
 1 Steel 3 Stainless steel 5 Fiberglass 8 RMP (SR) 11 Other (specify) \_\_\_\_\_  
 2 Brass 4 Galvanized steel 6 Concrete tile 9 ABS 12 None used (open hole)  
 SCREEN OR PERFORATION OPENINGS ARE: 5 Gauzed wrapped **X** Saw cut 11 None (open hole)  
 1 Continuous slot 3 Mill slot 6 Wire wrapped 9 Drilled holes  
 2 Louvered shutter 4 Key punched 7 Torch cut 10 Other (specify) \_\_\_\_\_  
 SCREEN-PERFORATED INTERVALS: From: **132** ft. to **152** ft. From \_\_\_\_\_ ft. to \_\_\_\_\_ ft.  
 From \_\_\_\_\_ ft. to \_\_\_\_\_ ft. From \_\_\_\_\_ ft. to \_\_\_\_\_ ft.  
 GRAVEL PACK INTERVALS: From: **25** ft. to **152** ft. From \_\_\_\_\_ ft. to \_\_\_\_\_ ft.  
 From \_\_\_\_\_ ft. to \_\_\_\_\_ ft. From \_\_\_\_\_ ft. to \_\_\_\_\_ ft.

6 GROUT MATERIAL: 1 Neat cement 2 Cement grout **X** Bentonite 4 Other \_\_\_\_\_  
 Grout intervals: From: **5** ft. to **25** ft. From \_\_\_\_\_ ft. to \_\_\_\_\_ ft. From \_\_\_\_\_ ft. to \_\_\_\_\_ ft.  
 What is the nearest source of possible contamination:  
 1 Septic tank 4 Lateral lines 7 Pit privy 10 Livestock pens 14 Abandoned water well  
 2 Sewer lines 5 Cess pool 8 Sewage lagoon 11 Fuel storage 15 Oil well/Gas well  
 3 Water/soil sewer lines 6 Seepage pit 9 Feedyard 12 Fertilizer storage 16 Other (specify below)  
 13 Insecticide storage  
 Direction from well? \_\_\_\_\_ How many feet? **500**

FROM	TO	LITHOLOGIC LOG	FROM	TO	PLUGGING INTERVALS
0	1	top soil			
1	38	gray clay			
38	41	medium to coarse sand			
41	66	brown clay & gypsum			
66	70	medium to coarse sand			
70	77	brown clay			
77	91	medium to coarse sand & gravel			
91	117	fine sand, clay streaks			
117	121	brown clay			
121	130	medium to coarse sand			
130	133	brown clay			
133	144	medium to coarse sand & gravel			
144	145	brown clay			
145	152	medium to coarse sand			

7 CONTRACTOR'S OR LANDOWNER'S CERTIFICATION This water well was **X** (1) constructed, (2) reconstructed, or (3) plugged under my jurisdiction and was completed on (mo/day/year) **9-14-99** and this record is true to the best of my knowledge and belief, Kansas Water Well Contractor's License No. **532** This Water Well Record was completed on (mo/day/yr) **9-16-99** under the business name of **Midwest Well & Pump Inc** by (signature) *Patrick Ryan*

INSTRUCTIONS: Use typewriter or ball point pen. PLEASE PRINT NAME, ADDRESS AND PHONE CLEARLY. Please fill in blanks, underline or circle the correct answers. Send top three copies to Kansas Department of Health and Environment, Bureau of Water, Topeka, Kansas 66620-0001. Telephone 913-296-5545. Send one to WATER WELL OWNER and retain one for your records.

Kansas Geological Survey  
 Comments to webadmin@kgs.ku.edu  
 URL=http://www.kgs.ku.edu/Magellan/WaterWell/index.html  
 Display Programs Updated July 2, 2014  
 Data added continuously.

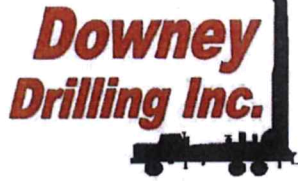

**Well Design  
& Construction**  
"PROPOSED"

Customer Name: HRC FEEDYARD

Legal: NW 35-18S-33W

County: SCOTT CO.

GPS: 38.45297

Date: \_\_\_\_\_

100.941342

WO #: \_\_\_\_\_

DRILLER: \_\_\_\_\_

WATER SUPPLY: NEARBY WELL

HELPER(S): \_\_\_\_\_

DRILLING RIG: 908

BOREHOLE DIAMETER: 16"

DRILLING METHOD: REVERSE

CASING DIAMETER: 8" SDR 17 PVC

QUIKGEL: TBD

HOLE PLUG: 40'

TOTAL WELL DEPTH: 175'

GRAVEL: 70/30 WELL GRAVEL

DRILLING FLUID: H2O

GRAVEL SUPPLIER: HUBER

ADDITIONAL INFO: \_\_\_\_\_

GROUT AND GRAVEL

SCREEN AND CASING

