

Kansas Department of Agriculture
 Division of Water Resources
CHANGE: P/U WORKSHEET

1. File Number: 21792	2. Status Change Date: <i>10-30-2023</i>	3. Change Num: C3	4. Field Office: 4	5. GMD: 3
6. Status: <input checked="" type="checkbox"/> Approved <input type="checkbox"/> Denied by DWR/GMD <input type="checkbox"/> Dismiss by Request/Failure to Return				7. Filing Date of Change: 10/9/2023
8a. Landowner, applicant New to system <input type="checkbox"/> MILLER FARMS OF DEERFIELD INC Attn: MONTE R MILLER 2413 ROAD Y DEERFIELD, KS 67838		8c. Landowner(s) New to system <input type="checkbox"/> Person ID <u>29267</u> Add Seq# _____		
8b. Landowner(s) New to system <input type="checkbox"/> CROSS BELL FARMS 2411 ROAD Y DEERFIELD, KS 67838		8d. WUC New to system <input type="checkbox"/> 8a Person ID <u>40999</u> Add Seq# _____		
9. Documents and Enclosure(s): <input checked="" type="checkbox"/> DWR Meter(s) Date to Comply: 12/31/2024 <input type="checkbox"/> N & P Date to Comply: _____				
<input type="checkbox"/> Anti-Reverse Meter <input type="checkbox"/> Meter Seal <input checked="" type="checkbox"/> Check Valve <input type="checkbox"/> N & P Form <input type="checkbox"/> Water Tube <input type="checkbox"/> Driller Copy <input type="checkbox"/> H & E Letter <input type="checkbox"/> Conservation Plan Date Required: _____ Date Approved: _____ Date to Comply: _____				
10. Use Made of Water From: _____ To: _____				
Date Prepared: 10/30/2023 By: MAM Date Entered: _____ By: _____				

File No. **21792** 11. County: KE Basin: ARKANSAS RIVER Stream: Formation Code: Special Use:

12. Points of Diversion CHK MOD DEL ENT	PDIV	Qualifier	S	T	R	ID	'N	'W	Comment (AKA Line)	Rate and Quantity				
										Authorized				Additional
										Rate gpm/cfs	Quantity af/mgy	Rate gpm/cfs	Quantity af/mgy	Overlap PD Files

CHK 78473

13. Storage: Rate _____ NF Quantity _____ ac/ft Additional Rate _____ NF Additional Quantity _____ ac/ft

14. Limitation: _____ af/yr at _____ gpm (_____ cfs) when combined with file number(s) _____
 Limitation: _____ af/yr at _____ gpm (_____ cfs) when combined with file number(s) _____

15. 5YR Allocation: Allocation Type _____ Start Year _____ 5 YR Amount _____ Amount Unit _____ Base Acres _____ Comment _____

16. Place of Use CHK MOD DEL ENT	PUSE	S	T	R	ID	NE¼				NW¼				SW¼				SE¼				Total	Owner	Chg?	Overlap Files	
						NE ¼	NW ¼	SW ¼	SE ¼	NE ¼	NW ¼	SW ¼	SE ¼	NE ¼	NW ¼	SW ¼	SE ¼	NE ¼	NW ¼	SW ¼	SE ¼					
CHK	3380	4	23	38	W	1	L-1 34	L-2 34	34	34	L-3 34	L-4 34	34	34	40	40	40	40	40	40	36	15	563	8b	N	KE 002, 1473, 12421, 13914, 15925, 18130
MOD	15320	10	23	38	W	3					31.25	31.25	31.25										126	8a	N	KE 002, 1473, 12421, 13914, 15925, 27192
CHK	22190	33	22	35	W	3													11.2			12.5	23.7	8b	N	KE 002, 1473, 12421, 13914, 15925, 18130
CHK	33946	33	22	35	W	2					40	40	33	40	40	36.4	40	40	26.4	30	35	24	434.8	8b	N	KE 002, 1473, 12421, 13914, 15925, 18130
CHK	35240	9	23	35	W	3	40	40	40	40	40	40	40										320	8b	N	KE 002, 1473, 12421, 13914, 15925, 18130

Base Acres: Year: Minimum Reasonable Quantity:

Comments: PUSE ID 22190, LANDOWNER PERSON ID 66871 (ELAINE SCHEUREMAN), WATER RIGHT LAND RESERVED FROM WATER RIGHT, WR OWNER PERSON ID 28742

Correction Lots

Garden City Field Office
4532 W. Jones, Suite B
Garden City, KS 67846



Phone: 620-276-2901
Fax: 620-276-9315
www.agriculture.ks.gov

Mike Beam, Secretary

Laura Kelly, Governor

October 30, 2023

MILLER FARMS OF DEERFIELD INC
Attn: MONTE R MILLER
2413 ROAD Y
DEERFIELD, KS 67838

RE: Field Office Application for Change
Vested Right, File No. KE 002
Water Right, File Nos. 1473, 12421, 13914, 15925, 18130, 21792

Dear Sir:

Enclosed are orders executed by the designee of the Chief Engineer, Division of Water Resources, Kansas Department of Agriculture, approving the applications for change under the above referenced file numbers.

Your attention is directed to the enclosures and to the terms, conditions, and limitations specified in these approvals for change. A condition of these approvals is that an acceptable water flow meter must be installed on the diversion works authorized under the referenced file number and meet current specifications. Please return the required notification of completion of the diversion works and installation of the required meter as soon as these actions are completed.

Since the orders modify the original documents referred to above, they should be recorded with the Register of Deeds as other instruments affecting real estate.

Should you have any questions, please feel free contact this office. If you would prefer, you could arrange an appointment for additional assistance.

Sincerely,

A handwritten signature in blue ink, appearing to read "Michael A. Meyer".

Michael A. Meyer
Water Commissioner

MAM:
Enclosures
pc: Cross bell Farms

CERTIFICATE OF SERVICE

On this 30th day of October 2023, I hereby certify that the foregoing Approval of Application for Change in Place of Use, Vested Right, File No. KE 002, Water Right, File Nos. 1473, 12421, 13914, 15925, 18130, 21792 dated 30th day of October 2023 was mailed postage prepaid, first class, US mail to the following:

MILLER FARMS OF DEERFIELD INC
Attn: MONTE R MILLER
2413 ROAD Y
DEERFIELD, KS 67838

pc:

CROSS BELL FARMS
2411 ROAD Y
DEERFIELD, KS 67838

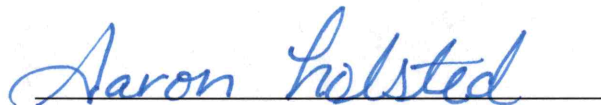
A handwritten signature in blue ink that reads "Aaron Holsted". The signature is written in a cursive style and is positioned above a solid horizontal line.

Division of Water Resources Staff

Submit completed application to:
 Kansas Department of Agriculture
 Division of Water Resources
 Field Office for your area.

Call for address:

Topeka -- (785) 296-5733
 Stafford -- (620) 234-5311
 Stockton -- (785) 425-6787
 Garden City -- (620) 276-2901
<http://agriculture.ks.gov/dwr>

DWR FIELD OFFICE APPLICATION FOR APPROVAL TO CHANGE THE PLACE OF USE AND/OR THE POINT OF DIVERSION



STATE OF KANSAS

Filing Fee Must Accompany the Application, K.S.A. 82a-708b(b), as amended.
 Fee Schedule is on the third page of this application form.

Paragraph Nos. 1, 2, 3 & 5 must be completed. Complete all other applicable portions. If change in point of diversion is greater than 100 feet, or if place of use will be changed, include a topographic map or detailed plat showing the authorized and proposed point(s) of diversion and/or place of use.

 File No. 21792

RECEIVED
8:52 am
OCT 09 2023

1. Application is hereby made for approval of the Chief Engineer to change the (check one or both): Garden City Field Office
Division of Water Resources
- Place of Use Point of Diversion
- under the water right which is the subject of this application in accordance with the conditions described below.
- The source of supply is: Groundwater Surface water

2. Name and address of Applicant: Monte R Miller, Miller Farms of Deerfield Inc
2413 Road Y, Deerfield, KS 67838
 Phone Number: () Email address: _____
 Name and address of Water Use Correspondent: same as above

 Phone Number: () Email address: _____

3. The presently authorized place of use is:
 Owner of Land ---- NAME: see attached
 ADDRESS: _____
 (If there is more than one landowner, attach supplemental sheets as necessary.)

Sec.	Twp.	Range	NE¼				NW¼				SW¼				SE¼				TOTAL ACRES	
			NE¼	NW¼	SW¼	SE¼	NE¼	NW¼	SW¼	SE¼	NE¼	NW¼	SW¼	SE¼	NE¼	NW¼	SW¼	SE¼		

4. If this application is for a change in place of use, it is proposed that the place of use be changed to:
 Owner of Land ---- NAME: see attached
 ADDRESS: _____
 (If there is more than one landowner, attach supplemental sheets as necessary.)

Sec.	Twp.	Range	NE¼				NW¼				SW¼				SE¼				TOTAL ACRES		
			NE¼	NW¼	SW¼	SE¼	NE¼	NW¼	SW¼	SE¼	NE¼	NW¼	SW¼	SE¼	NE¼	NW¼	SW¼	SE¼			

For Office Use Only: Code _____ Fee \$ <u>200.00</u> TR # _____ Receipt Date <u>10-9-23</u> Check # <u>002067</u>
--

APPLICATION FOR APPROVAL TO CHANGE THE PLACE OF USE AND/OR POINT OF DIVERSION
 SUPPLEMENTAL SHEET

FILE NO. 21792

MAKE ADDITIONAL COPIES AS NECESSARY

3. *Continued:* The presently authorized place of use is:

Owner of Land ---- NAME: Miller Farms of Deerfield, Inc.

ADDRESS: 2413 Road Y, Deerfield, KS 67838

Sec.	Twp.	Range	NE¼				NW¼				SW¼				SE¼				TOTAL ACRES
			NE¼	NW¼	SW¼	SE¼	NE¼	NW¼	SW¼	SE¼	NE¼	NW¼	SW¼	SE¼	NE¼	NW¼	SW¼	SE¼	
10	23	35 W					40	40	34	12									126
9	23	35 W	40	40	40	40	40	40	40	40									320

Owner of Land ---- NAME: Cross Bell Farms

ADDRESS: 2411 Road Y, Deerfield, KS 67838

Sec.	Twp.	Range	NE¼				NW¼				SW¼				SE¼				TOTAL ACRES	
			NE¼	NW¼	SW¼	SE¼	NE¼	NW¼	SW¼	SE¼	NE¼	NW¼	SW¼	SE¼	NE¼	NW¼	SW¼	SE¼		
4	23	35 W	34	34	34	34	34	34	34	34	34	34	34	34	34	34	34	34	34	563
33	22	35 W					40	40	33	40	40	36.4	40	40	26.4	30	35	24		434.8

Owner of Land ---- NAME: Elaine Scheuerman

ADDRESS: 571 N 8th Street, Garden City, KS 67846

Sec.	Twp.	Range	NE¼				NW¼				SW¼				SE¼				TOTAL ACRES		
			NE¼	NW¼	SW¼	SE¼	NE¼	NW¼	SW¼	SE¼	NE¼	NW¼	SW¼	SE¼	NE¼	NW¼	SW¼	SE¼			
33	22	35 W																11.2		12.5	23.7

4. *Continued:* If this application is for a change in place of use, it is proposed that the place of use be changed to:

Owner of Land ---- NAME: Miller Farms of Deerfield, Inc.

ADDRESS: 2413 Road Y, Deerfield, KS 67838

Sec.	Twp.	Range	NE¼				NW¼				SW¼				SE¼				TOTAL ACRES		
			NE¼	NW¼	SW¼	SE¼	NE¼	NW¼	SW¼	SE¼	NE¼	NW¼	SW¼	SE¼	NE¼	NW¼	SW¼	SE¼			
10	23	35 W					31.5	31.5	31.5	31.5											126
9	23	35 W	40	40	40	40	40	40	40	40											320

Owner of Land ---- NAME: Cross Bell Farms

ADDRESS: 2411 Road Y, Deerfield, KS 67838

Sec.	Twp.	Range	NE¼				NW¼				SW¼				SE¼				TOTAL ACRES		
			NE¼	NW¼	SW¼	SE¼	NE¼	NW¼	SW¼	SE¼	NE¼	NW¼	SW¼	SE¼	NE¼	NW¼	SW¼	SE¼			
4	23	35 W	34	34	34	34	34	34	34	34	34	34	34	34	34	34	34	34	34	34	563
33	22	35 W					40	40	33	40	40	36.4	40	40	26.4	30	35	24			434.8

Owner of Land ---- NAME: Elaine Scheuerman

ADDRESS: 571 N 8th Street, Garden City, KS 67846

Sec.	Twp.	Range	NE¼				NW¼				SW¼				SE¼				TOTAL ACRES		
			NE¼	NW¼	SW¼	SE¼	NE¼	NW¼	SW¼	SE¼	NE¼	NW¼	SW¼	SE¼	NE¼	NW¼	SW¼	SE¼			
33	22	35 W																11.2		12.5	23.7

5. **Presently authorized point of diversion:**
 One in the _____ Quarter of the _____ Quarter of the _____ Quarter
 of Section _____, Township _____ South, Range _____ (W),
 in _____ County, Kansas, _____ feet North _____ feet West of Southeast corner of section.
 Authorized Rate _____ Authorized Quantity _____ Depth of well _____ (feet)
(DWR use only: Computer ID No. _____ GPS _____ feet North _____ feet West)
 This point will not be changed This point will be changed as follows: No change, point better described with GPS as follows:
Proposed point of diversion: (Complete only if change is requested or if existing point is better described by GPS)
 One in the _____ Quarter of the _____ Quarter of the _____ Quarter
 of Section _____, Township _____ South, Range _____ (W),
 in _____ County, Kansas, _____ feet North _____ feet West of Southeast corner of section.
 Proposed Rate _____ Proposed Quantity _____ Proposed well depth (feet) _____
 This point is: Additional Well Geo Center List other water rights that will use this point _____

6. **Presently authorized point of diversion:**
 One in the _____ Quarter of the _____ Quarter of the _____ Quarter
 of Section _____, Township _____ South, Range _____ (W),
 in _____ County, Kansas, _____ feet North _____ feet West of Southeast corner of section.
 Authorized Rate _____ Authorized Quantity _____ Depth of well _____ (feet)
(DWR use only: Computer ID No. _____ GPS _____ feet North _____ feet West)
 This point will not be changed This point will be changed as follows: No change, point better described with GPS as follows:
Proposed point of diversion: (Complete only if change is requested or if existing point is better described by GPS)
 One in the _____ Quarter of the _____ Quarter of the _____ Quarter
 of Section _____, Township _____ South, Range _____ (W),
 in _____ County, Kansas, _____ feet North _____ feet West of Southeast corner of section.
 Proposed Rate _____ Proposed Quantity _____ Proposed well depth (feet) _____
 This point is: Additional Well Geo Center List other water rights that will use this point _____

7. The changes herein are desired for the following reasons?
 (please be specific) _____

8. If a well, is the test hole log attached? Yes No

9. The change(s) (was)(will be) completed by?

10. If the point of diversion is a well:
 (a) What are you going to do with the old well?

 (b) When will this be done? _____

11. Groundwater Management District recommendation attached?
 Yes No

12. Assisted by CI, GCFO _____

13a. If the proposed point of diversion will be relocated more than 300 feet but within 2,640 feet of the existing point of diversion, attach a topographic map or aerial photograph. For groundwater sources, show all wells (including domestic) within one-half mile of the proposed point of diversion and the names and mailing addresses of the owners. For surface water sources, show the names and addresses of the landowner(s) one-half mile downstream and one-half mile upstream from your property lines

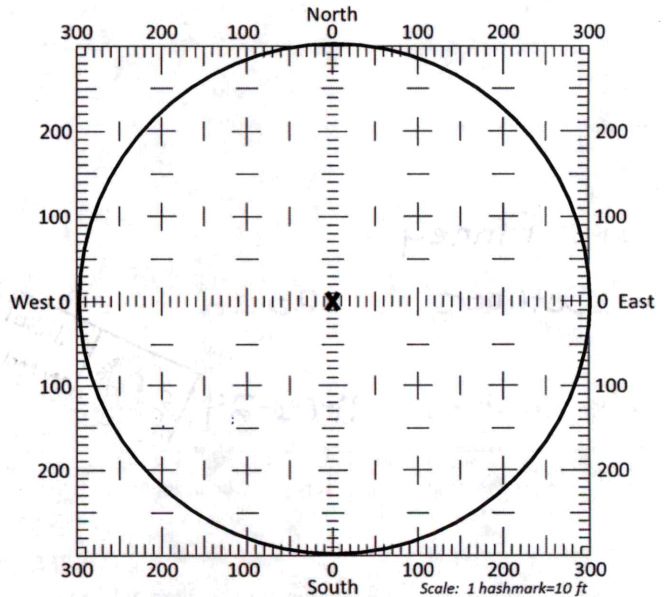

13b. If the proposed point of diversion will be relocated within a 300 foot radius of the existing point of diversion, indicate its location on the diagram shown above in relation to the existing point of diversion. The proposed point of diversion must be located within the circle shown above. **(PLEASE NOTE: The "X" in center of diagram above represents the presently authorized point of diversion.)**

14. If the proposed groundwater point of diversion is 300 or fewer feet from the existing point of diversion, complete the following:
- (a) Does the undersigned represent all owners of the currently authorized place(s) of use identified in this application?
 Yes No (If no, all owners must sign this application.)
 - (b) Will the ownership interest of any owner of the currently authorized place(s) of use identified in this application be adversely affected if this application is approved as requested?
 Yes No (If yes, all owners must sign this application.)
 - (c) If this application is not approved expeditiously, will there be substantial damage to property, public health or safety?
 Yes No (If no, all owners must sign this application.)

If the application proposes a surface water change in point of diversion, a groundwater change in point of diversion greater than 300 feet, or a change in place of use, the application must be signed by all owners of the currently authorized place of use, or their duly authorized agent (attach notarized statement authorizing representation).

I hereby verify, being first duly sworn upon my oath or affirmation and under penalty of perjury, that I am of lawful age and the owner, the spouse of the owner, or a duly authorized agent of the owner(s) to make this application on their behalf, in regards to the water right(s) to which this application pertains. I further verify that the statements contained in this application are true, correct and complete.

Dated at Garden City, Kansas, this 4th day of October, 2023.

Monte Miller

 (Owner)

 (Spouse)

 (Please Print)

 (Please Print)

 (Owner)

 (Spouse)

 (Please Print)

 (Please Print)

 (Owner)

 (Spouse)

 (Please Print)

 (Please Print)

State of Kansas }
 County of Finney } SS

I hereby certify that the foregoing application was signed in my presence and sworn to before me this 4th day of October, 2023.

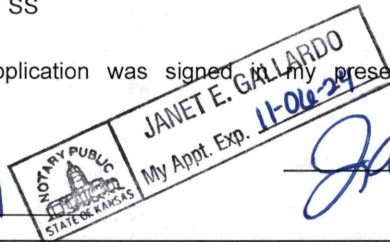

Janet E. Gallardo

 Notary Public

My Commission Expires 11-06-24

ONLY COMPLETE APPLICATIONS WILL BE PROCESSED. To be complete, all of the applicable portions of the application form must be completed with accurate information; maps, if necessary, must be included; signatures of all the appropriate owners' must be affixed to the application and notarized; and the appropriate fee must be paid.

FEE SCHEDULE

Each application to change the place of use or the point of diversion under this section shall be accompanied by the application fee set forth in the schedule below: Make checks payable to: **Kansas Department of Agriculture**

(1) Application to change a point of diversion 300 feet or less	\$100
(2) Application to change a point of diversion more than 300 feet	\$200
(3) Application to change the place of use	\$200

WR KE-02, 1472, 12421, 13914, 15925, 18130, 21792
 Change in Place of Use

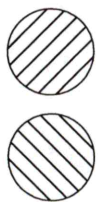
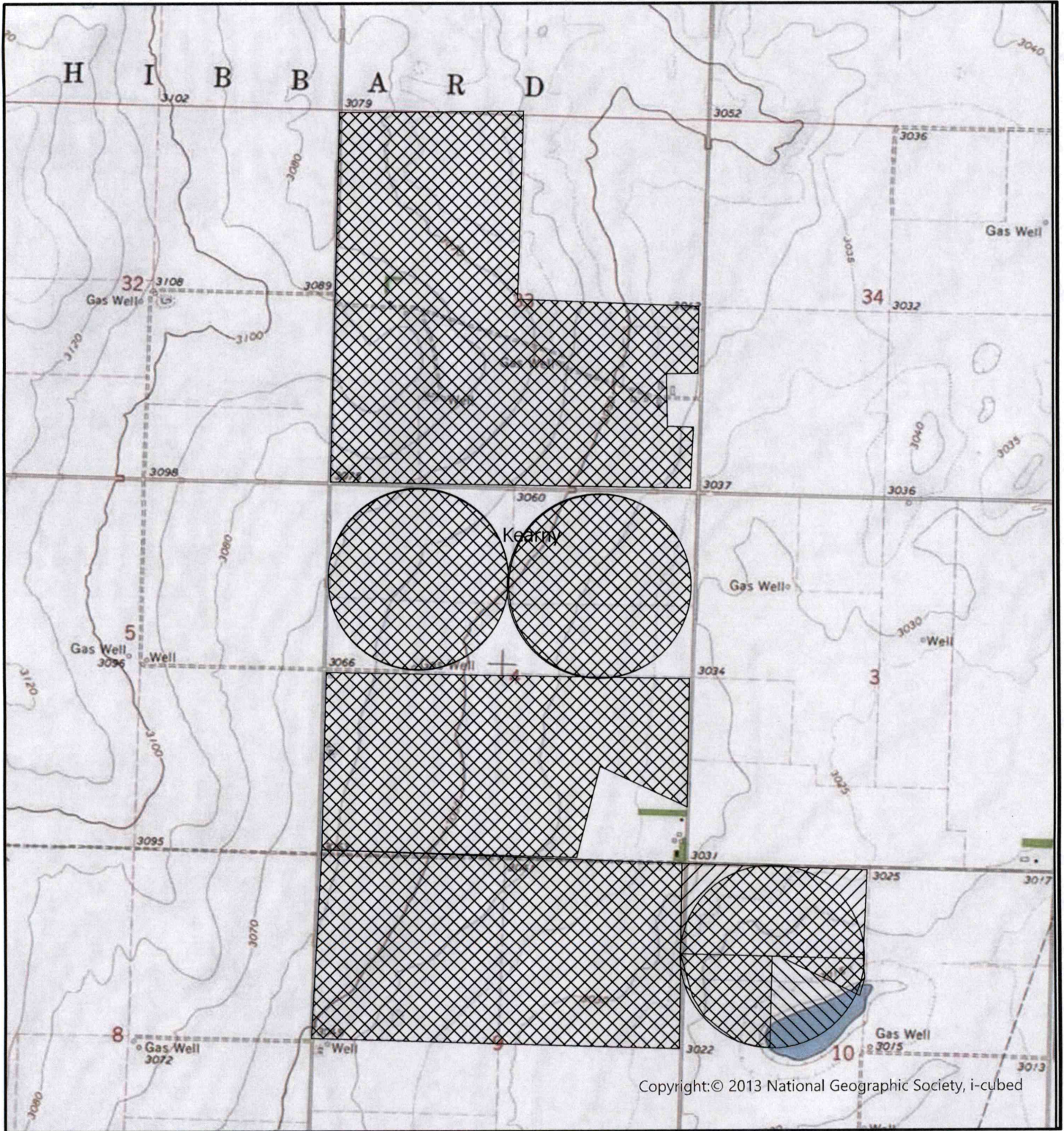

Authorized Place of Use

Proposed Place of Use



Existing Well

0 0.2 0.4 0.8 Miles



Created By: CI/GCFO

Garden City Field Office
4532 W. Jones, Suite B
Garden City, KS 67846



Phone: 620-276-2901
Fax: 620-276-9315
www.agriculture.ks.gov

Mike Beam, Secretary

Laura Kelly, Governor

October 9, 2023

SOUTHWEST KANSAS GROUNDWATER
MANAGEMENT DISTRICT NO. 3
2009 E SPRUCE ST
GARDEN CITY KS 67846

Re: Request for Recommendation
Vested Right, File No. KE 002, Water Right, File Nos. 1473, 12421, 13914,
15925, 18130, 21792,

Dear Mr. Norquest:

This is to advise you that Monte Miller has filed applications for approval of the Chief Engineer, Division of Water Resources, Kansas Department of Agriculture, to change the place of use.

We are delaying action on the change application to allow you time to review and provide a recommendation. Please submit a recommendation within 15 days from the date of this letter.

Thank you and as always feel free to contact this office at any time.

Sincerely,

A handwritten signature in blue ink that reads "Michael A. Meyer".

Michael A. Meyer
Water Commissioner

MAM
Enclosures