

Kansas Department of Agriculture  
 Division of Water Resources  
**CHANGE: P/D WORKSHEET**

1. File Number: <b>34127</b>	2. Status Change Date: <i>5-1-2023</i>	3. Change Num: <b>C1</b>	4. Field Office: <b>4</b>	5. GMD: <b>1</b>
---------------------------------	---	-----------------------------	------------------------------	---------------------

6. Status: <input checked="" type="checkbox"/> Approved <input type="checkbox"/> Denied by DWR/GMD <input type="checkbox"/> Dismiss by Request/Failure to Return	7. Filing Date of Change: <b>4/20/2023</b>
--	---

8a. Applicant, Landowner New to system <input type="checkbox"/>  <b>HRC FEED YARDS LLC</b> <b>PO BOX 224</b> <b>SCOTT CITY, KS 67871</b>	8c. Landowner(s) New to system <input type="checkbox"/>  
Person ID <u>63928</u> Add Seq# _____	Person ID _____ Add Seq# _____

8b. Landowner(s) New to system <input type="checkbox"/>	8d. WUC New to system <input type="checkbox"/>  <b>8a</b>
Person ID _____ Add Seq# _____	Person ID <u>63928</u> Add Seq# _____

9. Documents and Enclosure(s):  DWR Meter(s) Date to Comply: 12/31/2023     N & P Date to Comply: 3/1/2024

Anti-Reverse Meter     Meter Seal     Check Valve     N & P Form     Water Tube     Driller Copy     H & E Letter

Conservation Plan    Date Required: \_\_\_\_\_    Date Approved: \_\_\_\_\_    Date to Comply: \_\_\_\_\_

10. Use Made of Water    From: \_\_\_\_\_    To: \_\_\_\_\_

Date Prepared: **5/1/2023**    By: **MAM**

Date Entered: \_\_\_\_\_    By: \_\_\_\_\_

File No. **34127**      11. County: SC      Basin: WHITEWOMAN CREEK      Stream:      Formation Code: 211      Special Use:

12. Points of Diversion										Rate and Quantity						
CHK	MOD	DEL	PDIV	Qualifier	S	T	R	ID	'N	'W	Comment (AKA Line)	Rate gpm	Quantity mgy	Rate gpm	Quantity mgy	Overlap PD Files

**DEL 44244**

**ENT**      **NWNWNW**      **38**      **18S 33W**      **5143**      **4675**      **20**      **\* 5.304**      **20**      **\*5.304**      **NONE**

**CHK 63815**

13. Storage: Rate \_\_\_\_\_ NF      Quantity \_\_\_\_\_ ac/ft      Additional Rate \_\_\_\_\_ NF      Additional Quantity \_\_\_\_\_ ac/ft

14. Limitation: \_\_\_\_\_ af/yr at \_\_\_\_\_ gpm (\_\_\_\_\_ cfs) when combined with file number(s) \_\_\_\_\_  
 Limitation: \_\_\_\_\_ af/yr at \_\_\_\_\_ gpm (\_\_\_\_\_ cfs) when combined with file number(s) \_\_\_\_\_

15. 5YR Allocation:      Allocation Type \_\_\_\_\_      Start Year \_\_\_\_\_      5 YR Amount \_\_\_\_\_      Amount Unit \_\_\_\_\_      Base Acres \_\_\_\_\_      Comment \_\_\_\_\_

16. Place of Use																		Total	Owner	Chg?	Overlap Files									
CHK	MOD	DEL	ENT	PUSE	S	T	R	ID		NE¼				NW¼				SW¼				SE¼								
										NE ¼	NW ¼	SW ¼	SE ¼	NE ¼	NW ¼	SW ¼	SE ¼	NE ¼	NW ¼	SW ¼	SE ¼	NE ¼	NW ¼	SW ¼	SE ¼					
<b>CHK</b>	<b>39202</b>																													

Base Acres:      Year:      Minimum Reasonable Quantity:

Comments: . \*CORRECTED QUANTITY AS PER CERTIFICATE. WRIS ERROR

Garden City Field Office  
4532 W. Jones, Suite B  
Garden City, KS 67846



Phone: 620-276-2901  
Fax: 620-276-9315  
[www.agriculture.ks.gov](http://www.agriculture.ks.gov)

Mike Beam, Secretary

Laura Kelly, Governor

May 1, 2023

HRC FEED YARDS LLC  
PO BOX 224  
SCOTT CITY, KS 67871

RE: Field Office Application for Change  
Water Right, File Nos. 8715.05, 17125.05 & 34127

Dear Sir or Madam:

Enclosed are orders executed by the designee of the Chief Engineer, Division of Water Resources, Kansas Department of Agriculture, approving the application for change under the above referenced file numbers.

Your attention is directed to the enclosures and to the terms, conditions, and limitations specified in these approvals for change. A condition of this approval is that an acceptable water flow meter must be installed on the diversion works authorized under the referenced file number and meet current specifications. Please return the required notification of completion of the diversion works and installation of the required meter as soon as these actions are completed.

Since the orders modifies the original document referred to above, it should be recorded with the Register of Deeds as other instruments affecting real estate.

The abandoned well must be plugged in accordance with the requirements of Article 30 of the Rules and Regulations as adopted by the Kansas Department of Health and Environment.

Should you have any questions, please feel free contact this office. If you would prefer, you could arrange an appointment for additional assistance.

Sincerely,

A handwritten signature in blue ink that reads "Michael A. Meyer". The signature is fluid and cursive, with a long horizontal stroke at the end.

Michael A. Meyer  
Water Commissioner

MAM:  
Enclosures

**CERTIFICATE OF SERVICE**

On this 1<sup>st</sup> day of May 2023, I hereby certify that the foregoing Approval of Application for Change in Point of Diversion, Water Right, File Nos. 8,715.05, 17,125.05, and 34,127 dated 1<sup>st</sup> day of May 2023 was mailed postage prepaid, first class, US mail to the following:

HRC FEED YARDS LLC  
PO BOX 224  
SCOTT CITY, KS 67871

A handwritten signature in blue ink, reading "Aaron Holsted", written over a horizontal line.

Division of Water Resources Staff



Submit completed application to:  
 Kansas Department of Agriculture  
 Division of Water Resources  
 Field Office for your area.

Call for address:

Topeka -- (785) 296-5733  
 Stafford -- (620) 234-5311  
 Stockton -- (785) 425-6787  
 Garden City -- (620) 276-2901  
<http://agriculture.ks.gov/dwr>

## DWR FIELD OFFICE APPLICATION FOR APPROVAL TO CHANGE THE PLACE OF USE AND/OR THE POINT OF DIVERSION



**STATE OF KANSAS**

**Filing Fee Must Accompany the Application, K.S.A. 82a-708b(b), as amended.**  
 Fee Schedule is on the third page of this application form.

**Paragraph Nos. 1, 2, 3 & 5 must be completed. Complete all other applicable portions.** If change in point of diversion is greater than 100 feet, or if place of use will be changed, include a topographic map or detailed plat showing the authorized and proposed point(s) of diversion and/or place of use.

File No. 34127

**RECEIVED**  
 3:03 pm  
 APR 20 2023

Garden City Field Office  
 Division of Water Resources

1. Application is hereby made for approval of the Chief Engineer to change the (check one or both):

Place of Use                       Point of Diversion

under the water right which is the subject of this application in accordance with the conditions described below.

The source of supply is:                       Groundwater                       Surface water

2. Name and address of Applicant: HRC FEED YARDS LLC

PO BOX 224, SCOTT CITY KS, 67871

Phone Number: (620)872-5328

Email address: LEE@HRCFEEDYARDS.COM

Name and address of Water Use Correspondent: SAME AS ABOVE

SAME AS ABOVE

Phone Number: (     )

Email address: \_\_\_\_\_

3. The presently authorized place of use is:

Owner of Land ---- NAME: \_\_\_\_\_

ADDRESS: \_\_\_\_\_

(If there is more than one landowner, attach supplemental sheets as necessary.)

Sec.	Twp.	Range	NE¼				NW¼				SW¼				SE¼				TOTAL ACRES	
			NE¼	NW¼	SW¼	SE¼	NE¼	NW¼	SW¼	SE¼	NE¼	NW¼	SW¼	SE¼	NE¼	NW¼	SW¼	SE¼		

4. If this application is for a change in place of use, it is proposed that the place of use be changed to:

Owner of Land ---- NAME: \_\_\_\_\_

ADDRESS: \_\_\_\_\_

(If there is more than one landowner, attach supplemental sheets as necessary.)

Sec.	Twp.	Range	NE¼				NW¼				SW¼				SE¼				TOTAL ACRES	
			NE¼	NW¼	SW¼	SE¼	NE¼	NW¼	SW¼	SE¼	NE¼	NW¼	SW¼	SE¼	NE¼	NW¼	SW¼	SE¼		

**For Office Use Only:** Code \_\_\_\_\_ Fee \$ 200.00 TR # \_\_\_\_\_ Receipt Date 4-20-23 Check # 60876

5. **Presently authorized point of diversion:**  
 One in the NW Quarter of the NE Quarter of the NW Quarter of Section 35, Township 18 South, Range 33 W, in SCOTT County, Kansas, 5200 feet North 3865 feet West of Southeast corner of section. Authorized Rate 12 GPM Authorized Quantity 3.132 MGY Depth of well \_\_\_\_\_ (feet)  
**(DWR use only: Computer ID No. 07 GPS \_\_\_\_\_ feet North \_\_\_\_\_ feet West)**  
 This point will not be changed  This point will be changed as follows:  No change, point better described with GPS as follows:  
**Proposed point of diversion: (Complete only if change is requested or if existing point is better described by GPS)**  
 One in the \_\_\_\_\_ Quarter of the \_\_\_\_\_ Quarter of the \_\_\_\_\_ Quarter of Section \_\_\_\_\_, Township \_\_\_\_\_ South, Range \_\_\_\_\_, in \_\_\_\_\_ County, Kansas, \_\_\_\_\_ feet North \_\_\_\_\_ feet West of Southeast corner of section. Proposed Rate \_\_\_\_\_ Proposed Quantity \_\_\_\_\_ Proposed well depth (feet) \_\_\_\_\_.  
 This point is:  Additional Well  Geo Center List other water rights that will use this point \_\_\_\_\_.

6. **Presently authorized point of diversion:**  
 One in the NW Quarter of the NW Quarter of the NW Quarter of Section 35, Township 18 South, Range 33 W, in SCOTT County, Kansas, 4752 feet North 4874 feet West of Southeast corner of section. Authorized Rate 20 GPM Authorized Quantity 5.305 Depth of well \_\_\_\_\_ (feet)  
**(DWR use only: Computer ID No. 06 GPS \_\_\_\_\_ feet North \_\_\_\_\_ feet West)**  
 This point will not be changed  This point will be changed as follows:  No change, point better described with GPS as follows:  
**Proposed point of diversion: (Complete only if change is requested or if existing point is better described by GPS)**  
 One in the NW Quarter of the NW Quarter of the NW Quarter of Section 35, Township 18 South, Range 33 W, in SCOTT County, Kansas, 5143 feet North 4675 feet West of Southeast corner of section. Proposed Rate \_\_\_\_\_ Proposed Quantity \_\_\_\_\_ Proposed well depth (feet) 180.  
 This point is:  Additional Well  Geo Center List other water rights that will use this point \_\_\_\_\_.

*actual location within 300'*

7. The changes herein are desired for the following reasons? (please be specific) \_\_\_\_\_
8. If a well, is the test hole log attached?  Yes  No
9. The change(s) (was)(will be) completed by? \_\_\_\_\_
10. If the point of diversion is a well:  
 (a) What are you going to do with the old well? \_\_\_\_\_  
 (b) When will this be done? \_\_\_\_\_
11. Groundwater Management District recommendation attached?  Yes  No
12. Assisted by JG/GCFO

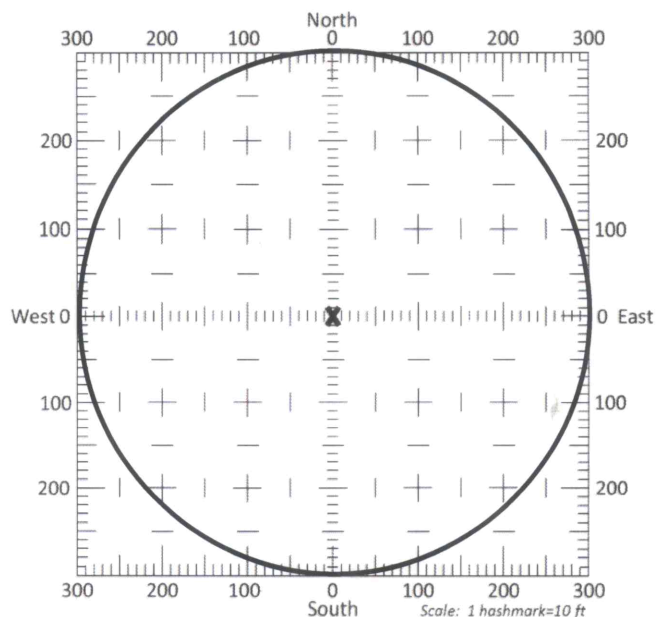

- 13a. If the proposed point of diversion will be relocated more than 300 feet but within 2,640 feet of the existing point of diversion, attach a topographic map or aerial photograph. For groundwater sources, show all wells (including domestic) within one-half mile of the proposed point of diversion and the names and mailing addresses of the owners. For surface water sources, show the names and addresses of the landowner(s) one-half mile downstream and one-half mile upstream from your property lines
- 13b. If the proposed point of diversion will be relocated within a 300 foot radius of the existing point of diversion, indicate its location on the diagram shown above in relation to the existing point of diversion. The proposed point of diversion must be located within the circle shown above. **(PLEASE NOTE: The "X" in center of diagram above represents the presently authorized point of diversion.)**



14. If the proposed groundwater point of diversion is 300 or fewer feet from the existing point of diversion, complete the following:
- (a) Does the undersigned represent all owners of the currently authorized place(s) of use identified in this application?  
 Yes     No    (If no, all owners must sign this application.)
  - (b) Will the ownership interest of any owner of the currently authorized place(s) of use identified in this application be adversely affected if this application is approved as requested?  
 Yes     No    (If yes, all owners must sign this application.)
  - (c) If this application is not approved expeditiously, will there be substantial damage to property, public health or safety?  
 Yes     No    (If no, all owners must sign this application.)

If the application proposes a surface water change in point of diversion, a groundwater change in point of diversion greater than 300 feet, or a change in place of use, the application must be signed by all owners of the currently authorized place of use, or their duly authorized agent (attach notarized statement authorizing representation).

I hereby verify, being first duly sworn upon my oath or affirmation and under penalty of perjury, that I am of lawful age and the owner, the spouse of the owner, or a duly authorized agent of the owner(s) to make this application on their behalf, in regards to the water right(s) to which this application pertains. I further verify that the statements contained in this application are true, correct and complete.

Dated at SCOTT CITY 1, Kansas, this 20 day of April, 2023.

<p><u>Lee Mayo</u>          (Owner)  <u>Lee Mayo</u>          (Please Print)</p>	<p>_____          (Spouse)</p>
<p>_____          (Owner)</p>	<p>_____          (Spouse)</p>
<p>_____          (Please Print)</p>	<p>_____          (Please Print)</p>
<p>_____          (Owner)</p>	<p>_____          (Spouse)</p>
<p>_____          (Please Print)</p>	<p>_____          (Please Print)</p>

State of Kansas }  
 County of SCOTT } SS

I hereby certify that the foregoing application was signed in my presence and sworn to before me this 20<sup>th</sup> day of April, 2023.

My Commission Expires \_\_\_\_\_

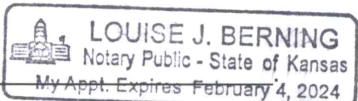

[Signature]  
 \_\_\_\_\_  
 Notary Public

**ONLY COMPLETE APPLICATIONS WILL BE PROCESSED.** To be complete, all of the applicable portions of the application form must be completed with accurate information; maps, if necessary, must be included; signatures of all the appropriate owners' must be affixed to the application and notarized; and the appropriate fee must be paid.

**FEE SCHEDULE**

Each application to change the place of use or the point of diversion under this section shall be accompanied by the application fee set forth in the schedule below: Make checks payable to: **Kansas Department of Agriculture**

(1) Application to change a point of diversion 300 feet or less .....	\$100
(2) Application to change a point of diversion more than 300 feet .....	\$200
(3) Application to change the place of use .....	\$200

**SUMMARY ORDER APPROVING APPLICATION FOR CHANGE AND IMPOSING CONDITIONS**

This Summary Order is issued under authority of K.S.A. 82a-708b, as amended, and K.A.R. 5-5-1, et seq. and other applicable provisions of the *Kansas Water Appropriation Law, K.S.A. 82a-701 et. seq.*, and rules and regulations promulgated thereunder, With the exception of those conditions expressly contained herein, this Summary Order does not change the terms, conditions and limitations of File No. 34,127.

1. A change application was received on April 20, 2023 requesting that the place of use and / or point of diversion authorized under the above-referenced file number be changed as described in the application.
2. On and after the effective date of this summary order, the authorized place(s) of use shall be located substantially as shown on the topographic map accompanying the application to change the place of use.  Applicable  Not Applicable
3. The change in point of diversion shall not impair existing rights and shall be limited to the same source or sources of water as previously authorized. The point of diversion authorized by this summary order shall be located within a 50 foot radius of the authorized point(s) of diversion.  Applicable  Not Applicable
4. The point(s) of diversion described herein is administratively corrected to be more accurately described using the Global Positioning System (GPS), as described in the application.  Applicable  Not Applicable
5. The point(s) of diversion authorized herein shall not actually be located more than 300 feet from the previously authorized point(s) of diversion.  Applicable  Not Applicable
6. As required by K.A.R. 5-3-5d, if the works for diversion is a well with a diversion rate of 100 gallons per minute or more, a tube or other device suitable for making water level measurements shall be installed, operated and maintained in accordance with K.A.R. 5-6-13.  Applicable  Not Applicable
7. **The owner of the authorized place(s) of use shall properly install an acceptable water flow meter on or before December 31, 2023**, or before the first use of water, whichever occurs first. The water flow meter shall be installed, operated and maintained in accordance with K.A.R. 5-1-4 through 5-1-12. As required by K.S.A. 82a-732, as amended, and K.A.R. 5-3-5e, the owner shall maintain records and report the reading of the water flow meter and the total quantity of water diverted annually to the Chief Engineer by March 1 following the end of each calendar year.  Applicable  Not Applicable
8. **Installation of the works for diversion of water shall be completed on or before December 31, 2023**, or within any authorized extension of time. By March 1, 2024 the applicant shall notify the Chief Engineer that construction of the works for diversion has been completed, on the form provided by the Chief Engineer, as required by K.A.R. 5-8-4e.  Applicable  Not Applicable
9. **The completed well log shall be submitted with the required notice.**  Applicable  Not Applicable
10. All diversion works into which any type of chemical or other foreign substance will be injected into the water shall be equipped with an in-line, automatic, quick-closing check valve capable of preventing pollution of the source of the water supply. The check valve(s) shall be installed, operated and maintained in accordance with K.A.R. 5-3-5c.  Applicable  Not Applicable
11. Additional Conditions are attached.  Yes  No
12. In accordance with K.S.A. 82a-708a, as amended, and K.A.R. 5-5-14, all of the owners of the authorized place(s) of use of water appropriated under the above-referenced file number are responsible for compliance with its terms, conditions and limitations, as amended and/or supplemented by this Summary Order, and with applicable provisions of the *Kansas Water Appropriation Law* and the *Rules and Regulations* promulgated thereunder. Failure to comply with these provisions may result in civil penalties pursuant to K.S.A. 82a-737, as amended, and/or the suspension or revocation and dismissal of the water or appropriation right or any other enforcement actions authorized by law.

**Administrative Appeal and Effective Date of Order**

If you are aggrieved by this order, pursuant to K.S.A. 82a-1901, you may request an evidentiary hearing before the Chief Engineer or request administrative review by the Secretary of Agriculture. A request for hearing by the Chief Engineer must be filed within **15 days** of service of this Order and a request for administrative review by the Secretary must be filed within **30 days** pursuant to K.S.A. 77-531. Any request for administrative review must state a basis for review pursuant to K.S.A. 77-527. File any request with **Kansas Department of Agriculture, Legal Division, 1320 Research Park Drive, Manhattan, KS 66502**. Failure to timely request a hearing or review may preclude review under the Kansas Judicial Review Act.

*For Use by Register of Deeds*

FOR OFFICE USE ONLY  
**APPLICATION APPROVED AND  
 SUMMARY ORDER ISSUED**

By: Michael A. Meyer  
 Duly Authorized Designee of the Chief Engineer  
 (Print Name): MICHAEL A. MEYER  
 Division of Water Resources - Kansas Department of Agriculture  
 Date of Issuance: May 4, 2023  
 State of Kansas )  
 County of Finney ) SS  
 Acknowledged before me on May 1, 2023  
 by Michael A. Meyer  
 Signature: Julie Jones  
 Notary Public

My commission expires:

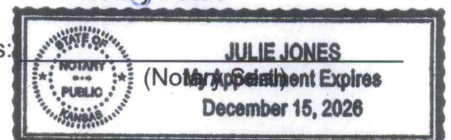





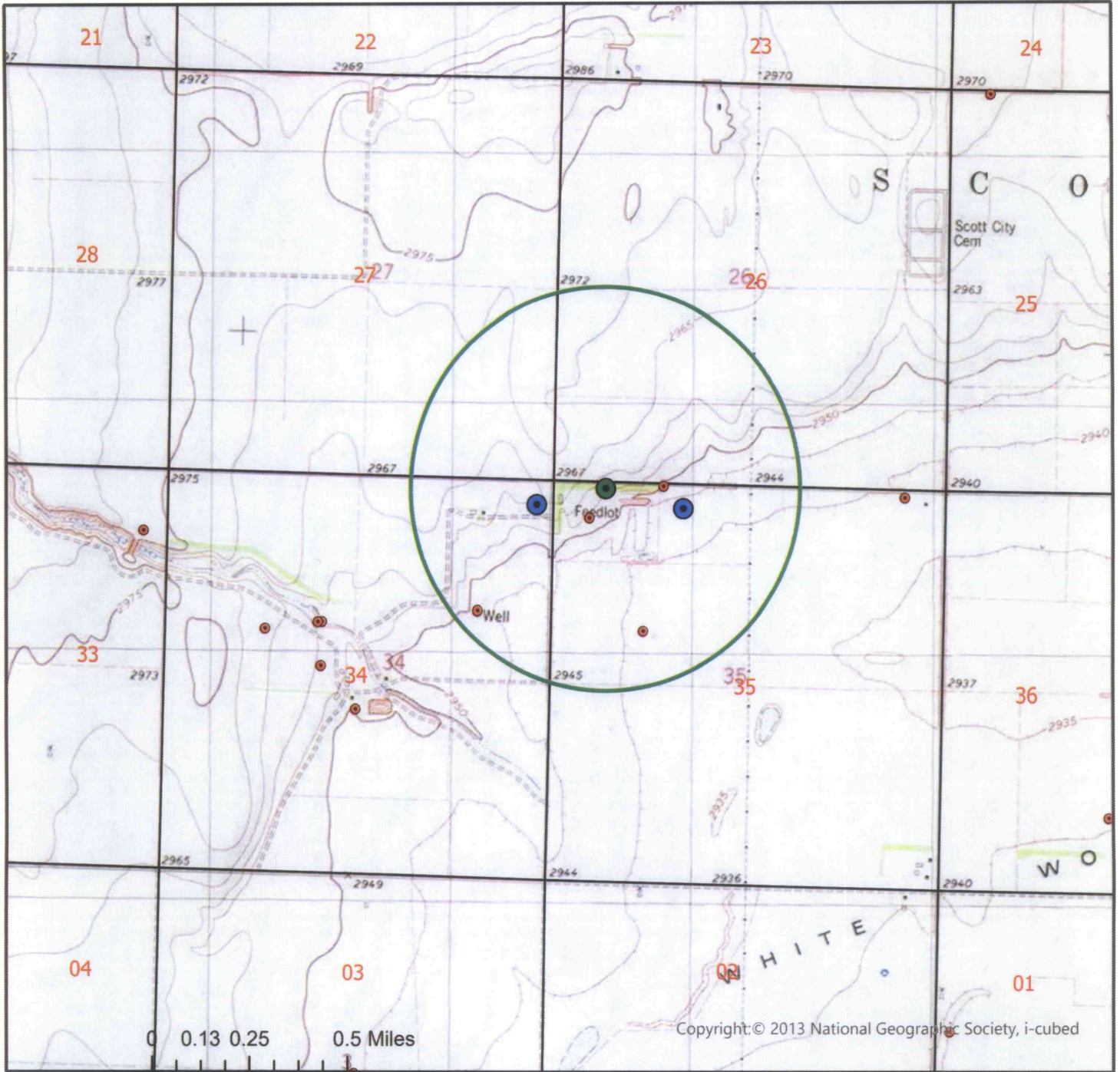

# CHANGE IN PLACE OF DIVERSION WATER RIGHT, FILE NO. 34127

NW 1/4 of Section 35 Township 18 South Range 33 West SCOTT County



	Authorized Point of Diversion
	Proposed Point of Diversion
	Domestic Well within 1/2 mile
	1/2 mile buffer

List of owner name and addresses within 1/2 mile:



All wells of any kind within 1/2 mile of the requested place of use have been plotted.

*[Handwritten Signature]*

(Signature)

Date

Date JG/GCFO  
1:24,000 Scale





# HRC FEEDYARD - #2

NW 35-18S-33W SCOTT CO.

Legend



WRd 190

WRd 190

HRC TH 2023 ELEV=2962'

WELL 1999 ELEV=2950'

Google Earth

700 ft







---

WESTERN KANSAS GROUNDWATER MANAGEMENT DISTRICT NO.1

Garden City Field Office  
4532 W. Jones, Suite B  
Garden City, KS 67846

April 25<sup>th</sup>, 2023

Re: Water Right File No. 17125

Dear Sir or Madam:

The Western Kansas Groundwater Management District No. 1 Staff has reviewed the application to change the Point of Diversion for Water Right No. 17125 and is providing recommendation for this application. It is noted that Water Right File No. 8716 will also be moved to this new proposed location.

If you have any questions or concerns, please feel free to reach out to District staff.

Regards,

Katie Durham  
District Manager  
GMD1

RECEIVED

APR 25 2023

Garden City Field Office  
Division of Water Resources

Garden City Field Office  
4532 W. Jones, Suite A  
Garden City, KS 67846



Phone: 620-276-2901  
Fax: 620-276-9315  
[www.agriculture.ks.gov](http://www.agriculture.ks.gov)

Mike Beam, Secretary

Laura Kelly, Governor

April 24, 2023

WESTERN KANSAS GROUNDWATER  
906 W. 5th  
P.O. BOX 604  
SCOTT CITY KS 67871

Re: Water Right File No. 17125.05

Dear Ms. Durham:

This is to advise you that HRC Feed Yards LLC has filed an application for approval of the Chief Engineer, Division of Water Resources, Kansas Department of Agriculture, to change the point of diversion for the above referenced file. This application meets the current rules and spacing is being increased from current spacing to other existing wells. Please note that File No. 8716.05 will be also moved to this new proposed location which is a less than 300 feet move to the proposed location which we will process.

We are delaying action on the change application to allow you time to review and provide a recommendation. Please submit a recommendation within 15 days from the date of this letter.

Thank you and as always feel free to contact this office at any time.

Sincerely,

A handwritten signature in blue ink that reads "Michael A. Meyer".

Michael A. Meyer  
Water Commissioner

MAM  
Enclosures