

NOTICE

This scan only represents the application as filed. The information contained herein meets the requirements of K.A.R. 5-3-1 or K.A.R. 5-5-1, and has been found acceptable for filing in the office of the Chief Engineer. The application should not be considered to be a complete application as per K.A.R. 5-3-1b or K.A.R. 5-5-2a.

AUG 28 2023

1215

KS DEPT OF AGRICULTURE



State of Kansas

Submit To: CHIEF ENGINEER
Division of Water Resources
Kansas Department of Agriculture
1320 Research Park Drive
Manhattan, Kansas 66502
http://agriculture.ks.gov/dwr

APPLICATION FOR APPROVAL TO CHANGE THE PLACE OF USE, THE POINT OF DIVERSION OR THE USE MADE OF THE WATER UNDER AN EXISTING WATER RIGHT

Filing Fee Must Accompany the Application
(Please refer to Fee Schedule on signature page of application form.)

Paragraph Nos. 1, 2, 3, 4 & 8 must be completed. Complete all other applicable portions. A topographic map or detailed plat showing the authorized and proposed points(s) of diversion and /or place of use must accompany this application.

1. Application is hereby made for approval of the Chief Engineer to change the

- Place of Use
Point of Diversion
Use Made of Water

File No. 44946

2. Name of applicant: HIGH PLAINS PONDEROSA DAIRY LLC

Address: 2042 V RD

City, State and Zip: PLAINS KS 67869

Phone Number: () E-mail address:

What is your relationship to the water right; owner tenant agent other? If other, please explain.

Name of water use correspondent: PARITY INVESTMENTS INC

Address: 303 MAIN

City, State and Zip: KISMET KS 67859 - 9612

Phone Number: () E-mail address:

3. The change(s) proposed herein are desired for the following reasons (please be specific): ADJUST THE CURRENT PLACE OF USE TO ACCOMMODATE AN EXPANSION OF A DAIRY

The change(s) (was) (will be) completed by (Date) 8/30/2023 LMoody

For Office Use Only:
F.O. 4 GMD 3 Meets K.A.R. 5-5-1 (YES/NO) Use IRR Source G/S County SW By ALB Date 8/28/23
Code CPLA Fee \$ 200 TR # Receipt Date 8/28/23 Check # 76187

4. The presently authorized place of use is:

Owner of Land — NAME: SEE ATTACHED SUPPLEMENTAL SHEET

ADDRESS: _____

| Sec. | Twp. | Range | NE¼ | | | | NW¼ | | | | SW¼ | | | | SE¼ | | | | TOTAL ACRES |
|------|------|-------|-----|-----|-----|-----|-----|-----|-----|-----|-----|-----|-----|-----|-----|-----|-----|-----|-------------|
| | | | NE¼ | NW¼ | SW¼ | SE¼ | NE¼ | NW¼ | SW¼ | SE¼ | NE¼ | NW¼ | SW¼ | SE¼ | NE¼ | NW¼ | SW¼ | SE¼ | |
| | | | | | | | | | | | | | | | | | | | |
| | | | | | | | | | | | | | | | | | | | |
| | | | | | | | | | | | | | | | | | | | |

List any other water rights that cover this place of use. _____

Owner of Land — NAME: _____

ADDRESS: _____

| Sec. | Twp. | Range | NE¼ | | | | NW¼ | | | | SW¼ | | | | SE¼ | | | | TOTAL ACRES |
|------|------|-------|-----|-----|-----|-----|-----|-----|-----|-----|-----|-----|-----|-----|-----|-----|-----|-----|-------------|
| | | | NE¼ | NW¼ | SW¼ | SE¼ | NE¼ | NW¼ | SW¼ | SE¼ | NE¼ | NW¼ | SW¼ | SE¼ | NE¼ | NW¼ | SW¼ | SE¼ | |
| | | | | | | | | | | | | | | | | | | | |
| | | | | | | | | | | | | | | | | | | | |
| | | | | | | | | | | | | | | | | | | | |

List any other water rights that cover this place of use. _____

(If there are more than two landowners, attach additional sheets as necessary.)

WATER RESOURCES
RECEIVED

AUG 28 2023

5. It is proposed that the place of use be changed to:

Owner of Land — NAME: SEE ATTACHED SUPPLEMENTAL SHEET

ADDRESS: _____

KS DEPT OF AGRICULTURE

| Sec. | Twp. | Range | NE¼ | | | | NW¼ | | | | SW¼ | | | | SE¼ | | | | TOTAL ACRES |
|------|------|-------|-----|-----|-----|-----|-----|-----|-----|-----|-----|-----|-----|-----|-----|-----|-----|-----|-------------|
| | | | NE¼ | NW¼ | SW¼ | SE¼ | NE¼ | NW¼ | SW¼ | SE¼ | NE¼ | NW¼ | SW¼ | SE¼ | NE¼ | NW¼ | SW¼ | SE¼ | |
| | | | | | | | | | | | | | | | | | | | |
| | | | | | | | | | | | | | | | | | | | |
| | | | | | | | | | | | | | | | | | | | |

List any other water rights that cover this place of use. _____

Owner of Land — NAME: _____

ADDRESS: _____

| Sec. | Twp. | Range | NE¼ | | | | NW¼ | | | | SW¼ | | | | SE¼ | | | | TOTAL ACRES |
|------|------|-------|-----|-----|-----|-----|-----|-----|-----|-----|-----|-----|-----|-----|-----|-----|-----|-----|-------------|
| | | | NE¼ | NW¼ | SW¼ | SE¼ | NE¼ | NW¼ | SW¼ | SE¼ | NE¼ | NW¼ | SW¼ | SE¼ | NE¼ | NW¼ | SW¼ | SE¼ | |
| | | | | | | | | | | | | | | | | | | | |
| | | | | | | | | | | | | | | | | | | | |
| | | | | | | | | | | | | | | | | | | | |

List any other water rights that cover this place of use. _____

IF MORE SPACE IS NEEDED, ATTACH ADDITIONAL SHEETS AS NECESSARY

APPLICATION FOR APPROVAL TO CHANGE
THE PLACE OF USE
SUPPLEMENTAL SHEET – IRRIGATION USE
FILE NOS. 22306; 26247; 40445; 41192; 41578;
41579; 41580; 41581; 42084; 42110; 42708; 43082;
43105; 43220; 43333; 43635; 43880; 44248; 44945; 44946; 45295
MAKE ADDITIONAL COPIES AS NECESSARY

WATER RESOURCES
RECEIVED

AUG 28 2023

KS DEPT OF AGRICULTURE

3. Continued: The presently authorized place of use is:

Owner of Land ---- NAME: CARL RAY & ZITA BOND

ADDRESS: PO BOX 265 GIRARD KS 66743

| Sec. | Twp. | Range | NE¼ | | | | NW¼ | | | | SW¼ | | | | SE¼ | | | | TOTAL ACRES |
|------|------|-------|-------|-------|-------|-------|-----|-----|-----|-----|-----|-----|-----|-----|-----|-----|-----|-----|-------------|
| | | | NE¼ | NW¼ | SW¼ | SE¼ | NE¼ | NW¼ | SW¼ | SE¼ | NE¼ | NW¼ | SW¼ | SE¼ | NE¼ | NW¼ | SW¼ | SE¼ | |
| 34 | 33S | 31W | 30.75 | 30.75 | 30.75 | 30.75 | | | | | | | | | | | | | 123 |

Owner of Land ---- NAME: ORMISTON TRUST OF 1992 / ORMISTON DESCENDANTS TRUST

ADDRESS: 303 MAIN ST KISMET KS 67859

| Sec. | Twp. | Range | NE¼ | | | | NW¼ | | | | SW¼ | | | | SE¼ | | | | TOTAL ACRES |
|------|------|-------|-----|-----|-----|-----|------|------|------|------|-----|-----|-----|-----|------|-----|-----|-----|-------------|
| | | | NE¼ | NW¼ | SW¼ | SE¼ | NE¼ | NW¼ | SW¼ | SE¼ | NE¼ | NW¼ | SW¼ | SE¼ | NE¼ | NW¼ | SW¼ | SE¼ | |
| 13 | 33S | 31W | | | | | 32.5 | 32.5 | 32.5 | 32.5 | | | | | 14.5 | 34 | 40 | 34 | 252.5 |

Owner of Land ---- NAME: SOUTHWEST AGRI-CENTER INC

ADDRESS: 303 MAIN ST KISMET KS 67859

| Sec. | Twp. | Range | NE¼ | | | | NW¼ | | | | SW¼ | | | | SE¼ | | | | TOTAL ACRES | |
|------|------|-------|------|------|------|------|-------|-------|-------|-------|-----|-----|-----|-----|-------|-------|-------|-------|-------------|-----|
| | | | NE¼ | NW¼ | SW¼ | SE¼ | NE¼ | NW¼ | SW¼ | SE¼ | NE¼ | NW¼ | SW¼ | SE¼ | NE¼ | NW¼ | SW¼ | SE¼ | | |
| 23 | 33S | 31W | | | | | | | | | | | | | | | | | | 260 |
| 28 | 33S | 31W | | | | | | | | | | | | | 24 | 24 | 35 | 35 | 118 | |
| 33 | 33S | 31W | 33 | 33 | 30.5 | 30.5 | | | | | | | | | | | | | 127 | |
| 24 | 33S | 31W | | | | | 30.75 | 30.75 | 30.75 | 30.75 | | | | | | | | | 123 | |
| 27 | 33S | 31W | 31.5 | 31.5 | 31.5 | 31.5 | | | | | | | | | 31.25 | 31.25 | 31.25 | 31.25 | 251 | |

Owner of Land ---- NAME: HIGH PLAINS PONDEROSA DAIRY LLC

ADDRESS: 2042 V RD PLAINS KS 67869

| Sec. | Twp. | Range | NE¼ | | | | NW¼ | | | | SW¼ | | | | SE¼ | | | | TOTAL ACRES |
|------|------|-------|------|-----|-----|-----|-------|-------------|--------------|--------------|-------|-----------|--------------|--------------|-------|-------|-----|------|-------------|
| | | | NE¼ | NW¼ | SW¼ | SE¼ | NE¼ | NW¼ | SW¼ | SE¼ | NE¼ | NW¼ | SW¼ | SE¼ | NE¼ | NW¼ | SW¼ | SE¼ | |
| 30 | 33S | 30W | | | | | 30.75 | 30.75 | L-1 30.75 | L-2 30.75 | 30.75 | 30.75 | | | | | | | 123 |
| 19 | 33S | 30W | 14.5 | 34 | 40 | 34 | 34 | L-1 14.5 | L-2 34 | 40 | 40 | L-3 34 | L-4 14.5 | 34 | 34 | 40 | 34 | 14.5 | 490 |
| 31 | 33S | 30W | | | | | | | | | | 30.75 | L-3 30.75 | L-4 30.75 | 30.75 | 30.75 | | | 123 |
| 7 | 33S | 30W | | | | | | | | | | 40 | L-3 38.22 | L-4 21.38 | 22.4 | | | | 122 |

Owner of Land ---- NAME: PARITY INVESTMENTS INC

ADDRESS: 303 MAIN KISMET KS 67859 - 9612

| Sec. | Twp. | Range | NE¼ | | | | NW¼ | | | | SW¼ | | | | SE¼ | | | | TOTAL ACRES |
|------|------|-------|-------|-------|-------|-------|-------|--------------|--------------|-------|-------|-------|-------|-------|-------|-----|-----|-----|-------------|
| | | | NE¼ | NW¼ | SW¼ | SE¼ | NE¼ | NW¼ | SW¼ | SE¼ | NE¼ | NW¼ | SW¼ | SE¼ | NE¼ | NW¼ | SW¼ | SE¼ | |
| 36 | 33S | 31W | 30.75 | 30.75 | 30.75 | 30.75 | | | | | | | | | | | | | 123 |
| 31 | 33S | 30W | | | | | 30.75 | L-1 30.75 | L-2 30.75 | 30.75 | 30.75 | | | | | | | | 123 |
| 27 | 33S | 31W | | | | | | | | | | 31.25 | 31.25 | 31.25 | 31.25 | | | | 125 |
| 34 | 33S | 31W | | | | | 27.5 | 27.5 | 27.5 | 27.5 | | | | | | | | | 110 |
| 35 | 33S | 31W | 30.75 | 30.75 | 30.75 | 30.75 | 30.75 | 30.75 | 30.75 | 30.75 | | | | | | | | | 246 |
| 25 | 33S | 31W | | | | | | | | | | 30.75 | 30.75 | 30.75 | 30.75 | | | | 123 |
| 35 | 33S | 31W | | | | | | | | | | 30.75 | 30.75 | 30.75 | 30.75 | | | | 123 |

AUG 28 2023

Owner of Land ---- NAME: ROCK A & STEPHANIE K ORMISTON II
ADDRESS: PO BOX 43 KISMET KS 67859 - 0043

| Sec. | Twp. | Range | NE¼ | | | | NW¼ | | | | SW¼ | | | | SE¼ | | | | TOTAL ACRES |
|------|------|-------|-----|-----|-----|-----|-----|-----|-----|-----|-----|-----|-----|-----|-----|-----|-----|-----|-------------|
| | | | NE¼ | NW¼ | SW¼ | SE¼ | NE¼ | NW¼ | SW¼ | SE¼ | NE¼ | NW¼ | SW¼ | SE¼ | NE¼ | NW¼ | SW¼ | SE¼ | |
| 13 | 33S | 31W | | | | | | | | | | | | | | | | | 122.5 |

Owner of Land ---- NAME: SOUTHWEST AGRI-CENTER INC / ROCK A & STEPHANIE K ORMISTON II
ADDRESS: 303 MAIN ST KISMET KS 67859 / PO BOX 43 KISMET KS 67859 - 0043

| Sec. | Twp. | Range | NE¼ | | | | NW¼ | | | | SW¼ | | | | SE¼ | | | | TOTAL ACRES |
|------|------|-------|-----|-----|-----|-----|-----|-----|-----|-----|-----|-----|-----|-----|-----|-----|-----|-----|-------------|
| | | | NE¼ | NW¼ | SW¼ | SE¼ | NE¼ | NW¼ | SW¼ | SE¼ | NE¼ | NW¼ | SW¼ | SE¼ | NE¼ | NW¼ | SW¼ | SE¼ | |
| 24 | 33S | 31W | 18 | 12 | 31 | 31 | | | | | | | | | | | | | 92 |

APPLICATION FOR APPROVAL TO CHANGE
THE PLACE OF USE
SUPPLEMENTAL SHEET – IRRIGATION USE
**FILE NOS. 22306; 26247; 40445; 41192; 41578;
41579; 41580; 41581; 42084; 42110; 42708; 43082;
43105; 43220; 43333; 43635; 43880; 44248; 44945; 44946; 45295**
MAKE ADDITIONAL COPIES AS NECESSARY

WATER RESOURCES
RECEIVED

AUG 28 2023

KS DEPT OF AGRICULTURE

4. *Continued:* If this application is for a change in place of use, it is proposed that the place of use be changed to:

Owner of Land ---- NAME: CARL RAY & ZITA BOND

ADDRESS: PO BOX 265 GIRARD KS 66743

| Sec. | Twp. | Range | NE¼ | | | | NW¼ | | | | SW¼ | | | | SE¼ | | | | TOTAL ACRES |
|------|------|-------|-------|-------|-------|-------|-----|-----|-----|-----|-----|-----|-----|-----|-----|-----|-----|-----|-------------|
| | | | NE¼ | NW¼ | SW¼ | SE¼ | NE¼ | NW¼ | SW¼ | SE¼ | NE¼ | NW¼ | SW¼ | SE¼ | NE¼ | NW¼ | SW¼ | SE¼ | |
| 34 | 33S | 31W | 30.75 | 30.75 | 30.75 | 30.75 | | | | | | | | | | | | | 123 |

Owner of Land ---- NAME: ORMISTON TRUST OF 1992 / ORMISTON DESCENDANTS TRUST

ADDRESS: 303 MAIN ST KISMET KS 67859

| Sec. | Twp. | Range | NE¼ | | | | NW¼ | | | | SW¼ | | | | SE¼ | | | | TOTAL ACRES |
|------|------|-------|-----|-----|-----|-----|------|------|------|------|-----|-----|-----|-----|------|-----|-----|-----|-------------|
| | | | NE¼ | NW¼ | SW¼ | SE¼ | NE¼ | NW¼ | SW¼ | SE¼ | NE¼ | NW¼ | SW¼ | SE¼ | NE¼ | NW¼ | SW¼ | SE¼ | |
| 13 | 33S | 31W | | | | | 32.5 | 32.5 | 32.5 | 32.5 | | | | | 14.5 | 34 | 40 | 34 | 252.5 |

Owner of Land ---- NAME: SOUTHWEST AGRI-CENTER INC

ADDRESS: 303 MAIN ST KISMET KS 67859

| Sec. | Twp. | Range | NE¼ | | | | NW¼ | | | | SW¼ | | | | SE¼ | | | | TOTAL ACRES |
|------|------|-------|------|------|------|------|-------|-------|-------|-------|-----|-----|-----|-----|-------|-------|-------|-------|-------------|
| | | | NE¼ | NW¼ | SW¼ | SE¼ | NE¼ | NW¼ | SW¼ | SE¼ | NE¼ | NW¼ | SW¼ | SE¼ | NE¼ | NW¼ | SW¼ | SE¼ | |
| 23 | 33S | 31W | | | | | | | | | | | | | 32.5 | 32.5 | 32.5 | 32.5 | 260 |
| 28 | 33S | 31W | | | | | | | | | | | | | 24 | 24 | 35 | 35 | 118 |
| 33 | 33S | 31W | 33 | 33 | 30.5 | 30.5 | | | | | | | | | | | | | 127 |
| 24 | 33S | 31W | | | | | 30.75 | 30.75 | 30.75 | 30.75 | | | | | | | | | 123 |
| 27 | 33S | 31W | 31.5 | 31.5 | 31.5 | 31.5 | | | | | | | | | 31.25 | 31.25 | 31.25 | 31.25 | 251 |

Owner of Land ---- NAME: HIGH PLAINS PONDEROSA DAIRY LLC

ADDRESS: 2042 V RD PLAINS KS 67869

| Sec. | Twp. | Range | NE¼ | | | | NW¼ | | | | SW¼ | | | | SE¼ | | | | TOTAL ACRES | |
|------|------|-------|------|-----|-----|-----|-------|--------------|--------------|-------|-----|-----------|--------------|--------------|-------|-----|-----|------|-------------|-----|
| | | | NE¼ | NW¼ | SW¼ | SE¼ | NE¼ | NW¼ | SW¼ | SE¼ | NE¼ | NW¼ | SW¼ | SE¼ | NE¼ | NW¼ | SW¼ | SE¼ | | |
| 30 | 33S | 30W | | | | | 30.75 | L-1 30.75 | L-2 30.75 | 30.75 | | | | | | | | | 123 | |
| 19 | 33S | 30W | 14.5 | 34 | 40 | 34 | 34 | L-1 14.5 | L-2 34 | 40 | 40 | L-3 34 | L-4 14.5 | 34 | 34 | 40 | 34 | 14.5 | 490 | |
| 31 | 33S | 30W | | | | | | | | | | 30.75 | L-3 30.75 | L-4 30.75 | 30.75 | | | | 123 | |
| 12 | 33S | 31W | | | | | | | | | | | 5 | 25 | | 30 | 20 | 20 | 22 | 122 |

Owner of Land ---- NAME: PARITY INVESTMENTS INC

ADDRESS: 303 MAIN KISMET KS 67859 - 9612

| Sec. | Twp. | Range | NE¼ | | | | NW¼ | | | | SW¼ | | | | SE¼ | | | | TOTAL ACRES |
|------|------|-------|-------|-------|-------|-------|-------|--------------|--------------|-------|-------|-------|-------|-------|-----|-----|-----|-----|-------------|
| | | | NE¼ | NW¼ | SW¼ | SE¼ | NE¼ | NW¼ | SW¼ | SE¼ | NE¼ | NW¼ | SW¼ | SE¼ | NE¼ | NW¼ | SW¼ | SE¼ | |
| 36 | 33S | 31W | 30.75 | 30.75 | 30.75 | 30.75 | | | | | | | | | | | | | 123 |
| 31 | 33S | 30W | | | | | 30.75 | L-1 30.75 | L-2 30.75 | 30.75 | | | | | | | | | 123 |
| 27 | 33S | 31W | | | | | | | | | 31.25 | 31.25 | 31.25 | 31.25 | | | | | 125 |
| 34 | 33S | 31W | | | | | 31.25 | 16.25 | 31.25 | 31.25 | | | | | | | | | 110 |
| 35 | 33S | 31W | 30.75 | 30.75 | 30.75 | 30.75 | 30.75 | 30.75 | 30.75 | 30.75 | | | | | | | | | 246 |
| 25 | 33S | 31W | | | | | | | | | 30.75 | 30.75 | 30.75 | 30.75 | | | | | 123 |
| 35 | 33S | 31W | | | | | | | | | 30.75 | 30.75 | 30.75 | 30.75 | | | | | 123 |

AUG 28 2023

KS DEPT OF AGRICULTURE

Owner of Land ---- NAME: ROCK A & STEPHANIE K ORMISTON II
 ADDRESS: PO BOX 43 KISMET KS 67859 - 0043



| Sec. | Twp. | Range | NE¼ | | | | NW¼ | | | | SW¼ | | | | SE¼ | | | | TOTAL ACRES |
|------|------|-------|-----|-----|-----|-----|-----|-----|-----|-----|-----|------|-----|-----|-----|-----|-----|-----|----------------|
| | | | NE¼ | NW¼ | SW¼ | SE¼ | NE¼ | NW¼ | SW¼ | SE¼ | NE¼ | NW¼ | SW¼ | SE¼ | NE¼ | NW¼ | SW¼ | SE¼ | |
| 13 | 33S | 31W | | | | | | | | | 34 | 14.5 | 34 | 40 | | | | | 122.5 |

Owner of Land ---- NAME: SOUTHWEST AGRI-CENTER INC / ROCK A & STEPHANIE K ORMISTON II
 ADDRESS: 303 MAIN ST KISMET KS 67859 / PO BOX 43 KISMET KS 67859 - 0043

| Sec. | Twp. | Range | NE¼ | | | | NW¼ | | | | SW¼ | | | | SE¼ | | | | TOTAL ACRES |
|------|------|-------|-----|-----|-----|-----|-----|-----|-----|-----|-----|-----|-----|-----|-----|-----|-----|-----|----------------|
| | | | NE¼ | NW¼ | SW¼ | SE¼ | NE¼ | NW¼ | SW¼ | SE¼ | NE¼ | NW¼ | SW¼ | SE¼ | NE¼ | NW¼ | SW¼ | SE¼ | |
| 24 | 33S | 31W | 18 | 12 | 31 | 31 | | | | | | | | | | | | | 92 |

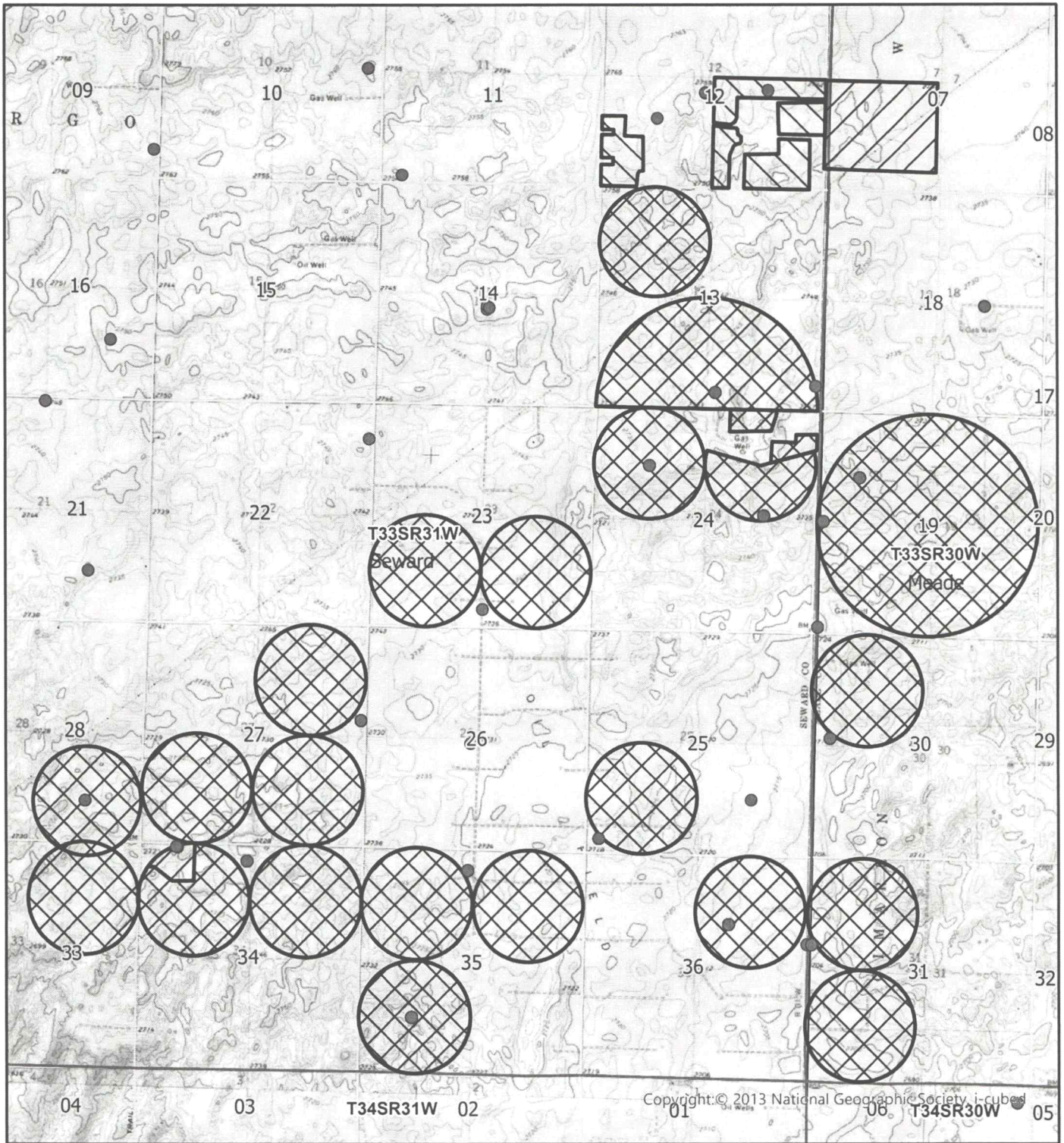
CHANGE IN PLACE OF USE



-  Permitted Water Right
-  Authorized Place of Use
-  Proposed Place of Use

File Nos. :
 22306; 26247; 40445; 41192; 41578;
 41579; 41580; 41581; 42084; 42110;
 42708; 43082; 43105; 43220; 43333;
 43635; 43880; 44248; 44945; 44946;
 45295

Irrigation Use



WATER RESOURCES RECEIVED

AUG 28 2023

- 6. The presently authorized point(s) of diversion (is) (are) ONE WELL; PUMP & MOTOR
(Provide description and number of points)
- 7. The proposed point(s) of diversion (is) (are) ONE WELL; PUMP & MOTOR
(Provide description and number of points)

List all presently authorized point(s) of diversion:

8. **Presently authorized point of diversion:**
 One in the _____ Quarter of the _____ Quarter of the _____ Quarter
 of Section _____, Township _____ South, Range _____ (E/W),
 in _____ County, Kansas, _____ feet North _____ feet West of Southeast corner of section.
 Authorized Rate _____ Authorized Quantity _____
 (DWR use only: Computer ID No. _____ GPS _____ feet North _____ feet West)
 This point will not be changed This point will be changed as follows:
Proposed point of diversion: (Complete only if change is requested)
 One in the _____ Quarter of the _____ Quarter of the _____ Quarter
 of Section _____, Township _____ South, Range _____ (E/W),
 in _____ County, Kansas, _____ feet North _____ feet West of Southeast corner of section.
 Proposed Rate _____ Proposed Quantity _____
 This point is: Additional Well Geo Center List other water rights that will use this point _____

WATER RESOURCES
RECEIVED

AUG 28 2023

KS DEPT OF AGRICULTURE

9. **Presently authorized point of diversion:**
 One in the _____ Quarter of the _____ Quarter of the _____ Quarter
 of Section _____, Township _____ South, Range _____ (E/W),
 in _____ County, Kansas, _____ feet North _____ feet West of Southeast corner of section.
 Authorized Rate _____ Authorized Quantity _____
 (DWR use only: Computer ID No. _____ GPS _____ feet North _____ feet West)
 This point will not be changed This point will be changed as follows:
Proposed point of diversion: (Complete only if change is requested)
 One in the _____ Quarter of the _____ Quarter of the _____ Quarter
 of Section _____, Township _____ South, Range _____ (E/W),
 in _____ County, Kansas, _____ feet North _____ feet West of Southeast corner of section.
 Proposed Rate _____ Proposed Quantity _____
 This point is: Additional Well Geo Center List other water rights that will use this point _____

10. **Presently authorized point of diversion:**
 One in the _____ Quarter of the _____ Quarter of the _____ Quarter
 of Section _____, Township _____ South, Range _____ (E/W),
 in _____ County, Kansas, _____ feet North _____ feet West of Southeast corner of section.
 Authorized Rate _____ Authorized Quantity _____
 (DWR use only: Computer ID No. _____ GPS _____ feet North _____ feet West)
 This point will not be changed This point will be changed as follows:
Proposed point of diversion: (Complete only if change is requested)
 One in the _____ Quarter of the _____ Quarter of the _____ Quarter
 of Section _____, Township _____ South, Range _____ (E/W),
 in _____ County, Kansas, _____ feet North _____ feet West of Southeast corner of section.
 Proposed Rate _____ Proposed Quantity _____
 This point is: Additional Well Geo Center List other water rights that will use this point _____

11. Describe the current condition of and future plans for any point(s) of diversion which will no longer be used. _____

IF MORE SPACE IS NEEDED, ATTACH ADDITIONAL SHEETS AS NECESSARY

12. The presently authorized use of water is for IRRIGATION purposes.

It is proposed that the use be changed to NO CHANGE purposes.

13. If changing the place of use and/or use made of water, describe how the consumptive use will not be increased.

NO CHANGE IN CONSUMPTIVE USE – NO INCREASE IN ACRES PROPOSED

**WATER RESOURCES
RECEIVED**

UTILIZATION OF EFFLUENT TO SUPPLEMENT IRRIGATION

AUG 28 2023

KS DEPT OF AGRICULTURE

(Please show any calculations here.)

14. It is requested that the maximum annual quantity of water be reduced to _____ (acre-feet or million gallons).

15. It is requested that the maximum rate of diversion of water be reduced to _____ gallons per minute (_____ c.f.s.).

16. The application must include either a topographic map or detailed plat. A U.S. Geological Survey Topographic Map, scale 1:24,000, is available through the Kansas Geological Survey, 1930 Constant Avenue, University of Kansas, Lawrence, Kansas 66047-3726 (www.usgs.gov). The map should show the location of the presently authorized point(s) of diversion. Distances North and West of the Southeast corner of the section must be shown. The presently authorized place of use should also be shown. Identify the center of the section, the section lines and the section corners and show the appropriate section, township, and range numbers on the map. In addition the following information must also be shown on the map.

- a. If a change in the location of the point(s) of diversion is proposed, show:
 - 1) The location of the proposed point(s) of diversion. Distances North and West of the Southeast corner of the section must be shown. Please be certain that the information shown on the map agrees with the information shown in Paragraph Nos. 9, 10 and 11 of the application.
 - 2) If the source of supply is groundwater, please show the location of existing water wells of any kind, including domestic wells, within 1/2 mile of the proposed well or wells. Identify each well as to its use and furnish name and mailing address of the property owner or owners. If there are no wells within 1/2 mile, please indicate so on the map.
 - 3) If the source of supply is surface water, the names and mailing addresses of all landowner(s) 1/2 mile downstream and 1/2 mile upstream from your property lines must be shown.
- b. If a change in the place of use is desired, show the proposed place of use by crosshatching on the map. Please be certain that the information shown on the map agrees with the information shown in Paragraph No. 5 of the application.

17. Attach documentation to show the change(s) proposed herein will not impair existing water rights and relates to the same local source of supply as to which the water right relates. This information may include statements, plats, geology reports, well logs, test hole logs, and other information as necessary information to show the above. Additional comments may be made below.

NO IMPAIRMENT EXPECTED

18. If the proposed change(s) does not meet all applicable rules and regulations of the Kansas Water Appropriation Act, please identify the rules and regulations for which you request a waiver. State the reason why a waiver is needed and why the request should be granted. Attach documentation showing that granting the request will not impair existing water rights and will not prejudicially and unreasonably affect the public interest.

MEETS ALL RULES AND REGULATIONS

IF MORE SPACE IS NEEDED, ATTACH ADDITIONAL SHEETS AS NECESSARY

Any use of water that is not as authorized by the water right or permit to authorize water **before** the chief engineer approves this application is a violation of the Kansas Water Appropriation Act for which criminal or civil penalties may be assessed. Such violation is a class C misdemeanor, punishable by a fine not to exceed \$500 and/or a term of confinement not to exceed one month in the county jail. K.S.A. 82a-728(b). Civil penalties shall be not less than \$100 nor more than \$1,000 per violation. In the case of a continuing violation, each day such violation continues may be deemed a separate violation. In addition to these penalties the water right may be modified or suspended. K.S.A. 82a-737, as amended.

The application must be signed by all owners of the place of use authorized under the water right and his or her spouse, if married. Please indicate if there is no spouse. If land is being purchased under contract, the seller must sign as landowner until such time as the contract is completed.

In the event that all applicants cannot appear before one notary public, they may as necessary sign separate copies of the application before any notary public conveniently available to them. All copies signed in this manner shall be considered to be valid parts of the application.

If the request is signed on behalf of any Owner by someone with legal authority to do so (for example, an agent, one who has power of attorney, or an executor, executrix, conservator), it will be necessary to attach proper documents showing such authority.

I declare that I am an owner of the currently authorized place of use as identified herein, or that I represent all such owners and am authorized to make this application on their behalf, and declare further that the statements contained herein are true, correct, and complete. By filing this application I authorize the chief engineer to permanently reduce the quantity of water and/or rate of diversion as specified in sections 14 and 15 of this application.

Dated at Plains, Kansas, this 22nd day of August, 2023.

| | | |
|---------------------------------------|-------|----------------|
| <u>CA</u> (Owner) | _____ | (Spouse) |
| <u>Greg Bernard</u> (Please Print) | _____ | (Please Print) |
| _____ | _____ | (Spouse) |
| _____ | _____ | (Please Print) |
| _____ | _____ | (Spouse) |
| _____ | _____ | (Please Print) |

State of Kansas)
County of Meade) SS

I hereby certify that the foregoing application was signed in my presence and sworn to before me this 22nd day of August, 2023.

My Commission Expires 5-19-2024



RYAN REIMER
Notary Public - State of Kansas
My Appt. Expires 5-19-2024

Ryan Reimer
Notary Public

FEE SCHEDULE

Each application to change the place of use, the point of diversion or the use made of the water under this section shall be accompanied by the application fee set forth in the schedule below:

- (1) Application to change a point of diversion 300 feet or less \$100
- (2) Application to change a point of diversion more than 300 feet \$200
- (3) Application to change the place of use \$200
- (4) Application to change the use made of the water \$300

Make check payable to **Kansas Department of Agriculture.**

WATER RESOURCES
RECEIVED

AUG 28 2023

KS DEPT OF AGRICULTURE