

Kansas Department of Agriculture
 Division of Water Resources
CHANGE: P/U WORKSHEET

| | | | | |
|--|---|--|------------------------------|--|
| 1. File Number: 9422 | 2. Status Change Date: 12-19-2023 | 3. Change Num: C3 | 4. Field Office: 4 | 5. GMD: 3 |
| 6. Status: <input checked="" type="checkbox"/> Approved <input type="checkbox"/> Denied by DWR/GMD <input type="checkbox"/> Dismiss by Request/Failure to Return | | | | 7. Filing Date of Change: 12/08/2023 |
| 8a. Landowner, applicant New to system <input type="checkbox"/> RONNIE & JACQUELINE GIBSON 2198 RD 4 COPELAND, KS 67837 | | 8c. Landowner(s) New to system <input type="checkbox"/> Person ID <u>40799</u> Add Seq# _____ | | |
| 8b. Landowner(s), New to system <input checked="" type="checkbox"/> LEVI & MEGAN HEDLUND 102 BAKER ST COPELAND KS 67837-8213 | | 8e. WUC New to system <input checked="" type="checkbox"/> Add Seq# _____ Person ID <u>69167</u> LEVI & MEGAN HEDLUND 102 BAKER ST COPELAND KS 67837-8213 | | |
| 9. Documents and Enclosure(s): <input checked="" type="checkbox"/> DWR Meter(s) Date to Comply: <u>12/31/2024</u> <input type="checkbox"/> N & P Date to Comply: <u>12/31/2025</u> | | | | |
| <input type="checkbox"/> Anti-Reverse Meter <input type="checkbox"/> Meter Seal <input checked="" type="checkbox"/> Check Valve <input type="checkbox"/> N & P Form <input type="checkbox"/> Water Tube <input type="checkbox"/> Driller Copy <input type="checkbox"/> H & E Letter <input type="checkbox"/> Conservation Plan Date Required: _____ Date Approved: _____ Date to Comply: _____ | | | | |
| 10. Use Made of Water From: _____ To: _____ | | | | |
| Date Prepared: 12/19/2023 By: MAM Date Entered: _____ By: _____ | | | | |

File No. **9422** 11. County: GY Basin: ARKANSAS RIVER Stream: Formation Code: Special Use:

12. Points of Diversion
 CHK
 MOD
 DEL PDIV
 ENT
 Qualifier S T R ID 'N 'W Comment (AKA Line) Rate gpm Quantity AF Rate gpm Quantity af Overlap PD Files

CHK 77966

CHK 90545

13. Storage: Rate _____ NF Quantity _____ ac/ft Additional Rate _____ NF Additional Quantity _____ ac/ft

14. Limitation: _____ af/ at _____ gpm (_____ cfs) when combined with file number(s) _____

Limitation: _____ af/yr at _____ gpm (_____ cfs) when combined with file number(s) _____

15. 5YR Allocation: Allocation Type _____ Start Year _____ 5 YR Amount _____ Amount Unit _____ Base Acres _____ Comment _____

| 16. Place of Use CHK MOD DEL ENT | PUSE | S | T | R | ID | NE¼ | | | | NW¼ | | | | SW¼ | | | | SE¼ | | | | Total | Owner | Chg? | Overlap Files |
|--|-------|---|----|-----|----|------|------|------|------|-----------|-----------|------|------|------|------|------|------|------|------|------|------|-------|-------|------|---------------|
| | | | | | | NE ¼ | NW ¼ | SW ¼ | SE ¼ | NE ¼ | NW ¼ | SW ¼ | SE ¼ | NE ¼ | NW ¼ | SW ¼ | SE ¼ | NE ¼ | NW ¼ | SW ¼ | SE ¼ | | | | |
| MOD | 6754 | 4 | 29 | 30W | 02 | | | | | | | 20 | 19 | 40 | 40 | 31 | 19 | | | | | 169 | 8a | N | 16507 |
| MOD | 13164 | 4 | 29 | 30W | 01 | | | | | L-4 35 | L-3 34 | 20 | 20 | | | | | | | | | 113 | 8b | Y | 16507 |
| DEL | 71524 | | | | | | | | | | | | | | | | | | | | | | | | |
| DEL | 71525 | | | | | | | | | | | | | | | | | | | | | | | | |
| | | | | | | | | | | | | | | | | | | | | | | | | | |
| | | | | | | | | | | | | | | | | | | | | | | | | | |

Base Acres: Year: **220** Minimum Reasonable Quantity:
 Comments: TOTAL COMBINED BASE ACRES WITH FILE NO. 16507 = 272 ACRES

Garden City Field Office
4532 W. Jones, Suite B
Garden City, KS 67846



Phone: 620-276-2901
Fax: 620-276-9315
www.agriculture.ks.gov

Mike Beam, Secretary

Laura Kelly, Governor

December 19, 2023

RONNIE & JACQUELINE GIBSON
2198 RD 4
COPELAND, KS 67837

RE: Field Office Application for Change
Water Right, File Nos. 9422 & 16507

Dear Sir and Madam:

Enclosed are orders executed by the designee of the Chief Engineer, Division of Water Resources, Kansas Department of Agriculture, approving the applications for change under the above referenced file numbers.

Your attention is directed to the enclosures and to the terms, conditions, and limitations specified in these approvals for change. A condition of these approvals is that an acceptable water flow meter must be installed on the diversion works authorized under the referenced file number and meet current specifications. Please return the required notification of completion of the diversion works and installation of the required meter as soon as these actions are completed.

Since the orders modify the original documents referred to above, they should be recorded with the Register of Deeds as other instruments affecting real estate.

Should you have any questions, please feel free contact this office. If you would prefer, you could arrange an appointment for additional assistance.

Sincerely,

A handwritten signature in blue ink that reads "Michael A. Meyer".

Michael A. Meyer
Water Commissioner

MAM:
Enclosures
pc:

LEVI & MEGAN HEDLUND (w/encl)
CARL & JOAN REED (w/encl)
JASON & SARA WOLFE (w/encl)
GMD3

CERTIFICATE OF SERVICE

On this 19th day of December 2023, I hereby certify that the foregoing Approvals of Application for Change in Place of Use, Water Right, File Nos. 9,422 and 16,507 dated 19th day of December 2023 was mailed postage prepaid, first class, US mail to the following:

RONNIE & JACQUELINE GIBSON
2198 RD 4
COPELAND, KS 67837

Photocopies to:

LEVI & MEGAN HEDLUND
102 BAKER ST
COPELAND KS 67837-8213

CARL & JOAN REED
PO BOX 97
COPELAND, KS 67837

JASON & SARA WOLFE
1717 TT RD
COPELAND KS 67837-7405

GMD3

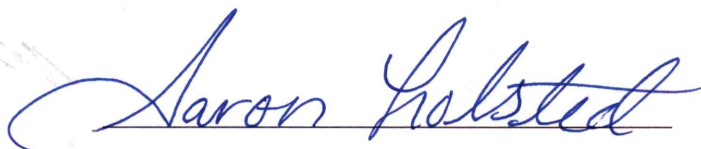

Division of Water Resources Staff

Submit completed application to:
 Kansas Department of Agriculture
 Division of Water Resources
 Field Office for your area.

Call for address:

Topeka – (785) 296-5733
 Stafford – (620) 234-5311
 Stockton – (785) 425-6787
 Garden City – (620) 276-2901
<http://agriculture.ks.gov/dwr>

DWR FIELD OFFICE APPLICATION FOR APPROVAL TO CHANGE THE PLACE OF USE AND/OR THE POINT OF DIVERSION



STATE OF KANSAS

Filing Fee Must Accompany the Application, K.S.A. 82a-708b(b), as amended.
 Fee Schedule is on the third page of this application form.

Paragraph Nos. 1, 2, 3 & 5 must be completed. Complete all other applicable portions. If change in point of diversion is greater than 100 feet, or if place of use will be changed, include a topographic map or detailed plat showing the authorized and proposed point(s) of diversion and/or place of use.

File No. 9422

RECEIVED
 1:00 pm
 DEC 08 2023

Garden City Field Office
 Division of Water Resources

1. Application is hereby made for approval of the Chief Engineer to change the (check one or both):

Place of Use Point of Diversion

under the water right which is the subject of this application in accordance with the conditions described below.

The source of supply is: Groundwater Surface water

2. Name and address of Applicant: Ronnie G Gibson

2198 4 Road, Copeland, KS 67837

Phone Number: () Email address: _____

Name and address of Water Use Correspondent: Robert Reed

PO Box 97, Copeland, KS 67837

Phone Number: () Email address: _____

3. The presently authorized place of use is:

Owner of Land — NAME: Ronnie G and Jacqueline I Gibson Living Trust

ADDRESS: 2198 4 Road, Copeland, KS 67837

(If there is more than one landowner, attach supplemental sheets as necessary.)

| Sec. | Twp. | Range | NE¼ | | | | NW¼ | | | | SW¼ | | | | SE¼ | | | | TOTAL ACRES |
|------|------|-------|-----|-----|-----|-----|-----|-----|-----|-----|-----|-----|-----|-----|-----|-----|-----|-----|-------------|
| | | | NE¼ | NW¼ | SW¼ | SE¼ | NE¼ | NW¼ | SW¼ | SE¼ | NE¼ | NW¼ | SW¼ | SE¼ | NE¼ | NW¼ | SW¼ | SE¼ | |
| 4 | 29 | 30 | | | | | | | 20 | 20 | 40 | 40 | 31 | 20 | | | | | 171 |
| | | | | | | | | | | | | | | | | | | | |

4. If this application is for a change in place of use, it is proposed that the place of use be changed to:

Owner of Land — NAME: Ronnie G and Jacqueline I Gibson Living Trust

ADDRESS: 2198 4 Road, Copeland, KS 67837

(If there is more than one landowner, attach supplemental sheets as necessary.)

| Sec. | Twp. | Range | NE¼ | | | | NW¼ | | | | SW¼ | | | | SE¼ | | | | TOTAL ACRES |
|------|------|-------|-----|-----|-----|-----|-----|-----|-----|-----|-----|-----|-----|-----|-----|-----|-----|-----|-------------|
| | | | NE¼ | NW¼ | SW¼ | SE¼ | NE¼ | NW¼ | SW¼ | SE¼ | NE¼ | NW¼ | SW¼ | SE¼ | NE¼ | NW¼ | SW¼ | SE¼ | |
| 4 | 29 | 30 | | | | | | | 20 | 19 | 40 | 40 | 31 | 19 | | | | | 169 |
| | | | | | | | | | | | | | | | | | | | |

For Office Use Only: Code _____ Fee \$ 200.00 TR # _____ Receipt Date 12-8-23 Check # 1746

THE PLACE OF USE AND/OR POINT OF DIVERSION
 SUPPLEMENTAL SHEET
FILE NO. 9422
 MAKE ADDITIONAL COPIES AS NECESSARY

3. *Continued:* The presently authorized place of use is:

Owner of Land — NAME: Levi and Megan Hedlund
 ADDRESS: 102 Baker Street, Copeland, KS 67837

| Sec. | Twp. | Range | NE¼ | | | | NW¼ | | | | SW¼ | | | | SE¼ | | | | TOTAL ACRES |
|------|------|-------|-----|-----|-----|-----|-------|-------|-----|-----|-----|-----|-----|-----|-----|-----|-----|-----|-------------|
| | | | NE¼ | NW¼ | SW¼ | SE¼ | NE¼ | NW¼ | SW¼ | SE¼ | NE¼ | NW¼ | SW¼ | SE¼ | NE¼ | NW¼ | SW¼ | SE¼ | |
| 4 | 29 | 30 | | | | | 34.71 | 39.87 | 20 | 20 | | | | | | | | | 114.58 |

Owner of Land — NAME: Jason J and Sara P Wolfe
 ADDRESS: 1717 TT Road, Copeland, KS 67837

| Sec. | Twp. | Range | NE¼ | | | | NW¼ | | | | SW¼ | | | | SE¼ | | | | TOTAL ACRES |
|------|------|-------|-----|-----|-----|-----|-----|-----|-----|-----|-----|-----|-----|-----|-----|-----|-----|-----|-------------|
| | | | NE¼ | NW¼ | SW¼ | SE¼ | NE¼ | NW¼ | SW¼ | SE¼ | NE¼ | NW¼ | SW¼ | SE¼ | NE¼ | NW¼ | SW¼ | SE¼ | |
| 4 | 29 | 30 | | | | | | 2.5 | | | | | | | | | | | 2.5 |

Owner of Land — NAME: Carl O and Dixie Lee Reed Trust et al.
 ADDRESS: PO Box 97, Copeland, KS 67837

| Sec. | Twp. | Range | NE¼ | | | | NW¼ | | | | SW¼ | | | | SE¼ | | | | TOTAL ACRES |
|------|------|-------|-----|-----|-----|-----|-----|-----|-----|-----|-----|-----|-----|-----|-----|-----|-----|-----|-------------|
| | | | NE¼ | NW¼ | SW¼ | SE¼ | NE¼ | NW¼ | SW¼ | SE¼ | NE¼ | NW¼ | SW¼ | SE¼ | NE¼ | NW¼ | SW¼ | SE¼ | |
| 4 | 29 | 30 | | | | | | 2.8 | | | | | | | | | | | 2.8 |

4. *Continued:* If this application is for a change in place of use, it is proposed that the place of use be changed to:

Owner of Land — NAME: Levi and Megan Hedlund
 ADDRESS: 102 Baker Street, Copeland, KS 67837

| Sec. | Twp. | Range | NE¼ | | | | NW¼ | | | | SW¼ | | | | SE¼ | | | | TOTAL ACRES |
|------|------|-------|-----|-----|-----|-----|-----|-----|-----|-----|-----|-----|-----|-----|-----|-----|-----|-----|-------------|
| | | | NE¼ | NW¼ | SW¼ | SE¼ | NE¼ | NW¼ | SW¼ | SE¼ | NE¼ | NW¼ | SW¼ | SE¼ | NE¼ | NW¼ | SW¼ | SE¼ | |
| 4 | 29 | 30 | | 1 | 3 | | 35 | 34 | 20 | 20 | | | | | | | | | 113 |

Owner of Land — NAME: _____
 ADDRESS: _____

| Sec. | Twp. | Range | NE¼ | | | | NW¼ | | | | SW¼ | | | | SE¼ | | | | TOTAL ACRES |
|------|------|-------|-----|-----|-----|-----|-----|-----|-----|-----|-----|-----|-----|-----|-----|-----|-----|-----|-------------|
| | | | NE¼ | NW¼ | SW¼ | SE¼ | NE¼ | NW¼ | SW¼ | SE¼ | NE¼ | NW¼ | SW¼ | SE¼ | NE¼ | NW¼ | SW¼ | SE¼ | |
| | | | | | | | | | | | | | | | | | | | |

Owner of Land — NAME: _____
 ADDRESS: _____

| Sec. | Twp. | Range | NE¼ | | | | NW¼ | | | | SW¼ | | | | SE¼ | | | | TOTAL ACRES |
|------|------|-------|-----|-----|-----|-----|-----|-----|-----|-----|-----|-----|-----|-----|-----|-----|-----|-----|-------------|
| | | | NE¼ | NW¼ | SW¼ | SE¼ | NE¼ | NW¼ | SW¼ | SE¼ | NE¼ | NW¼ | SW¼ | SE¼ | NE¼ | NW¼ | SW¼ | SE¼ | |
| | | | | | | | | | | | | | | | | | | | |

5. **Presently authorized point of diversion:**
 One in the _____ Quarter of the _____ Quarter of the _____ Quarter
 of Section _____, Township _____ South, Range _____ (W),
 in _____ County, Kansas, _____ feet North _____ feet West of Southeast corner of section.
 Authorized Rate _____ Authorized Quantity _____ Depth of well _____ (feet)
 (DWR use only: Computer ID No. _____ GPS _____ feet North _____ feet West)
 This point will not be changed This point will be changed as follows: No change, point better described with GPS as follows:
Proposed point of diversion: (Complete only if change is requested or if existing point is better described by GPS)
 One in the _____ Quarter of the _____ Quarter of the _____ Quarter
 of Section _____, Township _____ South, Range _____ (W),
 in _____ County, Kansas, _____ feet North _____ feet West of Southeast corner of section.
 Proposed Rate _____ Proposed Quantity _____ Proposed well depth (feet) _____
 This point is: Additional Well Geo Center List other water rights that will use this point _____

6. **Presently authorized point of diversion:**
 One in the _____ Quarter of the _____ Quarter of the _____ Quarter
 of Section _____, Township _____ South, Range _____ (W),
 in _____ County, Kansas, _____ feet North _____ feet West of Southeast corner of section.
 Authorized Rate _____ Authorized Quantity _____ Depth of well _____ (feet)
 (DWR use only: Computer ID No. _____ GPS _____ feet North _____ feet West)
 This point will not be changed This point will be changed as follows: No change, point better described with GPS as follows:
Proposed point of diversion: (Complete only if change is requested or if existing point is better described by GPS)
 One in the _____ Quarter of the _____ Quarter of the _____ Quarter
 of Section _____, Township _____ South, Range _____ (W),
 in _____ County, Kansas, _____ feet North _____ feet West of Southeast corner of section.
 Proposed Rate _____ Proposed Quantity _____ Proposed well depth (feet) _____
 This point is: Additional Well Geo Center List other water rights that will use this point _____

7. The changes herein are desired for the following reasons?
 (please be specific) Change the Place of Use to better
reflect the actual operation
Base Acres for both files = 272; Proposed is Base +10 Ac.

8. If a well, is the test hole log attached? Yes No

9. The change(s) (was)(will be) completed by?
Upon Approval

10. If the point of diversion is a well:
 (a) What are you going to do with the old well?

 (b) When will this be done? _____

11. Groundwater Management District recommendation attached?
 Yes No

12. Assisted by _____

13a. If the proposed point of diversion will be relocated more than 300 feet but within 2,640 feet of the existing point of diversion, attach a topographic map or aerial photograph. For groundwater sources, show all wells (including domestic) within one-half mile of the proposed point of diversion and the names and mailing addresses of the owners. For surface water sources, show the names and addresses of the landowner(s) one-half mile downstream and one-half mile upstream from your property lines

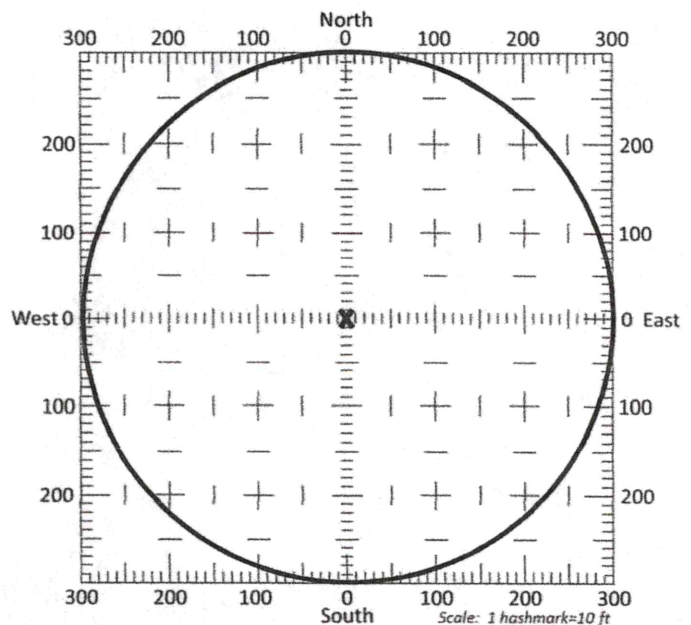

13b. If the proposed point of diversion will be relocated within a 300 foot radius of the existing point of diversion, indicate its location on the diagram shown above in relation to the existing point of diversion. The proposed point of diversion must be located within the circle shown above. (PLEASE NOTE: The "X" in center of diagram above represents the presently authorized point of diversion.)

14. If the proposed groundwater point of diversion is 300 or fewer feet from the existing point of diversion, complete the following:

- (a) Does the undersigned represent all owners of the currently authorized place(s) of use identified in this application?
 Yes No (If no, all owners must sign this application.)
- (b) Will the ownership interest of any owner of the currently authorized place(s) of use identified in this application be adversely affected if this application is approved as requested?
 Yes No (If yes, all owners must sign this application.)
- (c) If this application is not approved expeditiously, will there be substantial damage to property, public health or safety?
 Yes No (If no, all owners must sign this application.)

If the application proposes a surface water change in point of diversion, a groundwater change in point of diversion greater than 300 feet, or a change in place of use, the application must be signed by all owners of the currently authorized place of use, or their duly authorized agent (attach notarized statement authorizing representation).

I hereby verify, being first duly sworn upon my oath or affirmation and under penalty of perjury, that I am of lawful age and the owner, the spouse of the owner, or a duly authorized agent of the owner(s) to make this application on their behalf, in regards to the water right(s) to which this application pertains. I further verify that the statements contained in this application are true, correct and complete.

Dated at _____, Kansas, this _____ day of _____, 20_____.

Ronnie S. Gibson
(Owner)

Jacqueline J. Gibson
(Spouse)

Ronnie G. Gibson
(Please Print)

Jacqueline I. Gibson
(Please Print)

Levi Hedlund
(Owner)

Megan Hedlund
(Spouse)

Levi Hedlund
(Please Print)

Megan Hedlund
(Please Print)

(Owner)

(Spouse)

(Please Print)

(Please Print)

State of Kansas }
County of Gray } SS



I hereby certify that the foregoing application was signed in my presence and sworn to before me this 8th day of December, 2023.

My Commission Expires 2-19-2025

Lori Fleming
Notary Public

ONLY COMPLETE APPLICATIONS WILL BE PROCESSED. To be complete, all of the applicable portions of the application form must be completed with accurate information; maps, if necessary, must be included; signatures of all the appropriate owners' must be affixed to the application and notarized; and the appropriate fee must be paid.

FEE SCHEDULE

Each application to change the place of use or the point of diversion under this section shall be accompanied by the application fee set forth in the schedule below: Make checks payable to: **Kansas Department of Agriculture**

- (1) Application to change a point of diversion 300 feet or less \$100
- (2) Application to change a point of diversion more than 300 feet \$200
- (3) Application to change the place of use \$200

14. If the proposed groundwater point of diversion is 300 or fewer feet from the existing point of diversion, complete the following:

- (a) Does the undersigned represent all owners of the currently authorized place(s) of use identified in this application?
 Yes No (If no, all owners must sign this application.)
- (b) Will the ownership interest of any owner of the currently authorized place(s) of use identified in this application be adversely affected if this application is approved as requested?
 Yes No (If yes, all owners must sign this application.)
- (c) If this application is not approved expeditiously, will there be substantial damage to property, public health or safety?
 Yes No (If no, all owners must sign this application.)

If the application proposes a surface water change in point of diversion, a groundwater change in point of diversion greater than 300 feet, or a change in place of use, the application must be signed by all owners of the currently authorized place of use, or their duly authorized agent (attach notarized statement authorizing representation).

I hereby verify, being first duly sworn upon my oath or affirmation and under penalty of perjury, that I am of lawful age and the owner, the spouse of the owner, or a duly authorized agent of the owner(s) to make this application on their behalf, in regards to the water right(s) to which this application pertains. I further verify that the statements contained in this application are true, correct and complete.

Dated at _____, Kansas, this _____ day of _____, 20_____.

Robert L Reed

(Owner)

(Spouse)

Robert L Reed

(Please Print)

(Please Print)

(Owner)

(Spouse)

(Please Print)

(Please Print)

(Owner)

(Spouse)

(Please Print)

(Please Print)

State of Kansas }
County of Gray } SS

I hereby certify that the foregoing application was signed in my presence and sworn to before me this 27th day of September, 2023.

My Commission Expires 4/22/2024.

[Signature]

Notary Public

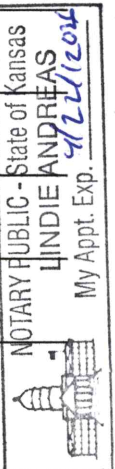

ONLY COMPLETE APPLICATIONS WILL BE PROCESSED. To be complete, all of the applicable portions of the application form must be completed with accurate information; maps, if necessary, must be included; signatures of all the appropriate owners' must be affixed to the application and notarized; and the appropriate fee must be paid.

FEE SCHEDULE

Each application to change the place of use or the point of diversion under this section shall be accompanied by the application fee set forth in the schedule below: Make checks payable to: **Kansas Department of Agriculture**

- (1) Application to change a point of diversion 300 feet or less \$100
- (2) Application to change a point of diversion more than 300 feet \$200
- (3) Application to change the place of use \$200

14. If the proposed groundwater point of diversion is 300 or fewer feet from the existing point of diversion, complete the following:

- (a) Does the undersigned represent all owners of the currently authorized place(s) of use identified in this application?
 Yes No (If no, all owners must sign this application.)
- (b) Will the ownership interest of any owner of the currently authorized place(s) of use identified in this application be adversely affected if this application is approved as requested?
 Yes No (If yes, all owners must sign this application.)
- (c) If this application is not approved expeditiously, will there be substantial damage to property, public health or safety?
 Yes No (If no, all owners must sign this application.)

If the application proposes a surface water change in point of diversion, a groundwater change in point of diversion greater than 300 feet, or a change in place of use, the application must be signed by all owners of the currently authorized place of use, or their duly authorized agent (attach notarized statement authorizing representation).

I hereby verify, being first duly sworn upon my oath or affirmation and under penalty of perjury, that I am of lawful age and the owner, the spouse of the owner, or a duly authorized agent of the owner(s) to make this application on their behalf, in regards to the water right(s) to which this application pertains. I further verify that the statements contained in this application are true, correct and complete.

Dated at Cimarron, Kansas, this 27th day of November, 20 23.

[Signature]

(Owner)

Jason Wolfe

(Please Print)

(Owner)

(Please Print)

(Owner)

(Please Print)

Sara Wolfe

(Spouse)

Sara Wolfe

(Please Print)

(Spouse)

(Please Print)

(Spouse)

(Please Print)

State of Kansas }
County of Gray } SS

I hereby certify that the foregoing application was signed in my presence and sworn to before me this 27th day of November, 20 23.



Ashley Rogers

Notary Public

My Commission Expires January 13, 2025

ONLY COMPLETE APPLICATIONS WILL BE PROCESSED. To be complete, all of the applicable portions of the application form must be completed with accurate information; maps, if necessary, must be included; signatures of all the appropriate owners' must be affixed to the application and notarized; and the appropriate fee must be paid.

FEE SCHEDULE

Each application to change the place of use or the point of diversion under this section shall be accompanied by the application fee set forth in the schedule below: Make checks payable to: **Kansas Department of Agriculture**

- (1) Application to change a point of diversion 300 feet or less \$100
- (2) Application to change a point of diversion more than 300 feet \$200
- (3) Application to change the place of use \$200

SUMMARY ORDER APPROVING APPLICATION FOR CHANGE AND IMPOSING CONDITIONS

This Summary Order is issued under authority of K.S.A. 82a-708b, as amended, and K.A.R. 5-5-1, *et seq.* and other applicable provisions of the *Kansas Water Appropriation Law, K.S.A. 82a-701 et seq.*, and rules and regulations promulgated thereunder, With the exception of those conditions expressly contained herein, this Summary Order does not change the terms, conditions and limitations of File No. 9422.

1. A change application was received on December 8, 2023 requesting that the place of use and / or point of diversion authorized under the above-referenced file number be changed as described in the application.
2. On and after the effective date of this summary order, the authorized place(s) of use shall be located substantially as shown on the topographic map accompanying the application to change the place of use. Applicable Not Applicable
3. The change in point of diversion shall not impair existing rights and shall be limited to the same source or sources of water as previously authorized. The point of diversion authorized by this summary order shall be located within a _____ foot radius of the authorized point(s) of diversion. Applicable Not Applicable
4. The point(s) of diversion described herein is administratively corrected to be more accurately described using the Global Positioning System (GPS), as described in the application. Applicable Not Applicable
5. The point(s) of diversion authorized herein shall not actually be located more than _____ feet from the previously authorized point(s) of diversion. Applicable Not Applicable
6. As required by K.A.R. 5-3-5d, if the works for diversion is a well with a diversion rate of 100 gallons per minute or more, a tube or other device suitable for making water level measurements shall be installed, operated and maintained in accordance with K.A.R. 5-6-13. Applicable Not Applicable
7. The owner of the authorized place(s) of use shall properly install an acceptable water flow meter on or before December 31, 2024, or before the first use of water, whichever occurs first. The water flow meter shall be installed, operated and maintained in accordance with K.A.R. 5-1-4 through 5-1-12. As required by K.S.A. 82a-732, as amended, and K.A.R. 5-3-5e, the owner shall maintain records and report the reading of the water flow meter and the total quantity of water diverted annually to the Chief Engineer by March 1 following the end of each calendar year. Applicable Not Applicable
8. Installation of the works for diversion of water shall be completed on or before December 31, 20____, or within any authorized extension of time. By March 1, 20____ the applicant shall notify the Chief Engineer that construction of the works for diversion has been completed, on the form provided by the Chief Engineer, as required by K.A.R. 5-8-4e. Applicable Not Applicable
9. The completed well log shall be submitted with the required notice. Applicable Not Applicable
10. All diversion works into which any type of chemical or other foreign substance will be injected into the water shall be equipped with an in-line, automatic, quick-closing check valve capable of preventing pollution of the source of the water supply. The check valve(s) shall be installed, operated and maintained in accordance with K.A.R. 5-3-5c. Applicable Not Applicable
11. Additional Conditions are attached. Yes No
12. In accordance with K.S.A. 82a-708a, as amended, and K.A.R. 5-5-14, all of the owners of the authorized place(s) of use of water appropriated under the above-referenced file number are responsible for compliance with its terms, conditions and limitations, as amended and/or supplemented by this Summary Order, and with applicable provisions of the *Kansas Water Appropriation Law* and the *Rules and Regulations* promulgated thereunder. Failure to comply with these provisions may result in civil penalties pursuant to K.S.A. 82a-737, as amended, and/or the suspension or revocation and dismissal of the water or appropriation right or any other enforcement actions authorized by law.

Administrative Appeal and Effective Date of Order

If you are aggrieved by this order, pursuant to K.S.A. 82a-1901, you may request an evidentiary hearing before the Chief Engineer or request administrative review by the Secretary of Agriculture. A request for hearing by the Chief Engineer must be filed within **15 days** of service of this Order and a request for administrative review by the Secretary must be filed within **30 days** pursuant to K.S.A. 77-531. Any request for administrative review must state a basis for review pursuant to K.S.A. 77-527. File any request with **Kansas Department of Agriculture, Legal Division, 1320 Research Park Drive, Manhattan, KS 66502**. Failure to timely request a hearing or review may preclude review under the Kansas Judicial Review Act.

For Use by Register of Deeds

FOR OFFICE USE ONLY
**APPLICATION APPROVED AND
SUMMARY ORDER ISSUED**

By: Michael A. Meyer
Duly Authorized Designee of the Chief Engineer

(Print Name): MICHAEL A. MEYER
Division of Water Resources - Kansas Department of Agriculture

Date of Issuance: December 19, 2023

State of Kansas)

County of Linney) SS

Acknowledged before me on December 19, 2023

by Michael A. Meyer

Signature: Aaron Holsted

My commission expires: _____
Notary Public
AARON T. HOLSTED
My Appointment Expires

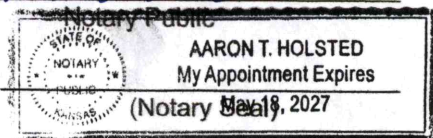

CHANGE IN PLACE OF USE WATER RIGHT, FILE NOS. 9422 & 16507

Section 4 Township 29 South Range 30 West Gray County

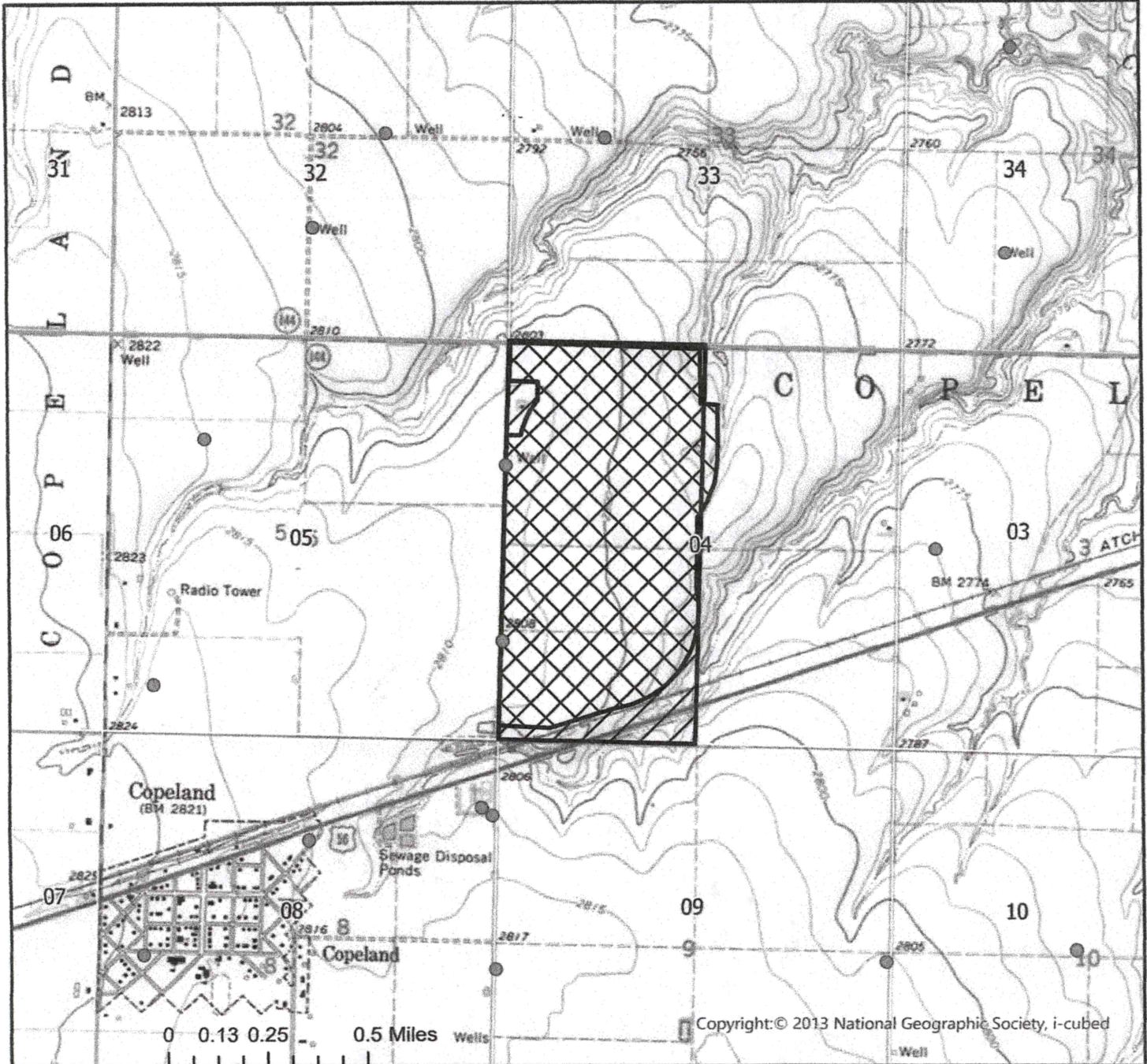

- Authorized Point of Diversion
- Permitted Water Right
- ★ Domestic Well within 1/2 mile
- ▨ Authorized Place of Use
- ▨ Proposed Place of Use

List of owner name and addresses within 1/2 mile:



By signing below I agree that all wells, including domestic, and owners names and addresses within 1/2 mile of the proposed point of diversion have been shown on the map

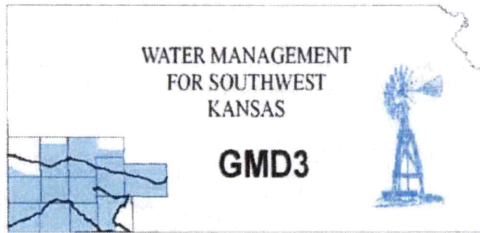

Southwest Kansas
Groundwater Management District No. 3
2009 E. Spruce Street
Garden City, Kansas 67846
(620) 275-7147 phone
www.gmd3.org

December 19, 2023

Michael A. Meyer
Division of Water Resources
4532 W Jones Ave., Suite B
Garden City, Kansas 67846

RE: Applications for Change in Place of Use
Water Right, File Nos. 9422 & 16507

Dear Mike:

We have reviewed the applications for the above referenced water rights. The proposal is not in conflict with the Management Program of the Southwest Kansas Groundwater Management District No. 3 (GMD3). The proposed change in place of use will rearrange the acres to better suit the operation and keeps the acres within the allowable range, in accordance with K.A.R. 5-5-11(b). At the same time, the water rights will Maintain a complete overlap in place of use. It is therefore recommended that the applications be approved at this time.

Thank you for the opportunity to review the applications and to provide a recommendation. If you have any questions, please don't hesitate to contact us.

Sincerely,

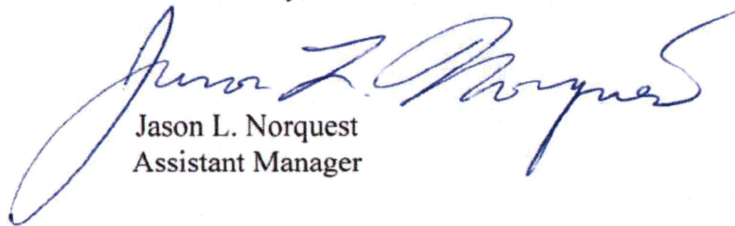
A handwritten signature in blue ink, which appears to read "Jason L. Norquest".

Jason L. Norquest
Assistant Manager

RECEIVED

DEC 19 2023

Garden City Field Office
Division of Water Resources

GMD3 Change Review

File No(s): 9422, 16507.

DWR office: GC.

App filed to change: PU.

Is Landowner(s) correct in WRIS: Ronnie G Gibson.

If NO, is documentation included?

Is Water Use Correspondent correct in WRIS? .

If NO, is documentation included?

Regulation(s) Reviewed: KAR 5-5-11

Point of diversion ID No(s) being changed.

| | ft. North | ft. West |
|---------------|-----------|----------|
| Authorized PD | | |
| Proposed PD | | |
| Difference | 0 | 0 |
| a2 + b2 = c2 | 0 | 0 |
| | | 0 |

GPS for proposed PD: Lat: Long: .

Is proposed PD stacking on existing WRs? No Change.

Is Proposed PU overlapping existing WRs? Rearranging of acres an complete overlap.

Neighboring certified well(s) notified: .

Name .

Address .

Zip .

Email: Phone: .

Domestic well(s) notified: .

Name .

Address .

Zip .

Base Acres: 272 combined.

Perfected Acres: .

Irr. Return-Flow %

Gray County

9422: 2 authorized PDs

ID03, 3591N 5240W, 4-29-30, 282AF @ 1190gpm

ID04, 1070N 5089W, 4-29-30, 100AF @ 100gpm

159.9 acres total in NW of section 4

131 acres in SW of section 4

16507: 135AF @ 1100gpm

Overlap PD on ID04

Overlap same acres as 9422

Combined 290.9 acres

Change App approved in 2000 to overlap current authorized acres

GMD3 Change Review

Proposed:

282 acres in W2 of section 4

Is a waiver needed: No, proposal is 10 acres over base, which is allowed in rules.
Change will better describe acres for current operation.

Recommendation: After review of available information, it appears current area rules are met. Staff therefore recommends approval of the applications.

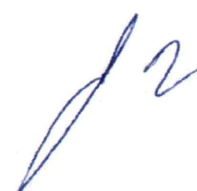

RECEIVED
DEC 19 2023
Garden City Field Office
Division of Water Resources

Garden City Field Office
4532 W. Jones, Suite B
Garden City, KS 67846



Phone: 620-276-2901
Fax: 620-276-9315
www.agriculture.ks.gov

Mike Beam, Secretary

Laura Kelly, Governor

December 12, 2023

SOUTHWEST KANSAS GROUNDWATER
MANAGEMENT DISTRICT NO. 3
2009 E SPRUCE ST
GARDEN CITY KS 67846

Re: Request for Recommendation
Water Right, File Nos. 9422 & 16507

Dear Mr. Norquest:

This is to advise you that Ronnie Gibson has filed applications for approval of the Chief Engineer, Division of Water Resources, Kansas Department of Agriculture, to change in place of use.

We are delaying action on the change application to allow you time to review and provide a recommendation. Please submit a recommendation within 15 days from the date of this letter.

Thank you and as always feel free to contact this office at any time.

Sincerely,

A handwritten signature in blue ink that reads "Michael A. Meyer".

Michael A. Meyer
Water Commissioner

MAM
Enclosures