

Kansas Department of Agriculture
 Division of Water Resources
CHANGE: P/U WORKSHEET

1. File Number: 8739	2. Status Change Date: 3-20-2024	3. Change Num: C3	4. Field Office: 4	5. GMD: 3
--------------------------------	--	-----------------------------	------------------------------	---------------------

6. Status: <input checked="" type="checkbox"/> Approved <input type="checkbox"/> Denied by DWR/GMD <input type="checkbox"/> Dismiss by Request/Failure to Return	7. Filing Date of Change: 9/19/2023
--	---

8a. Landowner, applicant, Person ID 26969
 New to system Add Seq# _____

**ALVIN J & FLORENCE J STOPPEL
 BOX 51
 SUBLETTE, KS 67877**

8c. Person ID _____
 New to system Add Seq# _____

8b. Landowner(s) Person ID _____
 New to system Add Seq# _____

8d. WUC Person ID 17366
 New to system Add Seq# _____

**ALVIN J STOPPEL
 PO BOX 592
 SUBLETTE, KS 67877-0592**

9. Documents and Enclosure(s): DWR Meter(s) Date to Comply: 12/31/2024 N & P Date to Comply: _____

Anti-Reverse Meter Meter Seal Check Valve N & P Form Water Tube Driller Copy H & E Letter

Conservation Plan Date Required: _____ Date Approved: _____ Date to Comply: _____

10. Use Made of Water From: _____ To: _____

Date Prepared: **4/20/2024** By: **MAM**
 Date Entered: _____ By: _____

File No. **8739** 11. County: **HS** Basin: **CROOKED CREEK** Stream: Formation Code: Special Use:

12. Points of Diversion Rate and Quantity
 CHK Authorized Additional
 MOD Rate Quantity Rate Quantity
 DEL PDIV Qualifier S T R ID 'N 'W Comment (AKA Line) gpm af gpm af Overlap PD Files
 ENT

CHK 89701 (pending C2)

13. Storage: Rate _____ NF Quantity _____ ac/ft Additional Rate _____ NF Additional Quantity _____ ac/ft

14. Limitation: _____ af/yr at _____ gpm (_____ cfs) when combined with file number(s) _____
 Limitation: _____ af/yr at _____ gpm (_____ cfs) when combined with file number(s) _____

15. 5YR Allocation: Allocation Type _____ Start Year _____ 5 YR Amount _____ Amount Unit _____ Base Acres _____ Comment _____

16. Place of Use CHK MOD DEL ENT	PUSE	S	T	R	ID	NE¼				NW¼				SW¼				SE¼				Total	Owner	Chg?	Overlap Files	
						NE ¼	NW ¼	SW ¼	SE ¼	NE ¼	NW ¼	SW ¼	SE ¼	NE ¼	NW ¼	SW ¼	SE ¼	NE ¼	NW ¼	SW ¼	SE ¼					
MOD	1986	2	30	32W	1	L-1 11.5	L-2 36.75	40	36.75	L-3 36.75	L-4 11.5	36.5	40	40	36.75	11.5	36.75	36.75	40	36.75	11.5	500	8a	N	7977, 18479	
ENT	31384	3	30	32W	2	L-1 31.5	L-2 31.5	31.25	31.25	L-3 31.25	L-4 31.25	31.25	31.25	31.25	31.25	31.25	31.25	31.25	31.25	31.25	31.25	500	8a	N	7977, 18479	

Base Acres: Year: Minimum Reasonable Quantity:
 Comments:

Garden City Field Office
4532 W. Jones, Suite B
Garden City, KS 67846



Phone: 620-276-2901
Fax: 620-276-9315
www.agriculture.ks.gov

Mike Beam, Secretary

Laura Kelly, Governor

March 20, 2024

TOM STOPPEL
PO BOX 592
SUBLETTE, KS 67877-0592

RE: Field Office Application for Change
Water Right, File Nos. 7977, 8739, 18479

Dear Sir:

Enclosed are orders executed by the designee of the Chief Engineer, Division of Water Resources, Kansas Department of Agriculture, approving the application for change under the above referenced file numbers.

Your attention is directed to the enclosures and to the terms, conditions, and limitations specified in these approvals for change. A condition of these approvals is that an acceptable water flow meter must be installed on the diversion works authorized under the referenced file number and meet current specifications. Please return the required notification of completion of the diversion works and installation of the required meter as soon as these actions are completed.

Since the order modifies the original documents referred to above, they should be recorded with the Register of Deeds as other instruments affecting real estate.

Should you have any questions, please feel free contact this office. If you would prefer, you could arrange an appointment for additional assistance.

Sincerely,

A handwritten signature in blue ink that reads "Michael A. Meyer".

Michael A. Meyer
Water Commissioner

MAM:
Enclosures

CERTIFICATE OF SERVICE

On this 20th day of March 2024, I hereby certify that the foregoing Approval of Application for Change in Place of Use, Water Right, File Nos. 7,977, 8,739 and 18,479 dated 20th day of March 2024 was mailed postage prepaid, first class, US mail to the following:

TOM STOPPEL
PO BOX 592
SUBLETTE, KS 67877-0592

A handwritten signature in blue ink that reads "Aaron Halsted". The signature is written in a cursive style and is positioned above a horizontal line.

Division of Water Resources Staff

Submit completed application to:
 Kansas Department of Agriculture
 Division of Water Resources
 Field Office for your area.

Call for address:

Topeka -- (785) 296-5733
 Stafford -- (620) 234-5311
 Stockton -- (785) 425-6787
 Garden City -- (620) 276-2901
<http://agriculture.ks.gov/dwr>

DWR FIELD OFFICE APPLICATION FOR APPROVAL TO CHANGE THE PLACE OF USE AND/OR THE POINT OF DIVERSION



STATE OF KANSAS

Filing Fee Must Accompany the Application, K.S.A. 82a-708b(b), as amended.
 Fee Schedule is on the third page of this application form.

Paragraph Nos. 1, 2, 3 & 5 must be completed. Complete all other applicable portions. If change in point of diversion is greater than 100 feet, or if place of use will be changed, include a topographic map or detailed plat showing the authorized and proposed point(s) of diversion and/or place of use.

File No. 8739-00

RECEIVED
 3:31 pm
 SEP 19 2023
 Garden City Field Office
 Division of Water Resources

1. Application is hereby made for approval of the Chief Engineer to change the (check one or both):

Place of Use Point of Diversion

under the water right which is the subject of this application in accordance with the conditions described below.

The source of supply is: Groundwater Surface water

2. Name and address of Applicant: ALVIN J STOPPEL

PO BOX 51, SUBLETTE, KS 67877

Phone Number: () Email address: _____

Name and address of Water Use Correspondent: SAME AS ABOVE

PO BOX 592, SUBLETTE, KS 67877

Phone Number: () Email address: _____

3. The presently authorized place of use is:

Owner of Land ---- NAME: SAME AS ABOVE

ADDRESS: SAME AS ABOVE

(If there is more than one landowner, attach supplemental sheets as necessary.)

Sec.	Twp.	Range	<u>L-1 L-2</u> NE¼				<u>L-3 L-4</u> NW¼				SW¼				SE¼				TOTAL ACRES
			NE¼	NW¼	SW¼	SE¼	NE¼	NW¼	SW¼	SE¼	NE¼	NW¼	SW¼	SE¼	NE¼	NW¼	SW¼	SE¼	
02	30	<u>32W</u>	39.74	39.80	40	40	39.84	39.90	40	40	40	40	40	40	40	40	40	40	639.28

4. If this application is for a change in place of use, it is proposed that the place of use be changed to:

Owner of Land ---- NAME: SAME AS ABOVE

ADDRESS: SAME AS ABOVE

(If there is more than one landowner, attach supplemental sheets as necessary.)

Sec.	Twp.	Range	<u>L-1 L-2</u> NE¼				<u>L-3 L-4</u> NW¼				SW¼				SE¼				TOTAL ACRES
			NE¼	NW¼	SW¼	SE¼	NE¼	NW¼	SW¼	SE¼	NE¼	NW¼	SW¼	SE¼	NE¼	NW¼	SW¼	SE¼	
03	30	<u>32W</u>	11.5	36.75	40	36.75	36.75	11.5	36.75	40	40	36.75	11.5	36.75	36.75	40	36.75	11.5	500
02	30	<u>32W</u>	31.25	31.25	31.25	31.25	31.25	31.25	31.25	31.25	31.25	31.25	31.25	31.25	31.25	31.25	31.25	31.25	500

For Office Use Only: Code _____ Fee \$ 200.00 TR # _____ Receipt Date 9-19-23 Check # 1144

5. **Presently authorized point of diversion:**
 One in the _____ Quarter of the _____ Quarter of the _____ Quarter
 of Section _____, Township _____ South, Range _____ W,
 in _____ County, Kansas, _____ feet North _____ feet West of Southeast corner of section.
 Authorized Rate _____ Authorized Quantity _____ Depth of well _____ (feet)
(DWR use only: Computer ID No. 1 _____ GPS _____ feet North _____ feet West)
 This point will not be changed This point will be changed as follows: No change, point better described with GPS as follows:
Proposed point of diversion: (Complete only if change is requested or if existing point is better described by GPS)
 One in the _____ Quarter of the _____ Quarter of the _____ Quarter
 of Section _____, Township _____ South, Range _____ W,
 in _____ County, Kansas, _____ feet North _____ feet West of Southeast corner of section.
 Proposed Rate _____ Proposed Quantity _____ Proposed well depth (feet) _____
 This point is: Additional Well Geo Center List other water rights that will use this point _____

6. **Presently authorized point of diversion:**
 One in the _____ Quarter of the _____ Quarter of the _____ Quarter
 of Section _____, Township _____ South, Range _____ W,
 in _____ County, Kansas, _____ feet North _____ feet West of Southeast corner of section.
 Authorized Rate _____ Authorized Quantity _____ Depth of well _____ (feet)
(DWR use only: Computer ID No. _____ GPS _____ feet North _____ feet West)
 This point will not be changed This point will be changed as follows: No change, point better described with GPS as follows:
Proposed point of diversion: (Complete only if change is requested or if existing point is better described by GPS)
 One in the _____ Quarter of the _____ Quarter of the _____ Quarter
 of Section _____, Township _____ South, Range _____ W,
 in _____ County, Kansas, _____ feet North _____ feet West of Southeast corner of section.
 Proposed Rate _____ Proposed Quantity _____ Proposed well depth (feet) _____
 This point is: Additional Well Geo Center List other water rights that will use this point _____

7. The changes herein are desired for the following reasons?
 (please be specific) _____

8. If a well, is the test hole log attached? Yes No

9. The change(s) (was)(will be) completed by?

10. If the point of diversion is a well:
 (a) What are you going to do with the old well?

 (b) When will this be done? _____

11. Groundwater Management District recommendation attached?
 Yes No

12. Assisted by JG/GCFO _____

13a. If the proposed point of diversion will be relocated more than 300 feet but within 2,640 feet of the existing point of diversion, attach a topographic map or aerial photograph. For groundwater sources, show all wells (including domestic) within one-half mile of the proposed point of diversion and the names and mailing addresses of the owners. For surface water sources, show the names and addresses of the landowner(s) one-half mile downstream and one-half mile upstream from your property lines

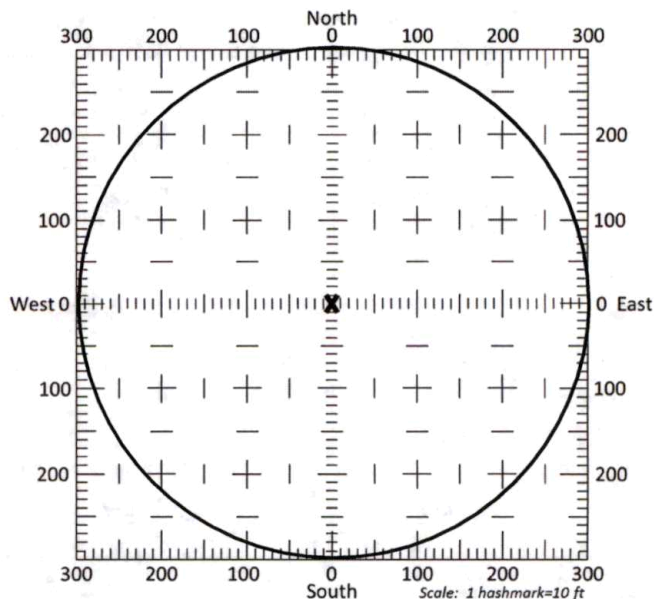

13b. If the proposed point of diversion will be relocated within a 300 foot radius of the existing point of diversion, indicate its location on the diagram shown above in relation to the existing point of diversion. The proposed point of diversion must be located within the circle shown above. **(PLEASE NOTE: The "X" in center of diagram above represents the presently authorized point of diversion.)**

14. If the proposed groundwater point of diversion is 300 or fewer feet from the existing point of diversion, complete the following:

- (a) Does the undersigned represent all owners of the currently authorized place(s) of use identified in this application?
 Yes No (If no, all owners must sign this application.)
- (b) Will the ownership interest of any owner of the currently authorized place(s) of use identified in this application be adversely affected if this application is approved as requested?
 Yes No (If yes, all owners must sign this application.)
- (c) If this application is not approved expeditiously, will there be substantial damage to property, public health or safety?
 Yes No (If no, all owners must sign this application.)

If the application proposes a surface water change in point of diversion, a groundwater change in point of diversion greater than 300 feet, or a change in place of use, the application must be signed by all owners of the currently authorized place of use, or their duly authorized agent (attach notarized statement authorizing representation).

I hereby verify, being first duly sworn upon my oath or affirmation and under penalty of perjury, that I am of lawful age and the owner, the spouse of the owner, or a duly authorized agent of the owner(s) to make this application on their behalf, in regards to the water right(s) to which this application pertains. I further verify that the statements contained in this application are true, correct and complete.

Dated at Garden City, Kansas, this 19th day of September, 20 23.

Thomas Stoppel DPOA
(Owner)

(Spouse)

Thomas Stoppel
(Please Print)

(Please Print)

(Owner)

(Spouse)

(Please Print)

(Please Print)

(Owner)

(Spouse)

(Please Print)

(Please Print)

State of Kansas }
County of Finney } SS

I hereby certify that the foregoing application was signed in my presence and sworn to before me this 19th day of September, 20 23.

My Commission Expires 

Julie Jones
Notary Public

ONLY COMPLETE APPLICATIONS WILL BE PROCESSED. To be complete, all of the applicable portions of the application form must be completed with accurate information; maps, if necessary, must be included; signatures of all the appropriate owners' must be affixed to the application and notarized; and the appropriate fee must be paid.

FEE SCHEDULE

Each application to change the place of use or the point of diversion under this section shall be accompanied by the application fee set forth in the schedule below: Make checks payable to: **Kansas Department of Agriculture**

- (1) Application to change a point of diversion 300 feet or less \$100
- (2) Application to change a point of diversion more than 300 feet \$200
- (3) Application to change the place of use \$200

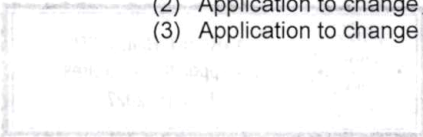

CHANGE IN PLACE OF USE WATER RIGHT, FILE NO. 8739

SW 1/4 of Section 02 Township 30 South Range 32 West Haskell County

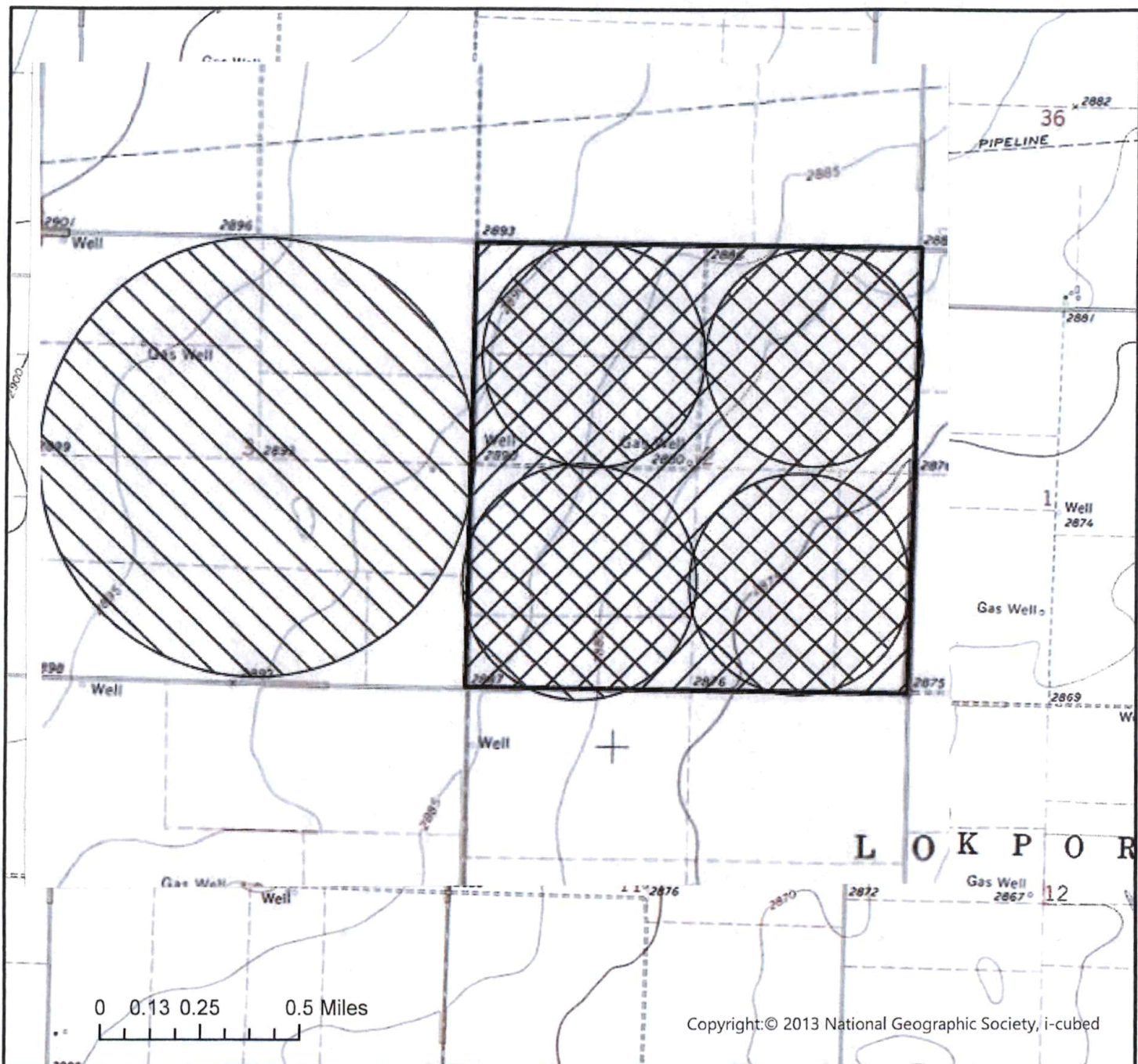

	Authorized Point of Diversion
	Domestic Well within 1/2 mile
	Domestic Well within 1/2 mile
	Authorized Place of Use
	Proposed Place of Use

List of owner name and addresses within 1/2 mile:



All wells of any kind within 1/2 mile of the requested place of use have been plotted.

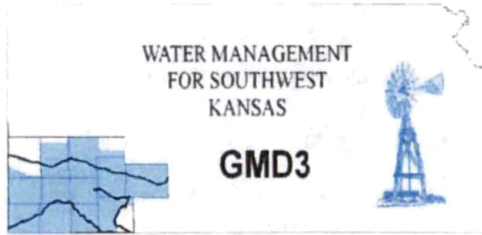

Southwest Kansas
Groundwater Management District No. 3
2009 E. Spruce Street
Garden City, Kansas 67846
(620) 275-7147 phone
www.gmd3.org

September 26, 2023

Michael A. Meyer
Division of Water Resources
4532 W Jones Ave., Suite B
Garden City, Kansas 67846

RE: Applications for Change in Place of Use
Water Right, File Nos. 7977, 8739 & 18479

Dear Mike:

We have reviewed the applications for the above referenced water rights. The proposals are not in conflict with the Management Program of the Southwest Kansas Groundwater Management District No. 3 (GMD3). The proposed change in place of use will eliminate the corners of the pivot systems to better suit the operation and keeps the acres within the allowable range, in accordance with K.A.R. 5-5-11(b). There is a future PD change proposed for one of the wells and the acre feet will be adjusted at that time. At the same time, the water rights will have a complete overlap in place of use. It is therefore recommended that the applications be approved at this time.

Thank you for the opportunity to review the applications and to provide a recommendation. If you have any questions, please don't hesitate to contact us.

Sincerely,

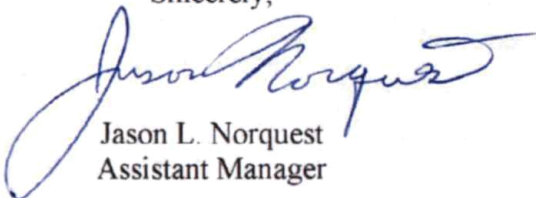

Jason L. Norquest
Assistant Manager

RECEIVED

SEP 25 2023

Garden City Field Office
Division of Water Resources

GMD3 Change Review

File No(s): 7977, 8739, 18479.

DWR office: GC.

App filed to change: PU.

Is Landowner(s) correct in WRIS: Alvin Stopel.

If NO, is documentation included?

Is Water Use Correspondent correct in WRIS?

If NO, is documentation included?

Regulation(s) Reviewed: KAR 5-5-11

Point of diversion ID No(s) being changed.

	ft. North	ft. West	
Authorized PD			
Proposed PD			
<hr/>			
Difference	0	0	
$a^2 + b^2 = c^2$	0	0	0
<hr/>			

GPS for proposed PD: Lat: Long:

Is proposed PD stacking on existing WRs? No Change.

Is Proposed PU overlapping existing WRs? Removing acres and making a complete overlap.

Neighboring certified well(s) notified:

Name

Address

Zip

Email: Phone:

Domestic well(s) notified:

Name

Address

Zip

Base Acres:

Perfected Acres:

Irr. Return-Flow %

Haskell County

7977: 552AF @ 1500gpm, 5160N 4818W, 3-30-32

319.04 acres, N2 3-30-32

8739: 1280AF @ 1920gpm, 2439N 5218W, 2-30-32. PD change is in the works and will then take care of AF reduction and make the ratio more in line

639.28 acres, 2-30-32

18479: 640AF @ 1240gpm, 2793N 4006W, 3-30-32

320 acres, 3-30-32

Combined: 2472AF on 1278.32 acres. 1.9AF/acre

Proposed:

GMD3 Change Review

500 acres, 3-30-32. Half mile pivot and dropping the corners in the section
500 acres, 2-30-32. Quarter mile pivot (125acres) in each quarter and
dropping the corners.
Combined: 2472AF on 1000 acres. 2.472AF/acres

Is a waiver needed: No new acres being proposed and will make a complete overlap on all three water rights.

Recommendation: After review of all information, it appears to meet current area rules. We will be working the PD change as soon as we get it. Staff recommends approval of the application.



RECEIVED

SEP 25 2023

Garden City Field Office
Division of Water Resources

Garden City Field Office
4532 W. Jones, Suite B
Garden City, KS 67846



Phone: 620-276-2901
Fax: 620-276-9315
www.agriculture.ks.gov

Mike Beam, Secretary

Laura Kelly, Governor

September 25, 2023

SOUTHWEST KANSAS GROUNDWATER
MANAGEMENT DISTRICT NO. 3
2009 E SPRUCE ST
GARDEN CITY KS 67846

Re: Request for Recommendation
Water Right, File Nos. 7977, 8739, 18479

Dear Mr. Norquest:

This is to advise you that Alvin Stoppel has filed an applications for approval of the Chief Engineer, Division of Water Resources, Kansas Department of Agriculture, to change the place of use.

We are delaying action on the change application to allow you time to review and provide a recommendation. Please submit a recommendation within 15 days from the date of this letter.

Thank you and as always feel free to contact this office at any time.

Sincerely,

A handwritten signature in blue ink that reads "Michael A. Meyer".

Michael A. Meyer
Water Commissioner

MAM
Enclosures