

NOTICE

This scan only represents the application as filed. The information contained herein meets the requirements of K.A.R. 5-3-1 or K.A.R. 5-5-1, and has been found acceptable for filing in the office of the Chief Engineer. The application should not be considered to be a complete application as per K.A.R. 5-3-1b or K.A.R. 5-5-2a.

THE STATE OF KANSAS



KANSAS DEPARTMENT OF AGRICULTURE
Jackie McClaskey, Secretary of Agriculture

DIVISION OF WATER RESOURCES
David W. Barfield, Chief Engineer

File Number 49,714
This item to be completed by the Division of Water Resources.

WATER RESOURCES RECEIVED

OCT 03 2016

10:00

KS DEPT OF AGRICULTURE

APPLICATION FOR PERMIT TO APPROPRIATE WATER FOR BENEFICIAL USE

Filing Fee Must Accompany the Application
(Please refer to Fee Schedule attached to this application form.)

To the Chief Engineer of the Division of Water Resources, Kansas Department of Agriculture,
1320 Research Park Drive, Manhattan, Kansas 66502:

1. Name of Applicant (Please Print): Donald and Patricia Schrag
Address: 5350 SE 100 Street
City: Kingman State KS Zip Code 67068-8334
Telephone Number: (316) 650-7272

2. The source of water is: surface water in _____ (stream)
OR groundwater in South Fork Ninnescah (drainage basin)

Certain streams in Kansas have minimum target flows established by law or may be subject to administration when water is released from storage for use by water assurance district members. If your application is subject to these regulations on the date we receive your application, you will be sent the appropriate form to complete and return to the Division of Water Resources.

3. The maximum quantity of water desired is 106.8 acre-feet OR n/a gallons per calendar year, to be diverted at a maximum rate of 800 gallons per minute OR n/a cubic feet per second.

Once your application has been assigned a priority, the requested maximum rate of diversion and maximum requested quantity of water under that priority number can **NOT** be increased. Please be certain your requested maximum rate of diversion and maximum quantity of water are appropriate and reasonable for your proposed project and are in agreement with the Division of Water Resources' requirements.

4. The water is intended to be appropriated for (Check use intended):
(a) Artificial Recharge (b) Irrigation (c) Recreational (d) Water Power
(e) Industrial (f) Municipal (g) Stockwatering (h) Sediment Control
(i) Domestic (j) Dewatering (k) Hydraulic Dredging (l) Fire Protection
(m) Thermal Exchange (n) Contamination Remediation

YOU **MUST** COMPLETE AND ATTACH ADDITIONAL DIVISION OF WATER RESOURCES FORM(S) PROVIDING INFORMATION TO SUBSTANTIATE YOUR REQUEST FOR THE AMOUNT OF WATER FOR THE INTENDED USE REFERENCED ABOVE.

For Office Use Only:							
F.O. <u>2</u>	GMD <u>RFZ</u>	Meets K.A.R. 5-3-1 (YES/NO) <u>YES</u>	Use <u>E122</u>	Source <u>S</u>	County <u>EM</u>	By <u>AW</u>	Date <u>10/3/16</u>
Code _____	Fee \$ <u>300</u>	TR # _____	Receipt Date <u>10/3/16</u>	Check # <u>1336</u>			

SCANNED 10/14/2016 LCM

5. The location of the proposed wells, pump sites or other works for diversion of water is:

Note: For the application to be accepted, the point of diversion location must be described to at least a 10 acre tract, unless you specifically request a 60 day period of time in which to locate the site within a specifically described, minimal legal quarter section of land. (request 60 days to locate well site)

(A) One in the ____ quarter of the ____ quarter of the NE quarter of Section 2, more particularly described as being near a point ____ feet North and ____ feet West of the Southeast corner of said section, in Township 29 South, Range 7 West, Kingman County, Kansas.

(B) One in the ____ quarter of the ____ quarter of the NE quarter of Section 2, more particularly described as being near a point ____ feet North and ____ feet West of the Southeast corner of said section, in Township 29 South, Range 7 West, Kingman County, Kansas.

(C) One in the ____ quarter of the ____ quarter of the NE quarter of Section 2, more particularly described as being near a point ____ feet North and ____ feet West of the Southeast corner of said section, in Township 29 South, Range 7 West, Kingman County, Kansas.

(D) One in the ____ quarter of the ____ quarter of the ____ quarter of Section ____, more particularly described as being near a point ____ feet North and ____ feet West of the Southeast corner of said section, in Township ____ South, Range ____ East/West (circle one), _____ County, Kansas.

If the source of supply is groundwater, a separate application shall be filed for each proposed well or battery of wells, except that a single application may include up to four wells within a circle with a quarter (1/4) mile radius in the same local source of supply which do not exceed a maximum diversion rate of 20 gallons per minute per well.

A battery of wells is defined as two or more wells connected to a common pump by a manifold; or not more than four wells in the same local source of supply within a 300 foot radius circle which are being operated by pumps not to exceed a total maximum diversion rate of 800 gallons per minute and which supply water to a common distribution system.

6. The owner of the point of diversion, if other than the applicant is (please print):

Donald and Patricia Schrag, 5350 SE 100 Street, Kingman, KS 67068-8334 316 650 7272
(name, address and telephone number)

(name, address and telephone number)

You must provide evidence of legal access to, or control of, the point of diversion from the landowner or the landowner's authorized representative. Provide a copy of a recorded deed, lease, easement or other document with this application. In lieu thereof, you may sign the following sworn statement:

I have legal access to, or control of, the point of diversion described in this application from the landowner or the landowner's authorized representative. I declare under penalty of perjury that the foregoing is true and correct.

Executed on 9-30, 2016.

Donald Schrag
Applicant's Signature

The applicant must provide the required information or signature irrespective of whether they are the landowner. Failure to complete this portion of the application will cause it to be unacceptable for filing and the application will be returned to the applicant.

7. The proposed project for diversion of water will consist of a battery of two wells
(number of wells, pumps or dams, etc.)
and (was/will be) completed (on) _____
(Month/Day/Year - each was or will be completed)

8. The first actual application of water for the proposed beneficial use was or is estimated to be 2017 if approved
(Mo/Day/Year)

WATER RESOURCES
RECEIVED

OCT 03 2016

SCANNED

9. Will pesticide, fertilizer, or other foreign substance be injected into the water pumped from the diversion works?
 Yes No If "yes", a check valve shall be required.

All chemigation safety requirements must be met including a chemigation permit and reporting requirements.

10. If you are planning to impound water, please contact the Division of Water Resources for assistance, prior to submitting the application. Please attach a reservoir area capacity table and inform us of the total acres of surface drainage area above the reservoir.

Have you also made an application for a permit for construction of this dam and reservoir with the Division of Water Resources? Yes No

- If yes, show the Water Structures permit number here _____
- If no, explain here why a Water Structures permit is not required _____

11. The application must be supplemented by a U.S.G.S. topographic map, aerial photograph or a detailed plat showing the following information. On the topographic map, aerial photograph, or plat, identify the center of the section, the section lines or the section corners and show the appropriate section, township and range numbers. Also, please show the following information:

- (a) The location of the proposed point(s) of diversion (wells, stream-bank installations, dams, or other diversion works) should be plotted as described in Paragraph No. 5 of the application, showing the North-South distance and the East-West distance from a section line or southeast corner of section.
- (b) If the application is for groundwater, please show the location of any existing water wells of any kind within 1/2 mile of the proposed well or wells. Identify each existing well as to its use and furnish the name and mailing address of the property owner or owners. If there are no wells within 1/2 mile, please advise us.
- (c) If the application is for surface water, the names and addresses of the landowner(s) 1/2 mile downstream and 1/2 mile upstream from your property lines must be shown.
- (d) The location of the proposed place of use should be shown by crosshatching on the topographic map, aerial photograph or plat.
- (e) Show the location of the pipelines, canals, reservoirs or other facilities for conveying water from the point of diversion to the place of use.

A 7.5 minute U.S.G.S. topographic map may be obtained by providing the section, township and range numbers to: Kansas Geological Survey, 1930 Constant, Campus West, University of Kansas, Lawrence, Kansas 66047.

12. List any application, appropriation of water, water right, or vested right file number that covers the same diversion points or any of the same place of use described in this application. Also list any other recent modifications made to existing permits or water rights in conjunction with the filing of this application.

Currently, Water Right, File No. 29360 covers a portion of the same place of use. We may complete the battery of wells at a different location than the currently authorized location for 29360. File No. 29360 is scheduled for an abandonment hearing on October 12, 2016.

WATER RESOURCES RECEIVED

OCT 03 2016

SCANNED
KS DEPT OF AGRICULTURE

13. Furnish the following well information if the proposed appropriation is for the use of groundwater. If the well has not been completed, give information obtained from test holes, if available.

- request 60 day locate -

Information below is from: Test holes Well as completed Drillers log attached

Well location as shown in paragraph No.	(A)	(B)	(C)	(D)
Date Drilled	_____	_____	_____	_____
Total depth of well	_____	_____	_____	_____
Depth to water bearing formation	_____	_____	_____	_____
Depth to static water level	_____	_____	_____	_____
Depth to bottom of pump intake pipe	_____	_____	_____	_____

14. The relationship of the applicant to the proposed place where the water will be used is that of owner
(owner, tenant, agent or otherwise)

15. The owner(s) of the property where the water is used, if other than the applicant, is (please print):
Donald and Patricia Schrag, 5350 SE 100 Street, Kingman, KS 67068-8334 316 650 7272
(name, address and telephone number)

16. The undersigned states that the information set forth above is true to the best of his/her knowledge and that this application is submitted in good faith.

Dated at Stafford, Kansas, this 30th day of September, 2016.
(month) (year)

Donald E. Schrag
(Applicant Signature)

By _____
(Agent or Officer Signature)

Patricia Schrag Donald E. Schrag
(Agent or Officer - Please Print)

Assisted by CRC-SFFO Assistant Water Commissioner Date: 9/30/16
(office/title)

WATER RESOURCES RECEIVED

OCT 03 2016

SCANNED

KS DEPT OF AGRICULTURE

FEE SCHEDULE

1. The fee for an application for a permit to appropriate water for beneficial use, except for domestic use, shall be (see paragraph No. 2 below if requesting storage):

ACRE-FEET	FEE
0-100	\$200.00
101-320	\$300.00
More than 320	\$300.00 plus \$20.00 for each additional 100 acre-feet or any part thereof.

2. The fee for an application in which storage is requested, except for domestic use, shall be:

ACRE-FEET	FEE
0-250	\$200.00
More than 250	\$200.00 plus \$20.00 for each additional 250 acre-feet of storage or any part thereof.

Note: If an application requests both direct use *and* storage, the fee charged shall be as determined under No. 1 or No. 2 above, whichever is greater, but not both fees.

3. The fee for an application for a permit to appropriate water for water power or dewatering purposes shall be \$100.00 plus \$200.00 for each 100 cubic feet per second, or part thereof, of the diversion rate requested.

Note: The applicant shall notify the Chief Engineer and pay the statutorily required field inspection fee of \$400.00 when construction of the works for diversion has been completed, except that for applications filed on or after July 1, 2009, for works constructed for sediment control use and for evaporation from a groundwater pit for industrial use shall be accompanied by a field inspection fee of \$200.00.

MAKE CHECKS PAYABLE TO THE KANSAS DEPARTMENT OF AGRICULTURE

ATTENTION

A Water Conservation Plan may be required per K.S.A. 82a-733. A statement that your application for permit to appropriate water may be subject to the minimum desirable streamflow requirements per K.S.A. 82a-703a, b, and c may also be required from you. After the Division of Water Resources has had the opportunity to review your application, you will be notified whether or not you will need to submit a Water Conservation Plan. You also may be required to install a water flow meter or water stage measuring device on your diversion works prior to diverting water. There may be other special conditions or Groundwater Management District regulations that you will need to comply with if this application is approved.

CONVERSION FACTORS

1 acre-foot equals 325,851 gallons

1 million gallons equal 3.07 acre-feet

**WATER RESOURCES
RECEIVED**

OCT 03 2016

KS DEPT OF AGRICULTURE

SCANNED

File No. _____

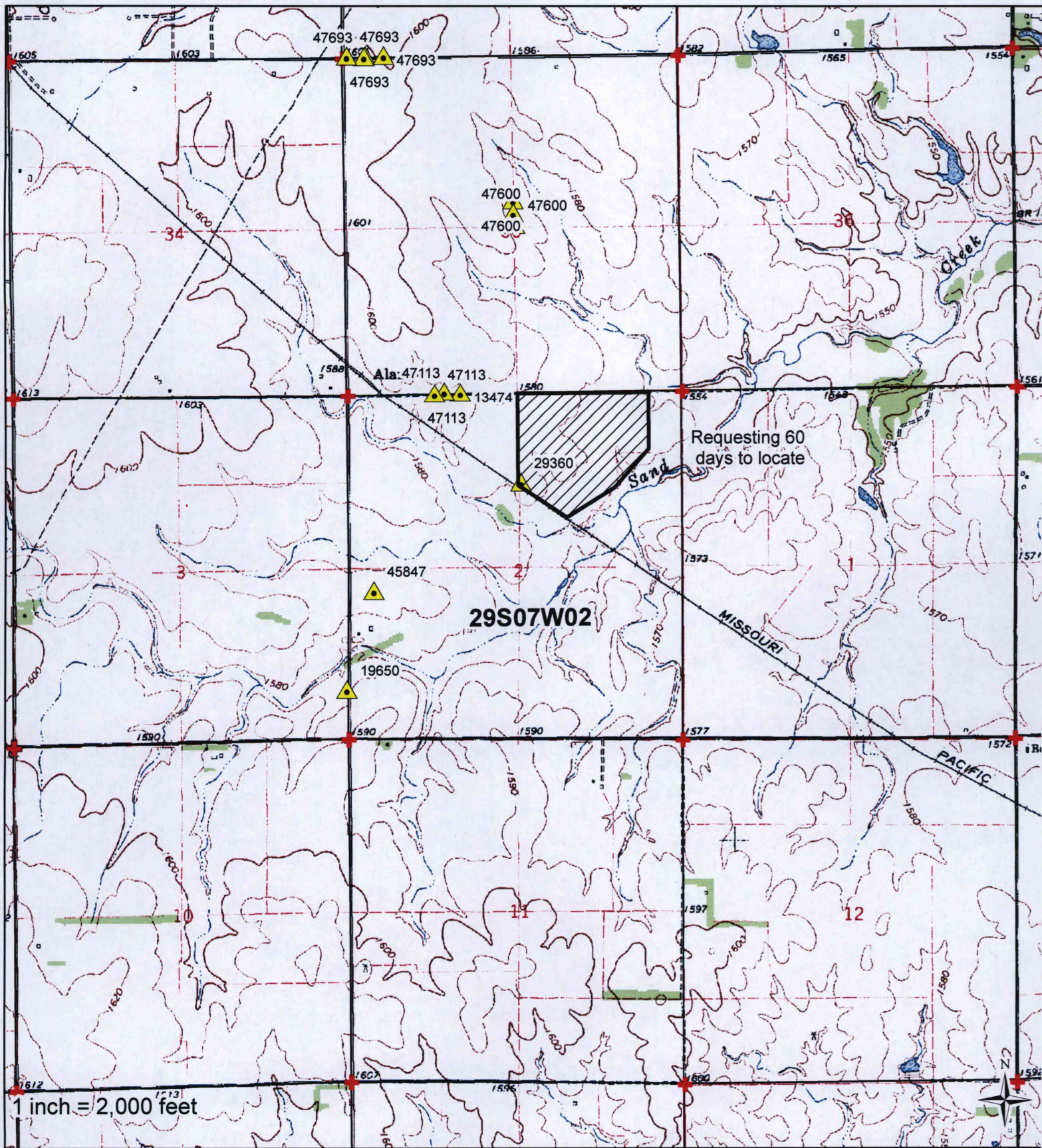

1 inch = 2,000 feet

I declare that all water wells or diversion sites using the same source of supply and within 1/2 mile of the proposed point of diversion have been plotted on the application map. **WATER RESOURCES RECEIVED**

- ★ Domestic Wells
- Proposed PD
- ▲ Water Rights
- ⊕ SFFOsec_corners
- ▨ Proposed Place of Use

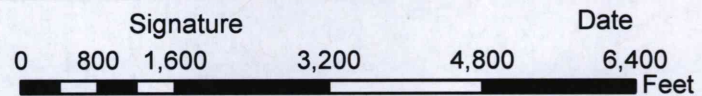

Date

SCANNED OCT 03 2016

KS DEPT OF AGRICULTURE



I declare that all water wells or diversion sites using the same source of supply and within 1/2 mile of the proposed point of diversion have been plotted on the application map.

WATER RESOURCES RECEIVED

- ★ Domestic Wells
- ⊕ Proposed PD
- ▲ Water Rights
- ⊕ SFFOsec_corners
- ▨ Proposed Place Of Use

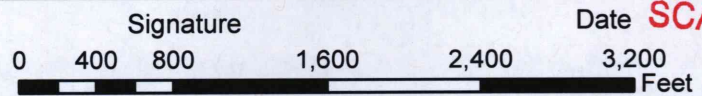

Date **SCANNED** OCT 03 2016

KS DEPT OF AGRICULTURE

IRRIGATION USE SUPPLEMENTAL SHEET

File No. 49,714

Name of Applicant (Please Print): Donald and Patricia Schrag

1. Please supply the name and address of each landowner, the legal description of the lands to be irrigated, and designate the actual number of acres to be irrigated in each forty acre tract or fractional portion thereof:

Landowner of Record NAME: Donald and Patricia Schrag

ADDRESS: Donald and Patricia Schrag, 5350 SE 100 Street, Kingman, KS 67068-8334

S	T	R	NE¼				NW¼				SW¼				SE¼				TOTAL
			NE	NW	SW	SE	NE	NW	SW	SE	NE	NW	SW	SE	NE	NW	SW	SE	
2	29S	7W	21	40	13.8	1.5													76.3

Landowner of Record NAME: _____

ADDRESS: _____

S	T	R	NE¼				NW¼				SW¼				SE¼				TOTAL
			NE	NW	SW	SE	NE	NW	SW	SE	NE	NW	SW	SE	NE	NW	SW	SE	

Landowner of Record NAME: _____

ADDRESS: _____

S	T	R	NE¼				NW¼				SW¼				SE¼				TOTAL
			NE	NW	SW	SE	NE	NW	SW	SE	NE	NW	SW	SE	NE	NW	SW	SE	

2. Please complete the following information for the description of the operation for the irrigation project. Attach supplemental sheets as needed.

a. Indicate the soils in the field(s) and their intake rates:

Soil Name	Percent of field (%)	Intake Rate (in/hr)	Irrigation Design Group
_____	_____	_____	_____
_____	_____	_____	_____
_____	_____	_____	_____
_____	_____	_____	_____
_____	_____	_____	_____
Total:	100 %		

b. Estimate the average land slope in the field(s): _____ %

Estimate the maximum land slope in the field(s): _____ %

c. Type of irrigation system you propose to use (check one):

- Center pivot Center pivot - LEPA "Big gun" sprinkler
 Gravity system (furrows) Gravity system (borders) Sideroll sprinkler

Other, please describe: Sub surface drip system

d. System design features:

i. Describe how you will control tailwater:

ii. For sprinkler systems:

(1) Estimate the operating pressure at the distribution system: _____ psi

(2) What is the sprinkler package design rate? _____ gpm

(3) What is the wetted diameter (twice the distance the sprinkler throws water) of a sprinkler on the outer 100 feet of the system? _____ feet

(4) Please include a copy of the sprinkler package design information.

e. Crop(s) you intend to irrigate. Please note any planned crop rotations:

crabgrass, perennial rye/crops, for baling & feeding livestock

DES 9-30-16

f. Please describe how you will determine when to irrigate and how much water to apply (particularly important if you do not plan a full irrigation).

Don would test soil moisture.

DES 9-30-16

You may attach any additional information you believe will assist in informing the Division of the need for your request.

WATER RESOURCES RECEIVED

OCT 03 2016

September 30, 2016
(Date)

Kansas Department of Agriculture
Division of Water Resources
David W. Barfield, Chief Engineer
1320 Research Park Drive
Manhattan, Kansas 66502

Re: Application File No. 49,714

Minimum Desirable Streamflow

Dear Sir:

I understand that a Minimum Desirable Streamflow requirement has been established by the legislature for the source of supply to which the above referenced application applies.

I understand that diversion of water pursuant to this application will be subject to regulation any time Minimum Desirable Streamflow requirements are not being met.

I also understand that if this application is approved, there could be times, as determined by the Division of Water Resources, when I would not be allowed to divert water. I realize that this could affect the economics of my decision to appropriate water.

I am aware of the above factors, and with the knowledge thereof, request that the Division of Water Resources proceed with processing and approval, if possible, of the above referenced application.

Donald E Schrag P. Schrag
Signature of Applicant

State of Kansas)
County of Stafford) ss

Donald E Schrag Patricia Schrag
(Print Applicant's Name)

I hereby certify that the foregoing instrument was signed in my presence and sworn to before me this 30 day of September, 2016.



Michaela Kirmer
Notary Public

My Commission Expires.

WATER RESOURCES
RECEIVED

OCT 03 2016

49,714

**MINIMUM DESIRABLE STREAMFLOW FORM TO BE USED WHEN
APPLICABLE WHEN FILING AN APPLICATION FOR PERMIT
TO APPROPRIATE WATER FOR BENEFICIAL USE**

The Kansas Legislature has established minimum desirable streamflows for the streams listed below. If your proposed diversion of water is going to be from one of these watercourses or adjacent alluvial aquifers, please complete the back side of this page and submit it along with your application for permit to appropriate water.

Arkansas River
Big Blue River
Chapman Creek
Chikaskia River
Cottonwood River
Delaware River
Little Arkansas River
Little Blue River
Marais des Cygnes River
Medicine Lodge River
Mill Creek (Wabaunsee Co. area)
Neosho River

Ninnescah River
North Fork Ninnescah River
Rattlesnake Creek
Republican River
Saline River
Smoky Hill River
Solomon River
South Fork Ninnescah
Spring River
Walnut River
Whitewater River

**WATER RESOURCES
RECEIVED**

OCT 03 2016

KS DEPT OF AGRICULTURE SCANNED

49,714

VOLUNTARY WAIVER OF HEARING & DISMISSAL OF WATER RIGHT

To: Kansas Department of Agriculture
Division of Water Resources (DWR)
1320 Research Park Drive
Manhattan, Kansas 66502
<http://agriculture.ks.gov/dwr>

Re: Appropriation of Water
Water Right
Vested Right
Term Permit
(Check Appropriate Box Above)
File No. 29360

The undersigned owner(s) and/or authorized agent(s) of the above referenced water right, or permit, freely and voluntarily request that the file be dismissed and its priority forfeited. By signing this waiver, I am indicating my understanding and agreement that I am relinquishing all right, title and interest in said water right.

The signature(s) below represent all present owners (or an authorized agent) for the file number shown above (attach duplicate copies of this document as necessary).

The signature(s) below also indicate(s) a waiver of any right to a hearing or an appeal that I/we may have had regarding the dismissal and termination of the above referenced file. I/we recognize that if this closure request is submitted to the Division of Water Resources, it will terminate this water right and forfeit any priority associated with it forever.

**** This is contingent upon approval of a new application on this land submitted with dismissal.**

Indicate here if you wish to retain the well(s) for domestic use (DWR water right not required):

Donald E Schrag
(Signature of Owner or Authorized Agent)

Pat Schrag
(Signature of Spouse or Title of Authorized Agent)

Donald E. Schrag
(Please print name here)

Patricia Schrag
(Please print name here)

5350 SE 100
(Mailing Address)

5350 SE 100
(Mailing Address)

Kingman KS 67068
(City, State, Zip)

Kingman KS 67068
(City, State, Zip)

ACKNOWLEDGMENT

State of Kansas)
County of Stafford)

This instrument was acknowledged before me this 30 day of September, 2016 by
(owners:)

(Seal)



Michaela Kirmer
Notary Public

My appointment expires

WATER RESOURCES RECEIVED

OCT 03 2016

DWR Initials



1320 Research Park Drive
Manhattan, Kansas 66502
Jackie McClaskey, Secretary

Phone: (785) 564-6700
Fax: (785) 564-6777
Email: ksag@kda.ks.gov
www.agriculture.ks.gov
Sam Brownback, Governor

October 3, 2016

DONALD AND PATRICIA SCHRAG
5350 SE 100 STREET
KINGMAN KS 67068

FILE COPY

RE: Application
File No. 49714

Dear Sir or Madam:

Your application for permit to appropriate water in 2-29S-7W in Kingman County, was received and has been assigned the file number noted above.

As a matter of record, the Division of Water Resources has on hand a large number of applications awaiting processing. Therefore to be fair to all concerned, and so that we can process those applications on hand in the order they were received, we intend to concentrate on the backlog of applications until the issue is resolved. Once review of your application has begun, we will contact you, if additional information is required.

In accordance with the provisions of the Kansas Water Appropriation Act, a portion of which is included below, the use of water as proposed prior to approval of the application is unlawful. Once approved, compliance with the terms, conditions and limitations of the permit is necessary. Conservation of the water resources of Kansas is required.

Section 82a-728 of the Kansas Water Appropriation Act, provides (a) except for the appropriation of water for the purpose of domestic use, . . . it shall be unlawful for any person to appropriate or threaten to appropriate water from any source without first applying for and obtaining a permit to appropriate water in accordance with the provisions of the Water Appropriation Act or for any person to violate any condition of a vested right, appropriation right or an approved application for a permit to appropriate water for beneficial use.

(b) (1) The violation of any provision of this section by any person is a class C misdemeanor . . .

A class C misdemeanor is punishable by a fine not to exceed \$500 and/or a term of confinement not to exceed one month in the county jail. Each day that the violation occurs constitutes a separate offense.

If you have any questions, please contact me at (785) 564-6645. If you wish to discuss a specific file, please have the file number ready so that we may help you more efficiently.

Sincerely,

Brent A Turney, P.G.
Change Application Unit Supervisor
Water Appropriation Program

BAT: dlw
pc: STAFFORD Field Office
GMD

SCANNED