

CHECK SHEET Short Change

(To be completed and attached to each application)

File No. 22295

Field Office No. 2

GMD No. 5

1. **Plugging agreement obtained for GMD?** Yes No Non Applicable
2. **Is Landowner correct as currently shown in WRIS?** Yes No **Address Change?** NO
If applicable, list Place of Use Overlap File Nos. 23868
3. **Is Water Use Correspondent correct as currently shown in WRIS?** Yes No **Address Change?** NO
Name of Former WUC --- Name of New WUC ---
4. a. **Point of diversion computer ID No(s).** NA **for point(s) being changed.**
- b. **Show feet distances from the** SE **corner of the section for the new point(s) of diversion:**

Action	PDIV ID	Geo Ctr?	Sec	Twp	Rng	'N	'W	County	Qualifiers
NO CHG	61911	NO	24	21S	16W	3960	3940	Pawnee	NC NW

- c. **If multiple points of diversion exist and rates and quantities are individually assigned, show:**
- | Old PDIV ID | Authorized Rate | Additional Rate | Authorized Quantity | Additional Quantity |
|-------------|-----------------|-----------------|---------------------|---------------------|
| _____ | _____ gpm/cfs | _____ gpm/cfs | _____ af/mgy | _____ af/mgy |
| _____ | _____ gpm/cfs | _____ gpm/cfs | _____ af/mgy | _____ af/mgy |
| _____ | _____ gpm/cfs | _____ gpm/cfs | _____ af/mgy | _____ af/mgy |
- d. **Name of Drainage Basin** _____ **Is this correctly shown in WRIS?** Yes No
- e. **Formation Name & No.** _____ **Special Use Area** _____
5. **Distances from the previous/original p/d:** _____ ' N / S _____ ' E / W

6. WATER RIGHT ACTION TRAIL COMMENTS

<u>12/11/2017</u>	Change Application Received (date accepted for priority)
<u>12/22/17</u>	Change Approved
_____/_____/_____	Notice and Proof by ____/____/_____
_____/_____/_____	Completion Requirement Removed (Change No. C_____)

7. METER ACTION TRAIL COMMENTS

<u>12/22/17</u>	DWR Meter Required by <u>12/31/2018</u>
_____/_____/_____	Anti-Reverse Meter Required by ____/____/_____
_____/_____/_____	Meter Seal Required by ____/____/_____

8. Base Acres 140 Year 1991 Minimum Reasonable Quantity 1.25 AF/acre

Date Created **12/22/17** by **TJS**
Date Entered _____ by _____

CHECK SHEET ATTACHMENT

File Number 22295

Changes to the place of use will be:

Action	Owner Person ID	Place Use ID #	Sec.	Twp.	Range		NE¼				NW¼				SW¼				SE¼				TOTAL ACRES
							NE¼	NW¼	SW¼	SE¼	NE¼	NW¼	SW¼	SE¼	NE¼	NW¼	SW¼	SE¼	NE¼	NW¼	SW¼	SE¼	
ENT MOD	60445	23431	24	21S	16W	Acres Authorized					39	36	40	40					39	40	24.5	38	296.5
						New Acres					39	36	40	40					39	40	24.5	38	296.5
						Acres Authorized																	
						New Acres																	
						Acres Authorized																	
						New Acres																	
						Acres Authorized																	
						New Acres																	

Names and Address:

1. Person ID # <u>60445</u> WFY HOLDING COMPANY PO BOX 1506 GREAT BEND KS 67530	2. Person ID # _____ _____ _____ _____	3. Person ID # _____ _____ _____ _____
--	---	---

GENERAL INSTRUCTIONS

- | | | |
|--|---|--|
| 1. Give to Applicant:
a. <u>Original</u> application/approval
b. Original receipt (one for <u>each</u> application)
c. Information packet containing:
<ul style="list-style-type: none"> • Notice and Proof form • Water Meter Specifications • Acceptable Meter list • Water level measurement tube specifications • Check Valve specifications • Pink Sheet - K.S.A. 82a-728 letter • Form stating to record in Register of Deeds Office (OPTIONAL AS NEEDED) | 2. Send to headquarters:
a. Good, scannable copy of application and/or approval and this check sheet
b. Original check and copy of receipt
c. Test hole log
d. GMD recommendation, if any
e. Map or aerial photograph, if any
3. Send to KDHE: Letter (KDHE.LT) advising of location of abandoned well. <input type="checkbox"/> | 4. Date stamp received and approved.
5. Complete ownership and WUC change information.

<u>ADDITIONAL PHOTOCOPIES</u>
HQ _____
GMD5 _____

_____ |
|--|---|--|

CONDITIONS

1. Insert notice and proof date.
2. Type or print applicant's/owner's name on line.
3. Complete notary statement.

Submit completed application to:
 Kansas Department of Agriculture
 Division of Water Resources
 Field Office for your area.
 Call for address:

Topeka -- (785) 296-5733
 Stafford -- (620) 234-5311
 Stockton -- (785) 425-6787
 Garden City -- (620) 276-2901
<http://agriculture.ks.gov/dwr>

DWR FIELD OFFICE APPLICATION FOR APPROVAL TO CHANGE THE PLACE OF USE AND/OR THE POINT OF DIVERSION **WATER METER REQUIRED**



STATE OF KANSAS

Filing Fee Must Accompany the Application, K.S.A. 82a-708b(b), as amended.
 Fee Schedule is on the third page of this application form.

Paragraph Nos. 1, 2, 3 & 5 must be completed. Complete all other applicable portions. If change in point of diversion is greater than 100 feet, or if place of use will be changed, include a topographic map or detailed plat showing the authorized and proposed point(s) of diversion and/or place of use.

RECEIVED
10:00am
DEC 11 2017

File No. 22295

Stafford Field Office
 Division of Water Resources

1. Application is hereby made for approval of the Chief Engineer to change the (check one or both):

Place of Use Point of Diversion

under the water right which is the subject of this application in accordance with the conditions described below.

The source of supply is: Groundwater Surface water

2. Name and address of Applicant: Bronson Smith

ILS Farms, PO Box 1506, Great Bend KS 67530

Phone Number: (620)792-6166

Email address: _____

Name and address of Water Use Correspondent: ILS Farms

WFY Holding Company INC, PO Box 1506, Great Bend KS 67530

Phone Number: (620)792-6166

Email address: _____

3. The presently authorized place of use is:

Owner of Land ---- NAME: WFY Holding Company INC

ADDRESS: PO Box 1506, Great Bend KS 67530

(If there is more than one landowner, attach supplemental sheets as necessary.)

Sec.	Twp.	Range	NE¼				NW¼				SW¼				SE¼				TOTAL ACRES
			NE¼	NW¼	SW¼	SE¼	NE¼	NW¼	SW¼	SE¼	NE¼	NW¼	SW¼	SE¼	NE¼	NW¼	SW¼	SE¼	
24	21	16W					40	40	40	40									160

4. If this application is for a change in place of use, it is proposed that the place of use be changed to:

Owner of Land ---- NAME: WFY Holding Company INC

ADDRESS: PO Box 1506, Great Bend KS 67530

(If there is more than one landowner, attach supplemental sheets as necessary.)

Sec.	Twp.	Range	NE¼				NW¼				SW¼				SE¼				TOTAL ACRES
			NE¼	NW¼	SW¼	SE¼	NE¼	NW¼	SW¼	SE¼	NE¼	NW¼	SW¼	SE¼	NE¼	NW¼	SW¼	SE¼	
24	21	16W					39	36	40	40					39	40	24.5	38	296.5

For Office Use Only: Code _____ Fee \$ 200 - TR # _____ Receipt Date _____ Check # 15973

5. **Presently authorized point of diversion:**
 One in the _____ Quarter of the _____ Quarter of the NC NW Quarter
 of Section 24, Township 21 South, Range 16 W,
 in Pawnee County, Kansas, 3,960 feet North 3,940 feet West of Southeast corner of section.
 Authorized Rate 575 gpm Authorized Quantity 151 AF Depth of well 65 (feet)
(DWR use only: Computer ID No. 3 GPS 3,900 feet North 3,931 feet West)
 This point will not be changed This point will be changed as follows: No change, point better described with GPS as follows:
Proposed point of diversion: (Complete only if change is requested or if existing point is better described by GPS)
 One in the _____ Quarter of the _____ Quarter of the _____ Quarter
 of Section _____, Township _____ South, Range _____ (E/W),
 in _____ County, Kansas, _____ feet North _____ feet West of Southeast corner of section.
 Proposed Rate _____ Proposed Quantity _____ Proposed well depth (feet) _____
 This point is: Additional Well Geo Center List other water rights that will use this point none _____

6. **Presently authorized point of diversion:**
 One in the _____ Quarter of the _____ Quarter of the _____ Quarter
 of Section _____, Township _____ South, Range _____ (E/W),
 in _____ County, Kansas, _____ feet North _____ feet West of Southeast corner of section.
 Authorized Rate _____ Authorized Quantity _____ Depth of well _____ (feet)
(DWR use only: Computer ID No. _____ GPS _____ feet North _____ feet West)
 This point will not be changed This point will be changed as follows: No change, point better described with GPS as follows:
Proposed point of diversion: (Complete only if change is requested or if existing point is better described by GPS)
 One in the _____ Quarter of the _____ Quarter of the _____ Quarter
 of Section _____, Township _____ South, Range _____ (E/W),
 in _____ County, Kansas, _____ feet North _____ feet West of Southeast corner of section.
 Proposed Rate _____ Proposed Quantity _____ Proposed well depth (feet) _____
 This point is: Additional Well Geo Center List other water rights that will use this point _____

7. The changes herein are desired for the following reasons?
 (please be specific) Create P/U overlap with File 23868
and better describe acres based on original application
map. No actual changes to acres.

8. If a well, is the test hole log attached? Yes No

9. The change(s) (was)(will be) completed by?
Spring 2018

10. If the point of diversion is a well:
 (a) What are you going to do with the old well?
N/A

(b) When will this be done? N/A

11. Groundwater Management District recommendation attached? Yes No

12. Assisted by EKF // SFFO

13a. If the proposed point of diversion will be relocated within 100 feet of the existing point of diversion, indicate its location on the diagram below in relation to the existing point of diversion. **(PLEASE NOTE: The "X" in center of diagram below represents presently authorized point of diversion.)**

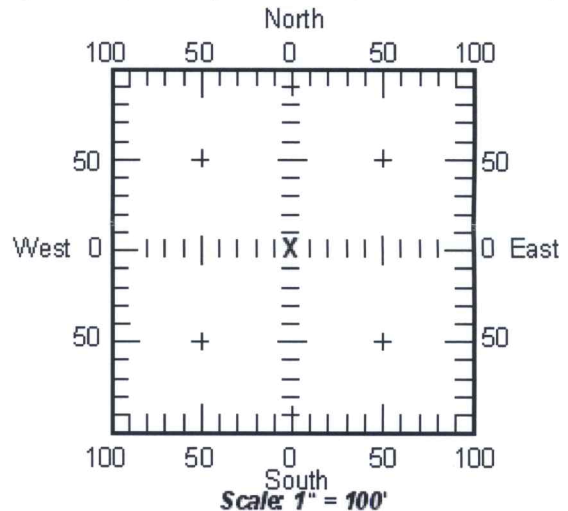

13b. If the proposed point of diversion will be relocated more than 100 feet but within 1320 feet from the existing point of diversion, attach a topographic map or aerial photograph. For groundwater sources, show all wells (including domestic) within one-half mile of the proposed point of diversion and the names and mailing addresses of the owners. For surface water sources, show the names and addresses of the landowner(s) one-half mile downstream and one-half mile upstream from your property lines.

RECEIVED

DEC 11 2017

Stafford Field Office

14. If the proposed groundwater point of diversion is 300 or fewer feet from existing point of diversion, complete the following:
- (a) Does the undersigned represent all owners of the currently authorized place(s) of use identified in this application?
 Yes No (If no, all owners must sign this application.)
 - (b) Will the ownership interest of any owner of the currently authorized place(s) of use identified in this application be adversely affected if this application is approved as requested?
 Yes No (If yes, all owners must sign this application.)
 - (c) If this application is not approved expeditiously, will there be substantial damage to property, public health or safety?
 Yes No (If no, all owners must sign this application.)

If the application proposes a surface water change in point of diversion, a groundwater change in point of diversion greater than 300 feet, or a change in place of use, the application must be signed by all owners of the currently authorized place of use, or their duly authorized agent (attach notarized statement authorizing representation).

I hereby verify, being first duly sworn upon my oath or affirmation and under penalty of perjury, that I am of lawful age and the owner, the spouse of the owner, or a duly authorized agent of the owner(s) to make this application on their behalf, in regards to the water right(s) to which this application pertains. I further verify that the statements contained in this application are true, correct and complete.

Dated at Great Bend, Kansas, this 16 day of November, 2017.

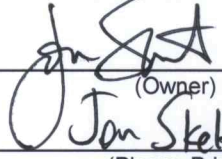
 (Owner)	 (Spouse)
<u>Jon Skelton v.p.</u> (Please Print)	 (Please Print)
 (Owner)	 (Spouse)
 (Please Print)	 (Please Print)
 (Owner)	 (Spouse)
 (Please Print)	 (Please Print)

State of Kansas }
 County of Barton } SS

I hereby certify that the foregoing application was signed in my presence and sworn to before me this 16th day of November, 2017.

LISA FERGUSON
 Notary Public - State of Kansas
 My Appt. Expires 1/25/19

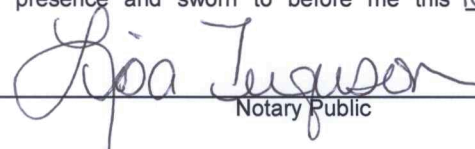
 Notary Public

My Commission Expires _____

ONLY COMPLETE APPLICATIONS WILL BE PROCESSED. To be complete, all of the applicable portions of the application form must be completed with accurate information; maps, if necessary, must be included; signatures of all the appropriate owners' must be affixed to the application and notarized; and the appropriate fee must be paid.

FEE SCHEDULE

Each application to change the place of use or the point of diversion under this section shall be accompanied by the application fee set forth in the schedule below: Make checks payable to: **Kansas Department of Agriculture**

(1) Application to change a point of diversion 300 feet or less	\$100
(2) Application to change a point of diversion more than 300 feet	\$200
(3) Application to change the place of use	\$200

RECEIVED

DEC 11 2017

SUMMARY ORDER APPROVING APPLICATION FOR CHANGE AND IMPOSING CONDITIONS

This Summary Order is issued under authority of K.S.A. 82a-708b, as amended, and K.A.R. 5-5-1, *et seq.* and other applicable provisions of the *Kansas Water Appropriation Law, K.S.A. 82a-701 et seq.*, and rules and regulations promulgated thereunder. With the exception of those conditions expressly contained herein, this Summary Order does not change the terms, conditions and limitations of File No. 22295.

1. A change application was received on 12/11/2017 requesting that the place of use and / or point of diversion authorized under the above-referenced file number be changed as described in the application.
2. On and after the effective date of this summary order, the authorized place(s) of use shall be located substantially as shown on the topographic map accompanying the application to change the place of use. Applicable Not Applicable
3. The change in point of diversion shall not impair existing rights and shall be limited to the same source or sources of water as previously authorized. The point of diversion authorized by this summary order shall be located within a foot radius of the authorized point(s) of diversion. Applicable Not Applicable
4. The point(s) of diversion authorized herein shall not actually be located more than feet from the previously authorized point(s) of diversion. Applicable Not Applicable
5. As required by K.A.R. 5-3-5d, if the works for diversion is a well with a diversion rate of 100 gallons per minute or more, a tube or other device suitable for making water level measurements shall be installed, operated and maintained in accordance with K.A.R. 5-6-13. Applicable Not Applicable
6. **The owner of the authorized place(s) of use shall properly install an acceptable water flow meter on or before December 31, 2018**, or before the first use of water, whichever occurs first. The water flow meter shall be installed, operated and maintained in accordance with K.A.R. 5-1-4 through 5-1-12. As required by K.S.A. 82a-732, as amended, and K.A.R. 5-3-5e, the owner shall maintain records and report the reading of the water flow meter and the total quantity of water diverted annually to the Chief Engineer by March 1 following the end of each calendar year.
 Applicable Not Applicable
7. **Installation of the works for diversion of water shall be completed on or before December 31, 20**, or within any authorized extension of time. By March 1, 20 the applicant shall notify the Chief Engineer that construction of the works for diversion has been completed, on the form provided by the Chief Engineer, as required by K.A.R. 5-8-4e.
 Applicable Not Applicable
8. **The completed well log shall be submitted with the required notice.** Applicable Not Applicable
9. All diversion works into which any type of chemical or other foreign substance will be injected into the water shall be equipped with an in-line, automatic, quick-closing check valve capable of preventing pollution of the source of the water supply. The check valve(s) shall be installed, operated and maintained in accordance with K.A.R. 5-3-5c. Applicable Not Applicable
10. Additional Conditions are attached. Yes No
11. In accordance with K.S.A. 82a-708a, as amended, and K.A.R. 5-5-14, all of the owners of the authorized place(s) of use of water appropriated under the above-referenced file number are responsible for compliance with its terms, conditions and limitations, as amended and/or supplemented by this Summary Order, and with applicable provisions of the *Kansas Water Appropriation Law* and the *Rules and Regulations* promulgated thereunder. Failure to comply with these provisions may result in civil penalties pursuant to K.S.A. 82a-737, as amended, and/or the suspension or revocation and dismissal of the water or appropriation right or any other enforcement actions authorized by law.

Administrative Appeal and Effective Date of Order

If you are aggrieved by this order, pursuant to K.S.A. 82a-1901, you may request an evidentiary hearing before the Chief Engineer or request administrative review by the Secretary of Agriculture. A request for hearing by the Chief Engineer must be filed within **15 days** of service of this Order and a request for administrative review by the Secretary must be filed within **30 days** pursuant to K.S.A. 77-531. Any request for administrative review must state a basis for review pursuant to K.S.A. 77-527. File any request with **Kansas Department of Agriculture, Legal Division, 1320 Research Park Drive, Manhattan, KS 66502**. Failure to timely request a hearing or review may preclude review under the Kansas Judicial Review Act.

For Use by Register of Deeds

FOR OFFICE USE ONLY
APPLICATION APPROVED AND SUMMARY ORDER ISSUED

By: Jeff Lanterman
Duly Authorized Designee of the Chief Engineer
(Print Name): Jeff Lanterman
Division of Water Resources - Kansas Department of Agriculture
Date of Issuance: 12/22/2017
State of Kansas)
County of Stafford) SS
Acknowledged before me on 12/22/2017
by Jeff Lanterman
Signature: Jessica Engelbrecht
Notary Public



My commission expires

(Notary Seal)

File No. 22295

RECEIVED

DEC 11 2017

Stafford Field Office
Division of Water Resources

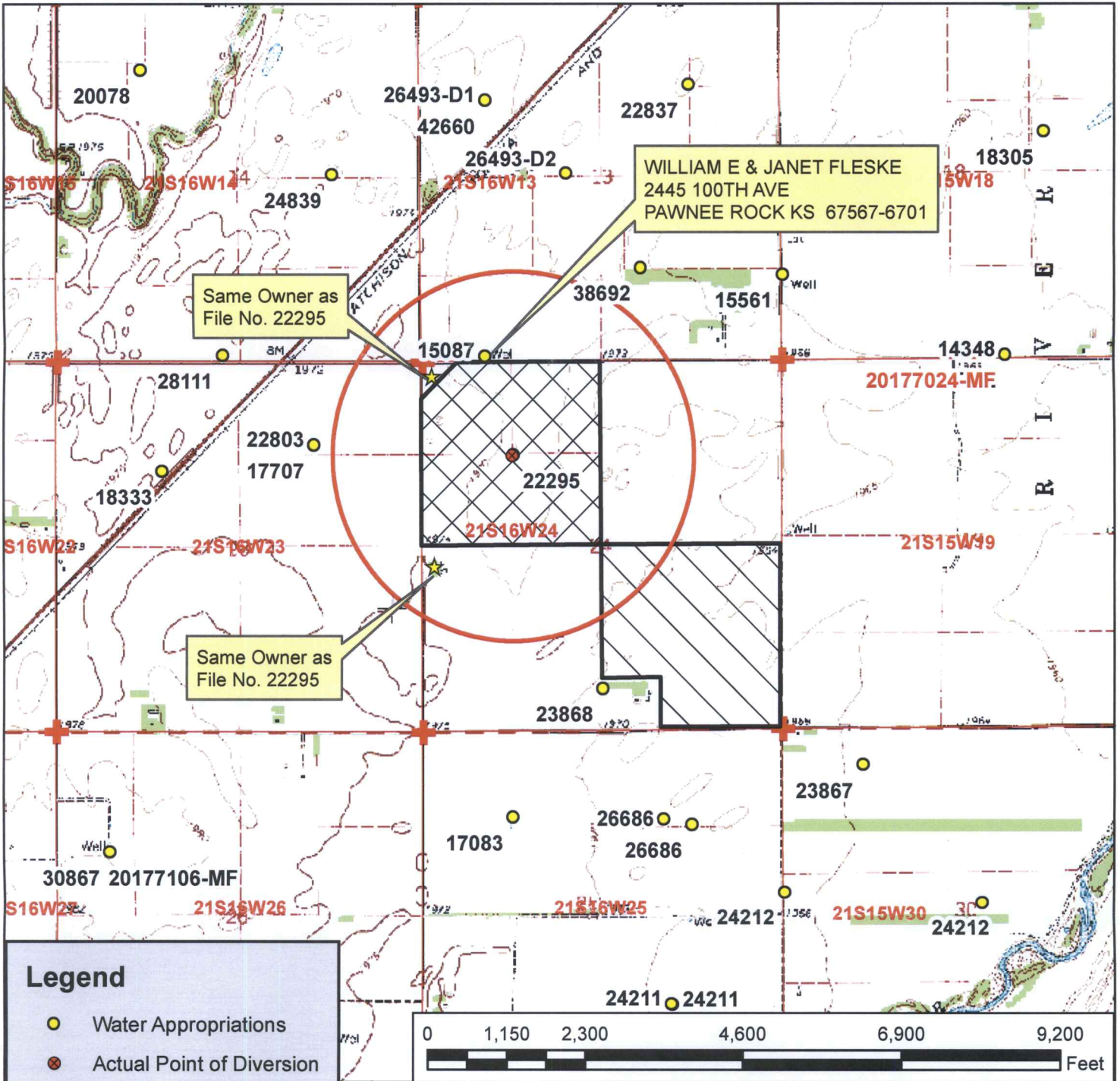

Legend

- Water Appropriations
- ⊗ Actual Point of Diversion
- ★ Domestic Well
- ⊕ Section Corner
- Half Mile Circle
- Section Line

Place of Use

- ▨ Proposed
- ▩ Authorized

Water Right, File No. 22295

Change in Place of Use Application Map
24-21-16W // Pawnee County

To the best of my knowledge, all of the known wells within
1/2 mile of the proposed point of diversion have been shown.

RECEIVED

DEC 11 2017

John Sant V.L.

Staff Office
Division of Water Resources





Stafford Field Office
300 S. Main Street
Stafford, Kansas 67578-1521
Jackie McClaskey, Secretary
David W. Barfield, Chief Engineer
Jeff Lanterman, Water Commissioner

Phone: (620) 234-5311
Fax: (620) 234-6900
www.agriculture.ks.gov
Sam Brownback, Governor

December 22, 2017

Bronson Smith
ILS Farms
PO Box 1506
Great Bend KS 67530

Re: Water Right, File No(s). 22295

Dear Water Right Owner:

Enclosed is the order executed by the Chief Engineer, Division of Water Resources, Kansas Department of Agriculture, approving the application for change under the above referenced file number(s).

Your attention is directed to the enclosures and to the terms, conditions and limitations specified in this approval for change. An acceptable water flow meter must be installed on your well before any water is applied as authorized under this change approval. A copy of the approved list of Certified Water Flowmeters as well as the regulations regarding the installation of flowmeters, measurement tubes and check valves can be found at <http://agriculture.ks.gov/divisions-programs/dwr/water-appropriation/water-flowmeters>. If you do not have access to the internet, please contact this office and we will send you a paper copy of the referenced information.

Since this order modifies the original document referred to above, it should be recorded with the Register of Deeds as other instruments affecting real estate.

Should you have any questions, please feel free to contact this office. If you wish to refer to a specific file, please reference it when you contact us.

Sincerely,

A handwritten signature in black ink, appearing to read "Jeff Lanterman".

Jeff Lanterman
Water Commissioner

Enclosures

pc: Water Rights Section
Groundwater Management District No.5
WFY Holding Company

CERTIFICATE OF SERVICE

On this **22nd** day of **December, 2017**, I hereby certify that the attached Change in Place of Use for Water Right, File No. **22295**, dated **December 22, 2017** was mailed via Certified U.S. mail to the following:

Bronson Smith
ILS Farms
PO Box 1506
Great Bend KS 67530

A copy of the letter was sent via First Class U.S. Mail to the following:

GMD #5
WFY Holding Company



Staff



KANSAS DEPARTMENT OF AGRICULTURE

Division of Water Resources

Stafford Field Office

MEMORANDUM

TO: File

DATE: 12/20/2017

FROM: Tyler Saryerwinnie

RE: File Nos. 22295 & 23868

This is a memorandum regarding surrounding well owner notification on irrigation field office PU changes and pertains to decisions made during the Water Commissioner meeting which took place on 11/16/2016 with directive from Lane Letourneau, Program Manager.

This is applicable to field office changes to increase the place of use by 10 acres or 10% (whichever is less) or a change in place of use to create a complete overlap in which no new acres are being irrigated.

During that meeting it was determined that no surrounding well owner notification will be sent under this type of Place of Use change. All well rates and quantities will remain unchanged and the referenced change will not cause impairment or impact surrounding well owners.

The change in place of use applications filed on **12/11/2017** for the above referenced files meet this criteria and surrounding well owners will not be notified.

Saryerwinnie, Tyler [KDA]

From: Saryerwinnie, Tyler [KDA]
Sent: Wednesday, December 20, 2017 12:03 PM
To: Orrin Feril (oferil@gmd5.org)
Cc: Conant, Cameron [KDA]
Subject: GMD Recommendation Request - File Nos. 22295 & 23868
Attachments: 22295.23868.Cover Letter.pdf; 22295.Change App.pdf; 23868.Change App.pdf

Orrin,

I have attached a cover letter and copies of two (2) change applications for GMD recommendation. Please provide the GMD recommendation by no later than January 11, 2018.

Please let me know if you are needing anything else, or have any questions.

Thank you,

Tyler

Tyler Saryerwinnie, Environmental Scientist
Kansas Department of Agriculture
Division of Water Resources
Stafford Field Office
Phone: (620)234-5311



Stafford Field Office
300 S. Main Street
Stafford, Kansas 67578-1521

Jackie McClaskey, Secretary
David W. Barfield, Chief Engineer
Jeff Lanterman, Water Commissioner

Phone: (620) 234-5311
Fax: (620) 234-6900
www.agriculture.ks.gov
Sam Brownback, Governor

December 20, 2017

Orrin Feril
Big Bend – GMD No. 5
125 S Main St.
Stafford, KS 67578

RE: Place of Use Change Applications, File Nos. 22,295 & 23,868

Dear Mr. Feril,

We are enclosing copies of the applications, as referenced above, for your review and recommendation. At this time the applications appear to be in proper form.

This office will delay any further action on this file for a period of 15 business days from the date of this letter to allow you time to submit your recommendation concerning the applications. Please submit your recommendation within the allotted time, or any authorized extension of time thereof.

If you have any questions, please feel free to contact the office.

Sincerely,

A handwritten signature in blue ink, appearing to read "T. Saryerwinnie".

Tyler Saryerwinnie
Environmental Scientist
Stafford Field Office
tyler.saryerwinnie@ks.gov

Enclosure

Saryerwinnie, Tyler [KDA]

From: Orrin Feril <oferil@gmd5.org>
Sent: Wednesday, December 20, 2017 3:51 PM
To: Saryerwinnie, Tyler [KDA]
Subject: Applications for Change, Water Right, File Nos. 22295 & 23868
Attachments: 22295 23868 2017-12-20 Rec.pdf

Tyler,

I'm attaching the recommendation requested by your office in a letter dated December 20, 2017. Please let me know if you have any questions.

Thank you for your consideration in this matter,

Orrin

--

Orrin Feril

Manager
Big Bend GMD#5
Email: oferil@gmd5.org
Phone: (620) 234-5352
Mobile: (620) 388-0172
Fax: (620) 234-5718
www.gmd5.org

Darrell Wood - Edwards (Pres.)
Fred Grunder - Pratt (V Pres.)
John Janssen - Kiowa (Treas.)
Jerry Cullop - Rice
Justin Gatz - Reno
Kent Lamb - Stafford
Phil Martin - Barton
Bob Standish - Pawnee
Tom Taylor - At-Large



Orrin Feril, Manager
125 South Main Street
Stafford, Kansas 67578
ph: (620) 234-5352
fx: (620) 234-5718
gmd5@gmd5.org
www.gmd5.org

December 20, 2017

Tyler Saryerwinnie
Division of Water Resources
Kansas Department of Agriculture
300 S Main St
Stafford, KS 67578

RE: Water Right File Nos. 22295 & 23868
Change in the Place of Use

Dear Mr. Saryerwinnie,

Big Bend Groundwater Management District #5 has reviewed the above referenced applications to change the places of use. It is the understanding of the District that the intent of these changes is to create an overlap of the places of use between these water right files. Therefore, the applications appear to be consistent with 5-25-20(b) and are recommended for approval.

The applications to change are subject to the District's well equipment regulation K.A.R. 5-25-5 for a required flow meter.

Please feel free to give me a call if you have any questions.

Sincerely,

A handwritten signature in black ink, appearing to read "Orrin Feril".

Orrin Feril
Manager

RECEIVED

DEC 20 2017

Stafford Field Office
Division of Water Resources