

CHECK SHEET Short Change

(To be completed and attached to each application)

File No. 31904

Field Office No. 2

GMD No. _____

1. **Plugging agreement obtained for GMD?** Yes No Non Applicable

2. **Is Landowner correct as currently shown in WRIS?** Yes No **Address Change?** NO
If applicable, list Place of Use Overlap File Nos. None

3. **Is Water Use Correspondent correct as currently shown in WRIS?** Yes No **Address Change?** NO
Name of Former WUC _____ Name of New WUC _____

4. a. **Point of diversion computer ID No(s).** 3 for point(s) being changed.

b. **Show feet distances from the** SE **corner of the section for the new point(s) of diversion:**

Action	PDIV ID	Geo Ctr?	Sec	Twp	Rng	'N	'W	County	Qualifiers
MOD	33314	NO	34	31S	18W	1302	2442	Comanche	NW SW SE

c. **If multiple points of diversion exist and rates and quantities are individually assigned, show:**

Old PDIV ID	Authorized Rate	Additional Rate	Authorized Quantity	Additional Quantity
_____	_____ gpm/cfs	_____ gpm/cfs	_____ af/mgy	_____ af/mgy
_____	_____ gpm/cfs	_____ gpm/cfs	_____ af/mgy	_____ af/mgy
_____	_____ gpm/cfs	_____ gpm/cfs	_____ af/mgy	_____ af/mgy

d. **Name of Drainage Basin** Salt Fork Arkansas River **Is this correctly shown in WRIS?** Yes No

e. **Formation Name & No.** _____ **Special Use Area** _____

5. **Distances from the previous/original p/d:** _____ ' N / S _____ ' E / W

6. WATER RIGHT ACTION TRAIL COMMENTS

05/03/2017 Change Application Received (date accepted for priority)
5 / 12 / 17 Change Approved
Notice and Proof by _____ / _____ / _____
_____ / _____ / _____ Completion Requirement Removed (Change No. C _____)

7. METER ACTION TRAIL COMMENTS

5 / 12 / 17 DWR Meter Required by 12/31/2017
_____ / _____ / _____ Anti-Reverse Meter Required by _____ / _____ / _____
_____ / _____ / _____ Meter Seal Required by _____ / _____ / _____

8. Base Acres 130 Year Multiple Minimum Reasonable Quantity 1.27 AF/acre

Date Created **5/9/17** by **TJS**
Date Entered by

CHECK SHEET ATTACHMENT

9. Changes to the place of use will be:

File Number 31904

Action	Owner Person ID	Place Use ID #	Sec.	Twp.	Range		NE¼				NW¼				SW¼				SE¼				TOTAL ACRES
							NE¼	NW¼	SW¼	SE¼	NE¼	NW¼	SW¼	SE¼	NE¼	NW¼	SW¼	SE¼	NE¼	NW¼	SW¼	SE¼	
MOD	65392	34450	34	31S	18W	Acres Authorized																	130
						New Acres																	
						Acres Authorized																	
						New Acres																	
						Acres Authorized																	
						New Acres																	
						Acres Authorized																	
						New Acres																	

Names and Address:

1. Person ID # <u>65392</u> DAVID M KRIEGEL DEREK M KRIEGEL PO BOX 698 COLDWATER KS 67029	2. Person ID # _____ _____ _____ _____ _____	3. Person ID # _____ _____ _____ _____ _____
-------------------------------------------------------------------------------------------------------	----------------------------------------------------------	----------------------------------------------------------

GENERAL INSTRUCTIONS

1. Give to Applicant:
 - a. Original application/approval
 - b. Original receipt (one for each application)
 - c. Information packet containing:
 - Notice and Proof form
 - Water Meter Specifications
 - Acceptable Meter list
 - Water level measurement tube specifications
 - Check Valve specifications
 - Pink Sheet - K.S.A. 82a-728 letter
 - Form stating to record in Register of Deeds Office (OPTIONAL AS NEEDED)

2. Send to headquarters:
 - a. Good, scannable copy of application and/or approval and this check sheet
 - b. Original check and copy of receipt
 - c. Test hole log
 - d. GMD recommendation, if any
 - e. Map or aerial photograph, if any
3. Send to KDHE: Letter (KDHE.LT) advising of location of abandoned well.

4. Date stamp received and approved.
5. Complete ownership and WUC change information.

ADDITIONAL PHOTOCOPIES

HQ _____

CONDITIONS

1. Insert notice and proof date.
2. Type or print applicant's/owner's name on line.
3. Complete notary statement.

Submit completed application to:
 Kansas Department of Agriculture
 Division of Water Resources
 Field Office for your area.

Call for address:

Topeka -- (785) 296-5733
 Stafford -- (620) 234-5311
 Stockton -- (785) 425-6787
 Garden City -- (620) 276-2901
<http://agriculture.ks.gov/dwr>

DWR FIELD OFFICE APPLICATION FOR APPROVAL TO CHANGE THE PLACE OF USE AND/OR THE POINT OF DIVERSION



WATER METER REQUIRED

STATE OF KANSAS

Filing Fee Must Accompany the Application, K.S.A. 82a-708b(b), as amended.
 Fee Schedule is on the third page of this application form.

Paragraph Nos. 1, 2, 3 & 5 must be completed. Complete all other applicable portions. If change in point of diversion is greater than 100 feet, or if place of use will be changed, include a topographic map or detailed plat showing the authorized and proposed point(s) of diversion and/or place of use.

File No. 31904

1. Application is hereby made for approval of the Chief Engineer to change the (check one or both):

Place of Use Point of Diversion

under the water right which is the subject of this application in accordance with the conditions described below.

The source of supply is: Groundwater Surface water

2. Name and address of Applicant: Derek M Kriegel

PO Box 698, Coldwater KS 67029-0698

Phone Number: (864)270-9031

Email address: _____

WATER RESOURCES
RECEIVED

Name and address of Water Use Correspondent: David M Kriegel

Derek M Kriegel, PO Box 698, Coldwater KS 67029-0698

Phone Number: () _____

Email address: _____

MAY 03 2017
1:05

3. The presently authorized place of use is:

Owner of Land ---- NAME: David M Kriegel & Derek M Kriegel

ADDRESS: PO Box 698, Coldwater KS 67029-0698

(If there is more than one landowner, attach supplemental sheets as necessary.)

KS DEPT OF AGRICULTURE

Sec.	Twp.	Range	NE¼				NW¼				SW¼				SE¼				TOTAL ACRES				
			NE¼	NW¼	SW¼	SE¼	NE¼	NW¼	SW¼	SE¼	NE¼	NW¼	SW¼	SE¼	NE¼	NW¼	SW¼	SE¼					
34	31	18W									30				30					40	40		140

4. If this application is for a change in place of use, it is proposed that the place of use be changed to:

Owner of Land ---- NAME: David M Kriegel & Derek M Kriegel

ADDRESS: PO Box 698, Coldwater KS 67029-0698

(If there is more than one landowner, attach supplemental sheets as necessary.)

Sec.	Twp.	Range	NE¼				NW¼				SW¼				SE¼				TOTAL ACRES				
			NE¼	NW¼	SW¼	SE¼	NE¼	NW¼	SW¼	SE¼	NE¼	NW¼	SW¼	SE¼	NE¼	NW¼	SW¼	SE¼					
34	31	18W									32.5				32.5					32.5	32.5		130

For Office Use Only: Code CPU Fee \$ 200 TR # _____ Receipt Date 5/3/17 Check # 1129
RECEIVED

5. **Presently authorized point of diversion:**
 One in the _____ Quarter of the _____ Quarter of the NC WS SE Quarter
 of Section 34, Township 31 South, Range 18 W,
 in Comanche County, Kansas, 1320 feet North 2500 feet West of Southeast corner of section.
 Authorized Rate 815 gpm Authorized Quantity 167 AF Depth of well 289 (feet)
(DWR use only: Computer ID No. 2 GPS 1302 feet North 2442 feet West)
 This point will not be changed This point will be changed as follows:
Proposed point of diversion: (Complete only if change is requested)
 One in the _____ Quarter of the _____ Quarter of the _____ Quarter
 of Section _____, Township _____ South, Range _____ (E/W),
 in _____ County, Kansas, _____ feet North _____ feet West of Southeast corner of section.
 Proposed Rate _____ Proposed Quantity _____ Proposed well depth (feet) _____
 This point is: Additional Well Geo Center List other water rights that will use this point none

6. **Presently authorized point of diversion:**
 One in the _____ Quarter of the _____ Quarter of the _____ Quarter
 of Section _____, Township _____ South, Range _____ (E/W),
 in _____ County, Kansas, _____ feet North _____ feet West of Southeast corner of section.
 Authorized Rate _____ Authorized Quantity _____ Depth of well _____ (feet)
(DWR use only: Computer ID No. _____ GPS _____ feet North _____ feet West)
 This point will not be changed This point will be changed as follows:
Proposed point of diversion: (Complete only if change is requested)
 One in the _____ Quarter of the _____ Quarter of the _____ Quarter
 of Section _____, Township _____ South, Range _____ (E/W),
 in _____ County, Kansas, _____ feet North _____ feet West of Southeast corner of section.
 Proposed Rate _____ Proposed Quantity _____ Proposed well depth (feet) _____
 This point is: Additional Well Geo Center List other water rights that will use this point 1:00

7. Why do you need a new point of diversion? N/A

8. If a well, is the test hole log attached? Yes No

9. When do you propose to complete the new point of diversion?
N/A

10. If the point of diversion is a well:
 (a) What are you going to do with the old well?
N/A
 (b) When will this be done? N/A

11. Groundwater Management District recommendation attached? Yes No

12. Assisted by EKF/SFFO

13a. If the proposed point of diversion will be relocated within 100 feet of the existing point of diversion, indicate its location on the diagram below in relation to the existing point of diversion. (PLEASE NOTE: The "X" in center of diagram below represents presently authorized point of diversion.)

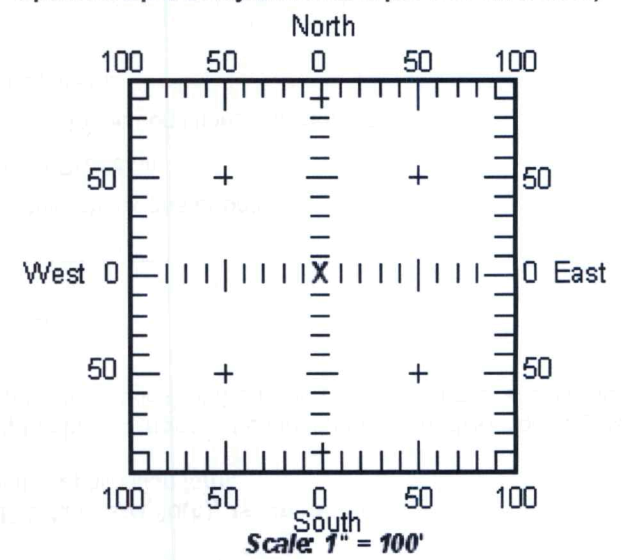

13b. If the proposed point of diversion will be relocated more than 100 feet but within 2640 feet from the existing point of diversion, attach a topographic map or aerial photograph. For groundwater sources, show all wells (including domestic) within one-half mile of the proposed point of diversion and the names and mailing addresses of the owners. For surface water sources, show the names and addresses of the landowner(s) one-half mile downstream and one-half mile upstream from your property lines.

RECEIVED

MAY 08 2017 Page 2

Stafford Field Office
 Division of Water Resources

14. If the proposed groundwater point of diversion is 300 or fewer feet from existing point of diversion, complete the following:
- (a) Does the undersigned represent all owners of the currently authorized place(s) of use identified in this application?
 Yes No (If no, all owners must sign this application.)
 - (b) Will the ownership interest of any owner of the currently authorized place(s) of use identified in this application be adversely affected if this application is approved as requested?
 Yes No (If yes, all owners must sign this application.)
 - (c) If this application is not approved expeditiously, will there be substantial damage to property, public health or safety?
 Yes No (If no, all owners must sign this application.)

If the application proposes a surface water change in point of diversion, a groundwater change in point of diversion greater than 300 feet, or a change in place of use, the application must be signed by all owners of the currently authorized place of use, or their duly authorized agent (attach notarized statement authorizing representation).

I hereby verify, being first duly sworn upon my oath or affirmation and under penalty of perjury, that I am of lawful age and the owner, the spouse of the owner, or a duly authorized agent of the owner(s) to make this application on their behalf, in regard to the water right(s) to which this application pertains. I further verify that the statements contained in this application are true, correct and complete.

Dated at Greensburg, Kansas, this 11th day of April, 20 17.

<u>[Signature]</u> (Owner)	_____	(Spouse)
<u>David M Krieger</u> (Please Print)	_____	(Please Print)
<u>[Signature]</u> (Owner)	_____	(Spouse)
<u>Derek Krieger</u> (Please Print)	_____	(Please Print)
_____	_____	(Spouse)
_____	_____	(Please Print)

State of Kansas }
 County of Kiowa } SS

I hereby certify that the foregoing application was signed in my presence and sworn to before me this 11th day of April, 20 17.



[Signature]
Notary Public

My Commission Expires 4-28-19

ONLY COMPLETE APPLICATIONS WILL BE PROCESSED. To be complete, all of the applicable portions of the application form must be completed with accurate information; maps, if necessary, must be included; signatures of all the appropriate owners' must be affixed to the application and notarized; and the appropriate fee must be paid.

FEE SCHEDULE

Each application to change the place of use or the point of diversion under this section shall be accompanied by the application fee set forth in the schedule below: Make checks payable to: **Kansas Department of Agriculture**

- (1) Application to change a point of diversion 300 feet or less \$100
- (2) Application to change a point of diversion more than 300 feet \$200
- (3) Application to change the place of use \$200

RECEIVED

WATER RESOURCES RECEIVED

MAY 08 2017

MAY 03 2017

SUMMARY ORDER APPROVING APPLICATION FOR CHANGE AND IMPOSING CONDITIONS

This Summary Order is issued under authority of K.S.A. 82a-708b, as amended, and K.A.R. 5-14-3 and other applicable provisions of the *Kansas Water Appropriation Law, K.S.A. 82a-701 et. seq.*, and rules and regulations promulgated thereunder, K.A.R. 5-1-1 et. seq. With the exception of those conditions expressly contained herein, this Summary Order does not change the terms, conditions and limitations of File No. 31904.

1. A change application was received on 5/3/17 requesting that the place of use and / or point of diversion authorized under the above-referenced file number be changed as described in the application.
2. On and after the effective date of this summary order, the authorized place(s) of use shall be located substantially as shown on the topographic map accompanying the application to change the place of use. Applicable Not Applicable
3. The change in point of diversion shall not impair existing rights and shall be limited to the same source or sources of water as previously authorized. The point of diversion authorized by this summary order shall be located within a _____ foot radius of the authorized point(s) of diversion. Applicable Not Applicable
4. The point(s) of diversion authorized herein shall not actually be located more than _____ feet from the previously authorized point(s) of diversion. Applicable Not Applicable
5. As required by K.A.R. 5-3-5d, if the works for diversion is a well with a diversion rate of 100 gallons per minute or more, a tube or other device suitable for making water level measurements shall be installed, operated and maintained in accordance with K.A.R. 5-6-13. Applicable Not Applicable
6. **The owner of the authorized place(s) of use shall properly install an acceptable water flow meter on or before December 31, 2017**, or before the first use of water, whichever occurs first. The water flow meter shall be installed, operated and maintained in accordance with K.A.R. 5-1-4 through 5-1-12. As required by K.S.A. 82a-732, as amended, and K.A.R. 5-3-5e, the owner shall maintain records and report the reading of the water flow meter and the total quantity of water diverted annually to the Chief Engineer by March 1 following the end of each calendar year. Applicable Not Applicable
7. **Installation of the works for diversion of water shall be completed on or before December 31, 20**_____, or within any authorized extension of time. By March 1, 20_____ the applicant shall notify the Chief Engineer that construction of the works for diversion has been completed, on the form provided by the Chief Engineer, as required by K.A.R. 5-8-4e. Applicable Not Applicable
8. **The completed well log shall be submitted with the required notice.** Applicable Not Applicable
9. All diversion works into which any type of chemical or other foreign substance will be injected into the water shall be equipped with an in-line, automatic, quick-closing check valve capable of preventing pollution of the source of the water supply. The check valve(s) shall be installed, operated and maintained in accordance with K.A.R. 5-3-5c. Applicable Not Applicable
10. Additional Conditions are attached. Yes No
11. In accordance with K.S.A. 82a-708a, as amended, and K.A.R. 5-5-14, all of the owners of the authorized place(s) of use of water appropriated under the above-referenced file number are responsible for compliance with its terms, conditions and limitations, as amended and/or supplemented by this Summary Order, and with applicable provisions of the *Kansas Water Appropriation Law* and the *Rules and Regulations* promulgated thereunder. Failure to comply with these provisions may result in civil penalties pursuant to K.S.A. 82a-737, as amended, and/or the suspension or revocation and dismissal of the water or appropriation right or any other enforcement actions authorized by law.

Administrative Appeal and Effective Date of Order

You have the right to a hearing in accordance with K.A.R. 5-14-3 before this Summary Order becomes final action of the Kansas Department of Agriculture. Any request for a hearing must be filed with the **Chief Engineer, Division of Water Resources, Kansas Department of Agriculture, 1320 Research Park Drive, Topeka, Kansas 66502**, within 15 days after the date shown on the Certificate of Service attached hereto. If a hearing is not requested in accordance with K.A.R. 5-14-3, this Summary Order will become effective on the 15th day after the date shown on the Certificate of Service.

For Use by Register of Deeds

FOR OFFICE USE ONLY
APPLICATION APPROVED AND SUMMARY ORDER ISSUED

By: Cameron R. Conard
Duly Authorized Designee of the Chief Engineer

(Print Name): Cameron R. Conard
Division of Water Resources - Kansas Department of Agriculture

Date of Issuance: 5/12/17

State of Kansas)
County of Stafford) SS

Acknowledged before me on 5/12/17

by Cameron Conard

Signature: Jessica R. Engelbrecht
Notary Public



Division of Water Resources
Stafford Field Office

My commission expires:

MAY 08 2017

RECEIVED

**ADDITIONAL CONDITION TO
SUMMARY ORDER APPROVING APPLICATION FOR CHANGE
AND IMPOSING CONDITIONS**

The effective date of the change shall be the date this order is executed by the Chief Engineer, after which the authorized location of the point(s) of diversion currently described as:

one (1) well located near the center of the west side of the Southeast Quarter of Section 34, more particularly described as being near a point 1,320 feet North and 2,500 feet West of the Southeast Corner of said section, Township 31 South, Range 18 West, Comanche County, Kansas

has been found to be more accurately located and will be hereafter described as:

one (1) well located in the Northwest Quarter of the Southwest Quarter of the Southeast Quarter of Section 34, more particularly described as being near a point 1,302 feet North and 2,442 feet West of the Southeast Corner of said section, Township 31 South, Range 18 West, Comanche County, Kansas

WATER RESOURCES
RECEIVED

MAY 03 2017

KS DEPT OF AGRICULTURE

RECEIVED

MAY 08 2017

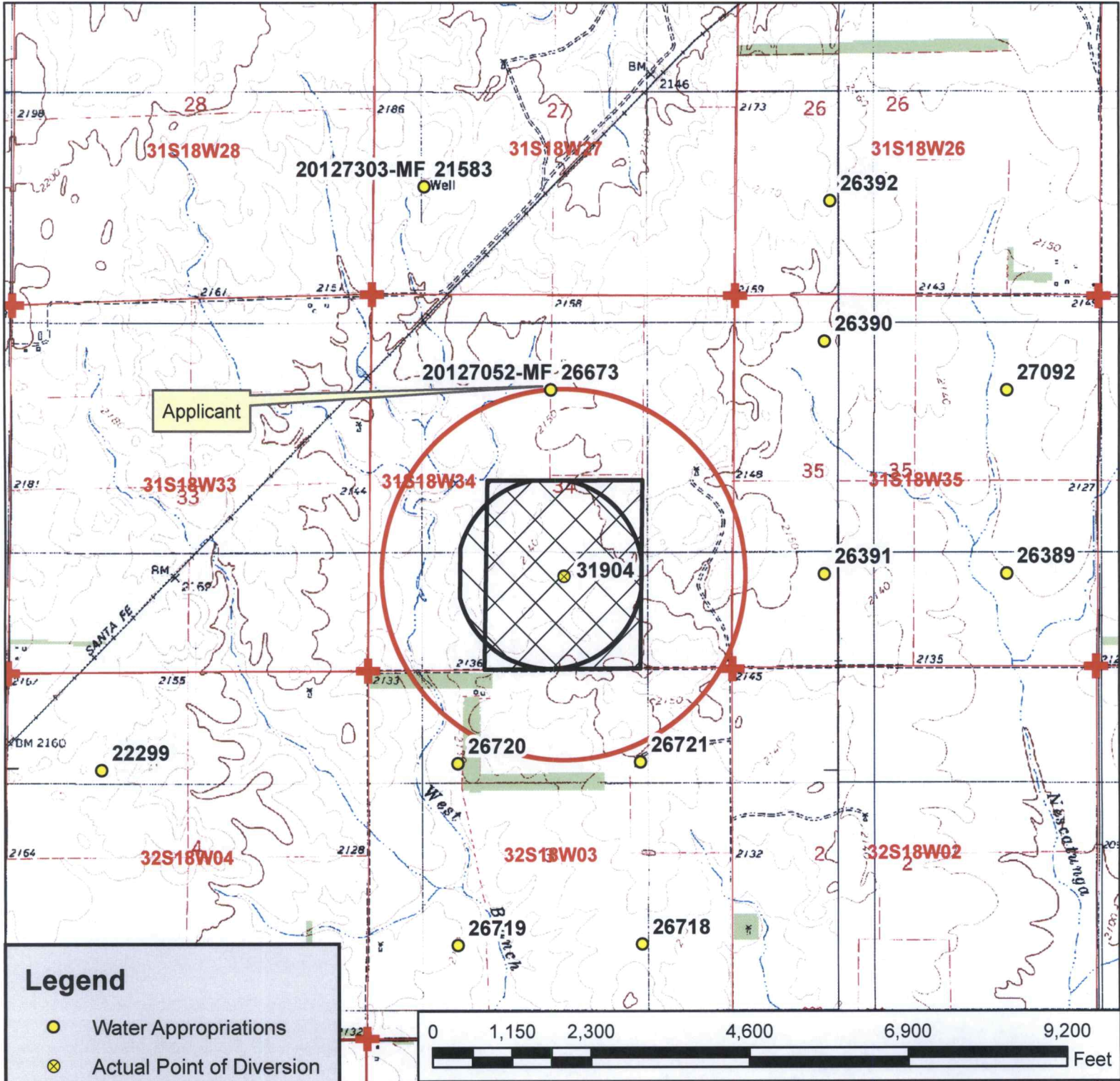

Legend

- Water Appropriations
- ⊗ Actual Point of Diversion
- ★ Domestic Well
- ⊕ Section Corner
- Half Mile Circle
- ▭ Section Line
- Place of Use**
- ▨ Proposed
- ▩ Authorized

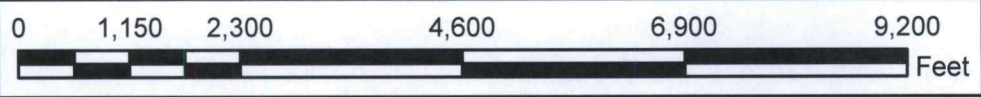

Water Right, File No. 31904

Change in Place of Use Application Map
 34-31S-18W // Comanche County

To the best of my knowledge, all water right wells within 1/2 mile of the proposed point of diversion have been shown.

RECEIVED
 MAY 08 2017
 Stafford Field Office
 Division of Water Resources

WATER RESOURCES RECEIVED
 MAY 03 2017
 KS DEPT OF AGRICULTURE



SCANNED



Stafford Field Office
300 S. Main Street
Stafford, Kansas 67578-1521
Jackie McClaskey, Secretary
David W. Barfield, Chief Engineer
Jeff Lanterman, Water Commissioner

Phone: (620) 234-5311
Fax: (620) 234-6900
www.agriculture.ks.gov
Sam Brownback, Governor

May 12, 2017

DAVID M KRIEGEL
DEREK M KRIEGEL
PO BOX 698
COLDWATER KS 67029

Re: Water Right, File No(s). 31904

Dear Water Right Owner:

Enclosed is the order executed by the Chief Engineer, Division of Water Resources, Kansas Department of Agriculture, approving the application for change under the above referenced file number(s).

Your attention is directed to the enclosures and to the terms, conditions and limitations specified in this approval for change. An acceptable water flow meter must be installed on your well before any water is applied as authorized under this change approval. A copy of the approved list of Certified Water Flowmeters as well as the regulations regarding the installation of flowmeters, measurement tubes and check valves can be found at <http://agriculture.ks.gov/divisions-programs/dwr/water-appropriation/water-flowmeters>. If you do not have access to the internet, please contact this office and we will send you a paper copy of the referenced information.

Since this order modifies the original document referred to above, it should be recorded with the Register of Deeds as other instruments affecting real estate.

Should you have any questions, please feel free to contact this office. If you wish to refer to a specific file, please reference it when you contact us.

Sincerely,

A handwritten signature in black ink, appearing to read "Jeff Lanterman".

Jeff Lanterman
Water Commissioner

Enclosures
pc: Water Rights Section

CERTIFICATE OF SERVICE

On this **12 May 2017**, I hereby certify that the attached Change in Place of Use, File No. 31904 dated May 12, 2017 was mailed to the following:

DAVID M KRIEGEL
DEREK M KRIEGEL
PO BOX 698
COLDWATER KS 67029

pc: Water Rights Section



Staff



KANSAS DEPARTMENT OF AGRICULTURE

Division of Water Resources

Stafford Field Office

MEMORANDUM

TO: File

DATE: 5/9/2017

FROM: Tyler Saryerwinnie

RE: File No. 31,904

This is a memorandum regarding surrounding well owner notification on irrigation field office PU changes and pertains to decisions made during the Water Commissioner meeting which took place on 11/16/2016.

This is applicable to field office changes to increase the place of use by 10 acres or 10% (whichever is less) or a change in place of use to create a complete overlap in which no new acres are being irrigated.

During that meeting it was determined that no surrounding well owner notification will be sent under this type of Place of Use change. All well rates and quantities will remain unchanged and the referenced change will not cause impairment or impact surrounding well owners.

The change in place of use filed on 5/3/2017 for the above referenced file meets this criteria and surrounding well owners will not be notified.