

Submit completed application to:  
 Kansas Department of Agriculture  
 Division of Water Resources  
 Field Office for your area.

Call for address:

Topeka -- (785) 296-5733  
 Stafford -- (620) 234-5311  
 Stockton -- (785) 425-6787  
 Garden City -- (620) 276-2901  
<http://agriculture.ks.gov/dwr>

**DWR FIELD OFFICE  
 APPLICATION FOR APPROVAL  
 TO CHANGE THE PLACE OF  
 USE AND/OR THE  
 POINT OF DIVERSION**



**WATER METER REQUIRED**

**STATE OF KANSAS**

**Filing Fee Must Accompany the Application, K.S.A. 82a-708b(b), as amended.**  
 Fee Schedule is on the third page of this application form.

**Paragraph Nos. 1, 2, 3 & 5 must be completed. Complete all other applicable portions.** If change in point of diversion is greater than 100 feet, or if place of use will be changed, include a topographic map or detailed plat showing the authorized and proposed point(s) of diversion and/or place of use.

RECEIVED  
 10:05am  
 SEP 27 2017

File No. 47906

1. Application is hereby made for approval of the Chief Engineer to change the (check one or both):

Place of Use       Point of Diversion

Stafford Field Office  
 Division of Water Resources

under the water right which is the subject of this application in accordance with the conditions described below.

The source of supply is:       Groundwater       Surface water

2. Name and address of Applicant: Lloyd H & Marcie A Bontrager  
4715 E Arlington Rd, Haven KS 67543

Phone Number: (620)474-9530      Email address: \_\_\_\_\_

Name and address of Water Use Correspondent: Lloyd H & Marcie A Bontrager  
4715 E Arlington Rd, Haven KS 67543

Phone Number: (620)474-9530      Email address: \_\_\_\_\_

3. The presently authorized place of use is:  
 Owner of Land ---- NAME: Lloyd H & Marcie A Bontrager

ADDRESS: 4715 E Arlington Rd, Haven KS 67543

(If there is more than one landowner, attach supplemental sheets as necessary.)

Sec.	Twp.	Range	NE¼				NW¼				SW¼				SE¼				TOTAL ACRES
			NE¼	NW¼	SW¼	SE¼	NE¼	NW¼	SW¼	SE¼	NE¼	NW¼	SW¼	SE¼	NE¼	NW¼	SW¼	SE¼	
5	24	5W			32.5	32.5													65

4. If this application is for a change in place of use, it is proposed that the place of use be changed to:  
 Owner of Land ---- NAME: Lloyd H & Marcie A Bontrager

ADDRESS: 4715 E Arlington Rd, Haven KS 67543

(If there is more than one landowner, attach supplemental sheets as necessary.)

Sec.	Twp.	Range	NE¼				NW¼				SW¼				SE¼				TOTAL ACRES
			NE¼	NW¼	SW¼	SE¼	NE¼	NW¼	SW¼	SE¼	NE¼	NW¼	SW¼	SE¼	NE¼	NW¼	SW¼	SE¼	
5	24	5W	Lot 1	Lot 2															71.5
			1	1	34.5	35													

**For Office Use Only: Code \_\_\_\_\_ Fee \$ \_\_\_\_\_ TR # \_\_\_\_\_ Receipt Date \_\_\_\_\_ Check # \_\_\_\_\_**



5. **Presently authorized point of diversion: Geographic Center of a Battery of Three Wells located**  
 One in the SW Quarter of the SE Quarter of the NE Quarter  
 of Section 5, Township 24 South, Range 5 W,  
 in Reno County, Kansas, 2690 feet North 1235 <sup>945\*</sup> feet West of Southeast corner of section.  
 Authorized Rate 800 gpm Authorized Quantity 91 AF Depth of well N/A (feet)  
**(DWR use only: Computer ID No. 08-07\* GPS 2684 feet North 946 feet West)**  
 This point will not be changed  This point will be changed as follows:  No change, point better described with GPS as follows:  
**Proposed point of diversion: (Complete only if change is requested or if existing point is better described by GPS)**  
 One in the \_\_\_\_\_ Quarter of the \_\_\_\_\_ Quarter of the \_\_\_\_\_ Quarter  
 of Section \_\_\_\_\_, Township \_\_\_\_\_ South, Range \_\_\_\_\_ (E/W),  
 in \_\_\_\_\_ County, Kansas, \_\_\_\_\_ feet North \_\_\_\_\_ feet West of Southeast corner of section.  
 Proposed Rate \_\_\_\_\_ Proposed Quantity \_\_\_\_\_ Proposed well depth (feet) \_\_\_\_\_  
 This point is:  Additional Well  Geo Center List other water rights that will use this point none

6. **Presently authorized point of diversion:**  
 One in the \_\_\_\_\_ Quarter of the \_\_\_\_\_ Quarter of the \_\_\_\_\_ Quarter  
 of Section \_\_\_\_\_, Township \_\_\_\_\_ South, Range \_\_\_\_\_ (E/W),  
 in \_\_\_\_\_ County, Kansas, \_\_\_\_\_ feet North \_\_\_\_\_ feet West of Southeast corner of section.  
 Authorized Rate \_\_\_\_\_ Authorized Quantity \_\_\_\_\_ Depth of well \_\_\_\_\_ (feet)  
**(DWR use only: Computer ID No. \_\_\_\_\_ GPS \_\_\_\_\_ feet North \_\_\_\_\_ feet West)**  
 This point will not be changed  This point will be changed as follows:  No change, point better described with GPS as follows:  
**Proposed point of diversion: (Complete only if change is requested or if existing point is better described by GPS)**  
 One in the \_\_\_\_\_ Quarter of the \_\_\_\_\_ Quarter of the \_\_\_\_\_ Quarter  
 of Section \_\_\_\_\_, Township \_\_\_\_\_ South, Range \_\_\_\_\_ (E/W),  
 in \_\_\_\_\_ County, Kansas, \_\_\_\_\_ feet North \_\_\_\_\_ feet West of Southeast corner of section.  
 Proposed Rate \_\_\_\_\_ Proposed Quantity \_\_\_\_\_ Proposed well depth (feet) \_\_\_\_\_  
 This point is:  Additional Well  Geo Center List other water rights that will use this point \_\_\_\_\_

7. The changes herein are desired for the following reasons?  
 (please be specific) To cover unauthorized acres being  
irrigated

8. If a well, is the test hole log attached?  Yes  No

9. The change(s) (was)(will be) completed by?  
Upon approval of the change

10. If the point of diversion is a well:  
 (a) What are you going to do with the old well?  
N/A

(b) When will this be done? N/A

11. Groundwater Management District recommendation attached?  Yes  No

12. Assisted by EKF // SFFO  
\*JS-SFFO

13a. If the proposed point of diversion will be relocated within 100 feet of the existing point of diversion, indicate its location on the diagram below in relation to the existing point of diversion. (PLEASE NOTE: The "X" in center of diagram below represents presently authorized point of diversion.)

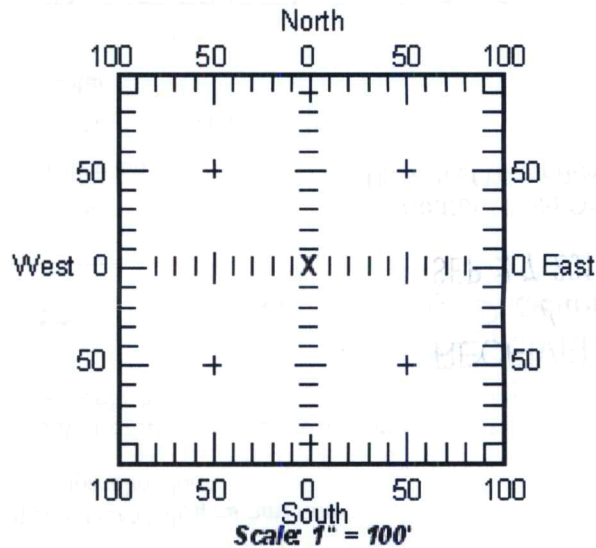

13b. If the proposed point of diversion will be relocated more than 100 feet but within 1320 feet from the existing point of diversion, attach a topographic map or aerial photograph. For groundwater sources, show all wells (including domestic) within one-half mile of the proposed point of diversion and the names and mailing addresses of the owners. For surface water sources, show the names and addresses of the landowner(s) one-half mile downstream and one-half mile upstream from your property lines.

RECEIVED

SEP 27 2017



14. If the proposed groundwater point of diversion is 300 or fewer feet from existing point of diversion, complete the following:
- (a) Does the undersigned represent all owners of the currently authorized place(s) of use identified in this application?  
 Yes     No    (If no, all owners must sign this application.)
  - (b) Will the ownership interest of any owner of the currently authorized place(s) of use identified in this application be adversely affected if this application is approved as requested?  
 Yes     No    (If yes, all owners must sign this application.)
  - (c) If this application is not approved expeditiously, will there be substantial damage to property, public health or safety?  
 Yes     No    (If no, all owners must sign this application.)

If the application proposes a surface water change in point of diversion, a groundwater change in point of diversion greater than 300 feet, or a change in place of use, the application must be signed by all owners of the currently authorized place of use, or their duly authorized agent (attach notarized statement authorizing representation).

I hereby verify, being first duly sworn upon my oath or affirmation and under penalty of perjury, that I am of lawful age and the owner, the spouse of the owner, or a duly authorized agent of the owner(s) to make this application on their behalf, in regards to the water right(s) to which this application pertains. I further verify that the statements contained in this application are true, correct and complete.

Dated at Hutchinson, Kansas, this 20 day of Sept, 2017.

Lloyd H. Bontrager  
 (Owner)

Marcie A. Bontrager  
 (Spouse)

Lloyd H. Bontrager  
 (Please Print)

Marcie A. Bontrager  
 (Please Print)

\_\_\_\_\_  
 (Owner)

\_\_\_\_\_  
 (Spouse)

\_\_\_\_\_  
 (Please Print)

\_\_\_\_\_  
 (Please Print)

\_\_\_\_\_  
 (Owner)

\_\_\_\_\_  
 (Spouse)

\_\_\_\_\_  
 (Please Print)

\_\_\_\_\_  
 (Please Print)

State of Kansas }  
 County of RN } SS

I hereby certify that the foregoing application was signed in my presence and sworn to before me this 20 day of Sept, 2017.

My Appt. Expires 05-01-21  
 Notary Public - State of Kansas  
**ANDREA STEWART**

My Commission Expires 03-01-21

[Signature]  
 Notary Public

**ONLY COMPLETE APPLICATIONS WILL BE PROCESSED.** To be complete, all of the applicable portions of the application form must be completed with accurate information; maps, if necessary, must be included; signatures of all the appropriate owners' must be affixed to the application and notarized; and the appropriate fee must be paid.

**FEE SCHEDULE**

Each application to change the place of use or the point of diversion under this section shall be accompanied by the application fee set forth in the schedule below: Make checks payable to: **Kansas Department of Agriculture**

- (1) Application to change a point of diversion 300 feet or less ..... \$100
- (2) Application to change a point of diversion more than 300 feet ..... \$200
- (3) Application to change the place of use ..... \$200

RECEIVED

SEP 27 2017







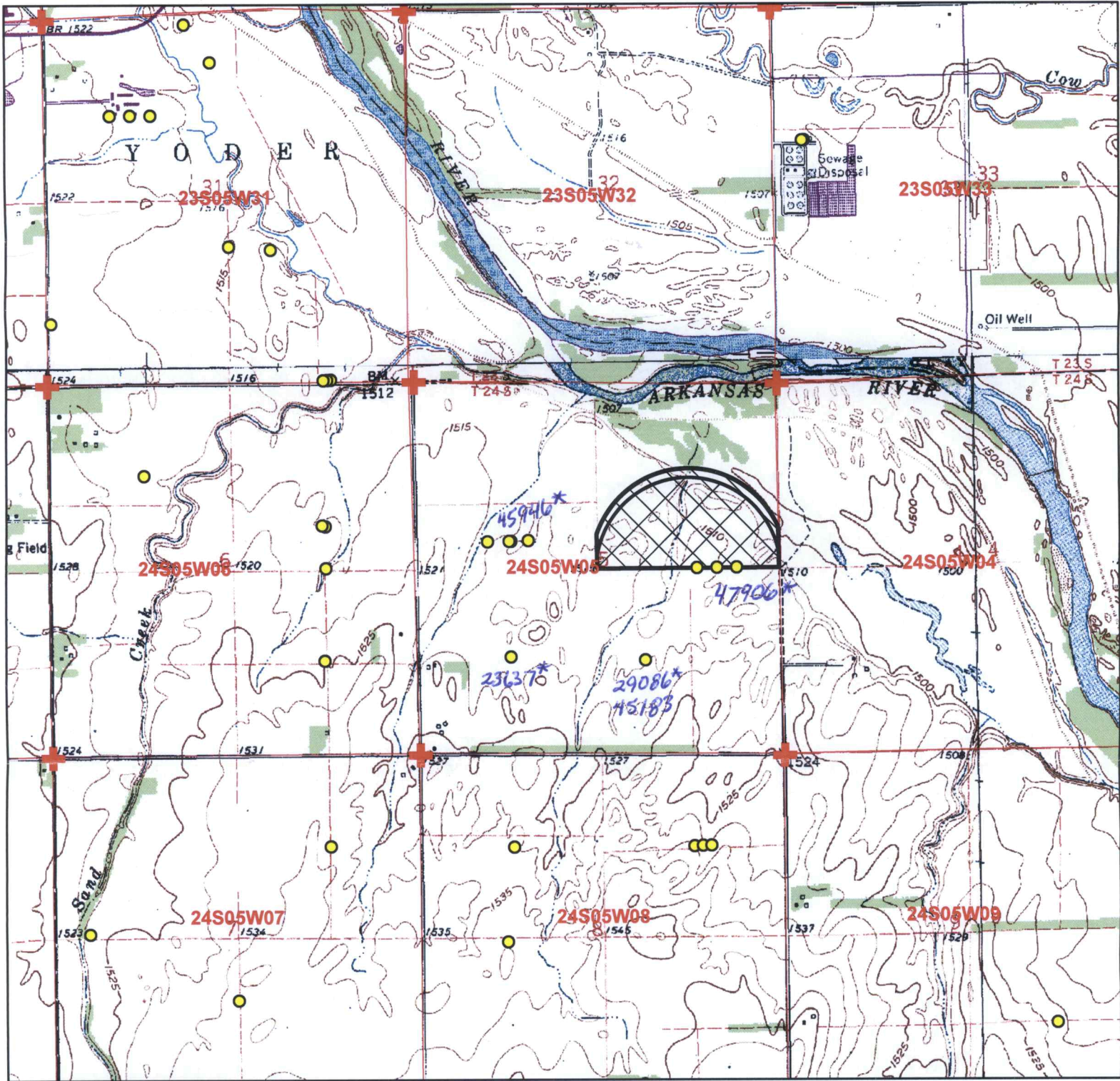

**Legend**

- Water Appropriations
- Section Line
- Place of Use**
- Authorized
- Proposed

RECEIVED  
SEP 27 2017

Stafford Field Office

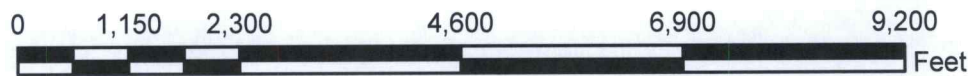

**Water Appropriation, File No. 47906**

Change in Place of Use Map

5-24S-5W

Reno County

