

Kansas Department of Agriculture
Division of Water Resources
PERMIT OF NEW APPLICATION WORKSHEET

1. File Number: 49594	2. Status Change Date: 5/4/2017	3. Field Office: 02	4. GMD: 02
---------------------------------	---	-------------------------------	----------------------

5. Status: Approved Denied by DWR/GMD Dismiss by Request/Failure to Return

6. Enclosures: Check Valve N of C Form Water Tube Driller Copy Meter

<p>7a. Applicant(s) New to system <input type="checkbox"/></p> <p style="text-align: right;">Person ID 58260 Add Seq# 1</p> <p>ROBERT A & SUSAN D BACON 3616 S MAYFIELD RD HUTCHINSON KS 67501</p>	<p>7c. Landowner(s) New to system <input type="checkbox"/></p> <p style="text-align: right;">Person ID _____ Add Seq# _____</p>
<p>7b. Landowner(s) New to system <input type="checkbox"/></p> <p style="text-align: right;">Person ID 64925 Add Seq# 1</p> <p>WILLIAM C ELLIS FAMILY TRUST 5505 E 64TH STREET TULSA OK 74136</p>	<p>7d. Landowner New to system <input type="checkbox"/></p> <p style="text-align: right;">Person ID _____ Add Seq# _____</p>

<p>8. WUR Correspondent New to system <input type="checkbox"/> Overlap File (s) WUC <input type="checkbox"/> Agree <input type="checkbox"/> Yes <input type="checkbox"/> No</p> <p style="text-align: right;">Person ID 58260 Add Seq# 1 Notarized WUC Form</p> <p>ROBERT A & SUSAN D BACON 3616 S MAYFIELD RD HUTCHINSON KS 67501</p>	<p>9. Use of Water: Changing? <input type="checkbox"/> Yes <input checked="" type="checkbox"/> No</p> <p style="text-align: center;"><input checked="" type="checkbox"/> Groundwater <input type="checkbox"/> Surface Water</p> <p><input checked="" type="checkbox"/> IRR <input type="checkbox"/> REC <input type="checkbox"/> DEW <input type="checkbox"/> MUN</p> <p><input type="checkbox"/> STK <input type="checkbox"/> SED <input type="checkbox"/> DOM <input type="checkbox"/> CON</p> <p><input type="checkbox"/> HYD DRG <input type="checkbox"/> WTR PWR <input type="checkbox"/> ART RECHRG</p> <p><input type="checkbox"/> IND SIC: _____ <input type="checkbox"/> OTHER: _____</p>
---	---

10. Completion Date: **12/31/2018** 11. Perfection Date: **12/31/2022** 12. Exp Date: _____

13. Conservation Plan Required? Yes No Date Required: _____ Date Approved: _____ Date to Comply: _____

14. Water Level Measuring Device? Yes No Date to Comply: _____ Date WLMD Installed: _____

Date Prepared: **04/08/2017** By: **RAK**
Date Entered: **5/9/2017** By: **LM**

File No. **49,594** 15. Formation Code: **190** Drainage Basin: **LITTLE ARKANSAS RIVER** County: **RN** Special Use: Stream:

16. Points of Diversion										17. Rate and Quantity					
MOD	DEL	ENT	PDIV	Qualifier	S	T	R	ID	'N	'W	Authorized		Additional		Overlap PD Files
											Rate gpm	Quantity af	Rate gpm	Quantity af	
MOD 81260			NC NW¼		24	23	5W	1	4000	3960	800 g.p.m.	94.5 AF	<u>0</u>	94.5 AF	48505
PD COMMENT GEO CTR															
MOD 81261			SW¼ NE¼ NW¼		24	23	5W	2	4000	3660					48505
PD COMMENT BATT 1 OF 4 WELLS; EAST WELL															
MOD 81262			SW¼ NE¼ NW¼		24	23	5W	3	4000	3810					48505
PD COMMENT BATT 1 OF 4 WELLS; MIDDLE EAST WELL															
MOD 81263			SE¼ NW¼ NW¼		24	23	5W	4	4000	4110					48505
PD COMMENT BATT 1 OF 4 WELLS; MIDDLE WEST WELL															
MOD 81264			SE¼ NW¼ NW¼		24	23	5W	5	4000	4260					48505
PD COMMENT BATT 1 OF 4 WELLS; WEST WELL															

18. Storage: Rate _____ NF Quantity _____ ac/ft Additional Rate _____ NF Additional Quantity _____ ac/ft

19. Limitation: _____ af/yr at 800 gpm (_____ cfs) when combined with file number(s) 48,505
 Limitation: _____ af/yr at _____ gpm (_____ cfs) when combined with file number(s) _____

20. Meter Required? Yes No To be installed by 12/31/2018 Date Acceptable Meter Installed _____

21. Place of Use										NE¼				NW¼				SW¼				SE¼				Total	Owner	Chg?	Overlap Files
MOD	DEL	ENT	PUSE	S	T	R	ID	NE ¼	NW ¼	SW ¼	SE ¼	NE ¼	NW ¼	SW ¼	SE ¼	NE ¼	NW ¼	SW ¼	SE ¼	NE ¼	NW ¼	SW ¼	SE ¼						
√			67648	24	23	5W	3							33.75	33.75										67.50	7b	NO	NO	

Comments:

KANSAS DEPARTMENT OF AGRICULTURE
Division of Water Resources
M E M O R A N D U M

TO: Files

DATE: April 25, 2017

FROM: Richelle A. Krueger

RE: Application, File No. 49,594

Robert A. Bacon filed the referenced application to appropriate groundwater for irrigation use, requesting a quantity of 94.5 acre-feet and a diversion rate of 800 gallons per minute. The proposed point of diversion will be one (1) existing battery of four wells authorized by Appropriation of Water, File No. 48,505 with a geographic center located 4,000 feet North and 3,960 feet West of the Southeast corner of Section 24, Township 23 South, Range 5 West, Reno County within the drainage basin of the Little Arkansas River Basin. No overlap in the place of use is proposed. The proposed acreage is owned by William C. Ellis Family Trust. The proposed well is owned by Harold E. Swanson Trust and presently irrigates the North Half of the Northwest Quarter of Section 24 under File No. 48,505.

WRIS and the submitted application indicate there is one battery of four wells authorized by Appropriation of Water, File No. 48,881 and two domestic wells within one-half mile of the proposed geocenter. Although the geocenter of a recreational groundwater pit authorized by Appropriation of Water, File No. 46,863 is outside the one-half mile radius, a portion of the pit is located within that radius. In a letter dated January 30, 2017, Equus Beds Groundwater Management District No. 2 requested notification of the pit owners as well as the owners of File No. 48,881 since they were not previously notified. The nearby domestic well owners were notified of the referenced application by letters dated October 25, 2016 sent by Erin McGrogan, former Environmental Scientist with the Permits Unit, and the nearby non-domestic owners were notified by letters dated February 1, 2017. No written responses have been received as of today's date.

In letter dated January 30, 2017 with attachments, Equus Beds Groundwater Management District No. 2 recommended the referenced application be approved and indicated that the application complies with K.A.R. 5-22-1 through K.A.R. 5-22-17 subject to the maximum rate of diversion be limited to 800 gallons per minute when combined with File No. 48,505.

The total quantity available for irrigation use by File No. 49,594, 94.5 acre-feet, will irrigate the proposed 67.5 acres with 1.4 acre-feet per acre and is the maximum reasonable quantity allowed pursuant to K.A.R. 5-3-24 in Reno County.

A test hole log was submitted with the pending new application. The source of supply was previously determined to be Equus Beds (190).

In accordance with K.S.A. 82a-706c, the Chief Engineer retains full authority to require any water user to install meters, gages, or other measuring devices, which devices he or she or his or her agents may read at any time. Water flowmeter requirements are further described in K.A.R. 5-1-4 through K.A.R. 5-1-12. If any chemical or foreign substance is injected into the water pumped under this permit, a check valve will also need to be installed. A water level measurement tube is required. The applicant signed, notarized, and returned a minimum desirable streamflow form to our office.

In an April 6, 2017 e-mail, Jeff Lanterman, Water Commissioner, Stafford Field Office, recommended approval of the referenced application.

Based on the above discussion, safe yield criteria are met, approval of the application will not impair senior water rights nor prejudicially or unreasonably affect the public interest, it has been recommended that the referenced application be approved.

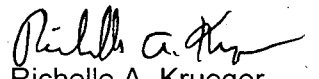
Richelle A. Krueger
Environmental Scientist

1320 Research Park Drive
Manhattan, Kansas 66502
(785) 564-6700



900 SW Jackson, Room 456
Topeka, Kansas 66612
(785) 296-3556

Jackie McClaskey, Secretary

Governor Sam Brownback

May 9, 2017

FILE COPY

ROBERT A AND SUSAN D BACON
3616 S MAYFIELD RD
HUTCHINSON KS 67501

RE: Appropriation of Water, File Nos. 49,587; 49,588; 49,589; 49,590; 49,592; 49,593 and 49,594
Dismissal of Application, File No. 49,591

Dear Mr. and Mrs. Bacon:

Enclosed is the Findings and Order by the Chief Engineer, Division of Water Resources, Kansas Department of Agriculture, dismissing Application, File No. 49,591, for failure to meet safe yield criteria per K.A.R. 5-22-7(a).

In addition, enclosed are permits (File Nos. 49,587; 49,588; 49,589; 49,590; 49,592; 49,593 and 49,594) to appropriate water authorizing you to proceed with construction of the proposed diversion works (except those dams and stream obstructions regulated by K.S.A. 82a-301 through 305a), to divert such unappropriated water as may be available from the source and at the locations specified in the permits, and to use it for the purpose and at the locations described in the permits.

Your attention is directed to the enclosures and to the terms, conditions, and limitations specified in these permits. Water meters are required and you must install them prior to water being put to beneficial use in order for you to maintain accurate records of water use. The meters should be used to provide the information required on the annual water use reports.

Failure to notify the Chief Engineer of the Division of Water Resources of the completion of the diversion works within the time allowed, or within any authorized extension of time thereof, will result in the dismissal of these permits. Enclosed are forms which may be used to notify the Chief Engineer that the proposed diversion works have been completed.

All requests for extensions of time to complete diversion works, or to perfect appropriations, must be submitted to the Chief Engineer before the expiration of time originally set forth in the permit to complete diversion works or to perfect an appropriation. If for any reason, you require an extension of time, you must request it before the expiration of time set forth in this permit. Failure to comply with this regulation will result in the dismissal of your permit or your water right. Any request for an extension of time shall be accompanied by the required statutory fee, which is currently \$100.00.

There is also enclosed an information sheet setting forth the procedure to obtain a Certificate of Appropriation which will establish the extent of your water rights.

(OVER→)

ROBERT A AND SUSAN D BACON

File Nos. 49,587; 49,588; 49,589; 49,590; 49,591; 49,592; 49,593 and 49,594

Page 2

Please be reminded that reports of water usage must be submitted to this office annually. Records indicating the amount of water used should be furnished to the Chief Engineer by March 1 following the end of the previous calendar year so that the continued use of water becomes a matter of record in this office. The owner, or his or her legally designated agent, is held responsible for submitting annual water use reports. Failure to file an accurate water use report is a violation of law which makes you subject to civil penalties.

If you have any questions, please contact this office. If you call, please reference the file number so we can help you more efficiently.

Sincerely,

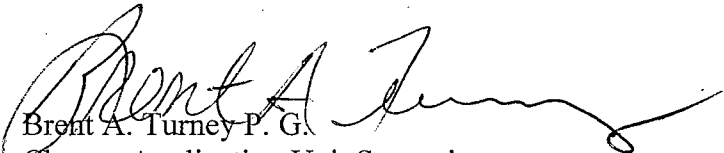
Brent A. Turney P. G.
Change Application Unit Supervisor

BAT

pc: Stafford Field Office
Groundwater Management District No. 2
Clifford Eugene Strandberg
William C. Ellis Family Trust
Robert C. Bacon Rev. Trust, c/o Juanita Bacon
John S. Bacon Rev. Trust
Hannah Eldridge Trust, c/o Elaine Eldridge

THE STATE OF KANSAS



KANSAS DEPARTMENT OF AGRICULTURE
Jackie McClaskey, Secretary of Agriculture

DIVISION OF WATER RESOURCES
David W. Barfield, Chief Engineer

**APPROVAL OF APPLICATION
and
PERMIT TO PROCEED**
(This is not a Certificate of Appropriation)

FILE COPY

This is to certify that I have examined Application File No. 49,594 of the applicant

**ROBERT A BACON
3616 S MAYFIELD RD
HUTCHINSON KS 67501**

for a permit to appropriate water for beneficial use, together with the maps, plans and other submitted data, and that the application is hereby approved and the applicant is hereby authorized, subject to vested rights and prior appropriations, to proceed with the construction of the proposed diversion works (except those dams and stream obstructions regulated by K.S.A. 82a-301 through 305a, as amended), and to proceed with all steps necessary for the application of the water to the approved and proposed beneficial use and otherwise perfect the proposed appropriation subject to the following terms, conditions and limitations:

1. That the priority date assigned to such application is **March 23, 2016**.
2. That the water sought to be appropriated shall be used for irrigation use on land described in the application, as follows:

Sec.	Twp.	Range	NE¼				NW¼				SW¼				SE¼				TOTAL
			NE¼	NW¼	SW¼	SE¼	NE¼	NW¼	SW¼	SE¼	NE¼	NW¼	SW¼	SE¼	NE¼	NW¼	SW¼	SE¼	
24	23S	5W							33.75	33.75								67.50	

3. That the authorized source from which the appropriation shall be made is groundwater, to be withdrawn by means of a battery of four(4) wells with a geographic center located near the center of the Northwest Quarter (NW¼) of Section 24, more particularly described as being near a point 4,000 feet North and 3,960 feet West of the Southeast corner of said section, in Township 23 South, Range 5 West, Reno County, Kansas, located substantially as shown on the map accompanying the application.

4. That the appropriation sought shall be limited to a maximum diversion rate not in excess of **800 gallons per minute (1.78 c.f.s.)** and to a quantity not to exceed **94.5 acre-feet** of water for any calendar year.

5. That installation of works for diversion of water shall be completed on or before **December 31, 2018** or within any authorized extension thereof. The applicant shall notify the Chief Engineer and pay the statutorily required field inspection fee of \$400.00 when construction of the works has been completed. Failure to timely submit the notice and the fee will result in revocation of the permit. Any request for an extension of time shall be submitted prior to the expiration of the deadline and shall be accompanied by the required statutory fee of \$100.00.

6. That the proposed appropriation shall be perfected by the actual application of water to the proposed beneficial use on or before **December 31, 2022** or any authorized extension thereof. Any request for an extension of time shall be submitted prior to the expiration of the deadline and shall be accompanied by the required statutory fee of \$100.00.

7. That the applicant shall not be deemed to have acquired a water appropriation for a quantity in excess of the amount approved herein nor in excess of the amount found by the Chief Engineer to have been actually used for the approved purpose during one calendar year subsequent to approval of the application and within the time specified for perfection or any authorized extension thereof.

8. That the use of water herein authorized shall not be made so as to impair any use under existing water rights nor prejudicially and unreasonably affect the public interest.

9. That the right of the appropriator shall relate to a specific quantity of water and such right must allow for a reasonable raising or lowering of the static water level and for the reasonable increase or decrease of the streamflow at the appropriator's point of diversion.

10. That this permit does not constitute authority under K.S.A. 82a-301 through 305a to construct any dam or other obstruction; nor does it grant any right-of-way, or authorize entry upon or injury to, public or private property.

11. That all diversion works constructed under the authority of this permit into which any type of chemical or other foreign substance will be injected into the water pumped from the diversion works shall be equipped with an in-line, automatic quick-closing, check valve capable of preventing pollution of the source of the water supply. The type of valve installed shall meet specifications adopted by the Chief Engineer and shall be maintained in an operating condition satisfactory to the Chief Engineer.

12. That all wells with a diversion rate of 100 gallons per minute or more drilled under the authority of this permit shall have a tube or other device installed in a manner acceptable to, and in accordance with specifications adopted by, the Chief Engineer. This tube or device shall be suitable for making water level measurements and shall be maintained in a condition satisfactory to the Chief Engineer.

13. That an acceptable water flow meter shall be installed and maintained on the diversion works authorized by this permit in accordance with the Kansas Administrative Regulations 5-1-4 through 5-1-12 adopted by the Chief Engineer. This water flow meter shall be used to provide an accurate quantity of water diverted as required for the annual water use report (including the meter reading at the beginning and end of the report year).

14. That the applicant shall maintain accurate and complete records from which the quantity of water diverted during each calendar year may be readily determined and the applicant shall file an annual water use report with the Chief Engineer by March 1 following the end of each calendar year. Failure to file the annual water use report by the due date shall cause the applicant to be subject to a civil penalty.

15. That no water user shall engage in nor allow the waste of any water diverted under the authority of this permit.

16. That failure without cause to comply with provisions of the permit and its terms, conditions and limitations will result in the forfeiture of the priority date, revocation of the permit and dismissal of the application.

CERTIFICATE OF SERVICE

On this *9th* day of *May*, *2017*, I hereby certify that the foregoing Approval of Application, File No. 49,594, dated *May 4th, 2017* was mailed postage prepaid, first class, US mail to the following:

ROBERT A BACON
3616 S MAYFIELD RD
HUTCHINSON KS 67501

With photocopies to:

WILLIAM C ELLIS FAMILY TRUST
5505 EAST 64TH STREET
TULSA OK 74136

Stafford Field Office
Groundwater Management District No. 2

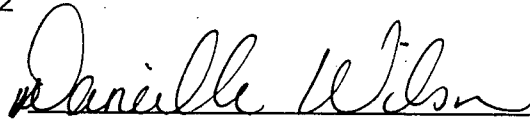

Division of Water Resources

THE STATE OF KANSAS



WATER RESOURCES RECEIVED

8

MAR 23 2016

4:21

KS DEPT OF AGRICULTURE

KANSAS DEPARTMENT OF AGRICULTURE
Jackie McClaskey, Secretary of Agriculture

DIVISION OF WATER RESOURCES
David W. Barfield, Chief Engineer

File Number 49,594

This item to be completed by the Division of Water Resources.

APPLICATION FOR PERMIT TO APPROPRIATE WATER FOR BENEFICIAL USE

Filing Fee Must Accompany the Application
(Please refer to Fee Schedule attached to this application form.)

To the Chief Engineer of the Division of Water Resources, Kansas Department of Agriculture,
1320 Research Park Drive, Manhattan, Kansas 66502:

1. Name of Applicant (Please Print): Robert A Bacon
Address: 3616 S Mayfield Road
City: Hutchinson State KS Zip Code 67501
Telephone Number: (620) 662-4424

2. The source of water is: surface water in _____
OR groundwater in Little Arkansas River (stream)
(drainage basin)

Certain streams in Kansas have minimum target flows established by law or may be subject to administration when water is released from storage for use by water assurance district members. If your application is subject to these regulations on the date we receive your application, you will be sent the appropriate form to complete and return to the Division of Water Resources.

3. The maximum quantity of water desired is 94.5 acre-feet OR _____ gallons per calendar year, to be diverted at a maximum rate of 800 gallons per minute OR _____ cubic feet per second.
limited to less than 800

Once your application has been assigned a priority, the requested maximum rate of diversion and maximum requested quantity of water under that priority number can **NOT** be increased. Please be certain your requested maximum rate of diversion and maximum quantity of water are appropriate and reasonable for your proposed project and are in agreement with the Division of Water Resources' requirements.

4. The water is intended to be appropriated for (Check use intended):
(a) Artificial Recharge (b) Irrigation (c) Recreational (d) Water Power
(e) Industrial (f) Municipal (g) Stockwatering (h) Sediment Control
(i) Domestic (j) Dewatering (k) Hydraulic Dredging (l) Fire Protection
(m) Thermal Exchange (n) Contamination Remediation

YOU **MUST** COMPLETE AND ATTACH ADDITIONAL DIVISION OF WATER RESOURCES FORM(S) PROVIDING INFORMATION TO SUBSTANTIATE YOUR REQUEST FOR THE AMOUNT OF WATER FOR THE INTENDED USE REFERENCED ABOVE.

For Office Use Only:		F.O. <u>2</u> GMD <u>2</u> Meets K.A.R. 5-3-1 (YES/NO) Use <u>IRR</u> Source <u>(S)</u> County <u>RN</u> By <u>ASW</u> Date <u>3/24/16</u>	
Code <u>REG</u>	Fee \$ <u>200</u>	TR # <u>16237458</u>	Receipt Date <u>3/23/16</u> Check # <u>1086</u>

APPLICATION COMPLETE
4/13/17
Reviewer AK

SCANNED 3/29/2016 LLM

49,594

Clara Miller domestic well
705 S Mayfield Rd
Hutchinson 67501



United States Department of Agriculture
Farm Service Agency
RENO COUNTY

24-23-5

March 25, 2010

FY
cy

Legend

clu.SDE.clu_a_ks155

Legend

fsa_gis_layers.SDE.wet_p_ks155
Wetland Determination Identifiers

- Restricted Use
- Limited Restrictions
- Exempt from Conservation Compliance Provisions



WATER RESOURCES
RECEIVED

Disclaimer: Wetland identifiers do not represent the size, shape or specific determination of the area. Refer to your original determination (CPA-026 and attached maps) for exact wetland boundaries and determinations, or contact NRCS.

SCANNED

MAR 23 2016

KS DEPT OF AGRICULTURE

File # 48505-00
see attachment

File No. 49,594

5. The location of the proposed wells, pump sites or other works for diversion of water is:

Note: For the application to be accepted, the point of diversion location must be described to at least a 10 acre tract, unless you specifically request a 60 day period of time in which to locate the site within a specifically described, minimal legal quarter section of land. ^{Geo NCNW 24-23-5W (4000'N, 3960'W) RENO COUNTY}

- (A) One in the SW quarter of the NE quarter of the NW quarter of Section 24, more particularly described as being near a point 4000 feet North and ³⁰⁶⁰3960 feet West of the Southeast corner of said section, in Township 23 South, Range 5 East/West (circle one), Reno County, Kansas.
- (B) One in the SW quarter of the NE quarter of the NW quarter of Section 24, more particularly described as being near a point 4000 feet North and ³⁸¹⁰3960 feet West of the Southeast corner of said section, in Township 23 South, Range 5 East/West (circle one), Reno County, Kansas.
- (C) One in the SE quarter of the NW quarter of the NW quarter of Section 24, more particularly described as being near a point 4000 feet North and ⁴¹¹⁰3960 feet West of the Southeast corner of said section, in Township 23 South, Range 5 East/West (circle one), Reno County, Kansas.
- (D) One in the SE quarter of the NW quarter of the NW quarter of Section 24, more particularly described as being near a point 4000 feet North and ⁴²⁶⁰3960 feet West of the Southeast corner of said section, in Township 23 South, Range 5 East/West (circle one), Reno County, Kansas.

If the source of supply is groundwater, a separate application shall be filed for each proposed well or battery of wells, except that a single application may include up to four wells within a circle with a quarter (1/4) mile radius in the same local source of supply which do not exceed a maximum diversion rate of 20 gallons per minute per well.

A battery of wells is defined as two or more wells connected to a common pump by a manifold; or not more than four wells in the same local source of supply within a 300 foot radius circle which are being operated by pumps not to exceed a total maximum diversion rate of 800 gallons per minute and which supply water to a common distribution system.

6. The owner of the point of diversion, if other than the applicant is (please print):

Harold Swanson Trust c/o Matt Brack 620-694-4018
(name, address and telephone number)
4000 E G Street Hutchinson KS 67501
(name, address and telephone number)

You must provide evidence of legal access to, or control of, the point of diversion from the landowner or the landowner's authorized representative. Provide a copy of a recorded deed, lease, easement or other document with this application. In lieu thereof, you may sign the following sworn statement:

I have legal access to, or control of, the point of diversion described in this application from the landowner or the landowner's authorized representative. I declare under penalty of perjury that the foregoing is true and correct.

Executed on March 22, 2016 Robert Brack
Applicant's Signature

The applicant must provide the required information or signature irrespective of whether they are the landowner. Failure to complete this portion of the application will cause it to be unacceptable for filing and the application will be returned to the applicant.

7. The proposed project for diversion of water will consist of 4 wells
(number of wells, pumps or dams, etc.)

and (was) will be completed (by) 2013
(Month/Day/Year - each was or will be completed)

8. The first actual application of water for the proposed beneficial use was or is estimated to be RECEIVED 2013
(Mo/Day/Year)

SCANNED

MAR 23 2016

KS DEPT OF AGRICULTURE

9. Will pesticide, fertilizer, or other foreign substance be injected into the water pumped from the diversion works?
 Yes No If "yes", a check valve shall be required.

All chemigation safety requirements must be met including a chemigation permit and reporting requirements.

10. If you are planning to impound water, please contact the Division of Water Resources for assistance, prior to submitting the application. Please attach a reservoir area capacity table and inform us of the total acres of surface drainage area above the reservoir.

Have you also made an application for a permit for construction of this dam and reservoir with the Division of Water Resources? Yes No

- If yes, show the Water Structures permit number here _____
- If no, explain here why a Water Structures permit is not required _____

11. The application must be supplemented by a U.S.G.S. topographic map, aerial photograph or a detailed plat showing the following information. On the topographic map, aerial photograph, or plat, identify the center of the section, the section lines or the section corners and show the appropriate section, township and range numbers. Also, please show the following information:

- ✓ (a) The location of the proposed point(s) of diversion (wells, stream-bank installations, dams, or other diversion works) should be plotted as described in Paragraph No. 5 of the application, showing the North-South distance and the East-West distance from a section line or southeast corner of section.
- ✓ (b) If the application is for groundwater, please show the location of any existing water wells of any kind within 1/2 mile of the proposed well or wells. Identify each existing well as to its use and furnish the name and mailing address of the property owner or owners. If there are no wells within 1/2 mile, please advise us.
- (c) If the application is for surface water, the names and addresses of the landowner(s) 1/2 mile downstream and 1/2 mile upstream from your property lines must be shown.
- ✓ (d) The location of the proposed place of use should be shown by crosshatching on the topographic map, aerial photograph or plat.
- (e) Show the location of the pipelines, canals, reservoirs or other facilities for conveying water from the point of diversion to the place of use. *well + pivot already exist*

A 7.5 minute U.S.G.S. topographic map may be obtained by providing the section, township and range numbers to: Kansas Geological Survey, 1930 Constant, Campus West, University of Kansas, Lawrence, Kansas 66047.

12. List any application, appropriation of water, water right, or vested right file number that covers the same diversion points or any of the same place of use described in this application. Also list any other recent modifications made to existing permits or water rights in conjunction with the filing of this application.

File # 48505-00 Matt waters north 80 of NW 1/4

overlapping point of diversion

I want to water south 80 of NW 1/4

WATER RESOURCES RECEIVED
SCANNED
MAR 23 2016



WATER RESOURCES
RECEIVED

3-13-17

MAR 15 2017

Brent,

KS DEPT OF AGRICULTURE

Thank goodness I took my
wife's car to exercise class this
morning. I found this envelope
which she was going to mail
for me. Grrrr.

Sorry

Bob

**IRRIGATION USE
SUPPLEMENTAL SHEET**

File No. 49,594

Name of Applicant (Please Print): Robert A Bacon

1. Please supply the name and address of each landowner, the legal description of the lands to be irrigated, and designate the actual number of acres to be irrigated in each forty acre tract or fractional portion thereof:

Landowner of Record NAME: William C Ellis Family Trust
 ADDRESS: 5505 E 64th Street Tulsa OK 74136

S	T	R	NE¼				NW¼				SW¼				SE¼				TOTAL	
			NE	NW	SW	SE	NE	NW	SW	SE	NE	NW	SW	SE	NE	NW	SW	SE		
24	23	5							33.75											67.5

Landowner of Record NAME: _____
 ADDRESS: _____

S	T	R	NE¼				NW¼				SW¼				SE¼				TOTAL	
			NE	NW	SW	SE	NE	NW	SW	SE	NE	NW	SW	SE	NE	NW	SW	SE		

Landowner of Record NAME: _____
 ADDRESS: _____

S	T	R	NE¼				NW¼				SW¼				SE¼				TOTAL	
			NE	NW	SW	SE	NE	NW	SW	SE	NE	NW	SW	SE	NE	NW	SW	SE		

SCANNED WATER RESOURCES RECEIVED
 MAR 23 2016

County
Reno

Tax year
2016

Section
24

Township
23

Range
05W

Legal

S 80AC OF NW/4

Total Acres
79

Irrigated
0

Total Parcel
79.349998

Name and Address

ELLIS, WILLIAM C FAM TRUST
C/O ELLIS, WILL & PATRICIA 5505 E 64TH ST
TULSA OK 74136-2053

Formatted address

C/O ELLIS, WILL & PATRICIA
5505 E 64TH ST
TULSA, OK 74136-2053

Property ID
26721

Property number
078-136-24-0-00-00-003.01-0

2. Please complete the following information for the description of the operation for the irrigation project. Attach supplemental sheets as needed.

a. Indicate the soils in the field(s) and their intake rates:

will get intake data

see attachment

Soil Name	Percent of field (%)	Intake Rate (in/hr)	Irrigation Design Group
_____	_____	_____	_____
_____	_____	_____	_____
_____	_____	_____	_____
_____	_____	_____	_____
Total:	100 %		

b. Estimate the average land slope in the field(s):

0-1 %

Estimate the maximum land slope in the field(s):

3 %

c. Type of irrigation system you propose to use (check one):

- Center pivot
- Center pivot - LEPA
- "Big gun" sprinkler
- Gravity system (furrows)
- Gravity system (borders)
- Sideroll sprinkler

Other, please describe: _____

d. System design features:

i. Describe how you will control tailwater:

Inman Irr. will supply pivot information

ii. For sprinkler systems:

- (1) Estimate the operating pressure at the distribution system: _____ psi
- (2) What is the sprinkler package design rate? _____ gpm
- (3) What is the wetted diameter (twice the distance the sprinkler throws water) of a sprinkler on the outer 100 feet of the system? _____ feet
- (4) Please include a copy of the sprinkler package design information.

e. Crop(s) you intend to irrigate. Please note any planned crop rotations:

corn, soybeans, milo, wheat, cover crop

f. Please describe how you will determine when to irrigate and how much water to apply (particularly important if you do not plan a full irrigation).

Kevin Schoenhals is my crop consultant

You may attach any additional information you believe will assist in informing the Division of the need for your request.

WATER RESOURCES RECEIVED

SCANNED

MAR 23 2016

49,594



1000 Corey Road
P.O. Box 886
Hutchinson, KS 67504-0886
620-665-5661
FAX 620-665-0559

Sample #	3400
Sample	Water ROBERT BACON
Other ID	9/12/06 IRR. #2

Received	09/13/2006
Reported	09/18/2006
Total Fee	\$35.00

DARLING DRILLING
1211 WEST 4TH
HUTCHINSON KS 67502

	Result Comment	Dry Basis	As Received
pH - SM 4500-H+ B			7.74 s.u.
Chloride - SM 4110 B			150.00 mg/L
Total Hardness - SM 2340B			269.89 mg/L
Nitrate-Nitrogen - SM 4500 NO3 D			1.97 mg/L
Calcium - SM 3111B			78.40 mg/L
Magnesium - SM 3111B			18.00 mg/L
Sodium - SM 3111B			102.00 mg/L
Sulfate - SM 15th Ed. 426C			175.00 mg/L
% Sodium			51.40 %
SAR-Sodium Absorption Ratio			2.69 s.u.
Electrical Conductivity - SM 2510B			1050.00 umhos/cm
TDS-Total Dissolved Solids - SM 2540C			628.00 mg/L
Irrigation Quality Rating	AS FOLLOWS		.00
Light Soil -Salinity Hazard	Low		.00
Light Soil - Sodium Hazard	Medium		.00
Medium Soil -Salinity Hazard	Low		.00
Medium Soil -Sodium Hazard	Medium		.00
Heavy Soil -Salinity Hazard	Medium		.00
Heavy Soil -Sodium Hazard	High		.00
General Comment:	Good to Permissible		.00

Approved By:

ANALYTICAL RESULTS APPLY ONLY TO THE SUBMITTED SAMPLE AND MAY NOT REFLECT RESULTS OF SEEMINGLY IDENTICAL MATERIAL OR PRODUCTS

AOCS OFFICIAL APPROVED CHEMISTS · NFTA CERTIFIED LABORATORY · KDHE CERTIFIED LABORATORY

SCANNED MAR 23 2016

KS DEPT OF AGRICULTURE



Contact Us | Subscribe | Archived Soil Surveys | Soil Survey Status | Glossary | Preferences | Link | Logout | Help | A | A | A

Area of Interest (AOI) | Soil Map | Soil Data Explorer | Download Soils Data | Shopping Cart (Free)

Printable Version | Add to Shopping Cart

Search

Map Unit Legend

Reno County, Kansas (KS155)

Map Unit Symbol	Map Unit Name	Acres in AOI	Percent of AOI
5730	Darlow-Elmer complex, 0 to 2 percent slopes	54.4	71.2%
5832	Punkin-Taver complex, 0 to 1 percent slopes	8.0	10.5%
5870	Carway and Carbika soils, 0 to 1 percent slopes	7.7	10.1%
5943	Saltcreek and Naron fine sandy loams, 0 to 1 percent slopes	6.3	8.2%
Totals for Area of Interest		76.4	100.0%

Soil Map

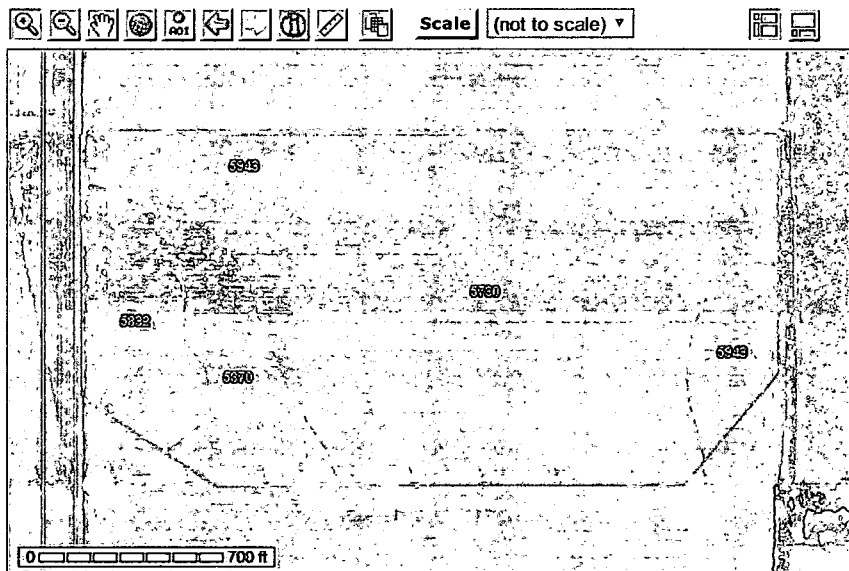

Warning: Soil Map may not be valid at this scale.

FOIA | Accessibility Statement | Privacy Policy | Non-Discrimination Statement | Information Quality | USA.gov | White House

WATER RESOURCES RECEIVED
SCANNED MAR 23 2016
KS DEPT OF AGRICULTURE

3-23-16
(Date)

Kansas Department of Agriculture
Division of Water Resources
David W. Barfield, Chief Engineer

109 SW 9th Street, 2nd Floor
Topeka, Kansas: 66612-1283
Revised Application # 49,594
File No: _____

Minimum Desirable Streamflow

Dear Sir:

I understand that a Minimum Desirable Streamflow requirement has been established by the legislature for the source of supply to which the above referenced application applies.

I understand that diversion of water pursuant to this application will be subject to regulation any time Minimum Desirable Streamflow requirements are not being met.

I also understand that if this application is approved, there could be times, as determined by the Division of Water Resources, when I would not be allowed to divert water. I realize that this could affect the economics of my decision to appropriate water.

I am aware of the above factors, and with the knowledge thereof, request that the Division of Water Resources proceed with processing and approval, if possible, of the above referenced application.

Robert A Bacon

Signature of Applicant

Robert A Bacon

(Print Applicant's Name)

State of Kansas)

County of Harvey)

) ss

I hereby certify that the foregoing instrument was signed in my presence and sworn to before me this 23 day of March, 2016.

[Signature]
Notary Public

My Commission Expires:

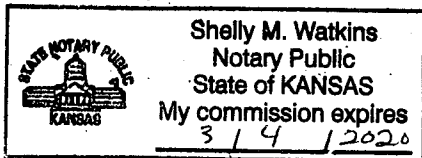

WATER RESOURCES
RECEIVED

SCANNED
MAR 23 2016

KS DEPT OF AGRICULTURE

**MINIMUM DESIRABLE STREAMFLOW FORM TO BE USED WHEN
APPLICABLE WHEN FILING AN APPLICATION FOR PERMIT
TO APPROPRIATE WATER FOR BENEFICIAL USE**

The Kansas Legislature has established minimum desirable streamflows for the streams listed below. If your proposed diversion of water is going to be from one of these watercourses or adjacent alluvial aquifers, please complete the back side of this page and submit it along with your application for permit to appropriate water.

- | | |
|---------------------------------|----------------------------|
| Arkansas River | Ninnescah River |
| Big Blue River | North Fork Ninnescah River |
| Chapman Creek | Rattlesnake Creek |
| Chikaskia River | Republican River |
| Cottonwood River | Saline River |
| Delaware River | Smoky Hill River |
| Little Arkansas River | Solomon River |
| Little Blue River | South Fork Ninnescah River |
| Marais des Cygnes River | Spring River |
| Medicine Lodge River | Walnut River |
| Mill Creek (Wabaunsee Co. area) | Whitewater River |
| Neosho River | |

... ..

... ..

... ..

... ..

... ..

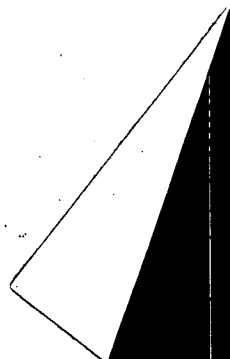
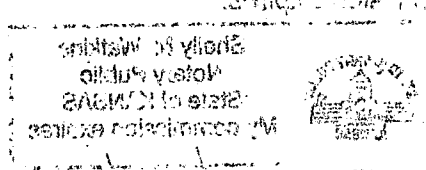

13. Furnish the following well information if the proposed appropriation is for the use of groundwater. If the well has not been completed, give information obtained from test holes, if available.

Information below is from: Test holes Well as completed Drillers log attached

see attached

Well location as shown in paragraph No.	(A)	(B)	(C)	(D)
Date Drilled	_____	_____	_____	_____
Total depth of well	_____	_____	_____	_____
Depth to water bearing formation	_____	_____	_____	_____
Depth to static water level	_____	_____	_____	_____
Depth to bottom of pump intake pipe	_____	_____	_____	_____

14. The relationship of the applicant to the proposed place where the water will be used is that of

tenant
(owner, tenant, agent or otherwise)

15. The owner(s) of the property where the water is used, if other than the applicant, is (please print):

William C Ellis Family Trust 918-481-5964
(name, address and telephone number)

5505 E 64th Street Tulsa OK 74136
(name, address and telephone number)

16. The undersigned states that the information set forth above is true to the best of his/her knowledge and that this application is submitted in good faith.

Dated at Hutchinson, Kansas, this 22 day of March, 2016.
(month) (year)

Robert Bacon
(Applicant Signature)

By _____
(Agent or Officer Signature)

(Agent or Officer - Please Print)

Assisted by _____ Date: _____
(office/title)

WATER RESOURCES RECEIVED

SCANNED MAR 23 2016

KS DEPT OF AGRICULTURE

49587 49588 49589
49590 49591 49592
49593 49594

Application 49590 continued

Daniel Kelly Domestic well
3806 South Mayfield Road
Hutchinson KS 67501

Robert Bacon Domestic well
3616 South Mayfield Road
Hutchinson KS 67501

WATER RESOURCES
RECEIVED

SEP 19 2016

KS DEPT OF AGRICULTURE

Application 49591

Matt Brack Irrigation well File Number 48505 NW4 24-23-5
4000 East G Street Irrigation well on SE4 23-23-5
Hutchinson KS 67501

Judy Langley Domestic well
6818 East Blanchard
Hutchinson KS 67501

J. Bartholomew Domestic well
5815 East Blanchard Street
Hutchinson KS 67501

Mickey Strandberg Domestic well
1718 South Mayfield Road
Hutchinson KS 67501

Application Number 49592

Anita Norton Domestic well
6809 East Illinois Avenue
Hutchinson KS 67501

Application Number 49593

Bryan Ford Domestic well
7817 East Illinois Avenue
Hutchinson KS 67501

Application Number 49594 Stacking on top of File Number 48505 Use existing well.

Unknown occupant Domestic well
705 South Mayfield Road
Hutchinson KS 67501

Unknown occupant Domestic well
718 South Mayfield Road
Hutchinson KS 67501

4

SCANNED

Application #49587

Julie Beal Irrigation well
3319 South Mayfield Road
Hutchinson KS 67501

Daniel Kelly Domestic well
3806 South Mayfield Road
Hutchinson KS 67501

Tony Bresino Domestic well
4005 South Mayfield Road
Hutchinson KS 67501

Matthew Burns Domestic well
5613 East Stroud Road
Hutchinson KS 67501

Application 49588

Ray Bartholomew Domestic well
4107 South Obee Road
Hutchinson KS 67501

Julie Beal Two Irrigation wells
3319 South Mayfield Road
Hutchinson KS 67501

Matthew Burns Domestic well
5613 East Stroud Road
Hutchinson KS 67501

Robert Bacon Irrigation well File Number 47609
3616 South Mayfield Road
Hutchinson KS 67501

Application 49589

No wells within one half mile

Application 49590

Julie Beal Domestic well
3319 South Mayfield Road
Hutchinson KS 67501

Anita Norton Domestic well
6809 East Illinois Avenue
Hutchinson KS 67501

Tony Bresino Domestic well
4005 South Mayfield Road
Hutchinson KS 67501

FEE SCHEDULE

1. The fee for an application for a permit to appropriate water for beneficial use, except for domestic use, shall be (see paragraph No. 2 below if requesting storage):

ACRE-FEET	FEE
0-100	\$200.00
101-320	\$300.00
More than 320	\$300.00 plus \$20.00 for each additional 100 acre-feet or any part thereof.

2. The fee for an application in which storage is requested, except for domestic use, shall be:

ACRE-FEET	FEE
0-250	\$200.00
More than 250	\$200.00 plus \$20.00 for each additional 250 acre-feet of storage or any part thereof.

Note: If an application requests both direct use *and* storage, the fee charged shall be as determined under No. 1 or No. 2 above, whichever is greater, but not both fees.

3. The fee for an application for a permit to appropriate water for water power or dewatering purposes shall be \$100.00 plus \$200.00 for each 100 cubic feet per second, or part thereof, of the diversion rate requested.

Note: The applicant shall notify the Chief Engineer and pay the statutorily required field inspection fee of \$400.00 when construction of the works for diversion has been completed, except that for applications filed on or after July 1, 2009, for works constructed for sediment control use and for evaporation from a groundwater pit for industrial use shall be accompanied by a field inspection fee of \$200.00.

MAKE CHECKS PAYABLE TO THE KANSAS DEPARTMENT OF AGRICULTURE

ATTENTION

A Water Conservation Plan may be required per K.S.A. 82a-733. A statement that your application for permit to appropriate water may be subject to the minimum desirable streamflow requirements per K.S.A. 82a-703a, b, and c may also be required from you. After the Division of Water Resources has had the opportunity to review your application, you will be notified whether or not you will need to submit a Water Conservation Plan. You also may be required to install a water flow meter or water stage measuring device on your diversion works prior to diverting water. There may be other special conditions or Groundwater Management District regulations that you will need to comply with if this application is approved.

CONVERSION FACTORS

1 acre-foot equals 325,851 gallons

1 million gallons equal 3.07 acre-feet

WATER RESOURCES
RECEIVED

SCANNED MAR 23 2016

KS DEPT OF AGRICULTURE

Krueger, Richelle

From: Lanterman, Jeff
Sent: Thursday, April 6, 2017 3:23 PM
To: Krueger, Richelle
Cc: Conant, Cameron
Subject: FW: Request for Recommendation, Bacon New Applications File Nos. 49587; 49589; 49590; 49592; 49593 and 49594
Attachments: newapp49594newappmembattgmd2pdolap48505rev.docx;
newapp49593newappmemgmd2.docx; newapp49592newappmemgmd2.docx;
newapp49590newappmemgmd2.docx; newapp49589newappmemgmd2.docx;
newapp49587newappmemgmd2.docx

Richelle,

Go ahead and approve these applications. I think they are good to go.

Jeff

From: Conant, Cameron
Sent: Thursday, April 6, 2017 2:41 PM
To: Lanterman, Jeff <Jeff.Lanterman@ks.gov>
Subject: FW: Request for Recommendation, Bacon New Applications File Nos. 49587; 49589; 49590; 49592; 49593 and 49594

Jeff, this packet of applications are all in pretty close proximity of one another and located several miles SE of Hutchinson. They have all been reviewed and recommended for approval by GMD#2, so the SY and spacing must be good on all these as there were no board reviews, denials, or appeals on the 6 attached applications.

Here are some representative hydrographs. The area appears very stable. One test log show a DTW of 5.5' and stopped in a clay layer around 33' deep, I didn't find test logs for each application so I guess we have them but they aren't in docuware yet.

http://hercules.kgs.ku.edu/geohydro/wizard/wizardwelldetail.cfm?usgs_id=380002097514503

http://hercules.kgs.ku.edu/geohydro/wizard/wizardwelldetail.cfm?usgs_id=380002097514502

http://hercules.kgs.ku.edu/geohydro/wizard/wizardwelldetail.cfm?usgs_id=380000097463003

http://hercules.kgs.ku.edu/geohydro/wizard/wizardwelldetail.cfm?usgs_id=380142097484001

I think you can pass these on to Richelle with a recommendation of approval.

Cameron

From: Krueger, Richelle
Sent: Wednesday, March 22, 2017 11:46 AM
To: Lanterman, Jeff <Jeff.Lanterman@ks.gov>
Cc: Conant, Cameron <Cameron.Conant@ks.gov>; Turney, Brent <Brent.Turney@ks.gov>
Subject: Request for Recommendation, Bacon New Applications File Nos. 49587; 49589; 49590; 49592; 49593 and 49594

Hi Jeff,

Attached are draft memos for the referenced new applications . I resubmitted Application File No. 49588 to GMD 2 for another recommendation but thought maybe you would want to start reviewing some of this package. Application File No. 49591 was recommended for denial based on safe yield, I think it will be dismissed.

Do you recommend approval of the attached new applications?

Thanks,
Richelle

Krueger, Richelle

From: Turney, Brent
Sent: Tuesday, February 7, 2017 2:39 PM
To: Krueger, Richelle
Subject: FW: Application No. 49594

Brent A. Turney, P.G.
Kansas Department of Agriculture
Division of Water Resources
1320 Research Park Drive
Manhattan Kansas 66502
(785) 564-6645
Brent.Turney@ks.gov
www.agriculture.ks.gov

From: Robert Bacon [mailto:bacon36235@gmail.com]
Sent: Tuesday, February 7, 2017 2:37 PM
To: Tim Boese <tboese@gmd2.org>
Cc: Turney, Brent <Brent.Turney@ks.gov>; Bacon Me <bacon36235@gmail.com>
Subject: Re: Application No. 49594

I believe the process has begun. I received a copy of a letter that went to a landowner who has a center pivot with wells in a battery and four or five entities that involve sandpit location.

If I have that wrong could Brent Turney can clarify the situation for me.

49588

Well batteries confuse this old farmer so I also ran afoul of regulations on the Appropriation Application No. 49588. I received a letter saying my application placed my proposed well less than 1,320 from my neighbors well.

It is true I am trying to place a well just over 1,300 feet from a well battery site found on Water Permit No. 45358. That well was never developed. Only the center site of the three was developed. I am 1,650 to 1,700 feet from an actual well. That site was developed in 2003.

Does this matter?

If the Water Permit holder notified you that no development of the proposed east well was planned and would forfeit that location, would that matter?

Can there be a variance from regulations in special circumstances?

Thanks for any and all clarifications about my two above situations.

45591

Oh yes, apparently I used incorrect data about existing and proposed consumptive appropriations when applying for water on Appropriation Application No. 49591. I will not appeal that denial.

On Feb 7, 2017 1:45 PM, "Tim Boese" <tboese@gmd2.org> wrote:

Robert – I received your telephone inquiry regarding Application No. 49594 and notification of nearby well owners. During our review of the application, we noted that it appears that there were nearby well owners who were not notified of the application, as the irrigation well authorized by Water Permit No. 48881, and the groundwater pit authorized by Water Permit No. 46863, were not identified on the application map you submitted with the application. As this is a Division of Water Resources' requirement and they send out the surrounding well owner notifications, I suggest you contact Brent Turney, DWR, to discuss on how to handle this. I have copied Brent with this email so you can email him or you can call him at 785-564-6645.

If I can be of assistance with a new application map, etc., please contact me.

Thanks.

Tim Boese, Manager

Equus Beds GMD2

313 Spruce, Halstead, Kansas 67056

316-835-2224

Fax: 316-835-2225

tboese@gmd2.org

www.gmd2.org

Krueger, Richelle

From: Turney, Brent
Sent: Tuesday, March 14, 2017 3:03 PM
To: Robert Bacon
Cc: Krueger, Richelle
Subject: FW: Bacon water applications

Mr. Bacon,

As per our last emails, you were going to print the maps and send them to this office. As soon as we receive them, we should be able to proceed with your applications.

Thank you,

Brent

Brent A. Turney, P.G.
Kansas Department of Agriculture
Division of Water Resources
1320 Research Park Drive
Manhattan Kansas 66502
(785) 564-6645
Brent.Turney@ks.gov
www.agriculture.ks.gov

From: Robert Bacon [mailto:bacon36235@gmail.com]
Sent: Wednesday, March 1, 2017 7:44 AM
To: Turney, Brent <Brent.Turney@ks.gov>
Subject: RE: Bacon water applications

I will get that done this morning while it is chilly outside.

We are having to build more electric fence around rye now because the wheat is about to start jointing! The first of March. It will be a miracle if we don't lose this crop to weather.

On Mar 1, 2017 7:39 AM, "Turney, Brent" <Brent.Turney@ks.gov> wrote:

Mr. Bacon,

Could you please print the maps out, sign and date them. Once this is complete, could you forward the hard copies to me?

Sorry for the inconvenience.

Brent,

Brent A. Turney, P.G.

Kansas Department of Agriculture

Division of Water Resources

1320 Research Park Drive

Manhattan Kansas 66502

(785) 564-6645

Brent.Turney@ks.gov

www.agriculture.ks.gov

From: Robert Bacon [mailto:bacon36235@gmail.com]

Sent: Tuesday, February 28, 2017 4:46 PM

To: Turney, Brent <Brent.Turney@ks.gov>; Stephen Flaherty <sflaherty@gmd2.org>

Subject: Bacon water applications

Brent Turney

On application 49588 I have moved the point of diversion 200' east of what I applied for on my original application.

On application 49594 I believe we are back on track after notifying the other water users north of my proposed development that were omitted on the original application?

Thank you both for your time in getting this maps clarified.

Bob Bacon

Krueger, Richelle

From: Turney, Brent
Sent: Tuesday, February 28, 2017 10:44 AM
To: Krueger, Richelle
Subject: FW: Bacon Application Maps
Attachments: bacon pou acreage.pdf; 49587POU.pdf; 49588POU.pdf; 49589POU.pdf; 49590POU.pdf; 49592POU.pdf; 49593POU.pdf

With any luck, Bacon will print these off and send them in????

What about the last statement? Other applications?

Brent A. Turney, P.G.
Kansas Department of Agriculture
Division of Water Resources
1320 Research Park Drive
Manhattan Kansas 66502
(785) 564-6645
Brent.Turney@ks.gov
www.agriculture.ks.gov

From: Steve Flaherty [mailto:sflaherty@gmd2.org]
Sent: Tuesday, February 28, 2017 10:32 AM
To: 'Robert Bacon' <bacon36235@gmail.com>
Subject: Bacon Application Maps

Robert,

I re drew the place of use maps for you and included a separate map with all of the acres I calculated in each quarter for application nos. 49587, 49588, 49589, 49590, 49592, and 49593.

If you agree with the acreages and maps then send them off to Brent Turney at DWR (Brent.Turney@ks.gov).

If there are any issues or if Brent thinks that you need place of use maps for your other applications then feel free to give me a call and I will help you out.

Thanks,

Steve Flaherty, Hydrogeologist
Equus Beds GMD No. 2
313 Spruce Street * Halstead, KS 67056
P: (316) 835-2224 * F: (316) 835-2225
www.gmd2.org

Krueger, Richelle

From: Turney, Brent
Sent: Tuesday, February 7, 2017 2:39 PM
To: Krueger, Richelle
Subject: FW: Application No. 49594

Brent A. Turney, P.G.
Kansas Department of Agriculture
Division of Water Resources
1320 Research Park Drive
Manhattan Kansas 66502
(785) 564-6645
Brent.Turney@ks.gov
www.agriculture.ks.gov

From: Robert Bacon [mailto:bacon36235@gmail.com]
Sent: Tuesday, February 7, 2017 2:37 PM
To: Tim Boese <tboese@gmd2.org>
Cc: Turney, Brent <Brent.Turney@ks.gov>; Bacon Me <bacon36235@gmail.com>
Subject: Re: Application No. 49594

I believe the process has begun. I received a copy of a letter that went to a landowner who has a center pivot with wells in a battery and four or five entities that involve sandpit location.

If I have that wrong could Brent Turney can clarify the situation for me.

49588

Well batteries confuse this old farmer so I also ran afoul of regulations on the Appropriation Application No. 49588. I received a letter saying my application placed my proposed well less than 1,320 from my neighbors well.

It is true I am trying to place a well just over 1,300 feet from a well battery site found on Water Permit No. 45358. That well was never developed. Only the center site of the three was developed. I am 1,650 to 1,700 feet from an actual well. That site was developed in 2003.

Does this matter?

If the Water Permit holder notified you that no development of the proposed east well was planned and would forfeit that location, would that matter?

Can there be a variance from regulations in special circumstances?

Thanks for any and all clarifications about my two above situations.

45591

Oh yes, apparently I used incorrect data about existing and proposed consumptive appropriations when applying for water on Appropriation Application No. 49591. I will not appeal that denial.

On Feb 7, 2017 1:45 PM, "Tim Boese" <tboese@gmd2.org> wrote:

Robert – I received your telephone inquiry regarding Application No. 49594 and notification of nearby well owners. During our review of the application, we noted that it appears that there were nearby well owners who were not notified of the application, as the irrigation well authorized by Water Permit No. 48881, and the groundwater pit authorized by Water Permit No. 46863, were not identified on the application map you submitted with the application. As this is a Division of Water Resources' requirement and they send out the surrounding well owner notifications, I suggest you contact Brent Turney, DWR, to discuss on how to handle this. I have copied Brent with this email so you can email him or you can call him at 785-564-6645.

If I can be of assistance with a new application map, etc., please contact me.

Thanks.

Tim Boese, Manager

Equus Beds GMD2

313 Spruce, Halstead, Kansas 67056

316-835-2224

Fax: 316-835-2225

tboese@gmd2.org

www.gmd2.org

1320 Research Park Drive
Manhattan, Kansas 66502
(785) 564-6700



900 SW Jackson, Room 456
Topeka, Kansas 66612
(785) 296-3556

Jackie McClaskey, Secretary

Governor Sam Brownback

February 1, 2017

BILL SHEARS
PO BOX 1605
HUTCHINSON KS 67501-1605

Re: Application File No. 49,594

Dear Sir or Madam:

This is to advise you that Robert Bacon has filed the application referred to above for a permit to appropriate 94.5 acre-feet of ground water per calendar year for irrigation use to be diverted at a maximum rate of 800 gallons per minute, from a battery of four wells with a geographic center located as follows:

one(1) battery of four (4) wells with a geographic center located near the center of the Northwest Quarter of Section 24, more particularly described as being near a point 4,000 feet North and 3,960 feet West of the Southeast corner of said section, in Township 23 South, Range 5 West, Reno County, Kansas.

A map is on the reverse of this letter for your information. Please note this is an existing well battery authorized by Appropriation of Water File No. 48,505. The applicant proposes to use this battery of wells in addition to the current owner. Records in this office indicate that you may have a well or wells in this vicinity and you are being notified of receipt of this application in order that you may be fully informed of the proposed location of the applicant's point of diversion and proposed use of water. Consideration will be given to comments or other information which you desire to submit to this office within 15 days from the date of this letter. If you have any questions about the referenced application, please contact me at 1-785-564-6635.

Sincerely,

Richelle A. Krueger
Environmental Scientist

pc: Stafford Office
Groundwater Management District No. 2
Robert Bacon

SCANNED

Application, File No. 49,594

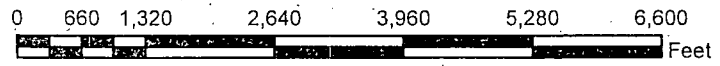
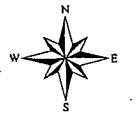
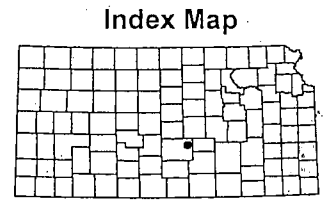
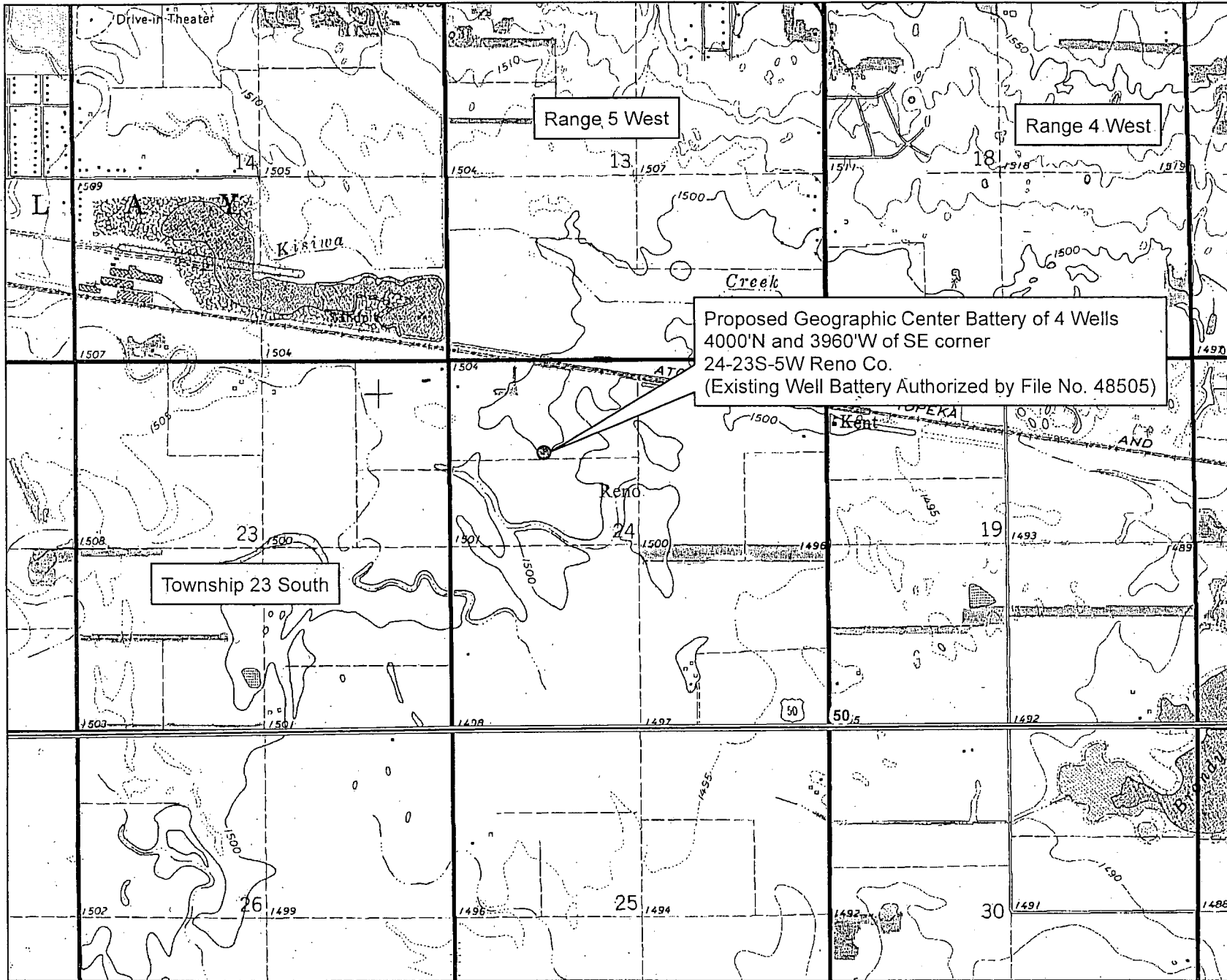

1:24,000

This map was created by WIMAS on 1/31/2017 1:29:43 PM

1320 Research Park Drive
Manhattan, Kansas 66502
(785) 564-6700



900 SW Jackson, Room 456
Topeka, Kansas 66612
(785) 296-3556

Jackie McClaskey, Secretary

Governor Sam Brownback

February 1, 2017

WILL H JR AND ZOE SHEARS FAM TRUST
C/O COMMERCE TRUST COMPANY
101 E 30TH AVE
HUTCHINSON KS 67502

Re: Application File No. 49,594

Dear Sir or Madam:

This is to advise you that Robert Bacon has filed the application referred to above for a permit to appropriate 94.5 acre-feet of ground water per calendar year for irrigation use to be diverted at a maximum rate of 800 gallons per minute, from a battery of four wells with a geographic center located as follows:

one(1) battery of four (4) wells with a geographic center located near the center of the Northwest Quarter of Section 24, more particularly described as being near a point 4,000 feet North and 3,960 feet West of the Southeast corner of said section, in Township 23 South, Range 5 West, Reno County, Kansas.

A map is on the reverse of this letter for your information. Please note this is an existing well battery authorized by Appropriation of Water File No. 48,505. The applicant proposes to use this battery of wells in addition to the current owner. Records in this office indicate that you may have a well or wells in this vicinity and you are being notified of receipt of this application in order that you may be fully informed of the proposed location of the applicant's point of diversion and proposed use of water. Consideration will be given to comments or other information which you desire to submit to this office within 15 days from the date of this letter. If you have any questions about the referenced application, please contact me at 1-785-564-6635.

Sincerely,

Richelle A. Krueger
Environmental Scientist

pc: Stafford Office
Groundwater Management District No. 2
Robert Bacon

SCANNED

Application, File No. 49,594

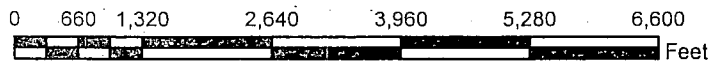
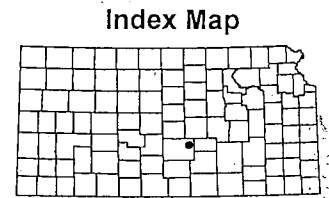
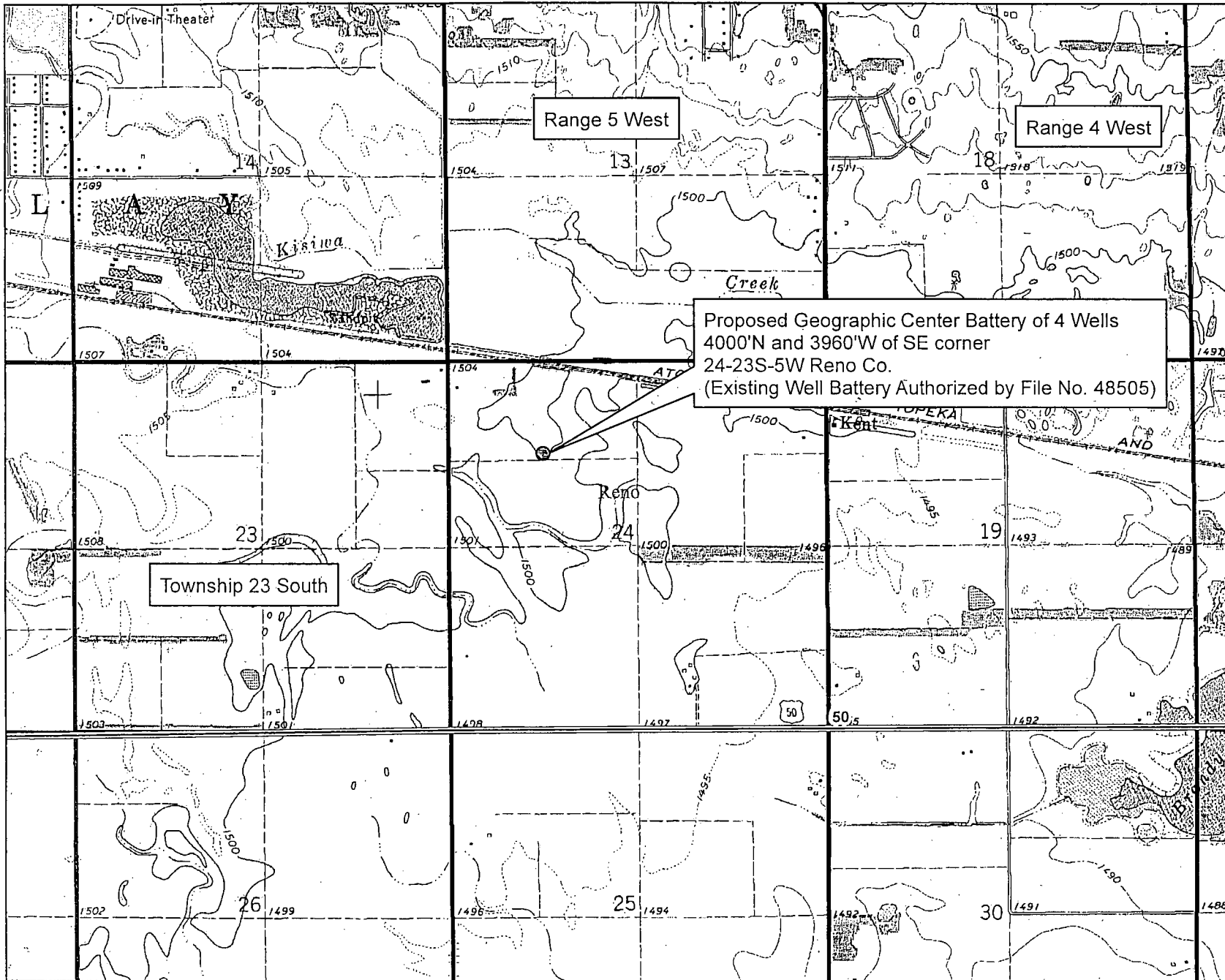

1:24,000

This map was created by WIMAS on 1/31/2017 1:29:43 PM



1320 Research Park Drive
Manhattan, Kansas 66502
(785) 564-6700

900 SW Jackson, Room 456
Topeka, Kansas 66612
(785) 296-3556

Jackie McClaskey, Secretary

Governor Sam Brownback

February 1, 2017

JARIS A & SHEILA L REGIER
7802 E 95TH AVE
BUHLER KS 67522

Re: Application File No. 49,594

Dear Sir or Madam:

This is to advise you that Robert Bacon has filed the application referred to above for a permit to appropriate 94.5 acre-feet of ground water per calendar year for irrigation use to be diverted at a maximum rate of 800 gallons per minute, from a battery of four wells with a geographic center located as follows:

one(1) battery of four (4) wells with a geographic center located near the center of the Northwest Quarter of Section 24, more particularly described as being near a point 4,000 feet North and 3,960 feet West of the Southeast corner of said section, in Township 23 South, Range 5 West, Reno County, Kansas.

A map is on the reverse of this letter for your information. Please note this is an existing well battery authorized by Appropriation of Water File No. 48,505. The applicant proposes to use this battery of wells in addition to the current owner. Records in this office indicate that you may have a well or wells in this vicinity and you are being notified of receipt of this application in order that you may be fully informed of the proposed location of the applicant's point of diversion and proposed use of water. Consideration will be given to comments or other information which you desire to submit to this office within 15 days from the date of this letter. If you have any questions about the referenced application, please contact me at 1-785-564-6635.

Sincerely,

Richelle A. Krueger
Environmental Scientist

pc: Stafford Office
Groundwater Management District No. 2
Robert Bacon

SCANNED

Application, File No. 49,594

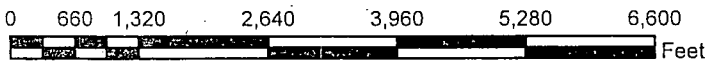
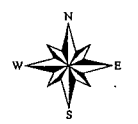
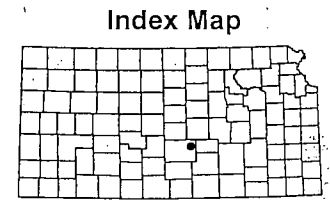
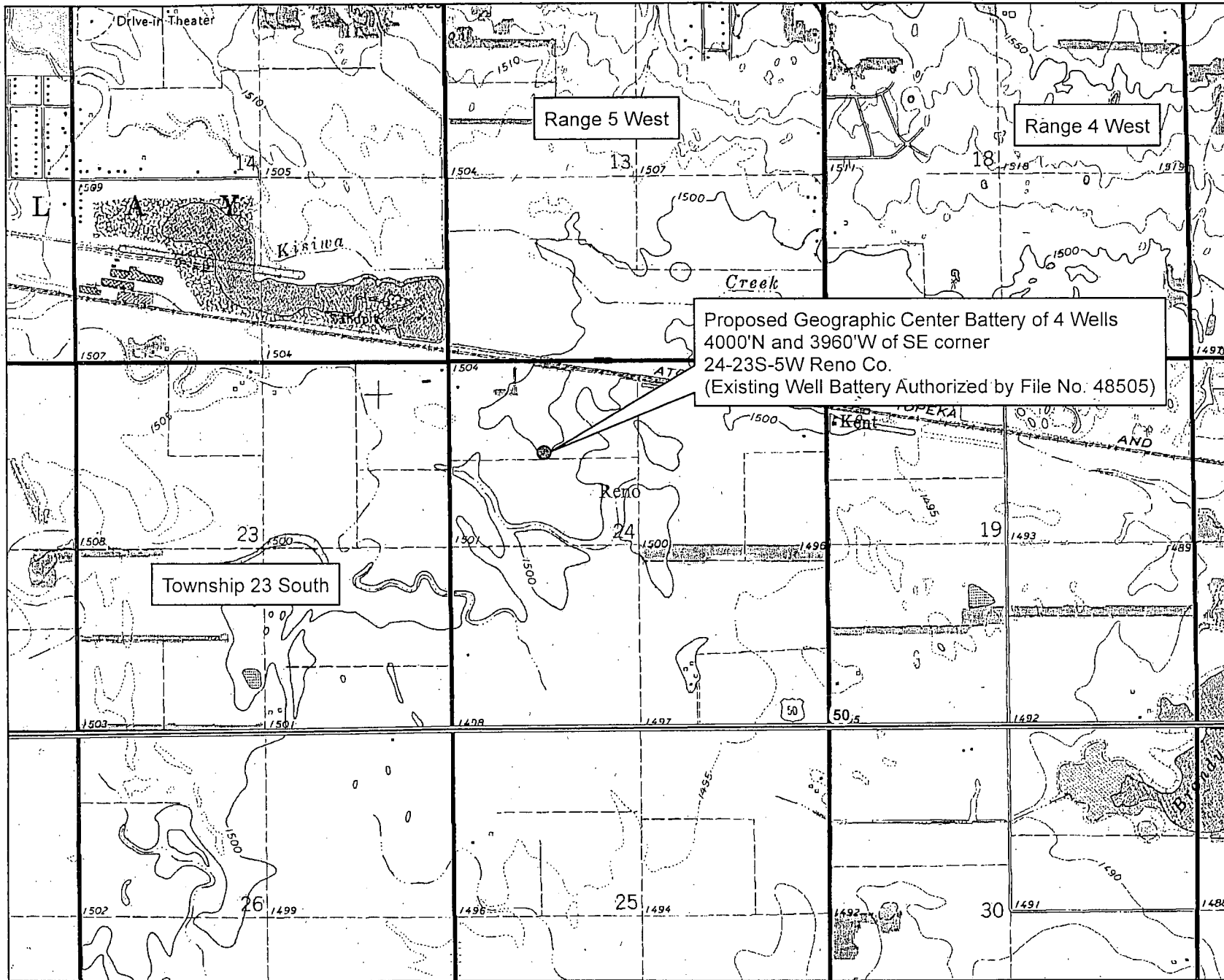

1:24,000

This map was created by WIMAS on 1/31/2017 1:29:43 PM

1320 Research Park Drive
Manhattan, Kansas 66502
(785) 564-6700



900 SW Jackson, Room 456
Topeka, Kansas 66612
(785) 296-3556

Jackie McClaskey, Secretary

Governor Sam Brownback

February 1, 2017

BILL GIRARD
GIRARD PROPERTY LLC
3319 N PRAIRIE HILLS DR
HUTCHINSON KS 67502-8767

Re: Application File No. 49,594

Dear Sir or Madam:

This is to advise you that Robert Bacon has filed the application referred to above for a permit to appropriate 94.5 acre-feet of ground water per calendar year for irrigation use to be diverted at a maximum rate of 800 gallons per minute, from a battery of four wells with a geographic center located as follows:

one(1) battery of four (4) wells with a geographic center located near the center of the Northwest Quarter of Section 24, more particularly described as being near a point 4,000 feet North and 3,960 feet West of the Southeast corner of said section, in Township 23 South, Range 5 West, Reno County, Kansas.

A map is on the reverse of this letter for your information. Please note this is an existing well battery authorized by Appropriation of Water File No. 48,505. The applicant proposes to use this battery of wells in addition to the current owner. Records in this office indicate that you may have a well or wells in this vicinity and you are being notified of receipt of this application in order that you may be fully informed of the proposed location of the applicant's point of diversion and proposed use of water. Consideration will be given to comments or other information which you desire to submit to this office within 15 days from the date of this letter. If you have any questions about the referenced application, please contact me at 1-785-564-6635.

Sincerely,

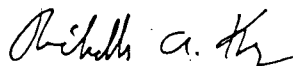
Richelle A. Krueger
Environmental Scientist

pc: Stafford Office
Groundwater Management District No. 2
Robert Bacon

SCANNED

Application, File No. 49,594

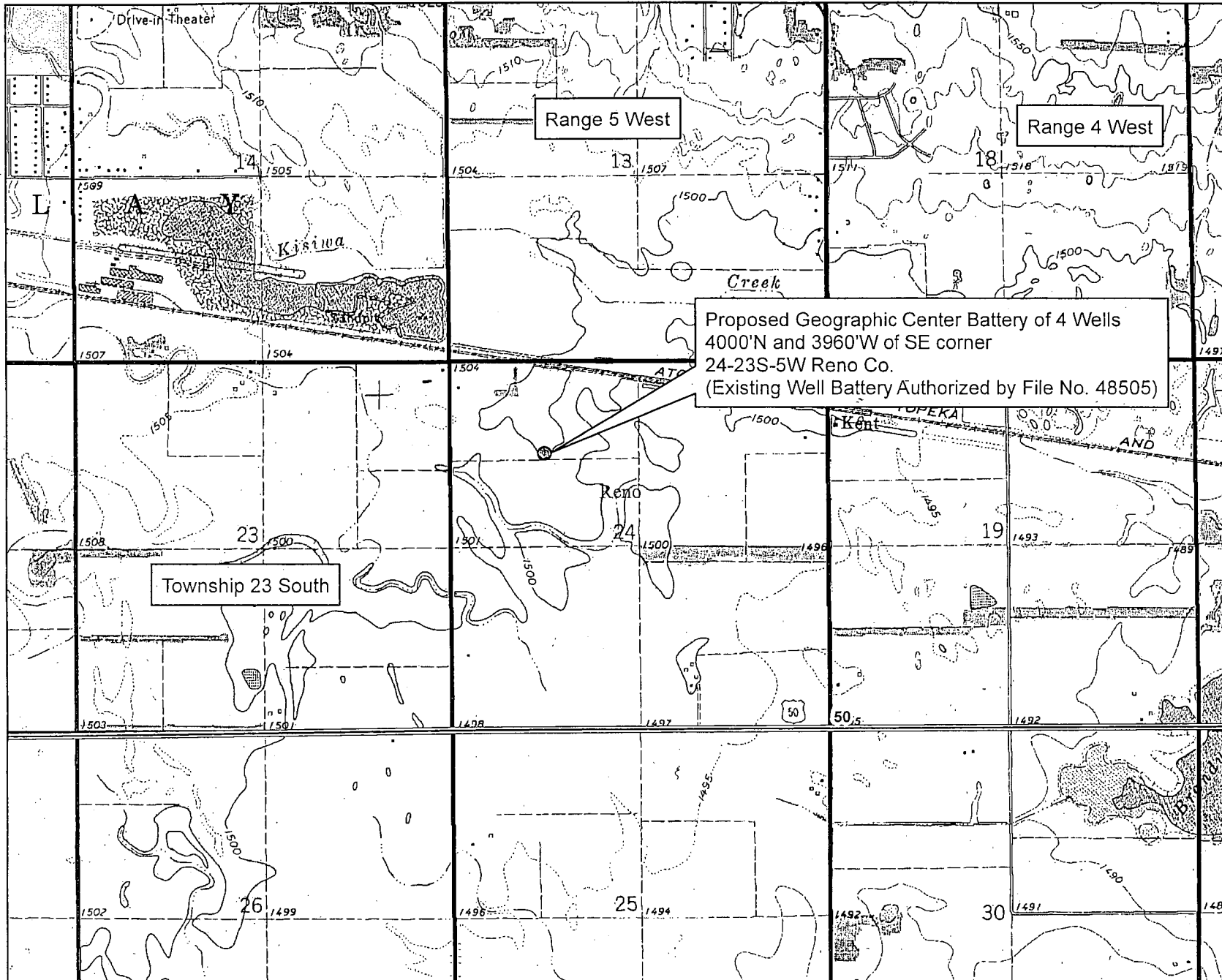

Proposed Geographic Center Battery of 4 Wells
4000'N and 3960'W of SE corner
24-23S-5W Reno Co.
(Existing Well Battery Authorized by File No. 48505)

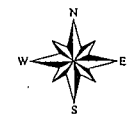
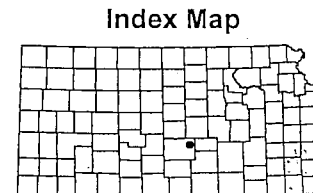

1:24,000

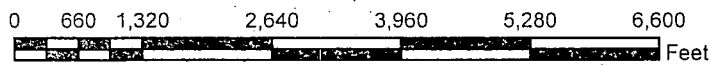

This map was created by WIMAS on 1/31/2017 1:29:43 PM

1320 Research Park Drive
Manhattan, Kansas 66502
(785) 564-6700



900 SW Jackson, Room 456
Topeka, Kansas 66612
(785) 296-3556

Jackie McClaskey, Secretary

Governor Sam Brownback

February 1, 2017

LAKESIDE ACRES HOMEOWNERS ASSOC INC
104 S OBEE RD
HUTCHINSON KS 67501-3437

Re: Application File No. 49,594

Dear Sir or Madam:

This is to advise you that Robert Bacon has filed the application referred to above for a permit to appropriate 94.5 acre-feet of ground water per calendar year for irrigation use to be diverted at a maximum rate of 800 gallons per minute, from a battery of four wells with a geographic center located as follows:

one(1) battery of four (4) wells with a geographic center located near the center of the Northwest Quarter of Section 24, more particularly described as being near a point 4,000 feet North and 3,960 feet West of the Southeast corner of said section, in Township 23 South, Range 5 West, Reno County, Kansas.

A map is on the reverse of this letter for your information. Please note this is an existing well battery authorized by Appropriation of Water File No. 48,505. The applicant proposes to use this battery of wells in addition to the current owner. Records in this office indicate that you may have a well or wells in this vicinity and you are being notified of receipt of this application in order that you may be fully informed of the proposed location of the applicant's point of diversion and proposed use of water. Consideration will be given to comments or other information which you desire to submit to this office within 15 days from the date of this letter. If you have any questions about the referenced application, please contact me at 1-785-564-6635.

Sincerely,

Richelle A. Krueger
Environmental Scientist

pc: Stafford Office
Groundwater Management District No. 2
Robert Bacon

SCANNED

Application, File No. 49,594

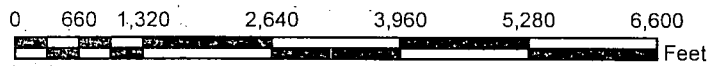
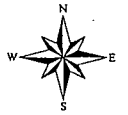
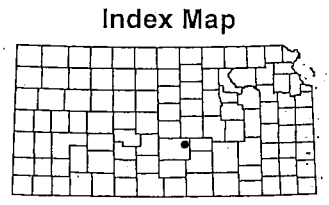
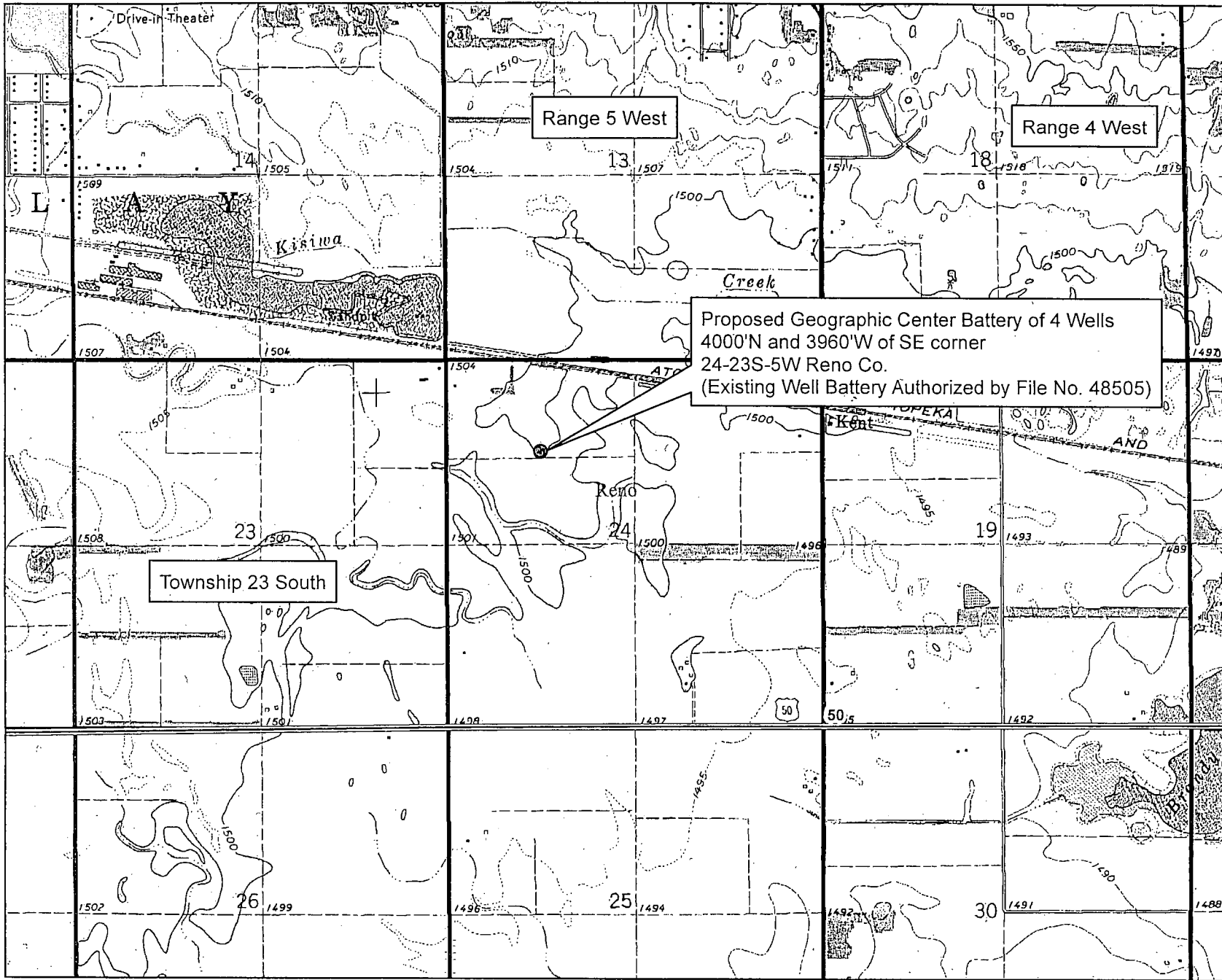

1:24,000

This map was created by WIMAS on 1/31/2017 1:29:43 PM

Krueger, Richelle

From: Turney, Brent
Sent: Tuesday, January 31, 2017 10:28 AM
To: Krueger, Richelle
Subject: FW: #49594 Application Approval Letters
Attachments: 49594 Application Approval Letter.pdf; 49594 Meter Installation Letter.pdf

Brent A. Turney, P.G.
Kansas Department of Agriculture
Division of Water Resources
1320 Research Park Drive
Manhattan Kansas 66502
(785) 564-6645
Brent.Turney@ks.gov
www.agriculture.ks.gov

From: Rebecca Wilson [mailto:rwilson@gmd2.org]
Sent: Tuesday, January 31, 2017 10:27 AM
To: Turney, Brent <Brent.Turney@ks.gov>
Cc: Engelbrecht, Jessica <Jessica.Engelbrecht@ks.gov>
Subject: #49594 Application Approval Letters

Good Morning!

Attached is an Application Approval Letter and a Meter Installation Letter from Manager Tim Boese for #49594.

Please let me know if you have any difficulty opening the attachments!

Thanks!

Rebecca Wilson

Rebecca Wilson
Administrative Assistant
Equus Beds GMD2
313 Spruce Street
Halstead, KS 67056
316-835-2224
316-835-2225 Fax
rwilson@gmd2.org
www.gmd2.org

WATER RESOURCES
RECEIVED

JAN 31 2017

KS DEPT. OF AGRICULTURE

1320 Research Park Drive
Manhattan, Kansas 66502
(785) 564-6700



900 SW Jackson, Room 456
Topeka, Kansas 66612
(785) 296-3556

Jackie McClaskey, Secretary

Governor Sam Brownback

December 21, 2016

GROUNDWATER MANAGEMENT DISTRICT NO 2
TIM BOESE
313 SPRUCE ST
HALSTEAD KS 67056-1925

FILE COPY

Re: Pending Application, File Nos. 49,587-49,594 (8 files)

Dear Mr. Boese:

In response to your correspondence by e-mail dated December 21, 2016, for an extension of time to review and submit revised recommendations regarding the referenced applications, the Chief Engineer has approved an extension of time of 30 days until **January 22, 2017**.

Please submit your recommendation within the allotted time, or any authorized extension of time thereof.

If you have any questions, please contact me at (785) 564-6640. If you wish to discuss a specific file, please have the file number ready so that I may help you more efficiently.

Sincerely,

A handwritten signature in cursive script that reads "Erin McGrogan".

Erin McGrogan
Environmental Scientist
Water Appropriation Program

pc: Stafford Field Office

1320 Research Park Drive
Manhattan, Kansas 66502
(785) 564-6700



900 SW Jackson, Room 456
Topeka, Kansas 66612
(785) 296-3556

Jackie McClaskey, Secretary

Governor Sam Brownback

FILE COPY

GROUNDWATER MANAGEMENT DISTRICT NO 2
TIM BOESE
313 SPRUCE ST
HALSTEAD KS 67056-1925

November 16, 2016

Re: Pending Application, File Nos. 49,587; 49,588;
49,589; 49,590; 49,591; 49,592; 49,593,49,594

Dear Mr. Boese:

We are enclosing a copy of the applications referred to above which appear to be in proper form. All information submitted by the applicant for well logs, nearby well owners, and water quality samples are included.

We are delaying any further action for a period of **30 days** from the date of this letter to allow you time to submit your recommendation concerning this application. Please submit your recommendation within the allotted time, or any authorized extension of time thereof.

If you have any questions, please contact me at (785) 564-6640. If you wish to discuss a specific file, please have the file number ready so that I may help you more efficiently.

Sincerely,

A handwritten signature in black ink that reads "Erin McGrogan".

Erin McGrogan
Environmental Scientist
Water Appropriation Program

Enclosure
pc: Stafford Field Office

SCANNED

1320 Research Park Drive
Manhattan, Kansas 66502
(785) 564-6700



900 SW Jackson, Room 456
Topeka, Kansas 66612
(785) 296-3556

Jackie McClaskey, Secretary

Governor Sam Brownback

October 25, 2016

FILE COPY

RESIDENT
705 SOUTH MAYFIELD ROAD
HUTCHINSON KS 67501

Re: Application File No. 49,594

Dear Sir or Madam:

This is to advise you that Robert Bacon has filed the application referred to above for a permit to appropriate 94.5 acre-feet of ground water per calendar year for irrigation use to be diverted at a maximum rate of 800 gallons per minute, from a battery of four wells with a geographic center located as follows:

A geographic center of a four well battery located near the center of the Northwest Quarter of Section 24, Township 23 South, Range 5 West, Reno County, Kansas.

Please note this is an existing well battery authorized by Appropriation of Water File No. 48,505. The applicant purposes to use this battery of wells in addition to the current owner. Records in this office indicate that you may have a well or wells in this vicinity and you are being notified of receipt of this application in order that you may be fully informed of the proposed location of the applicant's point of diversion and proposed use of water. Consideration will be given to comments or other information which you desire to submit to this office within 15 days from the date of this letter. If you have any questions about the referenced application, please contact me at 1-785-564-6640.

Sincerely,

A handwritten signature in cursive script that reads "Erin McGrogan".

Erin McGrogan
Environmental Scientist
Permits Unit

Enclosure: emc
pc: Stockton Field Office
Robert Bacon

SCANNED

Section 24 Township 23 South Range 5 West
(4,000 Feet North, 3,960 Feet West) Sec
Reno County, Kansas

Domestic Well

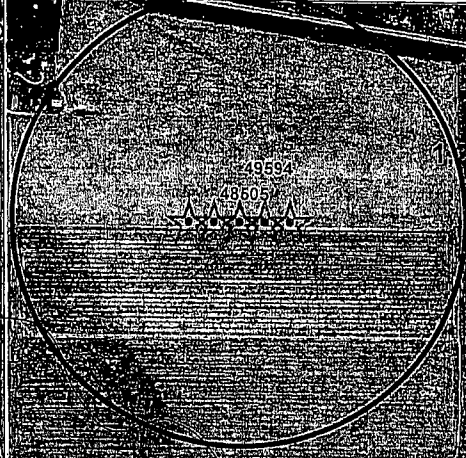

23S05W23

23S0

23S05W26

23S0

23S0

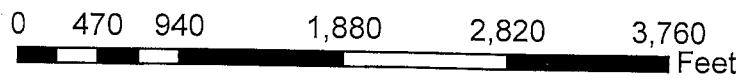



1320 Research Park Drive
Manhattan, Kansas 66502
(785) 564-6700

900 SW Jackson, Room 456
Topeka, Kansas 66612
(785) 296-3556

Jackie McClaskey, Secretary

Governor Sam Brownback

October 25, 2016

FILE COPY

RESIDENT
718 SOUTH MAYFIELD ROAD
HUTCHINSON KS 67501

Re: Application File No. 49,594

Dear Sir or Madam:

This is to advise you that Robert Bacon has filed the application referred to above for a permit to appropriate 94.5 acre-feet of ground water per calendar year for irrigation use to be diverted at a maximum rate of 800 gallons per minute, from a battery of four wells with a geographic center located as follows:

A geographic center of a four well battery located near the center of the Northwest Quarter of Section 24, Township 23 South, Range 5 West, Reno County, Kansas.

Please note this is an existing well battery authorized by Appropriation of Water File No. 48,505. The applicant purposes to use this battery of wells in addition to the current owner. Records in this office indicate that you may have a well or wells in this vicinity and you are being notified of receipt of this application in order that you may be fully informed of the proposed location of the applicant's point of diversion and proposed use of water. Consideration will be given to comments or other information which you desire to submit to this office within 15 days from the date of this letter. If you have any questions about the referenced application, please contact me at 1-785-564-6640.

Sincerely,

Erin McGrogan
Environmental Scientist
Permits Unit

Enclosure: emc
pc: Stockton Field Office
Robert Bacon

SCANNED

Section 24 Township 23 South Range 5 West
(4,000 Feet North, 3,960 Feet West) Gage
Reno County, Kansas

Domestic Well

23S05W23

23S0

23S05W26

23S0

23S0

0 470 940 1,880 2,820 3,760 Feet

10/8/2016 DWR

1320 Research Park Drive
Manhattan, Kansas 66502

Jackie McClaskey, Secretary



Phone: (785) 564-6700

Fax: (785) 564-6777

Email: ksag@kda.ks.gov

www.agriculture.ks.gov

Sam Brownback, Governor

March 25, 2016

ROBERT A BACON
3116 S MAYFIELD ROAD
HUTCHINSON KS 67501

RE: Application
File No. 49594

Dear Sir or Madam:

Your application for permit to appropriate water in 24-23S-5W in Reno County, was received and has been assigned the file number noted above.

As a matter of record, the Division of Water Resources has on hand a large number of applications awaiting processing. Therefore to be fair to all concerned, and so that we can process those applications on hand in the order they were received, we intend to concentrate on the backlog of applications until the issue is resolved. Once review of your application has begun, we will contact you, if additional information is required.

In accordance with the provisions of the Kansas Water Appropriation Act, a portion of which is included below, the use of water as proposed prior to approval of the application is unlawful. Once approved, compliance with the terms, conditions and limitations of the permit is necessary. Conservation of the water resources of Kansas is required.

Section 82a-728 of the Kansas Water Appropriation Act, provides (a) except for the appropriation of water for the purpose of domestic use, . . . it shall be unlawful for any person to appropriate or threaten to appropriate water from any source without first applying for and obtaining a permit to appropriate water in accordance with the provisions of the Water Appropriation Act or for any person to violate any condition of a vested right, appropriation right or an approved application for a permit to appropriate water for beneficial use.

(b) (1) The violation of any provision of this section by any person is a class C misdemeanor . . .

A class C misdemeanor is punishable by a fine not to exceed \$500 and/or a term of confinement not to exceed one month in the county jail. Each day that the violation occurs constitutes a separate offense.

If you have any questions, please contact me at (785) 564-6634. If you wish to discuss a specific file, please have the file number ready so that we may help you more efficiently.

Sincerely,

A handwritten signature in black ink, appearing to read "K. Kopp", is written over a faint, circular official stamp.

Kenneth A. Kopp, P.G.
New Application Unit Supervisor
Water Appropriation Program

SCANNED

KAK: DLW
pc: STAFFORDfield Office
GMD 2

New Application Map File No 49594

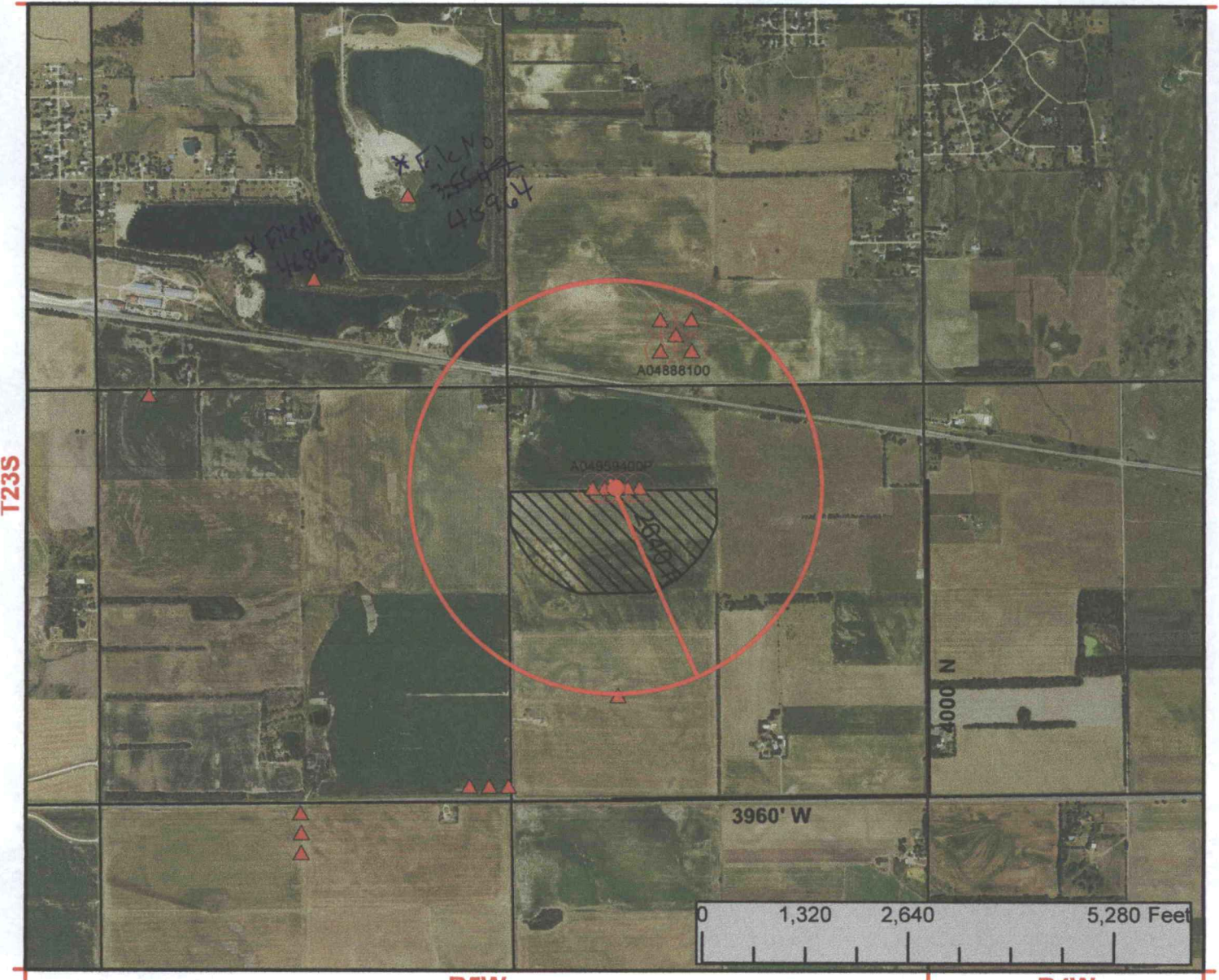

I declare that all water wells or diversion sites using the same source of supply and within 1/2 mile of the proposed point of diversion have been plotted on the application map.

Robert Abbaem
Signature

3-1-17
Date

- | | | |
|--|---------------------------------|--|
| <input checked="" type="checkbox"/> New Application | WATER RESOURCES RECEIVED | <input checked="" type="checkbox"/> Proposed Point of Diversion |
| <input type="checkbox"/> Application No. To Change: | MAR 15 2017 | <input checked="" type="checkbox"/> Existing Points of Diversion |
| <input type="checkbox"/> Point of Diversion | KS DEPT OF AGRICULTURE | <input checked="" type="checkbox"/> Proposed Place of Use |
| <input type="checkbox"/> Place of Use | | <input checked="" type="checkbox"/> Authorized Place of Use |
| <input type="checkbox"/> Use Made of Water | | |



** per Wiggins/WMS
* Noe/own 4/24/17*

See attached list for surrounding well owners **SCANNED**

FRED SEILER, PRESIDENT
VIN KISSICK, VICE PRESIDENT
JEFF WINTER, SECRETARY
MIKE MCGINN, TREASURER
TIM BOESE, MANAGER
THOMAS A. ADRIAN, ATTORNEY



DIRECTORS:
DAVID BOGNER
ALAN BURGHART
JOE PAJOR
BOB SEILER
DAVID STROBERG

EQUUS BEDS GROUNDWATER MANAGEMENT DISTRICT NO. 2

313 SPRUCE STREET • HALSTEAD, KANSAS 67056-1925 • PHONE (316) 835-2224 • FAX (316) 835-2225 • equusbeds@gmd2.org • www.gmd2.org

January 30, 2017

Chief Engineer, Division of Water Resources
Attn: Brent Turney
1320 Research Park Drive
Manhattan, Kansas 66502

Re: Appropriation Application No. 49594 – Robert Bacon

Dear Mr. Turney:

The Equus Beds Groundwater Management District No. 2 reviewed the referenced new application on January 30, 2017, using the District's Revised Management Program (effective May 1, 1995) and Rules and Regulations K.A.R. 5-22-1 through 5-22-17.

The application complies with the Revised Aquifer Management program approved by the Chief Engineer and with the District's Rules and Regulations K.A.R. 5-22-1 through 5-22-17. Therefore, the application is recommended for approval by the Equus Beds Groundwater Management District No. 2, subject to the maximum rate of diversion being further limited to 800 gallons per minute when combined with Water Permit No. 48505.

Additionally, the District's review found that it appears that not all of the owners of points of diversion within ½ mile of the proposed point of diversion were notified of the application, as the map submitted with the application did not appear to identify the irrigation well authorized by Water Permit No. 48881 and the groundwater pit authorized by Water Permit No. 46863. The District recommends that this issue is researched and resolved prior to the application being further processed.

A District decision may be appealed to the District Board of Directors by submitting a written petition to the District office within 30 days from date of this notification, pursuant to K.A.R. 5-22-12.

Please contact the District should you have any questions regarding the review or recommendation.

Sincerely,
EQUUS BEDS GROUNDWATER
MANAGEMENT DISTRICT NO. 2

Tim Boese
Manager
TDB/STF

Enclosure

pc: Robert A. Bacon, Applicant
William C. Ellis Family Trust, Landowner
Harold Swanson Trust, Point of Diversion Owner
Jeff Lanterman, Division of Water Resources, Stafford

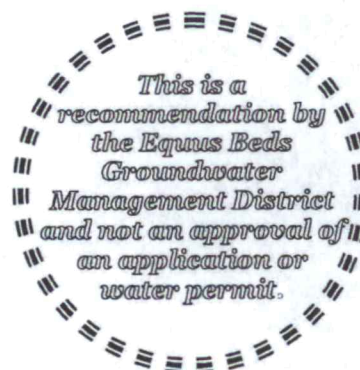

WATER RESOURCES
RECEIVED

FEB 06 2017

H:\MSOFFICE\LETTERS\APP\NewApp\Recommendation\Approve\#49594_Bacon.doc



KS DEPT OF AGRICULTURE

SCANNED

EQUUS BEDS GROUNDWATER MANAGEMENT DISTRICT NO. 2 FINAL APPLICATION REVIEW CHECKLIST

1) Application No. 49594 Date filed: March 23, 2016
 2) Applicant: Robert A Bacon County: Reno
 3) Proposed maximum quantity: 94.5 acre-feet/year Rate: 800 LTD GPM
 4) Proposed Use: Irrigation
 5) P/D location: NCNW 24-23S-5W Geo Center: North 4000 ft, West 3960 ft
 6) Number and type of points of diversion listed on the application 4 Well Battery

7) Meter required K.A.R. 5-22-4a or K.A.R. 5-22-8? Yes No, Why _____

8) Meets Safe Yield K.A.R. 5-22-7? Yes No N/A

(a) Total allowable appropriations: 4021.00 af/yr
 (b) Total existing appropriations: 3761.00 af/yr
 (c) Total small user exemptions: 4.00 af/yr
 (d) Total non-consumptive use: 0.00 af/yr
 (e) Total consumptive use: 3761.00 af/yr
 (Total existing appropriations) - (Total non-consumptive use)
 (f) exempt from regulation? Yes No,
 Cite exemption: _____

9) Meets Well Spacing K.A.R. 5-22-2? Yes No N/A

(a) POD in enhanced well spacing area? Yes No
 (b) Domestic well spacing interval: >960 ft
 (c) Non-Domestic well spacing interval: >1620 ft

10) Meets Max Reasonable Quantity K.A.R. 5-22-14? Yes No N/A

(a) Irrigation max quantity: 1.4 acre-feet / acre
 application paragraph 3 value (acre-feet) / proposed acres = Q
 (b) Stockwater max quantity: _____ GPD _____ unit
 (c) Industry max quantity: _____ Acre _____ unit
 Industry standard: _____
 (d) Municipal max quantity: _____ GCD
 Lesser of either 200 GCD or
 $1.10 * (X - Y) * 365 d * (z + t)$
 X - Average of last three years usage in Gallons per Capita per Day (GCD)
 Y - water usage for industries that use over 200,000 gal/yr (GCD)
 Z - Projected population in 20 years
 T - Reasonable projected water use for industries that use over 200,000 gallons per year (GCD)
 (e) Pond max quantity is _____
 (Net evap + seepage)/12 x pond area + any initial fill
 (f) Groundwater pit max Q: _____
 Net evap * pit area/12

11) Reasonable rate for intended use? Yes No N/A

12) Depth to water: ~7 ft bls at observation well: EB250

13) Date reviewed: December 23, 2016

14) Reviewed by: S. Flaherty

Title: Hydrogeologist

Renewed 1-30-17

15) District recommendation:

Approve Deny

Other, see comment

16) Comments and Calculations:

Item #10a. $94.5 \text{ AF} / 67.5 \text{ acres} = 1.4 \text{ AF/acre}$

No Overlapping Place of Use

Overlapping Point of Diversion with #48505. Applicant signed sworn statement that he had access to PD

Does not appear that Surrounding Well Owner Notification was sent to Jaris Regier (Water Permit#48881), as irrigation well was not identified on app. map.

Additionally, notification not sent to Lakeside Acres HOA for groundwater pit authorized by Water Permit No. 46863

No Nearby Well Owner Inquiries

Rate limited to 800 GPM when combined with #48505

Owner of PD - Harold Swanson Trust

No Quantity Limitations

No Special Use Areas or IGUCAs

**WATER RESOURCES
RECEIVED**

FEB 06 2017

H:\MSOFFICE\LETTERS\APP\NewApp\Checklist\#49594_Bacon.docx

KS DEPT OF AGRICULTURE

SCANNED

Equus Beds Groundwater Management District No. 2

Safe Yield Evaluation #49594

SWNENW (4000'N & 3960'W) 24-23S-05W, Reno County

Prepared By: Stephen Flaherty Date: 12/21/2016

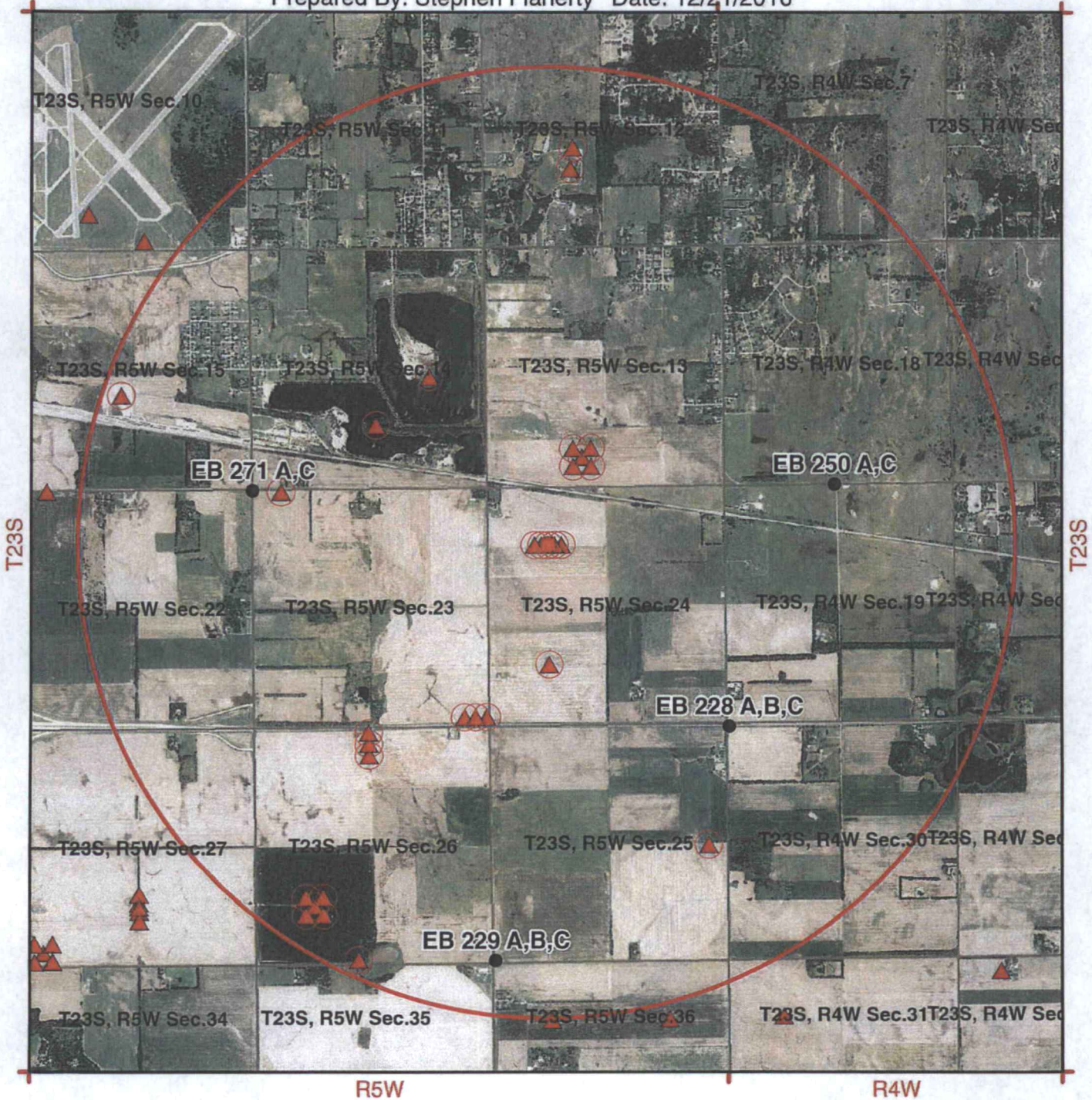

Map Legend

- Observation Well
 - Bedrock
 - ▨ Authorized Place of Use
 - ▩ Proposed Place of Use
 - Proposed Point of Diversion
 - ▲ Authorized Location
- Burrton IGUCA
 Hollow Nikkel SWQUA
 McPherson IGUCA
 Enhanced Well Spacing Area

0 1,320 2,640 5,280 Feet



Equus Beds Groundwater Management District No. 2
 313 Spruce Street, Halstead, KS 67056
 316-835-2224, equusbeds@gmd2.org

WATER RESOURCES RECEIVED

FEB 06 2017

SCANNED

KS DEPT OF AGRICULTURE

SAFEYIELD EVALUATION #49594

LOCATION: SWNENW (4000'N & 3960'W) 24-23S-05W, Reno County

SPECIAL USE AREA: None

EVALUATION DATE:- 12/21/2016

Total Areas: 8,042 acres; Area in 3 inch discharge zone: 0 acres; Area in 6 inch discharge zone: 8,042 acres

FILE_ID	WELL_ID	TOWNSHIP	RANGE	SECTION	QUALIFIER	USE	AUTHQUANTITY
A04004900	1729	23S	05W	12	21843317	IND	50
A04005200	13	23S	05W	12	17163383	IND	32.6
A04096400	1788	23S	05W	14	28551241	REC	275
A04523900	3007	23S	05W	26	46802700	IRR	0
A04523900	2979	23S	05W	26	49302700	IRR	215.6
A04523900	3006	23S	05W	26	51802700	IRR	0
A04601900	3204	23S	05W	25	26000400	IRR	190.4
A04657600	3398	23S	05W	23	1940037	IRR	0
A04657600	3399	23S	05W	23	1980533	IRR	0
A04657600	3395	23S	05W	23	1960285	IRR	147
A04686300	3466	23S	05W	14	14002450	REC	172.9
A04734400	3604	23S	05W	23	52404605	MUN	1935
A04758800	3688	23S	05W	26	13203960	IRR	182
A04758800	3689	23S	05W	26	15204160	IRR	0
A04758800	3690	23S	05W	26	15203760	IRR	0
A04758800	3691	23S	05W	26	11204160	IRR	0
A04758800	3692	23S	05W	26	11203760	IRR	0
A04850500	4129	23S	05W	24	40003960	IRR	94.5
A04850500	4130	23S	05W	24	40003660	IRR	0
A04850500	4131	23S	05W	24	40003810	IRR	0
A04850500	4132	23S	05W	24	40004110	IRR	0
A04850500	4133	23S	05W	24	40004260	IRR	0
A04888100	4241	23S	05W	13	6603164	IRR	273
A04888100	4242	23S	05W	13	8603364	IRR	0
A04888100	4243	23S	05W	13	8602964	IRR	0
A04888100	4244	23S	05W	13	4603364	IRR	0
A04888100	4266	23S	05W	13	4602964	IRR	0
A04959100P	4908	23S	05W	24	13403960	IRR	94.5
A04959400P	4920	23S	05W	24	40003960	IRR	94.5
A04959400P	4921	23S	05W	24	40003660	IRR	0
A04959400P	4922	23S	05W	24	40003810	IRR	0
A04959400P	4923	23S	05W	24	40004110	IRR	0
A04959400P	4924	23S	05W	24	40004260	IRR	0
A04960200P	4894	23S	05W	26	1112981	IRR	0
A20129466	4054	23S	05W	23	52404605	REM	0
A20139057	4144	23S	05W	15	21002900	IND	4

Allowable Appropriations	4,021.00	Total Existing Appropriation	3,761.00
Small User Quantity	4	Non Consumptive Appropriations	0
Remaining SUQ	41	Consumptive Appropriations	3,761.00
Note- Values are in acre-feet		Available Appropriations	260.00

WATER RESOURCES RECEIVED

FEB 06 2017

SCANNED KS DEPT OF AGRICULTURE

Equus Beds Groundwater Management District No. 2

Spacing Evaluation #49594

SWNENW (4000'N & 3960'W) 24-23S-05W, Reno County

Prepared By: Stephen Flaherty Date: 12/21/2016

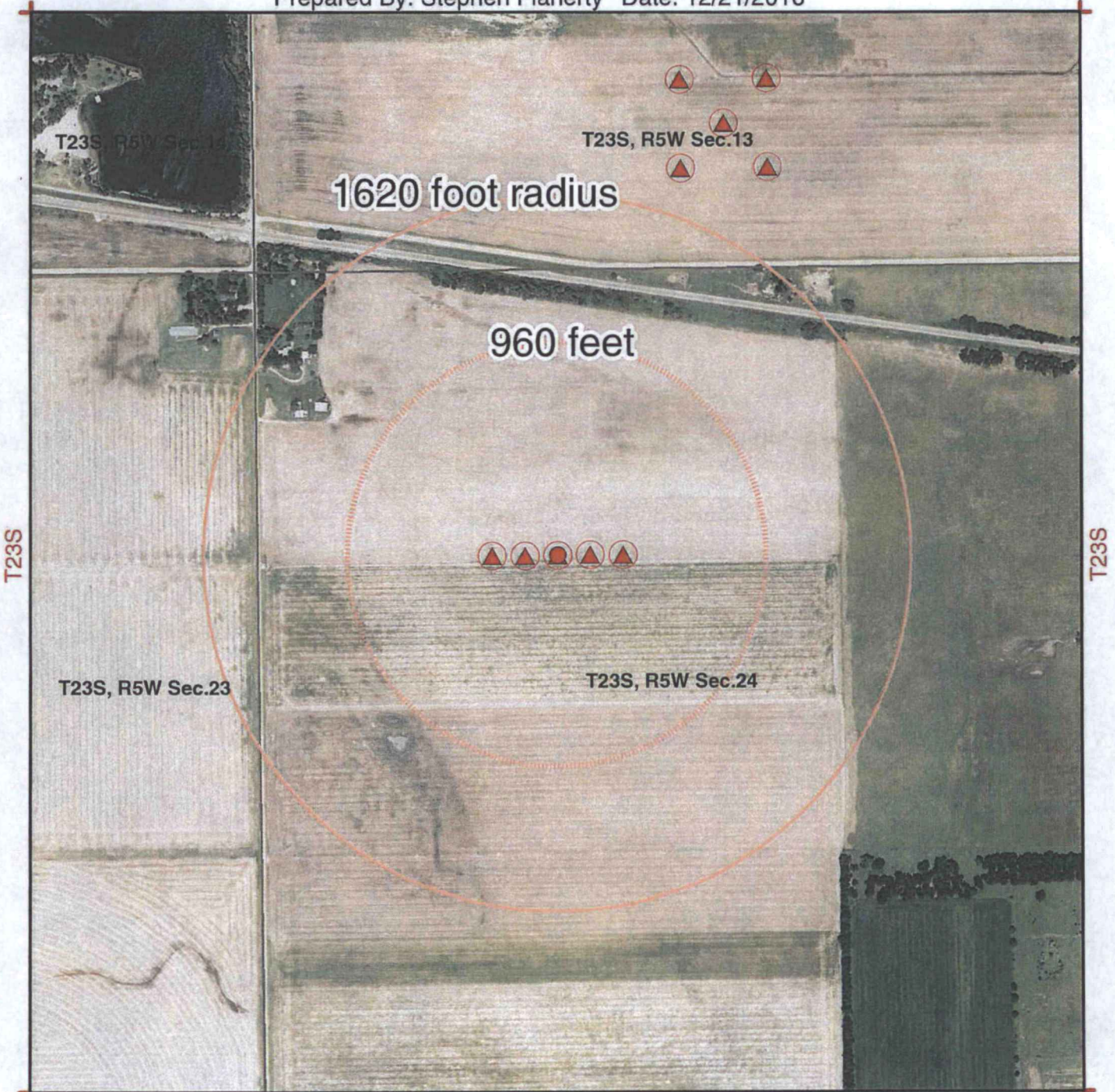

R5W

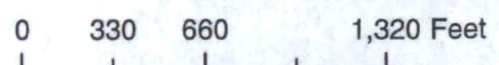

Map Legend

- Observation Well
- Bedrock
- ▨ Authorized Place of Use
- ▧ Proposed Place of Use

- Proposed Point of Diversion
- ▲ Authorized Location

- Burrton IGUCA
- Hollow Nikkel SWQUA
- McPherson IGUCA
- Enhanced Well Spacing Area

Equus Beds Groundwater Management District No. 2
313 Spruce Street, Halstead, KS 67056
316-835-2224, equusbeds@gmd2.org

WATER RESOURCES RECEIVED

2017

SCANNED

KS DEPT OF AGRICULTURE

Equus Beds Groundwater Management District No. 2

Estimated Place of Use for Application #49594

PD: NCNW (4000'N & 3960'W) 24-23S-05W, Reno County

Prepared By: Stephen Flaherty Date: 1/30/2017



R5W

R4W

0 330 660 1,320 Feet

Map Legend

- Observation Well
- Bedrock
- Authorized Place of Use
- Proposed Place of Use
- Proposed Point of Diversion
- Authorized Location
- Burrton IGUCA
- Hollow Nikkel SWQUA
- McPherson IGUCA
- Enhanced Well Spacing Area
- Application Suspension Area

Equus Beds Groundwater Management District No. 2
313 Spruce Street, Halstead, KS 67056
316-835-2224, equusbeds@gmd2.org

WATER RESOURCES RECEIVED

FEB 06 2017

SCANNED

KS DEPT OF AGRICULTURE

FRED SEILER, PRESIDENT
VIN KISSICK, VICE PRESIDENT
JEFF WINTER, SECRETARY
MIKE MCGINN, TREASURER
TIM BOESE, MANAGER
THOMAS A. ADRIAN, ATTORNEY



DIRECTORS:
DAVID BOGNER
ALAN BURGHART
JOE PAJOR
BOB SEILER
DAVID STROBERG

EQUUS BEDS GROUNDWATER MANAGEMENT DISTRICT NO. 2

313 SPRUCE STREET • HALSTEAD, KANSAS 67056-1925 • PHONE (316) 835-2224 • FAX (316) 835-2225 • equusbeds@gmd2.org • www.gmd2.org

January 30, 2017

Robert A. Bacon
3616 S. Mayfield Rd.
Hutchinson, KS 67501

Re: Appropriation Application No. 49594

Dear Mr. Bacon:

The Equus Beds Groundwater Management District No. 2 made a recommendation to the Division of Water Resources that Appropriation Application No. 49594 be approved. Pursuant to K.A.R. 5-22-4a, the well battery described in the application must be equipped with a District approved water flowmeter. The well battery geocenter is located Near the Center of the Northwest Quarter of Section 24, Township 23 South, Range 5 West, Reno County.

The battery must be properly equipped with an approved meter within 30 days after the approved battery is operational and prior to its operation. If more time is needed to install the meter or modify an existing meter installation, you may request an extension of time. The request must be made to the District before the end of the 30-day period.

Enclosed is a Flow Meter Installation form to be completed and returned to this office after completion of the meter installation or modifications. A copy of the Division of Water Resources' meter installation notification form (Notice and Proof of Completion of Works) may be substituted for the District form. Upon receiving the completed form, the District will inspect the installation.

Also enclosed is a copy of water meter and installation specifications. The water meter must meet these specifications and the list of certified water meters provided under K.A.R. 5-1-12, for District approval. The list of certified water meters can be obtained by contacting the District or at following link: <http://agriculture.ks.gov/divisions-programs/dwr/water-appropriation/water-flowmeters>. If you have any questions about the District's metering program or the enclosed material, please contact the District for assistance.

Sincerely,
EQUUS BEDS GROUNDWATER
MANAGEMENT DISTRICT NO. 2

Tim Boese
Manager
TDB/STF

Enclosures

Pc: William C. Ellis Family Trust, Landowner
Harold Swanson Trust, Point of Diversion Owner
Jeff Lanterman, Division of Water Resources, Stafford

WATER RESOURCES
RECEIVED

JAN 31 2017

KS DEPT OF AGRICULTURE

HEMSOFFICE\FITTERS\METER\New.Application#49594_Bacon.docx



SCANNED

Equus Beds Groundwater Management District No. 2

Spacing Evaluation #49594

SWNENW (4000'N & 3960'W) 24-23S-05W, Reno County

Prepared By: Stephen Flaherty Date: 12/21/2016

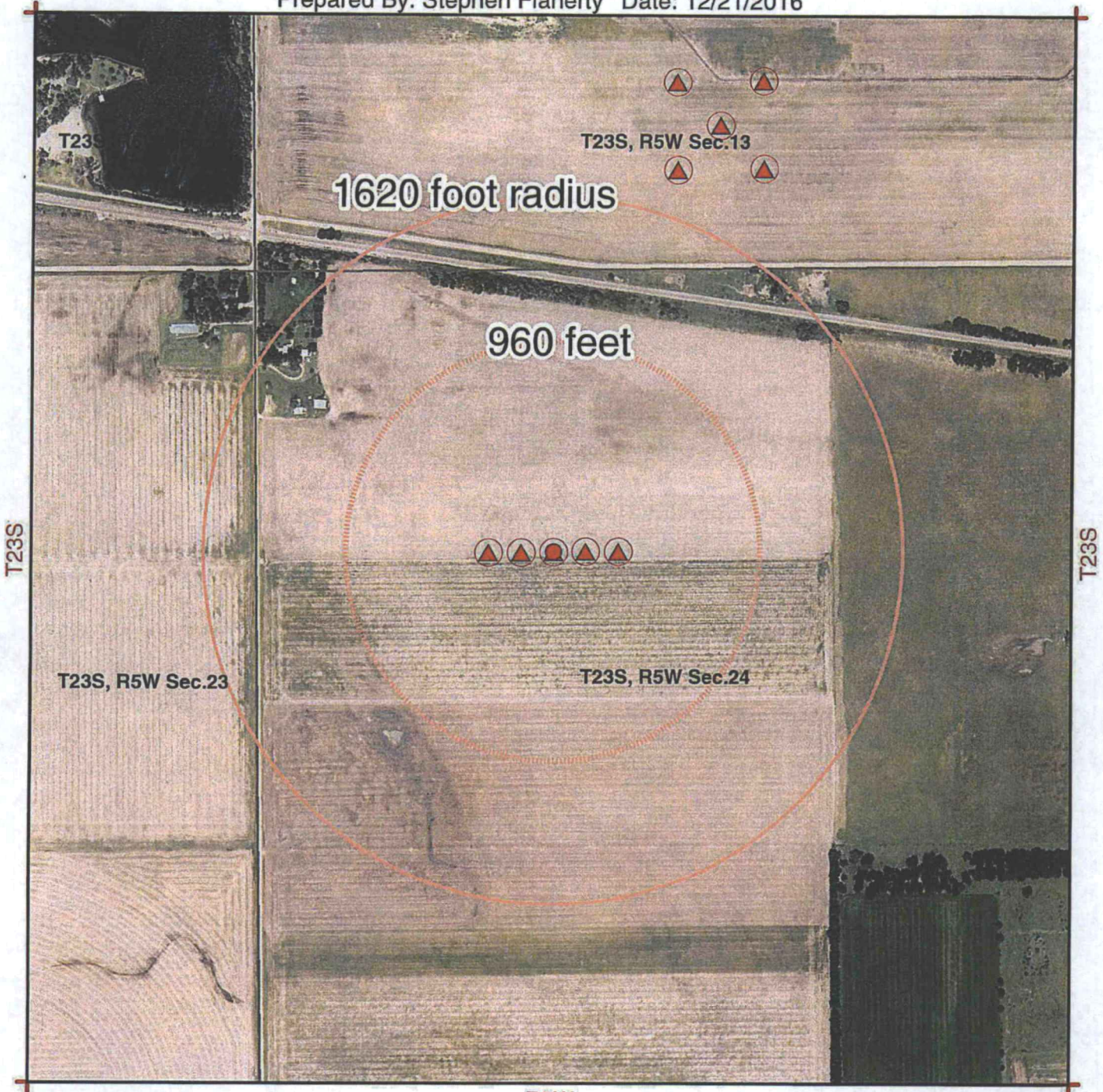

R5W

0 330 660 1,320 Feet

Map Legend

- Observation Well
- Bedrock
- ▨ Authorized Place of Use
- ▨ Proposed Place of Use

- Proposed Point of Diversion
- ▲ Authorized Location

- Burton IGUCA
- Hollow Nikkel SWQUA
- McPherson IGUCA
- Enhanced Well Spacing Area



JAN 31 2017



Equus Beds Groundwater Management District No. 2
313 Spruce Street, Halstead, KS 67056
316-635-2224, equusbeds@gmd2.org

Equus Beds Groundwater Management District No. 2

Estimated Place of Use for Application #49594

PD: NCNW (4000'N & 3960'W) 24-23S-05W, Reno County

Prepared By: Stephen Flaherty Date: 1/30/2017

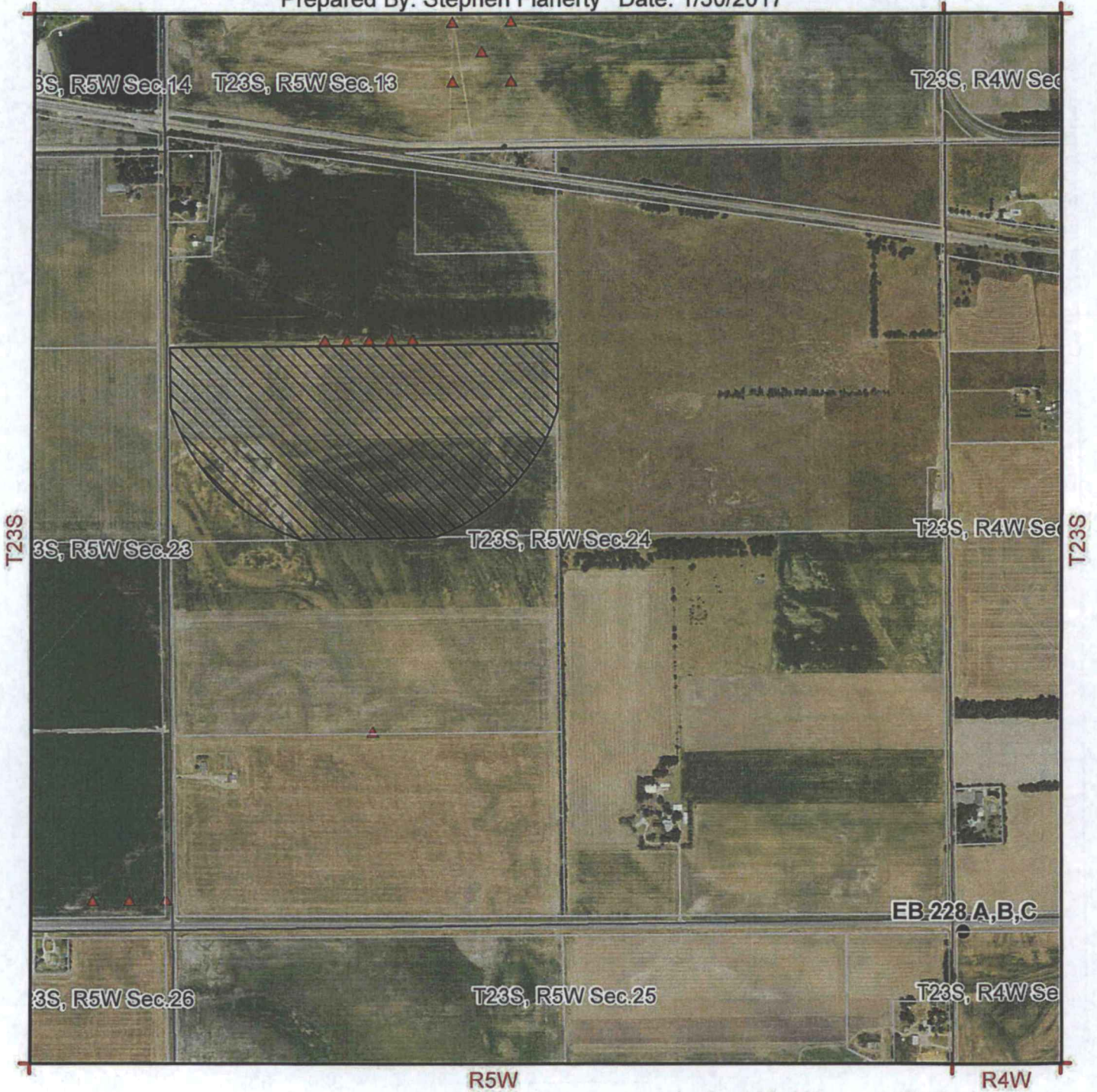

Map Legend

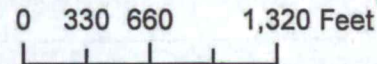

- | | | | |
|---------------------------|-------------------------------|-----------------------------|--|
| ● Observation Well | ● Proposed Point of Diversion | Burton IGUCA | |
| ■ Bedrock | ▲ Authorized Location | Hollow Nikkel SWQUA | |
| ▨ Authorized Place of Use | | McPherson IGUCA | |
| ▨ Proposed Place of Use | | Enhanced Well Spacing Area | |
| | | Application Suspension Area | |

Equus Beds Groundwater Management District No. 2
 313 Spruce Street, Halstead, KS 67056
 318-835-2224, equusbeds@gmd2.org

JAN 31 2017

Equus Beds Groundwater Management District No. 2

Safe Yield Evaluation #49594

SWNENW (4000'N & 3960'W) 24-23S-05W, Reno County

Prepared By: Stephen Flaherty Date: 12/21/2016

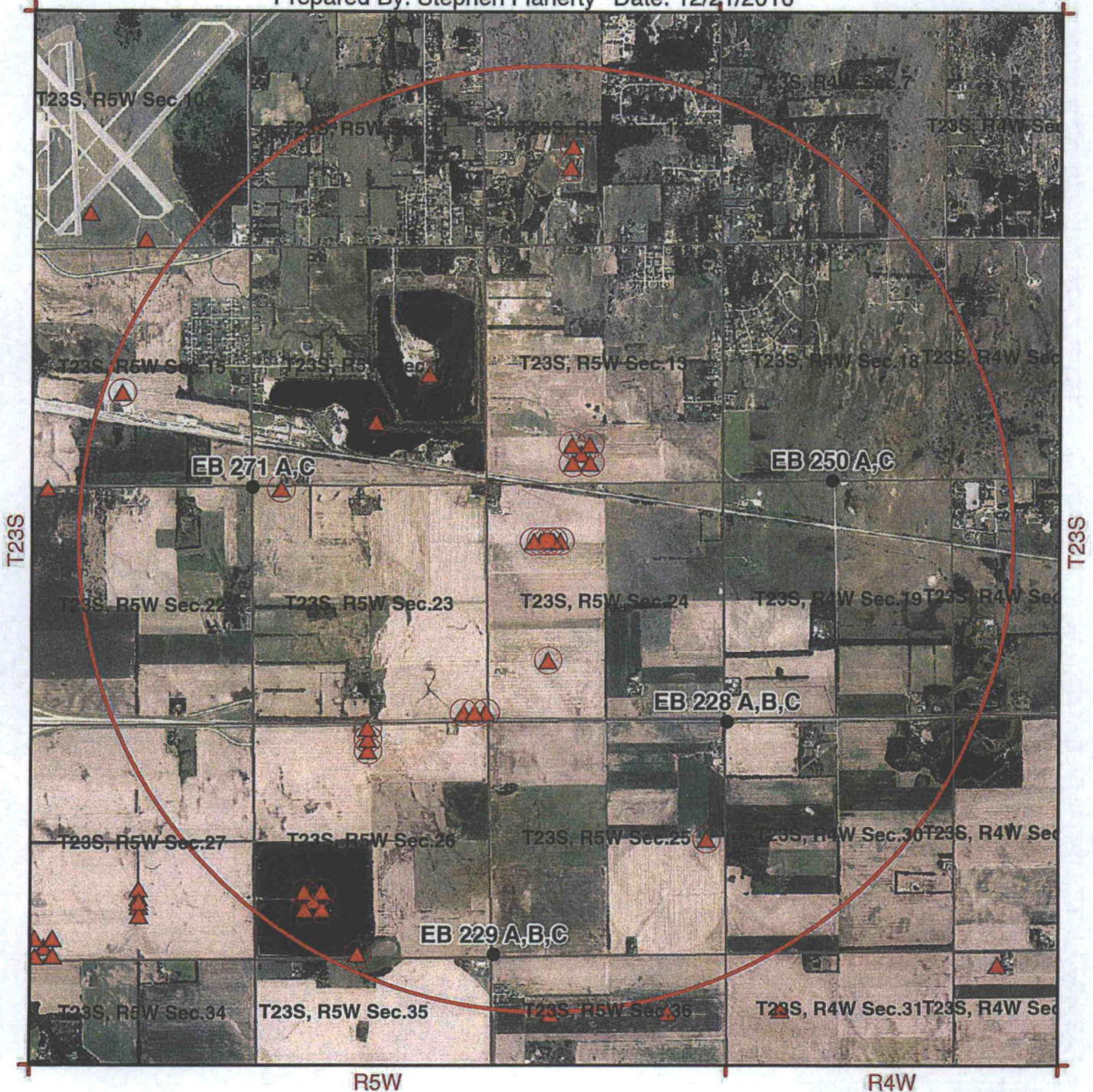

Map Legend

● Observation Well	● Proposed Point of Diversion	Burrton IGUCA	
■ Bedrock	▲ Authorized Location	Hollow Nickel SWQUA	
Authorized Place of Use	Proposed Place of Use	McPherson IGUCA	
		Enhanced Well Spacing Area	

0 1,320 2,640 5,280 Feet

JAN 31 2017

Equus Beds Groundwater Management District No. 2
313 Spruce Street, Halstead, KS 67056
316-835-2224, equusbeds@gmd2.org

SAFEYIELD EVALUATION #49594

LOCATION: SWNENW (4000'N & 3960'W) 24-23S-05W, Reno County

SPECIAL USE AREA: None

EVALUATION DATE:- 12/21/2016

Total Areas: 8,042 acres; Area in 3 inch discharge zone: 0 acres; Area in 6 inch discharge zone: 8,042 acres

FILE_ID	WELL_ID	TOWNSHIP	RANGE	SECTION	QUALIFIER	USE	AUTHQUANTITY
A04004900	1729	23S	05W	12	21843317	IND	50
A04005200	13	23S	05W	12	17163383	IND	32.6
A04096400	1788	23S	05W	14	28551241	REC	275
A04523900	3007	23S	05W	26	46802700	IRR	0
A04523900	2979	23S	05W	26	49302700	IRR	215.6
A04523900	3006	23S	05W	26	51802700	IRR	0
A04601900	3204	23S	05W	25	26000400	IRR	190.4
A04657600	3398	23S	05W	23	1940037	IRR	0
A04657600	3399	23S	05W	23	1980533	IRR	0
A04657600	3395	23S	05W	23	1960285	IRR	147
A04686300	3466	23S	05W	14	14002450	REC	172.9
A04734400	3604	23S	05W	23	52404605	MUN	1935
A04758800	3688	23S	05W	26	13203960	IRR	182
A04758800	3689	23S	05W	26	15204160	IRR	0
A04758800	3690	23S	05W	26	15203760	IRR	0
A04758800	3691	23S	05W	26	11204160	IRR	0
A04758800	3692	23S	05W	26	11203760	IRR	0
A04850500	4129	23S	05W	24	40003960	IRR	94.5
A04850500	4130	23S	05W	24	40003660	IRR	0
A04850500	4131	23S	05W	24	40003810	IRR	0
A04850500	4132	23S	05W	24	40004110	IRR	0
A04850500	4133	23S	05W	24	40004260	IRR	0
A04888100	4241	23S	05W	13	6603164	IRR	273
A04888100	4242	23S	05W	13	8603364	IRR	0
A04888100	4243	23S	05W	13	8602964	IRR	0
A04888100	4244	23S	05W	13	4603364	IRR	0
A04888100	4266	23S	05W	13	4602964	IRR	0
A04959100P	4908	23S	05W	24	13403960	IRR	94.5
A04959400P	4920	23S	05W	24	40003960	IRR	94.5
A04959400P	4921	23S	05W	24	40003660	IRR	0
A04959400P	4922	23S	05W	24	40003810	IRR	0
A04959400P	4923	23S	05W	24	40004110	IRR	0
A04959400P	4924	23S	05W	24	40004260	IRR	0
A04960200P	4894	23S	05W	26	1112981	IRR	0
A20129466	4054	23S	05W	23	52404605	REM	0
A20139057	4144	23S	05W	15	21002900	IND	4
Allowable Appropriations	4,021.00		Total Existing Appropriation				3,761.00
Small User Quantity	4		Non Consumptive Appropriations				0
Remaining SUQ	41		Consumptive Appropriations				3,761.00
Note- Values are in acre-feet	Available Appropriations				260.00		

WATER RESOURCES RECEIVED

JAN 31 2017

STOS I & WAL

KS DEPT OF AGRICULTURE

KS DEPT OF AGRICULTURE

FRED SEILER, PRESIDENT
VIN KISSICK, VICE PRESIDENT
JEFF WINTER, SECRETARY
MIKE MCGINN, TREASURER
TIM BOESE, MANAGER
THOMAS A. ADRIAN, ATTORNEY



DIRECTORS:
DAVID BOGNER
ALAN BURGHART
JOE PAJOR
BOB SEILER
DAVID STROBERG

EQUUS BEDS GROUNDWATER MANAGEMENT DISTRICT NO. 2

313 SPRUCE STREET • HALSTEAD, KANSAS 67056-1925 • PHONE (316) 835-2224 • FAX (316) 835-2225 • equusbeds@gmd2.org • www.gmd2.org

January 30, 2017

Chief Engineer, Division of Water Resources
Attn: Brent Turney
1320 Research Park Drive
Manhattan, Kansas 66502

Re: Appropriation Application No. 49594 – Robert Bacon

Dear Mr. Turney:

The Equus Beds Groundwater Management District No. 2 reviewed the referenced new application on January 30, 2017, using the District's Revised Management Program (effective May 1, 1995) and Rules and Regulations K.A.R. 5-22-1 through 5-22-17.

The application complies with the Revised Aquifer Management program approved by the Chief Engineer and with the District's Rules and Regulations K.A.R. 5-22-1 through 5-22-17. Therefore, the application is recommended for approval by the Equus Beds Groundwater Management District No. 2, subject to the maximum rate of diversion being further limited to 800 gallons per minute when combined with Water Permit No. 48505.

Additionally, the District's review found that it appears that not all of the owners of points of diversion within ½ mile of the proposed point of diversion were notified of the application, as the map submitted with the application did not appear to identify the irrigation well authorized by Water Permit No. 48881 and the groundwater pit authorized by Water Permit No. 46863. The District recommends that this issue is researched and resolved prior to the application being further processed.

A District decision may be appealed to the District Board of Directors by submitting a written petition to the District office within 30 days from date of this notification, pursuant to K.A.R. 5-22-12.

Please contact the District should you have any questions regarding the review or recommendation.

Sincerely,
EQUUS BEDS GROUNDWATER
MANAGEMENT DISTRICT NO. 2

Tim Boese
Manager
TDB/STF

Enclosure

pc: Robert A. Bacon, Applicant
William C. Ellis Family Trust, Landowner
Harold Swanson Trust, Point of Diversion Owner
Jeff Lanterman, Division of Water Resources, Stafford

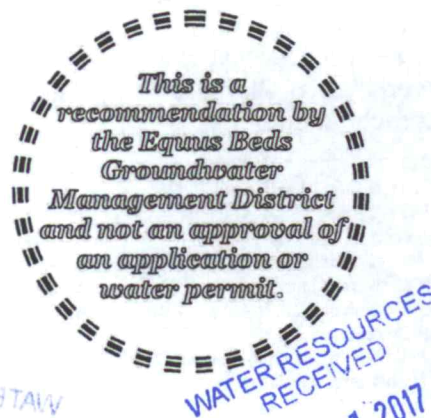

H:\MSOFFICE\LETTERS\APP\NewApp\Recommendation\Approve\#49594_Bacon.docx



KS DEPT OF AGRICULTURE

SCANNED

EQUUS BEDS GROUNDWATER MANAGEMENT DISTRICT NO. 2 FINAL APPLICATION REVIEW CHECKLIST

1) Application No. 49594 Date filed: March 23, 2016
 2) Applicant: Robert A Bacon County: Reno
 3) Proposed maximum quantity: 94.5 acre-feet/year Rate: 800 LTD GPM
 4) Proposed Use: Irrigation
 5) P/D location: NCNW 24-23S-5W Geo Center: North 4000 ft, West 3960 ft
 6) Number and type of points of diversion listed on the application 4 Well Battery

7) Meter required K.A.R. 5-22-4a or K.A.R. 5-22-8? Yes No, Why _____

8) Meets Safe Yield K.A.R. 5-22-7? Yes No N/A

(a) Total allowable appropriations: 4021.00 af/yr
 (b) Total existing appropriations: 3761.00 af/yr
 (c) Total small user exemptions: 4.00 af/yr
 (d) Total non-consumptive use: 0.00 af/yr
 (e) Total consumptive use: 3761.00 af/yr
 (Total existing appropriations) - (Total non-consumptive use)
 (f) exempt from regulation? Yes No,
 Cite exemption: _____

9) Meets Well Spacing K.A.R. 5-22-2? Yes No N/A

(a) POD in enhanced well spacing area? Yes No
 (b) Domestic well spacing interval: >960 ft
 (c) Non-Domestic well spacing interval: >1620 ft

10) Meets Max Reasonable Quantity K.A.R. 5-22-14? Yes No N/A

(a) Irrigation max quantity: 1.4 acre-feet / acre
 application paragraph 3 value (acre-feet) / proposed acres = Q
 (b) Stockwater max quantity: _____ GPD _____ unit
 (c) Industry max quantity: _____ Acre
 Industry standard: _____
 (d) Municipal max quantity: _____ GCD
 Lesser of either 200 GCD or
 $1.10 * (X - Y) * 365 d * (z + t)$
 X - Average of last three years usage in Gallons per Capita per Day (GCD)
 Y - water usage for industries that use over 200,000 gal/yr (GCD)
 Z - Projected population in 20 years
 T - Reasonable projected water use for industries that use over 200,000 gallons per year (GCD)
 (e) Pond max quantity is
 (Net evap + seepage)/12 x pond area + any initial fill
 (f) Groundwater pit max Q: _____
 Net evap * pit area/12

11) Reasonable rate for intended use? Yes No N/A

12) Depth to water: ~7 ft bls at observation well: EB250

13) Date reviewed: December 23, 2016

14) Reviewed by: S. Flaherty Title: Hydrogeologist

Revised 1-30-17

15) District recommendation: Approve Deny Other, see comment

16) Comments and Calculations:

Item #10a. 94.5AF/67.5 acres = 1.4 AF/acre
 No Overlapping Place of Use
 Overlapping Point of Diversion with #48505. Applicant signed sworn statement that he had access to PD
 Does not appear that Surrounding Well Owner Notification was sent to Jaris Regier (Water Permit#48881), as irrigation well was not identified on app. map.
 Additionally, notification not sent to Lakeside Acres HOA for groundwater pit authorized by Water Permit No. 46863
 No Nearby Well Owner Inquiries
 Rate limited to 800 GPM when combined with #48505
 Owner of PD - Harold Swanson Trust
 No Quantity Limitations
 No Special Use Areas or IGUCAs

**WATER RESOURCES
RECEIVED
JAN 31 2017
KS DEPT OF AGRICULTURE**

File No. 49,594 Robert Bacon
Section 24 Township 23 South Range 5 West
(4,000 Feet North, 3,960 Feet West) Geo
Reno County, Kansas

Domestic Well

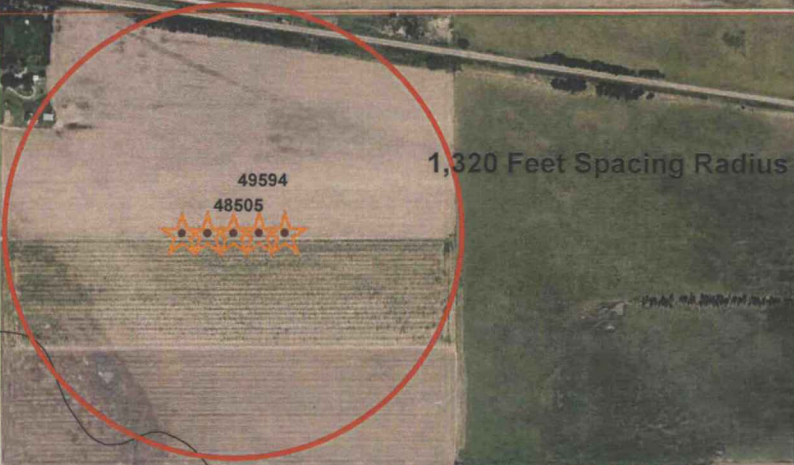

23S05W23

23S05W24

23S04W18

23S05W26

23S05W25

23S05W30

