

THE STATE  OF KANSAS

KANSAS DEPARTMENT OF AGRICULTURE
Dale A. Rodman, Secretary of Agriculture

DIVISION OF WATER RESOURCES
David W. Barfield, Chief Engineer

File Number 49,728
This item to be completed by the Division of Water Resources.

WATER RESOURCES RECEIVED
UNACCEPTABLE FOR PRIORITY
NOV 08 2016
11:55
KS DEPT OF AGRICULTURE

WATER RESOURCES RECEIVED
NOV 10 2016
2:50
KS DEPT OF AGRICULTURE

APPLICATION FOR PERMIT TO APPROPRIATE WATER FOR BENEFICIAL USE
Filing Fee Must Accompany the Application
(Please refer to Fee Schedule attached to this application form.)

To the Chief Engineer of the Division of Water Resources, Kansas Department of Agriculture,
109 SW 9th Street, Second Floor, Topeka, KS 66612-1283:

1. Name of Applicant (Please Print): Kansas Department of Wildlife, Parks & Tourism (KDWPT)
Address: 1020 S Kansas Ave, Suite 200
City: Topeka State KS Zip Code 66612
Telephone Number: (785) 296-2281

2. The source of water is: surface water in _____ (stream)
OR groundwater in North Fork Ninnescah River (drainage basin)

Certain streams in Kansas have minimum target flows established by law or may be subject to administration when water is released from storage for use by water assurance district members. If your application is subject to these regulations on the date we receive your application, you will be sent the appropriate form to complete and return to the Division of Water Resources.

3. The maximum quantity of water desired is _____ acre-feet OR 2 million gallons per calendar year, to be diverted at a maximum rate of 99 gallons per minute OR _____ cubic feet per second.

Once your application has been assigned a priority, the requested maximum rate of diversion and maximum requested quantity of water under that priority number can **NOT** be increased. Please be certain your requested maximum rate of diversion and maximum quantity of water are appropriate and reasonable for your proposed project and are in agreement with the Division of Water Resources' requirements.

4. The water is intended to be appropriated for (Check use intended):
(a) Artificial Recharge (b) Irrigation (c) Recreational (d) Water Power
(e) Industrial (f) Municipal (g) Stockwatering (h) Sediment Control
(i) Domestic (j) Dewatering (k) Hydraulic Dredging (l) Fire Protection
(m) Thermal Exchange (n) Contamination Remediation

YOU **MUST** COMPLETE AND ATTACH ADDITIONAL DIVISION OF WATER RESOURCES FORM(S) PROVIDING INFORMATION TO SUBSTANTIATE YOUR REQUEST FOR THE AMOUNT OF WATER FOR THE INTENDED USE REFERENCED ABOVE.

For Office Use Only:							
F.O. <u>2</u>	GMD <u>2</u>	Meets K.A.R. 5-3-1 (YES/NO)	Use <u>MUN</u>	Source <u>G</u> S County <u>PN</u>	By <u>ASW</u>	Date <u>11/10/16</u>	
Code <u>REP</u>	Fee \$ <u>200</u>	TR # _____	Receipt Date <u>11/10/16</u>	Check # <u>Inner fund</u>			

5. The location of the proposed wells, pump sites or other works for diversion of water is:

Note: For the application to be accepted, the point of diversion location must be described to at least a 10 acre tract, unless you specifically request a 60 day period of time in which to locate the site within a specifically described, minimal legal quarter section of land.

(A) One in the NE quarter of the NE quarter of the NE quarter of Section 30, more particularly described as being near a point 5,403 feet North and 859 feet West of the Southeast corner of said section, in Township 26 South, Range 4 West, Reno County, Kansas.

(B) One in the _____ quarter of the _____ quarter of the _____ quarter of Section _____, more particularly described as being near a point _____ feet North and _____ feet West of the Southeast corner of said section, in Township _____ South, Range _____ East/West (circle one), _____ County, Kansas.

(C) One in the _____ quarter of the _____ quarter of the _____ quarter of Section _____, more particularly described as being near a point _____ feet North and _____ feet West of the Southeast corner of said section, in Township _____ South, Range _____ East/West (circle one), _____ County, Kansas.

(D) One in the _____ quarter of the _____ quarter of the _____ quarter of Section _____, more particularly described as being near a point _____ feet North and _____ feet West of the Southeast corner of said section, in Township _____ South, Range _____ East/West (circle one), _____ County, Kansas.

If the source of supply is groundwater, a separate application shall be filed for each proposed well or battery of wells, except that a single application may include up to four wells within a circle with a quarter (1/4) mile radius in the same local source of supply which do not exceed a maximum diversion rate of 20 gallons per minute per well.

A battery of wells is defined as two or more wells connected to a common pump by a manifold; or not more than four wells in the same local source of supply within a 300 foot radius circle which are being operated by pumps not to exceed a total maximum diversion rate of 800 gallons per minute and which supply water to a common distribution system.

6. The owner of the point of diversion, if other than the applicant is (please print):

Applicant
(name, address and telephone number)

(name, address and telephone number)

You must provide evidence of legal access to, or control of, the point of diversion from the landowner or the landowner's authorized representative. Provide a copy of a recorded deed, lease, easement or other document with this application. In lieu thereof, you may sign the following sworn statement:

I have legal access to, or control of, the point of diversion described in this application from the landowner or the landowner's authorized representative. I declare under penalty of perjury that the foregoing is true and correct.

Executed on November 4, 2016. *Colly Buttr*
Applicant's Signature

The applicant must provide the required information or signature irrespective of whether they are the landowner. Failure to complete this portion of the application will cause it to be unacceptable for filing and the application will be returned to the applicant.

7. The proposed project for diversion of water will consist of one well (Mr. D Well)
(number of wells, pumps or dams, etc.)

and Was completed (by) 1993
(Month/Day/Year - each was or will be completed)

8. The first actual application of water for the proposed beneficial use was or is estimated to be 1993
(Mo/Day/Year)

WATER RESOURCES RECEIVED
WATER RESOURCES RECEIVED
UNACCEPTABLE FOR PRIORITY
NOV 10 2016
NOV 8 2016
KS DEPT OF AGRICULTURE
KS DEPT OF AGRICULTURE

9. Will pesticide, fertilizer, or other foreign substance be injected into the water pumped from the diversion works?
 Yes No If "yes", a check valve shall be required.

All chemigation safety requirements must be met including a chemigation permit and reporting requirements.

10. If you are planning to impound water, please contact the Division of Water Resources for assistance, prior to submitting the application. Please attach a reservoir area capacity table and inform us of the total acres of surface drainage area above the reservoir.

Have you also made an application for a permit for construction of this dam and reservoir with the Division of Water Resources? Yes No

• If yes, show the Water Structures permit number here _____

• If no, explain here why a Water Structures permit is not required _____

11. The application must be supplemented by a U.S.G.S. topographic map, aerial photograph or a detailed plat showing the following information. On the topographic map, aerial photograph, or plat, identify the center of the section, the section lines or the section corners and show the appropriate section, township and range numbers. Also, please show the following information:

(a) The location of the proposed point(s) of diversion (wells, stream-bank installations, dams, or other diversion works) should be plotted as described in Paragraph No. 5 of the application, showing the North-South distance and the East-West distance from a section line or southeast corner of section.

(b) If the application is for groundwater, please show the location of any existing water wells of any kind within 1/2 mile of the proposed well or wells. Identify each existing well as to its use and furnish the name and mailing address of the property owner or owners. If there are no wells within 1/2 mile, please advise us.

(c) If the application is for surface water, the names and addresses of the landowner(s) 1/2 mile downstream and 1/2 mile upstream from your property lines must be shown.

(d) The location of the proposed place of use should be shown by crosshatching on the topographic map, aerial photograph or plat.

(e) Show the location of the pipelines, canals, reservoirs or other facilities for conveying water from the point of diversion to the place of use.

A 7.5 minute U.S.G.S. topographic map may be obtained by providing the section, township and range numbers to: Kansas Geological Survey, 1930 Constant, Campus West, University of Kansas, Lawrence, Kansas 66047.

12. List any application, appropriation of water, water right, or vested right file number that covers the same diversion points or any of the same place of use described in this application. Also list any other recent modifications made to existing permits or water rights in conjunction with the filing of this application.

none

WATER RESOURCES RECEIVED

WATER RESOURCES RECEIVED

NOV 10 2016

UNACCEPTABLE FOR PRIORITY NOV 08 2016

SCANNED

KS DEPT OF AGRICULTURE

KS DEPT OF AGRICULTURE

13. Furnish the following well information if the proposed appropriation is for the use of groundwater. If the well has not been completed, give information obtained from test holes, if available.

Information below is from: Test holes Well as completed Drillers log attached

Well location as shown in paragraph No.	(A)	(B)	(C)	(D)
Date Drilled	<u>9/2/93</u>	_____	_____	_____
Total depth of well	<u>60</u>	_____	_____	_____
Depth to water bearing formation	<u>2</u>	_____	_____	_____
Depth to static water level	<u>13</u>	_____	_____	_____
Depth to bottom of pump intake pipe	_____	_____	_____	_____

14. The relationship of the applicant to the proposed place where the water will be used is that of

Owner
(owner, tenant, agent or otherwise)

15. The owner(s) of the property where the water is used, if other than the applicant, is (please print):

US Dept of the Interior-Bureau of Reclamation-Great Plains Region
Oklahoma-Texas ARea Office Federal Building 300 East 8th St, Room 801, Ausitn TX 78735-8931
(name, address and telephone number)

_____ (name, address and telephone number)

16. The undersigned states that the information set forth above is true to the best of his/her knowledge and that this application is submitted in good faith.

Dated at Pratt, Kansas, this 4 day of November, 2016.
(month) (year)

Eddy Butler
(Applicant Signature)

APPLICANT(S) SOCIAL SECURITY IDENTIFICATION NUMBER(S)

By _____
(Agent or Officer Signature)

and/or APPLICANT(S) TAXPAYER I.D. NO.(S)

(Agent or Officer - Please Print)

Assisted by EKF _____ SFFO/ESII _____ Date: 5/13/16
(office/title)

WATER RESOURCES RECEIVED
NOV 10 2016
KS DEPT OF AGRICULTURE

WATER RESOURCES RECEIVED
UNACCEPTABLE FOR PRIORITY
NOV 10 2016
KS DEPT OF AGRICULTURE
SCANNED

FEE SCHEDULE

- 1. The fee for an application for a permit to appropriate water for beneficial use, except for domestic use, shall be (see paragraph No. 2 below if requesting storage):

ACRE-FEET	FEE
0-100	\$200.00
101-320	\$300.00
More than 320	\$300.00 plus \$20.00 for each additional 100 acre-feet or any part thereof.

- 2. The fee for an application in which storage is requested, except for domestic use, shall be:

ACRE-FEET	FEE
0-250	\$200.00
More than 250	\$200.00 plus \$20.00 for each additional 250 acre-feet of storage or any part thereof.

Note: If an application requests both direct use *and* storage, the fee charged shall be as determined under No. 1 or No. 2 above, whichever is greater, but not both fees.

- 3. The fee for an application for a permit to appropriate water for water power or dewatering purposes shall be \$100.00 plus \$200.00 for each 100 cubic feet per second, or part thereof, of the diversion rate requested.

Note: The applicant shall notify the Chief Engineer and pay the statutorily required field inspection fee of \$400.00 when construction of the works for diversion has been completed, except that for applications filed on or after July 1, 2009, for works constructed for sediment control use and for evaporation from a groundwater pit for industrial use shall be accompanied by a field inspection fee of \$200.00.

MAKE CHECKS PAYABLE TO THE KANSAS DEPARTMENT OF AGRICULTURE

ATTENTION

A Water Conservation Plan may be required per K.S.A. 82a-733. A statement that your application for permit to appropriate water may be subject to the minimum desirable streamflow requirements per K.S.A. 82a-703a, b, and c may also be required from you. After the Division of Water Resources has had the opportunity to review your application, you will be notified whether or not you will need to submit a Water Conservation Plan. You also may be required to install a water flow meter or water stage measuring device on your diversion works prior to diverting water. There may be other special conditions or Groundwater Management District regulations that you will need to comply with if this application is approved.

CONVERSION FACTORS

- 1 acre-foot equals 325,851 gallons
- 1 million gallons equal 3.07 acre-feet

WATER RESOURCES RECEIVED

NOV 10 2016

KS DEPT OF AGRICULTURE

WATER RESOURCES RECEIVED

UNACCEPTABLE FOR PRIORITY

SCANNED

KS DEPT OF AGRICULTURE

Applicant's Name KDWP&T
(Please Print)

MUNICIPAL (PUBLIC WATER SUPPLY) APPLICATION SUPPLEMENTAL INFORMATION SHEET

Application File Number
49,728
(assigned by DWR)

**SECTION 1: PRESENT WATER USE SUMMARY (IF NO PREVIOUS MUNICIPAL WATER USE HAS BEEN UTILIZED, PROCEED TO SECTION 3)
NOTE: WORKSHEET FOR WATER PUMPED, PURCHASED, AND SOLD BY YOUR WATER DISTRIBUTION SYSTEM.**

Column 1 Raw Water Diverted Under Your Rights	Column 2 Water Purchased From All Sources	Column 3 Water Sold to Other Public Water Suppliers	Column 4 Water Sold to Your Industrial, Stock, and Bulk Customers	Column 5 Water Sold to Your Residential and Commercial Customers	Column 6 Other Metered Water	Column 7 Remaining Water Used (See Below Explanation)
TOTAL WATER = Columns 1 + 2		ACCOUNTED FOR WATER = Columns 3 + 4 + 5 + 6				UNACCOUNTED FOR WATER

UNACCOUNTED FOR WATER = TOTAL WATER - ACCOUNTED FOR WATER

- Column 1: The amount of raw water diverted from all of your points of diversion.
- Column 2: The amount of water purchased wholesale from all other public water supply systems or the Kansas Water Office.
- Column 3: The amount of water sold wholesale to all other public water supply systems.
- Column 4: The amount of water sold retail to all industrial, pasture, stockwater, feedlot, and bulk water service connections. Include the amount of water sold to all farmsteads using at least 200,000 gallons of water per year.
- Column 5: The amount of water sold retail to your residential and commercial customers and to industries and farmsteads using less than 200,000 gallons of water per year.
- Column 6: The amount of water used that is metered at individual service connections and supplied free, such as for public service, treatment processes, and connections receiving free water.
- Column 7: The amount of remaining water used. The gallons reported in this column are found by adding the numbers in Columns 1 and 2 and subtracting the numbers in Columns 3, 4, 5, and 6.

UNACCOUNTED FOR WATER

Use the following to calculate your distribution system's Unaccounted For Water:
Start with the amount in Column 1 and add the amount in Column 2, then subtract the amounts in Columns 3, 4, 5, and 6 leaving an amount of water representing your unaccounted for water to enter in Column 7.

Use the following to calculate the percent Unaccounted For Water versus the Total Water of your system:

$$\text{Percent Unaccounted For Water} = \frac{\text{Unaccounted For Water}}{\text{Total Water (Columns 1,2)}} \times 100$$
 If this number exceeds 20%, please explain the large amount of unaccounted for water and describe any steps being taken to reduce it.

**SECTION 2: PAST WATER USE
COMPLETE THE FOLLOWING TABLE FROM YOUR PAST WATER USE RECORDS.**

	Column 1 Raw Water Diverted Under Your Rights	Column 2 Water Purchased From All Sources	Column 3 Water Sold to Other Public Water Suppliers	Column 4 Water Sold to Your Industrial, Stock, and Bulk Customers	Column 5 Water Sold to Your Residential and Commercial Customers	Column 6 Other Metered Water	Column 7 Remaining Water Used (See Above Explanation)
20 years ago							
15 years ago							
10 years ago							
5 years ago							
	TOTAL WATER = Columns 1 + 2		ACCOUNTED FOR WATER = Columns 3 + 4 + 5 + 6				UNACCOUNTED FOR WATER

WATER RESOURCES RECEIVED

NOV 10 2016

WATER RESOURCES RECEIVED

UNACCEPTABLE FOR PRIORITY

SCANNED

KS DEPT OF AGRICULTURE

KS DEPT OF AGRICULTURE

SECTION 3: PROJECTED FUTURE WATER NEEDS

PLEASE COMPLETE THE FOLLOWING TABLE SHOWING YOUR FUTURE WATER REQUIREMENTS FOR THE NEXT 20 YEARS:

	Column 1 Raw Water Diverted Under Your Rights	Column 2 Water Purchased From All Sources	Column 3 Water Sold to Other Public Water Suppliers	Column 4 Water Sold to Your Industrial, Stock, and Bulk Customers	Column 5 Water Sold to Your Residential and Commercial Customers	Column 6 Other Metered Water	Column 7 Remaining Water Used (See Explanation on other side)
Year 5	2 mil gal.	0	0	0	0		
Year 10	2 mil gal.	0	0	0	0		
Year 15	2 mil gal.	0	0	0	0		
Year 20	2 mil gal.	0	0	0	0		
TOTAL WATER = Columns 1 + 2		ACCOUNTED FOR WATER = Columns 3 + 4 + 5 + 6				UNACCOUNTED FOR WATER	

WATER RESOURCES RECEIVED

NOV 10 2016

SCANNED

KS DEPT OF AGRICULTURE

SECTION 4: POPULATION AND SERVICE CONNECTIONS

ESTIMATE THE NUMBER OF PERSONS DIRECTLY SERVED BY YOUR WATER DISTRIBUTION SYSTEM

PAST POPULATION - PROVIDE INFORMATION BELOW:
(CENSUS BUREAU INFORMATION)

LAST 20 YEARS	POPULATION
20 years ago	
15 years ago	
10 years ago	
5 years ago	
Last Year	

PROJECTED FUTURE POPULATION

ESTIMATE FUTURE POPULATION AND SUBSTANTIATE NUMBERS ON SEPARATE ATTACHMENTS

NEXT 20 YEARS	POPULATION
Year 5	
Year 10	
Year 15	
Year 20	

WATER RESOURCES RECEIVED

UNACCEPTABLE FOR PRIORITY NOV 08 2016

Provide number of current active service connections:

_____ Residential _____ Industrial _____ Other (specify) _____
 _____ Commercial _____ Pasture/ Stockwater/ Feedlot _____ Total

SECTION 5: PRESENT GALLONS PER PERSON PER DAY
CALCULATE YOUR GALLONS PER PERSON PER DAY

Water in Columns 5, 6, and 7 + Population + 365 Days/Year = Gallons per Person per Day

$$\frac{\text{Amount of water in Columns 5, 6, and 7 of Section 1}}{\text{Population from Last Year of Section 4}} \div 365 \text{ Days/Year} = \text{GALLONS PER PERSON PER DAY.}$$

SECTION 6: AREA TO BE SERVED

Describe the area to be served or provide the legal description of the location where the water is to be used including any other city of water supply system (i.e. Rural Water District):

Area to be served is at Cheney State Park. Water is to three bath/shower houses and 60 campsites. These areas are used heavily for approximately 6 months per year.

You may attach additional information you believe will assist in informing the Division of the need for your request.



Legend

- Water Appropriations
- ⊗ Proposed Point of Diversion
- ★ Domestic Well
- + Section Corner
- Proposed Place of Use
- Half Mile Circle
- Section Line

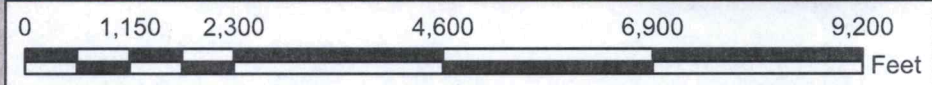

New Application File No. 30-26S-4W
Sedgwick County

WATER RESOURCES RECEIVED
 NOV 10 2016
 ACCEPTABLE FOR PRIORITY
 NOV 09 2016
 KS DEPT OF AGRICULTURE
 KS DEPT OF AGRICULTURE

To the best of my knowledge, all of the domestic wells within 1/2 mile of the proposed point of diversion have been shown.

Collyer Butts 11-04-2016
 Signature



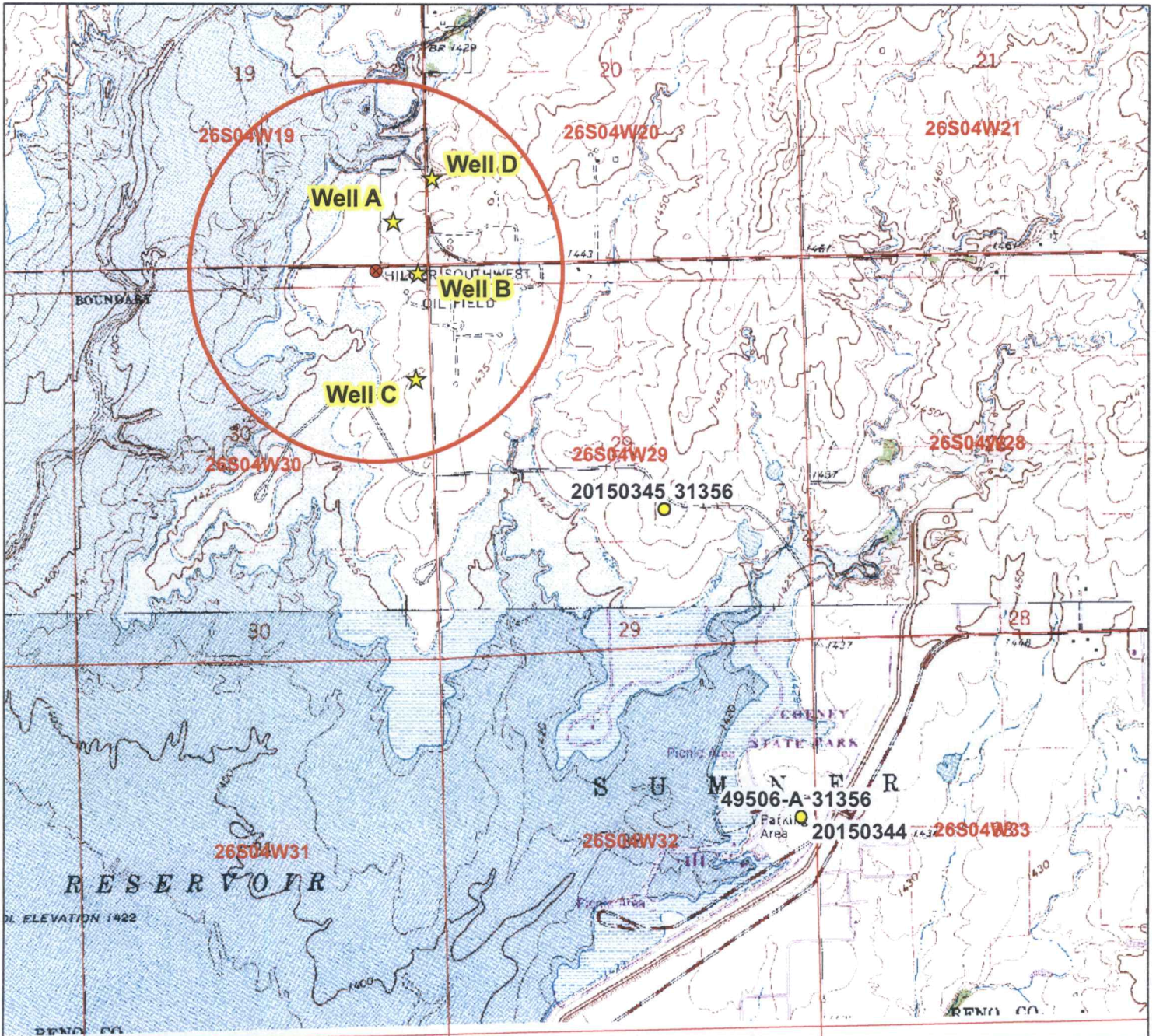

Legend

- Water Appropriations
- Proposed Point of Diversion
- ★ Domestic Well
- + Section Corner
- Proposed Place of Use
- Half Mile Circle
- Section Line

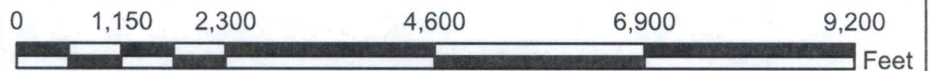

New Application, File No. 30-26S-4W

Sedgwick County

To the best of my knowledge, all of the domestic wells within 1/2 mile of the proposed point of diversion have been shown.

Colly Carter
Signature

11-04-2016

SCANNED

Nearby Well Owners Section 29 Well

Well A: (Multiple wells in vicinity, difficult to show:

- Jerome J & Barbara H Meyer Rev. Living Trusts, 20518 S Riverview Dr, Pretty Prairie KS 67570
- Jimmie Lee & Katherine J Kirby, 25303 S Cedarview Dr, Mount Hope KS 67108
- James L & W Sue Byers, 10378 N 281 HWY, Pratt KS 67124
- Larry E & Linda S Webb, 25209 S Cedarview Dr, Mount Hope KS 67108
- Charles R Williams, 25208 S Cedarview Dr, Mount Hope KS 67108
- Bobby J & Denise A Appelhans, 25210 S Cedarview Dr, Mount Hope KS 67108
- Charles B & Connie L Bellamy, 25302 S Cedarview Dr, Mount Hope KS 67108
- Harold V Dodson, 25207 S Westview Ln, Mount Hope KS 67108
- Jeffrey A & Kimberly A Graham, 8802 E Boundary Rd, Mount Hope KS 67108
- Edward Lynn Baker, 8814 E Boundary Rd, Mount Hope KS 67108
- Otto Contracting Inc, 10907 S Halstead St, Hutchinson KS 67501
- Darrell & Marie M Sober, 25306 S Westview Ln, Mount Hope KS 67108
- James D & Alicia M Branson, 25303 S Willison Rd, Mount Hope KS 67108
- Theodore Robert Bergkamp, 25202 Westview Ln, Mount Hope KS 67108-9671
- Bobby M Day, 8407 SE 81st St, Galena KS 66739
- Timothy Ray Howard, 8814 E Cedarview Dr, Mount Hope KS 67108

Well B: Sheila E Martin, 12 Countryside Rd, Hutchinson KS 67502-4428

Well C: Rhonda Kane Living Trust, 25719 S Willison Rd, Mount Hope KS 67108

Well D: Justin R Falk, 25110 S Willison Rd, Mount Hope KS 67108

WATER RESOURCES
RECEIVED

NOV 10 2016

KS DEPT OF AGRICULTURE

WATER RESOURCES
RECEIVED

UNACCEPTABLE FOR PRIORITY
NOV 08 2016

KS DEPT OF AGRICULTURE

SCANNED

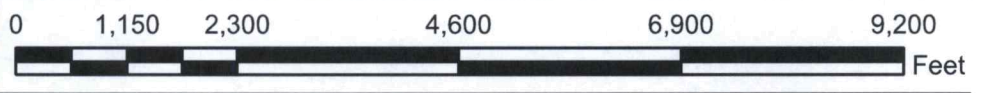
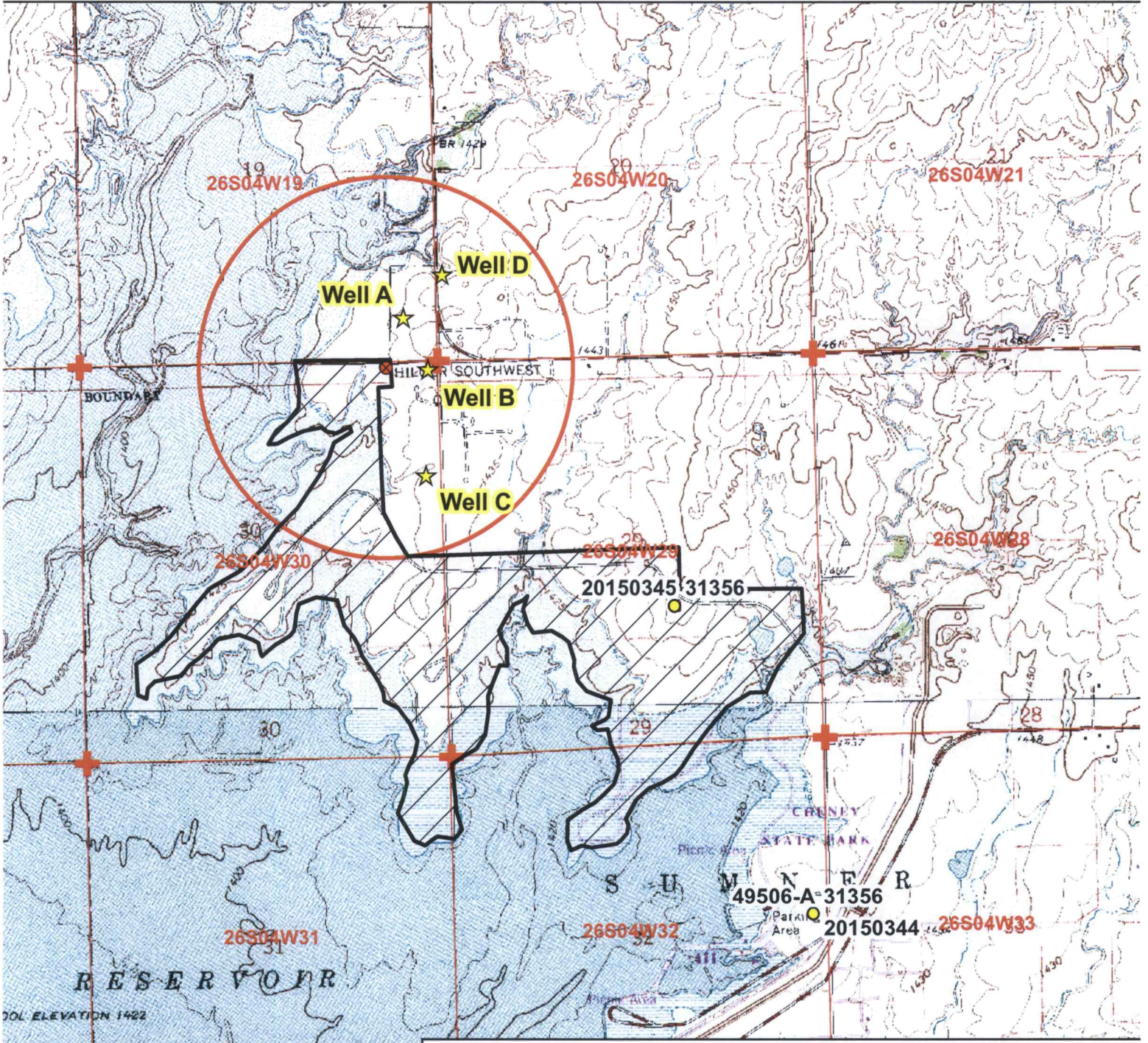

Legend

- Water Appropriations
- ⊗ Proposed Point of Diversion
- ★ Domestic Well
- + Section Corner
- Proposed Place of Use
- Half Mile Circle
- Section Line

New Application File No. 30-26S-4W

Sedgwick County

WATER RESOURCES RECEIVED
 NOV 1 0 2016
 NOV 0 8 2016
 ACCEPTABLE PRIORITY
 KS DEPT OF AGRICULTURE
 NOV 0 4 2016

To the best of my knowledge, all of the domestic wells within 1/2 mile of the proposed point of diversion have been shown.

Eddy Smith 11-04-2016



SCANNED

#19,728

WATER WELL RECORD Form WWC-5 KSA 82a-1212

1 LOCATION OF WATER WELL: Fraction NE 1/4 NE 1/4 NE 1/4 Section Number 30 Township Number T 26 S Range Number R 4 EW
 County: Beno
 Distance and direction from nearest town or city street address of well if located within city? 3 miles west of St. Joe Kansas

2 WATER WELL OWNER: Wildlife & Parks Dept
 RR#, St. Address, Box #: Rt 2 Box 54A Board of Agriculture, Division of Water Resources
 City, State, ZIP Code: Pratt KS 67124 Application Number:

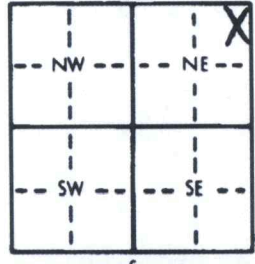
3 LOCATE WELL'S LOCATION WITH AN "X" IN SECTION BOX:

 4 DEPTH OF COMPLETED WELL: 60 ft. ELEVATION:
 Depth(s) Groundwater Encountered 1. 13 ft. 2. 9-2-93 ft. 3. 9-2-93 ft.
 WELL'S STATIC WATER LEVEL: 13 ft. below land surface measured on mo/day/yr 9-2-93
 Pump test data: Well water was _____ ft. after _____ hours pumping _____ gpm
 Est. Yield _____ gpm: Well water was _____ ft. after _____ hours pumping _____ gpm
 Bore Hole Diameter _____ in. to _____ ft., and _____ in. to _____ ft.
 WELL WATER TO BE USED AS: 5 Public water supply 8 Air conditioning 11 Injection well
 1 Domestic 3 Feedlot 6 Oil field water supply 9 Dewatering 12 Other (Specify below)
 2 Irrigation 4 Industrial 7 Lawn and garden only 10 Monitoring well
 Was a chemical/bacteriological sample submitted to Department? Yes _____ No X; If yes, mo/day/yr sample was submitted _____
 Water Well Disinfected? Yes X No _____

5 TYPE OF BLANK CASING USED:
 1 Steel 3 RMP (SR) 5 Wrought iron 8 Concrete tile CASING JOINTS: Glued X Clamped _____
2 PVC 4 ABS 6 Asbestos-Cement 9 Other (specify below) Welded _____
 Blank casing diameter 5 in. to 18 ft. Dia _____ in. to _____ ft. Dia _____ in. to _____ ft.
 Casing height above land surface 12 in. weight 2.60 lbs./ft. Wall thickness or gauge No. 100FS1
 TYPE OF SCREEN OR PERFORATION MATERIAL: 7 PVC 10 Asbestos-cement
 1 Steel 3 Stainless steel 5 Fiberglass 8 RMP (SR) 11 Other (specify) _____
 2 Brass 4 Galvanized steel 6 Concrete tile 9 ABS 12 None used (open hole)
 SCREEN OR PERFORATION OPENINGS ARE:
 1 Continuous slot 3 Mill slot 5 Gauzed wrapped 8 Saw cut 11 None (open hole)
 2 Louvered shutter 4 Key punched 6 Wire wrapped 9 Drilled holes
 7 Torch cut 10 Other (specify) _____
 SCREEN-PERFORATED INTERVALS: From 18 ft. to 60 ft. From _____ ft. to _____ ft.
 GRAVEL PACK INTERVALS: From 18 ft. to 60 ft. From _____ ft. to _____ ft.

6 GROUT MATERIAL: 3 1 Neat cement 2 Cement grout 3 Bentonite 4 Other _____
 Grout Intervals: From 3 ft. to 18 ft. From _____ ft. to _____ ft. From _____ ft. to _____ ft.
 What is the nearest source of possible contamination:
 1 Septic tank 4 Lateral lines 7 Pit privy 10 Livestock pens 14 Abandoned water well
 2 Sewer lines 5 Cess pool 8 Sewage lagoon 11 Fuel storage 15 Oil well/Gas well
 3 Watertight sewer lines 6 Seepage pit 9 Feedyard 12 Fertilizer storage 16 Other (specify below) Cherry Reservoir
 Direction from well? West How many feet? 1500

FROM	TO	LITHOLOGIC LOG	FROM	TO	PLUGGING INTERVALS
0	2	top soil			
2	60	shale			

WATER RESOURCES RECEIVED
 NOV 10 2016
 KS DEPT OF AGRICULTURE

WATER RESOURCES RECEIVED
 NOV 08 2016
 UNACCEPTED FOR FEE
 KS DEPT OF AGRICULTURE

7 CONTRACTOR'S OR LANDOWNER'S CERTIFICATION: This water well was (1) constructed, (2) reconstructed, or (3) plugged under my jurisdiction and was completed on (mo/day/year) 9-2-93 and this record is true to the best of my knowledge and belief. Kansas Water Well Contractor's License No. 318 This Water Well Record was completed on (mo/day/yr) 9-14-93 under the business name of Weninger Drilling Inc by (signature) Susan K. Weninger

INSTRUCTIONS: Use typewriter or ball point pen. PLEASE PRESS FIRMLY and PRINT clearly. Please fill in blanks, underline or circle the correct answers. Send top three copies to Kansas Department of Health and Environment, Bureau of Water, Topeka, Kansas 66620-0001. Telephone: 913-296-5545. Send one to WATER WELL OWNER and retain one for your records.

SCANNED

Fee will be paid through Inter-Agency Fund
Transfer.

WATER RESOURCES
RECEIVED

NOV 10 2016

KS DEPT OF AGRICULTURE

WATER RESOURCES
RECEIVED

NOV 08 2016

KS DEPT OF AGRICULTURE

SCANNED

UNACCEPTABLE PRIORITY



All Search

Interfund Details

Interfund Id AA00196754 Delete Expand All Collapse All Notify

Accounts Receivable Transactions

Add Deposit Find Deposit Remove Deposit Deposit BU Deposit ID

Details

Deposit Status Contact Information
 Posting Status
 Entered By
 Entered Dt
 Total Amt

AR Interfund Approval:
 Not Approved Approved
 Approved By
 Approval Dt

Payment

Payment ID Budget Status Seq
 Customer ID

Distribution Details

Details

Monetary Amount	Department	Fund	Budget Unit	Program	Account	Business Unit PC	Project	Activity	Source

Accounts Payable Transactions

View Voucher Find Voucher Remove Voucher AP BU 71000 Voucher 00171600

Details

Supplier SetID SOKID Post Status Unposted Budget Status Not Chk'd
 Supplier ID 04600
 Invoice Application for Permit
 Invoice Date 11/10/2016
 Total Amount 200.00
 Entered By FG00TJD
 Entered Dt 11/10/2016

AP Interfund Approval:
 Not Approved Approved
 Approved By
 Approval Dt

Distribution Details

Details

Line	Dist	Monetary Amount	Department	Fund	Budget Unit	Program	Account	PC Business Unit	Project	Activity	Source
1	1	200.00	7107010000	2122	2053	66000	526900	71000	NELTRAC814000	A00	PK

Comments

Teresa Dill interfunds@ksoutdoors.com
 KS Dept of Ag - Division of Water Resources
 Application for Permit to Appropriate Water for Beneficial Use (Diversion of Water)
 Source of Water: North Fork Ninnescah River
 Proposed Project for Diversion: one well (Mr. D Well) 30-26S-4W Sedgwick County

WATER RESOURCES RECEIVED

NOV 10 2016

KS DEPT OF AGRICULTURE

SCANNED

1320 Research Park Drive
Manhattan, Kansas 66502
Jackie McClaskey, Secretary



Phone: (785) 564-6700
Fax: (785) 564-6777
Email: ksag@kda.ks.gov
www.agriculture.ks.gov
Sam Brownback, Governor

November 14, 2016

KANSAS DEPT OF WILDLIFE PARKS & TOURISM
1020 S KANSAS AVE SUITE 200
TOPEKA KS 66612

FILE COPY

RE: Application
File No. 49728

Dear Sir or Madam:

Your application for permit to appropriate water in 30-26S-4W in Reno County, was received and has been assigned the file number noted above.

As a matter of record, the Division of Water Resources has on hand a large number of applications awaiting processing. Therefore to be fair to all concerned, and so that we can process those applications on hand in the order they were received, we intend to concentrate on the backlog of applications until the issue is resolved. Once review of your application has begun, we will contact you, if additional information is required.

In accordance with the provisions of the Kansas Water Appropriation Act, a portion of which is included below, the use of water as proposed prior to approval of the application is unlawful. Once approved, compliance with the terms, conditions and limitations of the permit is necessary. Conservation of the water resources of Kansas is required.

Section 82a-728 of the Kansas Water Appropriation Act, provides (a) except for the appropriation of water for the purpose of domestic use, . . . it shall be unlawful for any person to appropriate or threaten to appropriate water from any source without first applying for and obtaining a permit to appropriate water in accordance with the provisions of the Water Appropriation Act or for any person to violate any condition of a vested right, appropriation right or an approved application for a permit to appropriate water for beneficial use.

(b) (1) The violation of any provision of this section by any person is a class C misdemeanor . . .

A class C misdemeanor is punishable by a fine not to exceed \$500 and/or a term of confinement not to exceed one month in the county jail. Each day that the violation occurs constitutes a separate offense.

If you have any questions, please contact me at (785) 564-6645. If you wish to discuss a specific file, please have the file number ready so that we may help you more efficiently.

Sincerely,

Brent A Turney, P.G.
Change Application Unit Supervisor
Water Appropriation Program

BAT: dlw
pc: STAFFORD Field Office
GMD 2

SCANNED

Water Rights and Points of Diversion Within 2.00 miles of point defined as:
 5403 ft N and 859 ft W of the SE Corner of Section 30, T 26S, R 4W
 Located at: 97.792919 West Longitude and 37.762961 North Latitude
 GROUNDWATER ONLY

#49,728

File Number	Use	ST	SR	Dist (ft)	Q4	Q3	Q2	Q1	FeetN	FeetW	Sec	Twp	Rng	ID	Batt	Auth_Quan	Add_Quan	Unit
A__ 31356	00	MUN	NK	G	5256	--	SW	NW	SE	1836	2090	29	26	4W	1	3.07	1.44	AF
Same					9698	--	SE	SE	NE	2940	240	32	26	4W	1	3.07	1.63	AF
A__ 49506	A	MUN	GY	G	9698	--	SE	SE	NE	2940	240	32	26	4W	1	4.42	4.42	AF
A__ 49728	00	MUN	AY	G	0	--	NW	NE	NE	5403	859	30	26	4W	1	6.14	6.14	AF
P__20160135	00	MUN	GY	G	0	--	NW	NE	NE	5403	859	30	26	4W	1	6.14	6.14	AF

Total Net Quantities Authorized:	Direct	Storage
Total Requested Amount (AF) =	6.14	.00
Total Permitted Amount (AF) =	10.56	.00
Total Inspected Amount (AF) =	.00	.00
Total Pro_Cert Amount (AF) =	.00	.00
Total Certified Amount (AF) =	3.07	.00
Total Vested Amount (AF) =	.00	.00
TOTAL AMOUNT (AF) =	19.76	.00

An * after the source of supply indicates a pending application for change for the file number.
 An * after the ID indicates a 15 AF exemption was granted for the file number.
 A "G" in the Batt column indicates the GEO CTR of a battery. A "B" indicates a well in the battery.
 The number in the Batt column is the number of wells in the battery.

Water Rights and Points of Diversion Within 2.00 miles of point defined as:
 97.792919 West Longitude and 37.762961 North Latitude
 GROUNDWATER ONLY

WATER USE CORRESPONDENTS:

File Number	Use	ST	SR	
A__ 31356	00	MUN	NK	G
>	KANSAS DEPT OF WILDLIFE PARKS & TOURISM			
>	PROJECT ENGINEER (SFO)			
>	1020 S KANSAS AVE FL 2			
>	TOPEKA KS 66612			

A__ 49506	A	MUN	GY	G
>	KANSAS DEPT OF WILDLIFE PARKS & TOURISM			
>	PROJECT ENGINEER (SFO)			
>	1020 S KANSAS AVE FL 2			
>	TOPEKA KS 66612			

A__ 49728	00	MUN	AY	G
>	KANSAS DEPT OF WILDLIFE PARKS & TOURISM			
>	PROJECT ENGINEER (SFO)			
>	1020 S KANSAS AVE FL 2			
>	TOPEKA KS 66612			

P__20160135	00	MUN	GY	G
>	KANSAS DEPT OF WILDLIFE PARKS & TOURISM			
>	PROJECT ENGINEER (SFO)			

> 1020 S KANSAS AVE FL 2

> TOPEKA KS 66612

>-----
=====

Kansas
Department of Agriculture
Division of Water Resources

Stafford Field Office
300 S. Main Street
Stafford, Kansas 67578-1521
Jackie McClaskey, Secretary
David W. Barfield, Chief Engineer
Jeff Lanterman, Water Commissioner

Phone: (620) 234-5311
Fax: (620) 234-6900
www.agriculture.ks.gov
Sam Brownback, Governor

May 26, 2017

Jerome J & Barbara H Meyer Rev. Living Trusts
20518 S Riverview Dr
Pretty Prairie, KS 67570

Re: Pending Application, File No. 49,728

Dear Sir or Madam:

This is to advise you that the Kansas Department of Wildlife, Parks, & Tourism has filed the application referred to above for a permit to appropriate 2 million gallons of groundwater per calendar year for municipal use to be diverted at a maximum rate of 99 gallons per minute. The proposed point of diversion for 49,728 is one (1) well, which located as follows:

In the Northeast Quarter of the Northeast Quarter of the Northeast Quarter of Section 30, Township 26 South, Range 4 West, Reno County, Kansas.

A map is enclosed indicating the location of the proposed well. Records in this office indicate that you may have a well or wells in this vicinity and you are notified of receipt of this application in order that you may be fully informed of the proposed location of the applicant's point of diversion and proposed use of water. Consideration will be given to comments or other information which you desire to submit to this office **within 15 days** from the date of this letter.

If you have any questions or comments, you may also contact me at (620) 234-5311. If you call, please reference the file number so I can help you more efficiently. Mailed comments can be sent to the Stafford Field Office at 300 S. Main St. Stafford, KS 67578-1521.

Sincerely,

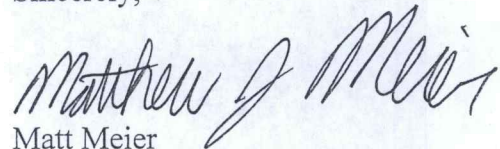

Matt Meier
Environmental Scientist
Water Appropriations Program

Enclosure

pc:

SCANNED

Kansas

Department of Agriculture
Division of Water Resources

Stafford Field Office
300 S. Main Street
Stafford, Kansas 67578-1521
Jackie McClaskey, Secretary
David W. Barfield, Chief Engineer
Jeff Lanterman, Water Commissioner

Phone: (620) 234-5311
Fax: (620) 234-6900
www.agriculture.ks.gov
Sam Brownback, Governor

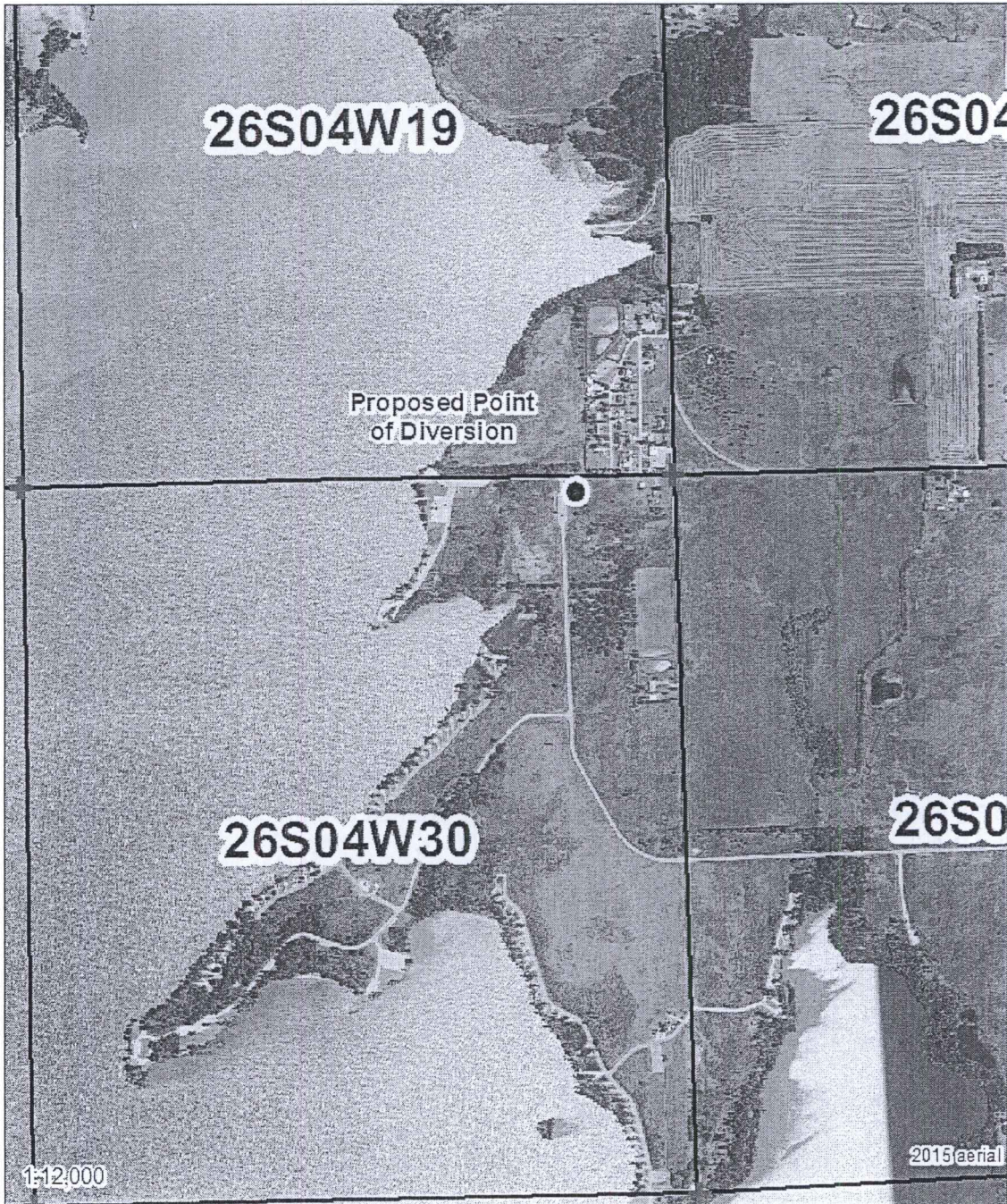

Legend

- + Section Corners
- Section Lines

MJM-DWR 5/25/17

Proposed Water Appropriation, File No. 49,728
30-26S-4W
Reno County



SCANNED

Kansas
Department of Agriculture
Division of Water Resources

Stafford Field Office
300 S. Main Street
Stafford, Kansas 67578-1521

Jackie McClaskey, Secretary
David W. Barfield, Chief Engineer
Jeff Lanterman, Water Commissioner

Phone: (620) 234-5311
Fax: (620) 234-6900
www.agriculture.ks.gov
Sam Brownback, Governor

May 26, 2017

Jimmie Lee & Katherine J Kirby
25303 S Cedarview Dr
Mount Hope, KS 67108

Re: Pending Application, File No. 49,728

Dear Sir or Madam:

This is to advise you that the Kansas Department of Wildlife, Parks, & Tourism has filed the application referred to above for a permit to appropriate 2 million gallons of groundwater per calendar year for municipal use to be diverted at a maximum rate of 99 gallons per minute. The proposed point of diversion for 49,728 is one (1) well, which located as follows:

In the Northeast Quarter of the Northeast Quarter of the Northeast Quarter of Section 30, Township 26 South, Range 4 West, Reno County, Kansas.

A map is enclosed indicating the location of the proposed well. Records in this office indicate that you may have a well or wells in this vicinity and you are notified of receipt of this application in order that you may be fully informed of the proposed location of the applicant's point of diversion and proposed use of water. Consideration will be given to comments or other information which you desire to submit to this office **within 15 days** from the date of this letter.

If you have any questions or comments, you may also contact me at (620) 234-5311. If you call, please reference the file number so I can help you more efficiently. Mailed comments can be sent to the Stafford Field Office at 300 S. Main St. Stafford, KS 67578-1521.

Sincerely,

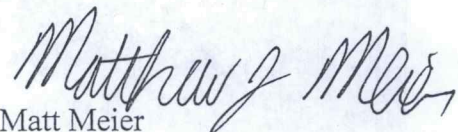

Matt Meier
Environmental Scientist
Water Appropriations Program

Enclosure

pc:

SCANNED

Kansas

Department of Agriculture
Division of Water Resources

Stafford Field Office
300 S. Main Street
Stafford, Kansas 67578-1521
Jackie McClaskey, Secretary
David W. Barfield, Chief Engineer
Jeff Lanterman, Water Commissioner

Phone: (620) 234-5311
Fax: (620) 234-6900
www.agriculture.ks.gov
Sam Brownback, Governor

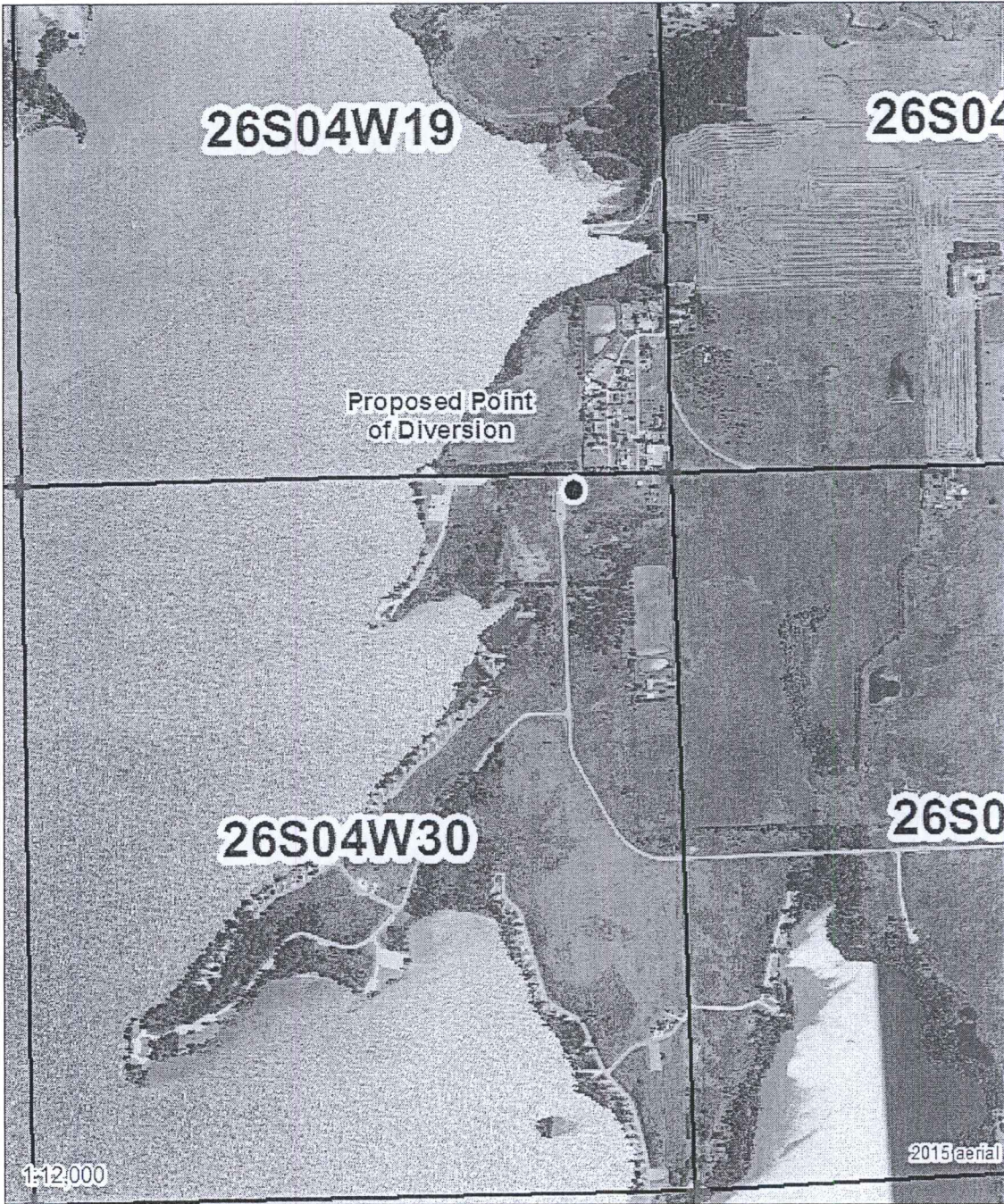

Legend

- + Section Corners
- Section Lines

MJM-DWR 5/25/17

Proposed Water Appropriation, File No. 49,728
30-26S-4W
Reno County



Kansas
Department of Agriculture
Division of Water Resources

Stafford Field Office
300 S. Main Street
Stafford, Kansas 67578-1521

Jackie McClaskey, Secretary
David W. Barfield, Chief Engineer
Jeff Lanterman, Water Commissioner

Phone: (620) 234-5311
Fax: (620) 234-6900
www.agriculture.ks.gov
Sam Brownback, Governor

May 26, 2017

James & Se Byers
10378 N 281 Hwy
Pratt, KS 67124

Re: Pending Application, File No. 49,728

Dear Sir or Madam:

This is to advise you that the Kansas Department of Wildlife, Parks, & Tourism has filed the application referred to above for a permit to appropriate 2 million gallons of groundwater per calendar year for municipal use to be diverted at a maximum rate of 99 gallons per minute. The proposed point of diversion for 49,728 is one (1) well, which located as follows:

In the Northeast Quarter of the Northeast Quarter of the Northeast Quarter of Section 30, Township 26 South, Range 4 West, Reno County, Kansas.

A map is enclosed indicating the location of the proposed well. Records in this office indicate that you may have a well or wells in this vicinity and you are notified of receipt of this application in order that you may be fully informed of the proposed location of the applicant's point of diversion and proposed use of water. Consideration will be given to comments or other information which you desire to submit to this office **within 15 days** from the date of this letter.

If you have any questions or comments, you may also contact me at (620) 234-5311. If you call, please reference the file number so I can help you more efficiently. Mailed comments can be sent to the Stafford Field Office at 300 S. Main St. Stafford, KS 67578-1521.

Sincerely,

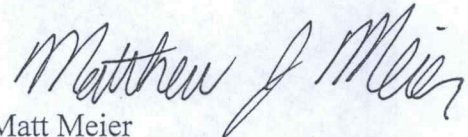

Matt Meier
Environmental Scientist
Water Appropriations Program

Enclosure

pc:

SCANNED

Kansas

Department of Agriculture
Division of Water Resources

Stafford Field Office
300 S. Main Street
Stafford, Kansas 67578-1521

Jackie McClaskey, Secretary
David W. Barfield, Chief Engineer
Jeff Lanterman, Water Commissioner

Phone: (620) 234-5311
Fax: (620) 234-6900
www.agriculture.ks.gov
Sam Brownback, Governor

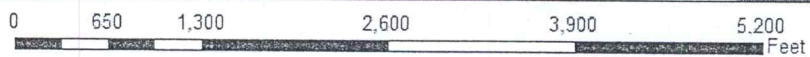
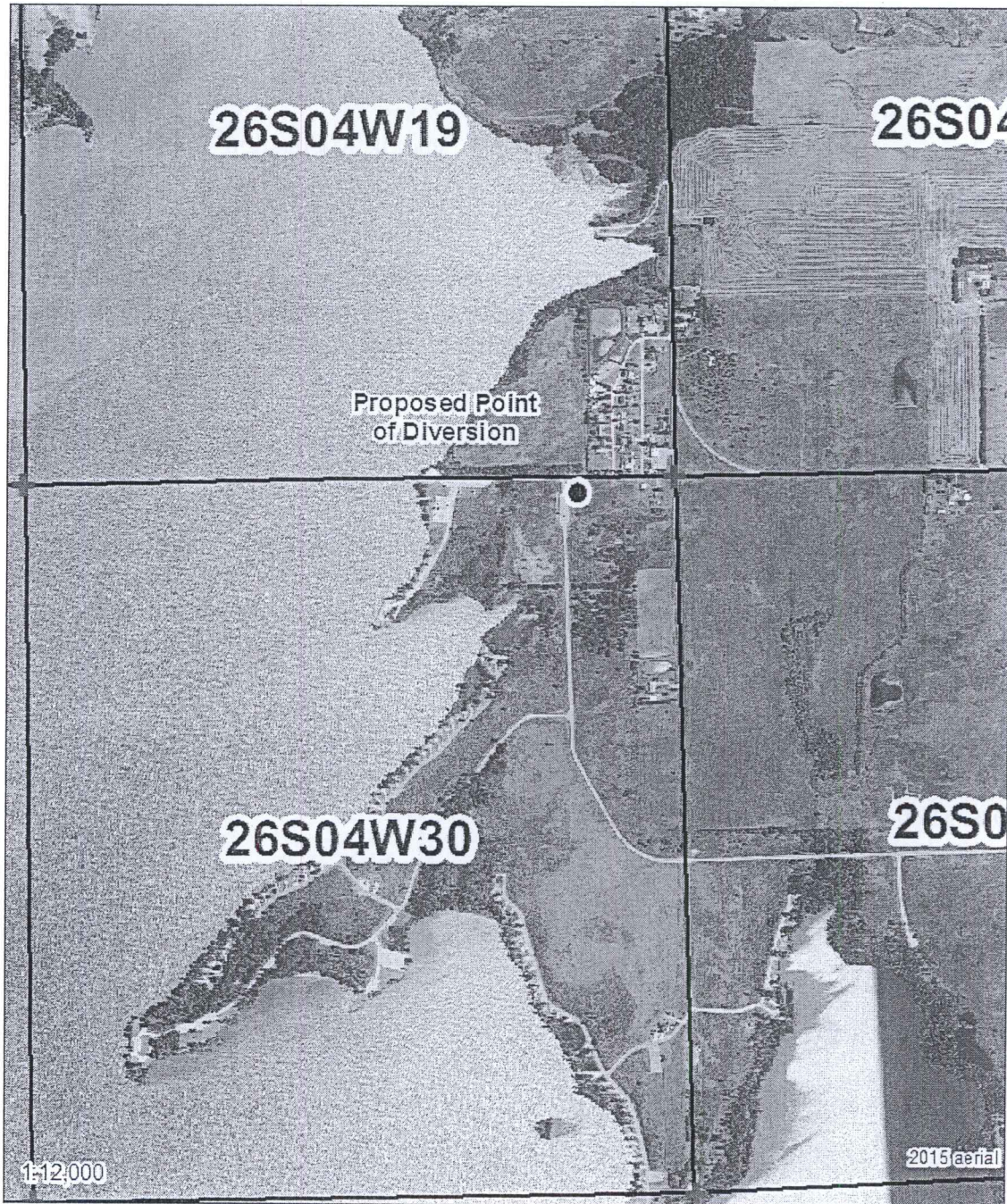

Legend

- + Section Corners
- ▭ Section Lines

MJM-DWR 5/25/17

Proposed Water Appropriation, File No. 49,728
30-26S-4W
Reno County



SCANNED

**Kansas**
Department of Agriculture
Division of Water Resources

Stafford Field Office
300 S. Main Street
Stafford, Kansas 67578-1521
Jackie McClaskey, Secretary
David W. Barfield, Chief Engineer
Jeff Lanterman, Water Commissioner

Phone: (620) 234-5311
Fax: (620) 234-6900
www.agriculture.ks.gov
Sam Brownback, Governor

May 26, 2017

Larry & Lina Webb
25209 S Cedarview Dr
Mount Hope, KS 67108

Re: Pending Application, File No. 49,728

Dear Sir or Madam:

This is to advise you that the Kansas Department of Wildlife, Parks, & Tourism has filed the application referred to above for a permit to appropriate 2 million gallons of groundwater per calendar year for municipal use to be diverted at a maximum rate of 99 gallons per minute. The proposed point of diversion for 49,728 is one (1) well, which located as follows:

In the Northeast Quarter of the Northeast Quarter of the Northeast Quarter of Section 30, Township 26 South, Range 4 West, Reno County, Kansas.

A map is enclosed indicating the location of the proposed well. Records in this office indicate that you may have a well or wells in this vicinity and you are notified of receipt of this application in order that you may be fully informed of the proposed location of the applicant's point of diversion and proposed use of water. Consideration will be given to comments or other information which you desire to submit to this office **within 15 days** from the date of this letter.

If you have any questions or comments, you may also contact me at (620) 234-5311. If you call, please reference the file number so I can help you more efficiently. Mailed comments can be sent to the Stafford Field Office at 300 S. Main St. Stafford, KS 67578-1521.

Sincerely,

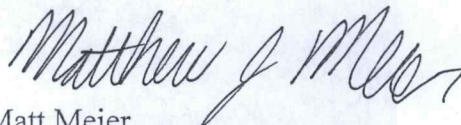

Matt Meier
Environmental Scientist
Water Appropriations Program

Enclosure

pc:

SCANNED

Kansas

Department of Agriculture
Division of Water Resources

Stafford Field Office
300 S. Main Street
Stafford, Kansas 67578-1521

Jackie McClaskey, Secretary
David W. Barfield, Chief Engineer
Jeff Lanterman, Water Commissioner

Phone: (620) 234-5311
Fax: (620) 234-6900
www.agriculture.ks.gov
Sam Brownback, Governor

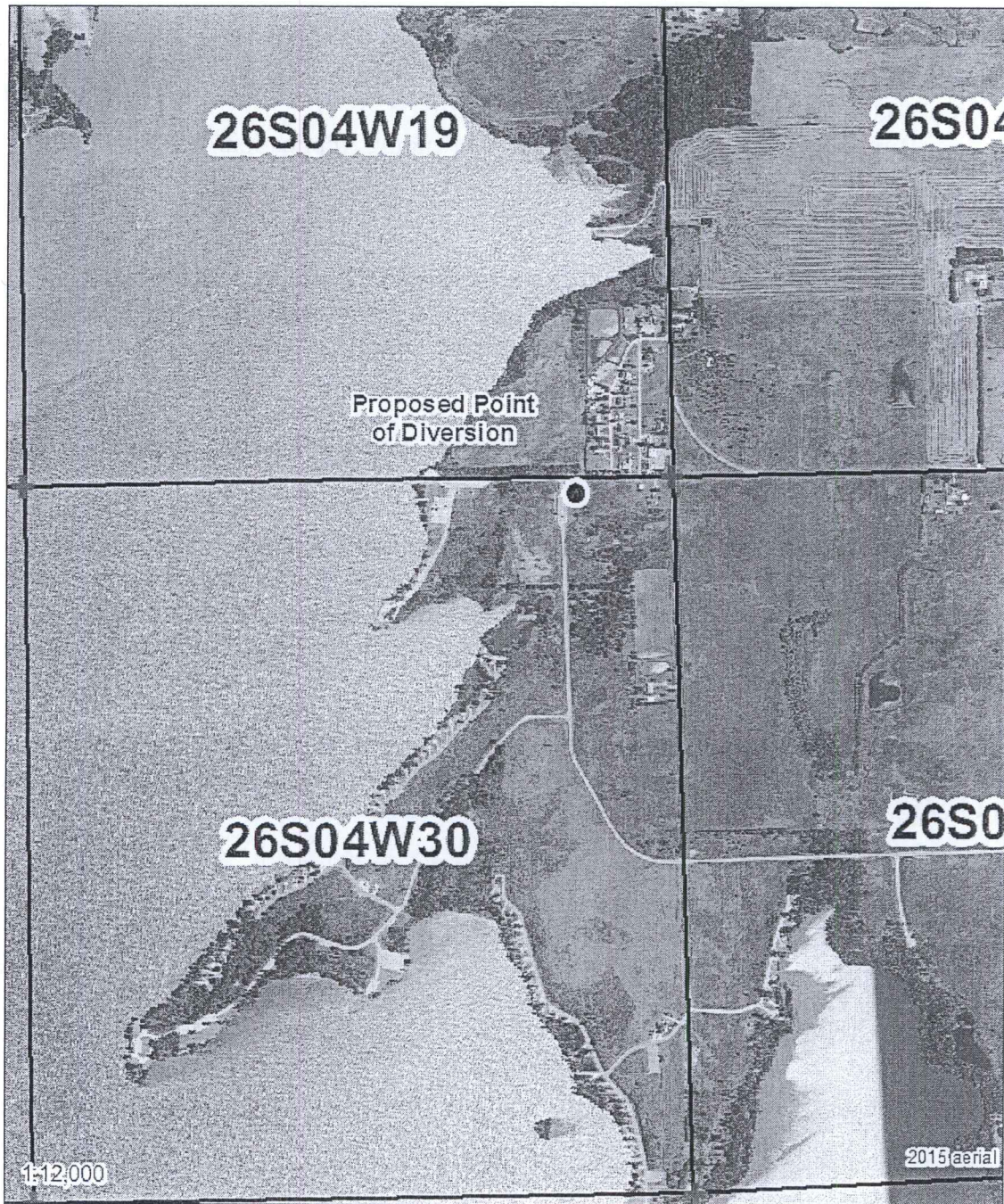

Legend

- + Section Corners
- Section Lines

MJM-DWR 5/25/17

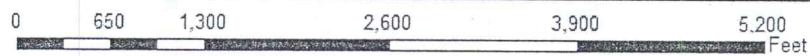

Proposed Water Appropriation, File No. 49,728
30-26S-4W
Reno County



SCANNED

Kansas
Department of Agriculture
Division of Water Resources

Stafford Field Office
300 S. Main Street
Stafford, Kansas 67578-1521

Jackie McClaskey, Secretary
David W. Barfield, Chief Engineer
Jeff Lanterman, Water Commissioner

Phone: (620) 234-5311
Fax: (620) 234-6900
www.agriculture.ks.gov
Sam Brownback, Governor

May 26, 2017

Charles R Williams
25208 S Cedarview Dr
Mount Hope, KS 67108

Re: Pending Application, File No. 49,728

Dear Sir or Madam:

This is to advise you that the Kansas Department of Wildlife, Parks, & Tourism has filed the application referred to above for a permit to appropriate 2 million gallons of groundwater per calendar year for municipal use to be diverted at a maximum rate of 99 gallons per minute. The proposed point of diversion for 49,728 is one (1) well, which located as follows:

In the Northeast Quarter of the Northeast Quarter of the Northeast Quarter of Section 30, Township 26 South, Range 4 West, Reno County, Kansas.

A map is enclosed indicating the location of the proposed well. Records in this office indicate that you may have a well or wells in this vicinity and you are notified of receipt of this application in order that you may be fully informed of the proposed location of the applicant's point of diversion and proposed use of water. Consideration will be given to comments or other information which you desire to submit to this office **within 15 days** from the date of this letter.

If you have any questions or comments, you may also contact me at (620) 234-5311. If you call, please reference the file number so I can help you more efficiently. Mailed comments can be sent to the Stafford Field Office at 300 S. Main St. Stafford, KS 67578-1521.

Sincerely,



Matt Meier
Environmental Scientist
Water Appropriations Program

Enclosure

pc:

SCANNED

Kansas

Department of Agriculture
Division of Water Resources

Stafford Field Office
300 S. Main Street
Stafford, Kansas 67578-1521

Jackie McClaskey, Secretary
David W. Barfield, Chief Engineer
Jeff Lanterman, Water Commissioner

Phone: (620) 234-5311
Fax: (620) 234-6900
www.agriculture.ks.gov
Sam Brownback, Governor

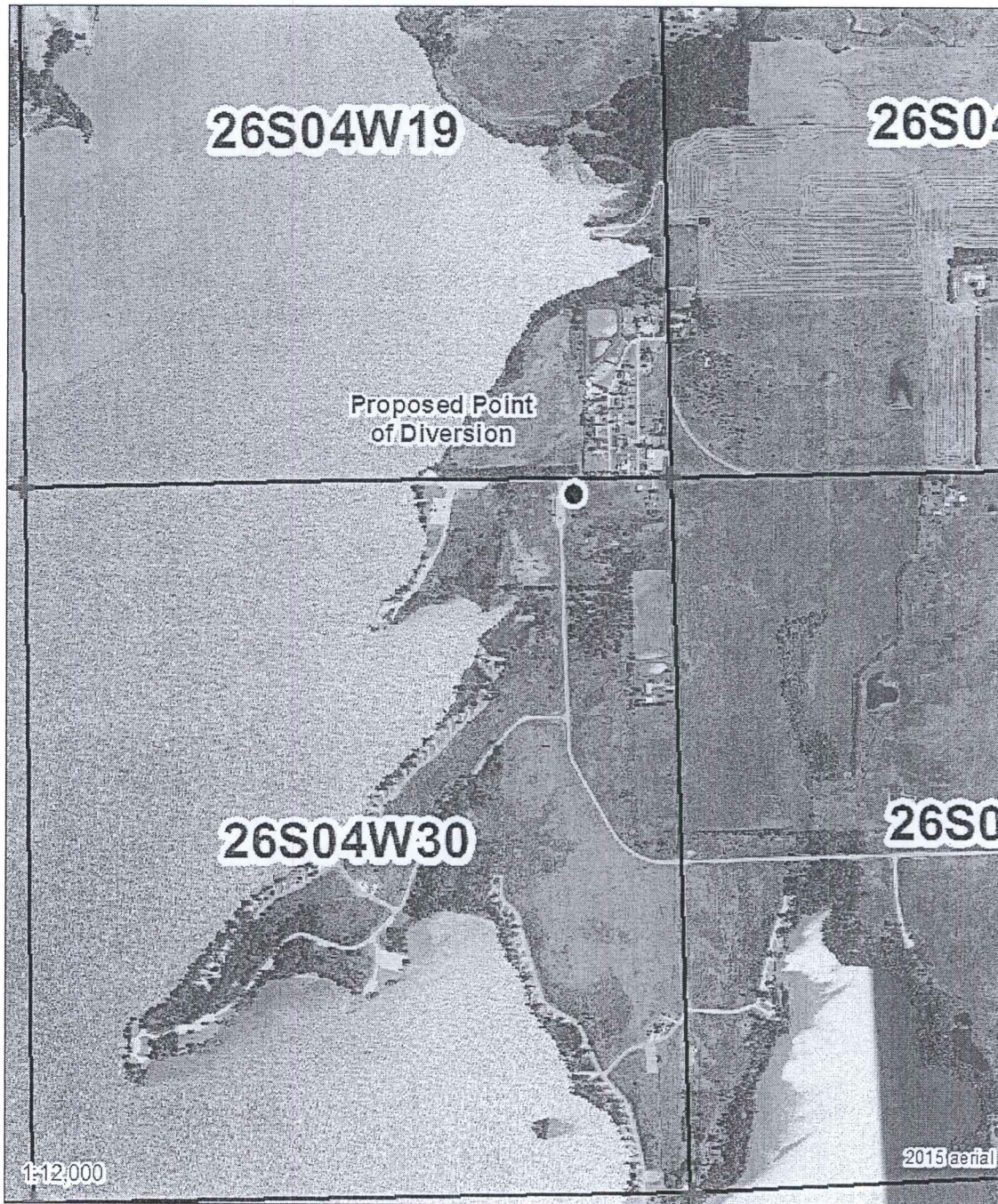

Legend

- + Section Corners
- Section Lines

MJM-DWR 5/25/17

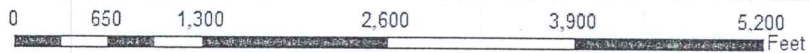

Proposed Water Appropriation, File No. 49,728
30-26S-4W
Reno County



Kansas
Department of Agriculture
Division of Water Resources

Stafford Field Office
300 S. Main Street
Stafford, Kansas 67578-1521

Jackie McClaskey, Secretary
David W. Barfield, Chief Engineer
Jeff Lanterman, Water Commissioner

Phone: (620) 234-5311
Fax: (620) 234-6900
www.agriculture.ks.gov
Sam Brownback, Governor

May 26, 2017

Bobby & Denis Appelhans
25210 S Cedarview Dr
Mount Hope, KS 67108

Re: Pending Application, File No. 49,728

Dear Sir or Madam:

This is to advise you that the Kansas Department of Wildlife, Parks, & Tourism has filed the application referred to above for a permit to appropriate 2 million gallons of groundwater per calendar year for municipal use to be diverted at a maximum rate of 99 gallons per minute. The proposed point of diversion for 49,728 is one (1) well, which located as follows:

In the Northeast Quarter of the Northeast Quarter of the Northeast Quarter of Section 30, Township 26 South, Range 4 West, Reno County, Kansas.

A map is enclosed indicating the location of the proposed well. Records in this office indicate that you may have a well or wells in this vicinity and you are notified of receipt of this application in order that you may be fully informed of the proposed location of the applicant's point of diversion and proposed use of water. Consideration will be given to comments or other information which you desire to submit to this office **within 15 days** from the date of this letter.

If you have any questions or comments, you may also contact me at (620) 234-5311. If you call, please reference the file number so I can help you more efficiently. Mailed comments can be sent to the Stafford Field Office at 300 S. Main St. Stafford, KS 67578-1521.

Sincerely,

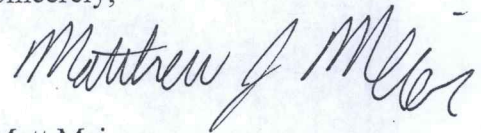

Matt Meier
Environmental Scientist
Water Appropriations Program

Enclosure

pc:

SCANNED

Kansas

Department of Agriculture
Division of Water Resources

Stafford Field Office
300 S. Main Street
Stafford, Kansas 67578-1521

Jackie McClaskey, Secretary
David W. Barfield, Chief Engineer
Jeff Lanterman, Water Commissioner

Phone: (620) 234-5311
Fax: (620) 234-6900
www.agriculture.ks.gov
Sam Brownback, Governor

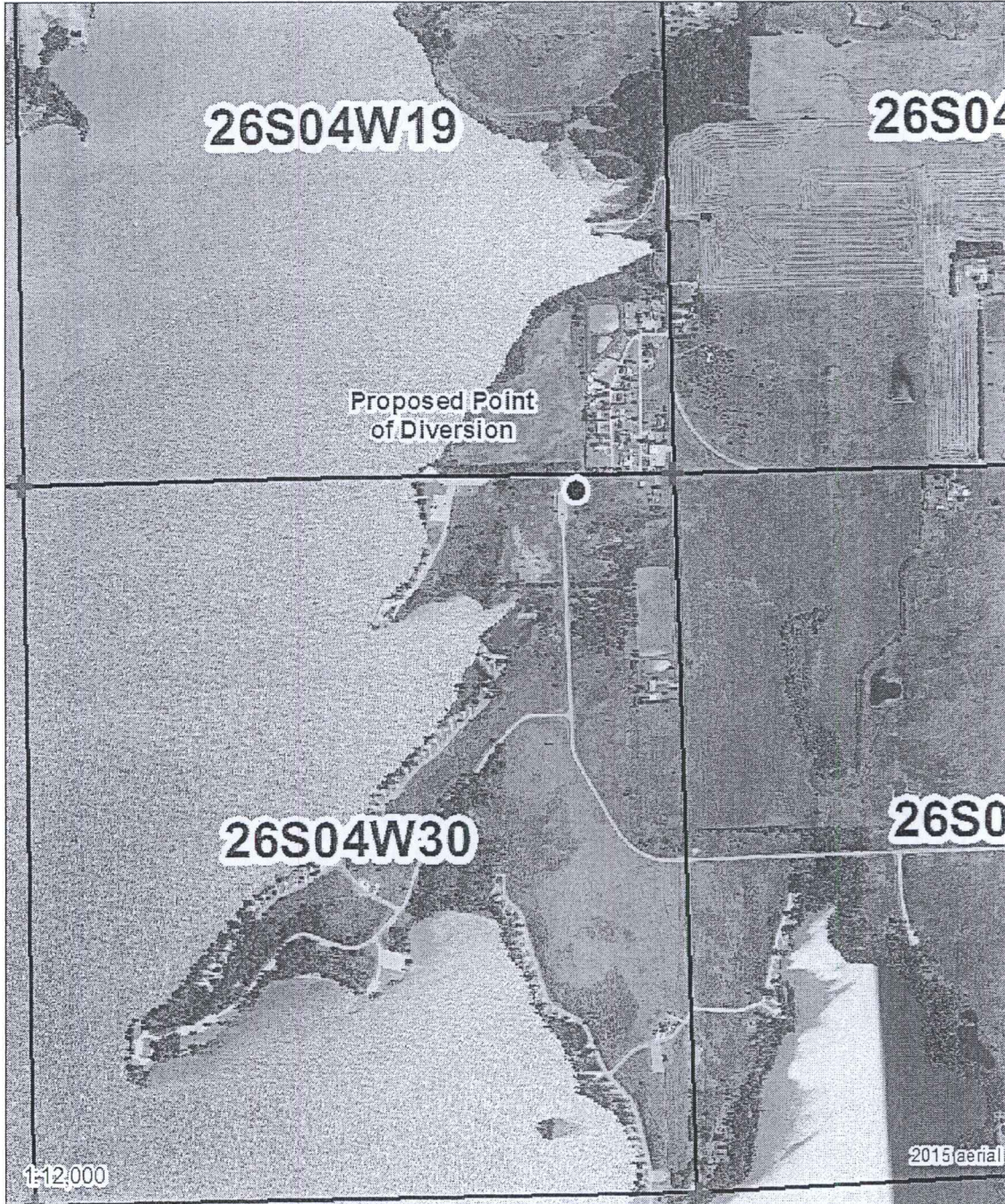

Legend

- + Section Corners
- ▭ Section Lines

MJM-DWR 5/25/17



Proposed Water Appropriation, File No. 49,728
30-26S-4W
Reno County





Stafford Field Office
300 S. Main Street
Stafford, Kansas 67578-1521
Jackie McClaskey, Secretary
David W. Barfield, Chief Engineer
Jeff Lanterman, Water Commissioner

Phone: (620) 234-5311
Fax: (620) 234-6900
www.agriculture.ks.gov
Sam Brownback, Governor

May 26, 2017

Charles & Connie Bellamy
25302 S Cedarview Dr
Mount Hope, KS 67108

Re: Pending Application, File No. 49,728

Dear Sir or Madam:

This is to advise you that the Kansas Department of Wildlife, Parks, & Tourism has filed the application referred to above for a permit to appropriate 2 million gallons of groundwater per calendar year for municipal use to be diverted at a maximum rate of 99 gallons per minute. The proposed point of diversion for 49,728 is one (1) well, which located as follows:

In the Northeast Quarter of the Northeast Quarter of the Northeast Quarter of Section 30, Township 26 South, Range 4 West, Reno County, Kansas.

A map is enclosed indicating the location of the proposed well. Records in this office indicate that you may have a well or wells in this vicinity and you are notified of receipt of this application in order that you may be fully informed of the proposed location of the applicant's point of diversion and proposed use of water. Consideration will be given to comments or other information which you desire to submit to this office **within 15 days** from the date of this letter.

If you have any questions or comments, you may also contact me at (620) 234-5311. If you call, please reference the file number so I can help you more efficiently. Mailed comments can be sent to the Stafford Field Office at 300 S. Main St. Stafford, KS 67578-1521.

Sincerely,

A handwritten signature in black ink that reads "Matthew J. Meier". The signature is written in a cursive, flowing style.

Matt Meier
Environmental Scientist
Water Appropriations Program

Enclosure

pc:

SCANNED

Kansas

Department of Agriculture
Division of Water Resources

Stafford Field Office
300 S. Main Street
Stafford, Kansas 67578-1521
Jackie McClaskey, Secretary
David W. Barfield, Chief Engineer
Jeff Lanterman, Water Commissioner

Phone: (620) 234-5311
Fax: (620) 234-6900
www.agriculture.ks.gov
Sam Brownback, Governor

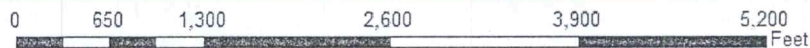
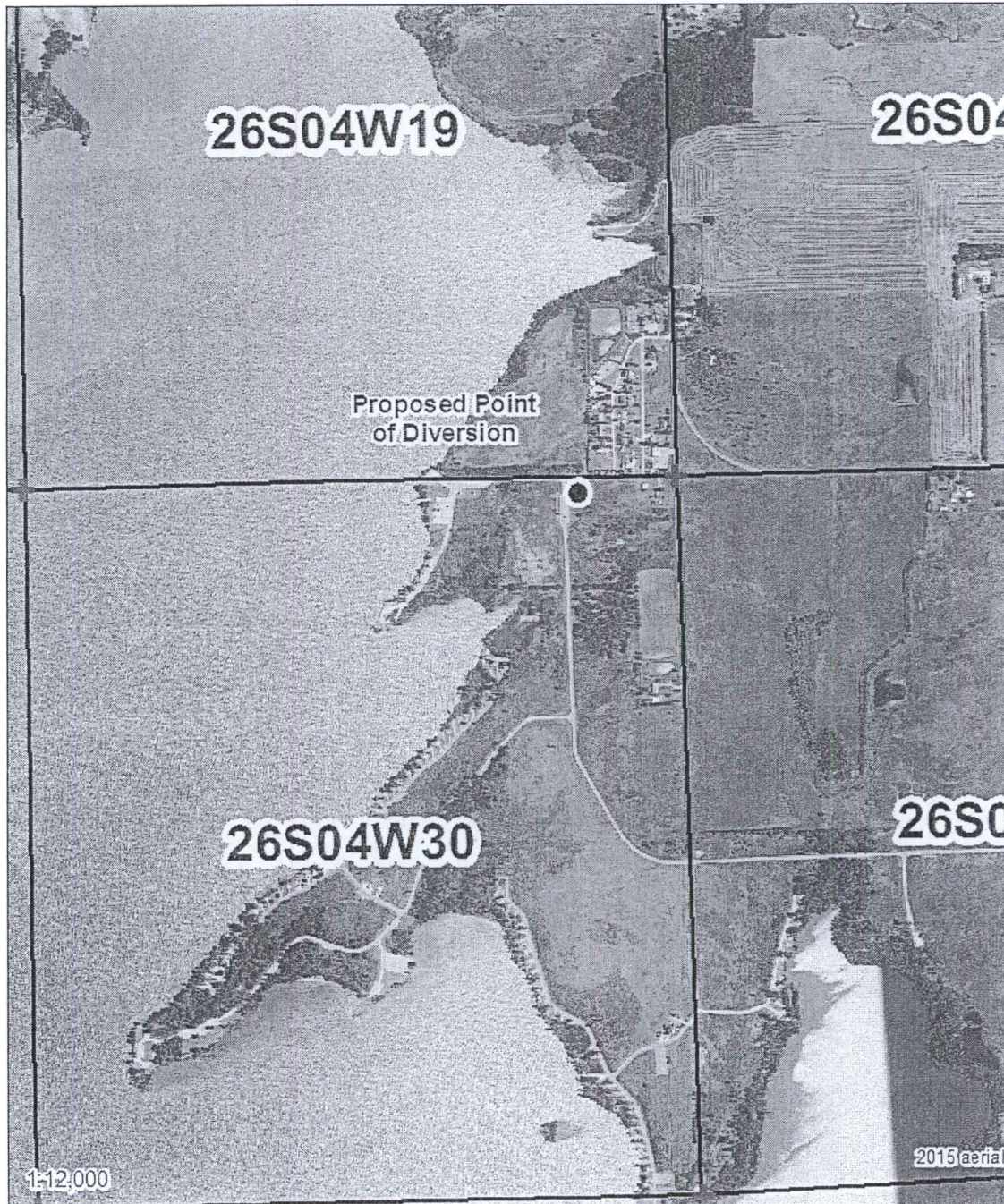

Legend

- Section Corners
- Section Lines

MJM-DWR 5/25/17

Proposed Water Appropriation, File No. 49,728
30-26S-4W
Reno County



SCANNED



Stafford Field Office
300 S. Main Street
Stafford, Kansas 67578-1521
Jackie McClaskey, Secretary
David W. Barfield, Chief Engineer
Jeff Lanterman, Water Commissioner

Phone: (620) 234-5311
Fax: (620) 234-6900
www.agriculture.ks.gov
Sam Brownback, Governor

May 26, 2017

Harold Dodson
25207 S Westview Ln
Mount Hope, KS 67108

Re: Pending Application, File No. 49,728

Dear Sir or Madam:

This is to advise you that the Kansas Department of Wildlife, Parks, & Tourism has filed the application referred to above for a permit to appropriate 2 million gallons of groundwater per calendar year for municipal use to be diverted at a maximum rate of 99 gallons per minute. The proposed point of diversion for 49,728 is one (1) well, which located as follows:

In the Northeast Quarter of the Northeast Quarter of the Northeast Quarter of Section 30, Township 26 South, Range 4 West, Reno County, Kansas.

A map is enclosed indicating the location of the proposed well. Records in this office indicate that you may have a well or wells in this vicinity and you are notified of receipt of this application in order that you may be fully informed of the proposed location of the applicant's point of diversion and proposed use of water. Consideration will be given to comments or other information which you desire to submit to this office **within 15 days** from the date of this letter.

If you have any questions or comments, you may also contact me at (620) 234-5311. If you call, please reference the file number so I can help you more efficiently. Mailed comments can be sent to the Stafford Field Office at 300 S. Main St. Stafford, KS 67578-1521.

Sincerely,

A handwritten signature in black ink that reads "Matthew J Meier".

Matt Meier
Environmental Scientist
Water Appropriations Program

Enclosure

pc:

SCANNED

Kansas

Department of Agriculture
Division of Water Resources

Stafford Field Office
300 S. Main Street
Stafford, Kansas 67578-1521

Jackie McClaskey, Secretary
David W. Barfield, Chief Engineer
Jeff Lanterman, Water Commissioner

Phone: (620) 234-5311
Fax: (620) 234-6900
www.agriculture.ks.gov
Sam Brownback, Governor

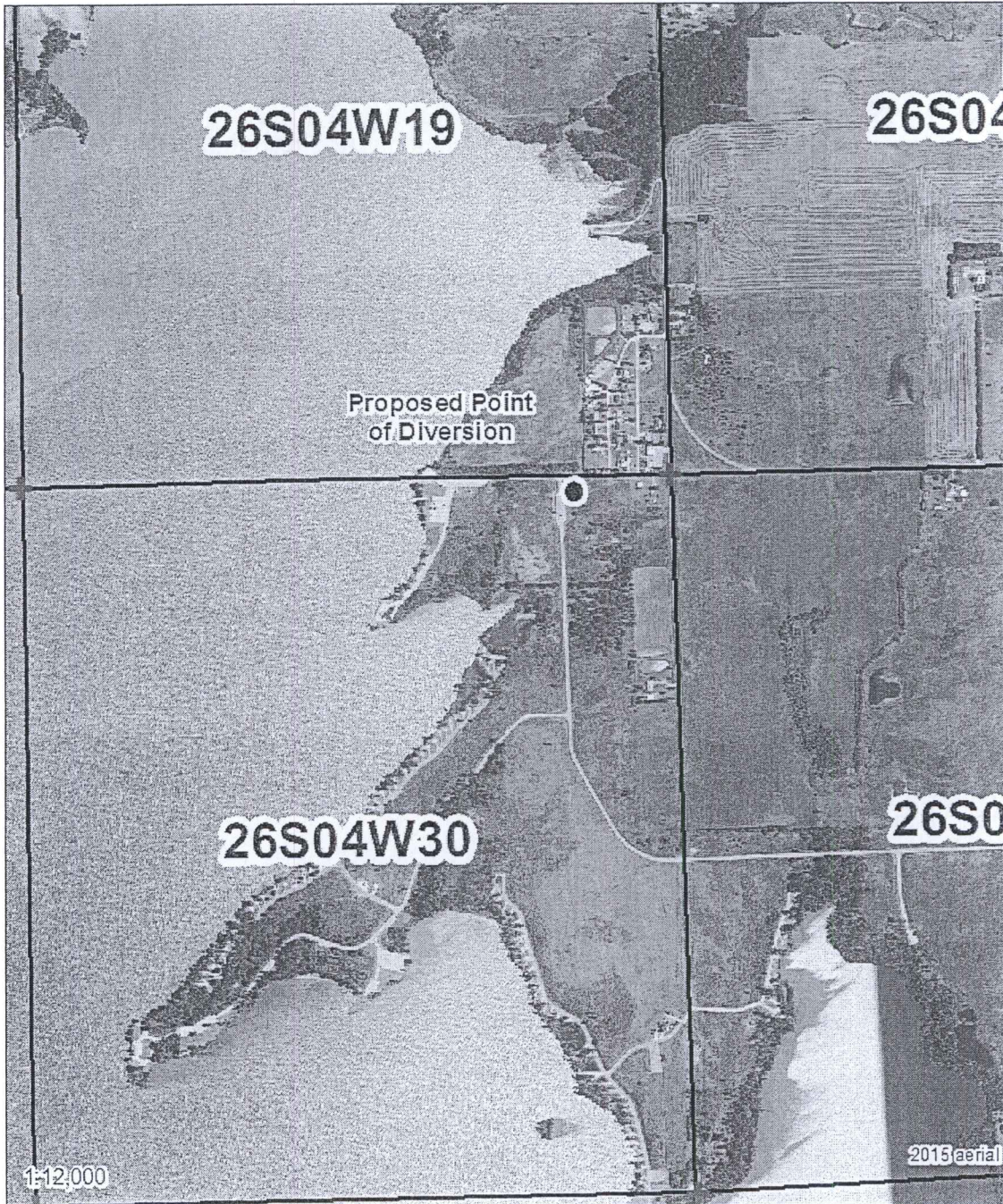

Legend
+ Section Corners
▭ Section Lines

MJM-DWR 5/25/17

Proposed Water Appropriation, File No. 49,728
30-26S-4W
Reno County



Kansas
Department of Agriculture
Division of Water Resources

Stafford Field Office
300 S. Main Street
Stafford, Kansas 67578-1521

Jackie McClaskey, Secretary
David W. Barfield, Chief Engineer
Jeff Lanterman, Water Commissioner

Phone: (620) 234-5311
Fax: (620) 234-6900
www.agriculture.ks.gov
Sam Brownback, Governor

May 26, 2017

Jeffrey & Kimberly Graham
8802 E Boundary Rd
Mount Hope, KS 67108

Re: Pending Application, File No. 49,728

Dear Sir or Madam:

This is to advise you that the Kansas Department of Wildlife, Parks, & Tourism has filed the application referred to above for a permit to appropriate 2 million gallons of groundwater per calendar year for municipal use to be diverted at a maximum rate of 99 gallons per minute. The proposed point of diversion for 49,728 is one (1) well, which located as follows:

In the Northeast Quarter of the Northeast Quarter of the Northeast Quarter of Section 30, Township 26 South, Range 4 West, Reno County, Kansas.

A map is enclosed indicating the location of the proposed well. Records in this office indicate that you may have a well or wells in this vicinity and you are notified of receipt of this application in order that you may be fully informed of the proposed location of the applicant's point of diversion and proposed use of water. Consideration will be given to comments or other information which you desire to submit to this office **within 15 days** from the date of this letter.

If you have any questions or comments, you may also contact me at (620) 234-5311. If you call, please reference the file number so I can help you more efficiently. Mailed comments can be sent to the Stafford Field Office at 300 S. Main St. Stafford, KS 67578-1521.

Sincerely,

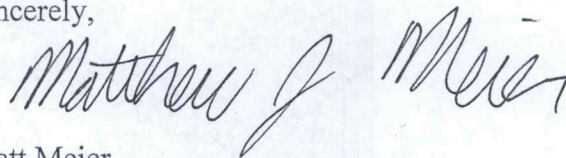

Matt Meier
Environmental Scientist
Water Appropriations Program

Enclosure

pc:

SCANNED

Kansas

Department of Agriculture
Division of Water Resources

Stafford Field Office
300 S. Main Street
Stafford, Kansas 67578-1521
Jackie McClaskey, Secretary
David W. Barfield, Chief Engineer
Jeff Lanterman, Water Commissioner

Phone: (620) 234-5311
Fax: (620) 234-6900
www.agriculture.ks.gov
Sam Brownback, Governor

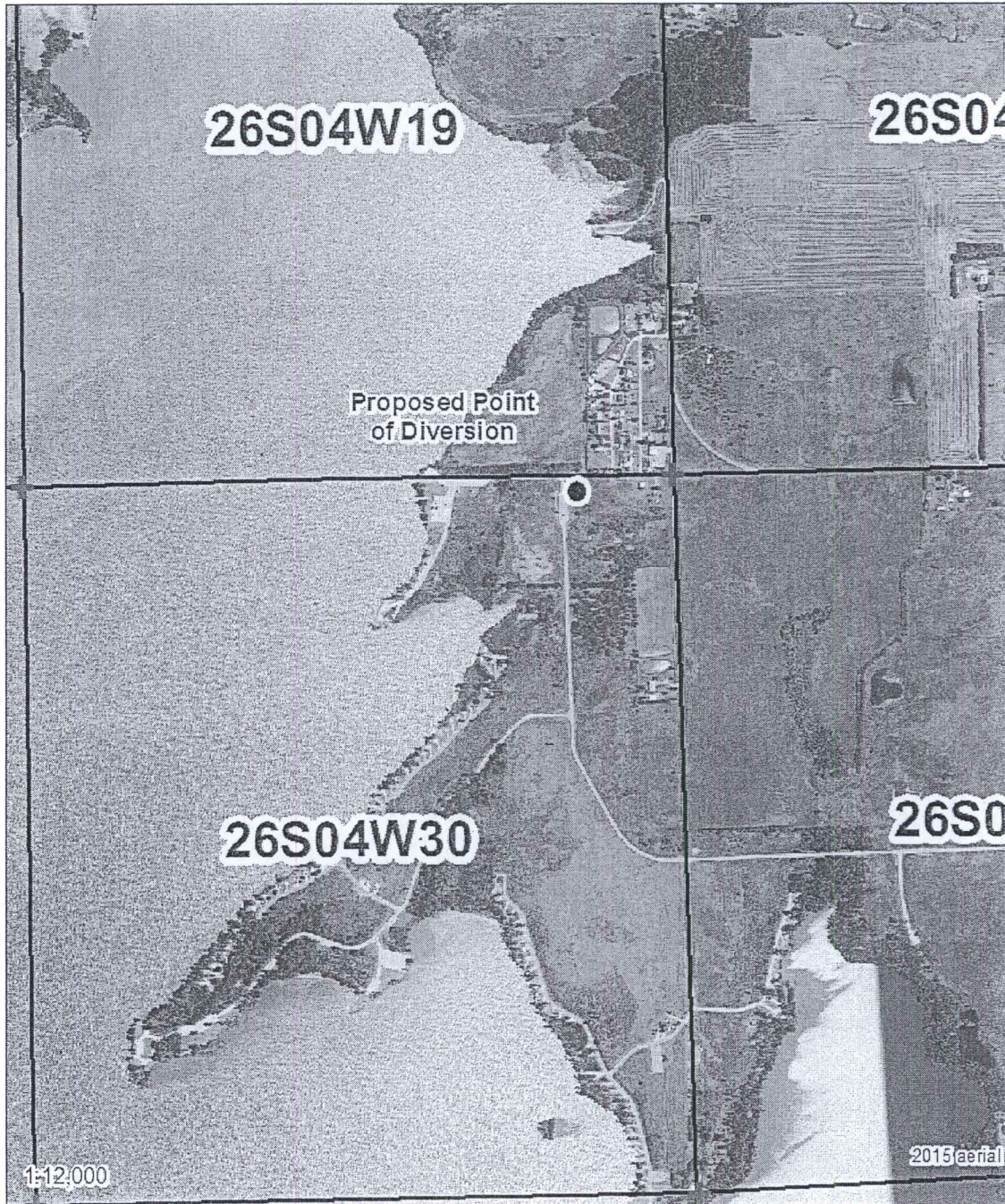

Legend

- + Section Corners
- ▭ Section Lines

MJM-DWR 5/25/17



Proposed Water Appropriation, File No. 49,728
30-26S-4W
Reno County



SCANNED

Kansas
Department of Agriculture
Division of Water Resources

Stafford Field Office
300 S. Main Street
Stafford, Kansas 67578-1521
Jackie McClaskey, Secretary
David W. Barfield, Chief Engineer
Jeff Lanterman, Water Commissioner

Phone: (620) 234-5311
Fax: (620) 234-6900
www.agriculture.ks.gov
Sam Brownback, Governor

May 26, 2017

Edward Lynn Baker
8814 E Boundary Rd
Mount Hope, KS 67108

Re: Pending Application, File No. 49,728

Dear Sir or Madam:

This is to advise you that the Kansas Department of Wildlife, Parks, & Tourism has filed the application referred to above for a permit to appropriate 2 million gallons of groundwater per calendar year for municipal use to be diverted at a maximum rate of 99 gallons per minute. The proposed point of diversion for 49,728 is one (1) well, which located as follows:

In the Northeast Quarter of the Northeast Quarter of the Northeast Quarter of Section 30, Township 26 South, Range 4 West, Reno County, Kansas.

A map is enclosed indicating the location of the proposed well. Records in this office indicate that you may have a well or wells in this vicinity and you are notified of receipt of this application in order that you may be fully informed of the proposed location of the applicant's point of diversion and proposed use of water. Consideration will be given to comments or other information which you desire to submit to this office **within 15 days** from the date of this letter.

If you have any questions or comments, you may also contact me at (620) 234-5311. If you call, please reference the file number so I can help you more efficiently. Mailed comments can be sent to the Stafford Field Office at 300 S. Main St. Stafford, KS 67578-1521.

Sincerely,

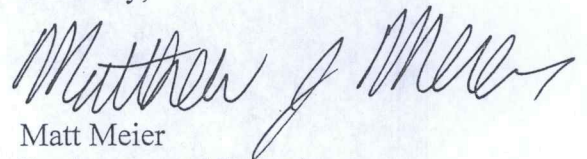

Matt Meier
Environmental Scientist
Water Appropriations Program

Enclosure

pc:

SCANNED

Kansas

Department of Agriculture
Division of Water Resources

Stafford Field Office
300 S. Main Street
Stafford, Kansas 67578-1521

Jackie McClaskey, Secretary
David W. Barfield, Chief Engineer
Jeff Lanterman, Water Commissioner

Phone: (620) 234-5311
Fax: (620) 234-6900
www.agriculture.ks.gov
Sam Brownback, Governor



Legend

- Section Corners
- Section Lines

MJM-DWR 5/25/17

Proposed Water Appropriation, File No. 49,728
30-26S-4W
Reno County



SCANNED

Kansas
Department of Agriculture
Division of Water Resources

Stafford Field Office
300 S. Main Street
Stafford, Kansas 67578-1521
Jackie McClaskey, Secretary
David W. Barfield, Chief Engineer
Jeff Lanterman, Water Commissioner

Phone: (620) 234-5311
Fax: (620) 234-6900
www.agriculture.ks.gov
Sam Brownback, Governor

May 26, 2017

Otto Contracting Inc
10907 S Halstead St
Hutchinson, KS 67501

Re: Pending Application, File No. 49,728

Dear Sir or Madam:

This is to advise you that the Kansas Department of Wildlife, Parks, & Tourism has filed the application referred to above for a permit to appropriate 2 million gallons of groundwater per calendar year for municipal use to be diverted at a maximum rate of 99 gallons per minute. The proposed point of diversion for 49,728 is one (1) well, which located as follows:

In the Northeast Quarter of the Northeast Quarter of the Northeast Quarter of Section 30, Township 26 South, Range 4 West, Reno County, Kansas.

A map is enclosed indicating the location of the proposed well. Records in this office indicate that you may have a well or wells in this vicinity and you are notified of receipt of this application in order that you may be fully informed of the proposed location of the applicant's point of diversion and proposed use of water. Consideration will be given to comments or other information which you desire to submit to this office **within 15 days** from the date of this letter.

If you have any questions or comments, you may also contact me at (620) 234-5311. If you call, please reference the file number so I can help you more efficiently. Mailed comments can be sent to the Stafford Field Office at 300 S. Main St. Stafford, KS 67578-1521.

Sincerely,

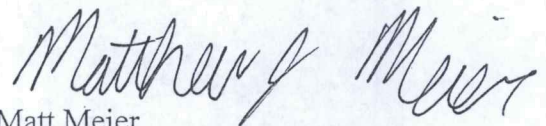

Matt Meier
Environmental Scientist
Water Appropriations Program

Enclosure

pc:

SCANNED

Kansas

Department of Agriculture
Division of Water Resources

Stafford Field Office
300 S. Main Street
Stafford, Kansas 67578-1521
Jackie McClaskey, Secretary
David W. Barfield, Chief Engineer
Jeff Lanterman, Water Commissioner

Phone: (620) 234-5311
Fax: (620) 234-6900
www.agriculture.ks.gov
Sam Brownback, Governor

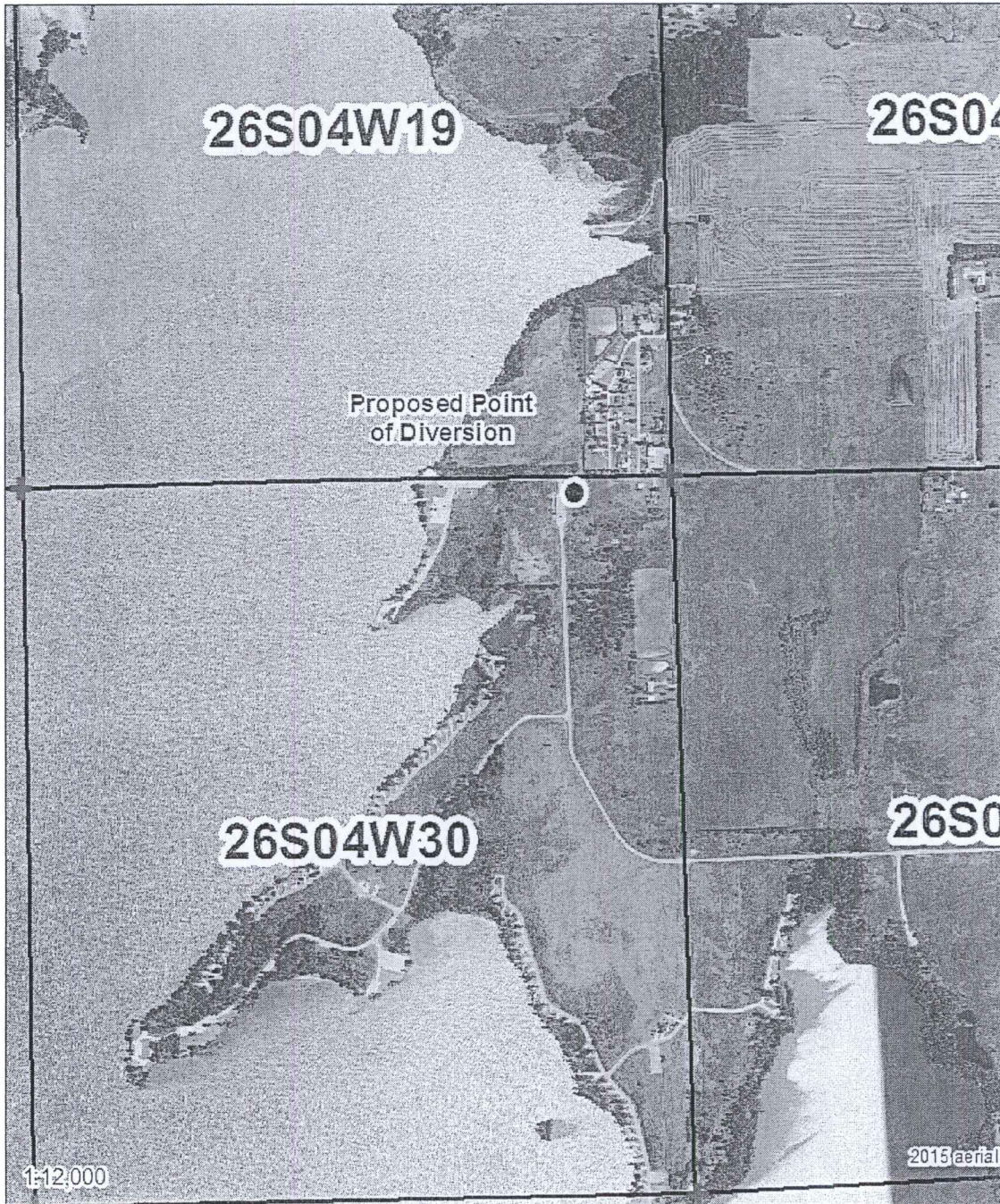

Legend

- Section Corners
- Section Lines

MJM-DWR 5/25/17

Proposed Water Appropriation, File No. 49,728
30-26S-4W
Reno County



Kansas
Department of Agriculture
Division of Water Resources

Stafford Field Office
300 S. Main Street
Stafford, Kansas 67578-1521
Jackie McClaskey, Secretary
David W. Barfield, Chief Engineer
Jeff Lanterman, Water Commissioner

Phone: (620) 234-5311
Fax: (620) 234-6900
www.agriculture.ks.gov
Sam Brownback, Governor

May 26, 2017

Darrell & Marie Sober
25306 S Westview Ln
Mount Hope, KS 67108

Re: Pending Application, File No. 49,728

Dear Sir or Madam:

This is to advise you that the Kansas Department of Wildlife, Parks, & Tourism has filed the application referred to above for a permit to appropriate 2 million gallons of groundwater per calendar year for municipal use to be diverted at a maximum rate of 99 gallons per minute. The proposed point of diversion for 49,728 is one (1) well, which located as follows:

In the Northeast Quarter of the Northeast Quarter of the Northeast Quarter of Section 30, Township 26 South, Range 4 West, Reno County, Kansas.

A map is enclosed indicating the location of the proposed well. Records in this office indicate that you may have a well or wells in this vicinity and you are notified of receipt of this application in order that you may be fully informed of the proposed location of the applicant's point of diversion and proposed use of water. Consideration will be given to comments or other information which you desire to submit to this office **within 15 days** from the date of this letter.

If you have any questions or comments, you may also contact me at (620) 234-5311. If you call, please reference the file number so I can help you more efficiently. Mailed comments can be sent to the Stafford Field Office at 300 S. Main St. Stafford, KS 67578-1521.

Sincerely,

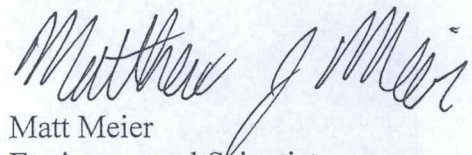

Matt Meier
Environmental Scientist
Water Appropriations Program

Enclosure

pc:

SCANNED

Kansas

Department of Agriculture
Division of Water Resources

Stafford Field Office
300 S. Main Street
Stafford, Kansas 67578-1521
Jackie McClaskey, Secretary
David W. Barfield, Chief Engineer
Jeff Lanterman, Water Commissioner

Phone: (620) 234-5311
Fax: (620) 234-6900
www.agriculture.ks.gov
Sam Brownback, Governor

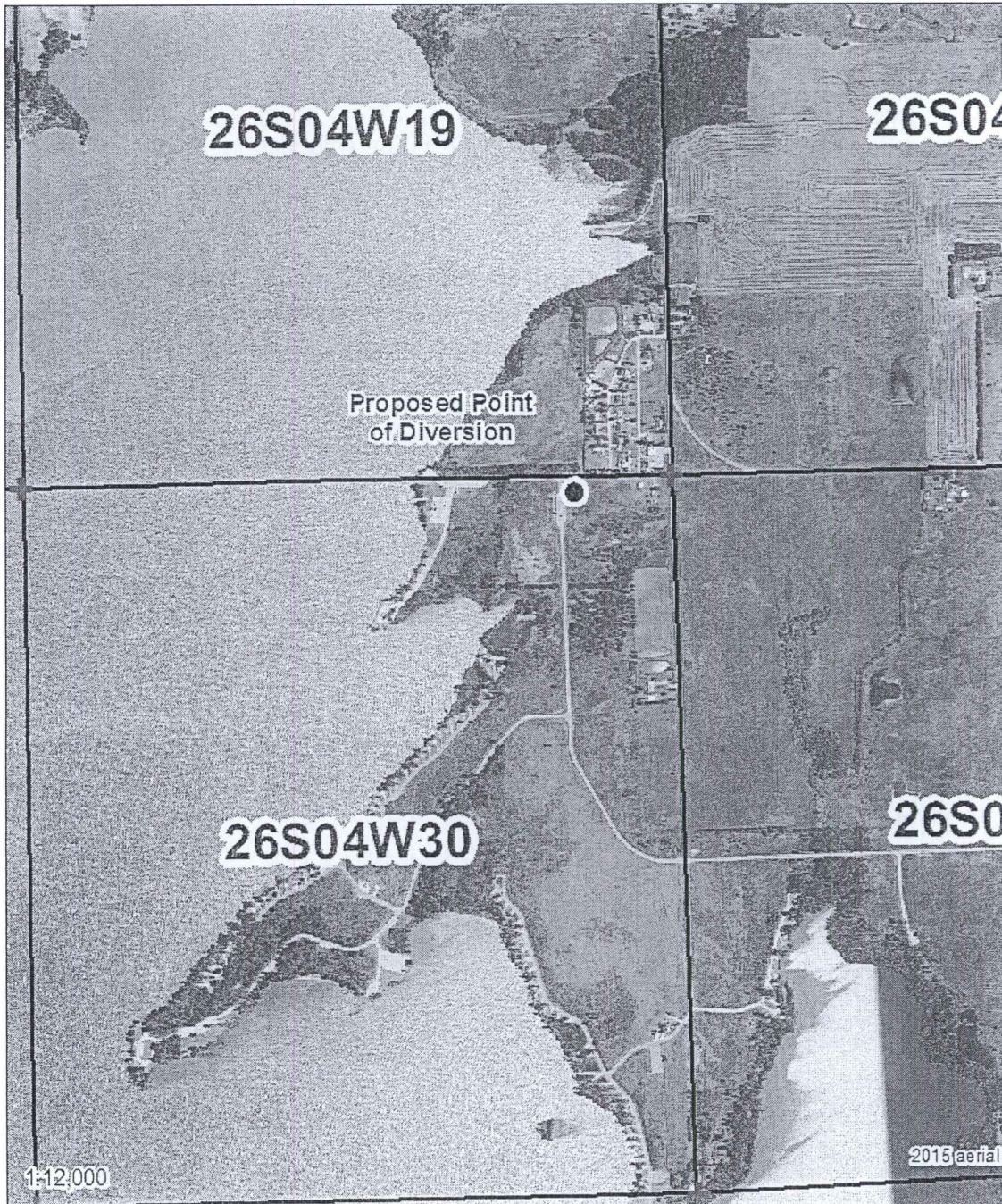

0 650 1,300 2,600 3,900 5,200 Feet

Legend
+ Section Corners
Section Lines
MJM-DWR 5/25/17

Proposed Water Appropriation, File No. 49,728
30-26S-4W
Reno County



Kansas
Department of Agriculture
Division of Water Resources

Stafford Field Office
300 S. Main Street
Stafford, Kansas 67578-1521
Jackie McClaskey, Secretary
David W. Barfield, Chief Engineer
Jeff Lanterman, Water Commissioner

Phone: (620) 234-5311
Fax: (620) 234-6900
www.agriculture.ks.gov
Sam Brownback, Governor

May 26, 2017

James & Alicia Branson
25303 S Willison Rd
Mount Hope, KS 67108

Re: Pending Application, File No. 49,728

Dear Sir or Madam:

This is to advise you that the Kansas Department of Wildlife, Parks, & Tourism has filed the application referred to above for a permit to appropriate 2 million gallons of groundwater per calendar year for municipal use to be diverted at a maximum rate of 99 gallons per minute. The proposed point of diversion for 49,728 is one (1) well, which located as follows:

In the Northeast Quarter of the Northeast Quarter of the Northeast Quarter of Section 30, Township 26 South, Range 4 West, Reno County, Kansas.

A map is enclosed indicating the location of the proposed well. Records in this office indicate that you may have a well or wells in this vicinity and you are notified of receipt of this application in order that you may be fully informed of the proposed location of the applicant's point of diversion and proposed use of water. Consideration will be given to comments or other information which you desire to submit to this office **within 15 days** from the date of this letter.

If you have any questions or comments, you may also contact me at (620) 234-5311. If you call, please reference the file number so I can help you more efficiently. Mailed comments can be sent to the Stafford Field Office at 300 S. Main St. Stafford, KS 67578-1521.

Sincerely,

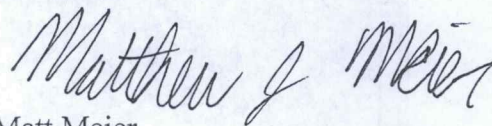

Matt Meier
Environmental Scientist
Water Appropriations Program

Enclosure

pc:

SCANNED

Kansas

Department of Agriculture
Division of Water Resources

Stafford Field Office
300 S. Main Street
Stafford, Kansas 67578-1521
Jackie McClaskey, Secretary
David W. Barfield, Chief Engineer
Jeff Lanterman, Water Commissioner

Phone: (620) 234-5311
Fax: (620) 234-6900
www.agriculture.ks.gov
Sam Brownback, Governor

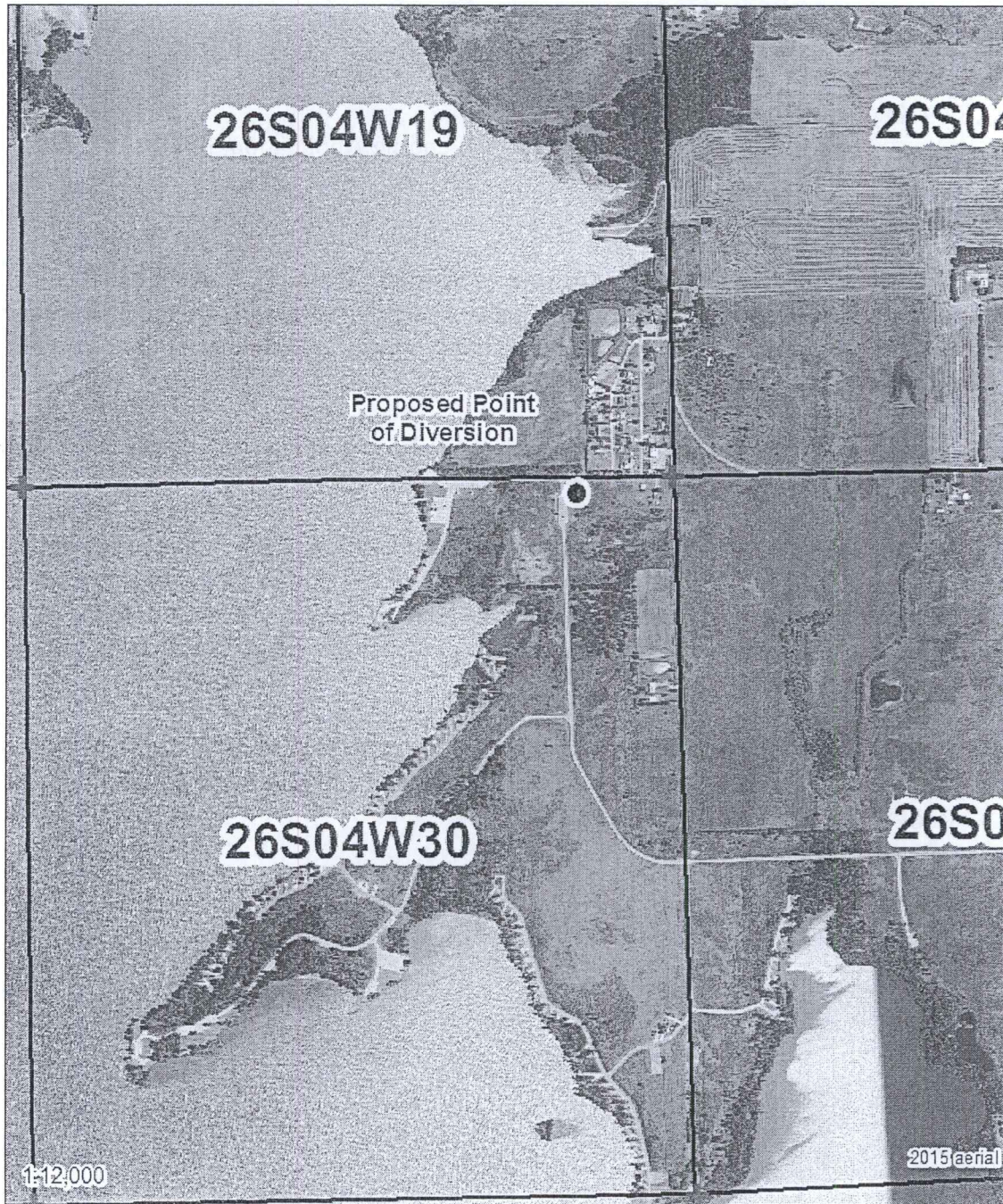

Legend

- + Section Corners
- Section Lines

MJM-DWR 5/25/17

Proposed Water Appropriation, File No. 49,728
30-26S-4W
Reno County



Kansas
Department of Agriculture
Division of Water Resources

Stafford Field Office
300 S. Main Street
Stafford, Kansas 67578-1521

Jackie McClaskey, Secretary
David W. Barfield, Chief Engineer
Jeff Lanterman, Water Commissioner

Phone: (620) 234-5311
Fax: (620) 234-6900
www.agriculture.ks.gov

Sam Brownback, Governor

May 26, 2017

Theodore Robert Bergkamp
25202 Westview Ln
Mount Hope, KS 67108

Re: Pending Application, File No. 49,728

Dear Sir or Madam:

This is to advise you that the Kansas Department of Wildlife, Parks, & Tourism has filed the application referred to above for a permit to appropriate 2 million gallons of groundwater per calendar year for municipal use to be diverted at a maximum rate of 99 gallons per minute. The proposed point of diversion for 49,728 is one (1) well, which located as follows:

In the Northeast Quarter of the Northeast Quarter of the Northeast Quarter of Section 30, Township 26 South, Range 4 West, Reno County, Kansas.

A map is enclosed indicating the location of the proposed well. Records in this office indicate that you may have a well or wells in this vicinity and you are notified of receipt of this application in order that you may be fully informed of the proposed location of the applicant's point of diversion and proposed use of water. Consideration will be given to comments or other information which you desire to submit to this office **within 15 days** from the date of this letter.

If you have any questions or comments, you may also contact me at (620) 234-5311. If you call, please reference the file number so I can help you more efficiently. Mailed comments can be sent to the Stafford Field Office at 300 S. Main St. Stafford, KS 67578-1521.

Sincerely,

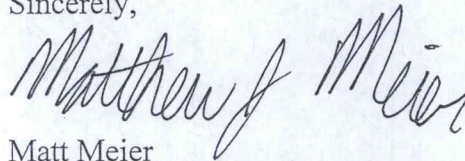

Matt Meier
Environmental Scientist
Water Appropriations Program

Enclosure

pc:

SCANNED

Kansas

Department of Agriculture
Division of Water Resources

Stafford Field Office
300 S. Main Street
Stafford, Kansas 67578-1521
Jackie McClaskey, Secretary
David W. Barfield, Chief Engineer
Jeff Lanterman, Water Commissioner

Phone: (620) 234-5311
Fax: (620) 234-6900
www.agriculture.ks.gov
Sam Brownback, Governor

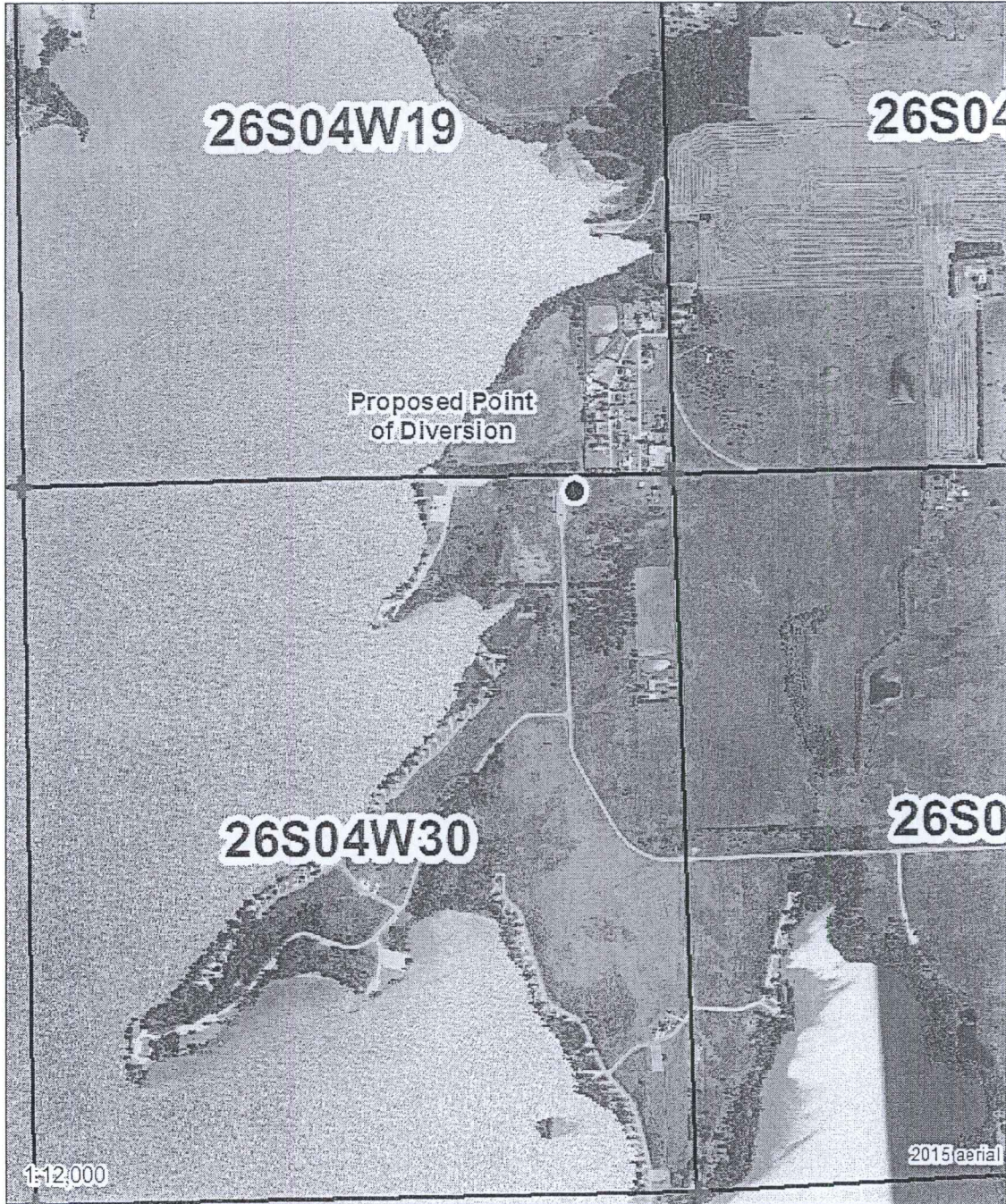

Legend
+ Section Corners
□ Section Lines
MJM-DWR 5/25/17

0 650 1,300 2,600 3,900 5,200 Feet

Proposed Water Appropriation, File No. 49,728
30-26S-4W
Reno County



Kansas
Department of Agriculture
Division of Water Resources

Stafford Field Office
300 S. Main Street
Stafford, Kansas 67578-1521
Jackie McClaskey, Secretary
David W. Barfield, Chief Engineer
Jeff Lanterman, Water Commissioner

Phone: (620) 234-5311
Fax: (620) 234-6900
www.agriculture.ks.gov
Sam Brownback, Governor

May 26, 2017

Bobby Day
8407 SE 81st St
Galena, KS 66739

Re: Pending Application, File No. 49,728

Dear Sir or Madam:

This is to advise you that the Kansas Department of Wildlife, Parks, & Tourism has filed the application referred to above for a permit to appropriate 2 million gallons of groundwater per calendar year for municipal use to be diverted at a maximum rate of 99 gallons per minute. The proposed point of diversion for 49,728 is one (1) well, which located as follows:

In the Northeast Quarter of the Northeast Quarter of the Northeast Quarter of Section 30, Township 26 South, Range 4 West, Reno County, Kansas.

A map is enclosed indicating the location of the proposed well. Records in this office indicate that you may have a well or wells in this vicinity and you are notified of receipt of this application in order that you may be fully informed of the proposed location of the applicant's point of diversion and proposed use of water. Consideration will be given to comments or other information which you desire to submit to this office **within 15 days** from the date of this letter.

If you have any questions or comments, you may also contact me at (620) 234-5311. If you call, please reference the file number so I can help you more efficiently. Mailed comments can be sent to the Stafford Field Office at 300 S. Main St. Stafford, KS 67578-1521.

Sincerely,

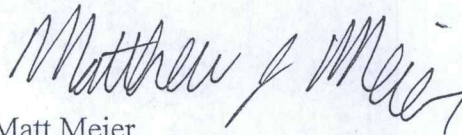

Matt Meier
Environmental Scientist
Water Appropriations Program

Enclosure

pc:

SCANNED

Kansas

Department of Agriculture
Division of Water Resources

Stafford Field Office
300 S. Main Street
Stafford, Kansas 67578-1521
Jackie McClaskey, Secretary
David W. Barfield, Chief Engineer
Jeff Lanterman, Water Commissioner

Phone: (620) 234-5311
Fax: (620) 234-6900
www.agriculture.ks.gov
Sam Brownback, Governor

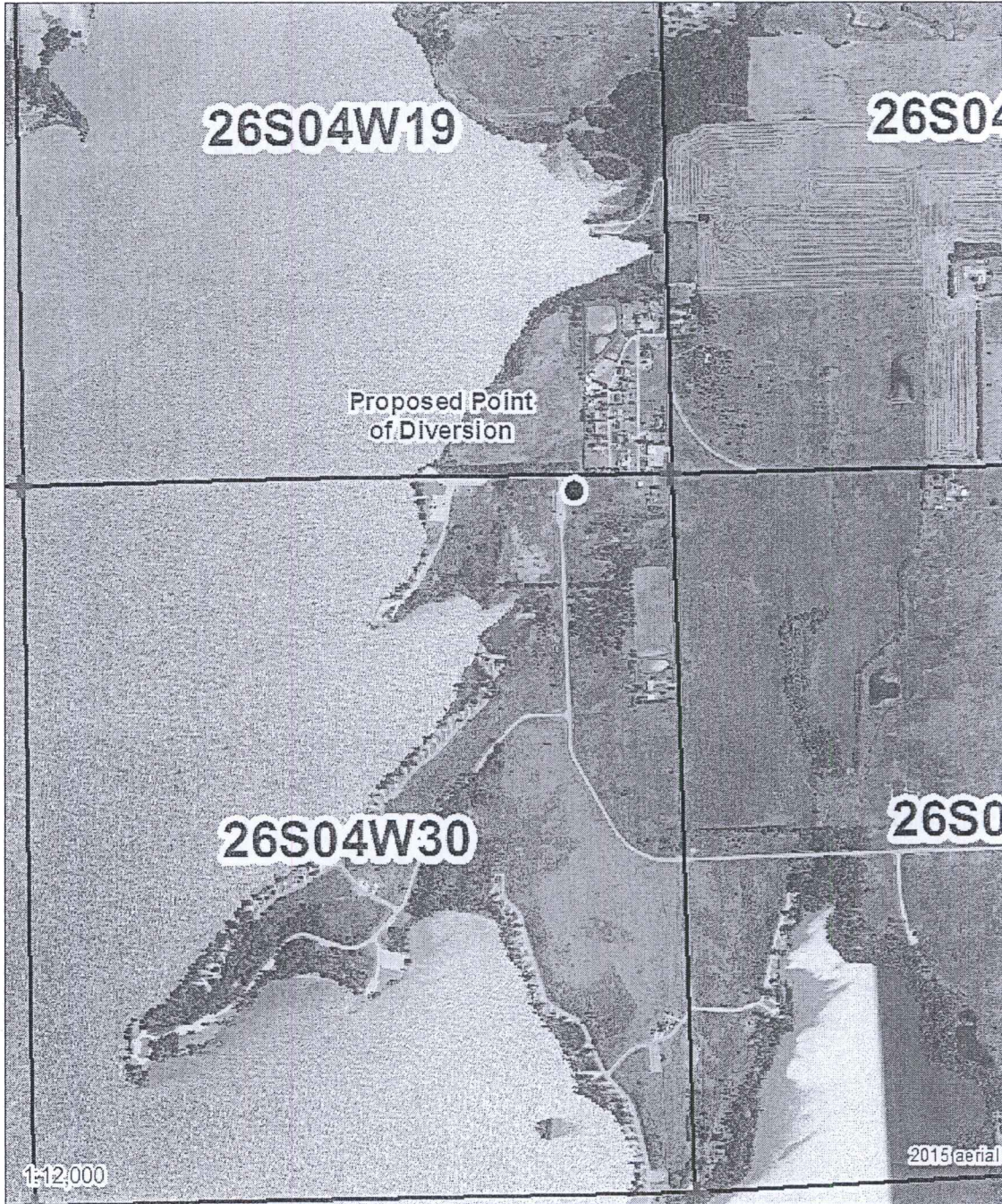

Legend

- + Section Corners
- Section Lines

MJM-DWR 5/25/17

0 650 1,300 2,600 3,900 5,200 Feet

Proposed Water Appropriation, File No. 49,728
30-26S-4W
Reno County





Stafford Field Office
300 S. Main Street
Stafford, Kansas 67578-1521
Jackie McClaskey, Secretary
David W. Barfield, Chief Engineer
Jeff Lanterman, Water Commissioner

Phone: (620) 234-5311
Fax: (620) 234-6900
www.agriculture.ks.gov
Sam Brownback, Governor

May 26, 2017

Timothy Howard
8814 E Cedarview Dr
Mount Hope, KS 67108

Re: Pending Application, File No. 49,728

Dear Sir or Madam:

This is to advise you that the Kansas Department of Wildlife, Parks, & Tourism has filed the application referred to above for a permit to appropriate 2 million gallons of groundwater per calendar year for municipal use to be diverted at a maximum rate of 99 gallons per minute. The proposed point of diversion for 49,728 is one (1) well, which located as follows:

In the Northeast Quarter of the Northeast Quarter of the Northeast Quarter of Section 30, Township 26 South, Range 4 West, Reno County, Kansas.

A map is enclosed indicating the location of the proposed well. Records in this office indicate that you may have a well or wells in this vicinity and you are notified of receipt of this application in order that you may be fully informed of the proposed location of the applicant's point of diversion and proposed use of water. Consideration will be given to comments or other information which you desire to submit to this office **within 15 days** from the date of this letter.

If you have any questions or comments, you may also contact me at (620) 234-5311. If you call, please reference the file number so I can help you more efficiently. Mailed comments can be sent to the Stafford Field Office at 300 S. Main St. Stafford, KS 67578-1521.

Sincerely,

A handwritten signature in black ink that reads "Matthew J. Meier".

Matt Meier
Environmental Scientist
Water Appropriations Program

Enclosure

pc:

SCANNED

Kansas

Department of Agriculture
Division of Water Resources

Stafford Field Office
300 S. Main Street
Stafford, Kansas 67578-1521
Jackie McClaskey, Secretary
David W. Barfield, Chief Engineer
Jeff Lanterman, Water Commissioner

Phone: (620) 234-5311
Fax: (620) 234-6900
www.agriculture.ks.gov
Sam Brownback, Governor

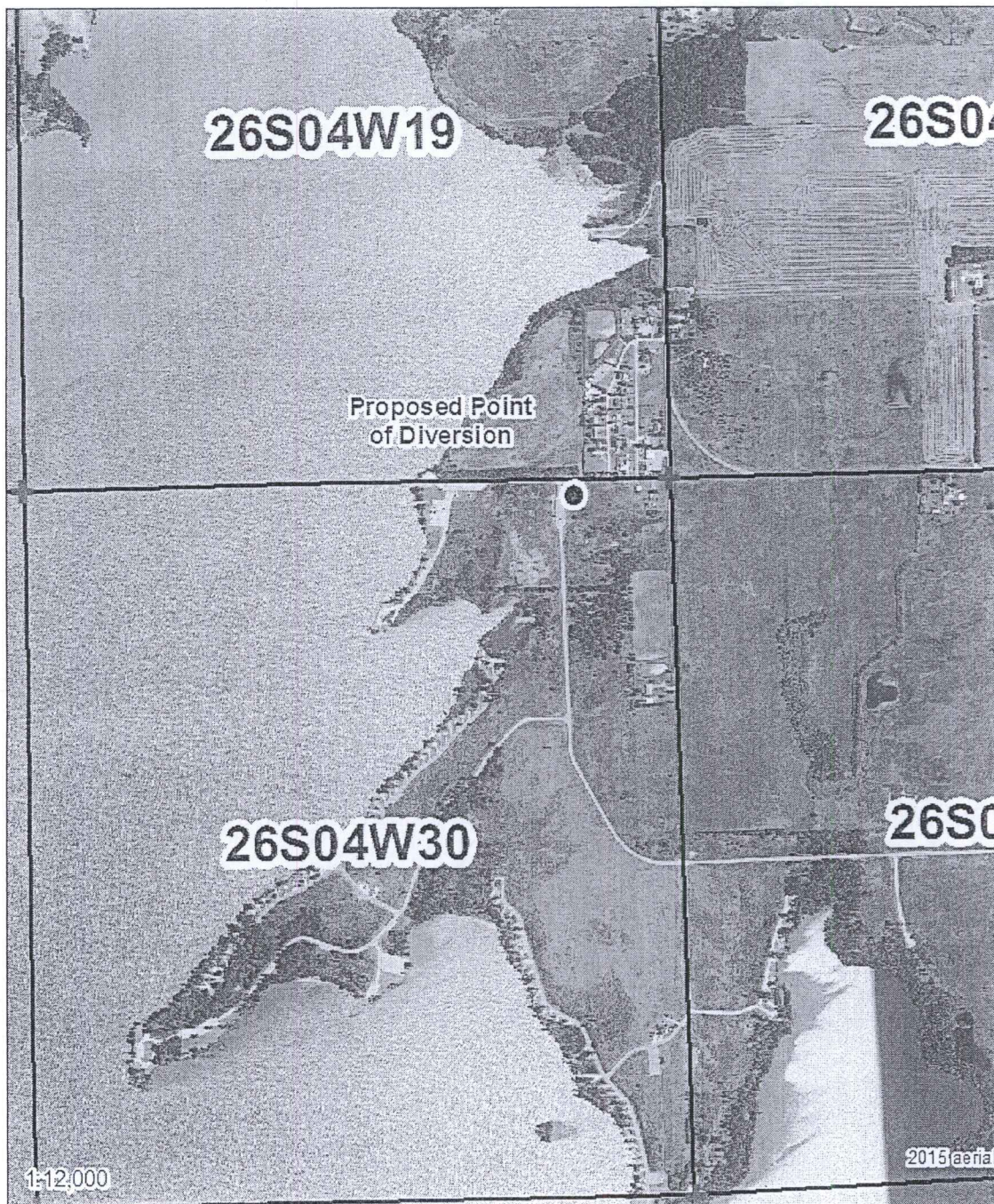

0 650 1,300 2,600 3,900 5,200 Feet

Legend
+ Section Corners
Section Lines

MJM-DWR 5/25/17

Proposed Water Appropriation, File No. 49,728
30-26S-4W
Reno County



Kansas
Department of Agriculture
Division of Water Resources

Stafford Field Office
300 S. Main Street
Stafford, Kansas 67578-1521
Jackie McClaskey, Secretary
David W. Barfield, Chief Engineer
Jeff Lanterman, Water Commissioner

Phone: (620) 234-5311
Fax: (620) 234-6900
www.agriculture.ks.gov
Sam Brownback, Governor

May 26, 2017

Sheila E Martin
12 Countryside RD
Hutchinson, KS 67502

Re: Pending Application, File No. 49,728

Dear Sir or Madam:

This is to advise you that the Kansas Department of Wildlife, Parks, & Tourism has filed the application referred to above for a permit to appropriate 2 million gallons of groundwater per calendar year for municipal use to be diverted at a maximum rate of 99 gallons per minute. The proposed point of diversion for 49,728 is one (1) well, which located as follows:

In the Northeast Quarter of the Northeast Quarter of the Northeast Quarter of Section 30, Township 26 South, Range 4 West, Reno County, Kansas.

A map is enclosed indicating the location of the proposed well. Records in this office indicate that you may have a well or wells in this vicinity and you are notified of receipt of this application in order that you may be fully informed of the proposed location of the applicant's point of diversion and proposed use of water. Consideration will be given to comments or other information which you desire to submit to this office **within 15 days** from the date of this letter.

If you have any questions or comments, you may also contact me at (620) 234-5311. If you call, please reference the file number so I can help you more efficiently. Mailed comments can be sent to the Stafford Field Office at 300 S. Main St. Stafford, KS 67578-1521.

Sincerely,

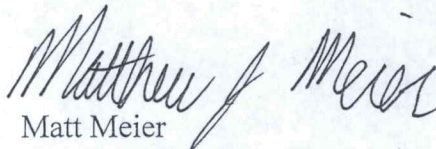

Matt Meier
Environmental Scientist
Water Appropriations Program

Enclosure

pc:

SCANNED

Kansas

Department of Agriculture
Division of Water Resources

Stafford Field Office
300 S. Main Street
Stafford, Kansas 67578-1521
Jackie McClaskey, Secretary
David W. Barfield, Chief Engineer
Jeff Lanterman, Water Commissioner

Phone: (620) 234-5311
Fax: (620) 234-6900
www.agriculture.ks.gov
Sam Brownback, Governor

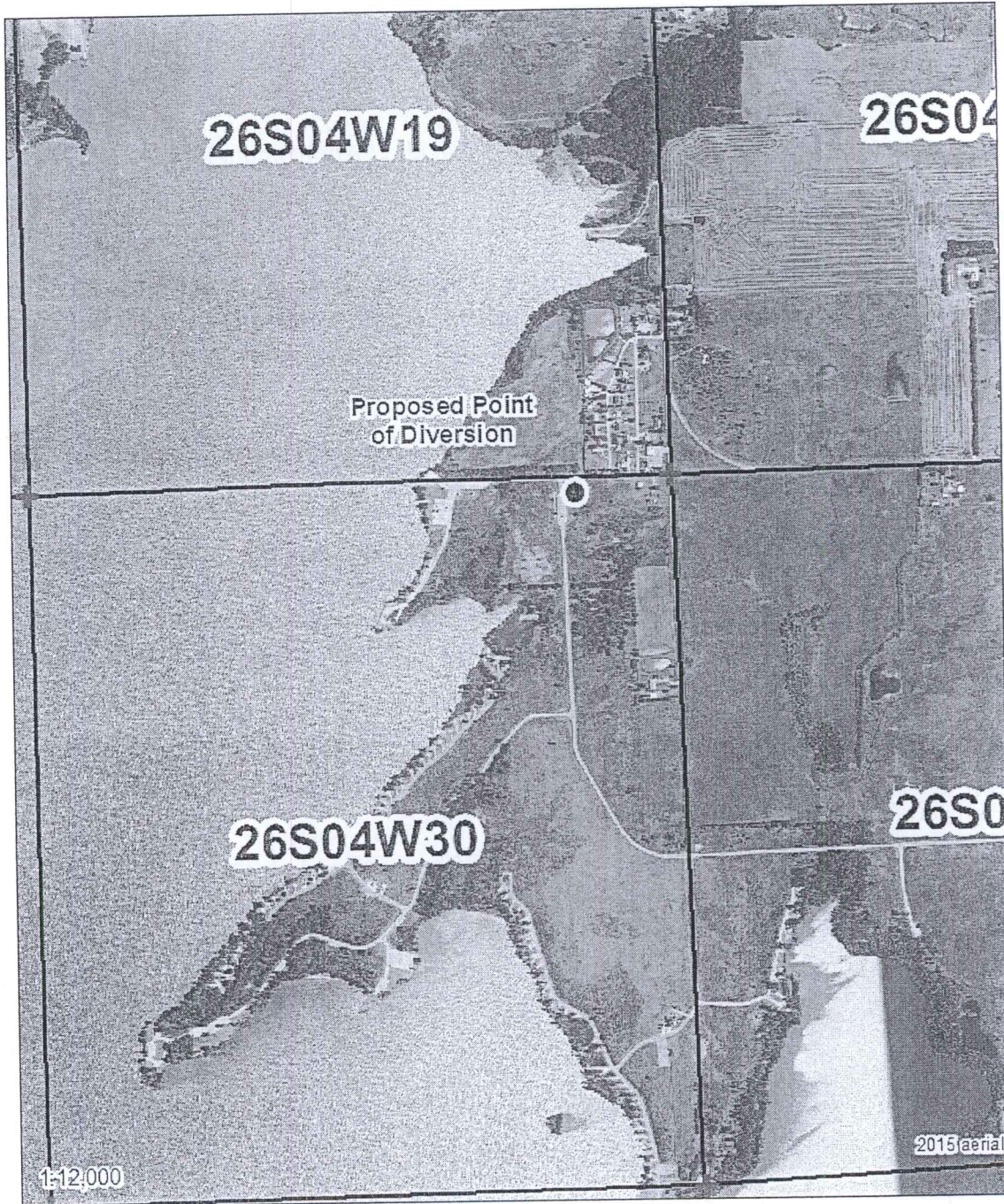

Legend

- + Section Corners
- ▭ Section Lines

MJM-DWR 5/25/17

Proposed Water Appropriation, File No. 49,728
30-26S-4W
Reno County



Kansas
Department of Agriculture
Division of Water Resources

Stafford Field Office
300 S. Main Street
Stafford, Kansas 67578-1521
Jackie McClaskey, Secretary
David W. Barfield, Chief Engineer
Jeff Lanterman, Water Commissioner

Phone: (620) 234-5311
Fax: (620) 234-6900
www.agriculture.ks.gov
Sam Brownback, Governor

May 26, 2017

Rhonda Kane Living Trust
25719 S Willison Rd
Mount Hope, KS 67108

Re: Pending Application, File No. 49,728

Dear Sir or Madam:

This is to advise you that the Kansas Department of Wildlife, Parks, & Tourism has filed the application referred to above for a permit to appropriate 2 million gallons of groundwater per calendar year for municipal use to be diverted at a maximum rate of 99 gallons per minute. The proposed point of diversion for 49,728 is one (1) well, which located as follows:

In the Northeast Quarter of the Northeast Quarter of the Northeast Quarter of Section 30, Township 26 South, Range 4 West, Reno County, Kansas.

A map is enclosed indicating the location of the proposed well. Records in this office indicate that you may have a well or wells in this vicinity and you are notified of receipt of this application in order that you may be fully informed of the proposed location of the applicant's point of diversion and proposed use of water. Consideration will be given to comments or other information which you desire to submit to this office **within 15 days** from the date of this letter.

If you have any questions or comments, you may also contact me at (620) 234-5311. If you call, please reference the file number so I can help you more efficiently. Mailed comments can be sent to the Stafford Field Office at 300 S. Main St. Stafford, KS 67578-1521.

Sincerely,

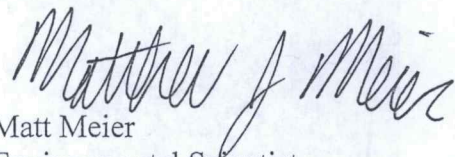

Matt Meier
Environmental Scientist
Water Appropriations Program

Enclosure

pc:

SCANNED

Kansas

Department of Agriculture
Division of Water Resources

Stafford Field Office
300 S. Main Street
Stafford, Kansas 67578-1521
Jackie McClaskey, Secretary
David W. Barfield, Chief Engineer
Jeff Lanterman, Water Commissioner

Phone: (620) 234-5311
Fax: (620) 234-6900
www.agriculture.ks.gov
Sam Brownback, Governor

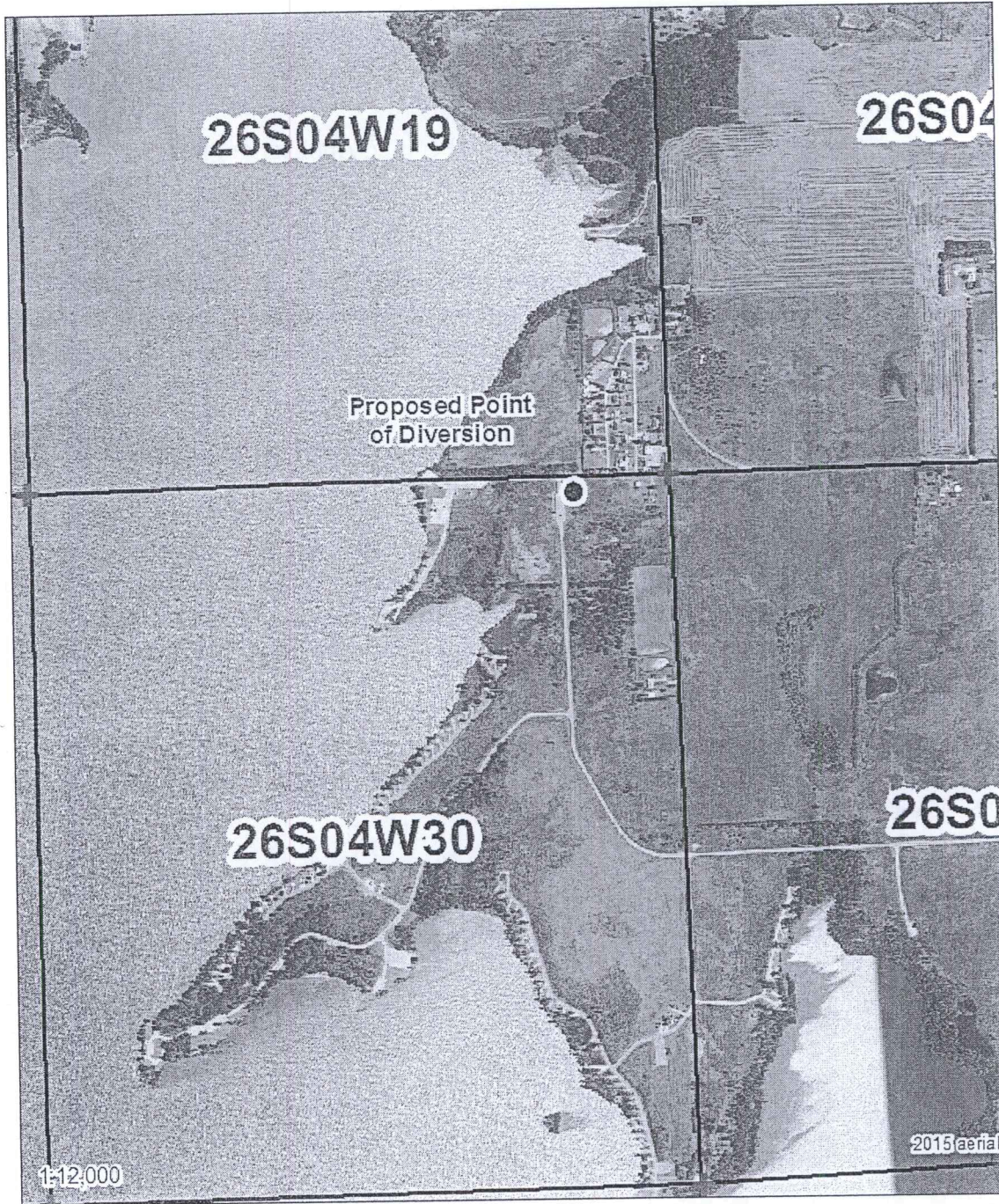

Legend

- Section Corners
- Section Lines

MJM-DWR 5/25/17

Proposed Water Appropriation, File No. 49,728
30-26S-4W
Reno County



Kansas
Department of Agriculture
Division of Water Resources

Stafford Field Office
300 S. Main Street
Stafford, Kansas 67578-1521
Jackie McClaskey, Secretary
David W. Barfield, Chief Engineer
Jeff Lanterman, Water Commissioner

Phone: (620) 234-5311
Fax: (620) 234-6900
www.agriculture.ks.gov
Sam Brownback, Governor

May 26, 2017

Justin Falk
25110 S Willison Rd
Mount Hope, KS 67108

Re: Pending Application, File No. 49,728

Dear Sir or Madam:

This is to advise you that the Kansas Department of Wildlife, Parks, & Tourism has filed the application referred to above for a permit to appropriate 2 million gallons of groundwater per calendar year for municipal use to be diverted at a maximum rate of 99 gallons per minute. The proposed point of diversion for 49,728 is one (1) well, which located as follows:

In the Northeast Quarter of the Northeast Quarter of the Northeast Quarter of Section 30, Township 26 South, Range 4 West, Reno County, Kansas.

A map is enclosed indicating the location of the proposed well. Records in this office indicate that you may have a well or wells in this vicinity and you are notified of receipt of this application in order that you may be fully informed of the proposed location of the applicant's point of diversion and proposed use of water. Consideration will be given to comments or other information which you desire to submit to this office **within 15 days** from the date of this letter.

If you have any questions or comments, you may also contact me at (620) 234-5311. If you call, please reference the file number so I can help you more efficiently. Mailed comments can be sent to the Stafford Field Office at 300 S. Main St. Stafford, KS 67578-1521.

Sincerely,

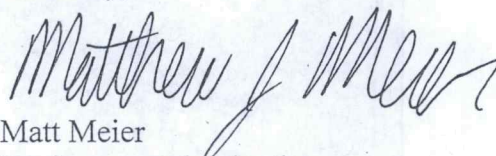

Matt Meier
Environmental Scientist
Water Appropriations Program

Enclosure

pc:

SCANNED

Kansas

Department of Agriculture
Division of Water Resources

Stafford Field Office
300 S. Main Street
Stafford, Kansas 67578-1521

Jackie McClaskey, Secretary
David W. Barfield, Chief Engineer
Jeff Lanterman, Water Commissioner

Phone: (620) 234-5311
Fax: (620) 234-6900
www.agriculture.ks.gov
Sam Brownback, Governor

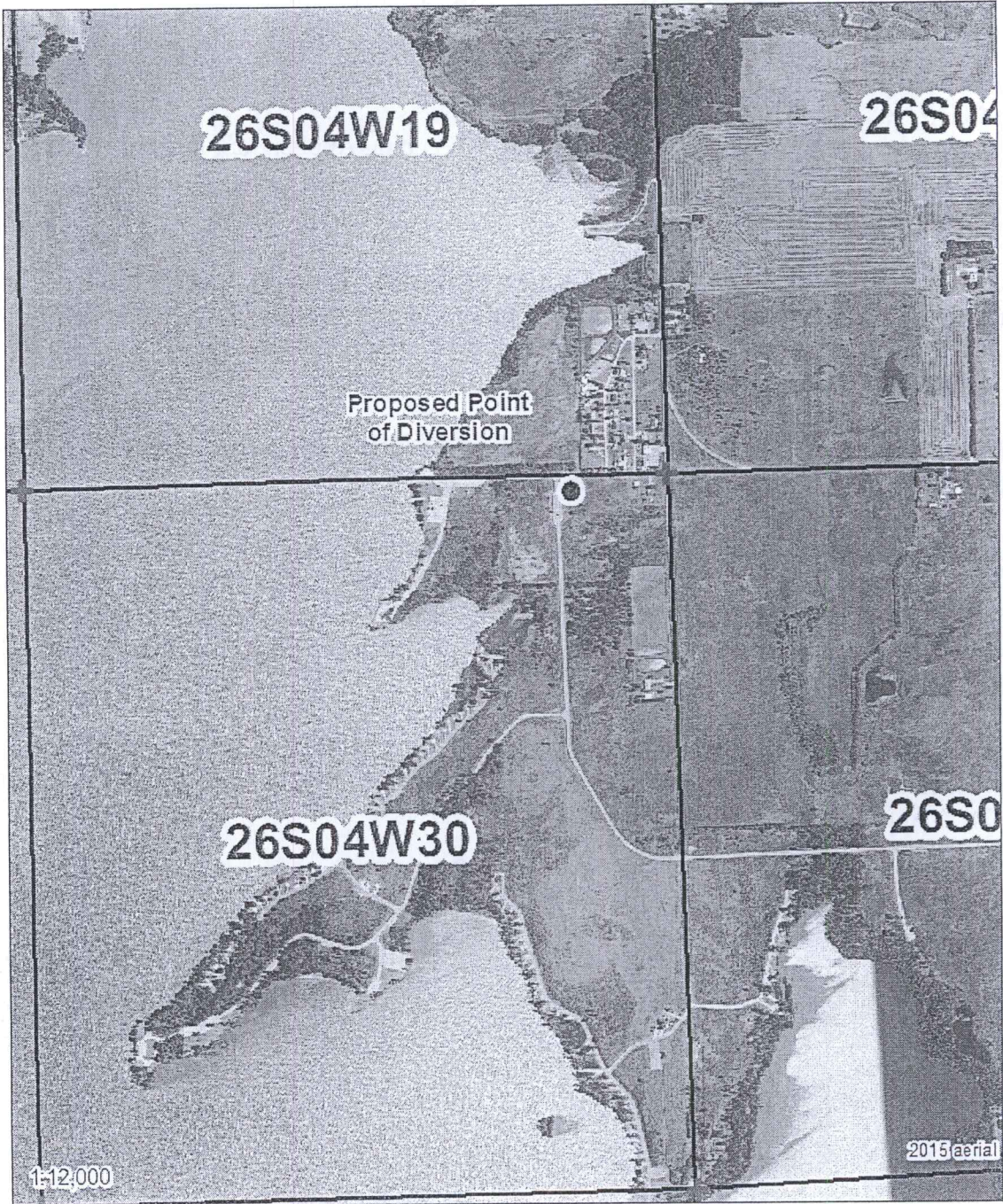

Legend

- Section Corners
- Section Lines

MJM-DWR 5/25/17

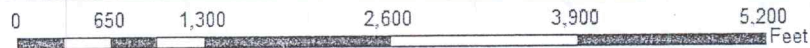

Proposed Water Appropriation, File No. 49,728
30-26S-4W
Reno County



SCANNED